

# Public Involvement

## US 8 Lustila Road to Tracy Road Price, Lincoln, and Oneida Counties

Project ID: 1580-30-00



**Public Comment Period:  
June 12, 2020 to July 1, 2020**

An in-person Public Involvement Meeting (PIM) is no longer being held based on public health guidance to limit public gatherings.

The Wisconsin Department of Transportation continues to review prioritization and potential alternatives for public meetings and events.

This handout and other meeting items are available on the design website at:  
<https://wisconsindot.gov/Pages/projects/by-region/nc/us8price/default.aspx>

Thank you for your interest in this project. We look forward to your feedback.

The Wisconsin Department of Transportation (WisDOT) has an improvement project on US 8 between Lustila Road and Tracy Road in Price, Lincoln and Oneida counties. As part of the project, WisDOT is proposing to close two US 8 intersections. This handout will focus on the two intersections.

Our objective is to obtain your input regarding proposed improvements on US 8 at two intersections. The proposed improvements being considered are:

- Close the intersection at Tripoli Drive and eliminate the railroad crossing
- Close the intersection at Short Road and eliminate the railroad crossing

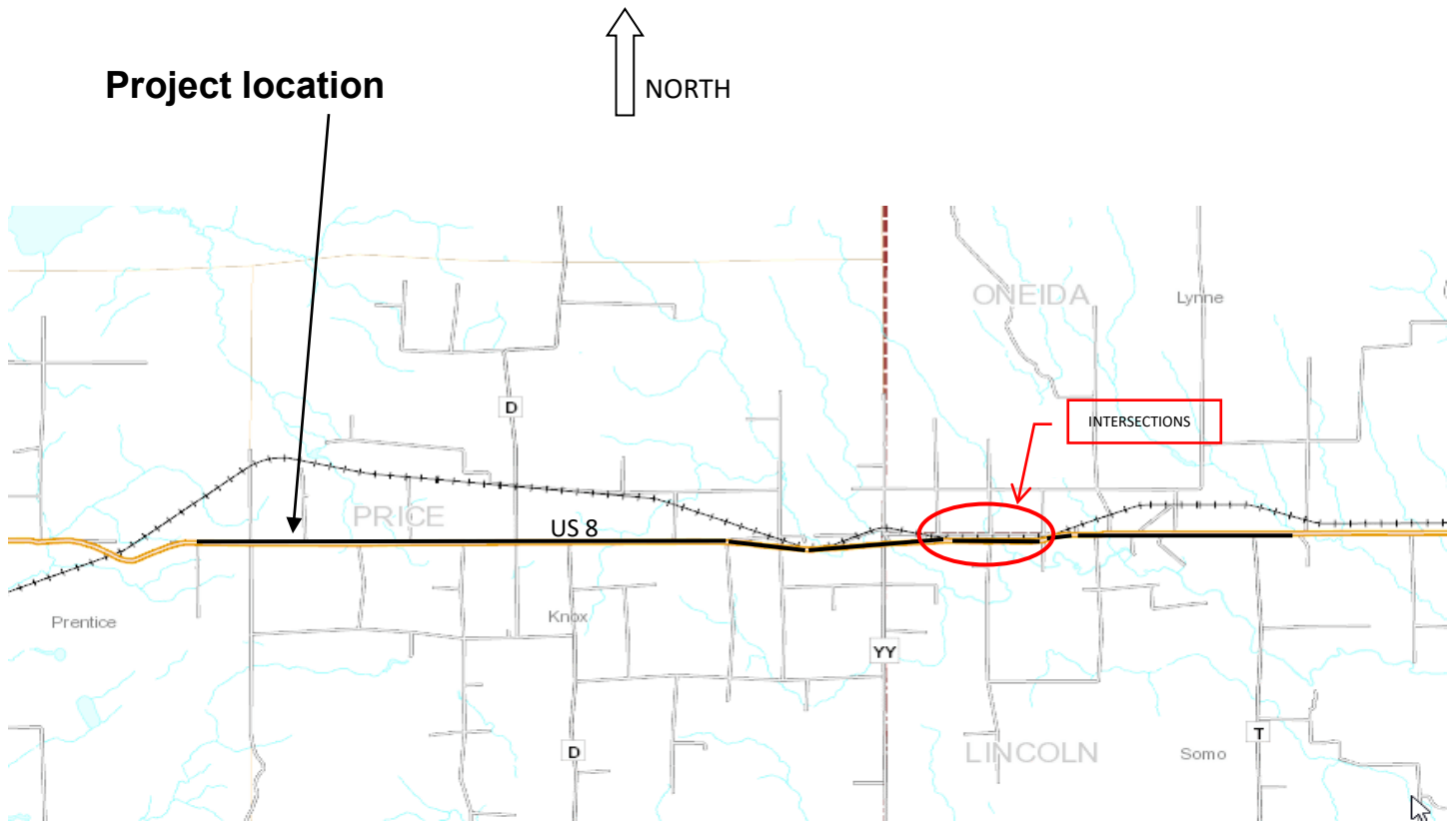

## **Purpose and need for roadway improvements**

### **Tripoli Drive intersection**

As the rail road (RR) crossing is near US 8, Federal Regulations requires evaluation of warning devices. The crossing is at a skewed angle on a curved roadway. This geometry creates an unusually restrictive sight distance resulting in need for RR crossing signals and gates estimated at \$300,000. The safety, signal cost, access to other local roads and low population density challenges the need for the Tripoli Drive intersection to remain open.

### **Short Road intersection**

Short road has a similar situation as the Tripoli Drive intersection. The RR crossing is further from US 8, so evaluation of warning devices is not required. The crossing is at a skewed angle on a curved highway and creates an unusually restrictive sight distance. The trees and high ground also restrict sight distance. The safety, access to other local roads and low population density challenges the need for the Short Road intersection to remain open.

## **Proposed improvements**

- Close the intersection at Tripoli Drive and eliminate the railroad crossing
- Close the intersection at Short Road and eliminate the railroad crossing

## **Proposed traffic impacts**

US 8 construction is currently scheduled for construction in 2024 but could be constructed as early as 2022.

If the intersections are closed, side road traffic would not have access to US 8 at Short Road nor at Tripoli Drive. The handout shows a map of the alternate travel routes and average travel times.

## **Real estate**

Additional right of way may be required for closing the intersections.

## **Current project schedule**

- Local Officials Meeting March 18, 2015, June 10, 2019 and May 6, 2020
- Public Involvement Meeting September 20, 2019 and June 12, 2020
- Complete Environmental Document March 2021
- Final design completed August 2021
- Construction currently scheduled 2024
- Construction early schedule 2022

## Project design website

Access the following materials on the project design website:

<https://wisconsin.dot.gov/Pages/projects/by-region/nc/us8price/default.aspx>

- This handout
- Project Location Map
- Map showing travel times with proposed closures
- Information on Landowner Rights

## Public input/comments

Please forward your comments/input by **July 1, 2020** using one of the following methods:

- Fill out the comment form attached to this document and mail it to WisDOT
- Complete the fillable online survey on the project website
- E-mail comments or questions to the contact listed below

Your comments assist us in developing a project that will serve the needs of the traveling public as well as the needs of the local community. Your input is welcome and appreciated throughout the design process. For more information, please contact:

Jesse Jefferson, PE  
Wisconsin Department of Transportation  
510 N Hanson Lake Road  
Rhineland, WI 54501  
715-365-5714  
[jesse.jefferson@dot.wi.gov](mailto:jesse.jefferson@dot.wi.gov)

# Public Involvement Meeting Comment Form

Project ID 1580-30-00  
Prentice - Bradley  
Lustila Road to Tracy Road  
Price, Lincoln and Oneida Counties

June 12, 2020

Please place this form in the mail by **July 1, 2020** to the address on the back of this sheet. Comments can also be e-mailed to Jesse.Jefferson@dot.wi.gov. Your comments assist us in developing a project that will serve the needs of the traveling public as well as the needs of the local community. Your input is welcome and appreciated throughout the design process.

Name: \_\_\_\_\_

Address: \_\_\_\_\_

Daytime Phone Number (optional): \_\_\_\_\_

Email Address (optional): \_\_\_\_\_

Please Print Comments (attach additional sheets if necessary)

---

---

---

---

---

---

---

---

---

---

---

---

---

---

---

---

---

---

---

---

---

---

---

---

*The information in this document including names, addresses, phone numbers, e-mail addresses, and signatures is not confidential, and may be subject to disclosure upon request, pursuant to the requirements of the Wisconsin open records law, sections 19.31 - 19.39 of the Wisconsin Statutes.*

Fold here

---

[Stamp]

Wisconsin Department of Transportation

510 N Hanson Lake Road

Rhineland, WI 54501

Attn: Jesse Jefferson

---

Fold here and staple to mail