



WIS 25 Proposed Improvements Buffalo & Pepin Counties

WisDOT Project ID:7170-00-06

**Bryan Lipke, P.E.
WisDOT Project Manager**

September 2021

WIS 25 improvements – Tell us what you think

The Wisconsin Department of Transportation (WisDOT) is seeking public feedback on proposed improvements for WIS 25 in Buffalo and Pepin County. The purpose of this outreach is to obtain your input on the identified needs and proposed design details. We appreciate your input and encourage you take a moment to review the project information and provide comment.

- Project Staff

- Project Manager – Bryan Lipke, P.E., WisDOT
- Project Supervisor – Daniel Segerstrom, P.E., WisDOT
- Consultant Designer – Ashley Nelson, P.E., ISG

- Project Design Website

- <https://wisconsindot.gov/Pages/projects/by-region/nw/WIS25pepin/default.aspx>



Improvement Presentation Agenda

WisDOT provided this presentation to local officials on Sept. 13, 2021

- 1) Project Location
- 2) Project Overview
- 3) Review of Public Involvement Materials
- 4) Upcoming Schedule
- 5) Traffic Control and Construction Staging
- 6) Local Officials Concerns & Comments



Project Overview – Project Location

The Wisconsin Department of Transportation (WisDOT) is planning pavement resurfacing for 13.6 miles of WIS 25 in Buffalo and Pepin County.

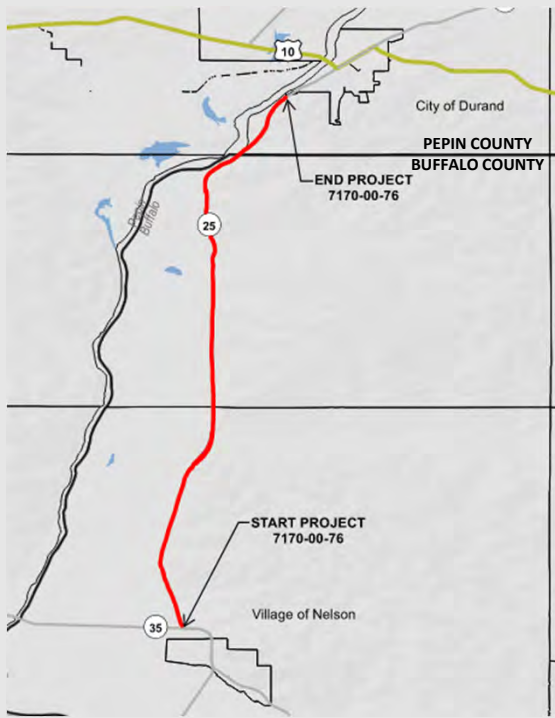

Begin Project Location
60 Feet North of WIS 35

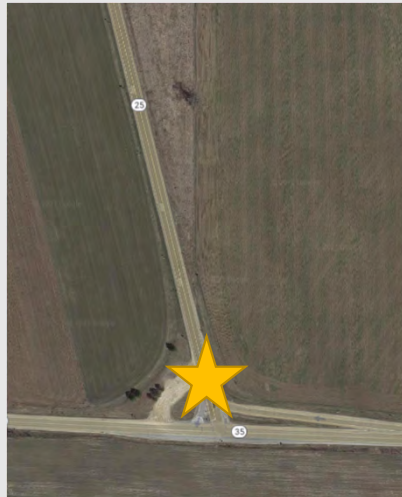

End Project Location
200 Feet North of Pleasant Ridge Rd

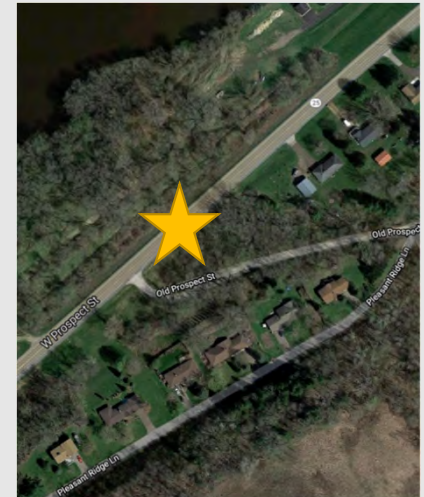

Project Overview - Purpose and Need

The purpose of the project is to address the deterioration of the existing roadway.

Project Needs:

- New asphaltic surface
- Culvert replacements
- Culvert/ditch cleaning
- Adjusting beamguard
- Grading at beamguard energy absorbing terminals
- Concrete surface repair of box culvert



Project Overview - Alternatives Considered

Alternative 1 - No Build

Maintain the existing facility with no improvements other than routine maintenance.

★ Alternative 2 – Rehabilitation

Mill the existing asphalt pavement, place an overlay of new asphaltic pavement, and perform spot beamguard adjustments and grading, cleaning or replacing under functioning culvert pipes.

Alternative 3 – Reconstruction

Replace the entire depth of pavement and base course, culvert pipes, beamguard, and signs. Widening would occur to meet current clear zone and shoulder standards which would require purchasing of right of way.



Project Overview – Proposed Improvement

- Mill the existing asphalt pavement 3.5-inches and overlay with 3.75-inches new Hot Mix Asphalt pavement, raising the roadway 0.25 inches
- Adjusting beamguard and grading at end terminals to current standards
- Cleaning culvert pipes, replacing culvert pipes, and cleaning and grading ditches to improve drainage
- Spot concrete surface repair on box culvert
- Centerline and shoulder rumble strips
- No real estate anticipated

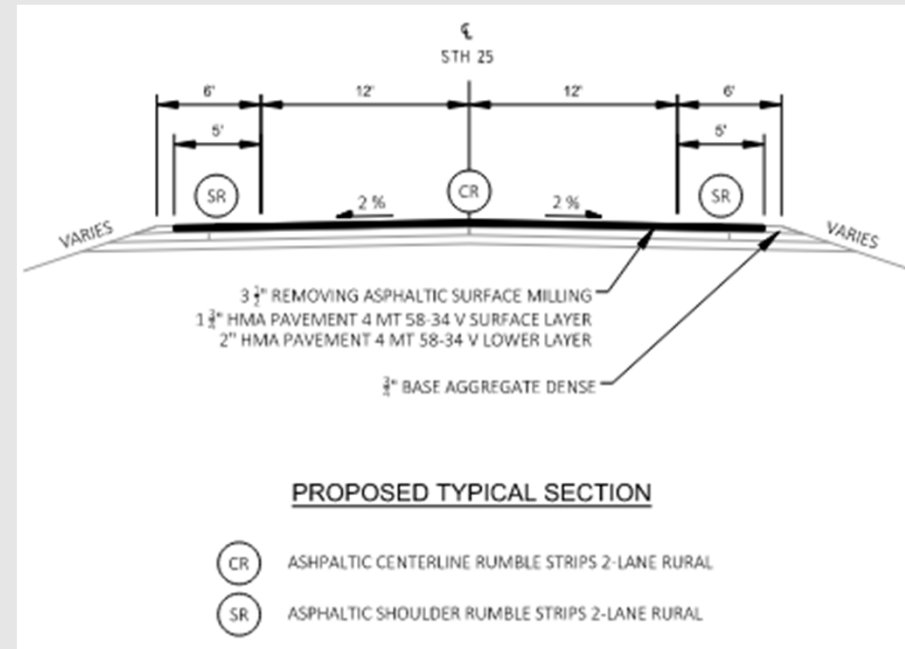

Project Overview – Environmental Awareness

- Potential wetland impacts at culverts
- Bald Eagles – known active nest(s) in area
 - Construction restricted from January 15 through July 31
- State Natural Areas
 - Tiffany Wildlife Area and the Lower Chippewa River State Natural Area
- Other species of concern:
 - Eastern Massasauga
 - Kentucky Warbler
 - Avoidance period May 20 through August 10
 - Red-shouldered Hawk
 - Avoidance period April 1 through July 31



Review of Public Involvement Material

- Public Involvement Mailer

- Project Notification Letters including Project Maps were sent to all property owners August 26, 2021
- Comment period is open until September 30, 2021

- Public Involvement Handout

- In this meeting invite we have included the Public Involvement handout that contains details that we are providing in today's meeting
- This handout is also located on the project website: <https://wisconsin.gov/Pages/projects/by-region/nw/WIS25pepin/default.aspx>
- Comment forms are located at the back of the handout for use as well as contact information

- Project Exhibits

- See plan sent in the invite for proposed typical section and project overview that were presented in the previous slides



Traffic Control and Construction Staging

- During construction, motorists can expect single lane closures and flagging operations
 - Culvert replacements will be completed half at a time under single lane closure
 - Driveways will be accessible at all times
 - Advanced notification will be given for temporary disruptions to access due to milling and paving operations
- Construction currently planned for summer 2024



Upcoming Schedule

- September 13, 2021: Local officials meeting held.
- Now until September 30, 2021: Public comment submission.
- October 1, 2021: Final environmental document submission
- August 1, 2023: Final plans, specifications and estimates submission.
- 2024: Summer Construction.



Business Coordination

We're In This Together!

- Visit wisconsin.gov/together
 - Tips, tools and resources
 - New (2021) business coordination guide
- Project team is here to help
 - What information would help you...
 - Inform customers about the project?
 - Coordinate with suppliers?
 - Communicate with employees?

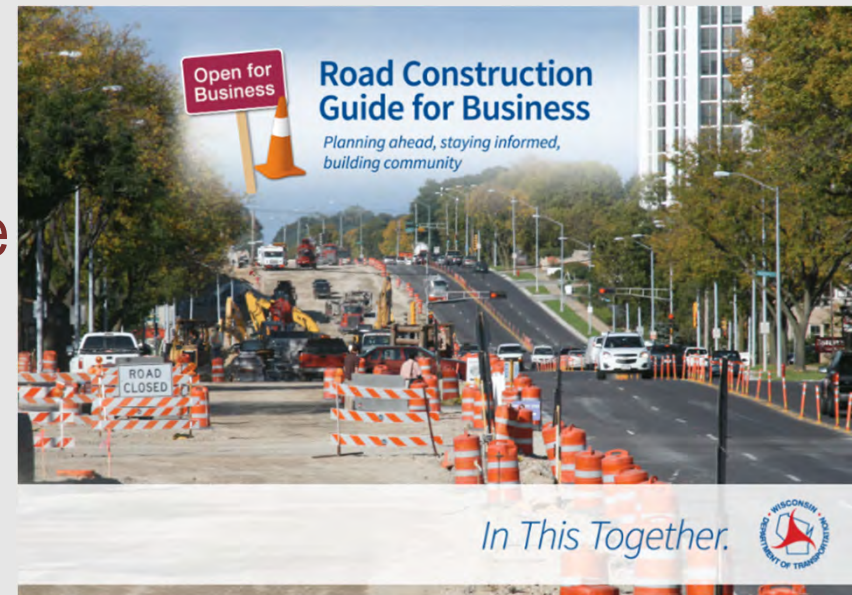

How to Provide Comments and/or Ask Questions

- Email or call:
Bryan Lipke, P.E.
WisDOT Project Manager
bryan.lipke@dot.wi.gov
(920) 492-5703
- Use the comment form provided on the project website. Mail to the address provided on the back of the form:
Wisconsin Department of Transportation
Attn. Bryan Lipke (WIS 25 Buffalo & Pepin Counties)
944 Vanderperren Way
Green Bay, WI 54304

