

PROJECT ID: 7180-00-77

COUNTY: PEPIN

ORDER OF SHEETS

Section No.	Title
1	Typical Sections and Details
2	Estimate of Quantities
3	Miscellaneous Quantities
4	Right of Way Plat
5	Plan and Profile
6	Standard Detail Drawings
7	Sign Plates
8	Structure Plans
9	Computer Earthwork Data
9	Cross Sections

TOTAL SHEETS =

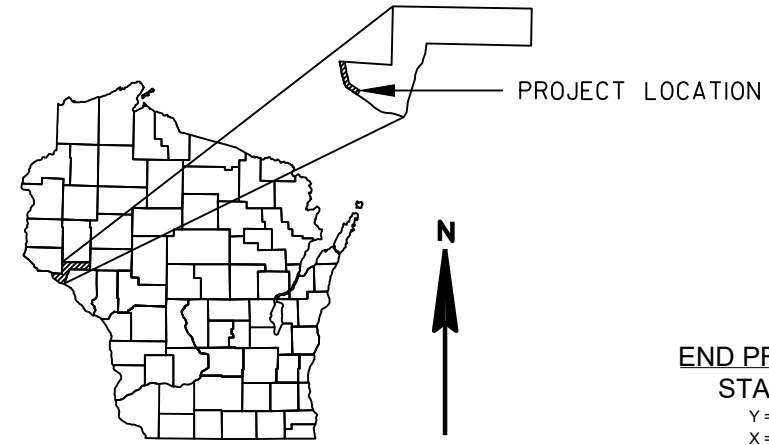

# STATE OF WISCONSIN DEPARTMENT OF TRANSPORTATION

PLAN OF PROPOSED IMPROVEMENT

## PEPIN - HAGER CITY

WALNUT ST TO PEPIN/PIERCE COUNTY LINE

STH 35  
PEPIN COUNTY

STATE PROJECT NUMBER  
**7180-00-77**

STATE PROJECT	FEDERAL PROJECT	
	PROJECT	CONTRACT
7180-00-77		

DESIGN DESIGNATION STH 35

A.A.D.T. 2026	=	1,580
A.A.D.T. 2046	=	1,820
D.H.V.	=	XX%
D.D.	=	50/50
T.	=	16.10%
DESIGN SPEED	=	60 MPH
ESALS	=	440,000

CONVENTIONAL SYMBOLS

PLAN	PROFILE
CORPORATE LIMITS	GRADE LINE
PROPERTY LINE	ORIGINAL GROUND
LOT LINE	MARSH OR ROCK PROFILE (To be noted as such)
LIMITED HIGHWAY EASEMENT	SPECIAL DITCH
EXISTING RIGHT OF WAY	GRADE ELEVATION
PROPOSED OR NEW R/W LINE	CULVERT (Profile View)
SLOPE INTERCEPT	UTILITIES
REFERENCE LINE	ELECTRIC
EXISTING CULVERT	FIBER OPTIC
PROPOSED CULVERT (Box or Pipe)	GAS
COMBUSTIBLE FLUIDS	SANITARY SEWER
MARSH AREA	STORM SEWER
WOODED OR SHRUB AREA	TELEPHONE
	WATER
	UTILITY PEDESTAL
	POWER POLE
	TELEPHONE POLE

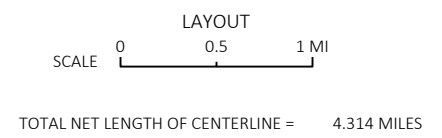
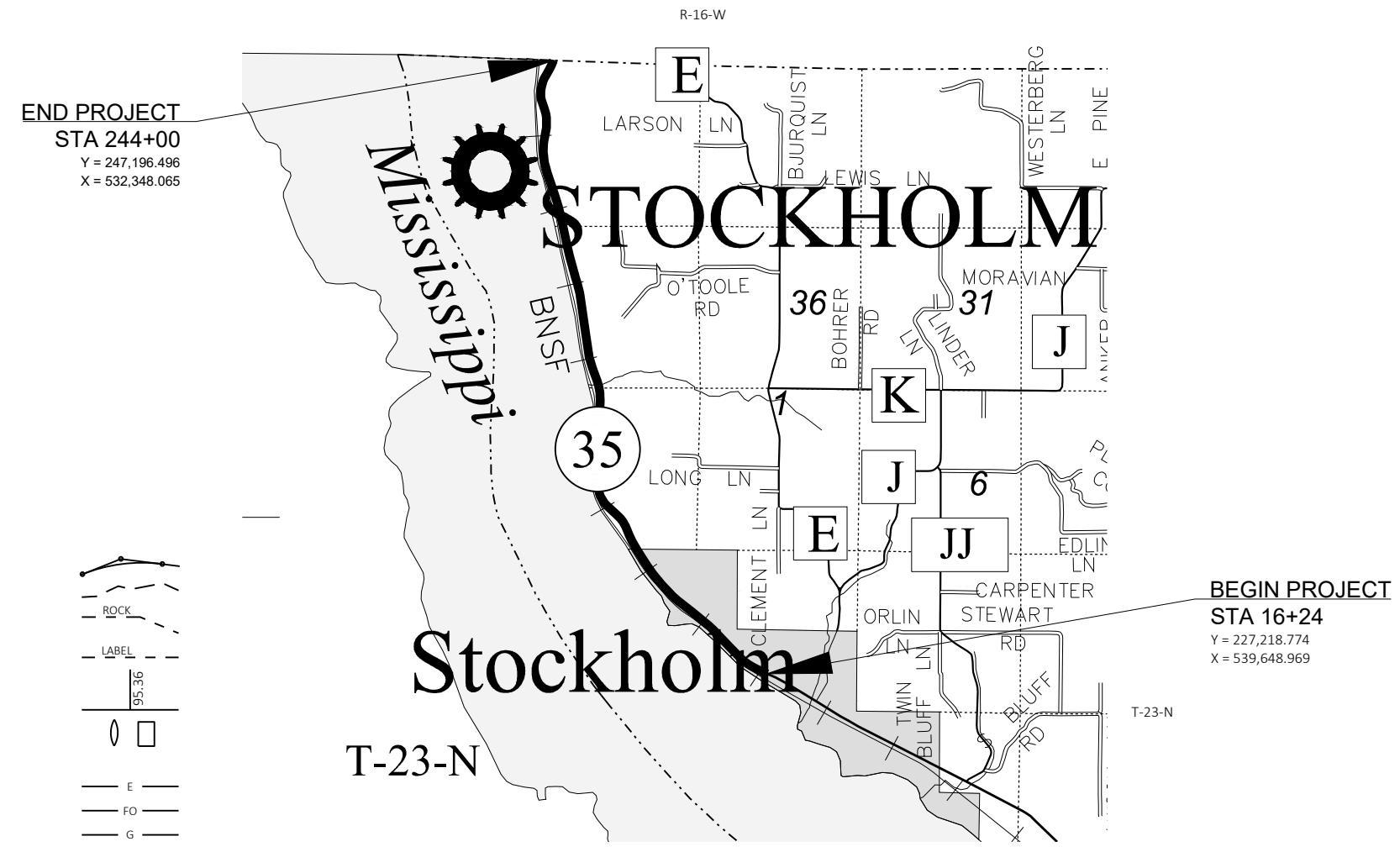

HORIZONTAL POSITIONS SHOWN ON THIS PLAN ARE WISCONSIN COORDINATE REFERENCE SYSTEM (WISCRS), PEPIN COUNTY, NAD83 (2011), IN U.S. SURVEY FEET. POSITIONS SHOWN ARE GRID COORDINATES, GRID BEARINGS, AND GRID DISTANCES. GRID DISTANCES ARE THE SAME AS GROUND DISTANCES. ELEVATIONS ARE REFERENCED TO NAVD 88 (2012). GPS DERIVED ELEVATIONS ARE BASED ON GEOID 12A.

ORIGINAL PLANS PREPARED BY  
**KNIGHT**  
831 Critter Court  
Suite 400  
Onalaska, WI 54650  
Engineers & Architects Phone: (608) 519-1455

**PRELIMINARY  
PLANS NOT FOR  
CONSTRUCTION**

STATE OF WISCONSIN  
DEPARTMENT OF TRANSPORTATION

PREPARED BY  
Surveyor \_\_\_\_\_ KNIGHT E/A INC.  
Designer \_\_\_\_\_ KNIGHT E/A INC.  
Project Manager \_\_\_\_\_ BRYAN LIPKE  
Regional Examiner \_\_\_\_\_  
Regional Supervisor \_\_\_\_\_

APPROVED FOR THE DEPARTMENT  
DATE: \_\_\_\_\_ (Signature)

**E**



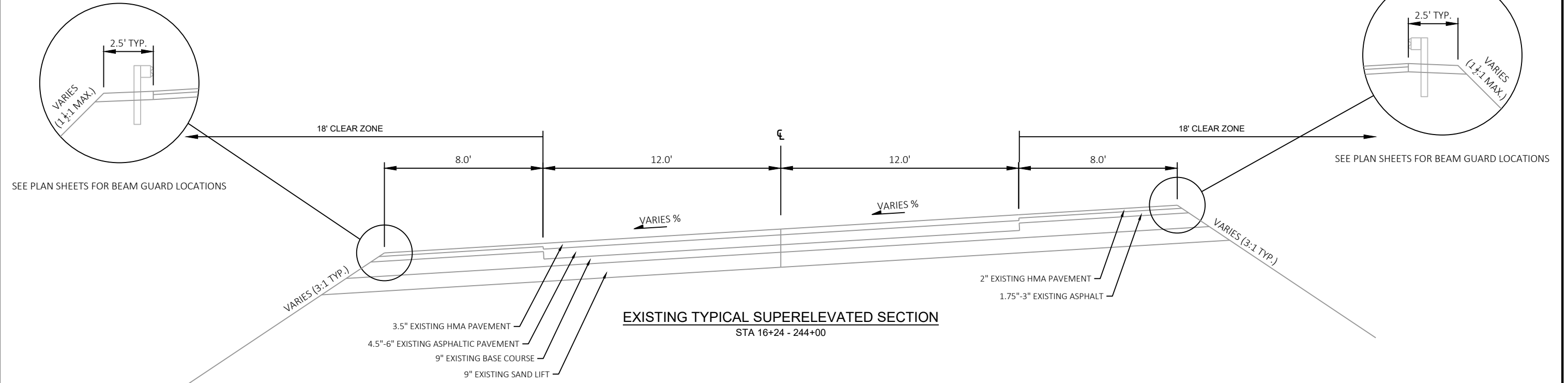
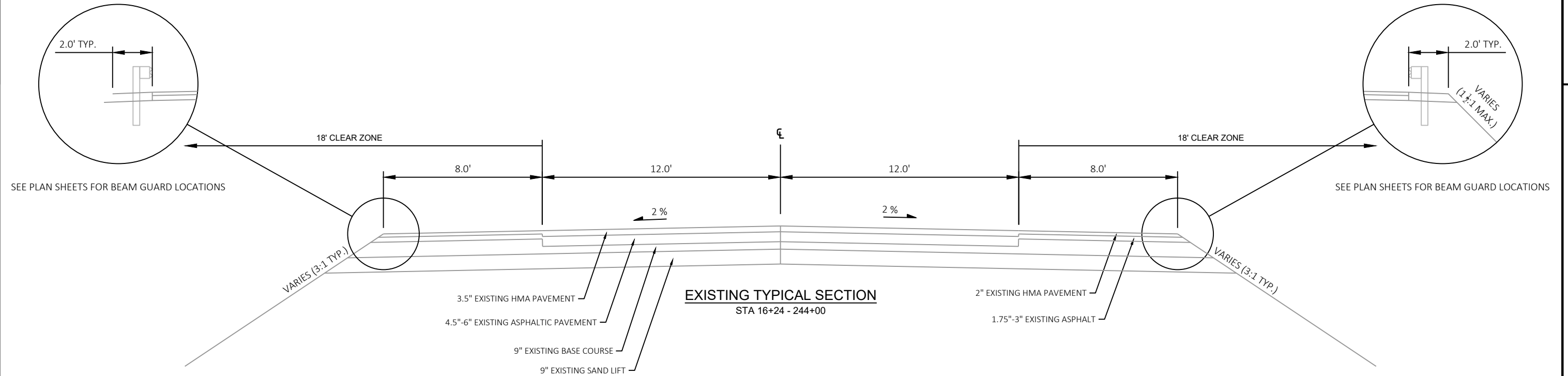



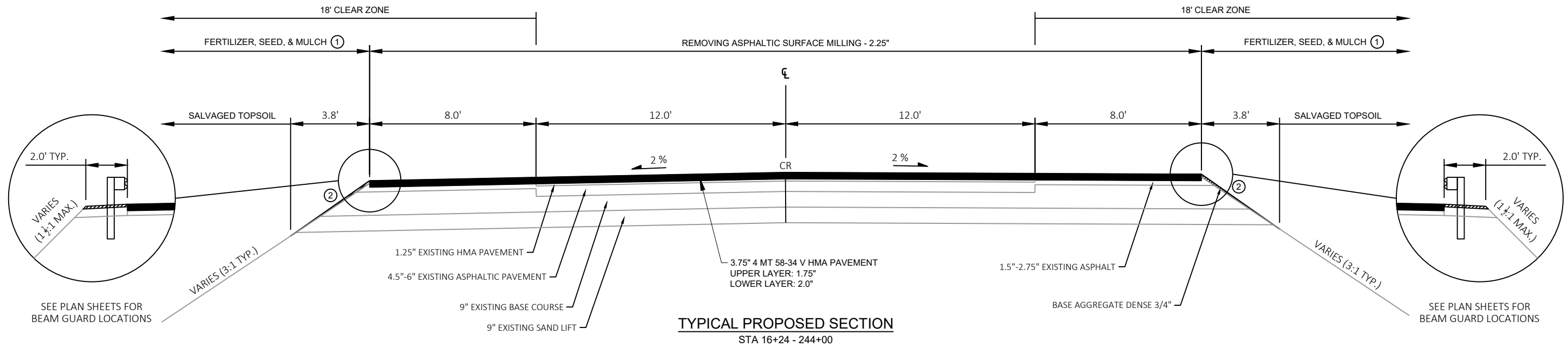

**TYPICAL PROPOSED SECTION**  
STA 16+24 - 244+00

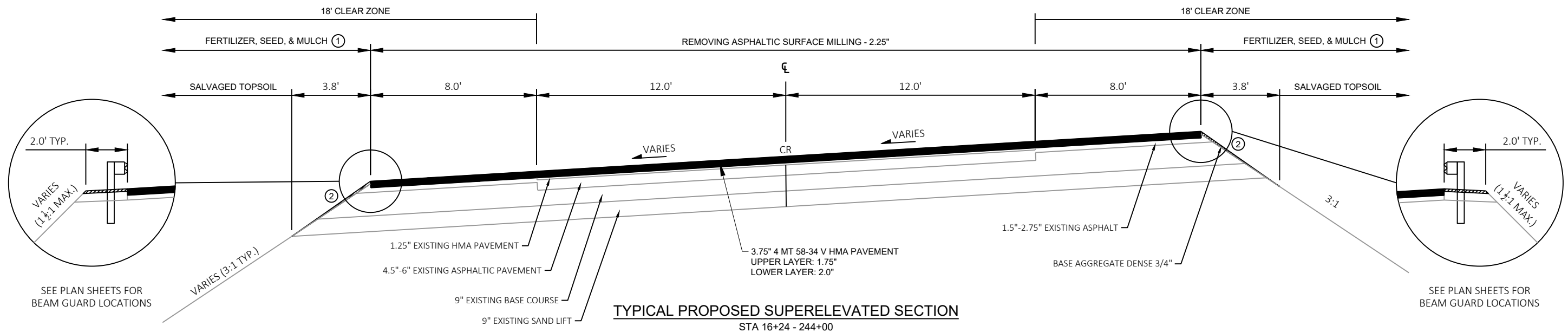

**TYPICAL PROPOSED SUPERELEVATED SECTION**  
STA 16+24 - 244+00

- ① RESTORATION ITEMS TO EXTEND 5-FT BEYOND DAYLIGHT OF SLOPE
- ② ROUND SHOULDERS TO MATCH EXISTING SLOPES

CR = CENTERLINE RUMBLE STRIPS

NOTES:

- SEE PLAN SHEETS FOR SUPERELEVATION LOCATIONS