

WIS 128, US 12 to WIS 170

St. Croix County

Public Involvement Meeting

Spring 2023

Project Contacts

- Lance Williston, P.E.
 - WisDOT Northwest Region Consultant Project Manager
- Jeff Smith, P.E.
 - Consultant Project Manager, Jewell Associates Engineers, Inc.
- Dave Koepp, P.E.
 - WisDOT Northwest Region Project Supervisor



Agenda

- Project Limits
- Purpose and Need
- Design Overview
- Construction Staging
- Recent Activities
- Schedule
- Contact Information



Project Limits

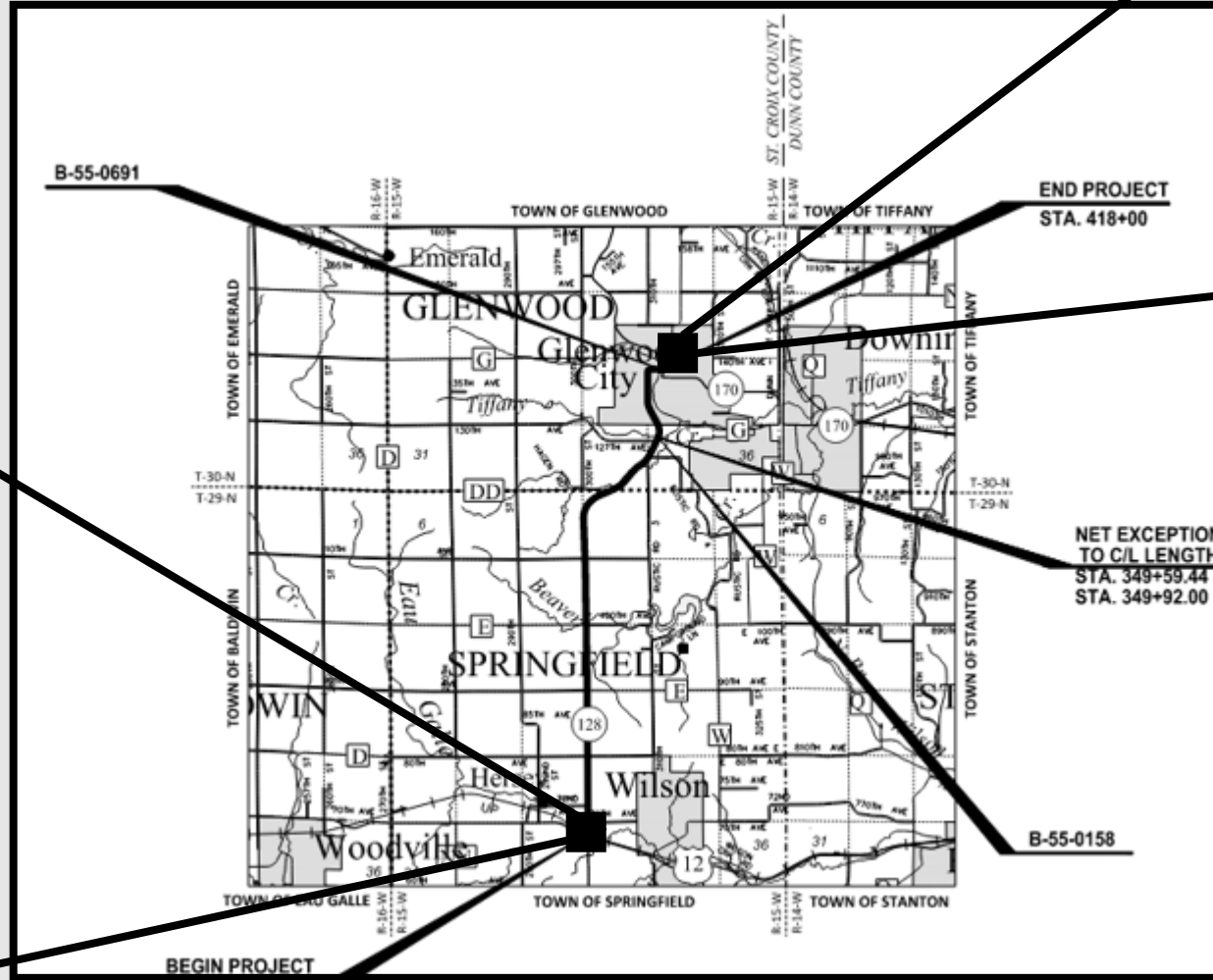

Purpose and Need

- Pavement distress



- Substandard guardrail



Design Overview

- Improving the pavement
 - Recycling 3.75 inches of pavement and paving 2.75 inches from US 12 to Glenwood City
 - Milling 3.25 inches of pavement and paving 3.25 inches in Glenwood City
- Replacing guardrail
- Cleaning or replacing existing culvert pipes
- Replacing sidewalk curb ramps
- Placing centerline rumble strips and pavement markings
- Overlaying the deck of the bridge in Glenwood City



Design Overview

Typical Sections of WIS 128

- Rural

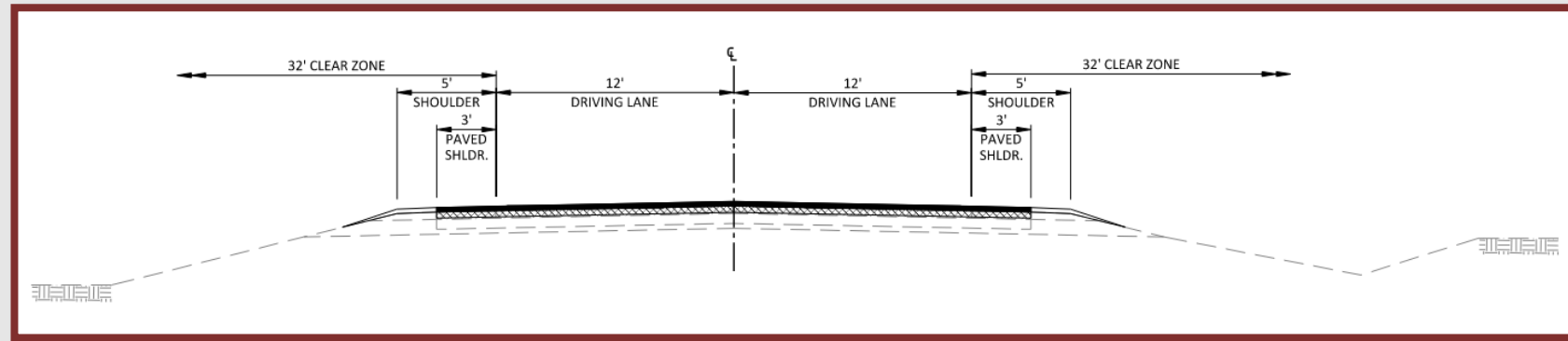

- Urban

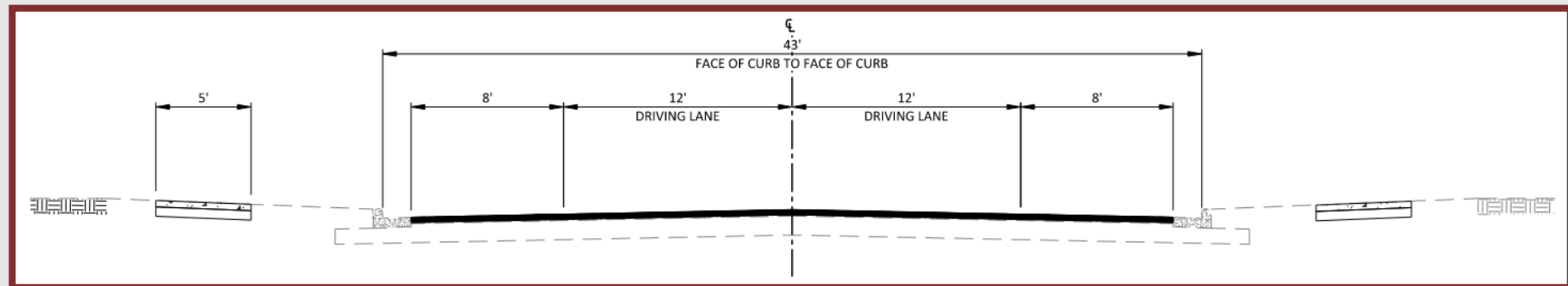

Construction Staging

- Impacts in rural area (US 12 to Glenwood City)
 - Paving and grading operations will result in single-lane closures controlled by flagging.
 - Culvert pipe replacement will result in short-term closure of the road, with traffic being detoured.
 - Guardrail replacement will result in shoulder closures.



Construction Staging

- Impacts in urban area (Glenwood City)
 - Paving operations will result in single-lane closures controlled by flagging.
 - Bridge work might result in the structure being open to a single lane of traffic controlled by temporary traffic signals.
 - Curb ramp replacement will result in sidewalk closures and a pedestrian detour.



Recent Activities

- 2021
 - Survey completed
- 2022
 - Initial agency coordination completed.
 - Preliminary plans completed.
 - Draft environmental document completed.



Schedule

- Environmental report signed
- Final plan submittal
- Construction

July 2023

August 2025

Spring 2026



Contact Information

- By email or phone:
 - Lance Williston, P.E.
lwilliston@klengineering.com
(608) 663-1218
 - Jeff Smith, P.E.
jeff.smith@jewellassoc.com
(608) 459-6091
 - Dave Koepp
david.koepp@dot.wi.gov
(715) 563-8402
- By mail:
 - Wisconsin Department of Transportation
718 W. Clairemont Ave.
Eau Claire, WI 54701
Attn.: Dave Koepp

Thank you for your time!

