



**Existing Wikdal Park**

**4.5' to 7.5' wide TLE  
(Temporary Limited  
Easement) for grading work.**

**New right of way  
(Approximately 8" wide strip)  
along south side of park.**

**New right of way  
(triangle area) for  
new pedestrian  
ramp.**

**Sidewalk to be replaced.**

**Anticipated limits of grading.**

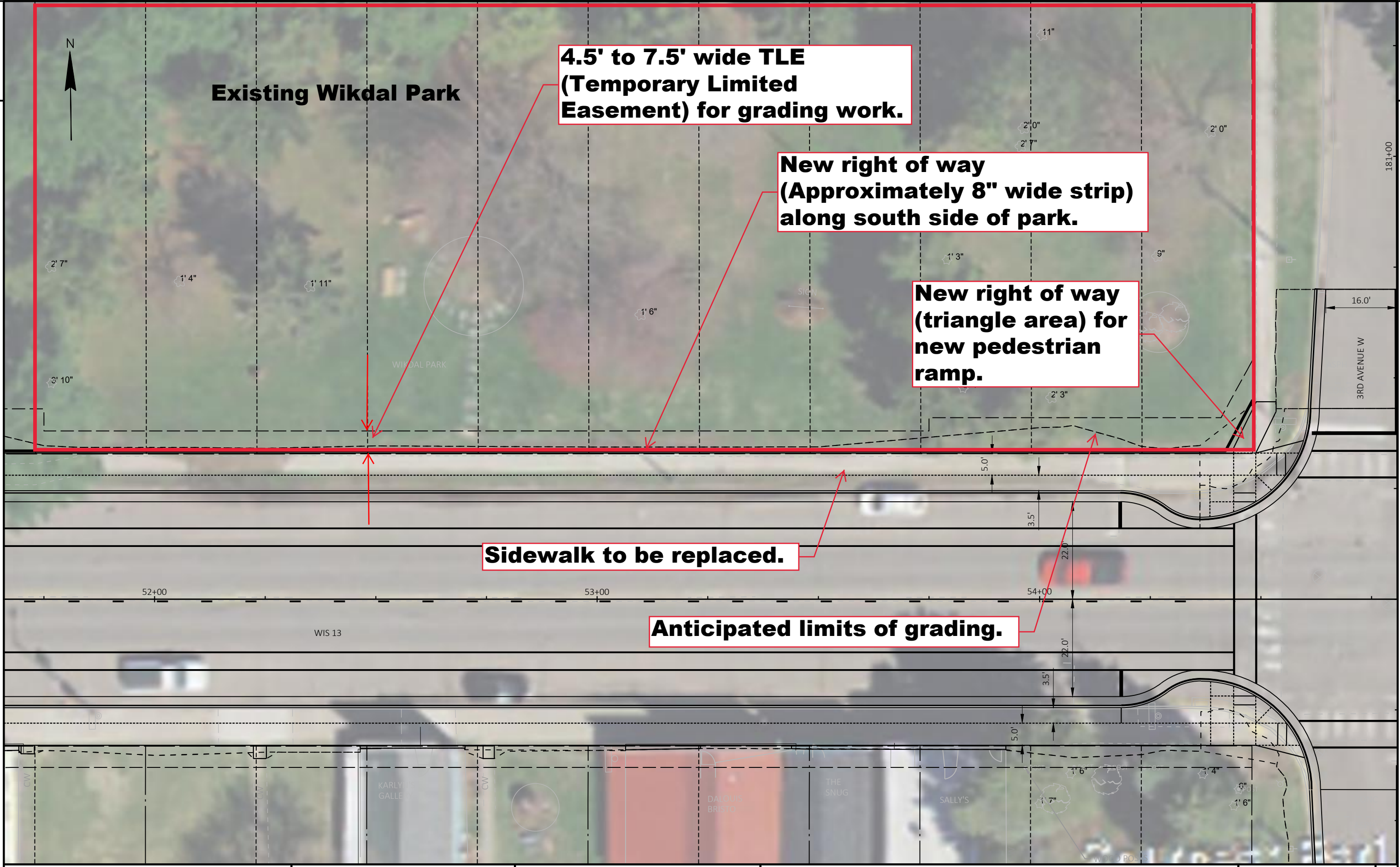

PROJECT NO: 8160-00-75	HWY: WIS 13	COUNTY: BAYFIELD	INTERSECTION DETAIL - 3RD AVENUE W	SHEET	<b>E</b>
------------------------	-------------	------------------	------------------------------------	-------	----------

Washburn, Wisconsin  
Google Street View  
Aug 2009 See more dates

**Approximate 4.5' to 7.5' TLE  
(Temporary Limited  
Easement) for sidewalk  
grading/grass blending.**

**Approximate location of  
8" new right of way  
strip along park south  
side for sidewalk.**

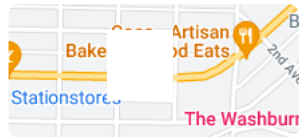

Washburn, Wisconsin  
Google Street View  
Aug 2009 See more dates

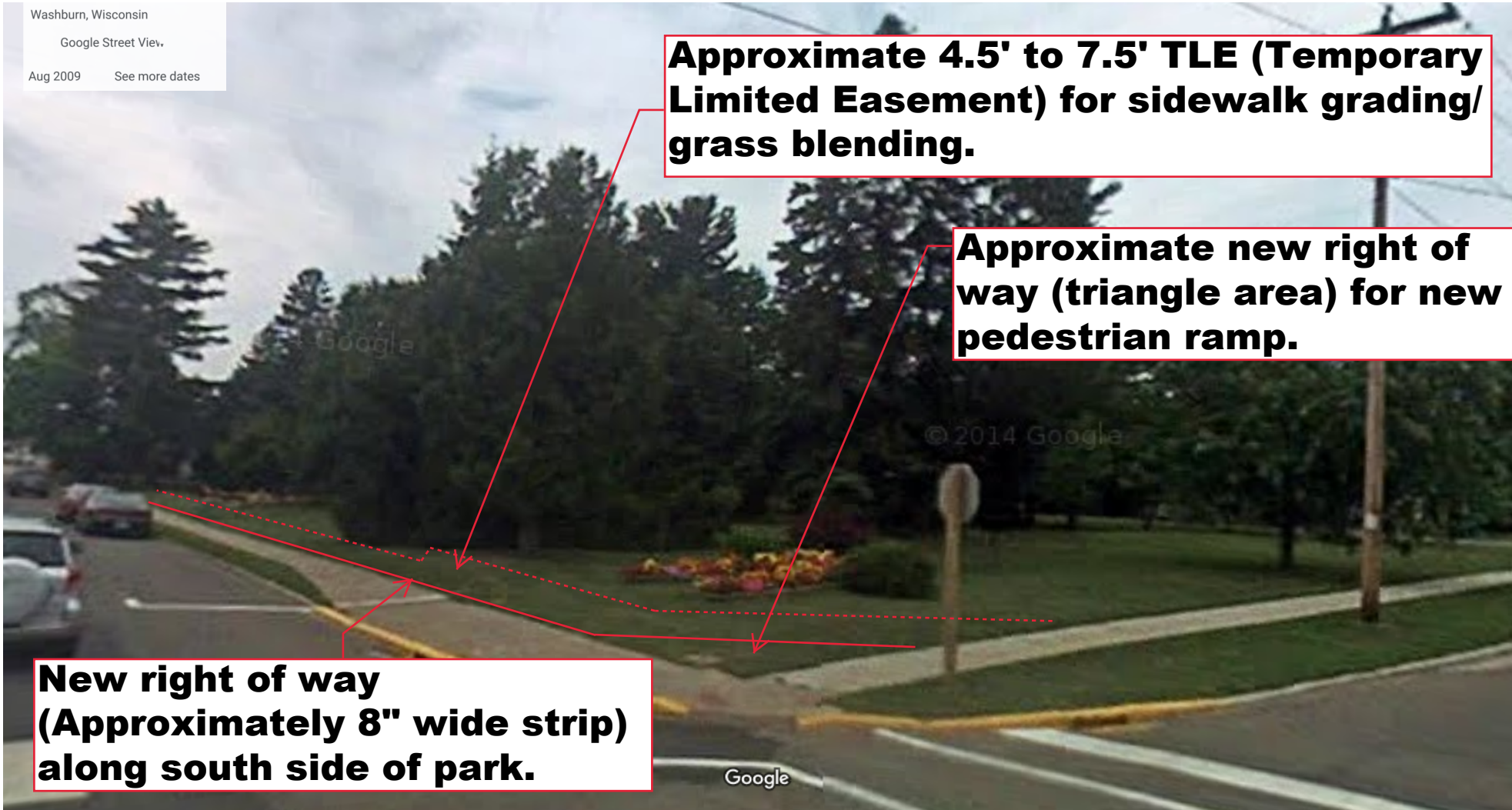

**Approximate 4.5' to 7.5' TLE (Temporary Limited Easement) for sidewalk grading/grass blending.**

**Approximate new right of way (triangle area) for new pedestrian ramp.**

**New right of way (Approximately 8" wide strip) along south side of park.**

