



WIS 60 (Main Street) Resurfacing Project

County P to Eagle Drive

Vida Shaffer, P.E.
Project Manager

Virtual Project Presentation for Public Information
Village of Jackson

June 2021

WIS 60 (Main Street) County P to Eagle Drive

- Project is scheduled for 2024 construction
- Project Length is 1.844 miles
- Current traffic is 8,700 to 15,700 average daily traffic (ADT)
- Forecasted traffic growth 9,900 to 17,800 ADT by 2044
- Commercial and residential corridor with 17.3% trucks
- Roadway originally built in 1984 and last resurfaced in 2003

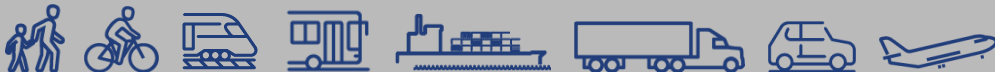

2024 Improvement includes: Pavement Repair & Resurfacing

- Remove 3-Inches of existing asphalt layer
- Base patch underlying concrete joints that have failed
- Resurface with new 3.5-Inch asphalt layer

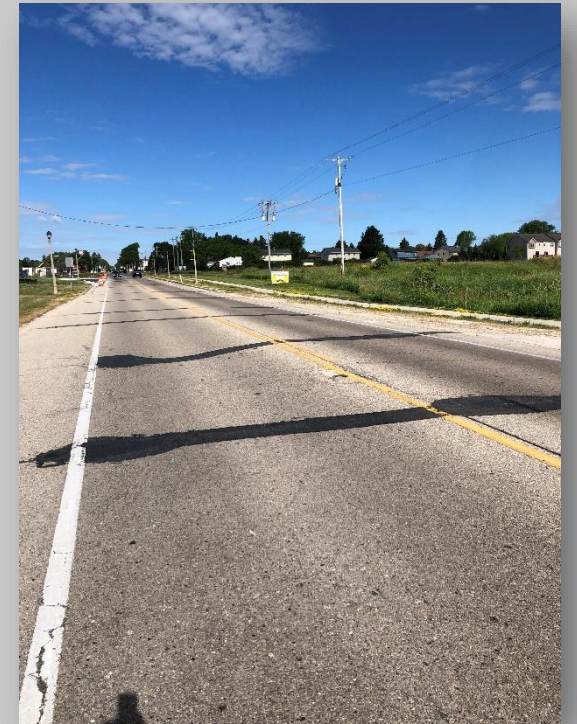

2024 Improvement also includes:

- Upgrades to highly visible monotube-style traffic signals at County P, Industrial Drive and Jackson Drive including new detection loops and timing.
- Replacement of all ADA non-compliant curb ramps. Improved positioning of pedestrian actuated signal controls.



Monotube-style Traffic Signal



2024 Improvement also includes:

- 450' of new sidewalk installation on the northside of Main Street to place it within public right-of-way
- Upgraded pavement markings at Jackson Drive to improve intersection operations and safety

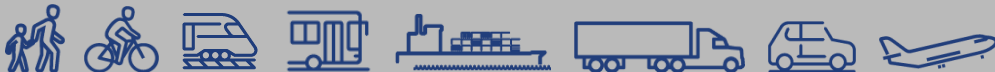
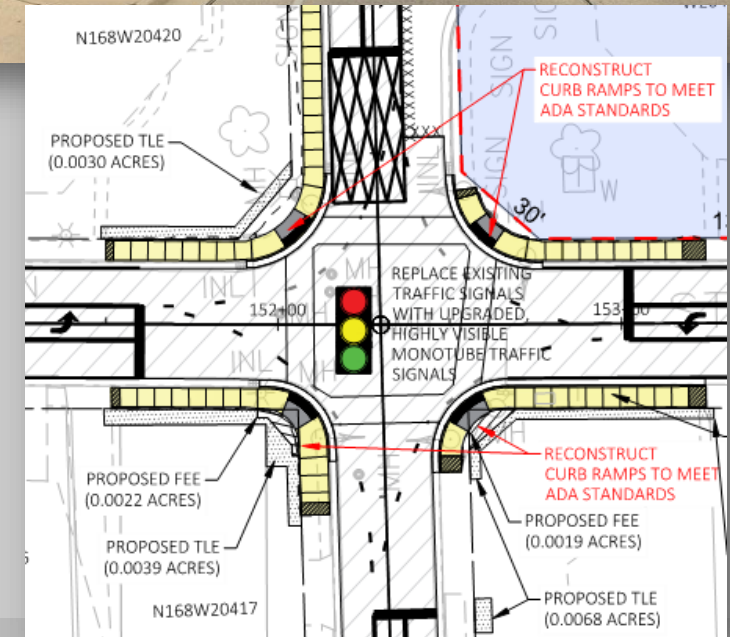

2024 Construction Staging

WIS 60 eastbound lane will be open to traffic

- There is insufficient room to maintain traffic on Main Street in a safe manner during construction
- One-way traffic pattern for eastbound WIS 60 traffic from US 45 to Eagle Drive throughout construction
- Westbound traffic on WIS 60 will be detoured to County G, County NN, County P, County PV & US 45 throughout construction

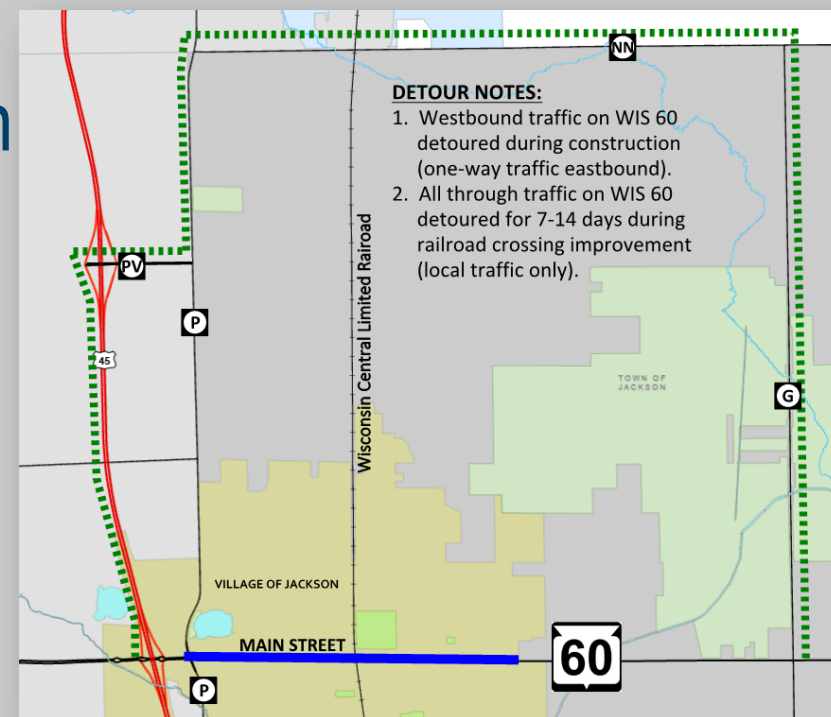

2024 Construction Staging

WIS 60 Detour for Railroad Crossing Work

- In the event that Wisconsin Central LTD Railroad (Canadian National) improves the at-grade crossing, a detour on WIS 60 will be needed in both directions for 7-14 days
- WIS 60 will be open to local traffic during this period
- State traffic on WIS 60 will be detoured to County G, County NN, County P, County PV & US 45 during this period

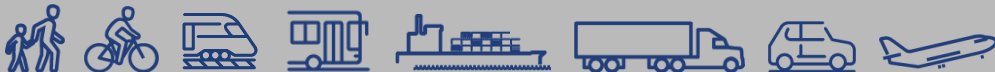

Real Estate Interests

Temporary Limited Easement (TLE) Acquisition

- Temporary real interest acquired to allow Contractor to blend slopes, install landscaping for sidewalks, curb ramps, etc.
- Any disturbed area within TLE will be restored “in-kind”. TLE expires once construction project is completed.
- 19 TLE Acquisitions starting in late 2021/early 2022 (See Plan Details for locations)

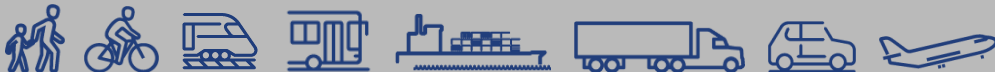
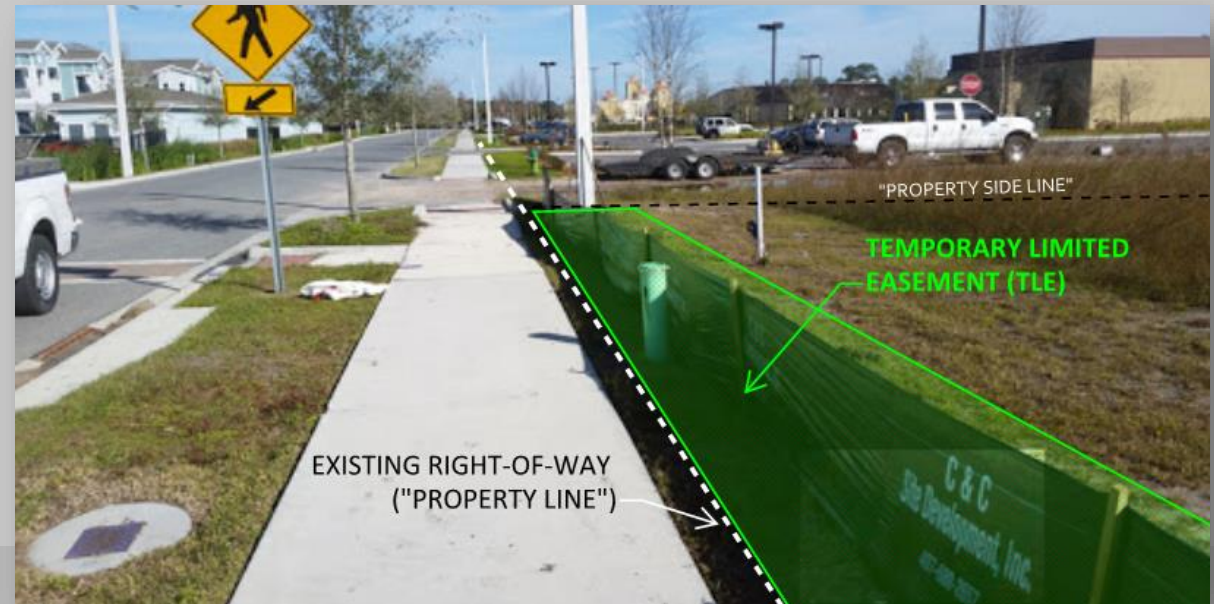

Real Estate Interests

Fee (Simple) Acquisition

- Permanent real interest acquired for the purposes of public roadway items such as sidewalks, curb ramps, curb & gutter, etc.
- Property owner is compensated for this acquisition at fair market value
- 16 Fee Acquisitions starting late 2021/early 2022 (See Plan Details for locations)



Driveway Access

Contractor to keep driveway access open at all times

- When work is required at your driveway, the contractor will work on it half at a time to keep access open to your driveway.
- Since working on the driveway half at a time will require a longer time period of disruption, please consider if alternate access is available or parking on a side street is an option, allowing the contractor to close your driveway. This allows them to complete the work needed in a shorter period of time and facilitates opening it to full operation sooner and minimizing disruption.



Drainage Correction

Existing drainage pattern causing issues

- Roadway drains directly over existing path on northside of WIS 60, west of Eagle Drive
- This drainage condition is causing erosion and potential safety problems
- New storm water inlet will be installed over existing storm pipe to convey water under the path

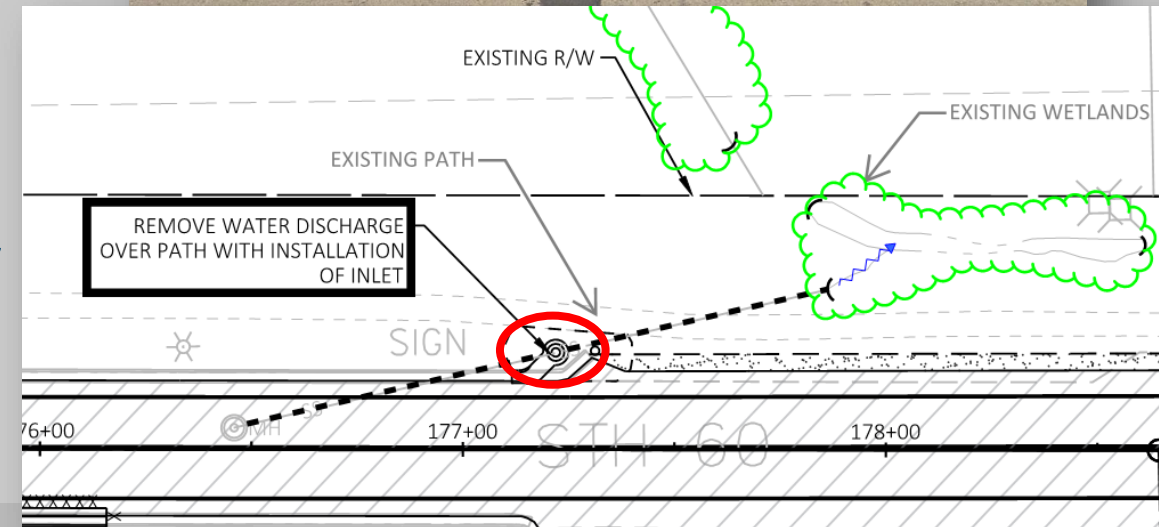

2024 Construction Timeframe

- Construction expected to start April of 2024
- Construction expected to be completed in August of 2024
- Pavement improvement is expected to last 15-20 years.

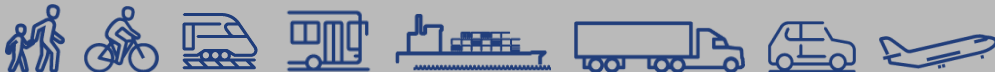

Village Improvements in 2021

Note:

- In summer of 2021, Village of Jackson will add new sidewalk and path on the southside of WIS 60. This will include new curb ramps at Eagle Drive.
- Village will install new curb ramps at Ridgeway Drive associated with the on-going Village Municipal Building Project in 2021



WisDOT Design Contacts

If you have any questions or concerns...

Vida Shaffer, P.E.
WisDOT Project Manager
(262) 548-6766
vida.shaffer@dot.wi.gov

Stan Lukasz, P.E.
Design Consultant Project Manager
DAAR Engineering, Inc.
(414) 935-4360
stan.lukasz@daarcorp.com

Mike Pyritz
**WisDOT Communications
Manager**
(262) 521-5373
michael.pyritz@dot.wi.gov

