

1 US 51 and WIS 30: Diamond Interchange

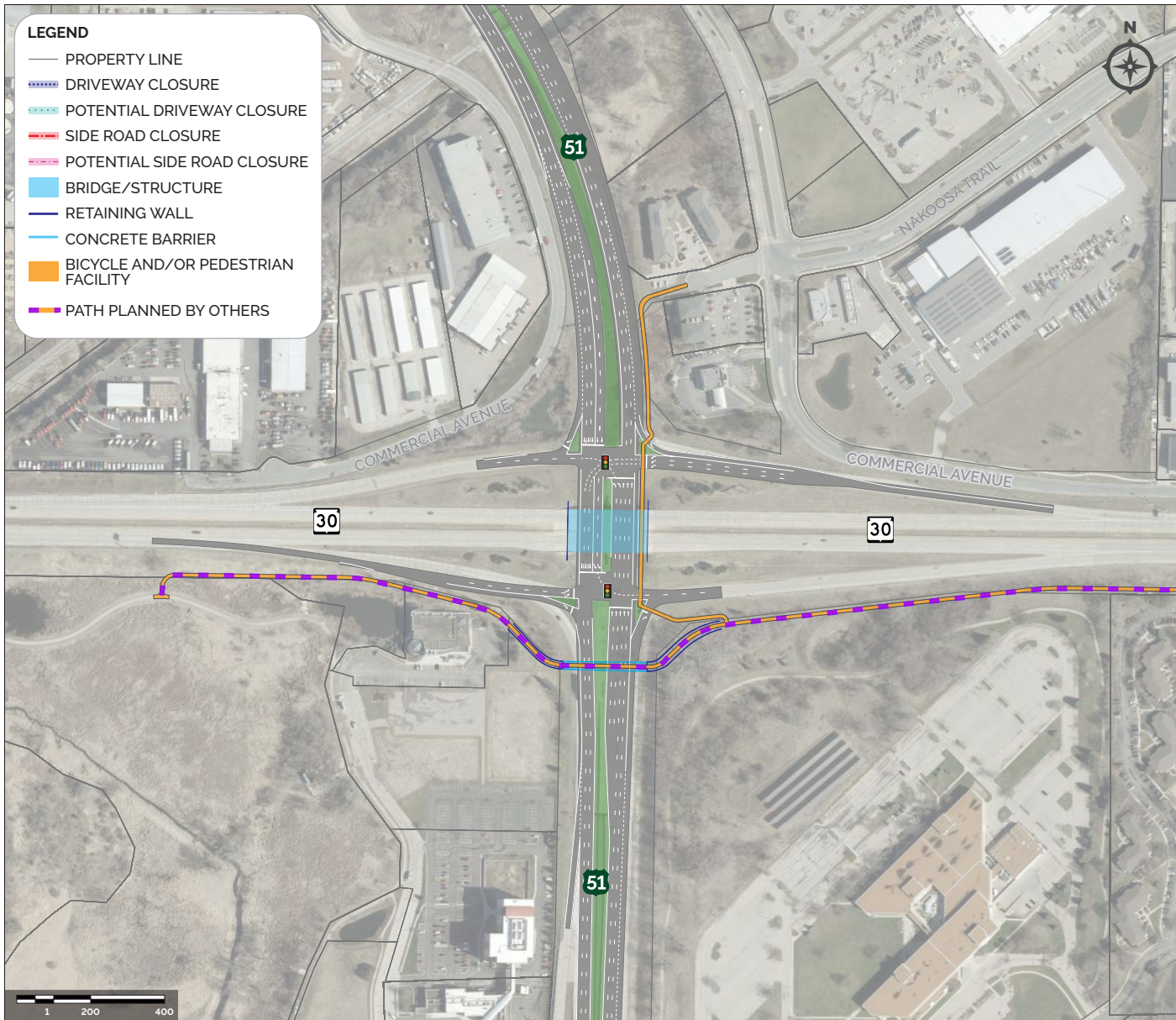

Concept Overview:

- A diamond interchange would remain with improvements to turn lanes and traffic signals

Pros

- Utilizes existing bridges
- Minimizes property acquisitions
- Allows for future shared-use path connection
- Ramp improvements to address traffic capacity

Cons

- Does not reduce conflict points* or address safety long-term

*Conflict points define situations where vehicles, bicycles, and/or pedestrians intersect at a point in space.

Number of lanes, length of turn lanes, and other geometric elements are conceptual and may not reflect final design.

