

# WIS 23 Public Involvement

Project I.D. 5080-02-74  
Spring Green – Reedsburg  
(US 14 to County GG)  
WIS 23  
Sauk County

Project I.D. 5080-02-82  
Spring Green – Reedsburg  
(Structures B-56-137 & B-56-138)  
WIS 23  
Sauk County



**Public Comment Period: August 30, 2021 to September 30, 2021**

**In lieu of a face to face meeting, public involvement will be conducted via this project mailer and comment feedback sheet (attached), and the project website listed below.**

This handout and other meeting items are available on the design website at:  
<https://wisconsindot.gov/Pages/projects/by-region/sw/wis23-saukcounty/default.aspx>

**Thank you for your interest in this project, we look forward to your feedback.**

## Overview

The Wisconsin Department of Transportation is gathering public input on proposed improvements along WIS 23 beginning just north of US 14 in the Town of Spring Green and ending near County GG in the Town of Franklin. This handout provides information regarding the proposed projects and potential impacts on the community. There will be no in-person public meeting due to the current health emergency.

## We want your comments

We appreciate your input and encourage you to take a moment and review the project information and ask the project team any questions.

## Project Need

This project will address deteriorating pavement and bridges on WIS 23 within the project limits. Two bridges identified for replacement show deterioration and have reached the end of their service life.

## Project Limits:

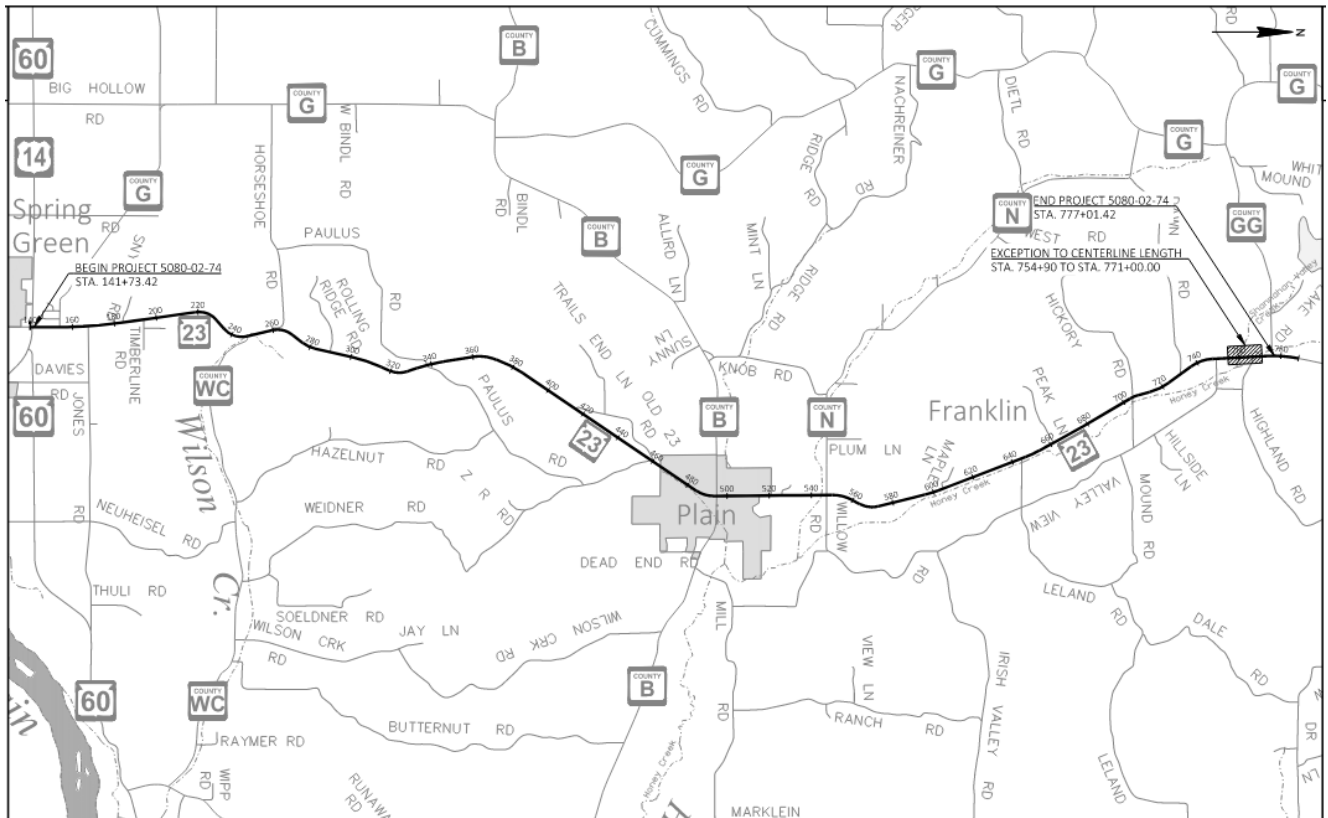

## **Proposed improvements**

### **5080-02-74 Construction Activities:**

- Milling the existing asphaltic pavement in place (2 inches), utilizing a cold-in-place recycling (CIR) of the existing underlying asphalt (3 inches), and overlaying with new asphalt pavement (2 ½ inches)
- Milling the existing asphaltic pavement in place (4 inches) and overlaying it with new asphalt pavement (4 inches) in the Village of Plain.
- Beam guard replacement and grading
- Spot curb and gutter, sidewalk, and curb ramp replacements in the Village of Plain
- Spot water main, sanitary, and storm sewer improvements in the Village of Plain
- Relocation of two light poles in the Village of Plain
- Culvert replacements near the Dawn Road intersection
- Utility Relocations

### **5080-02-82 Construction Activities:**

- Replacing two deteriorating bridge structures B-56-235 and B-56-236 south of the Highland Road intersection
- Reconstruction of the roadway approaches
- Beam guard replacements and grading
- Replacement of a cross culvert and a field entrance culvert on Highland Road

## **Right-of-way impacts**

New right of way and temporary limited easements (TLE) will be necessary for grading and curb ramp improvements. If your property will be impacted by this project, a member of our real estate department will contact you if they have not already.

## **Construction and traffic impacts**

An improvement project is currently scheduled for 2024. WIS 23 will be closed to through traffic during construction and a detour route will be posted utilizing WIS 130 and WIS 154. Roadway users can expect to encounter daily flagging operations on WIS 23 during the pavement resurfacing project within the project limits. A full closure of WIS 23 will be required to reconstruct the two bridges.

Access to adjacent properties and for first responders will be maintained during construction. Brief interruptions in access may occur temporarily at driveways. The contractor will be required to notify homeowners and businesses prior to construction.

## **Project Schedule**

- Public comment period August 30 to September 30, 2021
- Final plans August 2023
- Construction Spring 2024

## **Project design website**

Access the following materials on the project design website:

<https://wisconsin.dot.gov/Pages/projects/by-region/sw/wis23-saukcounty/default.aspx>

## **Public input/comments**

Please forward your comments by **September 30, 2021, by:**

1. Filling out the comment form attached to this document and mailing it to WisDOT.
2. Emailing comments or questions to the contact listed below.

Your comments assist us in developing a project that will serve the needs of the traveling public as well as the needs of the local community. Your input is welcome and appreciated throughout the design process. For more information, please contact:

Mahesh, Shrestha P.E, WisDOT Project Manager  
Southwest Region, La Crosse Office  
3550 Mormon Coulee Road, La Crosse, WI 54601  
(608) 245-2674  
[mahesh.shrestha@dot.wi.gov](mailto:mahesh.shrestha@dot.wi.gov)