

**4'-0" SECTIONS**

**REBAR DIMENSION**

SECT. DEPTH	SECT. NO.	"A"	"B"	"C"
1'-0"	1	7 1/2"	7 1/2"	6"
1'-5"	2	9"	1'-1"	10"
1'-9"	3	1'-3"	1'-5"	1'-2"
2'-3"	4	1'-3"	1'-11"	1'-8"
2'-9"	5	1'-3"	2'-5"	2'-2"
3'-6"	6	1'-3"	3'-2"	2'-11"

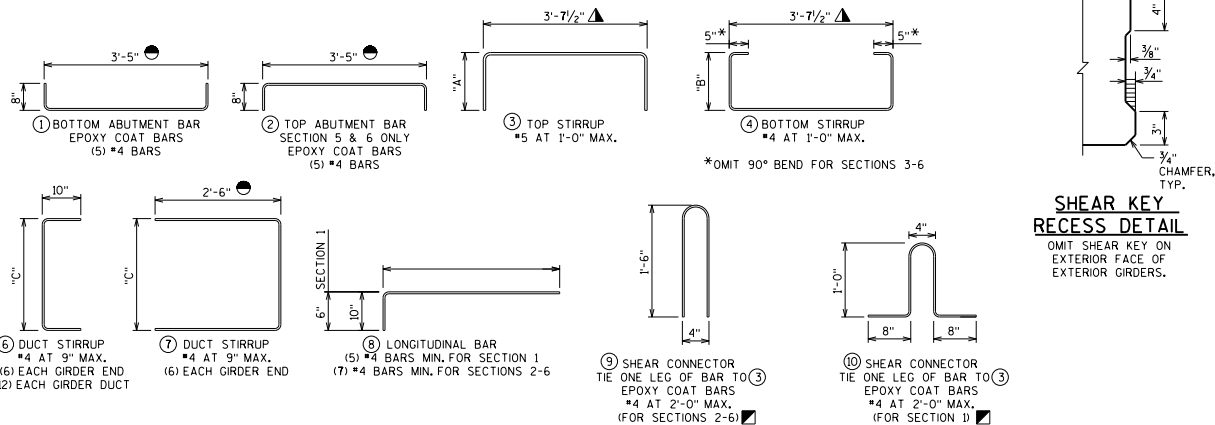

**SHEAR KEY RECESS DETAIL**

OMIT SHEAR KEY ON EXTERIOR FACE OF EXTERIOR GIRDERS.

**DESIGNER NOTE**

SEE STANDARD 19.50 FOR NOTES, DESIGNER NOTES, MATERIAL PROPERTIES.

**LEGEND**

- DIMENSION GIVEN FOR A POST-TENSIONING DUCT 1'-10" FROM END OF PRESTRESSED BOX GIRDER.
- ▲ DIMENSION GIVEN FOR STIRRUPS PERPENDICULAR TO THE PRESTRESSED BOX GIRDER LENGTH. ADJUST THE DIMENSION FOR STIRRUPS AT SKEWED PRESTRESSED BOX GIRDER ENDS.
- ⊙ SHOW SPACING FOR THESE STRANDS ONLY IF REQUIRED BY DESIGN.
- SUBSTITUTE (11) BAR ON EXTERIOR EDGE OF EXTERIOR GIRDERS. SEE STANDARD 19.56.

**4'-0" PRESTRESSED BOX GIRDER SECTIONS**

WISCONSIN  
DEPARTMENT OF  
TRANSPORTATION

**BUREAU OF  
STRUCTURES**

DATE:  
APPROVED: *Laura Shadewald* 1-18