

TYPICAL INSTALLATION AT  
BAR STEEL INTERSECTION

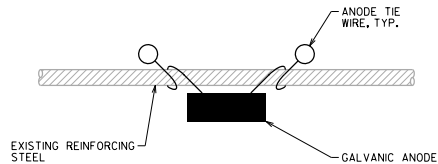

TYPICAL INSTALLATION  
FOR BAR STEEL

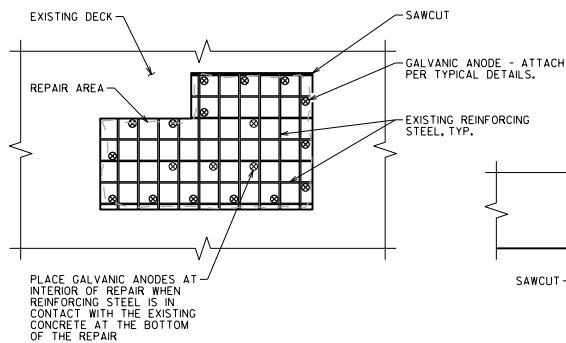

PART. PLAN TYPICAL REPAIR DETAIL

509.1500 CONCRETE SURFACE REPAIR SF  
SPV.0060 EMBEDDED GALVANIC ANODES EACH

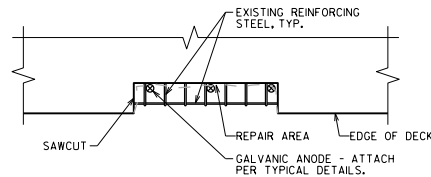

NOTES

SURFACE REPAIR AREAS WITH CATHODIC PROTECTION ARE BASED ON THE PLANS AND AS DETERMINED BY THE ENGINEER. THE PLAN QUANTITY FOR THE BID ITEM "EMBEDDED GALVANIC ANODES" IS BASED ON A MAXIMUM SPACING OF 24-INCHES AROUND THE SURFACE REPAIR PERIMETER. THE ACTUAL QUANTITY SHALL BE BASED ON THE FIELD CONDITIONS AND AS RECOMMENDED BY THE GALVANIC ANODE SUPPLIER.

SURFACE REPAIRS SHALL BE FILLED WITH REPAIR MATERIALS COMPATIBLE WITH CATHODIC PROTECTION, AS RECOMMENDED BY THE ANODE SUPPLIER.

EXISTING REINFORCING STEEL TO BE COMPLETELY CLEANED OF CORRODED MATERIAL AND CONCRETE TO PROVIDE SUFFICIENT ELECTRICAL CONNECTION AND BOND. CATHODIC PROTECTION PREPARATIONS ARE INCLUDED IN THE BID ITEM "EMBEDDED GALVANIC ANODES".

ANODES NEAREST TO EDGE OF REPAIR TO BE WITHIN 6" OF EDGE.

AFTER PLACEMENT, GALVANIC ANODES SHOULD MAINTAIN A MINIMUM TOP COVER OF 1/2" AND A MINIMUM BOTTOM COVER OF 3/4"

DESIGNER NOTES

CATHODIC PROTECTION SHALL BE USED ONLY AT THE REQUEST OF THE REGIONAL BRIDGE MAINTENANCE ENGINEER.

INCLUDE APPLICABLE CONCRETE MASONRY BID ITEM TO FILL REPAIRS.

CATHODIC PROTECTION



**BUREAU OF  
STRUCTURES**

APPROVED: *Laura Shadewald*

DATE:  
1-21