

WINGS PARALLEL TO ROADWAY

WINGS PARALLEL TO ABUTMENT

STANDARD WING

WITH STRUCTURAL APPROACH SLAB

WITH RAILING OR FENCE ONLY

STANDARD WING

STANDARD FILL

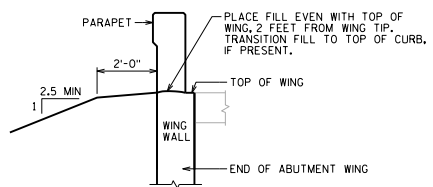

TYPICAL FILL SECTION AT WING TIPS

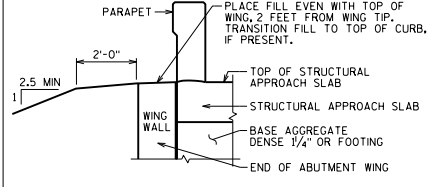

TYPICAL FILL SECTION AT WING TIPS

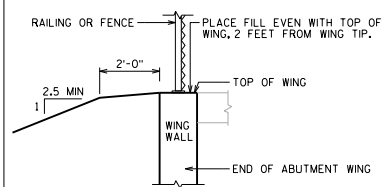

TYPICAL FILL SECTION AT WING TIPS

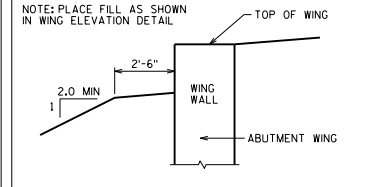

TYPICAL FILL SECTION AT WING

RIP RAP

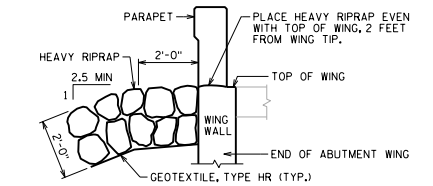

TYPICAL FILL SECTION AT WING TIPS

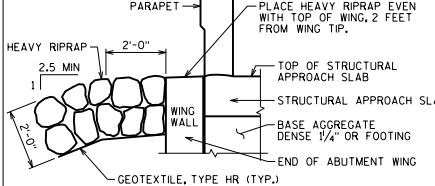

TYPICAL FILL SECTION AT WING TIPS

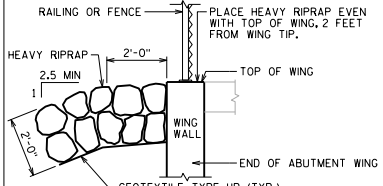

TYPICAL FILL SECTION AT WING TIPS

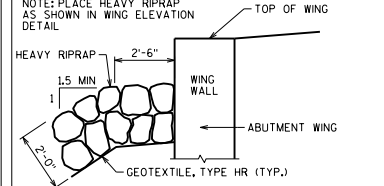

TYPICAL FILL SECTION AT WING

STANDARD FILL WITH SIDEWALK

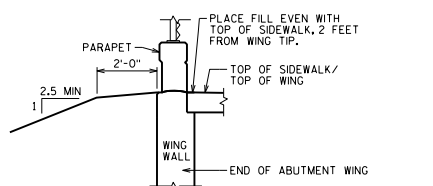

TYPICAL FILL SECTION AT WING TIPS

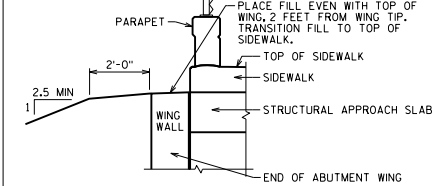

TYPICAL FILL SECTION AT WING TIPS

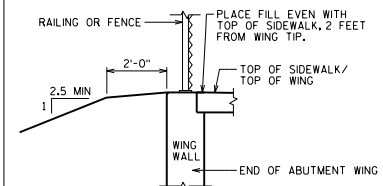

TYPICAL FILL SECTION AT WING TIPS

WING FILL SECTIONS AT WING TIPS



BUREAU OF STRUCTURES

APPROVED: *Laura Shadewald*

DATE: 1-18