

# Wisconsin Department of Transportation

May 5, 2015

## Division of Transportation Systems Development

Bureau of Project Development  
4802 Sheboygan Avenue, Rm 601  
P O Box 7916  
Madison, WI 53707-7916

Telephone: (608) 266-1631  
Facsimile (FAX): (608) 266-8459

### NOTICE TO ALL CONTRACTORS:

**Proposal #19: 1060-33-83  
Zoo IC, Ped Bridge Over USH 45  
At Wauwatosa West HS  
USH 45  
Milwaukee**

### Letting of May 12, 2015

This is Addendum No. 1, which provides for the following:

#### Special Provisions

Revised Special Provisions	
Article No.	Description
3	Prosecution and Progress
43	Storm Sewer

#### Plan Sheets

Revised Plan Sheets	
Plan Sheet	Plan Sheet Title (brief description of changes to sheet)
316	Structure R-40-624 – Aesthetic Details – Added panels and relief changes
317	Structure R-40-625 – General Plan & Elevation 1 – Changes to list of drawings and sheet numbers
327	Structure R-40-625 – Aesthetic Details 1 – Added panels and relief changes.
328	Structure R-40-626 – General Plan & Elevation 1 – Changes to list of drawings and sheet numbers
339	Structure R-40-626 – Aesthetic Details 1 – Added panels and relief changes.

Added Plan Sheets	
Plan Sheet	Plan Sheet Title (brief description of why sheet was added)
327A	Structure R-40-625 – Aesthetic Details 2 – New sheet detailing aesthetics of parapet
339A	Structure R-40-626 – Aesthetic Details 2 – New sheet detailing aesthetics of parapet

The responsibility for notifying potential subcontractors and suppliers of these changes remains with the prime contractor.

Sincerely,

*Mike Coleman*

Proposal Development Specialist  
Proposal Management Section

**ADDENDUM NO. 1**

**1060-33-83**

**May 5, 2015**

**Special Provisions**

**3. Prosecution and Progress**

**Definitions – Freeway Work Restrictions**

*Replace Weekend Peak Hours with the following:*

**Weekend Peak Hours**

8:00 AM – 7:00 PM      Saturday, Sunday

*Replace Weekend Off-Peak Hours with the following:*

**Weekend Off-Peak Hours**

7:00 PM – 11:00 PM      Saturday  
7:00 PM – 9:30 PM      Sunday

**43. Storm Sewer.**

*Replace entire article language with the following:*

*Supplement standard spec section 607.3.1.1 General with the following:*

(9) Review the Plans, Specifications, and existing site conditions prior to bidding to ascertain the extent of the work requiring shoring.

(10) Exercise additional caution when constructing sewers in close proximity to utilities, structures, and live traffic lanes.

(11) Proposed utilities are not shown on the plans. Review "Utilities" article for abandoned, relocated, adjusted, and/or new utility facilities prior to bidding.

(12) To facilitate drainage, maintain concrete barrier temporary precast drainage/lifting slot holes free from debris.

(13) Provide a shoring design and installation sequence for each location when shoring is used.

Have a professional engineer, registered in the State of Wisconsin and knowledgeable of the specific site conditions and requirements verify the adequacy of the design. Submit one electronic copy in portable document format of each shoring design, signed and sealed by the same professional engineer verifying the design, to the engineer for incorporation into the permanent project record.

(14) Shop drawings are required for all drainage structures. For structures where WisDOT standard detail drawings are not available, provide shop drawings prepared, verified and stamped by a professional engineer registered in the State of Wisconsin. Submit one electronic copy of shop drawings in portable document format for engineer's review two weeks prior to start fabrication.

Show clearly on shop drawings information for all pipe connections to the structure. The contractor is responsible for all errors of detailing and fabrication. The omission from the shop drawings of any pipe connection shall not relieve contractor of the responsibility of furnishing and installing such materials, even though the shop drawings may have been and reviewed and accepted by the engineer.

(15) Provide bolted covers for drainage structure cover types J Special, V and 27 M Bolted. Cost of providing bolted cover is considered incidental to cover type. Weld all other existing and proposed storm sewer structure covers subject to traffic loading. Remove welds from covers at the direction of engineer when construction is complete.

*Replace standard spec section 607.3.5(1) Backfilling with the following:*

Conform to backfill detail as shown on the plan. Backfill all trenches and excavations of all new storm sewer and storm sewer structures not occupied by Backfill Controlled Low Strength or stone chips immediately after completing the sewer work with backfill material conforming to section 209 of the standard specifications. Backfill locations where existing storm sewers or existing storm sewer structures have been called for removal or abandoning, not occupied by the new traveled way or occupied by Backfill Controlled Low Strength, immediately after completing the sewer work with native backfill above stone chips and conforming to detail shown on the plan.

*Supplement standard spec section 608.3 with the following:*

Provide rubber gasket joints for all storm sewer pipes except for horizontal elliptical pipe rise greater than 40-inches use mastic joint compound. Place rubber gasket over the spigot end or tongue of the entering pipe. Clean the gasket and the ends of the pipe from sand and gravel. Place the spigot or tongue of the pipe being laid with the gasket in place into the bell or groove end of the previously laid pipe. Set pipe carefully to line and grade, and push or jack home. The engineer can order the use of a jack or "come-along" if deemed necessary to ensure that the joints are completely tight.

Place rubber gasket over the spigot end or tongue of the entering pipe. Clean the gasket and the ends of the pipe from sand and gravel. Immediately before making the joint, lubricate the outside of the gasket and the inside of the bell or groove of the last pipe with an approved vegetable lubricant. Place the spigot or tongue of the pipe being laid with the gasket in place into the bell or groove end of the previously laid pipe. Set pipe carefully to line and grade, and push or jack home. The engineer can order the use of a jack or "come-along" if deemed necessary to ensure that the joints are completely tight.

*Replace standard spec 608.5(2) with the following*

Payment for the Storm Sewer Pipe bid items is full compensation for providing all materials, including all special Y's, mitered sections, elbows and connections required; for excavating and wasting excess material, except rock excavation; for providing rubber gaskets; for supporting utilities in storm sewer trench; for shoring design, providing a signed and sealed copy of the design; for installation, monitoring, and removal of shoring; for forming foundation; for laying pipe; for sealing joints and making connections to new or existing features; stone chips; granular backfill material, including bedding material; for backfilling; for maintaining concrete barrier temporary precast drainage/lifting slot holes to keep free from debris; for cleaning out; and absent the pertinent contract bid items, for restoring the work site.

### **Plan Sheets**

The following 8½ x 11-inch sheets are attached and made part of the plans for this proposal:

Revised: 316, 317, 327, 328, and 339.

Added: 327A, and 339A.

END OF ADDENDUM

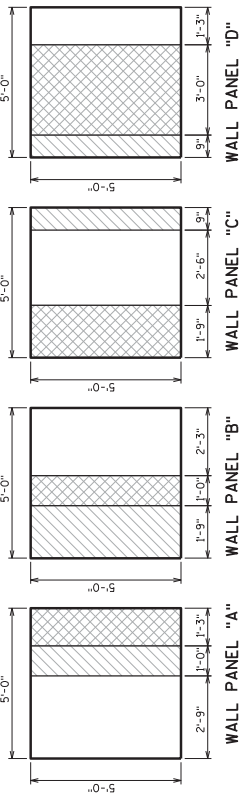

5'-0" X 5'-0" MSE CONCRETE PANEL RAISED SURFACE DETAILS

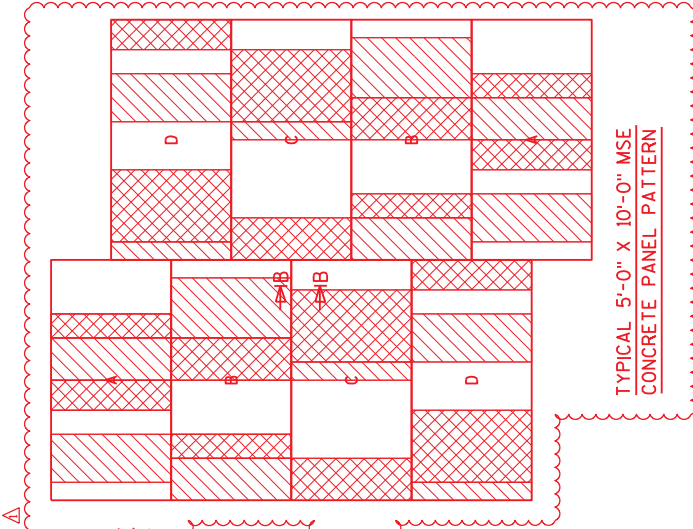
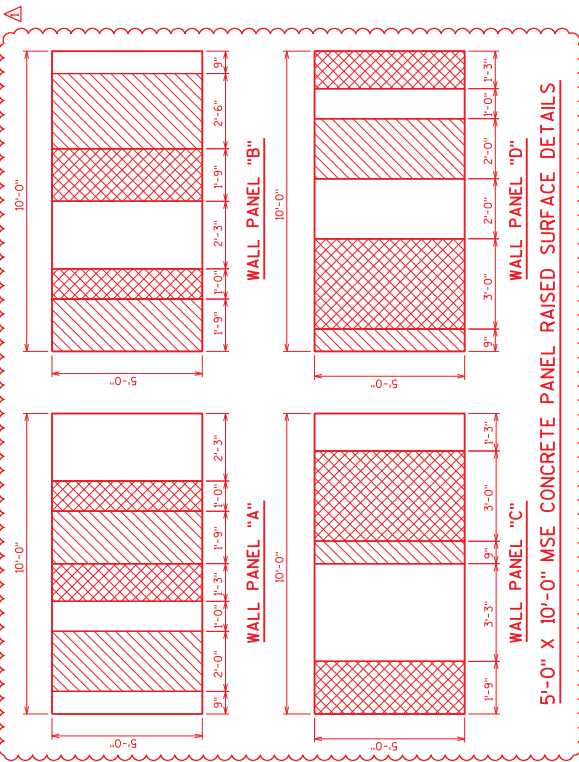

TYPICAL 5'-0" X 10'-0" MSE CONCRETE PANEL PATTERN

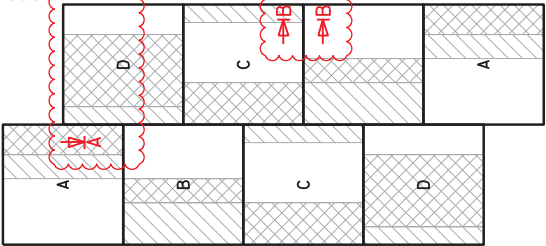

TYPICAL 5'-0" X 5'-0" MSE CONCRETE PANEL PATTERN

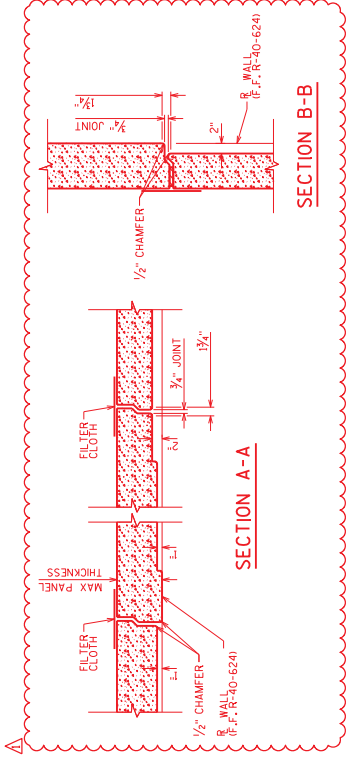

Addendum No. 1  
ID 1060-33-83  
Revised Sheet 316  
May 5, 2015

**STAIN COLOR**  
ALL EXPOSED SURFACES FOR BOTH THE WALL AND THE COPING SHALL BE STAINED. THE FINAL COLORING OF THE CONCRETE FOLLOWING APPLICATION OF THE STAIN SYSTEM SHALL MATCH THE FEDERAL STANDARD COLOR SYSTEM LISTED BELOW.  
FEDERAL COLOR NO. 35564

CONCRETE STAINING IS NOT INCLUDED IN THIS CONTRACT. CONCRETE STAINING WILL BE DONE BY OTHERS UNDER A FUTURE CONTRACT.

NO.	DATE	REVISION	BY
1	4/20	MSE PANEL REVISIONS	NAR
<i>William C. DeLoe</i> 4/30/15			
STATE OF WISCONSIN DEPARTMENT OF TRANSPORTATION STRUCTURES DESIGN SECTION			
STRUCTURE		R-40-624	
DRAWN BY	DDS	PKAS	AJBS
CHECKED BY			
AESTHETIC DETAILS			316
SHEET II			

STATE PROJECT NUMBER  
**1060-33-83**

**DESIGN DATA**

THE RETAINING WALL SHALL BE DESIGNED USING THE ELEVATIONS GIVEN ON THESE SHEETS.  
DESIGN FOR RETAINING WALL TO PROVIDE FOR FINISHED GRADE SLOPED BEHIND WALL AS SHOWN.

DESIGN RETAINING WALL FOR A LIVE LOAD SURCHARGE OF 240 PSF.

ULTIMATE DESIGN STRESSES:  
 PRECAST CONCRETE COPING:  $f'_c = 4,000$  P.S.I.  
 PRECAST CONCRETE WALL PANELS:  $f'_c = 4,000$  P.S.I.  
 BAR STEEL REINFORCEMENT GRADE 60:  $f_y = 60,000$  P.S.I.

**LIST OF DRAWINGS**

1. GENERAL PLAN & ELEVATION 1
2. GENERAL PLAN & ELEVATION 2
3. QUANTITIES, NOTES & PROFILE GRADE LINES
4. TYPICAL WALL SECTIONS
5. SUBSURFACE EXPLORATION
6. ANCHOR SLAB REINFORCEMENT
7. RAILING DETAILS 1
8. RAILING DETAILS 2
9. RAILING DETAILS 3
10. RAILING DETAILS 4

Addendum No. 1  
ID 1060-33-83  
Revised Sheet 317  
May 5, 2015

LEGEND  
 (E) EXPANSION JOINT  
 (C) ASBESTIC DETAILS ?

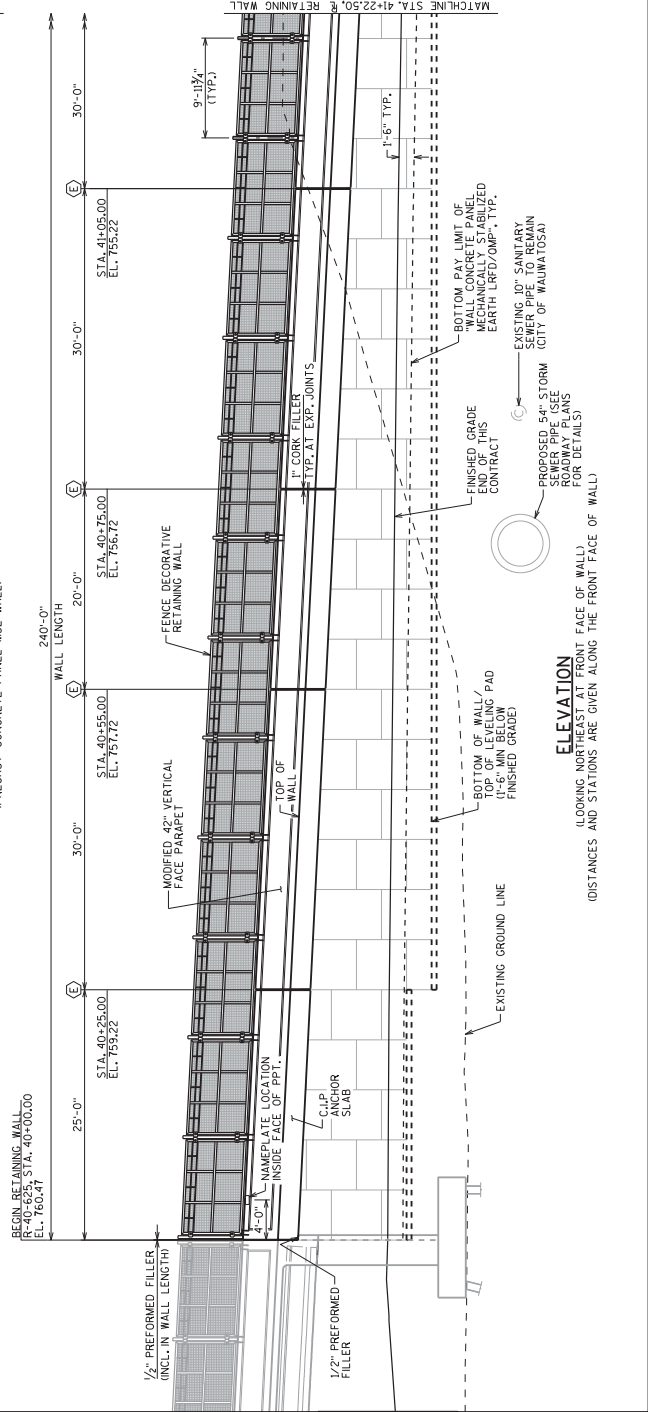
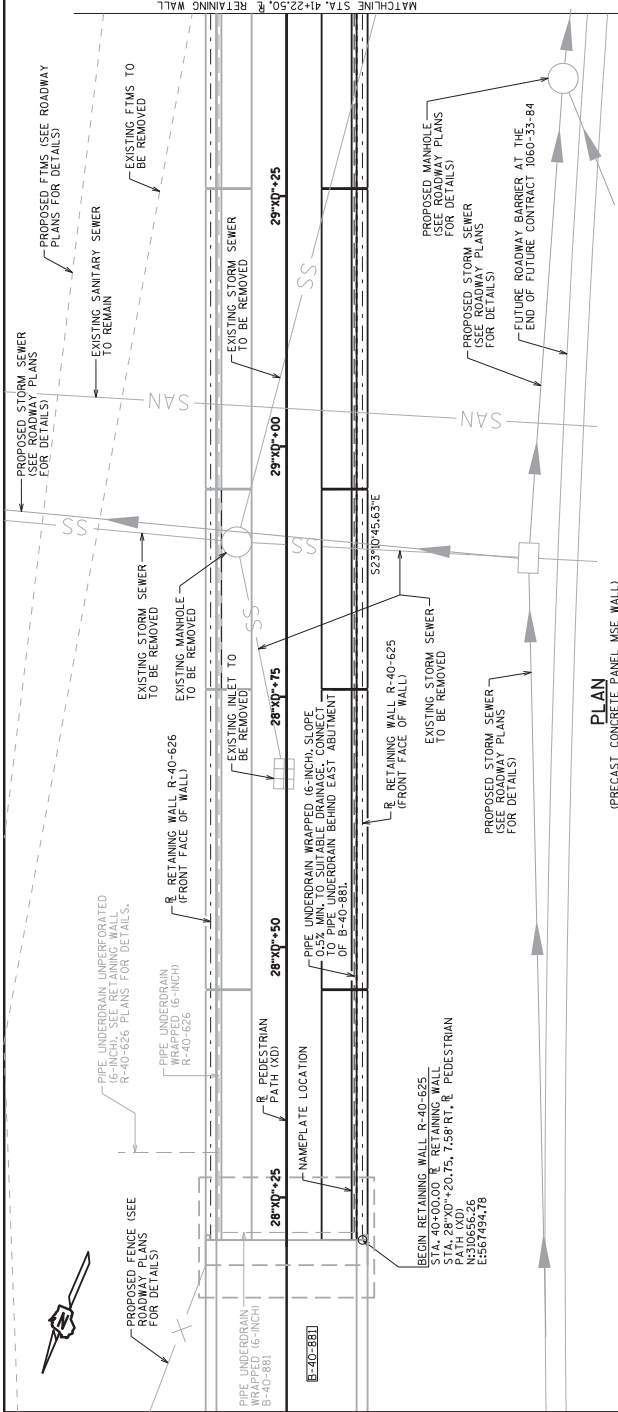

**CURVE DATA**

PEDESTRIAN PATH "XD"  
 P.I. = 25+32.90  
 $\Delta = 100^\circ-05'-38.73"$   
 D = 190'-59'-09.60  
 T = 25'-81"  
 R = 30'  
 S.E. = 15% N.C.  
 P.C. = 24+97.09  
 P.T. = 25+49.50

4/30/15

STRUCTURE DESIGN CONTACTS:  
 NICK RICE (608) 266-0092  
 AARON BOK (608) 261-0261

NO.	DATE	ADDED NEW SHEET	REVISION	BY	NAR
1	4/30				



Plans Prepared by  
**WISDOT**  
BUREAU OF STRUCTURES

ACCEPTED	CHIEF STRUCTURES DESIGN ENGINEER	DATE
	STRUCTURE R-40-625	
	PEDESTRIAN PATH OVER USH 45	
COUNTY	MILWAUKEE	WALUAWATOSA
DESIGN SPEC.	ASSTD. MHD. DESIGN SPEC.	PLANS ABS
BY	ASSTD. MHD. DES.	PLANS ABS

GENERAL PLAN & ELEVATION 1  
 SHEET 1 OF 2  
**317**

I.D. 1060-33-16F

DATE: MAR. 2015

**ELEVATION**

(LOOKING NORTHWEST FROM FRONT FACE OF WALL)  
 DISTANCES AND STATIONS ARE GIVEN ALONG THE FRONT FACE OF WALL

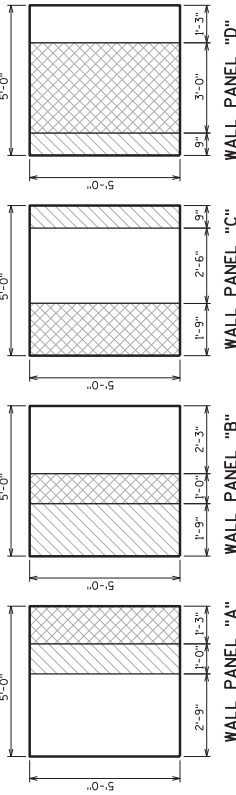

5'-0" X 5'-0" MSE CONCRETE PANEL RAISED SURFACE DETAILS

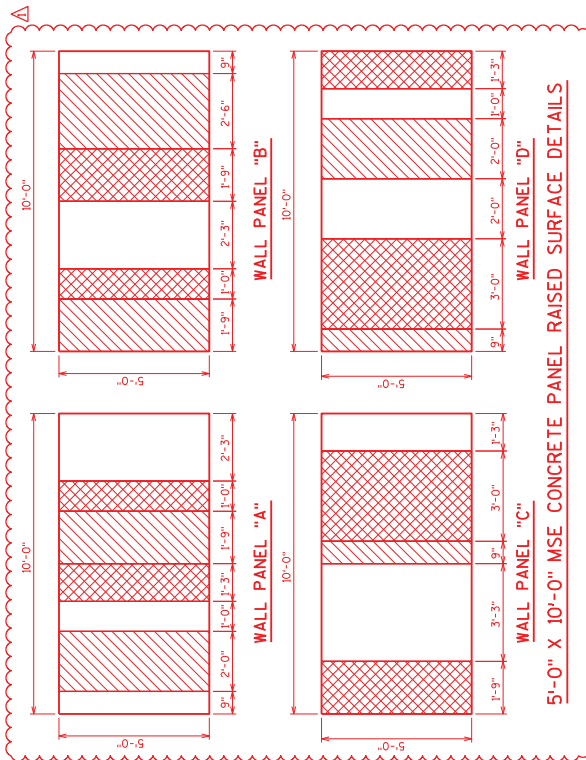

5'-0" X 10'-0" MSE CONCRETE PANEL RAISED SURFACE DETAILS

CONCRETE STAINING IS NOT INCLUDED IN THIS CONTRACT. CONCRETE STAINING WILL BE DONE BY OTHERS UNDER A FUTURE CONTRACT.

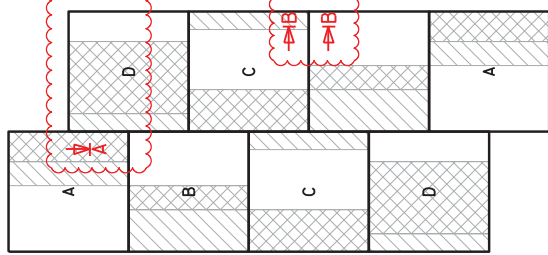

TYPICAL 5'-0" X 5'-0" MSE CONCRETE PANEL PATTERN

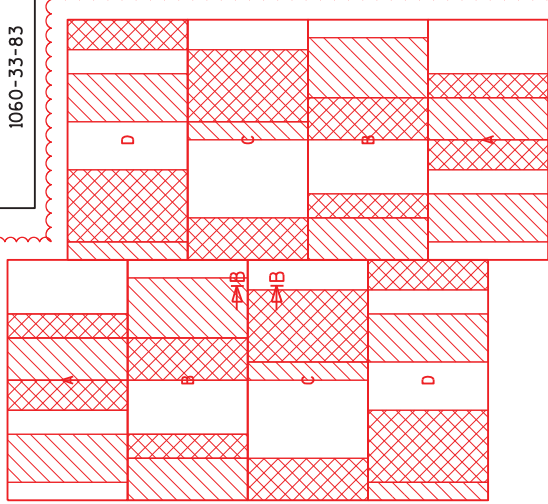

TYPICAL 5'-0" X 10'-0" MSE CONCRETE PANEL PATTERN

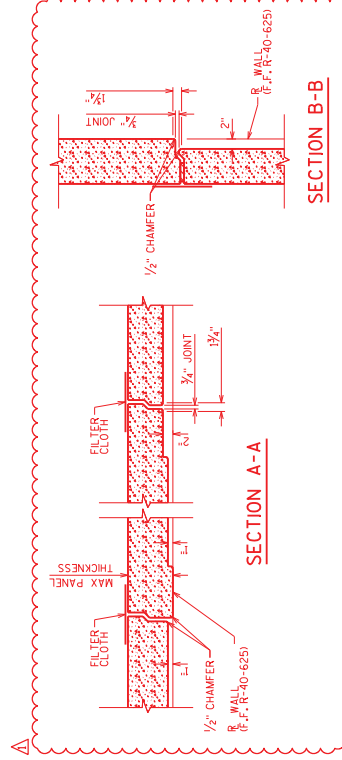

SECTION B-B

SECTION A-A

Addendum No. 1  
ID 1060-33-83  
Revised Sheet 327  
May 5, 2015

NO.	DATE	MSE PANEL REVISIONS	REVISION	BY
4/20				
STATE OF WISCONSIN DEPARTMENT OF TRANSPORTATION STRUCTURES DESIGN SECTION				
STRUCTURE R-40-625				
DESIGNED BY	DD	D	DD	DD
DRAWN BY	DD	D	DD	DD
SHEET II				
327				

William C. Decker 4/30/15

AESTHETIC DETAILS 1

Addendum No. 1  
ID 1060-33-83  
Added Sheet 327A  
May 5, 2015

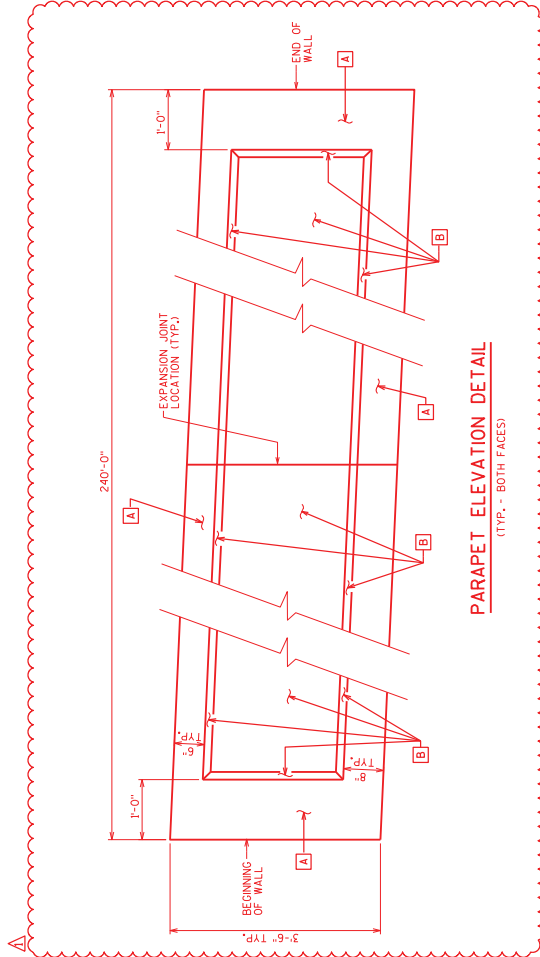
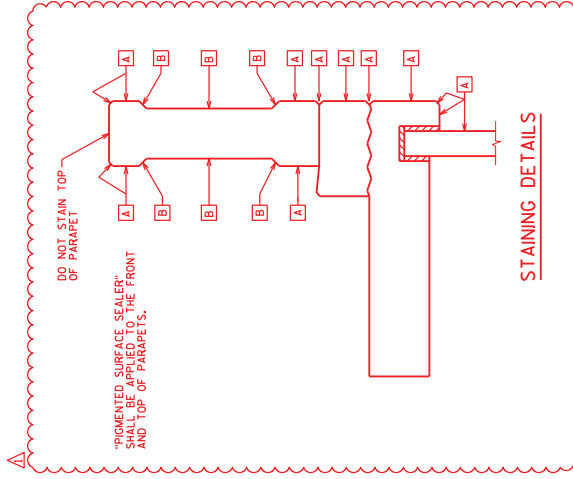

**CONCRETE STAINING SCHEDULE**

MARK	COLOR	LOCATION	NOTES
A	BASE COLOR	PARAPETS COPING WALL PANELS	BOTH SIDES, EXCEPT AS NOTED FOR ACCENT COLORS ALL EXPOSED EXTERIOR SURFACES FRONT FACE FROM TOP OF WALL PANEL TO 1'-0" BELOW FINISHED GRADE LINE.
B	ACCENT COLOR #1	PARAPETS	REVEALS ON PARAPETS

THE FINAL COLOR OF THE CONCRETE FOLLOWING APPLICATION OF THE STAIN SYSTEM SHALL MATCH THE SHERWIN-WILLIAMS STANDARD COLOR SYSTEM LISTED.  
 COLOR #1: BAGUETTE - SW 6123 FN 122  
 ACCENT COLOR #1: BAGUETTE - SW 6123 FN 124

CONCRETE STAINING IS NOT INCLUDED IN THIS CONTRACT. CONCRETE STAINING WILL BE DONE BY OTHERS UNDER A FUTURE CONTRACT.

*William C. Decker*  
4/30/15

AESTHETIC DETAILS 2

SHEET 327A

NO.	DATE	REVISION	BY
4/20		REARRANGEMENT OF DETAILS	NAR
STATE OF WISCONSIN DEPARTMENT OF TRANSPORTATION STRUCTURES DESIGN SECTION			
PROJECT NO.		DESIGN NO.	BY
R-40-625		R-40-625	DDS
DRAWN BY		CHKD BY	ABS
DDS		DDS	ABS

**DESIGN DATA**

THE RETAINING WALL SHALL BE DESIGNED USING THE ELEVATIONS GIVEN ON THESE SHEETS.

DESIGN FOR RETAINING WALL TO PROVIDE FOR FINISHED GRADE SLOPED BEHIND WALL AS SHOWN.

DESIGN RETAINING WALL FOR A LIVE LOAD SURCHARGE OF 240 PSF.

ULTIMATE DESIGN STRESSES:  
CONCRETE MASONRY (CONCRETE COPING):  $f_c = 4000$  P.S.I.  
STEEL REINFORCEMENT:  $f_y = 60,000$  P.S.I.  
BAR STEEL REINFORCEMENT, GRADE 60

**LIST OF DRAWINGS**

1. GENERAL PLAN & ELEVATION
2. QUANTITIES, NOTES & PROFILE GRADE LINES
3. TYPICAL WALL SECTIONS
4. SUBSURFACE EXPLORATION
5. ANCHOR SLAB REINFORCEMENT
6. MODIFIED VERTICAL FACE PARAPET "A"
7. RAILING DETAILS 1
8. RAILING DETAILS 2
9. RAILING DETAILS 3
10. RAILING DETAILS 4
11. RAILING DETAILS 5
12. RESTRETIC DETAILS 1
13. RESTRETIC DETAILS 2
14. RESTRETIC DETAILS 3

**LEGEND**

(E) EXPANSION JOINT

Addendum No. 1  
ID 1060-33-83  
Revised Sheet 328  
May 5, 2015

*William C. Decker* 4/30/15

STRUCTURE DESIGN CONTACTS:  
NICK RICE (608) 266-0092  
AARON BOK (608) 261-0261

NO.	DATE	REVISION	BY
1	4/30	ADDED NEW SHEET	NAR



Plans Prepared by  
**WISDOT**  
BUREAU OF STRUCTURES

ACCEPTED	CHIEF STRUCTURES DESIGN ENGINEER	DATE
<b>STRUCTURE R-40-626</b>		
PEDESTRIAN PATH OVER USH 45		
COUNTY	MILWAUKEE	WALWATOSA
DESIGN SPEC.	MMW/CITY/AREA	WALWATOSA
ASSTD. LIED. DESIGN SPEC.	MMW/CITY/AREA	WALWATOSA
DESIGNED BY	NAR/CDB	PLANS
		ABS BY NAR/CDBS (CDB)

**GENERAL PLAN & ELEVATION**  
SHEET 1 OF 1  
**328**

DATE: MAR. 2015

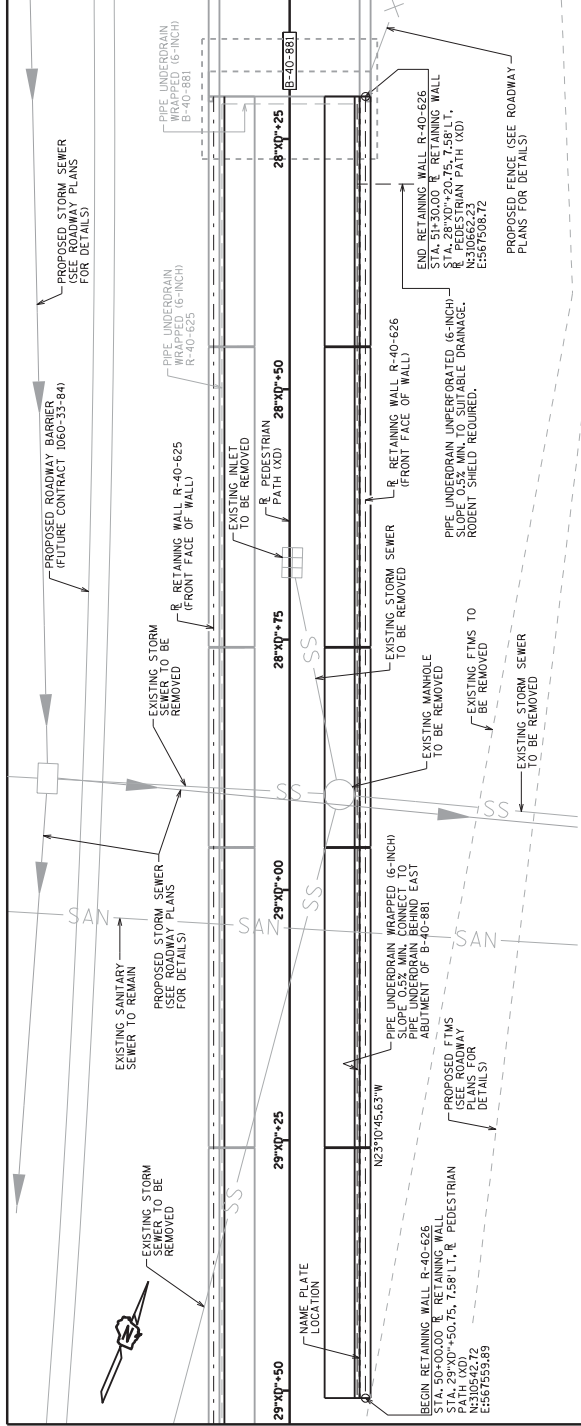

**PLAN**

(PRECAST CONCRETE PANEL WISE WALL)

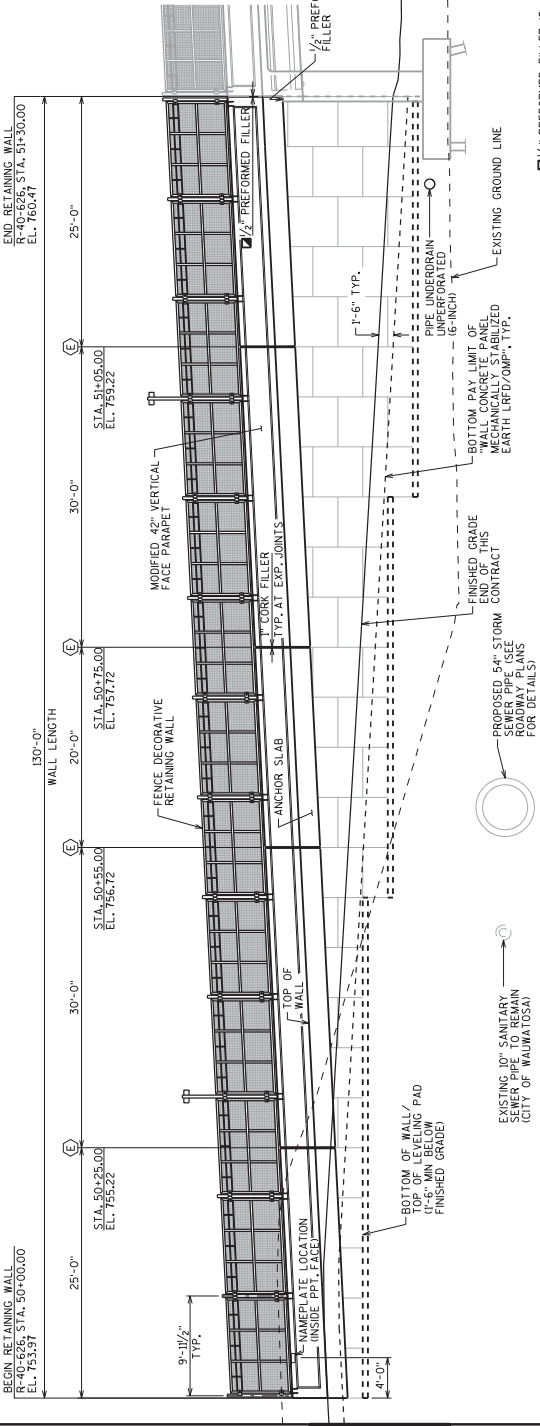

**ELEVATION**

(LOOKING SOUTHWEST FROM FACE OF WALL)

DISTANCES AND STATIONS ARE GIVEN ALONG THE FRONT FACE OF WALL



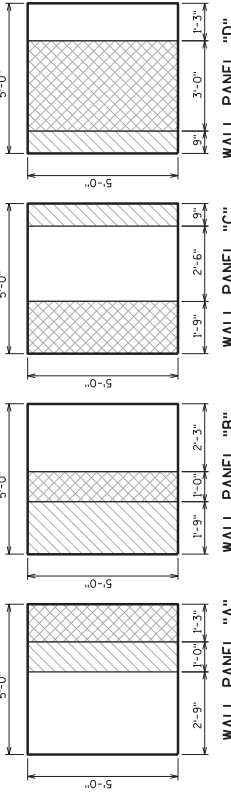

5'-0" X 5'-0" MSE CONCRETE PANEL RAISED SURFACE DETAILS

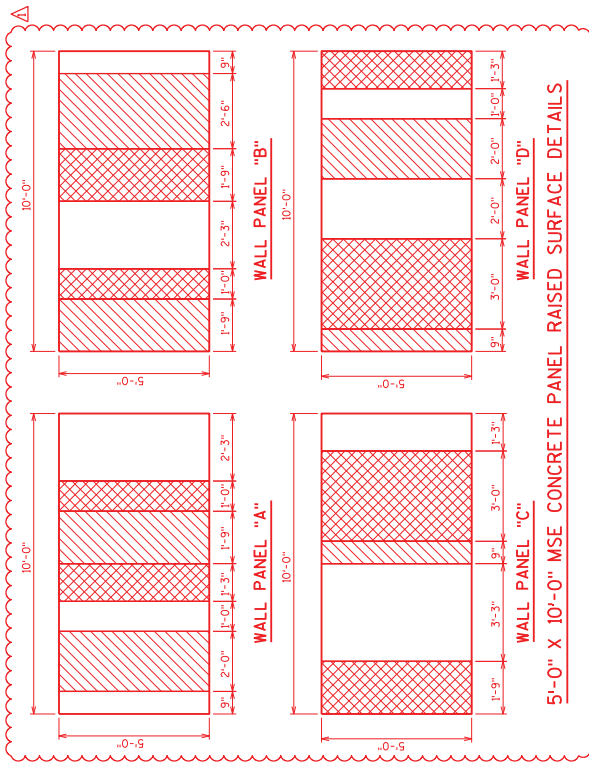

CONCRETE STAINING IS NOT INCLUDED IN THIS CONTRACT. CONCRETE STAINING WILL BE DONE BY OTHERS UNDER A FUTURE CONTRACT.

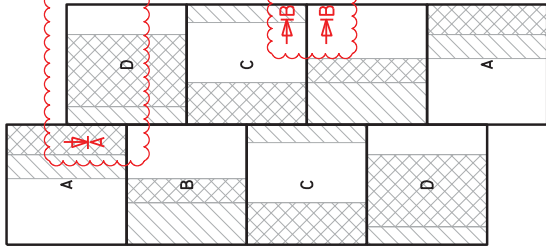

TYPICAL 5'-0" X 5'-0" MSE CONCRETE PANEL PATTERN

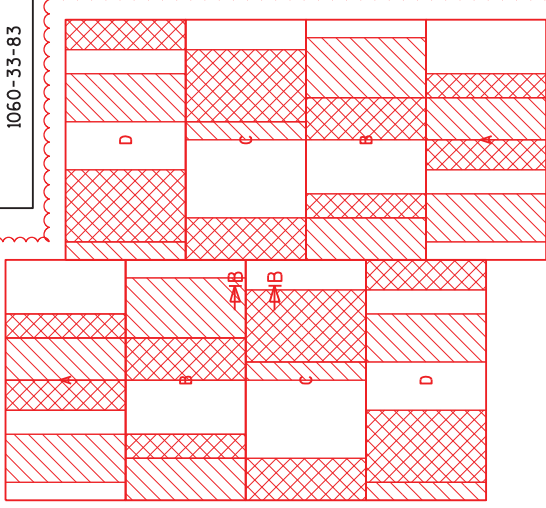

TYPICAL 5'-0" X 10'-0" MSE CONCRETE PANEL PATTERN

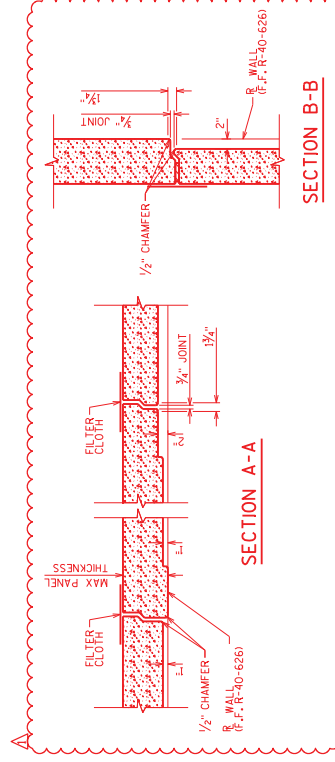

Addendum No. 1  
ID 1060-33-83  
Revised Sheet 339  
May 5, 2015

William C. Decker 4/30/15

NO.	DATE	MSE PANEL REVISIONS	REVISION	BY
4/20				

STATE OF WISCONSIN  
DEPARTMENT OF TRANSPORTATION  
STRUCTURES DESIGN SECTION  
STRUCTURE R-40-626  
DRAWN BY: DDS  
CHECKED BY: ABS

AESTHETIC DETAILS 1  
SHEET 12  
339

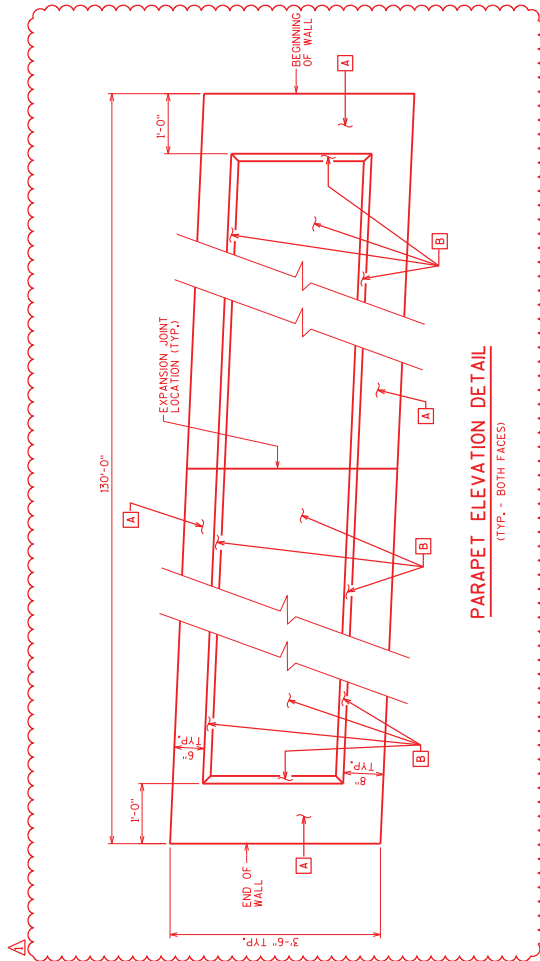
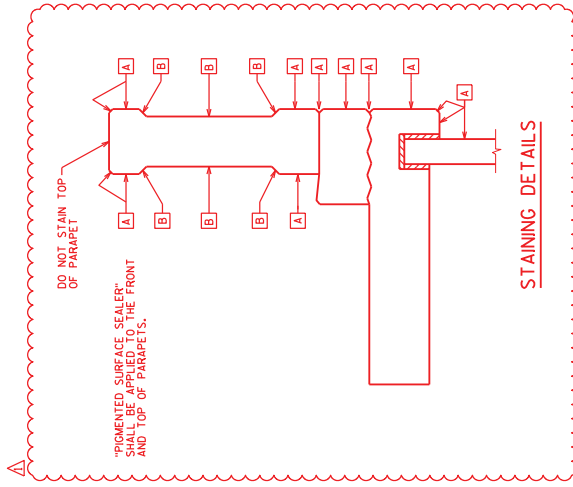

PARAPET ELEVATION DETAIL  
(TYP. - BOTH FACES)

Addendum No. 1  
ID 1060-33-83  
Added Sheet 339A  
May 5, 2015

*William C. Decker*  
4/30/15

CONCRETE STAINING SCHEDULE

MARK	COLOR	LOCATION	NOTES
A	BASE COLOR	PARAPETS COPING WALL PANELS	BOTH SIDES, EXCEPT AS NOTED FOR ACCENT COLORS ALL EXPOSED EXTERIOR SURFACES FRONT FACE FROM TOP OF WALL PANEL TO 1'-0" BELOW FINISHED GRADE LINE.
B	ACCENT COLOR #1	PARAPETS	REVEALS ON PARAPETS

THE FINAL COLOR OF THE CONCRETE FOLLOWING APPLICATION OF THE STAIN SYSTEM SHALL MATCH THE SHERWIN-WILLIAMS STANDARD COLOR SYSTEM LISTED.  
BASE COLOR #1: BAGUETTE - SW 6123 FN 122  
ACCENT COLOR #1: BAGUETTE - SW 6123 FN 124

CONCRETE STAINING IS NOT INCLUDED IN THIS CONTRACT. CONCRETE STAINING WILL BE DONE BY OTHERS UNDER A FUTURE CONTRACT.

NO.	DATE	REARRANGEMENT OF DETAILS	BY
4/20			NAR
STATE OF WISCONSIN DEPARTMENT OF TRANSPORTATION STRUCTURES DESIGN SECTION			
DRAWN BY		DESIGNED BY	DATE
DDS		DDS	4/30/15
PROJECT NAME			SHEET NO.
STRUCTURE R-40-626			339A
DRAWN BY			DATE
DDS			4/30/15
PROJECT NAME			SHEET NO.
STRUCTURE R-40-626			339A

AESTHETIC DETAILS 2

4/30/15