

# Wisconsin Department of Transportation

December 2, 2015

## Division of Transportation Systems Development

Bureau of Project Development  
4802 Sheboygan Avenue, Rm 601  
P O Box 7916  
Madison, WI 53707-7916

Telephone: (608) 266-1631  
Facsimile (FAX): (608) 266-8459

### NOTICE TO ALL CONTRACTORS:

**Proposal #03: 1023-00-72, WISC 2015 651**  
**Black River Falls - Tomah**  
**CTH O To South County Line**  
**(EB)**  
**IH 94**  
**Jackson County**

**1023-00-80, WISC 2015 652**  
**Black River Falls - Tomah**  
**CTH O To South County Line**  
**(WB)**  
**IH 94**  
**Jackson County**

**1023-06-73, WISC 2015 653**  
**Black River Falls - Tomah**  
**North County Line To CTH EW**  
**(EB)**  
**IH 94**  
**Monroe County**

**1023-06-75, WISC 2015 654**  
**Black River Falls - Tomah**  
**North County Line To CTH EW**  
**(WB)**  
**IH 94**  
**Monroe County**

### Letting of December 8, 2015

This is Addendum No. 01, which provides for the following:

#### Special Provisions

Revised Special Provisions	
Article No.	Description
3	Prosecution and Progress.

#### Schedule of Items

Revised Bid Item Quantities					
Bid Item	Item Description	Unit	Old Quantity	Revised Quantity	Proposal Total
204.0115	Removing Asphaltic Surface Butt Joints	SY	10,750	-5,586	5,164
205.0100	Excavation Common	CY	35,374	-26,473	8,901
208.0100	Borrow	CY	66,706	5,908	72,614
635.0300	Sign Supports Replacing Base Connection Bolts	EACH	72	-63	9

Added Bid Item Quantities					
Bid Item	Item Description	Unit	Old Quantity	Revised Quantity	Proposal Total
204.0105	Removing Pavement Butt Joints	SY	0	5,586	5,586

### Plan Sheets

Revised Plan Sheets	
Plan Sheet	Plan Sheet Title (brief description of changes to sheet)
3	GENERAL NOTES – EAST BOUND – Changed note regarding cross sections located in the plan.
9	TYPICAL SECTIONS: PROPOSED (EB & WB) – Changed ditch fore slopes and removed unnecessary information.
76	MISCELLANEOUS QUANTITIES – EAST BOUND – Changed Removing Asphaltic Surface Butt Joints to Removing Pavement Butt Joints as reflected in the bid item quantity changes above.
77	MISCELLANEOUS QUANTITIES – EAST BOUND – Changed Excavation Common and Borrow quantities based on changes to cross sections.
85	MISCELLANEOUS QUANTITIES – EAST BOUND – Changed quantity of Sign Supports Replacing Base Connection Bolts to reflect the correct amount of signs and not individual bolts.
98	MISCELLANEOUS QUANTITIES – WEST BOUND - Changed quantity of Sign Supports Replacing Base Connection Bolts to reflect the correct amount of signs and not individual bolts.
108	MISCELLANEOUS QUANTITIES – EAST BOUND – Changed Removing Asphaltic Surface Butt Joints to Removing Pavement Butt Joints as reflected in the bid item quantity changes above.
110	MISCELLANEOUS QUANTITIES – EAST BOUND – Changed Excavation Common and Borrow quantities based on changes to cross sections.
120	MISCELLANEOUS QUANTITIES – EAST BOUND – Changed quantity of Sign Supports Replacing Base Connection Bolts to reflect the correct amount of signs and not individual bolts.
137	MISCELLANEOUS QUANTITIES – WEST BOUND - Changed quantity of Sign Supports Replacing Base Connection Bolts to reflect the correct amount of signs and not individual bolts.

Added Plan Sheets	
Plan Sheet	Plan Sheet Title (brief description of why sheet was added)
359A	CROSS SECTIONS: IH 94 EB – Corrected slope intercepts to eliminate unnecessary earthwork to coincide with the Regions intention and scope of the project. STA 2425+00 – STA 2426+00
459A	CROSS SECTIONS: IH 94 EB – Corrected slope intercepts to eliminate unnecessary earthwork to coincide with the Regions intention and scope of the project. STA 2596+00
459B	CROSS SECTIONS: IH 94 EB – Corrected slope intercepts to eliminate unnecessary earthwork to coincide with the Regions intention and scope of the project. STA 2597+00 – STA 2598+00
496A	CROSS SECTIONS: IH 94 EB – Corrected slope intercepts to eliminate unnecessary earthwork to coincide with the Regions intention and scope of the project. STA 2473+00 – STA 2474+00
547A	CROSS SECTIONS: IH 94 EB – Corrected slope intercepts to eliminate unnecessary earthwork to coincide with the Regions intention and scope of the project. STA 2178+00 – STA 2179+79

547B	CROSS SECTIONS: IH 94 EB – Corrected slope intercepts to eliminate unnecessary earthwork to coincide with the Regions intention and scope of the project. STA 2180+00 – STA 2182+00
632A	CROSS SECTIONS: IH 94 EB – Corrected slope intercepts to eliminate unnecessary earthwork to coincide with the Regions intention and scope of the project. STA 2308+00 – STA 2310+00

<b>Deleted Plan Sheets</b>	
Plan Sheet	Plan Sheet Title (brief description of why sheet was deleted)
360	CROSS SECTIONS: IH 94 EB – Unnecessary common excavation and incorrect slope intercept. STA 2424+50 – STA 2425+00
361	CROSS SECTIONS: IH 94 EB – Unnecessary common excavation and incorrect slope intercept. STA 2425+50 – STA 2426+00
460	CROSS SECTIONS: IH 94 EB – Unnecessary common excavation and incorrect slope intercept. STA 2595+50
461	CROSS SECTIONS: IH 94 EB – Unnecessary common excavation and incorrect slope intercept. STA 2596+00
462	CROSS SECTIONS: IH 94 EB – Unnecessary common excavation and incorrect slope intercept. STA 2596+50
463	CROSS SECTIONS: IH 94 EB – Unnecessary common excavation and incorrect slope intercept. STA 2597+00
464	CROSS SECTIONS: IH 94 EB – Unnecessary common excavation and incorrect slope intercept. STA 2597+50
465	CROSS SECTIONS: IH 94 EB – Unnecessary common excavation and incorrect slope intercept. STA 2598+00
466	CROSS SECTIONS: IH 94 EB – Unnecessary common excavation and incorrect slope intercept. STA 2598+50 - STA 2599+00
476	CROSS SECTIONS: IH 94 EB – A bridge is located at these stations cross sections are unnecessary.
477	CROSS SECTIONS: IH 94 EB – A bridge is located at these stations cross sections are unnecessary.
478	CROSS SECTIONS: IH 94 EB – A bridge is located at these stations cross sections are unnecessary.
489	CROSS SECTIONS: IH 94 EB – A bridge is located at these stations cross sections are unnecessary.
490	CROSS SECTIONS: IH 94 EB – A bridge is located at these stations cross sections are unnecessary.
497	CROSS SECTIONS: IH 94 EB – Unnecessary common excavation and incorrect slope intercept. STA 2472+50 - STA 2473+00
498	CROSS SECTIONS: IH 94 EB – Unnecessary common excavation and incorrect slope intercept. STA 2473+50 - STA 2474+00
548	CROSS SECTIONS: IH 94 EB – Unnecessary common excavation and incorrect slope intercept. STA 2177+50 - STA 2178+50
549	CROSS SECTIONS: IH 94 EB – Unnecessary common excavation and incorrect slope intercept. STA 2179+00 - STA 2179+79
550	CROSS SECTIONS: IH 94 EB – Unnecessary common excavation and incorrect slope intercept. STA 2180+00 - STA 2181+00
633	CROSS SECTIONS: IH 94 EB – Unnecessary fill and incorrect slope intercept. STA 2309+50 - STA 2310+00

The responsibility for notifying potential subcontractors and suppliers of these changes remains with the prime contractor.

Sincerely,

*Mike Coleman*

Proposal Development Specialist  
Proposal Management Section

**ADDENDUM NO. 01**

**1023-00-72, 1023-00-80, 1023-06-73, 1023-06-75**

**December 02, 2015**

**Special Provisions**

**3. Prosecution and Progress.**

*Add the following:*

**Northern Long-eared Bat (*Myotis septentrionalis*)**

Northern Long-eared Bats (NLEB) have the potential to inhabit the project limits because they roost in trees and structures (bridges, culverts, buildings). Roosts may not have been observed on this project, but conditions to support the species exist. The species and all active roosts are protected by the Federal Endangered Species Act.

In order to avoid adverse impacts upon the NLEBs, no vegetation clearing and grubbing within the identified clearing and grubbing limits will be allowed from April 1 to September 30, both dates inclusive.

If the required clearing and removal is not completed by March 31, the department will suspend all clearing and associated work directly impacted by clearing. The department will issue a notice to proceed with clearing and associated work directly impacted by clearing after consulting with the United States Fish and Wildlife Service (USFWS).

Submit a schedule and description of Clearing and/or Grubbing operations with the ECIP 14 days prior to any Clearing operations. The department will determine, based on schedule and scope of work, what additional erosion control measures shall be implemented prior to the start of Clearing operations, and list those additional measures in the ECIP.

**Schedule of Items**

Attached, dated December 2, 2015, are the revised Schedule of Items Pages 1, 2, 11, and 22.

**Plan Sheets**

The following 8½ x 11-inch sheets are attached and made part of the plans for this proposal:

Revised: 3, 9, 76, 77, 85, 98, 108, 110, 120, and 137.

Added: 359A, 459A, 459B, 496A, 547A, 547B, and 632A.

END OF ADDENDUM

LIST OF STANDARD ABBREVIATIONS

AH. APPROX.  
 ASPH. ASPHALTIC  
 A.D.T. AIRCRAFT DAILY TRAFFIC  
 B.V. OR B.V. CENTER LINE  
 CONC. CONCRETE  
 CONST. CONSTRUCTION  
 COUNTY TRUNK HIGHWAY  
 C.T.H. DEPARTMENT OF TRANSPORTATION  
 D.O.T. DESIGN HOUR VOLUME  
 D.H.V. EAST  
 E. EASTBOUND  
 EB ELECTRIC  
 ELEC. ELECTRIC  
 ES&S EXISTING  
 EXIST. EXISTING  
 INLET INLET  
 L.T. LEFT  
 L.H.F. LEFT-HAND FORWARD  
 MAX. MAXIMUM  
 MISC. MISCELLANEOUS  
 N. NORTH  
 NOR. NORMALLY  
 P.C. POINT OF CURVATURE  
 P.I. POINT OF INTERSECTION  
 P.T. POINT OF TANGENCY  
 REQ'D. REQUIRED  
 R/L OR ~ REFERENCE LINE  
 RT. RIGHT  
 R.H.F. RIGHT-HAND FORWARD  
 R/W. RIGHT OF WAY  
 S.O.D. SOUTHWARD DETAIL DRAWINGS  
 SHLDR. SHOULDER  
 S.T.H. STATE TRUNK HIGHWAY  
 STA. STATION  
 TEL. TELEPHONE  
 TEMP. TEMPORARY  
 W. WEST  
 W.C.S. (PERCENT OF) WECS  
 WB WESTBOUND  
 WZ WORK ZONE

GENERAL NOTES

CURVE DATA IS BASED ON THE ARC DEFINITION.  
 RESHAPE AND SEED ANY PREVIOUSLY GRASSED AREAS THAT ARE DISTURBED BY OPERATIONS OUTSIDE THE NORMAL CONSTRUCTION LIMITS.  
 THERE ARE UTILITY FACILITIES WITHIN THE PROJECT AREA THAT ARE NOT SHOWN ON THE PLANS. COORDINATE CONSTRUCTION ACTIVITIES WITH A CALL TO DIGGERS HOTLINE AND/OR A DIRECT CALL TO THE UTILITIES THAT HAVE FACILITIES IN THE AREA. NOT ALL UTILITIES ARE MEMBERS OF DIGGERS HOTLINE. UTILITY FACILITIES WERE NOT FIELD LOCATED AND VERIFIED.  
 NO REMOVAL OF ANY SURVEY MARKER REQUIRES APPROVAL OF THE ENGINEER.  
 STATIONING, DISTANCE AND OFFSETS FOR PERMANENT SIGNS SHOWN ON THE PLANS ARE APPROXIMATE. ACTUAL LOCATIONS OF SIGNS ARE TO BE COORDINATED IN THE FIELD BY THE ENGINEER.  
 JOINT TIES REQUIRED FOR ALL PIPE WORK.  
 REMOVE ANY LOOSE MATERIAL AND  
 FILL DOWEL BAR SLOTS ON EASTBOUND IH 94 BEFORE PAVING PAID AS ASPHALTIC SURFACE PATCHING

S.D.D. 15 C 31 REPLACE WET REFLECTIVE TAPE WITH GROOVED WET REFLECTIVE EPOXY.  
 X-SECTIONS ARE FOR INFORMATIONAL USE ONLY. FINAL SECTIONS WILL BE DETERMINED BY THE CONTRACTOR USING EXISTING PAVEMENT ELEVATIONS OBTAINED BY THE CONTRACTOR. REVIEW DATA WITH THE PROJECT ENGINEER. USE THE EXISTING FIELD DATA TO PERFORM THE CONSTRUCTION STAKING SLOPE STAKES ITEM.

**DESIGN CONTACT**  
 MIKE BERTHOLD, P.E.  
 WISDOT NW REGION  
 718 W. CLAREMONT AVENUE  
 EAU CLAIRE, WI 54701  
 (715)836-3922  
 MIKE.BERTHOLD@DOT.WI.GOV

24-HOUR SPILLS HOTLINE  
 (800)943-0003

**DIGGERS HOTLINE**  
 Dial 811 or (800)242-8511  
 www.DiggersHotline.com

**DNR LIASON**  
 DNR WEST CENTRAL REGION HEADQUARTERS  
 ATTN: KAREN KALVELAGE  
 3550 MORMON COULLEE ROAD  
 LA CROSSE, WI 54601  
 608-785-9000  
 Karen.Kalvelage@wisconsin.gov

UTILITIES

**COMMUNICATIONS LINE**  
 CENTURYLINK (1023-00-72; 1023-06-73)  
 24-HOUR EMERGENCY REPAIR  
 800-824-2877  
 FIELD CONTACT  
 DONNA SMOTHERS  
 835 RED IRON ROAD  
 BLACK RIVER FALLS, WI 54615  
 715-284-4375 (OFFICE)  
 715-797-4854 (MOBILE)  
 donna.smotherse@CenturyLink.com

**ELECTRICITY - DISTRIBUTION**  
 ALLIANT ENERGY (1023-06-73)  
 MARK SCHOEN  
 338 E STATE STREET  
 MAUSTON, WI 53948  
 608-847-1315 (OFFICE)  
 608-206-4819 (MOBILE)  
 mark.schoene@alliantenergy.com

JACKSON ELECTRIC COOPERATIVE (1023-00-72)  
 ERIC STEIN  
 N6868 COUNTY HWY F  
 PO BOX 546  
 BLACK RIVER FALLS, WI 54615-0546  
 715-284-5385 (OFFICE)  
 este@jacksonelec.com

**SEWER & WATER**  
 WARRENS, VILLAGE OF (1023-06-73)  
 BRIAN KNOECKER  
 301 MAIN STREET  
 PO BOX 97  
 WARRENS, WI 54666-0097  
 608-378-4177 (OFFICE)  
 608-343-7601 (MOBILE)  
 warrensch@centuryrel.net

**RAILROAD**  
 UNION PACIFIC RAILROAD  
 101 NORTH WACKER DRIVE, SUITE 1920  
 CHICAGO, IL 60606  
 ATTN: JOHN VENICE  
 (312)777-2043  
 JNVENICE@UP.COM

Addendum No. 01  
 ID 1023-00-72  
 ID 1023-00-80  
 ID 1023-06-73  
 ID 1023-06-75  
 Revised Sheet 3  
 December 2, 2015

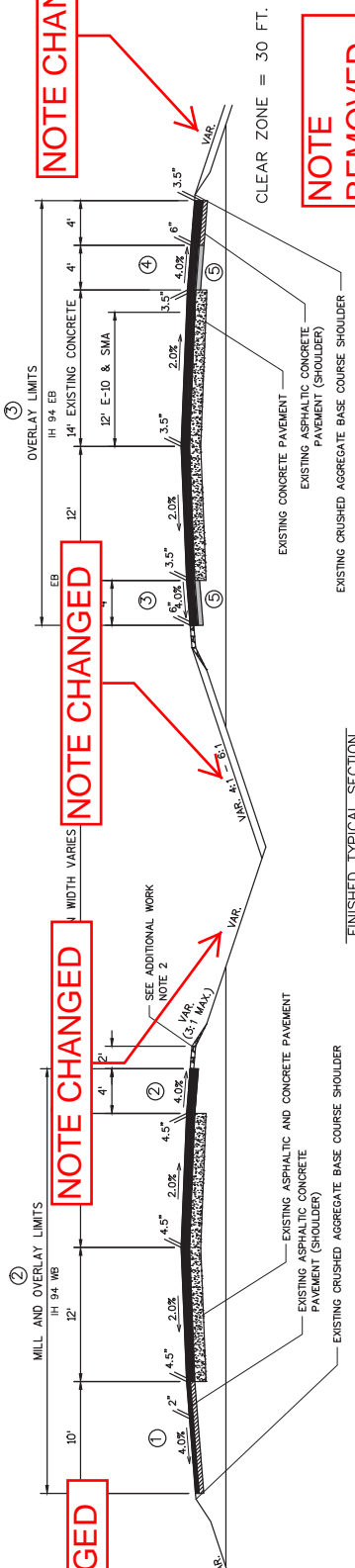

**NOTE CHANGED**

**NOTE CHANGED**

**NOTE CHANGED**

**NOTE CHANGED**

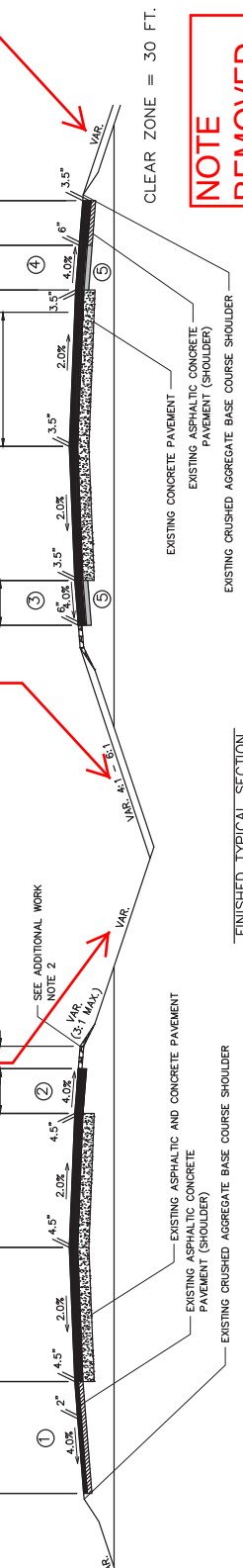

**NOTE REMOVED**

JACKSON & MONROE COUNTY  
 CTH 0 - CTH EW  
 STA. 2137+61 - STA. 2614+00

**NOTE CHANGED**

**NOTE CHANGED**

**NOTE CHANGED**

**NOTE CHANGED**

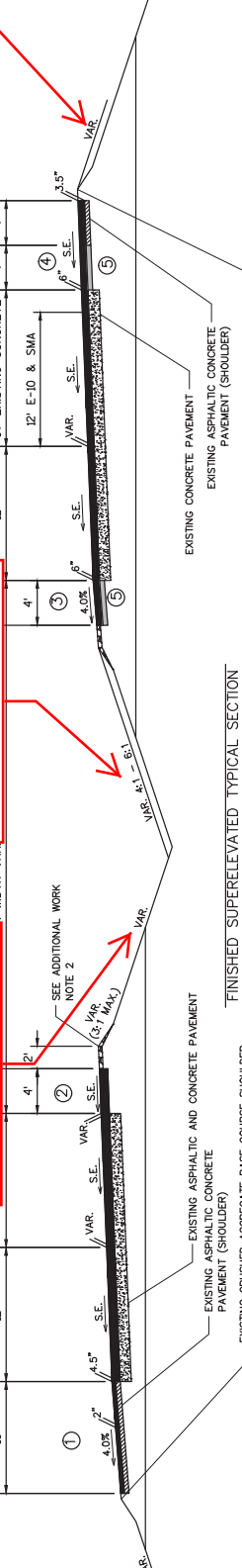

JACKSON & MONROE COUNTY  
 CTH 0 - CTH EW

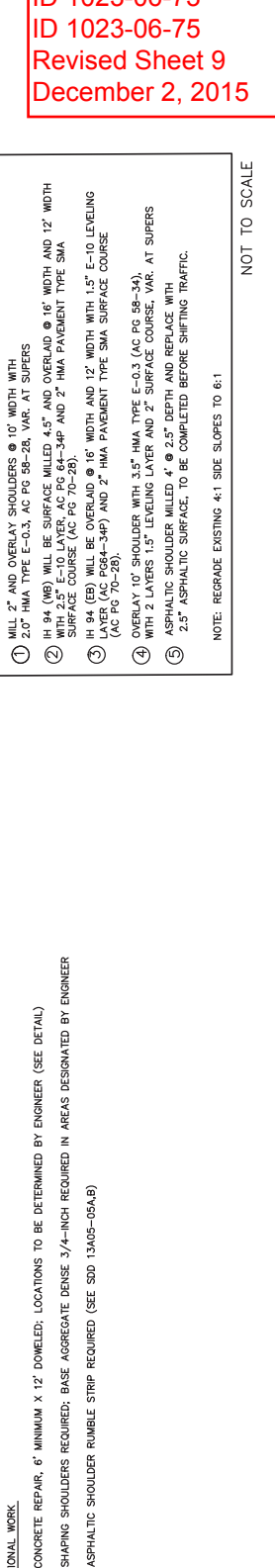

**NOTE CHANGED**

**NOTE CHANGED**

**NOTE CHANGED**

**NOTE CHANGED**

ADDITIONAL WORK:  
 1) CONCRETE REPAIR, 6" MINIMUM X 12" DOMEDED; LOCATIONS TO BE DETERMINED BY ENGINEER (SEE DETAIL)  
 2) SHAPING SHOULDERS REQUIRED; BASE AGGREGATE DENSE 3/4-INCH REQUIRED IN AREAS DESIGNATED BY ENGINEER  
 3) ASPHALTIC SHOULDER RUMBLE STRIP REQUIRED (SEE SDD 13405-054B)

- LEGEND**
- ① MILL 2" AND OVERLAY SHOULDERS @ 10' WIDTH WITH 2.0" HMA TYPE E-0.3, AC PG 58-28, VAR. AT SUPERS
  - ② IH 94 (WB) WILL BE SURFACE MILLED 4.5" AND OVERLAD @ 16" WIDTH AND 12" WIDTH SURFACE COURSE (AC PG 58-28)
  - ③ IH 94 (EB) WILL BE OVERLAD @ 16" WIDTH AND 12" WIDTH WITH 1.5" E-10 LEVELING LAYER (AC PG 58-28) AND 2" HMA PAVEMENT TYPE SMA SURFACE COURSE (AC PG 70-28)
  - ④ OVERLAY 10' SHOULDER WITH 3.5" HMA TYPE E-0.3 (AC PG 58-28) WITH 2 LAYERS 1.5" LEVELING LAYER AND 2" SURFACE COURSE. VAR. AT SUPERS
  - ⑤ ASPHALTIC SHOULDER MILLED 4" @ 2.5" DEPTH AND REPLACE WITH 2.5" ASPHALTIC SURFACE, TO BE COMPLETED BEFORE SHIFTING TRAFFIC.
- NOTE: REGRADE EXISTING 4:1 SIDE SLOPES TO 6:1  
 NOT TO SCALE

**Addendum No. 01**  
 ID 1023-00-72  
 ID 1023-00-80  
 ID 1023-06-73  
 ID 1023-06-75  
 Revised Sheet 9  
 December 2, 2015

Addendum No. 01  
 ID 1023-00-72  
 ID 1023-00-80  
 ID 1023-06-73  
 ID 1023-06-75  
 Revised Sheet 76  
 December 2, 2015

ROADSIDE CLEARING

CATEGORY	STATION TO	STATION	LOCATION	REMARKS	202. 0105	STA	REMARKS
0010	24' 0" +25	- 26' 0" +25	CTH 0 RT.	20FT. STRIP OF TREES	2	2	
	TOTAL	0010				2	
<u>REMOVING ASPHALTIC SURFACE</u>							
CATEGORY	STATION TO	STATION	LOCATION	REMARKS	204. 0110	SY	REMARKS
0010	2155+00		CTH 0 EXIT RAMP RT.	FLUME 6' X 20'	14		
0010	2155+00		CTH 0 EXIT RAMP LT.	FLUME 6' X 20'	14		
	TOTAL	0010				28	

REMOVING PAVEMENT BUTT JOINTS

CATEGORY	STATION TO	STATION	LOCATION	REMARKS	204. 0105	SY	REMARKS
0010	2137+61	- 2372+92	IH 94 EB		2032		
	TOTAL	0010				2032	

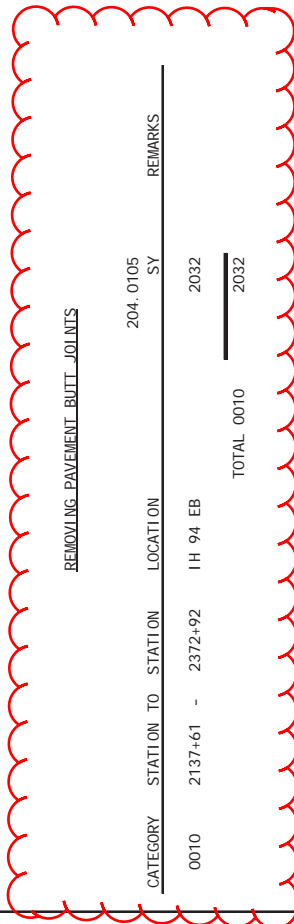

REMOVING ASPHALTIC SURFACE MILLING

CATEGORY	STATION TO	STATION	LOCATION	REMARKS	204. 0120	SY	REMARKS
0010			MAINTENANCE X-OVERS	DEPTH 1.75-INCH	445		
0010	2137+61	- 2372+92.34	IH 94 RT. SHLD 4' WIDE		10459		
0010	2137+61	- 2372+92.34	IH 94 LT. SHLD 4' WIDE		10459		
0010	12+50	- 20+00	CTH 0	ROADWAY	2000		
0010	12+50	- 20+00	CTH 0	SHOULDERS	1334		
	TOTAL	0010				24697	

REMOVING DELINEATORS AND MARKERS

CATEGORY	STATION TO	STATION	LOCATION	REMARKS	204. 0180	EACH	REMARKS
0010	2137+61	- 2372+92	IH 94		82		
0010	2158+00	- 2180+00	CTH 0 ENTRANCE RAMP		26		
0010	2140+00	- 2156+00	CTH 0 EXIT RAMP		18		
0010	2137+61	- 2372+92	IH 94	CULVERTS	32		
	TOTAL	0010				158	

REMOVING (ITEM DESCRIPTION) 01. APRON ENDWALLS

CATEGORY	STATION TO	STATION	LOCATION	REMARKS	204. 9060. S. 01	EACH	REMARKS
0010	2137+61	- 2258+00	IH 94	RIGHT UNDERDRAIN 6-INCH	48		
0010	2137+61	- 2258+00	IH 94	LEFT UNDERDRAIN 6-INCH	42		
0010	2259+00	- 2372+92	IH 94	RIGHT UNDERDRAIN 6-INCH	36		
0010	2259+00	- 2372+92	IH 94	LEFT UNDERDRAIN 6-INCH	41		
0010	2578+10		IH 94	RIGHT 36"	1		
0010	2603+38		IH 94	RIGHT 36"	1		
0010	2607+00		IH 94	RIGHT 18"	1		
0010	2611+00		IH 94	RIGHT 30"	1		
	TOTAL	0010				171	

PROJECT NO: 1023-00-72

HWY: IH 94

COUNTY: JACKSON

MISCELLANEOUS QUANTITIES - EAST BOUND

SHEET: 76

E



Division	From/To Station	Common Excavation (1)		Salvaged/Unusable Pavement Material (3)	Available Material (4)	Unexpanded Fill	Expanded Fill (5)		Mass Ordinate +/- (6)	Waste	Borrow
		Cut (2)	Item #205.0100				Factor	Factor			
Division 1	090201-IH 94 JC EB	1,779	0	0	1,779	9,043	11,304	11,304	-9,525	0	(Item #208.0100) 9,525
	Division 1 Subtotal	1,779	0	0	1,779	9,043	11,304	11,304	-9,525	0	9,525
Division 2	090202-IH 94 JC EB	37	0	0	37	9,463	11,829	11,829	-11,792	0	11,792
	Division 2 Subtotal	37	0	0	37	9,463	11,829	11,829	-11,792	0	11,792
Division 3	090203-IH 94 JC EB	199	0	0	199	11,624	14,530	14,530	-14,332	0	14,332
	Division 3 Subtotal	199	0	0	199	11,624	14,530	14,530	-14,332	0	14,332
Division 4	090204-IH 94 JC EB	655	0	0	655	6,018	7,522	7,522	-6,867	0	6,867
	Division 4 Subtotal	655	0	0	655	6,018	7,522	7,522	-6,867	0	6,867
Grand Total		2,670.33	0.00	0.00	2,670.33	36,148.11	45,185.14	45,185.14	-42,514.81	0.00	42,514.81
	<b>Total Common Exc</b>	<b>2,670.33</b>	<b>0.00</b>	<b>0.00</b>	<b>2,670.33</b>	<b>36,148.11</b>	<b>45,185.14</b>	<b>45,185.14</b>	<b>-42,514.81</b>	<b>0.00</b>	<b>42,514.81</b>

- 1) Item number 205.0100
- 2) Salvaged/Unusable Pavement Material is included in Cut.
- 3) Salvaged/Unusable Pavement Material
- 4) Available Material = Cut - Salvaged/Unusable Pavement Material
- 5) Expanded Fill. Factor = 1.25
- 6) The Mass Ordinate + or - Qty calculated for the Division. Plus quantity indicates an excess of material within the Division. Minus indicates a shortage of material within the Division.

Addendum No. 01  
 ID 1023-00-72  
 ID 1023-00-80  
 ID 1023-06-73  
 ID 1023-06-75  
 Revised Sheet 77  
 December 2, 2015

SIGN SUPPORTS REPLACING BASE CONNECTION BOLTS

CATEGORY	STATION	LOCATION	635.0300 EACH	REMARKS
0010	2139+61	IH 94 RT.	1	EXIT 128
0010	2200+00	IH 94 RT.	1	MILEAGE
TOTAL 0010			<u>2</u>	

SIGNS TYPE I REFLECTIVE H

CATEGORY	SIGN CODE	STATION	SIZE	LOCATION	637.1210 SF	REMARKS
0010	E1-5P	2139+61	108 X 30	IH 94	22.5	EXIT 128
0010	E4-1A	2200+00	192 X 90	IH 94	120.0	MILLSTON / 0 / ARROW
0010	D2-2	2200+00	168 X 60	IH 94	70.0	TOMAH MADISON
TOTAL 0010					<u>212.5</u>	

REMOVING SIGNS TYPE I

CATEGORY	STATION	LOCATION	638.2601 EACH	REMARKS
0010	2139+61	IH 94	1	EXIT 128
0010	2200+00	IH 94	1	MILEAGE SIGN
TOTAL 0010			<u>2</u>	

Addendum No. 01  
 ID 1023-00-72  
 ID 1023-00-80  
 ID 1023-06-73  
 ID 1023-06-75  
 Revised Sheet 85  
 December 2, 2015

CATEGORY	SIGN CODE	STATION	SIZE	SIGN DESCRIPTION	WOOD 4 X 6 14-FT 634.0614 EACH	WOOD 4 X 6 16-FT 634.0616 EACH	WOOD 4 X 6 18-FT 634.0618 EACH	WOOD 4 X 6 20-FT 634.062 EACH	SIGNS TYPE 11 REF H 637.221 SF	TYPE 11 FOLDING 637.2215 SF	SIGNS TYPE 11 REF F 637.223 SF	REMOVING SIGNS TYPE 11 638.2602 EACH	SMALL SIGN SUPPORTS 638.3 EACH	REMARKS
0020	G27-12	16' C' +90 RT.		ID PLAQUE					0.60					
0020	G27-13	23' C' +00 LT.		ID PLAQUE					0.60					
0020	CCTV	2158+00		ID PLAQUE					0.60					
0020	SDS	2158+00		ID PLAQUE										
0020	R11-54F	17' C' +00 RT.		ID PLAQUE	2					10.00				
0020	R11-54F	18' C' +50 LT.		ID PLAQUE	2					10.00				
0020	R11-54F	22' C' +50 RT.		ID PLAQUE	2					10.00				
0020	R11-54F	24' C' +50 LT.		ID PLAQUE	2					10.00				
TOTAL 0020					8.0				2.40	40.00				
PROJECT TOTAL					14.0				263.76	53.50				

CCTV-27-0036  
SDS-27-0008

Addendum No. 01  
ID 1023-00-72  
ID 1023-00-80  
ID 1023-06-73  
ID 1023-06-75  
Revised Sheet 98  
December 2, 2015

CATEGORY	SIGN CODE	SIZE	SIGN DESCRIPTION	LOCATION	SIGN SUPPORTS REPLACING BASE CON BOLTS 635.0300 EACH	SIGNS TYPE 1 REF H 637.1210 SF	REMOVING SIGNS TYPE 1 638.2601 EACH	REMARKS
0010	E1-5P	108 X 30	EXIT 128	IH 94	0	22.5	1	
0010	E4-1A	192 X 90	0 / MILLSTON / ARROW	IH 94	1	120.0	1	
0010	E3-1	156 X 84	STATE FOREST EXIT 128	IH 94	1	91.0	1	
0010	E1-5P	108 X 30	EXIT 128	IH 94	0	22.5	1	
0010	E1-1A	168 X 120	0 / MILLSTON / 1 MILE	IH 94	1	140.0	1	
TOTAL 0010					3	396.0	5	

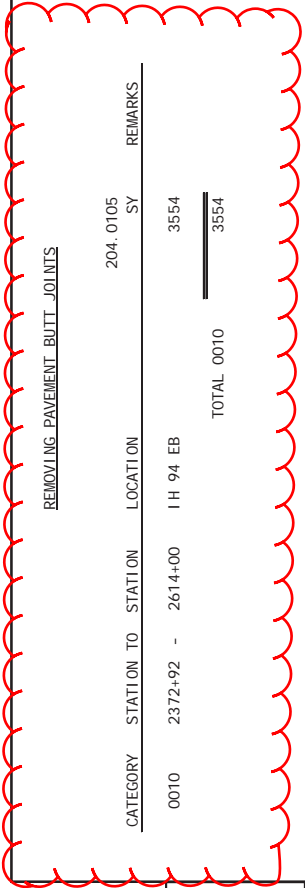

REMOVING PAVEMENT BUTT JOINTS

CATEGORY	STATION TO	STATION	LOCATION	SY	REMARKS
0010	2372+92	- 2614+00	I H 94 EB	3554	
				<u>3554</u>	
			TOTAL 0010		

CATEGORY	STATION TO	STATION	LOCATION	204. 0180	REMARKS
0010	2372+92	- 2614+00	I H 94	55	
0010	32' H' 00	51' H' 00	CTH EW ENTRANCE RAMP	25	
0010	33' G' 00	51' G' 00	CTH EW EXI T RAMP	20	
0010	2372+92	- 2614+00	I H 94	33	CULVERTS
			TOTAL 0010	<u>133</u>	

REMOVING CURB & GUTTER

CATEGORY	STATION TO	STATION	LOCATION	204. 0150	REMARKS
0010	2545+55	- 2548+05	I H 94 RT.	250	REPLACE WITH DRIVEWAY C&G
0010	37' H' +47	37' H' +67	E. B. ON RAMP	20	
0010				10	SPOT REPAIR
			TOTAL 0010	<u>280</u>	

REMOVING SURFACE DRAINS

CATEGORY	STATION	LOCATION	204. 0190	REMARKS
0010	2450+40	I H 94 RT.	1	UNDER BEAMGUARD
		TOTAL 0010	<u>1</u>	

Addendum No. 01  
 ID 1023-00-72  
 ID 1023-00-80  
 ID 1023-06-73  
 ID 1023-06-75  
 Revised Sheet 108  
 December 2, 2015

Addendum No. 01  
 ID 1023-00-72  
 ID 1023-00-80  
 ID 1023-06-73  
 ID 1023-06-75  
 Revised Sheet 110  
 December 2, 2015

Division	From/To Station	Common Excavation (1)		Salvaged/Unusable Pavement Material (3)	Available Material (4)	Unexpanded Fill	Expanded Fill (5)		Mass Ordinate +/- (6)	Waste	Borrow
		Cut (2)	item #205.0100				Factor				
Division 1	090201-IH 94 Mon EB	1,927	0	1,927	6,915	8,644	1.25	-6,717	0	6,717	
	Division 1 Subtotal	1,927	0	1,927	6,915	8,644		-6,717	0	6,717	
Division 2	090202-IH 94 Mon EB	1,526	0	1,526	7,140	8,925		-7,399	0	7,399	
	Division 2 Subtotal	1,526	0	1,526	7,140	8,925		-7,399	0	7,399	
Division 3	090203-IH 94 Mon EB	2,778	0	2,778	15,009	18,761		-15,983	0	15,983	
	Division 3 Subtotal	2,778	0	2,778	15,009	18,761		-15,983	0	15,983	
Grand Total		6,231.14	0.00	6,231.14	29,063.84	36,329.80		-30,098.66	0.00	30,098.66	
	<b>Total Common Ex</b>	<b>6,231</b>	<b>0.00</b>	<b>6,231</b>		<b>Total</b>				<b>30,099</b>	

- 1) Item number 205.0100
- 2) Salvaged/Unusable Pavement Material is included in Cut.
- 3) Salvaged/Unusable Pavement Material
- 4) Available Material = Cut - Salvaged/Unusable Pavement Material
- 5) Expanded Fill. Factor = 1.25
- 6) The Mass Ordinate + or - Qty calculated for the Division. Plus quantity indicates an excess of material within the Division. Minus indicates a shortage of material within the Division.

SIGN SUPPORTS REPLACING BASE CONNECTION BOLTS

CATEGORY	STATION	LOCATION	REMARKS
0010	2476+25	IH 94 RT.	1
0010	2528+00	IH 94 RT.	1
0010	2587+00	IH 94 RT.	1
TOTAL 0010			3

CATEGORY	STATION	LOCATION	REMARKS
0010	2476+00	IH 94	1
0010	2528+00	IH 94	1
0010	2587+00	IH 94	1
TOTAL 0010			3

635.0300 EACH

638.2601 EACH

SIGNS TYPE I - REFLECTIVE H

CATEGORY	SIGN CODE	STATION	SIZE	LOCATION	SF	REMARKS
0010	E1-5P	2476+00	108 X 30	IH 94	22.5	EXIT 135
0010	E1-1A	2476+00	168 X 120	IH 94	140.0	EW / WARRENS / 1 MILE
0010	E1-5P	2528+00	108 X 30	IH 94	22.5	EXIT 135
0010	E4-1A	2528+00	204 X 90	IH 94	127.5	EW WARRENS ARROW
0010	D2-2	2587+00	168 X 60	IH 94	70.0	TOMAH MADISON
TOTAL 0010					382.5	

637.1210 SF

Addendum No. 01  
 ID 1023-00-72  
 ID 1023-00-80  
 ID 1023-06-73  
 ID 1023-06-75  
 Revised Sheet 120  
 December 2, 2015

Addendum No. 01  
 ID 1023-00-72  
 ID 1023-00-80  
 ID 1023-06-73  
 ID 1023-06-75  
 Revised Sheet 137  
 December 2, 2015

CATEGORY	SIGN CODE	STATION	SIZE	SIGN DESCRIPTION	LOCATION	SIGN STRUCTURAL		SIGN SUPPORTS REPLACING BASE		SIGN SUPPORTS CONCRETE MASONRY		STEEL REINFORCEMENT LB	SIGNS TYPE 1		REMOVING SIGNS TYPE 1	REMARKS
						STEEL HS LB	CON BOLTS EACH	W/ASONRY CY	REF H SF	TYPE 1						
0010	D2-3	2490+00	192 X 84	MILLSTON EAU CLAIRE ST PAUL	IH 94	0	0	0	0	0	0	0	0	0	1	SIGN MOVED
0010	D2-3	2500+00	192 X 84	MILLSTON EAU CLAIRE ST PAUL	IH 94	837	0	1.6	98	112.0	0	0	0	0	0	2 - TYPE B BEAMS K = 146.5 LB
0010	E1-5P	2553+50	108 X 30	EXIT 135	IH 94	0	0	0	0	22.5	0	0	0	1		
0010	E4-1A	2553+50	204 X 90	EW / WARRENS / ARROW	IH 94	0	1	0	0	127.5	0	0	0	0		
TOTAL 0010						837	1	1.6	98	262.0	0	0	0	2		

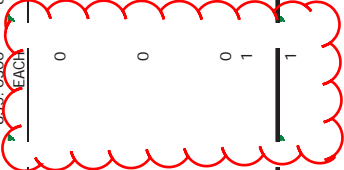

Addendum No. 01  
 ID 1023-00-72  
 ID 1023-00-80  
 ID 1023-06-73  
 ID 1023-06-75  
 Added Sheet 359A  
 December 2, 2015

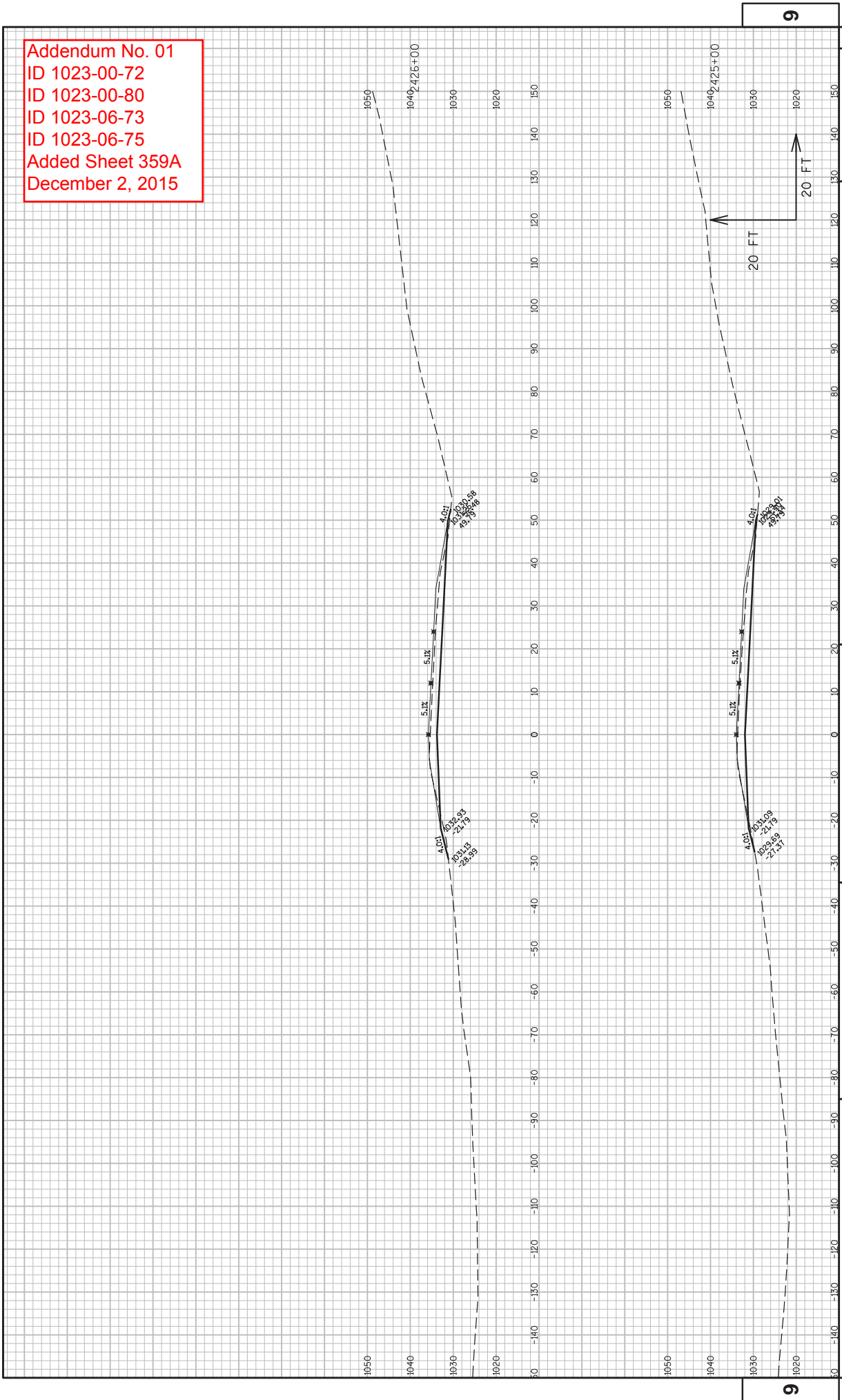

PROJECT NO: 1023-06-73  
 COUNTY: MONROE  
 HWY: IH 94  
 CROSS SECTIONS: IH 94 EB  
 SHEET 359A  
 E  
 FILE NAME : N:\VPOS\C30\10230603\SHEETS\PLAN\EA5T BOUND C30 2014\090201-XS-1094-MC-EB.DWG  
 PLOT DATE : 11/30/2015 10:00 AM  
 PLOT BY : PITTSCH, NICHOLAS J  
 PLOT NAME :  
 PLOT SCALE : 1 IN:20 FT  
 WSDOT/CADD SHEET 49  
 LAYOUT NAME - SECTION SHEET - (155)



Addendum No. 01  
 ID 1023-00-72  
 ID 1023-00-80  
 ID 1023-06-73  
 ID 1023-06-75  
 Added Sheet 459A  
 December 2, 2015

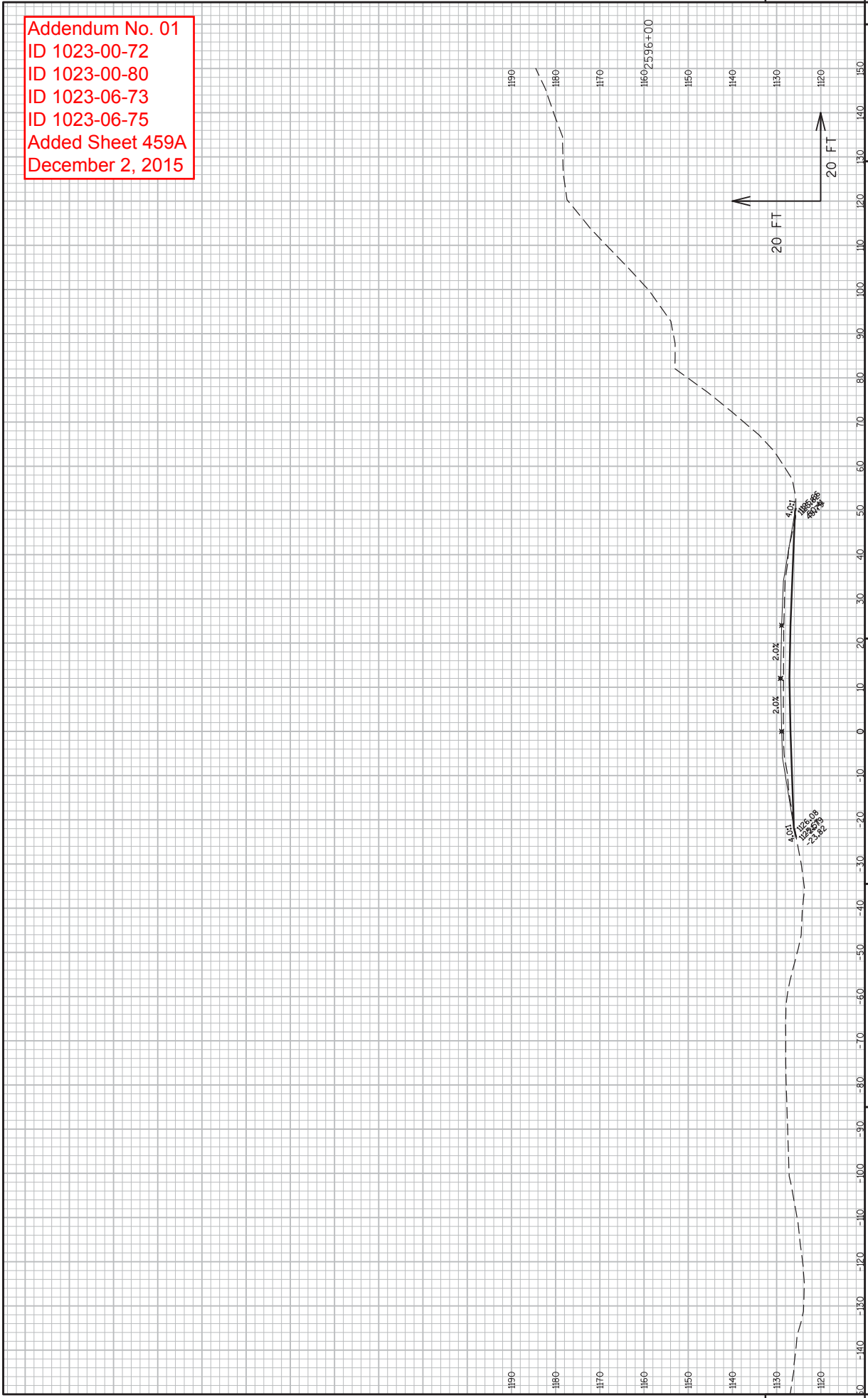

PROJECT NO: 1023-06-73  
 COUNTY: MONROE  
 HWY: IH 94  
 CROSS SECTIONS: IH 94 EB  
 SHEET 459A  
 E  
 9  
 FILE NAME : N:\VPOS\C3D\10230603\SHEETS\PLAN\EA5T BOUND C3D 2014\090201-XS-I94+MC-EB.DWG  
 LAYOUT NAME - SECTION SHEET - (226)  
 PLOT DATE : 11/30/2015 10:05 AM  
 PLOT BY : PITTSCH, NICOLAS J  
 PLOT NAME :  
 PLOT SCALE : 1 IN:20 FT  
 WSDOT/CADD SHEET 49

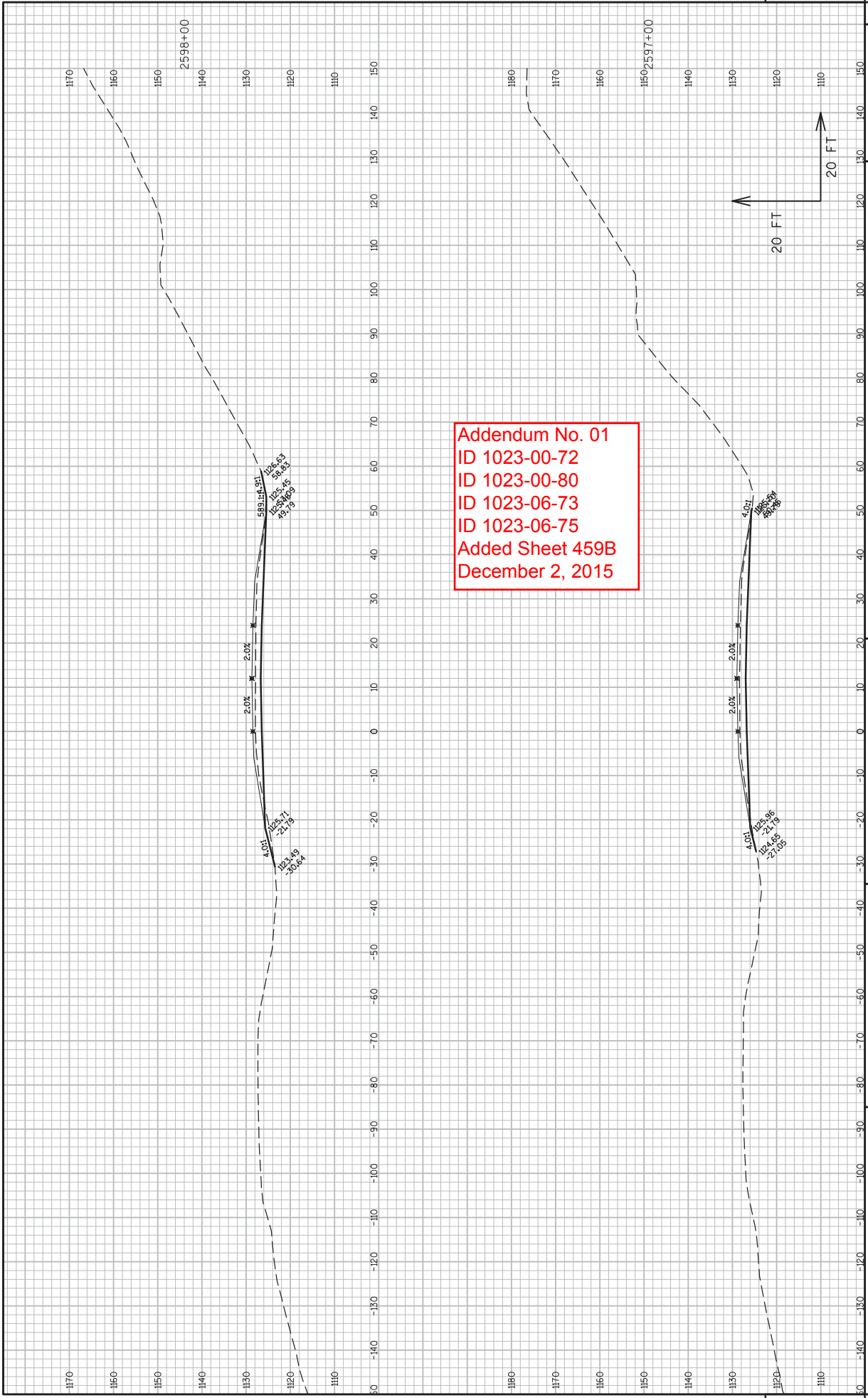

Addendum No. 01  
 ID 1023-00-72  
 ID 1023-00-80  
 ID 1023-06-73  
 ID 1023-06-75  
 Added Sheet 459B  
 December 2, 2015

9

9

Addendum No. 01  
 ID 1023-00-72  
 ID 1023-00-80  
 ID 1023-06-73  
 ID 1023-06-75  
 Added Sheet 496A  
 December 2, 2015

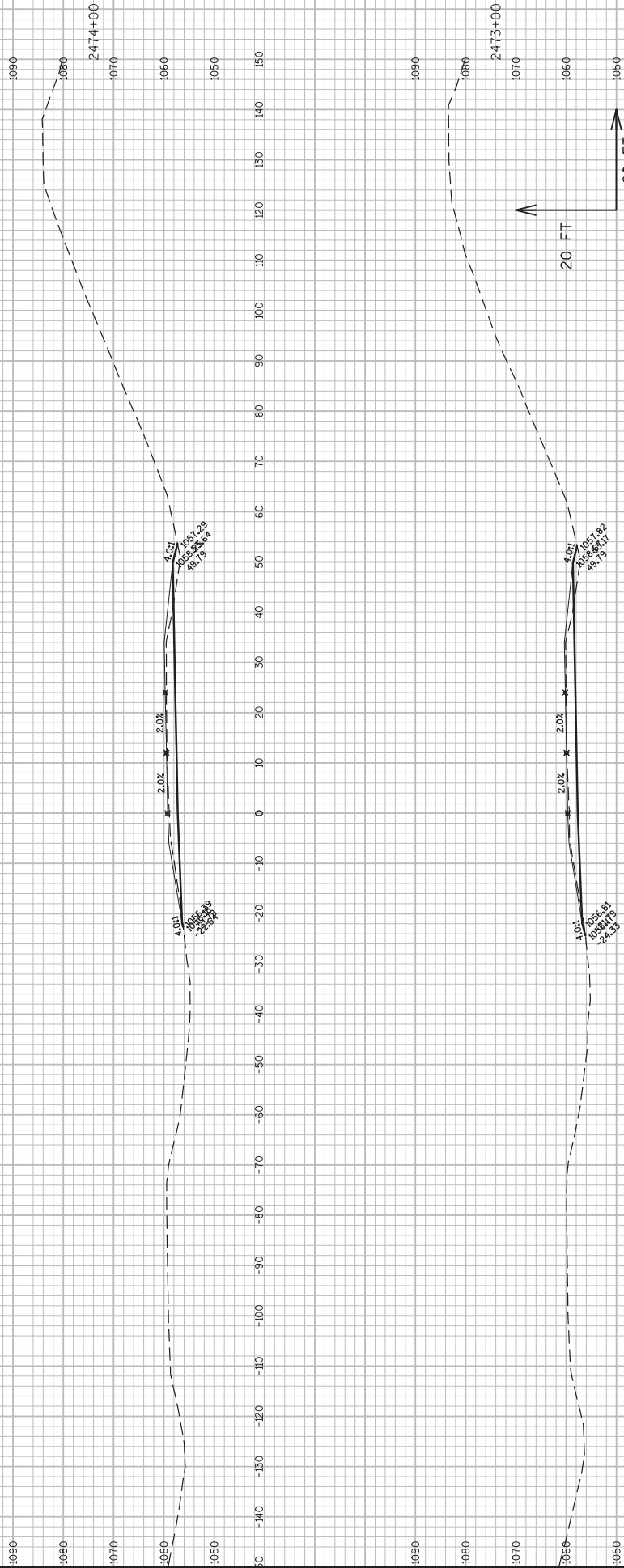

9

9

PROJECT NO: 1023-06-73  
 COUNTY: MONROE  
 HWY: IH 94  
 CROSS SECTIONS: IH 94 EB  
 SHEET 496A  
 E  
 FILE NAME : N:\VPOS\C3D\10230603\SHEETS\PLAN\EA... BOUND C3D 2014\090201.XS-1094-MC-EB.DWG  
 LAYOUT NAME - SECTION SHEET - (174)  
 PLOT DATE : 11/30/2015 10:01 AM  
 PLOT BY : PITTSCH, NICOLAS J  
 PLOT NAME :  
 PLOT SCALE : 1 IN=20 FT  
 WSDOT/CADD SHEET 49

Addendum No. 01  
 ID 1023-00-72  
 ID 1023-00-80  
 ID 1023-06-73  
 ID 1023-06-75  
 Added Sheet 547A  
 December 2, 2015

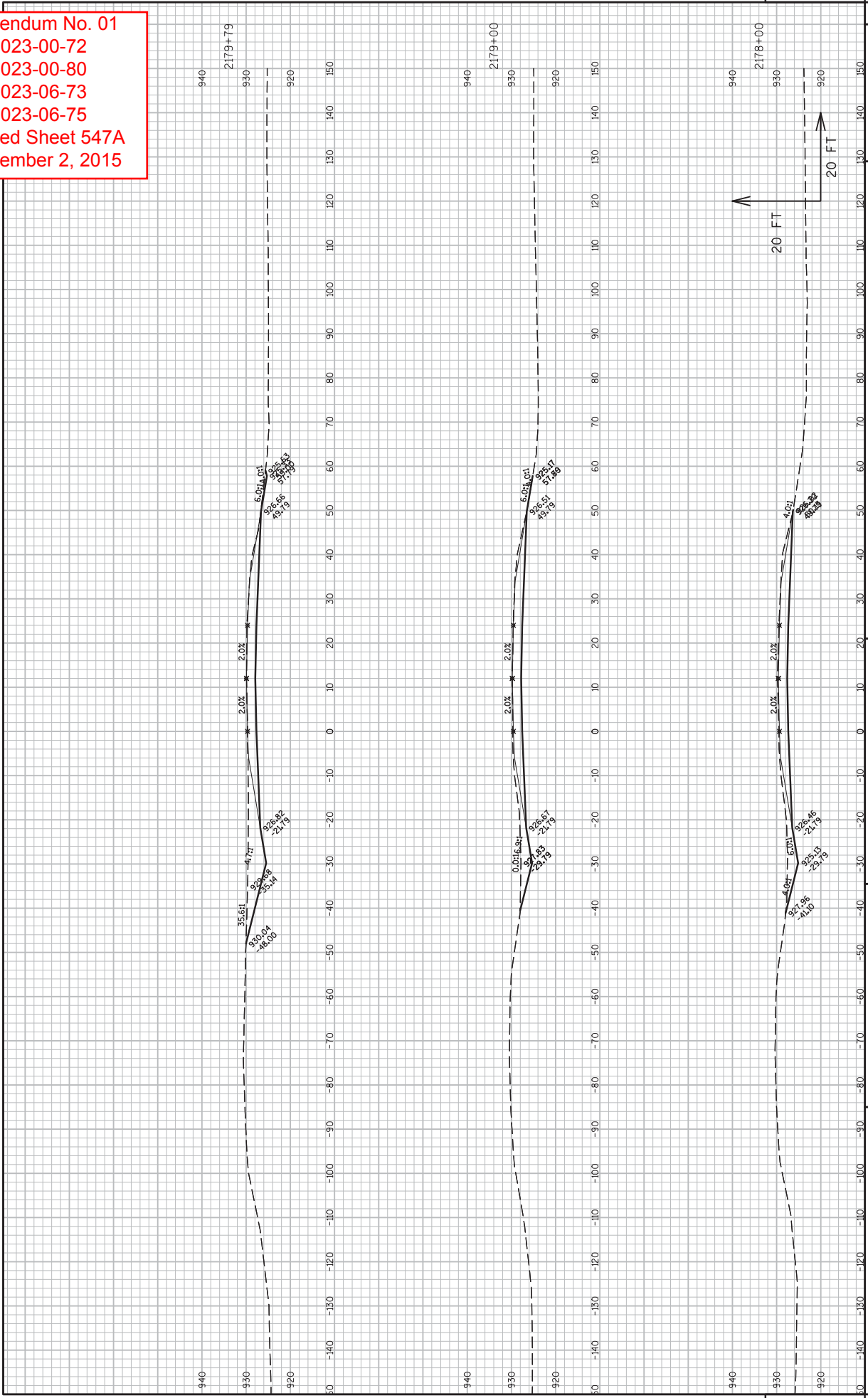

Addendum No. 01  
 ID 1023-00-72  
 ID 1023-00-80  
 ID 1023-06-73  
 ID 1023-06-75  
 Added Sheet 547B  
 December 2, 2015

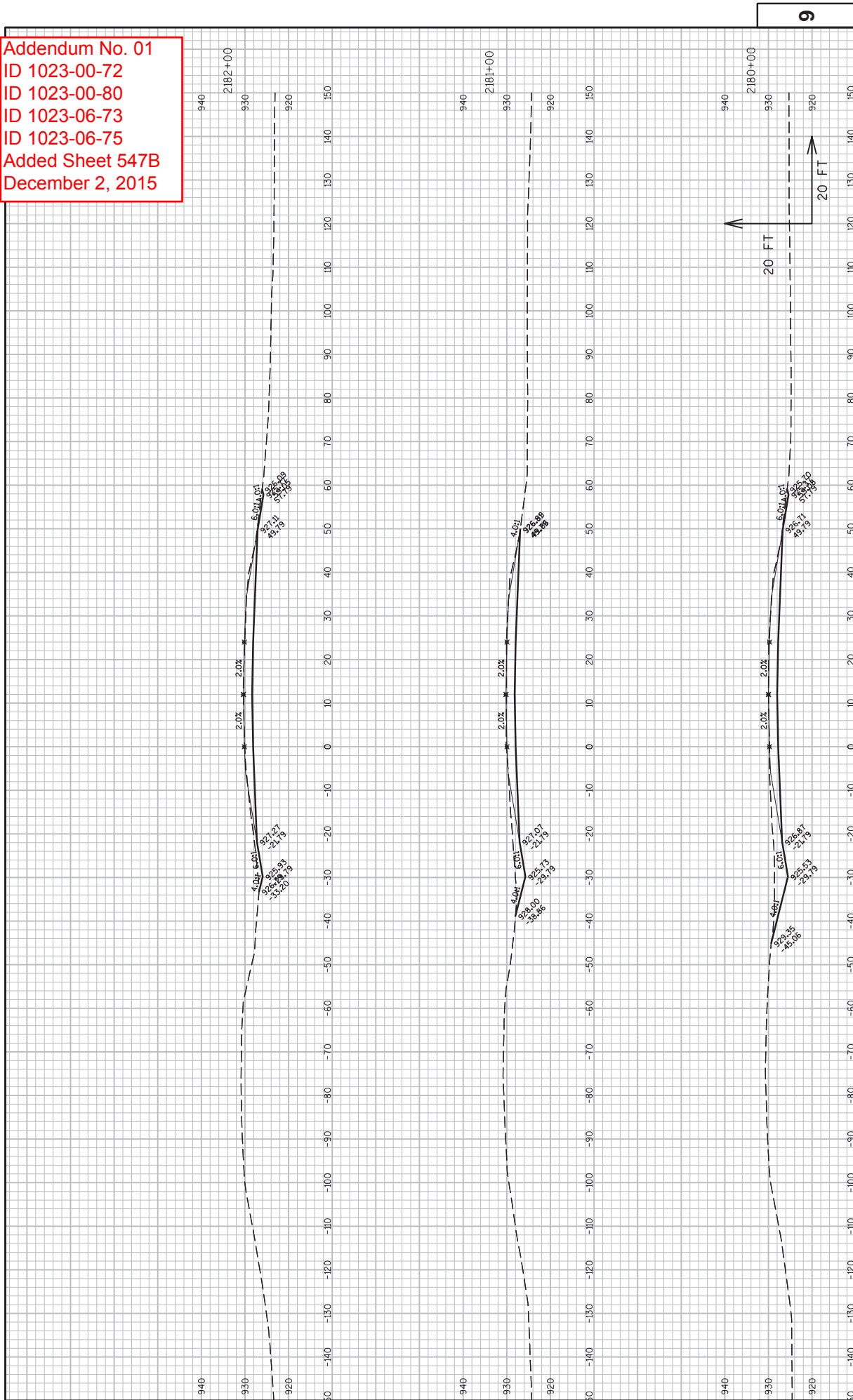

Addendum No. 01  
 ID 1023-00-72  
 ID 1023-00-80  
 ID 1023-06-73  
 ID 1023-06-75  
 Added Sheet 632A  
 December 2, 2015

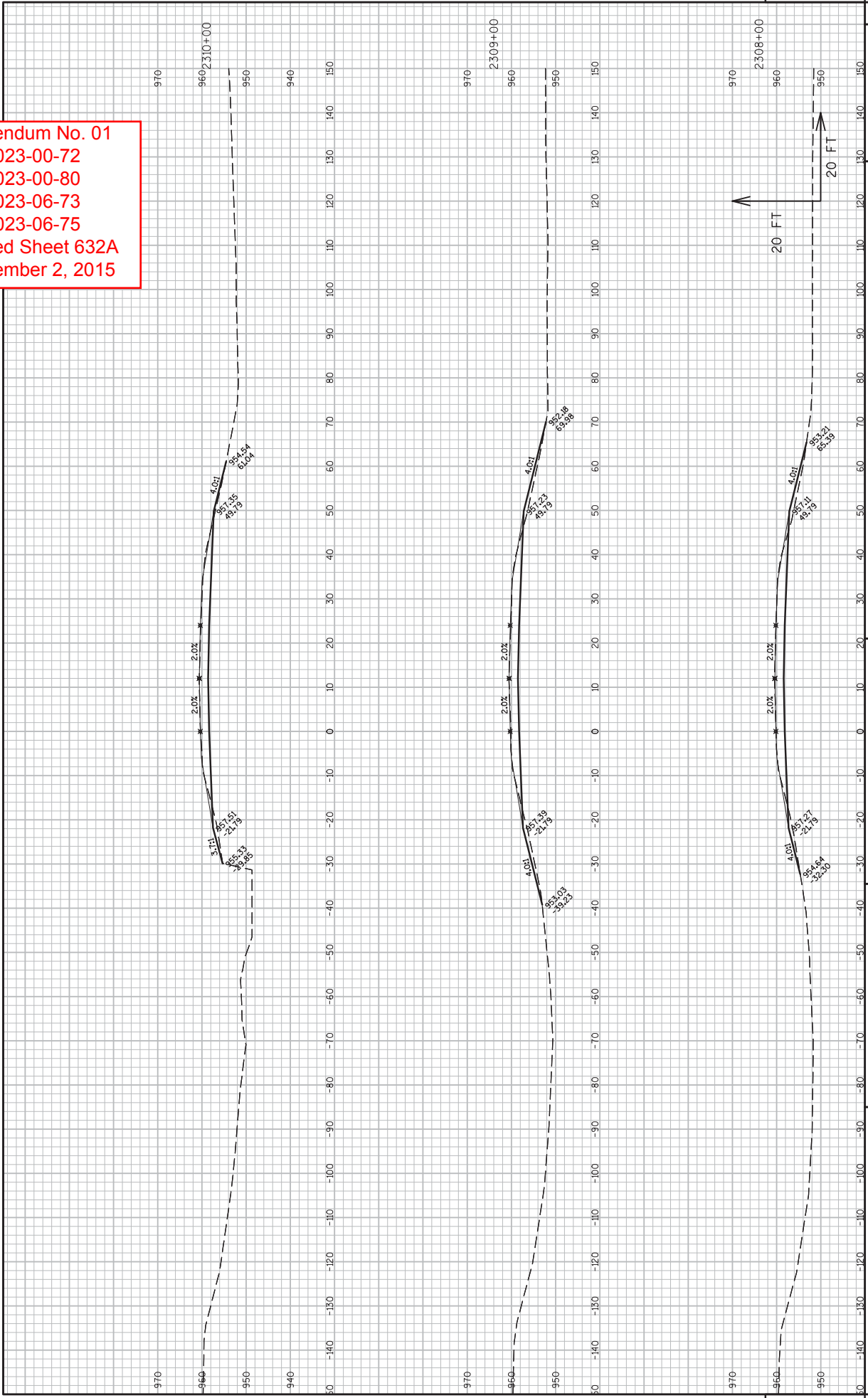

## SCHEDULE OF ITEMS

REVISED:

CONTRACT:	PROJECT(S):	FEDERAL ID(S):
20151208003	1023-00-72	WISC 2015651
	1023-00-80	WISC 2015652
	1023-06-73	WISC 2015653
	1023-06-75	WISC 2015654

CONTRACTOR : \_\_\_\_\_

LINE NO	ITEM DESCRIPTION	APPROX. QUANTITY AND UNITS	UNIT PRICE		BID AMOUNT	
			DOLLARS	CTS	DOLLARS	CTS

## SECTION 0001 Contract Items

0010	202.0105 Roadside Clearing	5.000 STA	.	.	.	.
0020	203.0200 Removing Old Structure (station) 01. 48'G'+50	LUMP	LUMP	.	.	.
0030	204.0109.S Removing Concrete Surface Partial Depth	36,202.000 SF	.	.	.	.
0040	204.0110 Removing Asphaltic Surface	42.000 SY	.	.	.	.
0050	204.0115 Removing Asphaltic Surface Butt Joints	5,164.000 SY	.	.	.	.
0060	204.0120 Removing Asphaltic Surface Milling	276,231.000 SY	.	.	.	.
0070	204.0150 Removing Curb & Gutter	305.000 LF	.	.	.	.
0080	204.0180 Removing Delineators and Markers	596.000 EACH	.	.	.	.
0090	204.0190 Removing Surface Drains	1.000 EACH	.	.	.	.

## SCHEDULE OF ITEMS

REVISED:

CONTRACT:	PROJECT(S):	FEDERAL ID(S):
20151208003	1023-00-72	WISC 2015651
	1023-00-80	WISC 2015652
	1023-06-73	WISC 2015653
	1023-06-75	WISC 2015654

CONTRACTOR : \_\_\_\_\_

LINE NO	ITEM DESCRIPTION	APPROX. QUANTITY AND UNITS	UNIT PRICE		BID AMOUNT	
			DOLLARS	CTS	DOLLARS	CTS
0100	204.0195 Removing Concrete Bases	4.000 EACH	.		.	
0110	204.9060.S Removing (item description) 01. Apron Endwalls	334.000 EACH	.		.	
0120	204.9060.S Removing (item description) 02. Inlet Covers	1.000 EACH	.		.	
0130	205.0100 Excavation Common	8,901.000 CY	.		.	
0140	208.0100 Borrow	72,614.000 CY	.		.	
0150	213.0100 Finishing Roadway (project) 01. 1023-00-72	1.000 EACH	.		.	
0160	213.0100 Finishing Roadway (project) 02. 1023-00-80	1.000 EACH	.		.	
0170	213.0100 Finishing Roadway (project) 03. 1023-06-73	1.000 EACH	.		.	
0180	213.0100 Finishing Roadway (project) 04. 1023-06-75	1.000 EACH	.		.	
0190	305.0110 Base Aggregate Dense 3/4-Inch	7,800.000 TON	.		.	



## SCHEDULE OF ITEMS

REVISED:

CONTRACT:	PROJECT(S):	FEDERAL ID(S):
20151208003	1023-00-72	WISC 2015651
	1023-00-80	WISC 2015652
	1023-06-73	WISC 2015653
	1023-06-75	WISC 2015654

CONTRACTOR : \_\_\_\_\_

LINE NO	ITEM DESCRIPTION	APPROX. QUANTITY AND UNITS	UNIT PRICE		BID AMOUNT	
			DOLLARS	CTS	DOLLARS	CTS
0970	633.0100 Delineator Posts Steel	452.000 EACH	.		.	
0980	633.0500 Delineator Reflectors	471.000 EACH	.		.	
0990	633.5200 Markers Culvert End	139.000 EACH	.		.	
1000	634.0614 Posts Wood 4x6-Inch X 14-FT	93.000 EACH	.		.	
1010	634.0616 Posts Wood 4x6-Inch X 16-FT	39.000 EACH	.		.	
1020	634.0618 Posts Wood 4x6-Inch X 18-FT	31.000 EACH	.		.	
1030	634.0620 Posts Wood 4x6-Inch X 20-FT	11.000 EACH	.		.	
1040	635.0200 Sign Supports Structural Steel HS	837.000 LB	.		.	
1050	635.0300 Sign Supports Replacing Base Connection Bolts	9.000 EACH	.		.	
1060	636.0100 Sign Supports Concrete Masonry	1.600 CY	.		.	

SCHEDULE OF ITEMS

REVISED:

CONTRACT:  
20151208003

PROJECT(S):  
1023-00-72  
1023-00-80  
1023-06-73  
1023-06-75

FEDERAL ID(S):  
WISC 2015651  
WISC 2015652  
WISC 2015653  
WISC 2015654

CONTRACTOR : \_\_\_\_\_

LINE NO	ITEM DESCRIPTION	APPROX. QUANTITY AND UNITS	UNIT PRICE		BID AMOUNT	
			DOLLARS	CTS	DOLLARS	CTS
2010	SPV.0195 Special 02. SMA Pavement Compaction Acceptance	32,841.000 TON	.	.	.	.
2020	204.0105 Removing Pavement Butt Joints	5,586.000 SY	.	.	.	.
	SECTION 0001 TOTAL				.	.
	TOTAL BID				.	.