



Wisconsin Department of Transportation

May 4, 2016

Division of Transportation Systems Development

Bureau of Project Development
 4802 Sheboygan Avenue, Rm 601
 P O Box 7916
 Madison, WI 53707-7916

Telephone: (608) 266-1631
 Facsimile (FAX): (608) 266-8459

NOTICE TO ALL CONTRACTORS:

**Proposal #09: 5657-00-72, WISC 2016 166
 Mount Horeb – Cross Plains
 (CTH S – Bourbon Road)
 CTH P
 Dane County**

Letting of May 10, 2016

This is Addendum No. 01, which provides for the following:

Schedule of Items

Revised Bid Item Quantities					
Bid Item	Item Description	Unit	Old Quantity	Revised Quantity	Proposal Total
305.0120	Base Aggregate Dense 1-1/4 Inch	Ton	4,420	235	4,655

Added Bid Item Quantities					
Bid Item	Item Description	Unit	Old Quantity	Revised Quantity	Proposal Total
628.2004	Erosion Mat Class I Type B	SY	0	18,000	18,000
628.2023	Erosion Mat Class II Type B	SY	0	12,380	12,380

Deleted Bid Item Quantities					
Bid Item	Item Description	Unit	Old Quantity	Revised Quantity	Proposal Total
628.2002	Erosion Mat Class I Type A	SY	18,000	-18,000	0
628.2021	Erosion Mat Class II Type A	SY	12,380	-12,380	0

Plan Sheets

Revised Plan Sheets	
Plan Sheet	Plan Sheet Title (brief description of changes to sheet)
6	Typical Section – Revise Base Aggregate Dense ¾-Inch and 1-1/4 Inch
19-25	Erosion Control Plan – Revise Erosion Mat Class and Type
36	Miscellaneous Quantities – Revise Base Aggregate Dense 1-1/4 Inch
40-41	Miscellaneous Quantities – Revise Erosion Mat Class and Type

Schedule of Items

Attached, dated May 4, are the revised Schedule of Items Pages 2 and 8 – 12.

Plan Sheets

The following 8½ x 11-inch sheets are attached and made part of the plans for this proposal:

Revised: 6, 19 – 25, 36, 40, and 41

The responsibility for notifying potential subcontractors and suppliers of these changes remains with the prime contractor.

Sincerely,

Mike Coleman

Proposal Development Specialist
Proposal Management Section

END OF ADDENDUM

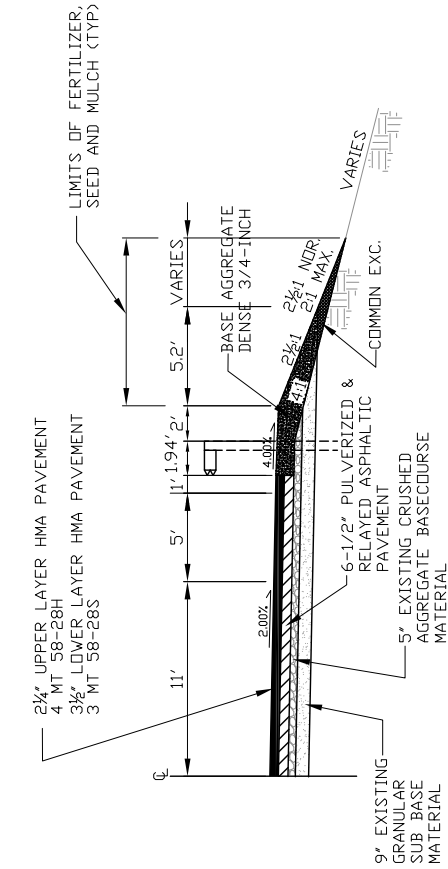

PROPOSED TYPICAL 1/2 SECTION BEAMGUARD LOCATIONS

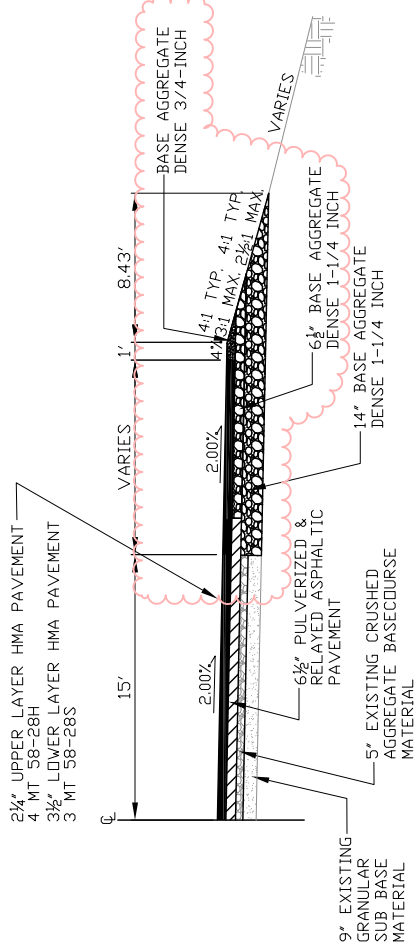

PROPOSED TYPICAL 1/2 SECTION - WIDENING
STA. 27+89-STA. 34+85 (RT)
STA. 138+87-STA. 142+75 (RT)

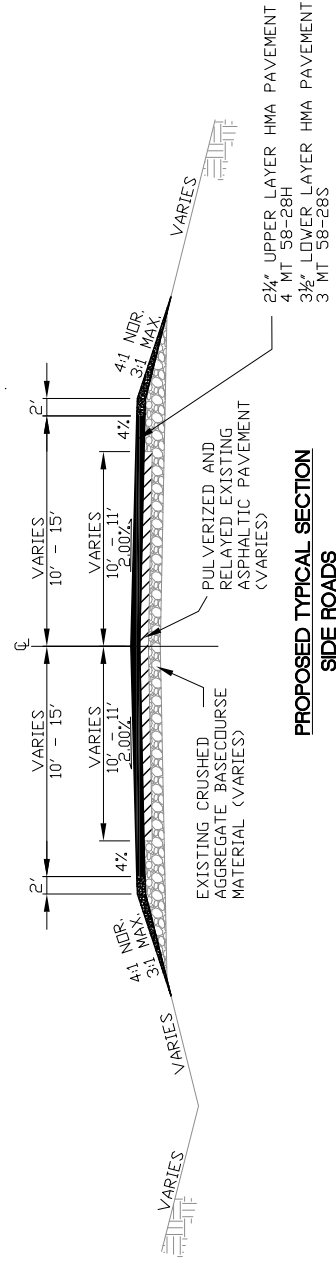

PROPOSED TYPICAL SECTION
SIDE ROADS
(OBSERVATORY ROAD)
(PINE HILL ROAD)
(STAGECOACH ROAD)

Addendum No. 01
ID 5657-00-72
Revised Sheet 6
May 4, 2016

NOT TO SCALE

Addendum No. 01
 ID 5657-00-72
 Revised Sheet 19
 May 4, 2016

SCALE 1" = 100'

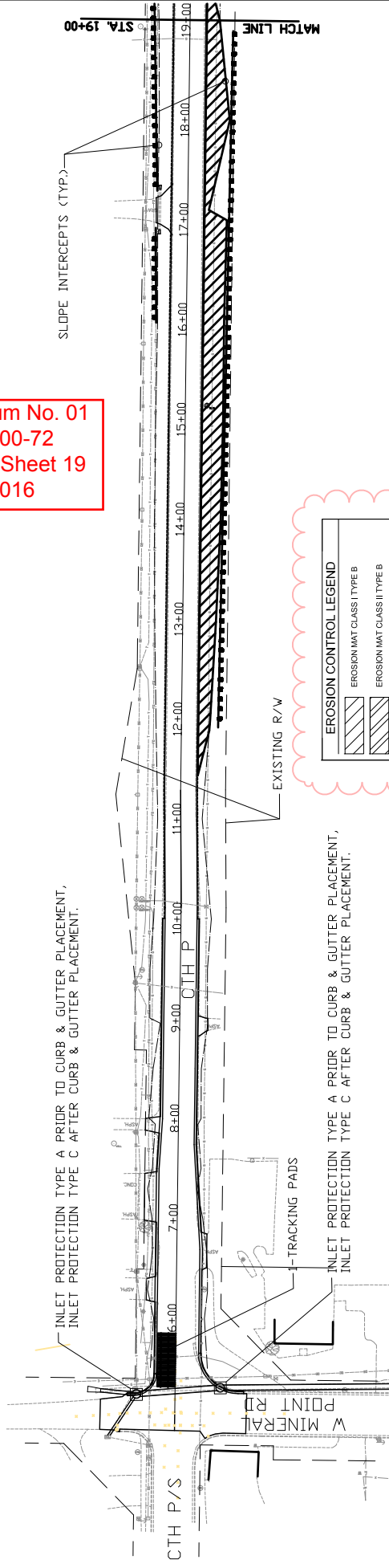

EROSION CONTROL LEGEND

- EROSION MAT CLASS I TYPE B
- EROSION MAT CLASS II TYPE B
- CULVERT PIPE CHECKS
- TEMPORARY DITCH CHECKS
- SILT FENCE

SCALE 1" = 100'

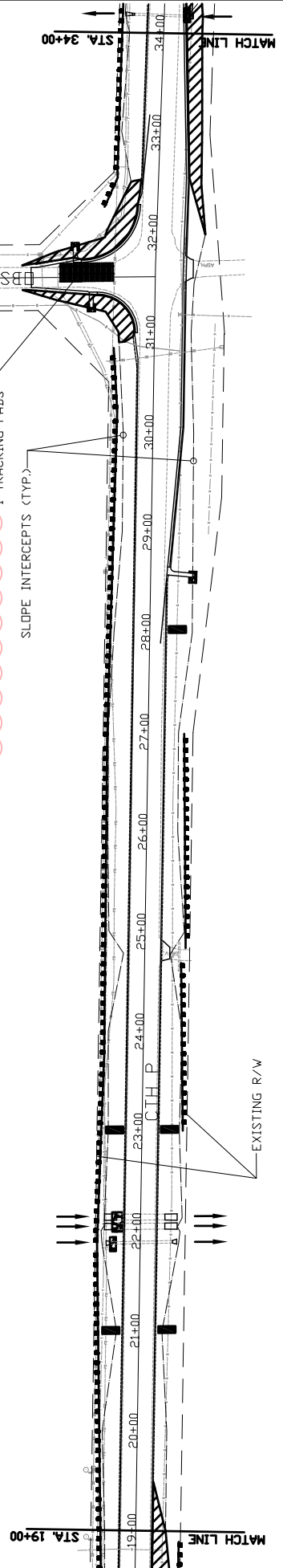

Addendum No. 01
 ID 5657-00-72
 Revised Sheet 20
 May 4, 2016

2



SCALE 1" = 100'

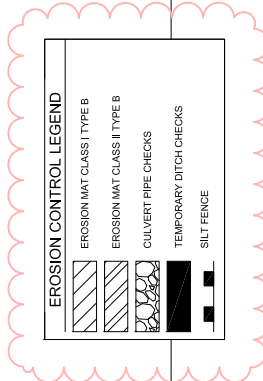
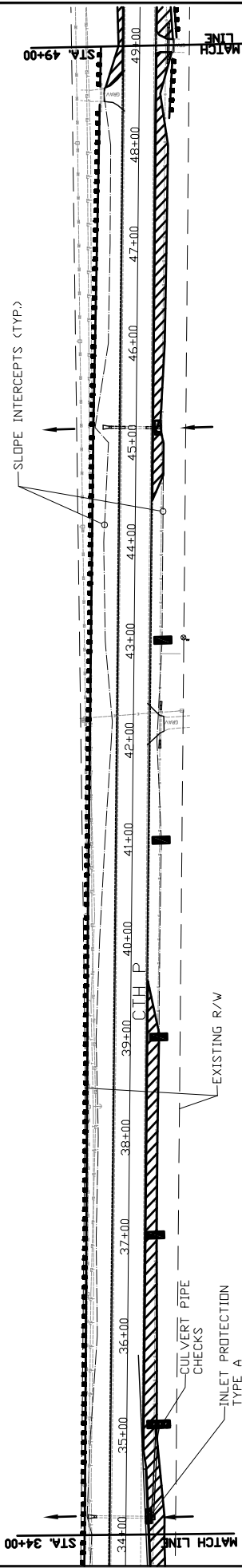

SLOPE INTERCEPTS (TYP.)

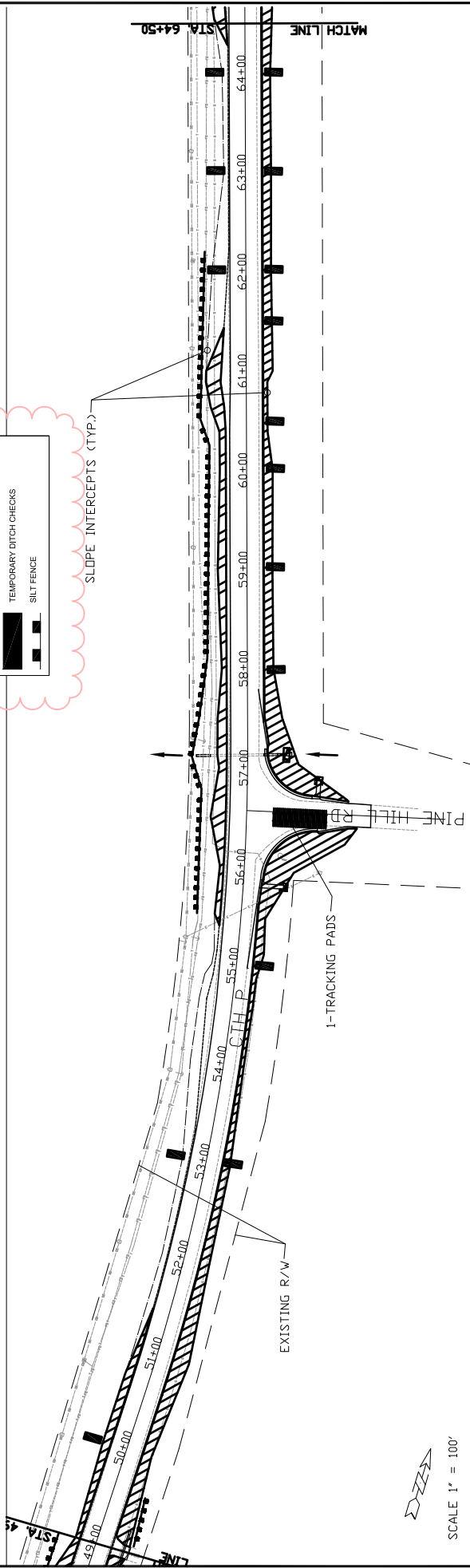

SCALE 1" = 100'

2

Addendum No. 01
 ID 5657-00-72
 Revised Sheet 21
 May 4, 2016

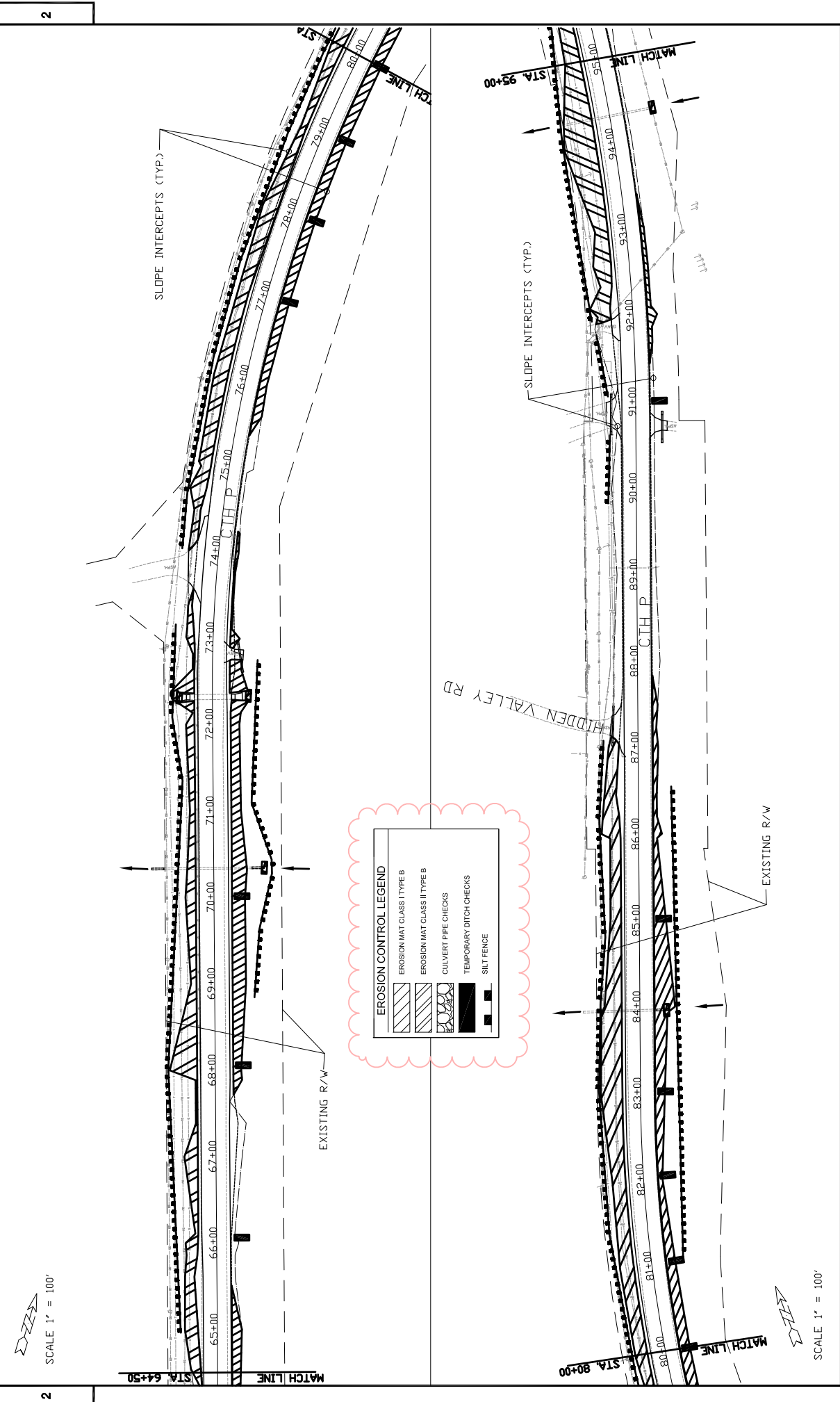

Addendum No. 01
 ID 5657-00-72
 Revised Sheet 22
 May 4, 2016

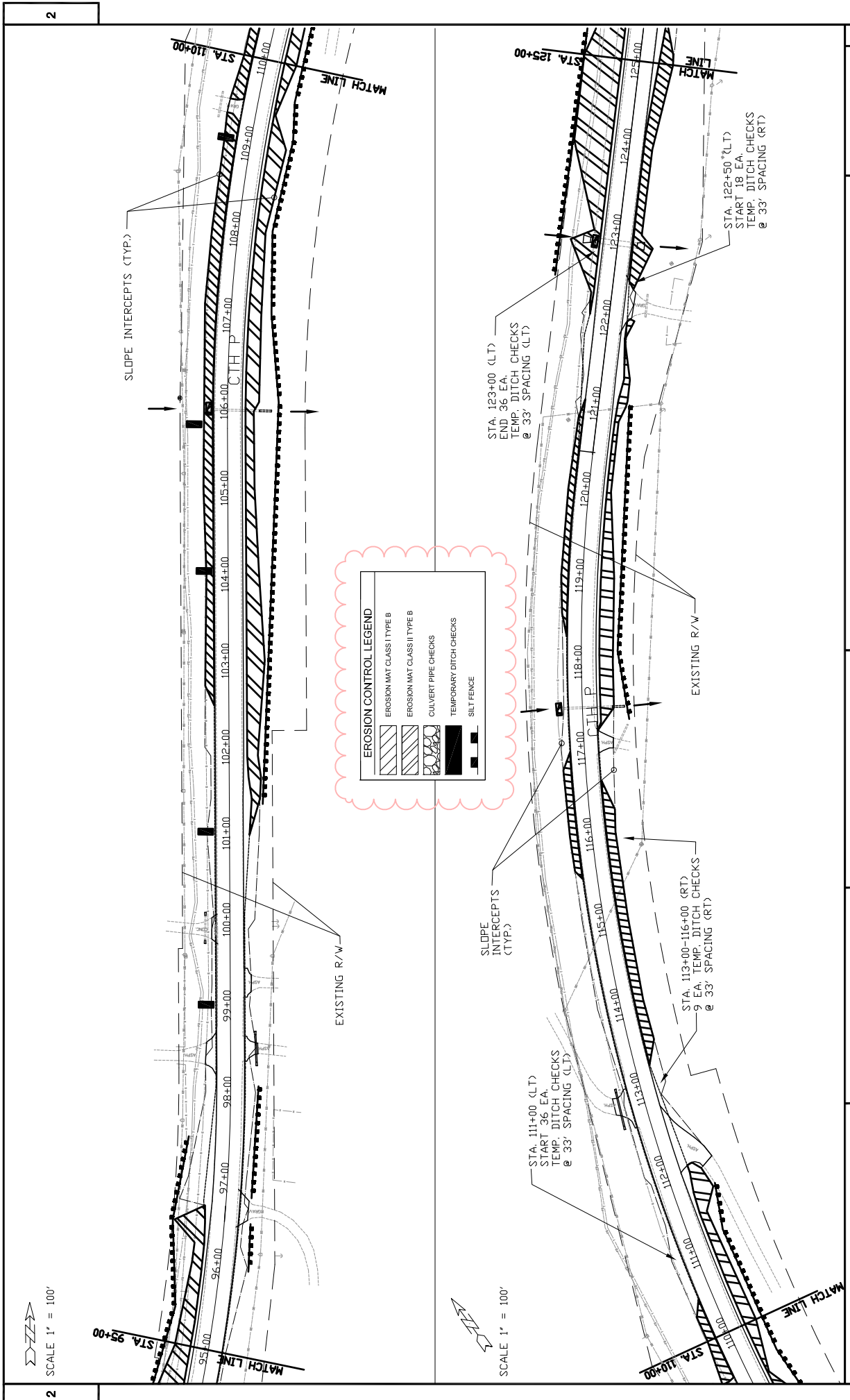

2

2

SHEET NO. 22

PROJECT NO. 5657-00-72

HWY: CTH P

COUNTY: DANE

EROSION CONTROL

PLOT BY: DANE COUNTY HIGHWAY DEPT.

PLOT DATE: 4/28/2016

FILE NAME: I:\highway\dane\proj\5657-00-72\5657-00-72.dwg

PLOT SCALE: NONE

WISDOT/CADSW SHEET 42

Addendum No. 01
 ID 5657-00-72
 Revised Sheet 23
 May 4, 2016

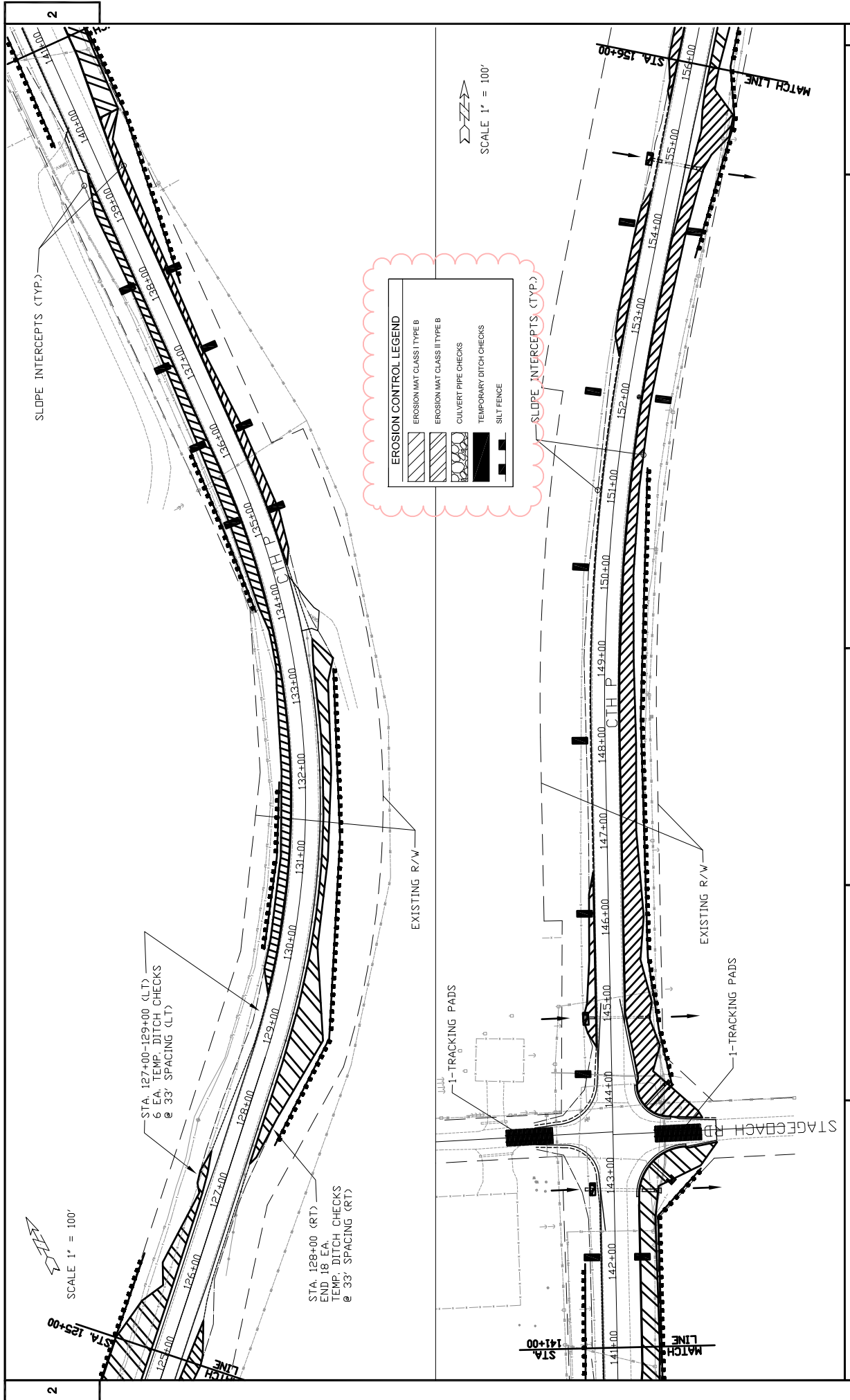

Addendum No. 01
 ID 5657-00-72
 Revised Sheet 24
 May 4, 2016

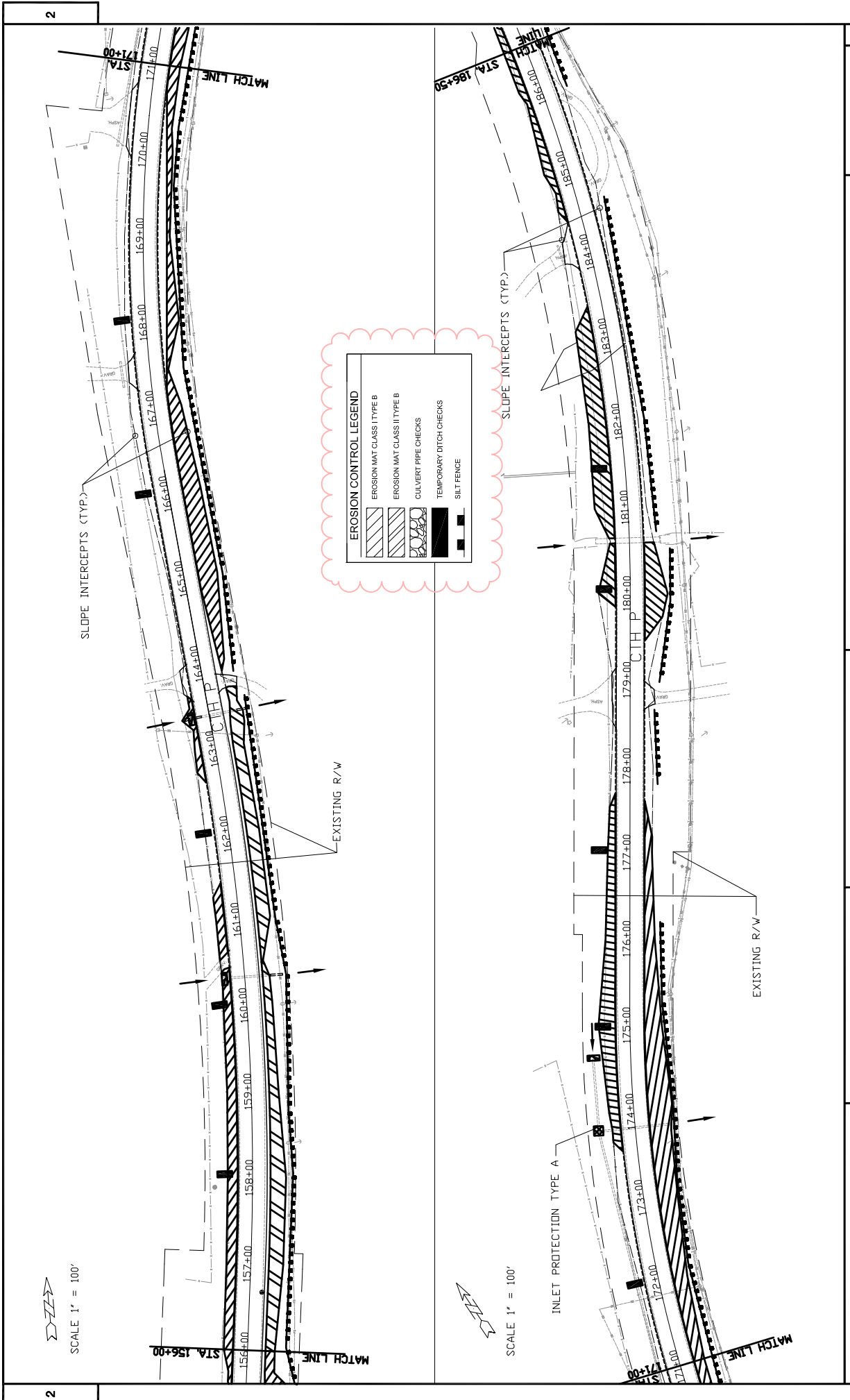

EROSION CONTROL LEGEND

	EROSION MAT CLASS I TYPE B
	EROSION MAT CLASS II TYPE B
	CULVERT PIPE CHECKS
	TEMPORARY DITCH CHECKS
	SILT FENCE

SCALE 1" = 100'

SCALE 1" = 100'



SCALE 1" = 100'

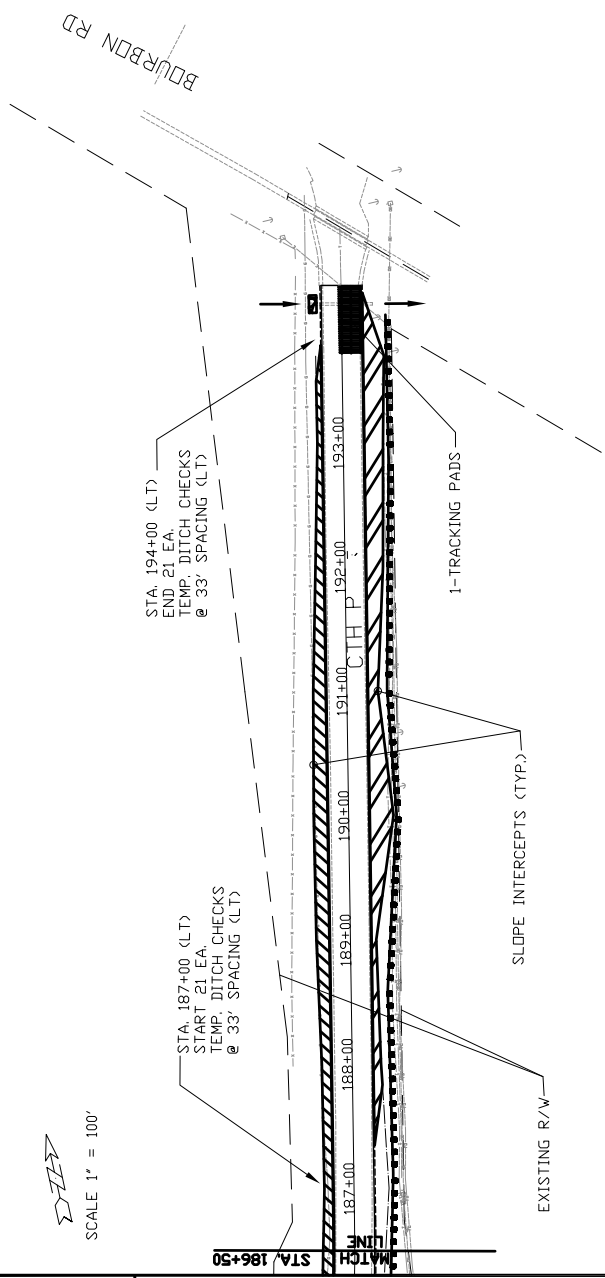

EROSION CONTROL LEGEND	
	EROSION MAT CLASS I TYPE B
	EROSION MAT CLASS II TYPE B
	CULVERT PIPE CHECKS
	TEMPORARY DITCH CHECKS
	SILT FENCE

Addendum No. 01
 ID 5657-00-72
 Revised Sheet 25
 May 4, 2016

EROSION CONTROL ITEMS SUMMARY

STA.	LOCATION	6281504 SILT FENCE QTY	6281520 SILT FENCE MAINTENANCE QTY	6282002 EROSION MAT CLASS I TYPE B QTY	6282021 EROSION MAT CLASS II TYPE B QTY	6287005 INLET PROTECTION TYPE A QTY	6287015 INLET PROTECTION TYPE C QTY	6287504 TEMPORARY DITCH CHECKS LF	6287555 CULVERT PIPE CHECKS QTY	6287560 TRACKING PADS QTY	6300200 SEEDING TEMPORARY QTY
5+05-194+27	MAINLINE LT/RT	---	---	---	---	---	---	---	---	---	---
5+23	LT	---	---	---	---	1	1	---	---	---	---
5+25	LT	---	---	---	---	---	---	---	---	1	---
5+30	RT	---	---	---	---	1	1	---	---	---	---
12+00-19+00	RT	700	700	---	---	---	---	---	---	---	---
16+00-31+00	LT	1500	1500	---	---	---	---	---	---	---	---
21+00	LT/RT	---	---	---	---	---	---	10	---	---	---
21+88	LT	---	---	---	---	---	---	3	---	---	---
22+05	LT	---	---	---	---	---	---	7	---	---	---
22+14	LT	---	---	---	---	---	---	7	---	---	---
23+00	LT/RT	---	---	---	---	---	---	10	---	---	---
23+00-27+00	RT	400	400	---	---	---	---	---	---	---	---
28+00	RT	---	---	---	---	---	---	5	---	---	---
32+00-49+00	LT	1700	1700	---	---	---	---	---	---	---	---
34+18	RT	---	---	---	---	1	---	---	---	---	---
35+00	RT	---	---	---	---	---	---	5	3	---	---
37+00	RT	---	---	---	---	---	---	5	---	---	---
39+00	RT	---	---	---	---	---	---	5	---	---	---
41+00	RT	---	---	---	---	---	---	5	---	---	---
43+00	RT	---	---	---	---	---	---	5	---	---	---
45+15	RT	---	---	---	---	---	---	---	3	---	---
48+50-49+50	RT	100	100	---	---	---	---	---	---	---	---
50+00	LT	---	---	---	---	---	---	5	---	---	---
52+00	LT/RT	---	---	---	---	---	---	10	---	---	---
55+00	RT	---	---	---	---	---	---	5	---	---	---
55+50-62+50	LT	700	700	---	---	---	---	---	---	---	---
58+00	RT	---	---	---	---	---	---	5	---	---	---
59+00	RT	---	---	---	---	---	---	5	---	---	---
57+13	RT	---	---	---	---	---	---	3	---	---	---
60+00	RT	---	---	---	---	---	---	5	---	---	---
61+00	RT	---	---	---	---	---	---	5	---	---	---
62+00	LT/RT	---	---	---	---	---	---	10	---	---	---
63+00	LT/RT	---	---	---	---	---	---	10	---	---	---
64+00	LT/RT	---	---	---	---	---	---	10	---	---	---
65+00-73+50	LT	850	850	---	---	---	---	---	---	---	---
66+00	RT	---	---	---	---	---	---	5	---	---	---
68+00	RT	---	---	---	---	---	---	5	---	---	---
69+00-73+00	RT	400	400	---	---	---	---	---	---	---	---
70+00	RT	---	---	---	---	---	---	5	---	---	---
70+32	RT	---	---	---	---	---	---	3	---	---	---
74+00-87+00	LT	1300	1300	---	---	---	---	---	---	---	---
77+00-85+00	RT	---	---	---	---	---	---	40	---	---	---
81+00-86+50	RT	550	550	---	---	---	---	---	---	---	---
83+93	RT	---	---	---	---	---	---	3	---	---	---
90+00-97+50	LT	750	750	---	---	---	---	---	---	---	---
91+00	RT	---	---	---	---	---	---	5	---	---	---
94+31	RT	---	---	---	---	---	---	3	---	---	---
96+00-98+00	RT	200	200	---	---	---	---	---	---	---	---
99+00	LT	---	---	---	---	---	---	5	---	---	---
101+00	LT	---	---	---	---	---	---	5	---	---	---
101+50-112+00	RT	1050	1050	---	---	---	---	---	---	---	---
104+00	LT	---	---	---	---	---	---	5	---	---	---
105+89	LT	---	---	---	---	---	---	3	---	---	---
106+00	LT	---	---	---	---	---	---	5	---	---	---
109+00	LT	---	---	---	---	---	---	5	---	---	---

Addendum No. 01
ID 5657-00-72
Revised Sheet 40
May 4, 2016

Addendum No. 01
 ID 5657-00-72
 Revised Sheet 41
 May 4, 2016

EROSION CONTROL ITEMS SUMMARY (CONT)

STA.	LOCATION	6281504 SILT FENCE QTY	6281520 SILT FENCE MAINTENANCE LF	6282002 EROSION MAT CLASS I QTY	6282021 EROSION MAT CLASS II QTY	6287005 INLET PROTECTION TYPE A QTY	6287015 INLET PROTECTION TYPE C QTY	6287504 TEMPORARY DITCH CHECKS LF	6287555 CULVERT PIPE CHECKS QTY	6287560 TRACKING PAD QTY	6300200 SEEDING TEMPORARY QTY
117+46	LT										
117+00-121+00	RT	400									
122+86	LT										
122+00-126+00	LT	400									
127+00-129+00	LT							30			
127+50-133+50	RT	600									
130+00-132+00	LT	200									
134+00-136+00	LT	200									
135+00-138+00	LT/RT							40			
138+00-143+50	RT	550									
140+00-142+00	LT	200									
142+00	LT/RT							10			
142+81	LT								5		
143+50-151+50	RT	800									
144+82	LT										
146+00-150+00	LT							15			
152+00-154+00	LT/RT							20			
153+50-176+00	RT	2250									
154+81	LT								5		
158+00-162+00	LT							15			
160+32	LT								3		
163+38	LT								3		
166+00-168+00	LT							10			
172+00	LT							5			
173+75	LT					1					
174+75	LT								3		
175+00	LT							5			
177+00	LT							5			
177+50-184+50	RT	700									
180+00	LT										
181+50	LT							5			
186+00-194+00	RT	800									
194+10	LT								3		
194+27	RT									1	
198+75	LT/RT									1	
198+75-199+83	OBSERVATORY ROAD										
300+17-301+25	PINE HILL ROAD			400							
301+25	LT/RT									1	
399+10	LT/RT									1	
399+10-399+63	STAGECOACH ROAD (WEST)			240							
400+17-401+54	STAGECOACH ROAD (EAST)				230						
401+54	LT/RT									1	
PROJECT	UNDISTRIBUTED	500							15		200
TOTAL		17800	17800	18000	12380	4	2	370	88	6	200

FOSTS WOOD 4X6-INCH X 14-FT

634.0614	QTY	20
UNDISTRIBUTED	EACH	20
TOTAL	EACH	20

SCHEDULE OF ITEMS

REVISED:

CONTRACT:
20160510009PROJECT(S):
5657-00-72FEDERAL ID(S):
WISC 2016166

CONTRACTOR : _____

LINE NO	ITEM DESCRIPTION	APPROX. QUANTITY AND UNITS	UNIT PRICE		BID AMOUNT	
			DOLLARS	CTS	DOLLARS	CTS
0100	205.9010.S Grading and Shaping Intersection (location) 01. Observatory Road	LUMP	LUMP			.
0110	205.9010.S Grading and Shaping Intersection (location) 02. Pine Hill Road	LUMP	LUMP			.
0120	205.9010.S Grading and Shaping Intersection (location) 03. Stagecoach Road	LUMP	LUMP			.
0130	208.0100 Borrow	9,836.000 CY				.
0140	213.0100 Finishing Roadway (project) 01. 5657-00-72	1.000 EACH				.
0150	305.0110 Base Aggregate Dense 3/4-Inch	11,850.000 TON				.
0160	305.0120 Base Aggregate Dense 1 1/4-Inch	4,655.000 TON				.
0170	305.0130 Base Aggregate Dense 3-Inch	3,700.000 TON				.
0180	325.0100 Pulverize and Relay	65,485.000 SY				.
0190	374.1020.S QMP Pulverize and Relay Compaction	65,485.000 SY				.

SCHEDULE OF ITEMS

REVISED:

CONTRACT:
20160510009PROJECT(S):
5657-00-72FEDERAL ID(S):
WISC 2016166

CONTRACTOR : _____

LINE NO	ITEM DESCRIPTION	APPROX. QUANTITY AND UNITS	UNIT PRICE		BID AMOUNT	
			DOLLARS	CTS	DOLLARS	CTS
0730	628.7005 Inlet Protection Type A	4.000 EACH
0740	628.7015 Inlet Protection Type C	2.000 EACH
0750	628.7504 Temporary Ditch Checks	370.000 LF
0760	628.7555 Culvert Pipe Checks	88.000 EACH
0770	628.7560 Tracking Pads	6.000 EACH
0780	629.0210 Fertilizer Type B	30.000 CWT
0790	630.0120 Seeding Mixture No. 20	1,280.000 LB
0800	630.0200 Seeding Temporary	200.000 LB
0810	630.0300 Seeding Borrow Pit	200.000 LB
0820	634.0614 Posts Wood 4x6-Inch X 14-FT	20.000 EACH
0830	638.2102 Moving Signs Type II	72.000 EACH

SCHEDULE OF ITEMS

REVISED:

CONTRACT:
20160510009PROJECT(S):
5657-00-72FEDERAL ID(S):
WISC 2016166

CONTRACTOR : _____

LINE NO	ITEM DESCRIPTION	APPROX. QUANTITY AND UNITS	UNIT PRICE		BID AMOUNT	
			DOLLARS	CTS	DOLLARS	CTS
0840	642.5001 Field Office Type B	1.000 EACH	.		.	
0850	643.0100 Traffic Control (project) 01. 5657-00-72	1.000 EACH	.		.	
0860	643.0300 Traffic Control Drums	1,250.000 DAY	.		.	
0870	643.0420 Traffic Control Barricades Type III	2,160.000 DAY	.		.	
0880	643.0705 Traffic Control Warning Lights Type A	3,240.000 DAY	.		.	
0890	643.0900 Traffic Control Signs	2,484.000 DAY	.		.	
0900	643.0920 Traffic Control Covering Signs Type II	3.000 EACH	.		.	
0910	643.2000 Traffic Control Detour (project) 01. 5657-00-72	1.000 EACH	.		.	
0920	643.3000 Traffic Control Detour Signs	18,360.000 DAY	.		.	
0930	645.0120 Geotextile Type HR	90.000 SY	.		.	
0940	646.0106 Pavement Marking Epoxy 4-Inch	32,609.000 LF	.		.	

SCHEDULE OF ITEMS

REVISED:

CONTRACT:
20160510009PROJECT(S):
5657-00-72FEDERAL ID(S):
WISC 2016166

CONTRACTOR : _____

LINE NO	ITEM DESCRIPTION	APPROX. QUANTITY AND UNITS	UNIT PRICE		BID AMOUNT	
			DOLLARS	CTS	DOLLARS	CTS
0950	646.0116 Pavement Marking Epoxy 6-Inch	37,040.000 LF
0960	646.0126 Pavement Marking Epoxy 8-Inch	365.000 LF
0970	647.0110 Pavement Marking Railroad Crossings Epoxy	1.000 EACH
0980	647.0166 Pavement Marking Arrows Epoxy Type 2	2.000 EACH
0990	647.0356 Pavement Marking Words Epoxy	1.000 EACH
1000	647.0566 Pavement Marking Stop Line Epoxy 18-Inch	195.000 LF
1010	647.0726 Pavement Marking Diagonal Epoxy 12-Inch	40.000 LF
1020	648.0100 Locating No-Passing Zones	4.000 MI
1030	649.0402 Temporary Pavement Marking Paint 4-Inch	200.000 LF
1040	650.4000 Construction Staking Storm Sewer	6.000 EACH
1050	650.4500 Construction Staking Subgrade	14,226.000 LF

SCHEDULE OF ITEMS

REVISED:

CONTRACT:
20160510009PROJECT(S):
5657-00-72FEDERAL ID(S):
WISC 2016166

CONTRACTOR : _____

LINE NO	ITEM DESCRIPTION	APPROX. QUANTITY AND UNITS	UNIT PRICE		BID AMOUNT	
			DOLLARS	CTS	DOLLARS	CTS
1060	650.5000 Construction Staking Base	14,226.000 LF
1070	650.5500 Construction Staking Curb Gutter and Curb & Gutter	2,115.000 LF
1080	650.6000 Construction Staking Pipe Culverts	24.000 EACH
1090	650.8000 Construction Staking Resurfacing Reference	5,197.000 LF
1100	650.9910 Construction Staking Supplemental Control (project) 01. 5657-00-72	LUMP	LUMP	.	.	.
1110	650.9920 Construction Staking Slope Stakes	13,230.000 LF
1120	690.0150 Sawing Asphalt	935.000 LF
1130	690.0250 Sawing Concrete	50.000 LF
1140	ASP.1T0A On-the-Job Training Apprentice at \$5.00/HR	600.000 HRS	5.00000		3000.00	
1150	ASP.1T0G On-the-Job Training Graduate at \$5. 00/HR	325.000 HRS	5.00000		1625.00	

SCHEDULE OF ITEMS

REVISED:

CONTRACT:
20160510009

PROJECT(S):
5657-00-72

FEDERAL ID(S):
WISC 2016166

CONTRACTOR : _____

LINE NO	ITEM DESCRIPTION	APPROX. QUANTITY AND UNITS	UNIT PRICE		BID AMOUNT	
			DOLLARS	CTS	DOLLARS	CTS
1160	SPV.0060 Special 01. Apron Endwalls for Pipe Arch Sloped Cross Drains Steel 71x47-inch 4 to 1	EACH 4.000	.		.	
1170	SPV.0060 Special 02. Apron Endwalls for Culvert Pipe Sloped Cross Drains Steel 72-inch 4 to 1	EACH 1.000	.		.	
1180	SPV.0060 Special 03. Traversable Driveway Side Slopes	EACH 14.000	.		.	
1190	SPV.0060 Special 04. Utility Line Opening (ULO)	EACH 10.000	.		.	
1200	628.2004 Erosion Mat Class I Type B	SY 18,000.000	.		.	
1210	628.2023 Erosion Mat Class II Type B	SY 12,380.000	.		.	
	SECTION 0001 TOTAL				.	
	TOTAL BID				.	