



Wisconsin Department of Transportation

November 2, 2016

Division of Transportation Systems Development

Bureau of Project Development
 4802 Sheboygan Avenue, Rm 601
 P O Box 7916
 Madison, WI 53707-7916

Telephone: (608) 266-1631
 Facsimile (FAX): (608) 266-8459

NOTICE TO ALL CONTRACTORS:

Proposal #02: 1010-02-84, WISC 2016 338
Madison - Portage
CTH CS – Portage Interchange
IH 39
Columbia County

Letting of November 8, 2016

This is Addendum No. 01, which provides for the following:

Schedule of Items

Revised Bid Item Quantities					
Bid Item	Item Description	Unit	Old Quantity	Revised Quantity	Proposal Total
460.4110.S	Reheating HMA Pavement Longitudinal Joints	LF	87,396	117,197	204,593
646.0841.S	Pavement Marking Grooved Wet Contrast Tape	LF	4,100	-2,970	1,130
646.0881.S	Pavement Marking Grooved Wet Tape	LF	92,548	-68,708	23,840
SPV.0090.03	Removing HMA Pavement Longitudinal Joint Milling	LF	87,396	117,197	204,593

Added Bid Item Quantities					
Bid Item	Item Description	Unit	Old Quantity	Revised Quantity	Proposal Total
608.3018	Storm Sewer Pipe Reinforced Concrete Class III-A 18-Inch	LF	0	40	40

Deleted Bid Item Quantities					
Bid Item	Item Description	Unit	Old Quantity	Revised Quantity	Proposal Total
608.0318	Storm Sewer Pipe Reinforced Concrete Class III 18-Inch	LF	40	-40	0

Plan Sheets

Revised Plan Sheets	
Plan Sheet	Plan Sheet Title (brief description of changes to sheet)
25	Revised longitudinal joint detail to depict milling of pavement notch in upper layer only
80	Revised to correct type of apron endwalls to match the bid item.
154	Revised to reflect updated quantity for longitudinal joint milling and reheating
155	Revised to reflect correct bid item for storm sewer pipe
170	Revised to reflect correct bid quantities
186	Revised to remove errant note regarding pipe

Schedule of Items

Attached, dated November 2, 2016, are the revised Schedule of Items Pages. All pages of the Schedule of Items are being replaced.

Plan Sheets

The following 8½ x 11-inch sheets are attached and made part of the plans for this proposal:
Revised: 25, 80, 154, 155, 170 and 186.

The responsibility for notifying potential subcontractors and suppliers of these changes remains with the prime contractor.

Sincerely,

Mike Coleman

Proposal Development Specialist
Proposal Management Section

END OF ADDENDUM

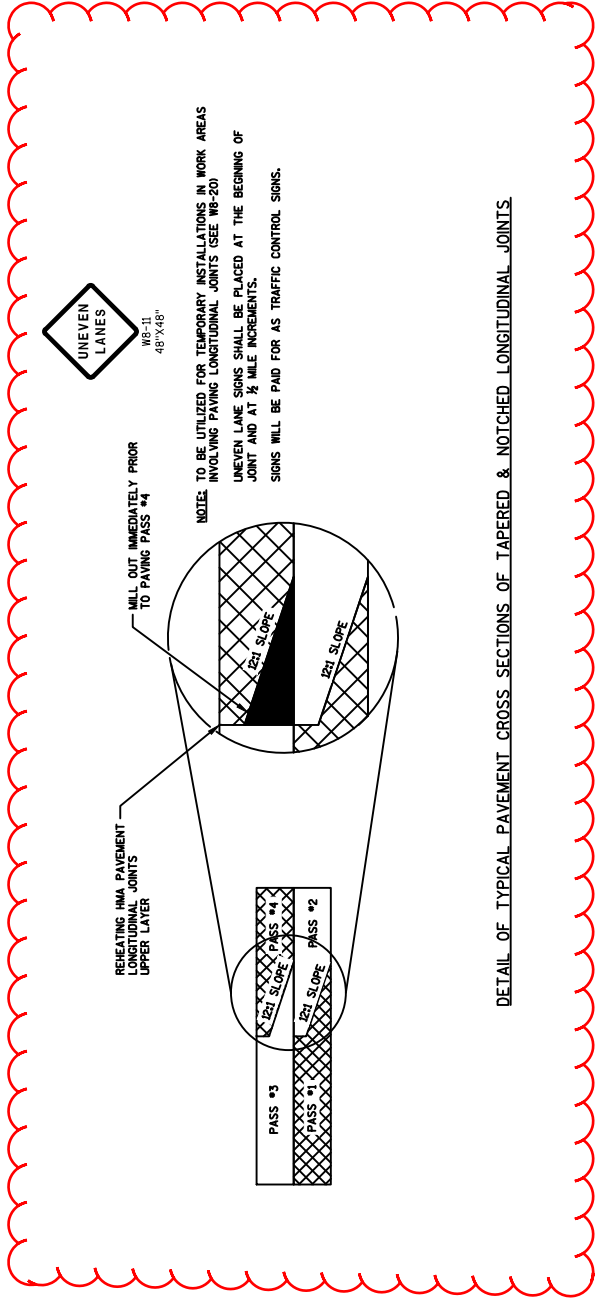

RECREATING HMA PAVEMENT JOINTS UNIFORM PAVING UPPER LAYER

MILL OUT IMMEDIATELY PRIOR TO PAVING PASS #4

NOTE: TO BE UTILIZED FOR TEMPORARY INSTALLATIONS IN WORK AREAS INVOLVING PAVING LONGITUDINAL JOINTS (SEE WB-20) UNEVEN LANE SIGNS SHALL BE PLACED AT THE BEGINNING OF JOINT AND AT 1/2 MILE INCREMENTS. SIGNS WILL BE PAID FOR AS TRAFFIC CONTROL SIGNS.

DETAIL OF TYPICAL PAVEMENT CROSS SECTIONS OF TAPERED & NOTCHED LONGITUDINAL JOINTS

Addendum No. 01
ID 1010-02-84
Revised Sheet 25
November 2, 2016

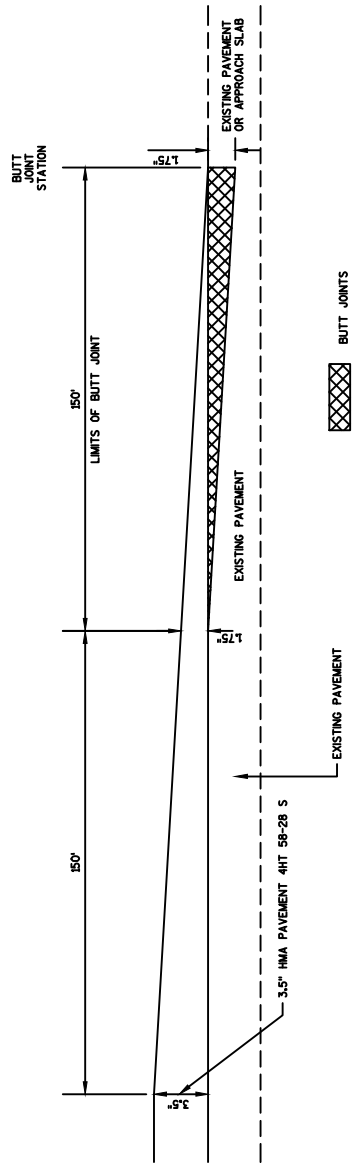

DETAIL OF BUTT JOINT DETAIL

Addendum No. 01
ID 1010-02-84
Revised Sheet 154
November 2, 2016

ASPHALTIC SHOULDER RUMBLE STRIPS

STATION	STATION	LOCATION	RT	LF
830+00 SB	- 1131+48 SB	RT	30,148	
830+00 NB	- 862+00 SB	RT	3,200	
863+00 SB	- 868+70 SB	RT	570	
871+40 SB	- 962+00 SB	RT	9,060	
966+00 SB	- 1009+50 SB	RT	4,350	
1023+60 SB	- 1131+48 SB	RT	10,788	
830+00 NB	- 1131+48 NB	LT	30,148	
830+00 NB	- 843+80 NB	LT	1,380	
847+25 NB	- 854+75 NB	LT	750	
860+00 NB	- 870+85 NB	LT	1,385	
875+65 NB	- 966+75 NB	LT	9,110	
972+70 NB	- 999+30 NB	LT	2,660	
1001+25 NB	- 1131+48 NB	LT	13,023	
TOTAL				116,572

465.0400
ASPHALTIC SHOULDER RUMBLE STRIPS

REMOVING HMA LONGITUDINAL JOINTS

STATION	STATION	LOCATION	RT	LF
830+00 NB	- 864+00NB	10,200	10,200	
885+00NB	- 934+40NB	14,820	14,820	
934+40NB	- 956+00NB	8,640	8,640	
956+00NB	- 965+00NB	4,500	4,500	
965+00NB	- 969+37NB	2,622	2,622	
969+37NB	- 1008+82NB	15,780	15,780	
1008+82NB	- 1014+14NB	3,724	3,724	
1014+14NB	- 1016+97NB	1,698	1,698	
1016+97NB	- 1034+46NB	8,745	8,745	
1034+46NB	- 1131+89NB	38,972	38,972	
830+00SB	- 864+00SB	10,200	10,200	
885+00SB	- 960+75SB	22,725	22,725	
960+75SB	- 1031+00SB	21,075	21,075	
1031+00SB	- 1037+00SB	3,500	3,500	
1038+00SB	- 1131+48SB	37,392	37,392	
TOTAL				204,593

460.4110.5
REMOVING HMA LONGITUDINAL JOINTS

HOT MIX ASPHALT

STATION	STATION	LOCATION	RT	LF
830+00 NB	- 864+00NB	10,200	10,200	
885+00NB	- 934+40NB	14,820	14,820	
934+40NB	- 956+00NB	8,640	8,640	
956+00NB	- 965+00NB	4,500	4,500	
965+00NB	- 969+37NB	2,622	2,622	
969+37NB	- 1008+82NB	15,780	15,780	
1008+82NB	- 1014+14NB	3,724	3,724	
1014+14NB	- 1016+97NB	1,698	1,698	
1016+97NB	- 1034+46NB	8,745	8,745	
1034+46NB	- 1131+89NB	38,972	38,972	
830+00SB	- 864+00SB	10,200	10,200	
885+00SB	- 960+75SB	22,725	22,725	
960+75SB	- 1031+00SB	21,075	21,075	
1031+00SB	- 1037+00SB	3,500	3,500	
1038+00SB	- 1131+48SB	37,392	37,392	
TOTAL				204,593

SPV.0060.17
HOT MIX ASPHALT

HMA
PERCENT WITHIN LIMITS (PWL) TEST STRIP (EACH)

LOCATION	REMARKS
PROJECT	1 TEST STRIP UPPER LAYER
PROJECT	1 TEST STRIP LOWER LAYER
TOTAL	

ASPHALTIC PAVEMENT

STATION	STATION	LOCATION	TACK COAT (GAL)	SPECIAL VA REGRESSION	ASPHALTIC SURFACE	ASPHALTIC FLUMES	
830+00 SB	- 1129+94 SB		20,845	28,966	-	-	
830+00 NB	- 1130+26 NB		22,889	32,905	-	-	
861+50 A	- 865+25 A		53	86	-	-	
82+80 B	- 70+38 B		106	175	-	-	
33+50 C	- 41+00 C		105	172	-	-	
10+00 D	- 2+00 D		196	322	-	-	
336+28S	- 345+18S	RT	22.5	-	87	-	
336+38S	- 341+61S	LT	9.8	-	38	-	
43+93P	- 48+32P	RT	4.7	-	18	-	
44+77P	- 48+16P	LT	3.9	-	15	-	
47+50P	- 48+32P		9.8	-	16	-	
48+19P		RT	-	-	-	3	
48+03P		LT	-	-	-	3	
51+00P	- 52+85P		2.5	-	10	-	
50+85P	- 52+28P		2.1	-	7	-	
50+83P	- 51+50P		7.6	-	13	-	
14+15U	- 16+11U	RT	4	-	17	-	
15+50U	- 16+19U		8	-	14	-	
13+75U	- 16+05U	LT	3	-	12	-	
18+40U	- 19+17U	RT	2	-	6	-	
18+50U	- 22+20U	LT	5	-	20	-	
18+50U	- 19+00U		8	-	14	-	
18+50U		LT	-	-	-	3	
44+70V	- 48+43V		3.8	-	15	-	
47+75V	- 48+53V		8.9	-	15	-	
48+29V		RT	-	-	-	3	
45+13V	- 48+48V		3.8	-	21	-	
48+35V		LT	-	-	-	3	
50+78V	- 56+99V	RT	6.3	-	24	-	
50+74V	- 51+50V		9.0	-	15	-	
50+84V	- 58+84V	LT	6.5	-	25	-	
43+74K	- 48+58K	RT	5	-	18	-	
44+00K	- 48+50K	LT	6	-	22	-	
47+75K	- 48+58K		10	-	16	-	
48+37K		LT	-	-	-	3	
48+53K		RT	-	-	-	3	
50+73K	- 51+50K		9	-	15	-	
50+77K	- 54+45K	LT	3	-	14	-	
50+84K	- 53+17K	RT	3	-	11	-	
50+94K		RT	-	-	-	3	
58+87K		LT	-	-	-	3	
TOTAL				44,361	63,626	498	27

* ADDITIONAL QUANTITY SHOWN ELSEWHERE
ALL ITEMS CATEGORY 0010 UNLESS OTHERWISE NOTED

Addendum No. 01
ID 1010-02-84
Revised Sheet 155
November 2, 2016

DRAINAGE ITEMS		520.9700.S.01	520.9702.S.02	520.9703.S.03	520.9706.S.04	520.9750.S	521.1018	521.1024	521.1030	522.1018	608.3018	611.0430	SPV.0035.01
PIPE NO.	LOCATION	INLET DISCHARGE ELEVATION	CULVERT PIPE LINERS 16-INCH (LF)	CULVERT PIPE LINERS 22-INCH (LF)	CULVERT PIPE LINERS 28-INCH (LF)	CULVERT PIPE LINERS 42-INCH (LF)	CLEANING CULVERT LINES FOR VERIFICATION (EACH)	APRON ENDWALLS FOR CULVERT PIPE STEEL 24-INCH (EACH)	APRON ENDWALLS FOR CULVERT PIPE STEEL 30-INCH (EACH)	APRON ENDWALLS FOR CULVERT PIPE REINFORCED CONCRETE 18-INCH (EACH)	STORM SEWER PIPE REINFORCED CONCRETE CLASS III-A 18-INCH (LF)	RECONSTRUCTING INLETS (EACH)	PRESSURE GROUTING (CY)
C1	1034+78NB	848.29	-	129	-	-	1	-	-	-	-	-	-
C2	1033+66SB	848.44	-	125	-	-	1	-	-	-	-	-	-
C3	1038+47NB	848.29	-	-	130	-	1	-	-	-	-	-	-
C4	1038+02SB	848.50	-	-	148	-	1	-	-	-	-	-	-
C5	1082+14SB	839.82	134	-	-	-	1	-	-	-	-	-	-
C6	1085+02NB	835.85	-	-	259	-	1	-	-	-	-	-	-
C7	1070+18NB	834.06	-	-	-	-	1	-	-	-	-	-	5.6
C8	1069+39SB	834.09	-	-	-	-	1	-	-	-	-	-	6.6
C9	1073+32SB	835.06	129	-	-	-	1	-	-	-	-	-	-
C10	1083+39NB	844.85	-	-	-	-	1	-	-	-	-	-	3.1
C11	1105+60SB	833.15	-	-	122	-	1	-	1	-	-	-	-
C12	1106+36NB	835.18	-	-	123	-	1	-	1	-	-	-	-
C34	35+73.8'C	794.00	-	-	-	-	-	-	-	1	20	1	-
C35	37+20.0'C	794.00	-	-	-	-	-	-	-	1	20	1	-
TOTAL			263	254	523	259	9	2	2	2	40	2	15.3

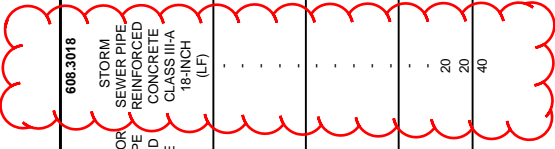

TEMPORARY PRECAST BARRIER

603.8000		603.8125		614.0905	
STATION	LOCATION	CONCRETE BARRIER PRECAST DELIVERED (LF)	CONCRETE BARRIER PRECAST INSTALLED (LF)	CRASH CUSHIONS TEMPORARY (EACH)	CRASH TEST LEVEL
858+75SB	RT	255	255	1	TL-3
858+00NB	LT	300	300	1	TL-3
TOTAL		555	555	2	

* ADDITIONAL QUANTITY SHOWN ELSEWHERE
ALL ITEMS CATEGORY 0010 UNLESS OTHERWISE NOTED

PROJECT NO: 1010-02-84

HWY: IH 39

COUNTY: COLUMBIA

MISCELLANEOUS QUANTITIES

SHEET 155

E

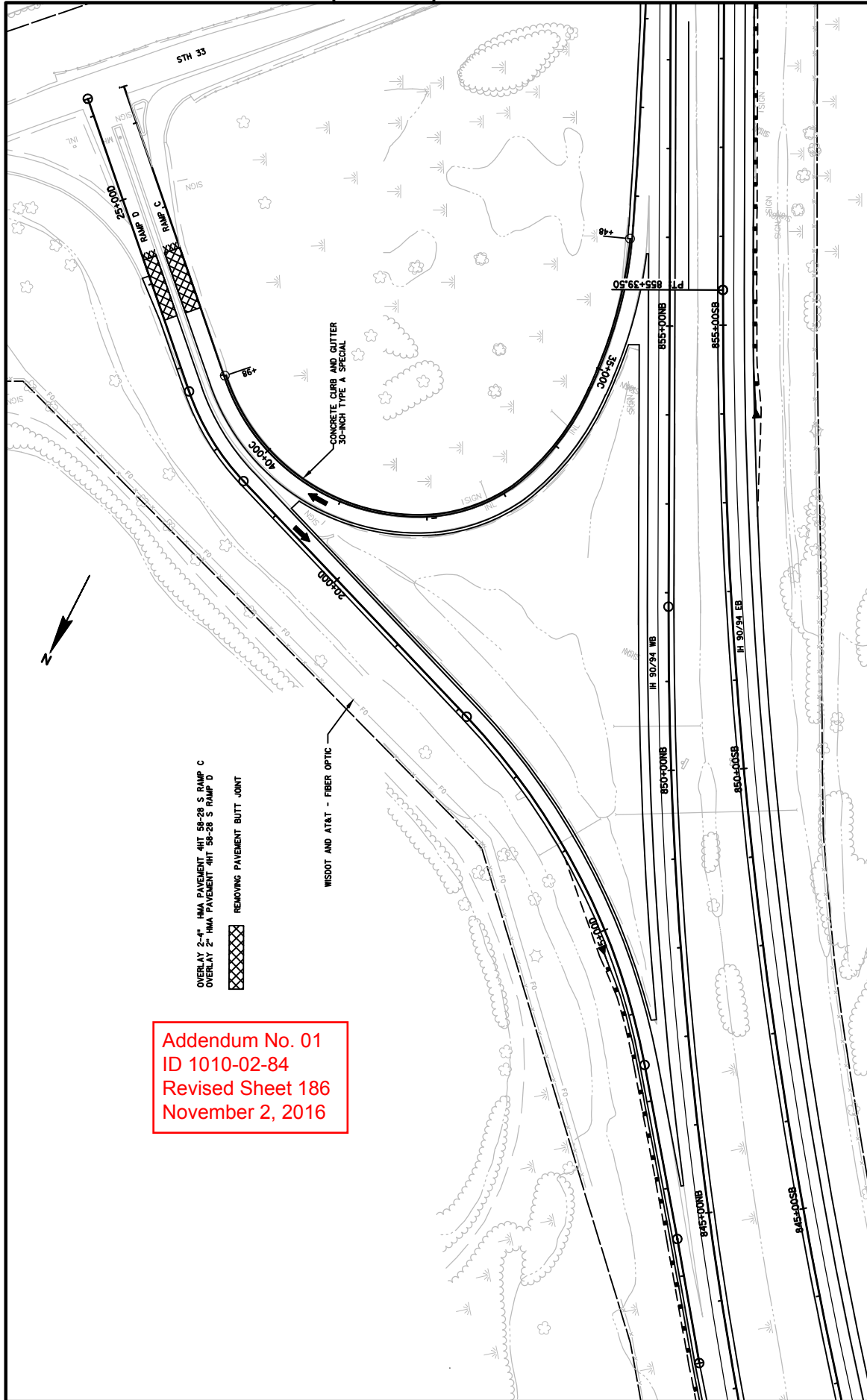

Addendum No. 01
 ID 1010-02-84
 Revised Sheet 186
 November 2, 2016

OVERLAY 2"-4" HMA PAVEMENT 4HT 58-28 S RAMP C
 OVERLAY 2" HMA PAVEMENT 4HT 58-28 S RAMP D
 REMOVING PAVEMENT BUTT JOINT

WISDOT AND ATRT - FIBER OPTIC

CONCRETE CURB AND GUTTER
30-INCH TYPE A SPECIAL

PROJECT NO: 1010-02-84	HWY: IH 39	COUNTY: COLUMBIA	PLAN: RAMP C & D
FILE NAME : X:\3239800\131208-01\TECH\CAD\10100202\SHEETPLAN\CONSTRUCTION PROJECT 1, 1010-02-84\050202.PN-RAMP C, D.DWG			
PLOT DATE : 10/26/2016 11:53 PM			
PLOT BY : DAVID YAHKE			
PLOT NAME :			
			SHEET 186
			WISDOT/CADDS SHEET 42

5

5



Proposal Schedule of Items

Proposal ID: 20161108002

Project(s): 1010-02-84

SECTION: 0001 Contract Items

Alt Set ID:

Alt Mbr ID:

Proposal Line Number	Item ID Description	Approximate Quantity and Units	Unit Price	Bid Amount
0010	201.0105 Clearing	21.000 STA	_____.	_____.
0020	201.0205 Grubbing	21.000 STA	_____.	_____.
0030	203.0100 Removing Small Pipe Culverts	2.000 EACH	_____.	_____.
0040	204.0105 Removing Pavement Butt Joints	9,390.000 SY	_____.	_____.
0050	204.0115 Removing Asphaltic Surface Butt Joints	1,409.000 SY	_____.	_____.
0060	204.0157 Removing Concrete Barrier	50.000 LF	_____.	_____.
0070	204.0165 Removing Guardrail	13,314.000 LF	_____.	_____.
0080	204.0170 Removing Fence	290.000 LF	_____.	_____.
0090	204.0180 Removing Delineators and Markers	255.000 EACH	_____.	_____.
0100	204.0195 Removing Concrete Bases	4.000 EACH	_____.	_____.
0110	204.9060.S Removing (item description) 01. Raised Pavement Markers	750.000 EACH	_____.	_____.
0120	204.9060.S Removing (item description) 02. Lighting Control Cabinet	1.000 EACH	_____.	_____.
0130	204.9060.S Removing (item description) 03. Electrical Meter Breaker	1.000 EACH	_____.	_____.
0140	204.9060.S Removing (item description) 04. Light and Pole	3.000 EACH	_____.	_____.
0150	204.9060.S Removing (item description) 05. Flexible Tubular Markers	70.000 EACH	_____.	_____.
0160	205.0100 Excavation Common	12,407.000 CY	_____.	_____.



Proposal Schedule of Items

Proposal ID: 20161108002

Project(s): 1010-02-84

SECTION: 0001 Contract Items

Alt Set ID:

Alt Mbr ID:

Proposal Line Number	Item ID Description	Approximate Quantity and Units	Unit Price	Bid Amount
0170	208.0100 Borrow	10,758.000 CY	_____.	_____.
0180	213.0100 Finishing Roadway (project) 01. 1010-02-84	1.000 EACH	_____.	_____.
0190	305.0110 Base Aggregate Dense 3/4-Inch	10,039.000 TON	_____.	_____.
0200	305.0120 Base Aggregate Dense 1 1/4-Inch	3,937.000 TON	_____.	_____.
0210	305.0500 Shaping Shoulders	384.000 STA	_____.	_____.
0220	390.0203 Base Patching Asphaltic	10,799.000 SY	_____.	_____.
0230	416.0610 Drilled Tie Bars	372.000 EACH	_____.	_____.
0240	440.4410 Incentive IRI Ride	60,000.000 DOL	1.00000	60,000.00
0250	455.0605 Tack Coat	44,361.000 GAL	_____.	_____.
0260	460.2000 Incentive Density HMA Pavement	82,720.000 DOL	1.00000	82,720.00
0270	460.2010 Incentive Air Voids HMA Pavement	82,720.000 DOL	1.00000	82,720.00
0280	460.4110.S Reheating HMA Pavement Longitudinal Joints	204,593.000 LF	_____.	_____.
0290	465.0105 Asphaltic Surface	498.000 TON	_____.	_____.
0300	465.0315 Asphaltic Flumes	27.000 SY	_____.	_____.
0310	465.0400 Asphaltic Shoulder Rumble Strips	116,572.000 LF	_____.	_____.
0320	502.0100 Concrete Masonry Bridges	117.000 CY	_____.	_____.



Proposal Schedule of Items

Proposal ID: 20161108002

Project(s): 1010-02-84

SECTION: 0001 Contract Items

Alt Set ID:

Alt Mbr ID:

Proposal Line Number	Item ID Description	Approximate Quantity and Units	Unit Price	Bid Amount
0330	502.3100 Expansion Device (structure) 01. B-11-30	LS	LUMP SUM	_____.
0340	502.3100 Expansion Device (structure) 02. B-11-33	LS	LUMP SUM	_____.
0350	502.3200 Protective Surface Treatment	2,984.000 SY	_____.	_____.
0360	502.3210 Pigmented Surface Sealer	8.000 SY	_____.	_____.
0370	502.5005 Masonry Anchors Type L No. 5 Bars	72.000 EACH	_____.	_____.
0380	502.6110 Masonry Anchors Type S 3/4-Inch	126.000 EACH	_____.	_____.
0390	505.0600 Bar Steel Reinforcement HS Coated Structures	19,020.000 LB	_____.	_____.
0400	505.0905 Bar Couplers No. 5	12.000 EACH	_____.	_____.
0410	506.0605 Structural Steel HS	475.000 LB	_____.	_____.
0420	509.0301 Preparation Decks Type 1	819.000 SY	_____.	_____.
0430	509.0302 Preparation Decks Type 2	615.000 SY	_____.	_____.
0440	509.1000 Joint Repair	54.000 SY	_____.	_____.
0450	509.1200 Curb Repair	425.000 LF	_____.	_____.
0460	509.1500 Concrete Surface Repair	840.000 SF	_____.	_____.
0470	509.2000 Full-Depth Deck Repair	6.000 SY	_____.	_____.
0480	509.2500 Concrete Masonry Overlay Decks	276.000 CY	_____.	_____.



Proposal Schedule of Items

Proposal ID: 20161108002

Project(s): 1010-02-84

SECTION: 0001 Contract Items

Alt Set ID:

Alt Mbr ID:

Proposal Line Number	Item ID Description	Approximate Quantity and Units	Unit Price	Bid Amount
0490	509.9005.S Removing Concrete Masonry Deck Overlay (structure) 02. B-11-33	654.000 SY	_____.	_____.
0500	509.9005.S Removing Concrete Masonry Deck Overlay (structure) 03. B-11-35	617.000 SY	_____.	_____.
0510	509.9005.S Removing Concrete Masonry Deck Overlay (structure) 04. B-11-37	644.000 SY	_____.	_____.
0520	509.9005.S Removing Concrete Masonry Deck Overlay (structure) 05. B-11-39	581.000 SY	_____.	_____.
0530	509.9020.S Epoxy Crack Sealing	8.000 LF	_____.	_____.
0540	517.1010.S Concrete Staining (structure) 01. S-11-25	545.000 SF	_____.	_____.
0550	517.1800.S Structure Repainting Recycled Abrasive (structure) 02. B-11-33	LS	LUMP SUM	_____.
0560	517.1800.S Structure Repainting Recycled Abrasive (structure) 03. B-11-35	LS	LUMP SUM	_____.
0570	517.1800.S Structure Repainting Recycled Abrasive (structure) 04. B-11-37	LS	LUMP SUM	_____.
0580	517.1800.S Structure Repainting Recycled Abrasive (structure) 05. B-11-39	LS	LUMP SUM	_____.
0590	517.4500.S Negative Pressure Containment and Collection of Waste Materials (structure) 02. B-11-33	LS	LUMP SUM	_____.
0600	517.4500.S Negative Pressure Containment and Collection of Waste Materials (structure) 03. B-11-35	LS	LUMP SUM	_____.
0610	517.4500.S Negative Pressure Containment and Collection of Waste Materials (structure) 04. B-11-37	LS	LUMP SUM	_____.



Proposal Schedule of Items

Proposal ID: 20161108002

Project(s): 1010-02-84

SECTION: 0001 Contract Items

Alt Set ID:

Alt Mbr ID:

Proposal Line Number	Item ID Description	Approximate Quantity and Units	Unit Price	Bid Amount
0620	517.4500.S Negative Pressure Containment and Collection of Waste Materials (structure) 05. B-11-39	LS	LUMP SUM	_____.
0630	517.6001.S Portable Decontamination Facility	4.000 EACH	_____.	_____.
0640	520.9700.S Culvert Pipe Liners (size) 01. 16-Inch	263.000 LF	_____.	_____.
0650	520.9700.S Culvert Pipe Liners (size) 02. 22-Inch	254.000 LF	_____.	_____.
0660	520.9700.S Culvert Pipe Liners (size) 03. 28-Inch	523.000 LF	_____.	_____.
0670	520.9700.S Culvert Pipe Liners (size) 04. 42-Inch	259.000 LF	_____.	_____.
0680	520.9750.S Cleaning Culvert Pipes for Liner Verification	9.000 EACH	_____.	_____.
0690	521.1018 Apron Endwalls for Culvert Pipe Steel 18-Inch	1.000 EACH	_____.	_____.
0700	521.1024 Apron Endwalls for Culvert Pipe Steel 24-Inch	2.000 EACH	_____.	_____.
0710	521.1030 Apron Endwalls for Culvert Pipe Steel 30-Inch	2.000 EACH	_____.	_____.
0720	522.1018 Apron Endwalls for Culvert Pipe Reinforced Concrete 18-Inch	2.000 EACH	_____.	_____.
0730	528.0112 Culvert Pipe Corrugated Steel Polymer Coated 12-Inch	50.000 LF	_____.	_____.
0740	603.0105 Concrete Barrier Single-Faced 32-Inch	50.000 LF	_____.	_____.
0750	603.8000 Concrete Barrier Temporary Precast Delivered	555.000 LF	_____.	_____.



Proposal Schedule of Items

Proposal ID: 20161108002

Project(s): 1010-02-84

SECTION: 0001 Contract Items

Alt Set ID:

Alt Mbr ID:

Proposal Line Number	Item ID Description	Approximate Quantity and Units	Unit Price	Bid Amount
0760	603.8125 Concrete Barrier Temporary Precast Installed	555.000 LF	_____.	_____.
0770	604.9015.S Reseal Crushed Aggregate Slope Paving	290.000 SY	_____.	_____.
0780	606.0200 Riprap Medium	195.000 CY	_____.	_____.
0800	611.0430 Reconstructing Inlets	2.000 EACH	_____.	_____.
0810	611.8115 Adjusting Inlet Covers	12.000 EACH	_____.	_____.
0820	613.1100.S Cable Barrier Type 1	1,900.000 LF	_____.	_____.
0830	613.1200.S Cable Barrier End Terminal Type 1	2.000 EACH	_____.	_____.
0840	614.0150 Anchor Assemblies for Steel Plate Beam Guard	5.000 EACH	_____.	_____.
0850	614.0200 Steel Thrie Beam Structure Approach	49.000 LF	_____.	_____.
0860	614.0220 Steel Thrie Beam Bullnose Terminal	4.000 EACH	_____.	_____.
0870	614.0230 Steel Thrie Beam	275.000 LF	_____.	_____.
0880	614.0400 Adjusting Steel Plate Beam Guard	1,060.000 LF	_____.	_____.
0890	614.0905 Crash Cushions Temporary	2.000 EACH	_____.	_____.
0900	614.2300 MGS Guardrail 3	24,123.000 LF	_____.	_____.
0910	614.2330 MGS Guardrail 3 K	212.500 LF	_____.	_____.
0920	614.2500 MGS Thrie Beam Transition	939.000 LF	_____.	_____.
0930	614.2610 MGS Guardrail Terminal EAT	45.000 EACH	_____.	_____.



Proposal Schedule of Items

Proposal ID: 20161108002

Project(s): 1010-02-84

SECTION: 0001 Contract Items

Alt Set ID:

Alt Mbr ID:

Proposal Line Number	Item ID Description	Approximate Quantity and Units	Unit Price	Bid Amount
0940	614.2620 MGS Guardrail Terminal Type 2	29.000 EACH	_____.	_____.
0950	616.0100 Fence Woven Wire (height) 01. 4-FT	230.000 LF	_____.	_____.
0960	618.0100 Maintenance And Repair of Haul Roads (project) 01. ID 1010-02-84	1.000 EACH	_____.	_____.
0970	619.1000 Mobilization	1.000 EACH	_____.	_____.
0980	624.0100 Water	279.000 MGAL	_____.	_____.
0990	625.0105 Topsoil	1,500.000 CY	_____.	_____.
1000	625.0500 Salvaged Topsoil	66,365.000 SY	_____.	_____.
1010	627.0200 Mulching	5,500.000 SY	_____.	_____.
1020	628.1504 Silt Fence	35,620.000 LF	_____.	_____.
1030	628.1520 Silt Fence Maintenance	35,620.000 LF	_____.	_____.
1040	628.1905 Mobilizations Erosion Control	12.000 EACH	_____.	_____.
1050	628.1910 Mobilizations Emergency Erosion Control	8.000 EACH	_____.	_____.
1060	628.2002 Erosion Mat Class I Type A	69,578.000 SY	_____.	_____.
1070	628.7005 Inlet Protection Type A	22.000 EACH	_____.	_____.
1080	628.7504 Temporary Ditch Checks	480.000 LF	_____.	_____.
1090	628.7555 Culvert Pipe Checks	116.000 EACH	_____.	_____.
1100	628.7560 Tracking Pads	2.000 EACH	_____.	_____.



Proposal Schedule of Items

Proposal ID: 20161108002

Project(s): 1010-02-84

SECTION: 0001 Contract Items

Alt Set ID:

Alt Mbr ID:

Proposal Line Number	Item ID Description	Approximate Quantity and Units	Unit Price	Bid Amount
1110	628.7570 Rock Bags	1,180.000 EACH	_____.	_____.
1120	629.0210 Fertilizer Type B	48.100 CWT	_____.	_____.
1130	630.0120 Seeding Mixture No. 20	50.000 LB	_____.	_____.
1140	630.0130 Seeding Mixture No. 30	1,257.000 LB	_____.	_____.
1150	630.0200 Seeding Temporary	120.000 LB	_____.	_____.
1160	633.0100 Delineator Posts Steel	295.000 EACH	_____.	_____.
1170	633.0500 Delineator Reflectors	290.000 EACH	_____.	_____.
1180	633.1000 Delineator Brackets	25.000 EACH	_____.	_____.
1190	633.5200 Markers Culvert End	1.000 EACH	_____.	_____.
1200	634.0612 Posts Wood 4x6-Inch X 12-FT	74.000 EACH	_____.	_____.
1210	634.0616 Posts Wood 4x6-Inch X 16-FT	33.000 EACH	_____.	_____.
1220	634.0618 Posts Wood 4x6-Inch X 18-FT	44.000 EACH	_____.	_____.
1230	634.0620 Posts Wood 4x6-Inch X 20-FT	27.000 EACH	_____.	_____.
1240	634.0622 Posts Wood 4x6-Inch X 22-FT	20.000 EACH	_____.	_____.
1250	635.0200 Sign Supports Structural Steel HS	2,361.000 LB	_____.	_____.
1260	636.0100 Sign Supports Concrete Masonry	36.000 CY	_____.	_____.
1270	636.0500 Sign Supports Steel Reinforcement	186.000 LB	_____.	_____.



Proposal Schedule of Items

Proposal ID: 20161108002

Project(s): 1010-02-84

SECTION: 0001 Contract Items

Alt Set ID:

Alt Mbr ID:

Proposal Line Number	Item ID Description	Approximate Quantity and Units	Unit Price	Bid Amount
1280	636.1500 Sign Supports Steel Coated Reinforcement HS	6,340.000 LB	_____.	_____.
1290	637.1220 Signs Type I Reflective SH	4,628.920 SF	_____.	_____.
1300	637.1230 Signs Type I Reflective F	49.000 SF	_____.	_____.
1310	637.2210 Signs Type II Reflective H	1,627.340 SF	_____.	_____.
1320	637.2220 Signs Type II Reflective SH	46.500 SF	_____.	_____.
1330	637.2230 Signs Type II Reflective F	417.000 SF	_____.	_____.
1340	638.2102 Moving Signs Type II	10.000 EACH	_____.	_____.
1350	638.2601 Removing Signs Type I	20.000 EACH	_____.	_____.
1360	638.2602 Removing Signs Type II	147.000 EACH	_____.	_____.
1370	638.3000 Removing Small Sign Supports	175.000 EACH	_____.	_____.
1380	638.3100 Removing Structural Steel Sign Supports	18.000 EACH	_____.	_____.
1390	638.4000 Moving Small Sign Supports	9.000 EACH	_____.	_____.
1400	641.0600 Sign Bridge Single Pole Sign Support Two Signs (structure) 01. S-11-25	LS	LUMP SUM	_____.
1410	642.5401 Field Office Type D	1.000 EACH	_____.	_____.
1420	643.0200 Traffic Control Surveillance and Maintenance (project) 01. 1010-02-84	233.000 DAY	_____.	_____.
1430	643.0300 Traffic Control Drums	42,000.000 DAY	_____.	_____.



Proposal Schedule of Items

Proposal ID: 20161108002

Project(s): 1010-02-84

SECTION: 0001 Contract Items

Alt Set ID:

Alt Mbr ID:

Proposal Line Number	Item ID Description	Approximate Quantity and Units	Unit Price	Bid Amount
1440	643.0420 Traffic Control Barricades Type III	5,434.000 DAY	_____.	_____.
1450	643.0500 Traffic Control Flexible Tubular Marker Posts	75.000 EACH	_____.	_____.
1460	643.0600 Traffic Control Flexible Tubular Marker Bases	75.000 EACH	_____.	_____.
1470	643.0705 Traffic Control Warning Lights Type A	10,828.000 DAY	_____.	_____.
1480	643.0715 Traffic Control Warning Lights Type C	3,184.000 DAY	_____.	_____.
1490	643.0800 Traffic Control Arrow Boards	2,689.000 DAY	_____.	_____.
1500	643.0900 Traffic Control Signs	6,820.000 DAY	_____.	_____.
1510	643.0910 Traffic Control Covering Signs Type I	17.000 EACH	_____.	_____.
1520	643.0920 Traffic Control Covering Signs Type II	948.000 EACH	_____.	_____.
1530	643.1050 Traffic Control Signs PCMS	600.000 DAY	_____.	_____.
1540	643.2000 Traffic Control Detour (project) 01. 1010-02-84	1.000 EACH	_____.	_____.
1550	643.3000 Traffic Control Detour Signs	1,880.000 DAY	_____.	_____.
1560	645.0120 Geotextile Type HR	719.000 SY	_____.	_____.
1570	646.0103 Pavement Marking Paint 4-Inch	5,094.000 LF	_____.	_____.
1580	646.0106 Pavement Marking Epoxy 4-Inch	154,237.000 LF	_____.	_____.
1590	646.0600 Removing Pavement Markings	950.000 LF	_____.	_____.



Proposal Schedule of Items

Proposal ID: 20161108002

Project(s): 1010-02-84

SECTION: 0001 Contract Items

Alt Set ID:

Alt Mbr ID:

Proposal Line Number	Item ID Description	Approximate Quantity and Units	Unit Price	Bid Amount
1600	646.0841.S Pavement Marking Grooved Wet Reflective Contrast Tape 4-Inch	1,130.000 LF	_____.	_____.
1610	646.0843.S Pavement Marking Grooved Wet Reflective Contrast Tape 8-Inch	390.000 LF	_____.	_____.
1620	646.0881.S Pavement Marking Grooved Wet Reflective Tape 4-Inch	23,840.000 LF	_____.	_____.
1630	646.0883.S Pavement Marking Grooved Wet Reflective Tape 8-Inch	7,157.000 LF	_____.	_____.
1640	647.0196 Pavement Marking Arrows Epoxy Type 5	4.000 EACH	_____.	_____.
1650	647.0746 Pavement Marking Diagonal Epoxy 24-Inch	1,430.000 LF	_____.	_____.
1660	649.0400 Temporary Pavement Marking Removable Tape 4-Inch	1,500.000 LF	_____.	_____.
1670	649.0403 Temporary Pavement Marking Epoxy 4-Inch	96,575.000 LF	_____.	_____.
1680	649.1400 Temporary Pavement Marking Stop Line Removable Tape 24-Inch	48.000 LF	_____.	_____.
1690	650.4500 Construction Staking Subgrade	4,395.000 LF	_____.	_____.
1700	650.5000 Construction Staking Base	4,395.000 LF	_____.	_____.
1710	650.5500 Construction Staking Curb Gutter and Curb & Gutter	1,589.000 LF	_____.	_____.
1720	650.6000 Construction Staking Pipe Culverts	2.000 EACH	_____.	_____.
1730	650.6500 Construction Staking Structure Layout (structure) 01. S-11-25	LS	LUMP SUM	_____.



Proposal Schedule of Items

Proposal ID: 20161108002

Project(s): 1010-02-84

SECTION: 0001 Contract Items

Alt Set ID:

Alt Mbr ID:

Proposal Line Number	Item ID Description	Approximate Quantity and Units	Unit Price	Bid Amount
1740	650.8000 Construction Staking Resurfacing Reference	57,411.000 LF	_____.	_____.
1750	650.8500 Construction Staking Electrical Installations (project) 01. 1010-02-84	LS	LUMP SUM	_____.
1760	650.8500 Construction Staking Electrical Installations (project) 02. 1010-02-84 ITS	LS	LUMP SUM	_____.
1770	650.9910 Construction Staking Supplemental Control (project) 01. 1010-02-84	LS	LUMP SUM	_____.
1780	650.9920 Construction Staking Slope Stakes	39,045.000 LF	_____.	_____.
1790	652.0225 Conduit Rigid Nonmetallic Schedule 40 2-Inch	4,180.000 LF	_____.	_____.
1800	652.0235 Conduit Rigid Nonmetallic Schedule 40 3-Inch	135.000 LF	_____.	_____.
1810	652.0605 Conduit Special 2-Inch	2,295.000 LF	_____.	_____.
1820	652.0615 Conduit Special 3-Inch	120.000 LF	_____.	_____.
1830	652.0700.S Install Conduit into Existing Item	4.000 EACH	_____.	_____.
1840	654.0105 Concrete Bases Type 5	9.000 EACH	_____.	_____.
1850	654.0106 Concrete Bases Type 6	3.000 EACH	_____.	_____.
1860	654.0230 Concrete Control Cabinet Bases Type L30	1.000 EACH	_____.	_____.
1870	655.0615 Electrical Wire Lighting 10 AWG	8,733.000 LF	_____.	_____.
1880	655.0635 Electrical Wire Lighting 2 AWG	8,965.000 LF	_____.	_____.



Proposal Schedule of Items

Proposal ID: 20161108002

Project(s): 1010-02-84

SECTION: 0001 Contract Items

Alt Set ID:

Alt Mbr ID:

Proposal Line Number	Item ID Description	Approximate Quantity and Units	Unit Price	Bid Amount
1890	656.0200 Electrical Service Meter Breaker Pedestal (location) 01. STH 78	LS	LUMP SUM	_____.
1900	656.0200 Electrical Service Meter Breaker Pedestal (location) 02. DMS-11-0057(NB)/DMS-11-0058(SB)	LS	LUMP SUM	_____.
1910	656.0500 Electrical Service Breaker Disconnect Box (location) 01. DMS-11-0056	LS	LUMP SUM	_____.
1920	656.0500 Electrical Service Breaker Disconnect Box (location) 02. DMS-11-0057(NB)/DMS-11-0058(SB)	LS	LUMP SUM	_____.
1930	657.0255 Transformer Bases Breakaway 11 1/2-Inch Bolt Circle	12.000 EACH	_____.	_____.
1940	657.0322 Poles Type 5-Aluminum	5.000 EACH	_____.	_____.
1950	657.0327 Poles Type 6-Aluminum	3.000 EACH	_____.	_____.
1960	657.0615 Luminaire Arms Single Member 4 1/2-Inch Clamp 8-FT	3.000 EACH	_____.	_____.
1970	659.1125 Luminaires Utility LED C	3.000 EACH	_____.	_____.
1980	659.2130 Lighting Control Cabinets 120/240 30-Inch	1.000 EACH	_____.	_____.
1990	661.0100 Temporary Traffic Signals for Bridges (structure) 01. B-11-30	LS	LUMP SUM	_____.
2000	662.1030.S Ramp Closure Gates Hardwired 30-FT	2.000 EACH	_____.	_____.
2010	662.1037.S Ramp Closure Gates Hardwired 37-FT	2.000 EACH	_____.	_____.
2020	670.0100 Field System Integrator	LS	LUMP SUM	_____.



Proposal Schedule of Items

Proposal ID: 20161108002

Project(s): 1010-02-84

SECTION: 0001 Contract Items

Alt Set ID:

Alt Mbr ID:

Proposal Line Number	Item ID Description	Approximate Quantity and Units	Unit Price	Bid Amount
2030	670.0200 ITS Documentation	LS	LUMP SUM	_____.
2040	673.0225.S Install Pole Mounted Cabinet	2.000 EACH	_____.	_____.
2050	674.0200 Cable Microwave Detector	5,936.000 LF	_____.	_____.
2060	675.0300 Install Mounted Controller Microwave Detector Assembly	6.000 EACH	_____.	_____.
2070	675.0400.S Install Ethernet Switch	1.000 EACH	_____.	_____.
2080	677.0200 Install Camera Assembly	1.000 EACH	_____.	_____.
2090	678.0100.S Install Overhead Freeway DMS Full Matrix	2.000 EACH	_____.	_____.
2100	690.0150 Sawing Asphalt	2,595.000 LF	_____.	_____.
2110	690.0250 Sawing Concrete	25,919.000 LF	_____.	_____.
2120	ASP.1T0A On-the-Job Training Apprentice at \$5.00/HR	1,500.000 HRS	5.00000	7,500.00
2130	ASP.1T0G On-the-Job Training Graduate at \$5.00/HR	1,050.000 HRS	5.00000	5,250.00
2140	SPV.0035 Special 01. Pressure Grouting	15.300 CY	_____.	_____.
2150	SPV.0060 Special 01. Replace Conduit Plug	3.000 EACH	_____.	_____.
2160	SPV.0060 Special 02. Tension Post to Truss Connection Bolt	7.000 EACH	_____.	_____.
2170	SPV.0060 Special 03. Tension Anchor Rods	1.000 EACH	_____.	_____.



Proposal Schedule of Items

Proposal ID: 20161108002

Project(s): 1010-02-84

SECTION: 0001 Contract Items

Alt Set ID:

Alt Mbr ID:

Proposal Line Number	Item ID Description	Approximate Quantity and Units	Unit Price	Bid Amount
2180	SPV.0060 Special 04. Replace Sign Panel Connector	13.000 EACH	_____.	_____.
2190	SPV.0060 Special 05. Install / Replace U-Bolt	1.000 EACH	_____.	_____.
2200	SPV.0060 Special 06. Replace Sign Bridge ID Plaque	3.000 EACH	_____.	_____.
2210	SPV.0060 Special 07. Removing Raised Pavement Markers and Filling Voids	310.000 EACH	_____.	_____.
2220	SPV.0060 Special 08. Pull Box Non-Conductive 24x42-Inch	20.000 EACH	_____.	_____.
2230	SPV.0060 Special 09. Concrete Barrier Wall Surface Repair	100.000 EACH	_____.	_____.
2240	SPV.0060 Special 10. Pull Box Non-Conductive 24x36-Inch	11.000 EACH	_____.	_____.
2250	SPV.0060 Special 11. Cleaning And Painting Bearings	140.000 EACH	_____.	_____.
2260	SPV.0060 Special 12. Install Vibration Control Damper	1.000 EACH	_____.	_____.
2270	SPV.0060 Special 13. Bearing Repair	2.000 EACH	_____.	_____.
2280	SPV.0060 Special 14. Install IP Radio	4.000 EACH	_____.	_____.
2290	SPV.0060 Special 15. Install Roadway Dynamic Message Sign	1.000 EACH	_____.	_____.
2300	SPV.0060 Special 16. Salvage Camera Assembly	1.000 EACH	_____.	_____.
2310	SPV.0060 Special 17. HMA Percent Within Limits (PWL) Test Strip	2.000 EACH	_____.	_____.



Proposal Schedule of Items

Proposal ID: 20161108002

Project(s): 1010-02-84

SECTION: 0001 Contract Items

Alt Set ID:

Alt Mbr ID:

Proposal Line Number	Item ID Description	Approximate Quantity and Units	Unit Price	Bid Amount
2320	SPV.0090 Special 01. EMSEAL - Bridge Expansion Joint System	446.000 LF	_____.	_____.
2330	SPV.0090 Special 03. Removing HMA Pavement Longitudinal Joint Milling	204,593.000 LF	_____.	_____.
2340	SPV.0090 Special 04. Concrete Approach Curb and Gutter	160.000 LF	_____.	_____.
2350	SPV.0090 Special 05. Sawing Concrete Partial Sawcut	1,992.000 LF	_____.	_____.
2360	SPV.0090 Special 06. Cleaning Concrete Girder Ends	196.000 LF	_____.	_____.
2370	SPV.0090 Special 07. Concrete Curb & Gutter 30-Inch Type A Special	1,450.000 LF	_____.	_____.
2380	SPV.0090 Special 08. Clean and Fill Crack Treatment	4,152.000 LF	_____.	_____.
2390	SPV.0105 Special 01. Remove Catwalk	LS	LUMP SUM	_____.
2400	SPV.0180 Special 01. Cable Barrier Mow Strip, Asphalt	650.000 SY	_____.	_____.
2410	SPV.0180 Special 02. Continuously Reinforced Concrete Pavement SHES Repair	1,430.000 SY	_____.	_____.
2420	SPV.0180 Special 03. Deck Patching B-11-30	9.000 SY	_____.	_____.
2430	SPV.0195 Special 01. HMA Pavement 4 HT-28 S 3.0% Va Regression Special	63,626.000 TON	_____.	_____.
2440	608.3018 Storm Sewer Pipe Class III-A 18-Inch	40.000 LF	_____.	_____.

Section: 0001

Total: _____.

Total Bid: _____.