



Wisconsin Department of Transportation

November 2, 2016

Division of Transportation Systems Development

Bureau of Project Development
 4802 Sheboygan Avenue, Rm 601
 P O Box 7916
 Madison, WI 53707-7916

Telephone: (608) 266-1631
 Facsimile (FAX): (608) 266-8459

NOTICE TO ALL CONTRACTORS:

Proposal #25: 7575-08-72, WISC 2016 414
Cass Street, City of La Crosse
4th Street - 7th Street
STH 16
La Crosse County

7575-08-73
Cass Street, City of La Crosse
4th Street - 7th Street
Water & Sanitary
STH 16
La Crosse County

Letting of November 8, 2016

This is Addendum No. 01, which provides for the following:

Schedule of Items

Revised Bid Item Quantities – ID 7575-08-72					
Bid Item	Item Description	Unit	Old Quantity	Revised Quantity	Proposal Total
647.0306	Pavement Marking Symbols Bike Lane Epoxy	Each	12	-6	6

Added Bid Item Quantities – ID 7575-08-72					
Bid Item	Item Description	Unit	Old Quantity	Revised Quantity	Proposal Total
647.0356	Pavement Marking Words Epoxy	Each	0	4	4

Plan Sheets

Revised Plan Sheets – ID 7575-08-72	
Plan Sheet	Plan Sheet Title (brief description of changes to sheet)
86	Miscellaneous Quantity Sheet – Pavement Marking Table revised to show corrected totals.

Revised Plan Sheets – ID 7575-08-73	
Plan Sheet	Plan Sheet Title (brief description of changes to sheet)
4	Sanitary Sewer Details – Discharge invert elevations of the drops for sanitary manholes “A” and “B” added.

Schedule of Items

Attached, dated November 2, 2016, are the revised Schedule of Items. All pages of the Schedule of Items are being replaced.

Plan Sheets

The following 8½ x 11-inch sheets are attached and made part of the plans for this proposal:

7575-08-72

Revised: 86

7575-08-73

Revised: 4

The responsibility for notifying potential subcontractors and suppliers of these changes remains with the prime contractor.

Sincerely,

Mike Coleman

Proposal Development Specialist
Proposal Management Section

Plan Sheets – ID 7575-08-72

The following 8½ x 11-inch sheet is attached and made part of the plans for this proposal:

Revised: 86.

Plan Sheets – ID 7575-08-73

The following 8½ x 11-inch sheet is attached and made part of the plans for this proposal:

Revised: 4.

END OF ADDENDUM

PAVEMENT MARKING ITEMS

STATION-STATION	LOCATION	646.0106 EPOXY 4-INCH (YELLOW)	646.0126 EPOXY 8-INCH (YELLOW)	646.0156 EPOXY 18-INCH (WHITE)	647.0166 ARROWS EPOXY TYPE 2 (WHITE)	647.0206 BIKE LANE EPOXY (YELLOW)	647.0306 SYMBOLS BIKE LANE EPOXY (YELLOW)	647.0336 SYMBOLS BIKES SHARED LANE EPOXY	647.0356 WORDS "YIELD" EACH	647.0456 CURB EPOXY (YELLOW)	STOP LINE EPOXY (YELLOW)	647.0550 CURB GUTTER AND PAVEMENT STAKES	647.0606 INCH EPOXY (YELLOW)	647.0656 STALLING EPOXY (YELLOW)	647.0706 DIAGONAL EPOXY (YELLOW)	647.0778 CROSSWALK EPOXY 12-INCH
CATEGORY 0010																
5TH 16 (CASS ST)	LT & RT	729	491	15	42	15	2	1	2	10	21	1	82	51	43	227
100+40-110+ALE+26.46																
5TH STREET S	LT & RT	414	13	42	18	18	2	2	1	10	1	1	82	51	18	83
112BLN+45.00 - 113BLN+96.69																
7TH STREET S	LT & RT	308	14	44	18	18	2	2	1	10	1	1	82	51	2	74
43SSN+31.04 - 44SSN+08.80																
CASS STREET	LT & RT	272	15	46	16	16	2	2	1	10	1	1	82	51	2	72
54CSE+75.22 - 56CSE+22																
SUBTOTAL		1723	491	57	174	67	2	6	4	40	4	4	82	51	63	456
CATEGORY 0040																
5TH 16 (CASS ST)	LT & RT	987	716	100	1	2	2	2	0	20	60	2	60	51	121	191
100+22.39 - 103+25.00																
103+00-106+90	LT & RT	832	675	100	3	2	2	2	0	20	45	2	45	51	47	238
5TH AVENUE S	LT & RT	600	18	200	2	4	4	4	0	20	54	2	54	51	168	194
13+10.00 - 16+00																
SUBTOTAL		2419	1409	400	6	4	4	6	0	20	159	2	159	51	168	623
ITEM TOTAL		4142	1900	574	8	6	6	6	4	60	180	6	180	51	231	1079

CONSTRUCTION STAKING

STATION-STATION	LOCATION	650.4000 SEWER STORM	650.4500 SUBGRADE	650.5000 BASE	650.5500 CURB GUTTER AND PAVEMENT STAKES	650.7000 CONCRETE	650.9820 SLOPE ROUNDABOUT	SPV.0105.02 SIDEWALKS
CATEGORY 0010								
5TH 16 (CASS ST)	LT & RT	2	164	164	164	164	164	164
108ALW+63.29 - 110ALW+27.04								
108ALE+63.29 - 110ALE+26.46	LT & RT	3	163	163	163	163	163	163
ROUNDABOUT								
80ALR+00 - 83ALR+40.85	LT & RT	4	341	341	341	341	341	341
108ALE+63.29 - 113BLN+96.69								
5TH 16 (7TH STREET S)	LT & RT	2	90	90	90	90	90	90
112BLN+50.31 - 113BLN+40								
112BLN+45.00 - 113BLN+96.69	LT & RT	2	153	153	153	153	153	153
7TH STREET S	LT & RT	2	135	135	135	135	135	135
43SSN+31.06 - 44SSN+65.81								
43SSN+31.05 - 44SSN+64.76	LT & RT	1	134	134	134	134	134	134
CASS STREET	LT & RT	1	34	34	34	34	34	34
54CSW+78.95 - 55CSW+50								
54CSE+75.22 - 56CSE+22	LT & RT	19	147	147	147	147	147	147
SUBTOTAL		19	1397	286	362	1100	1397	1397
CATEGORY 0040								
5TH 16 (CASS ST)	LT & RT	4	303	303	303	303	303	303
100+22.39 - 103+25.00								
103+25 - 106+93.29	LT & RT	11	600	22	44	579	600	600
5TH AVENUE S	LT & RT	6	171	146	297	25	171	171
13+10.00 - 14+60.52								
15+39.28 - 16+00.00	LT & RT	2	81	125	20	81	81	81
SUBTOTAL		23	1155	229	468	928	1155	1155
ITEM TOTAL		42	2552	525	830	2027	2552	2552

REMOVING PAVEMENT MARKINGS

STATION-STATION	LOCATION	646.0600 LF
CATEGORY 0010		
CASS STREET	LT & RT	75
54CSE+75.22 - 56CSE+22		
SUBTOTAL		75
CATEGORY 0040		
5TH 16 (CASS ST)	LT & RT	313
100+22.39 - 103+25.00		
5TH AVENUE S	LT & RT	25
13+10.00 - 16+00		
SUBTOTAL		338
ITEM TOTAL		413

NOTE: ALL ITEMS AND QUANTITIES ON THIS SHEET ARE FOR ENGINEER ESTIMATE CATEGORY 0010 UNLESS OTHERWISE NOTED.

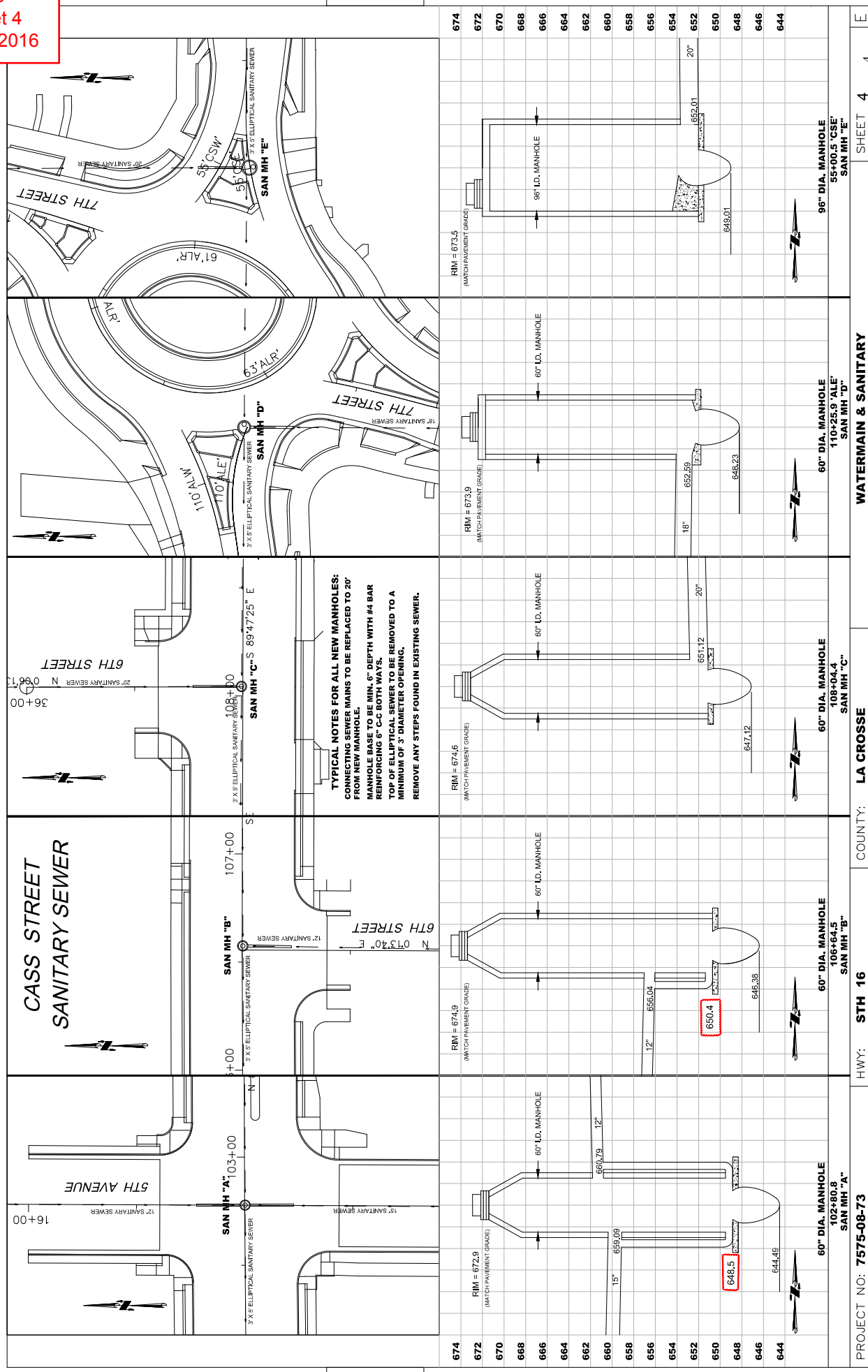

674	RIM = 674.9 (MATCH PAVEMENT GRADE)	60" DIA. MANHOLE 106+64.5 SAN MH "B"	60" DIA. MANHOLE 108+04.4 SAN MH "C"	60" DIA. MANHOLE 110+25.9 "ALE" SAN MH "D"	96" DIA. MANHOLE 55+00.5 "CSE" SAN MH "E"
672	RIM = 672.9 (MATCH PAVEMENT GRADE)	60" DIA. MANHOLE 102+80.8 SAN MH "A"	60" DIA. MANHOLE 108+04.4 SAN MH "C"	60" DIA. MANHOLE 110+25.9 "ALE" SAN MH "D"	96" DIA. MANHOLE 55+00.5 "CSE" SAN MH "E"
670	650.09	60" DIA. MANHOLE 102+80.8 SAN MH "A"	60" DIA. MANHOLE 108+04.4 SAN MH "C"	60" DIA. MANHOLE 110+25.9 "ALE" SAN MH "D"	96" DIA. MANHOLE 55+00.5 "CSE" SAN MH "E"
668	650.79	60" DIA. MANHOLE 102+80.8 SAN MH "A"	60" DIA. MANHOLE 108+04.4 SAN MH "C"	60" DIA. MANHOLE 110+25.9 "ALE" SAN MH "D"	96" DIA. MANHOLE 55+00.5 "CSE" SAN MH "E"
666	650.79	60" DIA. MANHOLE 102+80.8 SAN MH "A"	60" DIA. MANHOLE 108+04.4 SAN MH "C"	60" DIA. MANHOLE 110+25.9 "ALE" SAN MH "D"	96" DIA. MANHOLE 55+00.5 "CSE" SAN MH "E"
664	650.09	60" DIA. MANHOLE 102+80.8 SAN MH "A"	60" DIA. MANHOLE 108+04.4 SAN MH "C"	60" DIA. MANHOLE 110+25.9 "ALE" SAN MH "D"	96" DIA. MANHOLE 55+00.5 "CSE" SAN MH "E"
662	650.09	60" DIA. MANHOLE 102+80.8 SAN MH "A"	60" DIA. MANHOLE 108+04.4 SAN MH "C"	60" DIA. MANHOLE 110+25.9 "ALE" SAN MH "D"	96" DIA. MANHOLE 55+00.5 "CSE" SAN MH "E"
660	650.09	60" DIA. MANHOLE 102+80.8 SAN MH "A"	60" DIA. MANHOLE 108+04.4 SAN MH "C"	60" DIA. MANHOLE 110+25.9 "ALE" SAN MH "D"	96" DIA. MANHOLE 55+00.5 "CSE" SAN MH "E"
658	650.09	60" DIA. MANHOLE 102+80.8 SAN MH "A"	60" DIA. MANHOLE 108+04.4 SAN MH "C"	60" DIA. MANHOLE 110+25.9 "ALE" SAN MH "D"	96" DIA. MANHOLE 55+00.5 "CSE" SAN MH "E"
656	650.09	60" DIA. MANHOLE 102+80.8 SAN MH "A"	60" DIA. MANHOLE 108+04.4 SAN MH "C"	60" DIA. MANHOLE 110+25.9 "ALE" SAN MH "D"	96" DIA. MANHOLE 55+00.5 "CSE" SAN MH "E"
654	650.09	60" DIA. MANHOLE 102+80.8 SAN MH "A"	60" DIA. MANHOLE 108+04.4 SAN MH "C"	60" DIA. MANHOLE 110+25.9 "ALE" SAN MH "D"	96" DIA. MANHOLE 55+00.5 "CSE" SAN MH "E"
652	650.09	60" DIA. MANHOLE 102+80.8 SAN MH "A"	60" DIA. MANHOLE 108+04.4 SAN MH "C"	60" DIA. MANHOLE 110+25.9 "ALE" SAN MH "D"	96" DIA. MANHOLE 55+00.5 "CSE" SAN MH "E"
650	650.09	60" DIA. MANHOLE 102+80.8 SAN MH "A"	60" DIA. MANHOLE 108+04.4 SAN MH "C"	60" DIA. MANHOLE 110+25.9 "ALE" SAN MH "D"	96" DIA. MANHOLE 55+00.5 "CSE" SAN MH "E"
648	648.3	60" DIA. MANHOLE 102+80.8 SAN MH "A"	60" DIA. MANHOLE 108+04.4 SAN MH "C"	60" DIA. MANHOLE 110+25.9 "ALE" SAN MH "D"	96" DIA. MANHOLE 55+00.5 "CSE" SAN MH "E"
646	644.46	60" DIA. MANHOLE 102+80.8 SAN MH "A"	60" DIA. MANHOLE 108+04.4 SAN MH "C"	60" DIA. MANHOLE 110+25.9 "ALE" SAN MH "D"	96" DIA. MANHOLE 55+00.5 "CSE" SAN MH "E"
644	644.46	60" DIA. MANHOLE 102+80.8 SAN MH "A"	60" DIA. MANHOLE 108+04.4 SAN MH "C"	60" DIA. MANHOLE 110+25.9 "ALE" SAN MH "D"	96" DIA. MANHOLE 55+00.5 "CSE" SAN MH "E"



Proposal Schedule of Items

Proposal ID: 20161108025

Project(s): 7575-08-72, 7575-08-73

SECTION: 0001 ROADWAY ITEMS

Alt Set ID: Alt Mbr ID:

Proposal Line Number	Item ID Description	Approximate Quantity and Units	Unit Price	Bid Amount
0010	201.0120 Clearing	31.000 ID	_____.	_____.
0020	201.0220 Grubbing	31.000 ID	_____.	_____.
0030	204.0100 Removing Pavement	8,738.000 SY	_____.	_____.
0040	204.0130 Removing Curb	37.000 LF	_____.	_____.
0050	204.0150 Removing Curb & Gutter	767.000 LF	_____.	_____.
0060	204.0155 Removing Concrete Sidewalk	2,820.000 SY	_____.	_____.
0070	204.0195 Removing Concrete Bases	39.000 EACH	_____.	_____.
0080	204.0210 Removing Manholes	9.000 EACH	_____.	_____.
0090	204.0220 Removing Inlets	14.000 EACH	_____.	_____.
0100	204.0245 Removing Storm Sewer (size) 01. 12-Inch	1,161.000 LF	_____.	_____.
0110	204.0245 Removing Storm Sewer (size) 02. 15-Inch	160.000 LF	_____.	_____.
0120	204.9060.S Removing (item description) 01. Metal Pipe Casings	1.000 EACH	_____.	_____.
0130	205.0100 Excavation Common	4,788.000 CY	_____.	_____.
0140	205.0501.S Excavation, Hauling, and Disposal of Petroleum Contaminated Soil	300.000 TON	_____.	_____.
0150	213.0100 Finishing Roadway (project) 01. 7575-08-72	1.000 EACH	_____.	_____.
0160	305.0110 Base Aggregate Dense 3/4-Inch	409.000 TON	_____.	_____.



Proposal Schedule of Items

Page 2 of 16

Proposal ID: 20161108025

Project(s): 7575-08-72, 7575-08-73

SECTION: 0001 ROADWAY ITEMS

Alt Set ID:

Alt Mbr ID:

Proposal Line Number	Item ID Description	Approximate Quantity and Units	Unit Price	Bid Amount
0170	305.0120 Base Aggregate Dense 1 1/4-Inch	4,105.000 TON	_____.	_____.
0180	405.0100 Coloring Concrete WisDOT Red	168.000 CY	_____.	_____.
0190	415.0080 Concrete Pavement 8-Inch	6,778.000 SY	_____.	_____.
0200	415.1080 Concrete Pavement HES 8-Inch	289.000 SY	_____.	_____.
0210	416.0160 Concrete Driveway 6-Inch	523.000 SY	_____.	_____.
0220	416.0260 Concrete Driveway HES 6-Inch	73.000 SY	_____.	_____.
0230	416.0508 Concrete Roundabout Truck Apron 8-Inch	379.000 SY	_____.	_____.
0240	416.0610 Drilled Tie Bars	75.000 EACH	_____.	_____.
0250	416.0620 Drilled Dowel Bars	72.000 EACH	_____.	_____.
0260	440.4410 Incentive IRI Ride	1,380.000 DOL	_____.	_____.
0270	455.0605 Tack Coat	85.000 GAL	_____.	_____.
0280	460.2000 Incentive Density HMA Pavement	250.000 DOL	_____.	_____.
0290	460.5224 HMA Pavement 4 LT 58-28 S	368.000 TON	_____.	_____.
0300	465.0105 Asphaltic Surface	28.000 TON	_____.	_____.
0310	601.0105 Concrete Curb Type A	5.000 LF	_____.	_____.
0320	601.0110 Concrete Curb Type D	35.000 LF	_____.	_____.
0330	601.0405 Concrete Curb & Gutter 18-Inch Type A	241.000 LF	_____.	_____.



Proposal Schedule of Items

Proposal ID: 20161108025

Project(s): 7575-08-72, 7575-08-73

SECTION: 0001 ROADWAY ITEMS

Alt Set ID:

Alt Mbr ID:

Proposal Line Number	Item ID Description	Approximate Quantity and Units	Unit Price	Bid Amount
0340	601.0409 Concrete Curb & Gutter 30-Inch Type A	702.000 LF	_____.	_____.
0350	601.0411 Concrete Curb & Gutter 30-Inch Type D	830.000 LF	_____.	_____.
0360	601.0580 Concrete Curb & Gutter 4-Inch Sloped 36-Inch Type R	330.000 LF	_____.	_____.
0370	601.0600 Concrete Curb Pedestrian	136.000 LF	_____.	_____.
0380	602.0410 Concrete Sidewalk 5-Inch	20,138.000 SF	_____.	_____.
0390	602.0415 Concrete Sidewalk 6-Inch	3,589.000 SF	_____.	_____.
0400	602.0515 Curb Ramp Detectable Warning Field Natural Patina	474.000 SF	_____.	_____.
0410	602.1000 Concrete Loading Zone	397.000 SF	_____.	_____.
0420	602.1500 Concrete Steps	25.000 SF	_____.	_____.
0430	608.0312 Storm Sewer Pipe Reinforced Concrete Class III 12-Inch	316.000 LF	_____.	_____.
0440	608.0315 Storm Sewer Pipe Reinforced Concrete Class III 15-Inch	228.000 LF	_____.	_____.
0450	608.0318 Storm Sewer Pipe Reinforced Concrete Class III 18-Inch	239.000 LF	_____.	_____.
0460	608.0330 Storm Sewer Pipe Reinforced Concrete Class III 30-Inch	489.000 LF	_____.	_____.
0470	608.0336 Storm Sewer Pipe Reinforced Concrete Class III 36-Inch	537.000 LF	_____.	_____.
0480	608.0342 Storm Sewer Pipe Reinforced Concrete Class III 42-Inch	157.000 LF	_____.	_____.



Proposal Schedule of Items

Proposal ID: 20161108025

Project(s): 7575-08-72, 7575-08-73

SECTION: 0001 ROADWAY ITEMS

Alt Set ID: Alt Mbr ID:

Proposal Line Number	Item ID Description	Approximate Quantity and Units	Unit Price	Bid Amount
0490	608.0412 Storm Sewer Pipe Reinforced Concrete Class IV 12-Inch	457.000 LF	_____.	_____.
0500	608.0415 Storm Sewer Pipe Reinforced Concrete Class IV 15-Inch	120.000 LF	_____.	_____.
0510	608.0418 Storm Sewer Pipe Reinforced Concrete Class IV 18-Inch	117.000 LF	_____.	_____.
0520	611.0624 Inlet Covers Type H	7.000 EACH	_____.	_____.
0530	611.0639 Inlet Covers Type H-S	17.000 EACH	_____.	_____.
0540	611.0652 Inlet Covers Type T	3.000 EACH	_____.	_____.
0550	611.1004 Catch Basins 4-FT Diameter	4.000 EACH	_____.	_____.
0560	611.1230 Catch Basins 2x3-FT	21.000 EACH	_____.	_____.
0570	611.2004 Manholes 4-FT Diameter	4.000 EACH	_____.	_____.
0580	611.2005 Manholes 5-FT Diameter	7.000 EACH	_____.	_____.
0590	611.2006 Manholes 6-FT Diameter	2.000 EACH	_____.	_____.
0600	611.2007 Manholes 7-FT Diameter	1.000 EACH	_____.	_____.
0610	611.9710 Salvaged Inlet Covers	2.000 EACH	_____.	_____.
0620	612.0902.S Insulation Board Polystyrene (inch) 01.2-Inch	288.000 SY	_____.	_____.
0630	619.1000 Mobilization	1.000 EACH	_____.	_____.
0640	620.0300 Concrete Median Sloped Nose	200.000 SF	_____.	_____.



Proposal Schedule of Items

Proposal ID: 20161108025

Project(s): 7575-08-72, 7575-08-73

SECTION: 0001 ROADWAY ITEMS

Alt Set ID: Alt Mbr ID:

Proposal Line Number	Item ID Description	Approximate Quantity and Units	Unit Price	Bid Amount
0650	624.0100 Water	122.000 MGAL	_____.	_____.
0660	625.0100 Topsoil	1,656.000 SY	_____.	_____.
0670	628.1905 Mobilizations Erosion Control	5.000 EACH	_____.	_____.
0680	628.1910 Mobilizations Emergency Erosion Control	3.000 EACH	_____.	_____.
0690	628.7005 Inlet Protection Type A	28.000 EACH	_____.	_____.
0700	628.7015 Inlet Protection Type C	28.000 EACH	_____.	_____.
0710	629.0210 Fertilizer Type B	1.050 CWT	_____.	_____.
0720	631.0300 Sod Water	26.900 MGAL	_____.	_____.
0730	631.1000 Sod Lawn	960.000 SY	_____.	_____.
0740	632.0101 Trees (species) (size) (root) 01. Hawthorne, 'Winter King' (Shrub Tree Form), B&B, 8 - Foot Ht.	3.000 EACH	_____.	_____.
0750	632.0201 Shrubs (species) (size) (root) 01. Juniper, Pfitzer 'Kallay's Compact', Container, 24-Inch Spread	21.000 EACH	_____.	_____.
0760	632.9101 Landscape Planting Surveillance and Care Cycles	26.000 EACH	_____.	_____.
0770	634.0612 Posts Wood 4x6-Inch X 12-FT	8.000 EACH	_____.	_____.
0780	634.0614 Posts Wood 4x6-Inch X 14-FT	8.000 EACH	_____.	_____.
0790	634.0616 Posts Wood 4x6-Inch X 16-FT	3.000 EACH	_____.	_____.
0800	637.2210 Signs Type II Reflective H	376.780 SF	_____.	_____.



Proposal Schedule of Items

Proposal ID: 20161108025

Project(s): 7575-08-72, 7575-08-73

SECTION: 0001 ROADWAY ITEMS

Alt Set ID: Alt Mbr ID:

Proposal Line Number	Item ID Description	Approximate Quantity and Units	Unit Price	Bid Amount
0810	637.2230 Signs Type II Reflective F	122.500 SF	_____.	_____.
0820	638.2602 Removing Signs Type II	18.000 EACH	_____.	_____.
0830	638.3000 Removing Small Sign Supports	2.000 EACH	_____.	_____.
0840	638.3100 Removing Structural Steel Sign Supports	3.000 EACH	_____.	_____.
0850	642.5001 Field Office Type B	1.000 EACH	_____.	_____.
0860	643.0100 Traffic Control (project) 01. 7575-08-72	1.000 EACH	_____.	_____.
0870	643.0410 Traffic Control Barricades Type II	2,614.000 DAY	_____.	_____.
0880	643.0420 Traffic Control Barricades Type III	5,959.000 DAY	_____.	_____.
0890	643.0705 Traffic Control Warning Lights Type A	7,176.000 DAY	_____.	_____.
0900	643.0900 Traffic Control Signs	6,097.000 DAY	_____.	_____.
0910	643.2000 Traffic Control Detour (project) 01. 7575-08-72	1.000 EACH	_____.	_____.
0920	643.3000 Traffic Control Detour Signs	8,715.000 DAY	_____.	_____.
0930	644.1420.S Temporary Pedestrian Surface Plywood	681.000 SF	_____.	_____.
0940	644.1601.S Temporary Curb Ramp	14.000 EACH	_____.	_____.
0950	644.1616.S Temporary Pedestrian Safety Fence	3,400.000 LF	_____.	_____.
0960	645.0111 Geotextile Type DF Schedule A	12,580.000 SY	_____.	_____.
0970	646.0106 Pavement Marking Epoxy 4-Inch	4,142.000 LF	_____.	_____.



Proposal Schedule of Items

Proposal ID: 20161108025

Project(s): 7575-08-72, 7575-08-73

SECTION: 0001 ROADWAY ITEMS

Alt Set ID:

Alt Mbr ID:

Proposal Line Number	Item ID Description	Approximate Quantity and Units	Unit Price	Bid Amount
0980	646.0126 Pavement Marking Epoxy 8-Inch	2,531.000 LF	_____.	_____.
0990	646.0156 Pavement Marking Epoxy 18-Inch	67.000 LF	_____.	_____.
1000	646.0600 Removing Pavement Markings	413.000 LF	_____.	_____.
1010	647.0166 Pavement Marking Arrows Epoxy Type 2	8.000 EACH	_____.	_____.
1020	647.0206 Pavement Marking Arrows Bike Lane Epoxy	6.000 EACH	_____.	_____.
1030	647.0256 Pavement Marking Symbols Epoxy	1.000 EACH	_____.	_____.
1040	647.0306 Pavement Marking Symbols Bike Lane Epoxy	6.000 EACH	_____.	_____.
1050	647.0336 Pavement Marking Symbols Bike Shared Lane Epoxy	6.000 EACH	_____.	_____.
1060	647.0456 Pavement Marking Curb Epoxy	60.000 LF	_____.	_____.
1070	647.0566 Pavement Marking Stop Line Epoxy 18-Inch	180.000 LF	_____.	_____.
1080	647.0606 Pavement Marking Island Nose Epoxy	6.000 EACH	_____.	_____.
1090	647.0656 Pavement Marking Parking Stall Epoxy	82.000 LF	_____.	_____.
1100	647.0706 Pavement Marking Diagonal Epoxy 6-Inch	51.000 LF	_____.	_____.
1110	647.0726 Pavement Marking Diagonal Epoxy 12-Inch	231.000 LF	_____.	_____.
1120	647.0776 Pavement Marking Crosswalk Epoxy 12-Inch	1,079.000 LF	_____.	_____.



Proposal Schedule of Items

Proposal ID: 20161108025

Project(s): 7575-08-72, 7575-08-73

SECTION: 0001 ROADWAY ITEMS

Alt Set ID:

Alt Mbr ID:

Proposal Line Number	Item ID Description	Approximate Quantity and Units	Unit Price	Bid Amount
1130	650.4000 Construction Staking Storm Sewer	42.000 EACH	_____.	_____.
1140	650.4500 Construction Staking Subgrade	2,552.000 LF	_____.	_____.
1150	650.5000 Construction Staking Base	525.000 LF	_____.	_____.
1160	650.5500 Construction Staking Curb Gutter and Curb & Gutter	830.000 LF	_____.	_____.
1170	650.7000 Construction Staking Concrete Pavement	2,026.000 LF	_____.	_____.
1180	650.8500 Construction Staking Electrical Installations (project) 01. 7575-08-72	LS	LUMP SUM	_____.
1190	650.9910 Construction Staking Supplemental Control (project) 01. 7575-08-72	LS	LUMP SUM	_____.
1200	650.9920 Construction Staking Slope Stakes	2,552.000 LF	_____.	_____.
1210	652.0225 Conduit Rigid Nonmetallic Schedule 40 2-Inch	4,129.000 LF	_____.	_____.
1220	652.0235 Conduit Rigid Nonmetallic Schedule 40 3-Inch	1,304.000 LF	_____.	_____.
1230	653.0140 Pull Boxes Steel 24x42-Inch	31.000 EACH	_____.	_____.
1240	653.0905 Removing Pull Boxes	12.000 EACH	_____.	_____.
1250	654.0102 Concrete Bases Type 2	4.000 EACH	_____.	_____.
1260	654.0217 Concrete Control Cabinet Bases Type 9 Special	1.000 EACH	_____.	_____.
1270	654.0230 Concrete Control Cabinet Bases Type L30	1.000 EACH	_____.	_____.



Proposal Schedule of Items

Proposal ID: 20161108025

Project(s): 7575-08-72, 7575-08-73

SECTION: 0001 ROADWAY ITEMS

Alt Set ID: Alt Mbr ID:

Proposal Line Number	Item ID Description	Approximate Quantity and Units	Unit Price	Bid Amount
1280	655.0230 Cable Traffic Signal 5-14 AWG	448.000 LF	_____	_____
1290	655.0250 Cable Traffic Signal 9-14 AWG	569.000 LF	_____	_____
1300	655.0260 Cable Traffic Signal 12-14 AWG	577.000 LF	_____	_____
1310	655.0305 Cable Type UF 2-12 AWG Grounded	676.000 LF	_____	_____
1320	655.0515 Electrical Wire Traffic Signals 10 AWG	933.000 LF	_____	_____
1330	655.0610 Electrical Wire Lighting 12 AWG	4,362.000 LF	_____	_____
1340	655.0615 Electrical Wire Lighting 10 AWG	5,218.000 LF	_____	_____
1350	655.0630 Electrical Wire Lighting 4 AWG	7,641.000 LF	_____	_____
1360	655.0635 Electrical Wire Lighting 2 AWG	2,609.000 LF	_____	_____
1370	655.0900 Traffic Signal EVP Detector Cable	128.000 LF	_____	_____
1380	656.0200 Electrical Service Meter Breaker Pedestal (location) 01. CB100	LS	LUMP SUM	_____
1390	656.0200 Electrical Service Meter Breaker Pedestal (location) 02. CB1	LS	LUMP SUM	_____
1400	658.0110 Traffic Signal Face 3-12 Inch Vertical	8.000 EACH	_____	_____
1410	658.0155 Traffic Signal Face 3-12 Inch Horizontal	4.000 EACH	_____	_____
1420	658.0215 Backplates Signal Face 3 Section 12-Inch	12.000 EACH	_____	_____
1430	658.0416 Pedestrian Signal Face 16-Inch	8.000 EACH	_____	_____



Proposal Schedule of Items

Proposal ID: 20161108025

Project(s): 7575-08-72, 7575-08-73

SECTION: 0001 ROADWAY ITEMS

Alt Set ID: Alt Mbr ID:

Proposal Line Number	Item ID Description	Approximate Quantity and Units	Unit Price	Bid Amount
1440	658.0600 Led Modules 12-Inch Red Ball	12.000 EACH	_____.	_____.
1450	658.0605 Led Modules 12-Inch Yellow Ball	12.000 EACH	_____.	_____.
1460	658.0610 Led Modules 12-Inch Green Ball	12.000 EACH	_____.	_____.
1470	658.0635 Led Modules Pedestrian Countdown Timer 16-Inch	8.000 EACH	_____.	_____.
1480	658.5069 Signal Mounting Hardware (location) 01. STH 16 & 5TH Avenue S	LS	LUMP SUM	_____.
1490	659.2130 Lighting Control Cabinets 120/240 30- Inch	1.000 EACH	_____.	_____.
1500	678.0200 Fiber Optic Splice Enclosure	2.000 EACH	_____.	_____.
1510	678.0300 Fiber Optic Splice	2.000 EACH	_____.	_____.
1520	690.0150 Sawing Asphalt	594.000 LF	_____.	_____.
1530	690.0250 Sawing Concrete	993.000 LF	_____.	_____.
1540	715.0415 Incentive Strength Concrete Pavement	1,897.000 DOL	_____.	_____.
1550	999.1000.S Seismograph	LS	LUMP SUM	_____.
1560	999.1500.S Crack and Damage Survey	LS	LUMP SUM	_____.
1570	ASP.1T0A On-the-Job Training Apprentice at \$5.00/HR	600.000 HRS	_____.	_____.
1580	ASP.1T0G On-the-Job Training Graduate at \$5.00/HR	300.000 HRS	_____.	_____.
1590	SPV.0035 Special 60. Planting Mixture	750.000 CY	_____.	_____.



Proposal Schedule of Items

Proposal ID: 20161108025

Project(s): 7575-08-72, 7575-08-73

SECTION: 0001 ROADWAY ITEMS

Alt Set ID: Alt Mbr ID:

Proposal Line Number	Item ID Description	Approximate Quantity and Units	Unit Price	Bid Amount
1600	SPV.0060 Special 01. Catch Basins 4-FT Diameter Special	3.000 EACH	_____.	_____.
1610	SPV.0060 Special 02. Posts Steel U-Channel 10-FT	23.000 EACH	_____.	_____.
1620	SPV.0060 Special 03. Posts Steel U-Channel 12-FT	10.000 EACH	_____.	_____.
1630	SPV.0060 Special 04. Install V-Loc Post Anchors	33.000 EACH	_____.	_____.
1640	SPV.0060 Special 05. Install Manhole Covers	13.000 EACH	_____.	_____.
1650	SPV.0060 Special 06. Salvaged Metal Railing	1.000 EACH	_____.	_____.
1660	SPV.0060 Special 20. Corporation Stop 1-Inch	15.000 EACH	_____.	_____.
1670	SPV.0060 Special 21. Corporation Stop 1 1/4-Inch	1.000 EACH	_____.	_____.
1680	SPV.0060 Special 22. Corporation Stop 1 1/2-Inch	2.000 EACH	_____.	_____.
1690	SPV.0060 Special 23. Curb Stop 1-Inch	15.000 EACH	_____.	_____.
1700	SPV.0060 Special 24. Curb Stop 1 1/4-Inch	1.000 EACH	_____.	_____.
1710	SPV.0060 Special 25. Curb Stop 1 1/2-Inch	2.000 EACH	_____.	_____.
1720	SPV.0060 Special 26. Service Tap 4-Inch	1.000 EACH	_____.	_____.
1730	SPV.0060 Special 27. Service Valve 4-Inch	1.000 EACH	_____.	_____.
1740	SPV.0060 Special 28. Hydrant	4.000 EACH	_____.	_____.
1750	SPV.0060 Special 29. Hydrant Control Valve 6-Inch	4.000 EACH	_____.	_____.
1760	SPV.0060 Special 30. Nitrile Gaskets-Hydrant Lead 6-Inch	3.000 EACH	_____.	_____.



Proposal Schedule of Items

Proposal ID: 20161108025

Project(s): 7575-08-72, 7575-08-73

SECTION: 0001 ROADWAY ITEMS

Alt Set ID: Alt Mbr ID:

Proposal Line Number	Item ID Description	Approximate Quantity and Units	Unit Price	Bid Amount
1770	SPV.0060 Special 31. Salvage Hydrant	3.000 EACH	_____.	_____.
1780	SPV.0060 Special 32. R S Wedge Valve 16-Inch	1.000 EACH	_____.	_____.
1790	SPV.0060 Special 33. R S Wedge Valve 12-Inch	10.000 EACH	_____.	_____.
1800	SPV.0060 Special 34. R S Wedge Valve 8-Inch	1.000 EACH	_____.	_____.
1810	SPV.0060 Special 35. R S Wedge Valve 6-Inch	3.000 EACH	_____.	_____.
1820	SPV.0060 Special 36. Connect to Existing 16-Inch Water Main/Valve	2.000 EACH	_____.	_____.
1830	SPV.0060 Special 37. Connect to Existing 12-Inch Water Main	1.000 EACH	_____.	_____.
1840	SPV.0060 Special 38. Connect to Existing 8-Inch Water Main	2.000 EACH	_____.	_____.
1850	SPV.0060 Special 39. Connect to Existing 6-Inch Water Main	3.000 EACH	_____.	_____.
1860	SPV.0060 Special 40. Line Stop 16-Inch	1.000 EACH	_____.	_____.
1870	SPV.0060 Special 41. Reducer 12 to 8-Inch	1.000 EACH	_____.	_____.
1880	SPV.0060 Special 42. Reducer 12 to 6-Inch	1.000 EACH	_____.	_____.
1890	SPV.0060 Special 43. Cross 12 x 16-Inch	1.000 EACH	_____.	_____.
1900	SPV.0060 Special 44. Tee 12 x 12-Inch	1.000 EACH	_____.	_____.
1910	SPV.0060 Special 45. Tee 12 x 8-Inch	1.000 EACH	_____.	_____.
1920	SPV.0060 Special 46. Tee 12 x 6-Inch	5.000 EACH	_____.	_____.



Proposal Schedule of Items

Proposal ID: 20161108025

Project(s): 7575-08-72, 7575-08-73

SECTION: 0001 ROADWAY ITEMS

Alt Set ID: Alt Mbr ID:

Proposal Line Number	Item ID Description	Approximate Quantity and Units	Unit Price	Bid Amount
1930	SPV.0060 Special 47. 45 Degree Bend 12-Inch	12.000 EACH	_____.	_____.
1940	SPV.0060 Special 48. 45 Degree Bend 6-Inch	8.000 EACH	_____.	_____.
1950	SPV.0060 Special 49. Nitrile Gasket 12-Inch	12.000 EACH	_____.	_____.
1960	SPV.0060 Special 50. Nitrile Gasket 6-Inch	7.000 EACH	_____.	_____.
1970	SPV.0060 Special 51. Manhole 60-Inch I.D.	4.000 EACH	_____.	_____.
1980	SPV.0060 Special 52. Manhole 96-Inch I.D.	1.000 EACH	_____.	_____.
1990	SPV.0060 Special 53. Water Service Manifold	1.000 EACH	_____.	_____.
2000	SPV.0060 Special 60. Remove Existing Lighting Control	2.000 EACH	_____.	_____.
2010	SPV.0060 Special 61. Salvage Street Light Assembly	27.000 EACH	_____.	_____.
2020	SPV.0060 Special 62. Reinstall Decorative Street Light Assembly	2.000 EACH	_____.	_____.
2030	SPV.0060 Special 63. Decorative Base Type A	20.000 EACH	_____.	_____.
2040	SPV.0060 Special 64. Decorative Base Type B	4.000 EACH	_____.	_____.
2050	SPV.0060 Special 65. Decorative Street Light Assembly Type A	20.000 EACH	_____.	_____.
2060	SPV.0060 Special 66. Decorative Street Light Assembly Type B	4.000 EACH	_____.	_____.
2070	SPV.0060 Special 67. Decorative Traffic Signal Assembly Type C	4.000 EACH	_____.	_____.



Proposal Schedule of Items

Proposal ID: 20161108025

Project(s): 7575-08-72, 7575-08-73

SECTION: 0001 ROADWAY ITEMS

Alt Set ID:

Alt Mbr ID:

Proposal Line Number	Item ID Description	Approximate Quantity and Units	Unit Price	Bid Amount
2080	SPV.0060 Special 68. Perennials, Feather Reed Grass karl Foerster CG 1 Gal	137.000 EACH	_____	_____
2090	SPV.0060 Special 69. Perennials, Prairie Dropseed CG 1 Gal	275.000 EACH	_____	_____
2100	SPV.0090 Special 01. Concrete Curb & Gutter Integral 24-Inch Type D	1,707.000 LF	_____	_____
2110	SPV.0090 Special 02. Concrete Curb & Gutter HES Integral 24-Inch Type D	115.000 LF	_____	_____
2120	SPV.0090 Special 03. Concrete Curb & Gutter 24-Inch Type A	24.000 LF	_____	_____
2130	SPV.0090 Special 04. Concrete Curb & Gutter 30-Inch Type A Full Depth	450.000 LF	_____	_____
2140	SPV.0090 Special 05. Salvaged Decorative Fence	8.000 LF	_____	_____
2150	SPV.0090 Special 06. Storm Sewer Pipe PVC 6-Inch	8.000 LF	_____	_____
2160	SPV.0090 Special 07. Storm Sewer Pipe PVC 12-Inch	68.000 LF	_____	_____
2170	SPV.0090 Special 20. Copper Water Service 1-Inch	495.000 LF	_____	_____
2180	SPV.0090 Special 21. Copper Water Service 1 1/4-Inch	46.000 LF	_____	_____
2190	SPV.0090 Special 22. Copper Water Service 1 1/2-Inch	59.000 LF	_____	_____
2200	SPV.0090 Special 23. Ductile Iron Water Service 4-Inch	15.000 LF	_____	_____
2210	SPV.0090 Special 24. Ductile Iron Water Main 16-Inch	110.000 LF	_____	_____



Proposal Schedule of Items

Proposal ID: 20161108025

Project(s): 7575-08-72, 7575-08-73

SECTION: 0001 ROADWAY ITEMS

Alt Set ID: Alt Mbr ID:

Proposal Line Number	Item ID Description	Approximate Quantity and Units	Unit Price	Bid Amount
2220	SPV.0090 Special 25. Ductile Iron Water Main 12-Inch	1,453.000 LF	_____.	_____.
2230	SPV.0090 Special 26. Ductile Iron Water Main 8-Inch	108.000 LF	_____.	_____.
2240	SPV.0090 Special 27. Ductile Iron Water Main 6-Inch	105.000 LF	_____.	_____.
2250	SPV.0090 Special 28. Ductile Iron Hydrant Lead 6-Inch	62.000 LF	_____.	_____.
2260	SPV.0090 Special 29. Sanitary Sewer 12-Inch	40.000 LF	_____.	_____.
2270	SPV.0090 Special 30. Sanitary Sewer 15-Inch	20.000 LF	_____.	_____.
2280	SPV.0090 Special 31. Sanitary Sewer 18-Inch	20.000 LF	_____.	_____.
2290	SPV.0090 Special 32. Sanitary Sewer 20-Inch	40.000 LF	_____.	_____.
2300	SPV.0090 Special 60. Fiber Optic Tracer Cable	2,604.000 LF	_____.	_____.
2310	SPV.0090 Special 61. Fiber Optic Warning Tape	1,629.000 LF	_____.	_____.
2320	SPV.0090 Special 62. Fiber Optic Cable Outdoor Plant 12-CT	2,372.000 LF	_____.	_____.
2330	SPV.0090 Special 63. Furnish & Install Equivalent Lighting Conductors	3,222.000 LF	_____.	_____.
2340	SPV.0105 Special 01. Concrete Pavement Joint Layout	LS	LUMP SUM	_____.
2350	SPV.0105 Special 02. Construction Staking Roundabout Sidewalks	LS	LUMP SUM	_____.
2360	SPV.0105 Special 60. Traffic Signal Communication Systems Integration	LS	LUMP SUM	_____.



Proposal Schedule of Items

Proposal ID: 20161108025

Project(s): 7575-08-72, 7575-08-73

SECTION: 0001 ROADWAY ITEMS

Alt Set ID: Alt Mbr ID:

Proposal Line Number	Item ID Description	Approximate Quantity and Units	Unit Price	Bid Amount
2370	SPV.0105 Special 61. Remove Traffic Signal (STH 16 & 5TH Avenue South)	LS	LUMP SUM	_____.
2380	SPV.0105 Special 62. Remove Traffic Signal (STH 16 & 7TH Street)	LS	LUMP SUM	_____.
2390	SPV.0105 Special 63. Furnish & Install Traffic Signal Cabinet And Controller (STH 16 & 5TH Ave)	LS	LUMP SUM	_____.
2400	SPV.0105 Special 64. Remove And Salvage EVP Equipment (STH 16 & 5th Avenue South)	LS	LUMP SUM	_____.
2410	SPV.0165 Special 01. Permeable Interlocking Concrete Pavers	9,102.000 SF	_____.	_____.
2420	SPV.0180 Special 60. Shredded Hardwood Bark Mulch	500.000 SY	_____.	_____.
2430	647.0356 Pavement Marking Words Epoxy	4.000 EACH	_____.	_____.
Section: 0001			Total:	_____.
			Total Bid:	_____.