



# Wisconsin Department of Transportation

January 3, 2017

## Division of Transportation Systems Development

Bureau of Project Development  
4802 Sheboygan Avenue, Rm 601  
P O Box 7916  
Madison, WI 53707-7916

Telephone: (608) 266-1631  
Facsimile (FAX): (608) 266-8459

### NOTICE TO ALL CONTRACTORS:

**Proposal #08: 4986-00-22, WISC 2017 007**  
**C Fond du Lac, CTH VV**  
**Hickory Street to Rogersville Road**  
**CTH VV**  
**Fond du Lac County**

### Letting of January 10, 2017

This is Addendum No. 01, which provides for the following:

#### Special Provisions

Revised Special Provisions	
Article No.	Description
4	Traffic

#### Plan Sheets

Revised Plan Sheets	
Plan Sheet	Plan Sheet Title (brief description of changes to sheet)
414-428, 430-434, 451-453	Updated the asphaltic path pavement structure depth to match the typical sections

The responsibility for notifying potential subcontractors and suppliers of these changes remains with the prime contractor.

Sincerely,

*Mike Coleman*

Proposal Development Specialist  
Proposal Management Section

**ADDENDUM NO. 01**

**4986-00-22**

**January 3, 2017**

**Special Provisions**

**4. Traffic.**

*Replace paragraph five with the following:*

Additionally, stage construction operations to accommodate two way local traffic on CTH VV at all times from station 272'EB'+00 to 276'EB'+00 and from Military Road to station 311'EB'+06.90. Stage construction operations to accommodate two way local traffic on Military Road with the exception of the 60 day interim completion duration of Military Road between station 450'NB'+00 to 457'NB'+84. When construction operations do not accommodate two way local traffic on Military Road between station 450'NB'+00 to 457'NB'+84, stage construction operations to accommodate two way local traffic on CTH VV between station 276'EB'+00 to Military Road. Traffic control drums shall be used to delineate two way local traffic. Maintain a 10' wide minimum lane width (11' wide desirable width) for local traffic. Flagging operations will be allowed during daylight hours to reduce local traffic to one lane as needed to complete construction operations. Notify the City of Fond du Lac and Fond du Lac County emergency services departments/dispatch at least 48 hours prior to elimination of two way traffic on Military Road, or any change in business access along the project.

**Plan Sheets**

The following 8½ x 11-inch sheets are attached and made part of the plans for this proposal:

Revised: 414-428, 430-434, and 451-453

END OF ADDENDUM

Addendum No. 01  
 ID 4986-00-22  
 Revised Sheet 414  
 January 3, 2017

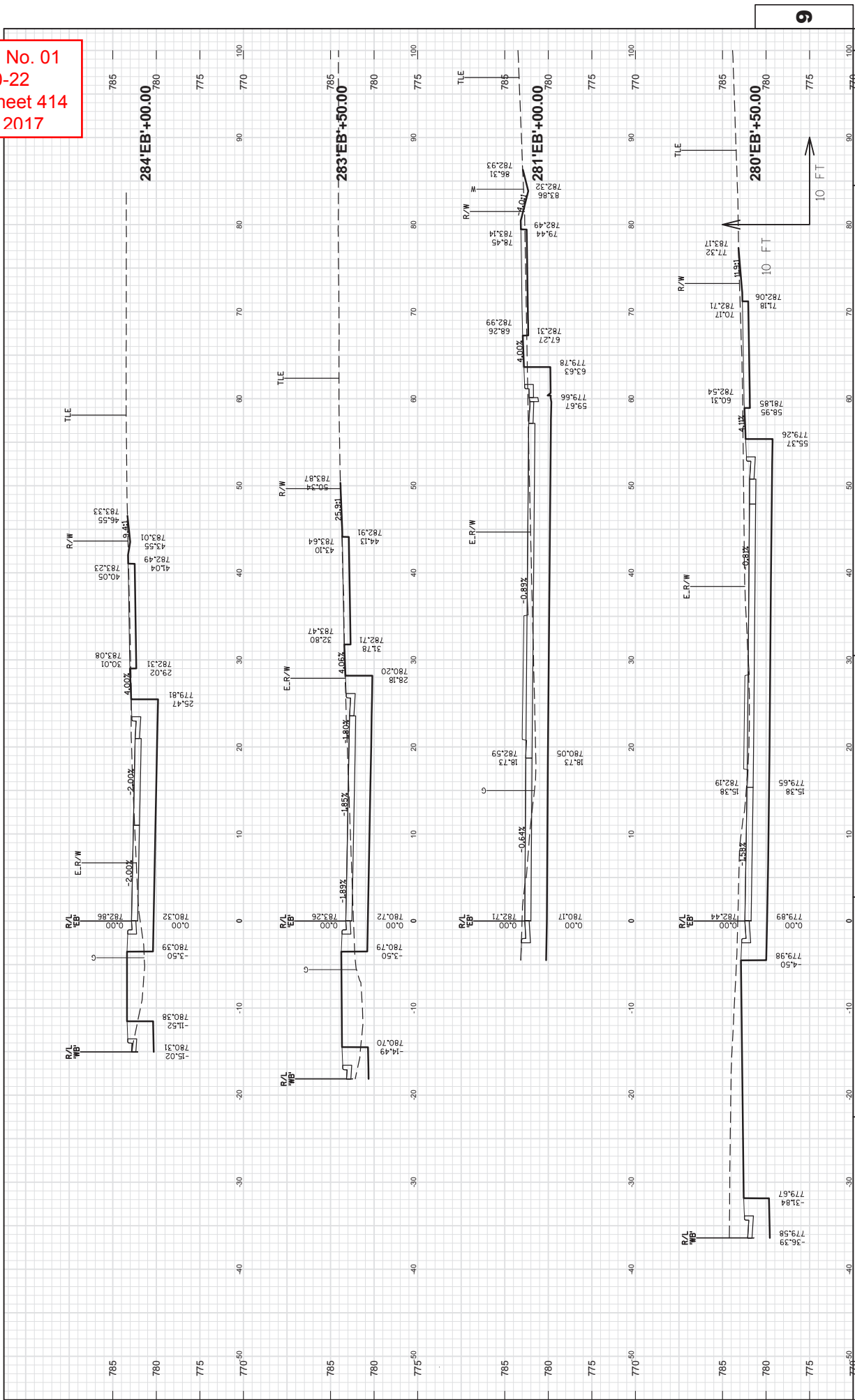

Addendum No. 01  
 ID 4986-00-22  
 Revised Sheet 415  
 January 3, 2017

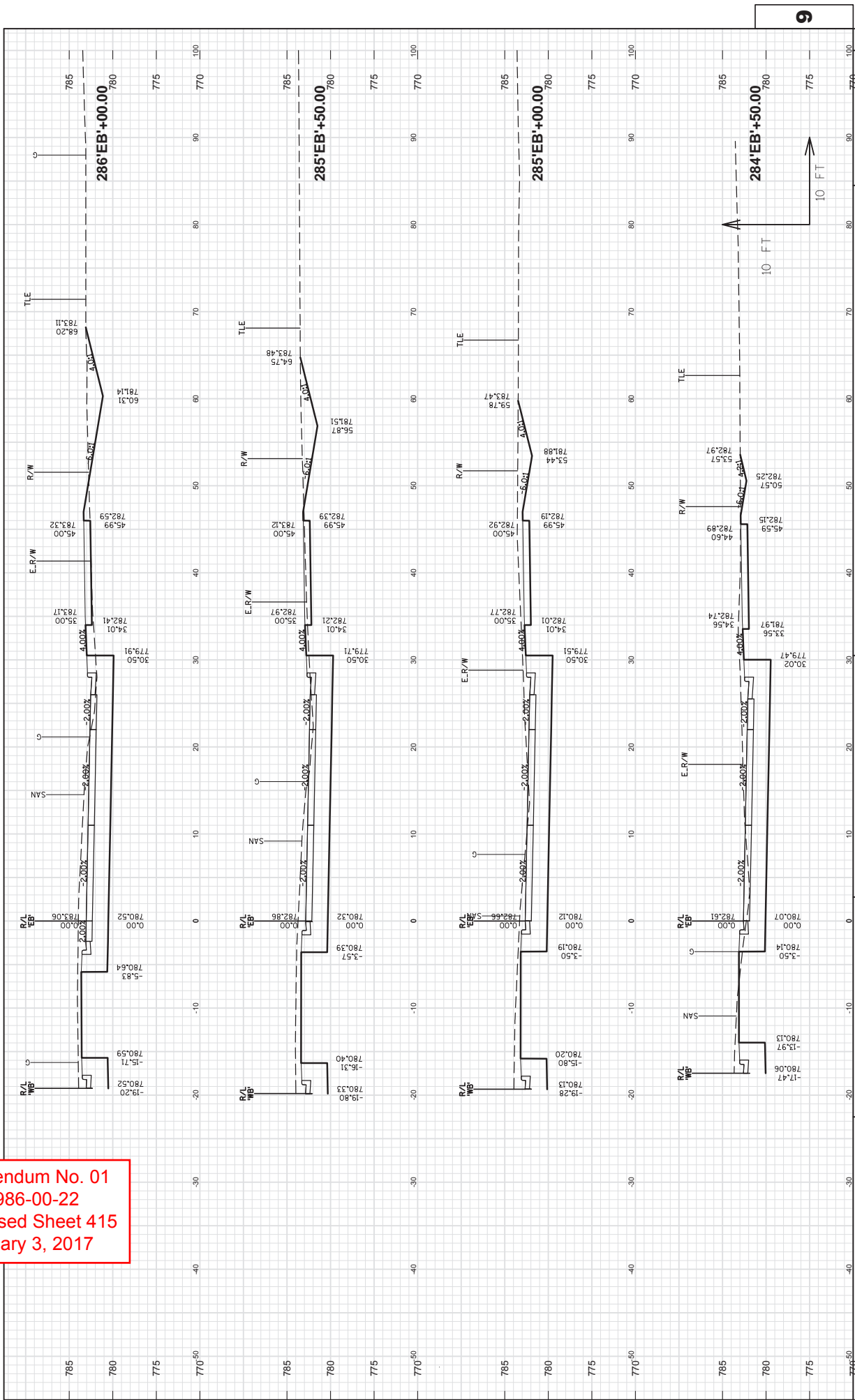

Addendum No. 01  
 ID 4986-00-22  
 Revised Sheet 416  
 January 3, 2017

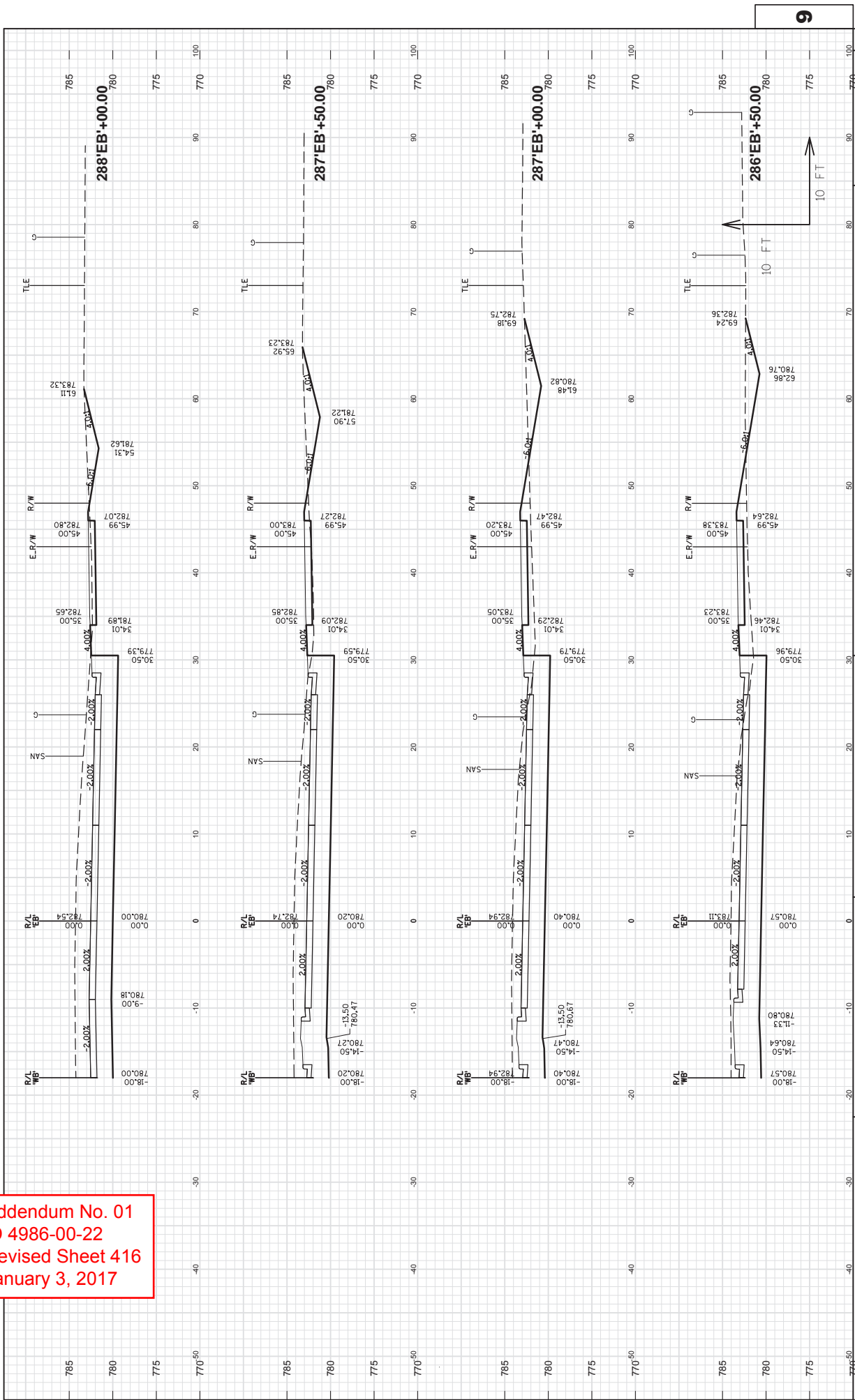

Addendum No. 01  
 ID 4986-00-22  
 Revised Sheet 417  
 January 3, 2017

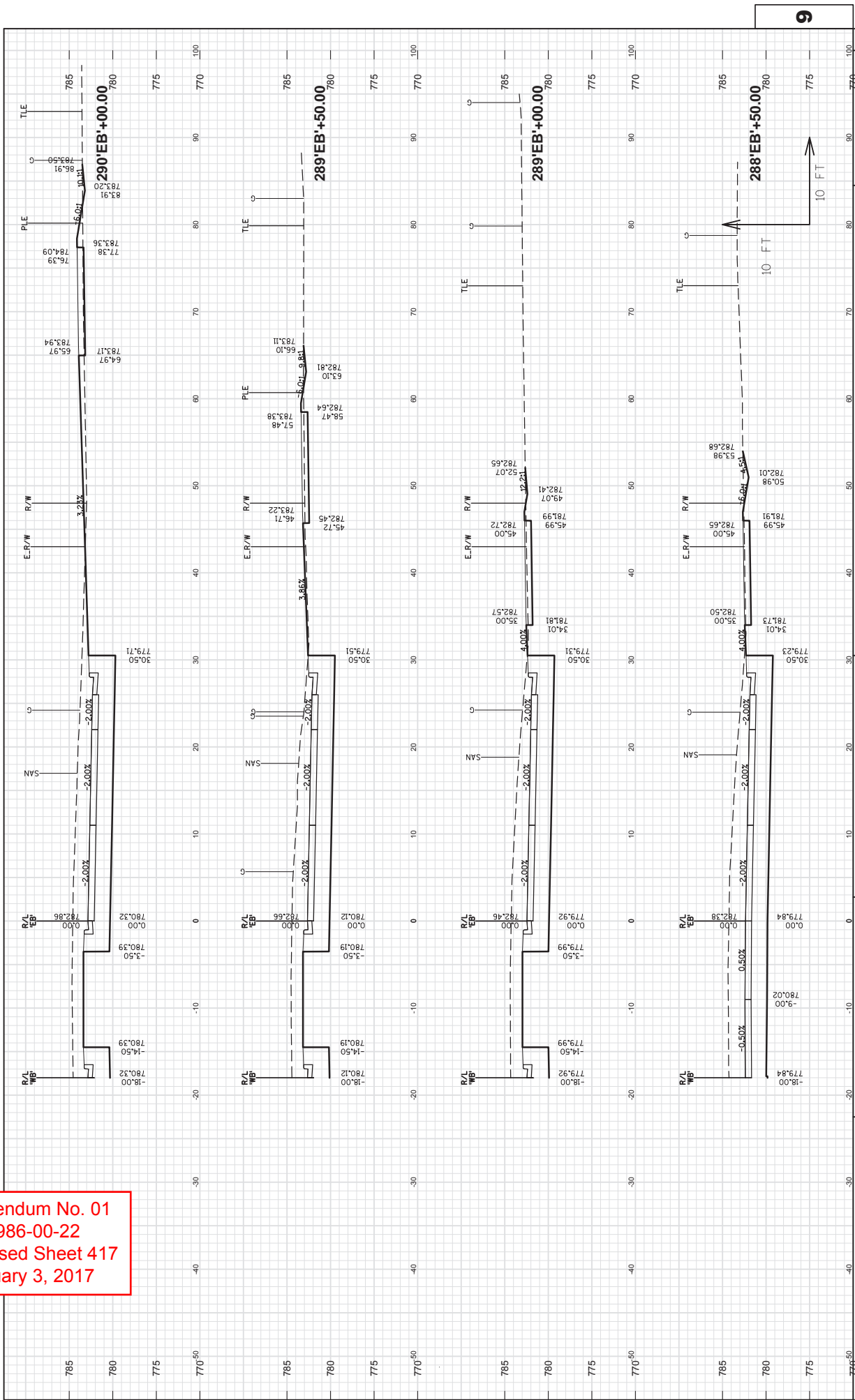

Addendum No. 01  
 ID 4986-00-22  
 Revised Sheet 418  
 January 3, 2017

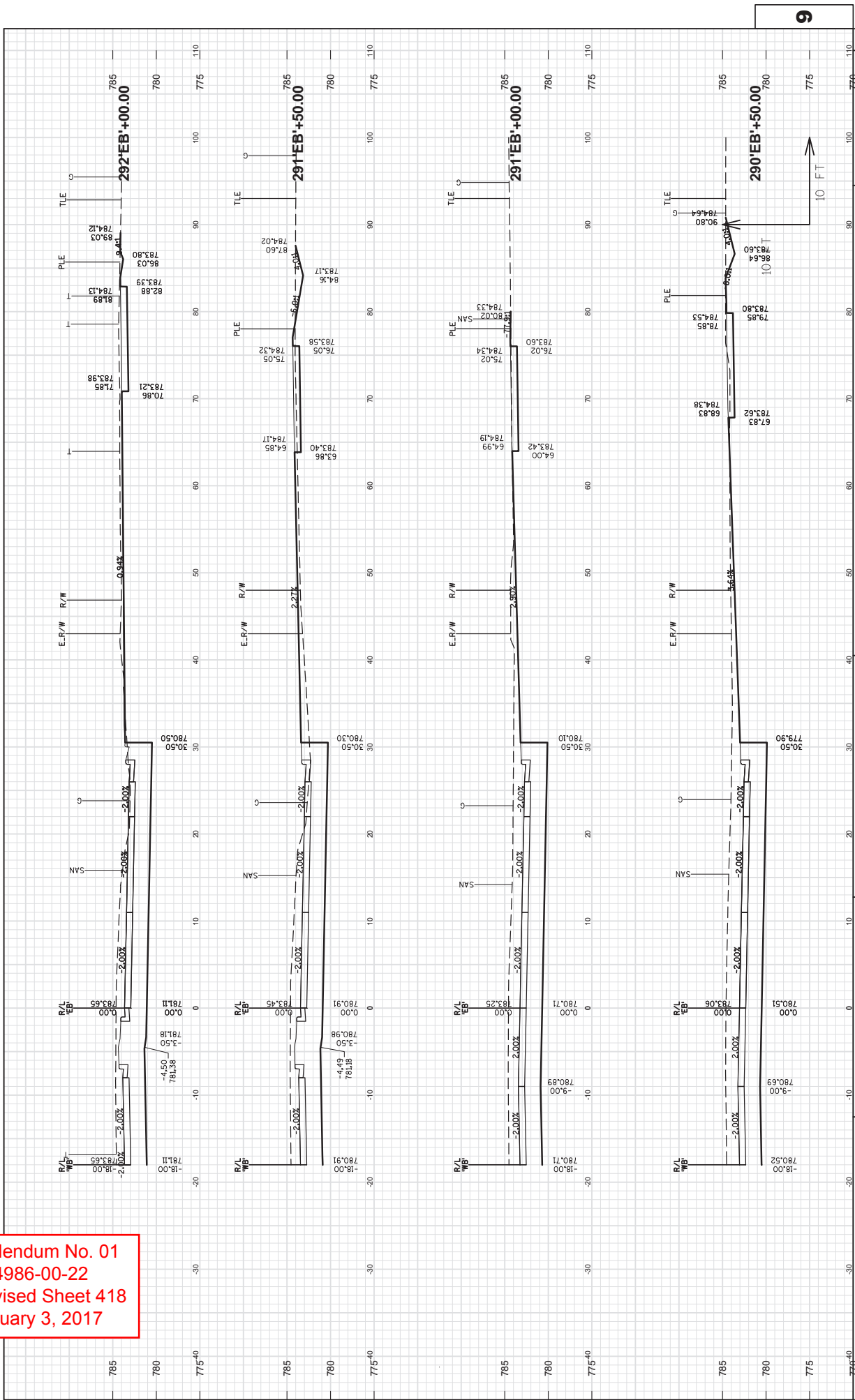

Addendum No. 01  
 ID 4986-00-22  
 Revised Sheet 419  
 January 3, 2017

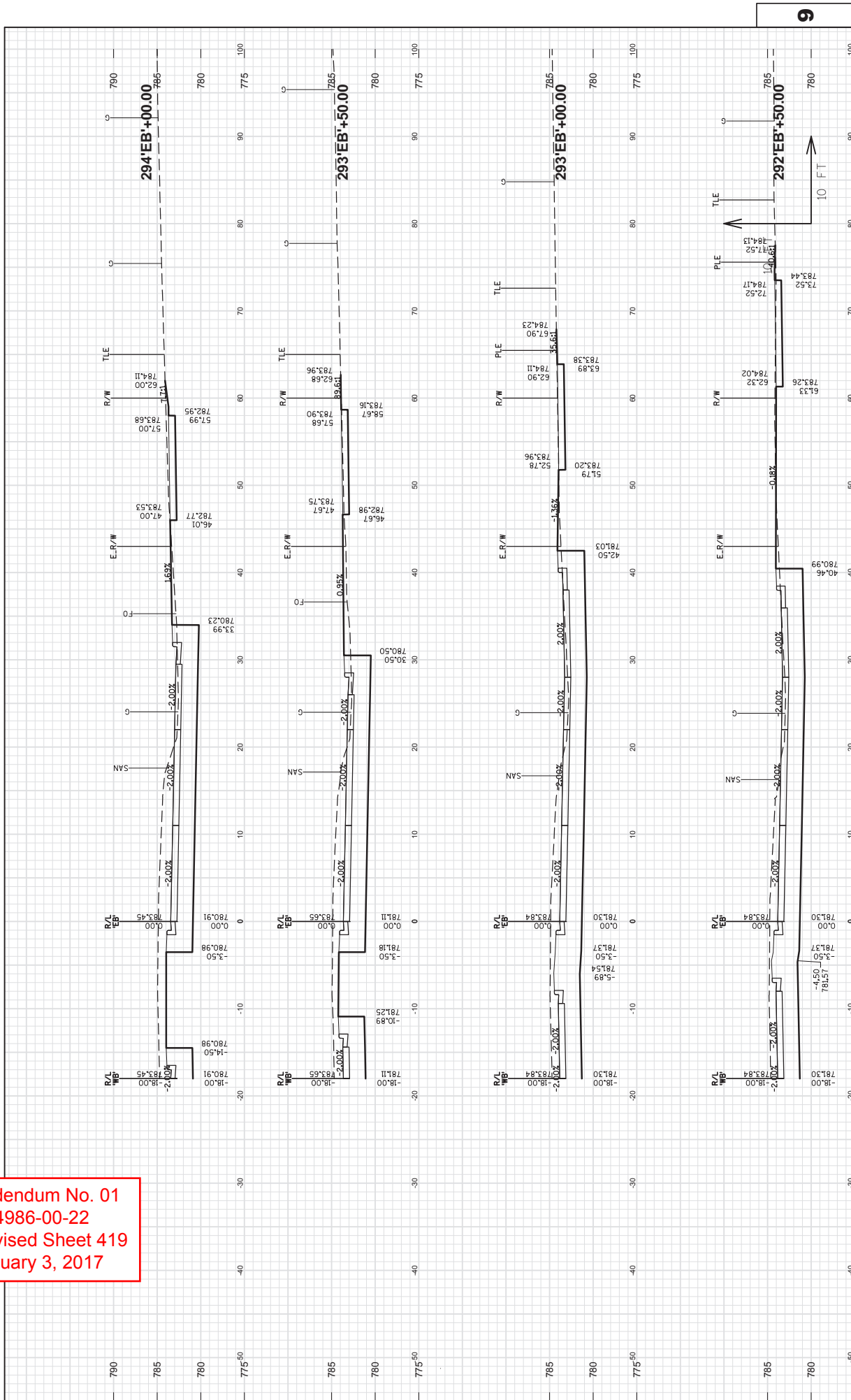



Addendum No. 01  
 ID 4986-00-22  
 Revised Sheet 420  
 January 3, 2017

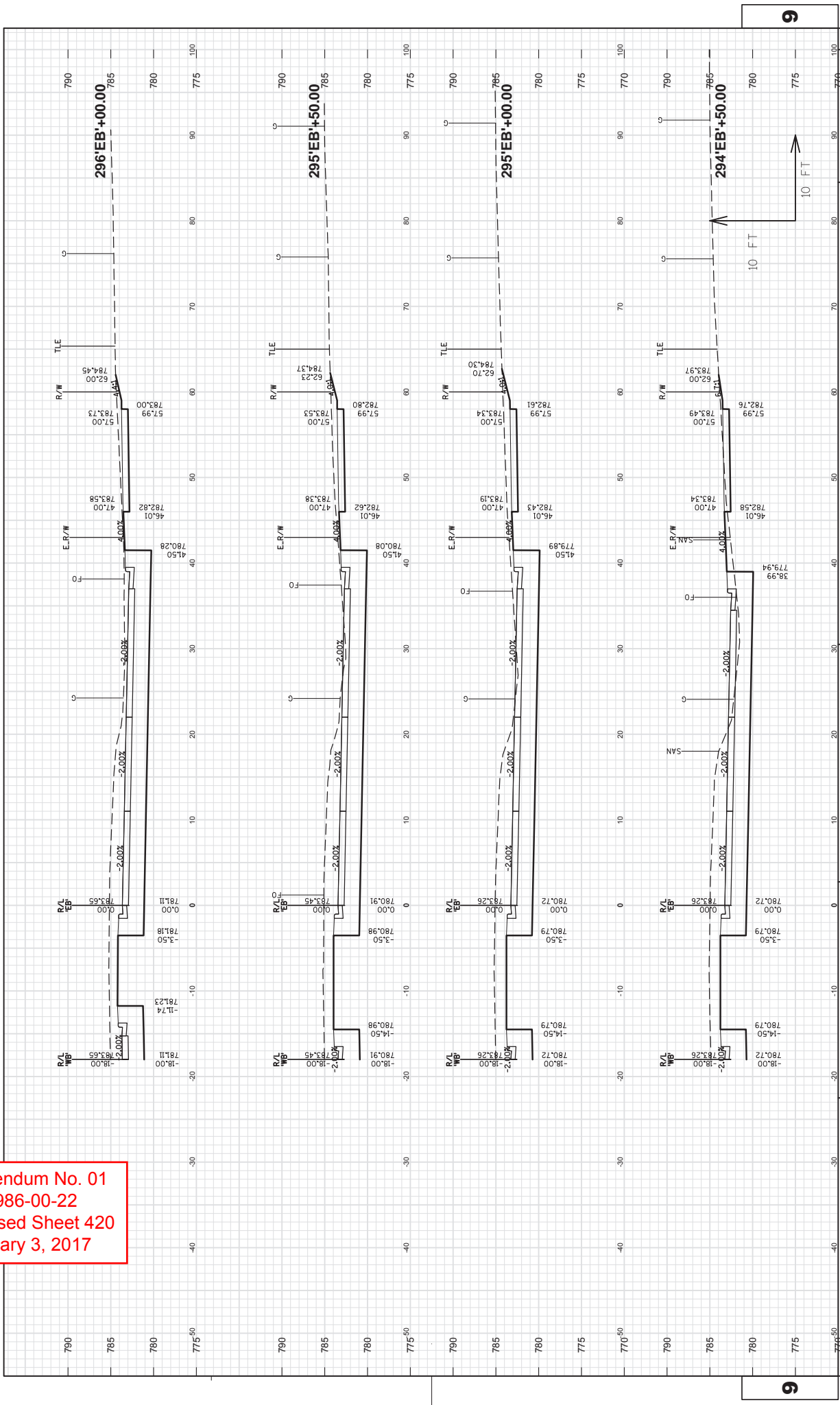

Addendum No. 01  
 ID 4986-00-22  
 Revised Sheet 421  
 January 3, 2017

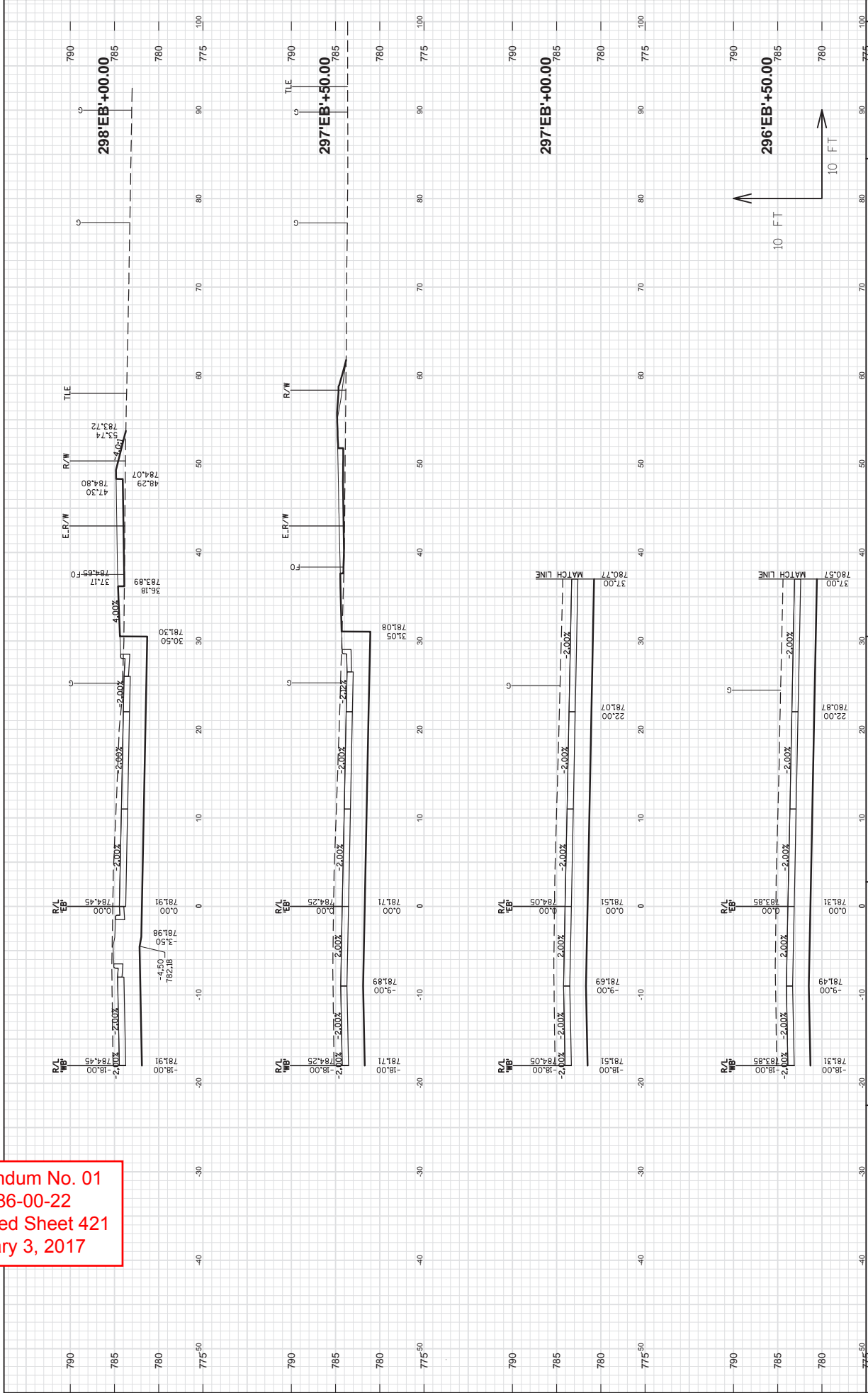

Addendum No. 01  
 ID 4986-00-22  
 Revised Sheet 422  
 January 3, 2017

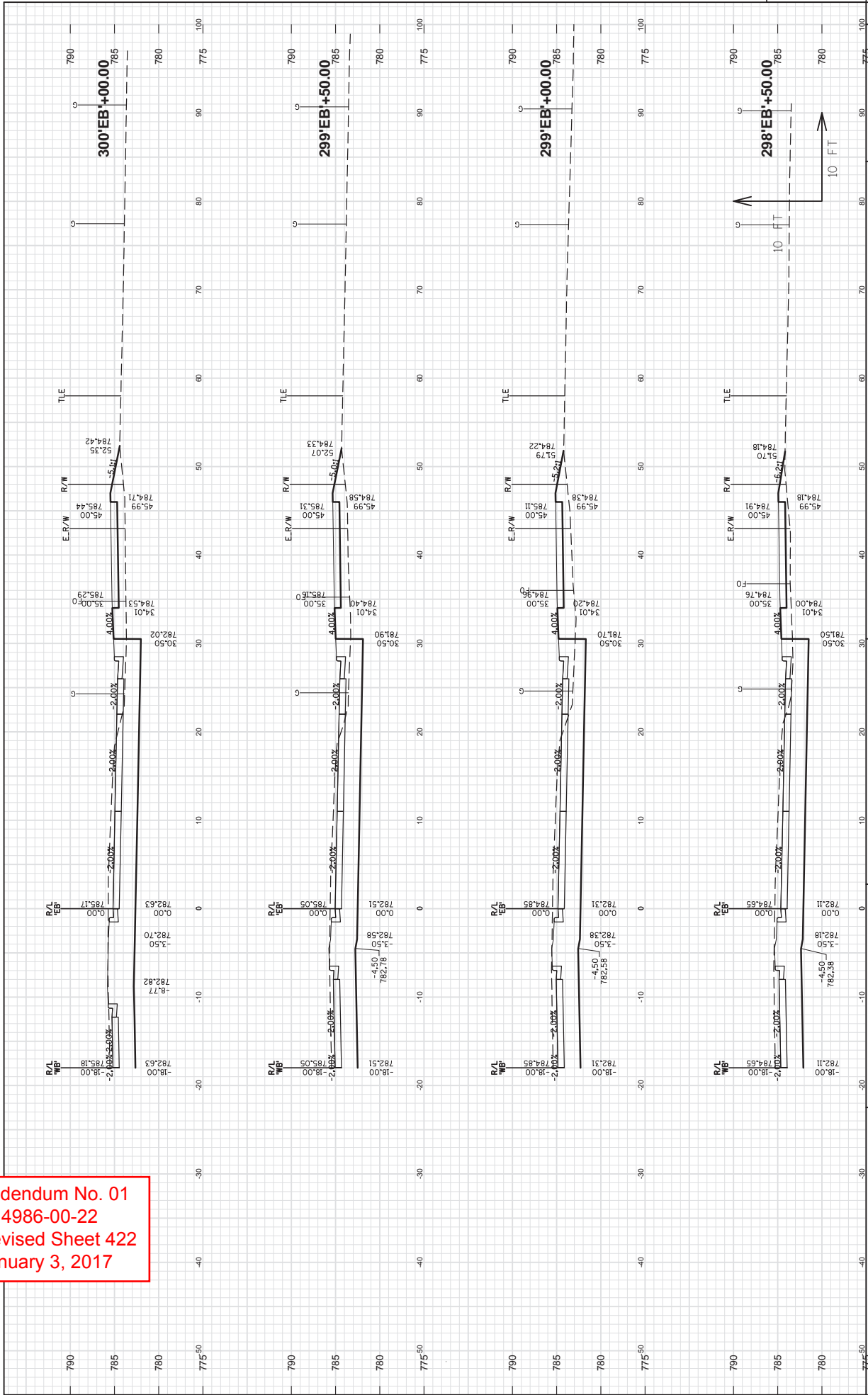

Addendum No. 01  
 ID 4986-00-22  
 Revised Sheet 423  
 January 3, 2017

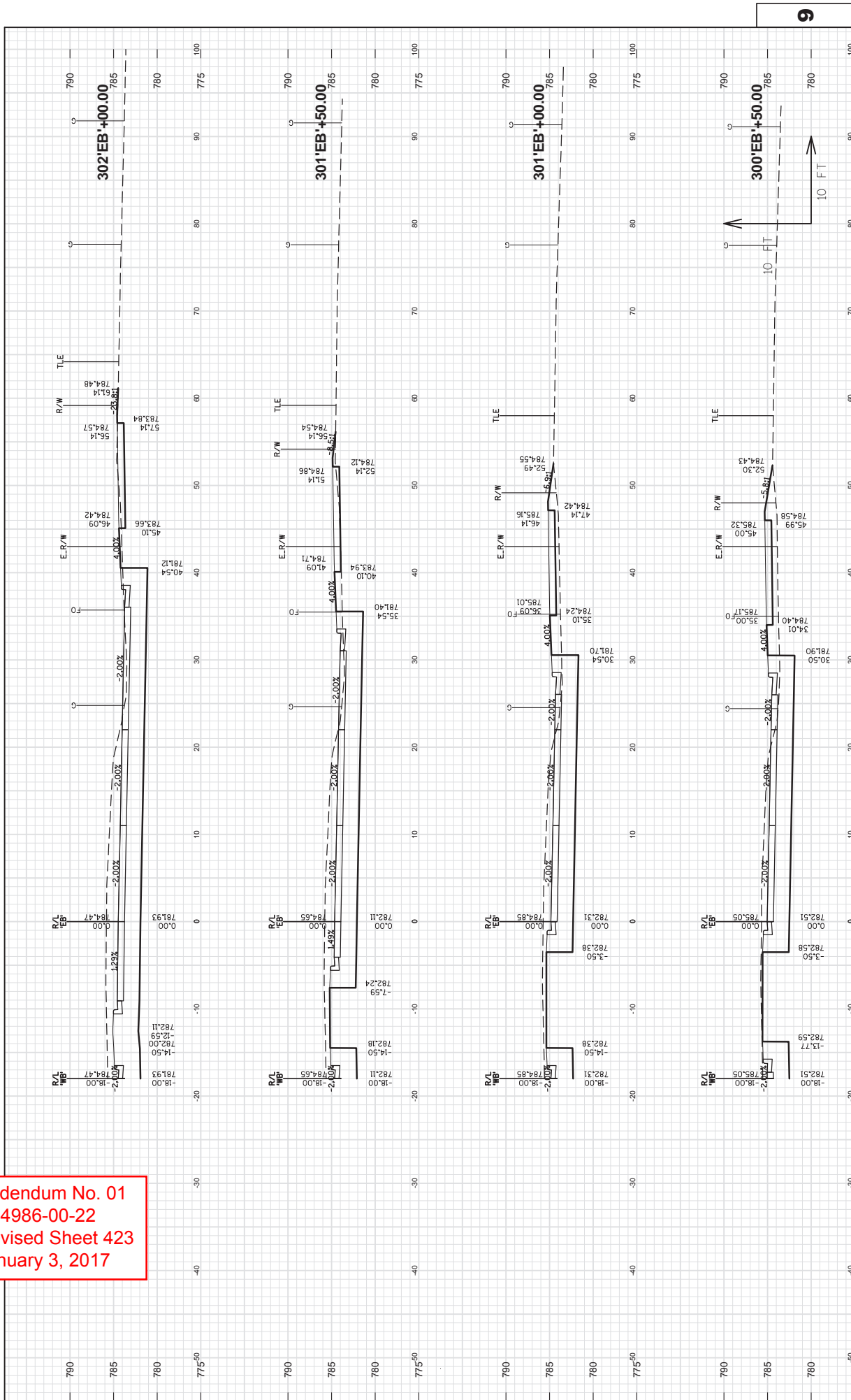

Addendum No. 01  
 ID 4986-00-22  
 Revised Sheet 424  
 January 3, 2017

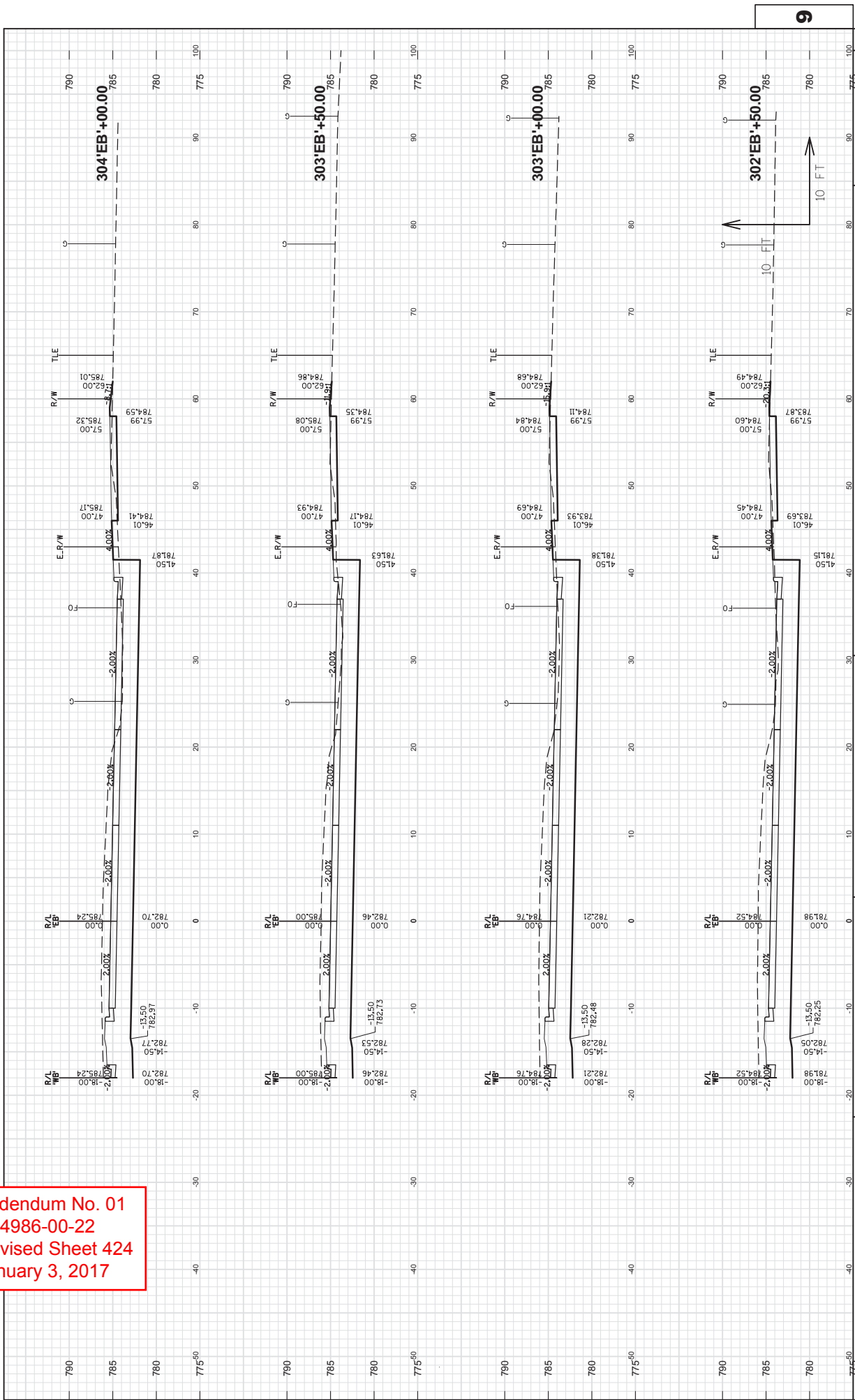

Addendum No. 01  
 ID 4986-00-22  
 Revised Sheet 425  
 January 3, 2017

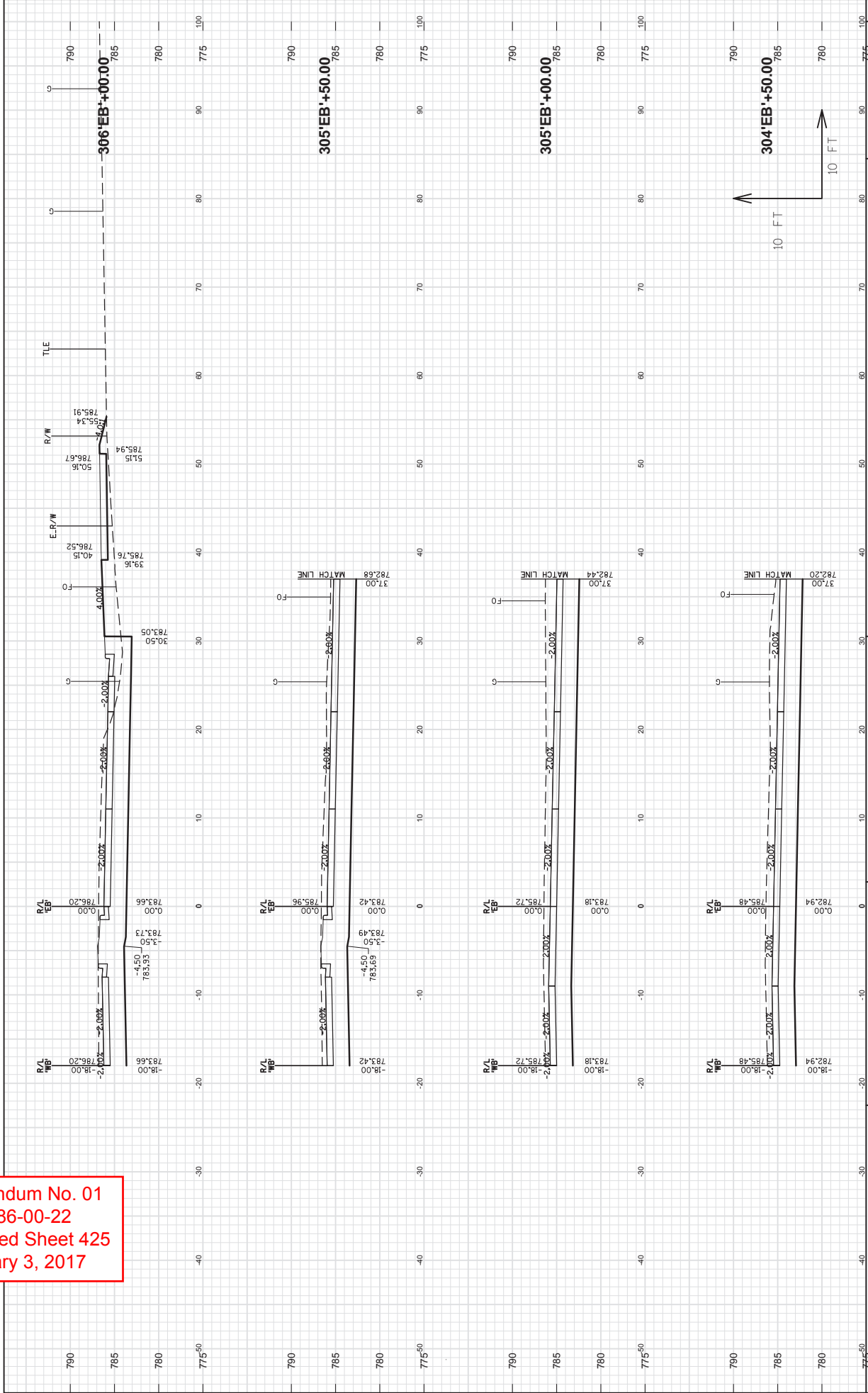

Addendum No. 01  
 ID 4986-00-22  
 Revised Sheet 426  
 January 3, 2017

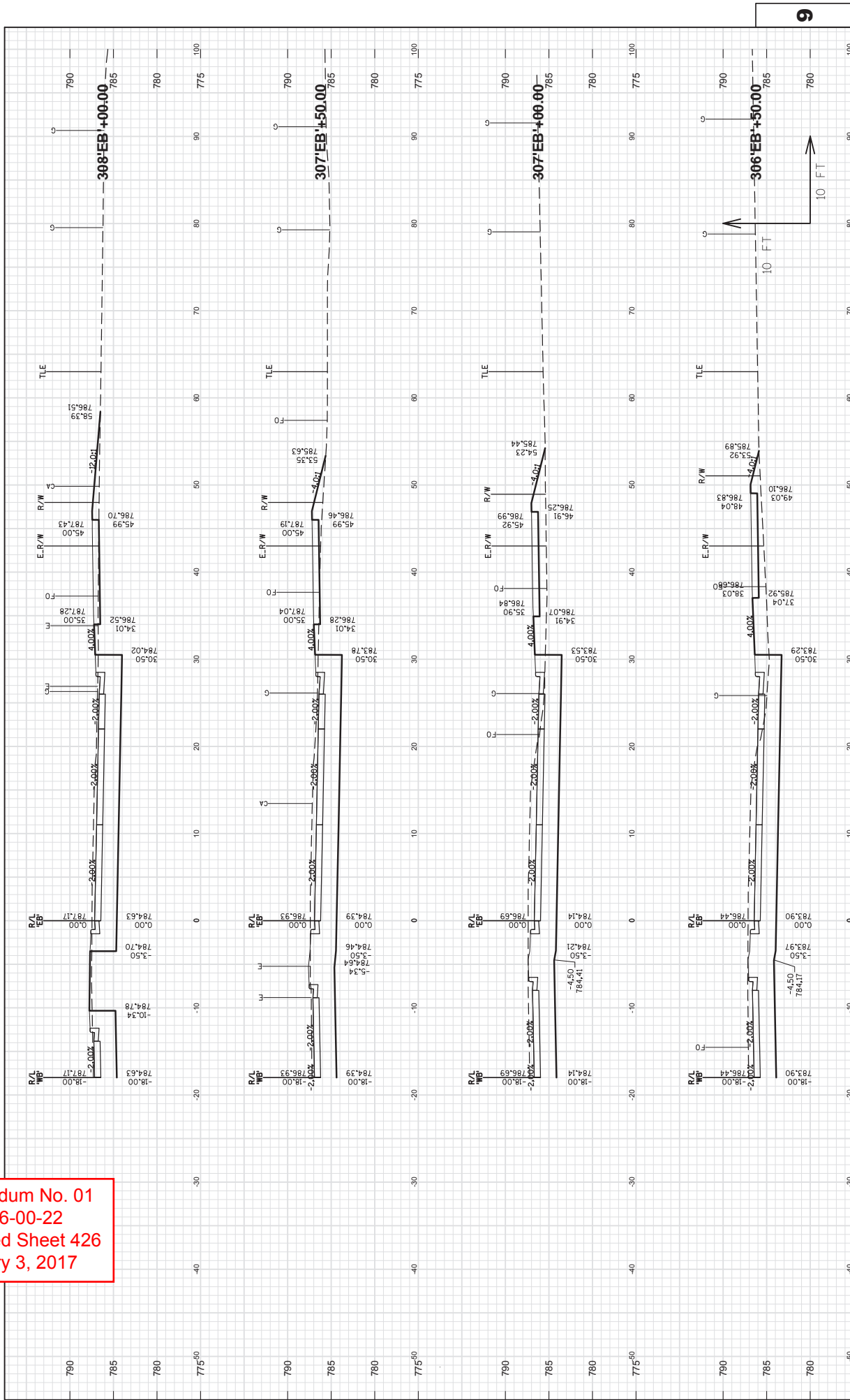

Addendum No. 01  
 ID 4986-00-22  
 Revised Sheet 427  
 January 3, 2017

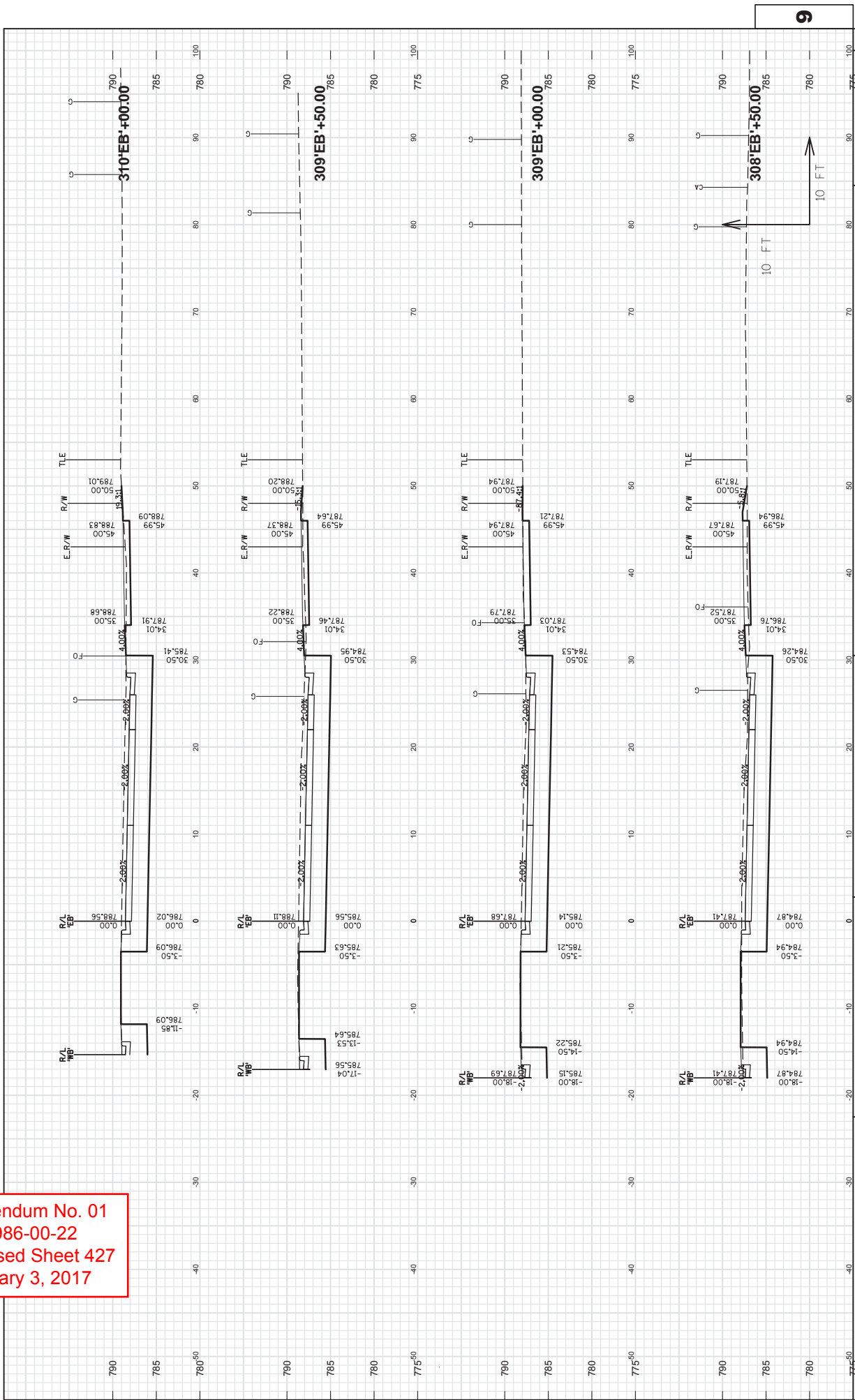



Addendum No. 01  
 ID 4986-00-22  
 Revised Sheet 428  
 January 3, 2017

END PROJECT  
 STA 311'EB'+06.90

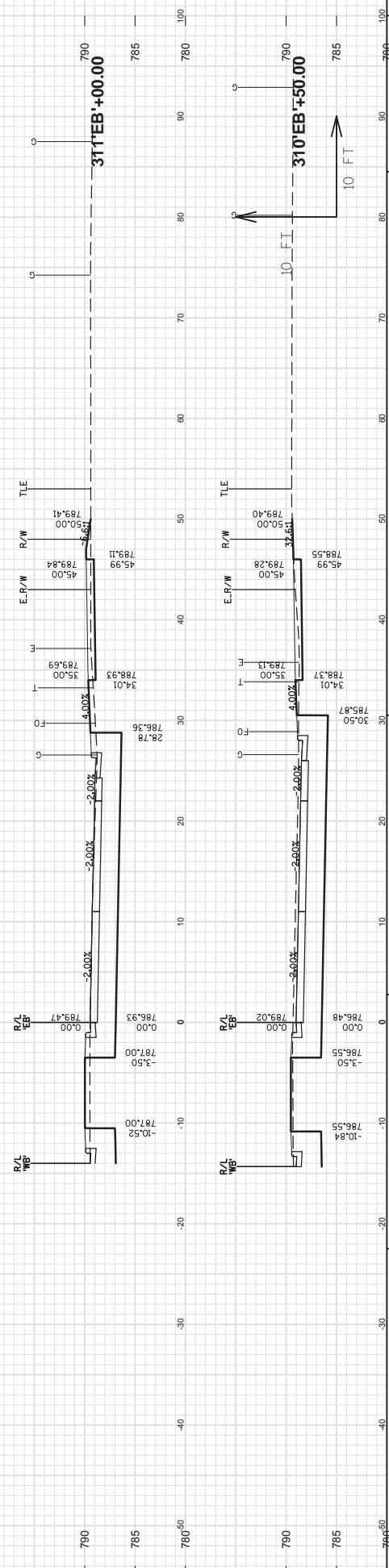

PROJECT NO: 4986-00-22  
 COUNTY: FOND DU LAC  
 HWY: CTH VV  
 CROSS SECTIONS: CTH VV - EB  
 SHEET: 428  
 WISDOT/CADD SHEET 49

9

9

Addendum No. 01  
 ID 4986-00-22  
 Revised Sheet 430  
 January 3, 2017

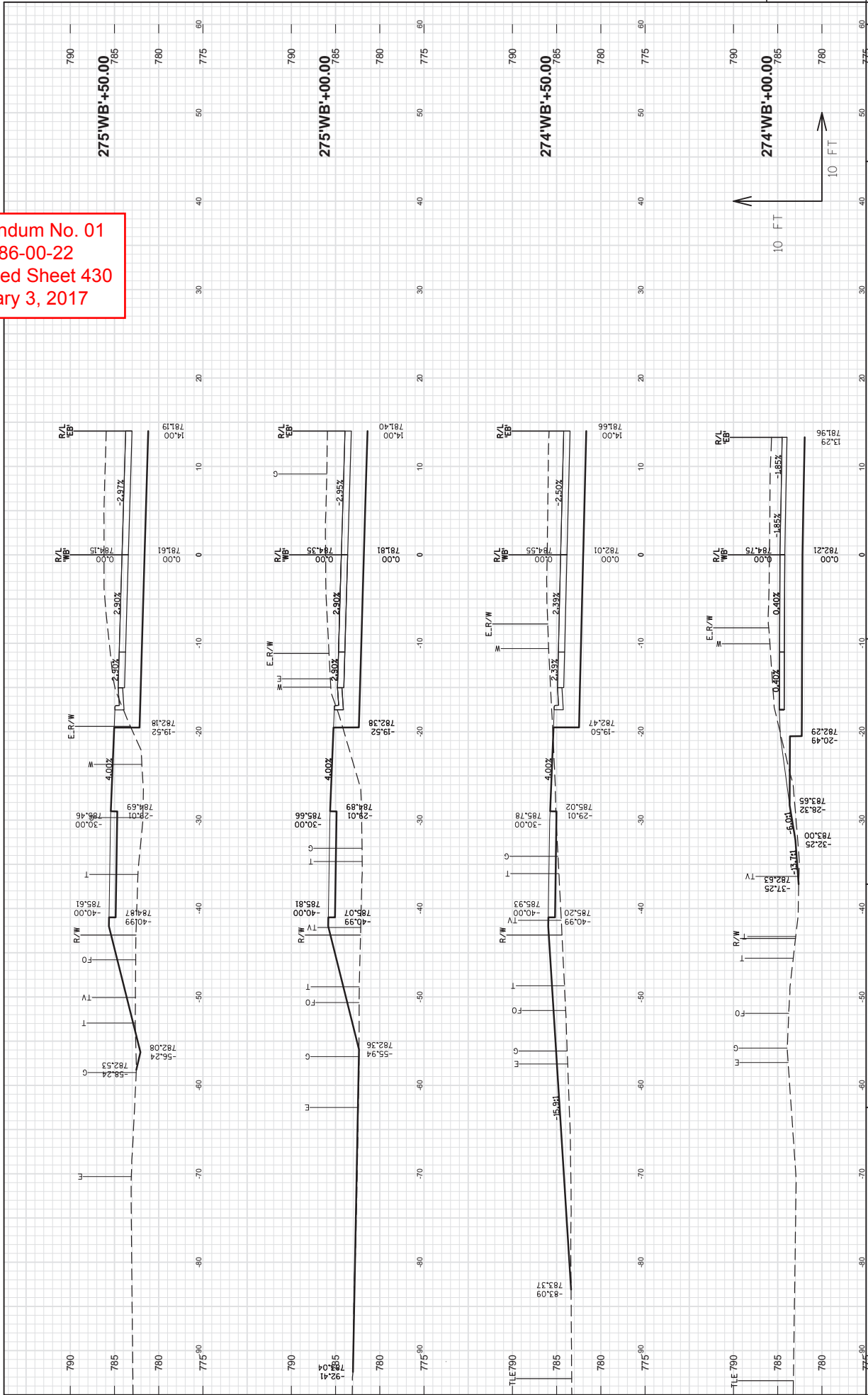



Addendum No. 01  
 ID 4986-00-22  
 Revised Sheet 432  
 January 3, 2017

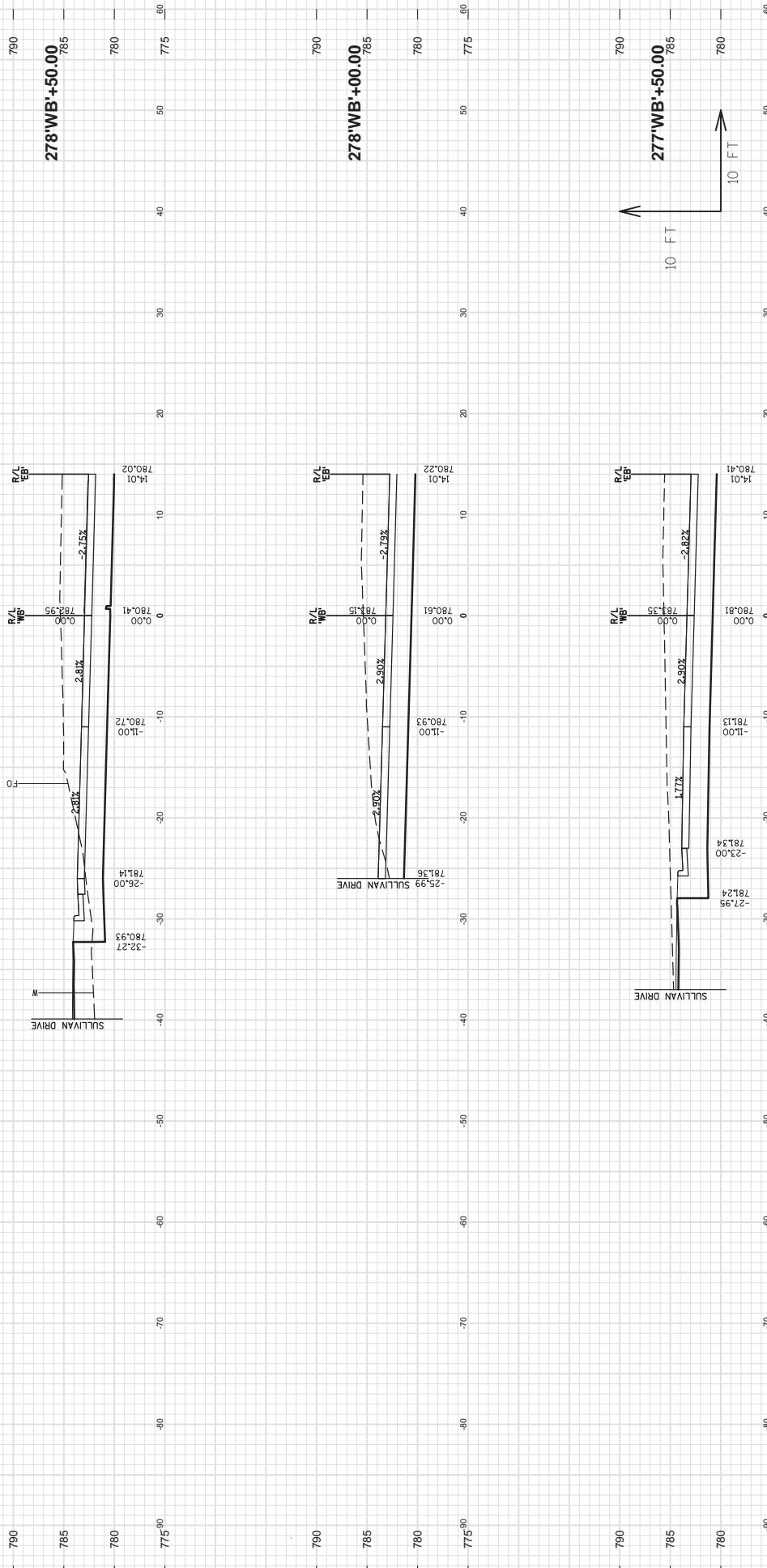

Addendum No. 01  
 ID 4986-00-22  
 Revised Sheet 433  
 January 3, 2017

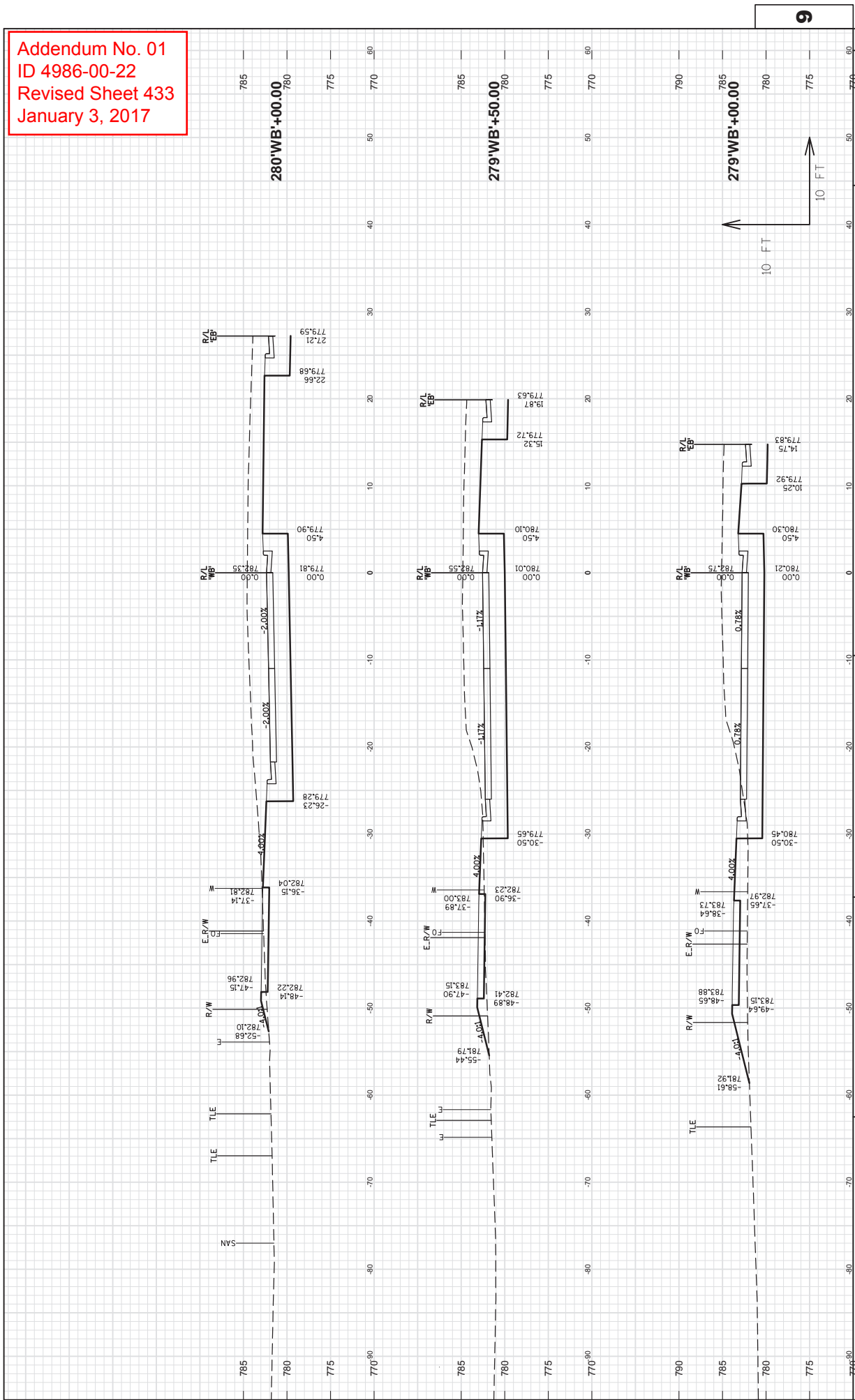

Addendum No. 01  
 ID 4986-00-22  
 Revised Sheet 434  
 January 3, 2017

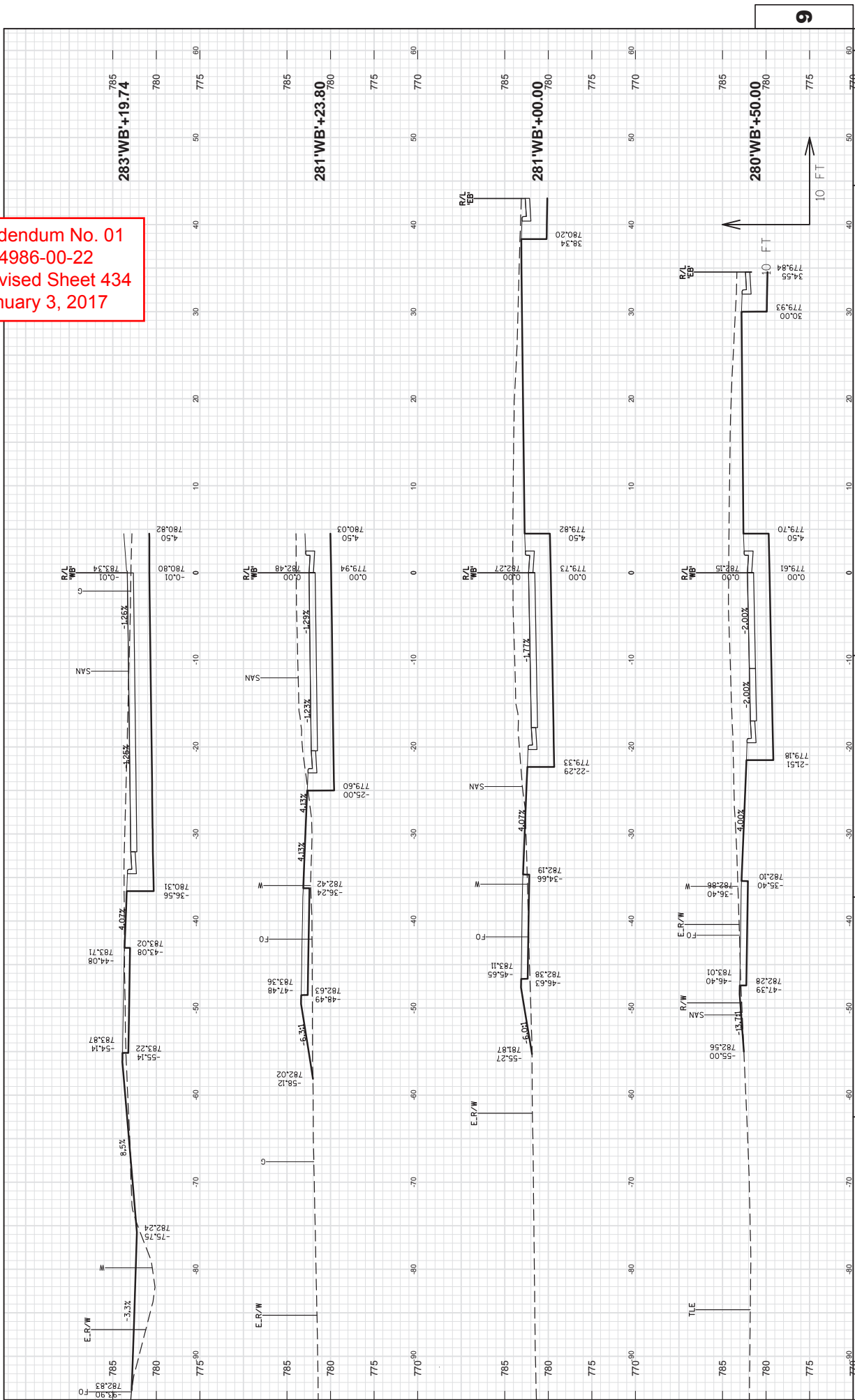

Addendum No. 01  
 ID 4986-00-22  
 Revised Sheet 451  
 January 3, 2017

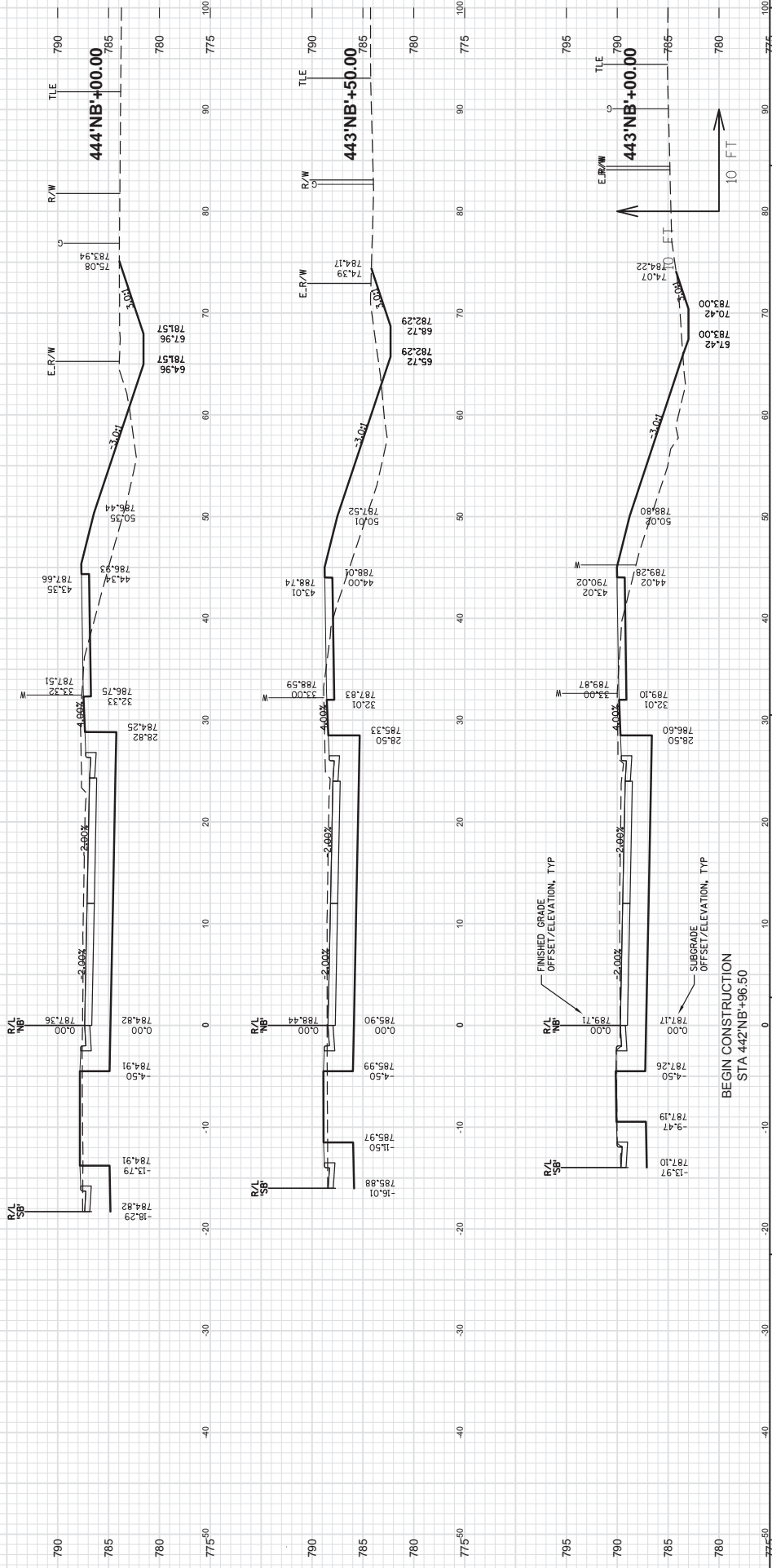

PROJECT NO: 4986-00-22  
 COUNTY: FOND DU LAC  
 HWY: CTH VV  
 CROSS SECTIONS: MILITARY ROAD - NB  
 SHEET: 451  
 FILE NAME: S:\CURRPROJ\FONDUCO\CTH VV - MILITARY TO HECKORY\CIVIL\3D\4986\021\SE\ET\PLAN\4986\022-090101-XS.DWG  
 PLOT DATE: 11/30/2016 1:05 PM  
 PLOT BY: BENJAMIN OITZINGER  
 PLOT NAME: \*\*\*\*\*  
 PLOT SCALE: \*\*\*\*\*  
 WISDOT/CADD SHEET 49

Addendum No. 01  
 ID 4986-00-22  
 Revised Sheet 452  
 January 3, 2017

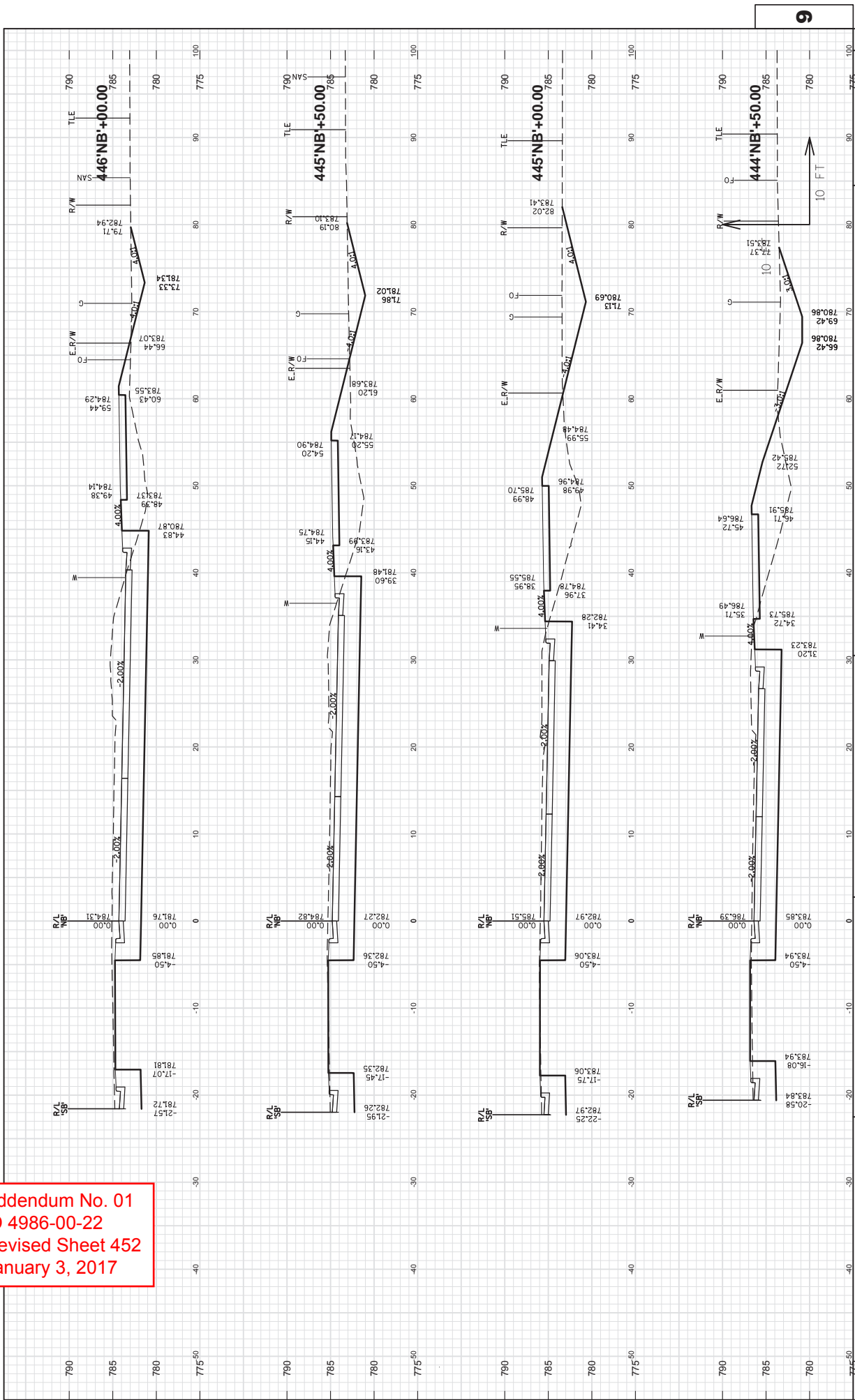



Addendum No. 01  
 ID 4986-00-22  
 Revised Sheet 453  
 January 3, 2017

