



Wisconsin Department of Transportation

March 28, 2017

Division of Transportation Systems Development

Bureau of Project Development
 4802 Sheboygan Avenue, Rm 601
 P O Box 7916
 Madison, WI 53707-7916

Telephone: (608) 266-1631
 Facsimile (FAX): (608) 266-8459

NOTICE TO ALL CONTRACTORS:

Proposal #27: 6663-02-71
Rib Mt Drive (CTH N) Ped Facility
Town of Rib Mountain
Local Street
Marathon County

6999-18-72, WISC 2017 171
T Rib Mountain, Rib Mountain Drive
Morning Glory Lane to Robin Lane
Local Street
Marathon County

6999-18-82, WISC 2017 172
T Rib Mountain, Rib Mountain Drive
Morning Glory Lane to CTH NN
Local Street
Marathon County

Letting of April 11, 2017

This is Addendum No. 01, which provides for the following:

Special Provisions

Added Special Provisions	
Article No.	Description
43	Storm Sewer Pipe Connection, Item SPV.0060.21

Deleted Special Provisions	
Article No.	Description
33	Storm Sewer Pipe Corrugated Polyethylene, 42-Inch, Item SPV.0090.01

Schedule of Items

Revised Bid Item Quantities					
Bid Item	Item Description	Unit	Old Quantity	Revised Quantity	Proposal Total
608.3012	Storm Sewer Pipe Class III-A 12-Inch	LF	151	-24	127
608.3018	Storm Sewer Pipe Class III-A 18-Inch	LF	59	-42	17

Added Bid Item Quantities					
Bid Item	Item Description	Unit	Old Quantity	Revised Quantity	Proposal Total
608.0312	Storm Sewer Pipe Reinforced Concrete Class III 12-Inch	LF	0	24	24
608.0318	Storm Sewer Pipe Reinforced Concrete Class III 18-Inch	LF	0	42	42
608.0342	Storm Sewer Pipe Reinforced Concrete Class III 42-Inch	LF	0	466	466
SPV.0060.21	Storm Sewer Pipe Connection	EACH	0	1	1

Deleted Bid Item Quantities					
Bid Item	Item Description	Unit	Old Quantity	Revised Quantity	Proposal Total
SPV.0090.01	Storm Sewer Pipe Corrugated Polyethylene, 42-Inch	LF	466	-466	0

Plan Sheets

Revised Plan Sheets	
Plan Sheet	Plan Sheet Title (brief description of changes to sheet)
44	Storm Sewer (revised the callout on the profile view of the pipe to say RCP Class III for the runs from 3.0 to 4.0 and from 4.0 to 5.0)
49	Storm Sewer (revised the callout on the profile view of the pipe to say RCP Class III for the runs from 5.0 to 6.0, from 6.0 to 7.0, and from 6.1 to 42" SS; added callout for "Storm Sewer Pipe Connection from 6.1 to 42" SS)
151	Miscellaneous Quantities (revised storm sewer pipe quantities for the described changes on sheets 44 and 49)

The responsibility for notifying potential subcontractors and suppliers of these changes remains with the prime contractor.

Sincerely,

Mike Coleman

Proposal Development Specialist
Proposal Management Section

ADDENDUM NO. 01
6663-02-71, 6999-18-72 & 6999-18-82
March 28, 2017

Special Provisions

33. **DELETED.**

43. **Storm Sewer Pipe Connection, Item SPV.0060.21.**

A Description

This special provision describes sawcutting into the wall of a storm sewer pipe and installing a concrete collar to make a connection.

B Materials

Furnish materials conforming to Section 520.2.4 of the Standard Specifications for the concrete collar attachment.

C Construction

Confirm the location of the connection with the engineer in the field prior to making the sawcut into the 42" pipe. Carefully construct the masonry around the connection to prevent leakage around the outer surfaces.

D Measurement

The department will measure the Storm Sewer Pipe Connection by each acceptably completed.

E Payment

The department will pay for the measured quantity at the contract unit price under the following bid item:

ITEM NUMBER	DESCRIPTION	UNIT
SPV.0060.21	Storm Sewer Pipe Connection	EACH

Payment is full compensation for materials, labor, tools, equipment, and incidentals necessary to complete the work of installing the collar along with sawcutting into the connecting pipe.

Schedule of Items

Attached, dated March 28, 2017, are the revised Schedule of Items Pages 3 and 13 – 15.

Plan Sheets

The following 8½ x 11-inch sheets are attached and made part of the plans for this proposal:
Revised: 44, 49, and 158

END OF ADDENDUM

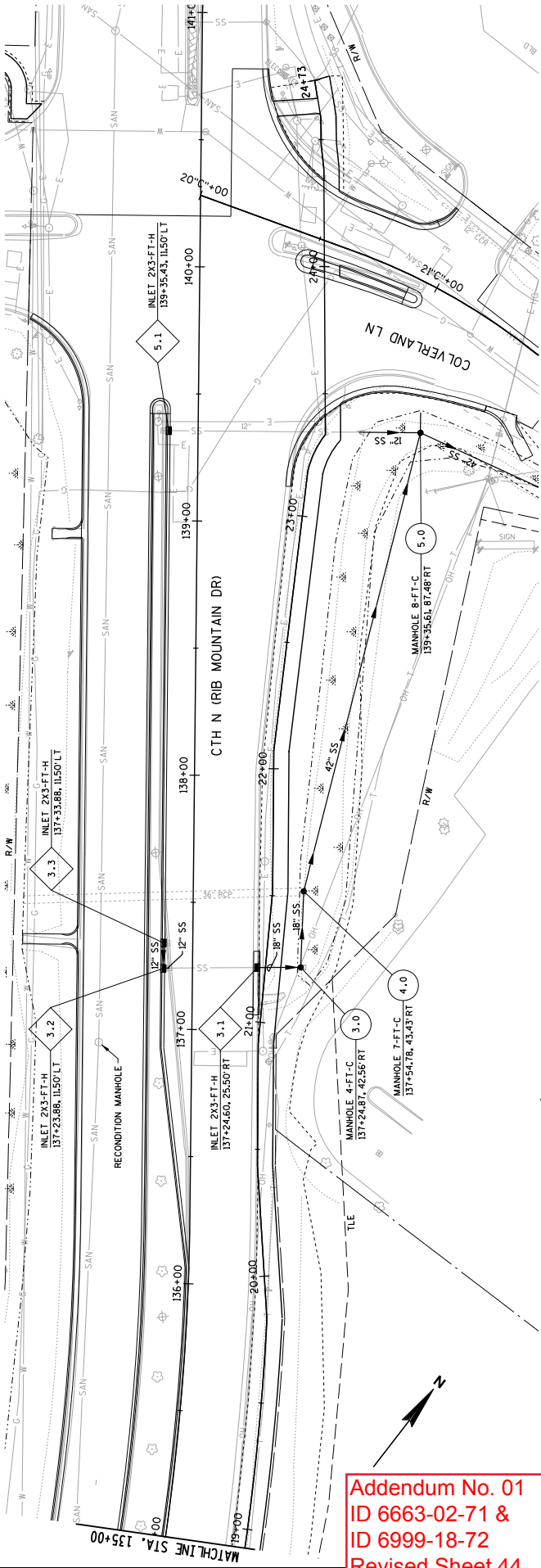

Addendum No. 01
 ID 6663-02-71 &
 ID 6999-18-72
 Revised Sheet 44
 March 28, 2017

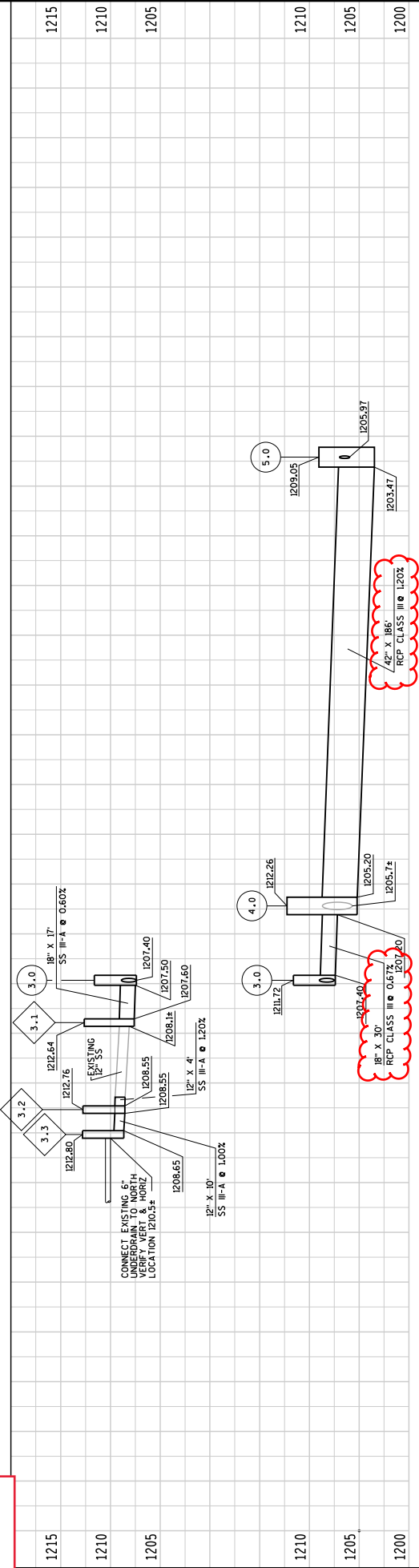

1215	1210	1205	1210	1205	1200
PROJECT NUMBER: 6999-18-72/6663-02-71 HWY: RIB MOUNTAIN DRIVE COUNTY: PORTAGE					
STORM SEWER - RIB MOUNTAIN DRIVE SHEET 44					
E					

FILE NAME: P:\6999-18-72-6663-02-71\6999-18-72\6663-02-71\6999-18-72\6663-02-71.dwg
 PLOT DATE: 3/22/2017
 PLOT TIME: 2:44 PM
 PLOT SCALE: 1/32"=1'

PRINTER DRIVER: S:_user\caddis\lib\eres\MapInfo\MicroStation\Resources\MS Printing\Printer-Driver-ET.PDF.1 x 17.0pt
 PEN TABLE: P:\6999-18-72-6663-02-71\6999-18-72\6663-02-71\6999-18-72\6663-02-71.dwg

BATCH PRINT SHEET 3 OF 8

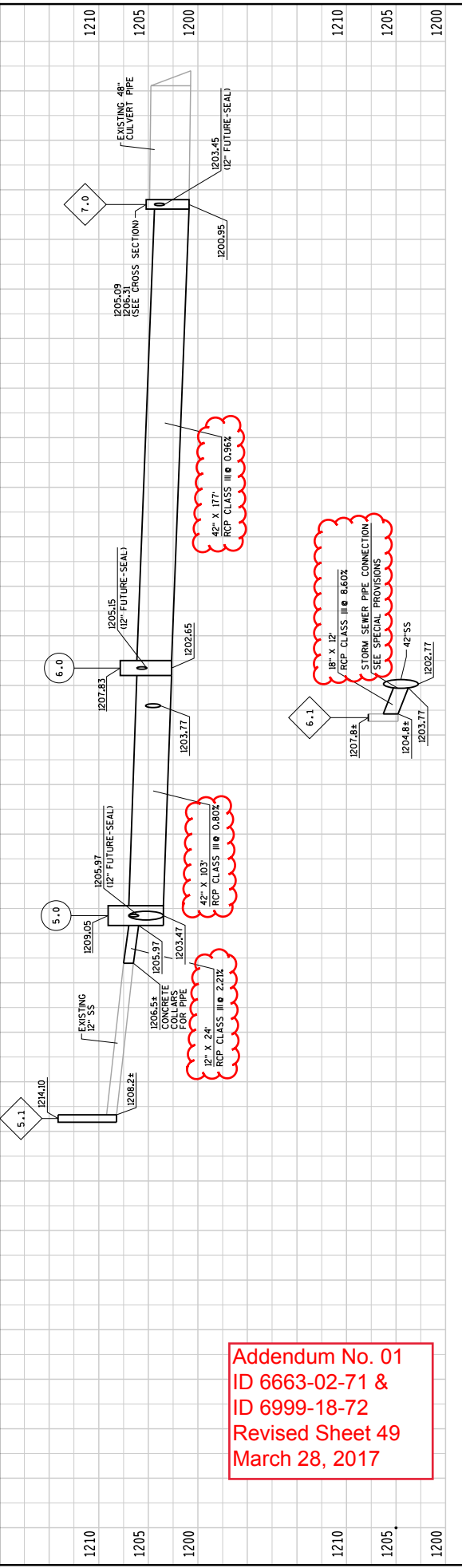
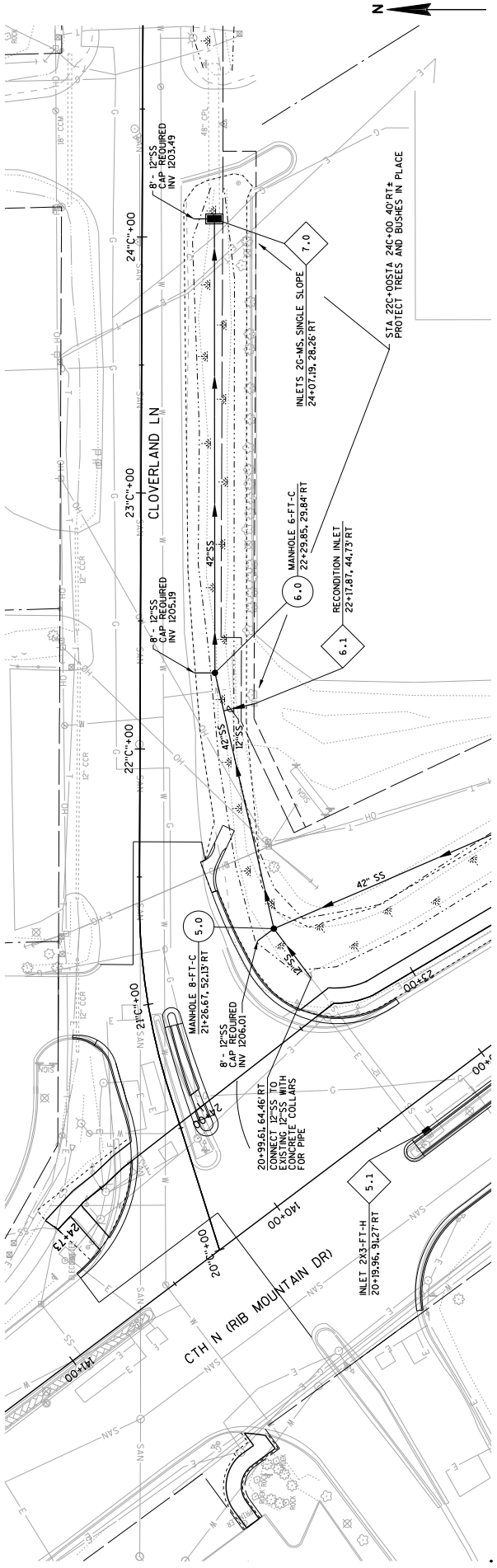

Addendum No. 01
ID 6663-02-71 &
ID 6999-18-72
Revised Sheet 49
March 28, 2017

Addendum No. 01
 ID 6663-02-71 &
 ID 6999-18-72
 Revised Sheet 158
 March 28, 2017

RPRAP

606.0100
 RPRAP
 LIGHT
 CY

645.0130
 GEOTEXTILE
 TYPE
 SY

PROJECT NUMBER	STAGE	STATION	LOCATION	REMARKS
6663-02-71	1A-11/A	125+75 - 125+85	RB MOUNTAIN DR RT	EXISTING CULVERT
		133+00 - 134+02	RB MOUNTAIN DR RT	ASPHALT FLUME
		137+20 - 137+41	RB MOUNTAIN DR RT	ASPHALT FLUME
		138+80 - 139+01	RB MOUNTAIN DR RT	ASPHALT FLUME
		170+38 - 170+54	RB MOUNTAIN DR LT	ASPHALT FLUME
		171+20 - 171+35	RB MOUNTAIN DR LT	ASPHALT FLUME
		21C+58 - 21C+91	CLOVERLAND LN RT	ASPHALT FLUME
PROJECT 6663-02-71 TOTAL				
			19	114

STORM SEWER PIPE

PROJECT NUMBER	STAGE	FROM STRUCTURE NUMBER	TO STRUCTURE NUMBER	INVERT ELEVATION	DISCHARGE ELEVATION	608.0312 STORM SEWER PIPE RCP 12-INCH LF	608.0312 STORM SEWER PIPE CLASS III-A 12-INCH LF	608.3015 STORM SEWER PIPE CLASS III-A 15-INCH LF	608.0318 STORM SEWER PIPE RCP 18-INCH LF	608.3018 STORM SEWER PIPE CLASS III-A 18-INCH LF	608.0342 STORM SEWER PIPE RCP 42-INCH LF	520.8000 CONCRETE COLLARS FOR PIPE EACH	612.0408 PIPE UNDERDRAIN WRAPPED 6-INCH LF	SPV.0060.21 STORM SEWER PIPE CONNECTION EACH
6999-18-72	1A-11/A	EXISTING	1.0	---	---	---	---	---	---	---	---	---	---	---
		3.1	3.0	1207.60	1207.50	---	---	---	---	---	---	---	---	---
		3.0	4.0	1207.40	1207.20	---	---	---	---	---	---	---	---	---
		4.0	5.0	1205.20	1203.47	---	---	---	---	---	---	---	---	---
		8.0	EXISTING	---	---	---	---	---	---	---	---	---	---	---
		11.1	13.0	1214.55	1211.73	---	---	---	---	---	---	---	---	---
		10.1	10.0	1213.06	1211.11	---	---	---	---	---	---	---	---	---
		EXISTING	5.0	1206.94	1205.97	---	---	---	---	---	---	---	---	---
		6.1	42" SS	1204.84	1203.77	24	---	---	---	---	---	---	---	---
		5.0	6.0	1203.47	1202.65	---	---	---	---	---	---	---	---	---
		6.0	7.0	1202.65	1200.95	---	---	---	---	---	---	---	---	---
		5.0	CAP	1206.01	1205.97	---	---	---	---	---	---	---	---	---
		6.0	CAP	1205.19	1205.15	---	---	---	---	---	---	---	---	---
		7.0	CAP	1203.04	1203.00	---	---	---	---	---	---	---	---	---
		UNDISTRIBUTED	---	---	---	24	---	---	---	---	---	---	---	---
		STAGE 1A-11/A SUBTOTAL					94	17	42	17	466	3	65	1
	1B	3.2	EXISTING	1208.65	---	---	---	---	---	---	---	---	---	---
		3.3	3.2	1208.65	1205.65	---	---	---	---	---	---	---	---	---
		2.1	2.0	1210.45	1210.28	---	---	---	---	---	---	---	---	---
		6.0	AEW	---	---	---	---	---	---	---	---	---	---	---
		UNDISTRIBUTED	---	---	---	0	---	---	---	---	---	---	---	---
		STAGE 1B SUBTOTAL					24	127	42	17	466	4	115	1
		PROJECT 6999-18-72 TOTAL					118	247	84	34	932	7	180	2



Proposal Schedule of Items

Proposal ID: 20170411027 Project(s): 6663-02-71, 6999-18-72, 6999-18-82

Federal ID(s): N/A, WISC 2017171, WISC 2017172

SECTION: 0001

Contract Items

Alt Set ID:

Alt Mbr ID:

Proposal Line Number	Item ID Description	Approximate Quantity and Units	Unit Price	Bid Amount
0330	602.0505 Curb Ramp Detectable Warning Field Yellow	458.000 SF	_____.	_____.
0340	606.0100 Riprap Light	19.000 CY	_____.	_____.
0350	608.3012 Storm Sewer Pipe Class III-A 12-Inch	127.000 LF	_____.	_____.
0360	608.3015 Storm Sewer Pipe Class III-A 15-Inch	94.000 LF	_____.	_____.
0370	608.3018 Storm Sewer Pipe Class III-A 18-Inch	17.000 LF	_____.	_____.
0380	611.0530 Manhole Covers Type J	3.000 EACH	_____.	_____.
0390	611.0612 Inlet Covers Type C	4.000 EACH	_____.	_____.
0400	611.0624 Inlet Covers Type H	9.000 EACH	_____.	_____.
0410	611.0642 Inlet Covers Type MS	6.000 EACH	_____.	_____.
0420	611.2004 Manholes 4-FT Diameter	1.000 EACH	_____.	_____.
0430	611.2006 Manholes 6-FT Diameter	1.000 EACH	_____.	_____.
0440	611.2007 Manholes 7-FT Diameter	1.000 EACH	_____.	_____.
0450	611.2008 Manholes 8-FT Diameter	1.000 EACH	_____.	_____.
0460	611.3230 Inlets 2x3-FT	6.000 EACH	_____.	_____.
0470	611.3902 Inlets Median 2 Grate	3.000 EACH	_____.	_____.
0480	612.0406 Pipe Underdrain Wrapped 6-Inch	115.000 LF	_____.	_____.



Proposal Schedule of Items

Proposal ID: 20170411027 Project(s): 6663-02-71, 6999-18-72, 6999-18-82
Federal ID(s): N/A, WISC 2017171, WISC 2017172

SECTION: 0001 Contract Items

Alt Set ID: Alt Mbr ID:

Proposal Line Number	Item ID Description	Approximate Quantity and Units	Unit Price	Bid Amount
1850	SPV.0060 Special 18. Recondition Inlet	12.000 EACH	_____.	_____.
1860	SPV.0060 Special 19. Concrete Bases Type 10 Special, Contractor Supplied Anchor Bolts and Rod Template	3.000 EACH	_____.	_____.
1870	SPV.0060 Special 20. Concrete Bases Type 13 Special, Contractor Supplied Anchor Bolts and Rod Template	2.000 EACH	_____.	_____.
1890	SPV.0105 Special 01. Research and Locate Existing Property Monuments	LS	LUMP SUM	_____.
1900	SPV.0105 Special 02. Verify and Replace Existing Property Monuments	LS	LUMP SUM	_____.
1910	SPV.0105 Special 03. Irrigation System	LS	LUMP SUM	_____.
1920	SPV.0105 Special 04. Remove Traffic Signals Rib Mountain Dr & Morning Glory Ln	LS	LUMP SUM	_____.
1930	SPV.0105 Special 05. Remove Traffic Signals Rib Mountain Dr & Cloverland Ln	LS	LUMP SUM	_____.
1940	SPV.0105 Special 06. Remove Traffic Signals Rib Mountain Dr & Starling Ln	LS	LUMP SUM	_____.
1950	SPV.0105 Special 07. Remove Traffic Signals Rib Mountain Dr & Parrot Ln	LS	LUMP SUM	_____.
1960	SPV.0105 Special 08. Remove Traffic Signals Rib Mountain Dr & Robin Ln	LS	LUMP SUM	_____.
1970	SPV.0105 Special 09. Remove Traffic Signals Rib Mountain Dr & CTH NN	LS	LUMP SUM	_____.
1980	SPV.0105 Special 10. Emergency Vehicle Preemption System Rib Mountain Dr & Morning Glory Ln	LS	LUMP SUM	_____.



Proposal Schedule of Items

Proposal ID: 20170411027 Project(s): 6663-02-71, 6999-18-72, 6999-18-82
Federal ID(s): N/A, WISC 2017171, WISC 2017172

SECTION: 0001 Contract Items

Alt Set ID: Alt Mbr ID:

Proposal Line Number	Item ID Description	Approximate Quantity and Units	Unit Price	Bid Amount
1990	SPV.0105 Special 11. Emergency Vehicle Preemption System Rib Mountain Dr & Cloverland Ln	LS	LUMP SUM	_____.
2000	SPV.0105 Special 12. Emergency Vehicle Preemption System Rib Mountain Dr & Starling Ln	LS	LUMP SUM	_____.
2010	SPV.0105 Special 13. Emergency Vehicle Preemption System Rib Mountain Dr & Parrot Ln	LS	LUMP SUM	_____.
2020	SPV.0105 Special 14. Emergency Vehicle Preemption System Rib Mountain Dr & Robin Ln	LS	LUMP SUM	_____.
2030	SPV.0105 Special 15. Emergency Vehicle Preemption System Rib Mountain Dr & CTH NN	LS	LUMP SUM	_____.
2040	SPV.0105 Special 16. Temporary Non-Intrusive Vehicle Detection System Rib Mt Dr & Morning Glory Ln	LS	LUMP SUM	_____.
2050	SPV.0105 Special 17. Temporary Non-Intrusive Vehicle Detection System Rib Mt Dr & Cloverland Ln	LS	LUMP SUM	_____.
2060	SPV.0105 Special 18. Temporary Non-Intrusive Vehicle Detection System Rib Mt Dr & Robin Ln	LS	LUMP SUM	_____.
2070	SPV.0105 Special 19. Reinstall Salvaged Traffic Signal Equipment Rib Mt Dr & Morning Glory Ln	LS	LUMP SUM	_____.
2080	SPV.0105 Special 20. Reinstall Salvaged Traffic Signal Equipment Rib Mt Dr & Cloverland Ln	LS	LUMP SUM	_____.



Proposal Schedule of Items

Proposal ID: 20170411027 Project(s): 6663-02-71, 6999-18-72, 6999-18-82
 Federal ID(s): N/A, WISC 2017171, WISC 2017172

SECTION: 0001 Contract Items

Alt Set ID: Alt Mbr ID:

Proposal Line Number	Item ID Description	Approximate Quantity and Units	Unit Price	Bid Amount
2090	SPV.0105 Special 21. Reinstall Salvaged Traffic Signal Equipment Rib Mt Dr & Starling Ln	LS	LUMP SUM	_____.
2100	SPV.0105 Special 22. Modify Traffic Signal Cabinet Rib Mountain Dr & Parrot Ln	LS	LUMP SUM	_____.
2110	SPV.0105 Special 23. Modify Traffic Signal Cabinet Rib Mountain Dr & Robin Ln	LS	LUMP SUM	_____.
2120	SPV.0105 Special 24. Modify Traffic Signal Cabinet Rib Mountain Dr & CTH NN	LS	LUMP SUM	_____.
2130	SPV.0180 Special 01. Preparing Topsoil for Lawn Type Turf	5,730.000 SY	_____.	_____.
2140	608.0312 Storm Sewer Pipe Reinforced Concrete Class III 12-Inch	24.000 LF	_____.	_____.
2150	608.0318 Storm Sewer Pipe Reinforced Concrete Class III 18-Inch	42.000 LF	_____.	_____.
2160	608.0342 Storm Sewer Pipe Reinforced Concrete Class III 42-Inch	466.000 LF	_____.	_____.
2170	SPV.0060 Special 21. Storm Sewer Pipe Connection	1.000 EACH	_____.	_____.

Section: 0001 Total: _____.

Total Bid: _____.