

Wisconsin Department of Transportation

Division of Transportation Systems Development

Bureau of Project Development
4802 Sheboygan Avenue, Rm 601
P O Box 7916
Madison, WI 53707-7916

April 26, 2017

NOTICE TO ALL CONTRACTORS:

Telephone: (608) 266-1631
Facsimile (FAX): (608) 266-8459

Proposal #12: 4880-01-71, WISC 2017 269
CTH D (Main Street)
Beech Street – CTH LL
CTH D
Ozaukee County

Letting of May 9, 2017

This is Addendum No. 01, which provides for the following:

Schedule of Items:

Deleted Bid Item Quantities					
Bid Item	Item Description	Unit	Old Quantity	Revised Quantity	Proposal Total
647.0153	Pavement Marking Arrows Paint Type 1	EACH	3	-3	0

Plan Sheets:

Revised Plan Sheets	
Plan Sheet	Plan Sheet Title (brief description of changes to sheet)
93-96	Pavement Marking Plan Removed Pavement Marking Arrows Paint Type 1 (Yellow) from Legend and plan view
117	Miscellaneous Quantities Removed Pavement Marking Arrows Paint Type 1 (Yellow)

Schedule of Items

Attached, dated April 26, 2017, are the revised Schedule of Items Pages 7 and 8.

Plan Sheets

The following 8½ x 11-inch sheets are attached and made part of the plans for this proposal:
Revised: 93, 94, 95, 96 and 117.

The responsibility for notifying potential subcontractors and suppliers of these changes remains with the prime contractor.

Sincerely,

Mike Coleman

Proposal Development Specialist
Proposal Management Section

END OF ADDENDUM

Addendum No. 01
 ID 4880-01-71
 Revised Sheet 93
 April 26, 2017

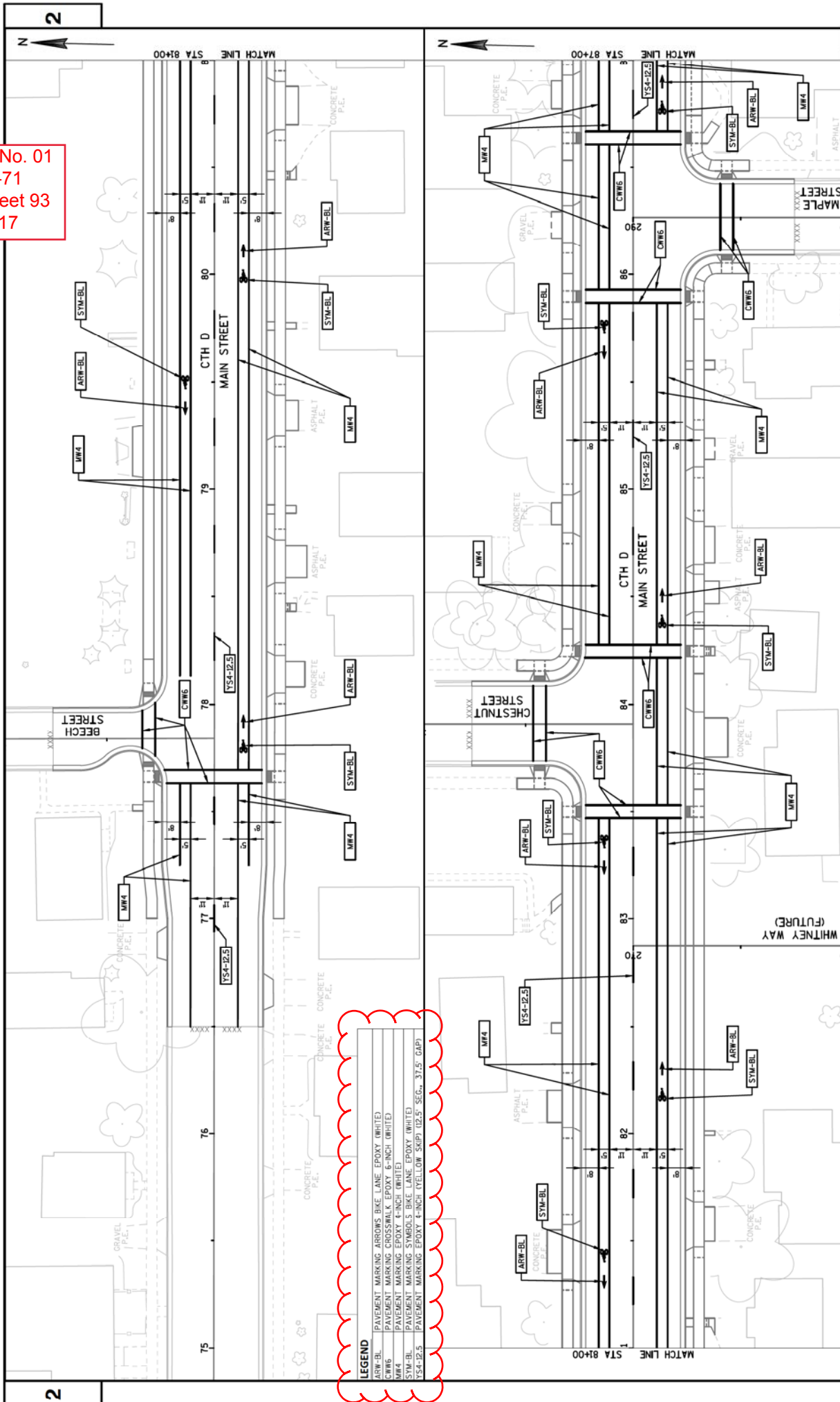

LEGEND

ARW-BL	PAVEMENT MARKING ARROWS BIKE LANE EPOXY (WHITE)
CWN6	PAVEMENT MARKING CROSSWALK EPOXY 6-INCH (WHITE)
MW4	PAVEMENT MARKING EPOXY 4-INCH (WHITE)
SYM-BL	PAVEMENT MARKING SYMBOLS BIKE LANE EPOXY (WHITE)
YS4-12.5	PAVEMENT MARKING EPOXY 4-INCH (YELLOW SKIP) (12.5' SEC., 37.5' GAP)

Addendum No. 01
 ID 4880-01-71
 Revised Sheet 94
 April 26, 2017

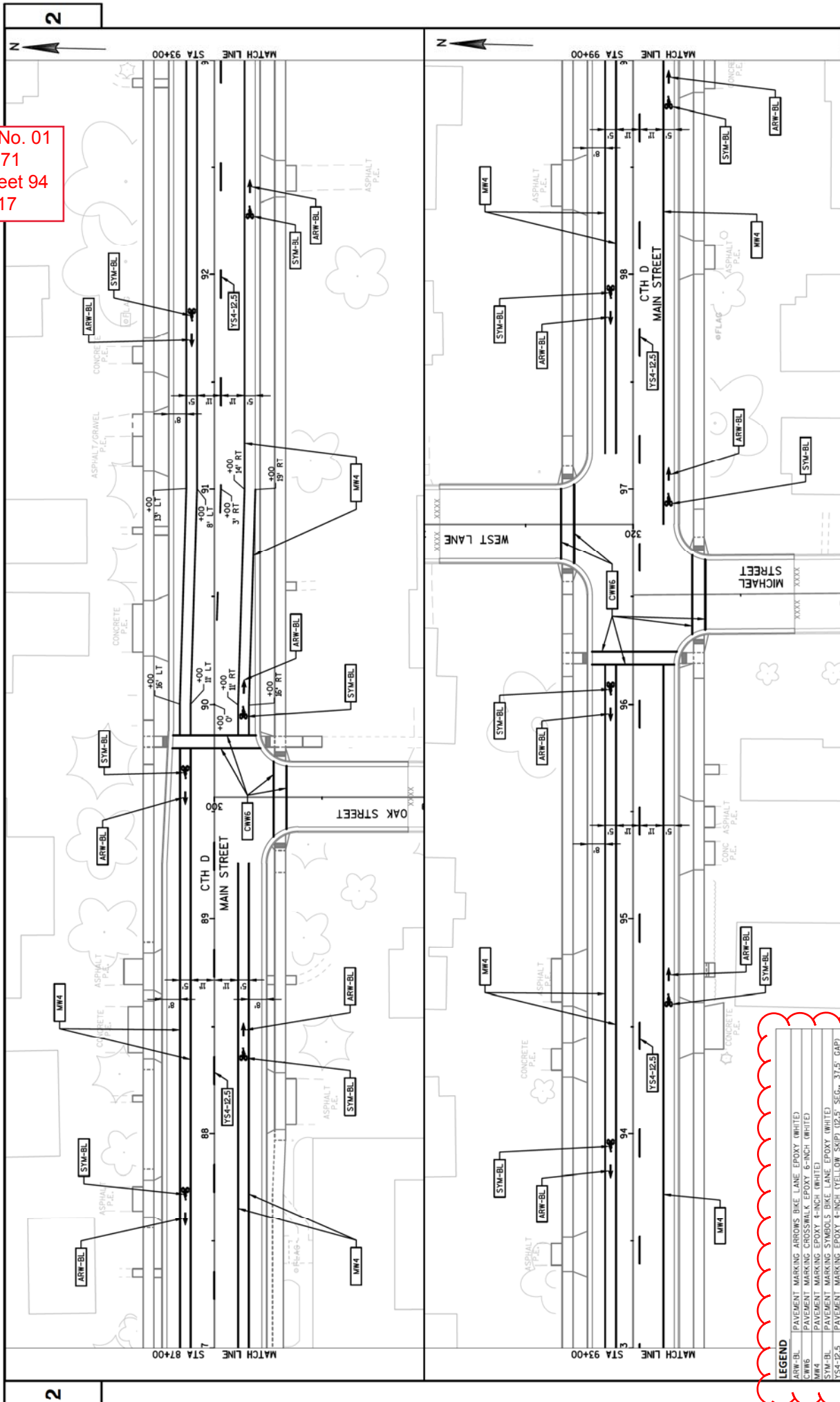

LEGEND

ARW-BL	PAVEMENT MARKING ARROWS BIKE LANE EPOXY (WHITE)
CW6	PAVEMENT MARKING CROSSWALK EPOXY 6-INCH (WHITE)
MW4	PAVEMENT MARKING EPOXY 4-INCH (WHITE)
SYM-BL	PAVEMENT MARKING SYMBOLS BIKE LANE EPOXY (WHITE)
YS4-B2.5	PAVEMENT MARKING EPOXY 4-INCH (YELLOW SKIP) 02.5' SEC., 37.5' GAP

PROJECT NO: 4880-01-71
HWY: CTH D
COUNTY: OZAUKEE
PAVEMENT MARKING PLAN: CTH D
SHEET 94
WISDOT/CADD SHEET 42

DATE: 4/21/2017 1:26 PM
 PLOT BY: ARON SARALER
 PLOT NAME: *****
 PLOT SCALE: *****

Addendum No. 01
 ID 4880-01-71
 Revised Sheet 95
 April 26, 2017

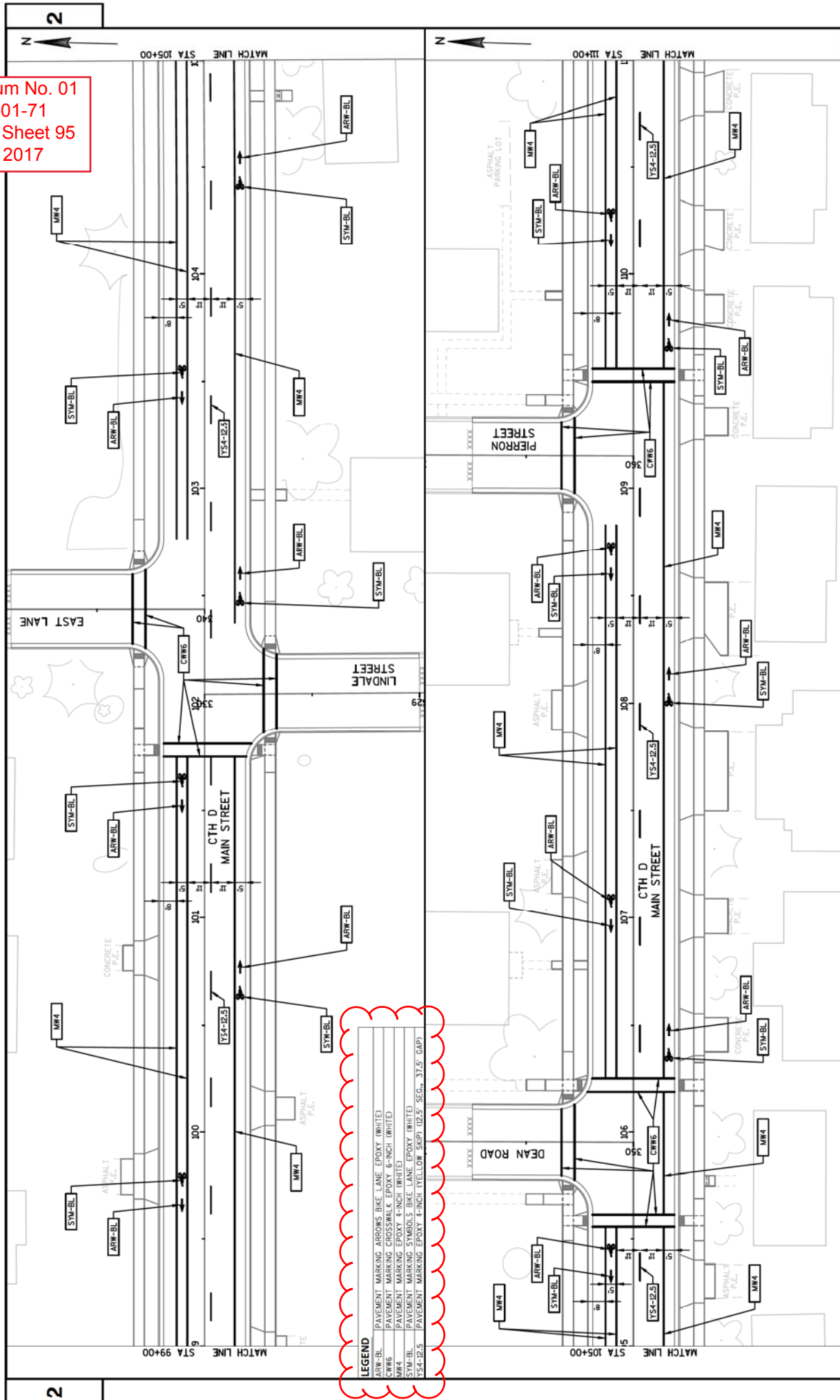

LEGEND	
ARW-BL	PAVEMENT MARKING ARROWS BIKE LANE EPOXY (WHITE)
CW6	PAVEMENT MARKING CROSSWALK EPOXY 6-INCH (WHITE)
MW4	PAVEMENT MARKING SYMBOLS BIKE LANE EPOXY (WHITE)
SYM-BL	PAVEMENT MARKING SYMBOLS BIKE LANE EPOXY (WHITE)
YS4-12.5	PAVEMENT MARKING EPOXY 4-INCH (YELLOW SKIP) (12.5' SEC., 37.5' GAP)

Addendum No. 01
 ID 4880-01-71
 Revised Sheet 96
 April 26, 2017

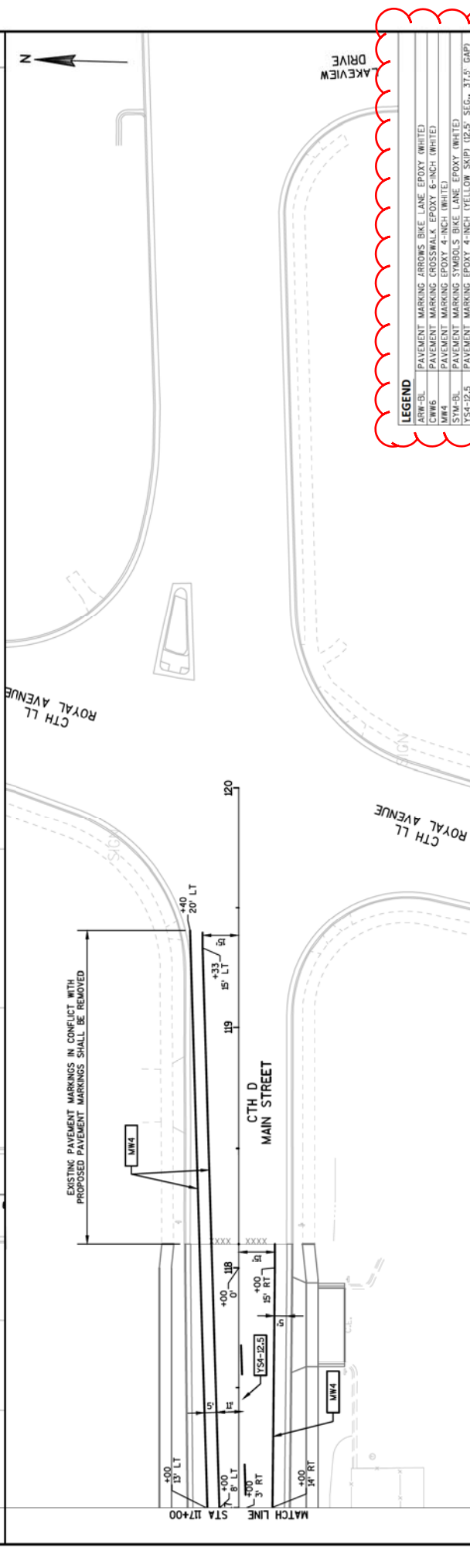
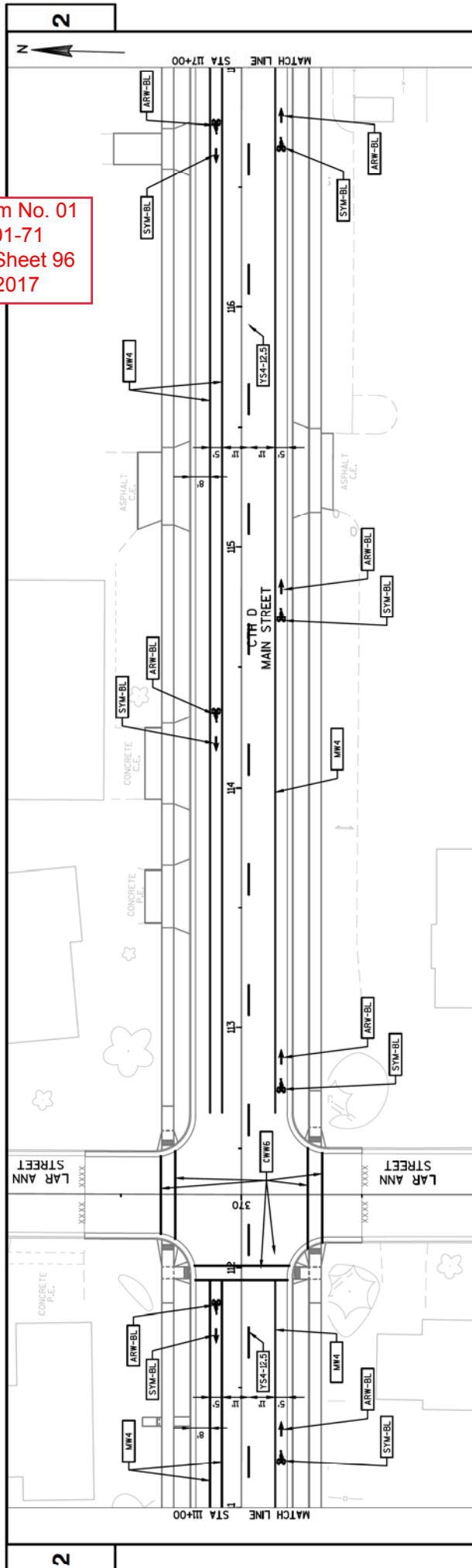

LEGEND	
ARW-BL	PAVEMENT MARKING ARROWS BIKE LANE EPOXY (WHITE)
CW6	PAVEMENT MARKING CROSSWALK EPOXY 6-INCH (WHITE)
MW4	PAVEMENT MARKING EPOXY 4-INCH (WHITE)
SYM-BL	PAVEMENT MARKING SYMBOLS BIKE LANE EPOXY (WHITE)
YSA-12.5	PAVEMENT MARKING EPOXY 4-INCH (YELLOW SKIP) 12.5" SEG., 37.5" GAP

PROJECT NO: 4880-01-71 HWY: CTH D COUNTY: OZAUKEE PAVEMENT MARKING PLAN: CTH D SHEET 96

FILE NAME : S:\OZAUKEE\OZAUKEE\CH1\DAC1V1L30V48800100\SHEETSP\AN_48800100-024501-FM.DWG PLOT BY : AARON SARALEY PLOT DATE : 4/21/2017 1:26 PM

LAYOUT NAME : 48800100-024501-FM - SHEET-04

Addendum No. 01
ID 4880-01-71
Revised Sheet 117
April 26, 2017

TEMPORARY PEDESTRIAN ACCOMMODATION ITEMS

Table with columns for item codes (e.g., 644.1430.S, 644.1601.S), descriptions (e.g., TEMPORARY SURFACE PLATE, TEMPORARY CURB RAMP), and quantities (SF, LF). Includes a summary row: TOTALS 2,875.0 32.0 1,210.0 1,195.0 256.0

TRAFFIC CONTROL ITEMS

Table with columns for item codes (e.g., 643.0410, 643.0420), descriptions (e.g., TRAFFIC CONTROL BARRICADES TYPE II), and quantities (NO., REQD., DAY). Includes a summary row: TOTALS 12 1,812 38 5,738 88 13,288 52 7,852 30.99 166 25,066

CONSTRUCTION STAKING ITEMS

Table with columns for item codes (e.g., 650.4500, 650.5000), descriptions (e.g., CONSTRUCTION STAKING SUBGRADE, CONSTRUCTION STAKING BASE), and quantities (LF, LS). Includes a summary row: TOTALS 5,095 5,095 1 5,095 1

PAVEMENT MARKING ITEMS

Table with columns for item codes (e.g., 646.0106, 647.0206), descriptions (e.g., PAVEMENT MARKING EPOXY ARROWS BIKE LANE), and quantities (LF, LF). Includes a summary row: TOTALS 13,450 41 41 1,790

STREET SWEEPING

Table with columns for location (e.g., CTH D, BEECH STREET), category/code (e.g., SPV.0075.001), and quantity (HRS). Includes a summary row: TOTAL 43

STAKING ITEMS FOR STORM SEWER, CURB & GUTTER, AND ELECTRICAL INSTALLATIONS SHOWN ELSEWHERE



Proposal Schedule of Items

Proposal ID: 20170509012 Project(s): 4880-01-71

Federal ID(s): WISC 2017269

SECTION: 0001 Contract Items

Alt Set ID: Alt Mbr ID:

Proposal Line Number	Item ID Description	Approximate Quantity and Units	Unit Price	Bid Amount
0940	643.0900 Traffic Control Signs	7,852.000 DAY	_____.	_____.
0950	643.1000 Traffic Control Signs Fixed Message	30.990 SF	_____.	_____.
0960	643.2000 Traffic Control Detour (project) 001. 4880-01-71	1.000 EACH	_____.	_____.
0970	643.3000 Traffic Control Detour Signs	25,066.000 DAY	_____.	_____.
0980	644.1430.S Temporary Pedestrian Surface Plate	2,875.000 SF	_____.	_____.
0990	644.1601.S Temporary Curb Ramp	32.000 EACH	_____.	_____.
1000	644.1616.S Temporary Pedestrian Safety Fence	1,210.000 LF	_____.	_____.
1010	646.0106 Pavement Marking Epoxy 4-Inch	13,450.000 LF	_____.	_____.
1030	647.0206 Pavement Marking Arrows Bike Lane Epoxy	41.000 EACH	_____.	_____.
1040	647.0306 Pavement Marking Symbols Bike Lane Epoxy	41.000 EACH	_____.	_____.
1050	647.0766 Pavement Marking Crosswalk Epoxy 6- Inch	1,790.000 LF	_____.	_____.
1060	649.0600 Temporary Pavement Marking Removable Tape 6-Inch	1,195.000 LF	_____.	_____.
1070	650.4000 Construction Staking Storm Sewer	87.000 EACH	_____.	_____.
1080	650.4500 Construction Staking Subgrade	5,095.000 LF	_____.	_____.
1090	650.5000 Construction Staking Base	5,095.000 LF	_____.	_____.



Proposal Schedule of Items

Proposal ID: 20170509012 Project(s): 4880-01-71

Federal ID(s): WISC 2017269

SECTION: 0001 Contract Items

Alt Set ID: Alt Mbr ID:

Proposal Line Number	Item ID Description	Approximate Quantity and Units	Unit Price	Bid Amount
1100	650.5500 Construction Staking Curb Gutter and Curb & Gutter	9,100.000 LF	_____.	_____.
1110	650.8500 Construction Staking Electrical Installations (project) 001. 4880-01-71	LS	LUMP SUM	_____.
1120	650.9910 Construction Staking Supplemental Control (project) 001. 4880-01-71	LS	LUMP SUM	_____.
1130	650.9920 Construction Staking Slope Stakes	5,095.000 LF	_____.	_____.
1140	652.0225 Conduit Rigid Nonmetallic Schedule 40 2-Inch	8,995.000 LF	_____.	_____.
1150	654.0230 Concrete Control Cabinet Bases Type L30	1.000 EACH	_____.	_____.
1160	655.0610 Electrical Wire Lighting 12 AWG	3,969.000 LF	_____.	_____.
1170	655.0615 Electrical Wire Lighting 10 AWG	25,469.000 LF	_____.	_____.
1180	655.0625 Electrical Wire Lighting 6 AWG	42,181.000 LF	_____.	_____.
1190	656.0200 Electrical Service Meter Breaker Pedestal (location) 001. CB 100	LS	LUMP SUM	_____.
1200	659.2130 Lighting Control Cabinets 120/240 30-Inch	1.000 EACH	_____.	_____.
1210	690.0150 Sawing Asphalt	780.000 LF	_____.	_____.
1220	690.0250 Sawing Concrete	850.000 LF	_____.	_____.
1230	ASP.1T0A On-the-Job Training Apprentice at \$5.00/HR	1,500.000 HRS	5.00000	7,500.00