



Wisconsin Department of Transportation

July 6, 2017

Division of Transportation Systems Development

Bureau of Project Development
4802 Sheboygan Avenue, Rm 601
P O Box 7916
Madison, WI 53707-7916

Telephone: (608) 266-1631
Facsimile (FAX): (608) 266-8459

NOTICE TO ALL CONTRACTORS:

Proposal #17: 1000-08-81
NW Region, Var Sgnlized Intersections
Var Hwy & Location/Sgnl Head per Ln
Var Hwy
Chippewa, Dunn, & Eau Claire Counties

3700-50-26
Eau Claire – Chippewa Falls
IH 94 to STH 93 (USH 53 South Sect)
USH 53
Eau Claire County

3700-50-27
Eau Claire, STH 93
Golf Road Intersection
STH 93
Eau Claire County

Letting of July 11, 2017

This is Addendum No. 01, which provides for the following:

Schedule of Items

Revised Bid Item Quantities					
Bid Item	Item Description	Unit	Old Quantity	Revised Quantity	Proposal Total
634.0616	Posts Wood 4X6-Inch X 16-FT	Each	4	4	8
637.2210	Signs Type II Reflective H	S.F.	484.5	48	532.5
646.0600	Removing Pavement Markings	LF	280	60	340
647.0156	Pavement Marking Arrows Epoxy Type I	Each	3	8	11

Added Bid Item Quantities					
Bid Item	Item Description	Unit	Old Quantity	Revised Quantity	Proposal Total
647.0166	Pavement Marking Arrows Epoxy Type II	Each	0	6	6

Plan Sheets

Revised Plan Sheets	
Plan Sheet	Plan Sheet Title (brief description of changes to sheet)
51	Permanent Signing and Pavement Marking – STH 93 & Golf Road (Added lane designation arrows on Golf Road, Removed dashed Left-Turn pavement markings, and added W23-2 and R3-8-V signs on Golf Road)
163	Updated Quantities – 634.0616, 637.2210, 646.0600, 647.0156 Added Quantity – 647.0166

Added Plan Sheets	
Plan Sheet	Plan Sheet Title (brief description of why sheet was added)
257A	Sign Plate R3-8V
263A	Sign Plate W23-2

Schedule of Items

Attached, dated July 6, 2017, are the revised Schedule of Items Pages 2, 3, and 13.

Plan Sheets

The following 8½ x 11-inch sheets are attached and made part of the plans for this proposal:

Revised: 51 and 163

Added: 257A and 263A

The responsibility for notifying potential subcontractors and suppliers of these changes remains with the prime contractor.

Sincerely,

Mike Coleman

Proposal Development Specialist

Proposal Management Section

END OF ADDENDUM



Addendum No. 01
ID 3700-50-27
Revised Sheet 51
July 6, 2017

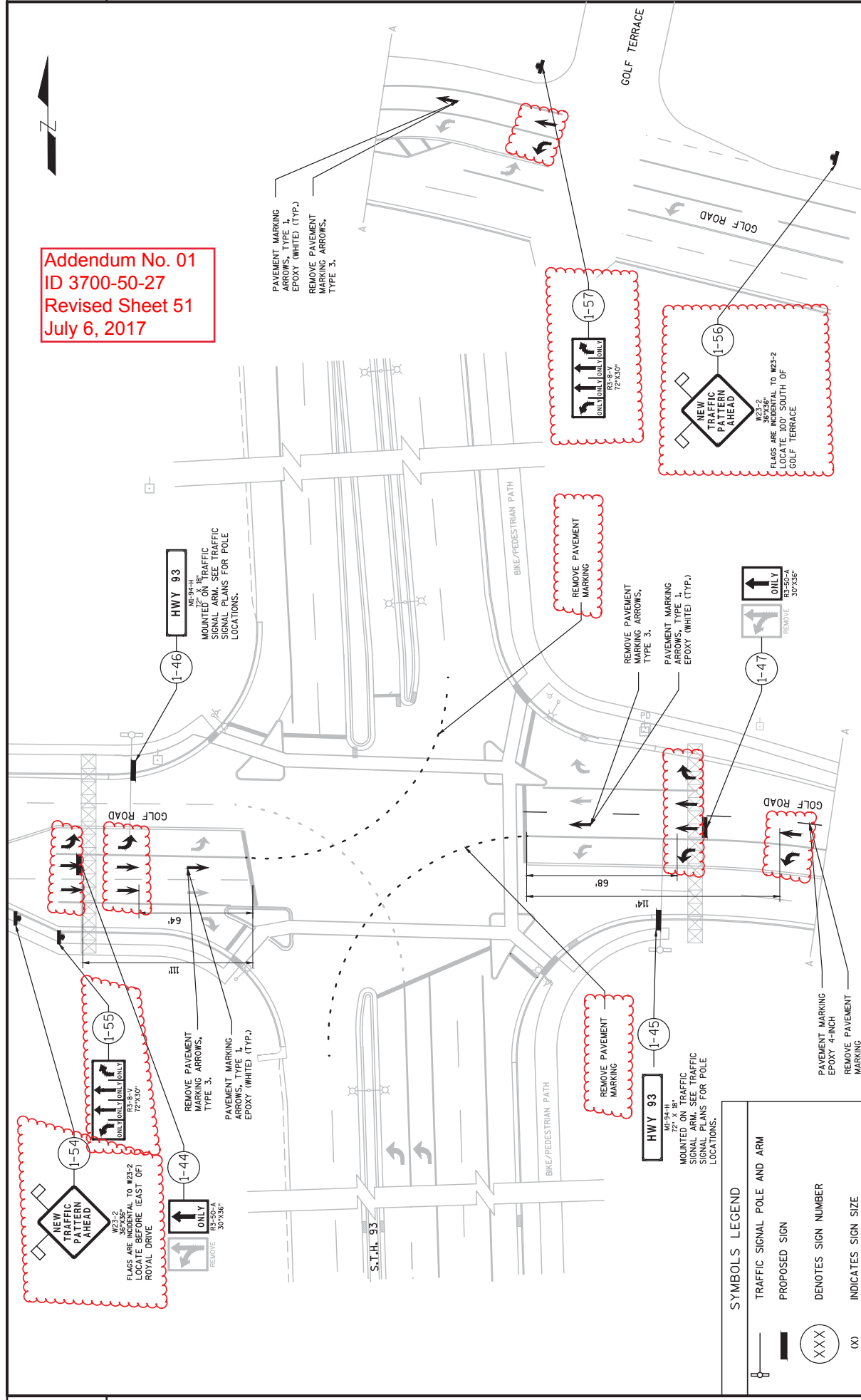

PAVEMENT MARKING ARROWS, TYPE 1, EPOXY (WHITE) (TYP.)
 REMOVE PAVEMENT MARKING ARROWS, TYPE 3.

REMOVE PAVEMENT MARKING ARROWS, TYPE 3.

PAVEMENT MARKING ARROWS, TYPE 1, EPOXY (WHITE) (TYP.)

REMOVE PAVEMENT MARKING ARROWS, TYPE 3.

REMOVE PAVEMENT MARKING ARROWS, TYPE 3.

PAVEMENT MARKING ARROWS, TYPE 1, EPOXY (WHITE) (TYP.)

REMOVE PAVEMENT MARKING

REMOVE PAVEMENT MARKING

PAVEMENT MARKING EPOXY 4-INCH REMOVE PAVEMENT MARKING

SYMBOLS LEGEND

	TRAFFIC SIGNAL POLE AND ARM
	PROPOSED SIGN
	DENOTES SIGN NUMBER
	INDICATES SIGN SIZE

Addendum No. 01
ID 3700-50-26
Revised Sheet 163
July 6, 2017

PERMANENT SIGNING-CONTINUED

LOCATION	SIGN ID	ID	634.0616 POSTS WOOD 4X6-INCH X 16-FT EACH	637.2210 SIGNS TYPE II REFLECTIVE H S.F.	657.1530 INSTALL MONOTUBE ARMS 30-FT EACH	638.2102 MOVING SIGNS TYPE II EACH	SPV.0060.03 REMOVING OVERHEAD SIGNS TYPE II EACH	* SIGN DECALS (FOR INFORMATION ONLY) EACH
S 18-0160	1-37	1000-08-81		12.75				
S 18-0373	1-38	1000-08-81		24.00				
S 18-0373	1-39	1000-08-81		24.00				
S 18-0894	1-40	1000-08-81		9.00				1
S 18-0894	1-41	1000-08-81		9.00				1
S 18-0894	1-42	1000-08-81						
S 18-0894	1-43	1000-08-81		7.50		1		
S 18-0377	1-44	3700-50-27		9.00				
S 18-0377	1-45	3700-50-27						
S 18-0377	1-46	3700-50-27		9.00				
S 18-0377	1-47	3700-50-27		7.50		1		
S 18-0651	1-48	1000-08-81		10.50				
S 18-0651	1-49	1000-08-81		10.50				
S 09-0800	1-50	1000-08-81		8.25				
S 09-0800	1-51	1000-08-81		8.25				
S 17-0693	1-52	1000-08-81		12.75				
S 17-0693	1-53	1000-08-81		12.75				
S 18-0377	1-54	3700-50-27	1	9.00				
S 18-0377	1-55	3700-50-27	1	15.00				
S 18-0377	1-56	3700-50-27	1	9.00				
S 18-0377	1-57	3700-50-27	1	15.00				
TOTAL 1000-08-81			4	451.5	0	7	0	2
TOTAL 3700-50-27			4	81	0	0	2	0

* INCIDENTAL TO SIGNAL POLE INSTALLATION

PAVEMENT MARKING

LOCATION	ID	647.0156 PAVEMENT MARKING ARROWS EPOXY TYPE I EACH	647.0166 PAVEMENT MARKING ARROWS EPOXY TYPE II EACH	646.0106 PAVEMENT MARKING EPOXY 4-INCH L.F.	647.0955 REMOVING PAVEMENT MARKING ARROWS EACH	646.0600 REMOVING PAVEMENT MARKINGS L.F.
S 18-0377	3700-50-27	11	6	70	3	340
TOTAL 1000-08-81		0	0	0	0	0
TOTAL 3700-50-27		11	6	70	3	340

ALL ITEMS ON THIS SHEET ARE CATEGORY 0010

PERMANENT SIGNING
VARIOUS HIGHWAYS
PAGE 2 OF 2

NOTES

1. Sign is Type II - Type H Reflective - reference WIS DOT Standard Specification for HIGHWAY and STRUCTURE CONSTRUCTION latest edition.
2. Color:
Background - WHITE
Message - BLACK
3. Message Series - D
4. Corners may be square or rounded when base material is plywood but borders shall be rounded as shown. When base material is metal, the corners and borders shall be rounded.

Addendum No. 01
ID 3700-50-27
Added Sheet 257A
July 6, 2017

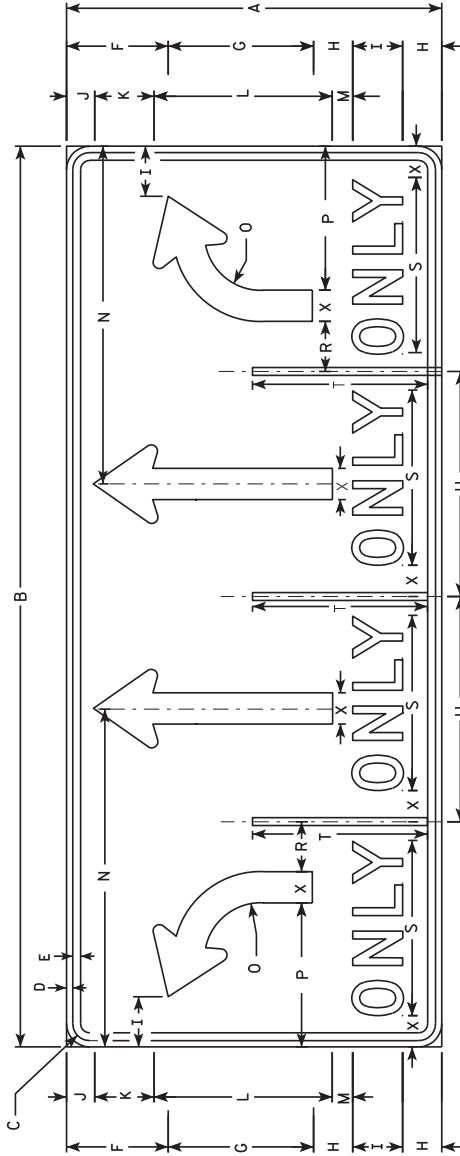

R3-8V

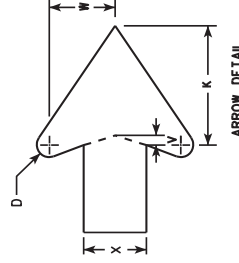

SIZE	A	B	C	D	E	F	G	H	I	J	K	L	M	N	O	P	Q	R	S	T	U	V	W	X	Y	Z	APPROX. SQ. FT.
1																											15.0
2S	30	72	1 3/8	1/2	5/8	8 1/8	11 3/8	3 1/8	4	2 1/4	4 3/4	14 1/4	1 5/8	27	4 1/2	11 1/2	4	4	14	14	18	3/8	2 5/8	2 1/2			15.0
2M	30	72	1 3/8	1/2	5/8	8 1/8	11 3/8	3 1/8	4	2 1/4	4 3/4	14 1/4	1 5/8	27	4 1/2	11 1/2	4	4	14	14	18	3/8	2 5/8	2 1/2			15.0
3																											36.0
4	48	108	2 1/4	3/4	1	14 3/8	17 1/4	5 3/8	6	5 3/8	7 1/8	21 1/2	3	40 1/2	7 1/4	17 1/4	6	6	20 5/8	22 3/8	27	5/8	4	3 3/4			36.0
5	48	108	2 1/4	3/4	1	14 3/8	17 1/4	5 3/8	6	5 3/8	7 1/8	21 1/2	3	40 1/2	7 1/4	17 1/4	6	6	20 5/8	22 3/8	27	5/8	4	3 3/4			36.0

STANDARD SIGN
R3-8V

WISCONSIN DEPT OF TRANSPORTATION
APPROVED

Matthew R. Lasech
State Traffic Engineer
DATE: 2/18/11 PLATE NO. R3-BV.3

SHEET NO: 257A E

PROJECT NO: _____ PLOT BY: mscsjo

FILE NAME: C:\Users\PROJECTS\T...s\p\d\plate\R3BV.DGN

NOTES

1. Sign is Type II - Type F Reflective - reference WIS DOT Standard Specification for HIGHWAY and STRUCTURE CONSTRUCTION latest edition.
2. Color:
Background - Yellow
Message - Black
3. Message Series - C
4. Corners may be square or rounded when base material is plywood but borders shall be rounded as shown. When base material is metal, the corners and borders shall be rounded.

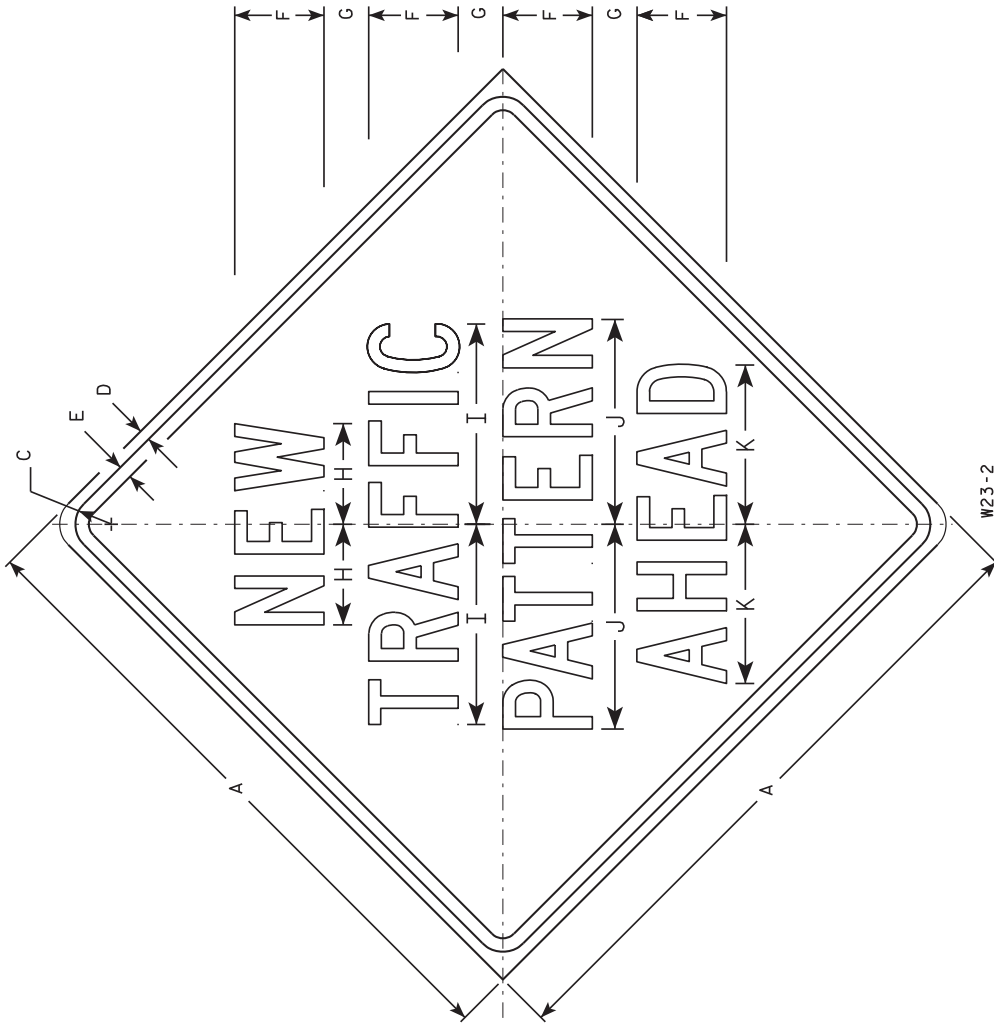

Addendum No. 01
ID 3700-50-27
Added Sheet 263A
July 6, 2017

SIZE	A	B	C	D	E	F	G	H	I	J	K	L	M	N	O	P	Q	R	S	T	U	V	W	X	Y	Z	APPROX. SQ. FT.
1																											
2S	36	1 5/8	5/8	3/4	5	2 1/2	5 5/8	11 1/4	11 1/2	8 7/8																	9.0
2M	36	1 5/8	5/8	3/4	5	2 1/2	5 5/8	11 1/4	11 1/2	8 7/8																	9.0
3																											
4																											
5																											

STANDARD SIGN
W23-2

WISCONSIN DEPT OF TRANSPORTATION
APPROVED *Matthew R. Rauch*
for State Traffic Engineer

DATE 3/13/13 PLATE NO. W23-2.2

PROJECT NO: _____ HWY: _____ COUNTY: _____ SHEET NO: 263A E

FILE NAME C:\CAEF\LessProj\ect's\tr-Stop\lot's\W232.DCN PLOT DATE :13-MAR-2013 13:58 PLOT BY : mscjsh PLOT NAME : _____ PLOT SCALE :6.9465511:000000 WISDOT/CADD SHEET 42



Proposal Schedule of Items

Proposal ID: 20170711017 Project(s): 1000-08-81, 3700-50-26, 3700-50-27

Federal ID(s): N/A, N/A, N/A

SECTION: 0001

Contract Items

Alt Set ID:

Alt Mbr ID:

Proposal Line Number	Item ID Description	Approximate Quantity and Units	Unit Price	Bid Amount
0160	627.0200 Mulching	11,000.000 SY	_____.	_____.
0170	628.1504 Silt Fence	100.000 LF	_____.	_____.
0180	628.1520 Silt Fence Maintenance	100.000 LF	_____.	_____.
0190	628.1905 Mobilizations Erosion Control	10.000 EACH	_____.	_____.
0200	628.1910 Mobilizations Emergency Erosion Control	8.000 EACH	_____.	_____.
0210	628.7010 Inlet Protection Type B	22.000 EACH	_____.	_____.
0220	628.7015 Inlet Protection Type C	30.000 EACH	_____.	_____.
0230	628.7020 Inlet Protection Type D	30.000 EACH	_____.	_____.
0240	628.7504 Temporary Ditch Checks	250.000 LF	_____.	_____.
0250	629.0210 Fertilizer Type B	9.000 CWT	_____.	_____.
0260	630.0130 Seeding Mixture No. 30	206.000 LB	_____.	_____.
0270	630.0200 Seeding Temporary	303.000 LB	_____.	_____.
0280	634.0616 Posts Wood 4x6-Inch X 16-FT	8.000 EACH	_____.	_____.
0290	636.0100 Sign Supports Concrete Masonry	39.000 CY	_____.	_____.
0300	636.1500 Sign Supports Steel Coated Reinforcement HS	5,780.000 LB	_____.	_____.
0310	637.1220 Signs Type I Reflective SH	288.000 SF	_____.	_____.



Proposal Schedule of Items

Proposal ID: 20170711017 Project(s): 1000-08-81, 3700-50-26, 3700-50-27

Federal ID(s): N/A, N/A, N/A

SECTION: 0001

Contract Items

Alt Set ID:

Alt Mbr ID:

Proposal Line Number	Item ID Description	Approximate Quantity and Units	Unit Price	Bid Amount
0320	637.2210 Signs Type II Reflective H	532.500 SF	_____.	_____.
0330	638.2102 Moving Signs Type II	7.000 EACH	_____.	_____.
0340	638.2601 Removing Signs Type I	2.000 EACH	_____.	_____.
0350	641.6600 Sign Bridge (structure) 01. S-18-118	LS	LUMP SUM	_____.
0360	643.0100 Traffic Control (project) 01. 1000-08-81	1.000 EACH	_____.	_____.
0370	643.0100 Traffic Control (project) 02. 3700-50-26	1.000 EACH	_____.	_____.
0380	643.0100 Traffic Control (project) 03. 3700-50-27	1.000 EACH	_____.	_____.
0390	643.0300 Traffic Control Drums	11,500.000 DAY	_____.	_____.
0400	643.0420 Traffic Control Barricades Type III	650.000 DAY	_____.	_____.
0410	643.0705 Traffic Control Warning Lights Type A	1,300.000 DAY	_____.	_____.
0420	643.0715 Traffic Control Warning Lights Type C	2,400.000 DAY	_____.	_____.
0430	643.0800 Traffic Control Arrow Boards	40.000 DAY	_____.	_____.
0440	643.0900 Traffic Control Signs	2,800.000 DAY	_____.	_____.
0450	643.1050 Traffic Control Signs PCMS	438.000 DAY	_____.	_____.
0460	646.0106 Pavement Marking Epoxy 4-Inch	70.000 LF	_____.	_____.
0470	646.0600 Removing Pavement Markings	340.000 LF	_____.	_____.
0480	647.0156 Pavement Marking Arrows Epoxy Type 1	11.000 EACH	_____.	_____.



Proposal Schedule of Items

Proposal ID: 20170711017 Project(s): 1000-08-81, 3700-50-26, 3700-50-27

Federal ID(s): N/A, N/A, N/A

SECTION: 0001

Contract Items

Alt Set ID:

Alt Mbr ID:

Proposal Line Number	Item ID Description	Approximate Quantity and Units	Unit Price	Bid Amount
1720	647.0166 Pavement Marking Arrows Epoxy Type 2	6.000 EACH	_____.	_____.
	Section: 0001		Total:	_____.
			Total Bid:	_____.

