



Wisconsin Department of Transportation

November 1, 2017

Division of Transportation Systems Development

Bureau of Project Development
4802 Sheboygan Avenue, Rm 601
P O Box 7916
Madison, WI 53707-7916

Telephone: (608) 266-1631
Facsimile (FAX): (608) 266-8459

NOTICE TO ALL CONTRACTORS:

Proposal #20: 6190-16-72, WISC 2017 516
E River Drive, City of Omro
Spruce Street - NCL
STH 116
Winnebago County

6190-16-73
E River Drive, City of Omro
Spruce Street - Pine Street
STH 116
Winnebago County

Letting of November 14, 2017

This is Addendum No. 01, which provides for the following:

Plan Sheets:

Revised Plan Sheets	
Plan Sheet	Plan Sheet Title (brief description of changes to sheet)
2	Typical Finished Section - Utility Trench Repair Area (Revised HMA Lower Layer type)

Plan Sheets

The following 8½ x 11-inch sheet is attached and made part of the plans for this proposal:
Revised: 2.

The responsibility for notifying potential subcontractors and suppliers of these changes remains with the prime contractor.

Sincerely,

Mike Coleman

Proposal Development Specialist
Proposal Management Section

END OF ADDENDUM

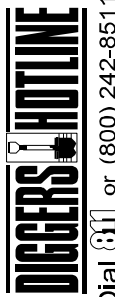

Dial 811 or (800) 242-8511

www.DiggersHotline.com

NOTE: THE LOCATIONS OF EXISTING AND PROPOSED UTILITY INSTALLATIONS AS SHOWN ON PLANS ARE APPROXIMATE. THERE MAY BE OTHER UTILITY INSTALLATIONS WITHIN THE PROJECT AREA THAT ARE NOT SHOWN.

DENOTES SANITARY & WATER SHEET NUMBER "X"

S&W "X"

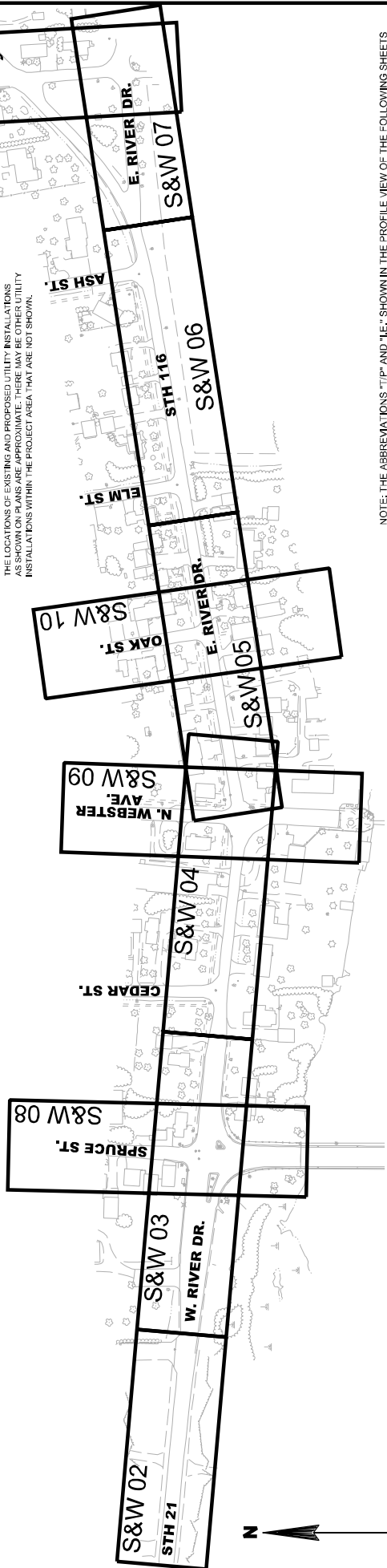

GENERAL SANITARY AND WATER CONSTRUCTION NOTES

- GENERAL: THESE NOTES ARE KEVED TO MATCH CIRCLED NUMBERS ON THE SHEETS THAT FOLLOW.
- THE SANITARY LATERAL LOCATIONS ARE SHOWN AS PER THE TELEVISION REPORTS SUPPLIED BY THE CITY. NOT ALL LOCATIONS MAY BE ACTIVE. THE CONTRACTOR SHALL OBTAIN THE LATERALS TO VERIFY WHICH LINES ARE ACTIVE AND RECONSTRUCT ONLY THE ACTIVE LATERALS. INVESTIGATION AND DYE TESTING SHALL BE INCIDENTAL TO THE SANITARY SEWER CONSTRUCTION. CITY UTILITY STAFF WILL ASSIST. THE SIZE OF THE EXISTING SANITARY LATERALS IS UNKNOWN. THE CONTRACTOR SHALL HAVE A SUFFICIENT AMOUNT OF BOTH 4" AND 6" DIAMETER CONNECTION FITTINGS AND PIPE ON HAND TO MAKE EQUIVALENT SIZE REPLACEMENTS TO A POINT NEAR THE R/W LINE AS DIRECTED BY THE FIELD ENGINEER. ALL 4" AND 6" DIAMETER SANITARY LATERAL REPLACEMENTS SHALL BE PAID ACCORDING TO THE SAME GENERIC BID ITEM FOR SANITARY WYE FITTING AND SANITARY LATERAL REPLACEMENT AND NO DIFFERENTIATION FOR PAYMENT SHALL BE MADE FOR PIPE SIZE.
 - INSTALL A NEW SANITARY LATERAL FOR A POSSIBLE FUTURE CONNECTION. LOCATION AND PIPE SIZE AS SHOWN. PLACE A WOODEN 2x4 AT THE TERMINATION AND PLACE A WOODEN 2x4 VERTICALLY FROM THE END OF PIPE TO A POINT LEVEL WITH THE FINISH GROUND SURFACE. PAINT THE WOODEN STAKE GREEN.
 - INSTALL WATER SERVICE WITH CURB STOP AND BOX LOCATED IN THE NEW STREET TERRACE AS DIRECTED BY THE FIELD ENGINEER. CONNECT TO EXISTING PIPING AT A CONVENIENT POINT NEAR THE RIGHT-OF-WAY LINE AS DIRECTED BY THE FIELD ENGINEER. THE CONTRACTOR IS RESPONSIBLE FOR CORRECTLY LOCATING THE CURB STOP BOX IN THE NEW STREET TERRACE (GRASS AREA), PARTICULAR ATTENTION SHALL BE PAID TO THE ACCOMPANYING ROADWAY PLANS FOR LAYOUT OF CURB/GUTTER, SIDEWALK AND DRIVEWAY APPROACHES.
 - INSTALL A NEW WATER SERVICE FOR A POSSIBLE FUTURE CONNECTION. LOCATION AND PIPE SIZE AS SHOWN. PLACE A WOODEN 2x4 VERTICALLY FROM THE END OF THE PIPE TO A POINT LEVEL WITH THE FINISH GROUND SURFACE. PAINT THE WOODEN STAKE BLUE.
 - REMOVE EXISTING SANITARY MANHOLE
 - REMOVE EXISTING FIRE HYDRANT
 - THIS GROUND ELEVATION FOR HYDRANT SETTING IS APPROXIMATE AND IS PROVIDED FOR CONTRACTOR'S REFERENCE. THE CONTRACTOR IS SOLELY RESPONSIBLE FOR SETTING THE EXACT ELEVATION AS SHOWN ON THE PLANS. THE CONTRACTOR SHALL VERIFY THE EXISTING ELEVATION. THE CONTRACTOR SHALL REQUIRE THAT THE CONTRACTOR ORDER HYDRANTS WITH DIFFERENT "BURY DEPTHS" AND/OR INSTALLING HYDRANT EXTENSIONS (INCIDENTAL).
 - SANITARY MAINLINE PIPE CONNECTION (NEW TO EXISTING). SUPPLY ALL APPLICABLE FITTINGS FOR A WATERTIGHT CONNECTION. BOTH THE NEW FACILITIES. THE CONTRACTOR SHALL VERIFY THE LOCATION AND ELEVATION OF THE EXISTING PIPE AT THE CONNECTION FOR COMPLIANCE WITH THE NEW FACILITIES.
 - WATER MAIN PIPE CONNECTION (NEW TO EXISTING). SUPPLY ALL APPLICABLE FITTINGS FOR A PRESSURE TIGHT CONNECTION. THE CONTRACTOR SHALL VERIFY THE LOCATION AND ELEVATION OF THE EXISTING PIPE AT THE CONNECTION FOR COMPLIANCE WITH THE NEW FACILITIES.

NOTE: THE ABBREVIATIONS "TP" AND "LE" SHOWN IN THE PROFILE VIEW OF THE FOLLOWING SHEETS HAS THE MEANING "TOP OF PIPE" (WATER MAIN ELEVATION) AND "INVERT ELEVATION" (SANITARY SEWER).

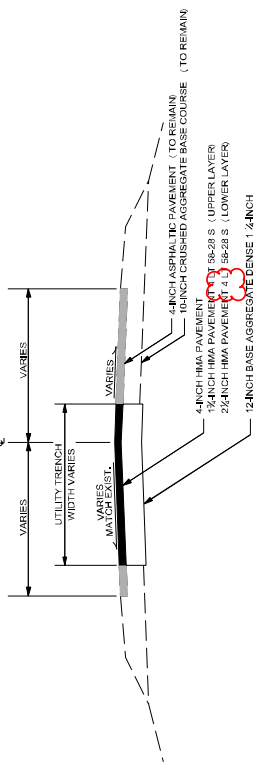

TYPICAL FINISHED SECTION - UTILITY TRENCH REPAIR AREA
STA. 13+95 SA - STA. 14+87 SA
STA. 11+70 ER - STA. 12+75 ER

Addendum No. 01
IDs 6190-16-72/73
Revised Sheet 2
November 1, 2017