



# Wisconsin Department of Transportation

## Division of Transportation Systems Development

Bureau of Project Development  
4802 Sheboygan Avenue, Rm 601  
P O Box 7916  
Madison, WI 53707-7916

November 9, 2017

Telephone: (608) 266-1631  
Facsimile (FAX): (608) 266-8459

### NOTICE TO ALL CONTRACTORS:

**Proposal #35: 1112-07-60, WISC 2017 606**  
**Madison – Sun Prairie**  
**East Springs Drive to Main Street**  
**USH 151**  
**Dane County**

### Letting of November 14, 2017

This is Addendum No. 01, which provides for the following:

#### Special Provisions:

Revised Special Provisions	
Article No.	Description
4	Traffic

#### Schedule of Items:

Revised Bid Item Quantities					
Bid Item	Item Description	Unit	Old Quantity	Revised Quantity	Proposal Total
204.0120	Removing Asphaltic Surface Milling	SY	21,258	150	21,408
305.0110	Base Aggregate Dense ¾-Inch	TON	547	6	553
415.6000.S	Route and Seal	LF	24,533	168	24,701
416.0610	Drilled Tie Bars	EACH	436	-9	427
455.0605	Tack Coat	GAL	1,490	10	1,500
460.2000	Incentive Density HMA Pavement	DOL	1,530	10	1,540
460.5224	HMA Pavement 4 LT 58-28 S	TON	2,381	17	2,398
465.0400	Asphaltic Shoulder Rumble Strips	LF	18,835	168	19,003
690.0250	Sawing Concrete	LF	8,483	2,517	11,000
SPV.0180.01	Concrete Pavement Repair Overnight	SY	1,795	120	1,915
SPV.0180.02	Concrete Pavement Replacement Overnight	SY	1,341	589	1,930

<b>Added Bid Item Quantities</b>					
Bid Item	Item Description	Unit	Old Quantity	Revised Quantity	Proposal Total
305.0120	Base Aggregate Dense 1 ¼-Inch	TON	0	19	19
420.1000	Continuous Diamond Grinding Concrete Pavement	SY	0	515	515
465.0125	Asphaltic Surface Temporary	TON	0	3	3
650.7000	Construction Staking Concrete Pavement	LF	0	122	122
690.0150	Sawing Asphalt	LF	0	260	260

**Plan Sheets:**

<b>Revised Plan Sheets</b>	
Plan Sheet	Plan Sheet Title (brief description of changes to sheet)
71	Miscellaneous Quantities (added Base Aggregate Dense 1 ¼-Inch and Concrete Pavement Continuous Diamond Grinding tables; revised Base Aggregate Dense ¾-Inch, Water, and Concrete tables)
72	Miscellaneous Quantities (added Asphaltic Surface Temporary table; revised Asphalt, Asphaltic Shoulder Rumble Strips, and Inlet Protection Type D tables)
75	Miscellaneous Quantities (replaced Sawing Concrete table with Construction Staking Concrete Pavement table; revised Field Office Type D and Pavement Marking tables)
81-82	Plan (added Concrete Pavement Replacement Overnight 439+62 NB to 440+78 NB)

<b>Added Plan Sheets</b>	
Plan Sheet	Plan Sheet Title (brief description of why sheet was added)
23A	Typical Section (Daytime Typical for 439+62 NB to 440+78 NB)
75A	Miscellaneous Quantities (added Sawing Asphalt table, and added revised Sawing Concrete table formerly on page 75)
91A	Plan & Profile (Profile Adjustment for 439+62 NB to 440+78 NB)
91B	Paving Grades (New Paving Grades for 439+62 to 440+78 NB)

The responsibility for notifying potential subcontractors and suppliers of these changes remains with the prime contractor.

Sincerely,

*Mike Coleman*

Proposal Development Specialist  
Proposal Management Section

**ADDENDUM NO. 01**

**1112-07-60**

**November 9, 2017**

**Special Provisions**

**4. Traffic**

*Add the following paragraph under section titled **General**:*

Complete HMA shoulder work after all Concrete Pavement Repair / Replacement in the adjacent lane has been completed.

**Schedule of Items**

Attached, dated November 9, 2017, are the revised Schedule of Items Pages 1 – 4.

**Plan Sheets**

The following 8½ x 11-inch sheets are attached and made part of the plans for this proposal:

Revised: 71, 72, 75, 81 and 82.

Added: 23A and 91A-91B.

END OF ADDENDUM

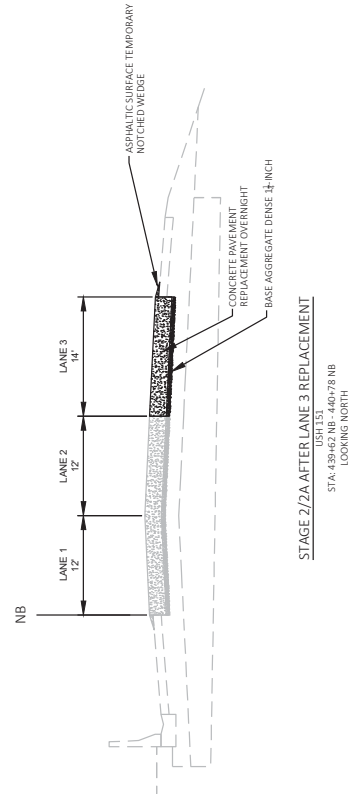
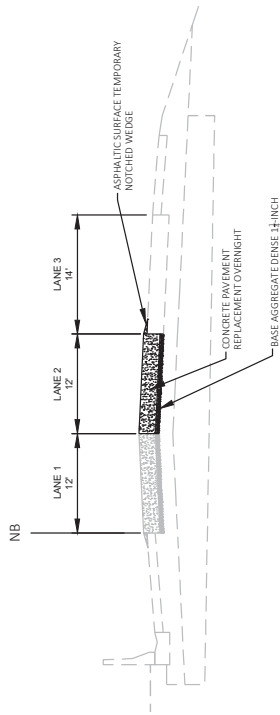
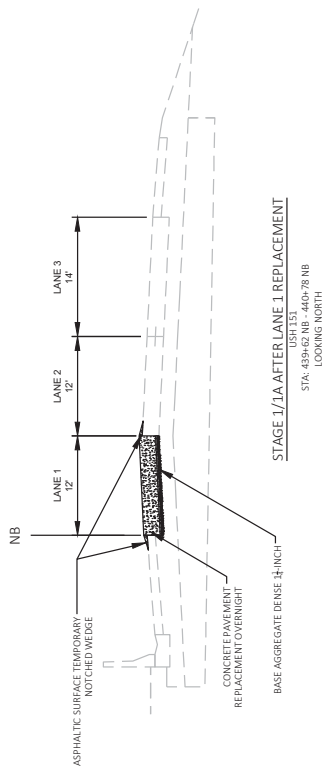

Addendum No. 01  
 ID 1112-07-60  
 Added Sheet 23A  
 November 9, 2017

PROJECT NO: 1112-07-60 COUNTY: DANE HWY: USH 151 TYPICAL SECTION AT PAVEMENT DIP REPAIR

SHEET 23A E

FILE NAME: N:\PROJECTS\111207\23A\SHEETSLAND\23A\TSDWG LAYOUT\T1A1E-3 PLOT DATE: 11/8/2017 8:56 AM PLOT BY: FELIPE PETERL PLOT NAME: TYPICAL SECTION AT PAVEMENT DIP REPAIR PLOT SCALE: 1:12.5 WSDOT/CADD/SHEET 42

BASE AGGREGATE DENSE 3/4-INCH

STATION	TO	STATION	LOCATION	TON
411+03	NB	417+20	OUTSIDE SHOULDER	24
434+46	NB	440+84	OUTSIDE SHOULDER	47
I H 94	WB RAMP	392+46	OUTSIDE SHOULDER	31
393+42	SB	399+68	OUTSIDE SHOULDER	62
405+50	SB	409+70	OUTSIDE SHOULDER	31
411+35	SB	422+44	OUTSIDE SHOULDER	110
422+99	SB	440+00	OUTSIDE SHOULDER	168
TOTAL 0010				553

BASE AGGREGATE DENSE 1 1/4-INCH

STATION	TO	STATION	LOCATION	TON	REMARKS
439+62	NB	440+84	NB	19	PAVEMENT DIP
TOTAL 0010				19	

CONCRETE PAVEMENT CONTINUOUS DIAMOND GRINDING

LOCATION	SY	
420, 1000, S	515	
TOTAL 0010		515

WATER

LOCATION	MGAL
PROJECT	3
TOTAL 0010	3

CONCRETE

STATION	TO	STATION	LOCATION	416.0610			416.0620			SPV. 0180.01			SPV. 0180.02		
				DRI LLED TIE BARS EACH			DRI LLED DOWEL BARS EACH			CONCRETE PAVEMENT REPAIR OVERNI GHT SY			CONCRETE PAVEMENT REPLACEMENT OVERNI GHT SY		
L1	L2	L3	AUX	RAMP	L1	L2	L3	AUX	RAMP	L1	L2	L3	AUX	RAMP	
332+00	NB	360+00	NB	-	-	-	-	-	-	-	-	-	-	-	
360+00	NB	401+00	NB	15	76	84	15	160	176	560	8	64	32	135	
401+00	NB	477+00	NB	-	61	61	-	128	336	496	-	96	48	203	
477+00	NB	547+57	NB	-	-	-	-	-	64	32	-	32	16	203	
332+00	SB	360+00	SB	-	-	-	-	-	-	-	-	-	-	-	
360+00	SB	401+00	SB	-	24	-	-	-	32	-	-	-	20	40	
401+00	SB	477+00	SB	8	46	88	-	16	304	384	16	96	157	215	
477+00	SB	547+57	SB	8	-	21	-	16	64	64	-	32	105	33	
TOTAL 0010				524	524	3352	1915	1915	1930						

Addendum No. 01  
ID 1112-07-60  
Revised Sheet 71  
November 9, 2017

Addendum No. 01  
ID 1112-07-60  
Revised Sheet 72  
November 9, 2017

ASPHALT

204.0120 415.6000.S 455.0605 460.5224  
REMOVING ASPHALTIC SURFACE MILLING SEAL COAT 4 LT 58-28 S HMA PAVEMENT TACK

STATION	TO	STATION	LOCATION	SY	LF	GAL	TON	REMARKS
380+00	NB	400+00	INSIDE SHOULDER	2222	2000	156	249	10' WIDTH WITH RAMP TAPER
382+00	NB	391+36	OUTSIDE SHOULDER	788	936	55	88	8' WIDTH WITH RAMP TAPER
392+63	NB	395+03	OUTSIDE SHOULDER	267	480	19	30	0'-20' TAPER
397+00	NB	399+97	OUTSIDE SHOULDER	198	297	14	22	6' WIDTH
402+14	NB	409+33	INSIDE SHOULDER	799	719	56	89	10' WIDTH
402+42	NB	404+93	OUTSIDE SHOULDER	151	251	11	17	6' WIDTH WITH -50' TAPER
407+17	NB	409+41	OUTSIDE SHOULDER	149	224	10	17	6' WIDTH
411+03	NB	423+68	OUTSIDE SHOULDER	947	1435	84	108	6' WIDTH WITH ON-RAMP
411+08	NB	440+84	INSIDE SHOULDER	3307	2976	231	370	10' WIDTH
434+46	NB	440+84	OUTSIDE SHOULDER	425	638	30	48	6' WIDTH
1H 94 WB RAMP	SB	392+46	OUTSIDE SHOULDER	2497	4226	175	280	6' WIDTH (ML) 5' WIDTH (RAMP)
376+00	SB	399+68	INSIDE SHOULDER	2631	2368	184	295	10' WIDTH
393+42	SB	399+68	OUTSIDE SHOULDER	462	716	32	52	6' WIDTH WITH RAMP TAPER
402+02	SB	409+42	INSIDE SHOULDER	822	740	58	92	10' WIDTH
402+02	SB	409+47	OUTSIDE SHOULDER	497	745	35	56	6' WIDTH
411+35	SB	422+44	OUTSIDE SHOULDER	909	1109	64	102	6' WIDTH WITH RAMP TAPERS
411+35	SB	440+00	INSIDE SHOULDER	3183	2940	223	356	10' WIDTH
422+99	SB	440+00	OUTSIDE SHOULDER	1134	1701	79	127	6' WIDTH
TOTAL 0010				21408	24701	1500	2398	

ASPHALTIC SHOULDER RUMBLE STRIPS

STATION	TO	STATION	LOCATION	LF	REMARKS
380+00	NB	400+00	INSIDE SHOULDER	2000	
382+00	NB	389+50	OUTSIDE SHOULDER	750	
397+00	NB	399+97	OUTSIDE SHOULDER	297	
402+14	NB	409+33	INSIDE SHOULDER	719	
402+42	NB	404+93	OUTSIDE SHOULDER	251	
407+17	NB	409+41	OUTSIDE SHOULDER	224	
411+03	NB	417+40	OUTSIDE SHOULDER	637	
411+08	NB	440+84	INSIDE SHOULDER	2976	
434+46	NB	440+84	OUTSIDE SHOULDER	638	
377+50	SB	392+46	OUTSIDE SHOULDER	1406	
376+00	SB	399+68	INSIDE SHOULDER	2368	
394+04	SB	399+68	OUTSIDE SHOULDER	564	
402+02	SB	409+42	INSIDE SHOULDER	740	
402+02	SB	409+47	OUTSIDE SHOULDER	745	
413+62	SB	421+70	OUTSIDE SHOULDER	808	
411+35	SB	440+00	INSIDE SHOULDER	2865	
430+75	SB	440+00	OUTSIDE SHOULDER	925	
TOTAL 0010				19003	

ASPHALTIC SURFACE TEMPORARY

STATION	TO	STATION	LOCATION	TON	REMARKS
439+62	NB	440+84	LT/RT	3	PAVEMENT DIP NOTCHED WEDGE
TOTAL 0010				3	

COLD PATCHING	
495.1000.S	SPV. 0060.03
	MOBILIZATION
	FOR COLD
	PATCH
	EACH
LOCATION	TON
PROJECT	50
TOTAL 0010	50

INLET PROTECTION TYPE D

LOCATION	EACH
PROJECT	65
TOTAL 0010	65

PROJECT NO: 1112-07-60

HWY: USH 151

COUNTY: DANE

MISCELLANEOUS QUANTITIES

SHEET: 72

Addendum No. 01  
ID 1112-07-60  
Revised Sheet 75  
November 9, 2017

3

PERMANENT SIGNING

NUMBER	STATION	LOCATION	(IN X IN)	SIGN SIZE	SIGN PLATE	14-FT	16-FT	18-FT	20-FT	22-FT	634.0614	634.0616	634.0618	634.0620	634.0622	637.2210	637.2215	637.2220	637.2230	638.2602	638.3000	
						EACH	EACH	EACH	EACH	EACH	POSTS WOOD 4X6-1INCH X 4X6-1INCH X	POSTS WOOD 4X6-1INCH X 4X6-1INCH X	POSTS WOOD 4X6-1INCH X 4X6-1INCH X	POSTS WOOD 4X6-1INCH X 4X6-1INCH X	POSTS WOOD 4X6-1INCH X 4X6-1INCH X	SIGNS TYPE II REFLECTIVE H	SIGNS TYPE II REFLECTIVE H FOLDING	SIGNS TYPE II REFLECTIVE SH	SIGNS TYPE II REFLECTIVE F	REMOVING SMALL SIGN SUPPORTS	REMOVING SMALL SIGN SUPPORTS	
10-2	484+85	NB	RT	30 X 36	155-56	1	-	-	-	-	-	-	-	-	-	-	-	-	-	-	-	-
10-3	486+25	NB	LT	21 X 60	D10-5	1	-	-	-	-	-	-	-	-	-	-	-	-	-	-	-	-
10-4	486+25	SB	RT	21 X 60	D10-5	-	-	-	-	-	-	-	-	-	-	-	-	-	-	-	-	-
10-5	487+75	SB	LT	90 X 60	E5-1A	-	-	-	-	-	-	-	-	-	-	-	-	-	-	-	-	-
10-6	496+75	NB	LT	21 X 60	D10-5	1	-	-	-	-	-	-	-	-	-	-	-	-	-	-	-	-
10-7	496+75	SB	RT	21 X 60	D10-5	-	-	-	-	-	-	-	-	-	-	-	-	-	-	-	-	-
11-1	507+30	NB	LT	21 X 60	D10-5	1	-	-	-	-	-	-	-	-	-	-	-	-	-	-	-	-
11-2	507+30	SB	RT	21 X 60	D10-5	-	-	-	-	-	-	-	-	-	-	-	-	-	-	-	-	-
12-1	518+00	NB	LT	21 X 60	D10-5	1	-	-	-	-	-	-	-	-	-	-	-	-	-	-	-	-
12-2	518+00	SB	RT	21 X 60	D10-5	-	-	-	-	-	-	-	-	-	-	-	-	-	-	-	-	-
13-1	528+55	NB	LT	21 X 60	D10-5	1	-	-	-	-	-	-	-	-	-	-	-	-	-	-	-	-
13-2	528+55	SB	RT	21 X 60	D10-5	-	-	-	-	-	-	-	-	-	-	-	-	-	-	-	-	-
13-3	539+00	NB	LT	21 X 60	D10-5	1	-	-	-	-	-	-	-	-	-	-	-	-	-	-	-	-
13-4	539+00	SB	RT	21 X 60	D10-5	-	-	-	-	-	-	-	-	-	-	-	-	-	-	-	-	-
TOTAL 0010						17	10	41	16	13	961	30	27.5	362	68	102						

TRAFFIC CONTROL

FIELD	OFFICE	TYPE	DURATI ON	643.0300	643.0420	643.0705	643.0715	643.0800	643.0900	643.0920	643.1050	643.0920	643.0920	643.0920	643.0920	643.0920	643.0920	643.0920	643.0920	643.0920	643.0920	643.0920	643.0920	
			DAYS	DRUMS	BARRICADES	WARNING	WARNING	ARROW	SIGNS	COVERING	SIGNS	SIGNS	SIGNS	SIGNS	SIGNS	SIGNS	SIGNS	SIGNS	SIGNS	SIGNS	SIGNS	SIGNS	SIGNS	
				EACH	TYPE III	TYPE A	TYPE C	BOARDS	ARROW	TYPE I	TYPE II	TYPE III	TYPE I	TYPE II	TYPE III	TYPE I	TYPE II	TYPE III	TYPE I	TYPE II	TYPE III	TYPE I	TYPE II	
				DAY	EACH	EACH	EACH	DAY	DAY	DAY	DAY	DAY	DAY	DAY	DAY	DAY	DAY	DAY	DAY	DAY	DAY	DAY	DAY	
642.5401	EACH			740	36	72	45	6	42	8	-	-	-	-	-	-	-	-	-	-	-	-	-	
PROJECT				2007	36	72	572	5	66	17	-	-	-	-	-	-	-	-	-	-	-	-	-	
				-	612	72	9724	85	1122	136	-	-	-	-	-	-	-	-	-	-	-	-	-	
				-	-	-	-	-	-	-	-	-	-	-	-	-	-	-	-	-	-	-	-	
				10	-	-	-	-	-	-	-	-	-	-	-	-	-	-	-	-	-	-	-	
				6	-	-	-	-	-	-	-	-	-	-	-	-	-	-	-	-	-	-	-	
TOTAL 0010				43739	1080	2160	10309	163	1668	136	254	30	30	30	30	30	30	30	30	30	30	30	30	30

PAVEMENT MARKING

STATION	TO	STATION	LOCATION	646.0106	646.0106	646.0126	646.0126	646.0126	646.0126	646.0126	646.0126	646.0126	646.0126	646.0126	646.0126	646.0126	646.0126	646.0126	646.0126	646.0126	646.0126	646.0126	646.0126	
				EPOXY 4-1 INCH	EPOXY 4-1 INCH	EPOXY 8-1 INCH	EPOXY 8-1 INCH	EPOXY 8-1 INCH	EPOXY 8-1 INCH	EPOXY 8-1 INCH	EPOXY 8-1 INCH	EPOXY 8-1 INCH	EPOXY 8-1 INCH	EPOXY 8-1 INCH	EPOXY 8-1 INCH	EPOXY 8-1 INCH	EPOXY 8-1 INCH	EPOXY 8-1 INCH	EPOXY 8-1 INCH	EPOXY 8-1 INCH	EPOXY 8-1 INCH	EPOXY 8-1 INCH	EPOXY 8-1 INCH	
				L1	L2	L3	AUX	RAMP	L1	L2	L3	AUX	RAMP	L1	L2	L3	AUX	RAMP	L1	L2	L3	AUX	RAMP	
332+00	NB	-	360+00	NB	194	40	89	90	-	-	-	-	-	-	-	-	-	-	-	-	-	-	-	
360+00	NB	-	401+00	NB	93	38	172	-	-	-	-	-	-	-	-	-	-	-	-	-	-	-	-	
401+00	NB	-	477+00	NB	8	12	-	-	-	-	-	-	-	-	-	-	-	-	-	-	-	-	-	
477+00	NB	-	547+57	NB	11	-	-	-	-	-	-	-	-	-	-	-	-	-	-	-	-	-	-	
332+00	SB	-	360+00	SB	4	31	40	24	-	-	-	-	-	-	-	-	-	-	-	-	-	-	-	
360+00	SB	-	401+00	SB	25	55	344	-	-	-	-	-	-	-	-	-	-	-	-	-	-	-	-	
401+00	SB	-	477+00	SB	25	20	73	-	-	-	-	-	-	-	-	-	-	-	-	-	-	-	-	
477+00	SB	-	547+57	SB	25	20	73	-	-	-	-	-	-	-	-	-	-	-	-	-	-	-	-	
TOTAL 0010				1388	78	1388	1388	1388	1388	1388	1388	1388	1388	1388	1388	1388	1388	1388	1388	1388	1388	1388	1388	1388

CONSTRUCTION STAKING CONCRETE PAVEMENT

STATION TO STATION LOCATION LF REMARKS

439+62 NB - 440+84 NB LT/RT 122 PAVEMENT DIP

TOTAL 0010 122

3

SAWLING ASPHALT

STATION TO	STATION	LOCATION	RT/LT	LF	REMARKS
439+62	NB - 440+84	NB	RT/LT	260	DIP LOCATION SHOULDERS
TOTAL 0010					260

690.0250

SAWLING CONCRETE

STATION TO	STATION	LOCATION	L1	L2	L3	AUX	RAMP	
		LANE NUMBER						
332+00	NB - 360+00	NB EAST SPRINGS DR. TO IH 90/94	593	657	1854	456	72	
360+00	NB - 401+00	NB IH 90/94 TO AMERICAN PKWY	329	854	1428	-	-	
401+00	NB - 477+00	NB AMERICAN PKWY TO REINER RD.	156	72	-	-	-	
477+00	NB - 547+57	NB REINER RD. TO W MAIN ST.	-	210	424	164	-	
332+00	SB - 360+00	SB EAST SPRINGS DR. TO IH 90/94	88	924	1750	140	-	
360+00	SB - 401+00	SB IH 90/94 TO AMERICAN PKWY	68	403	380	-	-	
401+00	SB - 477+00	SB AMERICAN PKWY TO REINER RD.						
477+00	SB - 547+57	SB REINER R. TO W MAIN ST.						
TOTAL 0010							11000	

Addendum No. 01  
ID 1112-07-60  
Added Sheet 75A  
November 9, 2017

PROJECT NO: 1112-07-60

HWY: USH 151

COUNTY: DANE

MISCELLANEOUS QUANTITIES

SHEET: 75A

E

FILE NAME : P:\bire\USH\_151\1112-07-30\Etch\Wbs-c030200\_mq.pptx

PLOT DATE: 9/19/2017 1:00 PM

PLOT BY: A.M.S.

PLOT NAME :

PLOT SCALE : 1:1



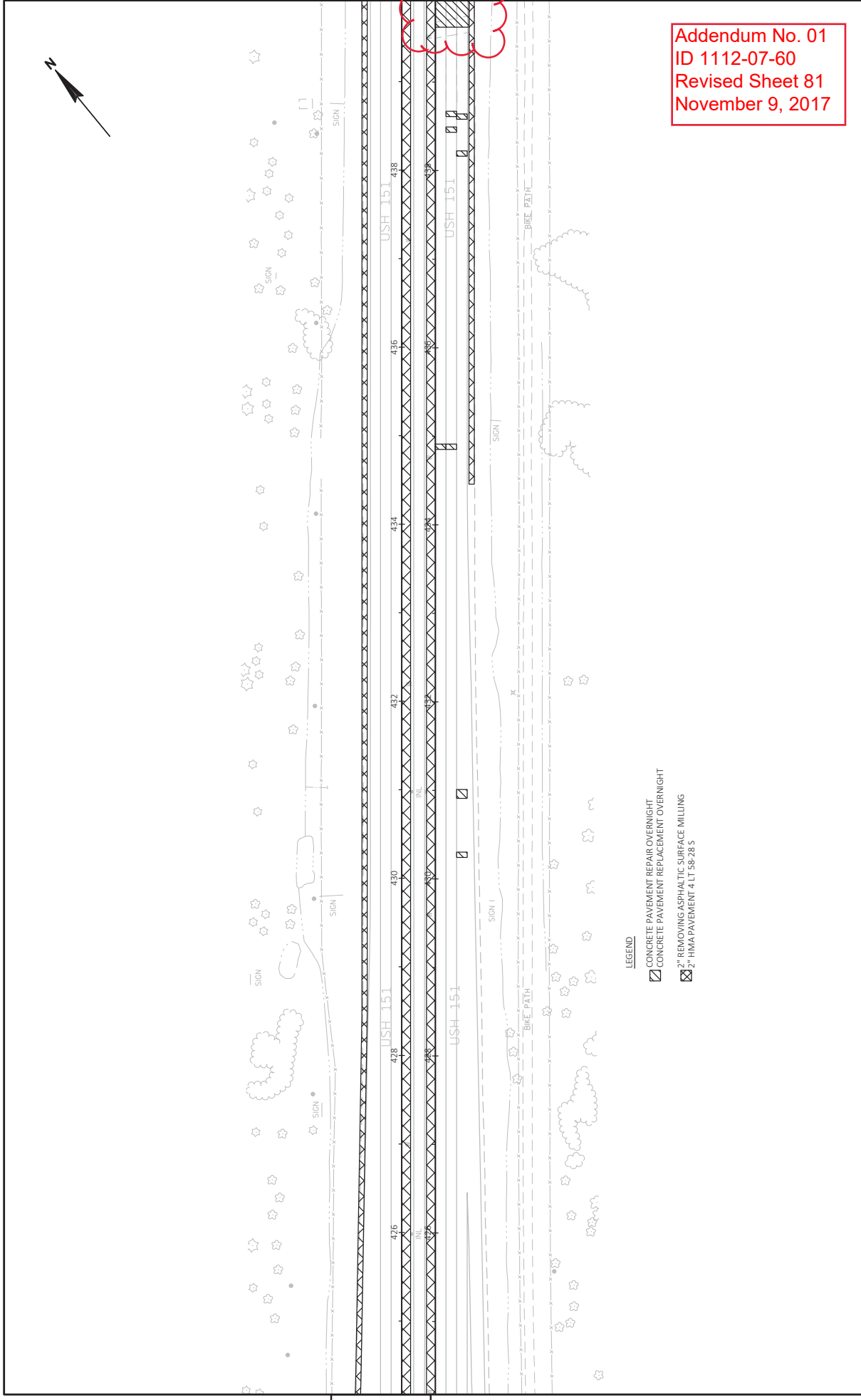

Addendum No. 01  
 ID 1112-07-60  
 Revised Sheet 81  
 November 9, 2017

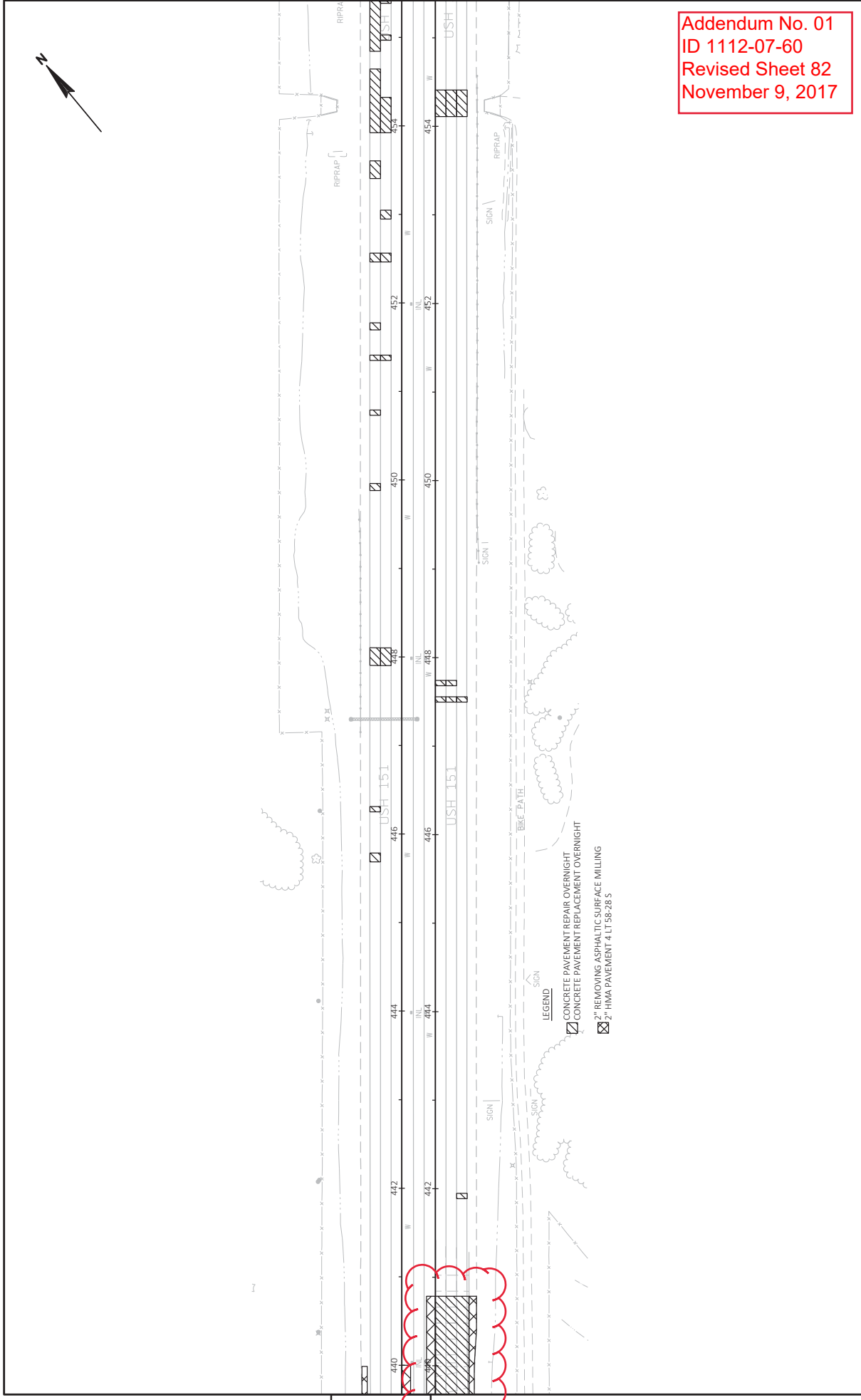

Addendum No. 01  
 ID 1112-07-60  
 Revised Sheet 82  
 November 9, 2017

PROJECT NO: 1112-07-60	COUNTY: DANE	PLAN	SHEET 82	E
FILE NAME: K:\PROJECTS\111207\95SHEETS\LANE\0201_PWD.DWG	HWY: USH 151	DATE: 11/7/2017 9:55 AM	PLOT BY: FELIPE PETERL	PLOT SCALE: 1 IN:100 FT
PROJECT NAME: LANES				WSDOT\CADSS\82\44

- LEGEND
- ☐ CONCRETE PAVEMENT REPAIR OVERNIGHT
  - ▨ CONCRETE PAVEMENT REPLACEMENT OVERNIGHT
  - ☒ 2" REMOVING ASPHALTIC SURFACE MILLING
  - ☒ 2" HMA PAVEMENT 4 LT 58-28 S

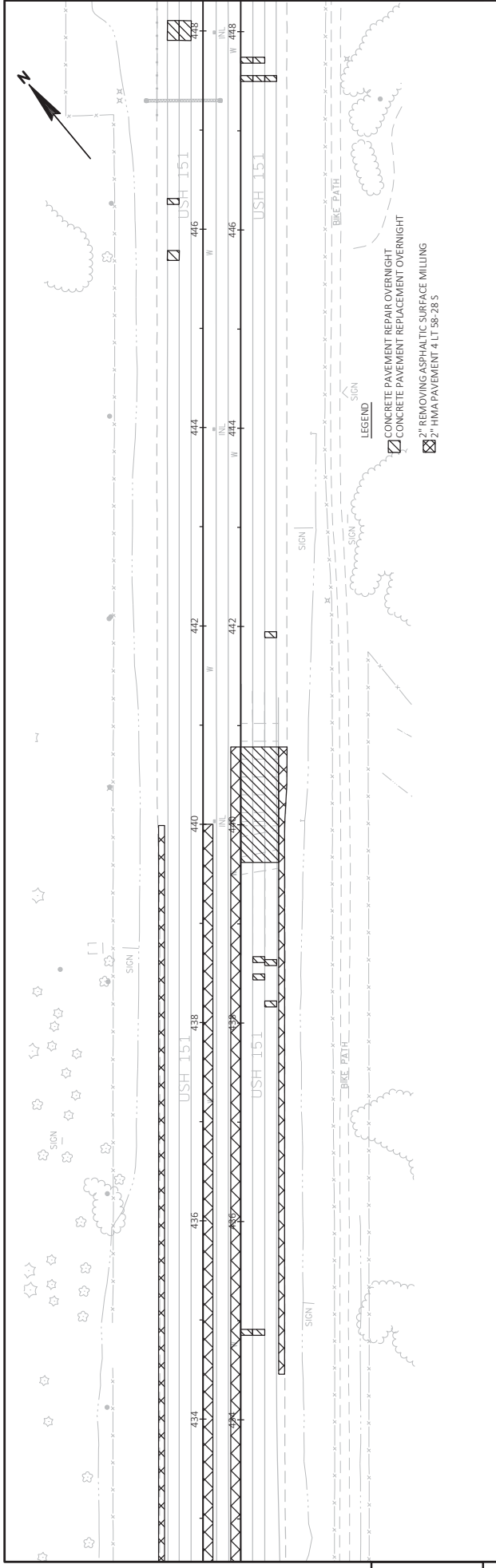

5

5

Addendum No. 01  
 ID 1112-07-60  
 Added Sheet 91A  
 November 9, 2017

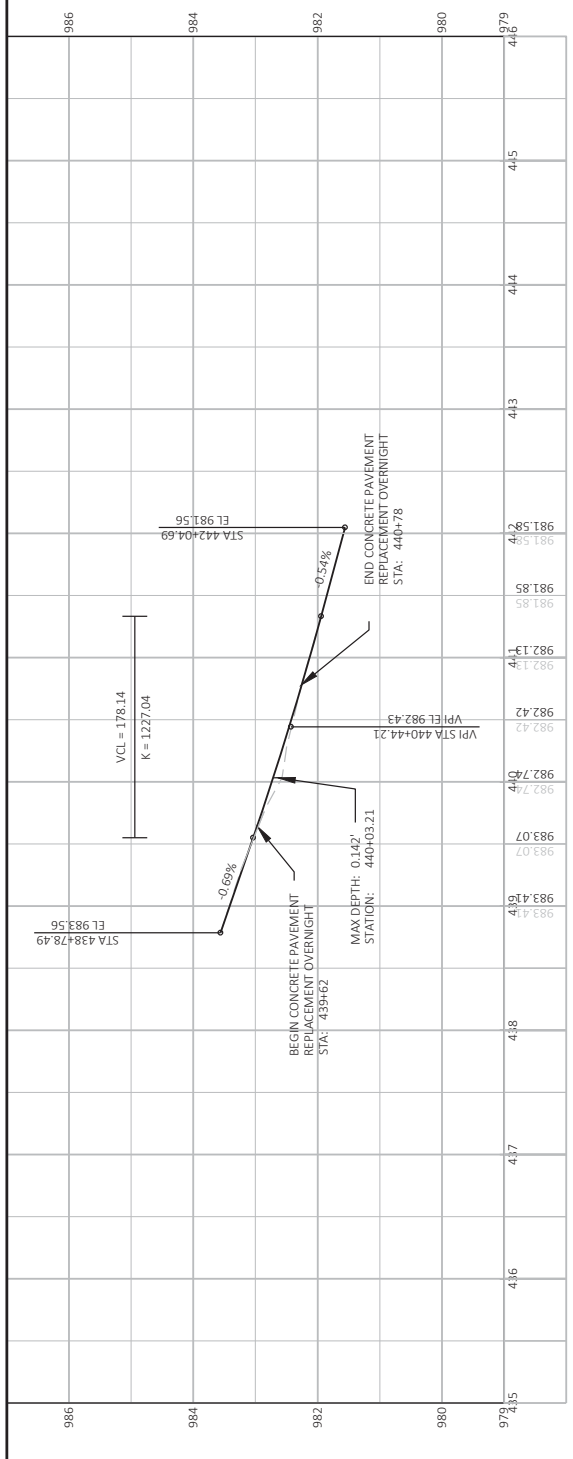

**PROJECT NO:** 1112-07-60

**HWY:** USH 151

**COUNTY:** DANE

**PLAN AND PROFILE:** FELUPI, PETER L

**PROFILE ADJUSTMENT LOCATION**

**SHEET 91A**

**E**

**FILE NAME:** N:\PROJECTS\111207\91\91A\DWG\91A\91A.DWG  
 LAYOUT NAME: Change-09a

**DATE:** 11/7/2017 9:56 AM

**PLOT SCALE:** 1 IN = 100 FT

**PLOT NAME:** W:\DOT\CADD\SHEET 44

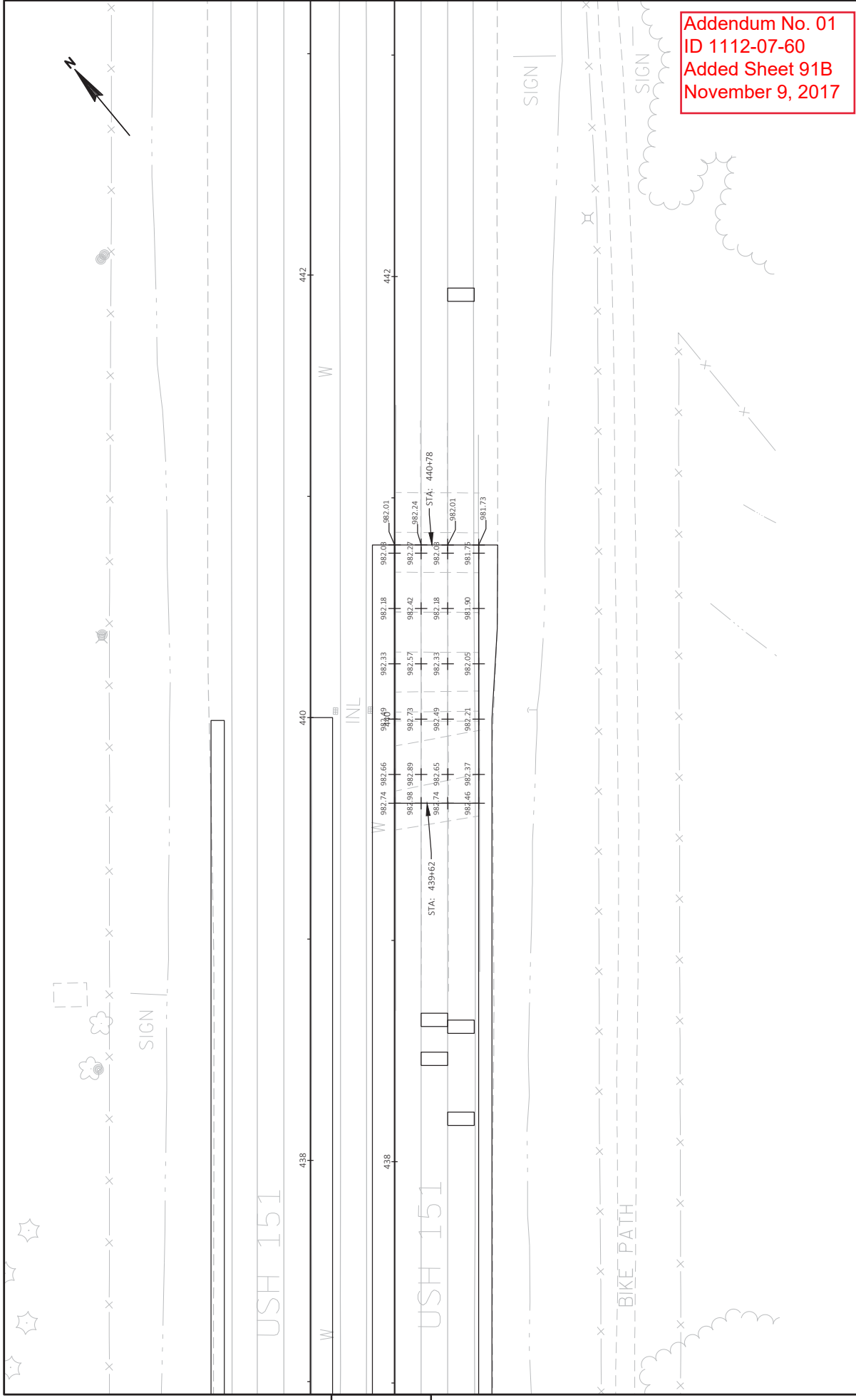

**Addendum No. 01**  
**ID 1112-07-60**  
**Added Sheet 91B**  
**November 9, 2017**



Proposal Schedule of Items

Proposal ID: 20171114035 Project(s): 1112-07-60

Federal ID(s): WISC 2017606

SECTION: 0001 Contract Items

Alt Set ID: Alt Mbr ID:

Proposal Line Number	Item ID Description	Approximate Quantity and Units	Unit Price	Bid Amount
0002	204.0120 Removing Asphaltic Surface Milling	21,408.000 SY	_____.	_____.
0004	213.0100 Finishing Roadway (project) 01. 1112-07-60	1.000 EACH	_____.	_____.
0006	305.0110 Base Aggregate Dense 3/4-Inch	553.000 TON	_____.	_____.
0008	415.6000.S Rout and Seal	24,701.000 LF	_____.	_____.
0010	416.0610 Drilled Tie Bars	427.000 EACH	_____.	_____.
0012	416.0620 Drilled Dowel Bars	3,352.000 EACH	_____.	_____.
0014	455.0605 Tack Coat	1,500.000 GAL	_____.	_____.
0016	460.2000 Incentive Density HMA Pavement	1,540.000 DOL	1.00000	1,540.00
0018	460.5224 HMA Pavement 4 LT 58-28 S	2,398.000 TON	_____.	_____.
0020	465.0400 Asphaltic Shoulder Rumble Strips	19,003.000 LF	_____.	_____.
0022	495.1000.S Cold patch	50.000 TON	_____.	_____.
0024	618.0100 Maintenance And Repair of Haul Roads (project) 01. 1112-07-60	1.000 EACH	_____.	_____.
0026	619.1000 Mobilization	1.000 EACH	_____.	_____.
0028	624.0100 Water	3.000 MGAL	_____.	_____.
0030	628.7020 Inlet Protection Type D	65.000 EACH	_____.	_____.
0032	634.0614 Posts Wood 4x6-Inch X 14-FT	17.000 EACH	_____.	_____.



Proposal Schedule of Items

Proposal ID: 20171114035 Project(s): 1112-07-60

Federal ID(s): WISC 2017606

SECTION: 0001 Contract Items

Alt Set ID: Alt Mbr ID:

Proposal Line Number	Item ID Description	Approximate Quantity and Units	Unit Price	Bid Amount
0034	634.0616 Posts Wood 4x6-Inch X 16-FT	10.000 EACH	_____.	_____.
0036	634.0618 Posts Wood 4x6-Inch X 18-FT	41.000 EACH	_____.	_____.
0038	634.0620 Posts Wood 4x6-Inch X 20-FT	16.000 EACH	_____.	_____.
0040	634.0622 Posts Wood 4x6-Inch X 22-FT	13.000 EACH	_____.	_____.
0042	637.2210 Signs Type II Reflective H	961.000 SF	_____.	_____.
0044	637.2215 Signs Type II Reflective H Folding	30.000 SF	_____.	_____.
0046	637.2220 Signs Type II Reflective SH	27.500 SF	_____.	_____.
0048	637.2230 Signs Type II Reflective F	362.000 SF	_____.	_____.
0050	638.2602 Removing Signs Type II	68.000 EACH	_____.	_____.
0052	638.3000 Removing Small Sign Supports	102.000 EACH	_____.	_____.
0054	642.5401 Field Office Type D	1.000 EACH	_____.	_____.
0056	643.0100 Traffic Control (project) 01. 1112-07-60	1.000 EACH	_____.	_____.
0058	643.0300 Traffic Control Drums	43,739.000 DAY	_____.	_____.
0060	643.0420 Traffic Control Barricades Type III	1,080.000 DAY	_____.	_____.
0062	643.0705 Traffic Control Warning Lights Type A	2,160.000 DAY	_____.	_____.
0064	643.0715 Traffic Control Warning Lights Type C	10,309.000 DAY	_____.	_____.
0066	643.0800 Traffic Control Arrow Boards	163.000 DAY	_____.	_____.



Proposal Schedule of Items

Proposal ID: 20171114035 Project(s): 1112-07-60

Federal ID(s): WISC 2017606

SECTION: 0001 Contract Items

Alt Set ID: Alt Mbr ID:

Proposal Line Number	Item ID Description	Approximate Quantity and Units	Unit Price	Bid Amount
0068	643.0900 Traffic Control Signs	1,668.000 DAY	_____.	_____.
0070	643.0920 Traffic Control Covering Signs Type II	136.000 EACH	_____.	_____.
0072	643.1050 Traffic Control Signs PCMS	254.000 DAY	_____.	_____.
0074	646.0106 Pavement Marking Epoxy 4-Inch	1,388.000 LF	_____.	_____.
0076	646.0126 Pavement Marking Epoxy 8-Inch	78.000 LF	_____.	_____.
0078	690.0250 Sawing Concrete	11,000.000 LF	_____.	_____.
0080	SPV.0060 Special 01. Repositioning Traffic Control Devices For Mainline Closures	30.000 EACH	_____.	_____.
0082	SPV.0060 Special 02. Traffic Control Close-Open Freeway Entrance Ramp	30.000 EACH	_____.	_____.
0084	SPV.0060 Special 03. Mobilization For Cold Patch	2.000 EACH	_____.	_____.
0086	SPV.0180 Special 01. Concrete Pavement Repair Overnight	1,915.000 SY	_____.	_____.
0088	SPV.0180 Special 02. Concrete Pavement Replacement Overnight	1,930.000 SY	_____.	_____.
0090	305.0120 Base Aggregate Dense 1 1/4-Inch	19.000 TON	_____.	_____.
0092	420.1000 Continuous Diamond Grinding Concrete Pavement	515.000 SY	_____.	_____.
0094	465.0125 Asphaltic Surface Temporary	3.000 TON	_____.	_____.
0096	650.7000 Construction Staking Concrete Pavement	122.000 LF	_____.	_____.



Proposal Schedule of Items

Proposal ID: 20171114035 Project(s): 1112-07-60

Federal ID(s): WISC 2017606

SECTION: 0001 Contract Items

Alt Set ID: Alt Mbr ID:

Proposal Line Number	Item ID Description	Approximate Quantity and Units	Unit Price	Bid Amount
0098	690.0150 Sawing Asphalt	260.000 LF	_____.	_____.
		Section: 0001	<b>Total:</b>	_____.
			<b>Total Bid:</b>	_____.