



Wisconsin Department of Transportation

March 7, 2018

Division of Transportation Systems Development

Bureau of Project Development
 4802 Sheboygan Avenue, Rm 601
 P O Box 7916
 Madison, WI 53707-7916

Telephone: (608) 266-1631
 Facsimile (FAX): (608) 266-8459

NOTICE TO ALL CONTRACTORS:

Proposal #38: 7110-05-72, WISC 2018 163
Mondovi – Eau Claire
IH 94 To USH 12
STH 37
Eau Claire County

Letting of March 13, 2018

This is Addendum No. 01, which provides for the following:

Schedule of Items:

Revised Bid Item Quantities					
Bid Item	Item Description	Unit	Old Quantity	Revised Quantity	Proposal Total
205.0100	Excavation Common	CY	13,155	11,895	25,050
208.0100	Borrow	CY	9,905	-1,760	8,145

Plan Sheets:

Revised Plan Sheets	
Plan Sheet	Plan Sheet Title (brief description of changes to sheet)
113	Miscellaneous Quantities, Earthwork Summary – Corrected Common Excavation quantity and Borrow quantity, changed the note to add concrete pavement to the quantity of excavation common.
154-156	Plan and Profile sheets for the shared use path, changed the elevations in the data band on the left side to reflect the existing elevation.
307-310	Earthwork Data, corrected to match the new quantities in the earthwork summary. In some tables changed the word unusable to usable.
320-330	Cross Sections, Northbound Roadway – Corrected ditch point elevation label.
362	Cross sections, Short Street – Added slope intercept labels.

Added Plan Sheets	
Plan Sheet	Plan Sheet Title (brief description of why sheet was added)
361A-361B	Cross sections, Short Street – these sheets were mistakenly omitted from the plan.

Schedule of Items

Attached, dated March 7, 2018, are the revised Schedule of Items Pages 1 and 2.

Plan Sheets

The following 8½ x 11-inch sheets are attached and made part of the plans for this proposal:

Revised: 113, 154-156, 307-310, 320-330, and 362.

Added: 361A and 361B.

The responsibility for notifying potential subcontractors and suppliers of these changes remains with the prime contractor.

Sincerely,

Mike Coleman

Proposal Development Specialist
 Proposal Management Section

END OF ADDENDUM

Addendum No. 01
ID 7110-05-72
Revised Sheet 113
March 7, 2018

EARTHWORK SUMMARY

FILL FACTOR = 1.3

CATEGORY	STATION TO STATION	LOCATION	(1) EXCAVATION COMMON			(1) AVAILABLE MATERIAL			EXPANDED FILL			BORROW			WASTE			REMARKS				
			205.0100	205.0100	205.0100	205.0100	205.0100	205.0100	205.0100	205.0100	205.0100	205.0100	205.0100	205.0100	205.0100	205.0100	205.0100		205.0100			
0010	39+25 - 51+00	NB ROADWAY	1,900	850	120	0	0	0	0	0	0	0	0	0	0	0	0	0	0	730		
	51+00 - 84+00	NB ROADWAY	5,030	2,300	8,390	0	0	0	0	0	0	0	0	0	0	0	0	0	0	0	0	
	84+00 - 100+82	NB ROADWAY	2,590	1,230	150	0	0	0	0	0	0	0	0	0	0	0	0	0	0	0	1,080	
	39+25 - 51+00	SB ROADWAY	2,170	0	0	0	0	0	0	0	0	0	0	0	0	0	0	0	0	0	1,220	
	51+00 - 84+00	SB ROADWAY	6,010	3,980	3,910	0	0	0	0	0	0	0	0	0	0	0	0	0	0	0	70	
	84+00 - 101+12	SB ROADWAY	3,040	1,590	560	0	0	0	0	0	0	0	0	0	0	0	0	0	0	0	1,030	
	40+00 - 45+93	CROSSOVER	425	380	110	0	0	0	0	0	0	0	0	0	0	0	0	0	0	0	270	CONSTRUCTION
	94+36 - 99+00	CROSSOVER	660	620	0	0	0	0	0	0	0	0	0	0	0	0	0	0	0	0	620	CONSTRUCTION
	40+00 - 45+93	CROSSOVER	110	110	0	0	0	0	0	0	0	0	0	0	0	0	0	0	0	0	110	REMOVE AND RESTORE
	96+00 - 99+00	CROSSOVER	0	0	520	0	0	0	0	0	0	0	0	0	0	0	0	0	0	0	0	REMOVE AND RESTORE
		ISLAND REMOVALS	190	0	0	0	0	0	0	0	0	0	0	0	0	0	0	0	0	0	0	
		WIDENINGS	240	0	0	0	0	0	0	0	0	0	0	0	0	0	0	0	0	0	0	
		SHORT ST.	280	220	300	0	0	0	0	0	0	0	0	0	0	0	0	0	0	0	0	
		HAMILTON AVE.	1,180	1,080	110	0	0	0	0	0	0	0	0	0	0	0	0	0	0	0	970	
		CRAIG RD.	730	730	100	0	0	0	0	0	0	0	0	0	0	0	0	0	0	0	630	
	CLAIREMONT AVE.	80	80	10	0	0	0	0	0	0	0	0	0	0	0	0	0	0	0	70		
	TOTAL 0010		24,635	14,390	14,280	600	600	7,230														
0030	51+00 - 84+00	NB ROADWAY	0	0	0	0	0	0	0	0	0	0	0	0	0	0	0	0	0	0	6,090	
	233+69 - 251+66	SHARED PATH	135	135	735	600	600	780														
	40+75 - 44+68	SHORT ST.	220	140	920	780	780	75														
	95+50 - 101+25	SIDEWALK	60	60	135	75	75															
		TOTAL 0030		415	7,545																	

(1) ASPHALTIC PAVEMENT AND CONCRETE PAVEMENT ARE INCLUDED IN THE QUANTITY OF EXCAVATION COMMON BUT NOT INCLUDED IN THE QUANTITY OF AVAILABLE MATERIAL.

305-BASE AGGREGATE DENSE

PREPARE FOUNDATION FOR BASE AGGREGATE

CATEGORY	STATION TO STATION	LOCATION	STA	REMARKS
0010	39+25 - 100+82	NB	62	
	39+25 - 101+12	SB	62	
	42+05 - 44+00	SHORT ST.	2	
	TOTAL 0010		126	

CATEGORY	STATION TO STATION	LOCATION	TON	305.0110	TON	305.0120	TON	305.0110	TON	305.0120	MGAL	REMARKS
0010	39+25 - 100+82	NB	375	6,600	6,600	150					150	
	39+25 - 101+12	SB	425	7,425	7,425	150					150	
	25+32 - 26+63	HAMILTON AVE		340	340							
	40+54 - 44+68	SHORT STREET		565	565							
	8+00 - 12+11	CRAIG ROAD		580	580							
		USH 12		55	55							
	TOTAL 0010		800	15,565	15,565	300					300	
0030	51+65 - 251+67	SHARED USE PATH		2,225	2,225							
		SHARED USE PATH		80	80							SHORT ST.
	TOTAL 0030		0	2,305	2,305	0					0	

PROJECT NO: HWY: COUNTY: MISCELLANEOUS QUANTITIES

SHEET: 113

Addendum No. 01
 ID 7110-05-72
 Revised Sheet 154
 March 7, 2018

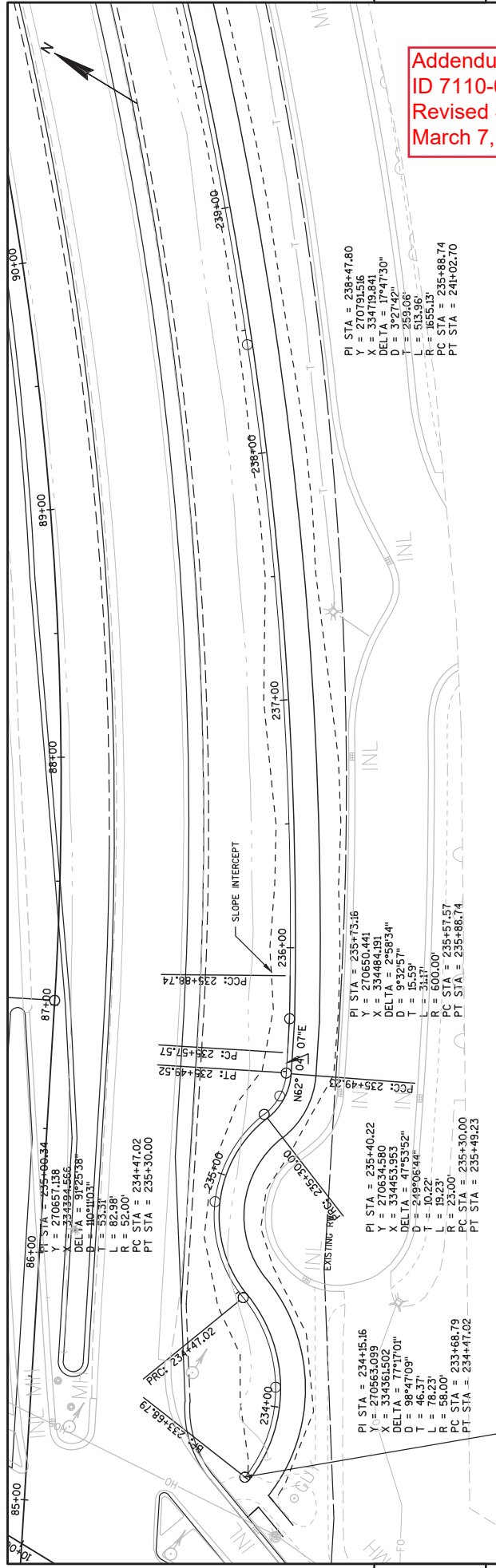

PI STA = 238+47.80
 Y = 2707915.516
 X = 334719.841
 DELTA = 17°47'30"
 D = 3°27'42"
 T = 269.06'
 L = 513.96'
 R = 1855.13'
 PC STA = 235+88.74
 PT STA = 241+02.70

PI STA = 235+73.16
 Y = 270650.441
 X = 334484.191
 DELTA = 18°58'54"
 D = 3°25'57"
 T = 15.59'
 L = 31.17'
 R = 600.00'
 PC STA = 235+57.57
 PT STA = 235+88.74

PI STA = 235+40.22
 Y = 270634.580
 X = 334453.953
 DELTA = 47°53'52"
 D = 2°49'06.44"
 T = 10.22'
 L = 10.22'
 R = 232.00'
 PC STA = 235+30.00
 PT STA = 235+49.23

PI STA = 234+15.16
 Y = 270563.089
 X = 334361.502
 DELTA = 77°17'01"
 D = 98°47'09"
 T = 46.37'
 L = 76.23'
 R = 58.00'
 PC STA = 233+68.79
 PT STA = 234+47.02

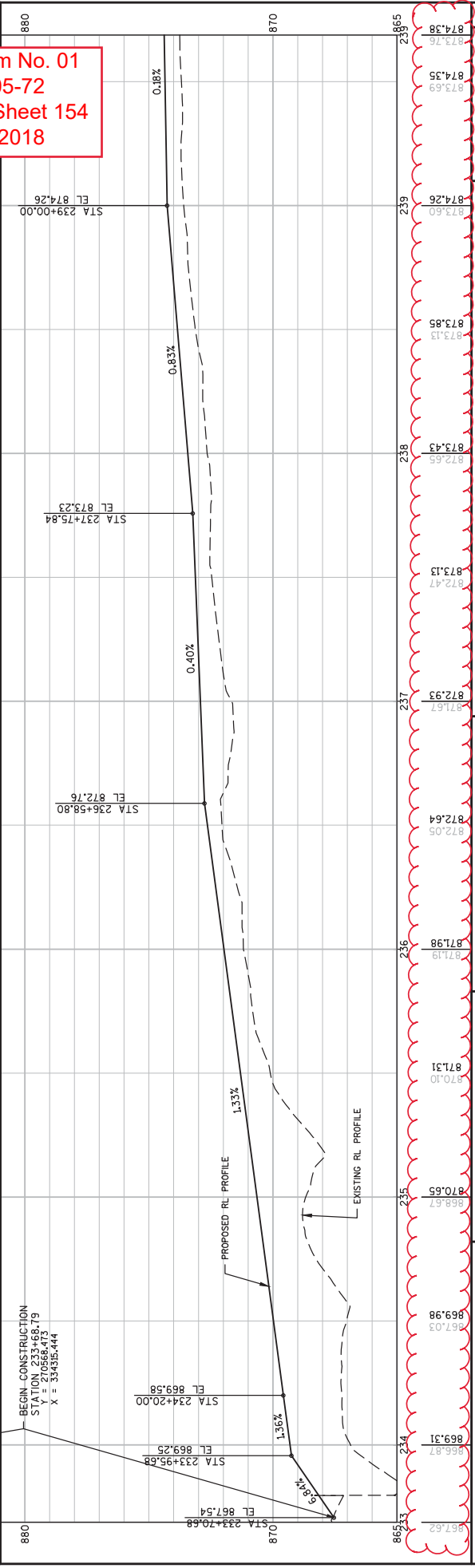

STATION	ELEVATION (EL)	PROFILE TYPE
867.62	867.62	EXISTING R/L PROFILE
867.54	867.54	EXISTING R/L PROFILE
869.25	869.25	EXISTING R/L PROFILE
869.58	869.58	EXISTING R/L PROFILE
869.98	869.98	EXISTING R/L PROFILE
870.10	870.10	EXISTING R/L PROFILE
870.69	870.69	EXISTING R/L PROFILE
871.98	871.98	EXISTING R/L PROFILE
872.05	872.05	EXISTING R/L PROFILE
872.64	872.64	EXISTING R/L PROFILE
872.76	872.76	EXISTING R/L PROFILE
872.93	872.93	EXISTING R/L PROFILE
873.13	873.13	EXISTING R/L PROFILE
873.43	873.43	EXISTING R/L PROFILE
873.69	873.69	EXISTING R/L PROFILE
874.26	874.26	EXISTING R/L PROFILE
874.38	874.38	EXISTING R/L PROFILE

**Addendum No. 01
ID 7110-05-72
Revised Sheet 155
March 7, 2018**

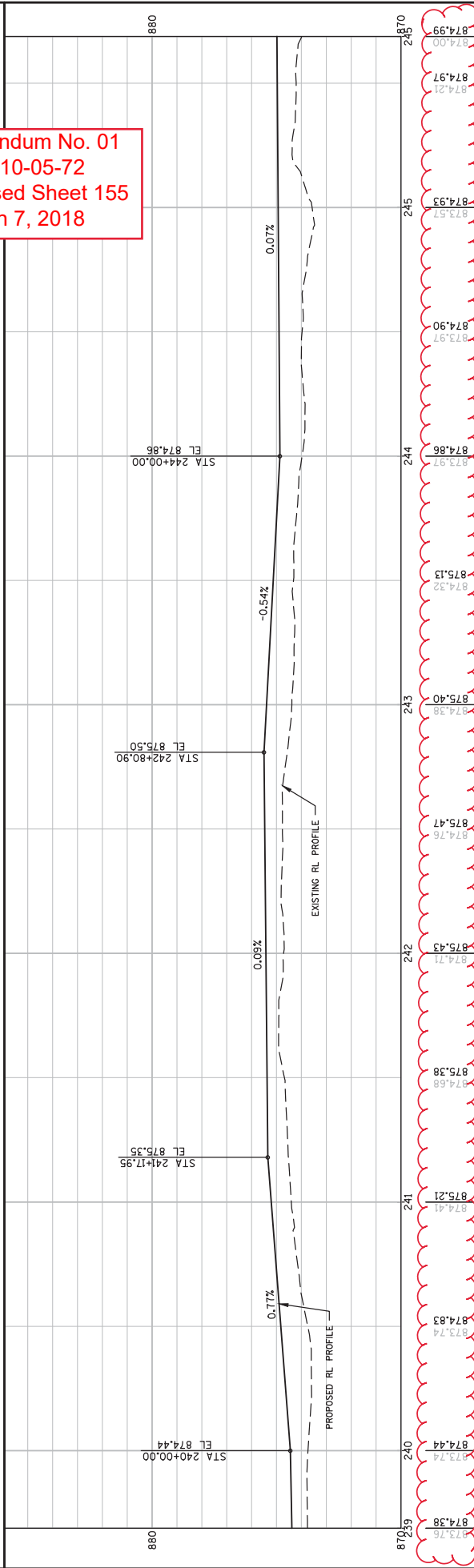
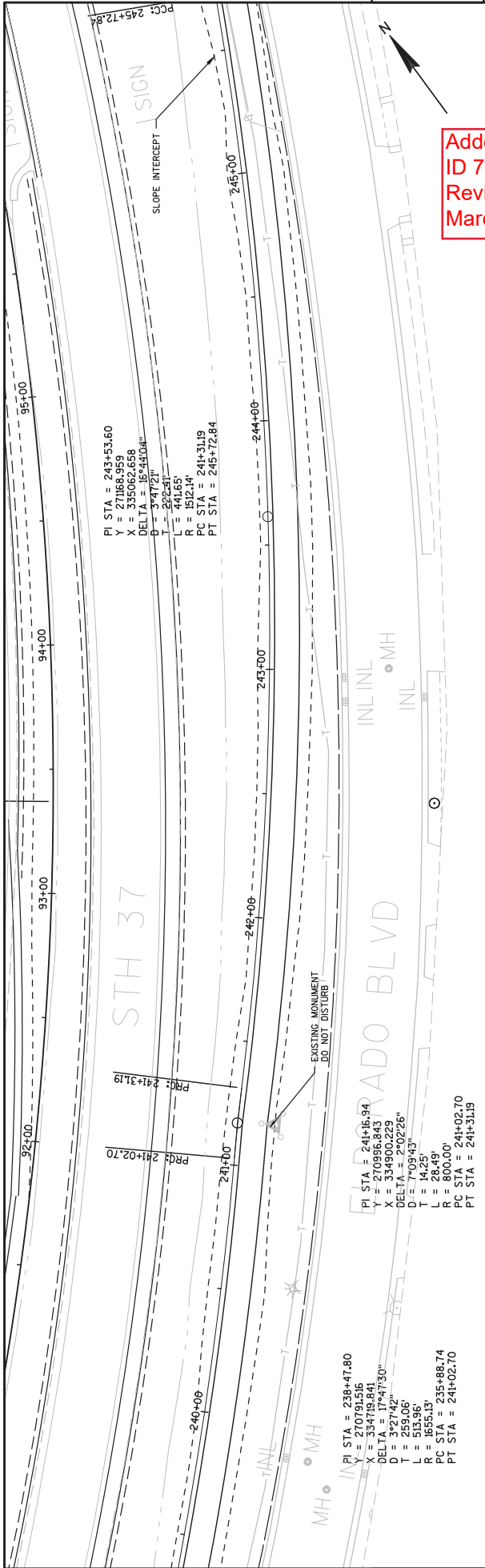

STATION	ELEVATION	SECTION
240+00	874.44	HWY: STH 37
240+10	873.74	
240+20	874.44	
240+30	874.38	
240+40	875.21	
241+00	875.43	COUNTY: EAU CLAIRE
241+10	874.76	
241+20	875.47	
241+30	875.13	
241+40	875.40	
242+00	874.93	PLAN AND PROFILE: SHARED USE PATH
242+10	873.97	
242+20	874.97	
242+30	874.21	
242+40	874.99	
243+00	874.86	SHEET 155
243+10	874.93	
243+20	874.97	
243+30	874.97	
243+40	874.99	
244+00	874.86	E
244+10	874.86	
244+20	874.86	
244+30	874.86	
244+40	874.86	

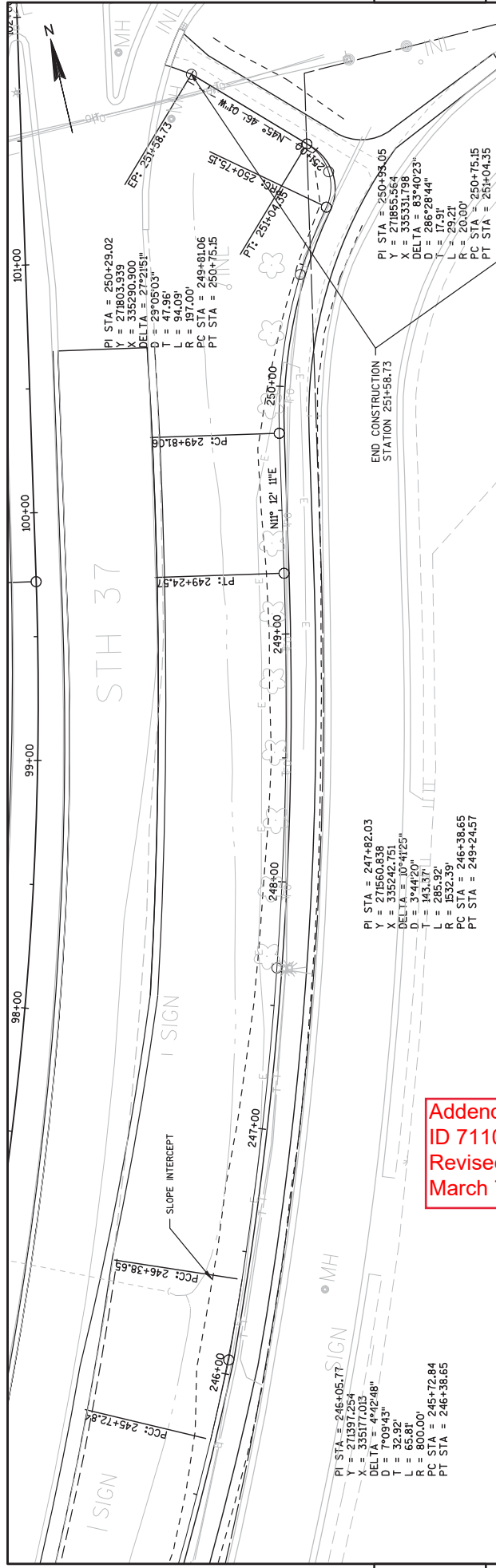

Addendum No. 01
 ID 7110-05-72
 Revised Sheet 156
 March 7, 2018

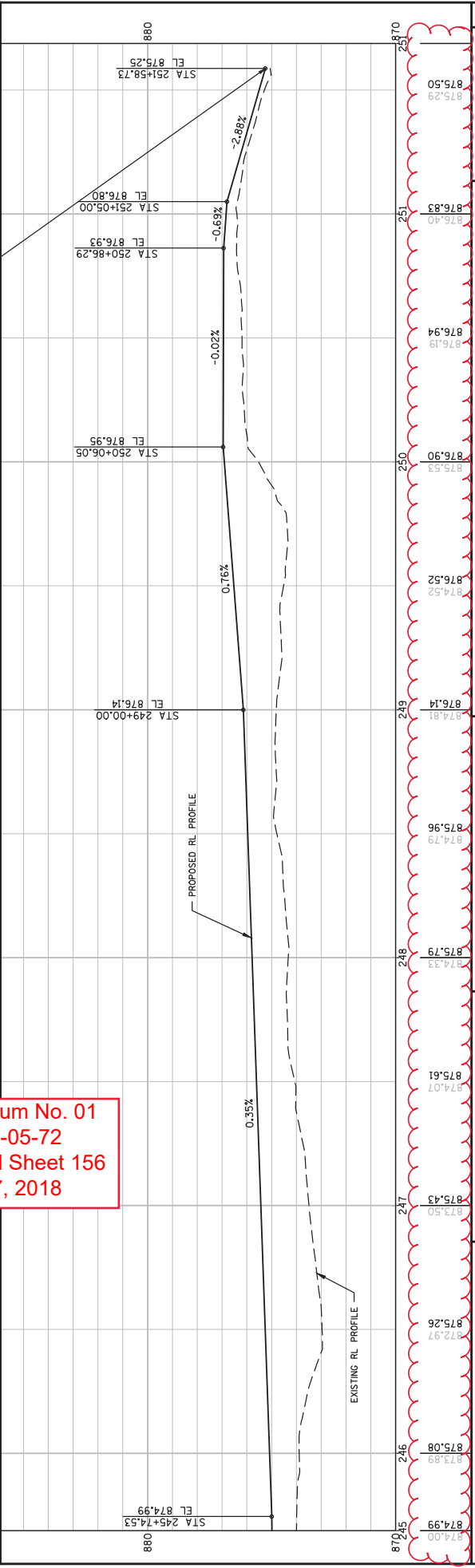

PROJECT NO: 7110-05-72	COUNTY: EAU CLAIRE	HWY: STH 37	PLAN AND PROFILE: SHARED USE PATH	SHEET 156	E
FILE NAME : N:\PDS\33071100502\SHEETS\PLAN\050301_PP.DWG LAYOUT NAME - PATH (3) PLOT DATE : 2/27/2018 12:55 PM PLOT BY : KRUG, GARY W PLOT SCALE : 1 IN=40 FT					WSDOT/CADD SHEET 44

Addendum No. 01
 ID 7110-05-72
 Revised Sheet 307
 March 7, 2018

9

Station	NORTH BOUND ROADWAY			FILL EXPANSION = 1.25			Cum. Net Vol. (CY)		
	Cut Area (SF)	Cut Volume (CY)	Usable Material (CY)	Fill Area (SF)	Fill Volume (CY)	Cum. Usable Vol. (CY)	Cum. Fill Vol. (CY)	Cum. Net Vol. (CY)	
39+25	46.4	0.0	0.0	0.0	0.0	0.0	0.0	0.0	
40+00	57.7	144.6	87.9	0.0	0.0	144.6	0.0	72.2	
41+00	50.6	200.4	124.5	0.0	0.0	345.0	0.0	196.7	
42+00	45.2	177.4	101.4	0.0	0.0	522.4	0.0	298.1	
43+00	39.4	156.7	80.7	0.0	0.0	679.1	0.0	378.8	
44+00	36.7	140.8	64.8	1.8	0.0	819.9	0.0	443.7	
45+00	35.5	133.6	57.7	11.3	24.3	953.6	30.4	471.0	
46+00	33.4	127.6	39.1	10.3	40.1	1081.1	80.5	460.0	
47+00	39.6	135.2	35.5	3.3	25.2	1216.4	111.9	454.0	
48+00	52.3	170.2	31.3	0.0	6.1	1386.5	119.6	477.6	
49+00	57.7	203.6	75.8	0.0	0.0	1590.1	119.6	553.4	
50+00	42.4	185.4	99.3	0.0	0.0	1775.5	119.6	652.6	
51+00	25.2	125.3	58.6	0.0	0.0	1900.8	119.6	711.3	
52+00	20.7	85.0	18.3	0.0	0.0	1985.8	119.6	729.6	
53+00	32.0	97.5	25.2	46.0	85.2	2083.3	226.1	648.4	
54+00	33.0	120.3	44.4	49.5	176.9	2203.6	447.1	471.7	
55+00	36.0	127.8	51.8	39.4	164.6	2331.4	652.9	317.7	
56+00	33.5	128.7	52.7	40.0	147.0	2460.1	836.7	186.6	
57+00	34.8	126.4	50.4	36.7	142.0	2586.5	1014.3	59.5	
58+00	31.2	122.1	46.1	40.0	142.0	2708.6	1191.8	-71.9	
59+00	36.1	124.6	48.6	29.0	127.8	2833.1	1351.5	-183.1	
60+00	31.9	125.9	49.9	11.9	75.7	2959.0	1446.2	-227.8	
61+00	41.5	135.9	59.9	9.8	40.2	3094.9	1496.4	-218.1	
62+00	34.8	141.3	65.3	6.6	30.4	3236.2	1534.4	-190.8	
63+00	34.7	128.6	52.7	5.4	22.2	3364.8	1562.2	-165.9	
64+00	34.0	127.1	51.2	39.7	83.5	3492.0	1666.6	-219.1	
65+00	33.4	124.9	48.9	73.2	209.1	3616.8	1496.4	-431.5	
66+00	36.3	129.1	53.1	89.4	301.1	3745.9	1549.5	-754.8	
67+00	36.5	134.9	58.9	75.1	304.6	3880.8	1608.4	-1076.7	
68+00	37.0	136.2	60.2	55.8	401.7	4017.0	1668.6	-1319.5	
69+00	49.0	159.3	83.3	5.4	113.3	4176.3	1752.0	-1377.8	
70+00	53.6	189.9	114.0	9.5	27.6	4366.2	1865.9	-1298.3	
71+00	52.7	196.8	120.8	2.0	21.3	4563.0	1986.7	-1204.2	
72+00	53.2	196.2	120.2	4.3	11.7	4759.1	2106.9	-1098.5	
73+00	57.8	205.6	129.6	2.2	12.0	4964.8	2236.6	-983.9	
74+00	41.2	183.4	107.4	15.1	32.0	5148.1	2344.0	-916.6	
75+00	38.8	148.2	72.3	66.6	151.3	5296.4	2449.7	-1033.4	
76+00	42.8	151.2	75.2	120.5	346.5	5447.6	2491.5	-1391.3	
77+00	35.4	144.8	68.9	122.0	449.5	5592.4	2560.3	-1883.8	
78+00	44.5	147.9	71.9	103.8	418.1	5740.3	2632.2	-2334.6	
79+00	46.7	168.8	78.8	222.8	604.8	5909.1	2711.0	-3011.8	
80+00	45.4	170.5	66.6	214.0	808.9	6079.6	2777.6	-3956.3	
81+00	51.7	179.8	66.4	158.3	689.4	6259.4	2844.1	-4751.7	
82+00	63.1	212.6	89.5	85.3	451.1	6472.0	2933.6	-5226.1	
83+00	62.2	232.0	98.1	33.4	219.8	6704.1	3031.7	-5402.7	
84+00	58.8	224.0	95.3	0.0	61.9	6928.0	3127.0	-5384.7	
85+00	63.5	226.5	79.3	0.0	0.0	7154.5	3206.3	-5305.5	
86+00	40.8	193.2	61.6	0.0	0.0	7347.7	3267.9	-5243.8	
87+00	41.5	152.4	76.5	0.0	0.0	7500.1	3344.4	-5167.3	
88+00	43.0	156.5	80.5	0.0	0.0	7656.6	3424.9	-5086.8	
89+00	42.3	157.9	81.9	0.0	0.0	7814.6	3506.9	-5004.9	
90+00	43.2	158.3	82.4	0.0	0.0	7972.9	3589.2	-4922.5	
91+00	41.4	155.0	79.0	0.0	0.0	8131.2	3671.6	-4840.1	
92+00	41.4	153.1	77.2	0.0	0.0	8286.2	3750.6	-4762.1	
93+00	41.3	153.1	77.2	0.0	0.0	8439.4	3827.8	-4683.9	
94+00	41.6	153.7	77.7	0.0	0.0	8592.5	3905.0	-4606.7	
95+00	41.8	154.4	78.5	0.0	0.0	8746.2	3982.7	-4529.0	
96+00	41.8	154.4	78.5	0.0	0.0	8900.7	4061.2	-4450.5	
97+00	40.0	151.5	79.2	0.0	0.0	9052.1	4140.4	-4371.3	
98+00	38.7	145.7	73.5	5.9	10.9	9197.9	4213.9	-4311.5	
99+00	32.7	132.2	62.8	26.0	59.1	9330.1	4276.6	-4322.6	
100+00	35.1	125.6	56.1	0.0	48.1	9455.7	4332.7	-4326.7	
100+50	35.0	64.9	28.8	0.0	0.0	9520.6	4361.5	-4297.9	

HAMILTON AVE

CRAIG ROAD

PROJECT NO: 7110-05-72 COUNTY: EAU CLAIRE HWY: STH 37 EARTHWORK TABULATIONS SHEET: 307

FILENAME: N:\PDS\030200_mq.ppk PLOT DATE: June 14, 1911 PLOT NAME: PLOT SCALE: 1:1

9

Addendum No. 01
 ID 7110-05-72
 Revised Sheet 308
 March 7, 2018

9

Station	Cut Area (SF)	Cut Volume (CY)	Usable Material (CY)	Fill Area (SF)	Fill Volume (CY)	SOUTH BOUND ROADWAY	Cum. Cut Vol. (CY)	Cum. Usable Vol. (CY)	Cum. Fill Vol. (CY)	FILL EXPANSION = 1.25	Cum. Net Vol. (CY)
39+25	65.4	0.0	0.0	0.0	0.0		0.0	0.0	0.0	0.0	0.0
40+00	63.4	178.9	101.0	0.0	0.0		178.9	0.0	0.0	0.0	101.0
41+00	52.1	213.9	126.2	0.0	0.0		342.8	0.0	0.0	0.0	227.2
42+00	51.3	191.5	115.5	0.0	0.0		534.3	0.0	0.0	0.0	342.7
43+00	50.0	187.6	111.6	0.0	0.0		721.9	0.0	0.0	0.0	454.4
44+00	48.6	182.6	106.6	0.0	0.0		904.5	0.0	0.0	0.0	561.0
45+00	49.8	182.2	106.3	0.0	0.0		1086.7	0.0	0.0	0.0	667.3
46+00	51.0	186.7	110.7	0.0	0.0		1273.4	0.0	0.0	0.0	778.0
47+00	49.1	185.4	109.4	0.0	0.0		1462.8	0.0	0.0	0.0	887.4
48+00	47.8	179.4	103.5	0.0	0.0		1642.2	0.0	0.0	0.0	990.8
49+00	46.8	175.2	102.9	0.0	0.0		1817.4	0.0	0.0	0.0	1093.8
50+00	41.4	163.3	80.2	0.0	0.0		1980.7	0.0	0.0	0.0	1173.9
51+00	37.4	145.9	46.1	0.0	0.0		2126.6	0.0	0.0	0.0	1220.0
52+00	41.4	145.9	43.1	0.0	0.0		2272.5	0.0	0.0	0.0	1263.2
53+00	53.3	179.1	76.3	0.0	0.0		2451.6	0.0	0.0	0.0	1339.5
54+00	64.8	222.4	116.8	0.0	0.0		2674.0	0.0	0.0	0.0	1425.5
55+00	55.0	221.9	122.5	0.0	0.0		2895.9	0.0	0.0	0.0	1441.1
56+00	52.8	199.6	111.8	0.0	0.0		3095.7	0.0	0.0	0.0	1365.6
57+00	61.6	212.2	134.8	0.0	0.0		3230.5	0.0	0.0	0.0	1399.9
58+00	60.6	226.7	150.7	0.0	0.0		3381.2	0.0	0.0	0.0	1427.7
59+00	66.0	234.4	158.5	0.0	0.0		3539.7	0.0	0.0	0.0	1548.4
60+00	61.7	236.5	160.0	0.0	0.0		3700.2	0.0	0.0	0.0	1704.7
61+00	61.5	228.1	152.2	0.0	0.0		3852.4	0.0	0.0	0.0	1865.2
62+00	78.6	259.4	183.5	0.0	0.0		4035.9	0.0	0.0	0.0	2017.4
63+00	75.5	285.4	209.4	0.0	0.0		4245.3	0.0	0.0	0.0	2200.9
64+00	69.1	267.7	191.7	0.0	0.0		4437.0	0.0	0.0	0.0	2410.3
65+00	59.9	238.8	162.8	0.0	0.0		4600.0	0.0	0.0	0.0	2602.0
66+00	58.3	218.9	142.9	0.0	0.0		4742.9	0.0	0.0	0.0	2764.8
67+00	70.7	238.9	162.9	0.0	0.0		4905.8	0.0	0.0	0.0	2907.8
68+00	67.4	255.7	179.8	0.0	0.0		5085.6	0.0	0.0	0.0	3070.7
69+00	56.1	228.7	152.7	0.0	0.0		5238.3	0.0	0.0	0.0	3250.5
70+00	52.8	201.7	125.7	0.0	0.0		5364.0	0.0	0.0	0.0	3403.2
71+00	55.1	199.8	123.8	0.0	0.0		5487.8	0.0	0.0	0.0	3528.9
72+00	56.7	207.0	131.1	0.0	0.0		5618.9	0.0	0.0	0.0	3652.7
73+00	58.2	212.8	136.8	0.0	0.0		5755.7	0.0	0.0	0.0	3783.8
74+00	55.3	210.2	134.2	0.0	0.0		5890.0	0.0	0.0	0.0	3920.6
75+00	49.6	194.3	118.3	0.0	0.0		6084.3	0.0	0.0	0.0	4054.8
76+00	48.6	181.9	105.9	0.0	0.0		6266.2	0.0	0.0	0.0	4173.1
77+00	38.2	160.7	84.8	0.0	0.0		6427.0	0.0	0.0	0.0	4279.0
78+00	29.7	125.7	49.8	0.0	0.0		6552.7	0.0	0.0	0.0	4355.5
79+00	27.1	105.2	29.2	0.0	0.0		6658.0	0.0	0.0	0.0	4382.8
80+00	21.8	90.6	14.6	0.0	0.0		6772.6	0.0	0.0	0.0	4376.1
81+00	30.3	96.5	146.0	0.0	0.0		6918.6	0.0	0.0	0.0	4306.2
82+00	55.7	159.3	83.3	0.0	0.0		7077.9	0.0	0.0	0.0	3926.0
83+00	35.1	168.1	174.4	0.0	0.0		7252.3	0.0	0.0	0.0	3267.7
84+00	70.0	194.6	352.0	0.0	0.0		7604.3	0.0	0.0	0.0	2141.3
85+00	36.0	196.3	118.7	0.0	0.0		7723.0	0.0	0.0	0.0	1290.3
86+00	53.3	165.4	57.0	0.0	0.0		7888.4	0.0	0.0	0.0	1245.6
87+00	59.6	209.1	84.1	0.0	0.0		8002.5	0.0	0.0	0.0	1302.7
88+00	60.9	223.1	97.2	0.0	0.0		8105.7	0.0	0.0	0.0	1379.1
89+00	52.1	209.3	112.9	0.0	0.0		8218.0	0.0	0.0	0.0	1429.5
90+00	49.6	188.3	112.4	0.0	0.0		8330.4	0.0	0.0	0.0	1457.5
91+00	47.7	180.2	104.2	0.0	0.0		8434.6	0.0	0.0	0.0	1486.7
92+00	47.1	175.6	99.6	0.0	0.0		8534.2	0.0	0.0	0.0	1513.4
93+00	45.8	172.0	96.1	0.0	0.0		8630.3	0.0	0.0	0.0	1541.5
94+00	44.0	166.3	90.3	0.0	0.0		8720.6	0.0	0.0	0.0	1606.3
95+00	41.1	157.6	81.6	0.0	0.0		8802.2	0.0	0.0	0.0	1696.6
96+00	40.3	150.7	74.8	0.0	0.0		8877.0	0.0	0.0	0.0	1778.2
97+00	38.5	145.9	70.0	0.0	0.0		8946.9	0.0	0.0	0.0	1853.0
98+00	40.4	146.1	70.1	0.0	0.0		9017.0	0.0	0.0	0.0	1923.0
99+00	51.3	169.8	93.8	0.0	0.0		9110.8	0.0	0.0	0.0	1993.1
100+00	55.4	187.6	121.6	0.0	0.0		9232.4	0.0	0.0	0.0	2087.0
101+00	46.1	188.0	112.0	0.0	0.0		9344.4	0.0	0.0	0.0	2208.6

HAMILTON AVENUE

CRALIG ROAD

PROJECT NO: 7110-05-72

HWY: STH 37

COUNTY: EAU CLAIRE

EARTHWORK TABULATIONS

SHEET: 308

FILE NAME: N:\PDS\1030200_mq.ppk PLOT DATE: June 14, 1911 PLOT BY: A.R.H. PLOT SCALE: 1:1

9

Addendum No. 01
 ID 7110-05-72
 Revised Sheet 309
 March 7, 2018

Station	SHARED PATH			SHARED PATH			SHARED PATH			SHARED PATH		
	Cut Area (SF)	Cut Volume (CY)	Usable Material (CY)	Fill Area (SF)	Fill Volume (CY)	Fill Volume (CY)	Cum. Cut Vol. (CY)	Cum. Cut Vol. (CY)	Cum. Usable Vol. (CY)	Cum. Fill Vol. (CY)	Cum. Net Vol. (CY)	
234+00	0.6	0.0	0.0	28.5	0.0	0.0	0.0	0.0	0.0	0.0	0.0	
235+00	1.1	1.1	1.1	32.1	112.2	112.2	1.1	1.1	1.1	140.3	-139.2	
236+00	3.0	5.6	5.6	8.1	74.4	74.4	6.7	6.7	6.7	233.3	-226.7	
237+00	0.7	6.9	6.9	10.8	35.0	35.0	13.5	13.5	13.5	277.1	-263.6	
238+00	1.7	4.4	4.4	5.2	29.6	29.6	18.0	18.0	18.0	314.1	-296.2	
239+00	2.4	7.6	7.6	4.3	17.6	17.6	25.6	25.6	25.6	336.1	-310.6	
240+00	2.7	9.4	9.4	4.1	15.6	15.6	35.0	35.0	35.0	373.6	-320.6	
241+00	4.4	13.1	13.1	3.7	14.4	14.4	48.1	48.1	48.1	425.3	-325.3	
242+00	4.1	15.7	15.7	4.0	14.3	14.3	63.9	63.9	63.9	489.2	-327.5	
243+00	0.0	7.6	7.6	6.7	19.8	19.8	71.5	71.5	71.5	560.7	-344.7	
244+00	0.0	0.0	0.0	5.6	22.8	22.8	77.1	77.1	77.1	637.8	-373.2	
245+00	0.0	0.0	0.0	10.8	30.4	30.4	87.9	87.9	87.9	725.7	-411.2	
246+00	4.1	7.6	7.6	9.5	37.6	37.6	97.4	97.4	97.4	823.1	-450.6	
247+00	1.8	9.1	9.1	15.1	45.6	45.6	112.5	112.5	112.5	935.6	-498.4	
248+00	1.8	4.8	4.8	4.8	27.0	27.0	117.3	117.3	117.3	1052.9	-547.1	
249+00	3.6	10.0	10.0	6.6	27.0	27.0	123.9	123.9	123.9	1176.8	-570.9	
250+00	3.9	13.9	13.9	5.8	23.0	23.0	129.7	129.7	129.7	1306.5	-585.7	
251+00	3.6	13.9	13.9	3.4	17.0	17.0	133.1	133.1	133.1	1439.6	-593.1	
251+50	0.0	3.3	3.3	6.6	9.3	9.3	139.7	139.7	139.7	1579.3	-601.3	

Station	SIDEWALK			SIDEWALK			SIDEWALK			SIDEWALK		
	Cut Area (SF)	Cut Volume (CY)	Usable Material (CY)	Fill Area (SF)	Fill Volume (CY)	Fill Volume (CY)	Cum. Cut Vol. (CY)	Cum. Cut Vol. (CY)	Cum. Usable Vol. (CY)	Cum. Fill Vol. (CY)	Cum. Net Vol. (CY)	
96+00	2.10	0.0	0.0	11.70	0.0	0.0	0.0	0.0	0.0	0.0	0.0	
97+00	2.50	8.5	8.5	7.40	35.4	35.4	8.5	8.5	8.5	44.2	-35.7	
98+00	4.70	13.3	13.3	2.10	17.6	17.6	21.9	21.9	21.9	66.2	-44.4	
99+00	6.30	20.4	20.4	1.10	5.9	5.9	42.2	42.2	42.2	111.4	-31.4	
100+00	0.00	11.7	11.7	11.00	22.4	22.4	53.9	53.9	53.9	165.3	-47.7	
101+00	2.10	3.9	3.9	2.72	25.4	25.4	57.8	57.8	57.8	223.1	-75.6	

Station	HAMILTON AVE. LEFT			HAMILTON AVE. LEFT			HAMILTON AVE. LEFT			HAMILTON AVE. LEFT		
	Cut Area (SF)	Cut Volume (CY)	Usable Material (CY)	Fill Area (SF)	Fill Volume (CY)	Fill Volume (CY)	Cum. Cut Vol. (CY)	Cum. Cut Vol. (CY)	Cum. Usable Vol. (CY)	Cum. Fill Vol. (CY)	Cum. Net Vol. (CY)	
1+00	0.0	0.0	0.0	0.0	0.0	0.0	0.0	0.0	0.0	0.0	0.0	
1+25	87.7	40.6	30.5	0.0	0.0	0.0	40.6	40.6	30.5	0.0	30.5	
1+50	165.3	117.1	105.3	0.0	0.0	0.0	157.7	157.7	135.8	0.0	135.8	
1+75	219.3	178.0	163.7	0.0	0.0	0.0	355.8	355.8	299.6	0.0	299.6	
2+00	163.3	177.1	155.6	0.0	0.0	0.0	512.9	512.9	455.2	0.0	455.2	
2+25	168.3	153.5	153.5	9.1	4.2	4.2	666.4	666.4	608.7	5.3	603.4	
2+50	1.6	78.7	78.7	33.3	19.6	19.6	745.1	745.1	687.4	29.8	657.6	
2+80	4.7	3.5	3.5	34.2	31.3	31.3	748.6	748.6	690.9	68.9	622.0	

Station	HAMILTON AVE. RIGHT			HAMILTON AVE. RIGHT			HAMILTON AVE. RIGHT			HAMILTON AVE. RIGHT		
	Cut Area (SF)	Cut Volume (CY)	Usable Material (CY)	Fill Area (SF)	Fill Volume (CY)	Fill Volume (CY)	Cum. Cut Vol. (CY)	Cum. Cut Vol. (CY)	Cum. Usable Vol. (CY)	Cum. Fill Vol. (CY)	Cum. Net Vol. (CY)	
0+10	9.3	0.0	0.0	7.2	0.0	0.0	0.0	0.0	0.0	0.0	0.0	
0+25	10.1	5.4	5.4	7.6	11.0	11.0	5.4	5.4	5.4	13.7	-8.3	
0+50	21.4	16.4	16.4	8.6	21.8	21.8	21.8	21.8	32.5	32.5	-10.7	
0+75	50.8	42.7	42.7	0.0	8.0	8.0	64.6	64.6	64.6	42.5	22.1	
1+00	109.4	95.8	84.5	0.0	0.0	0.0	160.3	160.3	149.1	42.5	106.6	
1+25	125.6	145.8	138.3	0.0	0.0	0.0	306.1	306.1	287.4	42.5	244.9	
1+50	33.8	86.7	79.5	0.0	0.0	0.0	392.8	392.8	366.9	42.5	324.4	
1+75	26.5	27.9	20.8	0.0	0.0	0.0	420.7	420.7	387.7	42.5	345.2	
1+88	25.2	12.4	5.3	0.0	0.0	0.0	433.2	433.2	393.0	42.5	350.5	

Addendum No. 01
ID 7110-05-72
Revised Sheet 310
March 7, 2018

Station	SHORT STREET			RIGHT			FILL EXPANSION = 1.25			
	Cut Area (SF)	Cut Volume (CY)	Usable Material (CY)	Fill Area (SF)	Fill Volume (CY)	FILL Volume (CY)	Cum. Cut Vol. (CY)	Cum. Usable Vol. (CY)	Cum. Fill Vol. (CY)	Cum. Net Vol. (CY)
40+75	14.7	0.0	0.0	0.0	0.0	0.0	0.0	0.0	0.0	0.0
41+00	15.8	14.1	14.1	0.0	0.1	14.1	14.1	14.1	0.1	14.0
42+00	11.5	50.6	50.6	0.2	22.6	64.7	22.6	64.7	28.4	36.3
43+00	19.8	58.0	58.0	12.0	62.5	122.7	122.6	106.6	16.1	16.1
43+25	17.8	17.4	17.4	21.8	10.1	140.0	140.0	140.1	119.2	20.9
5+00	18.2	0.0	0.0	0.0	0.0	0.0	0.0	0.0	0.0	0.0
5+50	31.6	46.1	29.4	22.2	20.6	46.1	46.1	25.7	25.7	3.7
6+00	35.6	62.2	45.5	56.0	72.4	108.3	108.3	74.9	116.2	-41.3
6+25	19.6	25.6	8.9	33.0	41.2	133.9	133.9	83.8	167.7	-83.9
6+36	19.0	7.9	0.0	29.8	12.8	141.8	141.8	83.8	183.7	-99.9
Station	SHORT STREET			LEFT			FILL EXPANSION = 1.25			
	Cut Area (SF)	Cut Volume (CY)	Usable Material (CY)	Fill Area (SF)	Fill Volume (CY)	FILL Volume (CY)	Cum. Cut Vol. (CY)	Cum. Usable Vol. (CY)	Cum. Fill Vol. (CY)	Cum. Net Vol. (CY)
7+00	16.3	0.0	0.0	109.8	0.0	0.0	0.0	0.0	0.0	0.0
7+50	24.4	37.7	21.0	156.5	246.6	37.7	37.7	21.0	308.2	-287.2
8+00	23.2	44.1	27.4	84.2	222.9	81.8	81.8	48.4	586.8	-538.4
8+50	27.0	46.5	29.8	64.9	138.1	128.2	128.2	78.1	759.4	-681.2
9+00	24.3	47.5	30.8	33.4	91.0	175.7	175.7	108.9	873.1	-764.2
9+50	23.7	44.4	27.7	3.7	34.4	220.2	220.2	136.7	916.1	-779.4

Station	CRAIG ROAD			RIGHT			FILL EXPANSION = 1.25			
	Cut Area (SF)	Cut Volume (CY)	Usable Material (CY)	Fill Area (SF)	Fill Volume (CY)	FILL Volume (CY)	Cum. Cut Vol. (CY)	Cum. Usable Vol. (CY)	Cum. Fill Vol. (CY)	Cum. Net Vol. (CY)
13+00	11.4	0.0	0.0	0.0	0.0	0.0	0.0	0.0	0.0	0.0
13+50	19.6	28.7	28.7	0.0	0.0	28.7	28.7	28.7	0.0	28.7
14+00	49.6	64.1	64.1	0.0	0.0	92.8	92.8	92.8	0.0	92.8
14+25	32.3	37.9	37.9	0.0	0.0	130.7	130.7	130.7	0.0	130.7
16+75	38.8	0.0	0.0	0.0	0.0	130.7	130.7	130.7	0.0	130.7
17+00	29.7	31.7	31.7	0.0	0.0	162.4	162.4	162.4	0.0	162.4
17+50	44.6	68.8	68.8	0.0	0.0	231.2	231.2	231.2	0.0	231.2
18+00	56.6	93.7	93.7	0.0	0.0	324.9	324.9	324.9	0.0	324.9
20+25	18.9	0.0	0.0	18.4	0.0	324.9	324.9	324.9	0.0	324.9
20+50	46.6	30.3	30.3	47.8	0.0	355.2	355.2	355.2	38.3	316.9
21+00	36.6	77.0	77.0	2.2	46.3	432.3	432.3	432.3	96.2	336.1
21+25	40.0	35.5	35.5	0.0	0.0	467.7	467.7	467.7	98.7	369.0
25+25	37.7	0.0	0.0	0.0	0.0	467.7	467.7	467.7	98.7	369.0
25+50	38.4	35.2	35.2	0.0	0.0	503.0	503.0	503.0	98.7	404.2
26+00	51.9	83.6	83.6	0.0	0.0	586.6	586.6	586.6	98.7	487.8
26+50	61.3	104.8	104.8	0.0	0.0	691.4	691.4	691.4	98.7	592.7
26+75	26.0	40.4	40.4	0.0	0.0	731.8	731.8	731.8	98.7	633.1

Addendum No. 01
 ID 7110-05-72
 Revised Sheet 320
 March 7, 2018

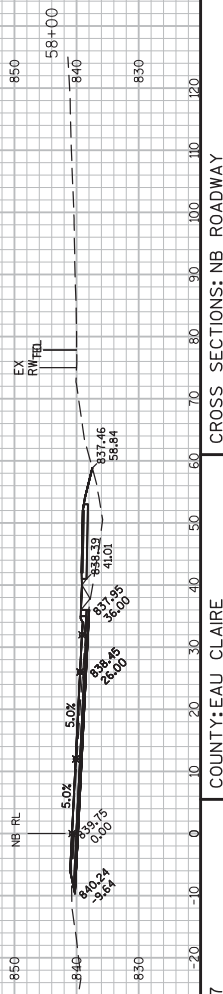
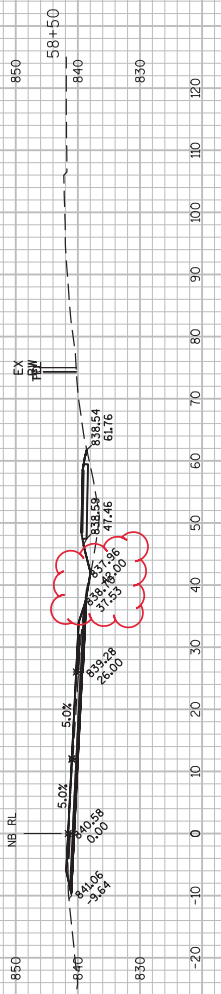
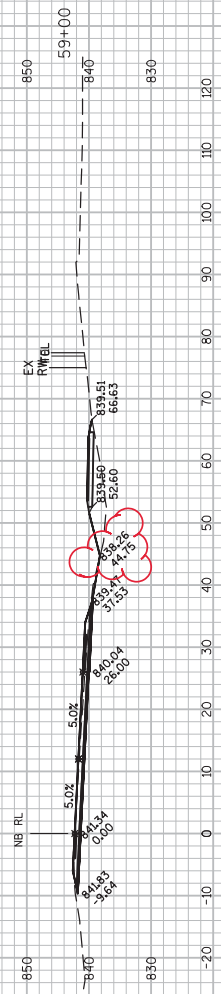

20 FT
 20 FT

Addendum No. 01
 ID 7110-05-72
 Revised Sheet 321
 March 7, 2018

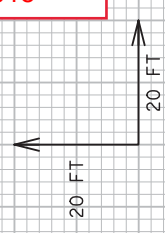
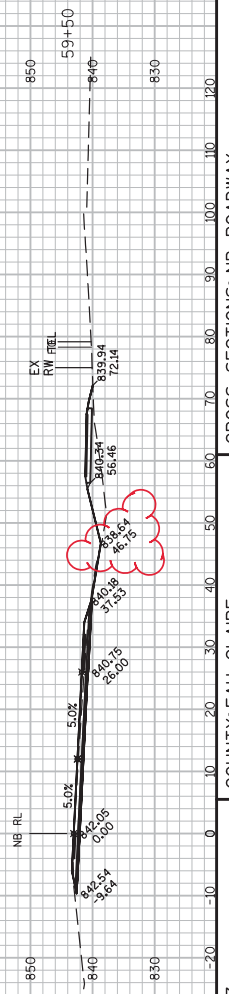
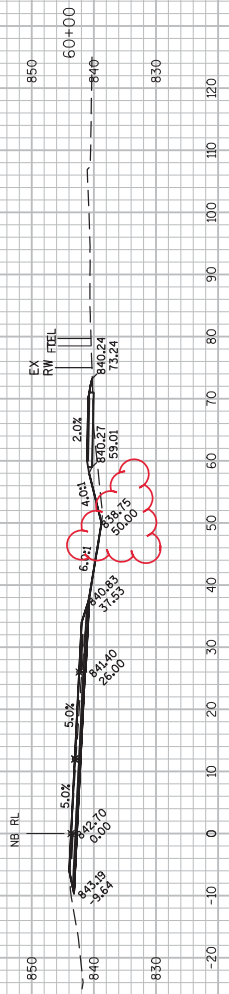
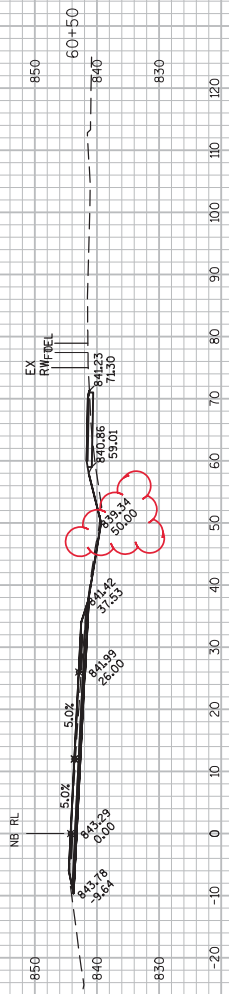

Addendum No. 01
 ID 7110-05-72
 Revised Sheet 322
 March 7, 2018

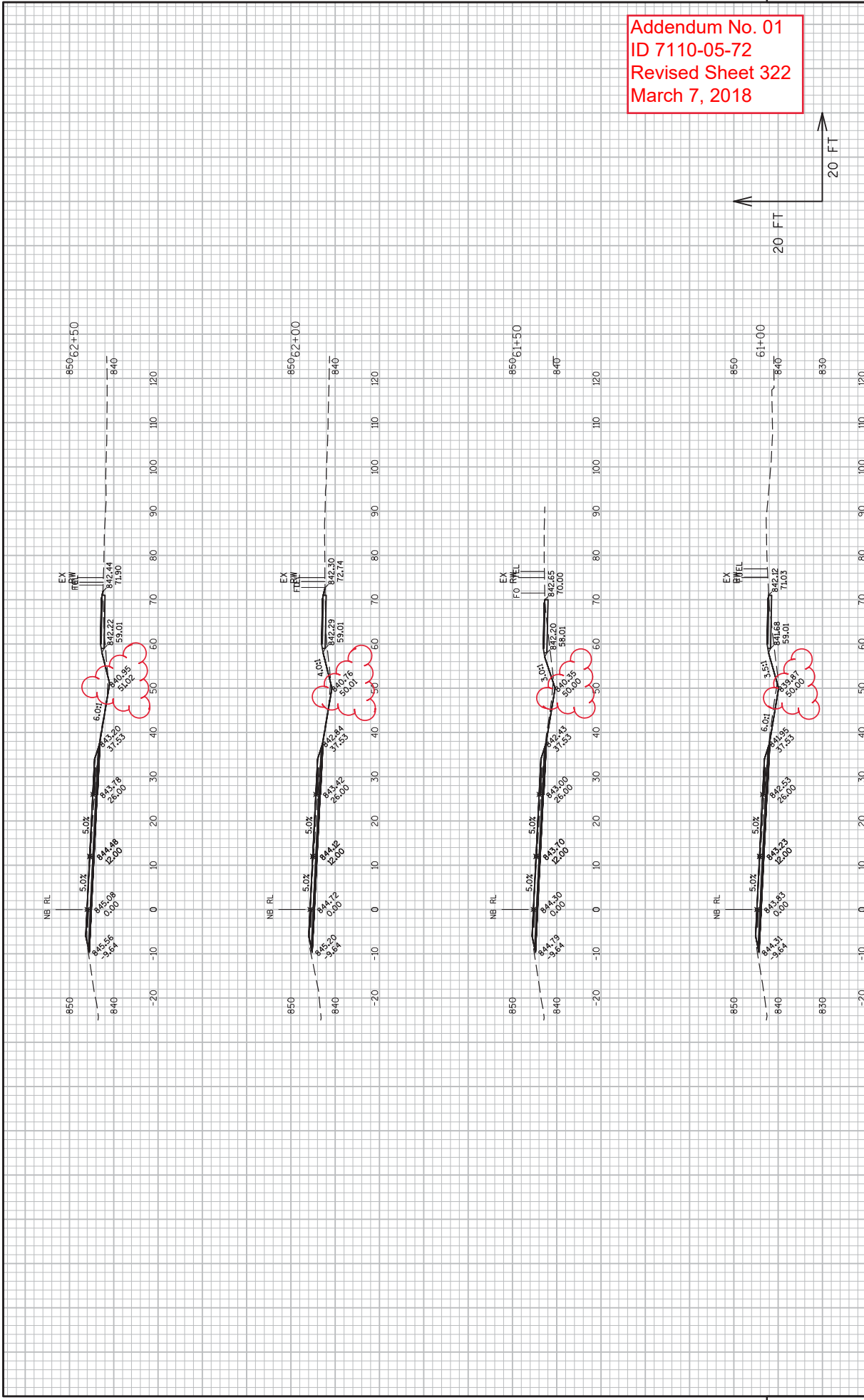

Addendum No. 01
 ID 7110-05-72
 Revised Sheet 323
 March 7, 2018

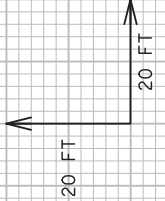
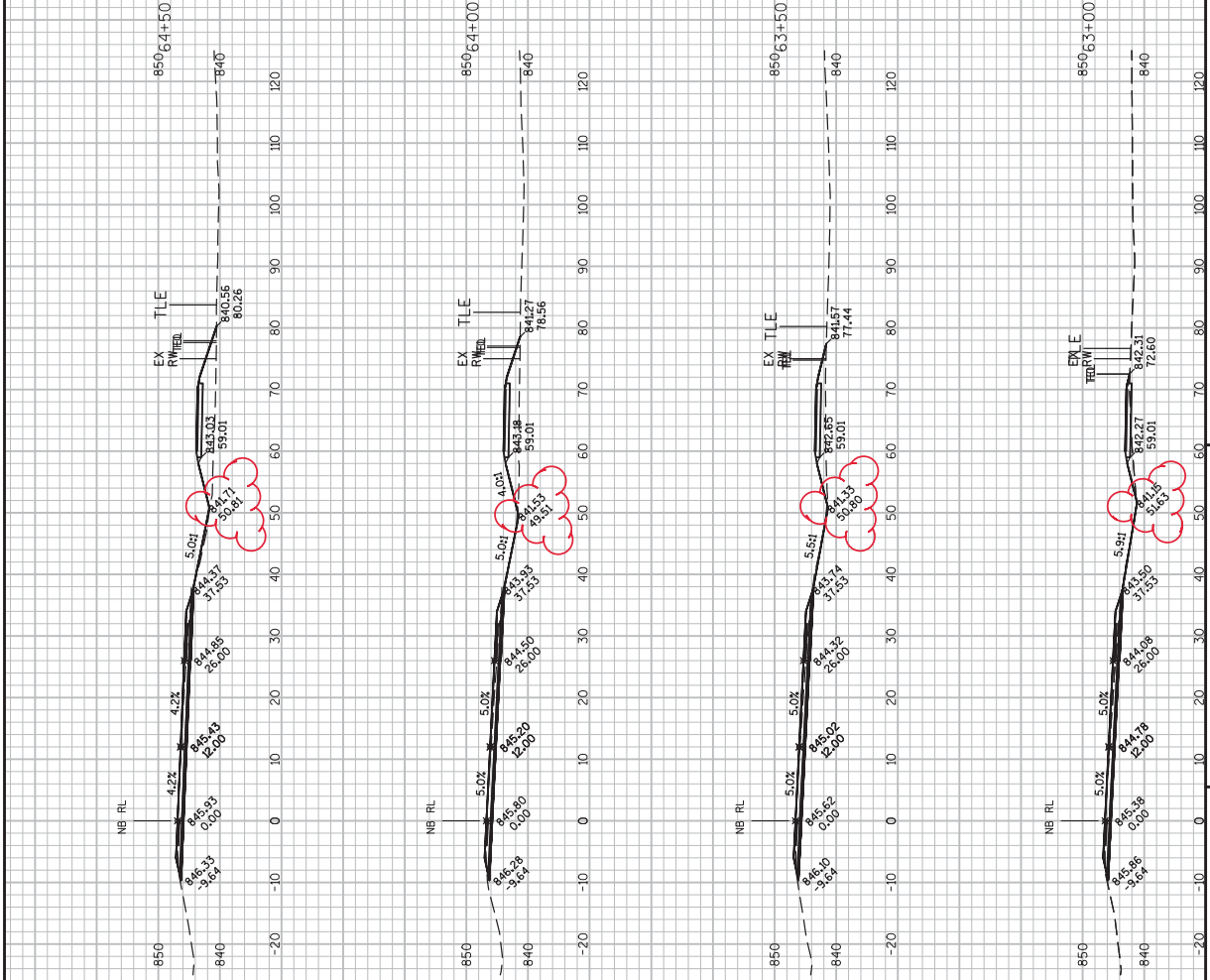

Addendum No. 01
 ID 7110-05-72
 Revised Sheet 324
 March 7, 2018

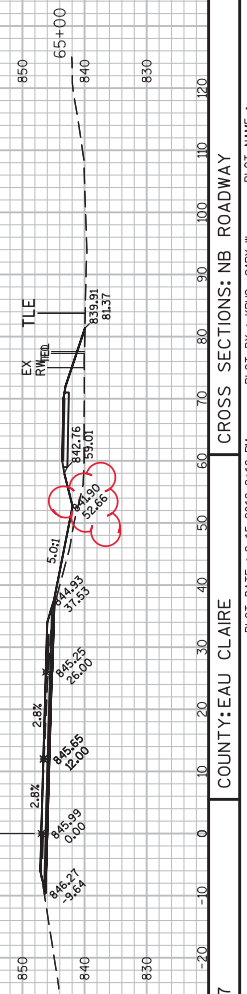
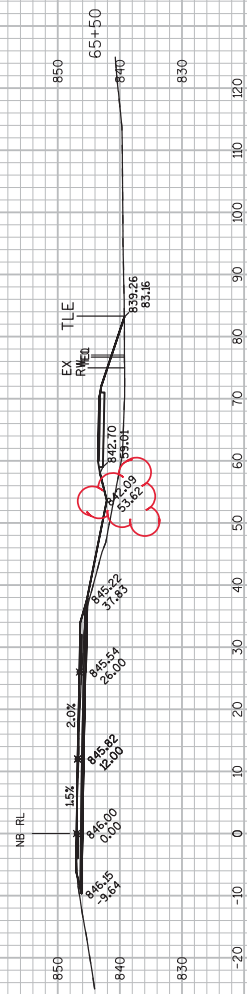
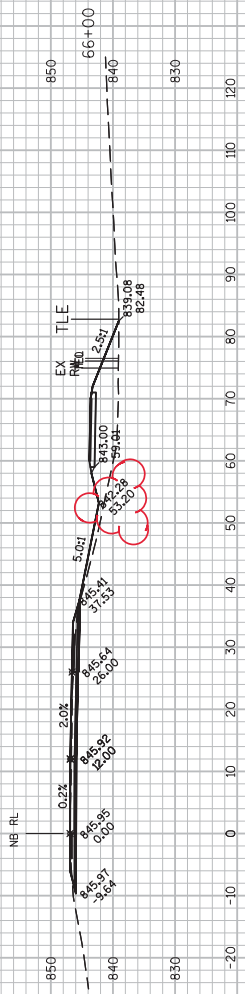

Addendum No. 01
 ID 7110-05-72
 Revised Sheet 325
 March 7, 2018

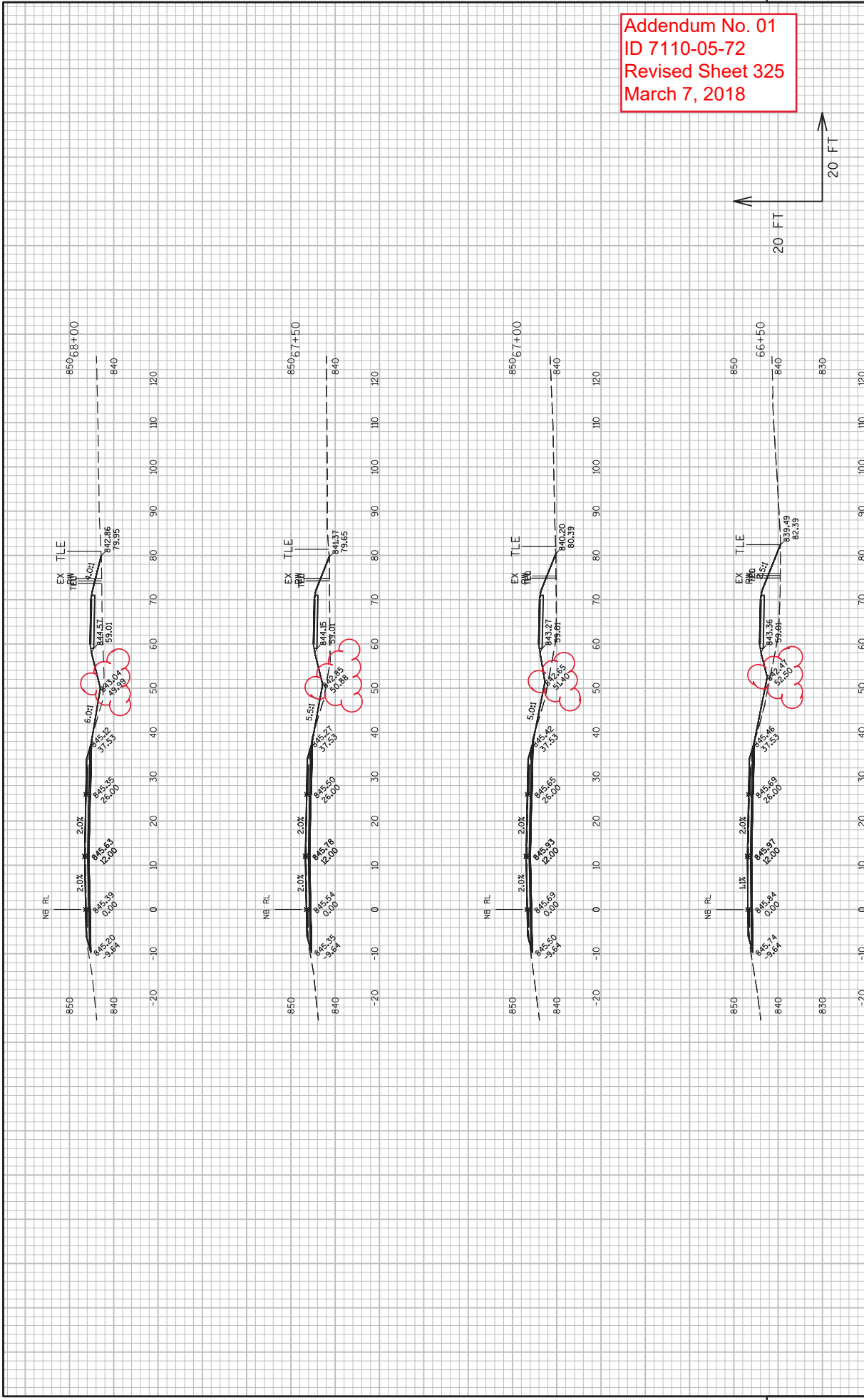

Addendum No. 01
 ID 7110-05-72
 Revised Sheet 326
 March 7, 2018

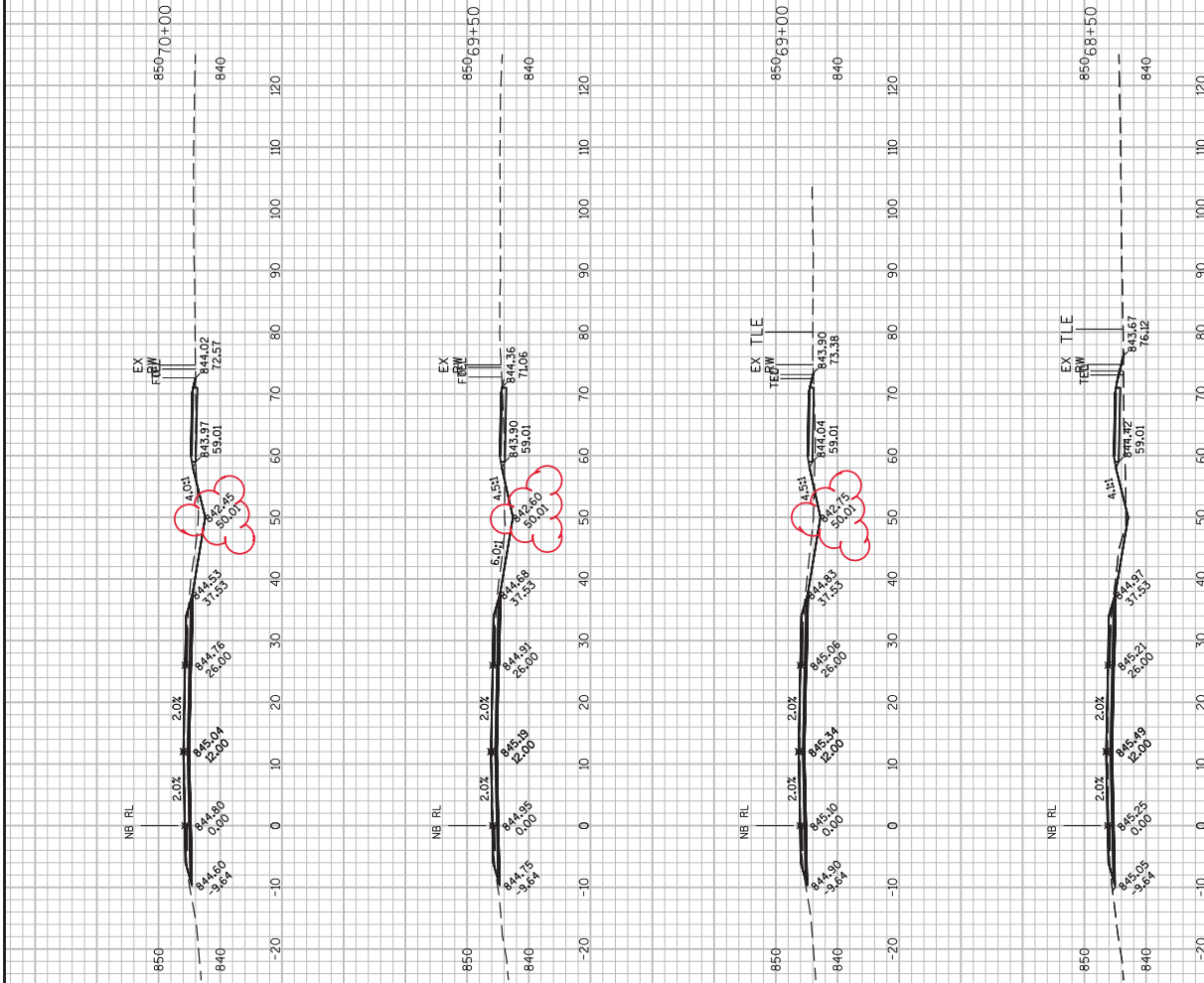

Addendum No. 01
 ID 7110-05-72
 Revised Sheet 327
 March 7, 2018

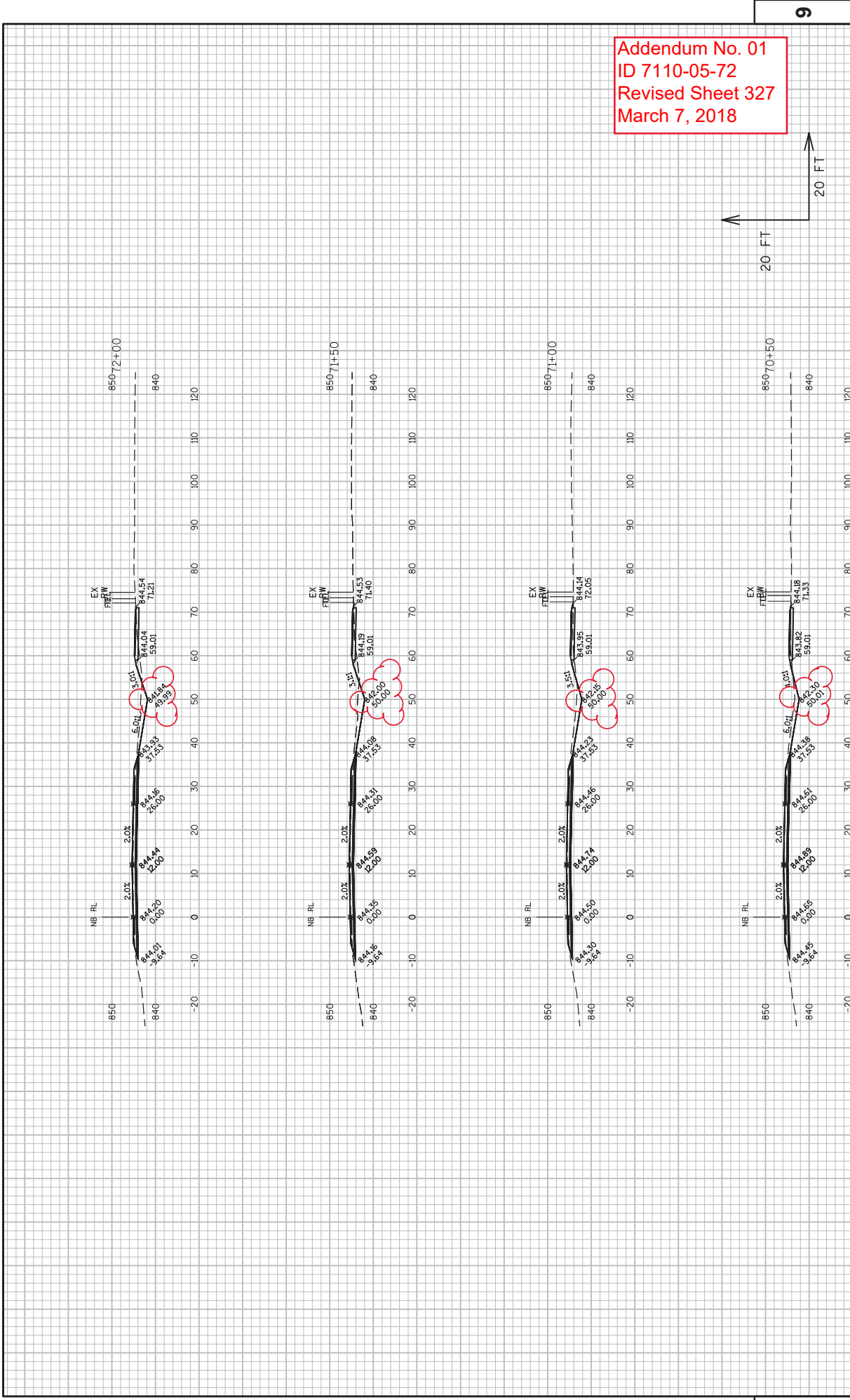

Addendum No. 01
 ID 7110-05-72
 Revised Sheet 328
 March 7, 2018

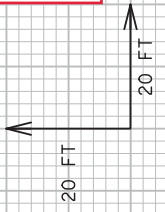
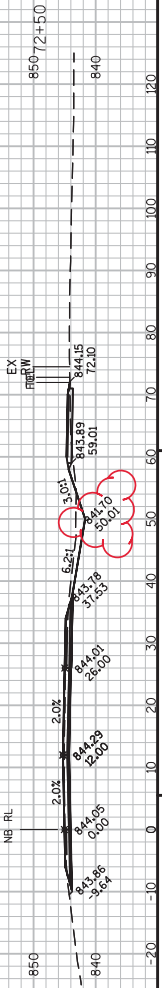
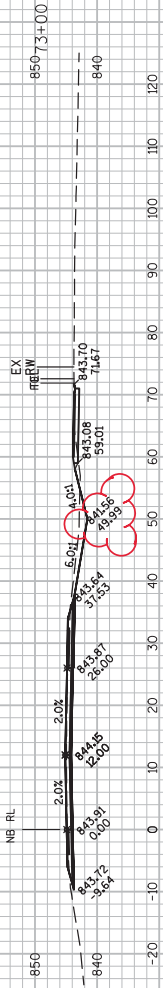
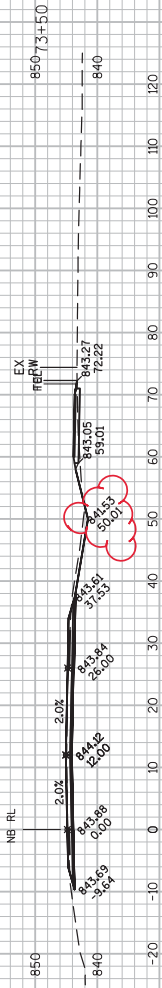
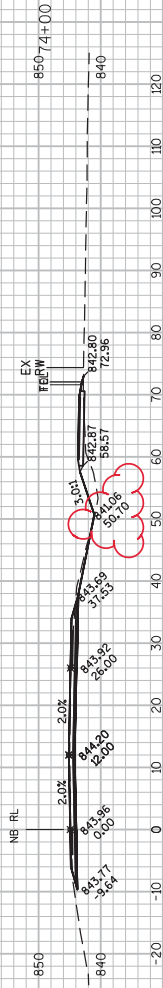

Addendum No. 01
 ID 7110-05-72
 Revised Sheet 329
 March 7, 2018

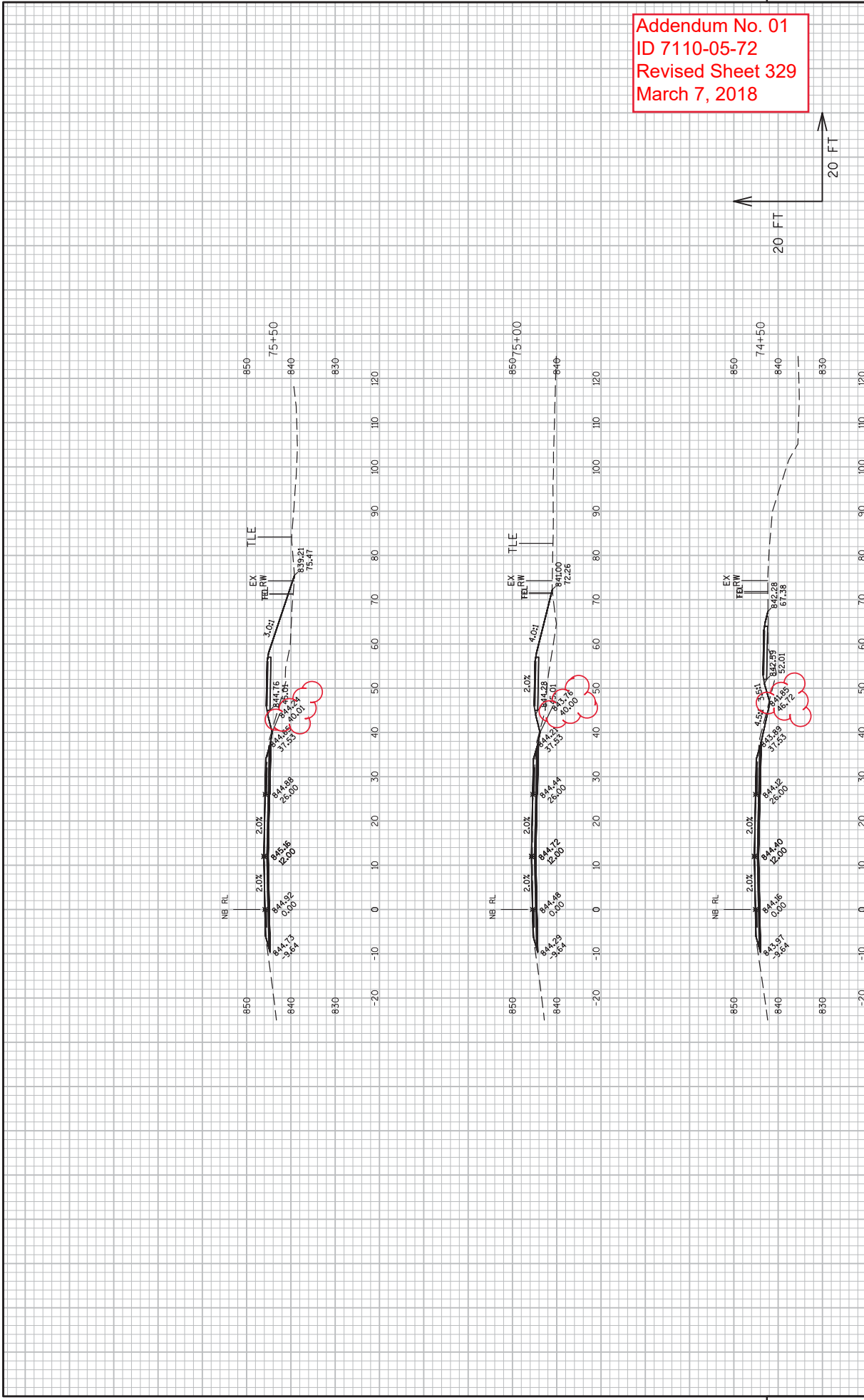

Addendum No. 01
ID 7110-05-72
Revised Sheet 330
March 7, 2018

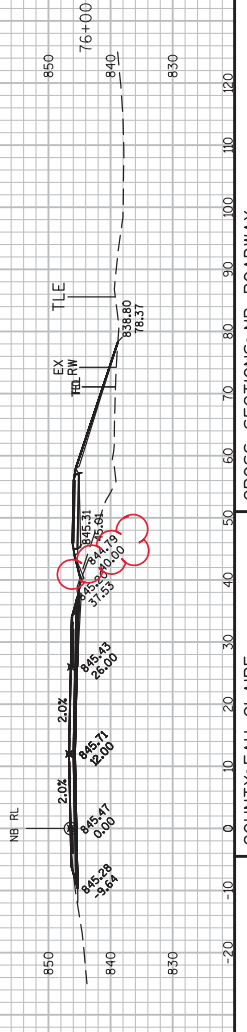
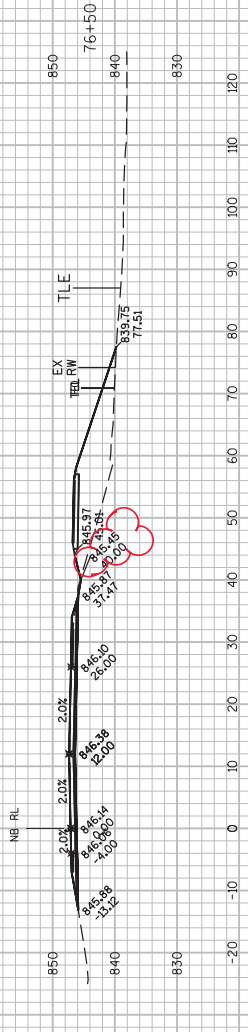
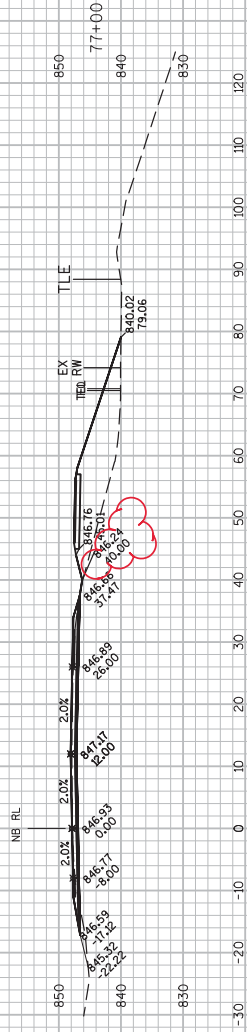

20 FT
20 FT
20 FT

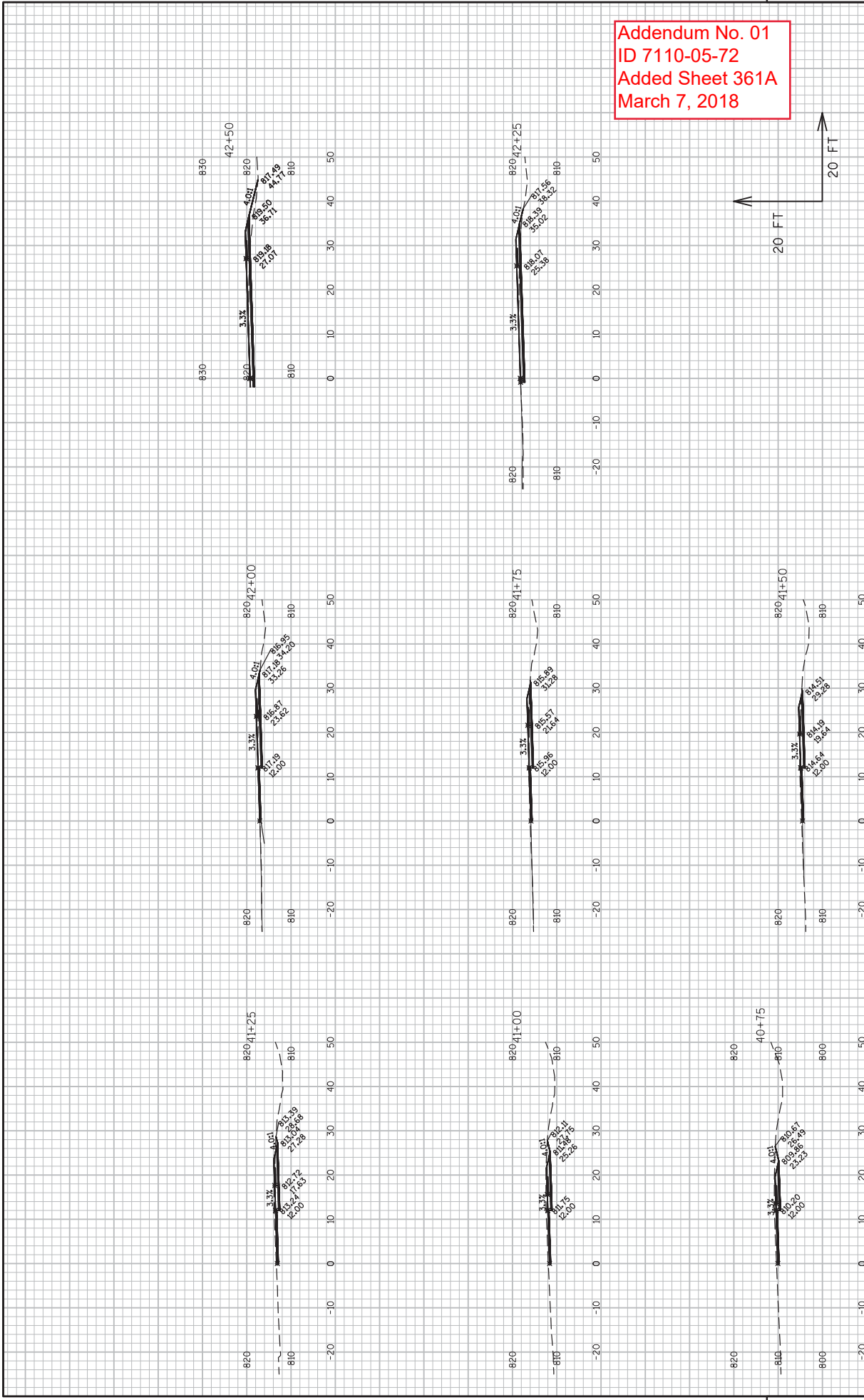

Addendum No. 01
 ID 7110-05-72
 Added Sheet 361A
 March 7, 2018

Addendum No. 01
ID 7110-05-72
Added Sheet 361B
March 7, 2018

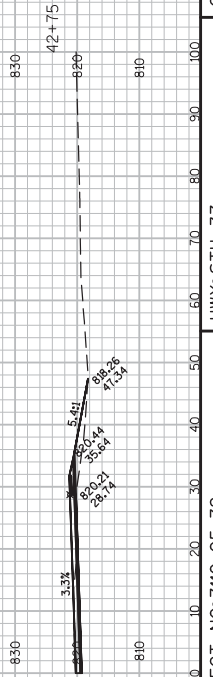
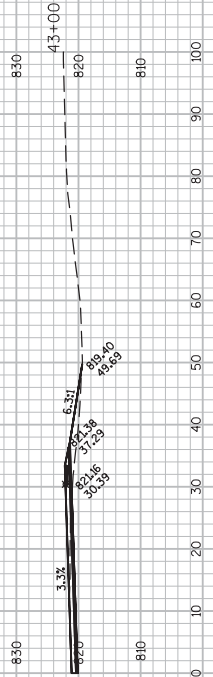
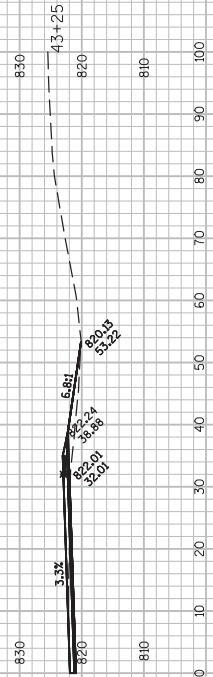
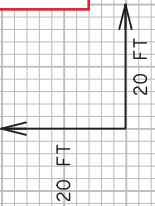

Addendum No. 01
 ID 7110-05-72
 Revised Sheet 362
 March 7, 2018

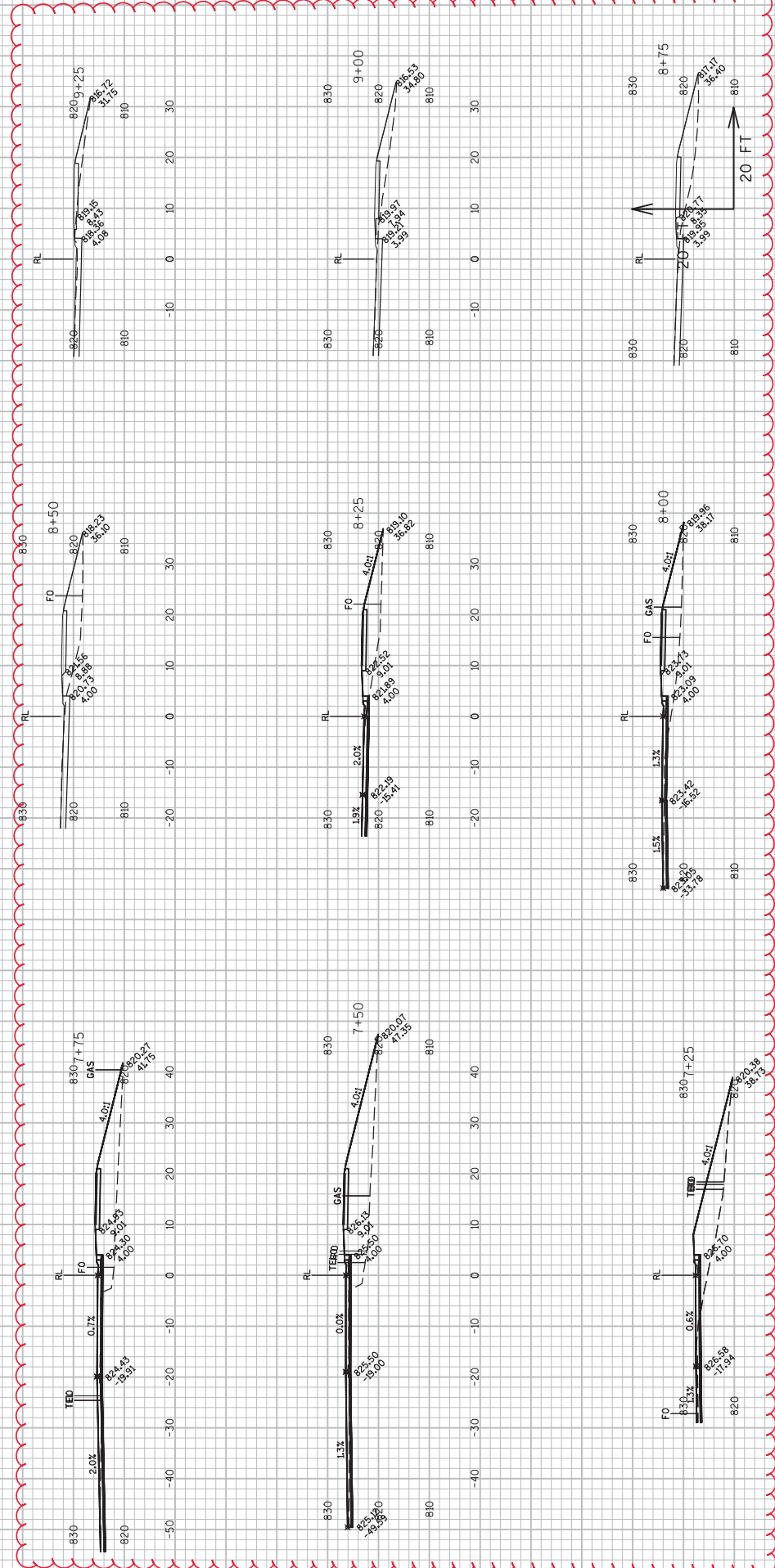



Proposal Schedule of Items

Proposal ID: 20180313038 Project(s): 7110-05-72

Federal ID(s): WISC 2018163

SECTION: 0001

ROADWAY CONSTRUCTION

Alt Set ID:

Alt Mbr ID:

Proposal Line Number	Item ID Description	Approximate Quantity and Units	Unit Price	Bid Amount
0002	201.0105 Clearing	5.000 STA	_____.	_____.
0004	201.0205 Grubbing	5.000 STA	_____.	_____.
0006	204.0100 Removing Pavement	38,435.000 SY	_____.	_____.
0008	204.0110 Removing Asphaltic Surface	4,880.000 SY	_____.	_____.
0010	204.0150 Removing Curb & Gutter	1,374.000 LF	_____.	_____.
0012	204.0155 Removing Concrete Sidewalk	600.000 SY	_____.	_____.
0014	204.0195 Removing Concrete Bases	42.000 EACH	_____.	_____.
0016	204.0210 Removing Manholes	3.000 EACH	_____.	_____.
0018	204.0220 Removing Inlets	12.000 EACH	_____.	_____.
0020	204.0245 Removing Storm Sewer (size) 01. 24-inch	158.000 LF	_____.	_____.
0022	204.0245 Removing Storm Sewer (size) 02. 18-inch	161.000 LF	_____.	_____.
0024	204.0245 Removing Storm Sewer (size) 03. 24-inch	222.000 LF	_____.	_____.
0026	204.0245 Removing Storm Sewer (size) 04. 36-inch	169.000 LF	_____.	_____.
0028	204.9060.S Removing (item description) 01. Apron Endwall	6.000 EACH	_____.	_____.
0030	205.0100 Excavation Common	25,050.000 CY	_____.	_____.



Proposal Schedule of Items

Proposal ID: 20180313038 Project(s): 7110-05-72

Federal ID(s): WISC 2018163

SECTION: 0001

ROADWAY CONSTRUCTION

Alt Set ID:

Alt Mbr ID:

Proposal Line Number	Item ID Description	Approximate Quantity and Units	Unit Price	Bid Amount
0032	208.0100 Borrow	8,145.000 CY	_____.	_____.
0034	211.0100 Prepare Foundation for Asphaltic Paving (project) 01. 7110-05-72	LS	LUMP SUM	_____.
0036	211.0200 Prepare Foundation for Concrete Pavement (project) 01. 7110-05-72	LS	LUMP SUM	_____.
0038	211.0500 Prepare Foundation for Base Aggregate	126.000 STA	_____.	_____.
0040	213.0100 Finishing Roadway (project) 01. 7110-05-72	1.000 EACH	_____.	_____.
0042	305.0110 Base Aggregate Dense 3/4-Inch	800.000 TON	_____.	_____.
0044	305.0120 Base Aggregate Dense 1 1/4-Inch	17,870.000 TON	_____.	_____.
0046	415.0085 Concrete Pavement 8 1/2-Inch	49,045.000 SY	_____.	_____.
0048	415.0210 Concrete Pavement Gaps	4.000 EACH	_____.	_____.
0050	416.0610 Drilled Tie Bars	878.000 EACH	_____.	_____.
0052	416.0620 Drilled Dowel Bars	108.000 EACH	_____.	_____.
0054	416.1010 Concrete Surface Drains	22.500 CY	_____.	_____.
0056	416.1110 Concrete Shoulder Rumble Strips	8,350.000 LF	_____.	_____.
0058	455.0605 Tack Coat	765.000 GAL	_____.	_____.
0060	460.2000 Incentive Density HMA Pavement	1,225.000 DOL	1.00000	1,225.00
0062	460.5244 HMA Pavement 4 LT 58-34 S	1,915.000 TON	_____.	_____.