



Wisconsin Department of Transportation

May 1, 2018

Division of Transportation Systems Development

Bureau of Project Development
4822 Madison Yards Way, 4th Floor South
Madison, WI 53705

Telephone: (608) 266-1631
Facsimile (FAX): (608) 266-8459

NOTICE TO ALL CONTRACTORS:

Proposal #15: 1430-18-71, WISC 2018 242
Rosendale – Fond du Lac
Becker Blvd-Townline Road
STH 23
Fond du Lac County

1430-23-71, WISC 2018 243
STH 23, Village of Rosendale
Lafayette St-Becker Blvd
STH 23
Fond du Lac County

Letting of May 8, 2018

This is Addendum No. 01, which provides for the following:

Special Provisions:

Added Special Provisions	
Article No.	Description
34	1430-18-71, HMA Pavement Longitudinal Joint Density

Deleted Special Provisions	
Article No.	Description
19	Reheating HMA Pavement Longitudinal Joints, Item 460.4110.S

Schedule of Items:

Revised Bid Item Quantities					
Bid Item	Item Description	Unit	Old Quantity	Revised Quantity	Proposal Total
455.0605	Tack Coat	GAL	26,471	-2,300	24,171
460.2005	Incentive Density PWL HMA pavement	DOL	27,080	-1,050	26,030
460.2010	Incentive Air Voids HMA Pavement	DOL	42,340	-1,630	40,710
460.6223	HMA pavement 3MT 58-28 S	TON	24,543	1,730	26,273
460.6224	HMA Pavement 4MT 58-28 S	TON	19,754	-1,717	18,037
465.0110	Asphaltic Surface Patching	TON	2,215	-1,237	978

Added Bid Item Quantities					
Bid Item	Item Description	Unit	Old Quantity	Revised Quantity	Proposal Total
460.2007	Incentive Density HMA Longitudinal Joints	DOL	0	31,921	31,921

Deleted Bid Item Quantities					
Bid Item	Item Description	Unit	Old Quantity	Revised Quantity	Proposal Total
460.4110.S	Reheating HMA Pavement Longitudinal Joints	LF	79,802	-79,802	0

Plan Sheets:

Revised Plan Sheets	
Plan Sheet	Plan Sheet Title (brief description of changes to sheet)
1430-18-71	
31-32	Misc. Quantities - Corrected the quantity for tack coat, HMA and Asphaltic surface patching
33	Misc. Quantities - Replaced Reheating HMA Pavement Longitudinal Joints with 460.2007 Incentive Density HMA Longitudinal Joints
69-73	Plan Sheets – Updated survey utility file to show missing gas line
1430-23-71	
30	Misc. Quantities - Removed the item Shaping Shoulders

The responsibility for notifying potential subcontractors and suppliers of these changes remains with the prime contractor.

Sincerely,

Mike Coleman

Proposal Development Specialist
Proposal Management Section

ADDENDUM NO. 01
1430-18-71 & 1430-23-71
May 1, 2018

Special Provisions

19. DELETED.

34. HMA Pavement Longitudinal Joint Density.

A Description

This special provision incorporates longitudinal joint density requirements into the contract and describes the data collection, acceptance, and procedure used for determination of pay adjustments for HMA pavement longitudinal joint density. Pay adjustments will be made on a linear foot basis, as applicable per pavement layer. Applicable longitudinal joints are defined as those between any two or more traffic lanes. This excludes ramp lanes, merging zones, medians/center turn lanes and any joint with one side defined as a shoulder. No joint exists when paved in echelon.

Pay is determined according to standard spec 460, the QMP HMA Pavement Nuclear Density or HMA Pavement Percent Within Limits QMP special provisions, and as modified within.

B Materials

Revise standard spec 460.3.3.1(1) table 460-3 by adding footnotes [6] & [7]:

TABLE 460-3 MINIMUM REQUIRED DENSITY^{[1][6][7]}

LOCATION	LAYER	PERCENT OF TARGET MAXIMUM DENSITY		
		MIXTURE TYPE		
		LT and MT	HT	SMA ^[5]
TRAFFIC LANES ^[2]	LOWER	93.0 ^[3]	93.0 ^[4]	—
	UPPER	93.0	93.0	—
SIDE ROADS, CROSSOVERS, TURN LANES, & RAMPS	LOWER	93.0 ^[3]	93.0 ^[4]	—
	UPPER	93.0	93.0	—
SHOULDERS & APPURTENANCES	LOWER	91.0	91.0	—
	UPPER	92.0	92.0	—

^[1] The table values are for average lot density. If any individual density test result falls more than 3.0 percent below the minimum required target maximum density, the engineer may investigate the acceptability of that material.

^[2] Includes parking lanes, bike lanes as determined by the engineer

^[3] Minimum reduced by 2.0 percent for a lower layer constructed directly on crushed aggregate or recycled base courses.

^[4] Minimum reduced by 1.0 percent for a lower layer constructed directly on crushed aggregate or recycled base courses.

^[5] The minimum required densities for SMA mixtures are determined according to [CMM 8-15](#).

^[6] Minimum reduced by 1.5 percent at longitudinal joint with lateral confinement (i.e., confined)

^[7] Minimum reduced by 3.0 percent at longitudinal joint having no lateral confinement (i.e., unconfined)

C Construction

Add the following to standard spec 460.3.3.2:

- (5) Establish companion density locations at each applicable joint. Each companion location shares longitudinal stationing with a QC or QV density location within each subplot, and is located transversely with the center of the gauge 6-inches from the edge of the paving area. Subplot and lot numbering remains the same as mainline densities, however, in addition to conventional naming, joint identification

must clearly indicate “M” for inside/median side of lane or “O” for outside shoulder side of lane, as well as “U” for an unconfined joint or “C” for a confined joint (e.g., XXXXX-MC or XXXXX-OU).

- (6) Each joint will be measured, reported, and accepted under methods and procedures consistent with the program employed for mainline density, i.e., QMP or PWL.
- (7) For single nuclear density test results greater than 3.0% below specified minimums, the department will perform the following per [standard spec 460.3.3.1](#) as modified here within:
 - a) Testing at 50 foot increments both ahead and behind the unacceptable site
 - b) Continued 50 foot incremental testing until test values indicate higher than or equal to -3.0 percent from target joint density.
 - c) Materials within the incremental testing indicating lower than -3.0 percent from target joint density are defined as unacceptable, and will be handled with remedial action as defined in the payment section of this document.
 - d) The remaining subplot average (exclusive of unacceptable material) will be determined by the first forward and backward 50 foot incremental tests that reach the criteria of higher than or equal to -3.0 percent from target joint density.

Note: If the 50 foot testing extends into a previously accepted subplot, remedial action is required up to and inclusive of such material; however, the results of remedial action must not be used to recalculate the previously accepted subplot density. When this occurs, the tonnage of any unacceptable material will be deducted from the subplot in which it is located, and the previously accepted subplot density will be used to calculate pay for the remainder of the subplot.

- (8) Joint density measurements will be kept separate from all other density measurements, and entered as an individual data set into Atwood Systems.

D (Vacant)

E Payment

Add the following as 460.5.2.4 Pay Adjustment for HMA Pavement Longitudinal Joint Density:

- (1) The department will administer longitudinal joint density adjustments under the Incentive Density HMA Pavement Longitudinal Joints and Disincentive Density HMA Pavement Longitudinal Joints items. The department will adjust pay based on density relative to the specified targets in Section B of this special provision, and linear foot of the HMA Pavement bid item for that subplot as follows:

PERCENT SUBLOT DENSITY ABOVE/BELOW SPECIFIED MINIMUM	PAY ADJUSTMENT PER LINEAR FOOT PER LANE
Equal to or greater than +1.0 confined, +2.0 unconfined	\$0.40
From 0.0 to +0.9 confined, 0.0 to +1.9 unconfined	\$0
From -0.1 to -1.0	\$(0.20)
From -1.1 to -2.0	\$(0.40)
From -2.1 to -3.0	\$(0.80)
More than -3.0	<i>REMEDIAL ACTION^[1]</i>

^[1] Remedial action must be approved by the engineer and agreed upon at the time of the pre-pave meeting, and may include partial sublots as determined and defined in 460.3.3.2(7) of this document

- (2) The department will not assess joint density disincentives for pavement placed in cold weather because of a department-caused delay as specified in [standard spec 450.5.2\(3\)](#).
- (3) The department will not pay incentive on the longitudinal joint density if the traffic lane is in disincentive or the material does not meet the air void requirements as specified in [standard spec 460.5.2.3\(1\)](#). A disincentive may be applied for each mainline lane and all joint densities if both qualify for a pay reduction.

The department will pay incentive for longitudinal joint density under the following bid items:

ITEM NUMBER	DESCRIPTION	UNIT
460.2007	Incentive Density HMA Pavement Longitudinal Joints	DOL

The department will administer disincentives under the Disincentive Density HMA Pavement Longitudinal Joints administrative item.

bts-Longitudinal Joint Density (20180426)

Appendix

WisDOT Longitudinal Joint – Nuclear Gauge Density Layout

Each QC and QV density location must have a companion density location at any applicable joint. This companion location must share longitudinal stationing with each QC or QV density location, and be located transversely with the center of the gauge 6-inches from the edge of the paving area.

For QMP HMA Pavement Nuclear Density projects, this appears as follows:

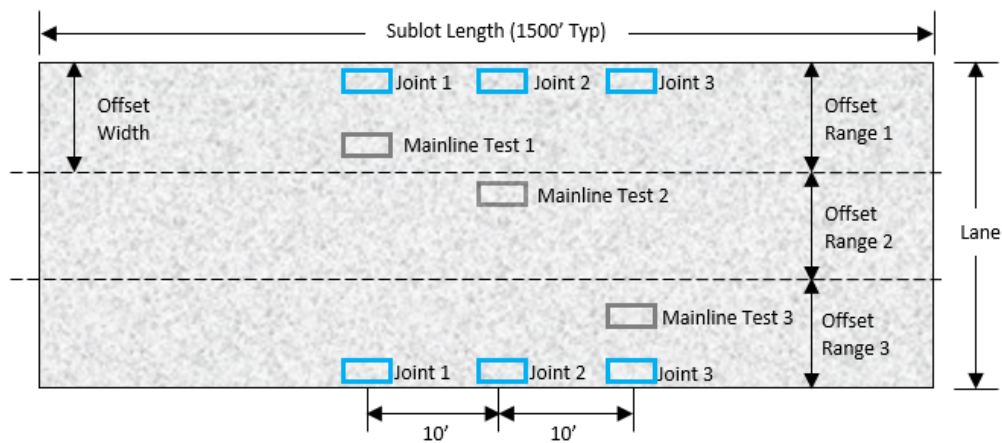

For HMA Pavement Percent Within Limits QMP projects, this appears as follows:

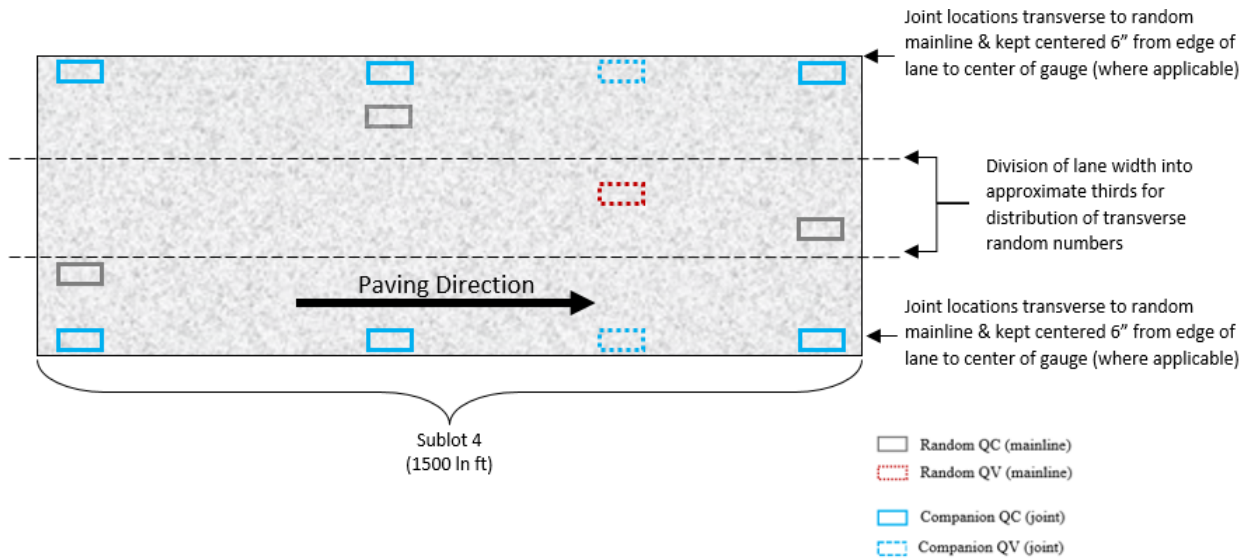

Further Explanation of PAY ADJUSTMENT FOR HMA PAVEMENT LONGITUDINAL JOINT DENSITY Table

	Confined				Pay Adjust
	Lower Layer (On Base)		Upper Layer		
	LT/MT	HT	LT/MT	HT	
Mainline Target (SS 460-3)	91.0	92.0	93.0	93.0	-
Confined Target (mainline - 1.5)	89.5	90.5	91.5	91.5	-
Equal to or greater than +1.0	≥ 90.5	≥ 91.5	≥ 92.5	≥ 92.5	\$0.40
From 0.0 to +0.9	90.4 - 89.5	91.4 - 90.5	92.4 - 91.5	92.4 - 91.5	\$0
From -0.1 to -1.0	89.4 - 88.5	90.4 - 89.5	91.4 - 90.5	91.4 - 90.5	(\$0.20)
From -1.1 to -2.0	88.4 - 87.5	89.4 - 88.5	90.4 - 89.5	90.4 - 89.5	(\$0.40)
From -2.1 to -3.0	87.4 - 86.5	88.4 - 87.5	89.4 - 88.5	89.4 - 88.5	(\$0.80)
More than -3.0	< 86.5	< 87.5	< 88.5	< 88.5	REMEDIAL ACTION

	Unconfined				Pay Adjust
	Lower Layer (On Base)		Upper Layer		
	LT/MT	HT	LT/MT	HT	
Mainline Target (SS 460-3)	91.0	92.0	93.0	93.0	-
Unconfined Target (Mainline -3.0)	88.0	89.0	90.0	90.0	-
Equal to or greater than +2.0	≥ 90.0	≥ 91.0	≥ 92.0	≥ 92.0	\$0.40
From 0.0 to +1.9	89.9 - 88.0	90.9 - 89.0	91.9 - 90.0	91.9 - 90.0	\$0
From -0.1 to -1.0	87.9 - 87.0	88.9 - 88.0	89.9 - 89.0	89.9 - 89.0	(\$0.20)
From -1.1 to -2.0	86.9 - 86.0	87.9 - 87.0	88.9 - 88.0	88.9 - 88.0	(\$0.40)
From -2.1 to -3.0	85.9 - 85.0	86.9 - 86.0	87.9 - 87.0	87.9 - 87.0	(\$0.80)
More than -3.0	< 85.0	< 86.0	< 87.0	< 87.0	REMEDIAL ACTION

Schedule of Items

Attached, dated May 1, 2018, are the revised Schedule of Items Pages 1 – 10.

Plan Sheets

The following 8½ x 11-inch sheets are attached and made part of the plans for this proposal:

1430-18-71

Revised: 31 – 33 and 69 – 73.

1430-18-71

Revised: 30

END OF ADDENDUM

Addendum No. 01
ID 1430-18-71
Revised Sheet 31
May 1, 2018

ASPHALT SUMMARY

CATEGORY	STATION TO	STATION	LOCATION	455.0605 HMA PAVEMENT 3 MT. 58-28 S		460.6223 HMA PAVEMENT 4 MT. 58-28 S		465.0110 ASPHALTIC SURFACE PATCHING		REMARKS
				TACK COAT GAL	DENSITY INCENTIVE TON*	PWL AIR VOIDS TON**	DENSITY INCENTIVE TON*	PWL AIR VOIDS TON**	TON	
0010	473+76	- 833+85	STH 23 RT	5761	6422	6422	4621	4621	4621	DRIVING LANE
0010	835+19	- 872+77	STH 23 RT	601	670	670	482	482	482	DRIVING LANE
0010	473+76	- 833+85	STH 23 LT	5761	6422	6422	4621	4621	4621	DRIVING LANE
0010	835+19	- 872+77	STH 23 LT	601	670	670	482	482	482	DRIVING LANE
0010	473+76	- 478+43	STH 23 RT	31	35	35	25	25	25	5' SHOULDER
0010	480+76	- 490+90	STH 23 RT	68	75	75	54	54	54	5' SHOULDER
0010	565+66	- 599+14	STH 23 RT	223	249	249	179	179	179	5' SHOULDER
0010	601+40	- 633+84	STH 23 RT	216	241	241	173	173	173	5' SHOULDER
0010	633+84	- 641+81	STH 23 RT	11	12	12	9	9	9	1' SHOULDER
0010	641+81	- 668+40	STH 23 RT	177	198	198	142	142	142	5' SHOULDER
0010	671+15	- 681+11	STH 23 RT	66	74	74	53	53	53	5' SHOULDER
0010	681+11	- 689+04	STH 23 RT	11	12	12	8	8	8	1' SHOULDER
0010	689+04	- 699+54	STH 23 RT	70	78	78	56	56	56	5' SHOULDER
0010	701+34	- 742+28	STH 23 RT	273	304	304	219	219	219	5' SHOULDER
0010	746+74	- 767+43	STH 23 RT	138	154	154	111	111	111	5' SHOULDER
0010	767+43	- 774+81	STH 23 RT	10	11	11	8	8	8	1' SHOULDER
0010	774+81	- 784+09	STH 23 RT	62	69	69	50	50	50	5' SHOULDER
0010	786+19	- 808+18	STH 23 RT	147	163	163	118	118	118	5' SHOULDER
0010	808+18	- 814+75	STH 23 RT	9	10	10	7	7	7	1' SHOULDER
0010	814+75	- 828+60	STH 23 RT	92	103	103	74	74	74	5' SHOULDER
0010	830+70	- 848+04	STH 23 RT	116	129	129	93	93	93	5' SHOULDER
0010	848+04	- 854+60	STH 23 RT	9	10	10	7	7	7	1' SHOULDER
0010	854+60	- 872+77	STH 23 RT	121	135	135	97	97	97	5' SHOULDER
0010	473+76	- 475+68	STH 23 LT	13	14	14	10	10	10	5' SHOULDER
0010	475+68	- 483+56	STH 23 LT	53	59	59	42	42	42	1' SHOULDER
0010	483+56	- 488+26	STH 23 LT	31	35	35	25	25	25	5' SHOULDER
0010	488+26	- 496+18	STH 23 LT	11	12	12	8	8	8	1' SHOULDER
0010	496+18	- 563+62	STH 23 LT	450	501	501	361	361	361	5' SHOULDER
0010	565+59	- 568+22	STH 23 LT	4	4	4	3	3	3	1' SHOULDER
0010	568+22	- 599+03	STH 23 LT	205	229	229	165	165	165	5' SHOULDER
0010	600+90	- 603+44	STH 23 LT	3	4	4	3	3	3	1' SHOULDER
0010	603+44	- 636+85	STH 23 LT	223	248	248	179	179	179	5' SHOULDER
0010	636+85	- 666+21	STH 23 LT	182	203	203	146	146	146	5' SHOULDER
0010	666+21	- 674+13	STH 23 LT	11	12	12	8	8	8	1' SHOULDER
0010	674+13	- 683+97	STH 23 LT	66	73	73	53	53	53	5' SHOULDER
0010	686+44	- 700+37	STH 23 LT	93	104	104	74	74	74	5' SHOULDER
0010	702+75	- 744+65	STH 23 LT	279	311	311	224	224	224	5' SHOULDER
0010	746+92	- 771+36	STH 23 LT	163	182	182	131	131	131	5' SHOULDER
0010	773+42	- 781+79	STH 23 LT	56	62	62	45	45	45	5' SHOULDER
0010	781+79	- 788+36	STH 23 LT	9	10	10	7	7	7	1' SHOULDER
SUBTOTAL				16424	18306	14184	13174	10207	13174	0

* Tonnage is eligible for Incentive Density PWL 460.2005.
** Tonnage is eligible for Incentive Air Voids 460.2010 and density is tested for acceptance in those areas.

ASPHALT SUMMARY (CONT.)

CATEGORY	STATION TO	STATION	LOCATION	TACK COAT	HMA PAVEMENT 3 MT. 58-28 S			HMA PAVEMENT 4 MT. 58-28 S			REMARKS
					TON	DENSITY	PWL	TON	DENSITY	PWL	
				GAL	TON**	INCENTIVE	PWL AIR VOIDS	TON**	INCENTIVE	PWL AIR VOIDS	
0010	788+36	-	810+24	146	163	-	163	117	-	117	465.0110 ASPHALTIC SURFACE PATCHING
0010	812+63	-	826+29	91	102	-	102	73	-	73	5' SHOULDER
0010	826+29	-	832+86	9	10	-	10	7	-	7	1' SHOULDER
0010	832+86	-	833+85	7	7	-	7	5	-	5	5' SHOULDER
0010	835+19	-	850+08	99	111	-	111	80	-	80	5' SHOULDER
0010	852+79	-	872+77	133	148	-	148	107	-	107	5' SHOULDER
0010	3+88	-	4+87	82	91	-	91	66	-	66	
0010	0+12	-	1+09	77	86	-	86	62	-	62	
0010	6+06	-	6+92	154	171	-	171	123	-	123	INCLUDES TURN LANE
0010	3+73	-	4+47	145	161	-	161	116	-	116	INCLUDES TURN LANE
0010	5+55	-	6+12	132	147	-	147	106	-	106	
0010	4+00	-	4+65	73	82	-	82	59	-	59	
0010	0+16	-	1+53	126	140	-	140	101	-	101	INCLUDES TURN LANE
0010	3+33	-	4+80	108	121	-	121	87	-	87	
0010	0+14	-	1+35	101	112	-	112	81	-	81	
0010	3+39	-	4+67	95	105	-	105	76	-	76	
0010	5+01	-	6+30	104	113	-	113	81	-	81	
0010	5+00	-	5+38	104	116	-	116	83	-	83	
0010	2+85	-	3+52	134	149	-	149	107	-	107	INCLUDES TURN LANE
0010	0+23	-	1+11	81	91	-	91	65	-	65	
0010	3+73	-	4+68	82	91	-	91	66	-	66	
0010	0+12	-	1+09	82	92	-	92	66	-	66	
0010	4+73	-	5+66	81	91	-	91	65	-	65	
0010	0+12	-	1+26	124	138	-	138	99	-	99	
0010			BYPASS LANES	833	929	-	929	668	-	668	INCLUDES TURN LANE
0010			BASE PATCHING	-	1730	-	-	-	-	-	
0010			UNDI STRIBUTED	2747	1094	-	-	787	-	-	824
SUBTOTAL				5947	6390	0	3566	3353	0	2566	824
TOTAL				22371	24696	14184	21873	16527	10207	15740	824

* Tonnage is eligible for Incentive Density PWL 460-2895.
 ** Tonnage is eligible for Incentive Air Voids 460.2010 and density is tested for acceptance in those areas.

Addendum No. 01
 ID 1430-18-71
 Revised Sheet 32
 May 1, 2018

HMA PERCENT WITHIN LIMITS (PWL) TEST STRIPS

CATEGORY	LOCATION	SPV. 0600.02		SPV. 0600.03	
		VOLUMETRICS	DENSITY	VOLUMETRICS	DENSITY
		EACH	EACH	EACH	EACH
0010	LOWER LAYER	1	1	1	1
0010	UPPER LAYER	1	1	1	1
TOTAL		2	2	2	2

INCENTIVE DENSITY HMA LONGITUDINAL JOINTS

ASPHALT SHOULDER RUMBLE STRIPS 2-LANE RURAL

ASPHALT SHOULDER RUMBLE STRIPS 2-LANE RURAL (CONT.)

CATEGORY	STATION TO	STATION	LOCATION	LOCATIONS	DOL	REMARKS
					460.2007	
0010	473+76 -	872+77	STH 23		15960	LOWER
0010	473+76 -	872+77	STH 23		15960	UPPER
			TOTAL		31921	

CATEGORY	STATION TO	STATION	LOCATION	LOCATIONS	LF	REMARKS
0010	473+76 -	475+68	STH 23	LT	192	
0010	483+56 -	488+26	STH 23	LT	470	
0010	495+82 -	526+13	STH 23	LT	3031	
0010	526+77 -	540+24	STH 23	LT	1347	
0010	540+86 -	558+17	STH 23	LT	1731	
0010	558+77 -	562+99	STH 23	LT	422	
0010	568+72 -	574+34	STH 23	LT	562	
0010	575+00 -	594+36	STH 23	LT	1936	
0010	595+01 -	598+40	STH 23	LT	339	
0010	607+44 -	614+29	STH 23	LT	685	
0010	615+05 -	621+84	STH 23	LT	679	
0010	622+45 -	630+81	STH 23	LT	836	
0010	631+49 -	636+07	STH 23	LT	458	
0010	639+78 -	664+91	STH 23	LT	2513	
0010	665+61 -	666+75	STH 23	LT	114	
0010	673+77 -	681+34	STH 23	LT	757	
0010	682+00 -	683+19	STH 23	LT	119	
0010	686+87 -	699+66	STH 23	LT	1279	
0010	703+56 -	726+01	STH 23	LT	2245	
0010	726+72 -	744+00	STH 23	LT	1728	
0010	747+70 -	751+97	STH 23	LT	427	
0010	752+61 -	770+67	STH 23	LT	1806	
0010	774+22 -	782+33	STH 23	LT	811	
0010	788+36 -	789+48	STH 23	LT	112	
0010	790+09 -	798+69	STH 23	LT	860	
0010	799+36 -	806+59	STH 23	LT	723	
0010	807+23 -	809+57	STH 23	LT	234	
0010	813+38 -	816+39	STH 23	LT	301	
0010	817+05 -	826+83	STH 23	LT	978	
0010	835+25 -	849+30	STH 23	LT	1405	
0010	853+92 -	860+05	STH 23	LT	613	
0010	860+66 -	861+64	STH 23	LT	98	
0010	862+27 -	864+98	STH 23	LT	271	
0010	865+62 -	867+48	STH 23	LT	186	
0010	473+76 -	477+43	STH 23	RT	367	
0010	481+47 -	489+80	STH 23	RT	833	
0010	494+60 -	504+43	STH 23	RT	983	
0010	505+08 -	508+62	STH 23	RT	354	
0010	509+26 -	522+97	STH 23	RT	1371	
0010	524+62 -	537+96	STH 23	RT	1334	
			SUBTOTAL		30268	

CATEGORY	STATION TO	STATION	LOCATION	LOCATIONS	TON	REMARKS
0010	508+96 RT		STH 23		9	
0010	524+10 RT		STH 23		10	
0010	540+61 LT		STH 23		14	
0010	558+56 LT		STH 23		12	
0010	561+92 RT		STH 23		6	
0010	574+34 RT		STH 23		11	
0010	574+73 LT		STH 23		8	
0010	594+70 LT		STH 23		7	
0010	631+13 LT		STH 23		12	
0010	631+13 RT		STH 23		18	
0010	644+30 RT		STH 23		11	
0010	646+78 RT		STH 23		10	
0010	726+36 LT		STH 23		11	
0010	799+00 LT		STH 23		7	
0010	807+00 LT		STH 23		9	
0010	816+74 LT		STH 23		9	
0010	851+05 RT		STH 23		10	
0010	853+80 RT		STH 23		18	
0010	865+34 LT		STH 23		8	
			TOTAL		199	

ASPHALTIC SURFACE DRIVEWAYS AND FIELD ENTRANCES

CATEGORY	STATION TO	STATION	LOCATION	LOCATIONS	LF	REMARKS
0010	538+61 -	560+27	STH 23	RT	2166	
0010	566+42 -	573+93	STH 23	RT	751	
0010	575+62 -	589+34	STH 23	RT	1372	
0010	590+00 -	591+27	STH 23	RT	127	
0010	591+88 -	598+07	STH 23	RT	619	
0010	602+29 -	602+94	STH 23	RT	65	
0010	603+56 -	630+84	STH 23	RT	2728	
0010	631+48 -	633+84	STH 23	RT	236	
0010	641+49 -	643+18	STH 23	RT	169	
0010	645+14 -	646+46	STH 23	RT	132	
0010	647+08 -	659+15	STH 23	RT	1207	
0010	661+09 -	667+42	STH 23	RT	633	
0010	672+22 -	678+32	STH 23	RT	610	
0010	680+01 -	681+48	STH 23	RT	147	
0010	688+49 -	698+46	STH 23	RT	997	
0010	702+30 -	740+78	STH 23	RT	3848	
0010	747+51 -	767+43	STH 23	RT	1992	
0010	774+81 -	779+32	STH 23	RT	451	
0010	779+94 -	782+99	STH 23	RT	305	
0010	787+09 -	788+68	STH 23	RT	159	
0010	789+28 -	798+08	STH 23	RT	880	
0010	798+73 -	808+18	STH 23	RT	945	
0010	814+75 -	827+50	STH 23	RT	1275	
0010	831+10 -	833+79	STH 23	RT	269	
0010	835+34 -	848+04	STH 23	RT	1270	
0010	854+12 -	863+81	STH 23	RT	969	
0010	864+46 -	867+48	STH 23	RT	302	
			SUBTOTAL		24624	
			TOTAL		54892	

Addendum No. 01
 ID 1430-18-71
 Revised Sheet 33
 May 1, 2018

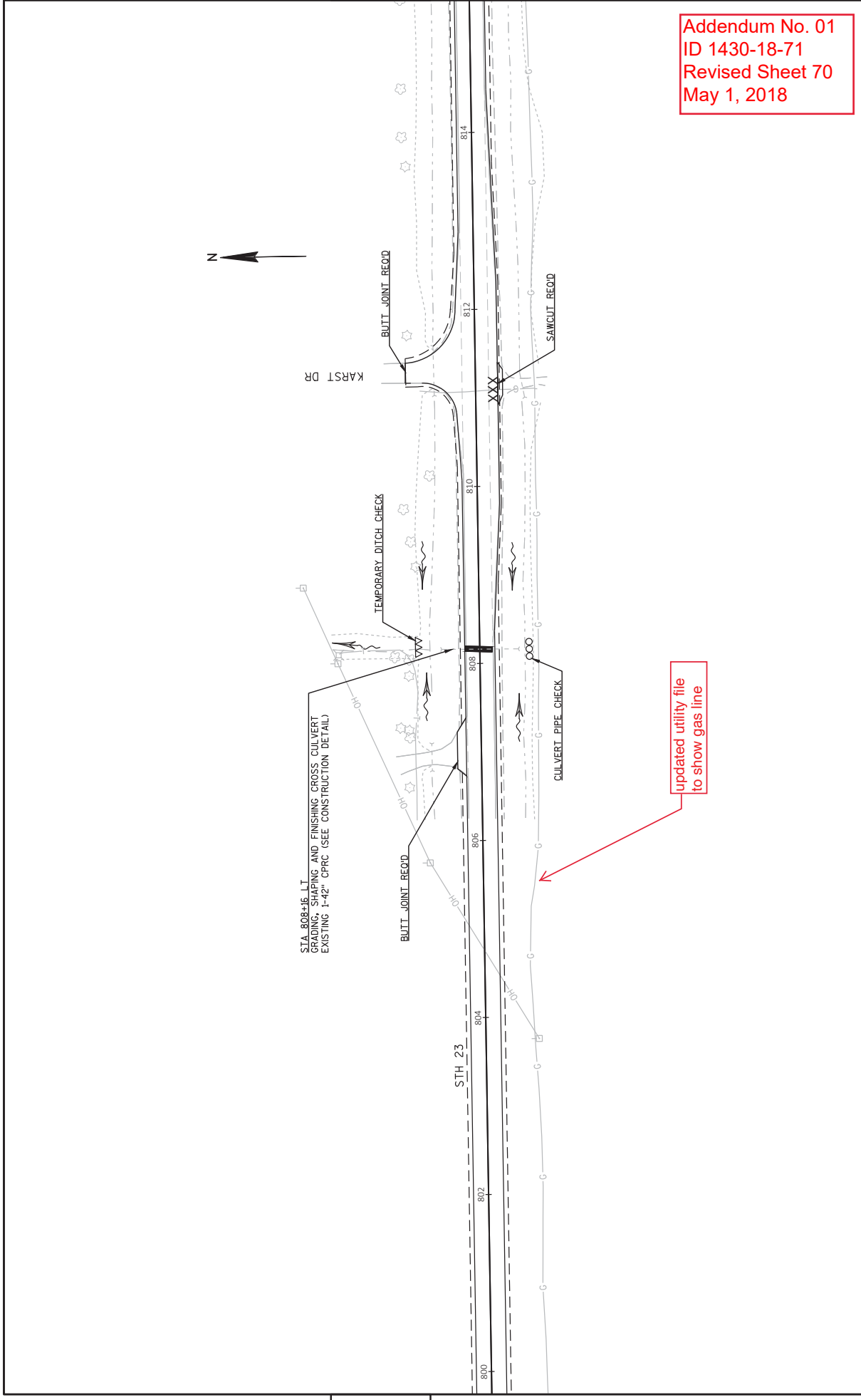

Addendum No. 01
 ID 1430-18-71
 Revised Sheet 70
 May 1, 2018

STA. 808+16 - LT.
 GRADING, SHAPING AND FINISHING CROSS CULVERT
 EXISTING 1'-42" CPVC (SEE CONSTRUCTION DETAIL)

PROJECT NO: 1430-18-71	HWY: STH 23	COUNTY: FOND DU LAC	PLAN	SHEET 70	E
FILE NAME: N:\DOT\CADD\1430-18-71\050202-PL.DWG	DATE: 4/26/2018 7:57 AM	PLOT BY: SMITH, JENNIFER B	PLOT NAME:	PLOT SCALE: 1"=100'	WISDOT/CADD/SHEET 44

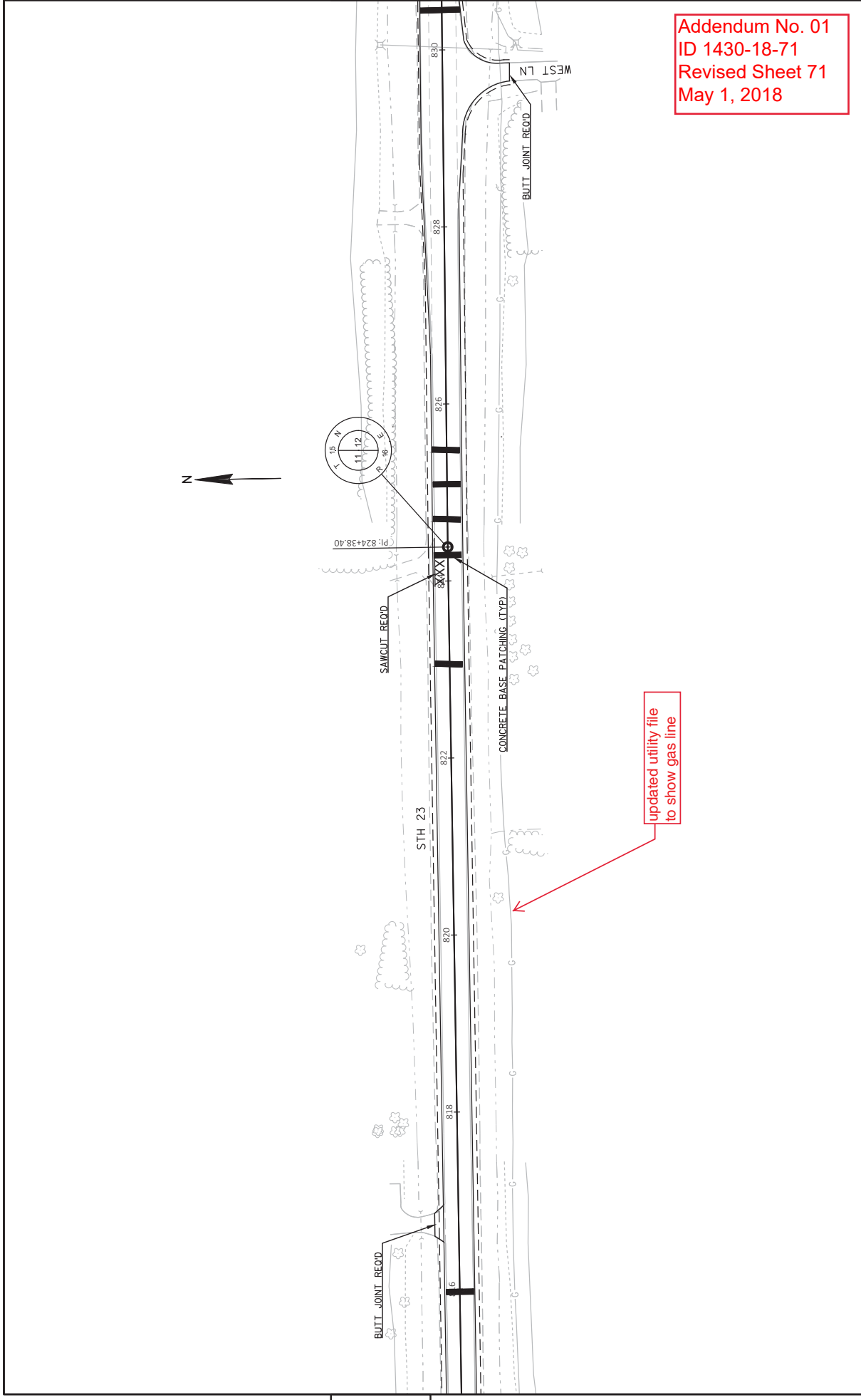

Addendum No. 01
 ID 1430-18-71
 Revised Sheet 71
 May 1, 2018

PROJECT NO: 1430-18-71	COUNTY: FOND DU LAC	PLAN	SHEET 71	E
FILE NAME: N:\PROJECTS\1430-18-71\050202-PN.DWG	HWY: STH 23	DATE: 4/26/2018 7:57 AM	PLOT SCALE: 1"=100'	WISDOT/CADD/SHEET 44
LANDMARK: 050202-PN1		PLOT BY: SMITH, JENNIFER B	PLOT NAME:	

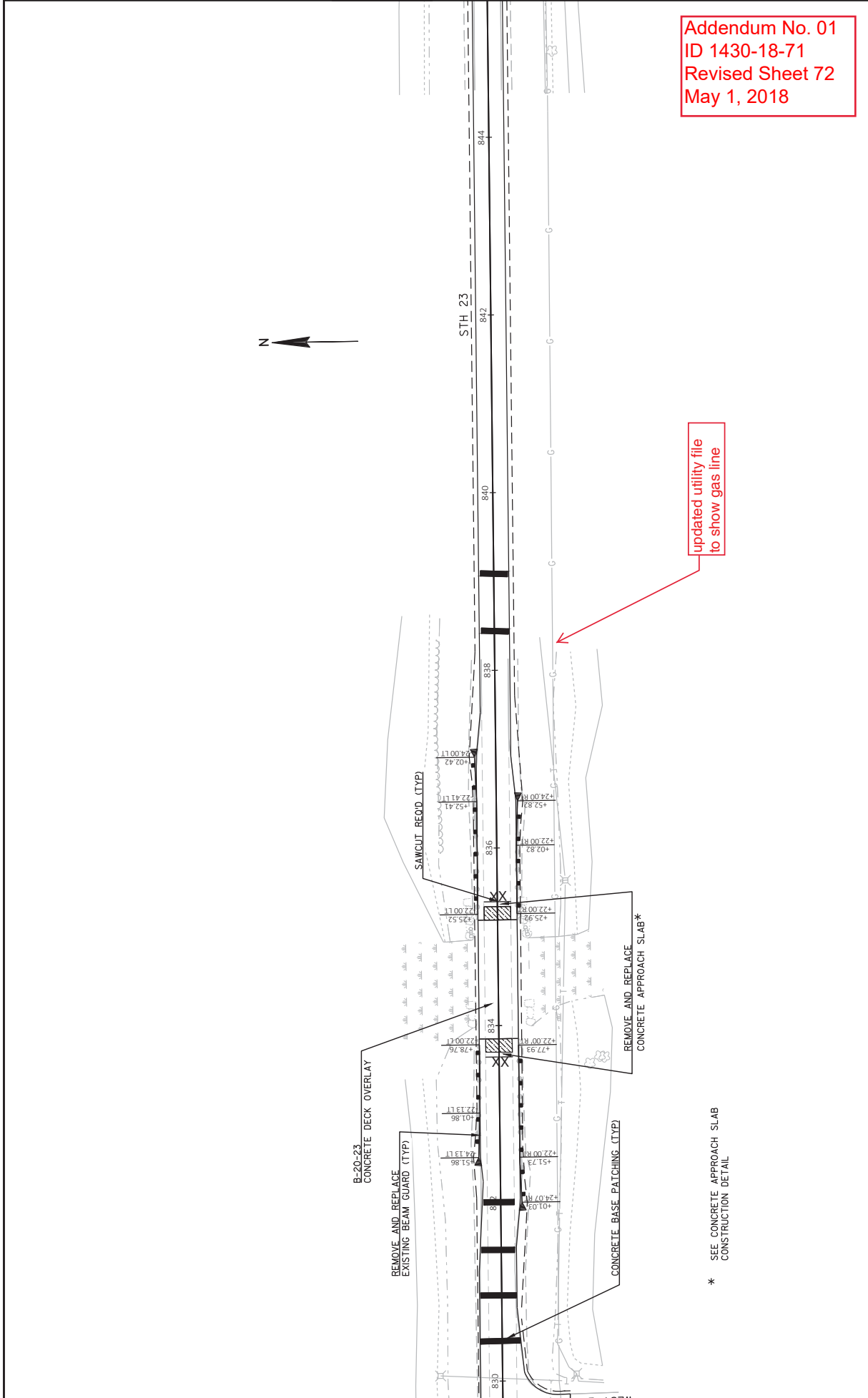

5

5

Addendum No. 01
 ID 1430-18-71
 Revised Sheet 72
 May 1, 2018

updated utility file
 to show gas line

* SEE CONCRETE APPROACH SLAB
 CONSTRUCTION DETAIL

Addendum No. 01
ID 1430-18-71
Revised Sheet 73
May 1, 2018

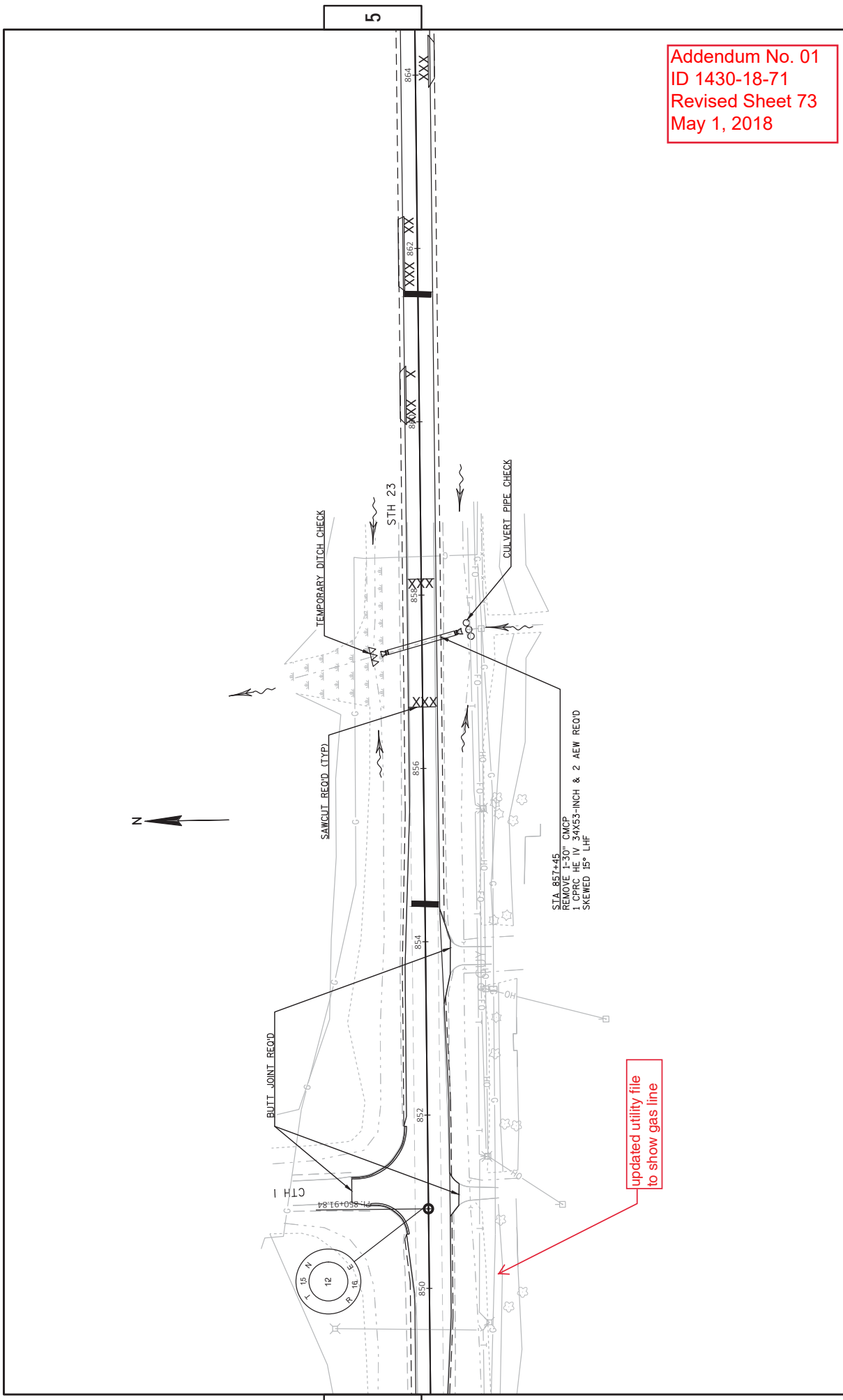

PROJECT NO: 1430-18-71	HWY: STH 23	COUNTY: FOND DU LAC	PLAN	SHEET 73	E
FILE NAME: N:\PROJECTS\1430-18-71\050202-PN.DWG	DATE: 4/26/2018 7:57 AM	PLOT BY: SMITH, JENNIFER B	PLOT NAME:	PILOT SCALE: 1"=100'	WISDOT/CADDSSHEET44

REMOVING CONCRETE SIDEWALK

CATEGORY	STATION TO	STATION	LOCATION	204.0155 SY	REMARKS
0010	435+43	-	STH 23 LT	4	LAFAYETTE ST
0010	435+93	-	STH 23 LT	8	LAFAYETTE ST
0010	439+18	-	STH 23 LT	7	STH 26 NW
0010	439+30	-	STH 23 LT	14	STH 26 NW
0010	440+24	-	STH 23 LT	9	STH 26 NE
0010	440+38	-	STH 23 LT	9	STH 26 NE
0010	439+14	-	STH 23 RT	11	STH 26 SW
0010	139+30	-	STH 23 RT	6	STH 26 SW
0010	440+13	-	STH 23 RT	15	STH 26 SE
0010	440+37	-	STH 23 RT	10	STH 26 SE
TOTAL 0010				94	

PREPARING FOUNDATION

CATEGORY	STATION TO	STATION	LOCATION	211.0100 LS	211.0400 ASPHALTIC SHOULDERS STA
0010	445+96	-	STH 23	1	-
0010	450+81	-	STH 23 RT	-	23
0010	450+72	-	STH 23 LT	-	23
TOTAL 0010				1	46

Addendum No. 01
ID 1430-23-71
Revised Sheet 30
May 1, 2018

Removed item "Shaping Shoulders"

STORM SEWER REMOVALS

CATEGORY	STRUCTURE TO	STRUCTURE	204.0210 REMOVING MANHOLES EACH	204.0220 REMOVING INLETS EACH	204.0245.01 REMOVING STORM SEWER 12-INCH LF	204.0245.02 REMOVING STORM SEWER 18-INCH LF
0010	104	-	1	-	-	-
0010	103	1	-	-	-	-
0010	101	-	1	-	-	-
0010	100	-	1	-	-	-
0010	102	1	-	-	-	-
0010	104	-	-	6	-	-
0010	103	-	-	-	8	-
0010	102	-	-	16	-	-
0010	100	101	-	16	-	-
0010	101	103	-	16	-	-
TOTAL			2	3	54	8

BASE AGGREGATE DENSE SUMMARY

CATEGORY	STATION TO	STATION	LOCATION	305.0110 3/4-INCH TON	305.0120 1 1/4-INCH TON	624.0100* WATER MGAL	REMARKS
0010	446+13	-	STH 23 RT	-	11.5	0.16	CONCRETE BASE
0010	446+26	-	STH 23 RT	-	2.6	0.04	CONCRETE BASE
0010	446+50	-	STH 23 RT	-	2.0	0.03	CONCRETE BASE
0010	446+70	-	STH 23 RT	-	2.3	0.03	CONCRETE BASE
0010	450+81	-	STH 23 RT	294.5	-	4.12	SHOULDERS
0010	450+72	-	STH 23 LT	295.7	-	4.14	SHOULDERS
0010	UNDI	STRI BUTED	UNDI STRI BUTED	-	14.2	0.20	BASE PATCHING
0010	UNDI	STRI BUTED	UNDI STRI BUTED	59.0	3.3	0.87	
TOTAL 0010				649	36	9.6	

*ADDITIONAL QUANTITIES ELSEWHERE IN THE PLAN



Proposal Schedule of Items

Proposal ID: 20180508015 Project(s): 1430-18-71, 1430-23-71

Federal ID(s): WISC 2018242, WISC 2018243

SECTION: 0001 Contract Items

Alt Set ID: Alt Mbr ID:

Proposal Line Number	Item ID Description	Approximate Quantity and Units	Unit Price	Bid Amount
0002	203.0100 Removing Small Pipe Culverts	12.000 EACH	_____.	_____.
0004	204.0100 Removing Pavement	146.000 SY	_____.	_____.
0006	204.0110 Removing Asphaltic Surface	2,181.000 SY	_____.	_____.
0008	204.0115 Removing Asphaltic Surface Butt Joints	273.000 SY	_____.	_____.
0010	204.0120 Removing Asphaltic Surface Milling	163,383.000 SY	_____.	_____.
0012	204.0150 Removing Curb & Gutter	164.000 LF	_____.	_____.
0014	204.0155 Removing Concrete Sidewalk	94.000 SY	_____.	_____.
0016	204.0165 Removing Guardrail	434.000 LF	_____.	_____.
0018	204.0210 Removing Manholes	2.000 EACH	_____.	_____.
0020	204.0220 Removing Inlets	3.000 EACH	_____.	_____.
0022	204.0245 Removing Storm Sewer (size) 01. 12-Inch	54.000 LF	_____.	_____.
0024	204.0245 Removing Storm Sewer (size) 02. 18-Inch	8.000 LF	_____.	_____.
0026	211.0100 Prepare Foundation for Asphaltic Paving (project) 01. 1430-18-71	LS	LUMP SUM	_____.
0028	211.0100 Prepare Foundation for Asphaltic Paving (project) 02. 1430-23-71	LS	LUMP SUM	_____.
0030	211.0400 Prepare Foundation for Asphaltic Shoulders	833.000 STA	_____.	_____.



Proposal Schedule of Items

Proposal ID: 20180508015 Project(s): 1430-18-71, 1430-23-71

Federal ID(s): WISC 2018242, WISC 2018243

SECTION: 0001 Contract Items

Alt Set ID: Alt Mbr ID:

Proposal Line Number	Item ID Description	Approximate Quantity and Units	Unit Price	Bid Amount
0032	213.0100 Finishing Roadway (project) 01. 1430-18-71	1.000 EACH	_____.	_____.
0034	213.0100 Finishing Roadway (project) 02. 1430-23-71	1.000 EACH	_____.	_____.
0036	305.0110 Base Aggregate Dense 3/4-Inch	5,951.000 TON	_____.	_____.
0038	305.0120 Base Aggregate Dense 1 1/4-Inch	3,968.000 TON	_____.	_____.
0040	390.0303 Base Patching Concrete	8,000.000 SY	_____.	_____.
0042	415.0410 Concrete Pavement Approach Slab	146.000 SY	_____.	_____.
0044	416.0610 Drilled Tie Bars	233.000 EACH	_____.	_____.
0046	416.0620 Drilled Dowel Bars	165.000 EACH	_____.	_____.
0048	416.1715 Concrete Pavement Repair SHES	101.000 SY	_____.	_____.
0050	416.1725 Concrete Pavement Replacement SHES	118.000 SY	_____.	_____.
0052	440.4410 Incentive IRI Ride	61,140.000 DOL	1.00000	61,140.00
0054	455.0605 Tack Coat	24,171.000 GAL	_____.	_____.
0056	460.2005 Incentive Density PWL HMA Pavement	26,030.000 DOL	1.00000	26,030.00
0058	460.2010 Incentive Air Voids HMA Pavement	40,710.000 DOL	1.00000	40,710.00
0062	460.6223 HMA Pavement 3 MT 58-28 S	26,273.000 TON	_____.	_____.
0064	460.6224 HMA Pavement 4 MT 58-28 S	18,037.000 TON	_____.	_____.



Proposal Schedule of Items

Proposal ID: 20180508015 Project(s): 1430-18-71, 1430-23-71

Federal ID(s): WISC 2018242, WISC 2018243

SECTION: 0001 Contract Items

Alt Set ID: Alt Mbr ID:

Proposal Line Number	Item ID Description	Approximate Quantity and Units	Unit Price	Bid Amount
0066	465.0110 Asphaltic Surface Patching	978.000 TON	_____.	_____.
0068	465.0120 Asphaltic Surface Driveways and Field Entrances	221.000 TON	_____.	_____.
0070	465.0425 Asphaltic Shoulder Rumble Strips 2-Lane Rural	54,892.000 LF	_____.	_____.
0072	465.0475 Asphalt Centerline Rumble Strips 2-Lane Rural	33,199.000 LF	_____.	_____.
0074	502.3200 Protective Surface Treatment	654.000 SY	_____.	_____.
0076	502.3210 Pigmented Surface Sealer	135.000 SY	_____.	_____.
0078	504.0900 Concrete Masonry Endwalls	13.000 CY	_____.	_____.
0080	509.0301 Preparation Decks Type 1	358.000 SY	_____.	_____.
0082	509.0302 Preparation Decks Type 2	268.000 SY	_____.	_____.
0084	509.0500 Cleaning Decks	654.000 SY	_____.	_____.
0086	509.1500 Concrete Surface Repair	98.000 SF	_____.	_____.
0088	509.2000 Full-Depth Deck Repair	1.000 SY	_____.	_____.
0090	509.2500 Concrete Masonry Overlay Decks	100.000 CY	_____.	_____.
0092	509.9010.S Removing Asphaltic Concrete Deck Overlay (structure) 01. B-20-0023	654.000 SY	_____.	_____.
0094	520.8000 Concrete Collars for Pipe	8.000 EACH	_____.	_____.
0096	520.8700 Cleaning Culvert Pipes	1.000 EACH	_____.	_____.



Proposal Schedule of Items

Proposal ID: 20180508015 Project(s): 1430-18-71, 1430-23-71

Federal ID(s): WISC 2018242, WISC 2018243

SECTION: 0001 Contract Items

Alt Set ID: Alt Mbr ID:

Proposal Line Number	Item ID Description	Approximate Quantity and Units	Unit Price	Bid Amount
0098	521.1018 Apron Endwalls for Culvert Pipe Steel 18-Inch	2.000 EACH	_____.	_____.
0100	521.3118 Culvert Pipe Corrugated Steel 18-Inch	40.000 LF	_____.	_____.
0102	522.0436 Culvert Pipe Reinforced Concrete Class IV 36-Inch	264.000 LF	_____.	_____.
0104	522.0448 Culvert Pipe Reinforced Concrete Class IV 48-Inch	176.000 LF	_____.	_____.
0106	522.1048 Apron Endwalls for Culvert Pipe Reinforced Concrete 48-Inch	4.000 EACH	_____.	_____.
0108	522.2424 Culvert Pipe Reinforced Concrete Horizontal Elliptical Class HE-IV 24x38-Inch	80.000 LF	_____.	_____.
0110	522.2429 Culvert Pipe Reinforced Concrete Horizontal Elliptical Class HE-IV 29x45-Inch	160.000 LF	_____.	_____.
0112	522.2434 Culvert Pipe Reinforced Concrete Horizontal Elliptical Class HE-IV 34x53-Inch	328.000 LF	_____.	_____.
0114	522.2624 Apron Endwalls for Culvert Pipe Reinforced Concrete Horizontal Elliptical 24x38-Inch	2.000 EACH	_____.	_____.
0116	522.2629 Apron Endwalls for Culvert Pipe Reinforced Concrete Horizontal Elliptical 29x45-Inch	4.000 EACH	_____.	_____.
0118	522.2634 Apron Endwalls for Culvert Pipe Reinforced Concrete Horizontal Elliptical 34x53-Inch	8.000 EACH	_____.	_____.
0120	601.0409 Concrete Curb & Gutter 30-Inch Type A	164.000 LF	_____.	_____.



Proposal Schedule of Items

Proposal ID: 20180508015 Project(s): 1430-18-71, 1430-23-71

Federal ID(s): WISC 2018242, WISC 2018243

SECTION: 0001 Contract Items

Alt Set ID: Alt Mbr ID:

Proposal Line Number	Item ID Description	Approximate Quantity and Units	Unit Price	Bid Amount
0122	602.0410 Concrete Sidewalk 5-Inch	844.000 SF	_____.	_____.
0124	602.0505 Curb Ramp Detectable Warning Field Yellow	80.000 SF	_____.	_____.
0126	603.8000 Concrete Barrier Temporary Precast Delivered	338.000 LF	_____.	_____.
0128	603.8125 Concrete Barrier Temporary Precast Installed	676.000 LF	_____.	_____.
0130	608.0412 Storm Sewer Pipe Reinforced Concrete Class IV 12-Inch	56.000 LF	_____.	_____.
0132	608.0418 Storm Sewer Pipe Reinforced Concrete Class IV 18-Inch	8.000 LF	_____.	_____.
0134	611.0430 Reconstructing Inlets	8.000 EACH	_____.	_____.
0136	611.0530 Manhole Covers Type J	5.000 EACH	_____.	_____.
0138	611.0639 Inlet Covers Type H-S	16.000 EACH	_____.	_____.
0140	611.2003 Manholes 3-FT Diameter	1.000 EACH	_____.	_____.
0142	611.3230 Inlets 2x3-FT	4.000 EACH	_____.	_____.
0144	611.8115 Adjusting Inlet Covers	4.000 EACH	_____.	_____.
0146	614.0010 Barrier System Grading Shaping Finishing	4.000 EACH	_____.	_____.
0148	614.0905 Crash Cushions Temporary	2.000 EACH	_____.	_____.
0150	614.2300 MGS Guardrail 3	250.000 LF	_____.	_____.



Proposal Schedule of Items

Proposal ID: 20180508015 Project(s): 1430-18-71, 1430-23-71

Federal ID(s): WISC 2018242, WISC 2018243

SECTION: 0001 Contract Items

Alt Set ID: Alt Mbr ID:

Proposal Line Number	Item ID Description	Approximate Quantity and Units	Unit Price	Bid Amount
0152	614.2500 MGS Thrie Beam Transition	156.000 LF	_____.	_____.
0154	614.2610 MGS Guardrail Terminal EAT	4.000 EACH	_____.	_____.
0156	618.0100 Maintenance And Repair of Haul Roads (project) 01. 1430-18-71	1.000 EACH	_____.	_____.
0158	618.0100 Maintenance And Repair of Haul Roads (project) 02. 1430-23-71	1.000 EACH	_____.	_____.
0160	619.1000 Mobilization	1.000 EACH	_____.	_____.
0162	624.0100 Water	92.000 MGAL	_____.	_____.
0164	625.0100 Topsoil	71.000 SY	_____.	_____.
0166	628.1905 Mobilizations Erosion Control	6.000 EACH	_____.	_____.
0168	628.1910 Mobilizations Emergency Erosion Control	4.000 EACH	_____.	_____.
0170	628.2006 Erosion Mat Urban Class I Type A	71.000 SY	_____.	_____.
0172	628.7015 Inlet Protection Type C	19.000 EACH	_____.	_____.
0174	628.7504 Temporary Ditch Checks	300.000 LF	_____.	_____.
0176	628.7555 Culvert Pipe Checks	72.000 EACH	_____.	_____.
0178	629.0210 Fertilizer Type B	0.022 CWT	_____.	_____.
0180	630.0140 Seeding Mixture No. 40	1.280 LB	_____.	_____.
0182	633.5200 Markers Culvert End	22.000 EACH	_____.	_____.



Proposal Schedule of Items

Proposal ID: 20180508015 Project(s): 1430-18-71, 1430-23-71

Federal ID(s): WISC 2018242, WISC 2018243

SECTION: 0001 Contract Items

Alt Set ID: Alt Mbr ID:

Proposal Line Number	Item ID Description	Approximate Quantity and Units	Unit Price	Bid Amount
0184	634.0614 Posts Wood 4x6-Inch X 14-FT	99.000 EACH	_____.	_____.
0186	634.0616 Posts Wood 4x6-Inch X 16-FT	48.000 EACH	_____.	_____.
0188	634.0618 Posts Wood 4x6-Inch X 18-FT	3.000 EACH	_____.	_____.
0190	637.2210 Signs Type II Reflective H	791.320 SF	_____.	_____.
0192	637.2215 Signs Type II Reflective H Folding	29.840 SF	_____.	_____.
0194	637.2230 Signs Type II Reflective F	114.000 SF	_____.	_____.
0196	638.2602 Removing Signs Type II	107.000 EACH	_____.	_____.
0198	638.3000 Removing Small Sign Supports	107.000 EACH	_____.	_____.
0200	642.5001 Field Office Type B	1.000 EACH	_____.	_____.
0202	643.0300 Traffic Control Drums	2,185.000 DAY	_____.	_____.
0204	643.0310.S Temporary Portable Rumble Strips	1.000 LS	_____.	_____.
0206	643.0410 Traffic Control Barricades Type II	108.000 DAY	_____.	_____.
0208	643.0420 Traffic Control Barricades Type III	9,242.000 DAY	_____.	_____.
0210	643.0705 Traffic Control Warning Lights Type A	17,398.000 DAY	_____.	_____.
0212	643.0715 Traffic Control Warning Lights Type C	968.000 DAY	_____.	_____.
0214	643.0800 Traffic Control Arrow Boards	25.000 DAY	_____.	_____.
0216	643.0900 Traffic Control Signs	21,347.000 DAY	_____.	_____.



Proposal Schedule of Items

Proposal ID: 20180508015 Project(s): 1430-18-71, 1430-23-71

Federal ID(s): WISC 2018242, WISC 2018243

SECTION: 0001 Contract Items

Alt Set ID: Alt Mbr ID:

Proposal Line Number	Item ID Description	Approximate Quantity and Units	Unit Price	Bid Amount
0218	643.0920 Traffic Control Covering Signs Type II	3.000 EACH	_____.	_____.
0220	643.1050 Traffic Control Signs PCMS	42.000 DAY	_____.	_____.
0222	643.5000 Traffic Control	1.000 EACH	_____.	_____.
0224	644.1601.S Temporary Curb Ramp	8.000 EACH	_____.	_____.
0226	646.1020 Marking Line Epoxy 4-Inch	1,769.000 LF	_____.	_____.
0228	646.1040 Marking Line Grooved Wet Ref Epoxy 4-Inch	80,471.000 LF	_____.	_____.
0230	646.3020 Marking Line Epoxy 8-Inch	547.000 LF	_____.	_____.
0232	646.3040 Marking Line Grooved Wet Ref Epoxy 8-Inch	1,200.000 LF	_____.	_____.
0234	646.4520 Marking Line Same Day Epoxy 4-Inch	47,121.000 LF	_____.	_____.
0236	646.5020 Marking Arrow Epoxy	5.000 EACH	_____.	_____.
0238	646.5120 Marking Word Epoxy	3.000 EACH	_____.	_____.
0240	646.7120 Marking Diagonal Epoxy 12-Inch	664.000 LF	_____.	_____.
0242	646.7420 Marking Crosswalk Epoxy Transverse Line 6-Inch	538.000 LF	_____.	_____.
0244	646.9000 Marking Removal Line 4-Inch	828.000 LF	_____.	_____.
0246	648.0100 Locating No-Passing Zones	7.500 MI	_____.	_____.
0248	649.0105 Temporary Marking Line Paint 4-Inch	42,922.000 LF	_____.	_____.



Proposal Schedule of Items

Proposal ID: 20180508015 Project(s): 1430-18-71, 1430-23-71

Federal ID(s): WISC 2018242, WISC 2018243

SECTION: 0001 Contract Items

Alt Set ID: Alt Mbr ID:

Proposal Line Number	Item ID Description	Approximate Quantity and Units	Unit Price	Bid Amount
0250	649.0150 Temporary Marking Line Removable Tape 4-Inch	2,161.000 LF	_____.	_____.
0252	649.0250 Temporary Marking Line Removable Tape 8-Inch	336.000 LF	_____.	_____.
0254	649.0850 Temporary Marking Stop Line Removable Tape 18-Inch	24.000 LF	_____.	_____.
0256	650.4000 Construction Staking Storm Sewer	5.000 EACH	_____.	_____.
0258	650.6000 Construction Staking Pipe Culverts	24.000 EACH	_____.	_____.
0260	650.8000 Construction Staking Resurfacing Reference	42,681.000 LF	_____.	_____.
0262	650.9910 Construction Staking Supplemental Control (project) 01. 1430-18-71	LS	LUMP SUM	_____.
0264	650.9910 Construction Staking Supplemental Control (project) 02. 1430-23-71	LS	LUMP SUM	_____.
0266	690.0150 Sawing Asphalt	4,435.000 LF	_____.	_____.
0268	690.0250 Sawing Concrete	21,079.000 LF	_____.	_____.
0270	715.0415 Incentive Strength Concrete Pavement	500.000 DOL	1.00000	500.00
0272	ASP.1T0A On-the-Job Training Apprentice at \$5.00/HR	2,300.000 HRS	5.00000	11,500.00
0274	ASP.1T0G On-the-Job Training Graduate at \$5.00/HR	1,920.000 HRS	5.00000	9,600.00
0276	SPV.0060 Special 01. Adjusting Manhole Covers With Rubber Rings	4.000 EACH	_____.	_____.



Proposal Schedule of Items

Proposal ID: 20180508015 Project(s): 1430-18-71, 1430-23-71

Federal ID(s): WISC 2018242, WISC 2018243

SECTION: 0001 Contract Items

Alt Set ID: Alt Mbr ID:

Proposal Line Number	Item ID Description	Approximate Quantity and Units	Unit Price	Bid Amount
0278	SPV.0060 Special 02. HMA Percent Within Limits (PWL) Test Strip Volumetrics	2.000 EACH	_____.	_____.
0280	SPV.0060 Special 03. HMA Percent Within Limits (PWL) Test Strip Density	2.000 EACH	_____.	_____.
0282	SPV.0060 Special 04. Grading Shaping and Finishing Cross Culverts	13.000 EACH	_____.	_____.
0284	SPV.0090 Special 01. Grading Shaping and Finishing Ditches	1,393.000 LF	_____.	_____.
0286	SPV.0105 Special 02. Railing Tubular Type J B-20-0023	LS	LUMP SUM	_____.
0288	460.2007 Incentive Density HMA Pavement Longitudinal Joints	31,921.000 DOL	1.00000	31,921.00
Section: 0001			Total:	_____.
			Total Bid:	_____.