



Wisconsin Department of Transportation

May 3, 2018

Division of Transportation Systems Development

Bureau of Project Development
 4822 Madison Yards Way, 4th Floor South
 Madison, WI 53705

Telephone: (608) 266-1631
 Facsimile (FAX): (608) 266-8459

NOTICE TO ALL CONTRACTORS:

Proposal #33: 1180-03-74, WISC 2018 255
Ino - Ashland
USH 63 to CTH G
USH 2
Bayfield County

Letting of May 8, 2018

This is Addendum No. 01, which provides for the following:

Special Provisions:

Revised Special Provisions	
Article No.	Description
3	Prosecution and Progress
15	Marking Line Same Day Epoxy 4-inch and Marking Line Epoxy 4-inch

Schedule of Items:

Revised Bid Item Quantities					
Bid Item	Item Description	Unit	Old Quantity	Revised Quantity	Proposal Total
204.0115	Removing Asphaltic Surface Butt Joints	SY	906	1,244	2,150
628.1504	Silt Fence	LF	770	-270	500
628.2027	Erosion Mat Class II Type C	SY	2,627	-1,950	677
629.0210	Fertilizer Type B	CWT	1.71	-1.14	0.57
630.0110	Seeding Mixture No. 10	LB	33.78	-25.50	8.28
630.0200	Seeding Temporary	LB	59.28	-42.72	16.56
649.0105	Temporary Marking Line Paint 4-Inch	LF	37,917	-6,198	31,719

Added Bid Item Quantities					
Bid Item	Item Description	Unit	Old Quantity	Revised Quantity	Proposal Total
650.5500	Construction Staking Curb Gutter and Curb & Gutter	LF	0	81	81

Plan Sheets:

Revised Plan Sheets	
Plan Sheet	Plan Sheet Title (brief description of changes to sheet)
9	Construction Details (Revised butt joint dimension)
10	Construction Details (Revised butt joint detail)
11	Construction Details (Clarified side road radius dimensions)
29	Misc. Quant. (Revised Milling Butt Joint Quantities)
33	Misc. Quant. (Revised Erosion Control Quantities)
36	Misc. Quant. (Added curb and gutter staking and modified paint qty)
42	Plan Sheet (Revised quantities and notes)
146	Cross Sections (Modified with labels)
147	Cross Sections (Modified with labels)
148	Cross Sections (Modified with labels)
149	Cross Sections (Modified with labels)
150	Cross Sections (Modified with labels)
151	Cross Sections (Modified with labels)
152	Cross Sections (Modified with labels)
153	Cross Sections (Modified with labels)

The responsibility for notifying potential subcontractors and suppliers of these changes remains with the prime contractor.

Sincerely,

Mike Coleman

Proposal Development Specialist
Proposal Management Section

ADDENDUM NO. 01

1180-03-74

May 3, 2018

Special Provisions

3. Prosecution and Progress.

Replace entire article language with the following:

Begin work within ten calendar days after the engineer issues a written notice to do so.

Provide the time frame for construction of the project within the 2018 construction season to the engineer in writing within a month after executing the contract but at least 14 calendar days before the preconstruction conference. Assure that the time frame is consistent with the contract completion time. Upon approval, the engineer will issue the notice to proceed within ten calendar days before the beginning of the approved time frame.

To revise the time frame, submit a written request to the engineer at least two weeks before the beginning of the intended time frame. The engineer will approve or deny that request based on the conditions cited in the request and its effect on the department's scheduled resources.

Except in areas requiring concrete repair, place the HMA pavement lower layer such that any existing asphalt removed by surface milling operations is replaced by the end of each day of operation, and such that there are no longitudinal drop-offs left in place during the nighttime hours when all lanes are open to the traveling public. Except that for a single Monday – Thursday period each passing lane may be closed, but if closed it shall be completely closed unless the portion of the passing lane impacted by milling is the first 1000' or less and that in this case the remaining passing lane that is not impacted by construction shall remain open.

Place the SMA pavement upper layer such that the joint between driving lane and adjacent passing lane match at the end of each day. The adjacent HMA bypass lanes, turn lanes and shoulder pavement shall be placed within 10 days of placing the driving and passing lanes.

Hold a pre-pave meeting prior to the start of milling and paving operations. In addition to discussing normal operation procedures and traffic handling, provide a contingency plan to handle machinery breakdowns or other uncontrollable events that would affect the ability to replace the milled asphaltic surface with the HMA pavement layer or the ability to apply pavement markings. Obtain approval from the engineer

Northern Long-eared Bat (*Myotis septentrionalis*)

Northern Long-eared Bats (NLEB) have the potential to inhabit the project limits because they roost in trees. Roosts may not have been observed on this project, but conditions to support the species exist. The species and all active roosts are protected by the Federal Endangered Species Act. If an individual bat or active roost is encountered during construction operations, stop work and notify the engineer and the WisDOT Regional Environmental Coordinator (REC).

In accordance to the final 4(d) rule issued for the NLEB, the department has determined that the proposed activity may affect, but will not result in prohibited take of the NLEB. The activity involves tree removal, but will not occur within 0.25 miles of a known hibernacula, nor will the activity remove a known maternity roost tree or any other tree within 150 feet of a known maternity roost tree.

If additional trees need to be removed, no Clearing shall occur without prior approval from the engineer, following coordination with the WisDOT REC. Additional tree removal beyond the area originally specified will require consultation with the United States Fish and Wildlife Service (USFWS)

and may require a bat presence/absence survey. Notify the engineer if additional Clearing cannot be avoided to begin coordination with the WisDOT REC. The WisDOT REC will initiate consultation with the USFWS and determine if a survey is necessary.

Submit a schedule and description of Clearing operations with the ECIP 14 days prior to any Clearing operations. The department will determine, based on schedule and scope of work, what additional erosion control measures shall be implemented prior to the start of Clearing operations, and list those additional measures in the ECIP.

15. Marking Line Same Day Epoxy 4-Inch and Marking Line Epoxy 4-Inch.

Add the following:

For pay item 646.1020 Marking Line Epoxy 4-Inch, prepare stone matrix asphalt (SMA) by scarifying to expose 75 percent or more of the stone substrate. Limit scarification to no more than the following:

- 3 inches from the beginning and end of applied line.
- ½ inch on either side of the applied line

Schedule of Items



Attached, dated May 3, 2018, are the revised Schedule of Items Pages 1 – 6.

Plan Sheets

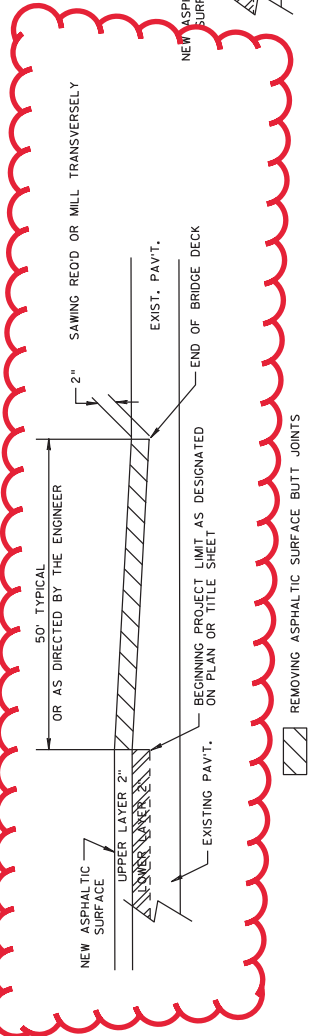

The following 8½ x 11-inch sheets are attached and made part of the plans for this proposal:
Revised: 9,10,11,29,33,36,42,146,147,148,149,150,151,152,153.

END OF ADDENDUM



 REMOVING ASPHALTIC SURFACE BUTT JOINTS
 REMOVING ASPHALTIC SURFACE MILLING
OVERLAP JOINT, BUTTED DETAIL
 MAINLINE, EXCLUDING SHOULDERS STA 1146+00
 AND BRIDGE DECKS OR APPROACH SLABS
 BRIDGE STATIONS
 1386+46 1389+54
 1408+33 1409+71

Addendum No. 01
 ID 1180-03-74
 Revised Sheet 9
 May 3, 2018

 ASPHALTIC SURFACE BUTT JOINTS
 REMOVING ASPHALTIC SURFACE MILLING
BUTT JOINT ON CONC. PAVT., OVERLAY
 STA 1441+30

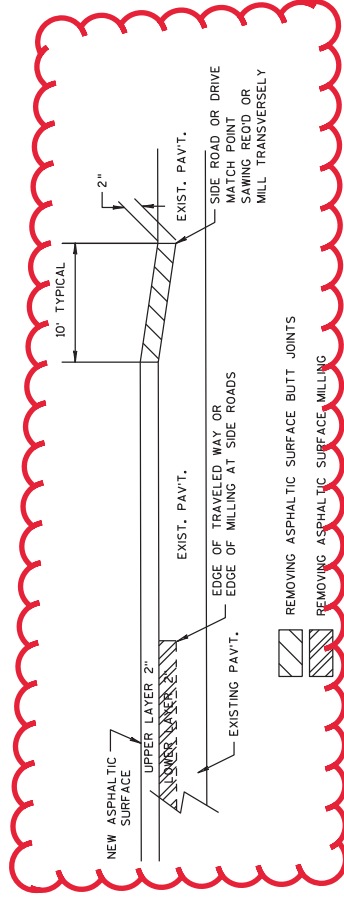

SIDE ROAD AND PAVED DRIVEWAY LOCATIONS
 BUDIASH ROAD STA: 1207+75R
 BUDIASH ROAD STA: 1208+71L
 COLBY ROAD STA: 1270+58R
 OLD USH 2 STA: 1234+22R
 PULYEART ROAD STA: 1289+14L
 KANES ROAD STA: 1305+87L
 FIORE ROAD STA: 1398+81L
 STATE FARM ROAD STA: 1375+08R
 CTH G STA: 1423+30L

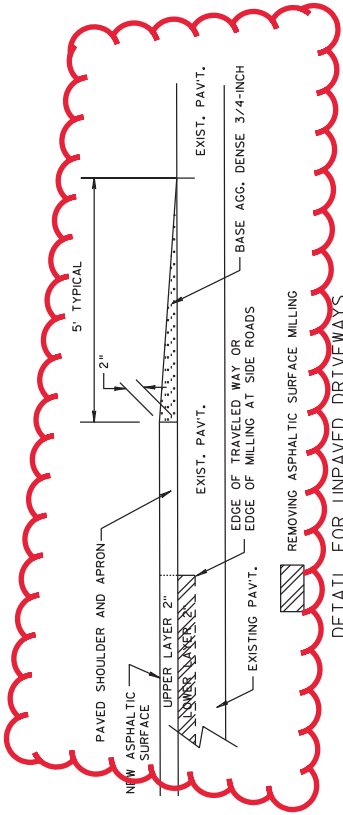

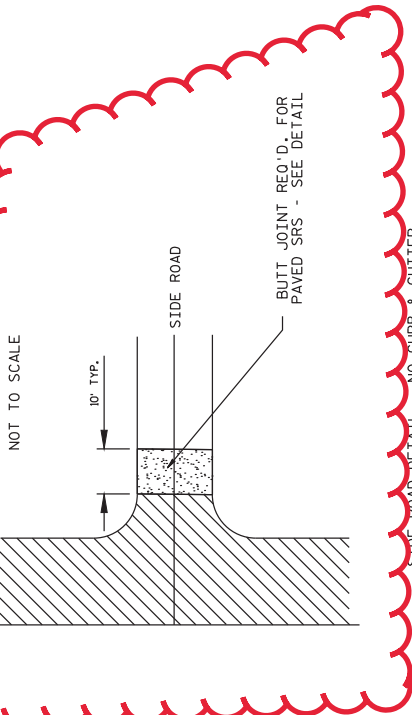

NOTE: IF THE EXISTING SIDEROAD CONSISTS OF A BASE COURSE SURFACE, THE NEW ASPHALT SHALL BE PLACED TO THE END OF THE FARTHER EXISTING SIDEROAD RADIUS.

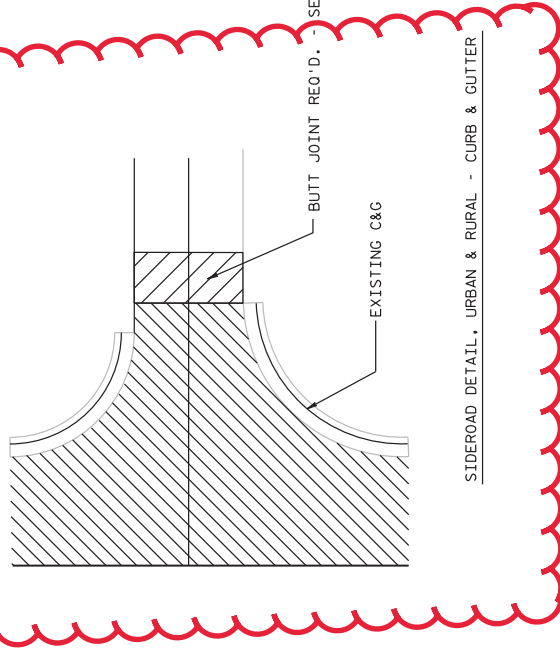

Addendum No. 01
ID 1180-03-74
Revised Sheet 10
May 3, 2018

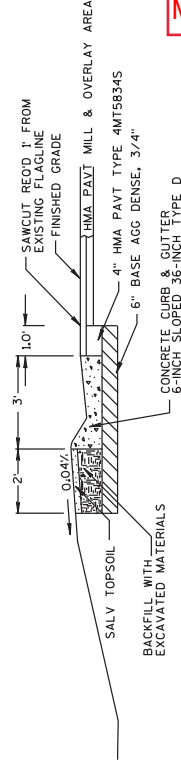
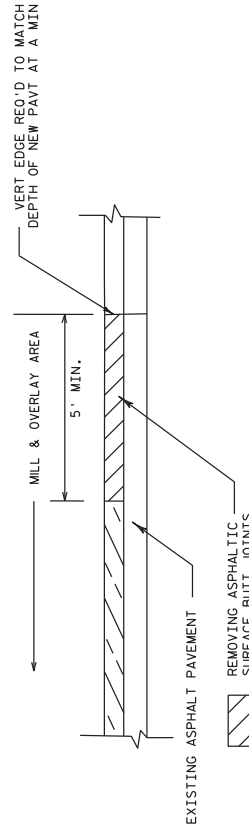

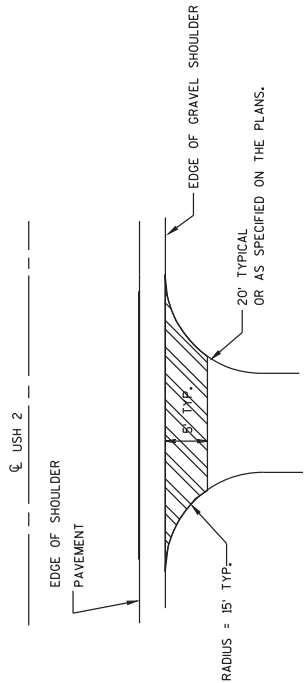

RURAL AGGREGATE DRIVEWAY DETAIL

EACH ENTRANCE SHALL RECEIVE ADEQUATE 3/4-INCH BASE AGG. DENSE AFTER MAINLINE PAVING TO BRING ENTRANCE UP TO SHOULDER PAVEMENT GRADE. MATCH EXISTING DRIVEWAY WIDTHS AND RADII.

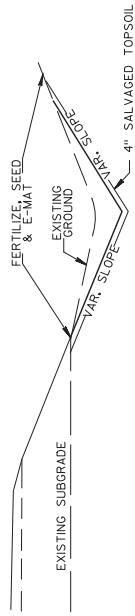

REGRADE DITCH DETAIL
REMOVE ANY BUILT UP SEDIMENTATION, BRUSH, SMALL TREES AND WOODY OR OTHER DEBRIS WITHIN REGRADE LIMITS

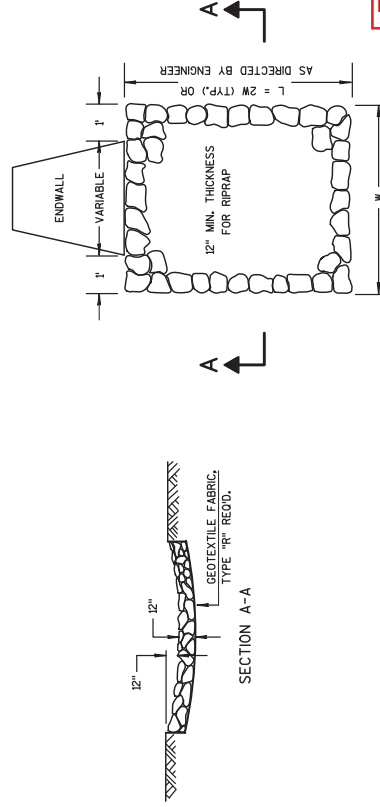
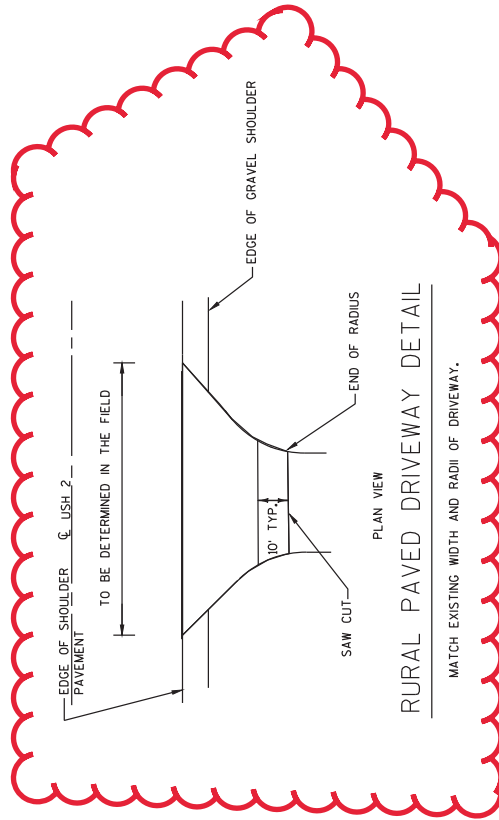

RIPRAP TREATMENT AT CULVERTS

Addendum No. 01
ID 1180-03-74
Revised Sheet 11
May 3, 2018

MISCELLANEOUS QUANTITIES

ROADSIDE CLEARING

CAT	STATION TO STATION	LOC	202.0105 STA	LENGTH FT	REMARKS
0010	1321+56 - 1322+34	ML - R	1	78.00	CLEAR TO 50' FROM CL
0010	1351+00 - 1352+00	ML - L	1	100.00	CLEAR AS NECESSARY FOR DITCH
0010	1355+00 - 1356+00	ML - L	1	100.00	CLEAR AS NECESSARY FOR DITCH
0010	1357+55 - 1357+83	ML - L	1	28.00	CLEAR TO 50' FROM CL
0010	1358+73 - 1359+33	ML - L	1	60.00	CLEAR TO 50' FROM CL
0010	1366+95 - 1367+82	ML - L	1	87.00	CLEAR TO 50' FROM CL
0010	1372+66 - 1374+07	ML - L	1	141.00	CLEAR TO 50' FROM CL
0010	1376+77 - 1377+95	ML - L	1	118.00	CLEAR TO 50' FROM CL
0010	1391+74 - 1392+01	ML - L	1	27.00	CLEAR TO 50' FROM CL
0010	1394+15 - 1395+01	ML - L	1	86.00	CLEAR TO 50' FROM CL
0010	1395+44 - 1397+46	ML - L	2	202.00	CLEAR TO 50' FROM CL
0010	1414+88 - 1415+97	ML - R	1	109.00	CLEAR TO 50' FROM CL
0010	1423+40 - 1425+20	ML - R	2	180.00	CLEAR TO 50' FROM CL
TOTAL 0010					15

REMOVING ASPHALTIC SURFACE MILLING

CAT	STATION TO STATION	LOC	204.0120 SV	REMARKS
0010	114600 - 114850	MAINLINE	1250	
0010	114850 - 136500	MAINLINE	57733	
0010	136500 - 138646	MAINLINE	5723	
0010	138954 - 140833	MAINLINE	5011	
0010	140971 - 143468	MAINLINE	6659	
0010	143468 - 144130	MAINLINE	4392	
0010	121600 - 129300	pass lanes	9526	
0010	125425 - 132775	pass lanes	8870	
0010	120450 - 121000	turn lane	691	
0010	120700 - 121200	turn lane	478	
0010	122650 - 123150	turn lane	616	
0010	123100 - 123600	turn lane	601	
0010	126600 - 127200	turn lane	684	
0010	129650 - 130750	turn lane	1406	
0010	130400 - 130925	turn lane	747	
0010	142150 - 142800	turn lane	756	
0010	137150 - 137850	bypass lane	942	
0010	142000 - 142800	bypass lane	826	
TOTAL 0010				106911

REMOVING ASPHALTIC SURFACE BUTT JOINTS

CAT	STATION	LOC	204.0115 SV	REMARKS
0010	1146+00	ML	239	START OF PROJECT DRIVE
0010	1154+81	LT	39	DRIVE
0010	1169+83	LT	24	DRIVE
0010	1277+30	RT	20	DRIVE
0010	1207+75	SR RT	32	BUDIASH RD
0010	1208+71	SR LT	29	BUDIASH RD
0010	1228+13	SR LT	34	OLD USH 2
0010	1234+22	SR RT	32	HNATH RD
0010	1270+58	SR RT	30	COLBY RD
0010	1285+00	LT	23	DRIVE
0010	1289+14	LT	22	PUYLEART RD
0010	1321+61	LT	14	DRIVE
0010	1305+69	SR RT	20	STH 137
0010	1305+87	SR LT	35	KANES RD
0010	1344+54	RT	31	DRIVE
0010	1346+84	RT	30	DRIVE
0010	1349+41	RT	17	DRIVE
0010	1369+09	RT	29	DRIVE
0010	1375+08	SR RT	35	STATE FARM RD
0010	1386+46	ML	268	BRIDGE DECK
0010	1389+54	ML	256	BRIDGE DECK
0010	1408+33	ML	229	BRIDGE DECK
0010	1409+71	ML	231	BRIDGE DECK
0010	1423+30	SR LT	34	CTH G
0010	1434+64	ML	397	EAST END ASPH PAVT
TOTAL 0010				2150

REMOVING GUARDRAIL

CAT	STATION TO STATION	LOC	204.0165 LF	REMARKS
0010	1379+31 - 1386+19	ML - L	688	TRI COUNTY CORRI DOR
0010	1379+31 - 1386+40	ML - R	709	TRI COUNTY CORRI DOR
0010	1389+55 - 1390+22	ML - L	67	TRI COUNTY CORRI DOR
0010	1389+76 - 1397+23	ML - R	747	TRI COUNTY CORRI DOR
0010	1407+55 - 1408+26	ML - L	71	FISH CREEK
0010	1407+55 - 1408+26	ML - R	71	FISH CREEK
0010	1409+78 - 1410+46	ML - L	68	FISH CREEK
0010	1409+78 - 1410+46	ML - R	68	FISH CREEK
TOTAL 0010				2489

Addendum No. 01
ID 1180-03-74
Revised Sheet 29
May 3, 2018

MISCELLANEOUS QUANTITIES

EROSION CONTROL SUMMARY

CAT	STATION	LOC	SILT FENCE		SILT MAINT		MOB CONTROL		EROSION CONTROL		EROSION MAT		FERTILIZER		SEED MIX		SEED TEMPORARY		REMARKS
			LF	LF	LF	LF	EACH	EACH	SY	TYPE C	TYPE B	CWT	LB	LB	LB	LB	LB		
0010	1225+07	PROJECT	500	500	30	1	3	1	44	0.03	0.40	0.80	UNDISTRI BUTED						CLEANING CULVERT ENDS
0010	1235+57	CULVERT END - L & R						44	0.03	0.40	0.80	CLEANING CULVERT ENDS							CLEANING CULVERT ENDS
0010	1242+19	CULVERT END - L & R						44	0.03	0.40	0.80	CLEANING CULVERT ENDS							CLEANING CULVERT ENDS
0010	1253+00	CULVERT END - L & R						44	0.03	0.40	0.80	CLEANING CULVERT ENDS							CLEANING CULVERT ENDS
0010	1257+32	CULVERT END - L & R						44	0.03	0.40	0.80	CLEANING CULVERT ENDS							CLEANING CULVERT ENDS
0010	1264+55	CULVERT END - L & R						44	0.03	0.40	0.80	CLEANING CULVERT ENDS							CLEANING CULVERT ENDS
0010	1289+88	CULVERT END - L						22	0.03	0.40	0.80	CLEANING CULVERT ENDS							CLEANING CULVERT ENDS
0010	1307+39	CULVERT END - L & R						44	0.03	0.40	0.80	CLEANING CULVERT ENDS							CLEANING CULVERT ENDS
0010	1323+64	CULVERT END - R						22	0.03	0.40	0.80	CLEANING CULVERT ENDS							CLEANING CULVERT ENDS
0010	1327+99	CULVERT END - R						22	0.03	0.40	0.80	CLEANING CULVERT ENDS							CLEANING CULVERT ENDS
0010	1330+99	CULVERT END - L & R						44	0.03	0.40	0.80	CLEANING CULVERT ENDS							CLEANING CULVERT ENDS
0010	1335+64	CULVERT END - R						22	0.03	0.40	0.80	CLEANING CULVERT ENDS							CLEANING CULVERT ENDS
0010	1351+70	CULVERT END - L						50	0.03	0.88	1.76	CLEANING CULVERT ENDS							CLEANING CULVERT ENDS
0010	1355+83	CULVERT END - L						33	0.03	0.60	1.20	OUT TO R/W (80' FROM CL)							OUT TO SWALE IN WOODS
0010	1355+83	CULVERT END - R						22	0.03	0.40	0.80	CLEANING CULVERT ENDS							CLEANING CULVERT ENDS
0010	1365+13	CULVERT END - R						22	0.03	0.40	0.80	CLEANING CULVERT ENDS							CLEANING CULVERT ENDS
0010	1370+14	CULVERT END - R						22	0.03	0.40	0.80	CLEANING CULVERT ENDS							CLEANING CULVERT ENDS
0010	1425+61	CULVERT END - L & R						44	0.03	0.40	0.80	CLEANING CULVERT ENDS							CLEANING CULVERT ENDS
0010	1434+67	CULVERT END - L & R						44	0.03	0.40	0.80	CLEANING CULVERT ENDS							CLEANING CULVERT ENDS
TOTAL 0010			30	500	500	3	1	677	0.57	8.28	16.56								

TRAFFIC CONTROL SUMMARY

643.0300	TRAFFIC CONTROL DRUMS	DAY	643.0610. S	TEMPORARY PORTABLE RUMBLE STRIPS	LS	1	643.0900	TRAFFIC CONTROL SIGNS	DAY	643.5000	TRAFFIC CONTROL	EACH	1	REMARKS
0010	PROJECT	225	48	0	1	ADVANCED WARNING FOR MOVING OPERATIONS (15C12)								
0010	PROJECT	5808	250	220	1	WORK ON SHOULDER-PIPES SIDE ROADS								
0010	PROJECT	6033	220	518	1	SMA MAINLINE (15D39-1)								
TOTAL 0010			1	1	518									

Addendum No. 01
ID 1180-03-74
Revised Sheet 33
May 3, 2018

Addendum No. 01
 ID 1180-03-74
 Revised Sheet 42
 May 3, 2018

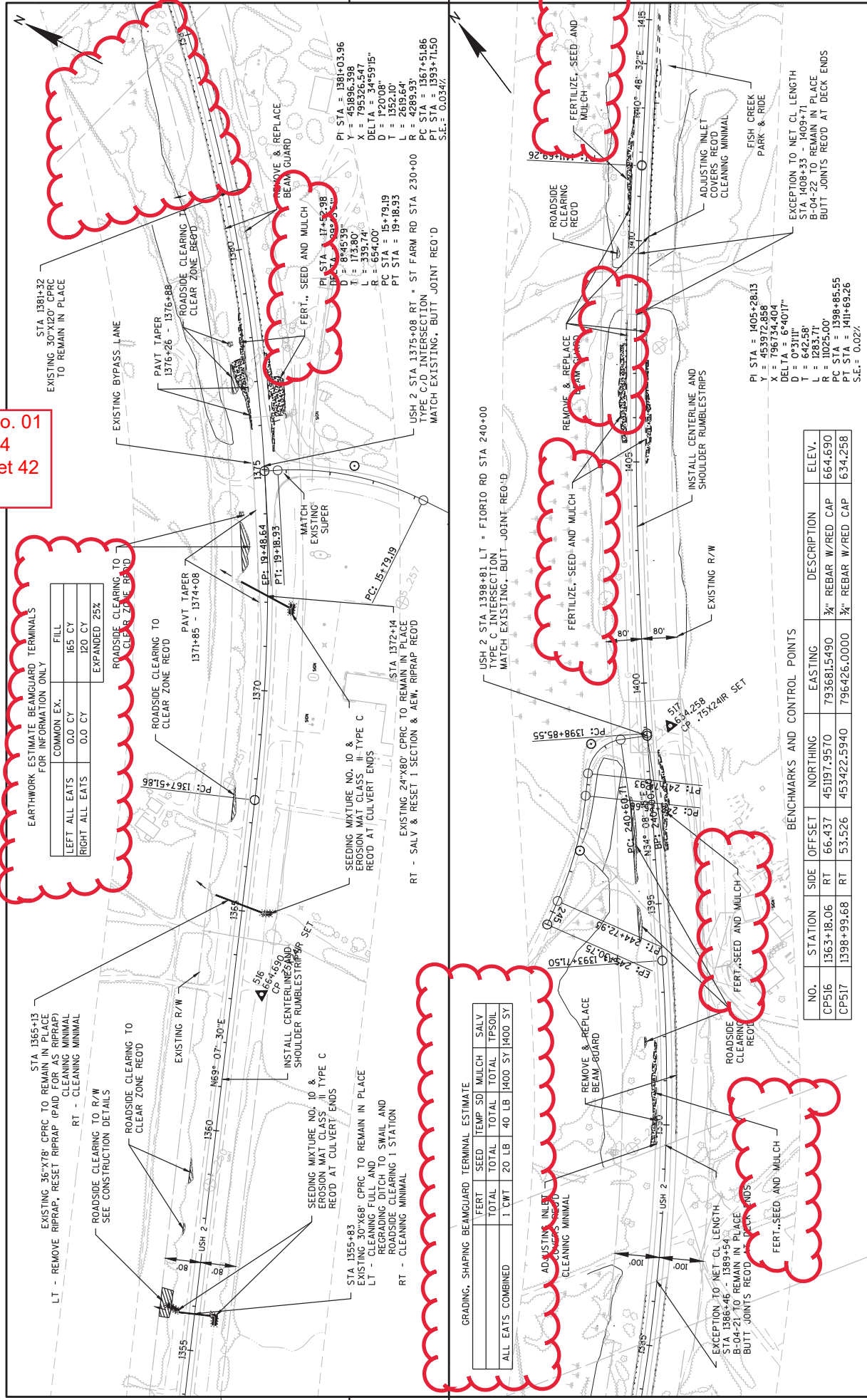

EARTHWORK ESTIMATE BEAMGUARD TERMINALS FOR INFORMATION ONLY

COMMON EX.	FILL
LEFT ALL EATS 0.0 CY	165 CY
RIGHT ALL EATS 0.0 CY	120 CY
	EXPANDED 25%

GRADING, SHAPING BEAMGUARD TERMINAL ESTIMATE

FERT	SEED	TEMP SDI	MULCH	SALV
TOTAL	TOTAL	TOTAL	TOTAL	TOTAL
1 CWT	20 LB	40 LB	1400 SY	1400 SY

BENCHMARKS AND CONTROL POINTS

NO.	STATION	SIDE	OFFSET	NORTHING	EASTING	DESCRIPTION	ELEV.
CP516	1363+18.06	RT	66.437	451097.9570	793681.5490	3/4" REBAR W/RED CAP	664.690
CP517	1398+99.68	RT	53.526	453422.5940	796426.0000	3/4" REBAR W/RED CAP	634.258

STA 1355+83
 EXISTING 36"X18" CPRC TO REMAIN IN PLACE
 LT - REMOVE RIPRAP, RESET RIPRAP (PAID FOR AS RIPRAP)
 RT - CLEANING MINIMAL
 CLEANING MINIMAL
 SEE CONSTRUCTION DETAILS

STA 1365+13
 EXISTING 30"X20" CPRC TO REMAIN IN PLACE
 RT - CLEANING MINIMAL

STA 1376+88
 EXISTING BYPASS LANE
 PAVT TAPER 1376+26 - 1376+88
 ROADSIDE CLEARING TO CLEAR ZONE RECD

STA 1377+14
 EXISTING 24"X80" CPRC TO REMAIN IN PLACE
 RT - SALV & RESET 1 SECTION & AEW, RIPRAP RECD

STA 1377+14
 SEEDING MIXTURE NO. 10 & EROSION MAT CLASS II-TYPE C RECD AT CULVERT ENDS

STA 1377+14
 EXISTING 30"X20" CPRC TO REMAIN IN PLACE
 RT - CLEANING MINIMAL

STA 1377+14
 EXISTING 30"X20" CPRC TO REMAIN IN PLACE
 RT - CLEANING MINIMAL

STA 1377+14
 EXISTING 30"X20" CPRC TO REMAIN IN PLACE
 RT - CLEANING MINIMAL

STA 1377+14
 EXISTING 30"X20" CPRC TO REMAIN IN PLACE
 RT - CLEANING MINIMAL

STA 1377+14
 EXISTING 30"X20" CPRC TO REMAIN IN PLACE
 RT - CLEANING MINIMAL

STA 1377+14
 EXISTING 30"X20" CPRC TO REMAIN IN PLACE
 RT - CLEANING MINIMAL

STA 1376+88
 EXISTING 30"X20" CPRC TO REMAIN IN PLACE
 RT - CLEANING MINIMAL

STA 1376+88
 EXISTING 30"X20" CPRC TO REMAIN IN PLACE
 RT - CLEANING MINIMAL

STA 1376+88
 EXISTING 30"X20" CPRC TO REMAIN IN PLACE
 RT - CLEANING MINIMAL

STA 1376+88
 EXISTING 30"X20" CPRC TO REMAIN IN PLACE
 RT - CLEANING MINIMAL

STA 1376+88
 EXISTING 30"X20" CPRC TO REMAIN IN PLACE
 RT - CLEANING MINIMAL

STA 1376+88
 EXISTING 30"X20" CPRC TO REMAIN IN PLACE
 RT - CLEANING MINIMAL

STA 1376+88
 EXISTING 30"X20" CPRC TO REMAIN IN PLACE
 RT - CLEANING MINIMAL

STA 1376+88
 EXISTING 30"X20" CPRC TO REMAIN IN PLACE
 RT - CLEANING MINIMAL

STA 1376+88
 EXISTING 30"X20" CPRC TO REMAIN IN PLACE
 RT - CLEANING MINIMAL

STA 1376+88
 EXISTING 30"X20" CPRC TO REMAIN IN PLACE
 RT - CLEANING MINIMAL

STA 1376+88
 EXISTING 30"X20" CPRC TO REMAIN IN PLACE
 RT - CLEANING MINIMAL

STA 1376+88
 EXISTING 30"X20" CPRC TO REMAIN IN PLACE
 RT - CLEANING MINIMAL

STA 1376+88
 EXISTING 30"X20" CPRC TO REMAIN IN PLACE
 RT - CLEANING MINIMAL

STA 1376+88
 EXISTING 30"X20" CPRC TO REMAIN IN PLACE
 RT - CLEANING MINIMAL

STA 1376+88
 EXISTING 30"X20" CPRC TO REMAIN IN PLACE
 RT - CLEANING MINIMAL

STA 1376+88
 EXISTING 30"X20" CPRC TO REMAIN IN PLACE
 RT - CLEANING MINIMAL

STA 1376+88
 EXISTING 30"X20" CPRC TO REMAIN IN PLACE
 RT - CLEANING MINIMAL

STA 1376+88
 EXISTING 30"X20" CPRC TO REMAIN IN PLACE
 RT - CLEANING MINIMAL

STA 1376+88
 EXISTING 30"X20" CPRC TO REMAIN IN PLACE
 RT - CLEANING MINIMAL

STA 1376+88
 EXISTING 30"X20" CPRC TO REMAIN IN PLACE
 RT - CLEANING MINIMAL

STA 1376+88
 EXISTING 30"X20" CPRC TO REMAIN IN PLACE
 RT - CLEANING MINIMAL

STA 1376+88
 EXISTING 30"X20" CPRC TO REMAIN IN PLACE
 RT - CLEANING MINIMAL

STA 1376+88
 EXISTING 30"X20" CPRC TO REMAIN IN PLACE
 RT - CLEANING MINIMAL

STA 1376+88
 EXISTING 30"X20" CPRC TO REMAIN IN PLACE
 RT - CLEANING MINIMAL

STA 1376+88
 EXISTING 30"X20" CPRC TO REMAIN IN PLACE
 RT - CLEANING MINIMAL

STA 1376+88
 EXISTING 30"X20" CPRC TO REMAIN IN PLACE
 RT - CLEANING MINIMAL

STA 1376+88
 EXISTING 30"X20" CPRC TO REMAIN IN PLACE
 RT - CLEANING MINIMAL

STA 1376+88
 EXISTING 30"X20" CPRC TO REMAIN IN PLACE
 RT - CLEANING MINIMAL

STA 1376+88
 EXISTING 30"X20" CPRC TO REMAIN IN PLACE
 RT - CLEANING MINIMAL

STA 1376+88
 EXISTING 30"X20" CPRC TO REMAIN IN PLACE
 RT - CLEANING MINIMAL

STA 1376+88
 EXISTING 30"X20" CPRC TO REMAIN IN PLACE
 RT - CLEANING MINIMAL

STA 1376+88
 EXISTING 30"X20" CPRC TO REMAIN IN PLACE
 RT - CLEANING MINIMAL

STA 1376+88
 EXISTING 30"X20" CPRC TO REMAIN IN PLACE
 RT - CLEANING MINIMAL

STA 1376+88
 EXISTING 30"X20" CPRC TO REMAIN IN PLACE
 RT - CLEANING MINIMAL

STA 1376+88
 EXISTING 30"X20" CPRC TO REMAIN IN PLACE
 RT - CLEANING MINIMAL

STA 1376+88
 EXISTING 30"X20" CPRC TO REMAIN IN PLACE
 RT - CLEANING MINIMAL

STA 1376+88
 EXISTING 30"X20" CPRC TO REMAIN IN PLACE
 RT - CLEANING MINIMAL

STA 1376+88
 EXISTING 30"X20" CPRC TO REMAIN IN PLACE
 RT - CLEANING MINIMAL

STA 1376+88
 EXISTING 30"X20" CPRC TO REMAIN IN PLACE
 RT - CLEANING MINIMAL

STA 1376+88
 EXISTING 30"X20" CPRC TO REMAIN IN PLACE
 RT - CLEANING MINIMAL

STA 1376+88
 EXISTING 30"X20" CPRC TO REMAIN IN PLACE
 RT - CLEANING MINIMAL

STA 1376+88
 EXISTING 30"X20" CPRC TO REMAIN IN PLACE
 RT - CLEANING MINIMAL

STA 1376+88
 EXISTING 30"X20" CPRC TO REMAIN IN PLACE
 RT - CLEANING MINIMAL

STA 1376+88
 EXISTING 30"X20" CPRC TO REMAIN IN PLACE
 RT - CLEANING MINIMAL

STA 1376+88
 EXISTING 30"X20" CPRC TO REMAIN IN PLACE
 RT - CLEANING MINIMAL

STA 1376+88
 EXISTING 30"X20" CPRC TO REMAIN IN PLACE
 RT - CLEANING MINIMAL

STA 1376+88
 EXISTING 30"X20" CPRC TO REMAIN IN PLACE
 RT - CLEANING MINIMAL

STA 1376+88
 EXISTING 30"X20" CPRC TO REMAIN IN PLACE
 RT - CLEANING MINIMAL

STA 1376+88
 EXISTING 30"X20" CPRC TO REMAIN IN PLACE
 RT - CLEANING MINIMAL

STA 1376+88
 EXISTING 30"X20" CPRC TO REMAIN IN PLACE
 RT - CLEANING MINIMAL

STA 1376+88
 EXISTING 30"X20" CPRC TO REMAIN IN PLACE
 RT - CLEANING MINIMAL

STA 1376+88
 EXISTING 30"X20" CPRC TO REMAIN IN PLACE
 RT - CLEANING MINIMAL

STA 1376+88
 EXISTING 30"X20" CPRC TO REMAIN IN PLACE
 RT - CLEANING MINIMAL

STA 1376+88
 EXISTING 30"X20" CPRC TO REMAIN IN PLACE
 RT - CLEANING MINIMAL

STA 1376+88
 EXISTING 30"X20" CPRC TO REMAIN IN PLACE
 RT - CLEANING MINIMAL

STA 1376+88
 EXISTING 30"X20" CPRC TO REMAIN IN PLACE
 RT - CLEANING MINIMAL

STA 1376+88
 EXISTING 30"X20" CPRC TO REMAIN IN PLACE
 RT - CLEANING MINIMAL

STA 1376+88
 EXISTING 30"X20" CPRC TO REMAIN IN PLACE
 RT - CLEANING MINIMAL

STA 1376+88
 EXISTING 30"X20" CPRC TO REMAIN IN PLACE
 RT - CLEANING MINIMAL

STA 1376+88
 EXISTING 30"X20" CPRC TO REMAIN IN PLACE
 RT - CLEANING MINIMAL

STA 1376+88
 EXISTING 30"X20" CPRC TO REMAIN IN PLACE
 RT - CLEANING MINIMAL

STA 1376+88
 EXISTING 30"X20" CPRC TO REMAIN IN PLACE
 RT - CLEANING MINIMAL

STA 1376+88
 EXISTING 30"X20" CPRC TO REMAIN IN PLACE
 RT - CLEANING MINIMAL

STA 1376+88
 EXISTING 30"X20" CPRC TO REMAIN IN PLACE
 RT - CLEANING MINIMAL

STA 1376+88
 EXISTING 30"X20" CPRC TO REMAIN IN PLACE
 RT - CLEANING MINIMAL

STA 1376+88
 EXISTING 30"X20" CPRC TO REMAIN IN PLACE
 RT - CLEANING MINIMAL

STA 1376+88
 EXISTING 30"X20" CPRC TO REMAIN IN PLACE
 RT - CLEANING MINIMAL

STA 1376+88
 EXISTING 30"X20" CPRC TO REMAIN IN PLACE
 RT - CLEANING MINIMAL

STA 1376+88
 EXISTING 30"X20" CPRC TO REMAIN IN PLACE
 RT - CLEANING MINIMAL

STA 1376+88
 EXISTING 30"X20" CPRC TO REMAIN IN PLACE
 RT - CLEANING MINIMAL

STA 1376+88
 EXISTING 30"X20" CPRC TO REMAIN IN PLACE
 RT - CLEANING MINIMAL

STA 1376+88
 EXISTING 30"X20" CPRC TO REMAIN IN PLACE
 RT - CLEANING MINIMAL

STA 1376+88
 EXISTING 30"X20" CPRC TO REMAIN IN PLACE
 RT - CLEANING MINIMAL

STA 1376+88
 EXISTING 30"X20" CPRC TO REMAIN IN PLACE
 RT - CLEANING MINIMAL

STA 1376+88
 EXISTING 30"X20" CPRC TO REMAIN IN PLACE
 RT - CLEANING MINIMAL

STA 1376+88
 EXISTING 30"X20" CPRC TO REMAIN IN PLACE
 RT - CLEANING MINIMAL

STA 1376+88
 EXISTING 30"X20" CPRC TO REMAIN IN PLACE
 RT - CLEANING MINIMAL

Addendum No. 01
 ID 1180-03-74
 Revised Sheet 146
 May 3, 2018

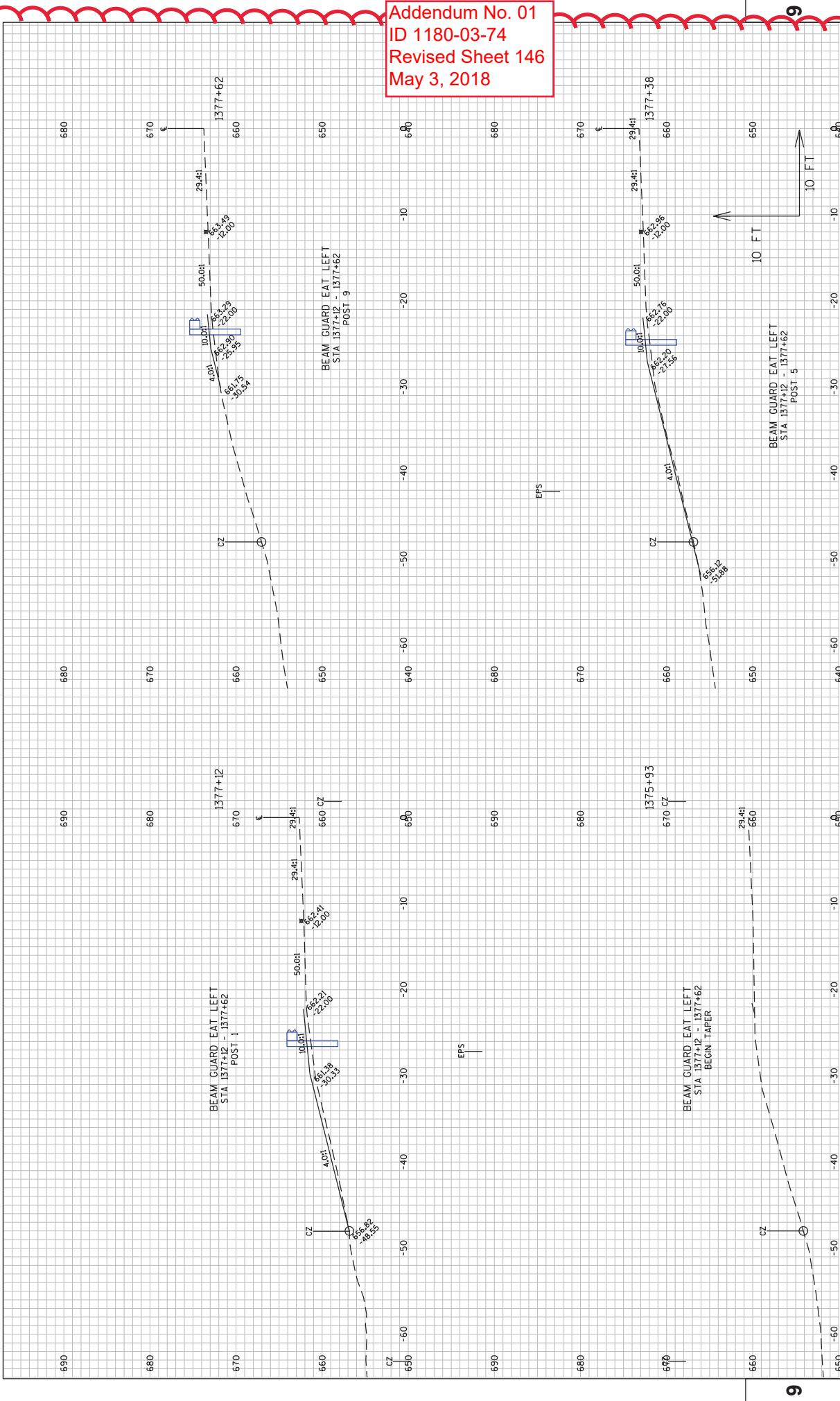

Addendum No. 01
 ID 1180-03-74
 Revised Sheet 147
 May 3, 2018

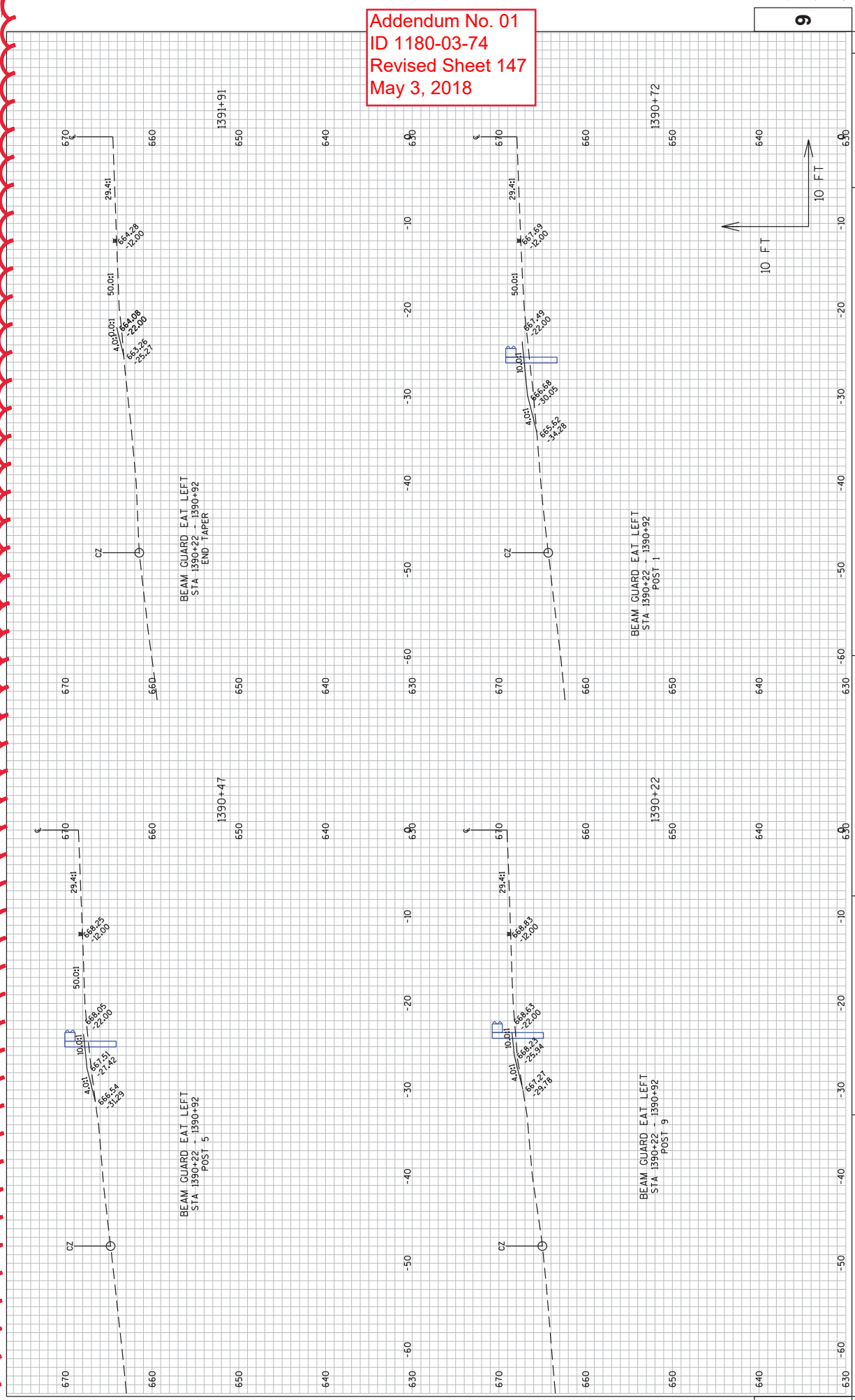

Addendum No. 01
 ID 1180-03-74
 Revised Sheet 148
 May 3, 2018

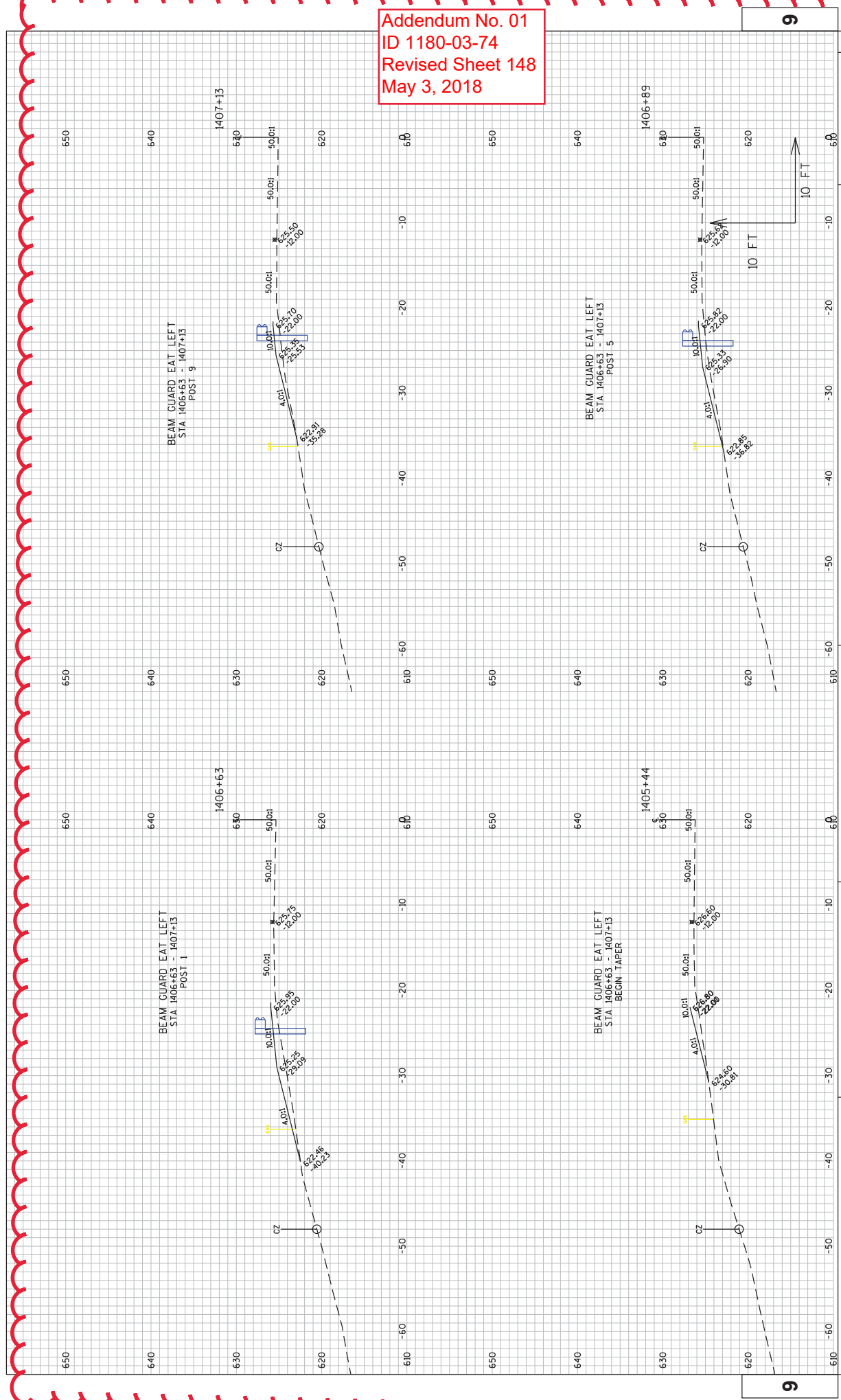

Addendum No. 01
 ID 1180-03-74
 Revised Sheet 149
 May 3, 2018

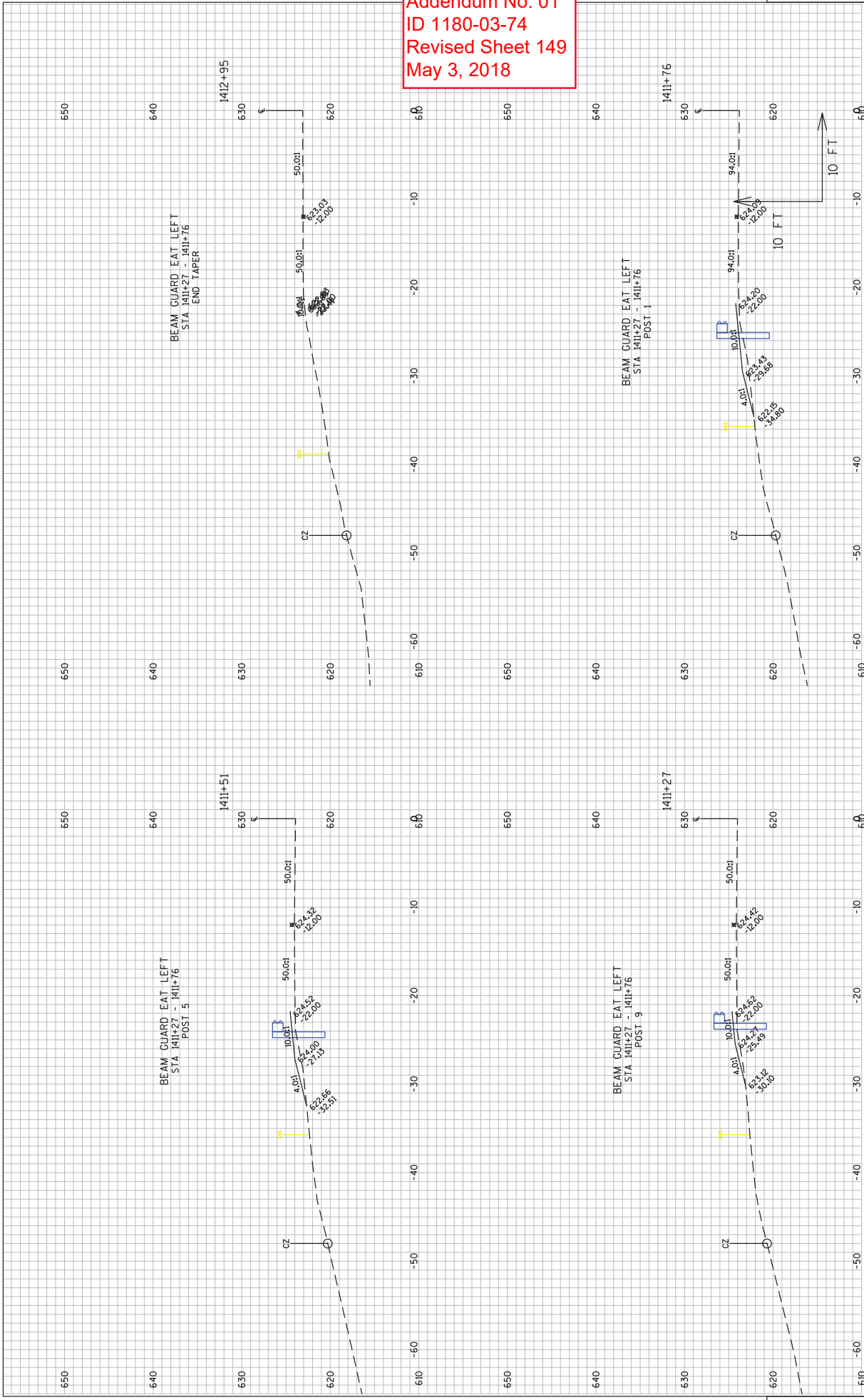

Addendum No. 01
 ID 1180-03-74
 Revised Sheet 150
 May 3, 2018

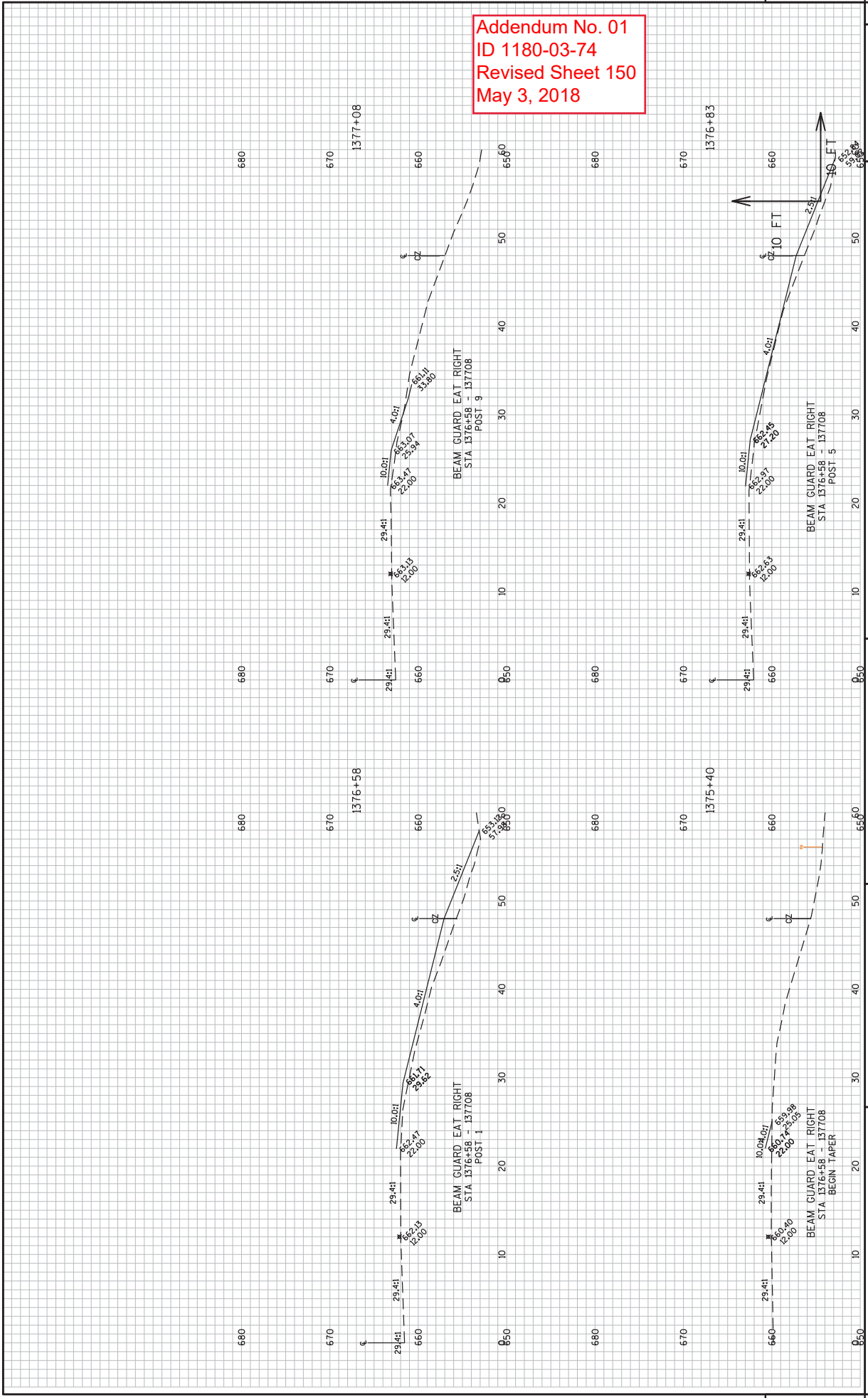

Addendum No. 01
 ID 1180-03-74
 Revised Sheet 151
 May 3, 2018

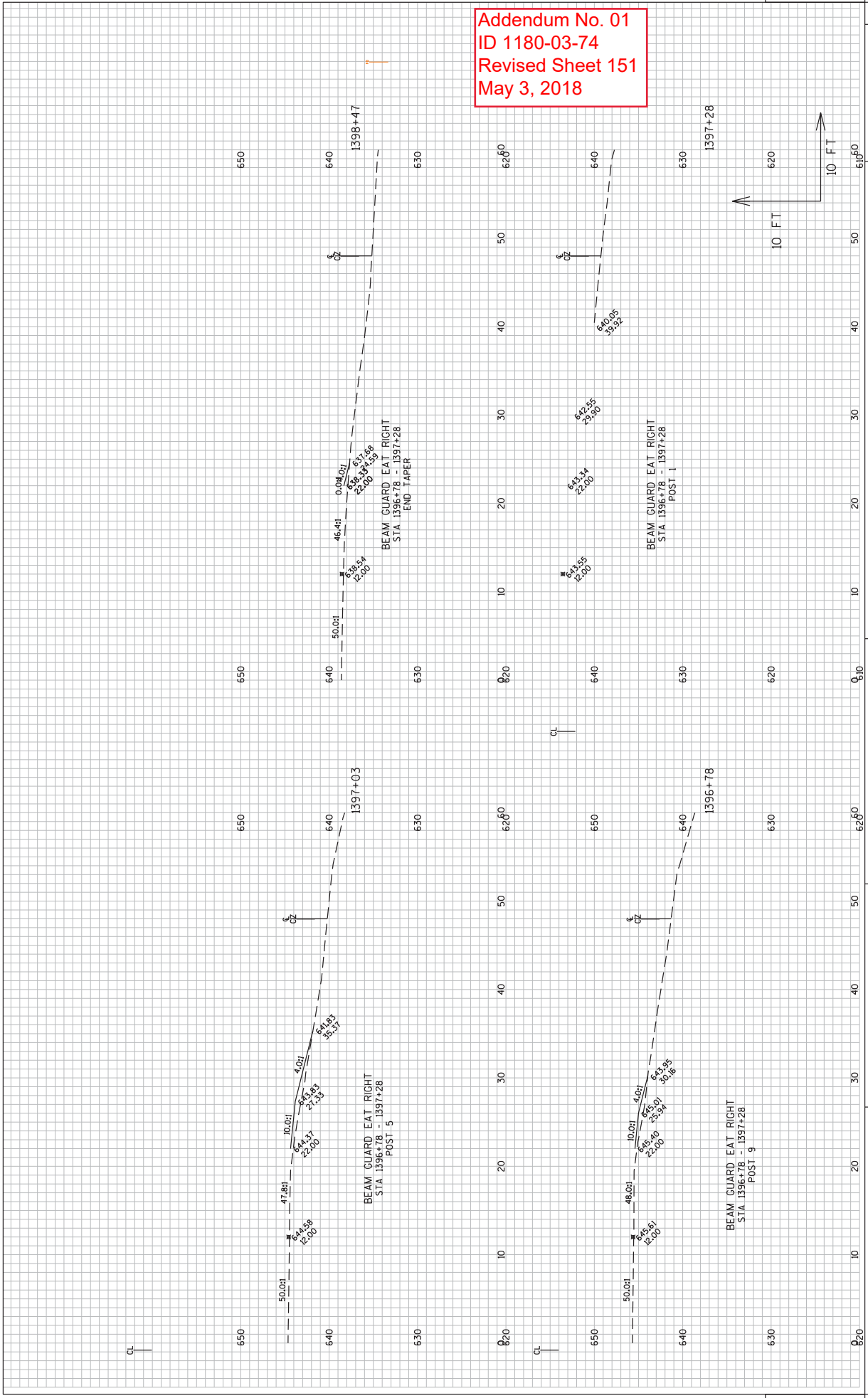

Addendum No. 01
 ID 1180-03-74
 Revised Sheet 152
 May 3, 2018

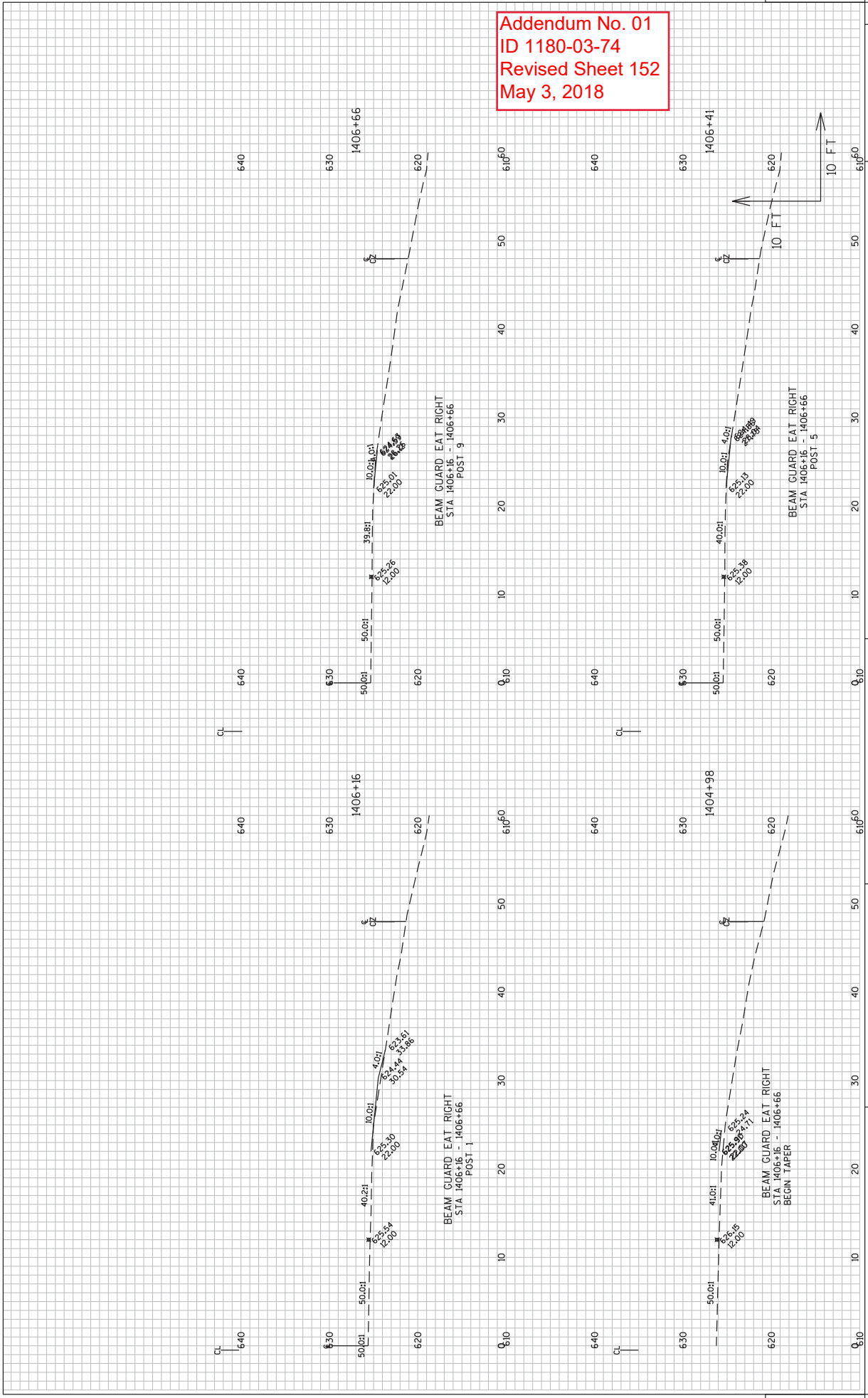

Addendum No. 01
 ID 1180-03-74
 Revised Sheet 153
 May 3, 2018

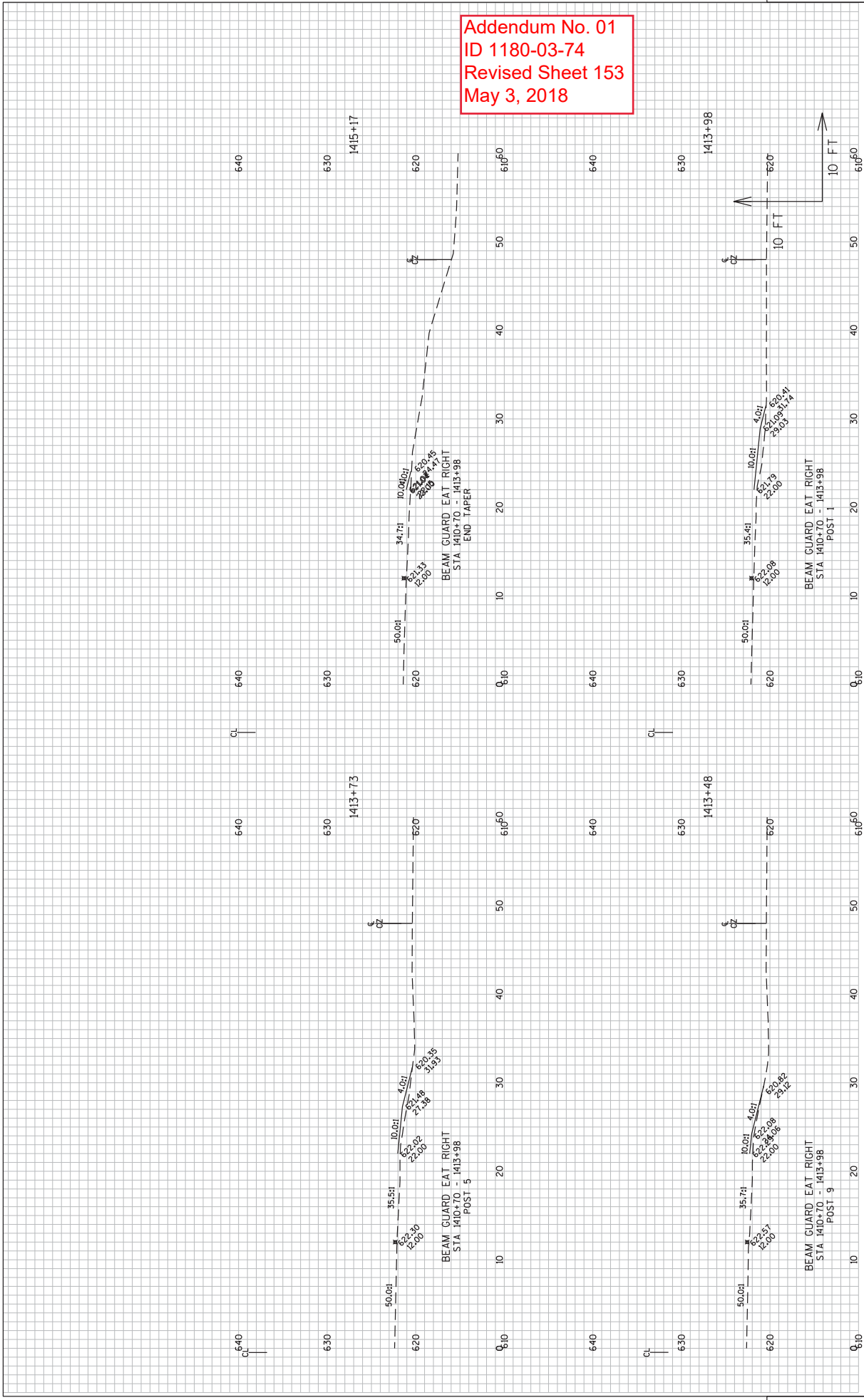



Proposal Schedule of Items

Proposal ID: 20180508033 Project(s): 1180-03-74

Federal ID(s): WISC 2018255

SECTION: 0001

Contract Items

Alt Set ID:

Alt Mbr ID:

Proposal Line Number	Item ID Description	Approximate Quantity and Units	Unit Price	Bid Amount
0002	202.0105 Roadside Clearing	15.000 STA	_____.	_____.
0004	204.0115 Removing Asphaltic Surface Butt Joints	2,150.000 SY	_____.	_____.
0006	204.0120 Removing Asphaltic Surface Milling	106,911.000 SY	_____.	_____.
0008	204.0150 Removing Curb & Gutter	81.000 LF	_____.	_____.
0010	204.0165 Removing Guardrail	2,489.000 LF	_____.	_____.
0012	211.0100 Prepare Foundation for Asphaltic Paving (project) 01. 1180-03-74	LS	LUMP SUM	_____.
0014	213.0100 Finishing Roadway (project) 01. 1180-03-74	1.000 EACH	_____.	_____.
0016	305.0110 Base Aggregate Dense 3/4-Inch	3,990.000 TON	_____.	_____.
0018	305.0500 Shaping Shoulders	582.000 STA	_____.	_____.
0020	440.4410 Incentive IRI Ride	27,734.000 DOL	1.00000	27,734.00
0022	455.0605 Tack Coat	16,261.000 GAL	_____.	_____.
0024	460.0100.S HMA Pavement Test Strip	1.000 EACH	_____.	_____.
0026	460.2000 Incentive Density HMA Pavement	19,910.000 DOL	1.00000	19,910.00
0028	460.4110.S Reheating HMA Pavement Longitudinal Joints	50,780.000 LF	_____.	_____.
0030	460.5244 HMA Pavement 4 LT 58-34 S	6,370.000 TON	_____.	_____.
0032	460.6244 HMA Pavement 4 MT 58-34 S	13,753.000 TON	_____.	_____.



Proposal Schedule of Items

Proposal ID: 20180508033 Project(s): 1180-03-74

Federal ID(s): WISC 2018255

SECTION: 0001

Contract Items

Alt Set ID:

Alt Mbr ID:

Proposal Line Number	Item ID Description	Approximate Quantity and Units	Unit Price	Bid Amount
0034	460.8644 HMA Pavement 4 SMA 58-34 V	10,976.000 TON	_____.	_____.
0036	465.0110 Asphaltic Surface Patching	300.000 TON	_____.	_____.
0038	465.0120 Asphaltic Surface Driveways and Field Entrances	122.000 TON	_____.	_____.
0040	465.0425 Asphaltic Shoulder Rumble Strips 2-Lane Rural	56,002.000 LF	_____.	_____.
0042	465.0475 Asphalt Centerline Rumble Strips 2-Lane Rural	29,501.000 LF	_____.	_____.
0044	524.0124 Culvert Pipe Salvaged 24-Inch	16.000 LF	_____.	_____.
0046	524.0624 Apron Endwalls for Culvert Pipe Salvaged 24-Inch	2.000 EACH	_____.	_____.
0048	601.0557 Concrete Curb & Gutter 6-Inch Sloped 36-Inch Type D	81.000 LF	_____.	_____.
0050	606.0200 Riprap Medium	98.000 CY	_____.	_____.
0052	611.8115 Adjusting Inlet Covers	2.000 EACH	_____.	_____.
0054	614.0010 Barrier System Grading Shaping Finishing	8.000 EACH	_____.	_____.
0056	614.2300 MGS Guardrail 3	2,714.000 LF	_____.	_____.
0058	614.2500 MGS Thrie Beam Transition	312.000 LF	_____.	_____.
0060	614.2610 MGS Guardrail Terminal EAT	8.000 EACH	_____.	_____.
0062	618.0100 Maintenance And Repair of Haul Roads (project) 01. 1180-03-74	1.000 EACH	_____.	_____.



Proposal Schedule of Items

Proposal ID: 20180508033 Project(s): 1180-03-74

Federal ID(s): WISC 2018255

SECTION: 0001

Contract Items

Alt Set ID:

Alt Mbr ID:

Proposal Line Number	Item ID Description	Approximate Quantity and Units	Unit Price	Bid Amount
0064	619.1000 Mobilization	1.000 EACH	_____.	_____.
0066	624.0100 Water	80.000 MGAL	_____.	_____.
0068	625.0500 Salvaged Topsoil	20.000 SY	_____.	_____.
0070	628.1104 Erosion Bales	30.000 EACH	_____.	_____.
0072	628.1504 Silt Fence	500.000 LF	_____.	_____.
0074	628.1520 Silt Fence Maintenance	500.000 LF	_____.	_____.
0076	628.1905 Mobilizations Erosion Control	3.000 EACH	_____.	_____.
0078	628.1910 Mobilizations Emergency Erosion Control	1.000 EACH	_____.	_____.
0080	628.2027 Erosion Mat Class II Type C	677.000 SY	_____.	_____.
0082	629.0210 Fertilizer Type B	0.570 CWT	_____.	_____.
0084	630.0110 Seeding Mixture No. 10	8.280 LB	_____.	_____.
0086	630.0200 Seeding Temporary	16.560 LB	_____.	_____.
0088	633.5200 Markers Culvert End	56.000 EACH	_____.	_____.
0090	634.0616 Posts Wood 4x6-Inch X 16-FT	84.000 EACH	_____.	_____.
0092	637.2210 Signs Type II Reflective H	592.880 SF	_____.	_____.
0094	637.2230 Signs Type II Reflective F	130.250 SF	_____.	_____.
0096	638.2602 Removing Signs Type II	78.000 EACH	_____.	_____.



Proposal Schedule of Items

Proposal ID: 20180508033 Project(s): 1180-03-74

Federal ID(s): WISC 2018255

SECTION: 0001

Contract Items

Alt Set ID:

Alt Mbr ID:

Proposal Line Number	Item ID Description	Approximate Quantity and Units	Unit Price	Bid Amount
0098	638.3000 Removing Small Sign Supports	88.000 EACH	_____.	_____.
0100	642.5201 Field Office Type C	1.000 EACH	_____.	_____.
0102	643.0300 Traffic Control Drums	6,033.000 DAY	_____.	_____.
0104	643.0310.S Temporary Portable Rumble Strips	1.000 LS	_____.	_____.
0106	643.0900 Traffic Control Signs	518.000 DAY	_____.	_____.
0108	643.5000 Traffic Control	1.000 EACH	_____.	_____.
0110	645.0130 Geotextile Type R	199.000 SY	_____.	_____.
0112	646.1020 Marking Line Epoxy 4-Inch	34,392.000 LF	_____.	_____.
0114	646.1040 Marking Line Grooved Wet Ref Epoxy 4-Inch	57,760.000 LF	_____.	_____.
0116	646.1545 Marking Line Grooved Wet Ref Contrast Epoxy 4-Inch	3,525.000 LF	_____.	_____.
0118	646.3545 Marking Line Grooved Wet Ref Contrast Epoxy 8-Inch	1,819.000 LF	_____.	_____.
0120	646.4520 Marking Line Same Day Epoxy 4-Inch	34,392.000 LF	_____.	_____.
0122	646.5020 Marking Arrow Epoxy	2.000 EACH	_____.	_____.
0124	646.5120 Marking Word Epoxy	1.000 EACH	_____.	_____.
0126	646.6120 Marking Stop Line Epoxy 18-Inch	100.000 LF	_____.	_____.
0128	646.7120 Marking Diagonal Epoxy 12-Inch	141.000 LF	_____.	_____.



Proposal Schedule of Items

Proposal ID: 20180508033 Project(s): 1180-03-74

Federal ID(s): WISC 2018255

SECTION: 0001

Contract Items

Alt Set ID:

Alt Mbr ID:

Proposal Line Number	Item ID Description	Approximate Quantity and Units	Unit Price	Bid Amount
0130	648.0100 Locating No-Passing Zones	6.000 MI	_____.	_____.
0132	649.0105 Temporary Marking Line Paint 4-Inch	31,719.000 LF	_____.	_____.
0134	650.8000 Construction Staking Resurfacing Reference	29,530.000 LF	_____.	_____.
0136	650.9910 Construction Staking Supplemental Control (project) 01. 1180-03-74	LS	LUMP SUM	_____.
0138	690.0150 Sawing Asphalt	560.000 LF	_____.	_____.
0140	ASP.1T0A On-the-Job Training Apprentice at \$5.00/HR	2,000.000 HRS	5.00000	10,000.00
0142	ASP.1T0G On-the-Job Training Graduate at \$5.00/HR	630.000 HRS	5.00000	3,150.00
0144	SPV.0060 Special 01. Cleaning Culvert Pipes Minimal	23.000 EACH	_____.	_____.
0146	SPV.0060 Special 02. Cleaning Culvert Pipes Full	8.000 EACH	_____.	_____.
0148	SPV.0090 Special 01. Regrading Ditch	279.000 LF	_____.	_____.
0150	SPV.0090 Special 02. Concrete Curb and Gutter Cure and Seal Treatment	81.000 LF	_____.	_____.
0152	SPV.0105 Special 01. Milling and Removing Temporary Joint Special	LS	LUMP SUM	_____.
0154	SPV.0105 Special 02. Material Transfer Vehicle	LS	LUMP SUM	_____.
0156	650.5500 Construction Staking Curb Gutter and Curb & Gutter	81.000 LF	_____.	_____.
Section: 0001			Total:	_____.

Total Bid: _____.

