



Wisconsin Department of Transportation

Division of Transportation Systems Development

Bureau of Project Development
4822 Madison Yards Way, 4th Floor South
Madison, WI 53705

November 27, 2018

Telephone: (608) 266-1631
Facsimile (FAX): (608) 266-8459

NOTICE TO ALL CONTRACTORS:

Proposal #15: 2415-00-71, WISC 2019 008
South 60th Street
W Morgan Ave to KK Rvr Pkwy
Local Street
Milwaukee County

Letting of December 11, 2018

This is Addendum No. 01, which provides for the following:

Special Provisions:

Added Special Provisions	
Article No.	Description
85	Riprap, Special Heavy, Item SPV.0035.010
86	Site Grading & Restoration, Item SPV.0105.010
87	Notice to Contractor – Milwaukee County Parks Coordination

Schedule of Items:

Added Bid Item Quantities					
Bid Item	Item Description	Unit	Old Quantity	Revised Quantity	Proposal Total
SPV.0035.010	Riprap, Special Heavy	CY	0	166	166
SPV.0105.010	Site Grading & Restoration	LS	0	1	1

Deleted Bid Item Quantities					
Bid Item	Item Description	Unit	Old Quantity	Revised Quantity	Proposal Total
606.0300	Riprap Heavy	CY	166	-166	0

Plan Sheets:

Revised Plan Sheets	
Plan Sheet	Plan Sheet Title (brief description of changes to sheet)
10	Construction Details (Updated Storm Sewer Outfall Detail callouts)
107	Erosion Control (Updated legend)
242	Misc. Quantities (Updated bid item name; added new item)

The responsibility for notifying potential subcontractors and suppliers of these changes remains with the prime contractor.

Sincerely,

Mike Coleman

Proposal Development Specialist
Proposal Management Section

ADDENDUM NO. 01
PROJECT ID 2415-00-71
November 27, 2018

Special Provisions

85. Riprap, Special Heavy, Item SPV.0035.010.

A Description

This special provision describes furnishing and placing Riprap, Special Heavy as shown on the plans.

B Materials

Furnish durable Wisconsin Granite Boulders and Joliet Boulders, or equivalent granite and dolomite boulders, that are sound, hard, dense, resistant to the action of air and water, and free of seams, cracks, or other structural defects. Each load of Riprap, Special Heavy delivered to the project site shall be a mixture of 33% Wisconsin Granite Boulders and 67% Joliet Boulders by weight. Size requirements are expressed as the percent of the gross in-place riprap volume occupied by stones within average dimension size ranges as follows:

Riprap Stone Size (inches)	Fraction of Gross In-Place Riprap Volume Occupied by Stones
Special Heavy	
>25	0%
18-20	15%-25%
14-18	15%-25%
6.5-14	20%-30%
<6.5	0%

C Construction

Prepare the bed for the riprap by excavating, shaping the slopes, and constructing the toe for riprap installation. Place riprap from the base of the slope upward. Freefall height of riprap must not exceed 6 inches. After placing the riprap, restore the surface of adjacent work and dispose of surplus material.

The contractor may place Riprap, Special Heavy by any mechanical means that produce a completed job within reasonable tolerances of the typical section the plans show. Limit handwork to the amount necessary to fill large voids or to correct segregated areas. Place riprap over geotextile type HR and conform to 645.3.1.7 of the standard specifications.

Make placement of Riprap, Special Heavy at least 24 inches thick.

D Measurement

The department will measure this item by the cubic yard acceptably completed, measured as the volume within the limiting dimensions this special provision and the plans designate or the engineer establishes in the field.

E Payment

The department will pay for measured quantities at the contract unit price under the following bid item:

ITEM NUMBER	DESCRIPTION	UNIT
SPV.0035.010	Riprap, Special Heavy	CY

Payment is full compensation for preparing the bed, providing and placing Riprap, Special Heavy, restoring adjacent work, and disposing of surplus material.

Geotextile will be paid separately under the item Geotextile Type HR.

86. Site Grading & Restoration, Item SPV.0105.010.

A Description

This special provision describes excavating, restoring, and planting shrubs at a storm sewer outfall area on the east side of S. 60th St. approximately 120' south of W. Kinnickinnic Parkway.

B Materials

Furnish topsoil consisting of loam, sandy loam, silt loam, silty clay loam, or clay loam humus-bearing soils adapted to sustain plant life, and ensure this topsoil is in a pH range of 6.0 to 7.0.

Furnish seeding conforming to Mixture No.75 in 630.2 of the standard specifications.

Furnish the shrubs listed in the table below conforming to 632.2 of the standard specifications. Each shrub container size shall be a minimum of five gallons.

Shrubs			
Scientific Name	Common Name	Quantity	Container Size (gallons)
Corylus Americana	American Hazelnut	5	≥5
Hamamelis Virginiana	Witch Hazel	5	≥5
Physocarpus Opulifolius	Ninebark	4	≥5

C Construction

Perform excavation conforming to 205.3 of the standard specifications and to the required depths shown on the plans. Implement excavation methods to ensure protection of the areas directly adjacent to proposed excavation. If excess materials are disturbed or excavated adjacent to the required areas as shown on the plans or below the elevations shown on the plans, the contractor shall replace and restore them in kind at no additional expense to the department.

Place topsoil conforming to 625.3 of the standard specifications.

Place seeding conforming to 630.3 of the standard specification.

Plant the shrubs listed in the table under B Materials at locations flagged by Milwaukee County Parks staff. Plant the shrubs conforming to 632.3 of the standard specifications. Contact Therese Gripentrog of the Milwaukee County Parks Department at (414) 257-6242 at least five days prior to starting work so that the Milwaukee County Parks Department can flag the locations of the proposed shrubs prior to construction.

It is strongly recommended to visit the site prior to bidding to determine the best access route and equipment to use on the project, within the permanent limited easement shown in the plans for this work. All areas between the S. 60th Street east sidewalk and the outfall ditch/channel disturbed by construction activities shall be restored as shown in the plans. Restore any areas disturbed by construction activities and accessing the project site. The work shall include but is not limited to repairing tire ruts, replacing turf/topsoil, etc. as disturbed when accessing the site.

D Measurement

The department will measure Site Grading & Restoration as a single lump sum acceptably completed.

E Payment

The department will pay for measured quantities at the contract unit price under the following bid item:

ITEM NUMBER	DESCRIPTION	UNIT
SPV.0105.010	Site Grading & Restoration	LS

Payment is full compensation for all work required to complete the grading, restoration, and planting for the site, including excavation, topsoil, seeding, planting shrubs, and disposal of all excess material.

Erosion control will be paid separately under contract bid items.

87. Notice to Contractor – Milwaukee County Parks Coordination.

Contact Erin Fischer (Erin.Fischer@milwaukeecountywi.gov) prior to bidding to obtain the draft right-of-entry permit for the storm sewer outfall area on the east side of S. 60th St. approximately 120' south of W. Kinnickinnic Parkway. Comply with the conditions in the draft right-of-entry permit.

The Milwaukee County Parks Department is not on the Diggers Hotline. Contact Milwaukee County Parks at 414-258-2322 to request marking of the private utilities 5 days prior to working on the park land.

Schedule of Items

Attached, dated November 27, 2018, are the revised Schedule of Items Pages 1 – 15.

Plan Sheets

The following 8½ x 11-inch sheets are attached and made part of the plans for this proposal:
Revised: 10, 107, and 242.

END OF ADDENDUM

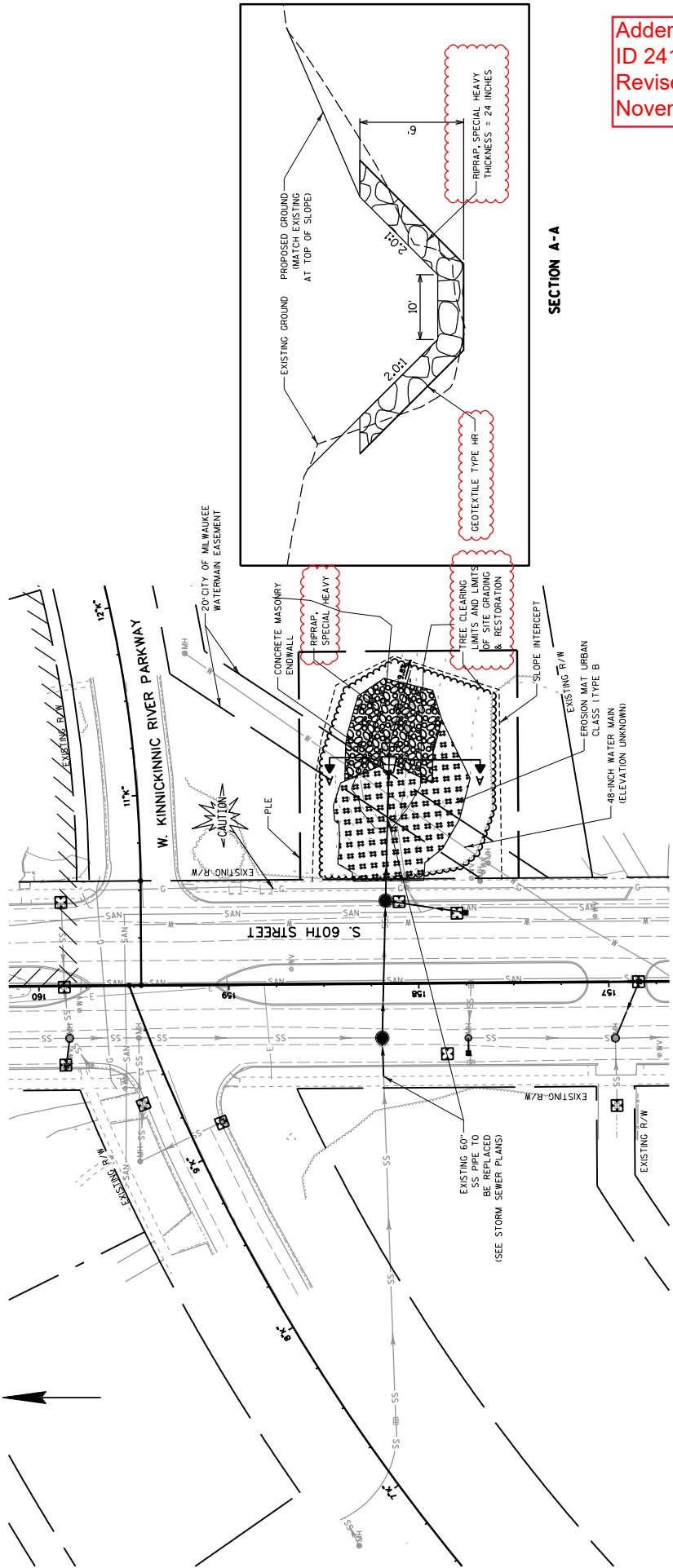

Addendum No. 01
 ID 2415-00-71
 Revised Sheet 10
 November 27, 2018

SECTION A-A

STORM SEWER OUTFALL DETAIL

PROJECT NO: 2415-00-71	COUNTY: MILWAUKEE	SHEET 10	E
HWY: S. 60TH ST.	CONSTRUCTION DETAILS	PLOT SCALE: 1:309.091	
FILE NAME: P:\19xx\4960.DP_S60TH.MKE\CADD\24150001_Sheets2\cn\021001.ccd.dgn	PLOT BY: SKD	PLOT NAME:	
	PLOT DATE: 11/21/2018		

LEGEND

- RIPRAP, SPECIAL HEAVY
- INLET PROTECTION TYPE A
- INLET PROTECTION TYPE B
- HEAVY DUTY SILT FENCE
- EROSION MAT URBAN CLASS (TYPE B)
- (A)
- (B)
- SEE CONSTRUCTION DETAIL "STORM SEWER OUTFALL DETAIL"

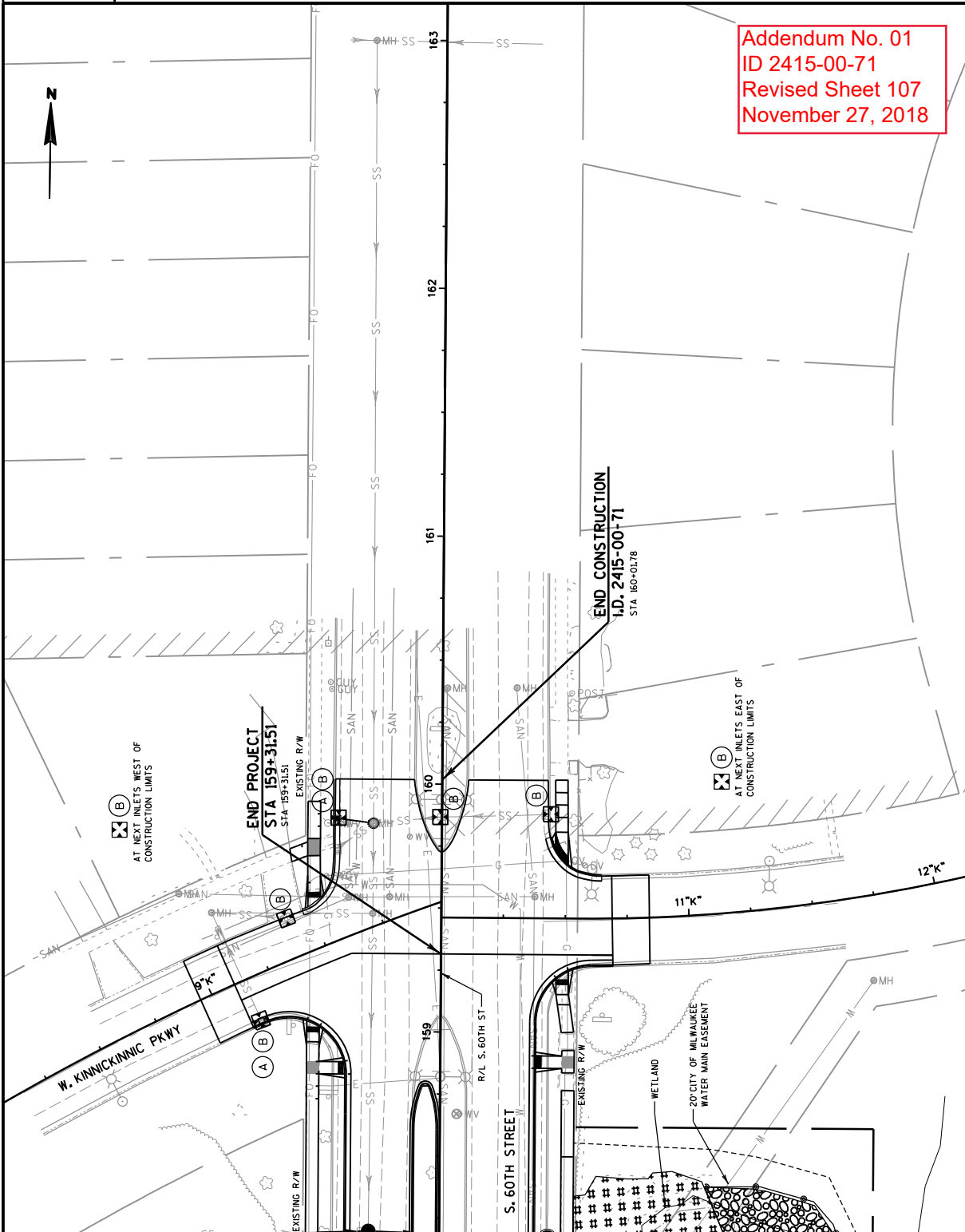

Addendum No. 01
 ID 2415-00-71
 Revised Sheet 107
 November 27, 2018

2

2

PROJECT NO: 2415-00-71

HWY: S. 60TH ST.

COUNTY: MILWAUKEE

EROSION CONTROL: S. 60TH STREET

SHEET 107

E

FILE NAME : P:\199x\4960.DP_S60TH.MKE\CADD\24150001\Sheets\2_107\2011.ec_dgn

PLOT DATE : 11/20/2018

PLOT BY : BKD

PLOT SCALE : 1:61.8182



Proposal Schedule of Items

Proposal ID: 20181211015 Project(s): 2415-00-71

Federal ID(s): WISC 2019008

SECTION: 0001 Contract Items

Alt Set ID: Alt Mbr ID:

Proposal Line Number	Item ID Description	Approximate Quantity and Units	Unit Price	Bid Amount
0002	201.0105 Clearing	2.000 STA	_____.	_____.
0004	201.0120 Clearing	779.000 ID	_____.	_____.
0006	201.0205 Grubbing	2.000 STA	_____.	_____.
0008	201.0220 Grubbing	779.000 ID	_____.	_____.
0010	203.0200 Removing Old Structure (station) 001. 158+18.68	LS	LUMP SUM	_____.
0012	204.0100 Removing Pavement	51,177.000 SY	_____.	_____.
0014	204.0105 Removing Pavement Butt Joints	547.000 SY	_____.	_____.
0016	204.0120 Removing Asphaltic Surface Milling	830.000 SY	_____.	_____.
0018	204.0150 Removing Curb & Gutter	526.000 LF	_____.	_____.
0020	204.0155 Removing Concrete Sidewalk	7,575.000 SY	_____.	_____.
0022	204.0195 Removing Concrete Bases	52.000 EACH	_____.	_____.
0024	204.0210 Removing Manholes	2.000 EACH	_____.	_____.
0026	204.0220 Removing Inlets	90.000 EACH	_____.	_____.
0028	204.0245 Removing Storm Sewer (size) 001. 8- Inch	1,860.000 LF	_____.	_____.
0030	204.0245 Removing Storm Sewer (size) 002. 12- Inch	118.000 LF	_____.	_____.
0032	204.0245 Removing Storm Sewer (size) 003. 15- Inch	13.000 LF	_____.	_____.



Proposal Schedule of Items

Proposal ID: 20181211015 Project(s): 2415-00-71

Federal ID(s): WISC 2019008

SECTION: 0001 Contract Items

Alt Set ID: Alt Mbr ID:

Proposal Line Number	Item ID Description	Approximate Quantity and Units	Unit Price	Bid Amount
0034	204.0245 Removing Storm Sewer (size) 004. 60-Inch	70.000 LF	_____.	_____.
0036	204.0245 Removing Storm Sewer (size) 005. 30-Inch	41.000 LF	_____.	_____.
0038	204.0250 Abandoning Manholes	1.000 EACH	_____.	_____.
0040	204.0280 Sealing Pipes	2.000 EACH	_____.	_____.
0042	205.0100 Excavation Common	30,678.000 CY	_____.	_____.
0044	209.2500 Backfill Granular Grade 2	410.000 TON	_____.	_____.
0046	213.0100 Finishing Roadway (project) 001. 2415.00-71	1.000 EACH	_____.	_____.
0048	305.0120 Base Aggregate Dense 1 1/4-Inch	22,135.000 TON	_____.	_____.
0050	415.0080 Concrete Pavement 8-Inch	39,779.000 SY	_____.	_____.
0052	415.0210 Concrete Pavement Gaps	2.000 EACH	_____.	_____.
0054	415.5110.S Concrete Pavement Joint Layout	1.000 LS	_____.	_____.
0056	416.0170 Concrete Driveway 7-Inch	1,547.000 SY	_____.	_____.
0058	416.0610 Drilled Tie Bars	184.000 EACH	_____.	_____.
0060	416.0620 Drilled Dowel Bars	424.000 EACH	_____.	_____.
0062	455.0605 Tack Coat	96.000 GAL	_____.	_____.
0064	460.2000 Incentive Density HMA Pavement	90.000 DOL	1.00000	90.00



Proposal Schedule of Items

Proposal ID: 20181211015 Project(s): 2415-00-71

Federal ID(s): WISC 2019008

SECTION: 0001 Contract Items

Alt Set ID: Alt Mbr ID:

Proposal Line Number	Item ID Description	Approximate Quantity and Units	Unit Price	Bid Amount
0066	460.5224 HMA Pavement 4 LT 58-28 S	132.000 TON	_____.	_____.
0068	465.0125 Asphaltic Surface Temporary	789.000 TON	_____.	_____.
0070	465.0310 Asphaltic Curb	244.000 LF	_____.	_____.
0072	504.0900 Concrete Masonry Endwalls	6.000 CY	_____.	_____.
0074	520.8000 Concrete Collars for Pipe	4.000 EACH	_____.	_____.
0076	601.0319 Concrete Curb & Gutter 19-Inch	10,116.000 LF	_____.	_____.
0078	601.0331 Concrete Curb & Gutter 31-Inch	14,526.000 LF	_____.	_____.
0080	601.0600 Concrete Curb Pedestrian	264.000 LF	_____.	_____.
0082	602.0410 Concrete Sidewalk 5-Inch	61,412.000 SF	_____.	_____.
0084	602.0420 Concrete Sidewalk 7-Inch	3,008.000 SF	_____.	_____.
0086	602.0505 Curb Ramp Detectable Warning Field Yellow	500.000 SF	_____.	_____.
0088	602.0605 Curb Ramp Detectable Warning Field Radial Yellow	20.000 SF	_____.	_____.
0092	608.0360 Storm Sewer Pipe Reinforced Concrete Class III 60-Inch	156.000 LF	_____.	_____.
0094	608.0412 Storm Sewer Pipe Reinforced Concrete Class IV 12-Inch	1,454.000 LF	_____.	_____.
0096	611.0420 Reconstructing Manholes	24.000 EACH	_____.	_____.
0098	611.1003 Catch Basins 3-FT Diameter	25.000 EACH	_____.	_____.



Proposal Schedule of Items

Proposal ID: 20181211015 Project(s): 2415-00-71

Federal ID(s): WISC 2019008

SECTION: 0001 Contract Items

Alt Set ID: Alt Mbr ID:

Proposal Line Number	Item ID Description	Approximate Quantity and Units	Unit Price	Bid Amount
0100	611.1004 Catch Basins 4-FT Diameter	5.000 EACH	_____.	_____.
0102	611.2003 Manholes 3-FT Diameter	10.000 EACH	_____.	_____.
0104	611.2004 Manholes 4-FT Diameter	2.000 EACH	_____.	_____.
0106	611.2005 Manholes 5-FT Diameter	2.000 EACH	_____.	_____.
0108	611.2008 Manholes 8-FT Diameter	4.000 EACH	_____.	_____.
0110	611.8120.S Cover Plates Temporary	4.000 EACH	_____.	_____.
0112	618.0100 Maintenance And Repair of Haul Roads (project) 001. 2415-00-71	1.000 EACH	_____.	_____.
0114	619.1000 Mobilization	1.000 EACH	_____.	_____.
0116	620.0300 Concrete Median Sloped Nose	426.000 SF	_____.	_____.
0118	624.0100 Water	322.000 MGAL	_____.	_____.
0120	625.0100 Topsoil	20,508.000 SY	_____.	_____.
0122	628.1905 Mobilizations Erosion Control	8.000 EACH	_____.	_____.
0124	628.1910 Mobilizations Emergency Erosion Control	5.000 EACH	_____.	_____.
0126	628.2008 Erosion Mat Urban Class I Type B	401.000 SY	_____.	_____.
0128	628.7005 Inlet Protection Type A	77.000 EACH	_____.	_____.
0130	628.7010 Inlet Protection Type B	162.000 EACH	_____.	_____.



Proposal Schedule of Items

Proposal ID: 20181211015 Project(s): 2415-00-71

Federal ID(s): WISC 2019008

SECTION: 0001 Contract Items

Alt Set ID: Alt Mbr ID:

Proposal Line Number	Item ID Description	Approximate Quantity and Units	Unit Price	Bid Amount
0132	629.0210 Fertilizer Type B	14.000 CWT	_____.	_____.
0134	631.0300 Sod Water	461.000 MGAL	_____.	_____.
0136	631.1000 Sod Lawn	20,508.000 SY	_____.	_____.
0138	632.0101 Trees (species) (size) (root) 001. Cleveland Select Pear 3" B&B	13.000 EACH	_____.	_____.
0140	632.0101 Trees (species) (size) (root) 002. Common Bald-Cypress 3"B&B	9.000 EACH	_____.	_____.
0142	632.0101 Trees (species) (size) (root) 003. Ivory Silk Lilac 3" B&B	10.000 EACH	_____.	_____.
0144	632.0101 Trees (species) (size) (root) 004. Red Bud 3" B&B	3.000 EACH	_____.	_____.
0146	632.0101 Trees (species) (size) (root) 005. Sunburst Honey Locust 3" B&B	7.000 EACH	_____.	_____.
0148	632.0101 Trees (species) (size) (root) 006. Freeman Maple 3" B&B	2.000 EACH	_____.	_____.
0150	632.0101 Trees (species) (size) (root) 007. Service Berry 3" B&B	4.000 EACH	_____.	_____.
0152	632.0101 Trees (species) (size) (root) 008. Kentucky Coffee 3" B&B	2.000 EACH	_____.	_____.
0154	632.0101 Trees (species) (size) (root) 009. English Oak 3" B&B	1.000 EACH	_____.	_____.
0156	632.0101 Trees (species) (size) (root) 010. Horse Chestnut 3" B&B	7.000 EACH	_____.	_____.
0158	632.0101 Trees (species) (size) (root) 011. Hawthorn Thornless 3" B&B	2.000 EACH	_____.	_____.



Proposal Schedule of Items

Proposal ID: 20181211015 Project(s): 2415-00-71

Federal ID(s): WISC 2019008

SECTION: 0001 Contract Items

Alt Set ID: Alt Mbr ID:

Proposal Line Number	Item ID Description	Approximate Quantity and Units	Unit Price	Bid Amount
0160	632.0101 Trees (species) (size) (root) 012. Catalpa 3" B&B	3.000 EACH	_____.	_____.
0162	632.0101 Trees (species) (size) (root) 013. River/Yellow Birch 3" B&B	1.000 EACH	_____.	_____.
0164	632.0101 Trees (species) (size) (root) 014. Geditsia Shademaster	1.000 EACH	_____.	_____.
0166	632.0101 Trees (species) (size) (root) 015. Malus Prairiefire	2.000 EACH	_____.	_____.
0168	632.0201 Shrubs (species) (size) (root) 001. Golden American Elderberry #5 CG	6.000 EACH	_____.	_____.
0170	632.0201 Shrubs (species) (size) (root) 002. Hydrangea Annabelle #2 CG	20.000 EACH	_____.	_____.
0172	632.0201 Shrubs (species) (size) (root) 003. Red Knockout Rose #2 CG	22.000 EACH	_____.	_____.
0174	632.0201 Shrubs (species) (size) (root) 004. Peony Kansas #5 CG	18.000 EACH	_____.	_____.
0176	632.0201 Shrubs (species) (size) (root) 005. Nine Bark Diablo #2 CG	8.000 EACH	_____.	_____.
0178	632.9101 Landscape Planting Surveillance and Care Cycles	10.000 EACH	_____.	_____.
0180	638.2602 Removing Signs Type II	99.000 EACH	_____.	_____.
0182	638.3000 Removing Small Sign Supports	50.000 EACH	_____.	_____.
0184	642.5201 Field Office Type C	1.000 EACH	_____.	_____.
0186	643.0300 Traffic Control Drums	27,366.000 DAY	_____.	_____.



Proposal Schedule of Items

Proposal ID: 20181211015 Project(s): 2415-00-71

Federal ID(s): WISC 2019008

SECTION: 0001 Contract Items

Alt Set ID: Alt Mbr ID:

Proposal Line Number	Item ID Description	Approximate Quantity and Units	Unit Price	Bid Amount
0188	643.0420 Traffic Control Barricades Type III	4,237.000 DAY	_____.	_____.
0190	643.0500 Traffic Control Flexible Tubular Marker Posts	34.000 EACH	_____.	_____.
0192	643.0600 Traffic Control Flexible Tubular Marker Bases	34.000 EACH	_____.	_____.
0194	643.0705 Traffic Control Warning Lights Type A	5,814.000 DAY	_____.	_____.
0196	643.0715 Traffic Control Warning Lights Type C	10,689.000 DAY	_____.	_____.
0198	643.0800 Traffic Control Arrow Boards	173.000 DAY	_____.	_____.
0200	643.0900 Traffic Control Signs	3,286.000 DAY	_____.	_____.
0202	643.1050 Traffic Control Signs PCMS	14.000 DAY	_____.	_____.
0204	643.5000 Traffic Control	1.000 EACH	_____.	_____.
0206	644.1410.S Temporary Pedestrian Surface Asphalt	3,360.000 SF	_____.	_____.
0208	644.1420.S Temporary Pedestrian Surface Plywood	1,500.000 SF	_____.	_____.
0210	644.1430.S Temporary Pedestrian Surface Plate	1,800.000 SF	_____.	_____.
0212	644.1601.S Temporary Curb Ramp	56.000 EACH	_____.	_____.
0214	644.1616.S Temporary Pedestrian Safety Fence	150.000 LF	_____.	_____.
0216	645.0120 Geotextile Type HR	293.000 SY	_____.	_____.
0218	646.1020 Marking Line Epoxy 4-Inch	12,820.000 LF	_____.	_____.



Proposal Schedule of Items

Proposal ID: 20181211015 Project(s): 2415-00-71

Federal ID(s): WISC 2019008

SECTION: 0001 Contract Items

Alt Set ID: Alt Mbr ID:

Proposal Line Number	Item ID Description	Approximate Quantity and Units	Unit Price	Bid Amount
0220	646.3020 Marking Line Epoxy 8-Inch	1,400.000 LF	_____.	_____.
0222	646.5020 Marking Arrow Epoxy	16.000 EACH	_____.	_____.
0224	646.5220 Marking Symbol Epoxy	16.000 EACH	_____.	_____.
0226	646.8120 Marking Curb Epoxy	1,143.000 LF	_____.	_____.
0228	646.8220 Marking Island Nose Epoxy	26.000 EACH	_____.	_____.
0230	646.9000 Marking Removal Line 4-Inch	1,000.000 LF	_____.	_____.
0232	646.9300 Marking Removal Special Marking	5.000 EACH	_____.	_____.
0234	649.0105 Temporary Marking Line Paint 4-Inch	22,697.000 LF	_____.	_____.
0236	649.0150 Temporary Marking Line Removable Tape 4-Inch	21,596.000 LF	_____.	_____.
0238	650.4000 Construction Staking Storm Sewer	121.000 EACH	_____.	_____.
0240	650.4500 Construction Staking Subgrade	12,826.000 LF	_____.	_____.
0242	650.5500 Construction Staking Curb Gutter and Curb & Gutter	142.000 LF	_____.	_____.
0244	650.7000 Construction Staking Concrete Pavement	12,826.000 LF	_____.	_____.
0246	650.8500 Construction Staking Electrical Installations (project) 001. 2415-00-71	LS	LUMP SUM	_____.
0248	650.9000 Construction Staking Curb Ramps	49.000 EACH	_____.	_____.



Proposal Schedule of Items

Proposal ID: 20181211015 Project(s): 2415-00-71

Federal ID(s): WISC 2019008

SECTION: 0001 Contract Items

Alt Set ID: Alt Mbr ID:

Proposal Line Number	Item ID Description	Approximate Quantity and Units	Unit Price	Bid Amount
0250	650.9910 Construction Staking Supplemental Control (project) 001. 2415-00-71	LS	LUMP SUM	_____.
0252	650.9920 Construction Staking Slope Stakes	12,826.000 LF	_____.	_____.
0254	652.0235 Conduit Rigid Nonmetallic Schedule 40 3-Inch	8,780.000 LF	_____.	_____.
0256	652.0330 Conduit Rigid Nonmetallic Schedule 80 2 1/2-Inch	300.000 LF	_____.	_____.
0258	652.0335 Conduit Rigid Nonmetallic Schedule 80 3-Inch	1,615.000 LF	_____.	_____.
0260	652.0615 Conduit Special 3-Inch	650.000 LF	_____.	_____.
0262	654.0101 Concrete Bases Type 1	6.000 EACH	_____.	_____.
0264	654.0105 Concrete Bases Type 5	41.000 EACH	_____.	_____.
0266	654.0110 Concrete Bases Type 10	4.000 EACH	_____.	_____.
0268	655.0260 Cable Traffic Signal 12-14 AWG	1,165.000 LF	_____.	_____.
0270	655.0270 Cable Traffic Signal 15-14 AWG	790.000 LF	_____.	_____.
0272	655.0305 Cable Type UF 2-12 AWG Grounded	3,100.000 LF	_____.	_____.
0274	655.0515 Electrical Wire Traffic Signals 10 AWG	800.000 LF	_____.	_____.
0276	655.0900 Traffic Signal EVP Detector Cable	820.000 LF	_____.	_____.
0278	657.0100 Pedestal Bases	6.000 EACH	_____.	_____.



Proposal Schedule of Items

Proposal ID: 20181211015 Project(s): 2415-00-71

Federal ID(s): WISC 2019008

SECTION: 0001 Contract Items

Alt Set ID: Alt Mbr ID:

Proposal Line Number	Item ID Description	Approximate Quantity and Units	Unit Price	Bid Amount
0280	657.0255 Transformer Bases Breakaway 11 1/2-Inch Bolt Circle	41.000 EACH	_____.	_____.
0282	657.0420 Traffic Signal Standards Aluminum 13-FT	6.000 EACH	_____.	_____.
0284	657.0615 Luminaire Arms Single Member 4 1/2-Inch Clamp 8-FT	82.000 EACH	_____.	_____.
0286	658.0173 Traffic Signal Face 3S 12-Inch	16.000 EACH	_____.	_____.
0288	658.0412 Pedestrian Signal Face 12-Inch	8.000 EACH	_____.	_____.
0290	658.0500 Pedestrian Push Buttons	4.000 EACH	_____.	_____.
0292	658.5069 Signal Mounting Hardware (location) 001. S 60th Street & Cleveland Avenue	LS	LUMP SUM	_____.
0294	690.0150 Sawing Asphalt	589.000 LF	_____.	_____.
0296	690.0250 Sawing Concrete	8,215.000 LF	_____.	_____.
0298	715.0415 Incentive Strength Concrete Pavement	11,934.000 DOL	1.00000	11,934.00
0300	715.0710 Optimized Aggregate Gradation Incentive	33,586.000 DOL	1.00000	33,586.00
0302	ASP.1T0A On-the-Job Training Apprentice at \$5.00/HR	1,800.000 HRS	5.00000	9,000.00
0304	ASP.1T0G On-the-Job Training Graduate at \$5.00/HR	3,000.000 HRS	5.00000	15,000.00
0306	SPV.0060 Special 001. Section Corner Monuments	1.000 EACH	_____.	_____.
0308	SPV.0060 Special 005. Water Main Protection	27.000 EACH	_____.	_____.



Proposal Schedule of Items

Proposal ID: 20181211015 Project(s): 2415-00-71

Federal ID(s): WISC 2019008

SECTION: 0001 Contract Items

Alt Set ID: Alt Mbr ID:

Proposal Line Number	Item ID Description	Approximate Quantity and Units	Unit Price	Bid Amount
0310	SPV.0060 Special 020. Temporary Bus Loading Zone	11.000 EACH	_____.	_____.
0312	SPV.0060 Special 030. Storm Inlet Type 45A	49.000 EACH	_____.	_____.
0314	SPV.0060 Special 031. Inlet Cover Type MS 57	53.000 EACH	_____.	_____.
0316	SPV.0060 Special 032. Curb Inlet Type 70A	24.000 EACH	_____.	_____.
0318	SPV.0060 Special 033. Manhole Cover Type MS 58-A	115.000 EACH	_____.	_____.
0320	SPV.0060 Special 034. Internal Sanitary Manhole Seals	53.000 EACH	_____.	_____.
0322	SPV.0060 Special 035. Adjusting Sanitary Manholes	53.000 EACH	_____.	_____.
0324	SPV.0060 Special 036. Adjusting Water Box	106.000 EACH	_____.	_____.
0326	SPV.0060 Special 037. Adjusting Water Manhole	12.000 EACH	_____.	_____.
0328	SPV.0060 Special 038. Reinforced Concrete Collars	1.000 EACH	_____.	_____.
0330	SPV.0060 Special 051. Marking Arrow Grooved Preformed Plastic	2.000 EACH	_____.	_____.
0332	SPV.0060 Special 052. Marking Word Grooved Preformed Plastic	2.000 EACH	_____.	_____.
0334	SPV.0060 Special 070. Install City Furnished Sign	158.000 EACH	_____.	_____.
0336	SPV.0060 Special 080. Karl Forester Grass #1 CG	72.000 EACH	_____.	_____.
0338	SPV.0060 Special 081. Day Lilies #1 CG	48.000 EACH	_____.	_____.



Proposal Schedule of Items

Proposal ID: 20181211015 Project(s): 2415-00-71

Federal ID(s): WISC 2019008

SECTION: 0001 Contract Items

Alt Set ID: Alt Mbr ID:

Proposal Line Number	Item ID Description	Approximate Quantity and Units	Unit Price	Bid Amount
0340	SPV.0060 Special 082. Day Lilies Strawberry Fields #1 CG	64.000 EACH	_____.	_____.
0342	SPV.0060 Special 083. Day Lilies Stella D'Oro #1 CG	2.000 EACH	_____.	_____.
0344	SPV.0060 Special 084. Signature Bed	3.000 EACH	_____.	_____.
0346	SPV.0060 Special 200. Install City Precast Controller Base 36"x21"x20"	1.000 EACH	_____.	_____.
0348	SPV.0060 Special 205. ATC Controller and Cabinet Installed	1.000 EACH	_____.	_____.
0350	SPV.0060 Special 212. Fiber Optic Patch Panel	1.000 EACH	_____.	_____.
0352	SPV.0060 Special 213. Ethernet Switch	1.000 EACH	_____.	_____.
0354	SPV.0060 Special 218. EVP 1 Channel 1 Direction Infrared Detector	4.000 EACH	_____.	_____.
0356	SPV.0060 Special 221. EVP Phase Selector Card 4 Channel	1.000 EACH	_____.	_____.
0358	SPV.0060 Special 223. EVP Confirmation Light Assembly	4.000 EACH	_____.	_____.
0360	SPV.0060 Special 224. Vehicular Video Detection System	2.000 EACH	_____.	_____.
0362	SPV.0060 Special 246. Poles Type 10	4.000 EACH	_____.	_____.
0364	SPV.0060 Special 258. Monotube Arm 20'	4.000 EACH	_____.	_____.
0366	SPV.0060 Special 265. Utility Line Opening (ULO)	5.000 EACH	_____.	_____.



Proposal Schedule of Items

Proposal ID: 20181211015 Project(s): 2415-00-71

Federal ID(s): WISC 2019008

SECTION: 0001 Contract Items

Alt Set ID: Alt Mbr ID:

Proposal Line Number	Item ID Description	Approximate Quantity and Units	Unit Price	Bid Amount
0368	SPV.0060 Special 267. Pedestrian Countdown Signal Face 12-Inch	8.000 EACH	_____.	_____.
0370	SPV.0060 Special 302. Pull Box 13-Inch x 24-Inch x 24-Inch	46.000 EACH	_____.	_____.
0372	SPV.0060 Special 303. Pull Box 17-Inch x 30-Inch x 24-Inch	12.000 EACH	_____.	_____.
0374	SPV.0060 Special 322. Poles Type 14-Aluminum 25-Ft.	41.000 EACH	_____.	_____.
0376	SPV.0060 Special 345. Luminaire Arms Single Member 6-FT	2.000 EACH	_____.	_____.
0378	SPV.0060 Special 346. Luminaire Arms Single Member 8-FT	4.000 EACH	_____.	_____.
0380	SPV.0060 Special 375. Luminaire Utility LED 2	88.000 EACH	_____.	_____.
0382	SPV.0060 Special 400. Adjusting CUC Manhole Covers	8.000 EACH	_____.	_____.
0384	SPV.0060 Special 425. Installing Conduit Into Existing Manhole	2.000 EACH	_____.	_____.
0386	SPV.0060 Special 641. Catmint Blue Wonder #1 CG	68.000 EACH	_____.	_____.
0388	SPV.0060 Special 644. Russian Sage #1 CG	18.000 EACH	_____.	_____.
0390	SPV.0060 Special 650. Dwarf Daylillies Happy Returns #1 CG	1.000 EACH	_____.	_____.
0392	SPV.0060 Special 651. Zagreb Coreopsis	18.000 EACH	_____.	_____.
0394	SPV.0090 Special 040. Heavy Duty Silt Fence	139.000 LF	_____.	_____.



Proposal Schedule of Items

Proposal ID: 20181211015 Project(s): 2415-00-71

Federal ID(s): WISC 2019008

SECTION: 0001 Contract Items

Alt Set ID: Alt Mbr ID:

Proposal Line Number	Item ID Description	Approximate Quantity and Units	Unit Price	Bid Amount
0396	SPV.0090 Special 050. Marking Line Epoxy 6-Inch	10,731.000 LF	_____.	_____.
0398	SPV.0090 Special 051. Marking Diagonal Epoxy 4-Inch	429.000 LF	_____.	_____.
0400	SPV.0090 Special 052. Marking Crosswalk Grooved Preformed Plastic 12-Inch	913.000 LF	_____.	_____.
0402	SPV.0090 Special 053. Marking Stop Line Grooved Preformed Plastic 24-Inch	204.000 LF	_____.	_____.
0404	SPV.0090 Special 054. Marking Crosswalk Grooved Preformed Plastic Ladder Pattern 24-Inch	174.000 LF	_____.	_____.
0406	SPV.0090 Special 085. Fieldstone Boulder Wall	120.000 LF	_____.	_____.
0408	SPV.0090 Special 306. Cable Type 3#6/1#8 LTP	850.000 LF	_____.	_____.
0410	SPV.0090 Special 307. Cable type 3#4/1#8 LTP	3,600.000 LF	_____.	_____.
0412	SPV.0090 Special 308. Cable Type 3#2/1#8 LTP	3,360.000 LF	_____.	_____.
0414	SPV.0090 Special 321. Cable Type #2 AL 15KV CONCENTRIC	350.000 LF	_____.	_____.
0416	SPV.0090 Special 402. 2-Duct Conduit Cement Encased 4-Inch Rigid Nonmetallic Conduit DB-60	133.000 LF	_____.	_____.
0418	SPV.0105 Special 202. Remove Traffic Signal Equipment	LS	LUMP SUM	_____.
0420	SPV.0165 Special 001. Construction Staking Sidewalk	64,400.000 SF	_____.	_____.
0422	SPV.0180 Special 001. Joint Sealing	39,779.000 SY	_____.	_____.



Proposal Schedule of Items

Proposal ID: 20181211015 Project(s): 2415-00-71

Federal ID(s): WISC 2019008

SECTION: 0001 Contract Items

Alt Set ID: Alt Mbr ID:

Proposal Line Number	Item ID Description	Approximate Quantity and Units	Unit Price	Bid Amount
0424	SPV.0035 Special 010. Riprap, Special Heavy	166.000 CY	_____.	_____.
0426	SPV.0105 Special 010. Site Grading & Restoration	LS	LUMP SUM	_____.
Section: 0001			Total:	_____.
			Total Bid:	_____.

