



Wisconsin Department of Transportation

Division of Transportation Systems Development

Bureau of Project Development
4822 Madison Yards Way, 4th Floor South
Madison, WI 53705

March 1, 2019

Telephone: (608) 266-1631
Facsimile (FAX): (608) 266-8459

NOTICE TO ALL CONTRACTORS:

**Proposal #55: 1560-04-70, WISC 2019 183
Hayward - Drummond
Larsen Road to CTH M
USH 63
Sawyer/Bayfield Counties**

Letting of March 12, 2019

This is Addendum No. 02, which provides for the following:

Special Provisions:

Added Special Provisions	
Article No.	Description
21	Marking Line Same Day Epoxy 4-Inch, Item 646.4520 and Marking Line Epoxy 4-Inch, Item 646.1020

Deleted Special Provisions	
Article No.	Description
14	Pavement Marking and Temporary Pavement Marking

Schedule of Items:

Revised Bid Item Quantities					
Bid Item	Item Description	Unit	Old Quantity	Revised Quantity	Proposal Total
305.0120	Base Aggregate Dense 1 ¼-Inch	Ton	180	300	480
465.0105	Asphaltic Surface	Ton	292	140	432
649.0105	Temporary Marking Line Paint 4-Inch	LF	189,448	-99,448	96,000
690.0150	Sawing Asphalt	LF	204	3,255	3459

Added Bid Item Quantities					
Bid Item	Item Description	Unit	Old Quantity	Revised Quantity	Proposal Total
646.4520	Marking Line Same Day Epoxy 4-Inch	LF	0	51,420	51,420

Plan Sheets:

Revised Plan Sheets	
Plan Sheet	Plan Sheet Title (brief description of changes to sheet)
7	Updated detail to include patch for Storm Sewer pipe crossings.
22	Updated quantity for Base Aggregate Dense to include Storm Sewer pipe crossings
23	Updated quantity for Asphaltic Surface to include Storm Sewer pipe crossings
29	Updated quantity for Temporary Marking Line Paint 4-Inch and added quantity for Marking Line Same Day Epoxy 4-Inch. Updated saw cut quantity to include storm sewer pipe crossing and curb replacement areas.

The responsibility for notifying potential subcontractors and suppliers of these changes remains with the prime contractor.

Sincerely,

Mike Coleman

Proposal Development Specialist
Proposal Management Section

ADDENDUM NO. 02

1560-04-70

March 1, 2019

Special Provisions

14. DELETED

21. Marking Line Same Day Epoxy 4-Inch, Item 646.4520 and Marking Line Epoxy 4-Inch, Item 646.1020

This work shall be in accordance to the pertinent requirements of standard spec 646 and as provided here.

Placement of Pavement Marking Same Day Epoxy 4-Inch, to be completed prior to placement of rumble strips, shall be completed at the following application rate of 16.5 gallons per mile (15 mil thickness).

After completion of Asphaltic Centerline Rumble Strips 2-Lane Rural, place Marking Line Epoxy 4-Inch at an application rate of 22 gallons per mile (20 mil thickness) in accordance to standard spec 646.3.1.2 and within the timeline to be determined by the engineer.

Schedule of Items

Attached, dated March 1, 2019, are the revised Schedule of Items Pages 1 - 7.

Plan Sheets

The following 8½ x 11-inch sheets are attached and made part of the plans for this proposal:

Revised: 7, 22, 23, and 29.

END OF ADDENDUM

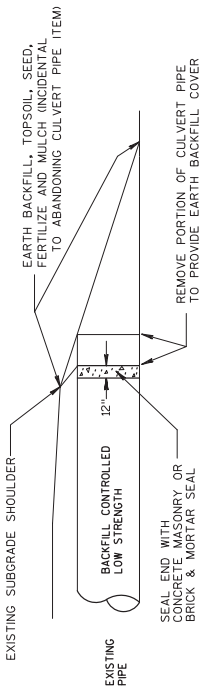

ABANDONING CULVERT PIPE DETAIL

STA 412+64
STA 111+55, LT

Addendum No. 02
ID 1560-04-70
Revised Sheet 7
March 1, 2019

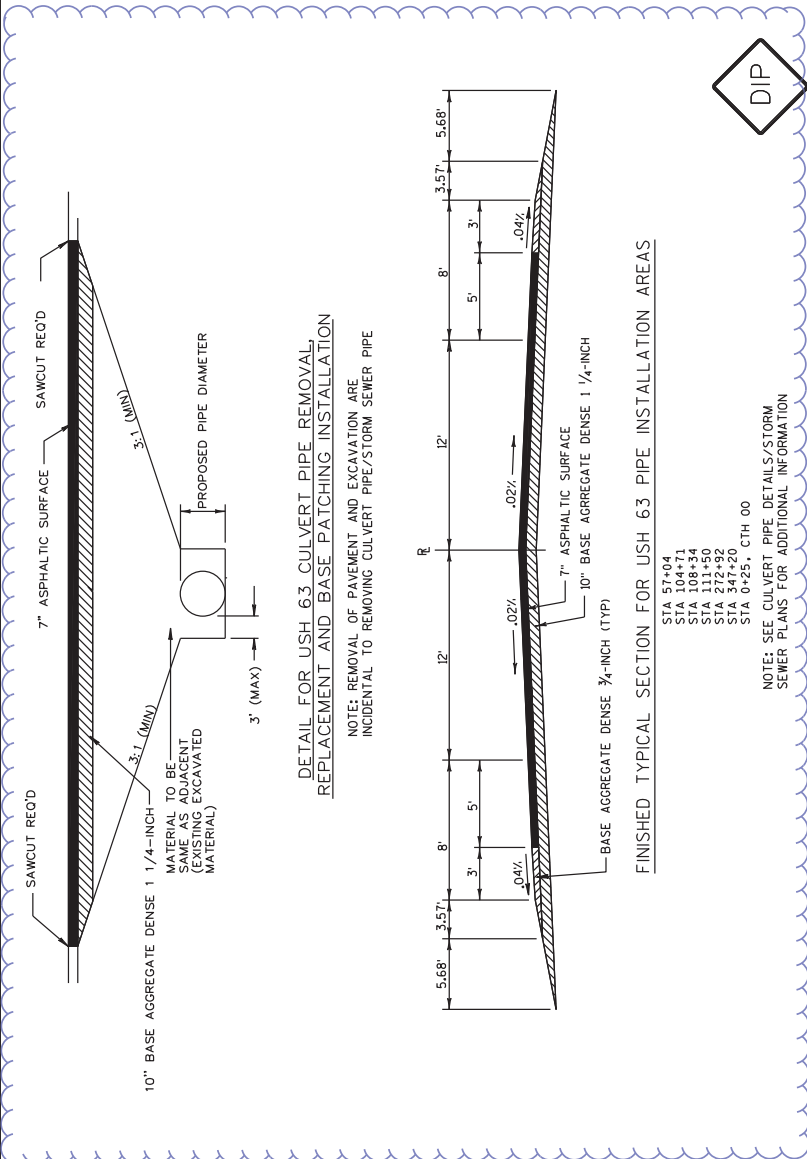

DETAIL FOR USH 63 CULVERT PIPE REMOVAL, REPLACEMENT AND BASE PATCHING INSTALLATION

NOTE: REMOVAL OF PAVEMENT AND EXCAVATION ARE INCIDENTAL TO REMOVING CULVERT PIPE/STORM SEWER PIPE

FINISHED TYPICAL SECTION FOR USH 63 PIPE INSTALLATION AREAS

STA 57+04
STA 104+71
STA 108+34
STA 111+50
STA 111+50
STA 272+92
STA 412+64
STA 0+25, CTH 00

NOTE: SEE CULVERT PIPE DETAILS/STORM SEWER PLANS FOR ADDITIONAL INFORMATION

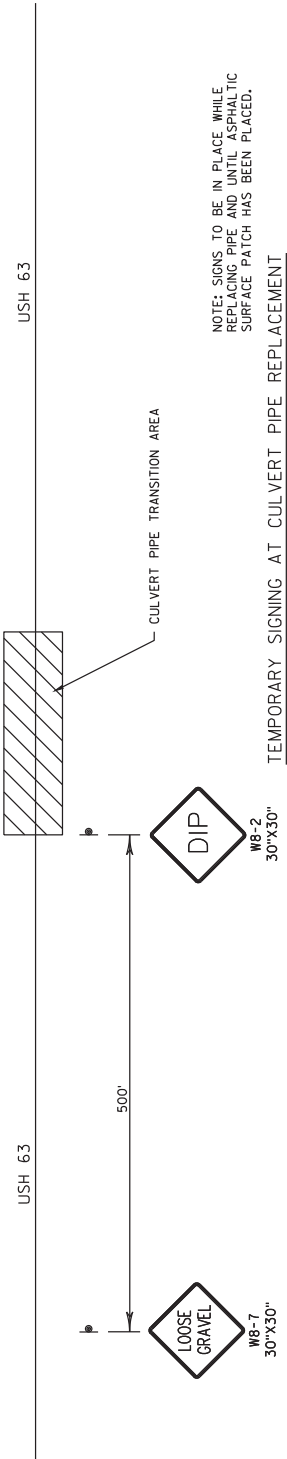

NOTE: SIGNS TO BE IN PLACE WHILE REPLACING PIPE AND UNTIL ASPHALTIC SURFACE PATCH HAS BEEN PLACED.

TEMPORARY SIGNING AT CULVERT PIPE REPLACEMENT

REMOVING SMALL PIPE CULVERTS

STATION	LOCATION	SIZE	MATERIAL	203.0100 EACH
57+04	USH 63	30"x121'	CMCP	1
272+92	USH 63	30"x106'	CMCP	1
347+70	USH 63	30"x143'	CMCP	1
PROJECT TOTAL				3

REMOVING ASPHALTIC SURFACE BUTT JOINTS

STATION TO STATION	LOCATION	SY	204.0115
0+90 - 1+40	USH 63	189	
476+35 - 496+85	USH 63	244	
12+00	LARSEN RD	278	
16+80	THANNUM FIRE LN	221	
78+80	STARK RD	165	
109+80	TOWN HALL RD	113	
112+10	OLD OO RD	272	
120+60	UHNHOLDT RD	241	
139+30	PETERSON RD	240	
146+80	SOMMERVILLE RD	126	
158+90	PARK RD	116	
175+30	COOK RD	208	
220+20	MOODY'S RD	36	
220+20	NORTHERN LIGHTS RD	208	
329+90	OLD MILL RD	221	
335+70	LEONARD SCHOOL RD	256	
335+70	E LEONARD SCHOOL RD	170	
402+40	NAMAKAGON RIVER RD	196	
425+90	SHORT RD	206	
492+70	CABLE SUNSET RD	234	
493+20	CTH M	607	
PROJECT TOTAL			4547

REMOVING ASPHALTIC SURFACE MILLING

STATION TO STATION	SY	204.0120
1+40 - 101+85	37947	
101+85 - 116+39	7108	
116+39 - 207+81	34536	
207+81 - 210+61	1369	
210+61 - 395+88	69991	
395+88 - 402+09	2596	
402+09 - 409+00	2610	
409+00 - 415+00	2267	
415+00 - 478+50	23989	
478+50 - 487+25	3305	
487+25 - 488+90	715	
488+90 - 496+35	3642	
INTERSECTIONS	4750	
PROJECT TOTAL		194825

REMOVING CURB & GUTTER

STATION TO STATION	LOCATION	LP	204.0150
101+85 - 108+64	LT	795	
101+85 - 112+08	RT	1045	
109+95 - 116+36	LT	650	
112+45 - 116+36	RT	425	
491+50 - 492+05	RT	55	
PROJECT TOTAL			2970

REMOVING INLETS

STATION	LOCATION	EACH	204.0220
111+38	LT	1	
111+73	RT	1	
112+71	RT	1	
PROJECT TOTAL			3

REMOVING STORM SEWER 12-INCH

STATION TO STATION	LOCATION	LF	204.0245.01
111+38 - 111+73	USH 63	58	
111+73 - 112+71	USH 63	97	
PROJECT TOTAL			155

ABANDONING CULVERT PIPES

STATION	LOCATION	EACH	204.0270
111+55	USH 63, LT	1	
412+64	USH 63	1	
PROJECT TOTAL			2

BACKFILL CONTROLLED LOW STRENGTH

STATION	LOCATION	CY	209.0200.S
111+55	USH 63, LT	9.1	
412+64	USH 63	14.4	
PROJECT TOTAL			23.5

PREPARING FOUNDATION FOR ASPHALT SHOULDER

STATION TO STATION	LOCATION	STA	211.0400
394+35 - 398+00	RT	4	
401+50 - 402+09	LT	2	
408+97 - 415+03	LT	9	
480+49 - 487+72	RT	8	
PROJECT TOTAL			23

FINISHING ROADWAY

PROJECT	213.0100 EACH	
1560-04-70	1	
PROJECT TOTAL		1

BASE AGGREGATE DENSE

STATION TO STATION	LOCATION	TON	TON
000+90 - 496+75	USH 63	3000	---
PIPE REPLACEMENT	USH 63	100	180
STORM SEWER REPLACEMENT	USH 63	---	300
MGS GUARDRAIL AREAS	USH 63	200	---
DRIVEWAYS	USH 63	100	---
PROJECT TOTALS		3400	480

SHAPING SHOULDERS

STATION TO STATION	LOCATION	STA	305.0500
0+90 - 101+85	USH 63	101	
115+07 - 489+40	USH 63	375	
PROJECT TOTAL			476

Addendum No. 02
ID 1560-04-70
Revised Sheet 22
March 1, 2019

HMA PAVEMENT ITEMS

STATION TO STATION	LOCATION	TON	TON	TON	GAL
000+90 - 101+85	USH 63	4215	---	---	2670
101+85 - 116+39	USH 63	802	---	---	500
116+39 - 207+81	USH 63	3839	---	---	2420
207+81 - 210+61	USH 63	151	---	---	100
210+61 - 394+40	USH 63	7657	---	---	4860
394+40 - 402+09	USH 63	365	---	---	230
402+09 - 408+97	USH 63	286	---	---	180
408+97 - 415+03	USH 63	289	---	---	180
415+03 - 480+49	USH 63	2720	---	---	1730
480+49 - 487+72	USH 63	389	---	---	250
487+72 - 488+90	USH 63	69	---	---	30
488+90 - 496+85	USH 63	428	92	---	270
PIPE REPLACEMENT AREAS					
STORM SEWER INSTALLATION AREAS					
DRIVEWAYS					
INTERSECTIONS					
SOFT/YIELDING AREAS					
UNDISTRIBUTED		---	---	---	40
PROJECT TOTALS		21733	432	30	13840

PILING STEEL SHEET TEMPORARY

STATION	LOCATION	SF
347+70	USH 63	1070
PROJECT TOTAL		1070

CONCRETE CURB AND GUTTER

STATION TO STATION	LOCATION	LOCATION	LF
101+85 - 109+64	RT	LT	795
101+85 - 112+08	RT	RT	1045
109+95 - 115+07	LT	LT	521
112+45 - 116+36	RT	RT	425
491+50 - 492+05	RT	RT	55
PROJECT TOTAL			2841

CULVERT PIPE REINFORCED CONCRETE CLASS III

STATION	LOCATION	LF	LF	LF	EACH	EACH
522.0130	30-INCH	522.0142	522.0160	522.1030	522.1042	522.1060
APRON ENDWALL FOR CULVERT PIPE						
30-INCH 42-INCH 30-INCH 42-INCH 60-INCH 60-INCH						
LF LF LF LF LF LF LF						
57+04	USH 63	116	---	---	2	---
272+92	USH 63	---	86	---	---	---
347+70	USH 63	---	---	120	---	2
PROJECT TOTALS		116	86	120	2	2

REHEATING HMA PAVEMENT LONGITUDINAL JOINTS

STATION TO STATION	LOCATION	TON
0+90 - 496+85	460.4110.S	49505
PROJECT TOTAL		49505

ASPHALTIC SURFACE PATCHING

STATION TO STATION	LOCATION	TON
UNDISTRIBUTED	SOFT/YIELDING AREAS	100
PROJECT TOTAL		100

BARRIER SYSTEM GRADING SHAPING FINISHING

STATION TO STATION	LOCATION	EXCAVATION COMMON CY	BORROW CY	TOPSOIL SY	FERTILIZER TYPE A CWT	SEEDING LB	MULCHING SY	614.0010 EACH
313+00 - 399+15	RT	---	120	400	0.3	11	400	1
400+16 - 402+09	LT	---	25	100	0.1	3	100	1
407+62 - 416+38	LT	---	120	400	0.3	11	400	1
479+14 - 484+40	RT	---	120	600	0.4	16	600	1
484+37 - 489+07	RT	---	900	200	0.1	5	200	1
PROJECT TOTAL								5

* FOR INFORMATION ONLY

MGE GUARDRAIL

STATION TO STATION	LOCATION	3K LF	RADIUS LF	SHORT THRIE BEAM TRANSITION LF	TERMINAL EAT EACH	614.2630 SHORT RADIUS TERMINAL
614.2300	GUARDRAIL	3	614.2350	614.2500	614.2610	614.2630
394+35 - 399+15	RT	388	---	---	39	---
400+16 - 402+09	LT	100	---	---	39	---
408+97 - 415+03	LT	500	---	---	2	---
480+49 - 484+40	RT	138	175	---	---	1
484+57 - 487+72	RT	63	175	---	---	1
PROJECT TOTALS		1189	350	76	78	6

Addendum No. 02
 ID 1560-04-70
 Revised Sheet 23
 March 1, 2019

Addendum No. 02
 ID 1560-04-70
 Revised Sheet 29
 March 1, 2019

TRAFFIC CONTROL ITEMS

PROJECT	STAINS	DAY	643.0900	643.5000	TRAFFIC CONTROL
	EACH				EACH
1560-04-70	136	8160	1		
19 SIDE ROADS	38	2280	---		
UNDISTRIBUTED		2610	---		
PROJECT TOTALS	13050		1		

MARKING LINE EPOXY 4-INCH

STATION TO STATION	DESCRIPTION	LF	646.1020	YELLOW
0+30 - 0+80	CTH OO	100		
0+90 - 99+00	CENTERLINE	3153		
99+00 - 119+00	TWTL	5550		
119+00 - 487+00	CENTERLINE	38875		
487+00 - 498+60	TWTL	3560		
16+25 - 17+15	CTH M	182		
PROJECT TOTAL		51420		

MARKING LINE GROOVED WET REF EPOXY 4-INCH

STATION TO STATION	DESCRIPTION	LF	646.1040	WHITE
0+90 - 99+00	EDGE LINE	19620		
99+00 - 119+00	EDGE LINE	4000		
119+00 - 487+00	EDGE LINE	73600		
487+00 - 498+60	EDGE LINE	2320		
PROJECT TOTAL		99540		

MARKING ARROW EPOXY

STATION	TYPE	COLOR	646.5020	COMMENT
			EACH	
102+79	2	WHITE	2	TWTL
107+11	2	WHITE	2	TWTL
111+43	2	WHITE	2	TWTL
113+33	2	WHITE	2	TWTL
116+34	2	WHITE	2	TWTL
490+05	2	WHITE	2	TWTL
491+87	2	WHITE	2	TWTL
494+24	2	WHITE	2	TWTL
495+05	2	WHITE	2	TWTL
PROJECT TOTAL			18	

MARKING STOP LINE EPOXY 18-INCH

LOCATION	646.6120	LF
OLD OO RD	33	
CABLE SUNSET RD	47	
CTH M	41	
PROJECT TOTAL	121	

MARKING LINE SAME DAY EPOXY 4-INCH

STATION TO STATION	LOCATION	LF	646.4520	YELLOW
ENTIRE PROJECT	UPPER LIFT HMA	51420		
PROJECT TOTAL		51420		

MARKING DIAGONAL EPOXY 12-INCH

STATION TO STATION	LOCATION	LF	646.7120	YELLOW
99+35 - 101+11	TWTL	53		
117+31 - 119+00	TWTL	48		
487+31 - 489+39	TWTL	66		
496+67 - 497+22	TWTL	53		
PROJECT TOTAL		220		

TEMPORARY MARKING LINE PAINT 4-INCH

STATION TO STATION	LOCATION	LF	649.0105	YELLOW
ENTIRE PROJECT	MILLED SURFACE C/L	48000		
ENTIRE PROJECT	CIR SURFACE C/L	48000		
PROJECT TOTAL		96000		

CONSTRUCTION STAKING CURB GUTTER AND CURB & GUTTER

STATION TO STATION	LOCATION	LF	650.5500
101+85 - 109+64	LT	795	
101+85 - 112+08	RT	1045	
109+95 - 115+07	LT	521	
112+45 - 116+36	RT	425	
491+50 - 492+05	RT	55	
PROJECT TOTAL		2841	

CONSTRUCTION STAKING PIPE CULVERTS

STATION	LOCATION	EACH	650.6000
57+04	USH 63	1	
272+92	USH 63	1	
349+70	USH 63	1	
PROJECT TOTAL		3	

CONSTRUCTION STAKING SUPPLEMENTAL CONTROL

PROJECT	LS	650.9910
1560-04-70	1	
PROJECT TOTAL	300	

REMOVE AND SALVAGE BRICK PAVERS

STATION TO STATION	SF	650.0165.01
112+70 - 113+75	315	
PROJECT TOTAL	315	

CONSTRUCTION STAKING RESURFACING REFERENCE

STATION TO STATION	LOCATION	LF	650.8000
0+90 - 496+95			
PROJECT TOTAL		49595	

SAWING

STATION TO STATION	LOCATION	LF	690.0150	ASPHALT	690.0250	CONCRETE
0+25	SS INSTALLATION	150				
57+04	PIPE INSTALLATION	68				
101+85 - 109+64	CURB REPLACEMENT, LT	795				
101+85 - 112+08	CURB REPLACEMENT, RT	1045				
104+71	SS INSTALLATION	88				
108+34	SS INSTALLATION	88				
109+95 - 115+07	CURB REPLACEMENT, LT	521				
111+50	SS INSTALLATION	86				
112+45 - 116+36	CURB REPLACEMENT, RT	425				
272+92	PIPE INSTALLATION	68				
347+20	PIPE INSTALLATION	68				
491+50 - 492+05	CURB REPLACEMENT, RT	55				
PROJECT TOTALS		3459				5

PREPARE FOUNDATION FOR HMA LAYER

PROJECT	LS	SPV.0105.01
1560-04-70	1	
PROJECT TOTAL	1	

COLD-IN-PLACE RECYCLING (CIR) PARTIAL DEPTH ITEMS

STATION TO STATION	SY	TON	SPV.0180.01	SPV.0195.01
000+90	- 101+85	27364		
101+85	- 116+39	7108		
116+39	- 207+81	24823		
207+81	- 210+61	747		
210+61	- 395+88	49405		
395+88	- 402+09	1416		
402+09	- 409+00	1843		
409+00	- 415+00	16000		
415+00	- 478+50	16933		
478+50	- 487+25	2333		
487+25	- 488+90	440		
488+90	- 496+75	4727		
INTERSECTIONS		4750		
PROJECT TOTALS		143489		504



Proposal Schedule of Items

Page 1 of 7

Proposal ID: 20190312055 Project(s): 1560-04-70

Federal ID(s): WISC 2019183

SECTION: 0001

Contract Items

Alt Set ID:

Alt Mbr ID:

Proposal Line Number	Item ID Description	Approximate Quantity and Units	Unit Price	Bid Amount
0002	203.0100 Removing Small Pipe Culverts	3.000 EACH	_____	_____
0004	204.0115 Removing Asphaltic Surface Butt Joints	4,547.000 SY	_____	_____
0006	204.0120 Removing Asphaltic Surface Milling	194,825.000 SY	_____	_____
0008	204.0150 Removing Curb & Gutter	2,970.000 LF	_____	_____
0010	204.0220 Removing Inlets	3.000 EACH	_____	_____
0012	204.0245 Removing Storm Sewer (size) 01. 12-Inch	155.000 LF	_____	_____
0014	204.0270 Abandoning Culvert Pipes	2.000 EACH	_____	_____
0016	209.0200.S Backfill Controlled Low Strength	23.500 CY	_____	_____
0018	211.0400 Prepare Foundation for Asphaltic Shoulders	23.000 STA	_____	_____
0020	213.0100 Finishing Roadway (project) 01. 1560-04-70	1.000 EACH	_____	_____
0022	305.0110 Base Aggregate Dense 3/4-Inch	3,400.000 TON	_____	_____
0024	305.0120 Base Aggregate Dense 1 1/4-Inch	480.000 TON	_____	_____
0026	305.0500 Shaping Shoulders	476.000 STA	_____	_____
0028	455.0605 Tack Coat	13,810.000 GAL	_____	_____
0030	460.2000 Incentive Density HMA Pavement	13,830.000 DOL	1.00000	13,830.00
0032	460.4110.S Reheating HMA Pavement Longitudinal Joints	49,505.000 LF	_____	_____



Proposal Schedule of Items

Proposal ID: 20190312055 Project(s): 1560-04-70

Federal ID(s): WISC 2019183

SECTION: 0001

Contract Items

Alt Set ID:

Alt Mbr ID:

Proposal Line Number	Item ID Description	Approximate Quantity and Units	Unit Price	Bid Amount
0034	460.6444 HMA Pavement 4 MT 58-34 H	21,733.000 TON	_____.	_____.
0036	465.0105 Asphaltic Surface	432.000 TON	_____.	_____.
0038	465.0110 Asphaltic Surface Patching	100.000 TON	_____.	_____.
0040	465.0120 Asphaltic Surface Driveways and Field Entrances	30.000 TON	_____.	_____.
0042	465.0315 Asphaltic Flumes	10.000 SY	_____.	_____.
0044	465.0425 Asphaltic Shoulder Rumble Strips 2-Lane Rural	93,180.000 LF	_____.	_____.
0046	465.0475 Asphalt Centerline Rumble Strips 2-Lane Rural	29,600.000 LF	_____.	_____.
0048	512.1000 Piling Steel Sheet Temporary	1,070.000 SF	_____.	_____.
0050	522.0130 Culvert Pipe Reinforced Concrete Class III 30-Inch	116.000 LF	_____.	_____.
0052	522.0142 Culvert Pipe Reinforced Concrete Class III 42-Inch	86.000 LF	_____.	_____.
0054	522.0160 Culvert Pipe Reinforced Concrete Class III 60-Inch	120.000 LF	_____.	_____.
0056	522.1018 Apron Endwalls for Culvert Pipe Reinforced Concrete 18-Inch	1.000 EACH	_____.	_____.
0058	522.1030 Apron Endwalls for Culvert Pipe Reinforced Concrete 30-Inch	2.000 EACH	_____.	_____.
0060	522.1042 Apron Endwalls for Culvert Pipe Reinforced Concrete 42-Inch	2.000 EACH	_____.	_____.



Proposal Schedule of Items

Proposal ID: 20190312055 Project(s): 1560-04-70

Federal ID(s): WISC 2019183

SECTION: 0001

Contract Items

Alt Set ID:

Alt Mbr ID:

Proposal Line Number	Item ID Description	Approximate Quantity and Units	Unit Price	Bid Amount
0062	522.1060 Apron Endwalls for Culvert Pipe Reinforced Concrete 60-Inch	2.000 EACH	_____.	_____.
0064	601.0415 Concrete Curb & Gutter 6-Inch Sloped 30-Inch Type J	2,841.000 LF	_____.	_____.
0066	608.0312 Storm Sewer Pipe Reinforced Concrete Class III 12-Inch	265.000 LF	_____.	_____.
0068	608.0318 Storm Sewer Pipe Reinforced Concrete Class III 18-Inch	946.000 LF	_____.	_____.
0072	611.3004 Inlets 4-FT Diameter	3.000 EACH	_____.	_____.
0074	611.3230 Inlets 2x3-FT	4.000 EACH	_____.	_____.
0076	614.0010 Barrier System Grading Shaping Finishing	5.000 EACH	_____.	_____.
0078	614.2300 MGS Guardrail 3	1,189.000 LF	_____.	_____.
0080	614.2330 MGS Guardrail 3 K	350.000 LF	_____.	_____.
0082	614.2350 MGS Guardrail Short Radius	76.000 LF	_____.	_____.
0084	614.2500 MGS Thrie Beam Transition	78.000 LF	_____.	_____.
0086	614.2610 MGS Guardrail Terminal EAT	6.000 EACH	_____.	_____.
0088	614.2630 MGS Guardrail Short Radius Terminal	2.000 EACH	_____.	_____.
0090	618.0100 Maintenance And Repair of Haul Roads (project) 01. 1560-04-70	1.000 EACH	_____.	_____.
0092	619.1000 Mobilization	1.000 EACH	_____.	_____.



Proposal Schedule of Items

Proposal ID: 20190312055 Project(s): 1560-04-70

Federal ID(s): WISC 2019183

SECTION: 0001

Contract Items

Alt Set ID:

Alt Mbr ID:

Proposal Line Number	Item ID Description	Approximate Quantity and Units	Unit Price	Bid Amount
0094	624.0100 Water	72.000 MGAL	_____.	_____.
0096	625.0500 Salvaged Topsoil	1,500.000 SY	_____.	_____.
0098	627.0200 Mulching	190.000 SY	_____.	_____.
0100	628.1504 Silt Fence	700.000 LF	_____.	_____.
0102	628.1520 Silt Fence Maintenance	700.000 LF	_____.	_____.
0104	628.1905 Mobilizations Erosion Control	4.000 EACH	_____.	_____.
0106	628.1910 Mobilizations Emergency Erosion Control	4.000 EACH	_____.	_____.
0108	628.2004 Erosion Mat Class I Type B	850.000 SY	_____.	_____.
0110	628.2027 Erosion Mat Class II Type C	100.000 SY	_____.	_____.
0112	628.7005 Inlet Protection Type A	7.000 EACH	_____.	_____.
0114	628.7015 Inlet Protection Type C	7.000 EACH	_____.	_____.
0116	628.7504 Temporary Ditch Checks	60.000 LF	_____.	_____.
0118	628.7555 Culvert Pipe Checks	32.000 EACH	_____.	_____.
0120	629.0205 Fertilizer Type A	1.000 CWT	_____.	_____.
0122	630.0120 Seeding Mixture No. 20	32.000 LB	_____.	_____.
0124	630.0140 Seeding Mixture No. 40	24.000 LB	_____.	_____.
0126	630.0200 Seeding Temporary	24.000 LB	_____.	_____.



Proposal Schedule of Items

Proposal ID: 20190312055 Project(s): 1560-04-70

Federal ID(s): WISC 2019183

SECTION: 0001

Contract Items

Alt Set ID:

Alt Mbr ID:

Proposal Line Number	Item ID Description	Approximate Quantity and Units	Unit Price	Bid Amount
0128	633.5200 Markers Culvert End	20.000 EACH	_____.	_____.
0130	634.0614 Posts Wood 4x6-Inch X 14-FT	91.000 EACH	_____.	_____.
0132	634.0616 Posts Wood 4x6-Inch X 16-FT	53.000 EACH	_____.	_____.
0134	634.0618 Posts Wood 4x6-Inch X 18-FT	11.000 EACH	_____.	_____.
0136	634.0620 Posts Wood 4x6-Inch X 20-FT	2.000 EACH	_____.	_____.
0138	637.2210 Signs Type II Reflective H	731.410 SF	_____.	_____.
0140	637.2230 Signs Type II Reflective F	150.720 SF	_____.	_____.
0142	638.2102 Moving Signs Type II	3.000 EACH	_____.	_____.
0144	638.2602 Removing Signs Type II	108.000 EACH	_____.	_____.
0146	638.3000 Removing Small Sign Supports	136.000 EACH	_____.	_____.
0148	642.5001 Field Office Type B	1.000 EACH	_____.	_____.
0150	643.0310.S Temporary Portable Rumble Strips	1.000 LS	_____.	_____.
0152	643.0900 Traffic Control Signs	13,050.000 DAY	_____.	_____.
0154	643.5000 Traffic Control	1.000 EACH	_____.	_____.
0156	646.1020 Marking Line Epoxy 4-Inch	51,420.000 LF	_____.	_____.
0158	646.1040 Marking Line Grooved Wet Ref Epoxy 4-Inch	99,540.000 LF	_____.	_____.



Proposal Schedule of Items

Proposal ID: 20190312055 Project(s): 1560-04-70

Federal ID(s): WISC 2019183

SECTION: 0001

Contract Items

Alt Set ID:

Alt Mbr ID:

Proposal Line Number	Item ID Description	Approximate Quantity and Units	Unit Price	Bid Amount
0160	646.5020 Marking Arrow Epoxy	18.000 EACH	_____	_____
0162	646.6120 Marking Stop Line Epoxy 18-Inch	121.000 LF	_____	_____
0164	646.7120 Marking Diagonal Epoxy 12-Inch	220.000 LF	_____	_____
0166	648.0100 Locating No-Passing Zones	8.830 MI	_____	_____
0168	649.0105 Temporary Marking Line Paint 4-Inch	96,000.000 LF	_____	_____
0170	650.4000 Construction Staking Storm Sewer	8.000 EACH	_____	_____
0172	650.5500 Construction Staking Curb Gutter and Curb & Gutter	2,841.000 LF	_____	_____
0174	650.6000 Construction Staking Pipe Culverts	3.000 EACH	_____	_____
0176	650.8000 Construction Staking Resurfacing Reference	49,595.000 LF	_____	_____
0178	650.9910 Construction Staking Supplemental Control (project) 01. 1560-04-70	LS	LUMP SUM	_____
0180	690.0150 Sawing Asphalt	3,459.000 LF	_____	_____
0182	690.0250 Sawing Concrete	5.000 LF	_____	_____
0184	740.0440 Incentive IRI Ride	37,600.000 DOL	1.00000	37,600.00
0186	ASP.1T0A On-the-Job Training Apprentice at \$5.00/HR	630.000 HRS	5.00000	3,150.00
0188	ASP.1T0G On-the-Job Training Graduate at \$5.00/HR	2,000.000 HRS	5.00000	10,000.00



Proposal Schedule of Items

Proposal ID: 20190312055 Project(s): 1560-04-70

Federal ID(s): WISC 2019183

SECTION: 0001

Contract Items

Alt Set ID:

Alt Mbr ID:

Proposal Line Number	Item ID Description	Approximate Quantity and Units	Unit Price	Bid Amount
0190	SPV.0035 Special 01. Base Repair for CIR Pavement	300.000 CY	_____.	_____.
0192	SPV.0060 Special 01. Ditch Cleaning	3.000 EACH	_____.	_____.
0194	SPV.0105 Special 01. Prepare Foundation for HMA Layer 1560-04-70	LS	LUMP SUM	_____.
0196	SPV.0105 Special 02. Prepare Foundation for CIR Asphalt Pavement	LS	LUMP SUM	_____.
0198	SPV.0165 Special 01. Remove and Salvage Brick Pavers	315.000 SF	_____.	_____.
0200	SPV.0180 Special 01. Cold In Place Recycling (CIR) Asphalt Pavement	143,489.000 SY	_____.	_____.
0202	SPV.0195 Special 01. Asphalt Stabilizing Agent	504.000 TON	_____.	_____.
0204	611.0630 Inlet Covers Type HM-GJ	7.000 EACH	_____.	_____.
0206	646.4520 Marking Line Same Day Epoxy 4-Inch	51,420.000 LF	_____.	_____.
Section: 0001			Total:	_____.
			Total Bid:	_____.