



# Wisconsin Department of Transportation

## Division of Transportation Systems Development

Bureau of Project Development  
4822 Madison Yards Way, 4<sup>th</sup> Floor South  
Madison, WI 53705

March 25, 2019

Telephone: (608) 266-1631  
Facsimile (FAX): (608) 266-8459

### NOTICE TO ALL CONTRACTORS:

**Proposal #03: 1204-05-72, WISC 2019 212  
Dodgeville – Mount Horeb  
USH 151 to E County Line  
USH 18  
Iowa County**

### Letting of April 9, 2019

This is Addendum No. 01, which provides for the following:

#### Schedule of Items:

Revised Bid Item Quantities					
Bid Item	Item Description	Unit	Old Quantity	Revised Quantity	Proposal Total
460.2005	Incentive Density PWL HMA Pavement	DOL	76,870	-3,140	73,640
460.2010	Incentive Air Voids HMA Pavement	DOL	110,610	-3,230	107,380
460.6224	HMA Pavement 4 MT 58-28 S	TON	110,623	-690	109,933

#### Plan Sheets:

Revised Plan Sheets	
Plan Sheet	Plan Sheet Title (brief description of changes to sheet)
8-9	Clarified paving and milling depths in the typical sections
12	Modified the specified bar length to 18-inches
13	Adjusted the tapered and notched longitudinal joint detail to show an additional inch of overpaving and milling.
54-56	Corrected the staging details to clarify that no cross slope correction would be required between STA 1027'EB'+93 and 1630'EB'+60 in the EB direction.
82-91	Updated the HMA tonnages and PWL quantities in the miscellaneous quantities to account for the other modifications discussed above.

**Schedule of Items**

Attached, dated March 25, 2019, are the revised Schedule of Items Page 2.

**Plan Sheets**

The following 8½ x 11-inch sheets are attached and made part of the plans for this proposal:

Revised: 8, 9, 12, 13, 54-56, 82-91

The responsibility for notifying potential subcontractors and suppliers of these changes remains with the prime contractor.

Sincerely,

*Mike Coleman*

Proposal Development Specialist  
Proposal Management Section

END OF ADDENDUM

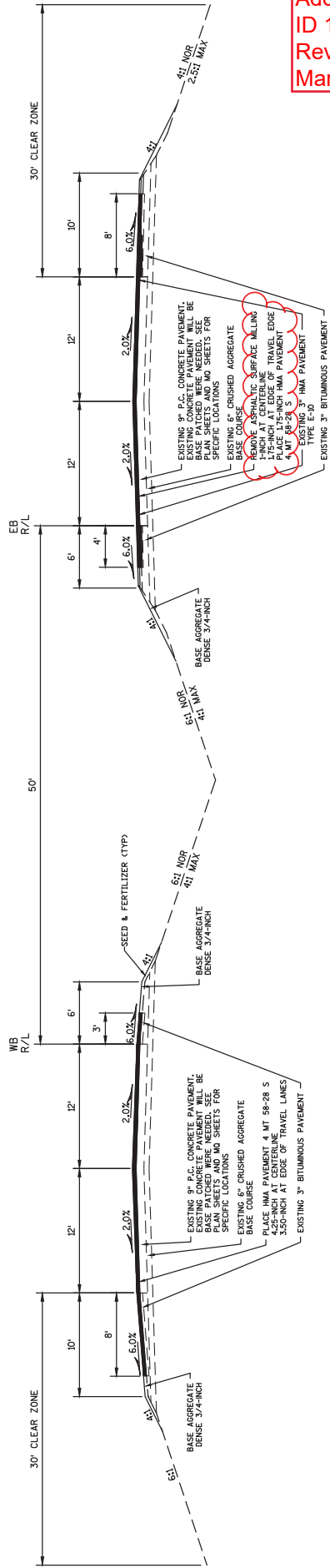

Addendum No. 01  
 ID 1204-05-72  
 Revised Sheet 8  
 March 25, 2019

TYPICAL FINISHED SECTION  
 STA. 910+36'EB' TO STA. 1017+61'EB'

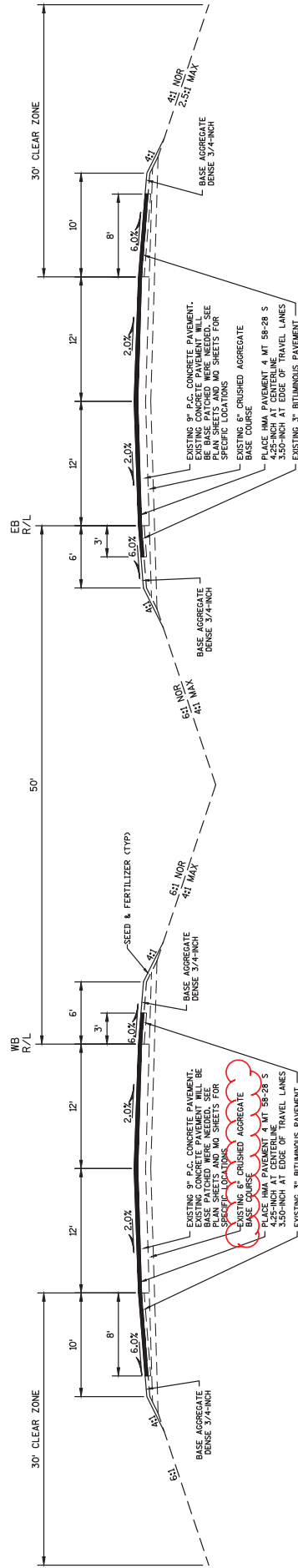

TYPICAL FINISHED SECTION  
 STA. 1017+61'EB' TO STA. 1027+93'EB'

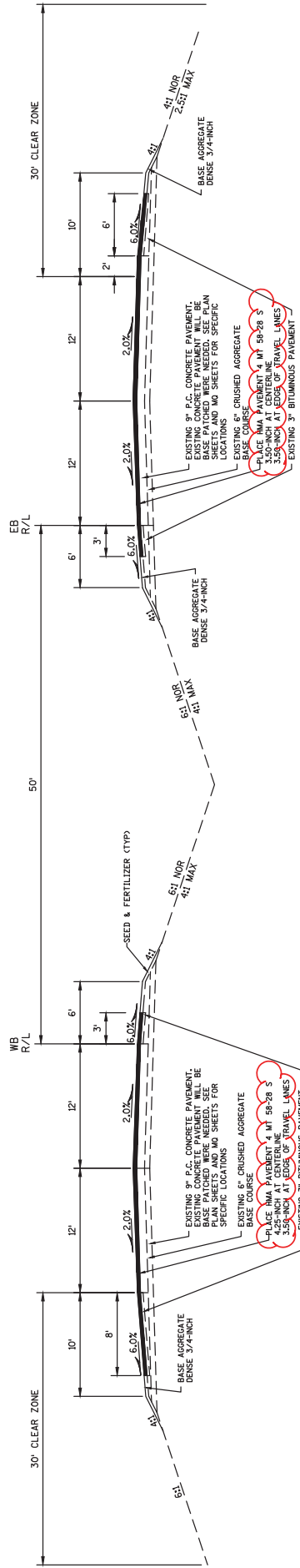

TYPICAL FINISHED SECTION

- STA. 1027+93'WB' TO STA. 1023+58'WB'
- STA. 1035+25'WB' TO STA. 1021+99'WB'
- STA. 1023+28'WB' TO STA. 1066+21'WB'
- STA. 1021+93'WB' TO STA. 1024+09'EB'
- STA. 1027+93'EB' TO STA. 1022+40'EB'
- STA. 1035+30'EB' TO STA. 1022+40'EB'
- STA. 1023+86'EB' TO STA. 1066+52'EB'
- STA. 1088+65'EB' TO STA. 1030+60'EB'

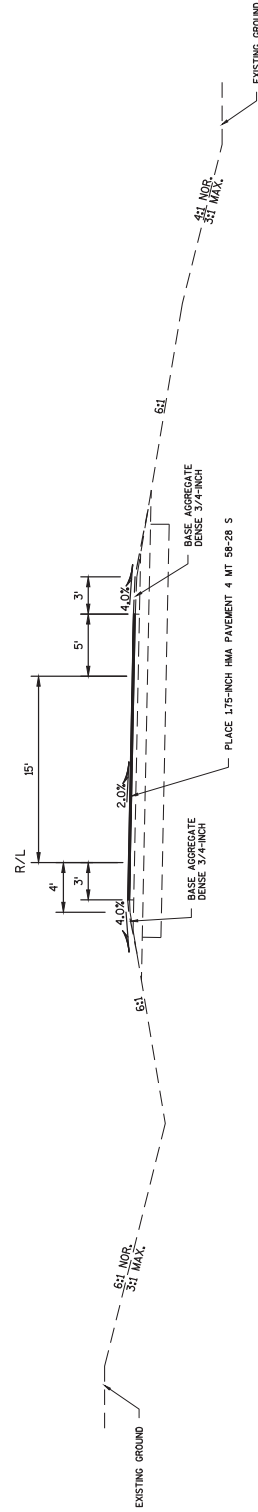

TYPICAL FINISHED SECTION

INTERCHANGE AT RIDGEWAY RAMPS

Addendum No. 01  
 ID 1204-05-72  
 Revised Sheet 9  
 March 25, 2019

Addendum No. 01  
ID 1204-05-72  
Revised Sheet 12  
March 25, 2019

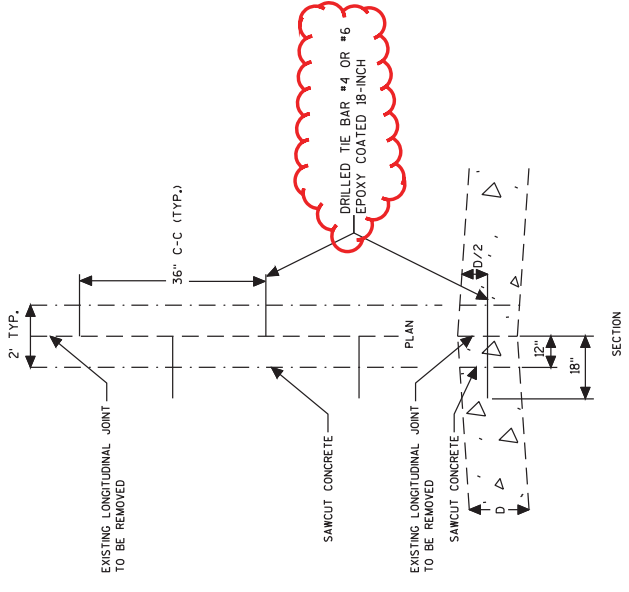

CONCRETE PAVEMENT REPAIR LONGITUDINAL JOINT DETAIL  
NOTE: TIE BAR MAY BE DRILLED AT AN ANGLE, THEN BENT PERPENDICULAR TO JOINT AFTER INSTALLATION

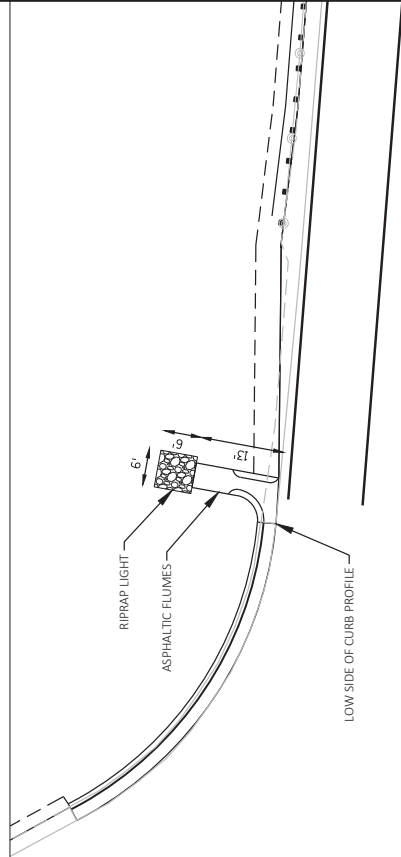

ASPHALTIC FLUMES AND RIP RAP (TYPICAL)

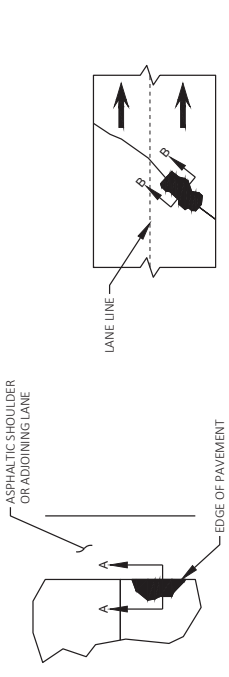

PLAN VIEW

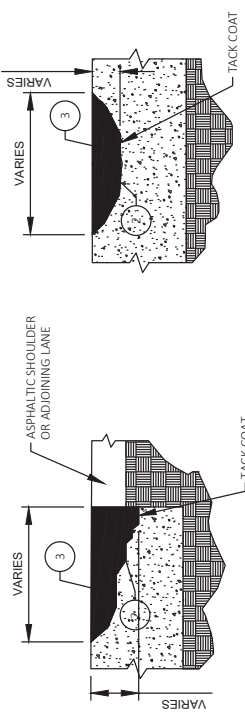

SECTION A-A

SECTION B-B

EDGE REPAIR

CRACK/JOINT REPAIR

- 1 REMOVE ALL UNSOUND AND DETERIORATED MATERIAL.
- 2 BLOW OUT REPAIR AREAS WITH 80 P.S.I. MINIMUM COMPRESSED AIR.
- 3 ASPHALTIC SURFACE AND TRACK COAT (INCIDENTAL TO CONCRETE JOINT AND CRACK CLEANING)

CONCRETE JOINT & CRACK CLEANING

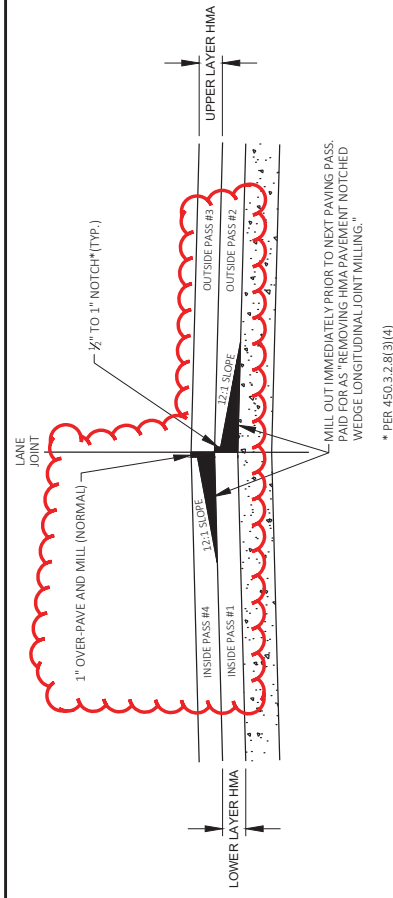

TYPICAL PAVEMENT CROSS SECTIONS OF TAPERED & NOTCHED LONGITUDINAL JOINTS

Addendum No. 01  
ID 1204-05-72  
Revised Sheet 13  
March 25, 2019

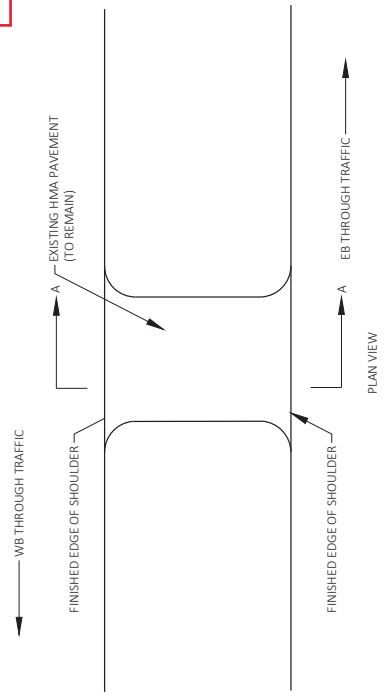
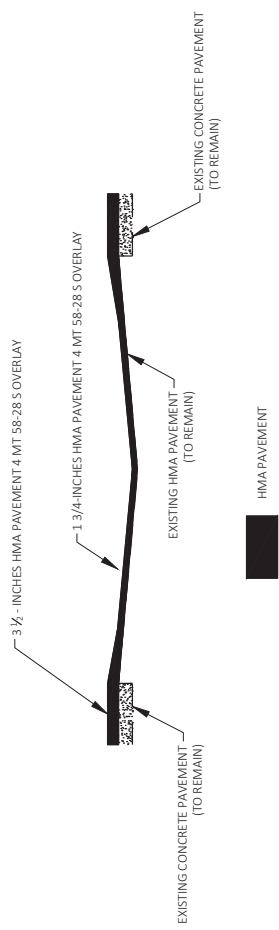

PAVING DETAIL FOR MAINTENANCE CROSSOVER

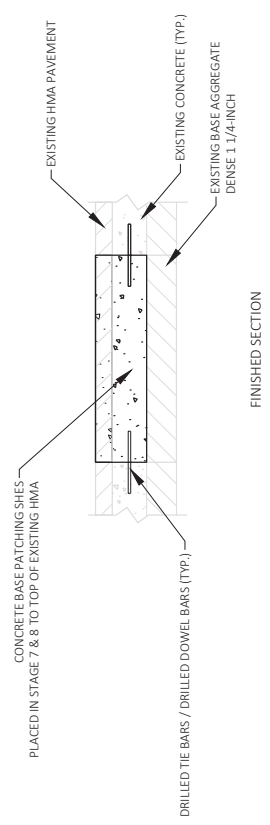

BASE PATCHING DETAIL IN EXISTING OVERLAY SECTION

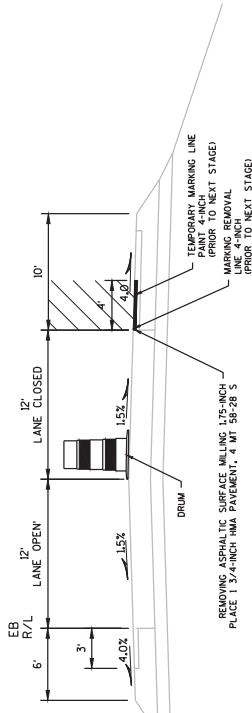

**CONSTRUCTION STAGE 6 TYPICAL SECTION**

STA. 1017+61 'EB' TO STA. 1027+93 'EB'  
OUTSIDE LANE AND SHOULDER CLOSED

MILLING OPERATION TO REMOVE EXISTING OUTSIDE SHOULDER RUMBLE

MILLING AND PAVING BINDER LAYER 1 3/4-INCH HMA PAVEMENT, 4 MT 58-28 S, 4-FT WIDTH

**Addendum No. 01  
ID 1204-05-72  
Revised Sheet 54  
March 25, 2019**

WB R/L



WB R/L

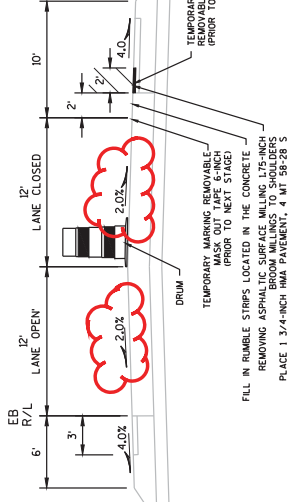

**CONSTRUCTION STAGE 6 TYPICAL SECTION**

STA. 1027+93 'EB' TO STA. 1630+60 'EB'  
OUTSIDE LANE AND SHOULDER CLOSED

MILLING OPERATION TO REMOVE EXISTING OUTSIDE SHOULDER RUMBLE

MILLING AND PAVING BINDER LAYER 1 3/4-INCH HMA PAVEMENT, 4 MT 58-28 S, 2-FT WIDTH

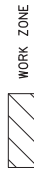





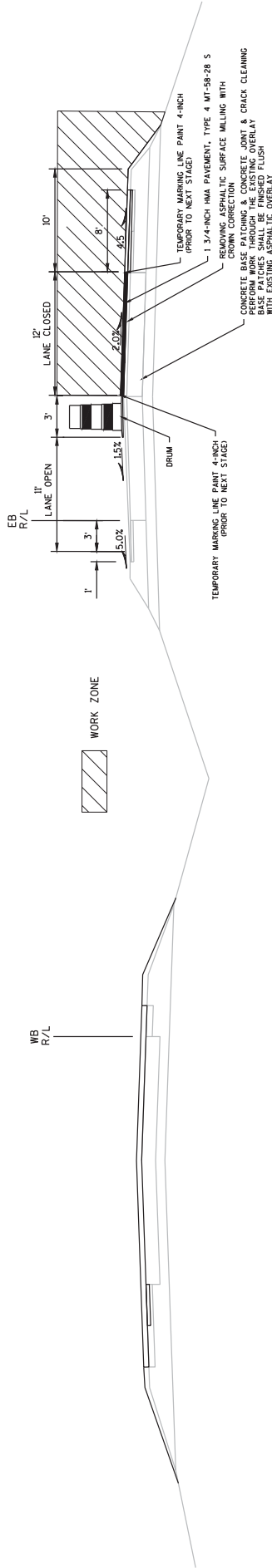

**CONSTRUCTION STAGE 8 TYPICAL SECTION**

STA. 909+59 'EB' TO STA. 1017+61 'EB'  
 OUTSIDE LANE AND SHOULDER CLOSED  
 ASPHALTIC SURFACE MILLING WITH CROWN CORRECTION  
 1-INCH AT CENTER LINE TO 1 3/4-INCH AT EDGE OF TRAVEL LANE  
 COMPLETE CONCRETE BASE PATCHING AND CONCRETE JOINT & CRACK CLEANING ON OUTSIDE LANE  
 SURFACE LAYER OVERLAY, 1 3/4-INCH HMA PAVEMENT, 4 MT 58-28 S OUTSIDE LANE

**Addendum No. 01  
 ID 1204-05-72  
 Revised Sheet 56  
 March 25, 2019**

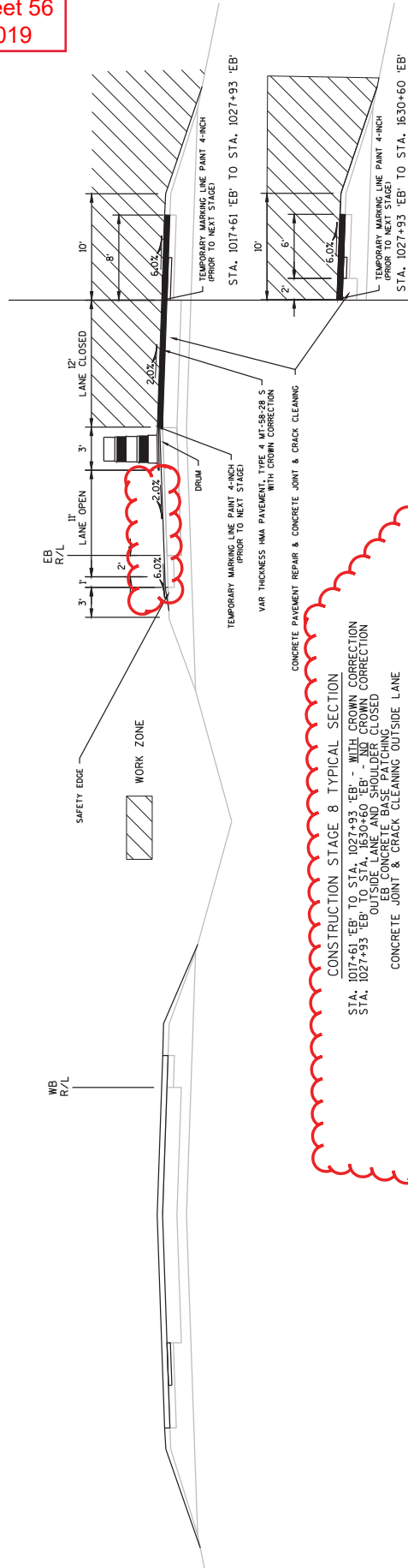

**CONSTRUCTION STAGE 8 TYPICAL SECTION**

STA. 1017+61 'EB' TO STA. 1027+93 'EB' - WITH CROWN CORRECTION  
 STA. 1027+93 'EB' TO STA. 1030+60 'EB' - WITH CROWN CORRECTION  
 OUTSIDE LANE AND SHOULDER CLOSED  
 EB CONCRETE BASE PATCHING  
 CONCRETE JOINT & CRACK CLEANING OUTSIDE LANE  
 EB OUTSIDE LANE AND SHOULDER, BINDER LAYER OVERLAY WITH CROWN CORRECTION, SHOULDERS  
 EB OUTSIDE LANE AND SHOULDER, BINDER LAYER OVERLAY WITH NO CROWN CORRECTION,  
 OVERLAY 1 3/4-INCH AT CENTER LINE AND 1 3/4-INCH AT EDGE OF CONCRETE TO 1 1/2-INCH AT EDGE OF SHOULDER

Addendum No. 01  
 ID 1204-05-72  
 Revised Sheet 82  
 March 25, 2019

3

ASPHALTIC PAVEMENT SUMMARY

STATION TO	STATION	LOCATION	LANE AREA		SHDR AREA		AVG LOWER LAYER DEPTH		UPPER LAYER DEPTH		TACK COAT		HMA PAVEMENT (4 MT 58-226)		ELIGIBLE TONNAGE		ELIGIBLE LF		450-4000 HMA		465-0120 ASPHALTIC SURFACE		465-0400 ASPHALTIC SHOULDER		SPV 0090.02 REMOVING HMA PAVEMENT NOTCHED WEDGE LONGITUDINAL JOINT MILLING		PAVING REMARKS			
			SY	SY	SY	SY	IN	IN	IN	IN	IN	IN	IN	IN	IN	IN	TON	TON	TON	TON	TON	TON	TON	TON	TON	TON		TON	TON	TON
<b>STAGE 1</b>																														
WESTBOUND																														
909' WB + 59	- 962' WB + 40	USH 18 OUTSIDE SHDR	0	2,347	0	1,750	0	1,750	0	164	226	0	226	0	226	0	226	0	226	0	226	0	226	0	226	0	226	0	BINDER	
962' WB + 40	- 1015' WB + 20	USH 18 OUTSIDE SHDR	0	2,347	0	1,750	0	1,750	0	164	226	0	226	0	226	0	226	0	226	0	226	0	226	0	226	0	226	0	BINDER	
1015' WB + 20	- 1068' WB + 00	USH 18 OUTSIDE SHDR	0	2,347	0	1,750	0	1,750	0	164	226	0	226	0	226	0	226	0	226	0	226	0	226	0	226	0	226	0	BINDER	
1068' WB + 00	- 1123' WB + 58	USH 18 OUTSIDE SHDR	0	2,470	0	1,750	0	1,750	0	173	238	0	238	0	238	0	238	0	238	0	238	0	238	0	238	0	238	0	BINDER	
1123' WB + 58	- 1173' WB + 60	USH 18 OUTSIDE SHDR	0	1,704	0	1,750	0	1,750	0	119	164	0	164	0	164	0	164	0	164	0	164	0	164	0	164	0	164	0	BINDER	
1173' WB + 60	- 1221' WB + 96	USH 18 OUTSIDE SHDR	0	2,149	0	1,750	0	1,750	0	150	207	0	207	0	207	0	207	0	207	0	207	0	207	0	207	0	207	0	BINDER	
1221' WB + 96	- 1276' WB + 10	USH 18 OUTSIDE SHDR	0	2,348	0	1,750	0	1,750	0	164	226	0	226	0	226	0	226	0	226	0	226	0	226	0	226	0	226	0	BINDER	
1276' WB + 10	- 1328' WB + 90	USH 18 OUTSIDE SHDR	0	2,347	0	1,750	0	1,750	0	164	226	0	226	0	226	0	226	0	226	0	226	0	226	0	226	0	226	0	BINDER	
1328' WB + 90	- 1384' WB + 00	USH 18 OUTSIDE SHDR	0	2,347	0	1,750	0	1,750	0	171	236	0	236	0	236	0	236	0	236	0	236	0	236	0	236	0	236	0	BINDER	
1384' WB + 00	- 1436' WB + 80	USH 18 OUTSIDE SHDR	0	2,347	0	1,750	0	1,750	0	164	226	0	226	0	226	0	226	0	226	0	226	0	226	0	226	0	226	0	BINDER	
1436' WB + 80	- 1486' WB + 13	USH 18 OUTSIDE SHDR	0	2,192	0	1,750	0	1,750	0	153	211	0	211	0	211	0	211	0	211	0	211	0	211	0	211	0	211	0	BINDER	
1487' WB + 87	- 1540' WB + 70	USH 18 OUTSIDE SHDR	0	2,348	0	1,750	0	1,750	0	164	226	0	226	0	226	0	226	0	226	0	226	0	226	0	226	0	226	0	BINDER	
1540' WB + 70	- 1593' WB + 50	USH 18 OUTSIDE SHDR	0	2,347	0	1,750	0	1,750	0	164	226	0	226	0	226	0	226	0	226	0	226	0	226	0	226	0	226	0	BINDER	
1593' WB + 50	- 1630' WB + 54	USH 18 OUTSIDE SHDR	0	1,646	0	1,750	0	1,750	0	115	158	0	158	0	158	0	158	0	158	0	158	0	158	0	158	0	158	0	BINDER	
WESTBOUND SUBTOTAL			0	31,388	0	2,197	3,021	2,197	3,021	0	0	0	0	0	0	0	0	0	0	0	0	0	0	0	0	0	0	0		
<b>STAGE 1 SUBTOTAL</b>			<b>0</b>	<b>31,388</b>	<b>0</b>	<b>2,197</b>	<b>3,021</b>	<b>2,197</b>	<b>3,021</b>	<b>0</b>	<b>0</b>	<b>0</b>	<b>0</b>	<b>0</b>	<b>0</b>	<b>0</b>	<b>0</b>	<b>0</b>	<b>0</b>	<b>0</b>	<b>0</b>	<b>0</b>	<b>0</b>	<b>0</b>	<b>0</b>	<b>0</b>	<b>0</b>	<b>0</b>		
<b>STAGE 2</b>																														
WESTBOUND																														
909' WB + 59	- 962' WB + 40	USH 18 INSIDE LANE & SHDR	7,041	1,760	2,125	1,400	0	616	959	80	823	959	5,281	5,281	5,281	5,281	5,281	5,281	5,281	5,281	5,281	5,281	5,281	5,281	5,281	5,281	5,281	5,281	VAR THICKNESS BINDER	
962' WB + 40	- 1015' WB + 20	USH 18 INSIDE LANE & SHDR	7,040	1,760	2,125	1,400	0	616	958	80	823	958	5,280	5,280	5,280	5,280	5,280	5,280	5,280	5,280	5,280	5,280	5,280	5,280	5,280	5,280	5,280	5,280	VAR THICKNESS BINDER	
1015' WB + 20	- 1068' WB + 00	USH 18 INSIDE LANE & SHDR	7,040	1,760	2,125	1,400	0	645	1,003	84	861	1,003	5,528	5,528	5,528	5,528	5,528	5,528	5,528	5,528	5,528	5,528	5,528	5,528	5,528	5,528	5,528	5,528	VAR THICKNESS BINDER	
1068' WB + 00	- 1123' WB + 28	USH 18 INSIDE LANE & SHDR	7,371	1,843	2,125	1,400	0	645	1,003	84	861	1,003	5,528	5,528	5,528	5,528	5,528	5,528	5,528	5,528	5,528	5,528	5,528	5,528	5,528	5,528	5,528	5,528	VAR THICKNESS BINDER	
1123' WB + 28	- 1173' WB + 60	USH 18 INSIDE LANE & SHDR	5,113	1,278	2,125	1,400	0	447	696	58	598	696	3,835	3,835	3,835	3,835	3,835	3,835	3,835	3,835	3,835	3,835	3,835	3,835	3,835	3,835	3,835	3,835	VAR THICKNESS BINDER	
1173' WB + 60	- 1221' WB + 96	USH 18 INSIDE LANE & SHDR	6,448	1,612	2,125	1,400	0	564	878	74	754	878	4,836	4,836	4,836	4,836	4,836	4,836	4,836	4,836	4,836	4,836	4,836	4,836	4,836	4,836	4,836	4,836	VAR THICKNESS BINDER	
1221' WB + 96	- 1276' WB + 10	USH 18 INSIDE LANE & SHDR	7,045	1,761	2,125	1,400	0	616	959	80	823	959	5,284	5,284	5,284	5,284	5,284	5,284	5,284	5,284	5,284	5,284	5,284	5,284	5,284	5,284	5,284	5,284	5,284	VAR THICKNESS BINDER
1276' WB + 10	- 1328' WB + 90	USH 18 INSIDE LANE & SHDR	7,040	1,760	2,125	1,400	0	616	958	80	823	958	5,280	5,280	5,280	5,280	5,280	5,280	5,280	5,280	5,280	5,280	5,280	5,280	5,280	5,280	5,280	5,280	5,280	VAR THICKNESS BINDER
1328' WB + 90	- 1384' WB + 00	USH 18 INSIDE LANE & SHDR	7,347	1,837	2,125	1,400	0	643	1,000	84	859	1,000	5,510	5,510	5,510	5,510	5,510	5,510	5,510	5,510	5,510	5,510	5,510	5,510	5,510	5,510	5,510	5,510	5,510	VAR THICKNESS BINDER
1384' WB + 00	- 1436' WB + 80	USH 18 INSIDE LANE & SHDR	7,040	1,760	2,125	1,400	0	616	958	80	823	958	5,280	5,280	5,280	5,280	5,280	5,280	5,280	5,280	5,280	5,280	5,280	5,280	5,280	5,280	5,280	5,280	5,280	VAR THICKNESS BINDER
1436' WB + 80	- 1481' WB + 95	USH 18 INSIDE LANE & SHDR	6,020	1,505	2,125	1,400	0	527	819	69	704	819	4,515	4,515	4,515	4,515	4,515	4,515	4,515	4,515	4,515	4,515	4,515	4,515	4,515	4,515	4,515	4,515	VAR THICKNESS BINDER	
1481' WB + 95	- 1486' WB + 13	USH 18 INSIDE LANE & SHDR	557	279	2,125	1,400	0	57	138	6	65	138	418	418	418	418	418	418	418	418	418	418	418	418	418	418	418	418	418	TWO BINDER LAYERS
1487' WB + 87	- 1493' WB + 63	USH 18 INSIDE LANE & SHDR	768	384	2,125	1,400	0	81	190	9	90	190	576	576	576	576	576	576	576	576	576	576	576	576	576	576	576	576	576	TWO BINDER LAYERS
1493' WB + 63	- 1540' WB + 70	USH 18 INSIDE LANE & SHDR	6,276	1,569	2,125	1,400	0	549	854	72	734	854	4,707	4,707	4,707	4,707	4,707	4,707	4,707	4,707	4,707	4,707	4,707	4,707	4,707	4,707	4,707	4,707	VAR THICKNESS BINDER	
1540' WB + 70	- 1593' WB + 50	USH 18 INSIDE LANE & SHDR	7,040	1,760	2,125	1,400	0	616	958	80	823	958	5,280	5,280	5,280	5,280	5,280	5,280	5,280	5,280	5,280	5,280	5,280	5,280	5,280	5,280	5,280	5,280	5,280	VAR THICKNESS BINDER
1593' WB + 50	- 1630' WB + 54	USH 18 INSIDE LANE & SHDR	4,939	1,235	2,125	1,400	0	432	672	56	577	672	3,704	3,704	3,704	3,704	3,704	3,704	3,704	3,704	3,704	3,704	3,704	3,704	3,704	3,704	3,704	3,704	3,704	VAR THICKNESS BINDER
WESTBOUND SUBTOTAL			94,125	23,863	8,259	12,960	0	8,259	12,960	0	1,074	11,001	12,960	70,594	70,594	70,594	70,594	70,594	70,594	70,594	70,594	70,594	70,594	70,594	70,594	70,594	70,594	70,594	0	
<b>STAGE 2 SUBTOTAL</b>			<b>94,125</b>	<b>23,863</b>	<b>8,259</b>	<b>12,960</b>	<b>0</b>	<b>8,259</b>	<b>12,960</b>	<b>0</b>	<b>1,074</b>	<b>11,001</b>	<b>12,960</b>	<b>70,594</b>	<b>70,594</b>	<b>70,594</b>	<b>70,594</b>	<b>70,594</b>	<b>70,594</b>	<b>70,594</b>	<b>70,594</b>	<b>70,594</b>	<b>70,594</b>	<b>70,594</b>	<b>70,594</b>	<b>70,594</b>	<b>70,594</b>	<b>70,594</b>	<b>0</b>	

3

ADDITIONAL QUANTITIES SHOWN ON NEXT PAGE

PROJECT NO: 1204-05-72

HWY: USH 18

COUNTY: IOWA

MISCELLANEOUS QUANTITIES

SHEET: 82

FILE NAME: X:\Projects\W0046380-06-06-5TH 97\ES&Q\030000\_mq.pptx

PLOT DATE: March 21, 2019

PLOT BY: JT ENGINEERING

PLOT NAME:

PLOT SCALE: 1:1

E



ASPHALTIC PAVEMENT SUMMARY

STATION TO STATION	LOCATION	LANE AREA SY	SHDR AREA SY	AVG LOWER LAYER DEPTH		UPPER SHDR LAYER DEPTH		TACK COAT GAL		455.0605		460.6224		450.4000		465.0120		465.0400		SPV 0090.02		PAVING REMARKS			
				LANE ML	SHDR ML	SHDR IN	LANE IN	SHDR IN	LANE IN	SHDR IN	TON	TON	TON	TON	TON	TON	TON	TON	TON	TON	TON		TON	TON	TON
<b>STAGE 4 WESTBOUND</b>																									
909 'WB' + 59 - 962 'WB' + 40	USH 18 INSIDE LANE & SHDR	7,041	1,760	0	0	1,750	616	0	847	0	847	0	847	0	847	0	847	0	847	0	847	0	5,281	5,281	SURFACE
962 'WB' + 40 - 1015 'WB' + 20	USH 18 INSIDE LANE & SHDR	7,040	1,760	0	0	1,750	616	0	847	0	847	0	847	0	847	0	847	0	847	0	847	0	5,280	5,280	SURFACE
1015 'WB' + 20 - 1068 'WB' + 00	USH 18 INSIDE LANE & SHDR	7,040	1,760	0	0	1,750	616	0	847	0	847	0	847	0	847	0	847	0	847	0	847	0	5,280	5,280	SURFACE
1068 'WB' + 00 - 1123 'WB' + 58	USH 18 INSIDE LANE & SHDR	7,411	1,853	0	0	1,750	648	0	892	0	892	0	892	0	892	0	892	0	892	0	892	0	5,558	5,558	SURFACE
1123 'WB' + 58 - 1173 'WB' + 60	USH 18 INSIDE LANE & SHDR	5,113	1,278	0	0	1,750	447	0	615	0	615	0	615	0	615	0	615	0	615	0	615	0	3,835	3,835	SURFACE
1173 'WB' + 60 - 1221 'WB' + 96	USH 18 INSIDE LANE & SHDR	6,448	1,612	0	0	1,750	564	0	776	0	776	0	776	0	776	0	776	0	776	0	776	0	4,836	4,836	SURFACE
1221 'WB' + 96 - 1276 'WB' + 10	USH 18 INSIDE LANE & SHDR	7,045	1,761	0	0	1,750	616	0	848	0	848	0	848	0	848	0	848	0	848	0	848	0	5,284	5,284	SURFACE
1276 'WB' + 10 - 1328 'WB' + 90	USH 18 INSIDE LANE & SHDR	7,040	1,760	0	0	1,750	616	0	847	0	847	0	847	0	847	0	847	0	847	0	847	0	5,280	5,280	SURFACE
1328 'WB' + 90 - 1384 'WB' + 00	USH 18 INSIDE LANE & SHDR	7,347	1,837	0	0	1,750	643	0	884	0	884	0	884	0	884	0	884	0	884	0	884	0	5,510	5,510	SURFACE
1384 'WB' + 00 - 1436 'WB' + 80	USH 18 INSIDE LANE & SHDR	7,040	1,760	0	0	1,750	616	0	847	0	847	0	847	0	847	0	847	0	847	0	847	0	5,280	5,280	SURFACE
1436 'WB' + 80 - 1481 'WB' + 95	USH 18 INSIDE LANE & SHDR	6,020	1,505	0	0	1,750	527	0	724	0	724	0	724	0	724	0	724	0	724	0	724	0	4,515	4,515	SURFACE
1481 'WB' + 95 - 1486 'WB' + 13	USH 18 INSIDE LANE & SHDR	557	279	0	0	1,750	59	0	80	0	80	0	80	0	80	0	80	0	80	0	80	0	418	418	SURFACE
1486 'WB' + 13 - 1493 'WB' + 63	USH 18 INSIDE LANE & SHDR	768	384	0	0	1,750	81	0	111	0	111	0	111	0	111	0	111	0	111	0	111	0	576	576	SURFACE
1493 'WB' + 63 - 1540 'WB' + 70	USH 18 INSIDE LANE & SHDR	6,276	1,569	0	0	1,750	549	0	755	0	755	0	755	0	755	0	755	0	755	0	755	0	4,707	4,707	SURFACE
1540 'WB' + 70 - 1593 'WB' + 50	USH 18 INSIDE LANE & SHDR	7,040	1,760	0	0	1,750	616	0	847	0	847	0	847	0	847	0	847	0	847	0	847	0	5,280	5,280	SURFACE
1593 'WB' + 50 - 1630 'WB' + 54	USH 18 INSIDE LANE & SHDR	4,939	1,235	0	0	1,750	432	0	594	0	594	0	594	0	594	0	594	0	594	0	594	0	3,704	3,704	SURFACE
WESTBOUND SUBTOTAL		94,165	23,873				8,263	0	11,361	0	11,361	0	11,361	0	11,361	0	11,361	0	11,361	0	11,361	0	70,624	70,624	
<b>SIDERODS</b>																									
CTH Y	LT TURK LN & 1/2 MEDIAN	881	0	0	0	1,750	62	0	85	0	85	0	85	0	85	0	85	0	85	0	85	0	0	0	SURFACE
CTH HH	LT TURK LN & 1/2 MEDIAN	295	0	0	0	1,750	21	0	28	0	28	0	28	0	28	0	28	0	28	0	28	0	0	0	SURFACE
PKES PEAK RD	LT TURK LN & 1/2 MEDIAN	656	0	0	0	1,750	46	0	63	0	63	0	63	0	63	0	63	0	63	0	63	0	0	0	SURFACE
THOMPSON RD	LT TURK LN & 1/2 MEDIAN	248	0	0	0	1,750	17	0	24	0	24	0	24	0	24	0	24	0	24	0	24	0	0	0	SURFACE
CTH T	LT TURK LN & 1/2 MEDIAN	833	0	0	0	1,750	4	0	5	0	5	0	5	0	5	0	5	0	5	0	5	0	0	0	SURFACE
CTH K	LT TURK LN & 1/2 MEDIAN	660	0	0	0	1,750	58	0	80	0	80	0	80	0	80	0	80	0	80	0	80	0	0	0	SURFACE
MOUNDS VIEW RD	LT TURK LN & 1/2 MEDIAN	329	0	0	0	1,750	23	0	32	0	32	0	32	0	32	0	32	0	32	0	32	0	0	0	SURFACE
E BRIGHAM RD	LT TURK LN & 1/2 MEDIAN	298	0	0	0	1,750	21	0	29	0	29	0	29	0	29	0	29	0	29	0	29	0	0	0	SURFACE
SIDEROD SUBTOTAL		4,250	0				298	0	405	0	405	0	405	0	405	0	405	0	405	0	405	0	0	0	
<b>STAGE 4 SUBTOTAL</b>		<b>98,415</b>	<b>23,873</b>				<b>8,560</b>	<b>0</b>	<b>11,770</b>	<b>0</b>	<b>11,770</b>	<b>0</b>	<b>11,770</b>	<b>0</b>	<b>11,770</b>	<b>0</b>	<b>11,770</b>	<b>0</b>	<b>11,770</b>	<b>0</b>	<b>11,770</b>	<b>0</b>	<b>70,624</b>	<b>70,624</b>	

ADDITIONAL QUANTITIES SHOWN ON NEXT PAGE

Addendum No. 01  
ID 1204-05-72  
Revised Sheet 84  
March 25, 2019



Addendum No. 01  
 ID 1204-05-72  
 Revised Sheet 86  
 March 25, 2019

ASPHALTIC PAVEMENT SUMMARY

STATION TO	STATION	LOCATION	LANE AREA SY	SHDR AREA SY	SHDR AREA SY	AVG LOWER LAYER DEPTH INCH	UPPER LAYER DEPTH INCH	TACK COAT	HMA PAVEMENT (BINDER) SURFACE	ELIGIBLE TONNAGE	DENSITY AIR VOLS	INCENTIVE	ELIGIBLE LF	HMA PAVEMENT LONGITUDINAL JOINT	TON	ASPHALTIC SURFACE DRI VIEWS	SHOULDER RUBBLE STRIPS	SPV 0090.02 REMOVING HMA PAVEMENT NOTCHED WEDGE LONGITUDINAL JOINT MILLING	PAVING REMARKS	
<b>STAGE 8</b>																				
<b>EASTBOUND</b>																				
909' EB + 59	- 962' EB + 40	USH 18 OUTSIDE LANE & SHDR	7.041	0	0	0	0	1.750	493	0	678	678	5,281							
1017' EB + 61	- 1077' EB + 61	USH 18 OUTSIDE LANE & SHDR	7.361	0	0	0	0	1.750	515	0	709	709	5,521							
1027' EB + 93	- 1027' EB + 93	USH 18 OUTSIDE LANE & SHDR	1.376	911	2.125	0.875	1.750	321	205	221	8	293	426	2,064				1,032		VAR THICK BINDER SURFACE
1068' EB + 00	- 1068' EB + 00	USH 18 OUTSIDE LANE & SHDR	5.343	3.56	1.750	0.875	1.750	1,247	686	857	31	1,028	1,543	8,014				4,007		BINDER & SURFACE
1135' EB + 90	- 1124' EB + 09	USH 18 OUTSIDE LANE & SHDR	7.479	4.99	1.750	0.875	1.750	1,745	960	1,200	43	1,440	2,159	11,218				5,609		BINDER & SURFACE
1173' EB + 60	- 1173' EB + 60	USH 18 OUTSIDE LANE & SHDR	5.027	3.35	1.750	0.875	1.750	1,173	645	806	29	968	1,451	7,540				3,770		BINDER & SURFACE
1223' EB + 89	- 1222' EB + 45	USH 18 OUTSIDE LANE & SHDR	6.513	4.34	1.750	0.875	1.750	1,520	836	1,045	37	1,254	1,881	9,770				4,885		BINDER & SURFACE
1276' EB + 70	- 1276' EB + 70	USH 18 OUTSIDE LANE & SHDR	7.041	4.69	1.750	0.875	1.750	1,643	904	1,130	40	1,355	2,033	10,562				5,281		BINDER & SURFACE
1329' EB + 50	- 1329' EB + 50	USH 18 OUTSIDE LANE & SHDR	7.040	4.69	1.750	0.875	1.750	1,643	903	1,129	40	1,355	2,033	10,560				5,280		BINDER & SURFACE
1382' EB + 30	- 1435' EB + 10	USH 18 OUTSIDE LANE & SHDR	7.040	4.69	1.750	0.875	1.750	1,643	903	1,129	40	1,355	2,033	10,560				5,280		BINDER & SURFACE
1435' EB + 10	- 1486' EB + 62	USH 18 OUTSIDE LANE & SHDR	6.869	4.58	1.750	0.875	1.750	1,603	882	1,102	40	1,322	1,984	10,304				5,152		BINDER & SURFACE
1488' EB + 76	- 1541' EB + 60	USH 18 OUTSIDE LANE & SHDR	7.040	4.69	1.750	0.875	1.750	1,644	904	1,130	41	1,356	2,034	10,568				5,284		BINDER & SURFACE
1541' EB + 60	- 1594' EB + 40	USH 18 OUTSIDE LANE & SHDR	7.040	4.69	1.750	0.875	1.750	1,643	903	1,129	40	1,355	2,033	10,560				5,280		BINDER & SURFACE
1594' EB + 40	- 1630' EB + 60	USH 18 OUTSIDE LANE & SHDR	4.827	3.21	1.750	0.875	1.750	1,126	619	774	28	929	1,394	7,240				3,620		BINDER & SURFACE
<b>EASTBOUND SUBTOTAL</b>			<b>94,083</b>	<b>53,120</b>				<b>19,600</b>	<b>10,254</b>	<b>14,168</b>	<b>458</b>	<b>16,753</b>	<b>24,422</b>	<b>130,322</b>	<b>0</b>	<b>0</b>	<b>0</b>	<b>59,760</b>		
<b>SIDERoads</b>																				
<b>CTH Y</b>																				
1046' EB + 25		RT TURN LANE & SOUTH LEG DRIVEWAY	905	0	0	0	0	1.750	63	0	87	0	87	0						
1102' EB + 90	- 1115' EB + 17	USH 18/USH 151 ON RAMP	1,806	0	0	0	0	1.750	126	174		174	0							
1135' EB + 90	- 1148' EB + 20	USH 18/USH 151 OFF RAMP	1,638	0	0	0	0	1.750	115	158		158	0							
<b>CTH HHI</b>																				
1288' EB + 58		DRIVEWAY	415	0	0	0	0	1.750	29	40		40	0							
<b>PIKES PEAK RD</b>																				
1323' EB + 37		RT TURN LANE & SOUTH LEG DRIVEWAY	693	0	0	0	0	1.750	49	67		67	0							
1357' EB + 67		DRIVEWAY	0	11	0	0	0	1.750	1	1		1	0							
<b>THOMPSON RD</b>																				
1405' EB + 00		RT TURN LANE & SOUTH LEG DRIVEWAY	380	0	0	0	0	1.750	27	37		37	0							
1426' EB + 43		DRIVEWAY	680	0	0	0	0	1.750	48	65		65	0							
1441' EB + 90	- 1448' EB + 44	USH 18/USH 151 ON RAMP	1,444	0	0	0	0	1.750	101	139		139	0							
1471' EB + 46	- 1486' EB + 78	USH 18/USH 151 OFF RAMP	2,394	0	0	0	0	1.750	168	230		230	0							
<b>CTH K</b>																				
1569' EB + 07		DRIVEWAY	821	0	0	0	0	1.750	57	79		79	0							
<b>MOUNDS VIEW RD</b>																				
1610' EB + 00		RT TURN LANE & SOUTH LEG DRIVEWAY	428	0	0	0	0	1.750	30	41		41	0							
<b>E BIRGHAM RD</b>																				
12,215		RT TURN LANE & SOUTH LEG DRIVEWAY	117	0	0	0	0	1.750	43	59		59	0							
<b>STAGE 8 SUBTOTAL</b>			<b>106,298</b>	<b>58,237</b>				<b>20,463</b>	<b>10,254</b>	<b>15,385</b>	<b>488</b>	<b>16,753</b>	<b>25,609</b>	<b>130,322</b>	<b>0</b>	<b>0</b>	<b>0</b>	<b>59,760</b>		

ADDITIONAL QUANTITIES SHOWN ON NEXT PAGE









Addendum No. 01  
 ID 1204-05-72  
 Revised Sheet 89  
 March 25, 2019

**PWL MIXTURE USE TABLE**

THE FOLLOWING ACCEPTANCE CRITERIA ARE APPLICABLE FOR THIS PROJECT:

LOCATION	STATION	MIXTURE USE	UNDERLYING SURFACE	BID ITEMS	TONS	THICKNESS	QUALITY MANAGEMENT PROGRAM TO BE USED FOR:	
							MIXTURE ACCEPTANCE	DENSITY ACCEPTANCE
<b>STAGE 1</b>								
WB 4' OUTSIDE SHOULDER	909+59 WB TO 1630+54 WB	LOWER BINDER LAYER	MILLED EXISTING HMA SURFACE	4 MT 58-28 S	3,021	1 1/4"	PWL INCENTIVE AIR VOIDS HMA PAVEMENT 460.2010	ACCEPTANCE TESTING BY THE DEPARTMENT; NOT ELIGIBLE FOR INCENTIVE
<b>STAGE 2</b>								
WB 6' INSIDE SHOULDER	1481+95 WB TO 1493+63 WB	LOWER BINDER LAYER	BASE AGGREGATE	4 MT 58-28 S	111	3"	PWL INCENTIVE AIR VOIDS HMA PAVEMENT 460.2010	ACCEPTANCE TESTING BY THE DEPARTMENT; NOT ELIGIBLE FOR INCENTIVE
WB 12' INSIDE DRIVING LANE	909+59 WB TO 1630+54 WB	BINDER LAYER	EXISTING CONCRETE PAVEMENT	4 MT 58-28 S	11,001	2 1/2" TO 1 1/4"	PWL INCENTIVE AIR VOIDS HMA PAVEMENT 460.2010	INCENTIVE DENSITY PWL HMA PAVEMENT 460.2005
WB 3' INSIDE SHOULDER	909+59 WB TO 1481+95 WB	BINDER LAYER	MILLED EXISTING HMA SURFACE	4 MT 58-28 S	1,435	1 1/4" TO 1"	PWL INCENTIVE AIR VOIDS HMA PAVEMENT 460.2010	ACCEPTANCE TESTING BY THE DEPARTMENT; NOT ELIGIBLE FOR INCENTIVE
WB 6' INSIDE SHOULDER	1481+95 WB TO 1493+63 WB	UPPER BINDER LAYER	4 MT 58-28 S	4 MT 58-28 S	62	1 1/4"	PWL INCENTIVE AIR VOIDS HMA PAVEMENT 460.2010	ACCEPTANCE TESTING BY THE DEPARTMENT; NOT ELIGIBLE FOR INCENTIVE
WB 3' INSIDE SHOULDER	1493+63 WB TO 1630+54 WB	BINDER LAYER	MILLED EXISTING HMA SURFACE	4 MT 58-28 S	351	1 1/4" TO 1"	PWL INCENTIVE AIR VOIDS HMA PAVEMENT 460.2010	ACCEPTANCE TESTING BY THE DEPARTMENT; NOT ELIGIBLE FOR INCENTIVE
<b>STAGE 3</b>								
WB 12' OUTSIDE DRIVING LANE	909+59 WB TO 1630+54 WB	BINDER LAYER	EXISTING CONCRETE PAVEMENT	4 MT 58-28 S	11,038	2 1/2" TO 1 1/4"	PWL INCENTIVE AIR VOIDS HMA PAVEMENT 460.2010	INCENTIVE DENSITY PWL HMA PAVEMENT 460.2005
WB 8' OUTSIDE SHOULDER	909+59 WB TO 1630+54 WB	BINDER LAYER	EXISTING HMA SURFACE & 4 MT 58-28 S	4 MT 58-28 S	3,018	1 1/4" TO 0"	PWL INCENTIVE AIR VOIDS HMA PAVEMENT 460.2010	ACCEPTANCE TESTING BY THE DEPARTMENT; NOT ELIGIBLE FOR INCENTIVE
WB 12' OUTSIDE DRIVING LANE	909+59 WB TO 1630+54 WB	SURFACE LAYER	4 MT 58-28 S	4 MT 58-28 S	9,031	1 1/4"	PWL INCENTIVE AIR VOIDS HMA PAVEMENT 460.2010	INCENTIVE DENSITY PWL HMA PAVEMENT 460.2005
WB 8' OUTSIDE SHOULDER	909+59 WB TO 1630+54 WB	SURFACE LAYER	4 MT 58-28 S	4 MT 58-28 S	6,045	1 1/4"	PWL INCENTIVE AIR VOIDS HMA PAVEMENT 460.2010	ACCEPTANCE TESTING BY THE DEPARTMENT; NOT ELIGIBLE FOR INCENTIVE
WB OUTSIDE SIDEROADS & TURN LANES	909+59 WB TO 1630+54 WB	SURFACE LAYER	EXISTING AND MILLED EXISTING HMA SURFACE	4 MT 58-28 S	1,230	1 1/4"	PWL INCENTIVE AIR VOIDS HMA PAVEMENT 460.2010	ACCEPTANCE TESTING BY THE DEPARTMENT; NOT ELIGIBLE FOR INCENTIVE

ADDITIONAL QUANTITIES SHOWN ON NEXT PAGE

Addendum No. 01  
ID 1204-05-72  
Revised Sheet 90  
March 25, 2019

**PWL MIXTURE USE TABLE**

THE FOLLOWING ACCEPTANCE CRITERIA ARE APPLICABLE FOR THIS PROJECT:

STAGE 4													
WB 12' INSIDE DRIVING LANE	909+59 WB TO 1630+54 WB	SURFACE LAYER	4 MT 58-28 S	9,063	1 1/4"	PWL INCENTIVE AIR VOIDS HMA PAVEMENT 460.2010	INCENTIVE DENSITY PWL HMA PAVEMENT 460.2005	ACCEPTANCE TESTING BY THE DEPARTMENT; NOT ELIGIBLE FOR INCENTIVE					
WB 3' INSIDE SHOULDER	909+59 WB TO 1481+95 WB	SURFACE LAYER	4 MT 58-28 S	1,796	1 1/4"	PWL INCENTIVE AIR VOIDS HMA PAVEMENT 460.2010	INCENTIVE DENSITY PWL HMA PAVEMENT 460.2005	ACCEPTANCE TESTING BY THE DEPARTMENT; NOT ELIGIBLE FOR INCENTIVE					
WB 6' INSIDE SHOULDER	1481+95 WB TO 1493+63 WB	SURFACE LAYER	4 MT 58-28 S	63	1 1/4"	PWL INCENTIVE AIR VOIDS HMA PAVEMENT 460.2010	INCENTIVE DENSITY PWL HMA PAVEMENT 460.2005	ACCEPTANCE TESTING BY THE DEPARTMENT; NOT ELIGIBLE FOR INCENTIVE					
WB 3' INSIDE SHOULDER	1493+63 WB TO 1630+54 WB	SURFACE LAYER	4 MT 58-28 S	439	1 1/4"	PWL INCENTIVE AIR VOIDS HMA PAVEMENT 460.2010	INCENTIVE DENSITY PWL HMA PAVEMENT 460.2005	ACCEPTANCE TESTING BY THE DEPARTMENT; NOT ELIGIBLE FOR INCENTIVE					
WB INSIDE SIDEROADS & TURN LANES	909+59 WB TO 1630+54 WB	SURFACE LAYER	4 MT 58-28 S	409	1 1/4"	PWL INCENTIVE AIR VOIDS HMA PAVEMENT 460.2010	INCENTIVE DENSITY PWL HMA PAVEMENT 460.2005	ACCEPTANCE TESTING BY THE DEPARTMENT; NOT ELIGIBLE FOR INCENTIVE					
STAGE 6													
EB 8' OUTSIDE SHOULDER	909+59 EB TO 1017+61 EB	BINDER LAYER	4 MT 58-28 S	924	1 1/4"	PWL INCENTIVE AIR VOIDS HMA PAVEMENT 460.2010	INCENTIVE DENSITY PWL HMA PAVEMENT 460.2005	ACCEPTANCE TESTING BY THE DEPARTMENT; NOT ELIGIBLE FOR INCENTIVE					
EB 4' OUTSIDE SHOULDER	1017+61 EB TO 1027+93 EB	BINDER LAYER	4 MT 58-28 S	44	1 1/4"	PWL INCENTIVE AIR VOIDS HMA PAVEMENT 460.2010	INCENTIVE DENSITY PWL HMA PAVEMENT 460.2005	ACCEPTANCE TESTING BY THE DEPARTMENT; NOT ELIGIBLE FOR INCENTIVE					
EB 2' OUTSIDE SHOULDER	1027+93 EB TO 1630+60	BINDER LAYER	4 MT 58-28 S	1,256	1 1/4"	PWL INCENTIVE AIR VOIDS HMA PAVEMENT 460.2010	INCENTIVE DENSITY PWL HMA PAVEMENT 460.2005	ACCEPTANCE TESTING BY THE DEPARTMENT; NOT ELIGIBLE FOR INCENTIVE					
STAGE 7													
EB 12' INSIDE DRIVING LANE	1017+61 EB TO 1027+93 EB	BINDER LAYER	3 MT 58-28 S	161	2 1/2" TO 1 1/4"	PWL INCENTIVE AIR VOIDS HMA PAVEMENT 460.2009	INCENTIVE DENSITY PWL HMA PAVEMENT 460.2004	ACCEPTANCE TESTING BY THE DEPARTMENT; NOT ELIGIBLE FOR INCENTIVE					
EB 12' INSIDE DRIVING LANE	1027+93 EB TO 1630+60 EB	BINDER LAYER	4 MT 58-28 S	7,537	1 1/4"	PWL INCENTIVE AIR VOIDS HMA PAVEMENT 460.2010	INCENTIVE DENSITY PWL HMA PAVEMENT 460.2005	ACCEPTANCE TESTING BY THE DEPARTMENT; NOT ELIGIBLE FOR INCENTIVE					
EB 3' INSIDE SHOULDER	1017+61 EB TO 1630+60 EB	BINDER LAYER	4 MT 58-28 S	1,533	1 1/4"	PWL INCENTIVE AIR VOIDS HMA PAVEMENT 460.2010	INCENTIVE DENSITY PWL HMA PAVEMENT 460.2005	ACCEPTANCE TESTING BY THE DEPARTMENT; NOT ELIGIBLE FOR INCENTIVE					

ADDITIONAL QUANTITIES SHOWN ON NEXT PAGE

Addendum No. 01  
 ID 1204-05-72  
 Revised Sheet 91  
 March 25, 2019

**PWL MIXTURE USE TABLE**

THE FOLLOWING ACCEPTANCE CRITERIA ARE APPLICABLE FOR THIS PROJECT:

STAGE	DESCRIPTION	SECTION	SURFACE LAYER	BASE	THICKNESS	GRADING	TESTING	ACCEPTANCE	
STAGE 8	EB 12' OUTSIDE DRIVING LANE	909+59 EB TO 1017+61 EB	SURFACE LAYER	MILLED EXISTING HMA SURFACE	4 MT 58-28 S	1,386	1%"	PWL INCENTIVE AIR VOIDS HMA PAVEMENT 460.2010	
		1017+61 EB TO 1027+93 EB	BINDER LAYER	EXISTING CONCRETE PAVEMENT	3 MT 58-28 S	162	2 1/2" TO 1 1/4"	PWL INCENTIVE AIR VOIDS HMA PAVEMENT 460.2009	
	EB 12' OUTSIDE DRIVING LANE	1027+93 EB TO 1630+60 EB	BINDER LAYER	EXISTING CONCRETE PAVEMENT	4 MT 58-28 S	7,670	1%"	PWL INCENTIVE AIR VOIDS HMA PAVEMENT 460.2005	
		1017+61 EB TO 1630+60 EB	BINDER LAYER	EXISTING CONCRETE PAVEMENT, 4 MT 58-28 S & MILLED EXISTING HMA SURFACE	4 MT 58-28 S	2,512	1%" TO 0"	PWL INCENTIVE AIR VOIDS HMA PAVEMENT 460.2010	
	EB 8' OUTSIDE SHOULDER	1017+61 EB TO 1630+60 EB	SURFACE LAYER	4 MT 58-28 S	4 MT 58-28 S	7,668	1%"	PWL INCENTIVE AIR VOIDS HMA PAVEMENT 460.2010	
		1017+61 EB TO 1630+60 EB	SURFACE LAYER	4 MT 58-28 S	4 MT 58-28 S	5,024	1%"	PWL INCENTIVE AIR VOIDS HMA PAVEMENT 460.2010	
	EB OUTSIDE SIDEROADS & TURN LANES	909+59 EB TO 1630+60 EB	SURFACE LAYER	EXISTING AND MILLED EXISTING HMA SURFACE	4 MT 58-28 S	1,187	1%"	PWL INCENTIVE AIR VOIDS HMA PAVEMENT 460.2010	
		909+59 EB TO 1017+61 EB	SURFACE LAYER	MILLED EXISTING HMA SURFACE	4 MT 58-28 S	1,386	1%"	PWL INCENTIVE AIR VOIDS HMA PAVEMENT 460.2010	
	STAGE 9	EB 12' INSIDE DRIVING LANE	909+59 EB TO 1017+61 EB	SURFACE LAYER	MILLED EXISTING HMA SURFACE	4 MT 58-28 S	462	1%"	PWL INCENTIVE AIR VOIDS HMA PAVEMENT 460.2010
			1017+61 EB TO 1630+60 EB	SURFACE LAYER	4 MT 58-28 S	4 MT 58-28 S	7,669	1%"	PWL INCENTIVE AIR VOIDS HMA PAVEMENT 460.2010
EB 4' INSIDE SHOULDER		909+59 EB TO 1017+61 EB	SURFACE LAYER	MILLED EXISTING HMA SURFACE	4 MT 58-28 S	1,918	1%"	PWL INCENTIVE AIR VOIDS HMA PAVEMENT 460.2010	
		1017+61 EB TO 1630+60 EB	SURFACE LAYER	EXISTING HMA SURFACE	4 MT 58-28 S	760	1%"	PWL INCENTIVE AIR VOIDS HMA PAVEMENT 460.2010	
EB INSIDE SIDEROADS, TURN LANES & MAINT. CROSOVERS		909+59 EB TO 1630+60 EB	SURFACE LAYER	EXISTING HMA SURFACE	4 MT 58-28 S			PWL INCENTIVE AIR VOIDS HMA PAVEMENT 460.2010	



Proposal Schedule of Items

Proposal ID: 20190409003 Project(s): 1204-05-72

Federal ID(s): WISC 2019212

SECTION: 0001 Contract Items

Alt Set ID: Alt Mbr ID:

Proposal Line Number	Item ID Description	Approximate Quantity and Units	Unit Price	Bid Amount
0034	305.0500 Shaping Shoulders	3,000.000 STA	_____.	_____.
0036	390.0303 Base Patching Concrete	27,245.000 SY	_____.	_____.
0038	390.0403 Base Patching Concrete Shes	282.000 SY	_____.	_____.
0040	416.0610 Drilled Tie Bars	30,508.000 EACH	_____.	_____.
0042	416.0620 Drilled Dowel Bars	56,485.000 EACH	_____.	_____.
0044	450.4000 HMA Cold Weather Paving	11,361.000 TON	_____.	_____.
0046	455.0605 Tack Coat	79,809.000 GAL	_____.	_____.
0048	460.0105.S HMA Percent Within Limits (PWL) Test Strip Volumetrics	2.000 EACH	_____.	_____.
0050	460.0110.S HMA Percent Within Limits (PWL) Test Strip Density	5.000 EACH	_____.	_____.
0052	460.2005 Incentive Density PWL HMA Pavement	73,640.000 DOL	1.00000	73,640.00
0054	460.2007 Incentive Density HMA Pavement Longitudinal Joints	160,750.000 DOL	1.00000	160,750.00
0056	460.2010 Incentive Air Voids HMA Pavement	107,380.000 DOL	1.00000	107,380.00
0058	460.6224 HMA Pavement 4 MT 58-28 S	109,933.000 TON	_____.	_____.
0060	465.0120 Asphaltic Surface Driveways and Field Entrances	15.000 TON	_____.	_____.
0062	465.0305 Asphaltic Surface Safety Islands	12.000 TON	_____.	_____.
0064	465.0315 Asphaltic Flumes	281.000 SY	_____.	_____.