



Wisconsin Department of Transportation

Division of Transportation Systems Development

Bureau of Project Development
4822 Madison Yards Way, 4th Floor South
Madison, WI 53705

November 6, 2019

Telephone: (608) 266-1631
Facsimile (FAX): (608) 266-8459

NOTICE TO ALL CONTRACTORS:

Proposal #06: 5155-02-63, WISC 2019 675
Madison - Evansville
Byrne Road to Netherwood Road
USH 14
Dane County

5155-02-83, WISC 2019 676
Madison - Evansville
Mccoys Rd/Byrne Rd/STH 138 Bridges
USH 14
Dane County

Letting of November 12, 2019

This is Addendum No. 02, which provides for the following:

Plan Sheets:

Revised Plan Sheets	
Plan Sheet	Plan Sheet Title (brief description of changes to sheet)
71	Staging Typical Sections (Added milling, paving, and installing rumble strips)
72	Staging Typical Sections (Added milling, paving, and installing rumble strips)

Plan Sheets

The following 8½ x 11-inch sheets are attached and made part of the plans for this proposal:
Revised: 71 and 72.

The responsibility for notifying potential subcontractors and suppliers of these changes remains with the prime contractor.

Sincerely,

Mike Coleman

Proposal Development Specialist
Proposal Management Section

END OF ADDENDUM

Addendum No. 02
ID 5155-02-83
Revised Sheet 71
November 6, 2019

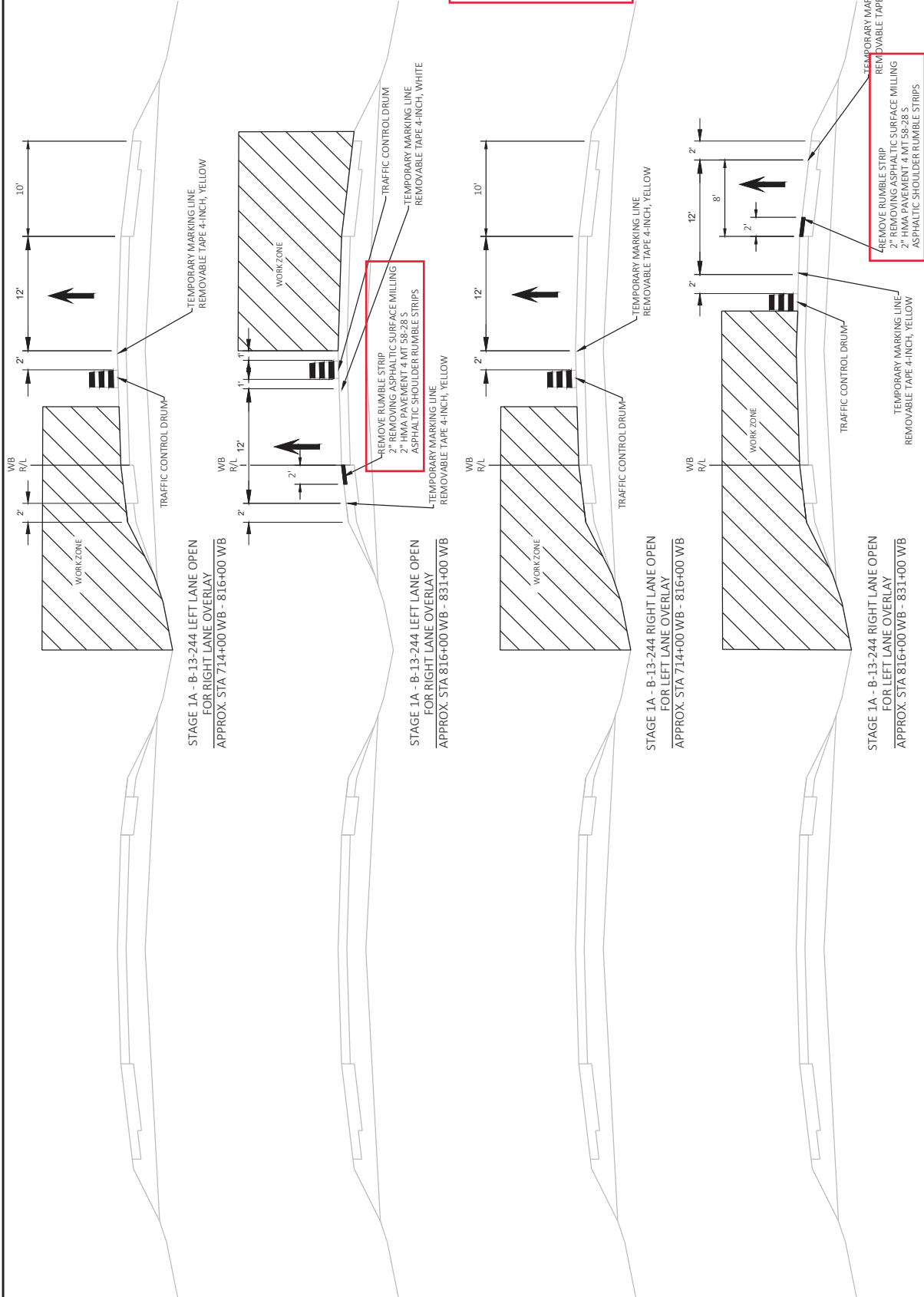

PROJECT NO: 5155-02-83	COUNTY: DANE	STAGING TYPICAL SECTIONS	SHEET 71	E
FILE NAME: N:\PDS\3D\5-1550003\SHEETS\PLAN\02\00_L15.DWG	HWY: USH 14	PLOT DATE: 11/6/2019 12:18 PM	PLOT NAME: BETZEL_LORRAINE_L	WISDOT/CADD/SHEET 42
		PLOT SCALE: 1 IN=10 FT		

Addendum No. 02
ID 5155-02-83
Revised Sheet 72
November 6, 2019

