



Wisconsin Department of Transportation

April 15, 2020

Division of Transportation Systems Development

Bureau of Project Development
4822 Madison Yards Way, 4th Floor South
Madison, WI 53705

Telephone: (608) 266-1631
Facsimile (FAX): (608) 266-8459

NOTICE TO ALL CONTRACTORS:

Proposal #07: 6075-00-74, WISC 2020 242
IH 39 - Arlington
Bullen Road to US 51
STH 60
Columbia County

Letting of May 12, 2020

This is Addendum No. 01, which provides for the following:

Schedule of Items:

Added Bid Item Quantities					
Bid Item	Item Description	Unit	Old Quantity	Revised Quantity	Proposal Total
634.0614	Posts Wood 4x6-Inch X 14-FT	EACH	0	18	18
634.0616	Posts Wood 4x6-Inch X 16-FT	EACH	0	16	16
634.0618	Posts Wood 4x6-Inch X 18-FT	EACH	0	2	2
634.0620	Posts Wood 4x6-Inch X 20-FT	EACH	0	2	2
637.2210	Signs Type II Reflective H	SF	0	232.8	232.8
637.2230	Signs Type II Reflective F	SF	0	23.2	23.2
638.2102	Moving Signs Type II	EACH	0	3	3
638.2602	Removing Signs Type II	EACH	0	32	32
638.3000	Removing Small Sign Supports	EACH	0	35	35

Plan Sheets:

Revised Plan Sheets	
Plan Sheet	Plan Sheet Title (brief description of changes to sheet)
38	Pavement Marking & Signing (added sign removals & replacements)
39	Pavement Marking & Signing (added sign removals & replacements)
40	Pavement Marking & Signing (added sign removals & replacements)

Added Plan Sheets	
Plan Sheet	Plan Sheet Title (brief description of changes to sheet)
68A	Miscellaneous Quantities (added signing table)
125A	Sign Plate

Schedule of Items

Attached, dated April 15, 2020, are the revised Schedule of Items Pages 1 – 8.

Plan Sheets

The following 8½ x 11-inch sheets are attached and made part of the plans for this proposal:

Revised: 38, 39, and 40.

Added: 68A & 125A.

The responsibility for notifying potential subcontractors and suppliers of these changes remains with the prime contractor.

Sincerely,

Mike Coleman

Proposal Development Specialist
 Proposal Management Section

END OF ADDENDUM

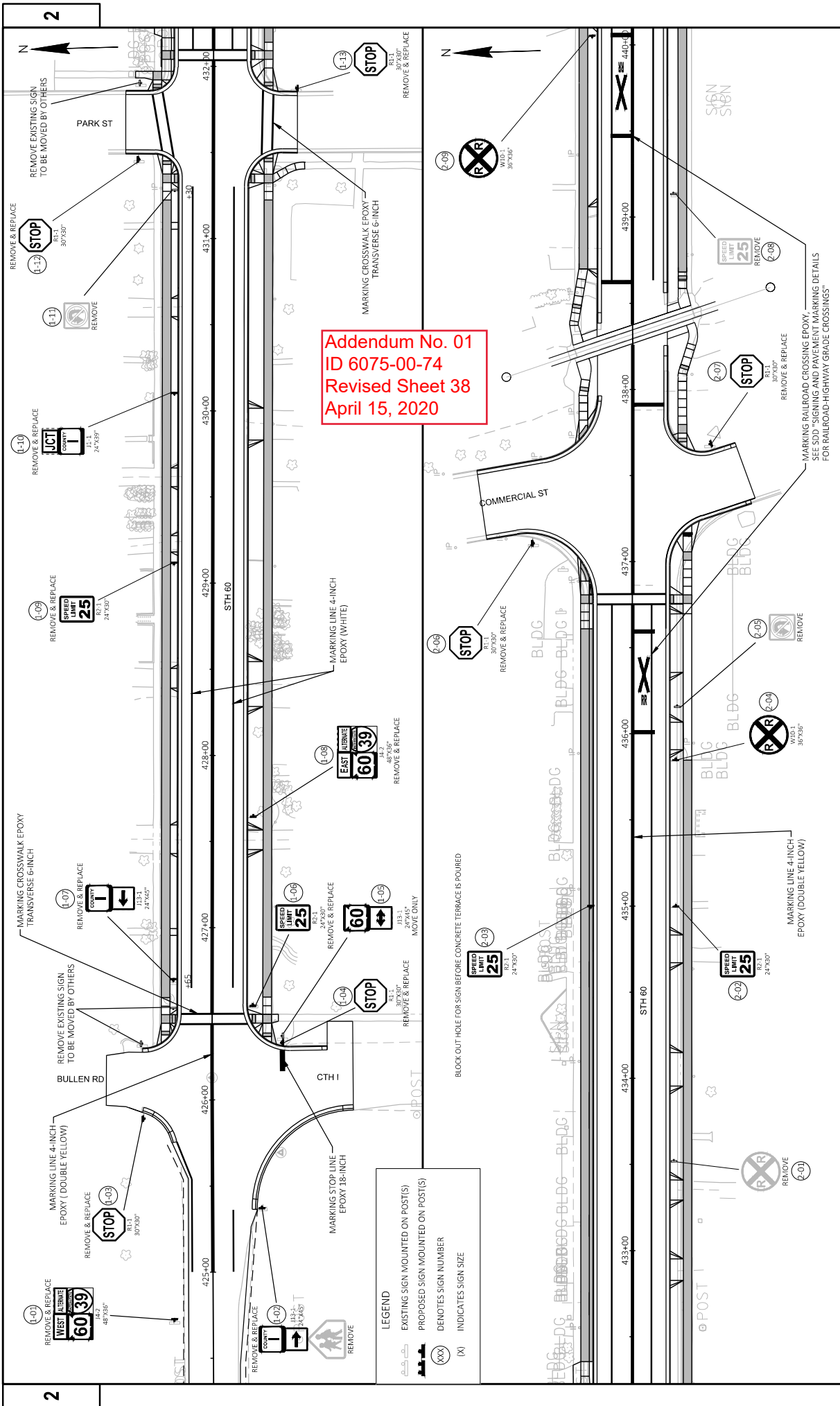

Addendum No. 01
 ID 6075-00-74
 Revised Sheet 38
 April 15, 2020

LEGEND

	EXISTING SIGN MOUNTED ON POST(S)
	PROPOSED SIGN MOUNTED ON POST(S)
	DENOTES SIGN NUMBER
	(X) INDICATES SIGN SIZE

PROJECT NO: 6075-00-74	COUNTY: COLUMBIA	PAVEMENT MARKING & SIGNING	SHEET 38
FILE NAME: C:\WISDOT\DESIGN\CD\60750004\SHEET\PLAN\AND\4501_PM.DWG	LAYOUT NAME: 024501-01	DATE: 4/20/2020 7:41 AM	SCALE: 1 IN=50 FT
HWY: STH 60		BY: BETZEL, LORRAINE L	
PROJECT NAME: WISDOT/CADDS SHEET 44		DATE: 4/20/2020 7:41 AM	

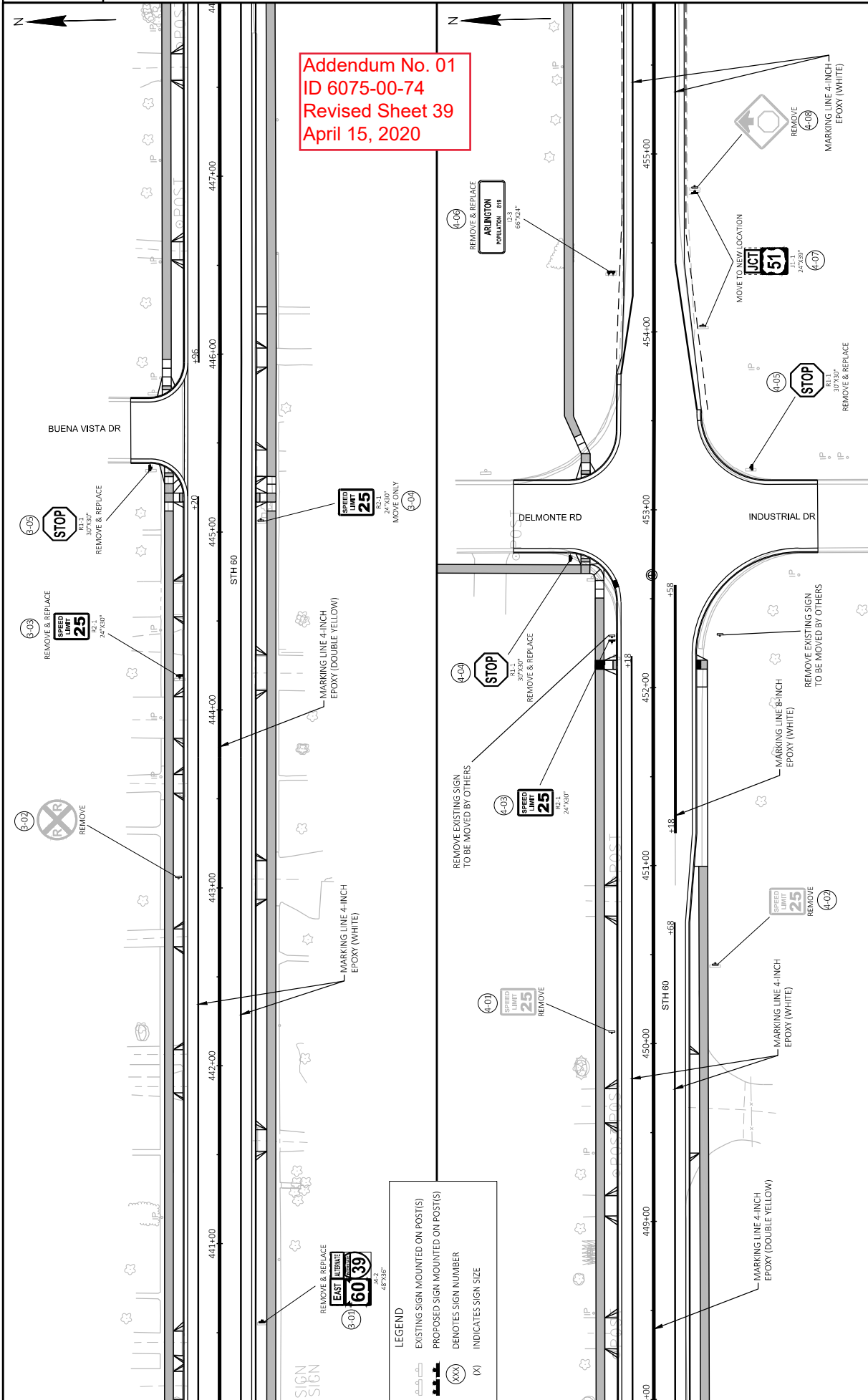

Addendum No. 01
 ID 6075-00-74
 Revised Sheet 39
 April 15, 2020

LEGEND

- EXISTING SIGN MOUNTED ON POST(S)
- PROPOSED SIGN MOUNTED ON POST(S)
- DENOTES SIGN NUMBER
- INDICATES SIGN SIZE

PROJECT NO: 6075-00-74	COUNTY: COLUMBIA	PAVEMENT MARKING & SIGNING	SHEET 39	E
FILE NAME: C:\WISDOT\DESIGN\CD\6075000A\SHEET\PLAN\AND\24501_P.M.DWG	PLLOT DATE: 4/20/2020 7:41 AM	PLLOT BY: BETZEL, LORRAINE L	PLLOT SCALE: 1 IN=50 FT	WISDOT/CADDS SHEET 44
HWY: STH 60				



REMOVE & REPLACE
SPEED LIMIT 25
R2.1
24°30'

REMOVE & REPLACE
WEST
SPEED LIMIT 60
R4.2
48°30'

REMOVE & REPLACE
PORTAGE
MADISON
COLUMBUS
R3.1
72°30'

REMOVE & REPLACE AT NEW LOCATION
NORTH SOUTH EAST WEST
SPEED LIMIT 51 60 39
R2.1
24°30'

REMOVE & REPLACE
SPEED LIMIT 25
R2.1
24°30'

REMOVE & REPLACE
WEST
SPEED LIMIT 60
R4.2
48°30'

REMOVE & REPLACE
SPEED LIMIT 25
R2.1
24°30'

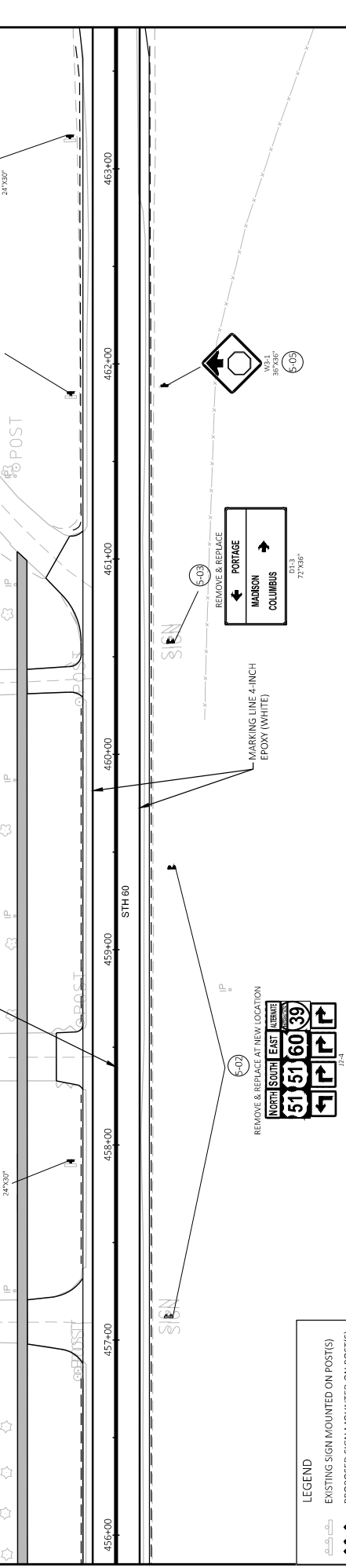

REMOVE & REPLACE
PORTAGE
MADISON
COLUMBUS
R3.1
72°30'

REMOVE & REPLACE AT NEW LOCATION
NORTH SOUTH EAST WEST
SPEED LIMIT 51 60 39
R2.1
24°30'

REMOVE & REPLACE
WEST
SPEED LIMIT 60
R4.2
48°30'

REMOVE & REPLACE
SPEED LIMIT 25
R2.1
24°30'

LEGEND

- EXISTING SIGN MOUNTED ON POST(S)
- PROPOSED SIGN MOUNTED ON POST(S)
- DENOTES SIGN NUMBER
- INDICATES SIGN SIZE

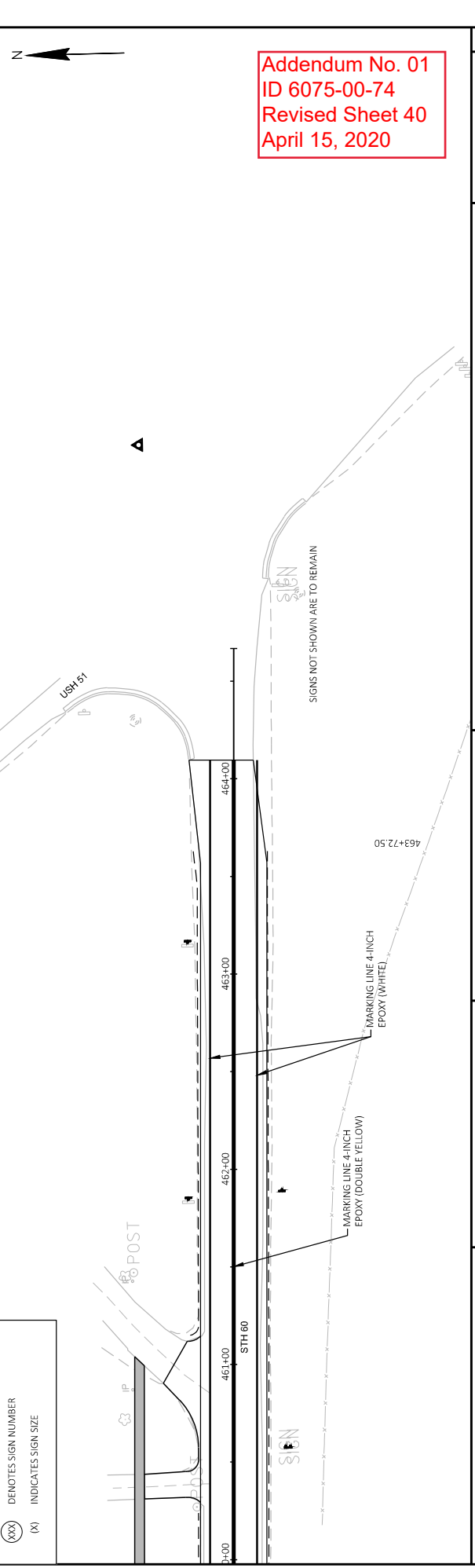

REMOVE & REPLACE
PORTAGE
MADISON
COLUMBUS
R3.1
72°30'

REMOVE & REPLACE AT NEW LOCATION
NORTH SOUTH EAST WEST
SPEED LIMIT 51 60 39
R2.1
24°30'

REMOVE & REPLACE
WEST
SPEED LIMIT 60
R4.2
48°30'

REMOVE & REPLACE
SPEED LIMIT 25
R2.1
24°30'

Addendum No. 01
ID 6075-00-74
Revised Sheet 40
April 15, 2020

PROJECT NO: 6075-00-74	COUNTY: COLUMBIA	SHEET: 40	E
FILE NAME: C:\WISDOT\DESIGN\CD\6075000A\SHEET\SPANDS4501_PM.DWG	LAYOUT NAME: 024501-01	PLOT DATE: 4/30/2020 7:41 AM	PLOT NAME: BETZEL, LORRAINE L
HWY: STH 60		PAVEMENT MARKING & SIGNING	
LAYOUT NAME: 024501-01		PLOT SCALE: 1 IN=50 FT	

SIGNING

CATEGORY	SIGN NO.	STATION	LOCATION	SIGN CODE	SIZE (IN)	634.0614 POSTS WOOD 4X6-INCH X 14-FT EACH	634.0616 POSTS WOOD 4X6-INCH X 16-FT EACH	634.0618 POSTS WOOD 4X6-INCH X 18-FT EACH	634.0620 POSTS WOOD 4X6-INCH X 20-FT EACH	637.2210 SIGNS TYPE II REFLECTIVE H SF	637.2230 SIGNS TYPE II REFLECTIVE F SF	638.2102 MOVING SIGNS TYPE II EACH	638.2602 REMOVING SIGNS TYPE II EACH	638.3000 REMOVING SMALL SIGN SUPPORTS EACH	SIGN MESSAGE
0010	1-01	424+72	LT	J4-2	48 X 36	-	1	-	-	12.0	-	-	1	1	WEST STH 60 / ALTERNATE IH 39
0010	1-02	425+37	RT	J13-1	24 X 45	-	1	-	-	7.5	-	-	1	1	CTH RIGHT ARROW
0010	1-03	425+89	RT	R1-1	30 X 30	1	-	-	-	6.3	-	-	1	1	STOP
0010	1-04	426+33	RT	R1-1	30 X 30	1	-	-	-	6.3	-	-	1	1	STOP
0010	1-05	426+37	RT	J13-1	24 X 45	-	1	-	-	-	-	1	-	-	STH 60 LEFT / RIGHT ARROW
0010	1-06	426+55	RT	R2-1	24 X 30	-	-	-	-	5.0	-	-	1	1	SPEED LIMIT 25 MPH
0010	1-07	426+70	LT	J13-1	24 X 45	-	1	-	-	7.5	-	-	1	1	CTH LEFT ARROW
0010	1-08	427+65	RT	J4-2	48 X 36	-	1	-	-	12.0	-	-	1	1	EAST STH 60 / ALTERNATE IH 39
0010	1-09	429+11	LT	R2-1	24 X 30	1	-	-	-	5.0	-	-	1	1	SPEED LIMIT 25 MPH
0010	1-10	430+10	LT	J1-1	24 X 39	-	1	-	-	6.5	-	-	1	1	JCT CTH
0010	1-11	431+28	LT	-	-	-	-	-	-	-	-	-	1	1	NO TURN
0010	1-12	431+46	LT	R1-1	30 X 30	1	-	-	-	6.3	-	-	1	1	STOP
0010	1-13	431+87	RT	R1-1	30 X 30	1	-	-	-	6.3	-	-	1	1	STOP
0010	2-01	433+52	RT	-	-	-	-	-	-	-	-	-	1	1	RAILROAD CROSSING
0010	2-02	435+00	RT	R2-1	24 X 30	1	-	-	-	5.0	-	-	-	-	SPEED LIMIT 25 MPH
0010	2-03	435+00	LT	R2-1	24 X 30	1	-	-	-	5.0	-	-	-	-	SPEED LIMIT 25 MPH
0010	2-04	435+85	RT	W10-1	36 X 36	-	1	-	-	-	7.1	-	-	-	RAILROAD CROSSING
0010	2-05	436+16	RT	-	-	-	-	-	-	-	-	-	1	1	NO TURN
0010	2-06	437+11	LT	R1-1	30 X 30	1	-	-	-	6.3	-	-	1	1	STOP
0010	2-07	437+68	RT	R1-1	30 X 30	1	-	-	-	6.3	-	-	1	1	STOP
0010	2-08	439+14	RT	-	-	-	-	-	-	-	-	-	1	1	SPEED LIMIT 25 MPH
0010	2-09	440+05	LT	W10-1	36 X 36	-	1	-	-	-	7.1	-	-	-	RAILROAD CROSSING
0010	3-01	440+56	RT	J4-2	48 X 36	-	1	-	-	12.0	-	-	1	1	EAST STH 60 / ALTERNATE IH 39
0010	3-02	443+06	LT	-	-	-	-	-	-	-	-	-	1	1	RAILROAD CROSSING
0010	3-03	444+19	LT	R2-1	24 X 30	1	-	-	-	5.0	-	-	1	1	SPEED LIMIT 25 MPH
0010	3-04	445+07	RT	R2-1	24 X 30	1	-	-	-	-	-	1	-	-	SPEED LIMIT 25 MPH
0010	3-05	445+36	LT	R1-1	30 X 30	1	-	-	-	6.3	-	-	1	1	STOP
0010	4-01	450+06	LT	-	-	-	-	-	-	-	-	-	1	1	SPEED LIMIT 25 MPH
0010	4-02	450+45	RT	-	-	-	-	-	-	-	-	-	1	1	SPEED LIMIT 25 MPH
0010	4-03	452+26	LT	R2-1	24 X 30	1	-	-	-	5.0	-	-	-	-	SPEED LIMIT 25 MPH
0010	4-04	452+72	LT	R1-1	30 X 30	1	-	-	-	6.3	-	-	1	1	STOP
0010	4-05	453+24	RT	R1-1	30 X 30	1	-	-	-	6.3	-	-	1	1	STOP
0010	4-06	454+33	LT	I2-3	66 X 24	-	2	-	-	11.0	-	-	1	1	ARLINGTON POPULATION
0010	4-07	454+78	RT	J1-1	24 X 39	-	1	-	-	-	-	1	-	-	JCT USH 51
0010	4-08	454+82	RT	-	-	-	-	-	-	-	-	-	1	1	STOP AHEAD
0010	5-01	457+92	LT	R2-1	24 X 30	-	1	-	-	5.0	-	-	1	1	SPEED LIMIT 25 MPH
0010	5-02	459+42	RT	J2-4	96 X 57	-	1	-	2	38.0	-	-	1	1	NORTH USH 51 / SOUTH USH 51 / EAST STH 60 / ALTERNATE IH 39
0010	5-03	460+58	RT	D1-3	72 X 36	-	1	-	-	18.0	-	-	1	1	PORTAGE / MADISON
0010	5-04	461+85	LT	J4-2	48 X 36	-	1	-	-	12.0	-	-	1	1	WEST STH 60 / ALTERNATE IH 39
0010	5-05	461+89	RT	W3-1	36 X 36	-	1	-	-	-	9	-	-	-	STOP AHEAD
0010	5-06	463+17	LT	R2-1	24 X 30	-	1	-	-	5.0	-	-	1	1	SPEED LIMIT 25 MPH
TOTAL 0010															
						18	16	2	2	232.8	23.2	3	32	35	

Addendum No. 01
 ID 6075-00-74
 Added Sheet 68A
 April 15, 2020

NOTES

1. All Signs Type II - Type H Reflective
2. Color:
Background - Green
Message - White
3. Message Series - E except as noted.

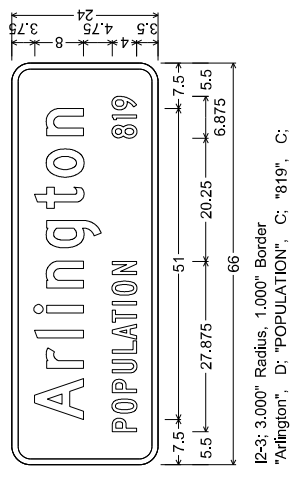
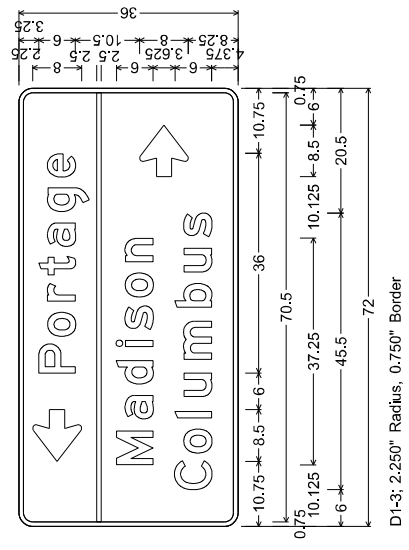

Addendum No. 01
ID 6075-00-74
Added Sheet 125A
April 15, 2020



Proposal Schedule of Items

Proposal ID: 20200512007 Project(s): 6075-00-74

Federal ID(s): WISC 2020242

SECTION: 0001

Contract Items

Alt Set ID:

Alt Mbr ID:

Proposal Line Number	Item ID Description	Approximate Quantity and Units	Unit Price	Bid Amount
0002	203.0100 Removing Small Pipe Culverts	3.000 EACH	_____.	_____.
0004	204.0100 Removing Pavement	320.000 SY	_____.	_____.
0006	204.0110 Removing Asphaltic Surface	941.000 SY	_____.	_____.
0008	204.0120 Removing Asphaltic Surface Milling	3,450.000 SY	_____.	_____.
0010	204.0150 Removing Curb & Gutter	5,188.000 LF	_____.	_____.
0012	204.0155 Removing Concrete Sidewalk	185.000 SY	_____.	_____.
0014	204.0210 Removing Manholes	3.000 EACH	_____.	_____.
0016	204.0220 Removing Inlets	13.000 EACH	_____.	_____.
0018	204.0245 Removing Storm Sewer (size) 01. 12-Inch	345.000 LF	_____.	_____.
0020	204.0245 Removing Storm Sewer (size) 02. 18-Inch	85.000 LF	_____.	_____.
0022	204.0245 Removing Storm Sewer (size) 03. 24-Inch	725.000 LF	_____.	_____.
0024	204.0245 Removing Storm Sewer (size) 04. 30-Inch	65.000 LF	_____.	_____.
0026	205.0100 Excavation Common	13,937.000 CY	_____.	_____.
0028	211.0400 Prepare Foundation for Asphaltic Shoulders	19.000 STA	_____.	_____.
0030	213.0100 Finishing Roadway (project) 01. 6075-00-74	1.000 EACH	_____.	_____.



Proposal Schedule of Items

Proposal ID: 20200512007 Project(s): 6075-00-74

Federal ID(s): WISC 2020242

SECTION: 0001

Contract Items

Alt Set ID:

Alt Mbr ID:

Proposal Line Number	Item ID Description	Approximate Quantity and Units	Unit Price	Bid Amount
0032	305.0110 Base Aggregate Dense 3/4-Inch	80.000 TON	_____.	_____.
0034	305.0120 Base Aggregate Dense 1 1/4-Inch	12,395.000 TON	_____.	_____.
0036	305.0130 Base Aggregate Dense 3-Inch	10,210.000 TON	_____.	_____.
0038	416.0160 Concrete Driveway 6-Inch	551.000 SY	_____.	_____.
0040	455.0605 Tack Coat	1,880.000 GAL	_____.	_____.
0042	460.2000 Incentive Density HMA Pavement	3,260.000 DOL	1.00000	3,260.00
0044	460.6224 HMA Pavement 4 MT 58-28 S	5,081.000 TON	_____.	_____.
0046	465.0105 Asphaltic Surface	51.800 TON	_____.	_____.
0048	465.0120 Asphaltic Surface Driveways and Field Entrances	38.600 TON	_____.	_____.
0050	504.0100 Concrete Masonry Culverts	0.200 CY	_____.	_____.
0052	511.1100 Temporary Shoring	520.000 SF	_____.	_____.
0054	520.1012 Apron Endwalls for Culvert Pipe 12-Inch	1.000 EACH	_____.	_____.
0056	520.1024 Apron Endwalls for Culvert Pipe 24-Inch	1.000 EACH	_____.	_____.
0058	520.8000 Concrete Collars for Pipe	3.000 EACH	_____.	_____.
0060	522.2419 Culvert Pipe Reinforced Concrete Horizontal Elliptical Class HE-IV 19x30-Inch	112.000 LF	_____.	_____.



Proposal Schedule of Items

Proposal ID: 20200512007 Project(s): 6075-00-74

Federal ID(s): WISC 2020242

SECTION: 0001

Contract Items

Alt Set ID:

Alt Mbr ID:

Proposal Line Number	Item ID Description	Approximate Quantity and Units	Unit Price	Bid Amount
0062	522.2619 Apron Endwalls for Culvert Pipe Reinforced Concrete Horizontal Elliptical 19x30-Inch	5.000 EACH	_____.	_____.
0064	601.0205 Concrete Gutter 24-Inch	75.000 LF	_____.	_____.
0066	601.0411 Concrete Curb & Gutter 30-Inch Type D	5,791.000 LF	_____.	_____.
0068	601.0600 Concrete Curb Pedestrian	36.000 LF	_____.	_____.
0070	602.0405 Concrete Sidewalk 4-Inch	6,265.000 SF	_____.	_____.
0072	602.0505 Curb Ramp Detectable Warning Field Yellow	280.000 SF	_____.	_____.
0074	602.0605 Curb Ramp Detectable Warning Field Radial Yellow	37.000 SF	_____.	_____.
0076	608.0312 Storm Sewer Pipe Reinforced Concrete Class III 12-Inch	5.000 LF	_____.	_____.
0078	608.0324 Storm Sewer Pipe Reinforced Concrete Class III 24-Inch	8.000 LF	_____.	_____.
0080	608.0412 Storm Sewer Pipe Reinforced Concrete Class IV 12-Inch	546.000 LF	_____.	_____.
0082	608.0424 Storm Sewer Pipe Reinforced Concrete Class IV 24-Inch	8.000 LF	_____.	_____.
0084	608.0524 Storm Sewer Pipe Reinforced Concrete Class V 24-Inch	72.000 LF	_____.	_____.
0086	608.2414 Storm Sewer Pipe Reinforced Concrete Horizontal Elliptical Class HE-IV 14x23-Inch	581.000 LF	_____.	_____.



Proposal Schedule of Items

Proposal ID: 20200512007 Project(s): 6075-00-74

Federal ID(s): WISC 2020242

SECTION: 0001

Contract Items

Alt Set ID:

Alt Mbr ID:

Proposal Line Number	Item ID Description	Approximate Quantity and Units	Unit Price	Bid Amount
0088	608.2419 Storm Sewer Pipe Reinforced Concrete Horizontal Elliptical Class HE-IV 19x30-Inch	562.000 LF	_____.	_____.
0090	611.0530 Manhole Covers Type J	4.000 EACH	_____.	_____.
0092	611.0545 Manhole Covers Type L	1.000 EACH	_____.	_____.
0094	611.0624 Inlet Covers Type H	11.000 EACH	_____.	_____.
0096	611.0639 Inlet Covers Type H-S	14.000 EACH	_____.	_____.
0098	611.2005 Manholes 5-FT Diameter	3.000 EACH	_____.	_____.
0100	611.2006 Manholes 6-FT Diameter	3.000 EACH	_____.	_____.
0102	611.3004 Inlets 4-FT Diameter	7.000 EACH	_____.	_____.
0104	611.3230 Inlets 2x3-FT	17.000 EACH	_____.	_____.
0106	611.8110 Adjusting Manhole Covers	14.000 EACH	_____.	_____.
0108	618.0100 Maintenance And Repair of Haul Roads (project) 01. 6075-00-74	1.000 EACH	_____.	_____.
0110	619.1000 Mobilization	1.000 EACH	_____.	_____.
0112	624.0100 Water	230.000 MGAL	_____.	_____.
0114	625.0100 Topsoil	3,350.000 SY	_____.	_____.
0116	627.0200 Mulching	3,350.000 SY	_____.	_____.
0118	628.1905 Mobilizations Erosion Control	4.000 EACH	_____.	_____.



Proposal Schedule of Items

Proposal ID: 20200512007 Project(s): 6075-00-74

Federal ID(s): WISC 2020242

SECTION: 0001

Contract Items

Alt Set ID:

Alt Mbr ID:

Proposal Line Number	Item ID Description	Approximate Quantity and Units	Unit Price	Bid Amount
0120	628.1910 Mobilizations Emergency Erosion Control	4.000 EACH	_____.	_____.
0122	628.7015 Inlet Protection Type C	25.000 EACH	_____.	_____.
0124	628.7504 Temporary Ditch Checks	60.000 LF	_____.	_____.
0126	628.7555 Culvert Pipe Checks	2.000 EACH	_____.	_____.
0128	629.0210 Fertilizer Type B	2.000 CWT	_____.	_____.
0130	630.0130 Seeding Mixture No. 30	63.000 LB	_____.	_____.
0132	630.0200 Seeding Temporary	57.000 LB	_____.	_____.
0134	630.0500 Seed Water	75.000 MGAL	_____.	_____.
0136	633.5200 Markers Culvert End	6.000 EACH	_____.	_____.
0138	642.5001 Field Office Type B	1.000 EACH	_____.	_____.
0140	643.0300 Traffic Control Drums	70.000 DAY	_____.	_____.
0142	643.0410 Traffic Control Barricades Type II	1,257.000 DAY	_____.	_____.
0144	643.0420 Traffic Control Barricades Type III	5,153.000 DAY	_____.	_____.
0146	643.0705 Traffic Control Warning Lights Type A	10,037.000 DAY	_____.	_____.
0148	643.0900 Traffic Control Signs	31,734.000 DAY	_____.	_____.
0150	643.0910 Traffic Control Covering Signs Type I	4.000 EACH	_____.	_____.
0152	643.0920 Traffic Control Covering Signs Type II	23.000 EACH	_____.	_____.



Proposal Schedule of Items

Proposal ID: 20200512007 Project(s): 6075-00-74

Federal ID(s): WISC 2020242

SECTION: 0001

Contract Items

Alt Set ID:

Alt Mbr ID:

Proposal Line Number	Item ID Description	Approximate Quantity and Units	Unit Price	Bid Amount
0154	643.1050 Traffic Control Signs PCMS	14.000 DAY	_____.	_____.
0156	643.5000 Traffic Control	1.000 EACH	_____.	_____.
0158	644.1420 Temporary Pedestrian Surface Plywood	4,020.000 SF	_____.	_____.
0160	644.1601 Temporary Pedestrian Curb Ramp	622.000 DAY	_____.	_____.
0162	644.1810 Temporary Pedestrian Barricade	120.000 LF	_____.	_____.
0164	645.0220 Geogrid Type SR	16,950.000 SY	_____.	_____.
0166	646.1020 Marking Line Epoxy 4-Inch	14,320.000 LF	_____.	_____.
0168	646.3020 Marking Line Epoxy 8-Inch	140.000 LF	_____.	_____.
0170	646.5320 Marking Railroad Crossings Epoxy	2.000 EACH	_____.	_____.
0172	646.6120 Marking Stop Line Epoxy 18-Inch	13.000 LF	_____.	_____.
0174	646.7420 Marking Crosswalk Epoxy Transverse Line 6-Inch	380.000 LF	_____.	_____.
0176	649.0150 Temporary Marking Line Removable Tape 4-Inch	64.000 LF	_____.	_____.
0178	650.4000 Construction Staking Storm Sewer	32.000 EACH	_____.	_____.
0180	650.4500 Construction Staking Subgrade	2,841.000 LF	_____.	_____.
0182	650.5000 Construction Staking Base	2,841.000 LF	_____.	_____.
0184	650.5500 Construction Staking Curb Gutter and Curb & Gutter	5,866.000 LF	_____.	_____.



Proposal Schedule of Items

Proposal ID: 20200512007 Project(s): 6075-00-74

Federal ID(s): WISC 2020242

SECTION: 0001

Contract Items

Alt Set ID:

Alt Mbr ID:

Proposal Line Number	Item ID Description	Approximate Quantity and Units	Unit Price	Bid Amount
0186	650.6000 Construction Staking Pipe Culverts	2.000 EACH	_____	_____
0188	650.8000 Construction Staking Resurfacing Reference	1,034.000 LF	_____	_____
0190	650.9000 Construction Staking Curb Ramps	26.000 EACH	_____	_____
0192	650.9910 Construction Staking Supplemental Control (project) 01. 6075-00-74	LS	LUMP SUM	_____
0194	650.9920 Construction Staking Slope Stakes	110.000 LF	_____	_____
0196	690.0150 Sawing Asphalt	830.000 LF	_____	_____
0198	690.0250 Sawing Concrete	61.000 LF	_____	_____
0200	740.0440 Incentive IRI Ride	2,935.606 DOL	1.00000	2,935.61
0202	SPV.0060 Special 01. Adjusting Water Valve Boxes	26.000 EACH	_____	_____
0204	634.0614 Posts Wood 4x6-Inch X 14-FT	18.000 EACH	_____	_____
0206	634.0616 Posts Wood 4x6-Inch X 16-FT	16.000 EACH	_____	_____
0208	634.0618 Posts Wood 4x6-Inch X 18-FT	2.000 EACH	_____	_____
0210	634.0620 Posts Wood 4x6-Inch X 20-FT	2.000 EACH	_____	_____
0212	637.2210 Signs Type II Reflective H	232.800 SF	_____	_____
0214	637.2230 Signs Type II Reflective F	23.200 SF	_____	_____
0216	638.2102 Moving Signs Type II	3.000 EACH	_____	_____



Proposal Schedule of Items

Proposal ID: 20200512007 Project(s): 6075-00-74

Federal ID(s): WISC 2020242

SECTION: 0001

Contract Items

Alt Set ID:

Alt Mbr ID:

Proposal Line Number	Item ID Description	Approximate Quantity and Units	Unit Price	Bid Amount
0218	638.2602 Removing Signs Type II	32.000 EACH	_____.	_____.
0220	638.3000 Removing Small Sign Supports	35.000 EACH	_____.	_____.
Section: 0001			Total:	_____.
			Total Bid:	_____.

