



Wisconsin Department of Transportation

Division of Transportation Systems Development

Bureau of Project Development
4822 Madison Yards Way, 4th Floor South
Madison, WI 53705

November 5, 2020

Telephone: (608) 266-1631
Facsimile (FAX): (608) 266-8459

NOTICE TO ALL CONTRACTORS:

Proposal #21: 4150-25-60, WISC 2020 542
Mid Junction – Baileys Harbor
STH 42 – Summit Road
STH 57
Door County

Letting of November 10, 2020

This is Addendum No. 02, which provides for the following:

Schedule of Items:

Revised Bid Item Quantities					
Bid Item	Item Description	Unit	Old Quantity	Revised Quantity	Proposal Total
305.0110	Base Aggregate Dense ¾-Inch	Ton	15,540	72	15,612

Deleted Bid Item Quantities					
Bid Item	Item Description	Unit	Old Quantity	Revised Quantity	Proposal Total
305.0120	Base Aggregate Dense 1 1/4-Inch	Ton	72	-72	0

Plan Sheets:

Revised Plan Sheets	
Plan Sheet	Plan Sheet Title (brief description of changes to sheet)
10	Construction Detail (The Base Aggregate material called out on the driveway details has been changed from 1 ¼" to ¾".)
18	Construction Detail (The dimension for the width of the ground-in sinusoidal rumble strip was changed from 14" to 8" in the cross-sectional view and in the General Notes.)
19	Construction Detail (The dimension for the width of the ground-in sinusoidal rumble strip was added in the cross-sectional view.)
61	Miscellaneous Quantities (The 72 Ton of Base Aggregate Dense 1 ¼-Inch that was called out for PE and CE locations was deleted and then added to the Base Aggregate Dense ¾-Inch bid item quantity.)

Schedule of Items

Attached, dated November 4, 2020, are the revised Schedule of Items Pages 1-4.

Plan Sheets

The following 8½ x 11-inch sheets are attached and made part of the plans for this proposal:

Revised: 10, 18, 19, and 61.

The responsibility for notifying potential subcontractors and suppliers of these changes remains with the prime contractor.

Sincerely,

Mike Coleman

Proposal Development Specialist
Proposal Management Section

END OF ADDENDUM

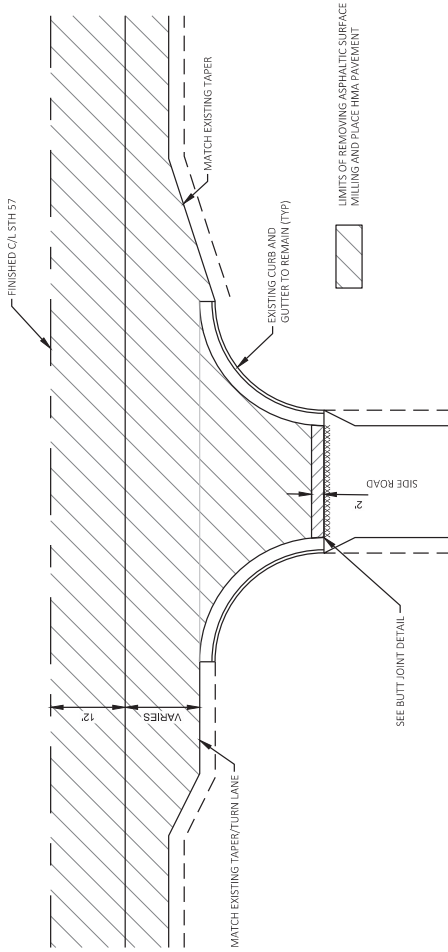

TYPICAL SIDE ROAD DETAIL WITH CURB & GUTTER

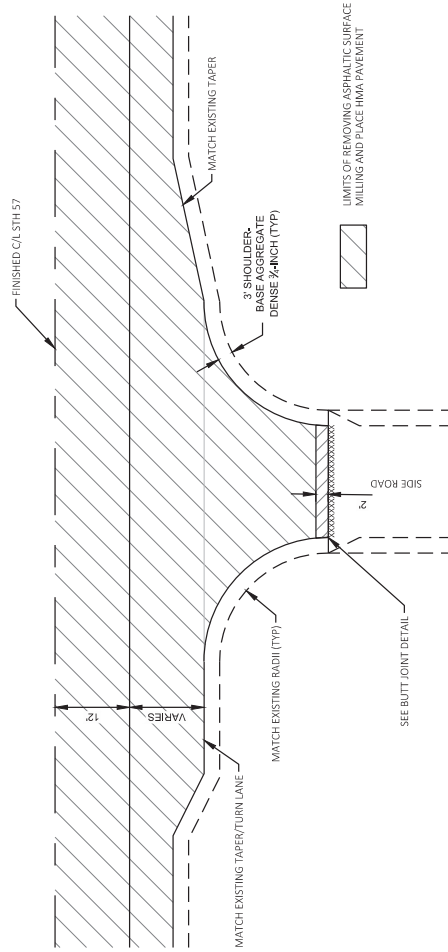

TYPICAL SIDE ROAD DETAIL WITHOUT CURB & GUTTER

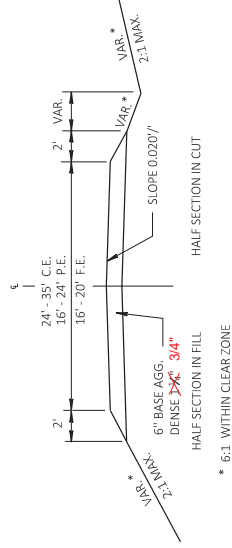

TYPICAL SECTION FOR PRIVATE ENTRANCES

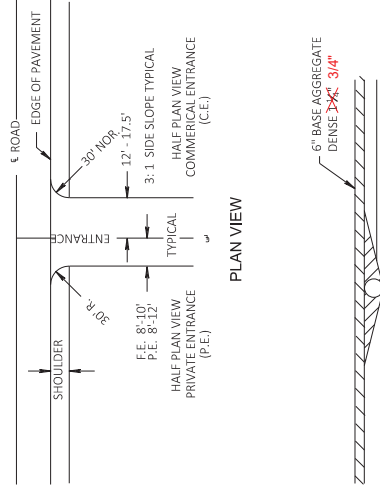

RURAL DRIVEWAY DETAIL

Addendum No. 02
 ID 4150-25-60
 Revised Sheet 10
 November 5, 2020

GENERAL NOTES

DETAILS OF CONSTRUCTION SHOWN ON THIS DRAWING SHALL CONFORM TO THE PERTINENT REQUIREMENTS OF THE STANDARD SPECIFICATIONS AND APPLICABLE SPECIAL PROVISIONS. DO NOT MILL CENTER LINE GROOVES THROUGH ANY INTERSECTION, MARKED CROSSWALK, NON-MOTORIZED PATH CROSSING, OR SNOWMOBILE CROSSING. INSTALL PAVEMENT MARKING AFTER THE GROOVES ARE INSTALLED.

SEE SIGNING PLAN FOR SIGN REQUIREMENTS THAT MAY BE NEEDED.

- ① THE WIDTH OF THE GROOVE WILL BE 14 INCHES - 8 INCHES
- ② CENTERLINE GROOVES MAY BE OMITTED IN AREAS WITH HIGH CONCENTRATIONS OF DRIVEWAYS, WHEN DIRECTED BY THE ENGINEER.

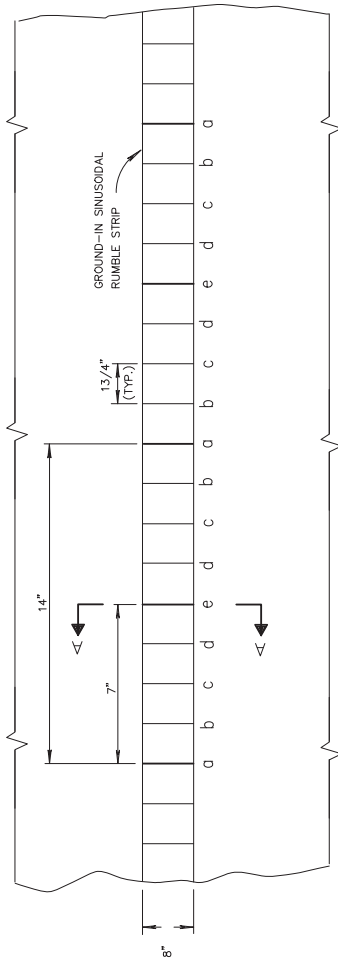

PLAN VIEW
CENTER LINE WITH GROUND-IN SINUSOIDAL RUMBLE STRIP

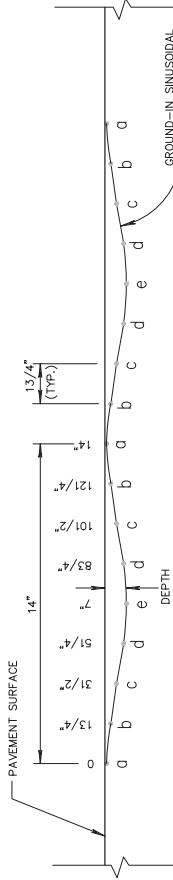

PROFILE VIEW
GROUND-IN SINUSOIDAL RUMBLE STRIP

LOCATION	DEPTH INCHES
a	1/16"
b	5/32"
c	9/32"
d	7/16"
e	1/2"

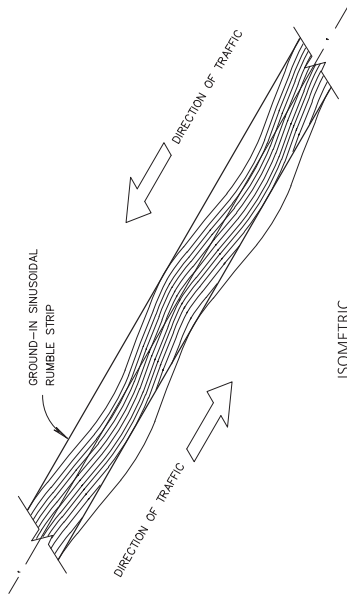

ISOMETRIC

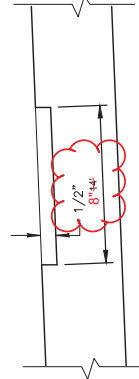

SECTION A-A
SUPERELEVATED ROADWAY

Addendum No. 02
ID 4150-25-60
Revised Sheet 18
November 5, 2020

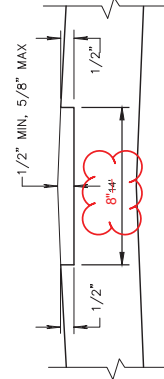

SECTION A-A
CROWNED ROADWAY

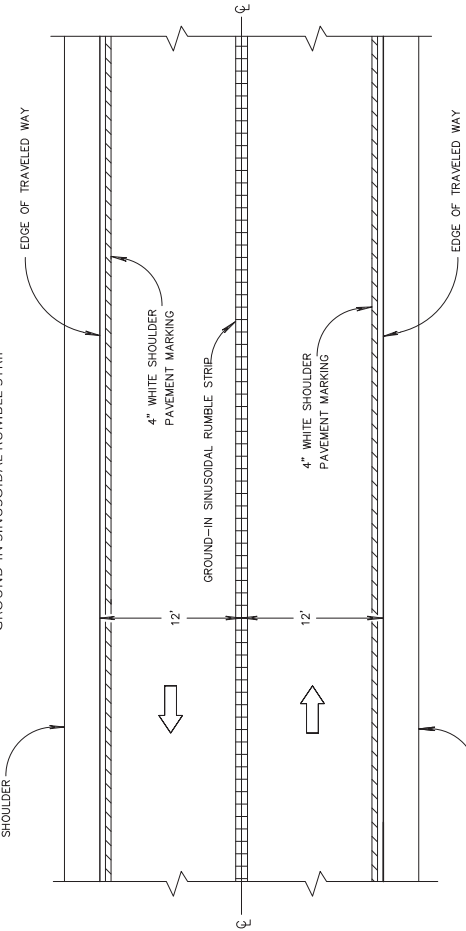

CENTER LINE SINUSOIDAL GROOVES ON TWO-WAY ROADWAYS
ASPHALTIC CENTERLINE RUMBLE STRIPS, SINUSOIDAL, 2-LANE RURAL

GENERAL NOTES

DETAILS OF CONSTRUCTION SHOWN ON THIS DRAWING SHALL CONFORM TO THE PERTINENT REQUIREMENTS OF THE STANDARD SPECIFICATIONS AND APPLICABLE SPECIAL PROVISIONS. DO NOT MILL SHOULDER GROOVES THROUGH ANY INTERSECTION, MARKED CROSSWALK, NON-MOTORIZED PATH CROSSING, OR SNOWMOBILE CROSSING.

- ① SHOULDER GROOVES MAY BE OMITTED IN AREAS WITH HIGH CONCENTRATIONS OF DRIVEWAYS, WHEN DIRECTED BY THE ENGINEER.

LOCATION	DEPTH INCHES
a	1/16"
b	5/32"
c	9/32"
d	7/16"
e	1/2"

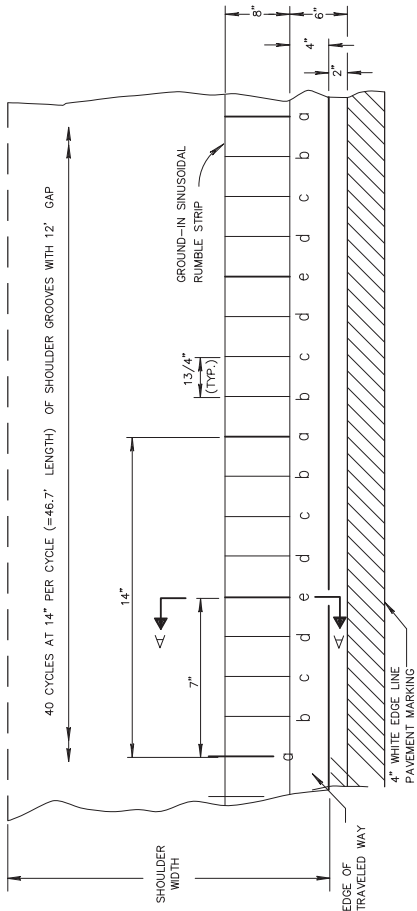

SHOULDER WITH GROUND-IN SINUSOIDAL RUMBLE STRIP

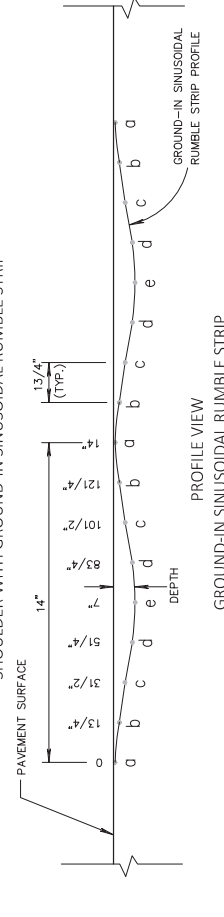

GROUND-IN SINUSOIDAL RUMBLE STRIP

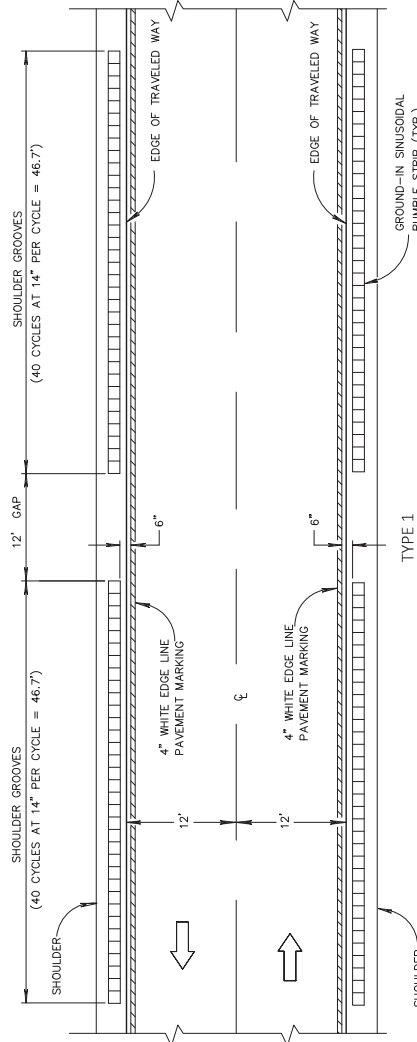

ISOMETRIC

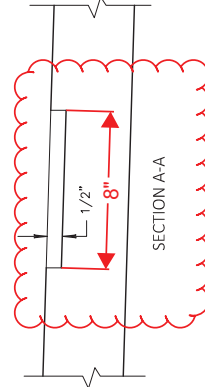

Addendum No. 02
ID 4150-25-60
Revised Sheet 19
November 5, 2020

STA	STA	SIDE	LF
340+99.9	- 341+50.1	RT	50
736+08.3	- 736+61.9	LT	53
TOTAL			103

PROJECT	LOCATION	LS
4150-25-60	STH 57	1
TOTAL		1

213.0100	618.0100	619.1000
FINISHING AND REPAIR OF ROADWAY	MAINTENANCE AND REPAIR OF HAUL ROADS	MOBILIZATION
4150-25-60 (EACH)	4150-25-60 (EACH)	(EACH)
STH 57	1	1
TOTAL		1

3

3

SHOULDERING & ENTRANCES

STA	STA	SIDE	(TON)	305.0110
110+19	- 263+10	LT/RT	1,693	BASE AGGREGATE - BASE AGGREGATE - DENSE 3/4-INCH (DENSE 1 1/4-INCH)
263+10	- 266+20	RT	17	
271+12	- 275+15	LT/RT	45	
275+15	- 354+80	LT/RT	1,514	
354+80	- 363+25	LT	47	
363+25	- 575+20	LT/RT	4,030	
575+20	- 580+80	LT	31	
580+80	- 671+55	LT/RT	1,725	
671+55	- 677+25	RT	32	
706+30	- 1022+00	LT/RT	6,002	
1022+00	- 1027+00	LT/RT	28	
P.E. / C.F.				
UNDISTRIBUTED			70	0 -70-
			381-379-	0 -2-
TOTAL			15,540-	0 -72-
			15,612	

460.0105.S	460.0110.S
HMA PWL STRIP VOLUMETRICS (EA)	HMA PWL STRIP DENSITY (EA)
PROJECT STA - STA	
4150-25-60 UNDISTRIBUTED	1
TOTAL	
	1

Addendum No. 02
ID 4150-25-60
Revised Sheet 61
November 5, 2020

ALL ITEMS ARE IN CATEGORY 0010 UNLESS NOTED OTHERWISE



Proposal Schedule of Items

Proposal ID: 20201110021 Project(s): 4150-25-60

Federal ID(s): WISC 2020542

SECTION: 0001 Contract Items

Alt Set ID: Alt Mbr ID:

Proposal Line Number	Item ID Description	Approximate Quantity and Units	Unit Price	Bid Amount
0002	204.0115 Removing Asphaltic Surface Butt Joints	420.000 SY	_____.	_____.
0004	204.0120 Removing Asphaltic Surface Milling	410,050.000 SY	_____.	_____.
0006	204.0165 Removing Guardrail	103.000 LF	_____.	_____.
0008	211.0100 Prepare Foundation for Asphaltic Paving (project) 01. 4150-25-60	LS	LUMP SUM	_____.
0010	213.0100 Finishing Roadway (project) 01.4150-25-60	1.000 EACH	_____.	_____.
0012	305.0110 Base Aggregate Dense 3/4-Inch	15,612.000 TON	_____.	_____.
0016	455.0605 Tack Coat	24,570.000 GAL	_____.	_____.
0018	460.0105.S HMA Percent Within Limits (PWL) Test Strip Volumetrics	1.000 EACH	_____.	_____.
0020	460.0110.S HMA Percent Within Limits (PWL) Test Strip Density	1.000 EACH	_____.	_____.
0022	460.2000 Incentive Density HMA Pavement	31,920.000 DOL	1.00000	31,920.00
0024	460.2005 Incentive Density PWL HMA Pavement	31,140.000 DOL	1.00000	31,140.00
0026	460.2007 Incentive Density HMA Pavement Longitudinal Joints	109,420.000 DOL	1.00000	109,420.00
0028	460.2010 Incentive Air Voids HMA Pavement	49,880.000 DOL	1.00000	49,880.00
0030	460.6224 HMA Pavement 4 MT 58-28 S	51,690.000 TON	_____.	_____.
0032	465.0110 Asphaltic Surface Patching	510.000 TON	_____.	_____.



Proposal Schedule of Items

Proposal ID: 20201110021 Project(s): 4150-25-60

Federal ID(s): WISC 2020542

SECTION: 0001 Contract Items

Alt Set ID: Alt Mbr ID:

Proposal Line Number	Item ID Description	Approximate Quantity and Units	Unit Price	Bid Amount
0034	465.0425 Asphaltic Shoulder Rumble Strips 2-Lane Rural	116,490.000 LF	_____.	_____.
0036	465.0475 Asphalt Centerline Rumble Strips 2-Lane Rural	52,750.000 LF	_____.	_____.
0038	611.8110 Adjusting Manhole Covers	4.000 EACH	_____.	_____.
0040	614.0010 Barrier System Grading Shaping Finishing	5.000 EACH	_____.	_____.
0042	614.0305 Steel Plate Beam Guard Class A	75.000 LF	_____.	_____.
0044	614.0370 Steel Plate Beam Guard Energy Absorbing Terminal	1.000 EACH	_____.	_____.
0046	614.0400 Adjusting Steel Plate Beam Guard	350.000 LF	_____.	_____.
0048	614.0950 Replacing Guardrail Posts and Blocks	60.000 EACH	_____.	_____.
0050	614.0951 Replacing Guardrail Rail and Hardware	50.000 LF	_____.	_____.
0052	614.0952 Replacing Guardrail Reflectors	6.000 EACH	_____.	_____.
0054	618.0100 Maintenance And Repair of Haul Roads (project) 01. 4150-25-60	1.000 EACH	_____.	_____.
0056	619.1000 Mobilization	1.000 EACH	_____.	_____.
0058	624.0100 Water	12.000 MGAL	_____.	_____.
0060	628.1504 Silt Fence	430.000 LF	_____.	_____.
0062	628.1520 Silt Fence Maintenance	430.000 LF	_____.	_____.



Proposal Schedule of Items

Proposal ID: 20201110021 Project(s): 4150-25-60

Federal ID(s): WISC 2020542

SECTION: 0001 Contract Items

Alt Set ID: Alt Mbr ID:

Proposal Line Number	Item ID Description	Approximate Quantity and Units	Unit Price	Bid Amount
0064	628.1905 Mobilizations Erosion Control	6.000 EACH	_____.	_____.
0066	628.1910 Mobilizations Emergency Erosion Control	3.000 EACH	_____.	_____.
0068	628.2002 Erosion Mat Class I Type A	790.000 SY	_____.	_____.
0070	628.7570 Rock Bags	45.000 EACH	_____.	_____.
0072	630.0500 Seed Water	18.000 MGAL	_____.	_____.
0074	642.5201 Field Office Type C	1.000 EACH	_____.	_____.
0076	643.0300 Traffic Control Drums	344.000 DAY	_____.	_____.
0082	643.0900 Traffic Control Signs	3,570.000 DAY	_____.	_____.
0084	643.1050 Traffic Control Signs PCMS	40.000 DAY	_____.	_____.
0088	643.5000 Traffic Control	1.000 EACH	_____.	_____.
0090	646.1040 Marking Line Grooved Wet Ref Epoxy 4-Inch	179,200.000 LF	_____.	_____.
0092	646.3040 Marking Line Grooved Wet Ref Epoxy 8-Inch	1,100.000 LF	_____.	_____.
0096	646.6105 Marking Stop Line Paint 18-Inch	32.000 LF	_____.	_____.
0098	648.0100 Locating No-Passing Zones	17.500 MI	_____.	_____.
0100	649.0120 Temporary Marking Line Epoxy 4-Inch	116,920.000 LF	_____.	_____.
0102	650.8000 Construction Staking Resurfacing Reference	92,400.000 LF	_____.	_____.



Proposal Schedule of Items

Proposal ID: 20201110021 Project(s): 4150-25-60

Federal ID(s): WISC 2020542

SECTION: 0001 Contract Items

Alt Set ID: Alt Mbr ID:

Proposal Line Number	Item ID Description	Approximate Quantity and Units	Unit Price	Bid Amount
0104	650.9910 Construction Staking Supplemental Control (project) 01. 4150-25-60	LS	LUMP SUM	_____.
0106	690.0150 Sawing Asphalt	1,880.000 LF	_____.	_____.
0108	740.0440 Incentive IRI Ride	70,000.000 DOL	1.00000	70,000.00
0110	ASP.1T0A On-the-Job Training Apprentice at \$5.00/HR	2,400.000 HRS	5.00000	12,000.00
0112	ASP.1T0G On-the-Job Training Graduate at \$5.00/HR	2,100.000 HRS	5.00000	10,500.00
0114	SPV.0090 Special 01. Asphaltic Centerline Rumble Strips, Sinusoidal, 2-Lane Rural	20,680.000 LF	_____.	_____.
0116	SPV.0090 Special 02. Asphaltic Shoulder Rumble Strips, Sinusoidal, 2-Lane Rural	47,220.000 LF	_____.	_____.
0118	SPV.0090 Special 03. Milling and Removing Temporary Joint	92,600.000 LF	_____.	_____.
0120	646.1020 Marking Line Epoxy 4-Inch	92,700.000 LF	_____.	_____.
0122	649.0105 Temporary Marking Line Paint 4-Inch	179,110.000 LF	_____.	_____.
Section: 0001			Total:	_____.
			Total Bid:	_____.