



# Wisconsin Department of Transportation

November 16, 2020

## Division of Transportation Systems Development

Bureau of Project Development  
4822 Madison Yards Way, 4<sup>th</sup> Floor South  
Madison, WI 53705

Telephone: (608) 266-1631  
Facsimile (FAX): (608) 266-8459

### NOTICE TO ALL CONTRACTORS:

**Proposal #22: 6054-06-72, WISC 2021 040**  
**STH 60 - Montello**  
**Columbia Cty Line to B-39-0062**  
**STH 22**  
**Marquette County**

**6054-06-72, WISC 2021 041**  
**STH 60 - Montello**  
**B-39-0062 to 5<sup>th</sup> Street**  
**STH 22**  
**Marquette County**

### Letting of December 8, 2020

This is Addendum No. 01, which provides for the following:

#### Schedule of Items:

Added Bid Item Quantities					
Bid Item	Item Description	Unit	Old Quantity	Revised Quantity	Proposal Total
520.1024	Apron Endwalls for Culvert Pipe 24-Inch	EACH	0	4	4
520.1030	Apron Endwalls for Culvert Pipe 30-Inch	EACH	0	4	4
520.3624	Culvert Pipe Class III-B Non-Metal 24-Inch	LF	0	167	167
520.3630	Culvert Pipe Class III-B Non-Metal 30-Inch	LF	0	126	126

Deleted Bid Item Quantities					
Bid Item	Item Description	Unit	Old Quantity	Revised Quantity	Proposal Total
522.0124	Culvert Pipe Reinforced Concrete Class III 24-Inch	LF	167	-167	0
522.0130	Culvert Pipe Reinforced Concrete Class III 30-Inch	LF	126	-126	0
522.1024	Apron Endwalls for Culvert Pipe Reinforced Concrete 24-Inch	EACH	4	-4	0
522.1030	Apron Endwalls for Culvert Pipe Reinforced Concrete 30-Inch	EACH	4	-4	0

**Plan Sheets:**

<b>Revised Plan Sheets</b>	
<b>Plan Sheet</b>	<b>Plan Sheet Title (brief description of changes to sheet)</b>
9	Typical Sections (Add note to both shoulders in the Proposed Typical Section that reads "Full Depth Mill & 3.75" Pavement)
15	Construction Detail Sheet (Replaced RCP Class III culvert pipes with Class III-B Non-Metal and Apron Endwalls for Culvert Pipe 24-Inch)
18	Construction Detail Sheet (Replaced RCP Class III culvert pipes with Class III-B Non-Metal and Apron Endwalls for Culvert Pipe 30-Inch)
20	Construction Detail Sheet (Replaced RCP Class III culvert pipes with Class III-B Non-Metal and Apron Endwalls for Culvert Pipe 24-Inch)
21	Construction Detail Sheet (Replaced RCP Class III culvert pipes with Class III-B Non-Metal and Apron Endwalls for Culvert Pipe 30-Inch)
47	Miscellaneous Quantities (replaced culvert pipes RCP Class III with Class III-B Non-Metal and Apron Endwalls for Culvert Pipe 24-Inch and for Culvert Pipe 30-Inch)

**Schedule of Items**

Attached, dated November 16, 2020, are the revised Schedule of Items Pages 1 – 5.

**Plan Sheets**

The following 8½ x 11-inch sheets are attached and made part of the plans for this proposal:

Revised: 9, 15, 18, 20, 21, 47.

The responsibility for notifying potential subcontractors and suppliers of these changes remains with the prime contractor.

Sincerely,

*Mike Coleman*

Proposal Development Specialist  
Proposal Management Section

END OF ADDENDUM

Addendum No. 01  
 ID 6054-06-72/73  
 Revised Sheet 9  
 November 16, 2020

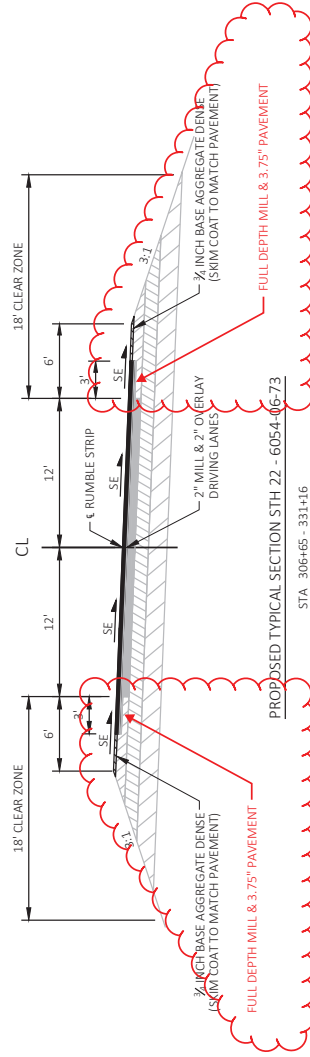
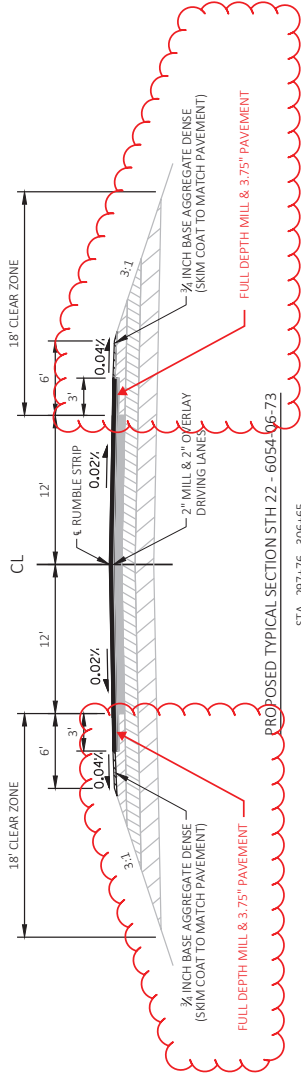

LEGEND

- 4 LT 58-28 S ASPHALT PAVEMENT
- 3/4" INCH BASE AGGREGATE DENSE (SKIM COAT TO MATCH PAVEMENT)
- EXISTING HMA PAVEMENT
- EXISTING B.A.D.
- EXISTING SAND-GRAVEL FILL

FULL DEPTH MILL & 3.75" PAVEMENT

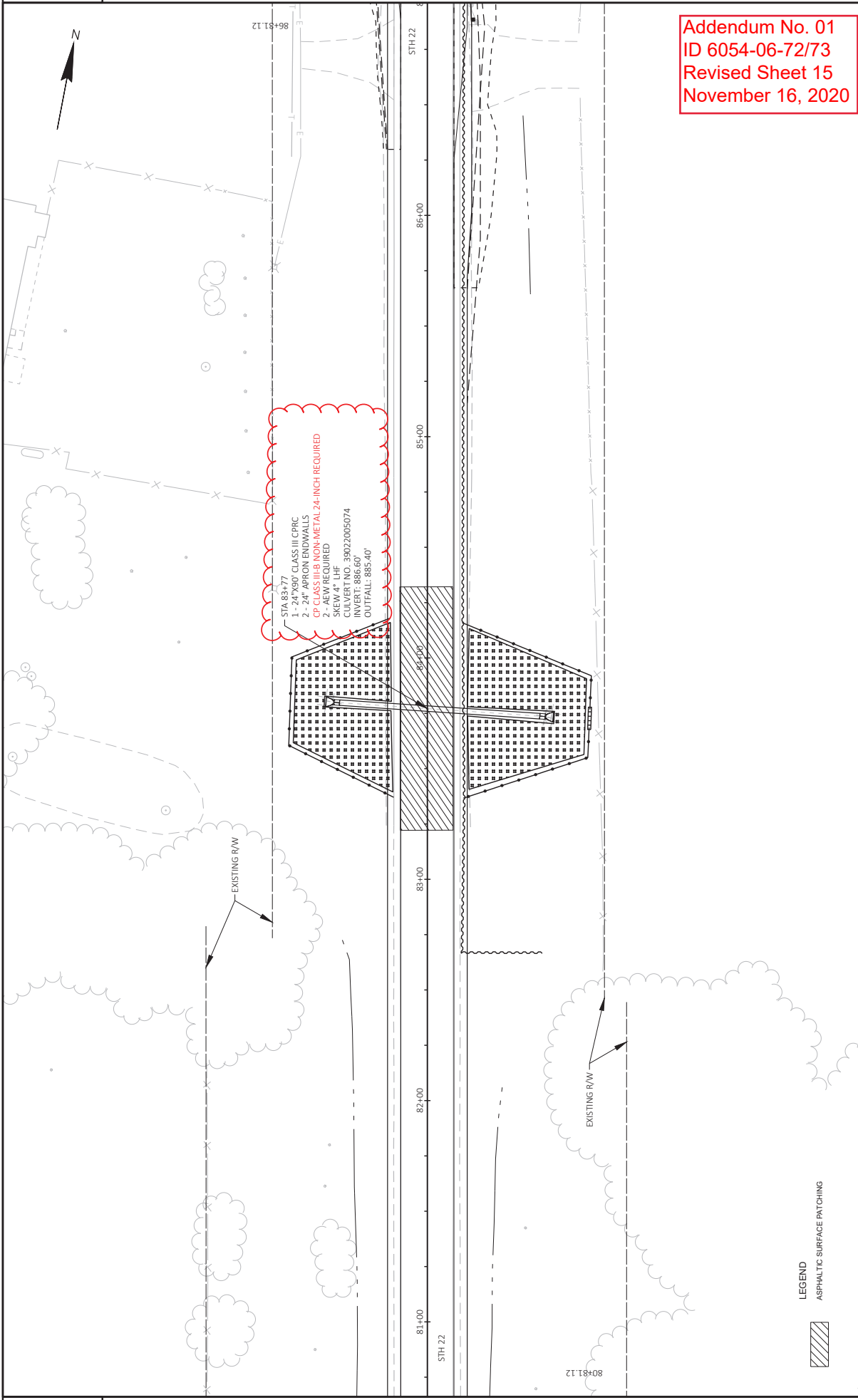

Addendum No. 01  
 ID 6054-06-72/73  
 Revised Sheet 15  
 November 16, 2020

LEGEND  
 ASPHALTIC SURFACE PATCHING

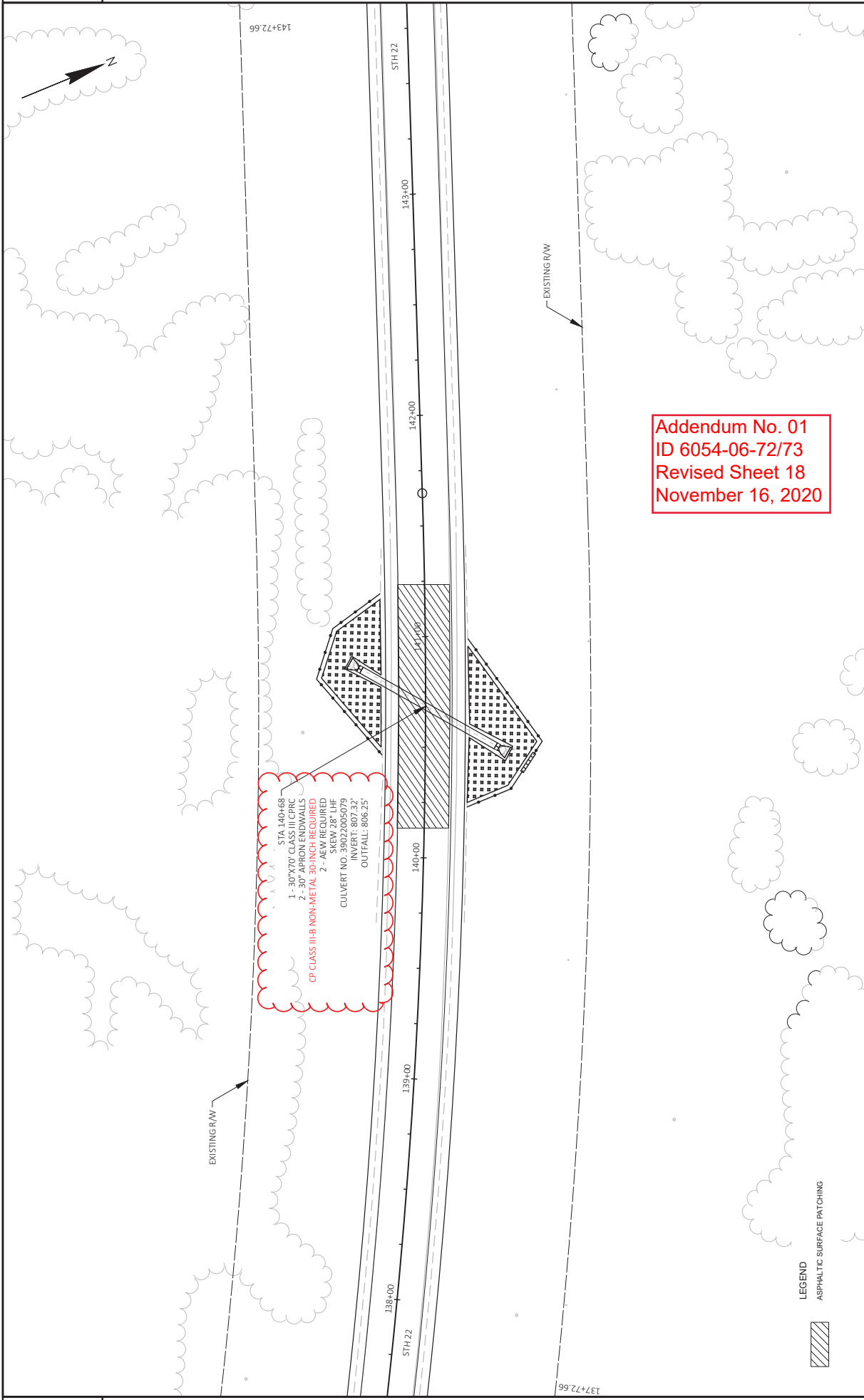

STA 140+68  
 1 - 30"x70" CLASS II CP RC  
 2 - 30" APRON ENDWALLS  
 CP CLASS III-B NON-METAL 30-INCH REQUIRED  
 2 - AEW REQUIRED  
 SKEW 28° LHF  
 CULVERT NO. 3622-0577  
 SERIAL: 807.327  
 OUTFALL: 806.25'

Addendum No. 01  
 ID 6054-06-72/73  
 Revised Sheet 18  
 November 16, 2020

LEGEND  
 ASPHALTIC SURFACE PATCHING

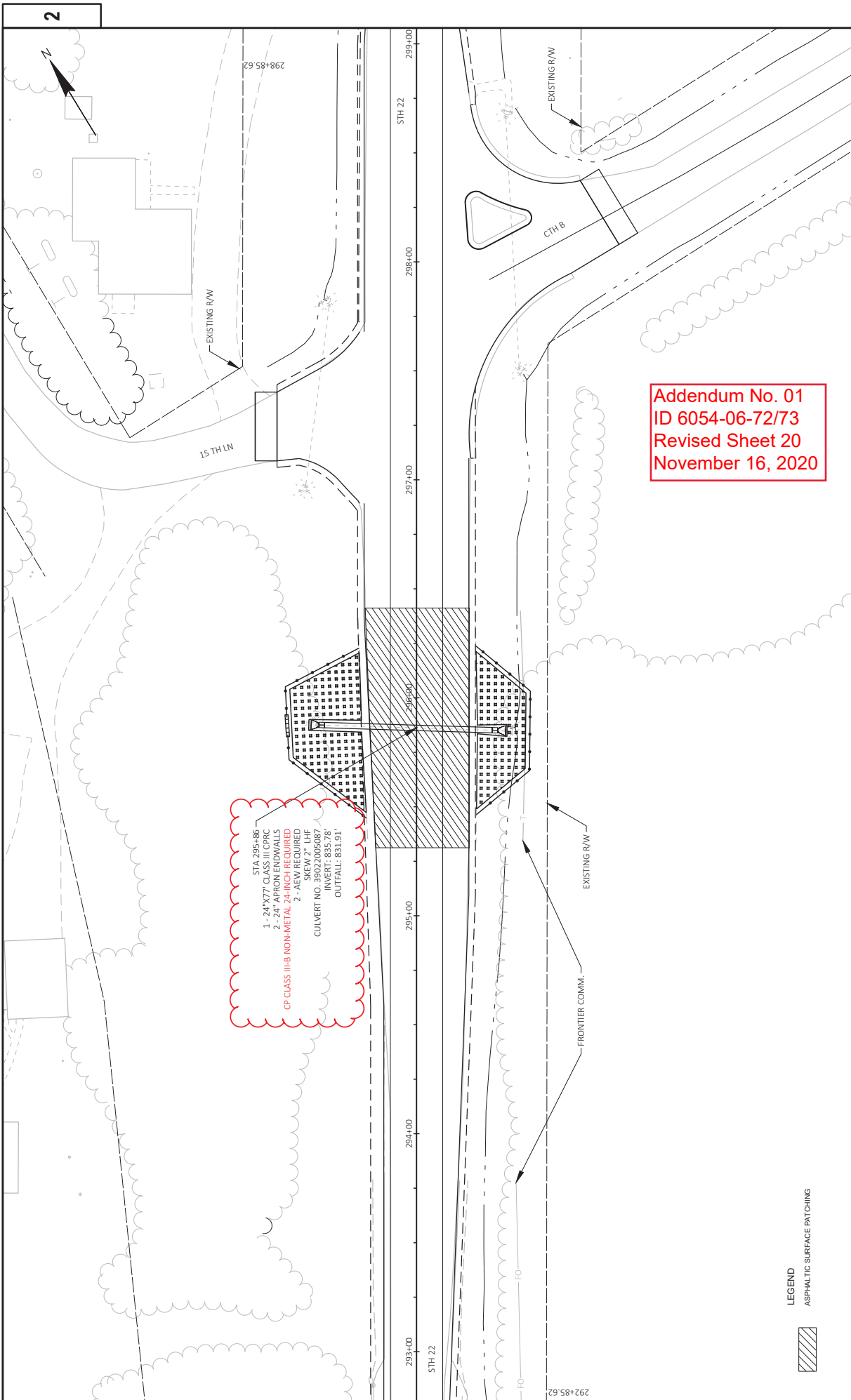

STA 295+86  
 1 - 24"x77" CLASS III CPVC  
 2 - 24" APRON ENDWALLS  
 CP CLASS III-B NO-IN-METAL 24-INCH REQUIRED  
 2 - AEW REQUIRED  
 SKEW 2° LHF  
 CULVERT NO. 39022005087  
 INVERT: 835.78  
 OUTFALL: 831.91

Addendum No. 01  
 ID 6054-06-72/73  
 Revised Sheet 20  
 November 16, 2020

LEGEND  
 ASPHALTIC SURFACE PATCHING

Addendum No. 01  
 ID 6054-06-72/73  
 Revised Sheet 21  
 November 16, 2020

2

2

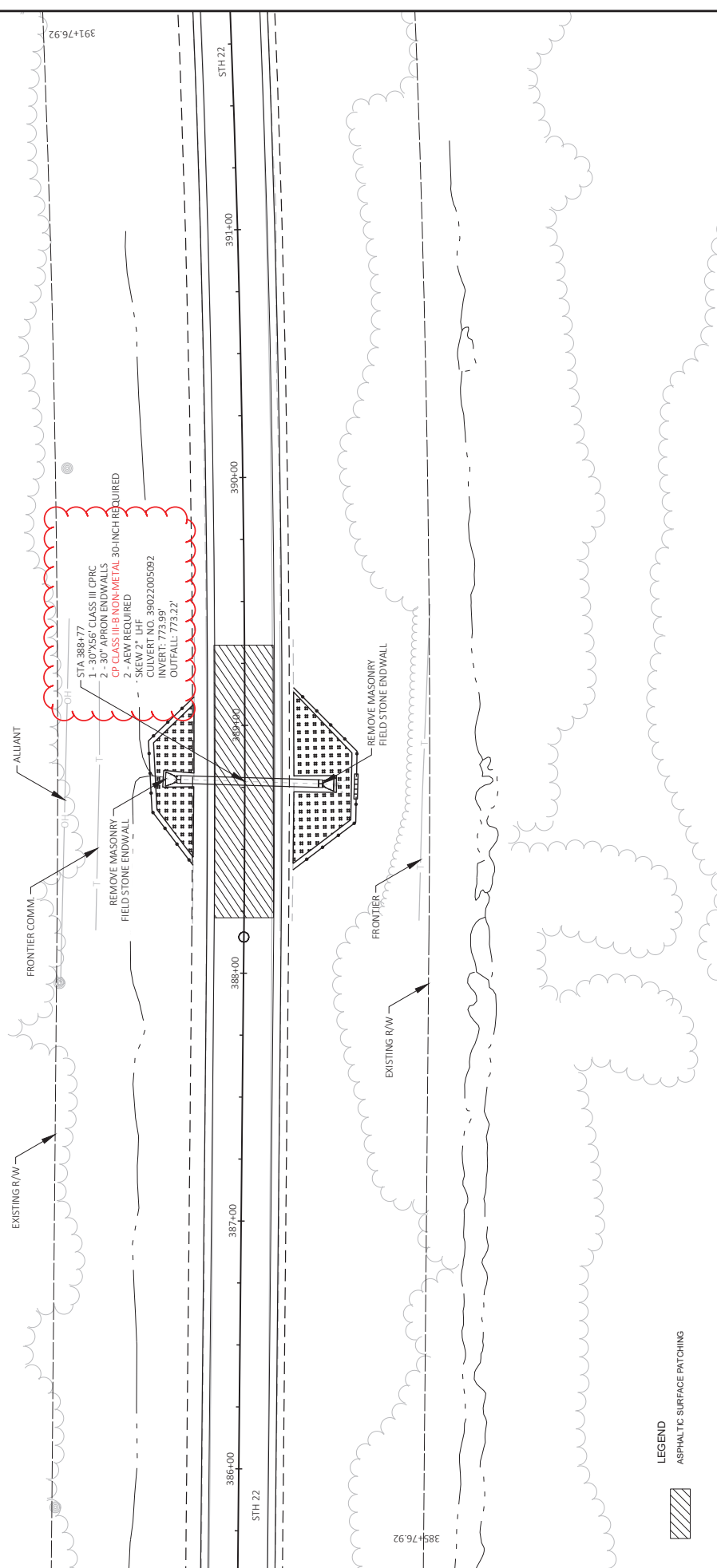

LEGEND  
 ASPHALTIC SURFACE PATCHING

Addendum No. 01  
 ID 6054-06-72/73  
 Revised Sheet 47  
 November 16, 2020

CROSS DRAIN & SIDE ROAD CULVERT PIPES													
STATION	LOCATION	CP CLASS III-B NON-METAL		CPRC CLASS III		CPRC CLASS IV		APRON ENDWALLS FOR CULVERT PIPE		RIPRAP MEDIUM			
		520.3624 24-INCH LF	520.3630 30-INCH LF	522.0160 60-INCH LF	522.2324 24X38-INCH LF	520.1024 24-INCH EACH	520.1030 30-INCH EACH	522.1060 60-INCH EACH	522.2624 24X38-INCH EACH	522.2648 48X76-INCH EACH	406.0200 CY	GEOTEXTILE TYPE HR 645.0120 SY	LANE SHIFT SPV.0060.01 EA
<b>PROJECT 6054-06-72</b>													
83+77	CL	90						2			1	4	1
112+97	CL				53						2	6	
133+88	CL			77					2				1
140+68	CL		70										1
200+30	CL												
295+86	CL	77						2			1	4	
		167	70	77	53			4	2	2	4	14	3
<b>PROJECT 6054-06-73</b>													
388+77	CL		56								2	5	
434+66	CL					63					5	15	1
			56			63					7	20	1
TOTALS		167	126	77	53	63	4	4	4	4	11	34	4

BARRIER SYSTEM GRADING SHAPING FINISHING													
STATION - STATION	LOCATION	MGS GUARDRAIL 3 LF	MGS GUARDRAIL TERMINAL EAT EACH	MGS BEAM GUARD SHORT RADIUS LF	614.0345 MGS	614.2610 MGS	614.0010 BARRIER SYSTEM GRADING SHAPING FINISHING EACH	EMAT CLASS II TYPE B SY	*TOP SOIL SY	*FERTILIZER TYPE B CWT	*SEED MIXTURE NO 20 LB	*EARTHWORK CUT FILL (CY)	REMARKS
<b>PROJECT 6054-06-72</b>													
87+48-27 - 94+51.3	LT	603	2				RT	134	134	0.08	3.63	6	1099
86+85.16 - 93+30.6	RT	545	2				RT	138	138	0.09	3.71		
174+37.7 - 8+33 RT	LT	688	2	75			LT	52	52	0.03	1.41		
174+91.8 - 181+72.2	RT	576	2				LT	64	64	0.04	1.73		
		2412	8	75			LT	68	68	0.04	1.83	3	805
<b>PROJECT 6054-06-73</b>													
367+17.3 - 372+11	LT	396	2				RT	49	446	0.28	12.05	0	509
365+98.7 - 370+86	RT	385	2				RT	73	73	0.03	1.32		
		781	4				RT	1024	1024	0.64	27.65		
TOTALS		3193	12	150			RT	149	149	0.09	4.01	28	319
							LT	120	120	0.08	3.47		
							LT	143	143	0.09	3.87		
TOTALS							4	540	540	0.34	14.60		
TOTALS							12	1564	1564	0.98	42.25		





Proposal Schedule of Items

Proposal ID: 20201208022 Project(s): 6054-06-72, 6054-06-73

Federal ID(s): WISC 2021040, WISC 2021041

SECTION: 0001 Contract Items

Alt Set ID: Alt Mbr ID:

Proposal Line Number	Item ID Description	Approximate Quantity and Units	Unit Price	Bid Amount
0002	203.0100 Removing Small Pipe Culverts	7.000 EACH	_____.	_____.
0004	204.0115 Removing Asphaltic Surface Butt Joints	609.000 SY	_____.	_____.
0006	204.0120 Removing Asphaltic Surface Milling	190,072.000 SY	_____.	_____.
0008	204.0165 Removing Guardrail	3,405.000 LF	_____.	_____.
0010	204.0185 Removing Masonry	6.000 CY	_____.	_____.
0012	205.0100 Excavation Common	4,866.000 CY	_____.	_____.
0014	211.0400 Prepare Foundation for Asphaltic Shoulders	362.400 STA	_____.	_____.
0016	213.0100 Finishing Roadway (project) 01. 6054-06-72	1.000 EACH	_____.	_____.
0018	213.0100 Finishing Roadway (project) 02. 6054-06-73	1.000 EACH	_____.	_____.
0020	305.0110 Base Aggregate Dense 3/4-Inch	1,141.000 TON	_____.	_____.
0022	455.0605 Tack Coat	8,076.000 GAL	_____.	_____.
0024	460.0105.S HMA Percent Within Limits (PWL) Test Strip Volumetrics	1.000 EACH	_____.	_____.
0026	460.0110.S HMA Percent Within Limits (PWL) Test Strip Density	1.000 EACH	_____.	_____.
0028	460.2005 Incentive Density PWL HMA Pavement	16,971.000 DOL	1.00000	16,971.00
0030	460.2007 Incentive Density HMA Pavement Longitudinal Joints	22,200.000 DOL	1.00000	22,200.00



Proposal Schedule of Items

Proposal ID: 20201208022 Project(s): 6054-06-72, 6054-06-73

Federal ID(s): WISC 2021040, WISC 2021041

SECTION: 0001 Contract Items

Alt Set ID: Alt Mbr ID:

Proposal Line Number	Item ID Description	Approximate Quantity and Units	Unit Price	Bid Amount
0032	460.2010 Incentive Air Voids HMA Pavement	22,245.000 DOL	1.00000	22,245.00
0034	460.5224 HMA Pavement 4 LT 58-28 S	22,237.000 TON	_____	_____
0036	465.0105 Asphaltic Surface	5,288.000 TON	_____	_____
0038	465.0315 Asphaltic Flumes	12.000 SY	_____	_____
0040	465.0475 Asphalt Centerline Rumble Strips 2-Lane Rural	49,218.000 LF	_____	_____
0042	504.0900 Concrete Masonry Endwalls	6.700 CY	_____	_____
0048	522.0160 Culvert Pipe Reinforced Concrete Class III 60-Inch	77.000 LF	_____	_____
0054	522.1060 Apron Endwalls for Culvert Pipe Reinforced Concrete 60-Inch	2.000 EACH	_____	_____
0056	522.2424 Culvert Pipe Reinforced Concrete Horizontal Elliptical Class HE-IV 24x38-Inch	53.000 LF	_____	_____
0058	522.2624 Apron Endwalls for Culvert Pipe Reinforced Concrete Horizontal Elliptical 24x38-Inch	2.000 EACH	_____	_____
0060	522.2648 Apron Endwalls for Culvert Pipe Reinforced Concrete Horizontal Elliptical 48x76-Inch	2.000 EACH	_____	_____
0062	606.0200 Riprap Medium	11.000 CY	_____	_____
0064	614.0010 Barrier System Grading Shaping Finishing	12.000 EACH	_____	_____
0066	614.2300 MGS Guardrail 3	3,193.000 LF	_____	_____



Proposal Schedule of Items

Proposal ID: 20201208022 Project(s): 6054-06-72, 6054-06-73

Federal ID(s): WISC 2021040, WISC 2021041

SECTION: 0001 Contract Items

Alt Set ID: Alt Mbr ID:

Proposal Line Number	Item ID Description	Approximate Quantity and Units	Unit Price	Bid Amount
0068	614.2350 MGS Guardrail Short Radius	75.000 LF	_____.	_____.
0070	614.2610 MGS Guardrail Terminal EAT	12.000 EACH	_____.	_____.
0072	618.0100 Maintenance And Repair of Haul Roads (project) 01. 6054-06-72	1.000 EACH	_____.	_____.
0074	618.0100 Maintenance And Repair of Haul Roads (project) 02. 6054-06-73	1.000 EACH	_____.	_____.
0076	619.1000 Mobilization	1.000 EACH	_____.	_____.
0078	624.0100 Water	11.400 MGAL	_____.	_____.
0080	625.0100 Topsoil	11,370.060 SY	_____.	_____.
0082	628.1504 Silt Fence	7,281.000 LF	_____.	_____.
0084	628.1520 Silt Fence Maintenance	7,281.000 LF	_____.	_____.
0086	628.1905 Mobilizations Erosion Control	4.000 EACH	_____.	_____.
0088	628.1910 Mobilizations Emergency Erosion Control	4.000 EACH	_____.	_____.
0090	628.2023 Erosion Mat Class II Type B	12,934.000 SY	_____.	_____.
0092	628.7555 Culvert Pipe Checks	50.000 EACH	_____.	_____.
0094	628.7570 Rock Bags	144.000 EACH	_____.	_____.
0096	629.0210 Fertilizer Type B	6.960 CWT	_____.	_____.
0098	630.0120 Seeding Mixture No. 20	101.220 LB	_____.	_____.



Proposal Schedule of Items

Proposal ID: 20201208022 Project(s): 6054-06-72, 6054-06-73

Federal ID(s): WISC 2021040, WISC 2021041

SECTION: 0001 Contract Items

Alt Set ID: Alt Mbr ID:

Proposal Line Number	Item ID Description	Approximate Quantity and Units	Unit Price	Bid Amount
0100	630.0500 Seed Water	365.000 MGAL	_____.	_____.
0102	633.5200 Markers Culvert End	14.000 EACH	_____.	_____.
0104	642.5201 Field Office Type C	1.000 EACH	_____.	_____.
0106	643.0300 Traffic Control Drums	1,155.000 DAY	_____.	_____.
0108	643.0420 Traffic Control Barricades Type III	16.000 DAY	_____.	_____.
0110	643.0900 Traffic Control Signs	980.000 DAY	_____.	_____.
0112	643.5000 Traffic Control	1.000 EACH	_____.	_____.
0114	645.0120 Geotextile Type HR	34.000 SY	_____.	_____.
0116	646.1020 Marking Line Epoxy 4-Inch	62,605.000 LF	_____.	_____.
0118	646.1040 Marking Line Grooved Wet Ref Epoxy 4-Inch	109,304.000 LF	_____.	_____.
0120	646.3040 Marking Line Grooved Wet Ref Epoxy 8-Inch	106.000 LF	_____.	_____.
0122	648.0100 Locating No-Passing Zones	10.650 MI	_____.	_____.
0124	649.0120 Temporary Marking Line Epoxy 4-Inch	62,605.000 LF	_____.	_____.
0126	650.6000 Construction Staking Pipe Culverts	7.000 EACH	_____.	_____.
0128	650.8000 Construction Staking Resurfacing Reference	55,502.000 LF	_____.	_____.
0130	690.0150 Sawing Asphalt	270.000 LF	_____.	_____.



Proposal Schedule of Items

Proposal ID: 20201208022 Project(s): 6054-06-72, 6054-06-73

Federal ID(s): WISC 2021040, WISC 2021041

SECTION: 0001 Contract Items

Alt Set ID: Alt Mbr ID:

Proposal Line Number	Item ID Description	Approximate Quantity and Units	Unit Price	Bid Amount
0132	740.0440 Incentive IRI Ride	32,280.000 DOL	1.00000	32,280.00
0134	ASP.1T0A On-the-Job Training Apprentice at \$5.00/HR	1,260.000 HRS	5.00000	6,300.00
0136	ASP.1T0G On-the-Job Training Graduate at \$5.00/HR	2,000.000 HRS	5.00000	10,000.00
0138	SPV.0060 Special 01. Lane Shift	4.000 EACH	_____.	_____.
0140	SPV.0090 Special 01. Culvert Pipe Reinforced Concrete Class IV 48X76-Inch HE	63.000 LF	_____.	_____.
0142	SPV.0170 Special 01. Regrade Cattle Pass	3.600 STA	_____.	_____.
0144	520.1024 Apron Endwalls for Culvert Pipe 24-Inch	4.000 EACH	_____.	_____.
0146	520.1030 Apron Endwalls for Culvert Pipe 30-Inch	4.000 EACH	_____.	_____.
0148	520.3624 Culvert Pipe Class III-B Non-metal 24-Inch	167.000 LF	_____.	_____.
0150	520.3630 Culvert Pipe Class III-B Non-metal 30-Inch	126.000 LF	_____.	_____.
<b>Section: 0001</b>			<b>Total:</b>	_____.
			<b>Total Bid:</b>	_____.

