



# Wisconsin Department of Transportation

March 22, 2021

## Division of Transportation Systems Development

Bureau of Project Development  
4822 Madison Yards Way, 4<sup>th</sup> Floor South  
Madison, WI 53705

Telephone: (608) 266-1631  
Facsimile (FAX): (608) 266-8459

### NOTICE TO ALL CONTRACTORS:

**Proposal #12: 9115-02-71, WISC 2021 265**  
**T Underhill, CTH R**  
**Shawano County Line to CTH VV**  
**CTH R**  
**Oconto County**

### Letting of April 13, 2021

This is Addendum No. 01, which provides for the following:

#### Schedule of Items:

Revised Bid Item Quantities					
Bid Item	Item Description	Unit	Old Quantity	Revised Quantity	Proposal Total
305.0120	Base Aggregate Dense, 1 ¼-Inch	Ton	5,000	1,000	6,000

#### Plan Sheets:

Revised Plan Sheets	
Plan Sheet	Plan Sheet Title (brief description of changes to sheet)
4	Construction Details – Pipe Bedding Detail added base aggregate and pavement thicknesses
10	Miscellaneous Quantities revised base aggregate dense 1 ¼-Inch quantity to include quantity at culvert pipe locations

#### **Schedule of Items**

Attached, dated March 22, 2021, are the revised Schedule of Items Page 1.

#### **Plan Sheets**

The following 8½ x 11-inch sheets are attached and made part of the plans for this proposal:  
Revised: 4 and 10.

The responsibility for notifying potential subcontractors and suppliers of these changes remains with the prime contractor.

Sincerely,

*Mike Coleman*

Proposal Development Specialist  
Proposal Management Section

END OF ADDENDUM

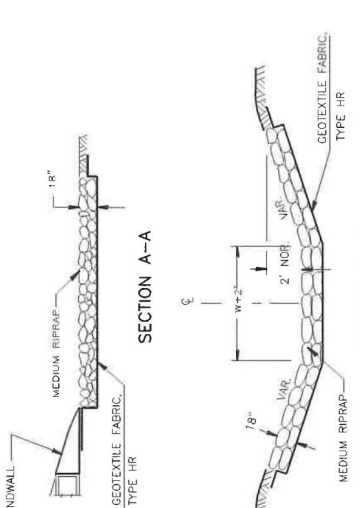
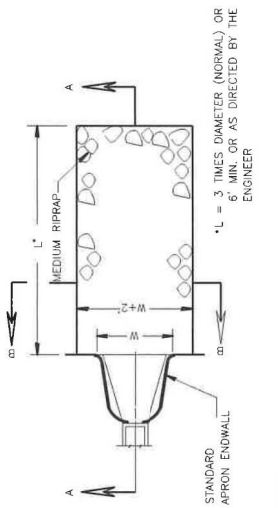
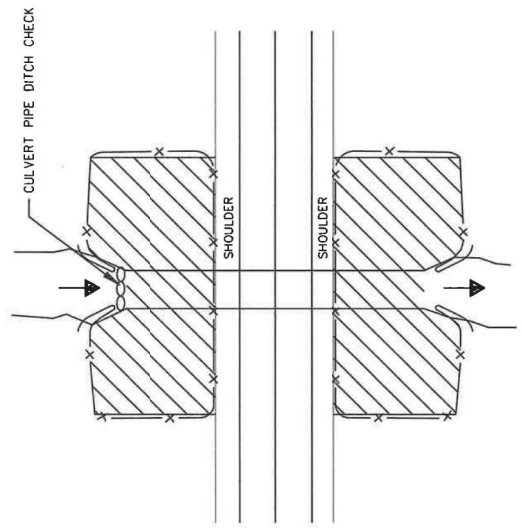

NOTE: SEE SPECIAL PROVISIONS FOR ADDITIONAL EROSION CONTROL REQUIREMENTS AT SPECIFIC LOCATIONS.

**MEDIUM RIPRAP TREATMENT AT CROSS CULVERTS**

1.75" HMA PAVEMENT 4 LT 58-345  
2.25" HMA PAVEMENT 3 LT 58-345

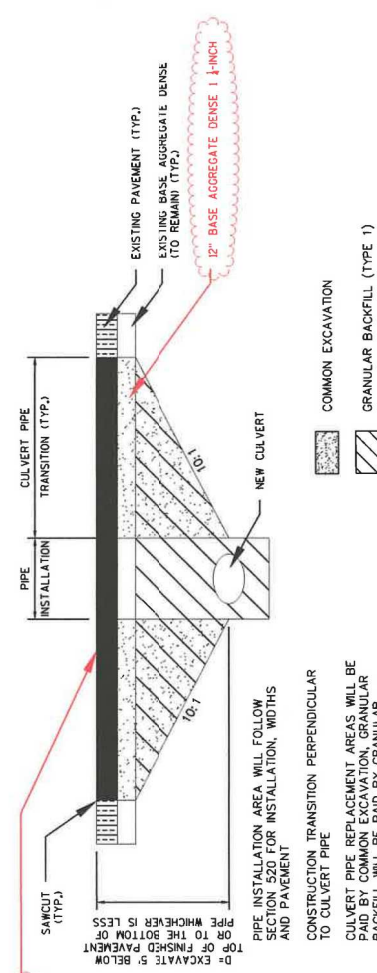

**CULVERT REPLACEMENT BEDDING DETAIL**

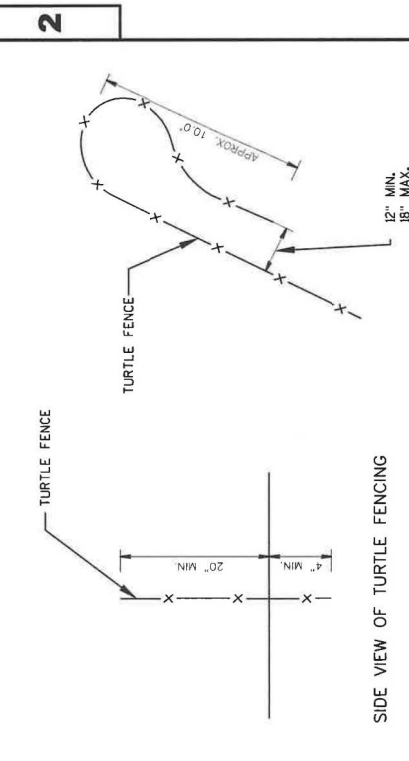

TURTLE FENCING WILL BE PAID UNDER STANDARD BID ITEM #628.1504, SILT FENCE.

**TURTLE FENCING**



Addendum No. 01  
ID 9115-02-71  
Revised Sheet 4  
March 22, 2021

EARTHWORK

Division	From/To Station	Location	Common Excavation (item # 205.0100)		Salvaged/Unusable Pavement Material	Available Material (2)	Unexpanded Fill	Expanded Fill (3)		Mass Ordinate +/- (4)	Waste	Borrow	Comment:
			Cut (1)	Excavation				Factor 1.25	Factor 1.25				
0010	205+00 - 214+92 52+57 - 55+43 123+70-160+02 UNDISTURBED	CTH R CTH VV CULVERTS	2768	0	0	2768	2768	130	2638	2638	2638	0	(item #208.0100)
			774	0	0	774	774	93	681	681	681	0	
			775	0	0	775	775	0	775	775	775	0	
			83			83	83	0	83	83	83	0	
Division 0010 Subtotal			4400	0	0	4400	4400	223	4177	4177	4177	0	
Grand Total			4400	0	0	4400	4400	223	4177	4177	4177	0	
Total Common Exc			4400										



- 1) Salvaged/Unusable Pavement Material is included in Cut.
- 2) Available Material = Cut - Salvaged/Unusable Pavement Material
- 3) Expanded Fill Factor = 1.25  
Depending on selections:  
Expanded Fill = (Unexpanded Fill - Rock\* Rock Factor - Reduced Marsh - Reduced EBS) \* Fill Factor  
Or  
Expanded Fill = (Unexpanded Fill - Rock\* Rock Factor - Reduced EBS) \* Fill Factor  
Or  
Expanded Fill = (Unexpanded Fill - Rock\* Rock Factor - Reduced Marsh) \* Fill Factor  
Or  
Expanded Fill = (Unexpanded Fill - Rock\* Rock Factor) \* Fill Factor
- 4) The Mass Ordinate +/- or - Qty calculated for the Division. Plus quantity indicates an excess of material within the Division. Minus indicates a shortage of material within the Division.

BASE AGGREGATE

STATION	LOCATION	CY	TON	MGAL	WATER
119+81 - 205+00	CTH R	--	1,750	0	18
205+00 - 214+92	CTH R	--	210	4,000	42
52+57 - 55+43	CTH VV	--	65	900	10
--	DRIVEWAYS	--	135	--	1
--	CULVERTS	775	--	1,000	--
UNDISTRIBUTED		25	40	40	3
PROJECT TOTAL		800	2,200	6,000	75

PULVERIZE AND RELAY

STATION	LOCATION	SY
119+81 - 205+00	CTH R	--
PROJECT TOTAL		28,400

ASPHALT

STATION	LOCATION	TON	TON	SY
119+81 - 205+00	CTH R	3,834	2,982	--
205+00 - 214+92	CTH R	446	347	15
52+57 - 55+43	CTH VV	129	100	--
UNDISTRIBUTED		21	21	--
PROJECT TOTAL		4,430	3,450	15



Proposal Schedule of Items

Proposal ID: 20210413012 Project(s): 9115-02-71

Federal ID(s): WISC 2021265

SECTION: 0001 Contract Items

Alt Set ID: Alt Mbr ID:

Proposal Line Number	Item ID Description	Approximate Quantity and Units	Unit Price	Bid Amount
0002	203.0100 Removing Small Pipe Culverts	5.000 EACH	_____.	_____.
0004	205.0100 Excavation Common	4,400.000 CY	_____.	_____.
0006	209.1100 Backfill Granular Grade 1	800.000 CY	_____.	_____.
0008	213.0100 Finishing Roadway (project) 01. 9115-02-71	1.000 EACH	_____.	_____.
0010	305.0110 Base Aggregate Dense 3/4-Inch	2,200.000 TON	_____.	_____.
0012	305.0120 Base Aggregate Dense 1 1/4-Inch	6,000.000 TON	_____.	_____.
0014	325.0100 Pulverize and Relay	28,400.000 SY	_____.	_____.
0016	374.1020.S QMP Pulverize and Relay Compaction	28,400.000 SY	_____.	_____.
0018	416.1010 Concrete Surface Drains	1.000 CY	_____.	_____.
0020	455.0605 Tack Coat	1,970.000 GAL	_____.	_____.
0022	460.2000 Incentive Density HMA Pavement	6,640.000 DOL	1.00000	6,640.00
0024	460.5223 HMA Pavement 3 LT 58-28 S	4,430.000 TON	_____.	_____.
0026	460.5244 HMA Pavement 4 LT 58-34 S	3,450.000 TON	_____.	_____.
0028	465.0315 Asphaltic Flumes	15.000 SY	_____.	_____.
0030	521.1018 Apron Endwalls for Culvert Pipe Steel 18-Inch	2.000 EACH	_____.	_____.
0032	521.1030 Apron Endwalls for Culvert Pipe Steel 30-Inch	2.000 EACH	_____.	_____.