



Wisconsin Department of Transportation

June 3, 2021

Division of Transportation Systems Development

Bureau of Project Development
4822 Madison Yards Way, 4th Floor South
Madison, WI 53705

Telephone: (608) 266-1631
Facsimile (FAX): (608) 266-8459

NOTICE TO ALL CONTRACTORS:

Proposal #09: 1021-00-78, WISC 2021 100
Baldwin - Menomonie
CTH NN Bridge EB B-55-0271
IH 94
St. Croix County

1021-00-79, WISC 2021 101
Baldwin - Menomonie
CTH NN Bridge WB B-55-0270
IH 94
St. Croix County

1021-04-77, WISC 2021 102
Baldwin - Menomonie
Carr Creek EB Br B-55-0281 & 0285
IH 94
St. Croix County

1021-04-78, WISC 2021 103
Baldwin - Menomonie
Carr Creek WB Br B-55-0282 & 0286
IH 94
St. Croix County

Letting of June 8, 2021

This is Addendum No. 03, which provides for the following:

Schedule of Items:

Revised Bid Item Quantities					
Bid Item	Item Description	Unit	Old Quantity	Revised Quantity	Proposal Total
204.0120	Removing Asphaltic Surface Milling	SY	5,430	+450	5,880
455.0605	Tack Coat	GAL	5,945	+25	5,970
465.0125	Asphaltic Surface Temporary	TON	24,650	+55	24,705
603.8000	Concrete Barrier Temporary Precast Delivered	LF	41,750	+7100	48,850
603.8125	Concrete Barrier Temporary Precast Installed	LF	57,950	+7100	65,050
614.0360	Steel Plate Beam Guard Temporary	LF	240	+240	480
614.0380	Steel Plate Beam Guard Energy Absorbing Terminal Temporary	EACH	1	+1	2
614.0905	Crash Cushions Temporary	EACH	10	+1	11

Plan Sheets:

Revised Plan Sheets	
Plan Sheet	Plan Sheet Title (brief description of changes to sheet)
51	Typical Sections for Traffic Control Staging (revised stage 1A)
78-80	Traffic Control Stage 1A (replace drums with temp barrier for 94 EB)
146	Miscellaneous Quantities (revised quantity for item 204.0120)
148	Miscellaneous Quantities (revised quantity for item 455.0605 and 465.0125)
149	Miscellaneous Quantities (revised quantity for item 603.8000 and 603.8125)
150	Miscellaneous Quantities (revised quantity for item 614.0905)

Schedule of Items

Attached, dated June 3, 2021, are the revised Schedule of Items Pages 1, 4, and 7 – 9.

Plan Sheets

The following 8½ x 11-inch sheets are attached and made part of the plans for this proposal:
Revised: 51, 78 – 80, 146, and 148 - 150

The responsibility for notifying potential subcontractors and suppliers of these changes remains with the prime contractor.

Sincerely,

Mike Coleman

Proposal Development Specialist
Proposal Management Section

END OF ADDENDUM

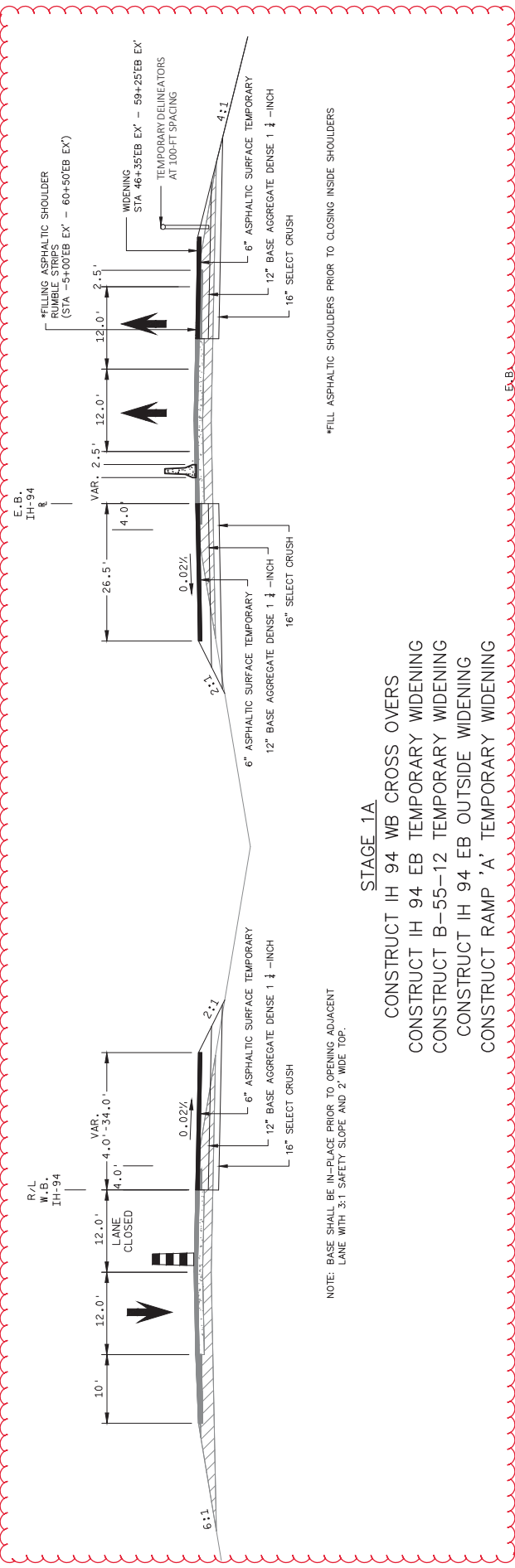

STAGE 1A
 CONSTRUCT IH 94 WB CROSS OVERS
 CONSTRUCT IH 94 EB TEMPORARY WIDENING
 CONSTRUCT B-55-12 TEMPORARY WIDENING
 CONSTRUCT IH 94 EB OUTSIDE WIDENING
 CONSTRUCT RAMP 'A' TEMPORARY WIDENING

*FILL ASPHALTIC SHOULDERS PRIOR TO CLOSING INSIDE SHOULDERS

NOTE: BASE SHALL BE IN-PLACE PRIOR TO OPENING ADJACENT LANE WITH 3:1 SAFETY SLOPE AND 2" WIDE TOP.

Addendum No. 03
 ID 1021-04-78
 Revised Sheet 51
 June 3, 2021

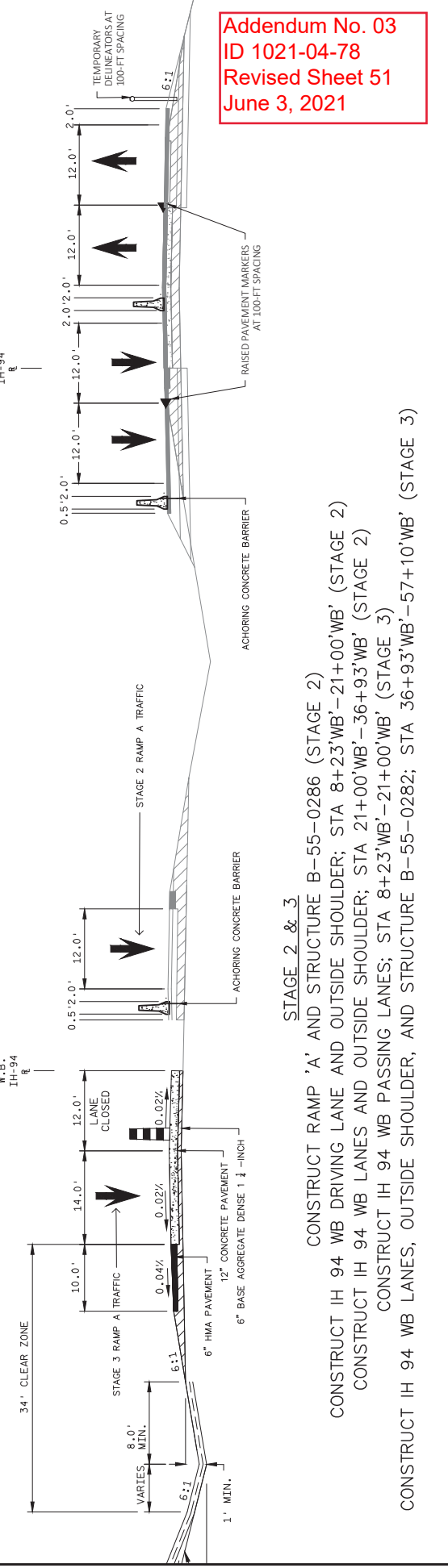

STAGE 2 & 3
 CONSTRUCT RAMP 'A' AND STRUCTURE B-55-0286 (STAGE 2)
 CONSTRUCT IH 94 WB DRIVING LANE AND OUTSIDE SHOULDER; STA 8+23'WB'-21+00'WB' (STAGE 2)
 CONSTRUCT IH 94 WB LANES AND OUTSIDE SHOULDER; STA 21+00'WB'-36+93'WB' (STAGE 2)
 CONSTRUCT IH 94 WB PASSING LANES; STA 8+23'WB'-21+00'WB' (STAGE 3)
 CONSTRUCT IH 94 WB LANES, OUTSIDE SHOULDER, AND STRUCTURE B-55-0282; STA 36+93'WB'-57+10'WB' (STAGE 3)

STAGE 1A:
 TRAFFIC
 SINGLE LANE CLOSURE ON I94 WB DURING OFF PEAK HOURS.
 SHIFT I94 EB TRAFFIC TO THE OUTSIDE, CLOSE INSIDE SHOULDERS.

CONSTRUCTION:
 CONSTRUCT I94WB CROSSOVERS AND WIDEN I94EB LANES.
 CONSTRUCT B-55-12 WIDENING.
 CONSTRUCT I94EB OUTSIDE WIDENING.
 CONSTRUCT RAMP A TEMPORARY WIDENING.

FOR ADDITIONAL TRAFFIC CONTROL DETAILS,
 SEE TRAFFIC CONTROL ADVANCED WARNING.

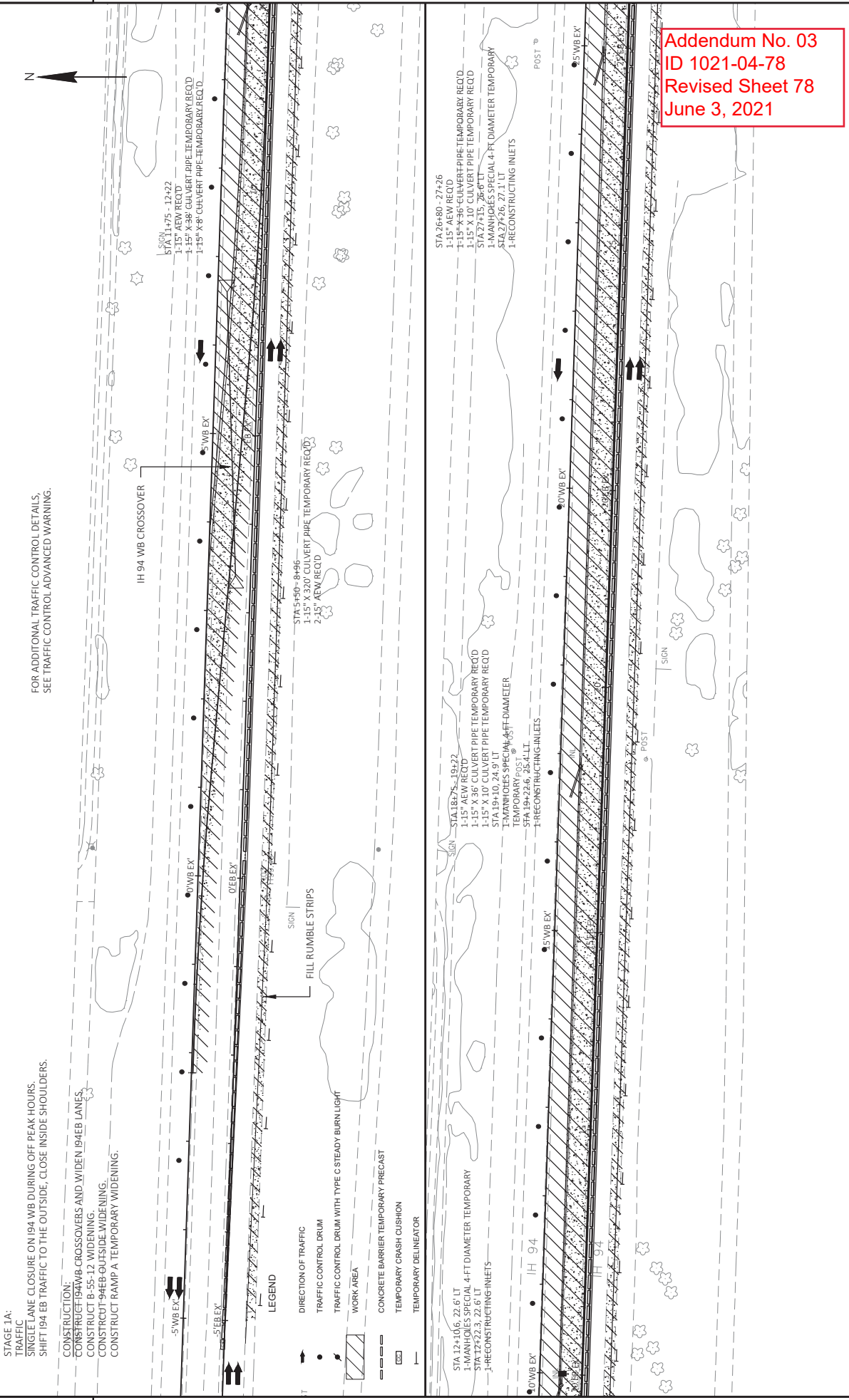

- LEGEND**
- ➔ DIRECTION OF TRAFFIC
 - TRAFFIC CONTROL DRUM
 - ▨ WORK AREA
 - ▭ CONCRETE BARRIER TEMPORARY PRECAST
 - ▭ TEMPORARY CRASH CUSHION
 - TEMPORARY DELINEATOR

- STA 12+10.6, 22.6' LT
- 1-MANHOLE SPECIAL 4-FT DIAMETER TEMPORARY
- STA 12+22.3, 22.6' LT
- 1-RECONSTRUCTING INLETS
- STA 18+75, 19+22
- 1-15' AEW REQ'D
- 1-15' X 36' CULVERT PIPE TEMPORARY REQ'D
- 1-15' X 10' CULVERT PIPE TEMPORARY REQ'D
- STA 19+10, 24.9' LT
- 1-MANHOLE SPECIAL 4-FT DIAMETER
- STA 19+24.8, 25.1' LT
- 1-RECONSTRUCTING INLETS
- STA 26+80, 27+26
- 1-15' AEW REQ'D
- 1-15' X 30' CULVERT PIPE TEMPORARY REQ'D
- 1-15' X 30' CULVERT PIPE TEMPORARY REQ'D
- STA 27+15, 26+FT
- 1-MANHOLE SPECIAL 4-FT DIAMETER TEMPORARY
- STA 27+26, 27+1' LT
- 1-RECONSTRUCTING INLETS

Addendum No. 03
 ID 1021-04-78
 Revised Sheet 78
 June 3, 2021

Addendum No. 03
 ID 1021-04-78
 Revised Sheet 79
 June 3, 2021

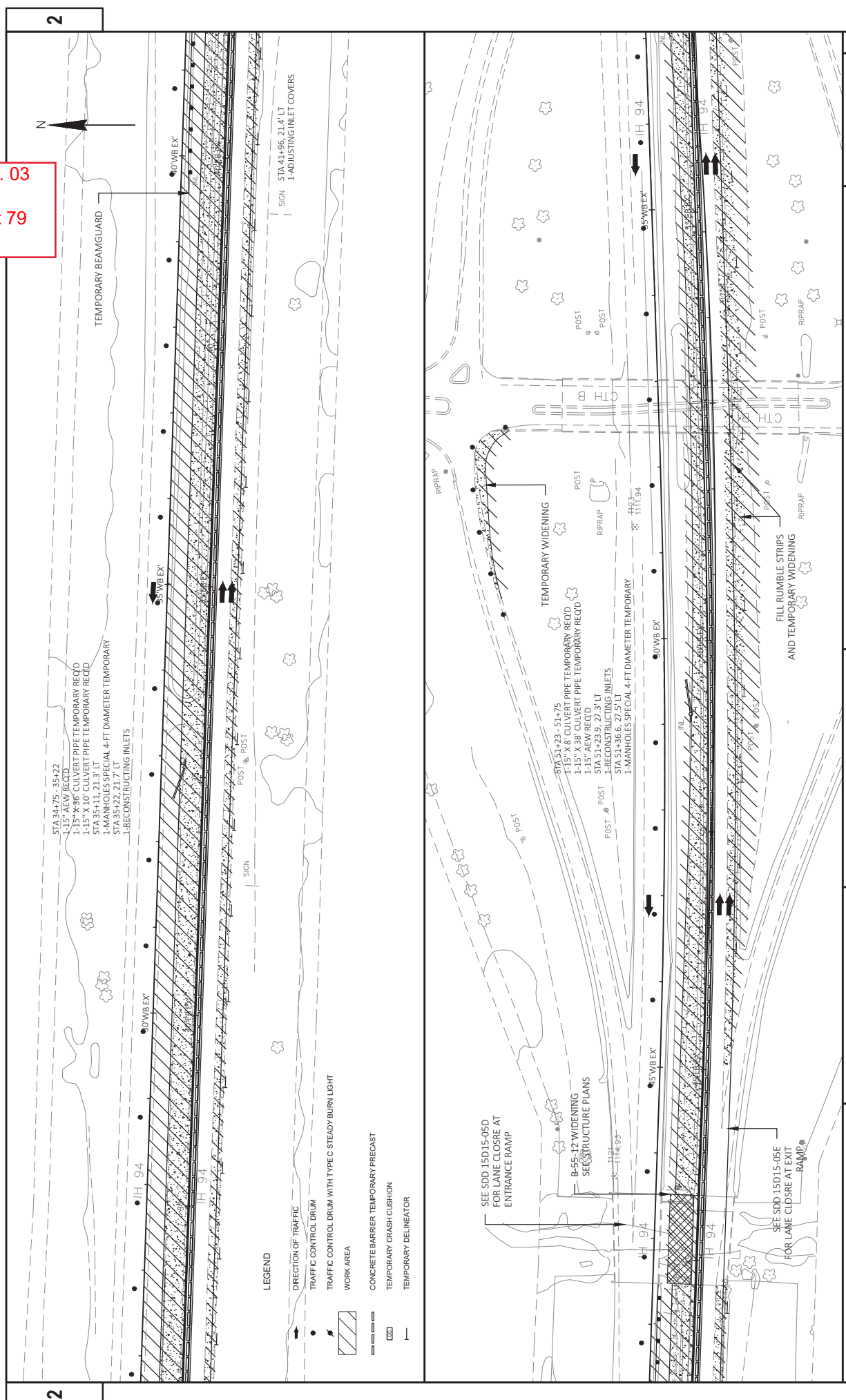

2

2

PROJECT NO: 1021-04-77 & 1021-04-78	COUNTY: ST. CROIX	TRAFFIC CONTROL STAGE 1A	SHEET 79	E
FILE NAME: C:\CSD\10210407\SHETPR\AND26001-53A\94-CTH-REVISED.DWG	LAYOUT NAME: 02	FLYBY: THAO, KOU	PLOT SCALE: 1 IN=100 FT	WISDOT/CADDS SHEET 44
HWY: IH 94	PLOT DATE: 5/27/2021 3:17 PM			

Addendum No. 03
 ID 1021-04-78
 Revised Sheet 80
 June 3, 2021

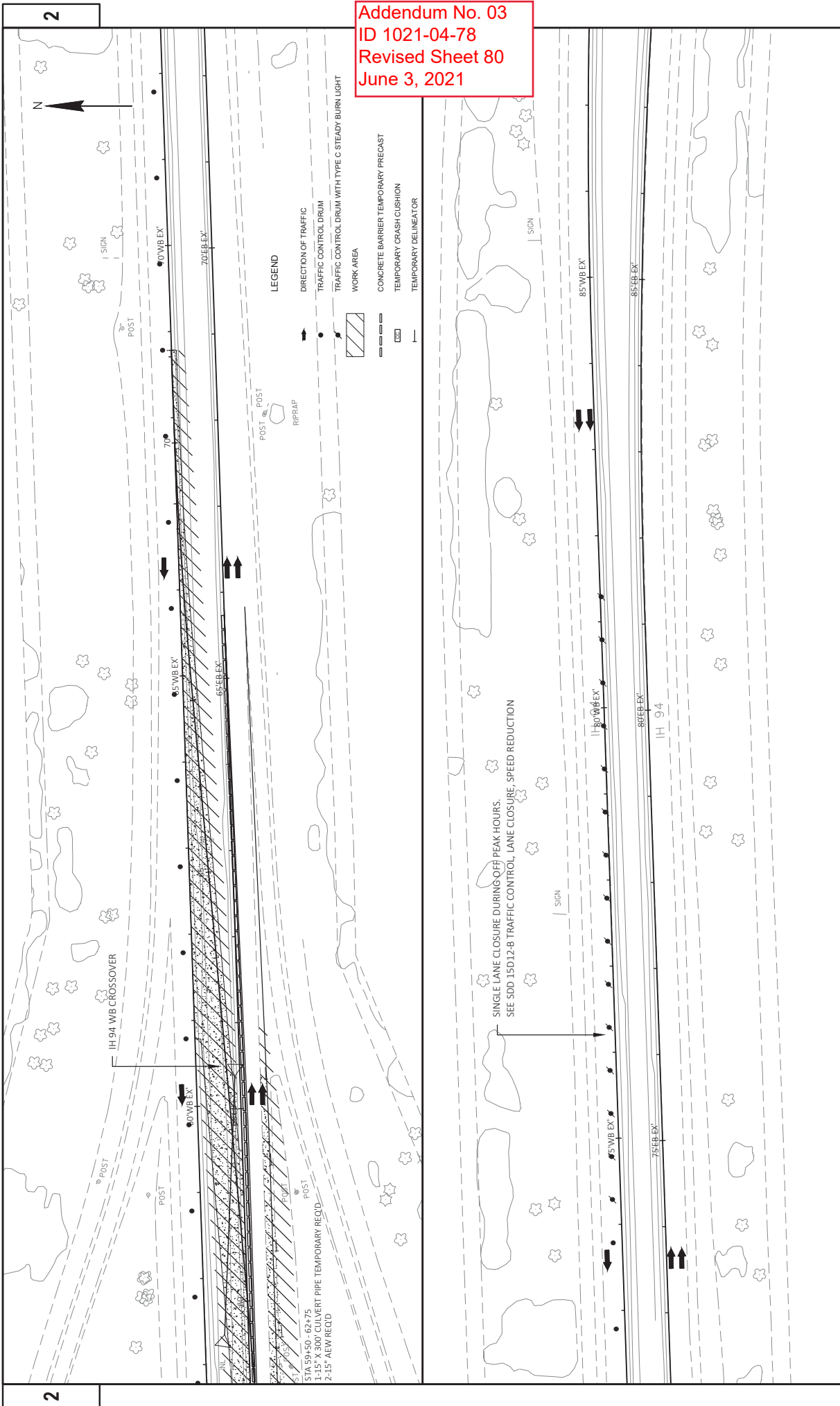

PROJECT NO: 1021-04-77 & 1021-04-78	HWY: IH 94	COUNTY: ST. CROIX	TRAFFIC CONTROL STAGE IA	SHEET 80	E
FILE NAME: C:\CROIX\210407\SHETS\PLAN\26001-53A\94-CTH-REVISED.DWG	LAYOUT NAME: 03	DATE: 5/27/2021 3:17 PM	BY: THAO, KOU	SCALE: 1 IN=100 FT	WISDOT/CADDIS SHEET 44

Addendum No. 03
ID 1021-04-78
Revised Sheet 146
June 3, 2021

REMOVING INLETS

CATEGORY	STATION	TO	STATION	LOCATION	LF	REMARKS	CATEGORY	STATION	LOCATION	EACH	REMARKS
0010	10+00'WB'	-	10+00'WB'	IH 94 WB			0010	10+00'WB'	IH 94 WB	1	MEDIAN
0010	17+00'WB'	-	17+00'WB'	IH 94 WB			0010	17+00'WB'	IH 94 WB	1	MEDIAN
0010	25+00'WB'	-	25+03'WB'	IH 94 WB			0010	25+03'WB'	IH 94 WB	1	MEDIAN
0010	33+00'WB'	-	39+72'WB'	IH 94 WB			0010	39+72'WB'	IH 94 WB	1	MEDIAN
TOTAL 0010										4	

REMOVING FENCE

CATEGORY	STATION	TO	STATION	LOCATION	LF	REMARKS
0010	8+23'WB'	-	51+90'WB'	IH 94 WB, RAMP A	4450	R/W FENCE
TOTAL 0010						4450

REMOVING SMALL PIPE CULVERTS

CATEGORY	STATION	LOCATION	REMARKS
0010	11+00'WB'	IH 94 WB	12-INCH, METAL PIPE, L = 76 FT
0010	17+00'WB'	IH 94 WB	24-INCH, METAL PIPE, L = 76 FT
0010	25+00'WB'	IH 94 WB	12-INCH, CONCRETE PIPE, L = 76 FT
0010	33+00'WB'	IH 94 WB	36-INCH, CONCRETE PIPE, L = 90 FT
0010	47+75'A	RAMP A	36x30-INCH, HORIZONTAL METAL PIPE, L = 105 FT
TOTAL 0010			5

REMOVING ASPHALTIC SURFACE MILLING

CATEGORY	STATION	TO	STATION	LOCATION	SY	REMARKS
0010	5+00	-	60+50	IH 94 EB OUTSIDE SHO	2680	STAGE 1, FILL RUMBLES
0010			PROJECT	IH 94	2270	STAGE 2, FILL RUMBLES
TOTAL 0010					4950	

EARTHWORK SUMMARY TABLE

CATEGORY	STATION	TO	STATION	LOCATION	CUT VOLUME		EXPANDED FILL		208.0100 BORROW		208.1100 SELECT BORROW		205.0100 EXCAVATION COMMON		205.0100 EXCAVATION SUITABLE		EXCAVATION BELOW SUBGRADE			
					CY	CY	CY	CY	CY	CY	CY	CY	CY	CY	CY	CY	CY	CY	CY	CY
010	0+00	-	71+08	IH 94 WB CROSSOVER	14697	576	0	14121	1055	0	1365	15747	13066	1050	1050					
010	48+60	-	61+50	IH 94 EB WIDENING	1958	231	0	1727	6	0	4615	5508	1721	3550	3550					
010	16+15	-	17+96	RAMP A, TEMP. WIDENING	98	25	0	73	6	0	0	98	67	0	0					
STAGE 1 SUBTOTALS					16753	832	0	15921	1067	0	5980	21353	14854	4600	4600					
010	8+23	-	36+94	IH 94 WB RAMP A	3546	1285	1035	1226	17494	16268	702	4086	0	540	540					
010	36+94	-	51+91	RAMP A	778	131	0	647	43794	43147	0	778	0	0	0					
STAGE 2 SUBTOTALS					4324	1416	1035	1873	61288	59415	702	4864	0	540	540					
010	36+94	-	57+10	IH 94 WB	15379	1800	1311	12288	966	0	0	15379	11302	0	0					
010	57+10	-	60+25	IH 94 WB, NEGORE	175	54	0	121	121	0	0	175	0	0	0					
STAGE 3 SUBTOTALS					15554	1854	1311	12389	1087	0	0	15554	11302	0	0					
Total					36631	4102	2346	30183	63442	59415	6682	41771	26156	5140	5140					

- (1) PAVEMENT (INCLUDES ASPHALT AND CONCRETE) IS INCLUDED IN THE QUANTITY OF EXCAVATION COMMON. PAVEMENT IS CONSIDERED SALVAGEABLE FOR OTHER PURPOSES AND IS NOT INCLUDED IN THE QUANTITY OF USEABLE MATERIAL.
- (2) USEABLE MATERIAL = EXCAVATION COMMON - EBS - PAVEMENT
- (3) SUITABLE WASTE IS SURPLUS MATERIAL SUITABLE FOR USE AS FILL THAT IS BEYOND THE VOLUME NEEDED FOR THE PROJECT.
- (4) UNSUITABLE WASTE = EBS
- (5) EXCAVATION BELOW SUBGRADE IS NOT USED TO BALANCE EARTHWORK. QUANTITY IS INCLUDED AND PAID FOR IN THE ITEM OF EXCAVATION COMMON.

PIPE UNDER DRAIN UNPERFORATED 6-INCH

RIEPPAR LIGHT

CONCRETE BARRIER

ACHORING CONCRETE BARRIER TEMPORARY PRECAST

CONCRETE BARRIER TEMPORARY PRECAST DELIVERED

CATEGORY	STATION	TO	STATION	LOCATION	LF	REMARKS
0010	5+00	-	66+00	IH 94 EB	7100	
0010	7+00	-	64+00	IH 94 WB & ON RAMP	5750	
0010	9+00	-	54+00	IH 94 WB/ENTRANCE RAMP	4550	
0010	00+00	-	71+00	IH 94 WB CROSSOVER	7100	
				TOTAL 0010	24500	

CATEGORY	STATION	TO	STATION	LOCATION	LF	REMARKS
0010	44+23'EB	-	44+23'EB	RT	4	AT FLUME
0010	44+23'EB	-	44+23'EB	RT	4	AT FLUME
0010	42+00'A	-	42+00'A	RT	4	AT FLUME
0010	11+00'WB	-	53' LT	IH 94 WB	2	AT AEW
0010	17+00'WB	-	64' LT	IH 94 WB	2	AT AEW
0010	25+00'WB	-	73' LT	IH 94 WB	2	AT AEW
0010	33+00'WB	-	82' LT	IH 94 WB	2	AT AEW
0010	45+64.3'A	-	49' LT	RAMP A	2	AT AEW
				TOTAL 0010	16	

CATEGORY	STATION	TO	STATION	LOCATION	CY	REMARKS
0010	44+23'EB	-	44+23'EB	RT	4	AT FLUME
0010	44+23'EB	-	44+23'EB	RT	4	AT FLUME
0010	42+00'A	-	42+00'A	RT	4	AT FLUME
0010	11+00'WB	-	53' LT	IH 94 WB	2	AT AEW
0010	17+00'WB	-	64' LT	IH 94 WB	2	AT AEW
0010	25+00'WB	-	73' LT	IH 94 WB	2	AT AEW
0010	33+00'WB	-	82' LT	IH 94 WB	2	AT AEW
0010	45+64.3'A	-	49' LT	RAMP A	2	AT AEW
				TOTAL 0010	16	

CATEGORY	STATION	TO	STATION	LOCATION	LF	REMARKS
0010	44+23'EB	-	44+23'EB	RT	4	AT FLUME
0010	44+23'EB	-	44+23'EB	RT	4	AT FLUME
0010	42+00'A	-	42+00'A	RT	4	AT FLUME
0010	11+00'WB	-	53' LT	IH 94 WB	2	AT AEW
0010	17+00'WB	-	64' LT	IH 94 WB	2	AT AEW
0010	25+00'WB	-	73' LT	IH 94 WB	2	AT AEW
0010	33+00'WB	-	82' LT	IH 94 WB	2	AT AEW
0010	45+64.3'A	-	49' LT	RAMP A	2	AT AEW
				TOTAL 0010	16	

CABLE BARRIER

CABLE BARRIER END TERMINAL

COVER PLATES TEMPORARY

ADJUSTING INLET COVERS

CATEGORY	STATION	TO	STATION	LOCATION	LF	REMARKS
0010	50+50	-	70+00	IH 94 WB	1850	
0010	49+75	-	70+00	IH 94 WB	1	
0010	70+00	-	70+00		1	
				TOTAL 0010	1850	

INLET

CATEGORY	STATION	TO	STATION	LOCATION	DEPTH	REMARKS
0010	10+00'WB	-	1192.95		3.50	1 25.4' RT
0010	17+00'WB	-	1178.75		3.50	1 31.5' RT
0010	25+00'WB	-	1155.75		3.60	1 29.8' RT
				TOTAL 0010	3	

RECONSTRUCTING INLETS

CATEGORY	STATION	TO	STATION	LOCATION	ELEVATION	DEPTH	REMARKS
0010	12+22.3	-	22.6' LT	IH 94 MEDIAN	1191.17	2.10	1
0010	19+22.6	-	25.4' LT	IH 94 MEDIAN	1178.90	2.90	1
0010	27+25	-	27.1' LT	IH 94 MEDIAN	1156.25	2.65	1
0010	35+10	-	21.3' LT	IH 94 MEDIAN	1130.50	4.20	1
0010	51+23.9	-	27.3' LT	IH 94 MEDIAN	1107.92	2.50	1
				TOTAL 0010			5

Addendum No. 03
 ID 1021-04-78
 Revised Sheet 149
 June 3, 2021

TEMPORARY GUARDRAIL

CATEGORY	STATION	TO	STATION	LOCATION	LF	REMARKS
0010	39+56'WB EX	-	42+47'WB EX	IH 94 WB	240	STAGE 1A
					TOTAL 0010	240
					TOTAL	1

CRASH CUSHIONS TEMPORARY

CATEGORY	STATION	LOCATION	BACK WIDTH FT	OBJECT MARKING PATTERN	CRASH TEST LEVEL	TRAFFIC DIRECTION	TRAFFIC LOCATION	CRASH CUSHION SHIELDS	REMARKS
0010	-5+00	IH 94 EB	1	OM-3L	TL-3	UNIDIRECTIONAL	LT	END OF TEMP. BARRIER	STAGE 1B
0010	64+20	IH 94 WB	1	OM-3R	TL-3	UNIDIRECTIONAL	RT	END OF TEMP. BARRIER	STAGE 2-3
0010	71+07	IH 94 WB	1	OM-3L	TL-3	UNIDIRECTIONAL	LT	END OF TEMP. BARRIER	STAGE 2-3
					TOTAL 0010				3

SALVAGED RAIL

CATEGORY	STATION	TO	STATION	LOCATION	LF	REMARKS
0010	43+54'WB	-	46+22'WB	IH 94 WB, RT	270	
0010	43+54'WB	-	44+83'WB	IH 94 WB, LT	130	
0010	43+54'WB	-	43+57'WB	MEDIAN	30	
0010	51+74'WB	-	53+67'WB	MEDIAN	410	
0010	53+03'WB	-	CTH B		70	110' LT, EXIT END
					TOTAL 0010	910

RESTORATION

CATEGORY	STATION	TO	STATION	LOCATION	SY	SALVAGED TOPSOIL	MULCHING	EROSION MAT CLASS 1 TYPE B	FERTILIZER TYPE B CWT	SEEDING MIXTURE NO. 30	SEEDING TEMPORARY	SEED WATER	REMARKS
0010	8+23'WB	-	42+28'WB	IH 94 WB	14370	625.0500	627.0200	628.2002	9.1	260	390	80	STAGE 2
0010	49+50'A	-	52+40'A	RAMP A, RT	1215				0.8	25	35	7	STAGE 2
0010	43+64'A	-	51+92'A	RAMP A, LT	4855				3.1	90	130	27	STAGE 2
0010	43+64'A	-	49+50'A	RAMP A, RT	3100				2.0	55	85	17	STAGE 2
0010	0+00	-	71+00	IH 94 WB CROSSOVER	5250				3.3	-	140	30	STAGE 1
0010	49+00	-	62+00	IH 94 EB WIDENING	1330				0.8	-	35	8	STAGE 1
0010	41+00'WB EX	-	60+00'WB EX	IH 94 WB	8410		6560	1850	5.3	150	230	47	STAGE 3
0010	PROJECT	-	PROJECT	IH 94	3850		2215	1640	2.6	60	105	735	UNDISTRIBUTED
					TOTAL 0010	42380	24360	18025	27	640	1150	735	238

WATER

CATEGORY	STATION	TO	STATION	LOCATION	MGAL	REMARKS
0010	0+00	-	71+08	IH 94 WB CROSSOVER	148	STAGE 1 - BASE AGG/DUST CONTROL
0010	48+60	-	61+50	IH 94 EB WIDENING	20	STAGE 1 - BASE AGG/DUST CONTROL
0010	16+15	-	17+96	RAMP A, TEMP WIDENING	2	STAGE 1 - BASE AGG/DUST CONTROL
0010	8+23	-	36+94	IH 94 WB	52	STAGE 2 - BASE AGG/DUST CONTROL
0010	36+94	-	51+91	RAMP A	36	STAGE 2 - BASE AGG/DUST CONTROL
0010	36+94	-	57+10	IH 94 WB	71	STAGE 3 - BASE AGG/DUST CONTROL
0010	57+10	-	60+25	IH 94 WB, NEGORE	4	STAGE 3 - BASE AGG/DUST CONTROL
					TOTAL 0010	333

SILTENCE

CATEGORY	STATION	TO	STATION	LOCATION	LF	REMARKS
0010	8+23'WB	-	42+28'WB	IH 94 WB	3460	STAGE 1
0010	43+64'A	-	51+92'A	RAMP A, LT	890	STAGE 1
0010	PROJECT	-	PROJECT	IH 94	435	UNDISTRIBUTED
					TOTAL 0010	4785

Addendum No. 03
ID 1021-04-78
Revised Sheet 150
June 3, 2021



Proposal Schedule of Items

Proposal ID: 20210608009 Project(s): 1021-00-78, 1021-00-79, 1021-04-77, 1021-04-78

Federal ID(s): N/A, N/A, N/A, N/A

SECTION: 0001 Contract Items

Alt Set ID: Alt Mbr ID:

Proposal Line Number	Item ID Description	Approximate Quantity and Units	Unit Price	Bid Amount
0002	201.0105 Clearing	74.000 STA	_____.	_____.
0004	201.0205 Grubbing	74.000 STA	_____.	_____.
0006	203.0100 Removing Small Pipe Culverts	14.000 EACH	_____.	_____.
0008	203.0200 Removing Old Structure (station) 02. 158+31.35 WB	LS	LUMP SUM	_____.
0010	203.0200 Removing Old Structure (station) 03. 160+50.91	LS	LUMP SUM	_____.
0012	203.0200 Removing Old Structure (station) 04. 42+48	LS	LUMP SUM	_____.
0014	203.0200 Removing Old Structure (station) 05. 158+25.29 EB	LS	LUMP SUM	_____.
0016	203.0600.S Removing Old Structure Over Waterway With Minimal Debris (station) 01. 42+50	LS	LUMP SUM	_____.
0018	203.0600.S Removing Old Structure Over Waterway With Minimal Debris (station) 02. 43+00	LS	LUMP SUM	_____.
0020	204.0100 Removing Concrete Pavement	39,552.000 SY	_____.	_____.
0022	204.0120 Removing Asphaltic Surface Milling	5,880.000 SY	_____.	_____.
0024	204.0155 Removing Concrete Sidewalk	18.000 SY	_____.	_____.
0026	204.0165 Removing Guardrail	1,835.000 LF	_____.	_____.
0028	204.0170 Removing Fence	11,890.000 LF	_____.	_____.
0030	204.0180 Removing Delineators and Markers	14.000 EACH	_____.	_____.



Proposal Schedule of Items

Proposal ID: 20210608009 Project(s): 1021-00-78, 1021-00-79, 1021-04-77, 1021-04-78

Federal ID(s): N/A, N/A, N/A, N/A

SECTION: 0001 Contract Items

Alt Set ID: Alt Mbr ID:

Proposal Line Number	Item ID Description	Approximate Quantity and Units	Unit Price	Bid Amount
0092	455.0605 Tack Coat	5,970.000 GAL	_____.	_____.
0094	460.2000 Incentive Density HMA Pavement	7,480.000 DOL	1.00000	7,480.00
0096	460.6223 HMA Pavement 3 MT 58-28 S	6,938.000 TON	_____.	_____.
0098	460.6224 HMA Pavement 4 MT 58-28 S	3,865.000 TON	_____.	_____.
0100	460.6244 HMA Pavement 4 MT 58-34 S	880.000 TON	_____.	_____.
0102	465.0110 Asphaltic Surface Patching	1,155.000 TON	_____.	_____.
0104	465.0125 Asphaltic Surface Temporary	24,705.000 TON	_____.	_____.
0106	465.0315 Asphaltic Flumes	10.000 SY	_____.	_____.
0108	465.0400 Asphaltic Shoulder Rumble Strips	16,900.000 LF	_____.	_____.
0110	501.1000.S Ice Hot Weather Concreting	24,830.000 LB	_____.	_____.
0112	502.0100 Concrete Masonry Bridges	4,178.000 CY	_____.	_____.
0114	502.3200 Protective Surface Treatment	5,643.000 SY	_____.	_____.
0116	502.3210 Pigmented Surface Sealer	979.000 SY	_____.	_____.
0118	502.4205 Adhesive Anchors No. 5 Bar	42.000 EACH	_____.	_____.
0120	503.0128 Prestressed Girder Type I 28-Inch	2,590.000 LF	_____.	_____.
0122	503.0137 Prestressed Girder Type I 36W-Inch	1,855.000 LF	_____.	_____.
0124	504.0100 Concrete Masonry Culverts	101.000 CY	_____.	_____.



Proposal Schedule of Items

Proposal ID: 20210608009 Project(s): 1021-00-78, 1021-00-79, 1021-04-77, 1021-04-78

Federal ID(s): N/A, N/A, N/A, N/A

SECTION: 0001 Contract Items

Alt Set ID: Alt Mbr ID:

Proposal Line Number	Item ID Description	Approximate Quantity and Units	Unit Price	Bid Amount
0180	531.1100 Concrete Masonry Ancillary Structures Type NS	7.000 CY	_____.	_____.
0182	531.1140 Steel Reinforcement HS Ancillary Structures Type NS	870.000 LB	_____.	_____.
0184	550.0020 Pre-Boring Rock or Consolidated Materials	1,470.000 LF	_____.	_____.
0186	550.0500 Pile Points	191.000 EACH	_____.	_____.
0188	550.1120 Piling Steel HP 12-Inch X 53 Lb	3,315.000 LF	_____.	_____.
0190	550.2106 Piling CIP Concrete 10 3/4 X 0.365-Inch	8,140.000 LF	_____.	_____.
0192	601.0576 Concrete Curb & Gutter 4-Inch Sloped 30-Inch Type J	50.000 LF	_____.	_____.
0194	601.0590 Concrete Curb & Gutter 4-Inch Sloped 36-Inch Type TBTT	560.000 LF	_____.	_____.
0196	602.0405 Concrete Sidewalk 4-Inch	160.000 SF	_____.	_____.
0198	603.8000 Concrete Barrier Temporary Precast Delivered	48,850.000 LF	_____.	_____.
0200	603.8125 Concrete Barrier Temporary Precast Installed	65,050.000 LF	_____.	_____.
0202	603.8500 Anchoring Concrete Barrier Temporary Precast	25,325.000 LF	_____.	_____.
0204	603.8505 Anchoring Concrete Barrier Temporary Precast on Bridge Decks	205.000 LF	_____.	_____.
0206	604.0500 Slope Paving Crushed Aggregate	1,380.000 SY	_____.	_____.



Proposal Schedule of Items

Proposal ID: 20210608009 Project(s): 1021-00-78, 1021-00-79, 1021-04-77, 1021-04-78

Federal ID(s): N/A, N/A, N/A, N/A

SECTION: 0001 Contract Items

Alt Set ID: Alt Mbr ID:

Proposal Line Number	Item ID Description	Approximate Quantity and Units	Unit Price	Bid Amount
0208	606.0100 Riprap Light	70.000 CY	_____.	_____.
0210	606.0300 Riprap Heavy	2,068.000 CY	_____.	_____.
0212	611.0430 Reconstructing Inlets	6.000 EACH	_____.	_____.
0214	611.0642 Inlet Covers Type MS	12.000 EACH	_____.	_____.
0216	611.3901 Inlets Median 1 Grate	8.000 EACH	_____.	_____.
0218	611.3902 Inlets Median 2 Grate	2.000 EACH	_____.	_____.
0220	611.8115 Adjusting Inlet Covers	1.000 EACH	_____.	_____.
0222	611.8120.S Cover Plates Temporary	7.000 EACH	_____.	_____.
0224	612.0206 Pipe Underdrain Unperforated 6-Inch	600.000 LF	_____.	_____.
0226	612.0406 Pipe Underdrain Wrapped 6-Inch	1,220.000 LF	_____.	_____.
0228	613.1100.S Cable Barrier Type 1	4,175.000 LF	_____.	_____.
0230	613.1200.S Cable Barrier End Terminal Type 1	4.000 EACH	_____.	_____.
0232	614.0150 Anchor Assemblies for Steel Plate Beam Guard	24.000 EACH	_____.	_____.
0234	614.0220 Steel Thrie Beam Bullnose Terminal	3.000 EACH	_____.	_____.
0236	614.0230 Steel Thrie Beam	253.000 LF	_____.	_____.
0238	614.0360 Steel Plate Beam Guard Temporary	480.000 LF	_____.	_____.



Proposal Schedule of Items

Proposal ID: 20210608009 Project(s): 1021-00-78, 1021-00-79, 1021-04-77, 1021-04-78

Federal ID(s): N/A, N/A, N/A, N/A

SECTION: 0001 Contract Items

Alt Set ID: Alt Mbr ID:

Proposal Line Number	Item ID Description	Approximate Quantity and Units	Unit Price	Bid Amount
0240	614.0380 Steel Plate Beam Guard Energy Absorbing Terminal Temporary	2.000 EACH	_____.	_____.
0242	614.0905 Crash Cushions Temporary	11.000 EACH	_____.	_____.
0244	614.0920 Salvaged Rail	1,366.000 LF	_____.	_____.
0246	614.2300 MGS Guardrail 3	4,738.000 LF	_____.	_____.
0248	614.2500 MGS Thrie Beam Transition	576.000 LF	_____.	_____.
0250	614.2610 MGS Guardrail Terminal EAT	10.000 EACH	_____.	_____.
0252	614.2620 MGS Guardrail Terminal Type 2	12.000 EACH	_____.	_____.
0254	616.0100 Fence Woven Wire (height) 01. 4-FT	11,630.000 LF	_____.	_____.
0256	618.0100 Maintenance And Repair of Haul Roads (project) 01. 1021-00-78	1.000 EACH	_____.	_____.
0258	618.0100 Maintenance And Repair of Haul Roads (project) 02. 1021-00-79	1.000 EACH	_____.	_____.
0260	618.0100 Maintenance And Repair of Haul Roads (project) 03. 1021-04-77	1.000 EACH	_____.	_____.
0262	618.0100 Maintenance And Repair of Haul Roads (project) 04. 1021-04-78	1.000 EACH	_____.	_____.
0264	619.1000 Mobilization	1.000 EACH	_____.	_____.
0266	620.0300 Concrete Median Sloped Nose	14.000 SF	_____.	_____.
0268	624.0100 Water	918.000 MGAL	_____.	_____.

