



Wisconsin Department of Transportation

October 21, 2021

Division of Transportation Systems Development

Bureau of Project Development
4822 Madison Yards Way, 4th Floor South
Madison, WI 53705

Telephone: (608) 266-1631
Facsimile (FAX): (608) 266-8459

NOTICE TO ALL CONTRACTORS:

Proposal #01: 1074-00-71
La Crosse – Sparta
STH 27 Interchange Area
IH 90
Monroe County

1077-02-74, WISC 2022001
Sparta - Tomah
STH 16 Interchange & B-41-91
IH 90
Monroe County

5140-05-60, WISC 2022005
Cashton – Sparta
CP RR & La Crosse R Br B-41-11/12
STH 27
Monroe County

Letting of November 9, 2021

This is Addendum No. 01, which provides for the following:

Plan Sheets:

Added Plan Sheets	
Plan Sheet	Plan Sheet Title (brief description of why sheet was added)
24A-C	(1074-00-71) Traffic Control Detour (Missing from plan)

The responsibility for notifying potential subcontractors and suppliers of these changes remains with the prime contractor.

Sincerely,

Mike Coleman

Proposal Development Specialist
Proposal Management Section

END OF ADDENDUM

Addendum No. 01
 ID 1074-00-71
 Added Sheet 24A
 October 21, 2021

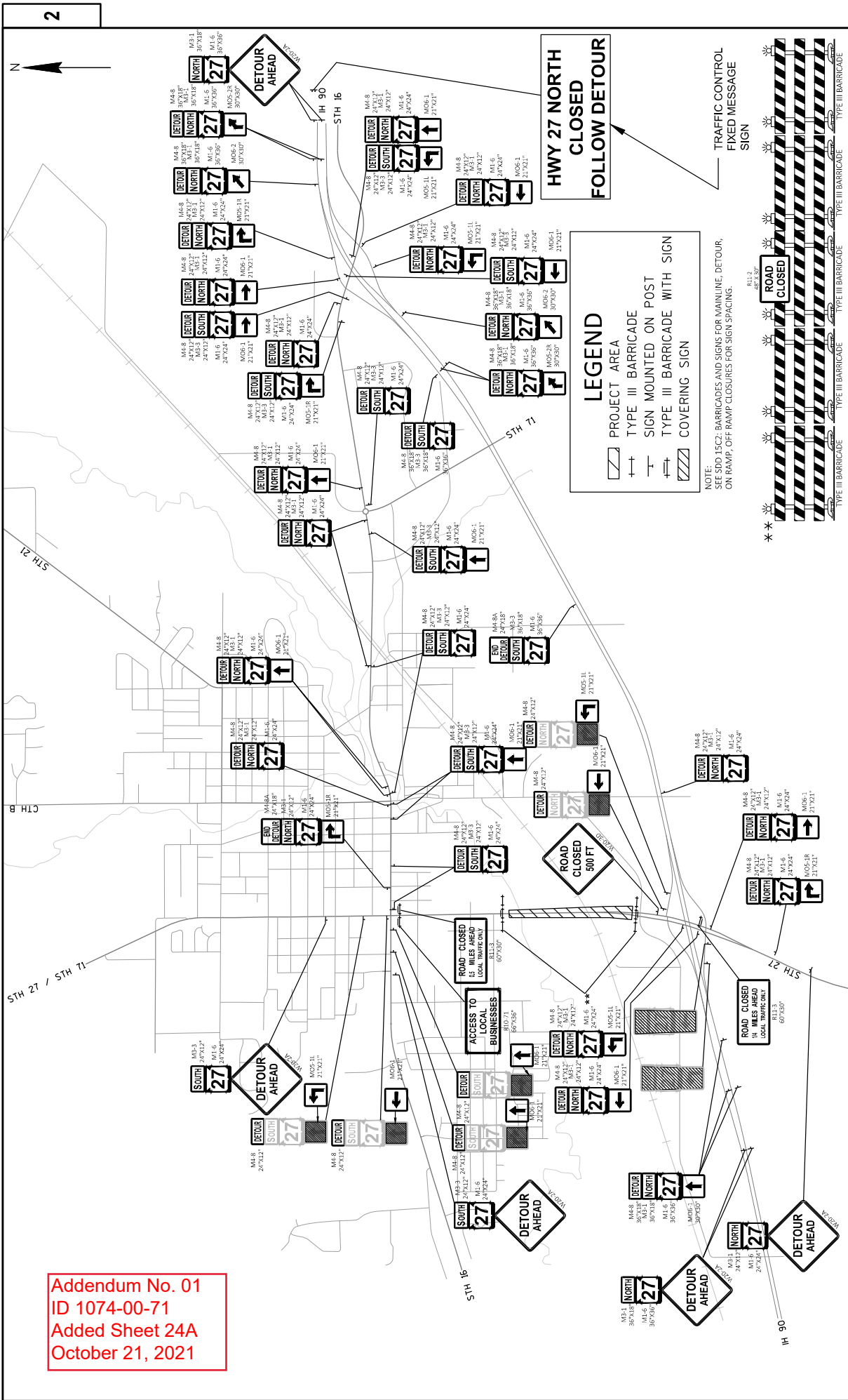

LEGEND

- PROJECT AREA
- TYPE III BARRICADE
- SIGN MOUNTED ON POST
- TYPE III BARRICADE WITH SIGN COVERING SIGN

NOTE:
 SEE SD-15C2 BARRICADES AND SIGNS FOR MAINLINE, DETOUR,
 ON RAMP, OFF RAMP CLOSURES FOR SIGN SPACINGS.

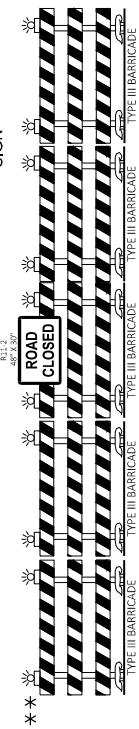

Addendum No. 01
 ID 1074-00-71
 Added Sheet 24B
 October 21, 2021

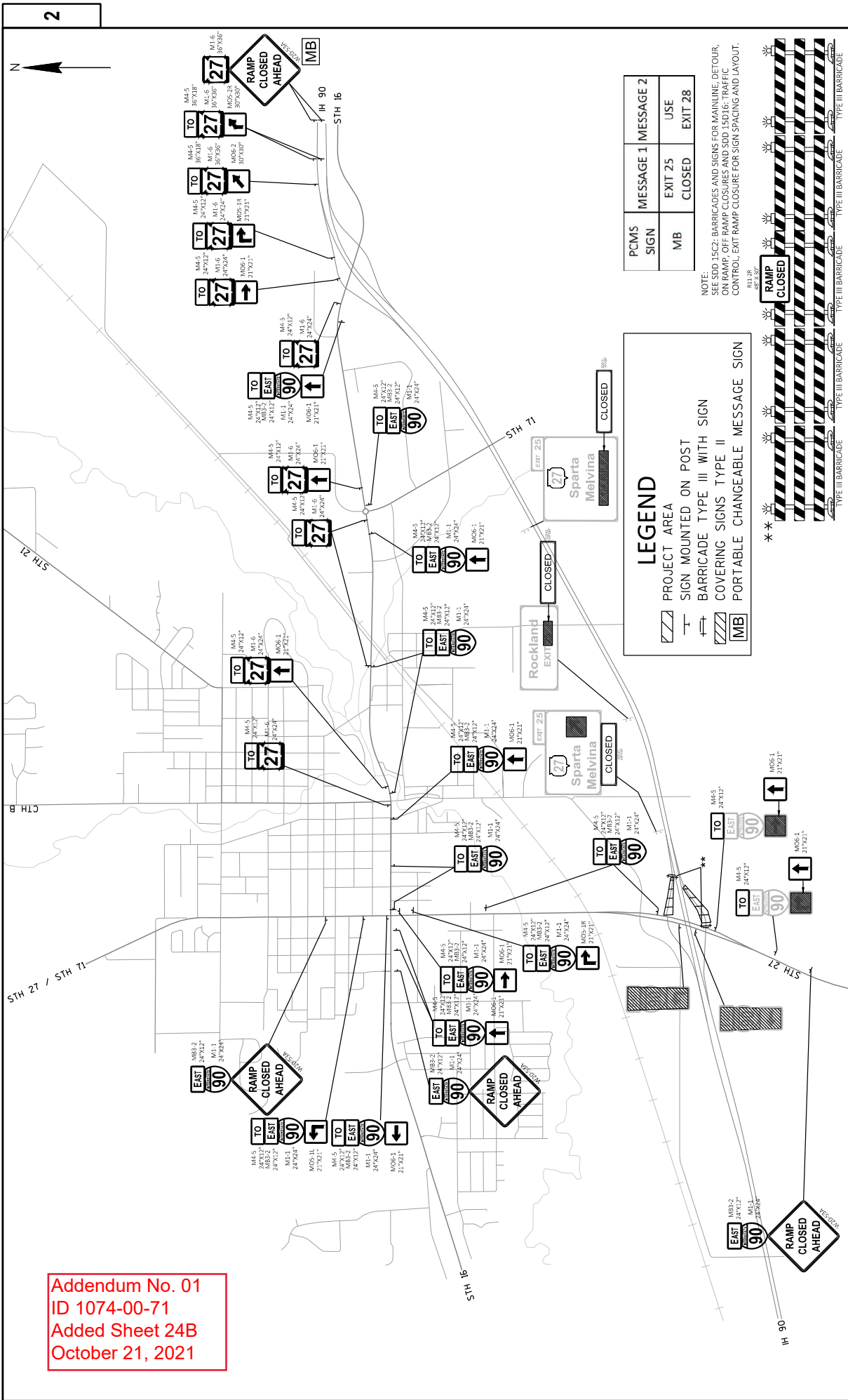

Addendum No. 01
 ID 1074-00-71
 Added Sheet 24C
 October 21, 2021

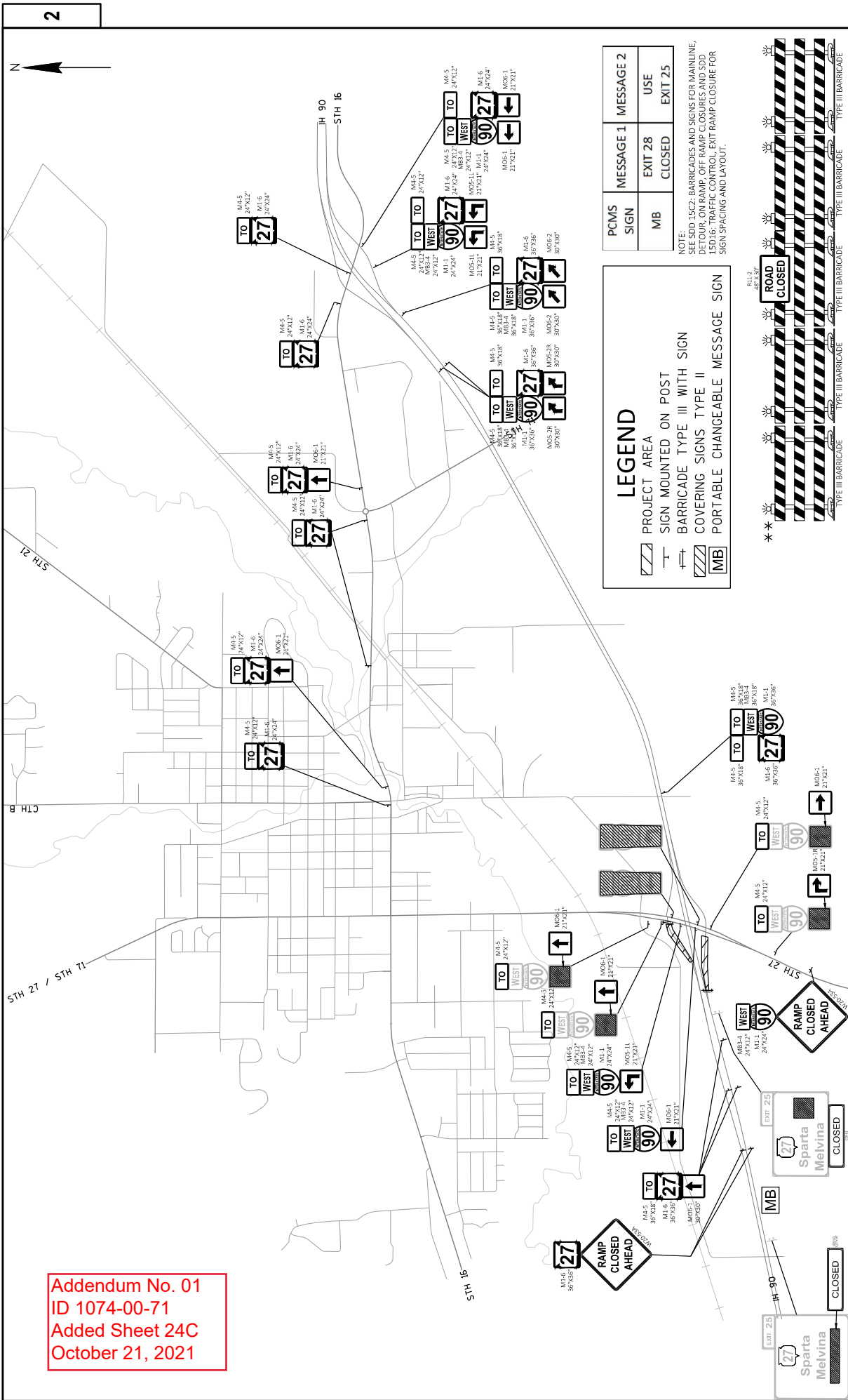

PCMS SIGN	MESSAGE 1	MESSAGE 2
MB	EXIT 28	CLOSED
	USE	EXIT 25

NOTE:
 SEE SDD 15C2: BARRICADES AND SIGNS FOR MAINLINE,
 DETOUR, ON RAMP, OFF RAMP CLOSURES AND SDD
 15D16: TRAFFIC CONTROL, EXIT RAMP CLOSURE FOR
 SIGN SPACING AND LAYOUT.

LEGEND

- PROJECT AREA
- SIGN MOUNTED ON POST
- BARRICADE TYPE III WITH SIGN
- COVERING SIGNS TYPE II
- PORTABLE CHANGEABLE MESSAGE SIGN

