



# Wisconsin Department of Transportation

## Division of Transportation Systems Development

Bureau of Project Development  
4822 Madison Yards Way, 4<sup>th</sup> Floor South  
Madison, WI 53705

November 5, 2021

Telephone: (608) 266-1631  
Facsimile (FAX): (608) 266-8459

### NOTICE TO ALL CONTRACTORS:

**Proposal #09: 1229-04-76, WISC 2022007**  
**I-43 North South Freeway**  
**Highland Rd to STH 60**  
**IH 43**  
**Ozaukee County**

### Letting of November 09, 2021

This is Addendum No. 03, which provides for the following:

#### Special Provisions:

Revised Special Provisions	
Article No.	Description
189	Compost, Item SPV.0180.0102

Added Special Provisions	
Article No.	Description
195	Exposing Existing Infrastructure Paved Area, Item SPV.0060.0970
196	Exposing Existing Infrastructure Unpaved Area, Item SPV.0060.0975
197	Salvaged Rail and Guardrail End Treatments

Deleted Special Provisions	
Article No.	Description
55	Removing Concrete Surface Partial Depth, Item 204.0109.S

#### Schedule of Items:

Revised Bid Item Quantities					
Bid Item	Item Description	Unit	Old Quantity	Revised Quantity	Proposal Total
204.9090.S.0005	Removing Temporary Precast Trench Drain	LF	2,957	-92	2,865
209.0200.S	Backfill Controlled Low Strength	CY	2,137	-700	1,437
520.8000	Concrete Collars for Pipe	EA	309	5	314
522.0124	Culvert Pipe Reinforced Concrete Class III 24-Inch	LF	715	-71	644

522.0136	Culvert Pipe Reinforced Concrete Class III 36-Inch	LF	363	-93	270
522.1015	Apron Endwalls for Culvert Pipe Reinforced Concrete 15-Inch	EA	11	1	12
522.1024	Apron Endwalls for Culvert Pipe Reinforced Concrete 24-Inch	EA	46	-2	44
522.1030	Apron Endwalls for Culvert Pipe Reinforced Concrete 30-Inch	EA	28	-2	26
522.1048	Apron Endwalls for Culvert Pipe Reinforced Concrete 48-Inch	EA	4	4	8
608.0330	Storm Sewer Pipe Reinforced Concrete Class III 30-Inch	LF	575	-198	377
608.0415	Storm Sewer Pipe Reinforced Concrete Class IV 15-Inch	LF	48	180	228
608.0418	Storm Sewer Pipe Reinforced Concrete Class IV 18-Inch	LF	6,482	25	6507
608.0448	Storm Sewer Pipe Reinforced Concrete Class IV 48-Inch	LF	16	182	198
611.0612	Inlet Covers Type C	EA	10	1	11
611.2007	Manholes 7-FT Diameter	EA	4	1	5
643.1205.S	Basic Traffic Queue Warning System	DAY	300	1200	1500
SPV.0060.8015	Pipe Connection to Existing Structure	EA	13	3	16
SPV.0090.8036	Temporary Precast Trench Drain	LF	2,957	-92	2,865

<b>Added Bid Item Quantities</b>					
Bid Item	Item Description	Unit	Old Quantity	Revised Quantity	Proposal Total
522.0148	Culvert Pipe Reinforced Concrete Class III 48-Inch	LF	0	88	88
522.0436	Culvert Pipe Reinforced Concrete Class IV 36-Inch	LF	0	58	58
614.0920	Salvaged Rail	LF	0	5,331	5,331
614.0925	Salvaged Guardrail End Treatments	EA	0	7	7
SPV.0060.0970	Exposing Existing Infrastructure Paved Area	EA	0	10	10

<b>Deleted Bid Item Quantities</b>					
Bid Item	Item Description	Unit	Old Quantity	Revised Quantity	Proposal Total
204.0109.S	Removing Concrete Surface Partial Depth	SF	50,000	-50,000	0
204.0165	Removing Guardrail	LF	5,331	-5,331	0

**Plan Sheets:**

<b>Revised Plan Sheets</b>	
Plan Sheet	Plan Sheet Title (brief description of changes to sheet)
93	Removal Plan – Legend (Bid item change)
467	Temporary Drainage Plan Stages 1 & 2 (Revision for outfall of trench drain)
488	Temporary Drainage Plan Stages 1 & 2 (Revision for outfall of trench drain)
553	Proposed Drainage Plan – Added field inlet in median.
554	Proposed Drainage Plan – Revised profile view of upsized culverts.
1097	Miscellaneous Quantities (Deleted item)
1098	Miscellaneous Quantities (Deleted one item and added two items)
1104	Miscellaneous Quantities (Revised quantity)
1119	Miscellaneous Quantities (Revised quantities)

1123	Drainage Quantities – Revised apron endwalls.
1127	Drainage Quantities – Revised apron endwall totals.
1131	Drainage Quantities – Revised inlet covers.
1135	Drainage Quantities – Revised inlet cover totals.
1139	Drainage Quantities – Revised drainage structures.
1143	Drainage Quantities – Revised drainage structure totals.
1146	Drainage Quantities – Revised culvert pipes.
1149	Drainage Quantities – Revised culvert pipe totals.
1152	Drainage Quantities – Revised storm sewer pipes.
1155	Drainage Quantities – Revised storm sewer pipe totals.
1201	Miscellaneous Quantities (Revised quantity)
1204	Miscellaneous Quantities (Added two items)

The responsibility for notifying potential subcontractors and suppliers of these changes remains with the prime contractor.

Sincerely,

*Mike Coleman*

Proposal Development Specialist  
Proposal Management Section

**ADDENDUM NO. 03**

**1229-04-76**

**November 5, 2021**

**Special Provisions**

**55. DELETED**

**189. Compost, Item SPV.0180.0102**

*Replace entire section titled C Construction with the following:*

**C Construction**

**C.1 Placement**

Place 4-inches of compost on top of the riprap and fill the riprap voids with compost by lightly tamping to provide a stable planting medium, as shown on the plan, and overseed with seed mix and fertilizer as specified.

**195. Exposing Existing Infrastructure Paved Area, Item SPV.0060.0970.**

**A Description**

This work includes locating and exposing existing infrastructure in paved areas as directed by the engineer. The contractor shall be responsible for compliance with s.182.0175 (2), Stats., with respect to precautions to be taken to avoid and prevent damage to utility facilities. The location of existing utilities and infrastructure needed to complete the contract work shall be addressed independent of this provision. Conform to Wisconsin State Statute 182.0175 (2) and Wisconsin Administrative code Trans 220. The work includes exposing existing infrastructure, including utilities, under paved surfaces and providing both lateral and depth measurements for use in determining potential infrastructure conflict solutions, and backfilling.

**B Materials**

**B.1 Backfill Slurry**

Utilize backfill slurry as specified elsewhere in these special provisions.

**C Construction**

**C.1 General**

The location of existing utilities and infrastructure needed to complete the contract work shall be addressed independent of this provision. This item will only be used as determined by the department for unique locations as directed by the engineer. It does not remove the contractor's obligation to locate utilities as specified by Wisconsin Administrative code Trans 220 and Wisconsin State Statute 182.0175. The engineer will direct all exposing existing infrastructure in writing. Coordinate infrastructure exposures with the engineer and notify the infrastructure owner or their agents of this work two working days in advance so that they may be present when the work commences.

**C.2 Excavation**

Remove all paved surfaces at locations where the existing infrastructure is being exposed. Saw or remove concrete and asphaltic pavements to the nearest joint. Remove all pavement surfaces in such a way that all existing edges consist of a true line having a perpendicular edge with no unraveling. Maintain drainage at all times in accordance to standard spec 205.3.3. Take precautions, including temporary shoring, in order to prevent any undermining of the existing roadway. Perform work in accordance to all applicable laws, ordinances, rules, regulations, and OSHA standards.

Expose all infrastructure locations within a given location to a minimum depth of 18-inches below the bottom of each infrastructure. Excavate in a manner that protects the integrity of the infrastructure and prevents any damage to wrappings or protective coatings such as by any mechanical method or hand digging. Notify the infrastructure owner promptly if damage or interruption of service occurs. Repair all damage caused to such infrastructure resulting from negligence or carelessness at own expense.

Take all lateral and depth measurements in US feet and tenths thereof. Identify horizontal locations of each exposed infrastructure with a coordinate northing and easting referenced to the Wisconsin County Coordinate System (WCCS), Ozaukee County, NAD 83 (2007). Provide vertical elevations for each exposed infrastructure and reference to NAVD 88 (2007).

The infrastructure location shall remain exposed and available for visual inspection until the completion of all work in a given location. If the infrastructure shall remain exposed overnight or for prolonged periods of time, protect the location with traffic-rated steel plating, safety barriers, and all necessary traffic control devices that may be required under applicable standards or as directed by the engineer.

### **C.3 Backfilling**

Upon completion of the infrastructure exposure, restore the location in kind to its original condition. When exposed infrastructure locations fall within local streets or city right-of-way, use backfill slurry to fill the entire location to the subgrade elevation.

Restore concrete pavement and concrete base course to the depth found in the existing roadway. Replace all locations that fall within live lanes of any roadway or pedestrian traffic with a high early-strength concrete pavement mix design having a depth equivalent to the existing pavement structure unless directed otherwise by the engineer. Locations that are closed to through traffic may use an approved concrete pavement mix conforming to standard spec 501. If directed by the engineer, tie concrete pavement and/or dowel it to the existing pavement according to the standard detail drawing for concrete pavement. All locations requiring asphaltic pavement shall consist of HMA Pavement mix type determined by the engineer. Place the HMA pavement in lifts to a depth as directed by the engineer. Apply tack coat to composite pavement structures and between lifts. Alternate restoration methods may be used upon written approval from the engineer. Place base aggregate dense between the subgrade surface and the bottom of the pavement.

### **C.4 Documentation**

Provide documentation to the engineer and include the coordinates, elevations, and sketches of the infrastructure locations tied to known features in the plans. Reference each infrastructure to a proposed alignment with a station and offset. Where near a ramp, reference the ramp alignment. Document the size and/or diameter, composition, and a description of each infrastructure and the location of the elevation with respect to each infrastructure noted. Supply digital photographs of the uncovered infrastructure to the engineer in .jpeg format for future reference.

### **D Measurement**

The department will measure Exposing Existing Infrastructure Paved Area as a unit for each location. A location may have multiple infrastructures located within the same exposure area. An exposure area will include all infrastructures within 6 lateral feet of each other and payment will only be made for one unit regardless of the number of infrastructures exposed. If the distance from the existing ground elevation, located above the existing infrastructure, to a point 18 inches below the exposed infrastructure is between 0 and 6 feet, the department will measure each location as a single unit of work. If the distance from the existing ground elevation, located above the existing infrastructure, to a point 18 inches below the exposed infrastructure is greater than 6 feet and less than

12 feet, the department will pay for the item as two units of work.

### **E Payment**

The department will pay for the measured quantities at the contract unit price under the following bid item:

ITEM NUMBER	DESCRIPTION	UNIT
SPV.0060.0970	Exposing Existing Infrastructure Paved Area	Each

Payment is full compensation for mobilization; for furnishing all excavation; for disposing of all materials; for locating all infrastructure within each respective location; for providing documentation and photographs of infrastructure locations to the engineer; for furnishing all surveying associated with exposing existing infrastructure; for furnishing all maintenance of the location during construction; for furnishing all traffic control, safety barriers, and steel plating required; for temporary shoring; and for furnishing all finishing items including, but not limited to, base aggregate dense, backfill slurry, concrete pavement, HMA pavement, curb and gutter, and sidewalk located above the subgrade elevation

## **196. Exposing Existing Infrastructure Unpaved Area, Item SPV.0060.0975.**

### **A Description**

This work includes locating and exposing existing infrastructure in unpaved areas as directed by the engineer. The contractor shall be responsible for compliance with s.182.0175 (2), Stats., with respect to precautions to be taken to avoid and prevent damage to utility facilities. The location of existing utilities and infrastructure needed to complete the contract work shall be addressed independent of this provision. Conform to Wisconsin State Statute 182.0175 (2) and Wisconsin Administrative code Trans 220. The work includes exposing existing infrastructure, including utilities, under unpaved surfaces and providing both lateral and depth measurements for use in determining potential infrastructure conflict solutions, and backfilling.

### **B Materials**

#### **B.1 Backfill Slurry**

Utilize backfill slurry as specified elsewhere in these special provisions.

### **C Construction**

#### **C.1 General**

The location of existing utilities and infrastructure needed to complete the contract work shall be addressed independent of this provision. This item will only be used as determined by the department for unique locations as directed by the engineer. It does not remove the contractor's obligation to locate utilities as specified by Wisconsin Administrative code Trans 220 and Wisconsin State Statute 182.0175. The engineer will direct all exposing existing infrastructure in writing. Coordinate infrastructure exposures with the engineer and notify the infrastructure owner or their agents of this work two working days in advance so that they may be present when the work commences.

#### **C.2 Excavation**

Remove all unpaved surfaces at locations where the existing infrastructure is being exposed. Maintain drainage at all times in accordance to standard spec 205.3.3. Take precautions, including temporary shoring, in order to prevent any undermining of the existing roadway. Perform work in accordance to all applicable laws, ordinances, rules, regulations, and OSHA standards.

Expose all infrastructure locations within a given location to a minimum depth of 18-inches below the bottom of each infrastructure. Excavate in a manner that protects the

integrity of the infrastructure and prevents any damage to wrappings or protective coatings such as by any mechanical method or hand digging. Notify the infrastructure owner promptly if damage or interruption of service occurs. Repair all damage caused to such infrastructure resulting from negligence or carelessness at own expense. Take all lateral and depth measurements in US feet and tenths thereof. Identify horizontal locations of each exposed infrastructure with a coordinate northing and easting referenced to the Wisconsin County Coordinate System (WCCS), Ozaukee County, NAD 83 (2007). Provide vertical elevations for each exposed infrastructure and reference to NAVD 88 (2007). The infrastructure location shall remain exposed and available for visual inspection until the completion of all work in a given location. If the infrastructure shall remain exposed overnight or for prolonged periods of time, protect the location with traffic-rated steel plating, safety barriers, and all necessary traffic control devices that may be required under applicable standards or as directed by the engineer.

### **C.3 Backfilling**

Upon completion of the infrastructure exposure, restore the location in kind to its original condition. Use backfill slurry, conforming to standard spec 501, to backfill the exposed infrastructure locations to the subgrade elevation except for areas located within local streets. In grassy areas, place 6-inches of topsoil, sod or seed and mulch, and fertilizer. Alternate restoration methods may be used upon written approval from the engineer.

### **C.4 Documentation**

Provide documentation to the engineer and include the coordinates, elevations, and sketches of the infrastructure locations tied to known features in the plans. Reference each infrastructure to a proposed alignment with a station and offset. Where near a ramp, reference the ramp alignment. Document the size and/or diameter, composition, and a description of each infrastructure and the location of the elevation with respect to each infrastructure noted. Supply digital photographs of the uncovered infrastructure to the engineer in .jpeg format for future reference.

### **D Measurement**

The department will measure Exposing Existing Infrastructure Unpaved Area as a unit for each location. A location may have multiple infrastructures located within the same exposure area. An exposure area will include all infrastructures within 6 lateral feet of each other, and payment will only be made for one unit regardless of the number of infrastructures exposed. If the distance from the existing ground elevation, located above the existing infrastructure, to a point 18 inches below the exposed infrastructure is between 0 and 6 feet, the department will measure each location as a single unit of work. If the distance from the existing ground elevation, located above the existing infrastructure, to a point 18 inches below the exposed infrastructure is greater than 6 feet and less than 12 feet, the department will pay for the item as two units of work.

### **E Payment**

The department will pay for the measured quantities at the contract unit price under the following bid item:

ITEM NUMBER	DESCRIPTION	UNIT
SPV.0060.0975	Exposing Existing Infrastructure Unpaved Area	Each

Payment is full compensation for mobilization; for furnishing all excavation; for disposing of all materials; for locating all infrastructure within each respective location; for providing documentation and photographs of infrastructure locations to the engineer; for furnishing all surveying associated with exposing existing infrastructure; for furnishing all maintenance of the location during construction; for furnishing all traffic control, safety barriers, and steel plating required; or temporary shoring; for furnishing backfill slurry and backfilling the locate.

**197. Salvaged Rail and Guardrail End Treatments.**

Do not cut sections of guardrail. Give three days advance notice to engineer and contact person below before starting the Salvaged Rail and Salvaged Guardrail End Treatments work to coordinate pickup arrangements. Contact Kevin Peiffer, WisDOT SE Region Maintenance, at (414) 750-1408 and kevin.peiffer@dot.wi.gov.

**Schedule of Items**

Attached, dated November 5, 2021, are the revised Schedule of Items Pages 1 – 40.

**Plan Sheets**

The following 8½ x 11-inch sheets are attached and made part of the plans for this proposal:

Revised Sheets:

93, 467, 488, 553, 554, 1097, 1098, 1104, 1119, 1123, 1127, 1131, 1135, 1139, 1143, 1146, 1149, 1152, 1155, 1201, 1204

END OF ADDENDUM



REMOVAL LEGEND

- XXXXXX SAWING PAVEMENT
- ||||| REMOVING CURB & GUTTER
- ▨ REMOVING CONCRETE PAVEMENT
- - - REMOVING FENCE
- REMOVING CABLE BARRIER
- SALVAGED RAIL (SEE NOTE B)
- · · · · CLEARING AND GRUBBING
- × CLEARING AND GRUBBING
- RM 2 - REMOVING STORM SEWER STAGE 2
- RM 3 - REMOVING STORM SEWER STAGE 3
- RM 4 - REMOVING STORM SEWER STAGE 4
- AB 2 - ABANDONING STORM SEWER STAGE 2
- AB 3 - ABANDONING STORM SEWER STAGE 3
- AB 4 - ABANDONING STORM SEWER STAGE 4
- REMOVING INLETS
- ▲ REMOVING DELINEATORS AND MARKERS

GENERAL NOTES

- 1) ALL ITEMS ASSOCIATED WITH LIGHTING REMOVALS ARE SHOWN IN LIGHTING PLAN.
- 2) ALL ITEMS ASSOCIATED WITH SIGN REMOVALS ARE SHOWN IN THE SIGN PLAN.
- 3) ALL ITEMS ASSOCIATED WITH TRAFFIC SIGNALS ARE SHOWN IN THE TRAFFIC SIGNAL PLAN.
- 4) ALL ITEMS ASSOCIATED WITH SIGN REMOVALS ARE SHOWN IN SIGNING PLAN.
- 5) CLEARING AND GRUBBING SHALL BE PAID FOR EITHER BY THE STATION OR INCH DIAMETER (I.D.)
- 6) ABANDONING PIPE WITHIN THE FOOTPRINT OF THE PROPOSED ROADWAY (OUTSIDE SHOULDER TO OUTSIDE SHOULDER) WILL BE DONE WITH BACKFILL CONTROLLED LOW STRENGTH.
- 7) ABANDONING PIPES OUTSIDE THE FOOTPRINT OF THE PROPOSED ROADWAY WILL BE DONE WITH ABANDONING SEWER.
- 8) SEE MISCELLANEOUS QUANTITY TABLE FOR LOCATIONS OF SALVAGED GUARDRAIL END TREATMENTS. REFER TO SPECIAL PROVISIONS FOR CONTACT PERSON.

Addendum No. 2  
 ID 1229-04-76  
 Revised Sheet 93  
 November 1, 2021

Addendum No. 3  
 ID 1229-04-76  
 Revised Sheet 93  
 November 5, 2021

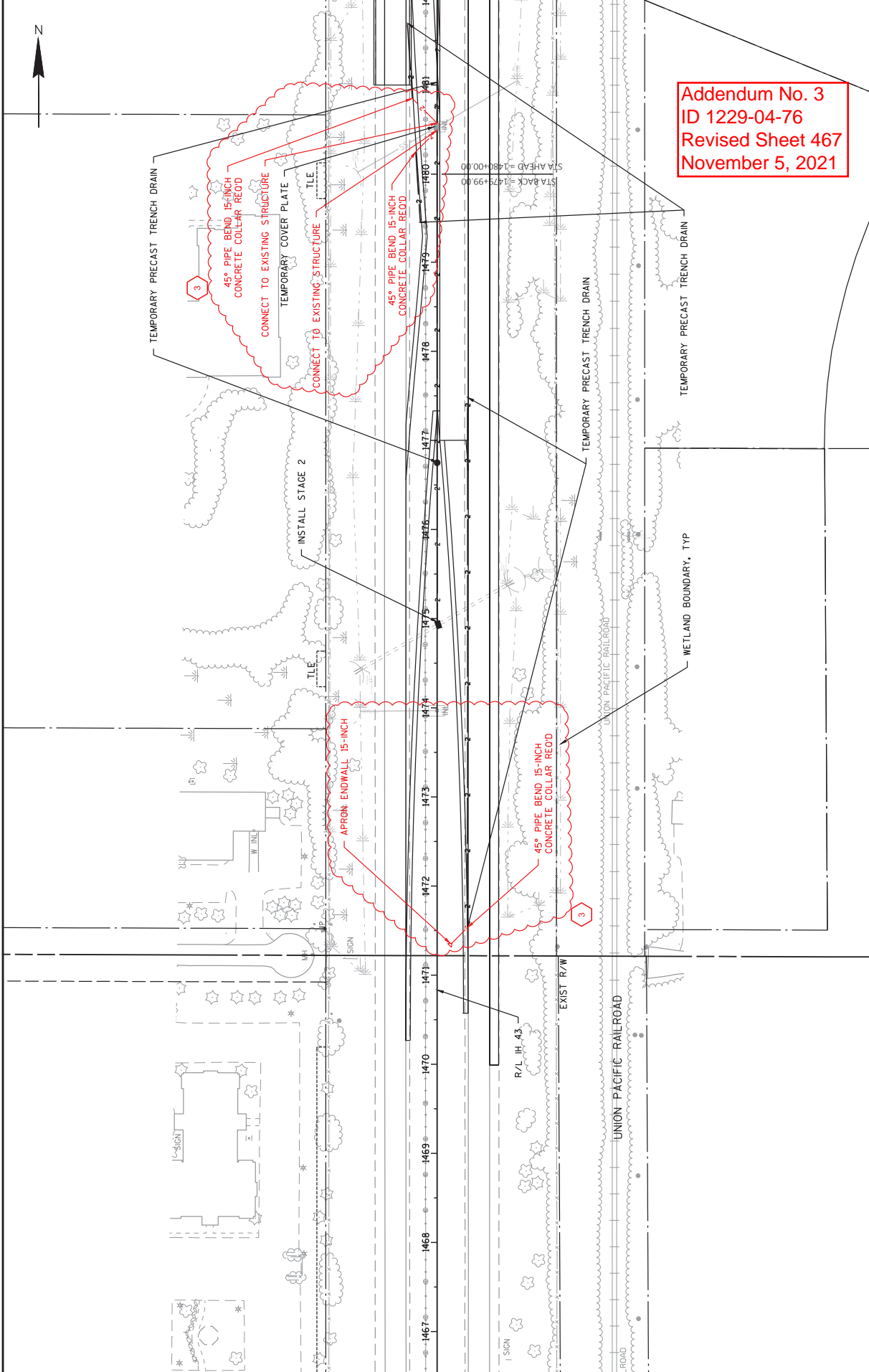

PROJECT NO: 1229-04-76	COUNTY: OZAUKEE	TEMPORARY DRAINAGE PLAN STAGES 1 & 2	SHEET 467	E
FILE NAME: C:\CADD\B\PW\WHITE_W\W000\ANGREAT\AKES\00256250\002500A_SS_MLDWG	FLYBY: WALTER A. WOLAKI	LOT NAME: WALTER A. WOLAKI	1 IN=100 FT	WIS007/CADD/SHEET 42
LAYOUT NAME: SSPROP-ML- (1)	DATE: 11/4/2021 10:42 AM			
HWY: IH 43				

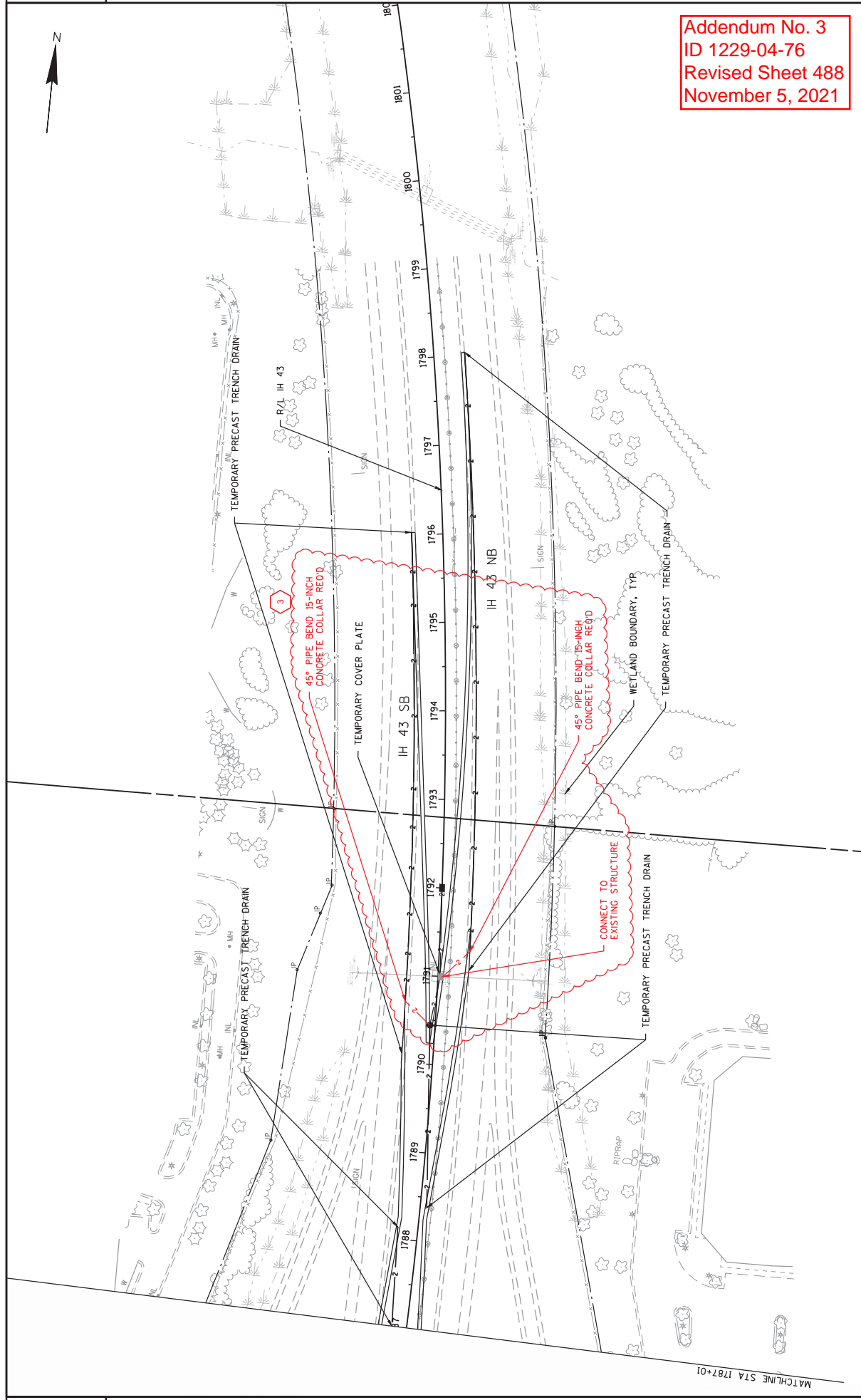

PROJECT NO: 1229-04-76	COUNTY: OZAUKEE	TEMPORARY DRAINAGE PLAN STAGES 1 & 2	SHEET 488	E
FILE NAME: C:\CADD\B\PW\WHITE_W\W00A\G\GREATLAKES\00256250\022500A_SS_MLDWG	DATE: 11/4/2021 10:43 AM	FLYBY: WALTER A. WOLAKI	1 IN=100 FT	WISDOT/CADDSS SHEET 42
LAYOUT NAME: SSPROP-ML- (22)				

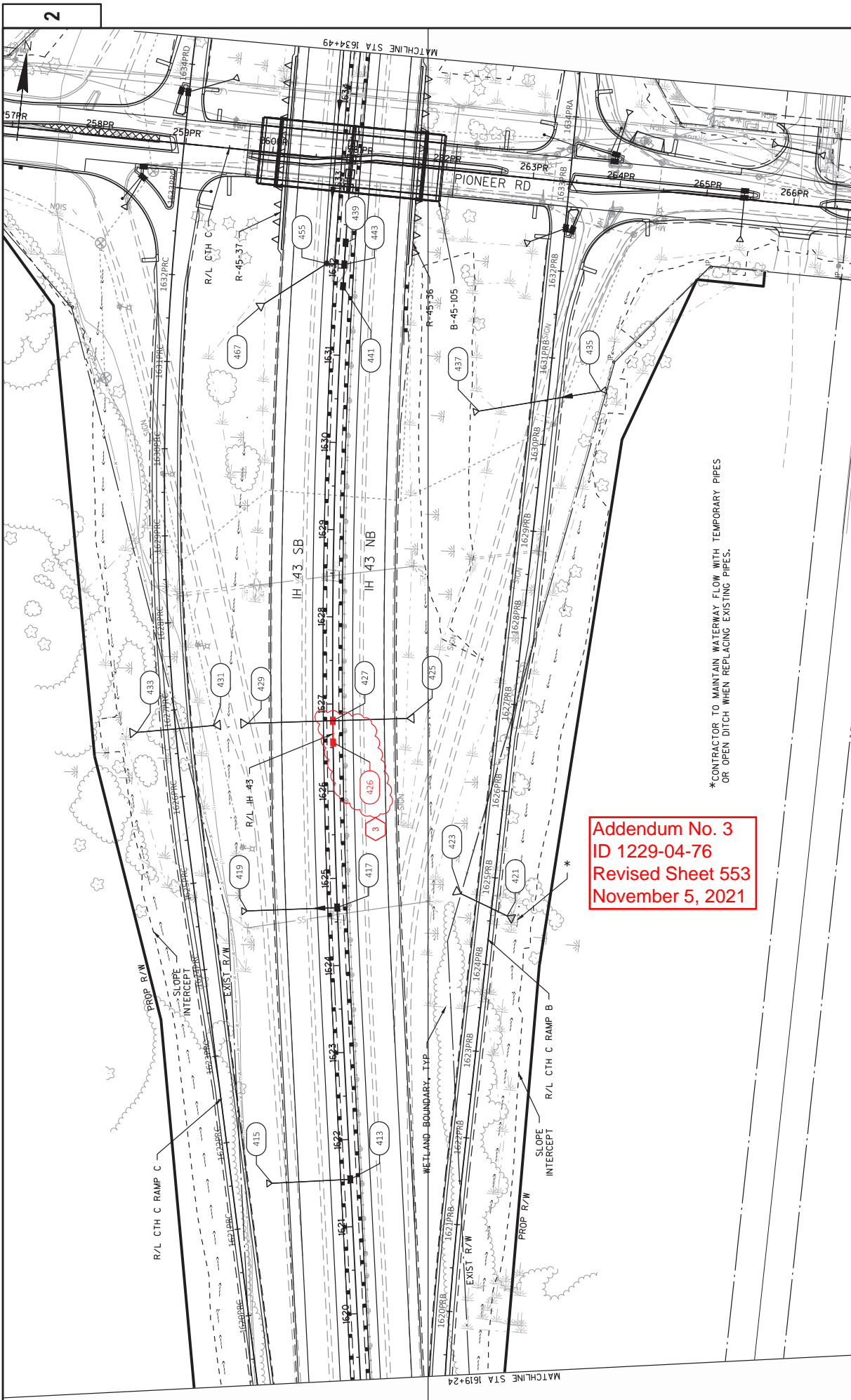

Addendum No. 3  
 ID 1229-04-76  
 Revised Sheet 553  
 November 5, 2021

\*CONTRACTOR TO MAINTAIN WATERWAY FLOW WITH TEMPORARY PIPES  
 OR OPEN DITCH WHEN REPLACING EXISTING PIPES.

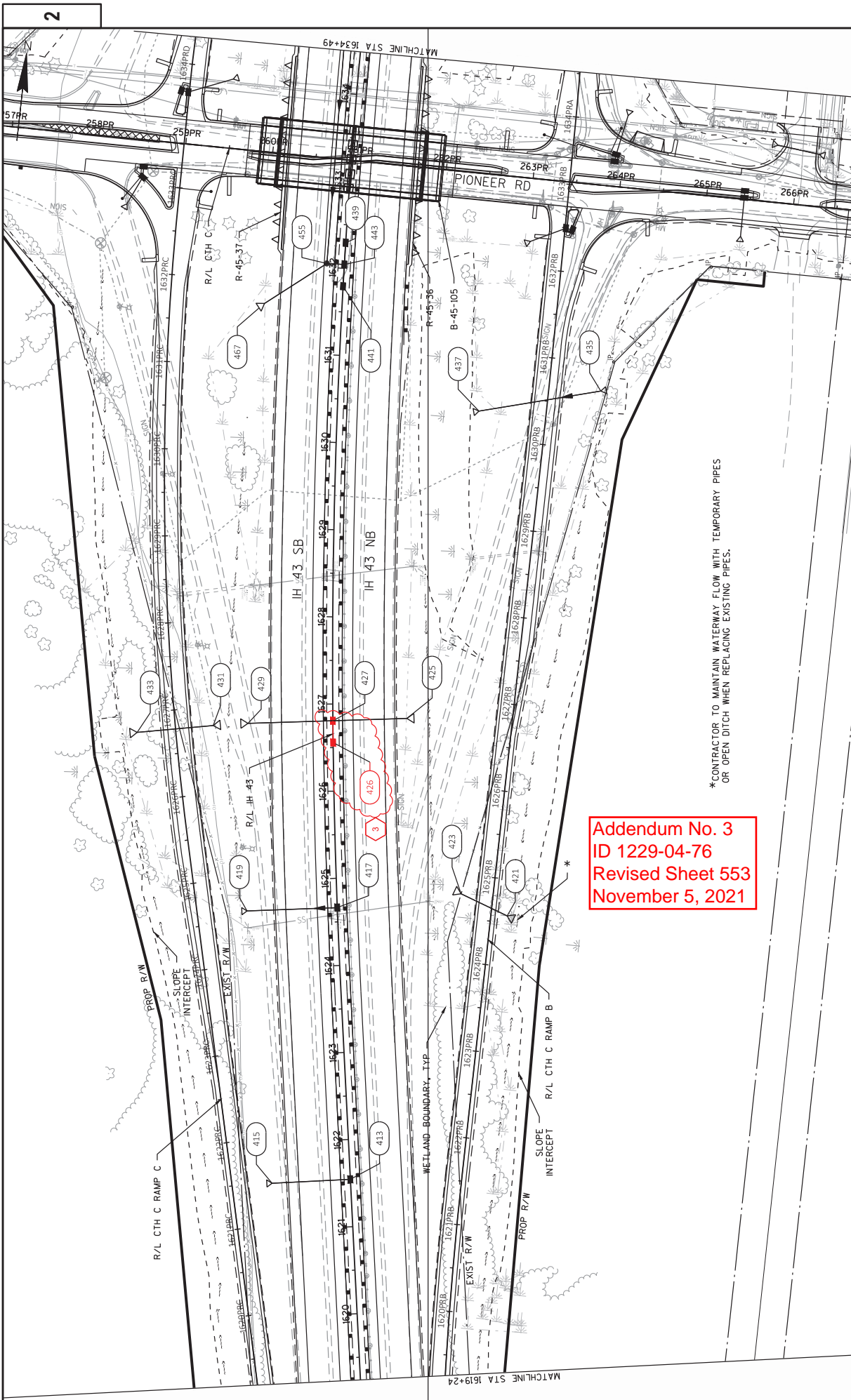

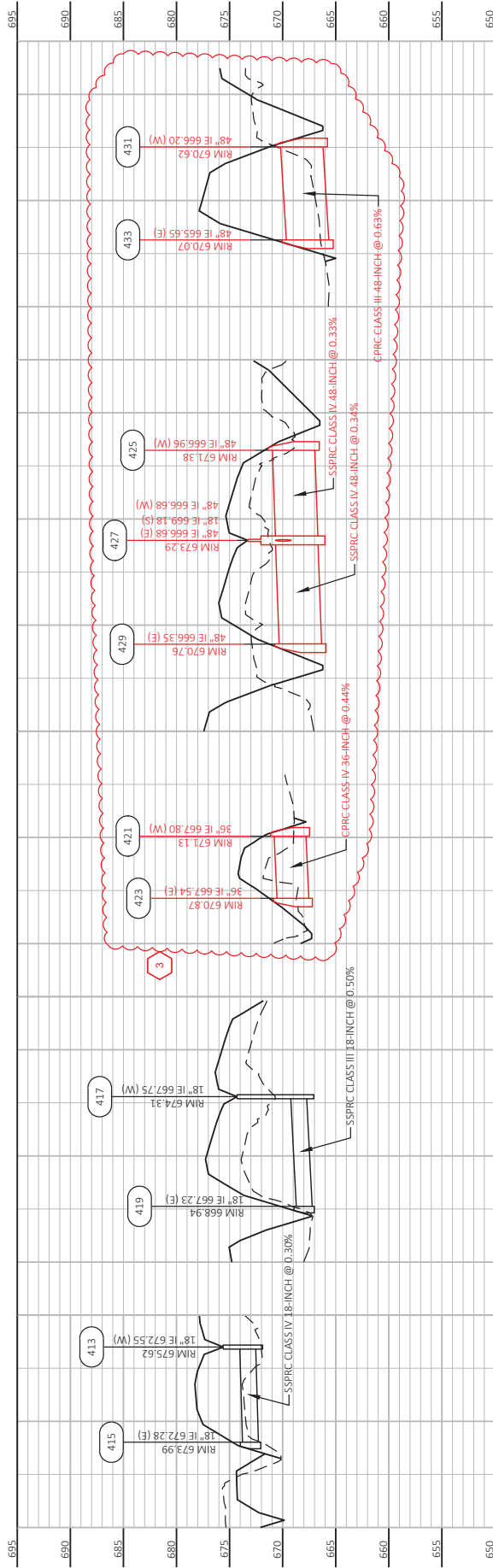

**Addendum No. 3**  
**ID 1229-04-76**  
**Revised Sheet 554**  
**November 5, 2021**

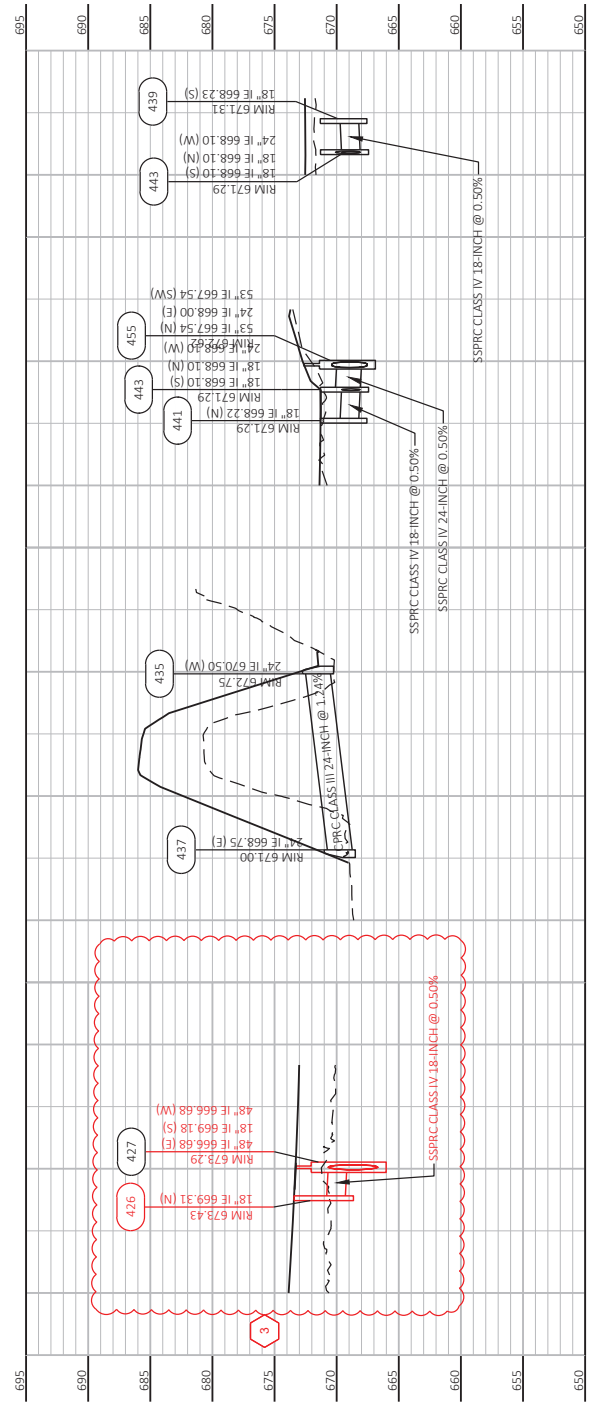

Addendum No. 3  
ID 1229-04-76  
Revised Sheet 1097  
November 5, 2021

3

REMOVING FENCE

STA	TO	STA	OFFSET	LOCATION	REMOVING FENCE LF
14HL+83	-	18HL+02	RT	HIGHLAND RD	334
22HL+88	-	24HL+74	RT	HIGHLAND RD	186
44LD+70	-	45LD+30	LT	FALLS RD	56
44LD+70	-	45LD+30	RT	FALLS RD	56
1488+00	-	1632+50	LT	IH 43	14541
1488+00	-	1632+50	RT	IH 43	14649
1634+00	-	1686+00	LT	IH 43	5307
1634+00	-	1686+00	RT	IH 43	5265
1686+80	-	1739+50	LT	IH 43	5346
1686+80	-	1739+50	RT	IH 43	5360
1739+65	-	1788+00	LT	IH 43	3671
1739+65	-	1788+00	RT	IH 43	3786
PROJECT 1229-04-76 TOTAL					58,757

REMOVING CURB AND GUTTER

STATION	OFFSET	LOCATION	REMOVING CURB AND GUTTER LF		
9HL+50	RT	HIGHLAND RD	142		
9HL+50	LT	HIGHLAND RD	284		
11HL+00	RT	HIGHLAND RD	43		
11HL+40	RT	HIGHLAND RD	45		
29HL+00	RT	HIGHLAND RD	56		
29HL+50	RT	HIGHLAND RD	45		
STAGE 1 SUBTOTAL			615		
STAGE 3					
253PR+39	-	257PR+33	LT	CTH C	394
253PR+39	-	257PR+70	MED	CTH C	865
253PR+41	-	257PR+45	RT	CTH C	403
1632PRC+85	-	1633PRC+20		CTH C RAMP C	137
1633PRD+32	-	1633PRD+63		CTH C RAMP D	108
1632PRB+61	-	1632PRB+87		CTH C RAMP B	64
1633PRA+23	-	1633PRA+38		CTH C RAMP A	69
STAGE 3 SUBTOTAL			2040		
PROJECT 1229-04-76 TOTAL			2,655		

REMOVING CONCRETE BARRIER

STATION	OFFSET	LOCATION	REMOVING CONCRETE BARRIER LF		
1524+10	-	1524+85	LT	IH 43	79
STAGE 3 SUBTOTAL			79		
STAGE 4					
1524+10	-	1524+85	RT	IH 43	89
STAGE 4 SUBTOTAL			89		
PROJECT 1229-04-76 TOTAL			168		

REMOVING PAVEMENT

STATION TO	STATION/OFFSET	LOCATION	SY	204.0100 REMOVING CONCRETE PAVEMENT	204.0109.S REMOVING CONCRETE SURFACE PARTIAL DEPTH	SF ELIMINATED
STAGE 3						
1481+00	-	1488+00	LT	IH 43		1,870
1488+00	-	1685+95	LT	IH 43		51,870
1615+65	-	1632+75	LT	CTH C RAMP C		2,930
1634+70	-	1647+00	LT	CTH C RAMP D		1,890
1686+75	-	1785+04	LT	IH 43		25,580
1755+25	-	1778+50	LT	STH 60 RAMP C		4,230
STAGE 3 SUBTOTAL						88,370
STAGE 4/2						
1481+00	-	1488+00	RT	IH 43		1,860
1488+00	-	1685+95	RT	IH 43		51,820
1620+00	-	1632+50	RT	CTH C RAMP B		2,080
1633+50	-	1651+00	RT	CTH C RAMP A		2,690
1686+75	-	1785+04	RT	IH 43		25,530
1764+65	-	1777+80	RT	STH 60 RAMP B		2,510
STAGE 4/2 SUBTOTAL						86,490
UNDISTRIBUTED						0
PROJECT 1229-04-76 TOTAL						174,860

ALL ITEMS CATEGORY 1000  
UNLESS OTHERWISE NOTED

**REMOVING DELINEATORS AND MARKERS**

204.0180  
REMOVING DELINEATORS AND MARKERS

STATION	LOCATION	EACH
1470+00 - 1524+00	IH 43 NB	20
1470+00 - 1524+00	IH 43 SB	20
1524+00 - 1633+00	IH 43 NB	62
1633+00 - 1686+50	IH 43 NB	43
1633+00 - 1686+50	IH 43 SB	37
1686+50 - 1739+50	IH 43 NB	15
1686+50 - 1739+50	IH 43 SB	15
1739+50 - 1785+00	IH 43 NB	27
1739+50 - 1785+00	IH 43 SB	30
UNDISTRIBUTED		50
PROJECT 1229-04-76 TOTAL		319

**REMOVING SURFACE DRAINS**

204.0190  
REMOVING SURFACE DRAINS

STATION	OFFSET	LOCATION	EACH
253+50	LT	CTH C	1
253+50	RT	CTH C	1
STAGE 3 SUBTOTAL			2
PROJECT 1229-04-76 TOTAL			2

Addendum No. 3  
ID 1229-04-76  
Revised Sheet 1098  
November 5, 2021

**REMOVING CABLE BARRIER**

204.9060 S.0001 204.9090 S.0001  
REMOVING CABLE BARRIER

STATION	OFFSET	LOCATION	EACH	LF
1470+00 - 1523+35	LT	IH 43	--	5335
1483+10 - 1483+65	LT	IH 43	2	--
1522+80 - 1525+90	MED	IH 43	2	--
1525+40 - 1534+35	RT	IH 43	2	895
1534+00 - 1535+75	RT	IH 43	2	--
1535+15 - 1611+20	RT	IH 43	--	7609
1553+45 - 1555+00	RT	IH 43	2	--
1572+50 - 1573+25	RT	IH 43	2	--
1591+50 - 1592+00	RT	IH 43	2	--
1611+00 - 1612+50	RT	IH 43	2	--
1612+10 - 1632+10	RT	IH 43	--	2000
1632+00 - 1632+25	RT	IH 43	1	--
1634+45 - 1655+52	RT	IH 43	--	2103
1634+50 - 1634+75	RT	IH 43	1	--
1644+75 - 1645+50	RT	IH 43	1	--
1655+25 - 1656+75	RT	IH 43	2	--
1656+45 - 1684+25	RT	IH 43	--	2784
1670+00 - 1671+00	RT	IH 43	2	--
1684+00 - 1684+50	RT	IH 43	1	--
1688+50 - 1689+00	RT	IH 43	1	--
1688+75 - 1738+45	LT	IH 43	--	4975
1704+75 - 1705+50	LT	IH 43	2	--
1738+25 - 1741+00	LT	IH 43	2	--
1740+65 - 1748+80	LT	IH 43	--	817
1748+50 - 1750+75	LT	IH 43	2	--
1749+60 - 1778+95	LT	IH 43	--	2935
1764+00 - 1765+00	LT	IH 43	2	--
1778+75 - 1779+00	LT	IH 43	1	--
1780+75 - 1781+00	RT	IH 43	1	--
1780+80 - 1796+00	RT	IH 43	--	1519
STAGE 2 SUBTOTAL			35	30972
PROJECT 1229-04-76 TOTAL			35	30,972

**SALVAGED GUARDRAIL**

STA	TO	STA	LOCATION	OFFSET	ELIMINATED	LF	EACH	END TREATMENTS
17HL+17	-	26HL+56	HIGHLAND RD	RT		544	--	
17HL+17	-	24HL+31	HIGHLAND RD	LT		317	--	
1522+84	-	1524+25	IH 43	MED		290	--	
1523+19	-	1524+02	IH 43	RT		84	1	
1524+64	-	1525+88	IH 43	MED		257	--	
1524+82	-	1525+69	IH 43	LT		87	1	
1631+82	-	1634+63	IH 43	MED		575	--	
1678+90	-	1685+85	IH 43	LT		692	1	
1679+45	-	1685+85	IH 43	RT		644	1	
1683+93	-	1685+85	IH 43	MED		247	1	
1687+00	-	1689+05	IH 43	MED		259	1	
1687+00	-	1691+10	IH 43	LT		405	1	
1738+31	-	1739+45	IH 43	MED		234	--	
1740+75	-	1740+85	IH 43	MED		226	--	
1778+75	-	1781+05	IH 43	MED		470	--	
PROJECT 1229-04-76 TOTAL						5,351	7	

**ABANDONING WELLS**

204.0265  
ABANDONING WELLS

STA	LOCATION	OFFSET	EACH
1523+11	IH 43	106' LT	1
1525+63	IH 43	122' RT	1
1526+05	IH 43	171' LT	1
1632+76	IH 43	73' LT	1
1633+74	IH 43	73' RT	1
1684+03	IH 43	62' RT	1
1684+05	IH 43	64' LT	1
1688+18	IH 43	63' RT	1
PROJECT 1229-04-76 TOTAL			8

ALL ITEMS CATEGORY 1000  
UNLESS OTHERWISE NOTED

**REMOVING DRAINTILE / UNDERDRAIN**

204.9090.S.0002	204.9090.S.0002	REMOVING DRAINTILE	LF	2,000
204.9090.S.0002	204.9090.S.0002	REMOVING UNDERDRAIN	LF	2,000
<b>PROJECT 1229-04-76 TOTAL</b>				<b>65,000</b>

2

**REMOVING RIPRAP**

204.9035.S.0001	204.9035.S.0001	REMOVING RIPRAP	CY	81
<b>PROJECT 1229-04-76 TOTAL</b>				<b>81</b>

NOTE:  
ASSUME 1.5' DEPTH

3

209.0200.S*	209.0200.S*	BACKFILL CONTROLLED LOW STRENGTH	CY	0
<b>PROJECT 1229-04-76 TOTALS</b>				<b>0</b>

\*NOTE: ADDITIONAL QUANTITIES SHOWN ELSEWHERE

**TEMPORARY EMERGENCY PULLOUTS**

205.3000.S	205.3000.S	TEMPORARY EMERGENCY PULLOUTS	EACH	4
1492+00	RT	IH 43 NB	1	
1575+50	RT	IH 43 NB	1	
1693+00	RT	IH 43 NB	1	
1750+50	RT	IH 43 NB	1	
<b>STAGE 1 SUBTOTAL</b>				<b>4</b>
<b>STAGE 2</b>				
1724+00	LT	IH 43 SB	1	
<b>STAGE 2 SUBTOTAL</b>				<b>1</b>
<b>STAGE 3</b>				
1724+00	LT	IH 43 NB	1	
1724+00	LT	IH 43 SB	1	
<b>STAGE 3 SUBTOTAL</b>				<b>2</b>
<b>PROJECT 1229-04-76 TOTAL</b>				<b>7</b>

**FINISHING ROADWAY**

213.0100.0001	213.0100.0001	FINISHING ROADWAY	PROJECT ID	1229-04-76
<b>PROJECT 1229-04-76 TOTAL</b>				<b>1</b>

Addendum No. 2  
ID 1229-04-76  
Revised Sheet 1104  
November 1, 2021

Addendum No. 3  
ID 1229-04-76  
Revised Sheet 1104  
November 5, 2021

**EMERGENCY PAVEMENT REPAIR ITEMS**

390.0203	390.0203	BASE PATCHING ASPHALTIC	SY	15,000	390.0203	BASE PATCHING ASPHALTIC	SY	15,000	
450.1100.S	450.1100.S	ASPHALTIC MIXTURE FOR EXTREME CONDITIONS	TON	400	450.1100.S	ASPHALTIC MIXTURE FOR EXTREME CONDITIONS	TON	400	
465.0125*	465.0125*	ASPHALTIC SURFACE TEMPORARY	TON	700	465.0125*	ASPHALTIC SURFACE TEMPORARY	TON	700	
485.1000.S	485.1000.S	COLD PATCH	TON	100	485.1000.S	COLD PATCH	TON	100	
690.0250*	690.0250*	SAWING CONCRETE	LF	5,000	690.0250*	SAWING CONCRETE	LF	5,000	
SPV.0195.0001	SPV.0195.0001	HMA JOINT REPAIR	TON	5,000	SPV.0195.0001	HMA JOINT REPAIR	TON	5,000	
SPV.0195.0002	SPV.0195.0002	HMA TRANSVERSE JOINT REPAIR	TON	1,000	SPV.0195.0002	HMA TRANSVERSE JOINT REPAIR	TON	1,000	
SPV.0060.0160	SPV.0060.0160	MOBILIZATIONS EMERGENCY PAVEMENT REPAIR	EACH	10	SPV.0060.0160	MOBILIZATIONS EMERGENCY PAVEMENT REPAIR	EACH	10	
<b>PROJECT 1229-04-76 TOTALS</b>				<b>5,000</b>	<b>PROJECT 1229-04-76 TOTALS</b>				<b>5,000</b>

2

PROJECT NO: 1229-04-76

HWY: IH 43

COUNTY: OZAUKEE

MISCELLANEOUS QUANTITIES

SHEET: 1104

ALL ITEMS CATEGORY 1000  
UNLESS OTHERWISE NOTED



**FASTENING SEWER ACCESS COVERS**

STAGE	ROADWAY	STATION	OFFSET	EACH
3	IH 43	1522+97	17 LT	1
		1523+62	17 LT	1
		1524+79	17 LT	1
		1632+04	20' LT	1
		1635+04	20' LT	1
		1688+00	14' LT	1
		1696+25	17 LT	1
<b>TOTAL</b>				<b>7</b>

**SPECIAL STRUCTURE**

STAGE	ROADWAY	STATION	OFFSET	EACH
				1

FOR LOCATION SEE STORM SEWER STRUCTURES TABLE

**APRON ENDWALLS SALVAGED**

524.0618  
APRON ENDWALLS  
FOR CULVERT PIPE  
SALVAGED  
18-INCH  
EACH

STAGE	ROADWAY	STATION	OFFSET	EACH	NOTES
4	IH 43	1762+75	83 RT	1	PROPOSED ENDWALL 695
<b>TOTAL</b>				<b>1</b>	

**PRECAST TRENCH DRAIN**

STAGE	ROADWAY	UPSTREAM END	OFFSET	DOWNSTREAM END	STRUCTURE	LF	NOTES
3	IH 43	1535+91	69' RT	132A	CONNECT TO PRECAST STORM SEWER TRENCH DRAIN	196	
<b>SUBTOTAL</b>						<b>196</b>	
4	IH 43	1511+84	61' RT	144A	3.8° BEND AT STA 1513+05.69.0' RT	175	
		1508+49	69' LT	250A		181	
<b>SUBTOTAL</b>						<b>356</b>	
<b>TOTAL</b>						<b>552</b>	

**TEMPORARY PRECAST TRENCH DRAIN**

STAGE	ROADWAY	UPSTREAM END	OFFSET	DOWNSTREAM END	STRUCTURE	LF	NOTES
2	IH 43	1477+48	34' RT	595	SPV.0090.8036 TEMPORARY PRECAST TRENCH DRAIN	595	
		1479+45	19' LT	80	204.9090.S.0005 TEMPORARY REMOVING PRECAST TRENCH DRAIN	80	
		1480+53	0' RT	377		377	
		1481+03	0' RT	50		50	
		1481+69	33' LT	84		84	
		1788+14	23 LT	265		265	
		1788+36	8 RT	206		206	
		1796+03	35 RT	530		530	
		1798+03	35 RT	678		678	
<b>TOTALS</b>						<b>2,865</b>	<b>2,865</b>

\* ADDITIONAL QUANTITIES FOUND ELSEWHERE

Addendum No. 2  
ID 1229-04-76  
Revised Sheet 1119  
November 1, 2021

Addendum No. 3  
ID 1229-04-76  
Revised Sheet 1119  
November 5, 2021

ALL ITEMS CATEGORY 1000 UNLESS OTHERWISE NOTED

SHEET: 1119

MISCELLANEOUS QUANTITIES

COUNTY: OZAUKEE

HWY: IH 43

PROJECT NO: 1229-04-76

Estimate of Quantities 022591\_ss\_MQ.apr

PLOT BY: BRAYN C. ADAMS

PLOT NAME: 022591\_ss\_MQ14

PLOT DATE: 11/4/2021 11:25:43 AM

North End MainlineSheetsPan03

Estimate of Quantities 022591\_ss\_MQ.apr

PLOT SCALE: 1:1

**APRON ENDWALLS**

STRUCTURE	STAGE	LOCATION	STATION	OFF-SET**	RIM ELEVATION	INVERT*** DEPTH****	FT	522.1015 15-INCH EACH	522.1024* 24-INCH EACH	522.1030* 30-INCH EACH	522.1036* 36-INCH EACH	522.1048* 48-INCH EACH	522.1060 60-INCH EACH	522.2629 29x45-INCH EACH	522.2638 38x60-INCH EACH	633.5200* MARKERS COVERT END EACH	
413	3	43-RL	1621+54.35	0.00' RT	675.62	672.55	3.27										
415	3	43-RL	1621+54.35	89.72' LT	673.99												
417	3	43-RL	1624+66.40	0.00' RT	674.31	667.75	6.77										
419	3	43-RL	1624+66.39	103.33' LT	668.94												
421	4	PRB	1624+58.17	18.64' RT	667.80	667.80		1	1								
423	4	PRB	1624+77.60	36.53' LT	667.54												
425	4	43-RL	1626+62.67	84.81' RT	666.96	666.96											
426	2	43-RL	1626+55.77	0.00' RT	673.43	669.31	4.33										
427	2	43-RL	1626+80.77	0.01' RT	673.29	666.68	5.79										
429	3	43-RL	1626+78.64	97.42' LT	666.35	666.35											
431	3	PRC	1626+78.26	43.34' RT	666.20												
433	3	PRC	1626+78.15	44.25' LT	665.65			3									
435	4	PRB	1630+88.01	59.54' RT	672.75												
437	4	PRB	1630+30.25	76.94' LT	671.00												
439	3	43-RL	1632+29.35	0.00' RT	671.31	668.23	3.29										
441	3	43-RL	1631+79.35	0.00' RT	671.29	668.22	3.28										
443	3	43-RL	1632+04.35	0.00' LT	671.29	668.10	3.44										
445	3	43-RL	1635+04.37	91.01' LT	671.41												
447	4	43-RL	1635+04.56	80.29' RT	671.12												
449	2	43-RL	1637+04.35	0.00' RT	673.23	669.73	3.70										
451	2	43-RL	1635+04.35	0.00' RT	672.34	668.63	3.96										
453	3	43-RL	1635+04.35	20.00' LT	673.62	668.44	4.35										
455	3	43-RL	1632+04.35	20.00' LT	672.62	667.54	4.26						1				
467	3	43-RL	1631+54.98	88.84' LT	670.54												
469	2	43-RL	1640+54.35	0.00' RT	674.77	671.31	3.67										
471	4	43-RL	1640+54.33	86.36' RT	672.76												
473	3	43-RL	1644+05.83	0.08' LT	676.06	669.50	6.81										
475	3	43-RL	1644+05.83	125.07' LT	671.38												
481	4	43-RL	1645+92.25	130.30' RT	671.38												
483	3	43-RL	1645+181.59	119.62' LT	670.59												
485	4	43-RL	1646+00.23	129.68' RT	671.39												
487	2	43-RL	1645+94.70	0.00' RT	676.76	667.64	9.45										
489	3	43-RL	1645+89.60	119.42' LT	670.59												
501	3	43-RL	1652+04.35	0.00' RT	675.68	670.96	4.93										
503	3	43-RL	1652+04.35	102.61' LT	672.16												
505	4	43-RL	1653+39.34	95.73' RT	673.65												
507	3	43-RL	1654+24.94	101.04' LT	671.35												
509	2	43-RL	1655+54.35	0.00' RT	674.29	671.16	3.33										
511	4	43-RL	1655+54.35	95.37' RT	672.57												
513	4	43-RL	1658+68.69	90.00' RT	671.94												
515	2	43-RL	1658+92.33	0.02' RT	672.98	668.28	4.95										
517	3	43-RL	1658+96.76	104.12' LT	668.88												
518	3	43-RL	1661+20.35	0.00' RT	672.56	669.88	2.88										
519	3	43-RL	1661+50.35	0.00' RT	672.56	669.88	2.88										
520	3	43-RL	1661+35.35	0.00' RT	672.55	669.84	2.92										
521	3	43-RL	1661+35.35	89.27' LT	671.10												
523	4	43-RL	1663+57.10	90.00' RT	671.26												
525	2	43-RL	1663+52.48	0.00' RT	672.90	667.67	5.49										
527	3	43-RL	1663+46.98	106.98' LT	668.32												
531	3	43-RL	1667+04.35	0.00' RT	673.99	670.82	3.37										
533	3	43-RL	1667+04.35	89.66' LT	672.08												
535	4	43-RL	1671+15.04	93.58' RT	672.48												
537	2	43-RL	1671+11.84	0.00' RT	675.24	669.76	5.73										
539	3	43-RL	1671+08.55	96.31' LT	671.55												
541	2	43-RL	1674+04.35	1.094' RT	676.18	671.72	5.33										
543	2	43-RL	1674+04.35	0.00' RT	676.49	671.67	5.03										

\* ADDITIONAL QUANTITIES FOUND ELSEWHERE  
 \*\* STATIONS AND OFFSETS ARE TO CENTER OF STRUCTURE  
 \*\*\* FOR STRUCTURES WITH SUMPS, THE INVERT ELEVATION IS THE ELEVATION OF THE LOWEST PIPE FLOW LINE  
 \*\*\*\* DEPTH = RIM ELEV. - TOP OF STRUCTURE BASE ELEV. - COVER HEIGHT - 6 INCH ADJUSTMENT RING HEIGHT

APRON ENDWALLS

STRUCTURE	STAGE	LOCATION	STATION	OFFSET**	RIM ELEVATION	INVERT*** ELEVATION	DEPTH*** FT	52.1015 15-INCH AEW FOR CPIC	52.1018* 18-INCH AEW FOR CPIC	52.1024* 24-INCH AEW FOR CPIC	52.1030* 30-INCH AEW FOR CPIC	52.1036* 36-INCH AEW FOR CPIC	52.1048* 48-INCH AEW FOR CPIC	52.1060 60-INCH AEW FOR CPIC	52.2629 29x45-INCH AEW FOR CPIC	52.2638 38x60-INCH AEW FOR CPIC	633.5200* MARKERS COVERT END	
943	4	PRA	1638+99.98	2.72 RT	678.89	672.00	5.90											
945	4	PRA	1641+92.48	2.73 RT	676.80	669.74	6.06											
947	4	PRA	1642+12.57	32.65 RT	671.72	671.72												
951	4	LD	43+65.79	30.76 LT	675.58	675.58			1									
953	4	LD	43+64.21	34.16 RT	674.32	674.32				1								
955	4	LD	43+73.76	30.24 LT	675.58	675.58												
957	4	LD	43+72.07	33.91 RT	674.32	674.32												
959	4	LD	44+72.18	17.00 LT	677.29	673.70	2.75											
961	4	LD	44+40.08	17.00 RT	677.38	677.95	3.64											
963	4	LD	44+72.18	17.00 RT	677.29	673.36	3.09											
965	4	LD	44+35.65	17.00 RT	677.38	672.11	4.52											
967	4	LD	43+85.67	50.06 RT	673.41	673.41				1								
969	4	LD	46+28.31	25.44 LT	676.11	676.11												
971	4	LD	46+26.74	30.99 RT	675.79	675.79												
973	4	LD	46+34.36	28.66 LT	676.11	676.11												
975	4	LD	46+32.99	30.14 RT	675.79	675.79												
981	3	F5	40+52.77	58.71 LT	706.00	706.00												
983	3	F5	40+51.91	73.16 RT	704.81	704.81												
985	4	F5	42+53.17	45.98 LT	704.59	704.59												
987	4	F5	42+54.98	62.14 RT	704.19	704.19												
989	2	F5	43+85.66	41.45 LT	720.06	720.06												
991	2	F5	44+26.66	31.61 LT	717.44	717.44												
993	2	F5	44+11.50	34.19 RT	718.93	718.93												
995	2	F5	44+45.84	30.67 RT	715.72	715.72												
T1001	2	43-RL	1530+39.87	71.13 RT	678.89	669.90	9.08											
T1003	2	43-RL	1520+97.64	74.83 RT	678.97	673.87	3.94											
T1004	2	43-RL	1520+89.88	71.16 RT	679.69	669.67	9.11											
T1005	2	43-RL	1524+88.27	97.66 LT	689.64	669.11	19.63											
T1007	2	43-RL	1525+95.52	53.84 LT	672.03	672.03												
T1011	2	43-RL	1531+88.33	73.83 RT	684.50	673.89	9.71											
T1013	2	43-RL	1530+88.50	76.19 LT	681.11	673.52	6.68											
T1015	2	43-RL	1530+55.63	30.87 LT	676.60	676.60												
TOTALS								11	62	37	12	22	4	1	4	5	4	188

3

3

3

Addendum No. 3  
 ID 1229-04-76  
 Revised Sheet 1127  
 November 5, 2021

\* ADDITIONAL QUANTITIES FOUND ELSEWHERE  
 \*\* STATIONS AND OFFSETS ARE TO CENTER OF STRUCTURE  
 \*\*\* FOR STRUCTURES WITH SUMPS, THE INVERT ELEVATION IS THE ELEVATION OF THE LOWEST PIPE FLOW LINE  
 \*\*\*\* DEPTH = RIM ELEV. - TOP OF STRUCTURE BASE ELEV. - COVER HEIGHT - 6 INCH ADJUSTMENT RING HEIGHT

Addendum No. 3  
ID 1229-04-76  
Revised Sheet 1131  
November 5, 2021

STORM SEWER STRUCTURES

STRUCTURE	STAGE	LOCATION	STATION	OFFSET**	RIM ELEVATION	DEPTH***	INVERT ELEVATION	611.0530 MANHOLE COVERS TYPE J EACH	611.0535* TYPE J/SPECIAL EACH	611.0606 INLET COVERS TYPE B EACH	611.0610 INLET COVERS TYPE C EACH	611.0624 INLET COVERS TYPE H EACH	611.0689 INLET COVERS TYPE H-S EACH	611.0642* INLET COVERS TYPE MS EACH
413	3	43-RL	1621+54.35	0.00 RT	675.62	3.27	672.35							2
415	3	43-RL	1621+54.35	89.72 LT	673.99		673.99							2
417	3	43-RL	1624+66.40	0.00 RT	674.31	6.77	667.54							
419	3	43-RL	1624+66.39	103.33 LT	668.94		668.94							
421	4	PRB	1624+58.17	18.64 RT	667.80		667.80							
423	4	PRB	1624+77.60	36.53 LT	667.54		667.54							
425	4	43-RL	1626+82.67	84.81 RT	666.96		666.96							
426	2	43-RL	1626+55.77	0.00 RT	673.43	4.33	669.10							2
427	2	43-RL	1626+80.77	0.01 RT	673.29	5.79	667.50							
429	3	43-RL	1626+78.64	97.42 LT	666.88		666.88							
431	3	PRC	1626+78.28	43.34 RT	666.20		666.20							3
433	3	PRC	1626+78.15	44.25 LT	665.05		665.05							
435	4	PRB	1630+68.01	59.54 RT	672.75		672.75							
437	4	PRB	1630+30.25	76.94 LT	671.00		671.00							2
439	3	43-RL	1632+29.35	0.00 RT	671.31	3.29	668.02							2
441	3	43-RL	1631+79.35	0.00 RT	671.29	3.28	668.01							2
443	3	43-RL	1632+04.35	0.00 LT	671.29	3.44	667.85							2
445	3	43-RL	1635+04.37	91.01 LT	671.41		671.41							
447	4	43-RL	1635+04.56	80.29 RT	671.12		671.12							2
449	2	43-RL	1637+04.35	0.00 RT	673.23	3.70	669.53							2
451	2	43-RL	1635+04.35	0.00 RT	672.34	3.96	669.38							2
453	3	43-RL	1635+04.35	20.00 LT	673.62	4.35	673.62		1					
455	3	43-RL	1632+04.35	20.00 LT	672.62	4.26	668.36		1					
467	3	43-RL	1631+54.88	88.84 LT	670.54		670.54							2
469	2	43-RL	1640+54.35	0.00 RT	674.77	3.67	671.10							
471	4	43-RL	1640+54.33	86.38 RT	672.76		672.76							2
473	3	43-RL	1644+05.83	0.08 LT	676.06	6.81	669.25							2
475	3	43-RL	1644+05.83	125.07 LT	671.38		671.38							
481	4	43-RL	1645+92.25	130.30 RT	671.38		671.38							
483	3	43-RL	1645+81.59	119.62 LT	670.59		670.59							
485	4	43-RL	1646+00.23	129.68 RT	671.39		671.39							
487	2	43-RL	1645+94.70	0.00 RT	676.76	9.45	667.31							2
489	3	43-RL	1645+89.60	119.42 LT	670.59		670.59							2
501	3	43-RL	1652+04.35	0.00 RT	675.68	4.93	670.75							2
503	3	43-RL	1652+04.35	102.61 LT	672.16		672.16							
505	4	43-RL	1653+39.34	95.73 RT	673.65		673.65							
507	3	43-RL	1654+24.94	101.94 LT	671.35		671.35							2
509	2	43-RL	1655+54.35	0.00 RT	674.29	3.33	670.96							
511	4	43-RL	1655+54.35	95.37 RT	672.57		672.57							
513	4	43-RL	1658+88.49	90.00 RT	671.94		671.94							
515	2	43-RL	1658+89.33	0.02 RT	672.98	4.95	668.03							2
517	3	43-RL	1658+96.76	104.12 LT	668.88		668.88							
518	3	43-RL	1661+20.35	0.00 RT	672.56	2.88	669.68							2
519	3	43-RL	1661+50.35	0.00 RT	672.56	2.88	669.68							2
520	3	43-RL	1661+35.35	0.00 RT	672.55	2.92	669.63							2
521	3	43-RL	1661+35.35	89.27 LT	671.10		671.10							
523	4	43-RL	1663+57.10	90.00 RT	671.26		671.26							2
525	2	43-RL	1663+52.48	0.00 RT	672.90	5.49	667.41							2
527	3	43-RL	1663+46.98	106.98 LT	668.32		668.32							2
531	3	43-RL	1667+04.35	0.00 RT	673.99	3.37	670.62							2
533	3	43-RL	1667+04.35	89.66 LT	672.08		672.08							
535	4	43-RL	1671+15.04	93.58 RT	672.48		672.48							2
537	2	43-RL	1671+11.84	0.00 RT	675.24	5.73	669.51							2
539	3	43-RL	1671+08.55	96.31 LT	671.55		671.55							
541	2	43-RL	1674+04.35	10.94 RT	678.18	5.33	672.85							
543	2	43-RL	1674+04.35	0.00 RT	676.49	5.03	671.46							2

\* ADDITIONAL QUANTITIES FOUND ELSEWHERE

\*\* STATIONS AND OFFSETS ARE TO CENTER OF STRUCTURE

\*\*\* FOR STRUCTURES WITH SUMPS, THE INVERT ELEVATION IS THE ELEVATION OF THE LOWEST PIPE FLOW LINE

\*\*\*\* DEPTH = RIM ELEV - TOP OF STRUCTURE BASE ELEV - COVER HEIGHT - 6 INCH ADJUSTMENT RING HEIGHT

PROJECT NO: 1229-04-76

HWY: IH 43

COUNTY: OZAUKEE

DRAINAGE QUANTITIES

SHEET: 1131

E

Addendum No. 3  
ID 1229-04-76  
Revised Sheet 1135  
November 5, 2021

STORM SEWER STRUCTURES

STRUCTURE	STAGE	LOCATION	STATION	OFFSET**	RIM ELEVATION	INVERT***	DEPTH****	MANHOLE COVERS	TYPE J	611.0530	611.0535*	611.0606	611.0624	611.0624	611.0624	611.0624*
					FT	FT	FT	TYPE J-SPECIAL	TYPE B	TYPE C	TYPE H	TYPE H-S	TYPE MS	TYPE H	TYPE H-S	TYPE MS
								EACH	EACH	EACH	EACH	EACH	EACH	EACH	EACH	EACH
943	4	PRA	1638+99.98	2.72 RT	678.89	672.00	5.90	1								
945	4	PRA	1641+92.48	2.73 RT	676.80	669.74	6.06	1								
947	4	PRA	1642+12.57	32.65 RT	671.72	671.72	0.00									
951	4	LD	43+65.79	30.76 LT	675.58	675.58	0.00									
953	4	LD	43+64.21	34.16 RT	674.32	674.32	0.00									
955	4	LD	43+73.76	30.24 LT	675.58	675.58	0.00									
957	4	LD	43+72.07	33.91 RT	674.32	674.32	0.00									
959	4	LD	44+72.18	17.00 LT	677.29	673.70	2.75					1				
961	4	LD	44+40.08	17.00 LT	677.38	672.95	3.64				1					
963	4	LD	44+72.18	17.00 RT	677.29	673.36	3.09					1				
965	4	LD	44+39.65	17.00 RT	677.38	672.11	4.52				1					
967	4	LD	43+85.67	50.06 RT	673.41	673.41	0.00									
969	4	LD	46+28.31	29.44 LT	676.11	676.11	0.00									
971	4	LD	46+26.74	30.99 RT	675.79	675.79	0.00									
973	4	LD	46+34.36	28.66 LT	676.11	676.11	0.00									
975	4	LD	46+32.99	30.14 RT	675.79	675.79	0.00									
981	3	FS	40+52.77	58.71 LT	706.00	706.00	0.00									
983	3	FS	40+51.91	73.16 RT	704.81	704.81	0.00									
985	4	FS	42+53.17	45.98 LT	704.59	704.59	0.00									
987	4	FS	42+54.98	62.14 RT	704.19	704.19	0.00									
989	2	FS	43+85.66	41.45 LT	720.06	720.06	0.00									
991	2	FS	44+26.66	31.61 LT	717.44	717.44	0.00									
993	2	FS	44+11.50	34.19 RT	718.93	718.93	0.00									
995	2	FS	44+45.84	30.67 RT	716.72	716.72	0.00									
T1001	2	43-RL	1520+39.87	71.15 RT	679.89	669.60	9.08	1								
T1003	2	43-RL	1520+97.64	74.83 RT	678.97	673.87	3.94				1					
T1004	2	43-RL	1520+89.88	71.16 RT	679.69	669.67	9.11	1								
T1005	2	43-RL	1522+58.27	97.66 LT	689.64	669.11	19.63	1								
T1007	2	HLD	1525+29.52	53.84 LT	672.03	672.03	0.00									
T1011	2	43-RL	1531+38.33	73.83 RT	684.50	673.89	9.71	1								
T1013	2	43-RL	1530+68.50	76.19 LT	681.11	673.52	6.68	1								
T1015	2	HLD	1530+55.63	30.87 LT	676.60	676.60	0.00									
TOTALS								6	23	4	53	11	50	8	190	

3

\* ADDITIONAL QUANTITIES FOUND ELSEWHERE  
 \*\* STATIONS AND OFFSETS ARE TO CENTER OF STRUCTURE  
 \*\*\* FOR STRUCTURES WITH SUMPS, THE INVERT ELEVATION IS THE ELEVATION OF THE LOWEST PIPE FLOW LINE  
 \*\*\*\* DEPTH = RIM ELEV - TOP OF STRUCTURE BASE ELEV - COVER HEIGHT - 6 INCH ADJUSTMENT RING HEIGHT

Addendum No. 3  
ID 1229-04-76  
Revised Sheet 1139  
November 5, 2021

STORM SEWER STRUCTURES

STRUCTURE	STAGE	LOCATION	STATION	OFFSET**	RIM ELEVATION	INVERT***	DEPTH****	DIAMETER	DIAMETER	DIAMETER	DIAMETER	DIAMETER	DIAMETER	DIAMETER	DIAMETER	DIAMETER	DIAMETER	
413	3	43-RL	1621+54.35	0.00' RT	675.62	672.55	3.27											611.3230
415	3	43-RL	1621+54.35	89.72' LT		673.99												611.3225
417	3	43-RL	1624+66.40	0.00' RT	674.31	667.75	6.77											611.3220
419	3	43-RL	1624+66.39	103.33' LT		668.94												611.3204
421	4	PRB	1626+58.17	18.64' RT		667.80												611.2007
422	4	PRB	1624+77.60	36.55' LT		667.54												611.3004
423	4	43-RL	1626+62.67	84.81' RT		666.96												611.2008
426	2	43-RL	1626+55.77	0.00' RT	673.43	669.31	4.33											611.2006
427	2	43-RL	1626+80.77	0.01' RT	673.29	666.68	5.79											611.2005
429	3	43-RL	1626+78.64	97.42' LT		666.35												611.2004*
431	3	PRC	1626+78.26	43.34' RT		666.20												MANHOLES 4-FIT
433	3	PRC	1626+78.15	44.25' LT		665.65												MANHOLES 5-FIT
435	4	PRB	1630+68.01	59.54' RT		672.75												MANHOLES 6-FIT
437	4	PRB	1630+30.25	76.94' LT		671.00												MANHOLES 7-FIT
439	3	43-RL	1632+29.35	0.00' RT	671.31	668.23	3.29											MANHOLES 8-FIT
441	3	43-RL	1631+79.35	0.00' RT	671.29	668.22	3.28											DIAMETER
443	3	43-RL	1632+04.35	0.00' LT	671.29	668.10	3.44											DIAMETER
445	3	43-RL	1635+04.37	91.01' LT		671.41												DIAMETER
447	4	43-RL	1635+04.56	80.29' RT		671.12												DIAMETER
449	2	43-RL	1637+04.35	0.00' RT	673.23	669.73	3.70											EACH
451	2	43-RL	1635+04.35	0.00' RT	672.34	668.63	3.96											EACH
453	3	43-RL	1635+04.35	20.00' LT	673.62	668.44	4.35											EACH
455	3	43-RL	1632+04.35	20.00' LT	672.62	667.54	4.26											EACH
467	3	43-RL	1631+54.98	88.84' LT		670.54												EACH
469	2	43-RL	1640+54.35	0.00' RT	674.77	671.31	3.67											EACH
471	4	43-RL	1640+54.33	86.36' RT		672.76												EACH
473	3	43-RL	1644+05.83	0.08' LT	676.06	669.50	6.81											EACH
475	3	43-RL	1644+05.83	125.07' LT		671.38												EACH
481	4	43-RL	1645+92.25	130.30' RT		671.38												EACH
483	3	43-RL	1645+81.59	119.62' LT		670.59												EACH
485	4	43-RL	1646+00.23	129.68' RT		671.39												EACH
487	2	43-RL	1645+94.70	0.00' RT	676.76	667.64	9.45											EACH
489	3	43-RL	1645+89.60	119.42' LT		670.59												EACH
501	3	43-RL	1652+04.35	0.00' RT	675.68	670.96	4.93											EACH
503	3	43-RL	1652+04.35	102.61' LT		672.16												EACH
505	4	43-RL	1653+39.34	95.73' RT		673.65												EACH
507	3	43-RL	1654+24.94	101.04' LT		671.35												EACH
509	2	43-RL	1655+54.35	0.00' RT	674.29	671.16	3.33											EACH
511	4	43-RL	1655+54.35	95.37' RT		672.57												EACH
513	4	43-RL	1658+88.49	90.00' RT		671.94												EACH
515	2	43-RL	1658+82.33	0.07' RT	672.98	668.28	4.95											EACH
517	3	43-RL	1658+96.76	104.12' LT		668.88												EACH
518	3	43-RL	1661+20.35	0.00' RT	672.56	669.88	2.88											EACH
519	3	43-RL	1661+50.35	0.00' RT	672.56	669.88	2.88											EACH
520	3	43-RL	1661+35.35	0.00' RT	672.55	669.84	2.92											EACH
521	3	43-RL	1661+35.35	89.27' LT		671.10												EACH
523	4	43-RL	1663+57.10	90.00' RT		671.26												EACH
525	2	43-RL	1663+52.48	0.00' RT	672.90	667.67	5.49											EACH
527	3	43-RL	1663+46.98	106.98' LT		668.32												EACH
531	3	43-RL	1667+04.35	0.00' RT	673.99	670.82	3.37											EACH
533	3	43-RL	1667+04.35	89.66' LT		672.08												EACH
535	4	43-RL	1671+15.04	93.58' RT		672.48												EACH
537	2	43-RL	1671+11.84	0.00' RT	675.24	669.76	5.73											EACH
539	3	43-RL	1671+08.55	96.31' LT		671.55												EACH
541	2	43-RL	1674+04.35	10.94' RT	678.18	671.72	5.33											EACH
543	2	43-RL	1674+04.35	0.00' RT	676.49	671.67	5.03											EACH

\* ADDITIONAL QUANTITIES FOUND ELSEWHERE  
\*\* STATIONS AND OFFSETS ARE TO CENTER OF STRUCTURE  
\*\*\* FOR STRUCTURES WITH SUMPS, THE INVERT ELEVATION IS THE ELEVATION OF THE LOWEST PIPE FLOW LINE  
\*\*\*\* DEPTH = RIM ELEV - TOP OF STRUCTURE BASE ELEV - COVER HEIGHT - 6 INCH ADJUSTMENT RING HEIGHT

PROJECT NO: 1229-04-76	COUNTY: OZAUKEE	DRAINAGE QUANTITIES	SHEET: 1139
HWY: IH 43	PLOT NAME: 022594_ss_020		PLOT SCALE: 1:1
Plot Name: I:\hwy_43\DWG\Drawings\1229-04-76 - North End MainlineSheetPlan\03 Estimate of Quantities\022594_ss_at.ppt	PLOT BY: BRIAN C. ADAMS		
	PLOT DATE: 11/8/2021 2:56:24 PM		

Addendum No. 3  
 ID 1229-04-76  
 Revised Sheet 1143  
 November 5, 2021

**STORM SEWER STRUCTURES**

STRUCTURE	STAGE	LOCATION	STATION	OFFSET**	RIM ELEVATION	INVERT*** DEPTH****	611.2004*		611.2005		611.2006		611.2007		611.3220		611.3225		611.3230		611.3902*		
							MANHOLES 4-FT DIAMETER EACH	MANHOLES 5-FT DIAMETER EACH	MANHOLES 6-FT DIAMETER EACH	MANHOLES 7-FT DIAMETER EACH	MANHOLES 8-FT DIAMETER EACH	MANHOLES 4-FT DIAMETER EACH	MANHOLES 5-FT DIAMETER EACH	MANHOLES 6-FT DIAMETER EACH	MANHOLES 7-FT DIAMETER EACH	MANHOLES 8-FT DIAMETER EACH	MANHOLES 4-FT DIAMETER EACH	MANHOLES 5-FT DIAMETER EACH	MANHOLES 6-FT DIAMETER EACH	MANHOLES 7-FT DIAMETER EACH	MANHOLES 8-FT DIAMETER EACH	INLETS 2X2.5-FT EACH	INLETS 2X2.5-FT EACH
943	4	PRA	1638+99.98	2.72 RT	678.89	672.00	5.90	1															
945	4	PRA	1641+92.48	2.73 RT	676.80	669.74	6.06	1															
947	4	PRA	1642+12.57	32.65 RT	671.72	675.58																	
951	4	LD	43+65.79	30.76 LT	675.58	674.32																	
953	4	LD	43+64.21	34.16 RT	674.32	675.58																	
955	4	LD	43+75.76	30.24 LT	675.58	674.32																	
957	4	LD	43+72.07	33.91 RT	674.32	673.70	2.75																
959	4	LD	44+72.18	17.00 LT	677.29	672.95	3.64																
961	4	LD	44+40.08	17.00 LT	677.38	672.95	3.09																
963	4	LD	44+72.18	17.00 RT	677.29	673.36	3.09																
965	4	LD	44+39.65	17.00 RT	677.38	672.11	4.52																
967	4	LD	43+85.67	50.06 RT	673.41	673.41																	
969	4	LD	46+28.31	29.44 LT	676.11	676.11																	
971	4	LD	46+26.74	30.99 RT	675.79	675.79																	
973	4	LD	46+34.36	28.66 LT	676.11	676.11																	
975	4	LD	46+32.99	30.14 RT	675.79	675.79																	
981	3	F5	40+52.77	58.71 LT	706.00	706.00																	
983	3	F5	40+51.91	73.16 RT	704.81	704.81																	
985	4	F5	42+53.17	45.98 LT	704.59	704.59																	
987	4	F5	42+54.98	62.14 RT	704.19	704.19																	
989	2	F5	43+85.66	41.45 LT	720.06	720.06																	
991	2	F5	44+26.66	31.61 LT	717.44	717.44																	
993	2	F5	44+11.50	34.19 RT	718.93	718.93																	
995	2	F5	44+45.84	30.67 RT	716.72	716.72																	
T1001	2	43-RL	1520+39.87	71.13 RT	679.89	669.90	9.08																
T1003	2	43-RL	1520+97.64	74.83 RT	678.97	673.87	3.94																
T1004	2	43-RL	1520+89.88	71.16 RT	679.69	669.67	9.11																
T1005	2	43-RL	1522+58.27	97.66 LT	689.64	669.11	19.63																
T1007	2	HL0	1525+29.52	53.84 LT	672.03	672.03																	
T1011	2	43-RL	1531+38.33	73.83 RT	684.50	673.89	9.71																
T1013	2	43-RL	1530+68.50	76.19 LT	681.11	673.52	6.68																
T1015	2	HL0	1530+55.63	30.87 LT	676.60	676.60																	
TOTALS								8	37	10	65	4	8	16	95								

3

\* ADDITIONAL QUANTITIES FOUND ELSEWHERE  
 \*\* STATIONS AND OFFSETS ARE TO CENTER OF STRUCTURE  
 \*\*\* FOR STRUCTURES WITH SUMPS, THE INVERT ELEVATION IS THE ELEVATION OF THE LOWEST PIPE FLOW LINE  
 \*\*\*\* DEPTH = RIM ELEV - TOP OF STRUCTURE BASE ELEV - COVER HEIGHT - 6 INCH ADJUSTMENT RING HEIGHT

Addendum No. 3  
ID 1229-04-76  
Revised Sheet 1146  
November 5, 2021

CULVERT PIPES

LOCATION	STAGE	FROM	TO	INLET ELEVATION	DISCHARGE ELEVATION	SLOPE FT/FT	522.0118* CPRC CLASS III 18-INCH LF	522.0124* CPRC CLASS III 24-INCH LF	522.0130* CPRC CLASS III 30-INCH LF	522.0136* CPRC CLASS III 36-INCH LF	522.0142 CPRC CLASS III 42-INCH LF	522.0148 CPRC CLASS III 48-INCH LF	522.0415 CPRC CLASS IV 15-INCH LF	522.0424 CPRC CLASS IV 24-INCH LF	522.0430 CPRC CLASS IV 30-INCH LF	522.0436 CPRC CLASS IV 36-INCH LF	522.0524 CPRC CLASS V 24-INCH LF	522.2338 CPRC CLASS HE-III 38X60-INCH LF	522.2429 CPRC CLASS HE-IV 29X45-INCH LF	522.2434 CPRC CLASS HE-IV 34X63-INCH LF	
43-RL	3	357	359	662.60	662.40	0.15%															
43-RL	3	371	373	665.10	664.62	0.50%															
43-RL	3	375	377	664.64	664.17	0.50%															170
43-RL	2/3/4	381	383	664.00	663.46	0.32%															169
43-RL	2/3/4	385	387	664.00	663.46	0.32%															
43-RL	3	388	390	664.22	664.17	0.30%															
43-RL	3	389	390	664.22	664.17	0.30%															
43-RL	3	390	391	664.17	663.85	0.38%															
43-RL	3	393	395	665.04	664.78	0.30%															
43-RL	2/4	397	399	665.43	664.94	0.50%															
43-RL	3	401	403	667.95	667.45	0.50%															
43-RL	3	405	407	669.55	669.00	0.50%															
43-RL	3	409	411	671.04	670.44	0.50%															
43-RL	3	415	415	672.55	672.28	0.30%															
43-RL	3	417	419	697.75	697.23	0.30%															
43-RL	4	421	423	687.80	687.54	0.46%															
43-RL	2/4	425	427	666.96	666.68	0.33%															
43-RL	2	426	427	669.31	669.18	0.30%															
43-RL	3	427	429	666.68	666.35	0.36%															
PRC	3	431	433	666.20	665.65	0.63%															
PRB	4	435	437	670.50	668.75	2.68%		142													
43-RL	3	439	443	668.23	668.10	0.30%															
43-RL	3	441	443	668.22	668.10	0.30%															
43-RL	3	443	455	668.10	668.00	0.30%															
43-RL	3	445	453	669.16	668.95	0.30%															
43-RL	2/4	447	451	668.87	668.63	0.30%															
43-RL	2	449	451	669.73	669.13	0.30%															
43-RL	3	451	453	668.63	668.57	0.30%															
43-RL	3	453	455	668.44	667.54	0.30%															
43-RL	3	455	467	667.54	667.29	0.30%															
43-RL	2/4	469	471	671.31	671.05	0.30%															
43-RL	3	473	475	669.50	669.13	0.30%															
43-RL	2/3/4	481	483	668.05	667.26	0.32%				250											
43-RL	2/4	485	487	668.06	667.64	0.32%															
43-RL	3	487	489	667.64	667.26	0.32%															
43-RL	3	501	503	670.96	670.45	0.50%															
43-RL	2/3/4	505	507	671.40	669.10	1.07%															
43-RL	2/4	509	511	671.16	670.86	0.31%															
43-RL	2/4	513	515	669.69	668.28	1.56%															
43-RL	3	515	517	668.28	666.63	1.58%															
43-RL	3	518	520	669.89	669.84	0.30%															
43-RL	3	519	520	669.89	669.84	0.30%															
43-RL	3	520	521	669.84	669.39	0.50%															
43-RL	2/4	523	525	669.01	667.67	1.49%															
43-RL	3	525	527	667.67	666.07	1.49%															
43-RL	3	531	533	670.82	670.37	0.50%															
43-RL	2/4	535	537	670.23	669.76	0.50%															
43-RL	3	537	539	669.77	669.30	0.48%															
43-RL	2	541	543	671.72	671.67	0.50%															
43-RL	3	543	545	671.67	671.61	0.50%															
43-RL	3	545	547	671.61	671.20	0.50%															
43-RL	2	549	551	674.87	674.84	0.50%															
43-RL	3	551	553	674.84	674.80	0.50%															
43-RL	3	553	555	674.80	674.40	0.50%															
43-RL	4	557	559	682.88	682.83	0.50%															
43-RL	3	559	561	682.83	682.49	0.50%															



CULVERT PIPES

LOCATION	STAGE	FROM	TO	ELEVATION	INLET	DISCHARGE	TO	ELEVATION	SLOPE	FT/FT	522.0118*	522.0124*	522.0130*	522.0136*	522.0142	522.0148	522.0415	522.0424	522.0430	522.0436	522.0524	522.2338	522.2429	522.2434
											CPRC CLASS III	CPRC CLASS III	CPRC CLASS III	CPRC CLASS III	CPRC CLASS III	CPRC CLASS III	CPRC CLASS IV	CPRC CLASS IV	CPRC CLASS IV	CPRC CLASS IV	CPRC CLASS V	CPRC CLASS HE-III	CPRC CLASS HE-IV	CPRC CLASS HE-IV
											18-INCH	24-INCH	30-INCH	36-INCH	42-INCH	48-INCH	15-INCH	24-INCH	30-INCH	36-INCH	24-INCH	38X60-INCH	29X45-INCH	34X63-INCH
											LF	LF	LF	LF	LF	LF	LF	LF	LF	LF	LF	LF	LF	LF
PR	3	933	935	678.30	677.90				0.82%															
PRA	3	939	941	674.28	673.98				0.77%															
PRA	4	941	943	673.98	672.00				0.77%															
PRA	4	943	945	672.00	669.74				0.77%															
PRA	4	945	947	669.74	669.47				0.77%															
LD	4	951	953	671.70	670.45				1.92%						65									
LD	4	955	957	671.70	670.45				1.95%						64									
LD	4	959	961	673.70	673.45				0.78%															
LD	4	961	965	672.95	672.61				1.00%															
LD	4	963	965	673.36	673.11				0.78%															
LD	4	965	967	672.11	671.16				1.59%															
LD	4	969	971	673.32	673.00				0.58%	60														
LD	4	973	975	673.32	673.00				0.58%	59														
FS	3	981	983	703.75	702.56				0.96%															
FS	4	985	987	702.34	701.94				0.37%															
FS	2	989	991	718.62	716.00				6.21%															
FS	2	993	995	717.49	715.28				6.39%															
43-HL	2	T1001	T1003	669.90	669.67				0.30%															
43-HL	2	T1003	T1004	673.87	673.83				0.50%															
43-HL	2	T1004	T1005	669.67	669.11																			
43-HL	2	T1005	T1007	669.11	668.70				0.16%															
43-HL	2	T1011	T1013	673.89	673.52																			
43-HL	2	T1013	T1015	673.52	673.27				0.30%															
TOTALS											49	630	119	750	129	88	77	397	418	58	240	404	336	339

3

3

3

3

Addendum No. 3  
 ID 1229-04-76  
 Revised Sheet 1149  
 November 5, 2021

SHEET: 1149

PLOT NAME: 022594\_ss\_d80

PLOT DATE: 11/8/2021 2:54:24 PM

COUNTY: OZAUKEE

PROJECT NO: 1229-04-76

HWY: IH 43

DRAINAGE QUANTITIES

ESTIMATE OF QUANTITIES

PLAN FILE: D:\Projects\1229-04-76 - North End Mainline\Drawings\Plan\03

Addendum No. 3  
ID 1229-04-76  
Revised Sheet 1152  
November 5, 2021

STORM SEWER PIPES

LOCATION	STAGE	FROM	TO	ELEVATION	DISCHARGE	SLOPE	FT/FT	608.0315 SSPRC CLASS III 15-INCH	608.0318* SSPRC CLASS III 18-INCH	608.0324* SSPRC CLASS III 24-INCH	608.0330* SSPRC CLASS III 30-INCH	608.0336* SSPRC CLASS III 36-INCH	608.0412 SSPRC CLASS IV 12-INCH	608.0415 SSPRC CLASS IV 15-INCH	608.0418* SSPRC CLASS IV 18-INCH	608.0430 SSPRC CLASS IV 30-INCH	608.0436 SSPRC CLASS IV 36-INCH	608.0448 SSPRC CLASS IV 48-INCH	608.0536 SSPRC CLASS V 36-INCH	608.0560 SSPRC CLASS V 60-INCH	608.2434 SSPRC CLASS HE-IV 36-INCH	SPV0090.8001 SSPRC SPECIAL 36-INCH	
43-RL	3	357	359	662.60	662.40	0.13%																	
43-RL	3	371	373	665.10	664.62	0.50%		97															
43-RL	3	375	377	664.64	664.17	0.50%																	
43-RL	2/3/4	381	383	664.00	663.46	0.32%																	
43-RL	2/3/4	385	387	664.00	663.46	0.32%																	
43-RL	3	388	390	664.22	664.17	0.30%																	
43-RL	3	389	390	664.22	664.17	0.30%																	
43-RL	3	390	391	664.17	663.85	0.38%																	
43-RL	3	393	395	665.04	664.78	0.30%																	
43-RL	2/4	397	399	665.43	664.94	0.50%		98															
43-RL	3	401	403	667.95	667.45	0.30%		100															
43-RL	3	405	407	669.35	669.00	0.30%		110															
43-RL	3	409	411	670.75	670.34	0.38%		120															
43-RL	3	413	415	672.15	671.26	0.30%		103															
43-RL	3	417	419	667.75	667.25	0.50%																	
43-RL	4	421	423	667.80	667.54	0.43%																	
43-RL	2/4	425	427	666.96	666.68	0.33%																	
43-RL	2	426	427	669.31	669.18	0.50%																	
43-RL	3	427	429	666.68	666.35	0.34%																	
PRC	3	431	433	666.20	665.65	0.63%																	
PRC	4	435	437	670.50	668.75	1.24%																	
43-RL	3	439	443	668.23	668.10	0.50%																	
43-RL	3	441	443	668.22	668.10	0.50%																	
43-RL	3	443	445	668.10	668.00	0.50%																	
43-RL	3	445	453	669.16	668.95	0.30%																	
43-RL	2/4	447	451	668.87	668.63	0.30%																	
43-RL	2	449	451	669.73	669.13	0.30%																	
43-RL	3	451	453	668.63	668.57	0.30%																	
43-RL	3	453	455	668.44	667.54	0.30%																	
43-RL	3	455	467	667.54	667.29	0.30%																	
43-RL	3	459	471	671.31	671.05	0.30%																	
43-RL	3	473	475	669.50	669.13	0.30%																	
43-RL	2/3/4	481	483	668.05	667.26	0.32%																	
43-RL	2/4	485	487	668.06	667.64	0.32%																	
43-RL	3	487	489	667.64	667.26	0.32%																	
43-RL	3	501	503	670.96	670.45	0.50%																	
43-RL	2/3/4	505	507	671.40	669.10	1.07%																	
43-RL	2/4	509	511	671.16	670.86	0.31%																	
43-RL	2/4	513	515	669.99	668.26	1.34%																	
43-RL	3	517	519	668.85	668.88	0.00%																	
43-RL	3	519	520	668.80	669.84	0.30%																	
43-RL	3	519	520	669.89	669.88	0.30%																	
43-RL	3	520	521	669.84	669.39	0.50%																	
43-RL	2/4	523	525	669.01	667.67	1.49%																	
43-RL	3	525	527	667.67	666.07	1.49%																	
43-RL	3	531	533	670.82	670.37	0.50%																	
43-RL	2/4	535	537	670.23	669.76	0.50%																	
43-RL	3	537	539	669.77	669.30	0.48%																	
43-RL	2	541	543	671.72	671.67	0.50%																	
43-RL	3	543	545	671.67	671.61	0.50%																	
43-RL	3	545	547	671.61	671.20	0.50%																	
43-RL	2	549	551	674.87	674.84	0.50%																	
43-RL	3	551	553	674.84	674.80	0.50%																	
43-RL	3	553	555	674.80	674.40	0.50%																	
43-RL	4	557	559	682.88	682.83	0.50%																	
43-RL	3	559	561	682.83	682.49	0.50%																	

25 85 97 3

3

STORM SEWER PIPES

LOCATION	STAGE	FROM	TO	ELEVATION	DISCHARGE	SLOPE	FT/FT	608.0315 SSPRC CLASS III 15-INCH	608.0318* SSPRC CLASS III 18-INCH	608.0324* SSPRC CLASS III 24-INCH	608.0330* SSPRC CLASS III 30-INCH	608.0336* SSPRC CLASS III 36-INCH	608.0412 SSPRC CLASS IV 12-INCH	608.0415 SSPRC CLASS IV 15-INCH	608.0418* SSPRC CLASS IV 18-INCH	608.0424 SSPRC CLASS IV 24-INCH	608.0430 SSPRC CLASS IV 30-INCH	608.0436 SSPRC CLASS IV 36-INCH	608.0448 SSPRC CLASS IV 48-INCH	608.0560 SSPRC CLASS V 60-INCH	608.2434 SSPRC CLASS HE-IV 36-INCH	SPV0090.8001 LF
PR	3	933	935	678.30	677.50	0.82%																
PRA	3	939	941	674.28	673.98	0.77%	39															
PRA	4	941	943	673.98	672.00	0.77%	257															
PRA	4	943	945	672.00	669.74	0.77%	292															
PRA	4	945	947	669.74	669.47	0.77%	36															
LD	4	951	953	671.70	670.45	1.92%																
LD	4	955	957	671.70	670.45	1.95%																
LD	4	959	961	673.70	673.45	0.88%																
LD	4	961	965	672.95	672.61	1.00%	32															
LD	4	963	965	673.36	673.11	0.88%	33															
LD	4	965	967	672.11	671.16	1.50%	63															
LD	4	969	971	673.32	673.00	0.53%																
LD	4	973	975	673.32	673.00	0.48%																
ES	4	983	985	703.36	703.56	0.90%																
ES	4	985	987	703.36	701.94	0.37%																
FS	2	989	991	718.62	715.00	6.21%																
FS	2	993	995	717.49	715.28	6.38%																
43-RU	2	T1001	T1003	669.90	669.67	0.50%																
43-RU	2	T1003	T1004	673.87	673.83	0.50%																
43-RU	2	T1004	T1005	669.67	669.11																	
43-RU	2	T1005	T1007	669.11	668.70	0.14%																
43-RU	2	T1011	T1013	673.89	673.52																	
43-RU	2	T1013	T1015	673.52	673.27	0.30%																
TOTALS				1115	2308	4498		2159	1376	392	48	5752	2750	767	286	138	916	458	386			1399

3

2 3

3

Addendum No. 2  
ID 1229-04-76  
Revised Sheet 1155  
November 1, 2021

Addendum No. 3  
ID 1229-04-76  
Revised Sheet 1155  
November 5, 2021

RAMP GATE

STATION	OFFSET	LOCATION	RAMP GATE	RAMP GATE	RAMP CLOSURE	RAMP CLOSURE	CONCRETE BASES	CONCRETE TYPE 5
28-FT	32-FT	37-FT	40-FT	EACH	EACH	EACH	EACH	EACH
1524HLA+79	28' RT	HIGHLAND RD RAMP A	--	--	1	1	1	1
1523HLC+66	29' RT	HIGHLAND RD RAMP C	--	--	1	1	1	1
1523HLC+68	55' LT	HIGHLAND RD RAMP C	--	--	1	1	1	1
263PR+95	67' LT	CTH C RAMP A	1	--	--	--	1	1
1632PRC+81	64' LT	CTH C RAMP C	--	1	--	--	1	1
1633PRA+76	34' LT	CTH C RAMP A	--	1	--	--	1	1
1632PRC+99	35' RT	CTH C RAMP C	--	1	--	--	1	1
PROJECT 1229-04-76 TOTAL			1	1	1	4	7	7

DELINEATORS

STATION TO	STATION	OFFSET	LOCATION	DELINEATOR	DELINEATOR	DELINEATOR	DELINEATOR
1482+00	-	1497+00	RT/LT	I43	5	5	5
1497+00	-	1512+50	RT/LT	I43	11	11	11
1512+50	-	1528+00	RT/LT	I43	--	--	--
15280+00	-	1543+25	RT/LT	I43	20	20	20
1543+25	-	1558+50	RT/LT	I43	14	14	14
1558+50	-	1573+50	RT/LT	I43	7	7	7
1573+50	-	1589+00	RT/LT	I43	8	8	8
1589+00	-	1604+25	RT/LT	I43	12	12	12
1604+25	-	1619+50	RT/LT	I43	27	27	27
1619+50	-	1634+75	RT/LT	I43	15	15	15
1634+75	-	1650+00	RT/LT	I43	29	29	29
1650+00	-	1665+25	RT/LT	I43	17	17	17
1665+25	-	1680+50	RT/LT	I43	3	3	3
1680+50	-	1695+75	RT/LT	I43	2	2	2
1695+75	-	1711+00	RT/LT	I43	6	6	6
1711+00	-	1726+25	RT/LT	I43	8	8	8
1726+25	-	1741+50	RT/LT	I43	8	8	8
1741+50	-	1756+75	RT/LT	I43	13	13	13
1756+75	-	1772+00	RT/LT	I43	33	33	33
1772+00	-	1787+00	RT/LT	I43	29	29	29
1787+00	-	1801+00	RT/LT	I43	1	1	1
PROJECT 1229-04-76 TOTAL					268	268	268

BASIC TRAFFIC QUEUE WARNING SYSTEM

LOCATION	DAY
PROJECT 1229-04-76	1500
PROJECT 1229-04-76 TOTAL	1500

3

Addendum No. 3  
 ID 1229-04-76  
 Revised Sheet 1201  
 November 5, 2021

ALL ITEMS CATEGORY 1000 UNLESS OTHERWISE NOTED

**MAINTAIN AND SALVAGE TRAFFIC CONTROL SIGNS LEFT IN PLACE**

SPV.0060.0011	
MAINTAIN AND SALVAGE TRAFFIC CONTROL SIGNS LEFT IN PLACE	
LOCATION	EACH
HIGHLAND RD DETOUR	80
LAKEFIELD RD DETOUR	93
FALLS RD DETOUR	105
<b>PROJECT 1229-04-76 TOTAL</b>	<b>278</b>

**SANITARY SEWER ITEMS**

SPV.0060.5000			
ADJUSTING SANITARY MANHOLE EACH			
CATEGORY	ROADWAY	STATION	OFFSET
7030	HIGHLAND ROAD	10HL+47.0	7.9RT
MEQUON			
		EXISTING ELEVATION	PROPOSED ELEVATION DIFF
		688.65	689.33 0.68
<b>PROJECT 1229-04-76 TOTAL</b>			<b>1</b>

**EXPOSING EXISTING UTILITIES**

SPV.0060.0970	
EXPOSING EXISTING INFRASTRUCTURE PAVED AREA	
LOCATION	EACH
UNDISTRIBUTED	10
<b>PROJECT 1229-04-76 TOTAL</b>	<b>10</b>

SPV.0060.0975	
EXPOSING EXISTING INFRASTRUCTURE UNPAVED AREA	
LOCATION	EACH
UNDISTRIBUTED	10
<b>PROJECT 1229-04-76 TOTAL</b>	<b>10</b>

**SURVEY PROJECT**

SPV.0060.1000	
SURVEY PROJECT 1229-04-76	
LOCATION	EACH
PROJECT 1229-04-76 TOTAL	1

**Addendum No. 3  
ID 1229-04-76  
Revised Sheet 1204  
November 5, 2021**

**PAVEMENT CLEANUP PROJECT**

SPV.0075.0601	
PAVEMENT CLEANUP PROJECT 1229-04-76	
LOCATION	HR
PROJECT 1229-04-76 TOTAL	500

**FENCE CHAIN LINK**

SPV.0090.0005			
FENCE CHAIN LINK POLYMER COATED 4-FT ROAD BARRIER			
STATION	TO STATION	OFFSET	LF
18HL+63	- 19HL+18	LT	88
18HL+68	- 19HL+18	RT	69
20HL+87	- 20HL+97	LT	12
20HL+87	- 20HL+95	RT	11
<b>PROJECT 1229-04-76 TOTAL</b>			<b>180</b>

**FIELD OFFICE SPECIAL**

SPV.0135.0001	
FIELD OFFICE SPECIAL MONTH	
PROJECT 1229-04-76 TOTAL	27

ALL ITEMS CATEGORY 1000 UNLESS OTHERWISE NOTED



Proposal Schedule of Items

Proposal ID: 20211109009 Project(s): 1229-04-76

Federal ID(s): WISC 2022007

SECTION: 0001 Contract Items

Alt Set ID: Alt Mbr ID:

Proposal Line Number	Item ID Description	Approximate Quantity and Units	Unit Price	Bid Amount
0002	201.0105 Clearing	363.000 STA	_____.	_____.
0004	201.0120 Clearing	390.000 ID	_____.	_____.
0006	201.0205 Grubbing	363.000 STA	_____.	_____.
0008	201.0220 Grubbing	390.000 ID	_____.	_____.
0010	203.0100 Removing Small Pipe Culverts	22.000 EACH	_____.	_____.
0012	203.0211.S Abatement of Asbestos Containing Material (structure) 4000. B-45-24	1.000 EACH	_____.	_____.
0014	203.0211.S Abatement of Asbestos Containing Material (structure) 4001. B-45-22	1.000 EACH	_____.	_____.
0016	203.0211.S Abatement of Asbestos Containing Material (structure) 4002. B-45-23	1.000 EACH	_____.	_____.
0018	203.0211.S Abatement of Asbestos Containing Material (structure) 4003. B-45-24	1.000 EACH	_____.	_____.
0020	203.0211.S Abatement of Asbestos Containing Material (structure) 4004. B-45-25	1.000 EACH	_____.	_____.
0022	203.0220 Removing Structure (structure) 4000. B-45-24	1.000 EACH	_____.	_____.
0024	203.0220 Removing Structure (structure) 4001. B-45-22	1.000 EACH	_____.	_____.
0026	203.0220 Removing Structure (structure) 4002. B-45-25	1.000 EACH	_____.	_____.
0028	203.0220 Removing Structure (structure) 4003. B-45-21	1.000 EACH	_____.	_____.



Proposal Schedule of Items

Proposal ID: 20211109009 Project(s): 1229-04-76

Federal ID(s): WISC 2022007

SECTION: 0001 Contract Items

Alt Set ID: Alt Mbr ID:

Proposal Line Number	Item ID Description	Approximate Quantity and Units	Unit Price	Bid Amount
0030	203.0220 Removing Structure (structure) 4004. B-45-24	1.000 EACH	_____.	_____.
0032	203.0220 Removing Structure (structure) 4005. B-45-23	1.000 EACH	_____.	_____.
0034	203.0220 Removing Structure (structure) 4006. B-45-28	1.000 EACH	_____.	_____.
0036	203.0330 Debris Containment (structure) 4001. B-45-21	1.000 EACH	_____.	_____.
0038	204.0100 Removing Concrete Pavement	174,860.000 SY	_____.	_____.
0042	204.0150 Removing Curb & Gutter	2,655.000 LF	_____.	_____.
0044	204.0157 Removing Concrete Barrier	168.000 LF	_____.	_____.
0048	204.0170 Removing Fence	58,757.000 LF	_____.	_____.
0050	204.0180 Removing Delineators and Markers	319.000 EACH	_____.	_____.
0052	204.0190 Removing Surface Drains	2.000 EACH	_____.	_____.
0054	204.0195 Removing Concrete Bases	33.000 EACH	_____.	_____.
0056	204.0220 Removing Inlets	91.000 EACH	_____.	_____.
0058	204.0245 Removing Storm Sewer (size) 0001. 12-Inch	318.000 LF	_____.	_____.
0060	204.0245 Removing Storm Sewer (size) 0002. 15-Inch	308.000 LF	_____.	_____.
0062	204.0245 Removing Storm Sewer (size) 0003. 18-Inch	1,369.000 LF	_____.	_____.



Proposal Schedule of Items

Proposal ID: 20211109009 Project(s): 1229-04-76

Federal ID(s): WISC 2022007

SECTION: 0001 Contract Items

Alt Set ID: Alt Mbr ID:

Proposal Line Number	Item ID Description	Approximate Quantity and Units	Unit Price	Bid Amount
0064	204.0245 Removing Storm Sewer (size) 0004. 24-Inch	115.000 LF	_____.	_____.
0066	204.0245 Removing Storm Sewer (size) 0005. 36-Inch	143.000 LF	_____.	_____.
0068	204.0260 Abandoning Inlets	28.000 EACH	_____.	_____.
0070	204.0265 Abandoning Wells	8.000 EACH	_____.	_____.
0072	204.0280 Sealing Pipes	65.000 EACH	_____.	_____.
0074	204.0291.S Abandoning Sewer	134.000 CY	_____.	_____.
0076	204.9035.S Removing (item description) 0001. Removing Riprap	81.000 CY	_____.	_____.
0078	204.9060.S Removing (item description) 0001. Removing Cable Barrier Terminal	35.000 EACH	_____.	_____.
0080	204.9060.S Removing (item description) 0002. Removing Apron Endwalls	44.000 EACH	_____.	_____.
0082	204.9060.S Removing (item description) 1001. Removing Lighting Units	8.000 EACH	_____.	_____.
0084	204.9060.S Removing (item description) 3101. Removing Traffic Signals CTH W & Highland Rd	1.000 EACH	_____.	_____.
0086	204.9060.S Removing (item description) 3102. Removing Traffic Signals Cth C & Cth W	1.000 EACH	_____.	_____.
0088	204.9060.S Removing (item description) 3103. Removing Traffic Signals IH 43 NB Ramps & Cth C	1.000 EACH	_____.	_____.





Proposal Schedule of Items

Proposal ID: 20211109009 Project(s): 1229-04-76

Federal ID(s): WISC 2022007

SECTION: 0001 Contract Items

Alt Set ID: Alt Mbr ID:

Proposal Line Number	Item ID Description	Approximate Quantity and Units	Unit Price	Bid Amount
0090	204.9060.S Removing (item description) 3104. Removing Loop Detector Wire & Lead in Cable CTH W & Highland Rd	1.000 EACH	_____.	_____.
0092	204.9060.S Removing (item description) 3105. Removing Loop Detector Wire and Lead- In Cable Cth C & Cth W	1.000 EACH	_____.	_____.
0094	204.9060.S Removing (item description) 3106. Removing Loop Detector Wire & Lead-In Cable IH 43 NB Ramps & CTH C	1.000 EACH	_____.	_____.
0096	204.9090.S Removing (item description) 0001. Removing Cable Barrier	30,972.000 LF	_____.	_____.
0098	204.9090.S Removing (item description) 0002. Removing Drain tile	2,000.000 LF	_____.	_____.
0100	204.9090.S Removing (item description) 0003. Removing Underdrain	65,000.000 LF	_____.	_____.
0102	204.9090.S Removing (item description) 0005. Removing Temporary Precast Trench Drain	2,865.000 LF	_____.	_____.
0104	205.0100 Excavation Common	429,318.000 CY	_____.	_____.
0106	205.3000.S Temporary Emergency Pullouts	7.000 EACH	_____.	_____.
0108	206.1000 Excavation for Structures Bridges (structure) 0001. B-45-111	LS	LUMP SUM	_____.
0110	206.1000 Excavation for Structures Bridges (structure) 4001. B-45-105	LS	LUMP SUM	_____.
0112	206.1000 Excavation for Structures Bridges (structure) 4002. B-45-107	LS	LUMP SUM	_____.



Proposal Schedule of Items

Proposal ID: 20211109009 Project(s): 1229-04-76

Federal ID(s): WISC 2022007

SECTION: 0001 Contract Items

Alt Set ID: Alt Mbr ID:

Proposal Line Number	Item ID Description	Approximate Quantity and Units	Unit Price	Bid Amount
0114	206.1000 Excavation for Structures Bridges (structure) 4003. B-45-110	LS	LUMP SUM	_____.
0116	206.1000 Excavation for Structures Bridges (structure) 4004. B-45-108	LS	LUMP SUM	_____.
0118	206.2000 Excavation for Structures Culverts (structure) 4000. B-45-28	LS	LUMP SUM	_____.
0120	206.5000 Cofferdams (structure) 4000. B-45-28	LS	LUMP SUM	_____.
0122	209.0200.S Backfill Controlled Low Strength	1,437.000 CY	_____.	_____.
0124	210.1500 Backfill Structure Type A	3,594.000 TON	_____.	_____.
0126	210.2500 Backfill Structure Type B	22.000 TON	_____.	_____.
0128	213.0100 Finishing Roadway (project) 0001. 1229-04-76	1.000 EACH	_____.	_____.
0130	305.0110 Base Aggregate Dense 3/4-Inch	13,112.000 TON	_____.	_____.
0132	305.0120 Base Aggregate Dense 1 1/4-Inch	367,682.000 TON	_____.	_____.
0134	311.0110 Breaker Run	760,073.000 TON	_____.	_____.
0136	311.0115 Breaker Run	4.000 CY	_____.	_____.
0140	390.0203 Base Patching Asphaltic	15,000.000 SY	_____.	_____.
0142	415.0410 Concrete Pavement Approach Slab	1,144.000 SY	_____.	_____.
0144	416.0170 Concrete Driveway 7-Inch	61.000 SY	_____.	_____.
0146	416.0620 Drilled Dowel Bars	114.000 EACH	_____.	_____.



Proposal Schedule of Items

Proposal ID: 20211109009 Project(s): 1229-04-76

Federal ID(s): WISC 2022007

SECTION: 0001 Contract Items

Alt Set ID: Alt Mbr ID:

Proposal Line Number	Item ID Description	Approximate Quantity and Units	Unit Price	Bid Amount
0148	416.1010 Concrete Surface Drains	17.000 CY	_____.	_____.
0150	416.1110 Concrete Shoulder Rumble Strips	113,095.000 LF	_____.	_____.
0152	450.1100.S Asphaltic Mixture For Extreme Conditions	400.000 TON	_____.	_____.
0154	455.0605 Tack Coat	16,429.000 GAL	_____.	_____.
0156	460.2000 Incentive Density HMA Pavement	41,934.000 DOL	1.00000	41,934.00
0158	460.6223 HMA Pavement 3 MT 58-28 S	36,806.000 TON	_____.	_____.
0160	460.6224 HMA Pavement 4 MT 58-28 S	15,524.000 TON	_____.	_____.
0162	465.0120 Asphaltic Surface Driveways and Field Entrances	197.000 TON	_____.	_____.
0164	465.0125 Asphaltic Surface Temporary	13,367.000 TON	_____.	_____.
0166	465.0315 Asphaltic Flumes	156.000 SY	_____.	_____.
0168	495.1000.S Cold patch	100.000 TON	_____.	_____.
0170	501.1000.S Ice Hot Weather Concreting	69,343.000 LB	_____.	_____.
0172	502.0100 Concrete Masonry Bridges	1,294.000 CY	_____.	_____.
0174	502.3200 Protective Surface Treatment	8,520.000 SY	_____.	_____.
0176	502.3210 Pigmented Surface Sealer	2,254.000 SY	_____.	_____.
0178	503.0137 Prestressed Girder Type I 36W-Inch	4,197.000 LF	_____.	_____.



Proposal Schedule of Items

Proposal ID: 20211109009 Project(s): 1229-04-76

Federal ID(s): WISC 2022007

SECTION: 0001 Contract Items

Alt Set ID: Alt Mbr ID:

Proposal Line Number	Item ID Description	Approximate Quantity and Units	Unit Price	Bid Amount
0180	503.0146 Prestressed Girder Type I 45W-Inch	4,160.000 LF	_____.	_____.
0182	504.0100 Concrete Masonry Culverts	6.000 CY	_____.	_____.
0184	504.0500 Concrete Masonry Retaining Walls	1,392.000 CY	_____.	_____.
0186	505.0400 Bar Steel Reinforcement HS Structures	69,655.000 LB	_____.	_____.
0188	505.0600 Bar Steel Reinforcement HS Coated Structures	848,410.000 LB	_____.	_____.
0190	505.0800.S Bar Steel Reinforcement HS Stainless Structures	8,760.000 LB	_____.	_____.
0192	506.2605 Bearing Pads Elastomeric Non-Laminated	174.000 EACH	_____.	_____.
0194	506.4000 Steel Diaphragms (structure) 0001. B-45-111	14.000 EACH	_____.	_____.
0196	506.4000 Steel Diaphragms (structure) 4000. B-45-105	28.000 EACH	_____.	_____.
0198	506.4000 Steel Diaphragms (structure) 4001. B-45-108	32.000 EACH	_____.	_____.
0200	506.4000 Steel Diaphragms (structure) 4002. B-45-107	32.000 EACH	_____.	_____.
0202	506.4000 Steel Diaphragms (structure) 4003. B-45-110	14.000 EACH	_____.	_____.
0204	506.4000 Steel Diaphragms (structure) 4004. B-45-109	36.000 EACH	_____.	_____.
0206	509.5100.S Polymer Overlay	1,142.000 SY	_____.	_____.



Proposal Schedule of Items

Proposal ID: 20211109009 Project(s): 1229-04-76

Federal ID(s): WISC 2022007

SECTION: 0001 Contract Items

Alt Set ID: Alt Mbr ID:

Proposal Line Number	Item ID Description	Approximate Quantity and Units	Unit Price	Bid Amount
0208	511.1100 Temporary Shoring	15,775.000 SF	_____.	_____.
0210	511.1200 Temporary Shoring (structure) 4000. B-45-28	200.000 SF	_____.	_____.
0212	511.1200 Temporary Shoring (structure) 4001. R-45-23	1,070.000 SF	_____.	_____.
0214	511.1200 Temporary Shoring (structure) 4002. R-45-26	1,070.000 SF	_____.	_____.
0216	513.2001 Railing Pipe	4,171.000 LF	_____.	_____.
0218	513.4091 Railing Tubular Screening	948.000 LF	_____.	_____.
0220	516.0500 Rubberized Membrane Waterproofing	352.000 SY	_____.	_____.
0222	520.8000 Concrete Collars for Pipe	314.000 EACH	_____.	_____.
0224	522.0118 Culvert Pipe Reinforced Concrete Class III 18-Inch	61.000 LF	_____.	_____.
0226	522.0124 Culvert Pipe Reinforced Concrete Class III 24-Inch	644.000 LF	_____.	_____.
0228	522.0130 Culvert Pipe Reinforced Concrete Class III 30-Inch	235.000 LF	_____.	_____.
0230	522.0136 Culvert Pipe Reinforced Concrete Class III 36-Inch	270.000 LF	_____.	_____.
0232	522.0142 Culvert Pipe Reinforced Concrete Class III 42-Inch	129.000 LF	_____.	_____.
0234	522.0415 Culvert Pipe Reinforced Concrete Class IV 15-Inch	77.000 LF	_____.	_____.



Proposal Schedule of Items

Proposal ID: 20211109009 Project(s): 1229-04-76

Federal ID(s): WISC 2022007

SECTION: 0001 Contract Items

Alt Set ID: Alt Mbr ID:

Proposal Line Number	Item ID Description	Approximate Quantity and Units	Unit Price	Bid Amount
0236	522.0424 Culvert Pipe Reinforced Concrete Class IV 24-Inch	397.000 LF	_____.	_____.
0238	522.0430 Culvert Pipe Reinforced Concrete Class IV 30-Inch	418.000 LF	_____.	_____.
0240	522.0524 Culvert Pipe Reinforced Concrete Class V 24-Inch	240.000 LF	_____.	_____.
0242	522.1015 Apron Endwalls for Culvert Pipe Reinforced Concrete 15-Inch	12.000 EACH	_____.	_____.
0244	522.1018 Apron Endwalls for Culvert Pipe Reinforced Concrete 18-Inch	70.000 EACH	_____.	_____.
0246	522.1024 Apron Endwalls for Culvert Pipe Reinforced Concrete 24-Inch	44.000 EACH	_____.	_____.
0248	522.1030 Apron Endwalls for Culvert Pipe Reinforced Concrete 30-Inch	26.000 EACH	_____.	_____.
0250	522.1036 Apron Endwalls for Culvert Pipe Reinforced Concrete 36-Inch	27.000 EACH	_____.	_____.
0252	522.1042 Apron Endwalls for Culvert Pipe Reinforced Concrete 42-Inch	4.000 EACH	_____.	_____.
0254	522.1048 Apron Endwalls for Culvert Pipe Reinforced Concrete 48-Inch	8.000 EACH	_____.	_____.
0256	522.1060 Apron Endwalls for Culvert Pipe Reinforced Concrete 60-Inch	1.000 EACH	_____.	_____.
0258	522.2338 Culvert Pipe Reinforced Concrete Horizontal Elliptical Class HE-III 38x60-Inch	404.000 LF	_____.	_____.
0260	522.2429 Culvert Pipe Reinforced Concrete Horizontal Elliptical Class HE-IV 29x45-Inch	336.000 LF	_____.	_____.



Proposal Schedule of Items

Proposal ID: 20211109009 Project(s): 1229-04-76

Federal ID(s): WISC 2022007

SECTION: 0001 Contract Items

Alt Set ID: Alt Mbr ID:

Proposal Line Number	Item ID Description	Approximate Quantity and Units	Unit Price	Bid Amount
0262	522.2434 Culvert Pipe Reinforced Concrete Horizontal Elliptical Class HE-IV 34x53-Inch	339.000 LF	_____.	_____.
0264	522.2629 Apron Endwalls for Culvert Pipe Reinforced Concrete Horizontal Elliptical 29x45-Inch	4.000 EACH	_____.	_____.
0266	522.2634 Apron Endwalls for Culvert Pipe Reinforced Concrete Horizontal Elliptical 34x53-Inch	5.000 EACH	_____.	_____.
0268	522.2638 Apron Endwalls for Culvert Pipe Reinforced Concrete Horizontal Elliptical 38x60-Inch	4.000 EACH	_____.	_____.
0270	531.1100 Concrete Masonry Ancillary Structures Type NS	39.000 CY	_____.	_____.
0272	531.1140 Steel Reinforcement HS Ancillary Structures Type NS	5,000.000 LB	_____.	_____.
0274	531.2024 Drilling Shaft 24-Inch	240.000 LF	_____.	_____.
0276	531.2030 Drilling Shaft 30-Inch	26.000 LF	_____.	_____.
0278	531.2036 Drilling Shaft 36-Inch	296.000 LF	_____.	_____.
0280	531.4050 Foundation Camera Pole 50-FT	3.000 EACH	_____.	_____.
0282	531.5220 Foundation Single-Shaft Type MF-II (structure) 1000. S-45-0225	2.000 EACH	_____.	_____.
0284	531.5310 Foundation Single-Shaft Type TC-I (structure) 1000. S-45-223	1.000 EACH	_____.	_____.
0286	531.6010 Foundation Two-Shaft Type FC-I (structure) 5000. S-45-008	1.000 EACH	_____.	_____.



Proposal Schedule of Items

Proposal ID: 20211109009 Project(s): 1229-04-76

Federal ID(s): WISC 2022007

SECTION: 0001 Contract Items

Alt Set ID: Alt Mbr ID:

Proposal Line Number	Item ID Description	Approximate Quantity and Units	Unit Price	Bid Amount
0288	531.6010 Foundation Two-Shaft Type FC-I (structure) 6000. S-45-0009	1.000 EACH	_____.	_____.
0290	531.6010 Foundation Two-Shaft Type FC-I (structure) 7000. S-45-0010	1.000 EACH	_____.	_____.
0292	531.6010 Foundation Two-Shaft Type FC-I (structure) 8000. S-45-0011	1.000 EACH	_____.	_____.
0294	531.6010 Foundation Two-Shaft Type FC-I (structure) 9000. S-45-0012	1.000 EACH	_____.	_____.
0296	531.6120 Foundation Two-Shaft Type FF-II (structure) 1000. S-45-403	1.000 EACH	_____.	_____.
0298	532.5220 Monotube Full Span Type II (structure) 1001. S-45-0225	1.000 EACH	_____.	_____.
0300	532.5310 Truss Cantilever 2-Chord Type I (structure) 1001. S-45-223	1.000 EACH	_____.	_____.
0302	532.6010 Truss Cantilever 4-Chord Type I (structure) 5001. S-45-008	1.000 EACH	_____.	_____.
0304	532.6010 Truss Cantilever 4-Chord Type I (structure) 6001. S-45-0009	1.000 EACH	_____.	_____.
0306	532.6010 Truss Cantilever 4-Chord Type I (structure) 7001. S-45-0010	1.000 EACH	_____.	_____.
0308	532.6010 Truss Cantilever 4-Chord Type I (structure) 8001. S-45-0011	1.000 EACH	_____.	_____.
0310	532.6010 Truss Cantilever 4-Chord Type I (structure) 9001. S-45-0012	1.000 EACH	_____.	_____.
0312	532.6120 Truss Full Span 4-Chord Type II (structure) 1001. S-45-403	1.000 EACH	_____.	_____.





Proposal Schedule of Items

Proposal ID: 20211109009 Project(s): 1229-04-76

Federal ID(s): WISC 2022007

SECTION: 0001 Contract Items

Alt Set ID: Alt Mbr ID:

Proposal Line Number	Item ID Description	Approximate Quantity and Units	Unit Price	Bid Amount
0314	541.0300.S Noise Barriers Double-Sided Sound Absorptive (structure) 5000. N-45-004	56,910.000 SF	_____.	_____.
0316	550.0010 Pre-Boring Unconsolidated Materials	21.000 LF	_____.	_____.
0318	550.0500 Pile Points	52.000 EACH	_____.	_____.
0320	550.1120 Piling Steel HP 12-Inch X 53 Lb	3,780.000 LF	_____.	_____.
0322	550.2126 Piling CIP Concrete 12 3/4 X 0.375-Inch	13,380.000 LF	_____.	_____.
0324	550.2128 Piling CIP Concrete 12 3/4 X 0.50-Inch	2,600.000 LF	_____.	_____.
0326	601.0409 Concrete Curb & Gutter 30-Inch Type A	731.000 LF	_____.	_____.
0328	601.0411 Concrete Curb & Gutter 30-Inch Type D	11,604.000 LF	_____.	_____.
0330	601.0555 Concrete Curb & Gutter 6-Inch Sloped 36-Inch Type A	200.000 LF	_____.	_____.
0332	601.0557 Concrete Curb & Gutter 6-Inch Sloped 36-Inch Type D	277.000 LF	_____.	_____.
0334	601.0590 Concrete Curb & Gutter 4-Inch Sloped 36-Inch Type TBTT	403.000 LF	_____.	_____.
0336	601.0600 Concrete Curb Pedestrian	24.000 LF	_____.	_____.
0338	602.0410 Concrete Sidewalk 5-Inch	25,312.000 SF	_____.	_____.
0340	602.0415 Concrete Sidewalk 6-Inch	2,056.000 SF	_____.	_____.
0342	602.0505 Curb Ramp Detectable Warning Field Yellow	146.000 SF	_____.	_____.



Proposal Schedule of Items

Proposal ID: 20211109009 Project(s): 1229-04-76

Federal ID(s): WISC 2022007

SECTION: 0001 Contract Items

Alt Set ID: Alt Mbr ID:

Proposal Line Number	Item ID Description	Approximate Quantity and Units	Unit Price	Bid Amount
0344	602.0605 Curb Ramp Detectable Warning Field Radial Yellow	107.000 SF	_____.	_____.
0346	603.1442 Concrete Barrier Type S42C	275.000 LF	_____.	_____.
0348	603.1456 Concrete Barrier Type S56C	98.000 LF	_____.	_____.
0350	603.3559 Concrete Barrier Transition Type S42 to S56	8.000 EACH	_____.	_____.
0352	603.3655 Concrete Barrier Transition Type V42 to S42	6.000 EACH	_____.	_____.
0354	603.8000 Concrete Barrier Temporary Precast Delivered	226,725.000 LF	_____.	_____.
0356	603.8125 Concrete Barrier Temporary Precast Installed	292,575.000 LF	_____.	_____.
0358	603.8500 Anchoring Concrete Barrier Temporary Precast	106,850.000 LF	_____.	_____.
0360	603.8505 Anchoring Concrete Barrier Temporary Precast on Bridge Decks	100.000 LF	_____.	_____.
0362	604.0400 Slope Paving Concrete	740.000 SY	_____.	_____.
0364	604.0500 Slope Paving Crushed Aggregate	939.000 SY	_____.	_____.
0366	606.0200 Riprap Medium	1,109.000 CY	_____.	_____.
0368	606.0300 Riprap Heavy	6.000 CY	_____.	_____.
0370	608.0315 Storm Sewer Pipe Reinforced Concrete Class III 15-Inch	1,119.000 LF	_____.	_____.



Proposal Schedule of Items

Proposal ID: 20211109009 Project(s): 1229-04-76

Federal ID(s): WISC 2022007

SECTION: 0001 Contract Items

Alt Set ID: Alt Mbr ID:

Proposal Line Number	Item ID Description	Approximate Quantity and Units	Unit Price	Bid Amount
0372	608.0318 Storm Sewer Pipe Reinforced Concrete Class III 18-Inch	2,651.000 LF	_____.	_____.
0374	608.0324 Storm Sewer Pipe Reinforced Concrete Class III 24-Inch	4,628.000 LF	_____.	_____.
0376	608.0330 Storm Sewer Pipe Reinforced Concrete Class III 30-Inch	377.000 LF	_____.	_____.
0378	608.0336 Storm Sewer Pipe Reinforced Concrete Class III 36-Inch	1,482.000 LF	_____.	_____.
0380	608.0348 Storm Sewer Pipe Reinforced Concrete Class III 48-Inch	24.000 LF	_____.	_____.
0382	608.0412 Storm Sewer Pipe Reinforced Concrete Class IV 12-Inch	392.000 LF	_____.	_____.
0384	608.0415 Storm Sewer Pipe Reinforced Concrete Class IV 15-Inch	228.000 LF	_____.	_____.
0386	608.0418 Storm Sewer Pipe Reinforced Concrete Class IV 18-Inch	6,507.000 LF	_____.	_____.
0388	608.0424 Storm Sewer Pipe Reinforced Concrete Class IV 24-Inch	2,750.000 LF	_____.	_____.
0390	608.0430 Storm Sewer Pipe Reinforced Concrete Class IV 30-Inch	767.000 LF	_____.	_____.
0392	608.0436 Storm Sewer Pipe Reinforced Concrete Class IV 36-Inch	287.000 LF	_____.	_____.
0394	608.0448 Storm Sewer Pipe Reinforced Concrete Class IV 48-Inch	198.000 LF	_____.	_____.
0396	608.0512 Storm Sewer Pipe Reinforced Concrete Class V 12-Inch	2,000.000 LF	_____.	_____.



Proposal Schedule of Items

Proposal ID: 20211109009 Project(s): 1229-04-76

Federal ID(s): WISC 2022007

SECTION: 0001 Contract Items

Alt Set ID: Alt Mbr ID:

Proposal Line Number	Item ID Description	Approximate Quantity and Units	Unit Price	Bid Amount
0398	608.0536 Storm Sewer Pipe Reinforced Concrete Class V 36-Inch	916.000 LF	_____.	_____.
0400	608.0560 Storm Sewer Pipe Reinforced Concrete Class V 60-Inch	458.000 LF	_____.	_____.
0402	608.2434 Storm Sewer Pipe Reinforced Concrete Horizontal Elliptical Class HE-IV 34x53-Inch	386.000 LF	_____.	_____.
0404	611.0530 Manhole Covers Type J	6.000 EACH	_____.	_____.
0406	611.0535 Manhole Covers Type J-Special	46.000 EACH	_____.	_____.
0408	611.0606 Inlet Covers Type B	4.000 EACH	_____.	_____.
0410	611.0610 Inlet Covers Type BW	53.000 EACH	_____.	_____.
0412	611.0612 Inlet Covers Type C	11.000 EACH	_____.	_____.
0414	611.0624 Inlet Covers Type H	50.000 EACH	_____.	_____.
0416	611.0639 Inlet Covers Type H-S	8.000 EACH	_____.	_____.
0418	611.0642 Inlet Covers Type MS	350.000 EACH	_____.	_____.
0420	611.2004 Manholes 4-FT Diameter	11.000 EACH	_____.	_____.
0422	611.2005 Manholes 5-FT Diameter	37.000 EACH	_____.	_____.
0424	611.2006 Manholes 6-FT Diameter	10.000 EACH	_____.	_____.
0426	611.2007 Manholes 7-FT Diameter	5.000 EACH	_____.	_____.



Proposal Schedule of Items

Proposal ID: 20211109009 Project(s): 1229-04-76

Federal ID(s): WISC 2022007

SECTION: 0001 Contract Items

Alt Set ID: Alt Mbr ID:

Proposal Line Number	Item ID Description	Approximate Quantity and Units	Unit Price	Bid Amount
0428	611.2008 Manholes 8-FT Diameter	1.000 EACH	_____.	_____.
0430	611.3004 Inlets 4-FT Diameter	65.000 EACH	_____.	_____.
0432	611.3220 Inlets 2x2-FT	4.000 EACH	_____.	_____.
0434	611.3225 Inlets 2x2.5-FT	8.000 EACH	_____.	_____.
0436	611.3230 Inlets 2x3-FT	16.000 EACH	_____.	_____.
0438	611.3902 Inlets Median 2 Grate	175.000 EACH	_____.	_____.
0440	611.8120.S Cover Plates Temporary	40.000 EACH	_____.	_____.
0442	612.0106 Pipe Underdrain 6-Inch	100,628.000 LF	_____.	_____.
0444	612.0206 Pipe Underdrain Unperforated 6-Inch	8,031.000 LF	_____.	_____.
0446	612.0406 Pipe Underdrain Wrapped 6-Inch	40,101.000 LF	_____.	_____.
0448	612.0700 Drain Tile Exploration	2,000.000 LF	_____.	_____.
0450	612.0806 Apron Endwalls for Underdrain Reinforced Concrete 6-Inch	421.000 EACH	_____.	_____.
0452	613.1100.S Cable Barrier Type 1	2,900.000 LF	_____.	_____.
0454	613.1200.S Cable Barrier End Terminal Type 1	5.000 EACH	_____.	_____.
0456	614.0150 Anchor Assemblies for Steel Plate Beam Guard	12.000 EACH	_____.	_____.
0458	614.0395 Guardrail Mow Strip Concrete	187.000 SY	_____.	_____.



Proposal Schedule of Items

Proposal ID: 20211109009 Project(s): 1229-04-76

Federal ID(s): WISC 2022007

SECTION: 0001 Contract Items

Alt Set ID: Alt Mbr ID:

Proposal Line Number	Item ID Description	Approximate Quantity and Units	Unit Price	Bid Amount
0460	614.0800 Crash Cushions Permanent	2.000 EACH	_____.	_____.
0462	614.0905 Crash Cushions Temporary	46.000 EACH	_____.	_____.
0464	614.2300 MGS Guardrail 3	58,586.000 LF	_____.	_____.
0466	614.2340 MGS Guardrail 3 L	850.000 LF	_____.	_____.
0468	614.2500 MGS Thrie Beam Transition	924.000 LF	_____.	_____.
0470	614.2610 MGS Guardrail Terminal EAT	30.000 EACH	_____.	_____.
0472	614.2620 MGS Guardrail Terminal Type 2	14.000 EACH	_____.	_____.
0474	616.0100 Fence Woven Wire (height) 0001. 5-Foot	54,882.000 LF	_____.	_____.
0476	616.0329 Gates Chain Link (width) 0001. 12-Foot	5.000 EACH	_____.	_____.
0478	616.0700.S Fence Safety	15,000.000 LF	_____.	_____.
0480	618.0100 Maintenance And Repair of Haul Roads (project) 0001. 1229-04-76	1.000 EACH	_____.	_____.
0482	619.1000 Mobilization	1.000 EACH	_____.	_____.
0484	620.0200 Concrete Median Blunt Nose	100.000 SF	_____.	_____.
0486	620.0300 Concrete Median Sloped Nose	1,973.000 SF	_____.	_____.
0488	624.0100 Water	11,600.000 MGAL	_____.	_____.
0490	627.0200 Mulching	60,000.000 SY	_____.	_____.



Proposal Schedule of Items

Proposal ID: 20211109009 Project(s): 1229-04-76

Federal ID(s): WISC 2022007

SECTION: 0001 Contract Items

Alt Set ID: Alt Mbr ID:

Proposal Line Number	Item ID Description	Approximate Quantity and Units	Unit Price	Bid Amount
0492	628.1104 Erosion Bales	1,000.000 EACH	_____.	_____.
0494	628.1504 Silt Fence	70,029.000 LF	_____.	_____.
0496	628.1520 Silt Fence Maintenance	70,029.000 LF	_____.	_____.
0498	628.1905 Mobilizations Erosion Control	4.000 EACH	_____.	_____.
0500	628.1910 Mobilizations Emergency Erosion Control	8.000 EACH	_____.	_____.
0502	628.2008 Erosion Mat Urban Class I Type B	10,973.000 SY	_____.	_____.
0504	628.2023 Erosion Mat Class II Type B	618,380.000 SY	_____.	_____.
0506	628.6510 Soil Stabilizer Type B	14.000 ACRE	_____.	_____.
0508	628.7005 Inlet Protection Type A	285.000 EACH	_____.	_____.
0510	628.7010 Inlet Protection Type B	66.000 EACH	_____.	_____.
0512	628.7015 Inlet Protection Type C	50.000 EACH	_____.	_____.
0514	628.7020 Inlet Protection Type D	9.000 EACH	_____.	_____.
0516	628.7504 Temporary Ditch Checks	12,034.000 LF	_____.	_____.
0518	628.7515.S Stone Ditch Checks	30.000 CY	_____.	_____.
0520	628.7555 Culvert Pipe Checks	312.000 EACH	_____.	_____.
0522	628.7560 Tracking Pads	8.000 EACH	_____.	_____.
0524	628.7570 Rock Bags	500.000 EACH	_____.	_____.



Proposal Schedule of Items

Proposal ID: 20211109009 Project(s): 1229-04-76

Federal ID(s): WISC 2022007

SECTION: 0001 Contract Items

Alt Set ID: Alt Mbr ID:

Proposal Line Number	Item ID Description	Approximate Quantity and Units	Unit Price	Bid Amount
0526	629.0210 Fertilizer Type B	389.000 CWT	_____.	_____.
0528	630.0120 Seeding Mixture No. 20	619.000 LB	_____.	_____.
0530	630.0200 Seeding Temporary	12,640.000 LB	_____.	_____.
0532	630.0500 Seed Water	3,820.000 MGAL	_____.	_____.
0534	631.1000 Sod Lawn	4,211.000 SY	_____.	_____.
0536	632.0201 Shrubs (species) (size) (root) 0001. Ninebark, CG, 1.5-Ft	350.000 EACH	_____.	_____.
0538	632.0201 Shrubs (species) (size) (root) 0002. Redosier Dogwood, CG, 1.5-Ft	350.000 EACH	_____.	_____.
0540	632.0201 Shrubs (species) (size) (root) 0003. Filbert, CG, 1.5-Ft	350.000 EACH	_____.	_____.
0542	632.9101 Landscape Planting Surveillance and Care Cycles	26.000 EACH	_____.	_____.
0544	633.0100 Delineator Posts Steel	268.000 EACH	_____.	_____.
0546	633.0500 Delineator Reflectors	268.000 EACH	_____.	_____.
0548	633.1000 Delineators Barrier Wall	118.000 EACH	_____.	_____.
0550	633.5200 Markers Culvert End	204.000 EACH	_____.	_____.
0552	634.0618 Posts Wood 4x6-Inch X 18-FT	195.000 EACH	_____.	_____.
0554	634.0622 Posts Wood 4x6-Inch X 22-FT	106.000 EACH	_____.	_____.
0556	634.0814 Posts Tubular Steel 2x2-Inch X 14-FT	71.000 EACH	_____.	_____.





Proposal Schedule of Items

Proposal ID: 20211109009 Project(s): 1229-04-76

Federal ID(s): WISC 2022007

SECTION: 0001 Contract Items

Alt Set ID: Alt Mbr ID:

Proposal Line Number	Item ID Description	Approximate Quantity and Units	Unit Price	Bid Amount
0558	634.0885 Posts Tubular Steel 2x2-Inch X 8.5-FT	6.000 EACH	_____.	_____.
0560	635.0200 Sign Supports Structural Steel HS	22,100.000 LB	_____.	_____.
0562	637.1220 Signs Type I Reflective SH	3,174.500 SF	_____.	_____.
0564	637.2210 Signs Type II Reflective H	3,378.720 SF	_____.	_____.
0566	637.2215 Signs Type II Reflective H Folding	185.660 SF	_____.	_____.
0568	637.2230 Signs Type II Reflective F	669.000 SF	_____.	_____.
0570	638.2101 Moving Signs Type I	3.000 EACH	_____.	_____.
0572	638.2102 Moving Signs Type II	1.000 EACH	_____.	_____.
0574	638.2601 Removing Signs Type I	21.000 EACH	_____.	_____.
0576	638.2602 Removing Signs Type II	247.000 EACH	_____.	_____.
0578	638.3000 Removing Small Sign Supports	279.000 EACH	_____.	_____.
0580	638.3100 Removing Structural Steel Sign Supports	42.000 EACH	_____.	_____.
0582	643.0300 Traffic Control Drums	184,193.000 DAY	_____.	_____.
0584	643.0420 Traffic Control Barricades Type III	35,395.000 DAY	_____.	_____.
0586	643.0705 Traffic Control Warning Lights Type A	70,789.000 DAY	_____.	_____.
0588	643.0715 Traffic Control Warning Lights Type C	18,755.000 DAY	_____.	_____.
0590	643.0800 Traffic Control Arrow Boards	2,331.000 DAY	_____.	_____.



Proposal Schedule of Items

Proposal ID: 20211109009 Project(s): 1229-04-76

Federal ID(s): WISC 2022007

SECTION: 0001 Contract Items

Alt Set ID: Alt Mbr ID:

Proposal Line Number	Item ID Description	Approximate Quantity and Units	Unit Price	Bid Amount
0592	643.0900 Traffic Control Signs	191,223.000 DAY	_____.	_____.
0594	643.0910 Traffic Control Covering Signs Type I	11.000 EACH	_____.	_____.
0596	643.0920 Traffic Control Covering Signs Type II	1,558.000 EACH	_____.	_____.
0598	643.1000 Traffic Control Signs Fixed Message	1,867.000 SF	_____.	_____.
0600	643.1050 Traffic Control Signs PCMS	1,438.000 DAY	_____.	_____.
0602	643.1055.S Truck or Trailer Mounted Attenuator	200.000 DAY	_____.	_____.
0604	643.1205.S Basic Traffic Queue Warning System	1,500.000 DAY	_____.	_____.
0606	643.4100.S Traffic Control Interim Lane Closure	200.000 EACH	_____.	_____.
0608	643.5000 Traffic Control	1.000 EACH	_____.	_____.
0610	645.0111 Geotextile Type DF Schedule A	66,830.000 SY	_____.	_____.
0612	645.0120 Geotextile Type HR	1,550.000 SY	_____.	_____.
0614	645.0130 Geotextile Type R	600.000 SY	_____.	_____.
0616	645.0140 Geotextile Type SAS	20,150.000 SY	_____.	_____.
0618	645.0220 Geogrid Type SR	102,885.000 SY	_____.	_____.
0620	646.1020 Marking Line Epoxy 4-Inch	55,468.000 LF	_____.	_____.
0622	646.1040 Marking Line Grooved Wet Ref Epoxy 4-Inch	101,740.000 LF	_____.	_____.



Proposal Schedule of Items

Proposal ID: 20211109009 Project(s): 1229-04-76

Federal ID(s): WISC 2022007

SECTION: 0001 Contract Items

Alt Set ID: Alt Mbr ID:

Proposal Line Number	Item ID Description	Approximate Quantity and Units	Unit Price	Bid Amount
0624	646.1545 Marking Line Grooved Wet Ref Contrast Epoxy 4-Inch	12,725.000 LF	_____.	_____.
0626	646.1555 Marking Line Grooved Contrast Permanent Tape 4-Inch	26,859.000 LF	_____.	_____.
0628	646.3020 Marking Line Epoxy 8-Inch	7,114.000 LF	_____.	_____.
0630	646.3555 Marking Line Grooved Contrast Permanent Tape 8-Inch	16,368.000 LF	_____.	_____.
0632	646.5020 Marking Arrow Epoxy	79.000 EACH	_____.	_____.
0634	646.5120 Marking Word Epoxy	13.000 EACH	_____.	_____.
0636	646.5220 Marking Symbol Epoxy	24.000 EACH	_____.	_____.
0638	646.5320 Marking Railroad Crossings Epoxy	5.000 EACH	_____.	_____.
0640	646.6120 Marking Stop Line Epoxy 18-Inch	547.000 LF	_____.	_____.
0642	646.6220 Marking Yield Line Epoxy 18-Inch	57.000 EACH	_____.	_____.
0644	646.6464 Cold Weather Marking Epoxy 4-Inch	20,000.000 LF	_____.	_____.
0646	646.6468 Cold Weather Marking Epoxy 8-Inch	2,000.000 LF	_____.	_____.
0648	646.7120 Marking Diagonal Epoxy 12-Inch	321.000 LF	_____.	_____.
0650	646.7220 Marking Chevron Epoxy 24-Inch	1,032.000 LF	_____.	_____.
0652	646.7420 Marking Crosswalk Epoxy Transverse Line 6-Inch	611.000 LF	_____.	_____.
0654	646.8120 Marking Curb Epoxy	412.000 LF	_____.	_____.



Proposal Schedule of Items

Proposal ID: 20211109009 Project(s): 1229-04-76

Federal ID(s): WISC 2022007

SECTION: 0001 Contract Items

Alt Set ID: Alt Mbr ID:

Proposal Line Number	Item ID Description	Approximate Quantity and Units	Unit Price	Bid Amount
0656	646.8220 Marking Island Nose Epoxy	20.000 EACH	_____.	_____.
0658	646.9000 Marking Removal Line 4-Inch	41,525.000 LF	_____.	_____.
0660	646.9010 Marking Removal Line Water Blasting 4-Inch	4,994.000 LF	_____.	_____.
0662	646.9055 Marking Removal Line Grooved Contrast Permanent Tape 4-Inch	9,791.000 LF	_____.	_____.
0664	646.9100 Marking Removal Line 8-Inch	500.000 LF	_____.	_____.
0666	646.9155 Marking Removal Line Grooved Contrast Permanent Tape 8-Inch	2,338.000 LF	_____.	_____.
0668	646.9310 Marking Removal Special Marking Water Blasting	5.000 EACH	_____.	_____.
0670	649.0105 Temporary Marking Line Paint 4-Inch	5,085.000 LF	_____.	_____.
0672	649.0120 Temporary Marking Line Epoxy 4-Inch	459,311.000 LF	_____.	_____.
0674	649.0220 Temporary Marking Line Epoxy 8-Inch	6,650.000 LF	_____.	_____.
0676	649.0760 Temporary Marking Raised Pavement Marker Type I	10,956.000 EACH	_____.	_____.
0678	652.0125 Conduit Rigid Metallic 2-Inch	147.000 LF	_____.	_____.
0680	652.0225 Conduit Rigid Nonmetallic Schedule 40 2-Inch	16,220.000 LF	_____.	_____.
0682	652.0235 Conduit Rigid Nonmetallic Schedule 40 3-Inch	3,062.000 LF	_____.	_____.
0684	652.0240 Conduit Rigid Nonmetallic Schedule 40 4-Inch	840.000 LF	_____.	_____.



Proposal Schedule of Items

Proposal ID: 20211109009 Project(s): 1229-04-76

Federal ID(s): WISC 2022007

SECTION: 0001 Contract Items

Alt Set ID: Alt Mbr ID:

Proposal Line Number	Item ID Description	Approximate Quantity and Units	Unit Price	Bid Amount
0686	652.0605 Conduit Special 2-Inch	1,470.000 LF	_____.	_____.
0688	652.0615 Conduit Special 3-Inch	341.000 LF	_____.	_____.
0690	652.0700.S Install Conduit into Existing Item	2.000 EACH	_____.	_____.
0692	652.0800 Conduit Loop Detector	1,413.000 LF	_____.	_____.
0694	653.0135 Pull Boxes Steel 24x36-Inch	11.000 EACH	_____.	_____.
0696	653.0140 Pull Boxes Steel 24x42-Inch	60.000 EACH	_____.	_____.
0698	653.0220 Junction Boxes 18x6x6-Inch	4.000 EACH	_____.	_____.
0700	653.0222 Junction Boxes 18x12x6-Inch	2.000 EACH	_____.	_____.
0702	653.0905 Removing Pull Boxes	59.000 EACH	_____.	_____.
0704	654.0101 Concrete Bases Type 1	5.000 EACH	_____.	_____.
0706	654.0102 Concrete Bases Type 2	9.000 EACH	_____.	_____.
0708	654.0105 Concrete Bases Type 5	39.000 EACH	_____.	_____.
0710	654.0106 Concrete Bases Type 6	11.000 EACH	_____.	_____.
0712	654.0110 Concrete Bases Type 10	3.000 EACH	_____.	_____.
0714	654.0217 Concrete Control Cabinet Bases Type 9 Special	1.000 EACH	_____.	_____.
0716	654.0230 Concrete Control Cabinet Bases Type L30	3.000 EACH	_____.	_____.



Proposal Schedule of Items

Proposal ID: 20211109009 Project(s): 1229-04-76

Federal ID(s): WISC 2022007

SECTION: 0001 Contract Items

Alt Set ID: Alt Mbr ID:

Proposal Line Number	Item ID Description	Approximate Quantity and Units	Unit Price	Bid Amount
0718	655.0210 Cable Traffic Signal 3-14 AWG	2,810.000 LF	_____.	_____.
0720	655.0230 Cable Traffic Signal 5-14 AWG	594.000 LF	_____.	_____.
0722	655.0240 Cable Traffic Signal 7-14 AWG	3,231.000 LF	_____.	_____.
0724	655.0260 Cable Traffic Signal 12-14 AWG	1,406.000 LF	_____.	_____.
0726	655.0270 Cable Traffic Signal 15-14 AWG	156.000 LF	_____.	_____.
0728	655.0320 Cable Type UF 2-10 AWG Grounded	2,307.000 LF	_____.	_____.
0730	655.0510 Electrical Wire Traffic Signals 12 AWG	1,043.000 LF	_____.	_____.
0732	655.0515 Electrical Wire Traffic Signals 10 AWG	39,831.000 LF	_____.	_____.
0734	655.0610 Electrical Wire Lighting 12 AWG	5,313.000 LF	_____.	_____.
0736	655.0620 Electrical Wire Lighting 8 AWG	4,878.000 LF	_____.	_____.
0738	655.0625 Electrical Wire Lighting 6 AWG	15,539.000 LF	_____.	_____.
0740	655.0635 Electrical Wire Lighting 2 AWG	440.000 LF	_____.	_____.
0742	655.0700 Loop Detector Lead In Cable	6,654.000 LF	_____.	_____.
0744	655.0800 Loop Detector Wire	5,212.000 LF	_____.	_____.
0746	655.0900 Traffic Signal EVP Detector Cable	2,810.000 LF	_____.	_____.
0748	656.0200 Electrical Service Meter Breaker Pedestal (location) 2001. SDS450058	LS	LUMP SUM	_____.



Proposal Schedule of Items

Proposal ID: 20211109009 Project(s): 1229-04-76

Federal ID(s): WISC 2022007

SECTION: 0001 Contract Items

Alt Set ID: Alt Mbr ID:

Proposal Line Number	Item ID Description	Approximate Quantity and Units	Unit Price	Bid Amount
0750	656.0200 Electrical Service Meter Breaker Pedestal (location) 2002. CCTV450239	LS	LUMP SUM	_____.
0752	656.0200 Electrical Service Meter Breaker Pedestal (location) 2003. SDS450060	LS	LUMP SUM	_____.
0754	656.0200 Electrical Service Meter Breaker Pedestal (location) 2004. CCTV450240	LS	LUMP SUM	_____.
0756	656.0200 Electrical Service Meter Breaker Pedestal (location) 2005. DMS450038	LS	LUMP SUM	_____.
0758	656.0200 Electrical Service Meter Breaker Pedestal (location) 2006. CS450001	LS	LUMP SUM	_____.
0760	656.0200 Electrical Service Meter Breaker Pedestal (location) 2007. CCTV450141	LS	LUMP SUM	_____.
0762	656.0200 Electrical Service Meter Breaker Pedestal (location) 3101. CTH W & Highland Rd	LS	LUMP SUM	_____.
0764	656.0200 Electrical Service Meter Breaker Pedestal (location) 3102. IH 43 NB Ramps & CTH C	LS	LUMP SUM	_____.
0766	656.0400 Electrical Service Main Lugs Only Meter Pedestal (location) 1001. HL-45-HL	LS	LUMP SUM	_____.
0768	656.0400 Electrical Service Main Lugs Only Meter Pedestal (location) 1002. HL-40-PN	LS	LUMP SUM	_____.
0770	656.0400 Electrical Service Main Lugs Only Meter Pedestal (location) 1003. HL-40-UL	LS	LUMP SUM	_____.
0772	656.0500 Electrical Service Breaker Disconnect Box (location) 2001. SDS450058	LS	LUMP SUM	_____.
0774	656.0500 Electrical Service Breaker Disconnect Box (location) 2002. CCTV450239	LS	LUMP SUM	_____.



Proposal Schedule of Items

Proposal ID: 20211109009 Project(s): 1229-04-76

Federal ID(s): WISC 2022007

SECTION: 0001 Contract Items

Alt Set ID: Alt Mbr ID:

Proposal Line Number	Item ID Description	Approximate Quantity and Units	Unit Price	Bid Amount
0776	656.0500 Electrical Service Breaker Disconnect Box (location) 2003. SDS450060	LS	LUMP SUM	_____.
0778	656.0500 Electrical Service Breaker Disconnect Box (location) 2004. CCTV450240	LS	LUMP SUM	_____.
0780	656.0500 Electrical Service Breaker Disconnect Box (location) 2005. DMS450038	LS	LUMP SUM	_____.
0782	656.0500 Electrical Service Breaker Disconnect Box (location) 2006. CS450001	LS	LUMP SUM	_____.
0784	656.0500 Electrical Service Breaker Disconnect Box (location) 2007. CCTV450141	LS	LUMP SUM	_____.
0786	657.0100 Pedestal Bases	6.000 EACH		_____.
0788	657.0255 Transformer Bases Breakaway 11 1/2-Inch Bolt Circle	49.000 EACH		_____.
0790	657.0305 Poles Type 2	3.000 EACH		_____.
0792	657.0310 Poles Type 3	6.000 EACH		_____.
0794	657.0322 Poles Type 5-Aluminum	32.000 EACH		_____.
0796	657.0327 Poles Type 6-Aluminum	8.000 EACH		_____.
0798	657.0420 Traffic Signal Standards Aluminum 13-FT	5.000 EACH		_____.
0800	657.0425 Traffic Signal Standards Aluminum 15-FT	1.000 EACH		_____.
0802	657.0595 Trombone Arms 25-FT	4.000 EACH		_____.
0804	657.0609 Luminaire Arms Single Member 4-Inch Clamp 6-FT	8.000 EACH		_____.





Proposal Schedule of Items

Proposal ID: 20211109009 Project(s): 1229-04-76

Federal ID(s): WISC 2022007

SECTION: 0001 Contract Items

Alt Set ID: Alt Mbr ID:

Proposal Line Number	Item ID Description	Approximate Quantity and Units	Unit Price	Bid Amount
0806	657.0610 Luminaire Arms Single Member 4 1/2-Inch Clamp 6-FT	33.000 EACH	_____.	_____.
0808	658.0173 Traffic Signal Face 3S 12-Inch	21.000 EACH	_____.	_____.
0810	658.0174 Traffic Signal Face 4S 12-Inch	7.000 EACH	_____.	_____.
0812	658.0175 Traffic Signal Face 5S 12-Inch	1.000 EACH	_____.	_____.
0814	658.0416 Pedestrian Signal Face 16-Inch	2.000 EACH	_____.	_____.
0816	658.0500 Pedestrian Push Buttons	2.000 EACH	_____.	_____.
0818	658.5069 Signal Mounting Hardware (location) 3101. CTH W & Highland Rd	LS	LUMP SUM	_____.
0820	658.5069 Signal Mounting Hardware (location) 3102. CTH C & CTH W	LS	LUMP SUM	_____.
0822	658.5069 Signal Mounting Hardware (location) 3103. Traffic Signal Mounting Hardware	LS	LUMP SUM	_____.
0824	659.1125 Luminaires Utility LED C	44.000 EACH	_____.	_____.
0826	659.2130 Lighting Control Cabinets 120/240 30-Inch	3.000 EACH	_____.	_____.
0828	661.0200 Temporary Traffic Signals for Intersections (location) 3101. CTH W & Highland Rd	LS	LUMP SUM	_____.
0830	661.0200 Temporary Traffic Signals for Intersections (location) 3102. CTH C & CTH W	LS	LUMP SUM	_____.
0832	661.0300 Generators	2.000 DAY	_____.	_____.



Proposal Schedule of Items

Proposal ID: 20211109009 Project(s): 1229-04-76

Federal ID(s): WISC 2022007

SECTION: 0001 Contract Items

Alt Set ID: Alt Mbr ID:

Proposal Line Number	Item ID Description	Approximate Quantity and Units	Unit Price	Bid Amount
0834	662.1028.S Ramp Closure Gates 28-FT	1.000 EACH	_____.	_____.
0836	662.1032.S Ramp Closure Gates 32-FT	1.000 EACH	_____.	_____.
0838	662.1037.S Ramp Closure Gates 37-FT	1.000 EACH	_____.	_____.
0840	662.1040.S Ramp Closure Gates 40-FT	4.000 EACH	_____.	_____.
0842	670.0100 Field System Integrator 2001. In FTMS	LS	LUMP SUM	_____.
0844	670.0100 Field System Integrator 3101. In Signals	LS	LUMP SUM	_____.
0846	670.0200 ITS Documentation 2001. In FTMS	LS	LUMP SUM	_____.
0848	670.0200 ITS Documentation 3101. In Signals	LS	LUMP SUM	_____.
0850	671.0132 Conduit HDPE 3-Duct 2-Inch	29,435.000 LF	_____.	_____.
0852	671.0232 Conduit HDPE Directional Bore 3-Duct 2-Inch	380.000 LF	_____.	_____.
0854	673.0105 Communication Vault Type 1	28.000 EACH	_____.	_____.
0856	673.0200 Tracer Wire Marker Posts	6.000 EACH	_____.	_____.
0858	673.0225.S Install Pole Mounted Cabinet	5.000 EACH	_____.	_____.
0860	674.0200 Cable Microwave Detector	7,830.000 LF	_____.	_____.
0862	674.0300 Remove Cable	3,610.000 LF	_____.	_____.
0864	675.0300 Install Mounted Controller Microwave Detector Assembly	28.000 EACH	_____.	_____.



Proposal Schedule of Items

Proposal ID: 20211109009 Project(s): 1229-04-76

Federal ID(s): WISC 2022007

SECTION: 0001 Contract Items

Alt Set ID: Alt Mbr ID:

Proposal Line Number	Item ID Description	Approximate Quantity and Units	Unit Price	Bid Amount
0866	677.0150 Install Camera Pole 50-FT	3.000 EACH	_____.	_____.
0868	677.0200 Install Camera Assembly	3.000 EACH	_____.	_____.
0870	678.0006 Install Fiber Optic Cable Outdoor Plant 6-CT	3,188.000 LF	_____.	_____.
0872	678.0072 Install Fiber Optic Cable Outdoor Plant 72-CT	31,515.000 LF	_____.	_____.
0874	678.0100.S Install Overhead Freeway DMS Full Matrix	1.000 EACH	_____.	_____.
0876	678.0200 Fiber Optic Splice Enclosure	1.000 EACH	_____.	_____.
0878	678.0300 Fiber Optic Splice	306.000 EACH	_____.	_____.
0880	678.0400 Fiber Optic Termination	36.000 EACH	_____.	_____.
0882	678.0500 Communication System Testing 2001. In FTMS	LS	LUMP SUM	_____.
0884	678.0500 Communication System Testing 3101. In Signals	LS	LUMP SUM	_____.
0886	678.0600 Install Ethernet Switches	9.000 EACH	_____.	_____.
0888	690.0150 Sawing Asphalt	26,254.000 LF	_____.	_____.
0890	690.0250 Sawing Concrete	53,572.000 LF	_____.	_____.
0892	715.0502 Incentive Strength Concrete Structures	20,000.000 DOL	1.00000	20,000.00
0894	715.0603 Incentive Strength Concrete Barrier	8,510.000 DOL	1.00000	8,510.00



Proposal Schedule of Items

Proposal ID: 20211109009 Project(s): 1229-04-76

Federal ID(s): WISC 2022007

SECTION: 0001 Contract Items

Alt Set ID: Alt Mbr ID:

Proposal Line Number	Item ID Description	Approximate Quantity and Units	Unit Price	Bid Amount
0896	715.0715 Incentive Flexural Strength Concrete Pavement	134,450.000 DOL	1.00000	134,450.00
0898	740.0440 Incentive IRI Ride	181,280.000 DOL	1.00000	181,280.00
0900	801.0117 Railroad Flagging Reimbursement	55,000.000 DOL	1.00000	55,000.00
0902	999.2000.S Installing and Maintaining Bird Deterrent System (station) 0001. Station 206+90PR	1.000 EACH	_____.	_____.
0904	999.2000.S Installing and Maintaining Bird Deterrent System (station) 0002. Station 41+52FS	1.000 EACH	_____.	_____.
0906	999.2000.S Installing and Maintaining Bird Deterrent System (station) 0003. Station 20+00HL	1.000 EACH	_____.	_____.
0908	999.2000.S Installing and Maintaining Bird Deterrent System (station) 0004. Station 1686+50RT	1.000 EACH	_____.	_____.
0910	999.2000.S Installing and Maintaining Bird Deterrent System (station) 0005. Station 1686+50LT	1.000 EACH	_____.	_____.
0912	ASP.1T0A On-the-Job Training Apprentice at \$5.00/HR	8,400.000 HRS	5.00000	42,000.00
0914	ASP.1T0G On-the-Job Training Graduate at \$5.00/HR	17,280.000 HRS	5.00000	86,400.00
0916	SPV.0030 Special 0001. Fertilizer Type B Special	8.000 CWT	_____.	_____.
0918	SPV.0035 Special 0001. Roadway Embankment	488,090.000 CY	_____.	_____.
0920	SPV.0035 Special 4000. High Performance Concrete (HPC) Masonry Structures	3,350.000 CY	_____.	_____.



Proposal Schedule of Items

Proposal ID: 20211109009 Project(s): 1229-04-76

Federal ID(s): WISC 2022007

SECTION: 0001 Contract Items

Alt Set ID: Alt Mbr ID:

Proposal Line Number	Item ID Description	Approximate Quantity and Units	Unit Price	Bid Amount
0922	SPV.0045 Special 1001. Truck Entering Warning System	3,000.000 DAY	_____.	_____.
0924	SPV.0045 Special 1002. Combination Work Zone Digital Speed Limit - Speed Feedback Sign Trailer	3,000.000 DAY	_____.	_____.
0926	SPV.0060 Special 0002. Temporary Sediment Traps	20.000 EACH	_____.	_____.
0928	SPV.0060 Special 0003. Sand Bags	500.000 EACH	_____.	_____.
0930	SPV.0060 Special 0005. Concrete Barrier Transition Type M1	4.000 EACH	_____.	_____.
0932	SPV.0060 Special 0006. Concrete Barrier Transition Type M2	1.000 EACH	_____.	_____.
0934	SPV.0060 Special 0007. Concrete Barrier Transition Type M3	1.000 EACH	_____.	_____.
0936	SPV.0060 Special 0008. Marking Contrast Epoxy Special Marking Arrow	2.000 EACH	_____.	_____.
0938	SPV.0060 Special 0011. Maintain & Salvage Traffic Control Signs Left In Place	278.000 EACH	_____.	_____.
0940	SPV.0060 Special 0012. Demolition and Debris Removal Parcel 41	1.000 EACH	_____.	_____.
0942	SPV.0060 Special 0160. Mobilizations Emergency Pavement Repair	10.000 EACH	_____.	_____.
0944	SPV.0060 Special 0601. Baseline CPM Progress Schedule	1.000 EACH	_____.	_____.
0946	SPV.0060 Special 0602. Monthly CPM Progress Schedule Updates	24.000 EACH	_____.	_____.



Proposal Schedule of Items

Proposal ID: 20211109009 Project(s): 1229-04-76

Federal ID(s): WISC 2022007

SECTION: 0001 Contract Items

Alt Set ID: Alt Mbr ID:

Proposal Line Number	Item ID Description	Approximate Quantity and Units	Unit Price	Bid Amount
0948	SPV.0060 Special 0910. Traffic Control Close-Open Freeway Entrance Ramp	10.000 EACH	_____.	_____.
0950	SPV.0060 Special 0918. Traffic Control Full Freeway Closure	6.000 EACH	_____.	_____.
0952	SPV.0060 Special 0950. Temporary Access Gates	2.000 EACH	_____.	_____.
0954	SPV.0060 Special 0960. Temporary Concrete Barrier Gate 24-Ft	4.000 EACH	_____.	_____.
0956	SPV.0060 Special 0965. Install State Furnished Signs	2.000 EACH	_____.	_____.
0958	SPV.0060 Special 1000. Survey Project 1229-04-76	1.000 EACH	_____.	_____.
0960	SPV.0060 Special 1001. Removing Electrical Service Meter Breaker Pedestal Lighting	3.000 EACH	_____.	_____.
0962	SPV.0060 Special 1002. Maintenance of Lighting System	1.000 EACH	_____.	_____.
0964	SPV.0060 Special 1003. Lighting System Integrator	1.000 EACH	_____.	_____.
0966	SPV.0060 Special 2000. Removing Electrical Service Meter Breaker Pedestal	4.000 EACH	_____.	_____.
0968	SPV.0060 Special 2001. Removing Controller Cabinet	7.000 EACH	_____.	_____.
0970	SPV.0060 Special 2002. Removing Controller Cabinet Base	7.000 EACH	_____.	_____.
0972	SPV.0060 Special 2008. Remove Pole	3.000 EACH	_____.	_____.
0974	SPV.0060 Special 2013. Ground Rod	15.000 EACH	_____.	_____.



Proposal Schedule of Items

Proposal ID: 20211109009 Project(s): 1229-04-76

Federal ID(s): WISC 2022007

SECTION: 0001 Contract Items

Alt Set ID: Alt Mbr ID:

Proposal Line Number	Item ID Description	Approximate Quantity and Units	Unit Price	Bid Amount
0976	SPV.0060 Special 2015. Refocus Vehicle Detector Assembly	34.000 EACH	_____.	_____.
0978	SPV.0060 Special 2016. Install Ethernet Radio	2.000 EACH	_____.	_____.
0980	SPV.0060 Special 2020. Install Terminal Server	3.000 EACH	_____.	_____.
0982	SPV.0060 Special 2021. Install State Furnished Pole	3.000 EACH	_____.	_____.
0984	SPV.0060 Special 2022. Remove Tar Sign Assembly	1.000 EACH	_____.	_____.
0986	SPV.0060 Special 2023. Install Cellular Model	4.000 EACH	_____.	_____.
0988	SPV.0060 Special 2024. Loop Detector Protection	6.000 EACH	_____.	_____.
0990	SPV.0060 Special 3001. Install Poles Type 9	1.000 EACH	_____.	_____.
0992	SPV.0060 Special 3002. Install Poles Type 10	2.000 EACH	_____.	_____.
0994	SPV.0060 Special 3008. Install Monotube Arms 20-Ft	2.000 EACH	_____.	_____.
0996	SPV.0060 Special 3009. Install Monotube Arms 25-Ft	1.000 EACH	_____.	_____.
0998	SPV.0060 Special 3019. Install Luminaire Arms Steel 15-Ft	3.000 EACH	_____.	_____.
1000	SPV.0060 Special 3020. Detector Loop Modification	2.000 EACH	_____.	_____.
1002	SPV.0060 Special 3151. Trnspt & Install State Furn Muni Traf Signal Cabinet CTH W & Highland Rd	1.000 EACH	_____.	_____.



Proposal Schedule of Items

Proposal ID: 20211109009 Project(s): 1229-04-76

Federal ID(s): WISC 2022007

SECTION: 0001 Contract Items

Alt Set ID: Alt Mbr ID:

Proposal Line Number	Item ID Description	Approximate Quantity and Units	Unit Price	Bid Amount
1004	SPV.0060 Special 3152. Trnsp & Install State Furn Traffic Signal Cabinet IH 43 NB Ramps & CTH C	1.000 EACH	_____.	_____.
1006	SPV.0060 Special 3153. Trnsp Traf Signal & Intersection Lighting Mat IH 43 NB Ramps & CTH C	1.000 EACH	_____.	_____.
1008	SPV.0060 Special 3154. Trnsprt & Install S-F FO Cable Pigtail 8-Ct IH 43 NB Ramps & CTH C	1.000 EACH	_____.	_____.
1010	SPV.0060 Special 3155. Trnsprt & Install S-F FO Cable Pigtail 8-Ct IH 43 NB Ramps & STH 60	1.000 EACH	_____.	_____.
1012	SPV.0060 Special 3156. Trnsprt & Install S-F FO Cable Pigtail 8-Ct IH 43 SB Ramps & STH 60	1.000 EACH	_____.	_____.
1014	SPV.0060 Special 3157. Transport & Install S-F Radar Detection System IH 43 NB Ramps & CTH C	1.000 EACH	_____.	_____.
1016	SPV.0060 Special 3158. Multi Sensor Detection System CTH C & CTH W	1.000 EACH	_____.	_____.
1018	SPV.0060 Special 3159. Temp Non-Intrusive Vehicle Det Sys for Intersections, CTH W & Highland Rd	1.000 EACH	_____.	_____.
1020	SPV.0060 Special 3160. Temp Non-Intrusive Vehicle Det Sys for Intersection CTH C & CTH W	1.000 EACH	_____.	_____.
1022	SPV.0060 Special 3161. Covering Traffic Signal Equipment CTH W & Highland Rd	1.000 EACH	_____.	_____.
1024	SPV.0060 Special 3162. Covering Traffic Signal Equipment CTH C & CTH W	1.000 EACH	_____.	_____.





Proposal Schedule of Items

Proposal ID: 20211109009 Project(s): 1229-04-76

Federal ID(s): WISC 2022007

SECTION: 0001 Contract Items

Alt Set ID: Alt Mbr ID:

Proposal Line Number	Item ID Description	Approximate Quantity and Units	Unit Price	Bid Amount
1026	SPV.0060 Special 3163. Trnspt & Install State Furn EVP Heads w/Conf Lights CTH W & Highland Rd	1.000 EACH	_____.	_____.
1028	SPV.0060 Special 3164. Trnspt & Install State Furn EVP Heads w/Conf Lights CTH C & CTH W	1.000 EACH	_____.	_____.
1030	SPV.0060 Special 3165. Trnspt & Install State Furn EVP Heads w/Conf Lights IH 43 NB Ramps & CTH C	1.000 EACH	_____.	_____.
1032	SPV.0060 Special 4000. Case Pile Wave Analysis Program (CAPWAP) Evaluation	4.000 EACH	_____.	_____.
1034	SPV.0060 Special 4001. Pile Dynamic Analyzer (PDA) Restrikes	8.000 EACH	_____.	_____.
1036	SPV.0060 Special 4002. Pile Dynamic Analyzer (PDA) Testing	8.000 EACH	_____.	_____.
1038	SPV.0060 Special 4003. Temporary Bridge Widening (B-45-0024)	1.000 EACH	_____.	_____.
1040	SPV.0060 Special 5000. Adjusting Sanitary Manhole	1.000 EACH	_____.	_____.
1042	SPV.0060 Special 8015. Pipe Connection to Existing Structure	16.000 EACH	_____.	_____.
1044	SPV.0060 Special 8018. Removing Bulkhead	65.000 EACH	_____.	_____.
1046	SPV.0060 Special 8020. Fastening Sewer Access Covers	7.000 EACH	_____.	_____.
1048	SPV.0060 Special 8501. Storm Sewer Structure 173	1.000 EACH	_____.	_____.
1050	SPV.0075 Special 0601. Pavement Cleanup Project 1229-04-76	500.000 HRS	_____.	_____.



Proposal Schedule of Items

Proposal ID: 20211109009 Project(s): 1229-04-76

Federal ID(s): WISC 2022007

SECTION: 0001 Contract Items

Alt Set ID: Alt Mbr ID:

Proposal Line Number	Item ID Description	Approximate Quantity and Units	Unit Price	Bid Amount
1052	SPV.0085 Special 0001. No-Mow Fescue Seed Mix	287.000 LB	_____.	_____.
1054	SPV.0085 Special 0002. Seed Mix Special	33.000 LB	_____.	_____.
1056	SPV.0085 Special 0003. Seeding Mixture No. 30 Special	7,916.000 LB	_____.	_____.
1058	SPV.0090 Special 0002. Concrete Barrier Type S42 Special	14,032.000 LF	_____.	_____.
1060	SPV.0090 Special 0003. Concrete Barrier Type S56 Special	2,328.000 LF	_____.	_____.
1062	SPV.0090 Special 0004. Concrete Barrier Transition Type Parapet to V42	194.000 LF	_____.	_____.
1064	SPV.0090 Special 0005. Fence Chain Link Polymer Coated 4-Ft Road Barrier	180.000 LF	_____.	_____.
1066	SPV.0090 Special 0301. Heavy Duty Silt Fence	41,554.000 LF	_____.	_____.
1068	SPV.0090 Special 0910. Glare Screen Temporary	64,050.000 LF	_____.	_____.
1070	SPV.0090 Special 2001. Outdoor Rated Network Cable	390.000 LF	_____.	_____.
1072	SPV.0090 Special 4000. Fence Chain Link Polymer Coated 4-Ft	857.000 LF	_____.	_____.
1074	SPV.0090 Special 4001. Fence Chain Link Polymer Coated 6-Ft	246.000 LF	_____.	_____.
1076	SPV.0090 Special 8001. SSPRC Special 36 Inch	199.000 LF	_____.	_____.
1078	SPV.0090 Special 8031. Precast Trench Drain	552.000 LF	_____.	_____.



Proposal Schedule of Items

Proposal ID: 20211109009 Project(s): 1229-04-76

Federal ID(s): WISC 2022007

SECTION: 0001 Contract Items

Alt Set ID: Alt Mbr ID:

Proposal Line Number	Item ID Description	Approximate Quantity and Units	Unit Price	Bid Amount
1080	SPV.0090 Special 8036. Temporary Precast Trench Dain	2,865.000 LF	_____.	_____.
1082	SPV.0135 Special 0001. Field Office Special	27.000 MON	_____.	_____.
1084	SPV.0165 Special 4000. Longitudinal Grooving Bridge Deck	42,796.000 SF	_____.	_____.
1086	SPV.0165 Special 4004. Temporary Wall Wire Faced Mechanically Stabilized Earth R-45-18	840.000 SF	_____.	_____.
1088	SPV.0165 Special 4006. Wall Concrete Panel Mechanically Stabilized Earth R-45-14	16,790.000 SF	_____.	_____.
1090	SPV.0165 Special 4007. Wall Concrete Panel Mechanically Stabilized Earth R-45-15	4,953.000 SF	_____.	_____.
1092	SPV.0165 Special 4008. Wall Concrete Panel Mechanically Stabilized Earth R-45-16	30,520.000 SF	_____.	_____.
1094	SPV.0165 Special 4009. Wall Concrete Panel Mechanically Stabilized Earth R-45-17	31,919.000 SF	_____.	_____.
1096	SPV.0165 Special 4010. Temporary Wall Wire Faced Mechanically Stabilized Earth R-45-17	1,897.000 SF	_____.	_____.
1098	SPV.0165 Special 4011. Wall Concrete Panel Mechanically Stabilized Earth R-45-18	14,367.000 SF	_____.	_____.
1100	SPV.0165 Special 4012. Wall Concrete Panel Mechanically Stabilized Earth R-45-19	11,535.000 SF	_____.	_____.
1102	SPV.0165 Special 4013. Wall Concrete Panel Mechanically Stabilized Earth R-45-23	13,993.000 SF	_____.	_____.
1104	SPV.0165 Special 4014. Temporary Wall Wire Faced Mechanically Stabilized Earth R-45-23	713.000 SF	_____.	_____.



Proposal Schedule of Items

Proposal ID: 20211109009 Project(s): 1229-04-76

Federal ID(s): WISC 2022007

SECTION: 0001 Contract Items

Alt Set ID: Alt Mbr ID:

Proposal Line Number	Item ID Description	Approximate Quantity and Units	Unit Price	Bid Amount
1106	SPV.0165 Special 4015. Wall Concrete Panel Mechanically Stabilized Earth R-45-26	3,744.000 SF	_____.	_____.
1108	SPV.0165 Special 4016. Temporary Wall Wire Faced Mechanically Stabilized Earth R-45-26	653.000 SF	_____.	_____.
1110	SPV.0165 Special 4017. Wall Concrete Panel Mechanically Stabilized Earth R-45-36	3,566.000 SF	_____.	_____.
1112	SPV.0165 Special 4018. Wall Concrete Panel Mechanically Stabilized Earth R-45-37	3,295.000 SF	_____.	_____.
1114	SPV.0180 Special 0001. Topsoil Special	629,353.000 SY	_____.	_____.
1116	SPV.0180 Special 0003. Concrete Pavement 8-Inch Special	41,754.000 SY	_____.	_____.
1118	SPV.0180 Special 0004. Concrete Pavement 10 1/2-Inch Special	406,324.000 SY	_____.	_____.
1120	SPV.0180 Special 0102. Compost	1,320.000 SY	_____.	_____.
1122	SPV.0180 Special 0106. Asphaltic Surface Binder	446.000 SY	_____.	_____.
1124	SPV.0195 Special 0001. HMA Longitudinal Joint Repair	5,000.000 TON	_____.	_____.
1126	SPV.0195 Special 0002. HMA Transverse Joint Repair	1,000.000 TON	_____.	_____.
1128	SPV.0195 Special 4000. Excavation, Hauling, and Disposal of Creosote Contaminated Soil	2,080.000 TON	_____.	_____.
1130	SPV.0200 Special 8001. Manholes 4-Ft Diameter Special	100.000 VF	_____.	_____.



Proposal Schedule of Items

Proposal ID: 20211109009 Project(s): 1229-04-76

Federal ID(s): WISC 2022007

SECTION: 0001 Contract Items

Alt Set ID: Alt Mbr ID:

Proposal Line Number	Item ID Description	Approximate Quantity and Units	Unit Price	Bid Amount
1132	204.0245 Removing Storm Sewer (size) 0006. 30-Inch	56.000 LF	_____.	_____.
1134	524.0618 Apron Endwalls for Culvert Pipe Salvaged 18-Inch	1.000 EACH	_____.	_____.
1136	522.0148 Culvert Pipe Reinforced Concrete Class III 48-Inch	88.000 LF	_____.	_____.
1138	522.0436 Culvert Pipe Reinforced Concrete Class IV 36-Inch	58.000 LF	_____.	_____.
1140	614.0920 Salvaged Rail	5,331.000 LF	_____.	_____.
1142	614.0925 Salvaged Guardrail End Treatments	7.000 EACH	_____.	_____.
1144	SPV.0060 Special 0970. Exposing Existing Infrastructure Paved Area	10.000 EACH	_____.	_____.
1146	SPV.0060 Special 0975. Exposing Existing Infrastructure Unpaved Area	10.000 EACH	_____.	_____.
<b>Section: 0001</b>			<b>Total:</b>	_____.
			<b>Total Bid:</b>	_____.

