



Wisconsin Department of Transportation

Division of Transportation Systems Development

Bureau of Project Development
4822 Madison Yards Way, 4th Floor South
Madison, WI 53705

November 5, 2021

Telephone: (608) 266-1631
Facsimile (FAX): (608) 266-8459

NOTICE TO ALL CONTRACTORS:

Proposal #17: 1480-29-71, WISC 2022013
Green Bay - Dyckesville
CTH K Intersection
STH 57
Brown County

Letting of November 9, 2021

This is Addendum No. 01, which provides for the following:

Schedule of Items:

Revised Bid Item Quantities					
Bid Item	Item Description	Unit	Old Quantity	Revised Quantity	Proposal Total
305.0110	Base Aggregate Dense ¾-Inch	TON	1,042	-409	633
305.0120	Base Aggregate Dense 1 ¼-Inch	TON	12,012	540	12,552
415.0090	Concrete Pavement 9-Inch	SY	10,074	199	10,273
455.0605	Tack Coat	GAL	493	-238	255
460.6223	HMA Pavement Lower Layer 3 MT 58-28S	TON	560	-276	284
460.6224	HMA Pavement Upper Layer 4 MT 58-28S	TON	403	126	529
522.0418	Culvert Pipe Reinforced Concrete Class IV 18-Inch	LF	24	-8	16
522.2419	Culvert Pipe Reinforced Concrete Horizontal Elliptical Class HE-IV 19x30-Inch	LF	440	-136	304
612.0206	Pipe Underdrain Unperforated 6-Inch	LF	43	37	80
612.0806	Apron Endwalls For Underdrain Reinforced Concrete 6-Inch	EACH	5	3	8

Added Bid Item Quantities					
Bid Item	Item Description	Unit	Old Quantity	Revised Quantity	Proposal Total
608.0418	Storm Sewer Pipe Reinforced Concrete Class IV 18-Inch	LF	0	8	8
608.2419	Storm Sewer Pipe Reinforced Concrete Horizontal Elliptical Class HE-IV 19x30-Inch	LF	0	191	191

Plan Sheets:

Revised Plan Sheets	
Plan Sheet	Plan Sheet Title (brief description of changes to sheet)
7	Typical Sections – Removed NB outside 1-foot wide HMA shoulder and extended concrete and additional 1 foot.
8	Typical Sections – Removed SB outside 1-foot wide HMA shoulder and extended concrete and additional 1 foot.
21	Culvert Pipe Plan Details - Changed label of pipe from culvert pipe to storm sewer pipe.
48	Miscellaneous Quantities – Updated Item 415.0090 Concrete Pavement 9-Inch quantity.
50	Miscellaneous Quantities – Updated Item 305.0110 Base Aggregate Dense ¾-Inch and Item 305.0120 Base Aggregate Dense 1-¼“ quantities.
51	Miscellaneous Quantities – Updated Items 455.0605 Tack Coat, 460.6223 HMA Pavement Lower Layer 3 MT 58-28S, 460.6224 HMA Pavement Upper Layer 4 MT 58-28S quantities.
53	Miscellaneous Quantities – Updated quantities for 522.0418 Culvert Pipe Reinforced Concrete IV 18-Inch, 522.2419 Culvert Pipe Reinforced Concrete Horizontal Elliptical Class HE-IV 19x30-Inch. Added Quantities for 608.0418 Storm Sewer Pipe Reinforced Concrete Class IV 18-Inch, 608.2419 Storm Sewer Pipe Reinforced Concrete Horizontal Elliptical Class HE-IV 19x30-Inch. Updated quantities for 612.0206 Pipe Underdrain Unperforated 6-Inch and 612.0806 Apron Endwalls For Underdrain Reinforced Concrete 6-Inch.

Schedule of Items

Attached, dated November 5, 2021, are the revised Schedule of Items Pages 1 – 7.

Plan Sheets

The following 8½ x 11-inch sheets are attached and made part of the plans for this proposal:
Revised: 7, 8, 21, 48, 50, 51, and 53.

The responsibility for notifying potential subcontractors and suppliers of these changes remains with the prime contractor.

Sincerely,

Mike Coleman

Proposal Development Specialist
Proposal Management Section

END OF ADDENDUM

POINT REFERRED TO ON PROFILE

34' MINIMUM CLEAR ZONE

EXISTING ASPHALT SHOULDER

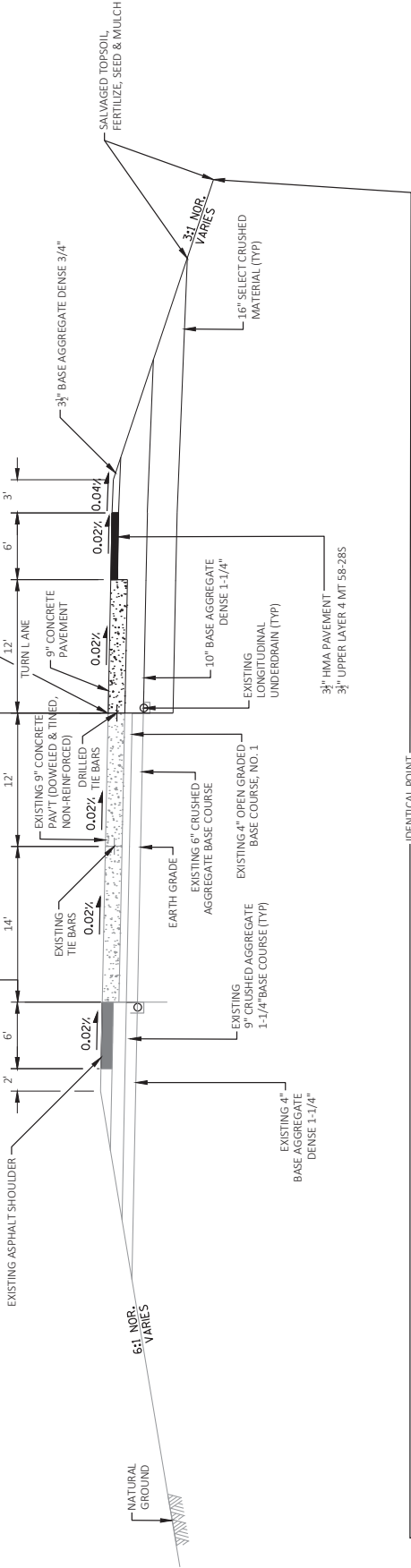

IDENTICAL POINT

Addendum No. 01
 ID 1480-29-71
 Revised Sheet 7
 November 5, 2021

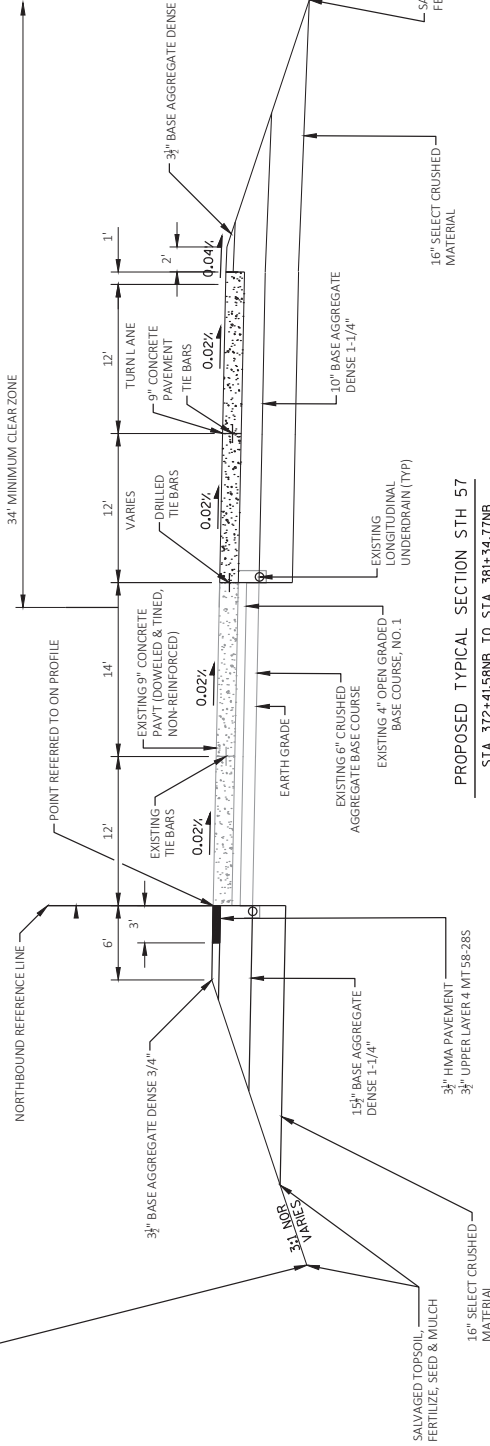

PROPOSED TYPICAL SECTION STH 57
 STA 372+41.58NB TO STA 381+34.77NB

TYPICAL SECTIONS

COUNTY: BROWN

HWY: STH 57

PROJECT NO: 1480-29-71

FILE NAME: C:\USERS\DOTA\DESKTOP\CURRENT PROJECTS\CD\1480-29-71\1480-29-71-SHEETS\1480-29-71-SHEET 7.DWG

Addendum No. 01
ID 1480-29-71
Revised Sheet 8
November 5, 2021

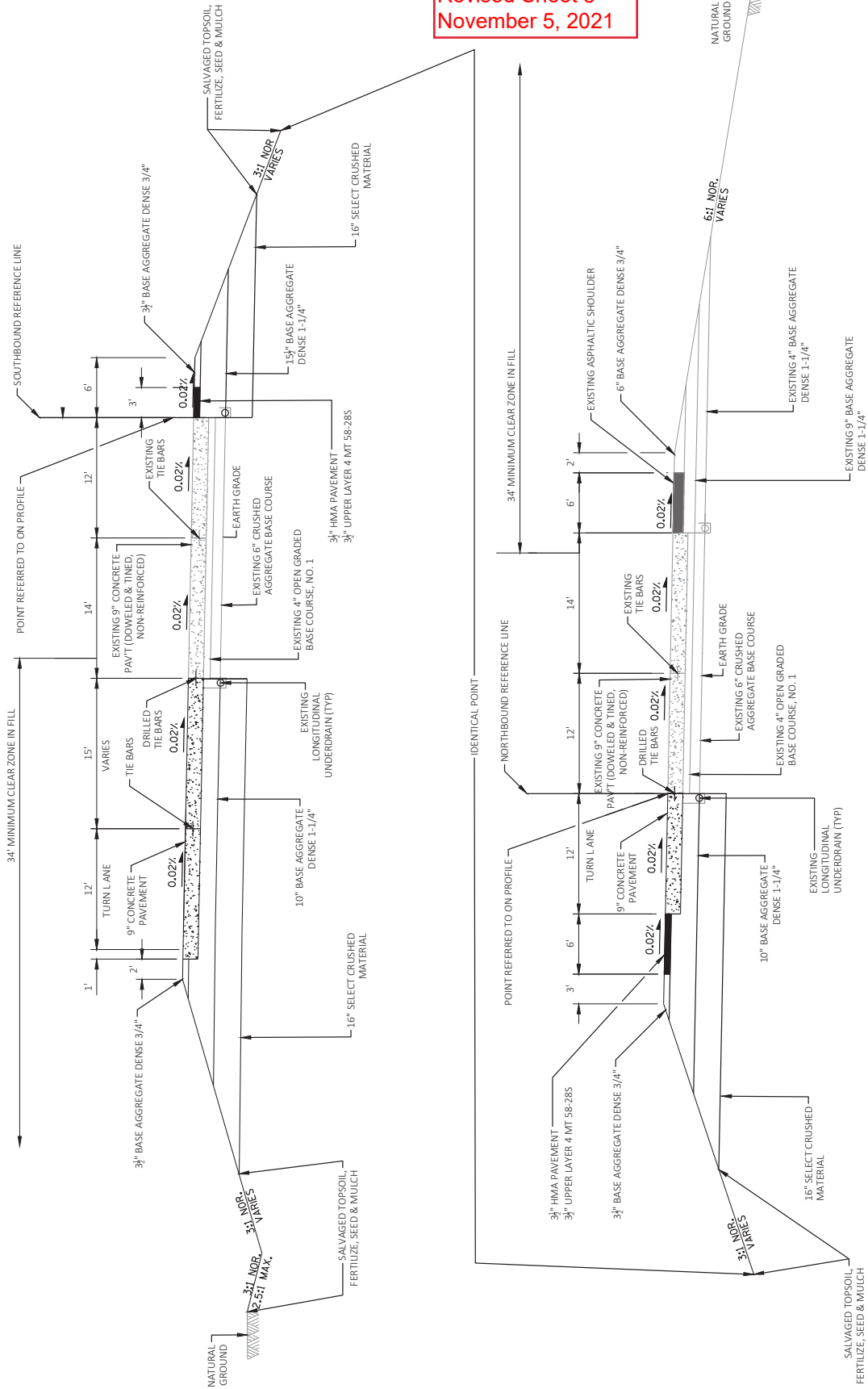

PROPOSED TYPICAL SECTION STH 57
STA 381+34.77NB TO STA 393+55.20NB

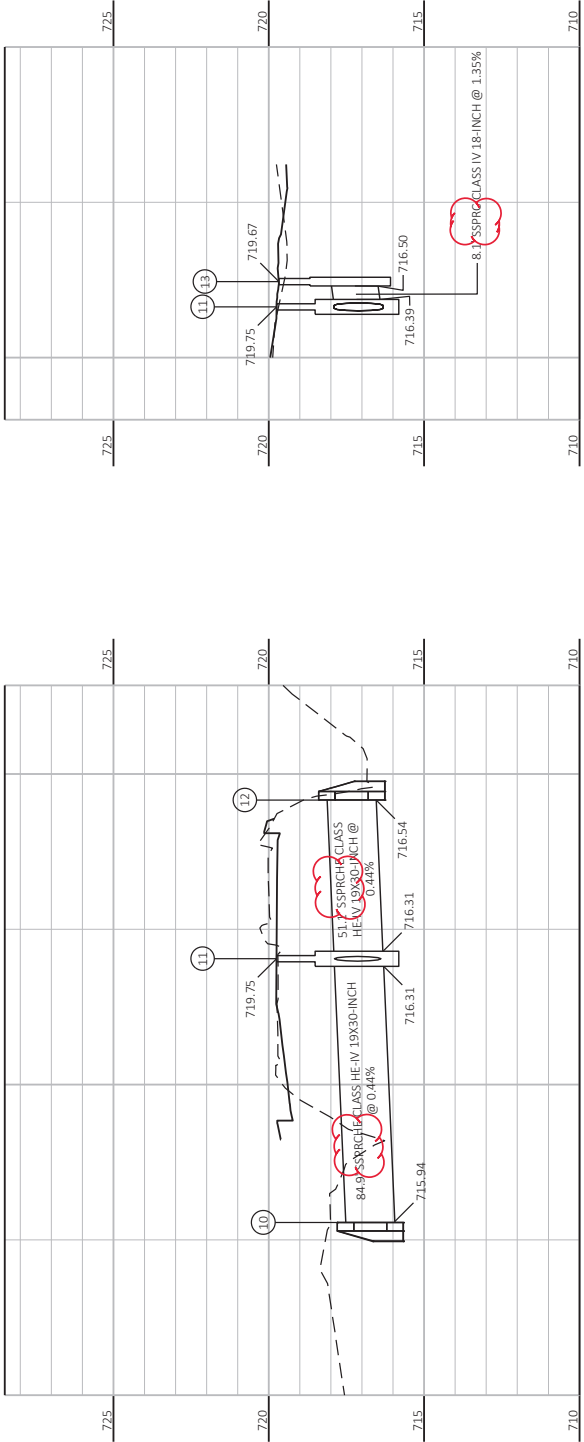
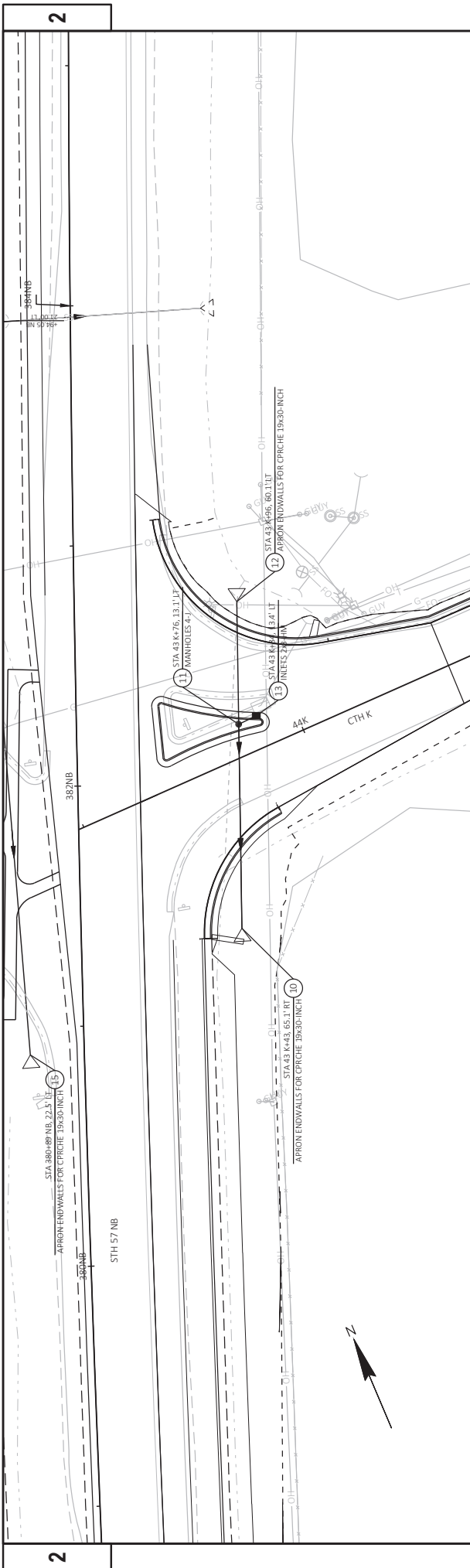

Addendum No. 01
 ID 1480-29-71
 Revised Sheet 21
 November 5, 2021

REMOVALS

203.0100 REMOVING SMALL PIPE 204.0220 REMOVING EXISTING

STATION	OFFSET	LOCATION	PIPE CULVERTS	INLETS	ENDWALL
CATEGORY 0010			EACH	EACH	EACH
377+05 SB	17' RT	MEDIAN	--	--	1
384+94 NB	26' LT	MEDIAN	--	--	1
41+47 K	31' LT	CTH K	--	--	1
43+49 K	34' LT	CTH K	--	--	1
43+66 K	0	CTH K	1	--	--
43+89 K	15' LT	CTH K	--	1	--
43+97 K	62' LT	CTH K	--	--	1
44+00 K	24' LT	CTH K	1	--	--
44+19 K	40' LT	CTH K	--	--	1
TOTAL			2	1	6

REMOVING CURB & GUTTER

204.0150 REMOVING CURB & GUTTER

STATION	TO	FROM	STATION	TO	FROM	LOCATION
CATEGORY 0010						
380+71 NB	-	381+33 NB	87			MEDIAN
382+10 SB	-	382+71 SB	83			MEDIAN
40+00 K	-	41+68 K	223			BAY SETTLEMENT ROAD SOUTH SIDE
40+41 K	-	42+16 K	227			BAY SETTLEMENT ROAD NORTH SIDE
43+19 K	-	43+65 K	57			CHAMPION ROAD SOUTH SIDE
43+49 K	-	43+93 K	107			CHAMPION ROAD SPLITTER ISLAND
43+75 K	-	46+19 K	290			CHAMPION ROAD NORTH SIDE
TOTAL			1,074			

TOTAL 1,074

Addendum No. 01 ID 1480-29-71 Revised Sheet 48 November 5, 2021

REMOVING FENCE

204.0170 REMOVING FENCE

STATION	TO	FROM	LF	LOCATION
CATEGORY 0010				
383+43 SB	-	391+80 SB	840	SOUTHBOUND LT
TOTAL			840	

TOTAL 840

CONCRETE PAVEMENT

415.0090 416.0610 602.0405 CONCRETE DRILLED CONCRETE PAVEMENT TIE BARS 9-INCH

SY	EACH	SF	REMARKS
400	--	--	MEDIAN TURNAROUND
2,219	298	--	OUTSIDE LANE AND SHOULDER
1,151	506	--	MEDIAN LANE AND SHOULDER
--	--	1,041	MEDIAN SIDEWALK CROSSING
421	--	--	MEDIAN TURNAROUND
974	502	--	MEDIAN LANE AND SHOULDER
3,128	385	--	OUTSIDE LANE AND SHOULDER
804	--	--	BAY SET ROAD AND CONNECTOR AND 57 SB INTERSECTION
1,176	--	--	CONCRETE PORTION
TOTAL			1,041

TOTAL 1,041

BASE AGGREGATE DENSE

STATION TO STATION CATEGORY 0010	LOCATION	305.0110 BASE AGGREGATE DENSE 3/4-INCH		305.0120 BASE AGGREGATE DENSE 1.1/4-INCH		312.0110 SELECT CRUSHED MATERIAL		REMARKS
		TON	TON	TON	TON			
372+42 - 374+42	STH 57 NB	20	180	252	MEDIAN SHOULDER			
374+42 - 374+97	MEDIAN	--	245	320	MEDIAN TURNAROUND			
372+42 - 381+35	STH 57 NB	85	1,858	2,705	OUTSIDE LANE AND SHOULDER			
374+97 - 390+15	STH 57 NB	150	2,221	3,033	MEDIAN LANE AND SHOULDER			
381+03 - 382+49	STH 57 NB	--	44	--	MEDIAN SIDEWALK CROSSING			
389+97 - 390+88	MEDIAN	--	234	337	MEDIAN TURNAROUND			
390+63 - 390+88	STH 57 NB	2	15	24	MEDIAN SHOULDER			
374+36 - 374+58	STH 57 SB	2	13	21	MEDIAN SHOULDER			
375+21 - 390+27	STH 57 SB	150	2,071	2,838	MEDIAN LANE AND SHOULDER			
382+14 - 393+68	STH 57 SB	109	2,521	3,690	OUTSIDE LANE AND SHOULDER			
390+85 - 393+68	STH 57 SB	27	257	359	MEDIAN SHOULDER			
13+82 - 15+98	BAY SET ROAD	49	--	--	WEST SHOULDER			
13+82 - 15+98	BAY SET ROAD	--	1,538	643	BAY SET ROAD AND CONNECTOR AND 57 SB INTERSECTION			
13+82 - 14+10	BAY SET ROAD	4	--	--	EAST SHOULDER			
15+63 - 15+98	BAY SET ROAD	5	--	--	EAST SHOULDER			
43+25 - 44+66	CTH K	--	767	941	CONCRETE PORTION			
44+66 - 46+83	CTH K	--	588	--	ASPHALT PORTION			
44+65 - 46+83	CTH K	25	--	--	NORTH SHOULDER			
46+19 - 46+83	CTH K	5	--	--	SOUTH SHOULDER			
TOTAL		633	12,552	15,162				

Addendum No. 01
 ID 1480-29-71
 Revised Sheet 50
 November 5, 2021

CONCRETE CURB & GUTTER

601.0551 601.0553
CONCRETE CURB & GUTTER 6-INCH SLOPED
36-INCH TYPE A 36-INCH TYPE D

STATION TO STATION	LOCATION	LF	REMARKS
374+40 - 374+55	5TH 57 NB	47	MEDIAN TURNAROUND SOUTH SIDE
40+00 - 41+19	BAY SET ROAD	--	CONNECTOR SOUTH SIDE
41+19 - 41+63	BAY SET ROAD	83	CONNECTOR SOUTH SIDE
41+48 - 41+97	BAY SET ROAD	101	CONNECTOR ISLAND
40+41 - 41+19	BAY SET ROAD	--	CONNECTOR NORTH SIDE
41+19 - 42+02	BAY SET ROAD	114	CONNECTOR NORTH SIDE
43+27 - 43+77	CTH K	63	SOUTH SIDE
43+39 - 43+89	CTH K	114	ISLAND
43+78 - 44+66	CTH K	136	NORTH SIDE
44+66 - 46+19	CTH K	153	NORTH SIDE
390+61 - 390+71	5TH 57 NB	45	MEDIAN TURNAROUND NORTH SIDE
TOTAL		703	

ASPHALTIC FLUMES

465.0315

STATION TO STATION	LOCATION	SY	REMARKS
374+33 - 374+57	5TH 57 SB	7	MEDIAN TURNAROUND SOUTH SIDE
14+17 - 14+20	BAY SET ROAD	8	EAST SIDE
40+80 - 41+00	CONNECTOR	15	NORTH SIDE
43+30 - 43+42	CTH K	3	SOUTH SIDE
44+19 - 44+24	CTH K	3	NORTH SIDE
390+83 - 391+05	5TH 57 SB	9	MEDIAN LANE AND SHOULDER
TOTAL		45	

ASPHALTIC MATERIALS

STATION TO STATION	LOCATION	TON	REMARKS
455.0605	TACK COAT	GAL	
372+42 - 374+42	5TH 57 NB	--	MEDIAN SHOULDER
374+97 - 390+15	5TH 57 NB	--	MEDIAN SHOULDER
375+21 - 390+27	5TH 57 SB	--	MEDIAN SHOULDER
390+85 - 393+68	5TH 57 SB	--	MEDIAN SHOULDER
13+82 - 15+98	BAY SET ROAD	156	BAY SET ROAD AND CONNECTOR AND 57 SB INTERSECTION
44+66 - 46+83	CTH K	99	ASPHALT PORTION
460.6223	HMA PAVEMENT LOWER LAYER	TON	
460.6224	HMA PAVEMENT UPPER LAYER	TON	
465.0305	ASPHALTIC SURFACE SAFETY ISLAND	TON	
372+42 - 374+42	5TH 57 NB	14	MEDIAN SHOULDER
374+97 - 390+15	5TH 57 NB	151	MEDIAN SHOULDER
375+21 - 390+27	5TH 57 SB	140	MEDIAN SHOULDER
390+85 - 393+68	5TH 57 SB	20	MEDIAN SHOULDER
13+82 - 15+98	BAY SET ROAD	174	BAY SET ROAD AND CONNECTOR AND 57 SB INTERSECTION
44+66 - 46+83	CTH K	110	ASPHALT PORTION
TOTAL		255	
TOTAL		284	
TOTAL		529	

Addendum No. 01
ID 1480-29-71
Revised Sheet 51
November 5, 2021

CULVERT PIPE AND STORM SEWER ITEMS

STRUCTURE NUMBER	STATION	OFFSET*	CATEGORY	521.3124		522.0418		522.0424		522.2419		608.2419		RIM OR FLANGE ELEV.	STR DEPTH**	FROM STR	TO STR	INLET ELEV.	DISCH ELEV.	SLOPE %
				LF	LF	LF	LF	LF	LF	LF	LF									
1	374+12NB	31.0' LT	CONCRETE COLLARS FOR PIPE	---	---	---	---	---	---	---	---	---	---	---	---	---	---	---	---	---
2	375+40NB	19.0' LT	CONCRETE COLLARS FOR PIPE	---	---	---	---	---	---	---	---	---	---	---	---	---	---	---	---	---
3	377+05SB	31.8' RT	CONCRETE COLLARS FOR PIPE	---	---	---	---	---	---	---	---	---	---	---	---	---	---	---	---	---
4	383+94NB	29.0' LT	CONCRETE COLLARS FOR PIPE	---	---	---	---	---	---	---	---	---	---	---	---	---	---	---	---	---
5	389+66NB	35.4' LT	CONCRETE COLLARS FOR PIPE	---	---	---	---	---	---	---	---	---	---	---	---	---	---	---	---	---
6	391+18NB	29.1' LT	CONCRETE COLLARS FOR PIPE	---	---	---	---	---	---	---	---	---	---	---	---	---	---	---	---	---
7	41+58BSC	47.4' LT	CONCRETE COLLARS FOR PIPE	---	---	---	---	---	---	---	---	---	---	---	---	---	---	---	---	---
8	41+22BSC	54.5' RT	CONCRETE COLLARS FOR PIPE	---	---	---	---	---	---	---	---	---	---	---	---	---	---	---	---	---
9	41+54BSC	10.3' RT	CONCRETE COLLARS FOR PIPE	---	---	---	---	---	---	---	---	---	---	---	---	---	---	---	---	---
10	43+43K	65.1' RT	CONCRETE COLLARS FOR PIPE	---	---	---	---	---	---	---	---	---	---	---	---	---	---	---	---	---
11	43+76K	13.1' LT	CONCRETE COLLARS FOR PIPE	---	---	---	---	---	---	---	---	---	---	---	---	---	---	---	---	---
12	43+96K	60.1' LT	CONCRETE COLLARS FOR PIPE	---	---	---	---	---	---	---	---	---	---	---	---	---	---	---	---	---
13	43+84K	13.4' LT	CONCRETE COLLARS FOR PIPE	---	---	---	---	---	---	---	---	---	---	---	---	---	---	---	---	---
14	382+64K	32.9' LT	CONCRETE COLLARS FOR PIPE	---	---	---	---	---	---	---	---	---	---	---	---	---	---	---	---	---
15	380+89K	22.5' LT	CONCRETE COLLARS FOR PIPE	---	---	---	---	---	---	---	---	---	---	---	---	---	---	---	---	---
TOTAL				1	24	16	8	152	304	191										

REMARKS
 * STATIONS AND OFFSETS ARE TO CENTER OF STRUCTURE
 ** DEPTH = RIM ELEV - TOP OF STRUCTURE BASE ELEV - COVER HEIGHT - 6 -INCH ADJUSTMENT RING HEIGHT; HAND POUR STRUCTURE FLOWLINES TO MATCH PIPE INVERTS AFTER STRUCTURE AND PIPE ARE INSTALLED
 *** MINIMUM PIPE THICKNESS SHALL BE 0.064 INCHES

Addendum No. 01
 ID 1480-29-71
 Revised Sheet 53
 November 5, 2021

PIPE UNDERDRAIN, UNPERFORATED, 6-INCH

STATION	LOCATION	LF	EACH	REMARKS
372+42	STH 57 NB LT AND RT	20	2	EXTEND TO NEW DITCH LOCATION AT PROJECT LIMITS
383+83	STH 57 NB RT	10	1	EXTEND TO NEW DITCH LOCATION AT PROJECT LIMITS
390+88	STH 57 NB LT	10	1	EXTEND TO NEW DITCH LOCATION AT PROJECT LIMITS
374+36	STH 5B RT	10	1	EXTEND TO NEW DITCH LOCATION AT PROJECT LIMITS
380+23	STH 57 SB LT	10	1	EXTEND TO NEW DITCH LOCATION AT PROJECT LIMITS
393+68	STH 57 SB LT AND RT	20	2	EXTEND TO NEW DITCH LOCATION AT PROJECT LIMITS
TOTAL		80	8	



Proposal Schedule of Items

Proposal ID: 20211109017 Project(s): 1480-29-71

Federal ID(s): WISC 2022013

SECTION: 0001

Contract Items

Alt Set ID:

Alt Mbr ID:

Proposal Line Number	Item ID Description	Approximate Quantity and Units	Unit Price	Bid Amount
0002	203.0100 Removing Small Pipe Culverts	2.000 EACH	_____.	_____.
0004	204.0150 Removing Curb & Gutter	1,074.000 LF	_____.	_____.
0006	204.0170 Removing Fence	840.000 LF	_____.	_____.
0008	204.0220 Removing Inlets	1.000 EACH	_____.	_____.
0010	204.9060.S Removing (item description) 01. Apron Endwall	6.000 EACH	_____.	_____.
0012	205.0100 Excavation Common	18,228.000 CY	_____.	_____.
0014	213.0100 Finishing Roadway (project) 01. 1480-29-71	1.000 EACH	_____.	_____.
0016	305.0110 Base Aggregate Dense 3/4-Inch	633.000 TON	_____.	_____.
0018	305.0120 Base Aggregate Dense 1 1/4-Inch	12,552.000 TON	_____.	_____.
0020	312.0110 Select Crushed Material	15,162.000 TON	_____.	_____.
0022	415.0090 Concrete Pavement 9-Inch	10,273.000 SY	_____.	_____.
0024	416.0610 Drilled Tie Bars	1,691.000 EACH	_____.	_____.
0026	455.0605 Tack Coat	255.000 GAL	_____.	_____.
0028	460.2000 Incentive Density HMA Pavement	630.000 DOL	1.00000	630.00
0030	460.6223 HMA Pavement 3 MT 58-28 S	284.000 TON	_____.	_____.
0032	460.6224 HMA Pavement 4 MT 58-28 S	529.000 TON	_____.	_____.



Proposal Schedule of Items

Proposal ID: 20211109017 Project(s): 1480-29-71

Federal ID(s): WISC 2022013

SECTION: 0001

Contract Items

Alt Set ID:

Alt Mbr ID:

Proposal Line Number	Item ID Description	Approximate Quantity and Units	Unit Price	Bid Amount
0034	465.0305 Asphaltic Surface Safety Islands	15.000 TON	_____.	_____.
0036	465.0315 Asphaltic Flumes	45.000 SY	_____.	_____.
0038	520.8000 Concrete Collars for Pipe	1.000 EACH	_____.	_____.
0040	521.1024 Apron Endwalls for Culvert Pipe Steel 24-Inch	1.000 EACH	_____.	_____.
0042	521.3124 Culvert Pipe Corrugated Steel 24-Inch	24.000 LF	_____.	_____.
0044	522.0418 Culvert Pipe Reinforced Concrete Class IV 18-Inch	16.000 LF	_____.	_____.
0046	522.0424 Culvert Pipe Reinforced Concrete Class IV 24-Inch	152.000 LF	_____.	_____.
0048	522.1018 Apron Endwalls for Culvert Pipe Reinforced Concrete 18-Inch	2.000 EACH	_____.	_____.
0050	522.1024 Apron Endwalls for Culvert Pipe Reinforced Concrete 24-Inch	2.000 EACH	_____.	_____.
0052	522.2419 Culvert Pipe Reinforced Concrete Horizontal Elliptical Class HE-IV 19x30-Inch	304.000 LF	_____.	_____.
0054	522.2619 Apron Endwalls for Culvert Pipe Reinforced Concrete Horizontal Elliptical 19x30-Inch	7.000 EACH	_____.	_____.
0056	601.0551 Concrete Curb & Gutter 4-Inch Sloped 36-Inch Type A	703.000 LF	_____.	_____.
0058	601.0553 Concrete Curb & Gutter 4-Inch Sloped 36-Inch Type D	400.000 LF	_____.	_____.
0060	602.0405 Concrete Sidewalk 4-Inch	1,041.000 SF	_____.	_____.



Proposal Schedule of Items

Proposal ID: 20211109017 Project(s): 1480-29-71

Federal ID(s): WISC 2022013

SECTION: 0001

Contract Items

Alt Set ID:

Alt Mbr ID:

Proposal Line Number	Item ID Description	Approximate Quantity and Units	Unit Price	Bid Amount
0062	611.0530 Manhole Covers Type J	1.000 EACH	_____.	_____.
0064	611.0627 Inlet Covers Type HM	2.000 EACH	_____.	_____.
0066	611.2004 Manholes 4-FT Diameter	1.000 EACH	_____.	_____.
0068	611.3230 Inlets 2x3-FT	2.000 EACH	_____.	_____.
0070	612.0206 Pipe Underdrain Unperforated 6-Inch	80.000 LF	_____.	_____.
0072	612.0806 Apron Endwalls for Underdrain Reinforced Concrete 6-Inch	8.000 EACH	_____.	_____.
0074	616.0205 Fence Chain Link 5-FT	843.000 LF	_____.	_____.
0076	618.0100 Maintenance And Repair of Haul Roads (project) 01. 1480-29-71	1.000 EACH	_____.	_____.
0078	619.1000 Mobilization	1.000 EACH	_____.	_____.
0080	624.0100 Water	168.000 MGAL	_____.	_____.
0082	625.0500 Salvaged Topsoil	14,640.000 SY	_____.	_____.
0084	627.0200 Mulching	11,657.000 SY	_____.	_____.
0086	628.1504 Silt Fence	1,130.000 LF	_____.	_____.
0088	628.1520 Silt Fence Maintenance	1,130.000 LF	_____.	_____.
0090	628.1905 Mobilizations Erosion Control	4.000 EACH	_____.	_____.
0092	628.1910 Mobilizations Emergency Erosion Control	2.000 EACH	_____.	_____.



Proposal Schedule of Items

Proposal ID: 20211109017 Project(s): 1480-29-71

Federal ID(s): WISC 2022013

SECTION: 0001

Contract Items

Alt Set ID:

Alt Mbr ID:

Proposal Line Number	Item ID Description	Approximate Quantity and Units	Unit Price	Bid Amount
0094	628.2002 Erosion Mat Class I Type A	2,983.000 SY	_____.	_____.
0096	628.7005 Inlet Protection Type A	1.000 EACH	_____.	_____.
0098	628.7015 Inlet Protection Type C	2.000 EACH	_____.	_____.
0100	628.7504 Temporary Ditch Checks	24.000 LF	_____.	_____.
0102	628.7555 Culvert Pipe Checks	18.000 EACH	_____.	_____.
0104	628.7570 Rock Bags	50.000 EACH	_____.	_____.
0106	629.0210 Fertilizer Type B	9.220 CWT	_____.	_____.
0108	630.0130 Seeding Mixture No. 30	218.000 LB	_____.	_____.
0110	630.0170 Seeding Mixture No. 70	9.000 LB	_____.	_____.
0112	630.0500 Seed Water	328.000 MGAL	_____.	_____.
0114	634.0616 Posts Wood 4x6-Inch X 16-FT	22.000 EACH	_____.	_____.
0116	634.0618 Posts Wood 4x6-Inch X 18-FT	30.000 EACH	_____.	_____.
0118	637.2210 Signs Type II Reflective H	739.860 SF	_____.	_____.
0120	638.2602 Removing Signs Type II	23.000 EACH	_____.	_____.
0122	638.3000 Removing Small Sign Supports	27.000 EACH	_____.	_____.
0124	642.5001 Field Office Type B	1.000 EACH	_____.	_____.
0126	643.0300 Traffic Control Drums	12,447.000 DAY	_____.	_____.



Proposal Schedule of Items

Proposal ID: 20211109017 Project(s): 1480-29-71

Federal ID(s): WISC 2022013

SECTION: 0001

Contract Items

Alt Set ID:

Alt Mbr ID:

Proposal Line Number	Item ID Description	Approximate Quantity and Units	Unit Price	Bid Amount
0128	643.0420 Traffic Control Barricades Type III	2,410.000 DAY	_____.	_____.
0130	643.0705 Traffic Control Warning Lights Type A	4,820.000 DAY	_____.	_____.
0132	643.0715 Traffic Control Warning Lights Type C	1,553.000 DAY	_____.	_____.
0134	643.0800 Traffic Control Arrow Boards	286.000 DAY	_____.	_____.
0136	643.0900 Traffic Control Signs	2,653.000 DAY	_____.	_____.
0138	643.0920 Traffic Control Covering Signs Type II	10.000 EACH	_____.	_____.
0140	643.1050 Traffic Control Signs PCMS	56.000 DAY	_____.	_____.
0142	643.1200.S Portable Automated Real-Time Traffic Queue Warning System	130.000 DAY	_____.	_____.
0144	643.5000 Traffic Control	1.000 EACH	_____.	_____.
0146	646.1020 Marking Line Epoxy 4-Inch	8,345.000 LF	_____.	_____.
0148	646.3020 Marking Line Epoxy 8-Inch	5,339.000 LF	_____.	_____.
0150	646.5020 Marking Arrow Epoxy	4.000 EACH	_____.	_____.
0152	646.5120 Marking Word Epoxy	2.000 EACH	_____.	_____.
0154	646.6120 Marking Stop Line Epoxy 18-Inch	90.000 LF	_____.	_____.
0156	646.6220 Marking Yield Line Epoxy 18-Inch	18.000 EACH	_____.	_____.
0158	646.7220 Marking Chevron Epoxy 24-Inch	1,297.000 LF	_____.	_____.



Proposal Schedule of Items

Proposal ID: 20211109017 Project(s): 1480-29-71

Federal ID(s): WISC 2022013

SECTION: 0001

Contract Items

Alt Set ID:

Alt Mbr ID:

Proposal Line Number	Item ID Description	Approximate Quantity and Units	Unit Price	Bid Amount
0160	646.8120 Marking Curb Epoxy	85.000 LF	_____.	_____.
0162	650.4000 Construction Staking Storm Sewer	6.000 EACH	_____.	_____.
0164	650.4500 Construction Staking Subgrade	6,921.000 LF	_____.	_____.
0166	650.6000 Construction Staking Pipe Culverts	6.000 EACH	_____.	_____.
0168	650.7000 Construction Staking Concrete Pavement	6,141.000 LF	_____.	_____.
0170	650.8500 Construction Staking Electrical Installations (project) 01. 1480-29-71	LS	LUMP SUM	_____.
0172	650.9910 Construction Staking Supplemental Control (project) 01. 1480-29-71	LS	LUMP SUM	_____.
0174	650.9920 Construction Staking Slope Stakes	6,921.000 LF	_____.	_____.
0176	652.0225 Conduit Rigid Nonmetallic Schedule 40 2-Inch	1,834.000 LF	_____.	_____.
0178	653.0164 Pull Boxes Non-Conductive 24x42-Inch	5.000 EACH	_____.	_____.
0180	654.0105 Concrete Bases Type 5	11.000 EACH	_____.	_____.
0182	654.0220 Concrete Control Cabinet Bases Type 10	1.000 EACH	_____.	_____.
0184	655.0610 Electrical Wire Lighting 12 AWG	1,650.000 LF	_____.	_____.
0186	655.0615 Electrical Wire Lighting 10 AWG	10,259.000 LF	_____.	_____.
0188	656.0200 Electrical Service Meter Breaker Pedestal (location) 01. STH 57 and CTH K	LS	LUMP SUM	_____.



Proposal Schedule of Items

Proposal ID: 20211109017 Project(s): 1480-29-71
Federal ID(s): WISC 2022013

SECTION: 0001 Contract Items

Alt Set ID: Alt Mbr ID:

Proposal Line Number	Item ID Description	Approximate Quantity and Units	Unit Price	Bid Amount
0190	657.0255 Transformer Bases Breakaway 11 1/2-Inch Bolt Circle	11.000 EACH	_____.	_____.
0192	657.0322 Poles Type 5-Aluminum	11.000 EACH	_____.	_____.
0194	657.0710 Luminaire Arms Truss Type 4 1/2-Inch Clamp 12-FT	11.000 EACH	_____.	_____.
0196	659.1115 Luminaires Utility LED A	11.000 EACH	_____.	_____.
0198	690.0150 Sawing Asphalt	6,336.000 LF	_____.	_____.
0200	715.0720 Incentive Compressive Strength Concrete Pavement	3,022.000 DOL	1.00000	3,022.00
0202	ASP.1T0A On-the-Job Training Apprentice at \$5.00/HR	600.000 HRS	5.00000	3,000.00
0204	ASP.1T0G On-the-Job Training Graduate at \$5.00/HR	1,200.000 HRS	5.00000	6,000.00
0206	608.0418 Storm Sewer Pipe Reinforced Concrete Class IV 18-Inch	8.000 LF	_____.	_____.
0208	608.2419 Storm Sewer Pipe Reinforced Concrete Horizontal Elliptical Class HE-IV 19x30-Inch	191.000 LF	_____.	_____.

Section: 0001 Total: _____.

Total Bid: _____.