



# Wisconsin Department of Transportation

## Division of Transportation Systems Development

Bureau of Project Development  
4822 Madison Yards Way, 4<sup>th</sup> Floor South  
Madison, WI 53705

December 2, 2021

Telephone: (608) 266-1631  
Facsimile (FAX): (608) 266-8459

### NOTICE TO ALL CONTRACTORS:

**Proposal #01: 1016-01-64, WISC 2022061**  
**Juneau County Structure Repair**  
**B-29-18,19,44,45**  
**IH 90/94**  
**Juneau County**

### Letting of December 14, 2021

This is Addendum No. 01, which provides for the following:

#### Special Provisions:

Revised Special Provisions	
Article No.	Description
11	Archaeological Site

Deleted Special Provisions	
Article No.	Description
23	Portable Automated Real-Time Traffic Queue Warning System, Item 643.1200.S

#### Schedule of Items:

Revised Bid Item Quantities					
Bid Item	Item Description	Unit	Old Quantity	Revised Quantity	Proposal Total
643.1100.S	Dynamic Late Merge System	DAY	52	30	82

Deleted Bid Item Quantities					
Bid Item	Item Description	Unit	Old Quantity	Revised Quantity	Proposal Total
643.1200.S	Portable Automated Real-Time Traffic Queue Warning System	DAY	495	-495	0

**Plan Sheets:**

<b>Revised Plan Sheets</b>	
<b>Plan Sheet</b>	<b>Plan Sheet Title (brief description of changes to sheet)</b>
8	Traffic Control – General Notes & Sheet Index (revised note 15 to remove reference to Queue Warning System and replace it with reference to Dynamic Late Merge System, and list the appropriate SDD)
10	Traffic Control – Stage 1 (revised SDD reference to Dynamic Late Merge System)
11	Traffic Control – Stage 1 (revised SDD reference to Dynamic Late Merge System)
12	Traffic Control – Stage 1 (revised SDD reference to Dynamic Late Merge System)
13	Traffic Control – Stage 1 (revised SDD reference to Dynamic Late Merge System)
25	Traffic Control – Stage 4 (revised SDD reference to Dynamic Late Merge System)
26	Traffic Control – Stage 4 (revised SDD reference to Dynamic Late Merge System)
27	Traffic Control – Stage 4 (revised SDD reference to Dynamic Late Merge System)
28	Traffic Control – Stage 4 (revised SDD reference to Dynamic Late Merge System)
47	Miscellaneous Quantities (revised Dynamic Late Merge System table and quantity, deleted Portable Automated Real-Time Traffic Queue Warning System table)

The responsibility for notifying potential subcontractors and suppliers of these changes remains with the prime contractor.

Sincerely,

*Mike Coleman*

Proposal Development Specialist  
Proposal Management Section

**ADDENDUM NO. 01**

**1016-01-64**

**December 2, 2021**

**Special Provisions**

**11. Archaeological Site.**

*Replace paragraph four with the following:*

Site 47JU77/BJU-0128 (Nytsell) is located along the project route from Station 510+00 EB/WB to Station 530+00 EB/WB, LT and RT, from the reference line to outside of the existing right-of-way.

**23. DELETED.**

**Schedule of Items**

Attached, dated December 2, 2021, are the revised Schedule of Items Pages 6 and 7.

**Plan Sheets**

The following 8½ x 11-inch sheets are attached and made part of the plans for this proposal:

Revised: 8, 10 – 13, 25 – 28, and 47.

END OF ADDENDUM



**STAGE 1 CONSTRUCTION SUMMARY**  
PAVE FULL WIDTH MEDIAN SHOULDERS.

**MAINTENANCE OF TRAFFIC**  
CLOSE INSIDE LANE AND MERGE TRAFFIC TO OUTSIDE LANE.  
WB ENTRANCE RAMP AT STH 80 CLOSED FOR STAGE 1.

**TRAFFIC CONTROL LEGEND**

	TRAFFIC CONTROL DRUM		CONC. BARRIER TEMP. PRECAST
	TRAFFIC CONTROL DRUM WITH TYPE C STEADY BURN LIGHT		CRASH CUSHIONS PERMANENT
	FLASHING ARROW BOARD		CRASH CUSHIONS TRAFFIC CNTRL.
	SIGN ON PERMANENT SUPPORT		DIRECTION OF TRAFFIC
	SIGN ON PERMANENT SUPPORTS		TRAFFIC CONTROL SIGN PCMS (POR-TABLE CHANGEABLE MESSAGE SIGNS)
	TYPE III BARRICADE		TEMPORARY MARKING RAISED PAVEMENT MARKER TYPE II
	TYPE III BARRICADE WITH SIGN		HMA PAVEMENT
	WORK SPACE		

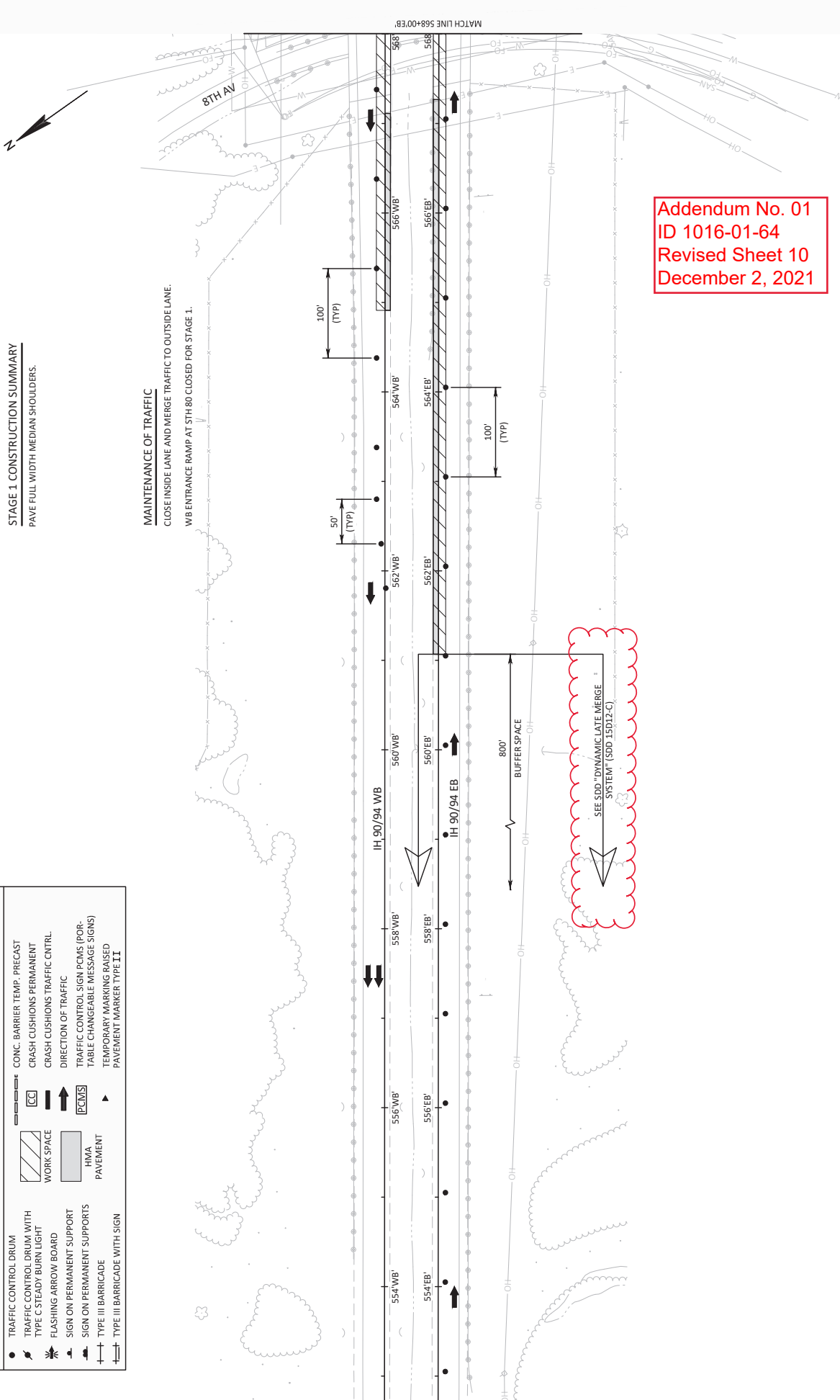



STAGE 1 CONSTRUCTION SUMMARY  
PAVE FULL WIDTH MEDIAN SHOULDERS.



**TRAFFIC CONTROL LEGEND**

	TRAFFIC CONTROL DRUM		CONC. BARRIER TEMP. PRECAST
	TRAFFIC CONTROL DRUM WITH TYPE C STEADY BURN LIGHT		CRASH CUSHIONS PERMANENT
	FLASHING ARROW BOARD		CRASH CUSHIONS TRAFFIC CNTRL.
	SIGN ON PERMANENT SUPPORT		DIRECTION OF TRAFFIC
	SIGN ON PERMANENT SUPPORTS		TRAFFIC CONTROL SIGN PCMS (PORTABLE CHANGEABLE MESSAGE SIGNS)
	TYPE III BARRICADE		TEMPORARY MARKING RAISED PAVEMENT MARKER TYPE III
	TYPE III BARRICADE WITH SIGN		
	WORK SPACE		
	HMA PAVEMENT		

MAINTENANCE OF TRAFFIC  
CLOSE INSIDE LANE AND MERGE TRAFFIC TO OUTSIDE LANE.

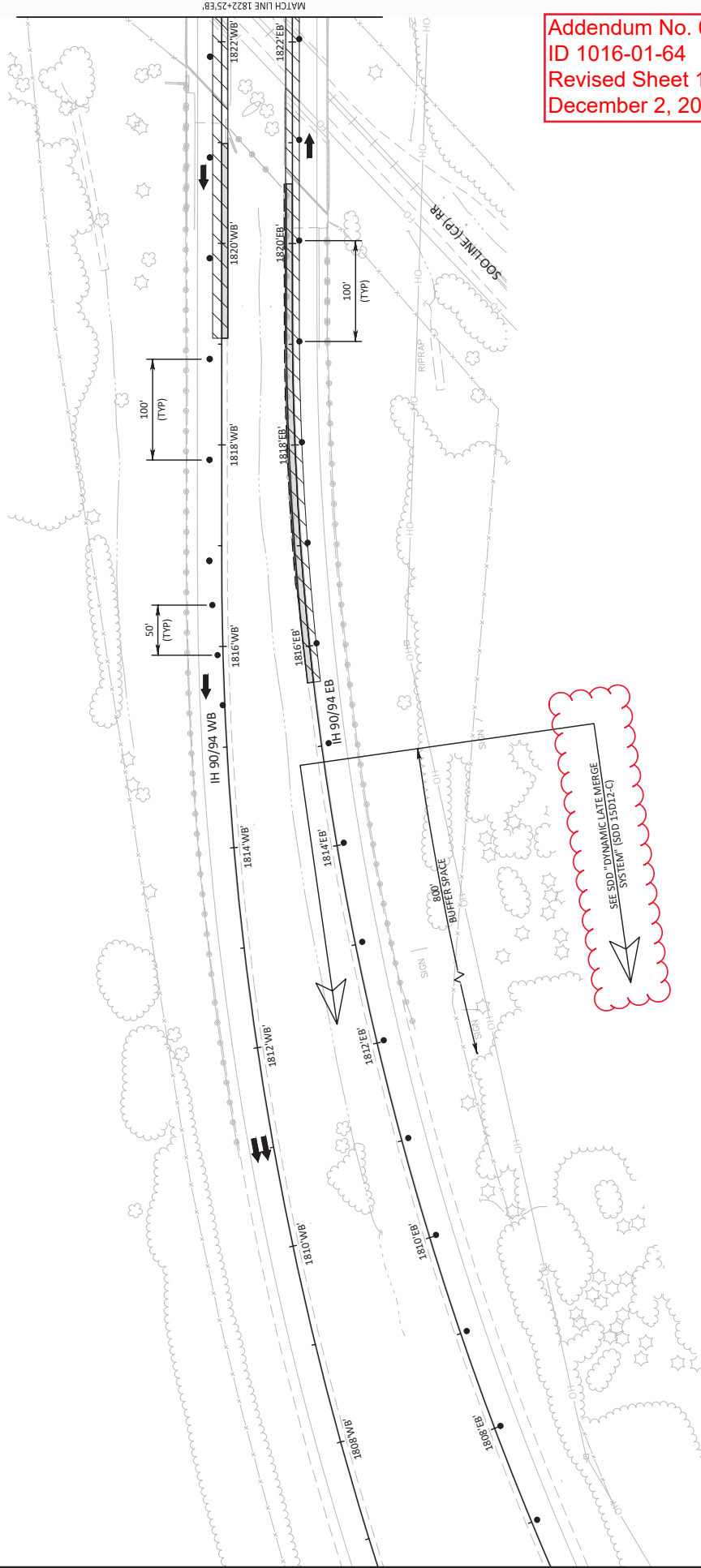

Addendum No. 01  
ID 1016-01-64  
Revised Sheet 12  
December 2, 2021

**TRAFFIC CONTROL LEGEND**

	TRAFFIC CONTROL DRUM		CONC. BARRIER TEMP. PRECAST
	TRAFFIC CONTROL DRUM WITH TYPE C STEADY BURN LIGHT		CRASH CUSHIONS PERMANENT
	FLASHING ARROW BOARD		DIRECTION OF TRAFFIC
	SIGN ON PERMANENT SUPPORT		TRAFFIC CONTROL SIGN PCMS (POR)
	TYPE III BARRICADE		TABLE CHANGEABLE MESSAGE SIGNS
	TYPE III BARRICADE WITH SIGN		TEMPORARY MARKING RAISED
	HMA PAVEMENT		PAVEMENT MARKER TYPE II
	WORK SPACE		

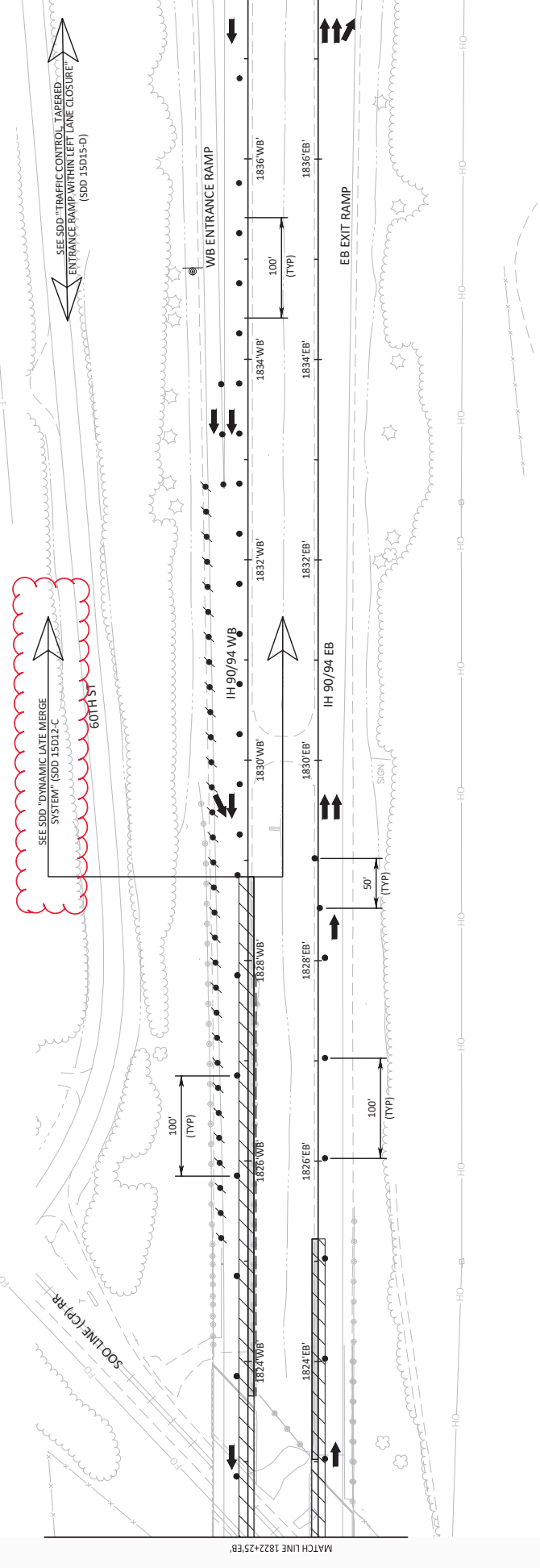

Addendum No. 01  
 ID 1016-01-64  
 Revised Sheet 13  
 December 2, 2021



**STAGE 4 CONSTRUCTION SUMMARY**  
 CONSTRUCT OUTSIDE SHOULDER RUMBLE STRIPS/MARKING

**MAINTENANCE OF TRAFFIC**  
 CLOSE OUTSIDE LANE AND MERGE TRAFFIC TO INSIDE LANE  
 WB ENTRANCE RAMP AT 5TH 80 CLOSED FOR STAGE 4.

**TRAFFIC CONTROL LEGEND**

	TRAFFIC CONTROL DRUM		CONC. BARRIER TEMP. PRECAST
	TRAFFIC CONTROL DRUM WITH TYPE C STEADY BURN LIGHT		CRASH CUSHIONS PERMANENT
	FLASHING ARROW BOARD		CRASH CUSHIONS TRAFFIC CNTRL.
	SIGN ON PERMANENT SUPPORT		DIRECTION OF TRAFFIC
	SIGN ON PERMANENT SUPPORTS		TRAFFIC CONTROL SIGN PCMS (POR-TABLE CHANGEABLE MESSAGE SIGNS)
	TYPE III BARRICADE		TEMPORARY MARKING RAISED PAVEMENT MARKER TYPE II
	TYPE III BARRICADE WITH SIGN		HMA PAVEMENT
	WORK SPACE		

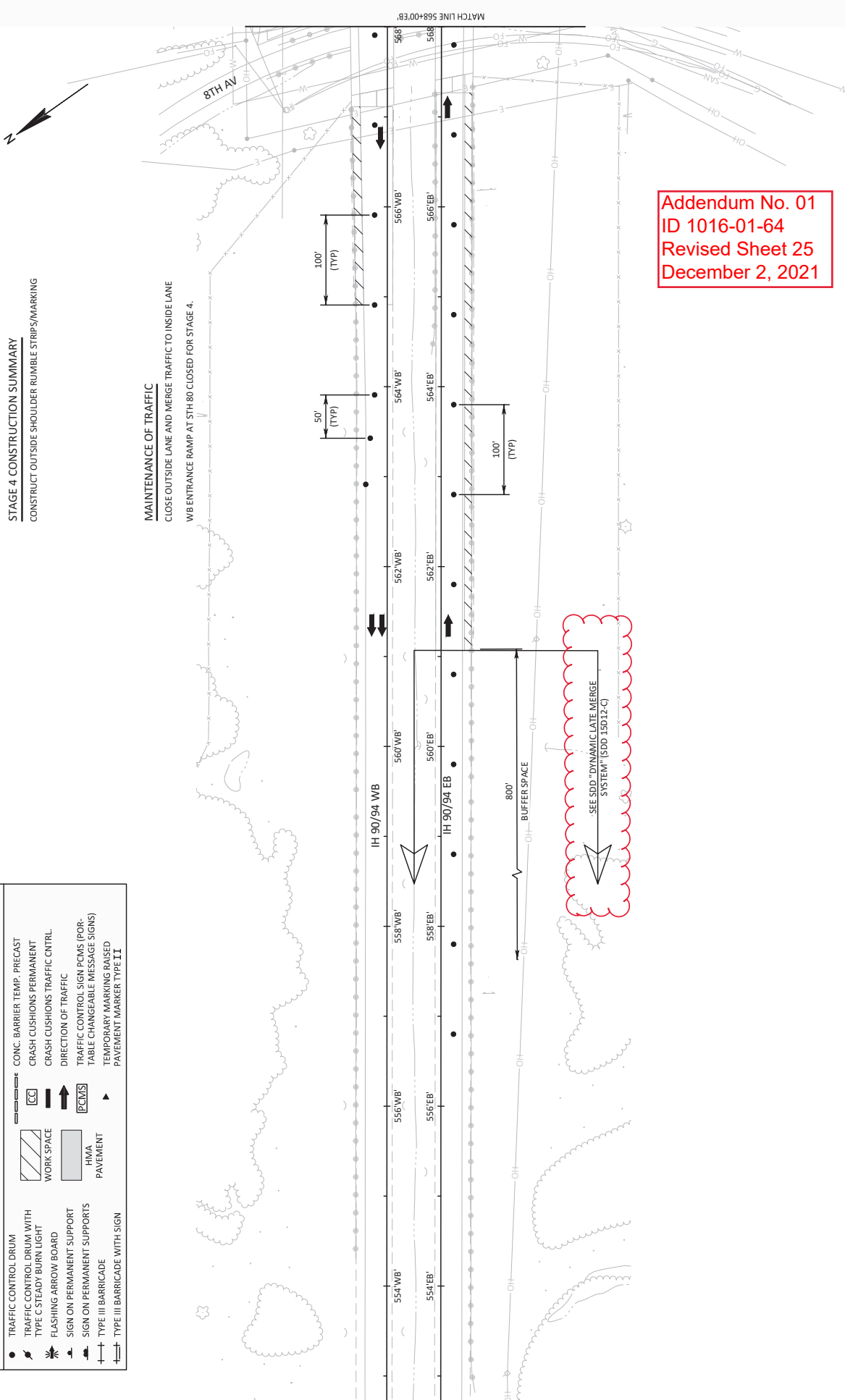

Addendum No. 01  
 ID 1016-01-64  
 Revised Sheet 25  
 December 2, 2021

Addendum No. 01  
 ID 1016-01-64  
 Revised Sheet 26  
 December 2, 2021

**TRAFFIC CONTROL LEGEND**

	TRAFFIC CONTROL DRUM		CONC. BARRIER TEMP.-PRECAST
	TRAFFIC CONTROL DRUM WITH TYPE C STEADY BURN LIGHT		CRASH CUSHIONS PERMANENT
	FLASHING ARROW BOARD		DIRECTION OF TRAFFIC
	SIGN ON PERMANENT SUPPORT		TRAFFIC CONTROL SIGN RCLAS (FOR TABLE CHANGEABLE MESSAGE SIGNS)
	SIGN ON PERMANENT SUPPORTS		TEMPORARY MARKING RAISED
	TYPE III BARRICADE		TEMPORARY MARKER TYPE II
	TYPE III BARRICADE WITH SIGN		
	WORK SPACE		
	HMA PAVEMENT		

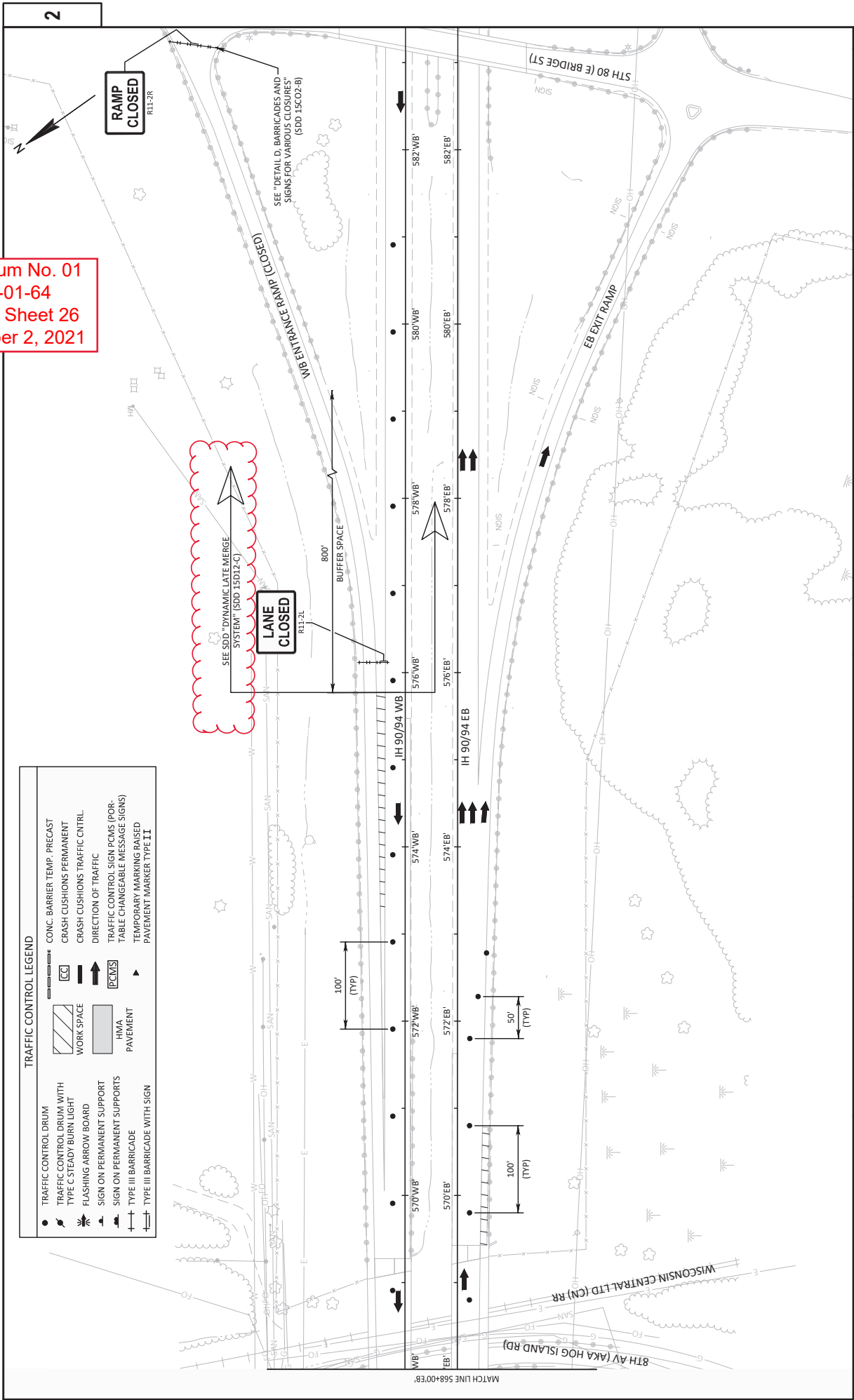

2

2

STAGE 4 CONSTRUCTION SUMMARY  
CONSTRUCT OUTSIDE SHOULDER RUMBLE STRIPS/MARKING



**TRAFFIC CONTROL LEGEND**

	TRAFFIC CONTROL DRUM		CONC. BARRIER TEMP. PRECAST
	TRAFFIC CONTROL DRUM WITH TYPE C STEADY BURN LIGHT		CRASH CUSHIONS PERMANENT
	FLASHING ARROW BOARD		CRASH CUSHIONS TRAFFIC CNTRL.
	SIGN ON PERMANENT SUPPORT		DIRECTION OF TRAFFIC
	SIGN ON PERMANENT SUPPORTS		TRAFFIC CONTROL SIGN PCMS (PORTABLE CHANGEABLE MESSAGE SIGNS)
	TYPE III BARRICADE		TEMPORARY MARKING RAISED PAVEMENT MARKER
	TYPE III BARRICADE WITH SIGN		PAVEMENT MARKER TYPE III

MAINTENANCE OF TRAFFIC  
CLOSE OUTSIDE LANE AND MERGE TRAFFIC TO INSIDE LANE

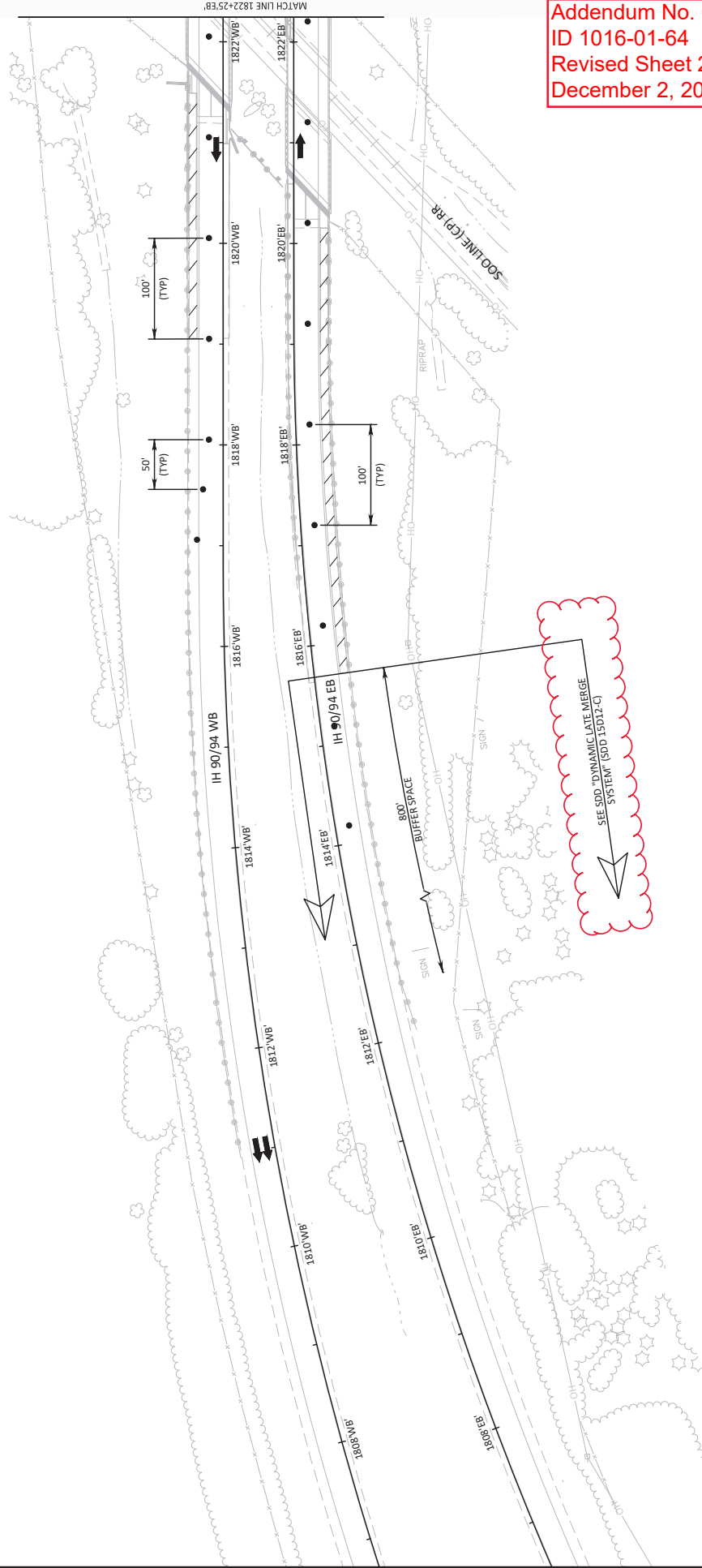

Addendum No. 01  
ID 1016-01-64  
Revised Sheet 27  
December 2, 2021



DYNAMIC LATE MERGE SYSTEM (DLMS)

APPROX. SERVICE PERIOD 643.1100.S DAYS

NOTES

\*DISTANCE (MILES) PROJECT LOCATION STAGE ZONE CATEGORY

Table with columns: CATEGORY, ZONE, STAGE, PROJECT LOCATION, DISTANCE (MILES), SERVICE PERIOD (DAYS), NOTES. Contains 24 rows of project data.

PROJECT TOTALS

\*DISTANCE CALCULATED BASED ON FLASHING ARROW BOARD LOCATION (AS SHOWN ON SDD 15D12-09C) TO 1 MILE BEYOND NEAREST INTERCHANGE

PERMANENT MARKINGS

646.1020 MARKING LINE 646.3020 MARKING LINE
EPOXY 4-INCH EPOXY 8-INCH
YELLOW WHITE WHITE

Table with columns: CATEGORY, STAGE, STATION, YELLOW LF, WHITE LF, COMMENTS. Contains 24 rows of marking data.

PROJECT TOTALS

5649 1144

Addendum No. 01
ID 1016-01-64
Revised Sheet 47
December 2, 2021



Proposal Schedule of Items

Proposal ID: 20211214001 Project(s): 1016-01-64

Federal ID(s): WISC 2022061

SECTION: 0001 Roadway Items

Alt Set ID: Alt Mbr ID:

Proposal Line Number	Item ID Description	Approximate Quantity and Units	Unit Price	Bid Amount
0158	643.0900 Traffic Control Signs	2,821.000 DAY	_____.	_____.
0160	643.0920 Traffic Control Covering Signs Type II	3.000 EACH	_____.	_____.
0162	643.1051 Traffic Control Signs PCMS with Cellular Communications	35.000 DAY	_____.	_____.
0164	643.1100.S Dynamic Late Merge System	82.000 DAY	_____.	_____.
0168	643.5000 Traffic Control	1.000 EACH	_____.	_____.
0170	645.0111 Geotextile Type DF Schedule A	31.000 SY	_____.	_____.
0172	645.0120 Geotextile Type HR	19.000 SY	_____.	_____.
0174	646.1020 Marking Line Epoxy 4-Inch	5,649.000 LF	_____.	_____.
0176	646.3020 Marking Line Epoxy 8-Inch	1,144.000 LF	_____.	_____.
0178	649.0150 Temporary Marking Line Removable Tape 4-Inch	22,413.000 LF	_____.	_____.
0180	649.0250 Temporary Marking Line Removable Tape 8-Inch	552.000 LF	_____.	_____.
0182	649.0970 Temporary Marking Removable Mask Out Tape 10-Inch	1,170.000 LF	_____.	_____.
0184	690.0150 Sawing Asphalt	1,042.000 LF	_____.	_____.
0186	690.0250 Sawing Concrete	472.000 LF	_____.	_____.
0188	715.0502 Incentive Strength Concrete Structures	588.000 DOL	1.00000	588.00
0190	801.0117 Railroad Flagging Reimbursement	44,496.000 DOL	1.00000	44,496.00



Proposal Schedule of Items

Proposal ID: 20211214001 Project(s): 1016-01-64

Federal ID(s): WISC 2022061

SECTION: 0001 Roadway Items

Alt Set ID: Alt Mbr ID:

Proposal Line Number	Item ID Description	Approximate Quantity and Units	Unit Price	Bid Amount
0192	ASP.1T0A On-the-Job Training Apprentice at \$5.00/HR	1,200.000 HRS	5.00000	6,000.00
0194	ASP.1T0G On-the-Job Training Graduate at \$5.00/HR	1,200.000 HRS	5.00000	6,000.00
0196	SPV.0090 Special 01. Salvage and Reinstall Steel Thrie Beam Structure Approach	42.000 LF	_____.	_____.
0198	SPV.0180 Special 01. Abutment Seat Cleaning and Sealing	62.000 SY	_____.	_____.
<b>Section: 0001</b>			<b>Total:</b>	_____.
			<b>Total Bid:</b>	_____.

