



# Wisconsin Department of Transportation

## Division of Transportation Systems Development

Bureau of Project Development  
4822 Madison Yards Way, 4<sup>th</sup> Floor South  
Madison, WI 53705

Telephone: (608) 266-1631  
Facsimile (FAX): (608) 266-8459

December 9, 2021

### NOTICE TO ALL CONTRACTORS:

**Proposal #36: 9509-00-70**  
**T Plum Lake, CTH N**  
**Plum Creek Bridge B-63-0030**  
**CTH N**  
**Vilas County**

### Letting of December 14, 2021

This is Addendum No. 01, which provides for the following:

#### Schedule of Items:

Revised Bid Item Quantities					
Bid Item	Item Description	Unit	Old Quantity	Revised Quantity	Proposal Total
550.0500	Pile Points	EA	14	4	18

#### Plan Sheets:

Revised Plan Sheets	
Plan Sheet	Plan Sheet Title (brief description of changes to sheet)
70	Total Estimated Quantities (W. Abut. to 9, E. Abut. to 9 for a total of 18 pile points.)

#### **Schedule of Items**

Attached, dated December 9, 2021, are the revised Schedule of Items Page 2.

#### **Plan Sheets**

The following 8½ x 11-inch sheets are attached and made part of the plans for this proposal:

Revised: 70

The responsibility for notifying potential subcontractors and suppliers of these changes remains with the prime contractor.

Sincerely,

*Mike Coleman*

Proposal Development Specialist  
Proposal Management Section

END OF ADDENDUM

STATE PROJECT NUMBER  
**9509-00-70**

**GENERAL NOTES**

- DRAWINGS SHALL NOT BE SCALED.
- ALL STATIONS AND ALL ELEVATIONS ARE IN FEET.
- BAR STEEL REINFORCEMENT SHALL BE EMBEDDED 2' CLEAR UNLESS SHOWN OR NOTED OTHERWISE.
- ALL REINFORCING BARS ARE ENGLISH. THE FIRST DIGIT OF A THREE-DIGIT BAR MARK OR THE FIRST TWO DIGITS OF A FOUR-DIGIT BAR MARK SIGNIFIES THE BAR SIZE.
- JOINT FILLER SHALL CONFORM TO THE REQUIREMENTS OF A.A.S.H.T.O. DESIGNATION M 153, TYPE I, II OR III OR A.A.S.H.T.O. DESIGNATION M 213.
- THE SLOPE OF THE FILL IN FRONT OF THE ABUTMENTS SHALL BE COVERED WITH RIPRAP HEAVY AND GEOTEXTILE TYPE 'HR' TO THE EXTENT SHOWN ON SHEETS 1 AND 2 AND IN THE ABUTMENT DETAILS.
- THE EXISTING STRUCTURE (B-63-0006) IS A 31.2' LONG BY 28.5' WIDE SINGLE SPAN STEEL DECK GIRDER BRIDGE.
- THE UPPER LIMITS OF EXCAVATION FOR STRUCTURES BRIDGES B-63-0307 SHALL BE THE EXISTING GRADE LINE.
- AT THE BACK FACE OF ABUTMENT ALL VOLUME WHICH CANNOT BE IN PLACE BEFORE ABUTMENT CONSTRUCTION SHALL BE BACKFILLED WITH BACKFILL STRUCTURE.
- AT ABUTMENTS, CONCRETE POURED UNDERWATER WILL BE ALLOWED AND SHALL BE DONE IN ACCORDANCE WITH SECTION 506.3.2.5 OF THE STANDARD SPECIFICATIONS.
- SLAB FALSE WORK SHALL BE SUPPORTED ON PILES OR THE SUBSTRUCTURE UNLESS AN ALTERNATE METHOD IS APPROVED BY THE ENGINEER.
- BACKFILL PAY LIMITS, BACKFILL BEYOND BACKFILL PAY LIMITS SHALL BE INCIDENTAL TO EXCAVATION FOR STRUCTURES. LIMITS OF EXCAVATION SHALL BE DETERMINED BY THE CONTRACTOR.
- PIPE UNDERDRAIN WRAPPED (6-INCH). SLOPE 0.5% MIN. TO SUITABLE DRAINAGE. ATTACH RODENT SHIELD AT ENDS OF PIPE UNDERDRAIN.

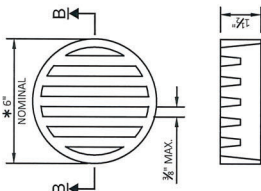

**RODENT SHIELD DETAIL**

- \* DIMENSION IS APPROXIMATE. THE GRATE IS SIZED TO FIT INTO A PIPE COUPLING. ORIENT SO SLOTS ARE VERTICAL.
- THE RODENT SHIELD, PIPE COUPLING AND SCREWS SHALL BE CONSIDERED INCIDENTAL TO THE BID ITEM "PIPE UNDERDRAIN WRAPPED 6-INCH".
- THE RODENT SHIELD SHALL BE A PVC GRATE SIMILAR TO THIS DETAIL. THE GRATE IS COMMERCIALY AVAILABLE FROM WORK SHOPS. A PIPESHIELD IS REQUIRED FOR THE EXISTING UNDERDRAIN. THE SHIELD SHALL BE FASTENED TO THE PIPE COUPLING WITH TWO OR MORE NO. 10X 1-INCH STAINLESS STEEL SHEET METAL SCREWS.

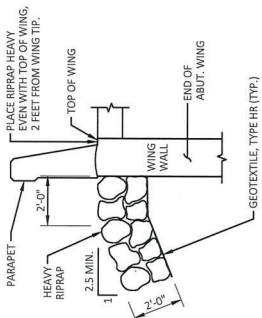

**TYPICAL FILL SECTION AT WING TIPS**

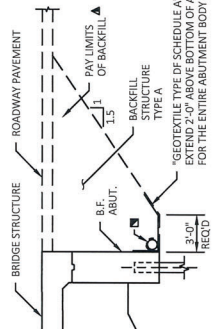

**STRUCTURE BACKFILL & LIMITS**

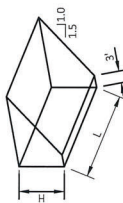

**ABUTMENT BACKFILL DIAGRAM FOR WINGS PARALLEL TO ROADWAY**

- L = OUT TO OUT OF ABUTMENT, INCLUDING WINGS (FT)
- H = AVERAGE ABUTMENT FILL HEIGHT (FT)
- E = EXPANSION FACTOR (1.20 FOR CY BID ITEMS & 1.00 FOR TON BID ITEMS)
- Vc =  $V_c = V_m (E+1) / (1+0.5)(L+5)(H)$
- Vm =  $V_m = V_c (2.0)$

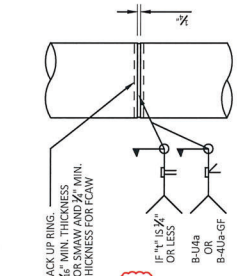

**CAST-IN-PLACE PIPE PILE**

**PILE SPLICE DETAIL**  
CAST-IN-PLACE PILE SHELL MATERIAL SHALL BE IN ACCORDANCE WITH THE STANDARD SPECIFICATION.

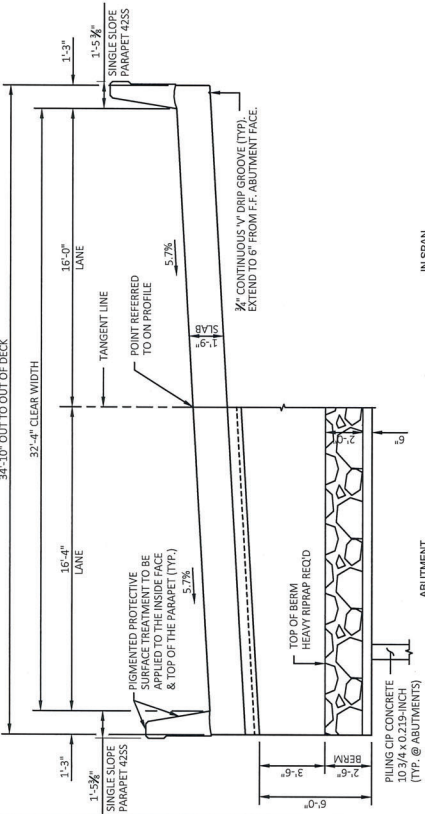

**CROSS SECTION THRU STRUCTURE**

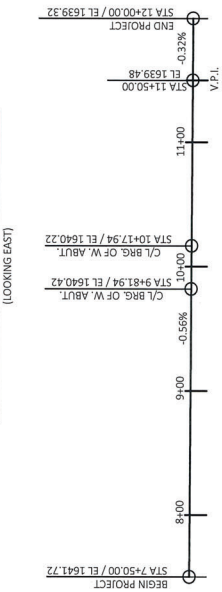

ITEM NUMBER	BID ITEMS	UNIT	WEST ABUT.	EAST ABUT.	SUPER.	TOTALS
203.027001	REMOVING STRUCTURE OVER WATERWAY (DEBRIS CAPTURE) (01. B-63-0006)	EACH	-	-	-	1
206.100001	EXCAVATION FOR STRUCTURES BRIDGES (STRUCTURE) (01. B-63-0300)	LS	-	-	-	1
210.15000	BACKFILL STRUCTURE TYPE A	TON	200	200	-	400
502.0100	CONCRETE MASONRY BRIDGES	CY	49.2	49.3	104.5	203.0
502.3200	PROTECTIVE SURFACE TREATMENT	SY	-	-	139.0	139.0
502.3210	PIGMENTED SURFACE SEALER	LB	2710	2710	-	5420
505.0400	BAR STEEL REINFORCEMENT HS STRUCTURES	LB	1670	1660	20610	23940
505.0600	BAR STEEL REINFORCEMENT HS COATED STRUCTURES	SY	10	10	-	20
516.0500	RUBBERIZED MEMBRANE WATERPROOFING	EACH	9	9	-	18
550.0500	PILE POINTS	LF	675	810	-	1485
550.2102	PIILING CIP CONCRETE 10 3/4 X 22 1/8 INCH	LF	90	85	-	175
606.0300	RIPRAP HEAVY	LF	90	90	-	180
612.0406	PIPE UNDERDRAIN WRAPPED 6-INCH	EACH	-	-	4	4
614.0150	ANCHOR ASSEMBLIES FOR STEEL PLATE BEAM GUARD	SY	35	35	-	70
645.0111	GEOTEXTILE TYPE OF SCHEDULE A	SY	162	166	-	328
645.0120	GEOTEXTILE TYPE HR	SIZE	-	-	-	3/2 X 3/4
	FILLER	NON-BID ITEMS	-	-	-	-

12/09/21

PROFESSIONAL ENGINEER  
TROY L. PETERSON  
E-31102  
MENOMONIE, WI

WISCONSIN PROFESSIONAL ENGINEER

Addendum No. 01  
ID 9509-00-70  
Revised Sheet 70  
December 9, 2021



## Proposal Schedule of Items

Proposal ID: 20211214036 Project(s): 9509-00-70

Federal ID(s): WISC 2022094

SECTION: 0001

Roadway Items

Alt Set ID:

Alt Mbr ID:

Proposal Line Number	Item ID Description	Approximate Quantity and Units	Unit Price	Bid Amount
0034	502.3210 Pigmented Surface Sealer	66.000 SY	_____.	_____.
0036	505.0400 Bar Steel Reinforcement HS Structures	5,420.000 LB	_____.	_____.
0038	505.0600 Bar Steel Reinforcement HS Coated Structures	23,980.000 LB	_____.	_____.
0040	516.0500 Rubberized Membrane Waterproofing	20.000 SY	_____.	_____.
0042	521.1217 Apron Endwalls for Pipe Arch Steel 17x13-Inch	2.000 EACH	_____.	_____.
0044	521.3717 Pipe Arch Corrugated Steel 17x13-Inch	30.000 LF	_____.	_____.
0046	550.0500 Pile Points	18.000 EACH	_____.	_____.
0048	550.2102 Piling CIP Concrete 10 3/4 X 0.219-Inch	1,485.000 LF	_____.	_____.
0050	601.0588 Concrete Curb & Gutter 4-Inch Sloped 36-Inch Type TBT	35.000 LF	_____.	_____.
0052	606.0200 Riprap Medium	2.000 CY	_____.	_____.
0054	606.0300 Riprap Heavy	175.000 CY	_____.	_____.
0056	612.0406 Pipe Underdrain Wrapped 6-Inch	180.000 LF	_____.	_____.
0058	614.0150 Anchor Assemblies for Steel Plate Beam Guard	4.000 EACH	_____.	_____.
0060	614.2500 MGS Thrie Beam Transition	157.600 LF	_____.	_____.
0062	614.2610 MGS Guardrail Terminal EAT	4.000 EACH	_____.	_____.

