



Wisconsin Department of Transportation

February 1, 2022

Division of Transportation Systems Development

Bureau of Project Development
4822 Madison Yards Way, 4th Floor South
Madison, WI 53705

Telephone: (608) 266-1631
Facsimile (FAX): (608) 266-8459

NOTICE TO ALL CONTRACTORS:

Proposal #32: 9170-12-71, WISC 2022203
Gillett – Mountain
Trinity Church Rd – CTH AA
STH 32
Oconto County

9190-28-71
Suring – Breed
South Branch Oconto River Bridge
STH 32
Oconto County

Letting of February 8, 2022

This is Addendum No. 01, which provides for the following:

Special Provisions:

Revised Special Provisions	
Article No.	Description
5	Traffic

Schedule of Items:

Revised Bid Item Quantities					
Bid Item	Item Description	Unit	Old Quantity	Revised Quantity	Proposal Total
634.0614	Posts Wood 4X6X14	EACH	27	-17	10
634.0616	Posts Wood 4X6X16	EACH	21	-6	15
634.2230	Signs Type II Reflective Type F	SF	292.25	-174.00	118.25
638.2602	Removing Signs Type II	EACH	27	-20	7
638.3000	Removing Small Sign Supports	EACH	36	-17	19
643.0420	Traffic Control Barricades Type III	DAY	2,695	140	2,835
643.0705	Traffic Control Warning Lights Type A	DAY	5,530	280	5,810
643.0900	Traffic Control Signs	DAY	19,984	5,040	25,024
643.0920	Traffic Control Covering Signs Type II	EACH	4	5	9

Plan Sheets:

Added Plan Sheets	
Plan Sheet	Plan Sheet Title (brief description of why sheet was added)
5A	Detour Signing Detail (replaces deleted detour signing plan)
5B	Detour Signing Detail (replaces deleted detour signing plan)
5C	Detour Signing Detail (replaces deleted detour signing plan)
8A	Miscellaneous Quantities (replaces deleted detour quantities)
8B	Miscellaneous Quantities (replaces deleted detour quantities)
8C	Miscellaneous Quantities (replaces deleted detour quantities)
8D	Miscellaneous Quantities (replaces deleted detour quantities)

Deleted Plan Sheets	
Plan Sheet	Plan Sheet Title (brief description of why sheet was deleted)
6	Detour Signing Detail (Detour route changed significantly)
9	Miscellaneous Quantities (Tied to detour route change)
10	Miscellaneous Quantities (Tied to detour route change)
11	Miscellaneous Quantities (Tied to detour route change)
12	Miscellaneous Quantities (Tied to detour route change)

The responsibility for notifying potential subcontractors and suppliers of these changes remains with the prime contractor.

Sincerely,

Mike Coleman

Proposal Development Specialist
Proposal Management Section

ADDENDUM NO. 01

9190-28-71

February 1, 2022

Special Provisions

5. Traffic.

*Replace paragraph three under section titled **STH 32 Closures and Detours** with the following:*

For the CTH R to CTH AA closure, detour STH 32 northbound traffic at CTH M, west on CTH M to STH 55, north on STH 55 to STH 64, and east on STH 64 to STH 32. STH 32 southbound traffic will utilize the same detour path in reverse. Backfill all excavations for culvert pipe work to an elevation approximate to the surrounding roadbed within 48 hours of starting the work.

*Replace paragraph one under section titled **Surface for Milling, Paving, and Trenches** with the following:*

Do not allow the milled surface to remain exposed for a period greater than 96 hours, unless adverse weather prevents placement of the asphalt surface layer. In the event of adverse weather, resume placement of the asphalt surface layer as soon as conditions permit. Provide an even cross-sectional profile of the roadway at the end of each day's milling operations, excepting the passing lane area (Station 840+93 – 913+93), where the northbound lanes may be left uneven if one of them remains closed to traffic.

Schedule of Items

Attached, dated February 1, 2022, are the revised Schedule of Items Page 10.

Plan Sheets

The following 8½ x 11-inch sheets are attached and made part of the plans for this proposal:

Revised: None.

Added: 5A – 5C and 8A – 8D

END OF ADDENDUM

- LEGEND**
- (X) SIGN NUMBER, REFER TO MISCELLANEOUS QUANTITY SHEET
 - PCMS PORTABLE CHANGEABLE MESSAGE SIGN
 - Sign mounted on type III barricade
 - Post mounted sign

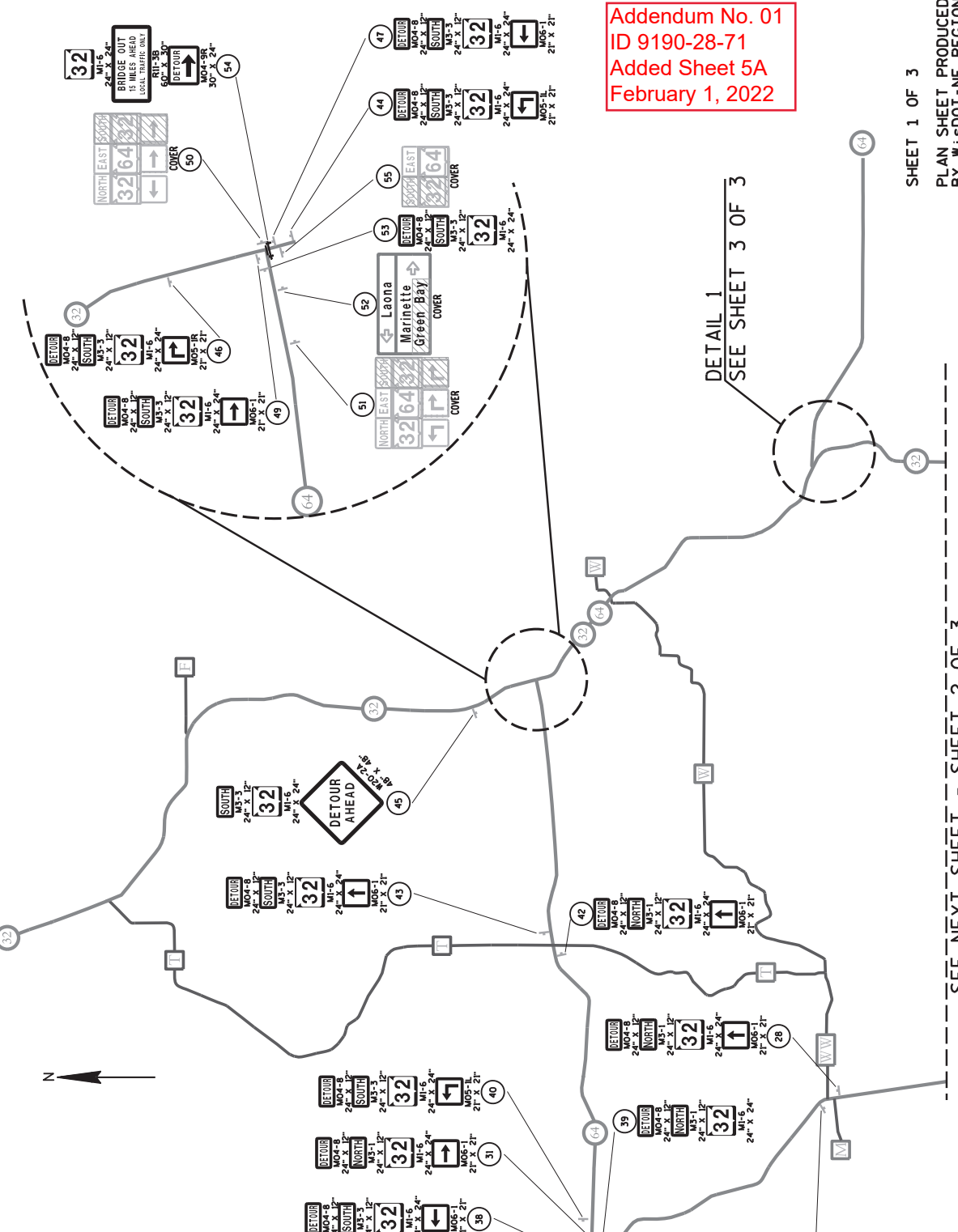

Addendum No. 01
ID 9190-28-71
Added Sheet 5A
February 1, 2022

SHEET 1 OF 3

PLAN SHEET PRODUCED BY WISDOT-NE REGION

SEE NEXT SHEET - SHEET 2 OF 3

COUNTY: ONTARIO

HWY: STH 32

PROJECT NO: 9190-28-71

DETOUR SIGNING DETAIL

SHEET 5A

E

LEGEND

-  SIGN NUMBER, REFER TO MISCELLANEOUS QUANTITY SHEET
-  PORTABLE CHANGEABLE MESSAGE SIGN
-  SIGN MOUNTED ON TYPE III BARRICADE
-  POST MOUNTED SIGN

SEE PREVIOUS SHEET - SHEET 1 OF 3

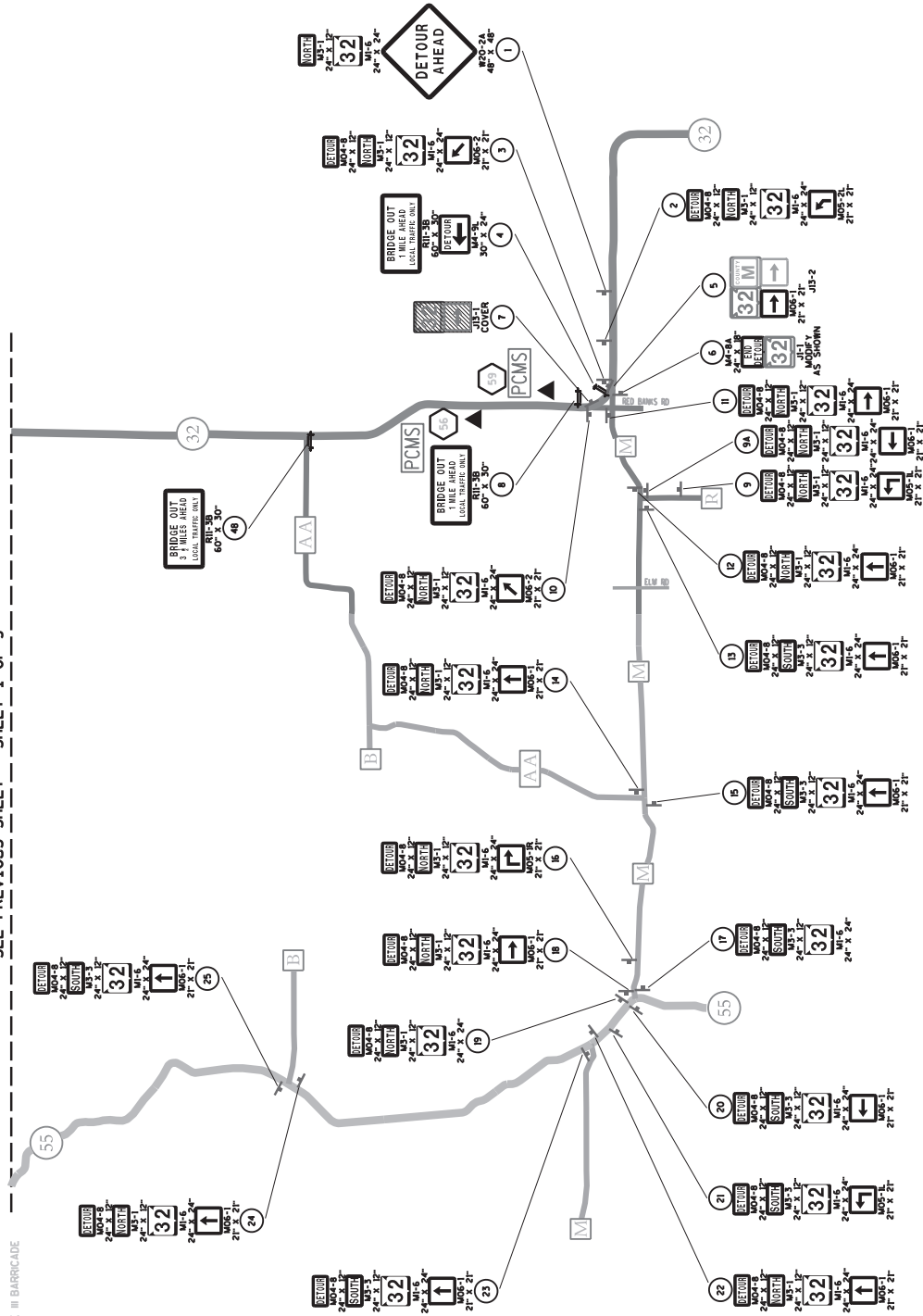

Addendum No. 01
 ID 9190-28-71
 Added Sheet 5B
 February 1, 2022

SHEET 2 OF 3
 PLAN SHEET PRODUCED
 BY WISDOT-NE REGION
 SHEET 5B

LEGEND

- (X) SIGN NUMBER, REFER TO MISCELLANEOUS QUANTITY SHEET
- PCMS PORTABLE CHANGEABLE MESSAGE SIGN
- SIGN MOUNTED ON TYPE III BARRICADE
- POST MOUNTED SIGN



Addendum No. 01
 ID 9190-28-71
 Added Sheet 5C
 February 1, 2022

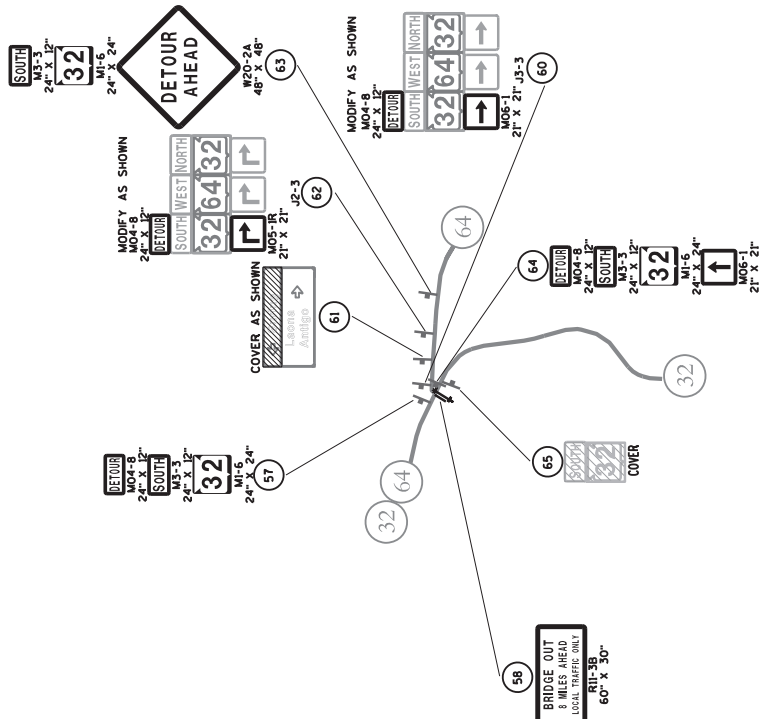

DETAIL 1

SHEET 3 OF 3

PLAN SHEET PRODUCED BY WISDOT-NE REGION

SHEET 5C

COUNTY: OCONTO

HWY: STH 32

PROJECT NO: 9180-28-71

DETOUR SIGNING DETAIL

E

PLOT DATE : \$\$. PLOT BY : \$\$. PLOT NAME :

FILE NAME : \$\$.

PLOT SCALE : \$\$.

WISDOT/CADD SHEET 42

Addendum No. 01
 ID 9190-28-71
 Added Sheet 8A
 February 1, 2022

TRAFFIC CONTROL DETOUR SIGN SUMMARY

SIGN NO.	LOCATION	SIGN CODE	SIZE W X H	NUMBER IN SERVICE	APPROX. SERVICE PERIOD DAYS	643.0900 SIGNS	643.0420 BARRICADES TYPE III	643.0705 WARNING LIGHTS TYPE A	643.1050 PORTABLE MESSAGE CHANGABLE DAYS	NO OF CYCLES	643.0920 COVERING SIGNS TYPE II	REMARKS
1	STH 32, E. OF CTH M, PLACE 1000' E. OF CTH M INTERSECTION	M 3-1	24"x12"	1	70	70						
	"	M 1-6	24"x24"	1	70	70						32
	"	M 20-2A	48"x48"	1	70	70						
2	STH 32, E. OF CTH M, PLACE 500' E. OF CTH M INTERSECTION	M 3-1	24"x12"	1	70	70						
	"	M 1-6	24"x24"	1	70	70						32
3	STH 32, E. OF CTH M, PLACE 100' E. OF CTH M INTERSECTION	M 3-1	24"x12"	1	70	70						
	"	M 1-6	24"x24"	1	70	70						32
4	STH 32, AT CTH M INTERSECTION, PLACE ON RIGHT SHOULDER	R 11-3B	60"x30"	1	70	70	70	140				TILT LEFT 1 MILE AHEAD
5	STH 32, AT CTH M INTERSECTION, MODIFY EXISTING J13-2 SIGN AS SHOWN	M 4-9L	30"x24"	1	70	70						RIGHT
6	CTH M, BETWEEN STH 32 AND RED BANKS RD, MODIFY EXISTING J1-1 SIGN AS SHOWN	M 6-1	21"x21"	1	70	70				1	1	COVER ENTIRE SIGN 1 MILE AHEAD
7	STH 32, AT RED BANKS RD INTERSECTION, COVER EXISTING J13-1 SIGN AS SHOWN	M 4-8A	24"x18"	1	70	70						
8	CTH R, S. OF CTH M, PLACE 500' S. OF CTH M INTERSECTION	R 11-3B	60"x30"	1	70	70	70	140				
9	CTH R, S. OF CTH M, PLACE 500' S. OF CTH M INTERSECTION	M 3-1	24"x12"	1	70	70						
	"	M 1-6	24"x24"	1	70	70						32
9A	CTH R, AT CTH M, PLACE RIGHT OF EXISTING R1-1 SIGN AT INTERSECTION	M 6-1	21"x21"	1	70	70						LEFT
10	STH 32, N. OF RED BANKS RD, PLACE 100' N. OF RED BANKS RD INTERSECTION	M 3-1	24"x12"	1	70	70						
	"	M 1-6	24"x24"	1	70	70						32
11	RED BANKS RD, AT CTH M INTERSECTION, PLACE RIGHT OF EXISTING R1-1 SIGN	M 6-2	21"x21"	1	70	70						TILT RIGHT
	"	M 4-8	24"x12"	1	70	70						
	"	M 3-1	24"x12"	1	70	70						32
	"	M 1-6	24"x24"	1	70	70						RIGHT
12	CTH M, E. OF CTH R, PLACE LEFT OF EXISTING J13-2 SIGN	M 3-1	24"x12"	1	70	70						
	"	M 1-6	24"x24"	1	70	70						32
13	CTH M, W. OF CTH R, PLACE RIGHT OF EXISTING J13-2 SIGN	M 6-1	21"x21"	1	70	70						AHEAD
	"	M 4-8	24"x12"	1	70	70						
	"	M 3-3	24"x12"	1	70	70						32
	"	M 1-6	24"x24"	1	70	70						AHEAD
14	CTH M, E. OF CTH AA, PLACE RIGHT OF EXISTING J13-2 SIGN	M 6-1	21"x21"	1	70	70						
	"	M 4-8	24"x12"	1	70	70						32
	"	M 3-1	24"x12"	1	70	70						AHEAD
	"	M 1-6	24"x24"	1	70	70						32
15	CTH M, W. OF CTH AA, PLACE RIGHT OF EXISTING J13-2 SIGN	M 6-1	21"x21"	1	70	70						
	"	M 4-8	24"x12"	1	70	70						32
	"	M 3-3	24"x12"	1	70	70						AHEAD
	"	M 1-6	24"x24"	1	70	70						32
	"	M 6-1	21"x21"	1	70	70						AHEAD
	PAGE SUBTOTALS			48		3,360	140	280	0		1	

PLAN SHEET PRODUCED
 BY WisDOT - NE REGION

PROJECT NUMBER: 9190-28-71

HWY: STH 32

COUNTY: OCONTO

MISCELLANEOUS QUANTITIES

SHEET 8A

E

Addendum No. 01
 ID 9190-28-71
 Added Sheet 8B
 February 1, 2022

TRAFFIC CONTROL DETOUR SIGN SUMMARY

SIGN NO.	LOCATION	SIGN CODE	SIZE W X H	NUMBER IN SERVICE	APPROX. SERVICE PERIOD DAYS	643-0900 SIGNS DAYS	643-0420 BARRICADES TYPE III DAYS	643-0705 WARNING LIGHTS TYPE A DAYS	643-1050 SIGNS PORTABLE MESSAGE CHANGEABLE DAYS	NO OF CYCLES	643-0920 COVERING SIGNS TYPE II EACH	REMARKS					
16	CTH M, E. OF STH 55, PLACE 500' E. OF STH 55 INTERSECTION	MO 4-8	24"x12"	1	70	70											
	"	M 3-1	24"x12"	1	70	70											
	"	M 1-6	24"x24"	1	70	70						32					
	"	MO 5-1R	21"x21"	1	70	70											
17	CTH M, E. OF STH 55, PLACE 200' E. OF STH 55 INTERSECTION	MO 4-8	24"x12"	1	70	70											
	"	M 3-3	24"x12"	1	70	70											
	"	M 1-6	24"x24"	1	70	70						32					
18	CTH M, E. OF STH 55, PLACE AT INTERSECTION SPLIT, 200' E. OF INTERSECTION	MO 4-8	24"x12"	1	70	70											
	"	M 3-1	24"x12"	1	70	70											
	"	M 1-6	24"x24"	1	70	70						32					
	"	MO 6-1	21"x21"	1	70	70						RIGHT					
19	STH 55, N. OF CTH M S. JCT, PLACE 250' N. OF CTH M INTERSECTION	MO 4-8	24"x12"	1	70	70											
	"	M 3-1	24"x12"	1	70	70											
	"	M 1-6	24"x24"	1	70	70						32					
20	STH 55, AT CTH M INTERSECTION, PLACE 100' N. OF CTH M	MO 4-8	24"x12"	1	70	70											
	"	M 3-3	24"x12"	1	70	70											
	"	M 1-6	24"x24"	1	70	70						32					
	"	MO 6-1	21"x21"	1	70	70						LEFT					
21	STH 55, N. OF CTH M S. JCT, PLACE 750' N. OF CTH M INTERSECTION	MO 4-8	24"x12"	1	70	70											
	"	M 3-3	24"x12"	1	70	70											
	"	M 1-6	24"x24"	1	70	70						32					
	"	MO 5-1L	21"x21"	1	70	70											
22	STH 55, S. OF CTH M N. JCT, PLACE 250' S. OF CTH M INTERSECTION	MO 4-8	24"x12"	1	70	70											
	"	M 3-1	24"x12"	1	70	70											
	"	M 1-6	24"x24"	1	70	70						32					
	"	MO 6-1	21"x21"	1	70	70						AHEAD					
23	STH 55, N. OF CTH M N. JCT, PLACE 250' N. OF CTH M INTERSECTION	MO 4-8	24"x12"	1	70	70											
	"	M 3-3	24"x12"	1	70	70											
	"	M 1-6	24"x24"	1	70	70						32					
	"	MO 6-1	21"x21"	1	70	70						AHEAD					
24	STH 55, S. OF CTH B, PLACE 100' S. OF CTH B INTERSECTION	MO 4-8	24"x12"	1	70	70											
	"	M 3-1	24"x12"	1	70	70											
	"	M 1-6	24"x24"	1	70	70						32					
	"	MO 6-1	21"x21"	1	70	70						AHEAD					
25	STH 55, N. OF CTH B, PLACE 100' N. OF CTH B INTERSECTION	MO 4-8	24"x12"	1	70	70											
	"	M 3-3	24"x12"	1	70	70											
	"	M 1-6	24"x24"	1	70	70						32					
	"	MO 6-1	21"x21"	1	70	70						AHEAD					
26	VACANT																
27	VACANT																
28	STH 55, S. OF CTH M, PLACE 250' S. OF CTH M INTERSECTION	MO 4-8	24"x12"	1	70	70											
	"	M 3-1	24"x12"	1	70	70											
	"	M 1-6	24"x24"	1	70	70						32					
	"	MO 6-1	21"x21"	1	70	70						AHEAD					
PAGE SUBTOTALS											42	2,940	0	0	0	0	0

PLAN SHEET PRODUCED
 BY WisDOT - NE REGION

PROJECT NUMBER:9190-28-71

HWY-STH 32

COUNTY:OCONTO

MISCELLANEOUS QUANTITIES

SHEET 8B

E

Addendum No. 01
 ID 9190-28-71
 Added Sheet 8C
 February 1, 2022

TRAFFIC CONTROL DETOUR SIGN SUMMARY

STGN NO.	LOCATION	STGN CODE	SIZE W X H	NUMBER IN SERVICE	APPROX. SERVICE PERIOD DAYS	643.0900 SIGNS DAYS	643.0420 BARRICADES TYPE III DAYS	643.0705 WARNING LIGHTS TYPE A DAYS	643.1050 SIGNS PORTABLE CHANGEABLE MESSAGE DAYS	NO OF CYCLES	643.0920 COVERING SIGNS TYPE II EACH	REMARKS					
29	STH 55, N. OF CTH WW, PLACE 250' N. OF CTH WW INTERSECTION	MO 4-8	24"X12"	1	70	70											
	"	M 3-3	24"X12"	1	70	70											
	"	M 1-6	24"X24"	1	70	70						32					
	"	MO 6-1	21"X21"	1	70	70						AHEAD					
30	VACANT																
31	STH 55, S. OF STH 64, PLACE 250' S. OF STH 64 INTERSECTION	MO 4-8	24"X12"	1	70	70											
	"	M 3-1	24"X12"	1	70	70											
	"	M 1-6	24"X24"	1	70	70						32					
	"	MO 6-1	21"X21"	1	70	70						RIGHT					
32	STH 55, S. OF STH 64, PLACE RIGHT OF EXISTING J4-1 SIGN	MO 4-8	24"X12"	1	70	70											
	"	M 3-3	24"X12"	1	70	70											
	"	M 1-6	24"X24"	1	70	70						32					
33	STH 64, E. OF STH 55, PLACE ON RIGHT SHOULDER JUST EAST OF INTERSECTION	M 1-6	24"X24"	1	70	70	70	140				32					
	"	M 3-3	24"X12"	1	70	70											
	"	R III-3B	60"X30"	1	70	70						26 MILES AHEAD					
	"	MO 4-9R	30"X24"	1	70	70											
34	STH 64, AT STH 55 INTERSECTION, PLACE/MODIFY EXISTING SIGN AT STH 55	MO 4-8	24"X12"	1	70	70											
	"	M 3-3	24"X12"	1	70	70											
	"	M 1-6	24"X24"	1	70	70						32					
	"	MO 6-1	21"X21"	1	70	70						RIGHT					
35	VACANT																
36	STH 64, W. OF STH 55 INTERSECTION, PLACE 400' W. OF STH 55	MO 4-8	24"X12"	1	70	70											
	"	M 3-3	24"X12"	1	70	70											
	"	M 1-6	24"X24"	1	70	70						32					
	"	MO 5-1R	21"X21"	1	70	70											
37	STH 64, W. OF STH 55 INTERSECTION, PLACE 1000' W. OF STH 55	MO 3-3	24"X12"	1	70	70											
	"	M 1-6	24"X24"	1	70	70						32					
	"	M 3-2	24"X24"	1	70	70											
	"	M 1-6	24"X24"	1	70	70						64					
	"	MO 20-2A	48"X48"	1	70	70											
38	STH 64, AT STH 55 INTERSECTION, PLACE 250' E. OF STH 55	MO 4-8	24"X12"	1	70	70											
	"	M 3-3	24"X12"	1	70	70											
	"	M 1-6	24"X24"	1	70	70						32					
	"	MO 6-1	21"X21"	1	70	70						LEFT					
39	STH 64, E. OF STH 55 INTERSECTION, PLACE E. OF STH 55 INTERSECTION AS SHOWN	MO 4-8	24"X12"	1	70	70											
	"	M 3-1	24"X12"	1	70	70											
	"	M 1-6	24"X24"	1	70	70						32					
40	STH 64, E. OF STH 55 INTERSECTION, PLACE 500' E. OF STH 55	MO 4-8	24"X12"	1	70	70											
	"	M 3-3	24"X12"	1	70	70											
	"	M 1-6	24"X24"	1	70	70											
	"	MO 5-1L	21"X21"	1	70	70											
41	VACANT																
42	STH 64, W. OF CTH T, PLACE 100' W. OF CTH T INTERSECTION	MO 4-8	24"X12"	1	70	70											
	"	M 3-1	24"X12"	1	70	70											
	"	M 1-6	24"X24"	1	70	70						32					
	"	MO 6-1	21"X21"	1	70	70						AHEAD					
43	STH 64, E. OF CTH T, PLACE 100' E. OF CTH T INTERSECTION	MO 4-8	24"X12"	1	70	70											
	"	M 3-3	24"X12"	1	70	70											
	"	M 1-6	24"X24"	1	70	70						32					
	"	MO 6-1	21"X21"	1	70	70						AHEAD					
PAGE SUBTOTALS											3,290	70	140	0	0		

PLAN SHEET PRODUCED
 BY WisDOT - NE REGION

PROJECT NUMBER:9190-28-71

HWY:STH 32

COUNTY:OCONTO

MISCELLANEOUS QUANTITIES

SHEET 8C

E

Addendum No. 01
 ID 9190-28-71
 Added Sheet 8D
 February 1, 2022

TRAFFIC CONTROL DETOUR SIGN SUMMARY

STGN NO.	LOCATION	SIGN CODE	SIZE W X H	NUMBER IN SERVICE	APPROX. SERVICE PERIOD DAYS	643.0900 SIGNS	643.0420 BARRICADES TYPE III	643.0705 WARNING LIGHTS TYPE A	643.1050 SIGNS PORTABLE MESSAGE CHANGABLE DAYS	NO. OF CYCLES	643.0920 COVERING SIGNS TYPE II	REMARKS
44	STH 32/64, S. OF STH 64, PLACE 500' S. OF STH 64 INTERSECTION	MO 4-8	24"X12"	1	70	70						
	"	M 3-3	24"X12"	1	70	70						
	"	M 1-6	24"X24"	1	70	70						32
	"	NO 5-1L	21"X21"	1	70	70						
45	STH 32, N. OF STH 64, PLACE 1000' N. OF STH 64 INTERSECTION	M 3-3	24"X12"	1	70	70						
	"	M 1-6	24"X24"	1	70	70						32
46	STH 32, N. OF STH 64, PLACE RIGHT OF EXISTING J2-2 SIGN AS SHOWN	MO 4-8	24"X12"	1	70	70						
	"	M 3-3	24"X12"	1	70	70						
	"	M 1-6	24"X24"	1	70	70						32
	"	MO 5-1R	21"X21"	1	70	70						
47	STH 32/64, AT STH 64, PLACE RIGHT OF EXISTING J3-2 SIGN	MO 4-8	24"X12"	1	70	70						
	"	M 1-6	24"X24"	1	70	70						32
	"	MO 6-1	21"X21"	1	70	70						LEFT
48	STH 32, AT CTH AA, PLACE ON RIGHT SHOULDER IN SW QUADRANT OF INTERSECTION	R 11-3B	60"X30"	1	70	70	70	140				3 1/2 MILES AHEAD
49	STH 32, AT STH 64 INTERSECTION, PLACE RIGHT OF EXISTING J3-1 SIGN	MO 4-8	24"X12"	1	70	70						
	"	M 3-3	24"X12"	1	70	70						
	"	M 1-6	24"X24"	1	70	70						32
	"	MO 6-1	21"X21"	1	70	70						RIGHT
50	STH 32, AT STH 64 INTERSECTION, COVER EXISTING J3-3 SIGN AS SHOWN									1	1	COVER "S. 32 RT"
51	STH 64, W. OF STH 32, COVER EXISTING J2-3 SIGN AS SHOWN									1	1	COVER "S. 32 ADV RT"
52	STH 64, W. OF STH 32, COVER EXISTING J2-3 SIGN AS SHOWN									1	1	COVER "GREEN BAY"
53	STH 64, W. OF STH 32, PLACE 100' W. OF STH 32 INTERSECTION											
	"											32
54	STH 32, AT STH 64 INTERSECTION, PLACE ON RIGHT SHOULDER IN SW QUADRANT OF INTERSECTION	M 1-6	24"X24"	1	70	70	70	140				15 MILES AHEAD
	"	R 11-3B	60"X30"	1	70	70						
	"	NO 4-9R	30"X24"	1	70	70						
55	STH 32, S. OF STH 64, COVER EXISTING J4-2 SIGN AS SHOWN	PCMS		1					7	1	1	COVER "SOUTH 32"
56	STH 32, S. OF CTH AA, PLACE ON RIGHT SHOULDER, FIELD DETERMINED	NO 4-8	24"X12"	1	70	70						PLACE IN ADVANCE OF CLOSURE
57	STH 32/64, N. OF STH 64, PLACE 250' N. OF STH 64 INTERSECTION	M 3-3	24"X12"	1	70	70						
	"	M 1-6	24"X24"	1	70	70						32
58	STH 32/64, AT STH 32/64 INTERSECTION, PLACE ON RIGHT SHOULDER IN SW QUADRANT	R 11-3B	60"X30"	1	70	70						
59	STH 32, N. OF CTH M, PLACE ON RIGHT SHOULDER, FIELD DETERMINED	PCMS		1					7			8 MILES AHEAD
60	STH 64, E. OF STH 32, MODIFY EXISTING J3-3 SIGN AS SHOWN	MO 4-8	24"X12"	1	70	70						RIGHT
	"	MO 6-1	21"X21"	1	70	70						COVER "LEFT SURING"
61	STH 64, E. OF STH 32, COVER EXISTING D1-3 SIGN AS SHOWN	MO 4-8	24"X12"	1	70	70						
62	STH 64, E. OF STH 32, MODIFY EXISTING J2-3 SIGN AS SHOWN	NO 5-1R	21"X21"	1	70	70						
	"	M 3-3	24"X12"	1	70	70						
63	STH 64, E. OF STH 32, PLACE 1000' E. OF STH 32 INTERSECTION	M 1-6	24"X24"	1	70	70						32
	"	W 20-2A	48"X48"	1	70	70						
64	STH 32, S. OF STH 64, PLACE 250' S. OF STH 64 INTERSECTION	MO 4-8	24"X12"	1	70	70						
	"	M 3-3	24"X12"	1	70	70						32
	"	M 1-6	24"X24"	1	70	70						AHEAD
	"	MO 6-1	21"X21"	1	70	70						COVER ENTIRE SIGN
65	STH 32, S. OF STH 64, COVER EXISTING J4-1 SIGN											
				44		3,010	210	420	14	1	6	
				181		12,600	420	840	14	7		

PAGE SUBTOTALS

DETOUR TOTALS

PLAN SHEET PRODUCED
 BY WisDOT - NE REGION

PROJECT NUMBER:9190-28-71

HWY-STH 32

COUNTY:OCONTO

MISCELLANEOUS QUANTITIES

SHEET 8D

E



Proposal Schedule of Items

Proposal ID: 20220208032 Project(s): 9170-12-71, 9190-28-71

Federal ID(s): WISC 2022203, N/A

SECTION: 0001 Roadway

Alt Set ID: Alt Mbr ID:

Proposal Line Number	Item ID Description	Approximate Quantity and Units	Unit Price	Bid Amount
0268	633.5200 Markers Culvert End	58.000 EACH	_____.	_____.
0270	634.0614 Posts Wood 4x6-Inch X 14-FT	10.000 EACH	_____.	_____.
0272	634.0616 Posts Wood 4x6-Inch X 16-FT	15.000 EACH	_____.	_____.
0274	637.2230 Signs Type II Reflective F	118.250 SF	_____.	_____.
0276	638.2102 Moving Signs Type II	13.000 EACH	_____.	_____.
0278	638.2602 Removing Signs Type II	7.000 EACH	_____.	_____.
0280	638.3000 Removing Small Sign Supports	19.000 EACH	_____.	_____.
0282	642.5401 Field Office Type D	1.000 EACH	_____.	_____.
0284	643.0300 Traffic Control Drums	9,915.000 DAY	_____.	_____.
0286	643.0410 Traffic Control Barricades Type II	1,050.000 DAY	_____.	_____.
0288	643.0420 Traffic Control Barricades Type III	2,835.000 DAY	_____.	_____.
0290	643.0705 Traffic Control Warning Lights Type A	5,810.000 DAY	_____.	_____.
0292	643.0715 Traffic Control Warning Lights Type C	1,046.000 DAY	_____.	_____.
0294	643.0900 Traffic Control Signs	25,024.000 DAY	_____.	_____.
0296	643.0920 Traffic Control Covering Signs Type II	9.000 EACH	_____.	_____.
0298	643.1050 Traffic Control Signs PCMS	42.000 DAY	_____.	_____.
0300	643.1070 Traffic Control Cones 42-Inch	40.000 DAY	_____.	_____.

