



Wisconsin Department of Transportation

April 4, 2022

Division of Transportation Systems Development

Bureau of Project Development
4822 Madison Yards Way, 4th Floor South
Madison, WI 53705

NOTICE TO ALL CONTRACTORS:

Telephone: (608) 266-1631
Facsimile (FAX): (608) 266-8459

Proposal #35: 8190-00-72, WISC 2022033
Bloomer - Cornell
North Jct STH 40 to CTH E
STH 64
Chippewa County

8620-00-73, WISC 2022036
Bloomer - Bruce
13th Ave to East Jct STH 64
STH 40
Chippewa County

Letting of April 12, 2022

This is Addendum No. 01, which provides for the following:

Schedule of Items:

Revised Bid Item Quantities					
Bid Item	Item Description	Unit	Old Quantity	Revised Quantity	Proposal Total
614.2300	MGS Guardrail 3	LF	785	-569	216
690.0150	Sawing Asphalt	LF	2,959	-430	2,529

Added Bid Item Quantities					
Bid Item	Item Description	Unit	Old Quantity	Revised Quantity	Proposal Total
614.2330	MGS Guardrail 3 K	LF	0	569	569

Plan Sheets:

Revised Plan Sheets	
Plan Sheet	Plan Sheet Title (brief description of changes to sheet)
14	Construction Details (Guardrail layout and sawcut locations revised)
43	Miscellaneous Quantities (Beamguard Items quantities revised)
45	Miscellaneous Quantities (Sawing Asphalt quantities revised)
46	Plan (Guardrail layout revised)
65 - 71	Cross Sections (Guardrail location and grading revised)

The responsibility for notifying potential subcontractors and suppliers of these changes remains with the prime contractor.

Sincerely,

Mike Coleman

Proposal Development Specialist
Proposal Management Section

ADDENDUM NO. 01
8190-00-72 & 8620-00-73
April 4, 2022

Special Provisions

6. Utilities.

*Replace entire subsection titled **We Energies (Gas)** under section titled Project 8620-00-73 with the following:*

We Energies (Gas)

We Energies has underground 8" ST gas main facilities from STA 101+00 to STA 114+00, 8' – 10' LT and STA 114+00 to STA 123+50, 19' – 25' LT.

Coordination is required during placement of the guardrail to ensure proper clearance between the posts and the existing underground utilities. Below are approximate locations of three underground gas crossings:

STA 116+60, LT: Existing underground gas service crossing.

STA 120+87, LT: Existing underground gas service crossing.

STA 121+60, LT: Existing underground gas main crossing

Schedule of Items

Attached, dated April 4, 2022, are the revised Schedule of Items Pages 4, 7, and 8.

Plan Sheets

The following 8 ½ x 11-inch sheets are attached and made part of the plans for this proposal:
Revised: 14, 43, 45, 46, 65, 66, 67, 68, 69, 70 and 71

END OF ADDENDUM



569 LF OF MGS GUARDRAIL 3 K
(DIGGERS LOCATE GAS MAIN, UTILIZE A 16 INCH DEPTH
WHERE 2-FOOT CLEARANCES ARE NOT MET PER SDD
MIDWEST GUARDRAIL SYSTEM (MGS) GUARDRAIL)

MGS GUARDRAIL TERMINAL EAT
SLOPE INTERCEPT
SLOPE INTERCEPT

7" TYP

POST 1
+87.61, 20.00' LT
POST 5
+12.61, 20.00' LT
POST 9
+37.61, 20.00' LT

115+00 116+00 117+00 118+00 119+00 120

CTH 40/CTH F/MAIN STREET

CTH SS/MARTIN ROAD

Addendum No. 01
ID 8190-00-72 &
ID 8620-00-73
Revised Sheet 14
April 4, 2022

GUARDRAIL NOTES:
VERIFY POST LOCATIONS ARE NOT IN CONFLICT WITH
EXISTING UTILITIES. FIELD ADJUSTMENTS CAN BE
MADE #3' WITH ENGINEER IN FIELD APPROVAL.
KEYNOTE:
NO TERMINAL FLARE REQUIRED. LIMIT
GRADING TO TOP OF EXISTING EMBANKMENT.



BEAMGUARD POSTS TO STRADDLE EXISTING GAS
LINE CROSSING. DIGGERS HOTLINE TO LOCATE
DIGGERS LOCATES GAS MAIN, UTILIZE A 16 INCH OR 36 INCH
BLOCKOUT DEPTH WHERE 2-FOOT CLEARANCES ARE NOT MET
PER SDD MIDWEST GUARDRAIL SYSTEM (MGS) GUARDRAIL

84 LF OF MGS GUARDRAIL 3 L
MGS GUARDRAIL TERMINAL EAT
SLOPE INTERCEPT

POST 1
+39.6, 25.12' LT
POST 5
+14.6, 22.73' LT
POST 8
+106.30, 20.00'
POST 9
+89.6, 20.00' LT

EX BOX
CULVERT
24'

121+00 122+00 123+00 124+00 125+00

STH 40/CTH F/MAIN STREET

SAWCUT RECD AT FACE OF RAIL AND DRIVEWAY CUTOUT

Addendum No. 01
ID 8620-00-73
Revised Sheet 43
April 4, 2022

3

CULVERT PIPE ITEMS											
STATION	LOCATION	APRON ENDWALLS REMOVE	520.4115 CULVERT PIPE CLASS IV	520.8700 CLEANING CULVERT PIPES	521.1015 APRON ENDWALLS FOR CULVERT PIPE	522.2619 APRON ENDWALL FOR CULVERT PIPE REINFORCED CONCRETE ELLIPTICAL	633.5200 CULVERT MARKERS	ENDWALL REPLACEMENT	ENDWALL REPLACEMENT	ENDWALL REPLACEMENT	COMMENTS
CATEGORY CODE 0010	LF	EACH	15-INCH	EACH	15-INCH	19X30-INCH	EACH	EACH	EACH	EACH	
190+04	LT & RT	1	--	1	--	1	2	2	2	2	ENDWALL REPLACEMENT
190+12	LT & RT	--	--	1	--	--	--	2	2	2	ENDWALL REPLACEMENT
194+49	LT & RT	2	--	1	--	2	2	2	2	2	ENDWALL REPLACEMENT
194+57	LT & RT	--	--	1	--	--	--	2	2	2	ENDWALL REPLACEMENT
243+44	LT & RT	--	--	1	--	--	--	2	2	2	ENDWALL REPLACEMENT
243+50	LT & RT	--	--	1	--	--	--	2	2	2	ENDWALL REPLACEMENT
261+04	LT & RT	--	68	--	2	--	--	2	2	2	CULVERT REPLACEMENT
TOTALS		3	68	6	2	3				14	

WATER

624.0100	WATER	MGAL
STATION - STATION		
CATEGORY CODE 0010		
PROJECT		125
TOTALS		125

* CONCRETE PIPE MUST BE TIED ACROSS THE ENTIRE LENGTH

BEAMGUARD ITEMS

STATION - STATION	LOCATION	614.0010 BARRIER SYSTEM GRADING SHAPING FINISHING	614.2330 MGS GUARDRAIL 3 K	614.2340 MGS GUARDRAIL 3 L	614.2610 MGS GUARDRAIL TERMINAL EAT	COMMENTS
CATEGORY CODE 0010	LF	EACH	LF	LF	EACH	
115+88 - 123+20	LT	1	569	84	2	DRAINAGE WAY
TOTAL		1	569	84	2	

CONCRETE SAFETY ISLANDS

STATION - STATION	LOCATION	602.2400 CONCRETE SAFETY ISLANDS	COMMENTS
CATEGORY CODE 0030	LF	SF	
116+35	RT	151	
126+10	RT	177	
TOTALS		328	

APPROXIMATE QUANTITIES FOR BARRIER SYSTEM GRADING SHAPING FINISHING, FOR INFORMATION PURPOSES ONLY

COMMON EXCAVATION	FILL (1.25)	TOPSOIL (SY)	FERTILIZER TYPE B (GWT)	SEEDING NO 60 (LBS)	SEEDING TEMPORARY (LBS)	SEED WATER (MGAL)	SLOPE STAKING (LF)
0.0	60.0	439.0	0.3	5.9	5.9	11.0	815.0

RIPRAP AND GEOTEXTILE FABRIC ITEMS

STATION - STATION	LOCATION	606.0300 RIPRAP HEAVY	645.0120 GEOTEXTILE FABRIC
CATEGORY CODE 0010	LF	CY	TYPE HR SY
261+04	LT	5	15
TOTALS		5	15

CURB AND GUTTER ITEMS

STATION - STATION	LOCATION	601.0407 CONCRETE CURB AND GUTTER 18-INCH TYPE D	601.0411 CONCRETE CURB AND GUTTER 30-INCH TYPE D	COMMENTS
CATEGORY CODE 0010	LF	LF	LF	
113+00	LT/RT	--	65	CURB RAMP REPLACEMENTS
116+35	RT	57	--	ISLAND REPLACEMENTS
126+10	RT	64	--	ISLAND REPLACEMENTS
TOTAL		121	65	

CONCRETE SIDEWALK ITEMS

STATION - STATION	LOCATION	602.0415 CONCRETE SIDEWALK 6-INCH	602.0505 CURB RAMP FIELD YELLOW	602.0610 CURB RAMP DETECTABLE WARNING FIELD RADIAL YELLOW	COMMENTS
CATEGORY CODE 0030	LF	SF	SF	SF	
113+00	LT & RT	646	30	12	CURB RAMP REPLACEMENT
TOTALS		646	30	12	

MISC. SHEET 3

PROJECT NO: 8620-00-73

HWY: STH 40

COUNTY: CHIPPEWA

MISCELLANEOUS QUANTITIES

SHEET: 43

FILE NAME: 030201_JTM.dwg

PLOT DATE:

PLOT BY: gaddk

PLOT NAME:

E

3

LOCATION	OFFSET	LF	LF	LF	LF	LF	LF	LF	M	LF	LF	LF
646.1040	MARKING LINE	WHITE	1,150	2,900	1,150	2,900	2,900	2,900	3.22	185	26,000	13,000
646.1020	MARKING LINE	YELLOW	1,150	2,900	1,150	2,900	2,900	2,900	3.22	185	26,000	13,000
646.3020	MARKING LINE	WHITE	1,150	2,900	1,150	2,900	2,900	2,900	3.22	185	26,000	13,000
646.4520	MARKING LINE	WHITE	1,150	2,900	1,150	2,900	2,900	2,900	3.22	185	26,000	13,000
646.5020	MARKING LINE	WHITE	1,150	2,900	1,150	2,900	2,900	2,900	3.22	185	26,000	13,000
646.5120	MARKING LINE	WHITE	1,150	2,900	1,150	2,900	2,900	2,900	3.22	185	26,000	13,000
646.5320	MARKING LINE	WHITE	1,150	2,900	1,150	2,900	2,900	2,900	3.22	185	26,000	13,000
646.6120	MARKING LINE	WHITE	1,150	2,900	1,150	2,900	2,900	2,900	3.22	185	26,000	13,000
646.6320	MARKING LINE	WHITE	1,150	2,900	1,150	2,900	2,900	2,900	3.22	185	26,000	13,000
646.7520	MARKING LINE	WHITE	1,150	2,900	1,150	2,900	2,900	2,900	3.22	185	26,000	13,000
646.8320	MARKING LINE	WHITE	1,150	2,900	1,150	2,900	2,900	2,900	3.22	185	26,000	13,000
648.0100	LOCATING ZONES	NO PASSING ZONES	3.22	26,000	3.22	26,000	26,000	26,000				
649.0120	TEMPORARY MARKING LINE	TEMPORARY MARKING LINE	13,000	29,600	13,000	29,600	29,600	29,600				
TOTALS												

LOCATION	OFFSET	LF	LF	LF	LF	LF	LF	LF	M	LF	LF	LF
646.1040	MARKING LINE	WHITE	1,150	2,900	1,150	2,900	2,900	2,900	3.22	185	26,000	13,000
646.1020	MARKING LINE	YELLOW	1,150	2,900	1,150	2,900	2,900	2,900	3.22	185	26,000	13,000
646.3020	MARKING LINE	WHITE	1,150	2,900	1,150	2,900	2,900	2,900	3.22	185	26,000	13,000
646.4520	MARKING LINE	WHITE	1,150	2,900	1,150	2,900	2,900	2,900	3.22	185	26,000	13,000
646.5020	MARKING LINE	WHITE	1,150	2,900	1,150	2,900	2,900	2,900	3.22	185	26,000	13,000
646.5120	MARKING LINE	WHITE	1,150	2,900	1,150	2,900	2,900	2,900	3.22	185	26,000	13,000
646.5320	MARKING LINE	WHITE	1,150	2,900	1,150	2,900	2,900	2,900	3.22	185	26,000	13,000
646.6120	MARKING LINE	WHITE	1,150	2,900	1,150	2,900	2,900	2,900	3.22	185	26,000	13,000
646.6320	MARKING LINE	WHITE	1,150	2,900	1,150	2,900	2,900	2,900	3.22	185	26,000	13,000
646.7520	MARKING LINE	WHITE	1,150	2,900	1,150	2,900	2,900	2,900	3.22	185	26,000	13,000
646.8320	MARKING LINE	WHITE	1,150	2,900	1,150	2,900	2,900	2,900	3.22	185	26,000	13,000
648.0100	LOCATING ZONES	NO PASSING ZONES	3.22	26,000	3.22	26,000	26,000	26,000				
649.0120	TEMPORARY MARKING LINE	TEMPORARY MARKING LINE	13,000	29,600	13,000	29,600	29,600	29,600				
TOTALS												

SAWING ASPHALT

LOCATION	OFFSET	LF	LF	LF	LF	LF	LF	LF	M	LF	LF	LF
690.0150	SAWING ASPHALT	SAWING ASPHALT	17,000	17,000	17,000	17,000	17,000	17,000				
TOTALS												

CONSTRUCTION STAKING ITEMS

LOCATION	OFFSET	LF	LF	LF	LF	LF	LF	LF	M	LF	LF	LF
650.5500	GUTTER	LF	186	186	186	186	186	186				
650.5800	CURB & GUTTER	LF	186	186	186	186	186	186				
650.6000	PIPE CULVERTS	EACH	1	1	1	1	1	1				
650.8000	RESURFACING REFERENCE	LF	17,000	17,000	17,000	17,000	17,000	17,000				
650.9000	CURB RAMPS	EACH	3	3	3	3	3	3				
650.9910	SUPPLEMENTAL CONTROL	LS	1	1	1	1	1	1				
TOTALS												

SAWING CONCRETE

LOCATION	OFFSET	LF	LF	LF	LF	LF	LF	LF	M	LF	LF	LF
690.0250	SAWING CONCRETE	SAWING CONCRETE	30	30	30	30	30	30				
TOTALS												

GRADING SHAPING AND FINISHING DITCH

STATION	LOCATION	LF	LF	LF	LF	LF	LF	LF	M	LF	LF	LF
190+08	LT & RT	100	100	100	100	100	100	100				
194+53	LT & RT	100	100	100	100	100	100	100				
243+47	LT & RT	100	100	100	100	100	100	100				
261+04	LT & RT	100	100	100	100	100	100	100				
UNDISTRIBUTED	LT & RT	100	100	100	100	100	100	100				
TOTALS												

MATERIAL TRANSFER VEHICLE

STATION	LOCATION	LF	LF	LF	LF	LF	LF	LF	M	LF	LF	LF
460.9000.S	MATERIAL TRANSFER VEHICLE	EACH	1	1	1	1	1	1				
TOTALS												

ASPHALT STABILIZING AGENT

STATION	LOCATION	LF	LF	LF	LF	LF	LF	LF	M	LF	LF	LF
455.0770.S	ASPHALT STABILIZING AGENT	TON	190	190	190	190	190	190				
TOTALS												

SAWING ASPHALT

CONSTRUCTION STAKING ITEMS

SAWING CONCRETE

GRADING SHAPING AND FINISHING DITCH

MATERIAL TRANSFER VEHICLE

ASPHALT STABILIZING AGENT

PROJECT NO: 8620-00-73
 COUNTY: CHIPPEWA
 HWY: STH 40
 FILE NAME: 03201_LTM3.PLT
 PLOT DATE: 03/20/2022
 PLOT BY: gbadk
 PLOT NAME: 8620-00-73
 PLOT SCALE: 1:1
 MISCELLANEOUS QUANTITIES
 SHEET: 45
 MISC. SHEET 5
 E

Addendum No. 01
 ID 8620-00-73
 Revised Sheet 45
 April 4, 2022

Addendum No. 01
 ID 8190-00-72 &
 ID 8620-00-73
 Revised Sheet 46
 April 4, 2022

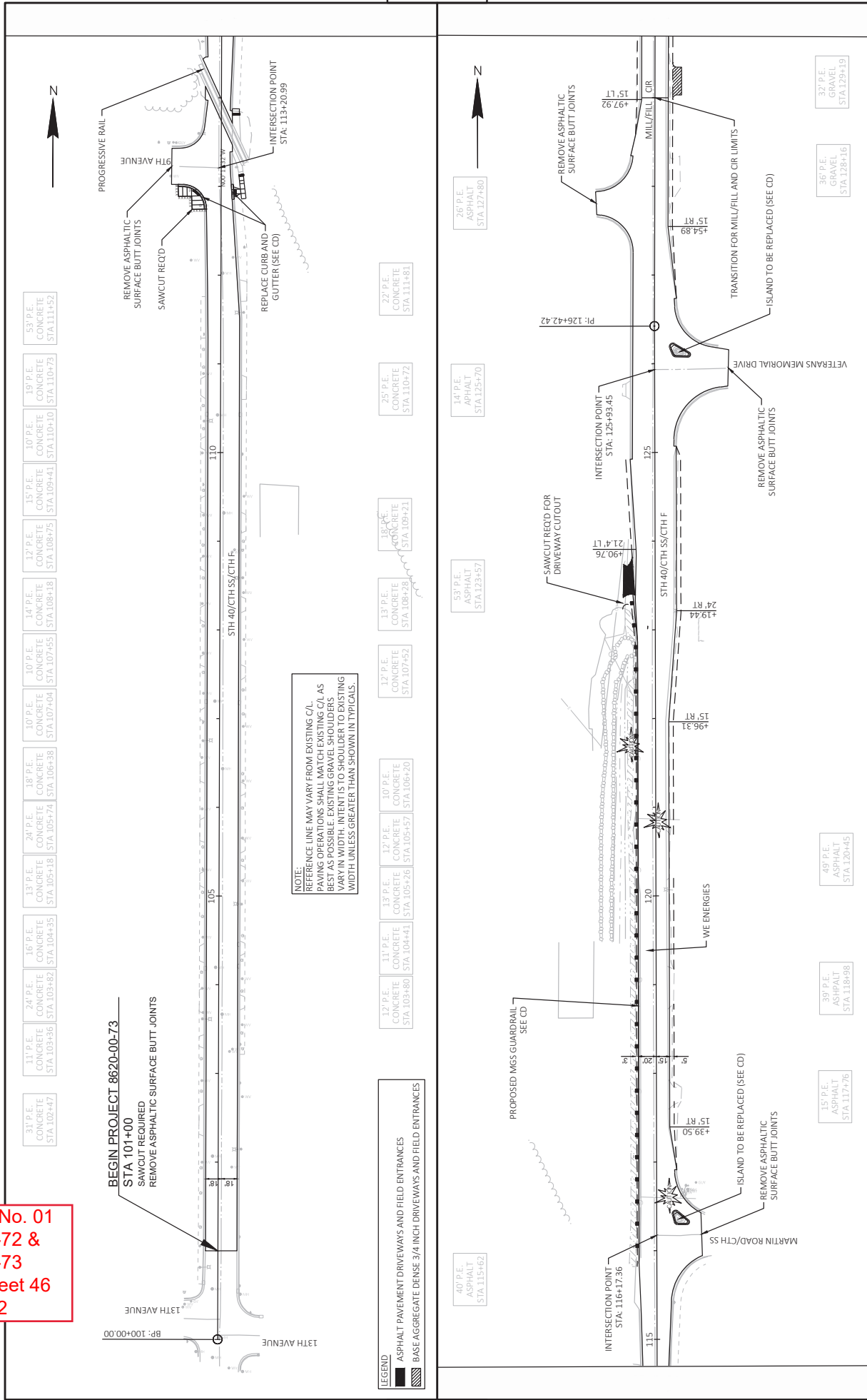

5

5

Addendum No. 01
 ID 8620-00-73
 Revised Sheet 65
 April 4, 2022

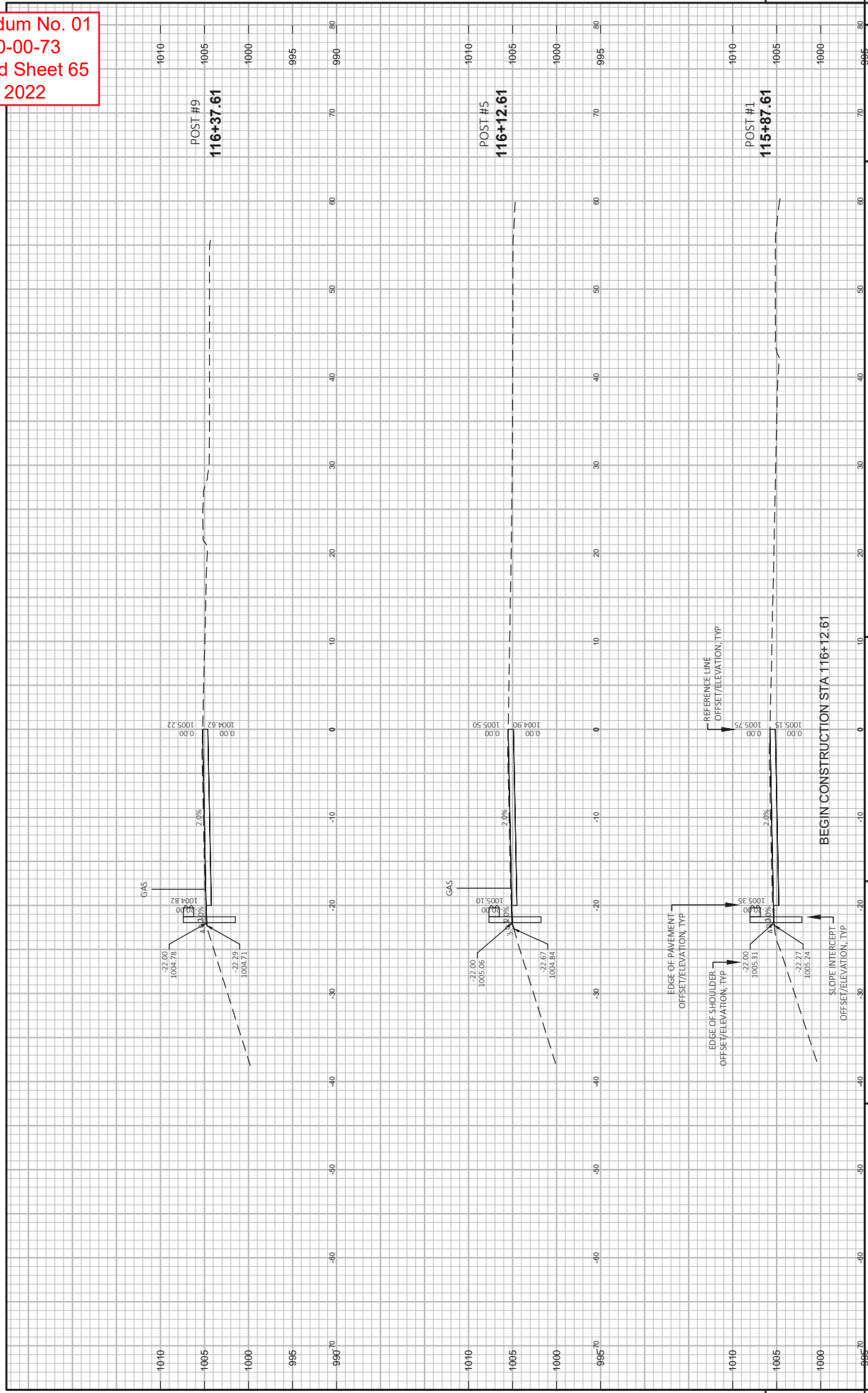

PROJECT NO: 8620-00-73
 COUNTY: CHIPPEWA
 CROSS SECTIONS: DRAINAGE WAY GUARDRAIL
 SHEET 65
 E

FILE NAME: P:\PROJECTS_CHIPPEWA\WISDOT\NR\STH 40\STH 64\RESURFACES-2019\STH 64 (8159-00)\CAO\DESIGN\CORRIDOR\STH64-GUARDRAIL\SECTIONS\UPDATED.DWG PLOT DATE: 4/2/2022 7:46 AM
 PLOT BY: DEETER KAETTERHEIM PLOT NAME: WISDOT\CAO\DESIGN SHEET 65

Addendum No. 01
 ID 8620-00-73
 Revised Sheet 66
 April 4, 2022

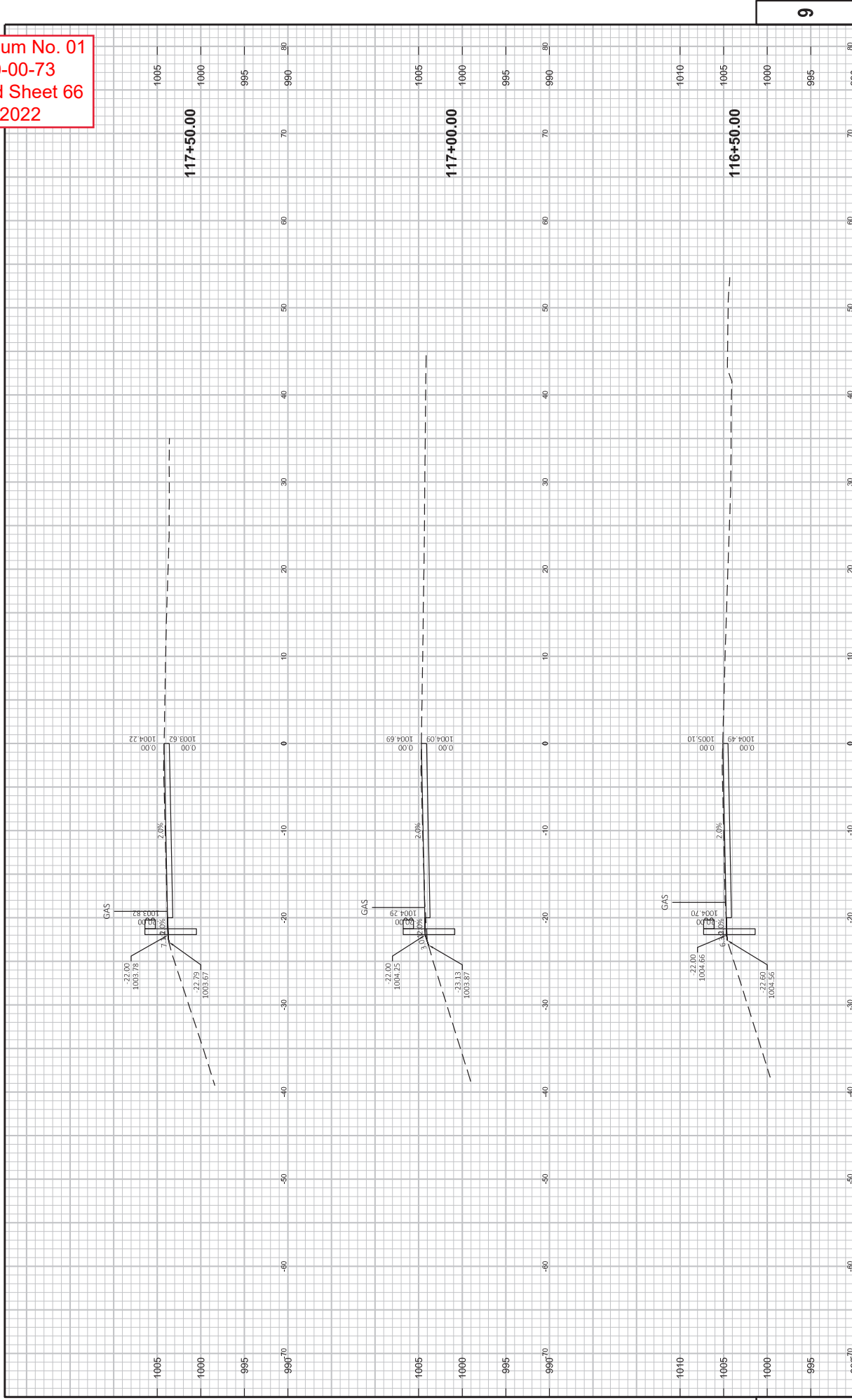

PROJECT NO: 8620-00-73
 COUNTY: CHIPPEWA
 CROSS SECTIONS: DRAINAGE WAY GUARDRAIL
 SHEET: 66
 HWY: STH 40/STH64
 PLOT BY: DEYTER KAETTERHEIMY
 PLOT DATE: 3/28/2022 2:06 PM
 FILE NAME: P:\PROJECTS_CHIPPEWA\WISDOT\NWR\STH 40-STH 64 RESURFACES-2019\STH 64 (8159-00-03)\CAD\DESIGN\CORRIDOR\STH40\STH64-GUARDRAIL\SECTIONS-UPDATED.DWG

9

9

E

E

66

WISDOT\CAD\DESIGN\SHEET 49

Addendum No. 01
 ID 8620-00-73
 Revised Sheet 67
 April 4, 2022

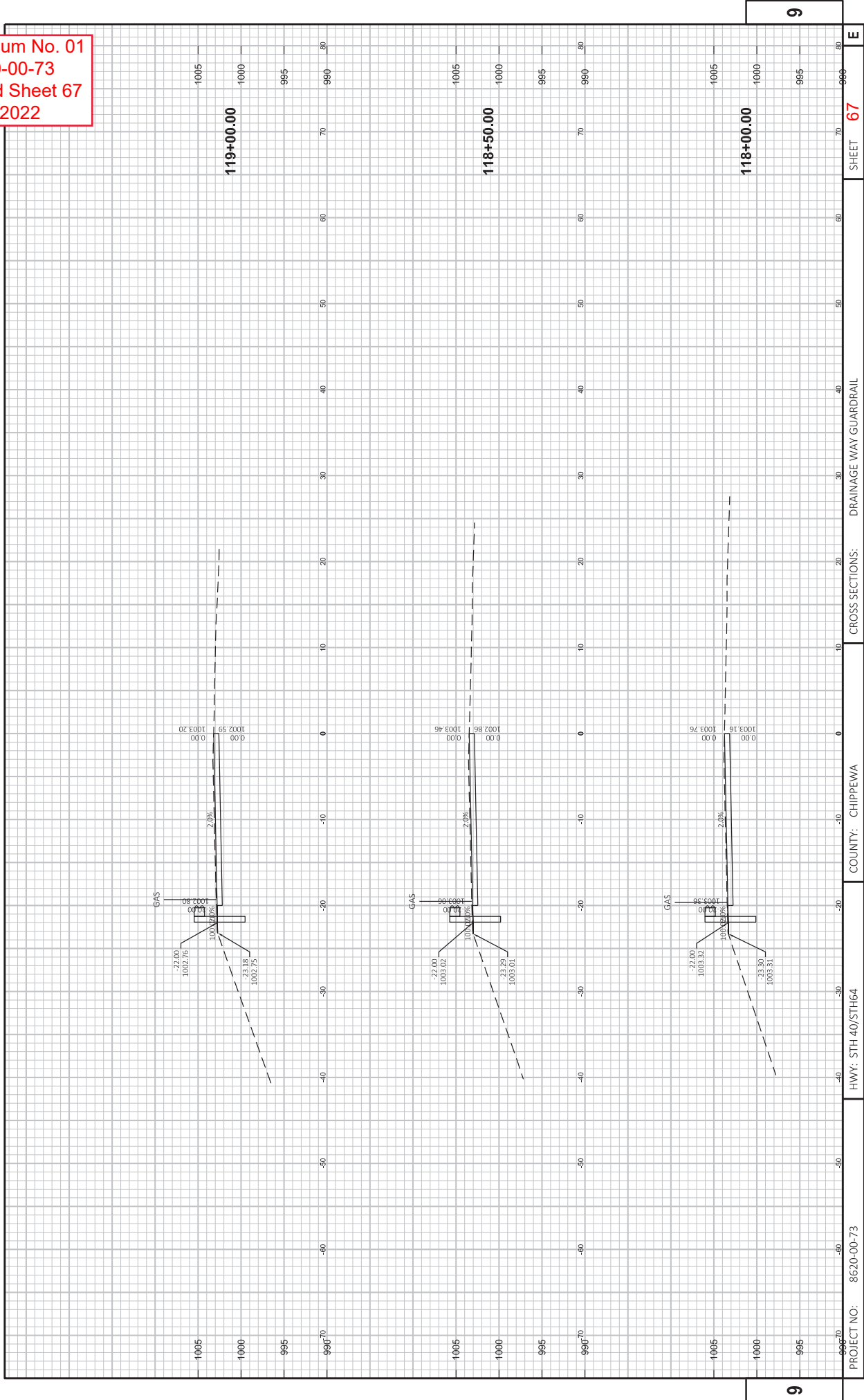

PROJECT NO: 8620-00-73
 COUNTY: CHIPPEWA
 HWY: STH 40/STH 64
 CROSS SECTIONS: DRAINAGE WAY GUARDRAIL
 SHEET 67
 E
 9

FILE NAME: P:\PROJECTS_CHIPPewa\WISDOT\NR\STH 40-STH 64 RESURFACES-2019\STH 64 (8159-00-03)\CAD\DESIGN\CORRIDOR\STH64-GUARDRAIL\SECTIONS\UPDATED.DWG PLOT DATE: 3/29/2022 2:06 PM PLOT BY: DEYTER KAETTERHEIMY

Addendum No. 01
 ID 8620-00-73
 Revised Sheet 68
 April 4, 2022

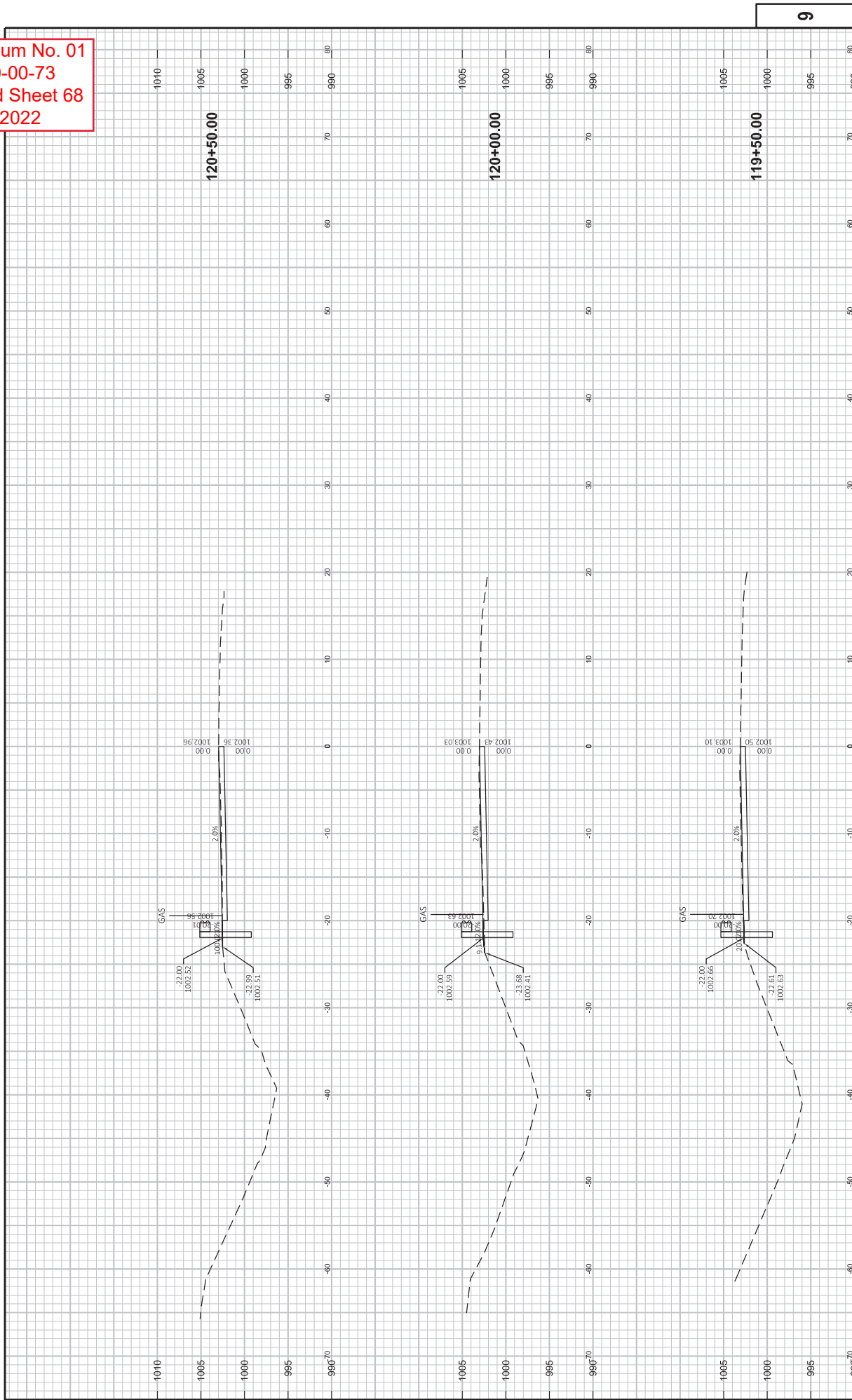

PROJECT NO: 8620-00-73
 COUNTY: CHIPPEWA
 CROSS SECTIONS: DRAINAGE WAY GUARDRAIL
 SHEET 68
 E

FILE NAME: P:\PROJECTS_CURRENT\CHIPPEWA\WISDOT\NR\STH-40\STH-40\RESURFACES-2019\STH 64 (8159-00-00)\CADD\DESIGN\CORRIDOR\STH40\GUARDRAIL\SECTIONS\UPDATED.DWG PLOT DATE: 3/28/2022 2:06 PM PLOT BY: DEITER KAETTERHENRY

9

9

Addendum No. 01
 ID 8620-00-73
 Revised Sheet 71
 April 4, 2022

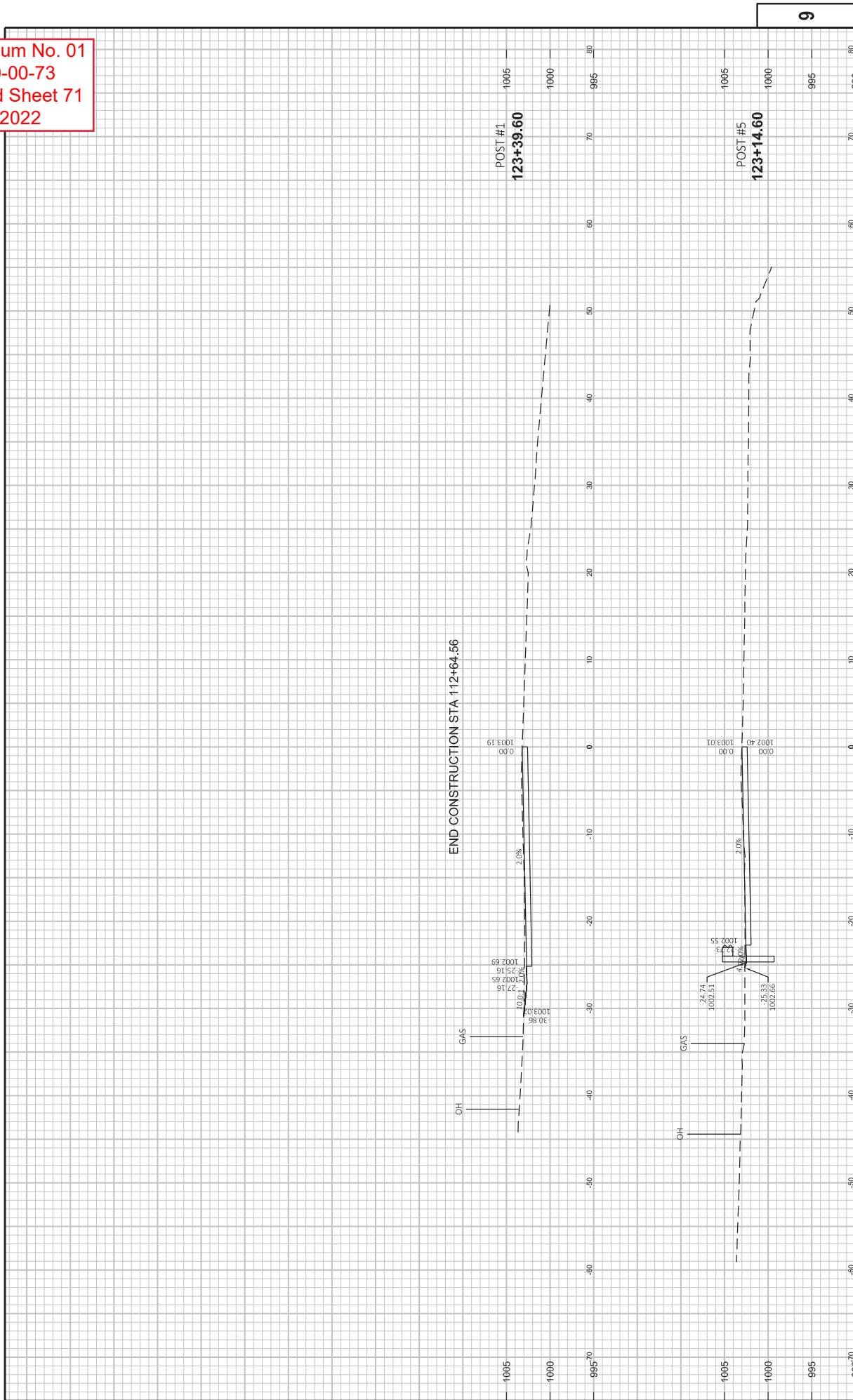



Proposal Schedule of Items

Proposal ID: 20220412035 Project(s): 8190-00-72, 8620-00-73

Federal ID(s): WISC 2022033, WISC 2022036

SECTION: 0001

Contract Items

Alt Set ID:

Alt Mbr ID:

Proposal Line Number	Item ID Description	Approximate Quantity and Units	Unit Price	Bid Amount
0090	601.0411 Concrete Curb & Gutter 30-Inch Type D	179.000 LF	_____.	_____.
0092	601.0557 Concrete Curb & Gutter 6-Inch Sloped 36-Inch Type D	300.000 LF	_____.	_____.
0094	602.0415 Concrete Sidewalk 6-Inch	646.000 SF	_____.	_____.
0096	602.0515 Curb Ramp Detectable Warning Field Natural Patina	30.000 SF	_____.	_____.
0098	602.0615 Curb Ramp Detectable Warning Field Radial Natural Patina	12.000 SF	_____.	_____.
0100	602.2400 Concrete Safety Islands	1,023.000 SF	_____.	_____.
0102	606.0300 Riprap Heavy	106.000 CY	_____.	_____.
0104	611.8110 Adjusting Manhole Covers	8.000 EACH	_____.	_____.
0106	614.0010 Barrier System Grading Shaping Finishing	3.000 EACH	_____.	_____.
0108	614.2300 MGS Guardrail 3	216.000 LF	_____.	_____.
0110	614.2340 MGS Guardrail 3 L	84.000 LF	_____.	_____.
0112	614.2350 MGS Guardrail Short Radius	71.000 LF	_____.	_____.
0114	614.2500 MGS Thrie Beam Transition	320.000 LF	_____.	_____.
0116	614.2610 MGS Guardrail Terminal EAT	9.000 EACH	_____.	_____.
0118	614.2630 MGS Guardrail Short Radius Terminal	1.000 EACH	_____.	_____.
0120	619.1000 Mobilization	1.000 EACH	_____.	_____.



Proposal Schedule of Items

Proposal ID: 20220412035 Project(s): 8190-00-72, 8620-00-73

Federal ID(s): WISC 2022033, WISC 2022036

SECTION: 0001

Contract Items

Alt Set ID:

Alt Mbr ID:

Proposal Line Number	Item ID Description	Approximate Quantity and Units	Unit Price	Bid Amount
0188	646.5120 Marking Word Epoxy	4.000 EACH	_____.	_____.
0190	646.5320 Marking Railroad Crossings Epoxy	2.000 EACH	_____.	_____.
0192	646.6120 Marking Stop Line Epoxy 18-Inch	305.000 LF	_____.	_____.
0194	646.7520 Marking Crosswalk Epoxy Block Style 24-Inch	34.000 LF	_____.	_____.
0196	646.8320 Marking Parking Stall Epoxy	185.000 LF	_____.	_____.
0198	648.0100 Locating No-Passing Zones	10.210 MI	_____.	_____.
0200	649.0105 Temporary Marking Line Paint 4-Inch	70,000.000 LF	_____.	_____.
0202	649.0120 Temporary Marking Line Epoxy 4-Inch	35,000.000 LF	_____.	_____.
0204	650.5500 Construction Staking Curb Gutter and Curb & Gutter	510.000 LF	_____.	_____.
0206	650.6000 Construction Staking Pipe Culverts	5.000 EACH	_____.	_____.
0208	650.8000 Construction Staking Resurfacing Reference	39,300.000 LF	_____.	_____.
0210	650.9000 Construction Staking Curb Ramps	3.000 EACH	_____.	_____.
0212	650.9910 Construction Staking Supplemental Control (project) 01. 8190-00-72	LS	LUMP SUM	_____.
0214	650.9910 Construction Staking Supplemental Control (project) 02. 8620-00-73	LS	LUMP SUM	_____.
0216	690.0150 Sawing Asphalt	2,529.000 LF	_____.	_____.



Proposal Schedule of Items

Proposal ID: 20220412035 Project(s): 8190-00-72, 8620-00-73

Federal ID(s): WISC 2022033, WISC 2022036

SECTION: 0001

Contract Items

Alt Set ID:

Alt Mbr ID:

Proposal Line Number	Item ID Description	Approximate Quantity and Units	Unit Price	Bid Amount
0218	690.0250 Sawing Concrete	30.000 LF	_____	_____
0220	740.0440 Incentive IRI Ride	27,000.000 DOL	1.00000	27,000.00
0222	ASP.1T0A On-the-Job Training Apprentice at \$5.00/HR	100.000 HRS	5.00000	500.00
0224	ASP.1T0G On-the-Job Training Graduate at \$5.00/HR	650.000 HRS	5.00000	3,250.00
0226	SPV.0090 Special 01. Grading Shaping and Finishing Ditch	1,500.000 LF	_____	_____
0228	SPV.0180 Special 01. Prepare Topsoil for Lawn Type Turf	85.000 SY	_____	_____
0230	614.2330 MGS Guardrail 3 K	569.000 LF	_____	_____
Section: 0001			Total:	_____
			Total Bid:	_____