



# Wisconsin Department of Transportation

## Division of Transportation Systems Development

Bureau of Project Development  
4822 Madison Yards Way, 4<sup>th</sup> Floor South  
Madison, WI 53705

Telephone: (608) 266-1631  
Facsimile (FAX): (608) 266-8459

March 30, 2022

### NOTICE TO ALL CONTRACTORS:

**Proposal #38: 1166-04-82, WISC 2022091**  
**Portage - Coloma**  
**Columbia Co Ln to Waushara Co Ln, NB**  
**IH 39**  
**Marquette County**

### Letting of April 12, 2022

This is Addendum No. 01, which provides for the following:

#### Special Provisions:

| Revised Special Provisions |                          |
|----------------------------|--------------------------|
| Article No.                | Description              |
| 3                          | Prosecution and Progress |

#### Plan Sheets:

| Revised Plan Sheets |   |
|---------------------|---|
| Plan Sheet          | Plan Sheet Title (brief description of changes to sheet)  |
| 36                  | Traffic Control Stage 1 Typical Sections – Mill and Overlay; modified to correctly indicate outside lane and outside shoulder milling and paving as well as showing the existing centerline and concrete edges appropriately. |
| 37                  | Traffic Control Stage 1 Typical Sections – Mill and Overlay; modified to correctly indicate the existing centerline and concrete edges appropriately.   |

The responsibility for notifying potential subcontractors and suppliers of these changes remains with the prime contractor.

Sincerely,

*Mike Coleman*

Proposal Development Specialist  
Proposal Management Section

**ADDENDUM NO. 01**

**1166-04-82**

**March 30, 2022**

**Special Provisions**

**3. Prosecution and Progress.**

*Replace paragraph two under section titled **Winter Suspension** with the following:*

Prior to the winter suspension stage, all areas of Stage 1 where construction has started and all areas of Stage 2 (both described under "Construction Staging" below) shall be completed through the upper layer of asphaltic pavement, guardrail, permanent pavement marking, landscaping, and rumble strip construction.

**Plan Sheets**

The following 8½ x 11-inch sheets are attached and made part of the plans for this proposal:  
Revised: 36 and 37.

END OF ADDENDUM

WORK:  
MILL EXISTING ASPHALTIC SURFACE, CENTERLINE CONCRETE REPAIRS, DOWEL BAR SLOT REPAIRS AND  
INSTALL LOWER LIFT OF HMA PAVEMENT  
INSIDE LANE AND SHOULDER

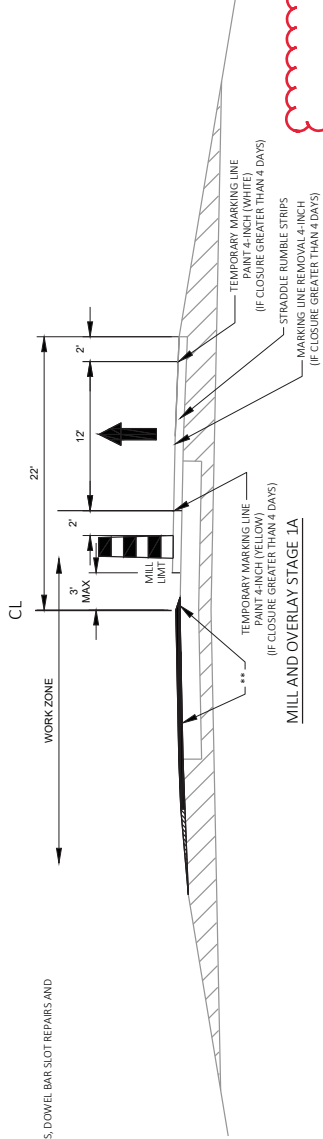

WORK:  
MILL EXISTING ASPHALTIC SURFACE, CENTERLINE CONCRETE REPAIRS, DOWEL BAR SLOT REPAIRS AND  
INSTALL LOWER LIFT OF HMA PAVEMENT OUTSIDE LANE  
MILL EXISTING ASPHALTIC SURFACE 1" OUTSIDE SHOULDER

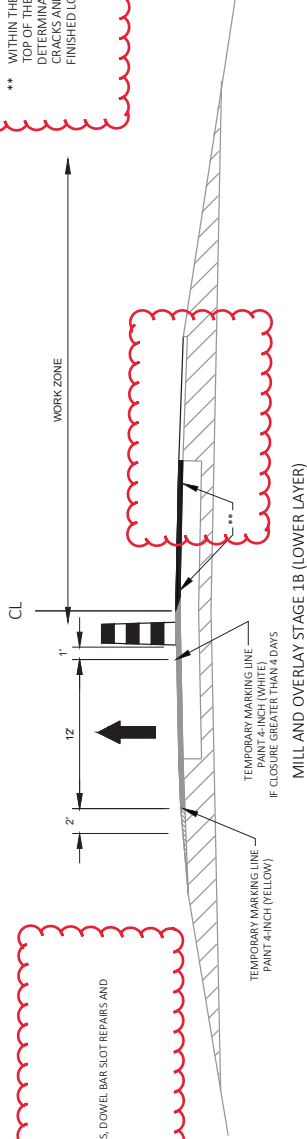

\*\* WITHIN THE DRIVING LANES, ALL MILLING SHALL EXPOSE THE TOP OF THE EXISTING CONCRETE SURFACE TO ALLOW FIELD DETERMINATIONS AND REPAIRS OF CENTERLINE JOINT AND CRACKS AND DOWEL BAR SLOTS PRIOR TO PAVING THE FINISHED LOWER LAYER.

Addendum No. 01  
ID 1166-04-82  
Revised Sheet 36  
March 30, 2022

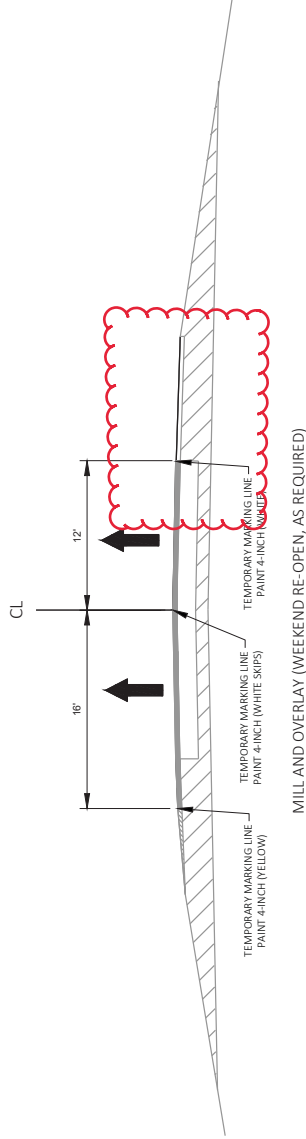

STA 2049+30 - STA 2062+30  
STA 0+00 - STA 310+00  
STA 445+00 - STA 759+92  
STA 769+04 - STA 839+12  
STA 848+22 - STA 1258+35

|   |                         |   |            |                       |
|---|-------------------------|---|------------|-----------------------|
| PROJECT NO: 1166-04-82  | COUNTY: MARQUETTE       | TRAFFIC CONTROL STAGE 1 TYPICAL SECTIONS - MILL AND OVERLAY | SHEET 36   | E                     |
| FILE NAME: S:\DESIGN\DESIGN PROJECTS\1166-04-12 (I-39)_MARQUETTE COUNTY - 0MMN\G3\DSHEETS\PLAN\RELEV\11660482-026105-TC-ST-TS-OVERLAY.DWG | HWY: IH 39 NB           | ADAM OSTYPOWSKI   | 1 IN:30 FT | WISDOT/CADDS SHEET 42 |
| LAYOUT NAME: -05  | DATE: 3/30/2022 9:16 AM |   |            |                       |

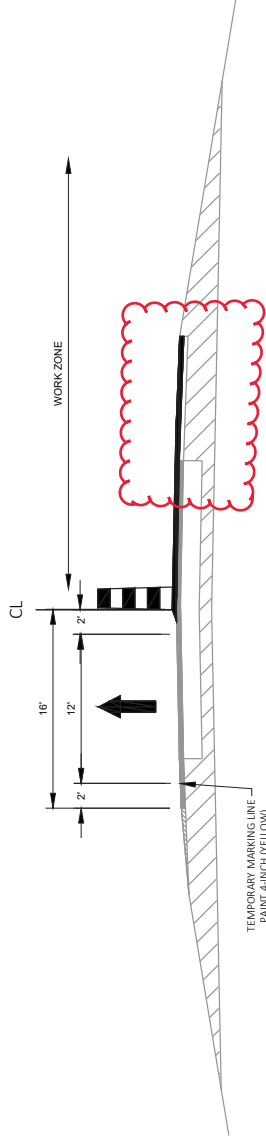

WORK:  
INSTALL UPPER LIFT OF HMA PAVEMENT  
OUTSIDE LANE AND SHOULDER

MILL AND OVERLAY STAGE 1C (UPPER LAYER)

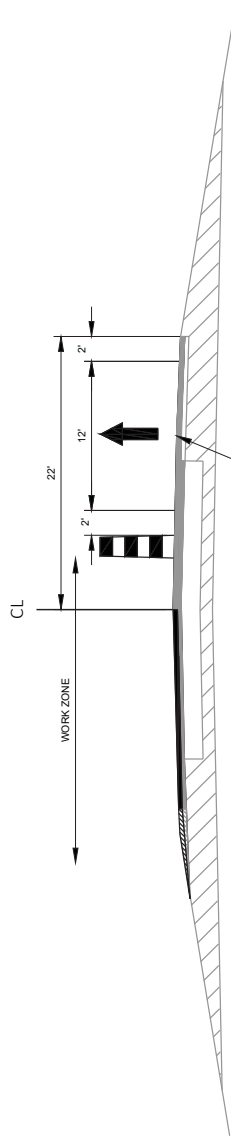

WORK:  
INSTALL UPPER LIFT OF HMA PAVEMENT  
INSIDE LANE AND SHOULDER

TEMPORARY MARKING LINE -  
PAINT 4-INCH (WHITE)  
NOTE: RETURN TRAFFIC CONTROL DRUMS TO OTHER SIDE OF CENTERLINE AT END OF WORK DAY

MILL AND OVERLAY STAGE 1D

Addendum No. 01  
ID 1166-04-82  
Revised Sheet 37  
March 30, 2022

STA 2049+30 - STA 2062+30  
STA 0+00 - STA 310+00  
STA 445+00 - STA 759+92  
STA 769+04 - STA 839+12  
STA 848+22 - STA 1258+35

|   |                   |   |            |                        |
|---|-------------------|---|------------|------------------------|
| PROJECT NO: 1166-04-82  | COUNTY: MARQUETTE | TRAFFIC CONTROL STAGE 1 TYPICAL SECTIONS - MILL AND OVERLAY | SHEET 37   | E                      |
| FILE NAME: S:\DESIGN\DESIGN PROJECTS\1166-04-12 (I-39)_MARQUETTE COUNTY - OMNI\GIS\3DSHEETS\PLAN\REL\11660482-026105-TC-ST-15-OVERLAY.DWG | HWY: IH 39 NB     | ADAM OSTROWSKI  | 1 IN=10 FT | WISDOT/CAD/05 SHEET 42 |
| LAYOUT NAME: -026305 (2)  | 3/30/2022 9:16 AM | ADAM OSTROWSKI  | 1 IN=10 FT |                        |