



# Wisconsin Department of Transportation

## Division of Transportation Systems Development

Bureau of Project Development  
4822 Madison Yards Way, 4<sup>th</sup> Floor South  
Madison, WI 53705

July 28, 2022

Telephone: (608) 266-1631  
Facsimile (FAX): (608) 266-8459

### NOTICE TO ALL CONTRACTORS:

**Proposal #12: 1150-76-71, WISC 2022489  
Green Bay - Oconto  
Little Suamico River Bridge  
USH 41  
Oconto County**

### Letting of August 9, 2022

This is Addendum No. 01, which provides for the following:

#### Schedule of Items:

Revised Bid Item Quantities					
Bid Item	Item Description	Unit	Old Quantity	Revised Quantity	Proposal Total
509.0905	Bar Couplers No. 5	EA	1061	-520	541
614.2300	MGS Guardrail 3	LF	79	121	200
614.2500	MGS Thrie Beam Transition	LF	200	-121	79

#### Plan Sheets:

Revised Plan Sheets	
Plan Sheet	Plan Sheet Title (brief description of changes to sheet)
38	Miscellaneous Quantities (revised quantity for guardrail items)
103	Structure B-42-19 (revised quantity for Bar Couplers No. 5)

**Schedule of Items**

Attached, dated July 28, 2022, are the revised Schedule of Items Pages 2 and 4.

**Plan Sheets**

The following 8½ x 11-inch sheets are attached and made part of the plans for this proposal:  
Revised: 38 and 103.

The responsibility for notifying potential subcontractors and suppliers of these changes remains with the prime contractor.

Sincerely,

*Mike Coleman*

Proposal Development Specialist  
Proposal Management Section

END OF ADDENDUM

Addendum No. 01  
 ID 1150-76-71  
 Revised Sheet 38  
 July 28, 2022

3

3

SURFACE DRAINS AND RIPRAPE

CATEGORY	STATION	LOCATION	CONCRETE CY	RIPRAPE MEDIUM CY	GEOTEXTILE TYPE HR	SY	REMARKS
<b>STAGE 2</b> 0010	405+94	USH 41, SB, RT	1	2	5	5	SURFACE DRAIN PERPENDICULAR, 6-FT MAX LENGTH
		STAGE 2 SUBTOTALS	1	2	5	5	
<b>STAGE 3</b> 0010	406+16	USH 41, SB, LT	1	2	5	5	SURFACE DRAIN PERPENDICULAR, 6-FT MAX LENGTH
		STAGE 2 SUBTOTALS	1	2	5	5	
		TOTAL 0010	2	4	10	10	

CONCRETE CURB & GUTTER

CATEGORY	STATION	TO	STATION	LOCATION	CONCRETE CURB & GUTTER 4- INCH SLOPED 36- INCH TYPE TBT	LF
<b>STAGE 2</b> 0010	405+50	-	406+16	USH 41, SB, RT	44	22
				STAGE 2 SUBTOTALS	44	22
<b>STAGE 3</b> 0010	405+72	-	406+38	USH 41, SB, LT	66	0
				STAGE 3 SUBTOTALS	66	0
				TOTAL 0010	110	22

GUARDRAIL

CATEGORY	STATION	TO	STATION	LOCATION	REMOVING GUARDRAIL	LF	MGS GUARDRAIL 3	LF	MGS THRIE BEAM TRANSITION	LF	SPV 0090 01 SALVAGE AND REINSTALL GUARDRAIL	LF
<b>STAGE 2</b> 0010	403+75	-	407+00	USH 41, SB, RT	-	-	-	-	-	-	12	
	405+46	-	407+00	USH 41, SB, RT	152	112.5	39.5	39.5				
				USH 41, SB, RT	-	-	-	-	-	-	12	
				STAGE 2 SUBTOTALS	152	112.5	39.5	39.5			24	
<b>STAGE 3</b> 0010	405+68	-	406+97	USH 41, SB, LT	127	87.5	39.5	39.5				
				USH 41, SB, LT	127	87.5	39.5	39.5			0	
				STAGE 3 SUBTOTALS	127	87.5	39.5	39.5			0	
				TOTAL 0010	279	200	79	79			24	

PROJECT NUMBER: 1150-76-71

HWY: USH 41

COUNTY: OCONTO

MISCELLANEOUS QUANTITIES

SHEET NO: 38

E

**TOTAL ESTIMATED QUANTITIES**

BID ITEM NUMBER	BID ITEMS	UNIT	S. ABUT.	N. ABUT.	SUPER.	TOTAL
201.0270	REMOVING STRUCTURE OVER WATERWAY DEBRIS CAPTURE B-42-19	EACH	-----	-----	-----	1
201.0600	EXCAVATION FOR STRUCTURES BRIDGES B-42-19	CY	-----	-----	-----	1
503.0100	CONCRETE MASONRY BRIDGES	CY	7.4	5.7	234.8	250
503.3101	EXPANSION DEVICE	LF	-----	-----	95	95
503.3200	PROTECTIVE SURFACE TREATMENT	SY	-----	-----	670	670
503.3210	PIGMENTED SURFACE SEALER	SY	-----	-----	170	170
503.4106	ADHESIVE ANCHORS 3/4" INCH	EACH	-----	-----	5	5
503.0600	BAR STEEL REINFORCEMENT HS COATED STRUCTURES	LB	217	217	52,100	55,550
503.0904	BAR COUPLERS NO. 4	EACH	5	5	-----	10
503.0905	BAR COUPLERS NO. 5	EACH	-----	-----	1,061	1,061
503.1500	CONCRETE SURFACE REPAIR	SF	-----	-----	-----	100
516.0500	RUBBERIZED MEMBRANE WATERPROOFING	SY	11	11	-----	22
51.0901.S	PREPARATION AND COATING OF TOP FLANGES B-42-19	EACH	-----	-----	-----	1
51.3001.S	STRUCTURE OVERCOATING AND PRIMING B-42-19	EACH	-----	-----	-----	1
51.4001.S	CONTAINMENT AND COLLECTION OF WASTE MATERIALS B-42-19	EACH	-----	-----	-----	1
51.6001.S	PORTABLE DECONTAMINATION FACILITY	EACH	-----	-----	-----	1
606.0300	RIPRAP HEAVY	CY	15	15	-----	30
614.0150	ANCHOR ASSEMBLIES FOR STEEL PLATE BEAM GUARD	EACH	2	2	-----	4
645.0120	GEOTEXTILE TYPE HR	SY	30	30	-----	60
SPV,0060.01	CLEANING AND PAINTING BEARINGS	EACH	-----	-----	-----	10
SPV,0060.02	TEMPORARY SUPPORT B-42-19	EACH	-----	-----	-----	1
	NON-BID ITEMS					
	FILLER					

\*\* UNDISTRIBUTED AS DIRECTED BY THE ENGINEER FOR REPAIRS AT ABUTMENTS AND PIERS

**GENERAL NOTES**

- DRAWINGS SHALL NOT BE SCALED.
- DIMENSIONS ARE BASED ON ORIGINAL STRUCTURE PLANS.
- BAR STEEL SHALL BE EMBEDDED 2 INCHES CLEAR UNLESS SHOWN OR NOTED OTHERWISE.
- THE FIRST DIGIT OF A THREE DIGIT BAR NO. AND THE FIRST TWO DIGITS OF A FOUR DIGIT BAR NO. SHALL BE THE SAME UNLESS CONCRETE REMOVAL SHALL BE DEFINED BY A "D" DEEP SAW CUT UNLESS SHOWN OR NOTED OTHERWISE.
- AT ABUTMENTS ALL SPACES EXCAVATED AND NOT OCCUPIED BY THE NEW STRUCTURE SHALL BE BACKFILLED. MINIMAL BACKFILL WILL BE REQUIRED AND INCLUDED IN THE ROADWAY QUANTITIES.
- THE FIELD ENGINEER TO THE STRUCTURES DESIGN SECTION FOR REVIEW.
- VARIATIONS TO THE NEW GRADE LINE OVER 1/4" MUST BE SUBMITTED BY THE FIELD ENGINEER TO THE STRUCTURES DESIGN SECTION FOR REVIEW.
- WITH SECTION 502.311 OF THE STANDARD SPECIFICATIONS AND THE STANDARD DETAIL DRAWINGS, NAME PLATE TO SHOW THE ORIGINAL CONSTRUCTION YEAR OF 1973.
- UTILIZE EXISTING BAR STEEL REINFORCEMENT WHERE SHOWN AND EXTEND 24 BAR DIAMETERS INTO NEW WORK, UNLESS SPECIFIED OTHERWISE.
- THE EXISTING GROUNDLINE SHALL BE THE UPPER LIMIT FOR EXCAVATION FOR STRUCTURES.
- JOINT FILLER SHALL CONFORM TO THE REQUIREMENTS OF A.A.S.H.T.O. DESIGNATION M 153, TYPE 1, 11 OR 111 OR A.A.S.H.T.O. DESIGNATION M 213.
- THE MINIMUM CONCRETE HAUNCH SHALL BE 2" FOR DESIGN CALCULATIONS AND THE HAUNCH CONCRETE QUANTITY IS BASED ON THE MINIMUM CONCRETE HAUNCH.
- QUANTITY FOR WHICH THE CONTRACTOR WILL BE PAID, BEVEL EXPOSED EDGES OF CONCRETE 3/4" UNLESS NOTED OTHERWISE.
- PROTECTIVE SURFACE TREATMENT AND PIGMENTED SURFACE SEALER TO BE APPLIED AS SHOWN IN THE DETAILS ON THIS SHEET.
- THE SLOPE OF THE FILL IN FRONT OF THE WINGWALLS SHALL BE 1:1 UNLESS NOTED OTHERWISE.
- CONCRETE SHALL BE CAST TO THE GENERAL PLAN SHEET EXTENT SHOWN ON THE GENERAL PLAN SHEET.
- ALL EXISTING STRUCTURAL STEEL 5-FEET FROM THE ENDS OF THE BRIDGE SHALL BE PAINTED. THE COLOR OF EPOXY SHALL BE 25240 AND THE URETHANE COATING MATERIAL SHALL MATCH THE COLOR NUMBER SHOWN ON THE PLANS CONFORMING TO AMS STANDARD 595A. ESTIMATED STRUCTURAL STEEL SURFACE AREA = 677 SF.
- ALL EXISTING STEEL BRACKET SHALL BE REPAIRED. BRACKETS ARE TO BE SALVAGED. SEE SPECIAL PROVISIONS FOR EXACT DETAILS.

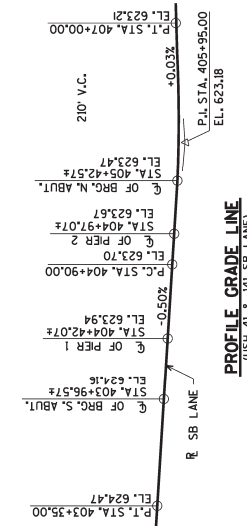

**PROTECTIVE SURFACE TREATMENT AND PIGMENTED SURFACE SEALER DETAIL**

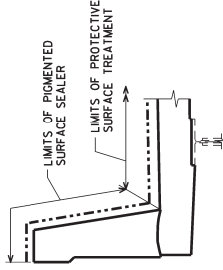

07/27/22

Addendum No. 01  
ID 1150-76-71  
Revised Sheet 103  
July 28, 2022

07/22	QUANTITY REVISION	BY	AYRES
NO.	DATE	REVISION	
STATE OF WISCONSIN DEPARTMENT OF TRANSPORTATION			
<b>STRUCTURE B-42-19</b>			
ISSUED BY	CLP	DATE	CBM
QUANTITIES AND NOTES			SHEET 3 OF 17
			103

ORIGINAL PLANS PREPARED BY  
3433 Oakwood Hills Parkway  
Eau Claire, WI 54601  
www.ayresandassociates.com





## Proposal Schedule of Items

Proposal ID: 20220809012 Project(s): 1150-76-71

Federal ID(s): WISC 2022489

SECTION: 0001

Contract Items

Alt Set ID:

Alt Mbr ID:

Proposal Line Number	Item ID Description	Approximate Quantity and Units	Unit Price	Bid Amount
0032	415.1120 Concrete Pavement HES 12-Inch	80.000 SY	_____.	_____.
0034	415.1410 Concrete Pavement Approach Slab HES	125.000 SY	_____.	_____.
0036	416.1010 Concrete Surface Drains	2.000 CY	_____.	_____.
0038	450.1100.S Asphaltic Mixture For Extreme Conditions	333.000 TON	_____.	_____.
0040	450.4000 HMA Cold Weather Paving	237.000 TON	_____.	_____.
0042	455.0605 Tack Coat	288.000 GAL	_____.	_____.
0044	465.0105 Asphaltic Surface	570.000 TON	_____.	_____.
0046	502.0100 Concrete Masonry Bridges	250.000 CY	_____.	_____.
0048	502.3101 Expansion Device	95.000 LF	_____.	_____.
0050	502.3200 Protective Surface Treatment	670.000 SY	_____.	_____.
0052	502.3210 Pigmented Surface Sealer	170.000 SY	_____.	_____.
0054	502.4106 Adhesive Anchors 3/4-inch	5.000 EACH	_____.	_____.
0056	502.4205 Adhesive Anchors No. 5 Bar	434.000 EACH	_____.	_____.
0058	505.0600 Bar Steel Reinforcement HS Coated Structures	55,550.000 LB	_____.	_____.
0060	505.0904 Bar Couplers No. 4	10.000 EACH	_____.	_____.
0062	505.0905 Bar Couplers No. 5	541.000 EACH	_____.	_____.



## Proposal Schedule of Items

Proposal ID: 20220809012 Project(s): 1150-76-71

Federal ID(s): WISC 2022489

SECTION: 0001

Contract Items

Alt Set ID:

Alt Mbr ID:

Proposal Line Number	Item ID Description	Approximate Quantity and Units	Unit Price	Bid Amount
0092	614.0150 Anchor Assemblies for Steel Plate Beam Guard	4.000 EACH	_____.	_____.
0094	614.0905 Crash Cushions Temporary	2.000 EACH	_____.	_____.
0096	614.2300 MGS Guardrail 3	200.000 LF	_____.	_____.
0098	614.2500 MGS Thrie Beam Transition	79.000 LF	_____.	_____.
0100	618.0100 Maintenance And Repair of Haul Roads (project) 01. 1150-76-71	1.000 EACH	_____.	_____.
0102	619.1000 Mobilization	1.000 EACH	_____.	_____.
0104	624.0100 Water	6.000 MGAL	_____.	_____.
0106	628.1504 Silt Fence	320.000 LF	_____.	_____.
0108	628.1520 Silt Fence Maintenance	320.000 LF	_____.	_____.
0110	628.1905 Mobilizations Erosion Control	4.000 EACH	_____.	_____.
0112	628.1910 Mobilizations Emergency Erosion Control	2.000 EACH	_____.	_____.
0114	628.7015 Inlet Protection Type C	4.000 EACH	_____.	_____.
0116	628.7555 Culvert Pipe Checks	10.000 EACH	_____.	_____.
0118	628.7570 Rock Bags	45.000 EACH	_____.	_____.
0120	634.0614 Posts Wood 4x6-Inch X 14-FT	2.000 EACH	_____.	_____.
0122	634.0622 Posts Wood 4x6-Inch X 22-FT	2.000 EACH	_____.	_____.