



Wisconsin Department of Transportation

Division of Transportation Systems Development

Bureau of Project Development
4822 Madison Yards Way, 4th Floor South
Madison, WI 53705

February 2, 2023

Telephone: (608) 266-1631
Facsimile (FAX): (608) 266-8459

NOTICE TO ALL CONTRACTORS:

Proposal #16: 7831-06-70, WISC 2023245
SCL – USH 12
SCL to Lange Road
CTH M
Eau Claire County

Letting of February 14, 2023

This is Addendum No. 01, which provides for the following:

Special Provisions:

Revised Special Provisions	
Article No.	Description
3	Prosecution and Progress

Schedule of Items:

Deleted Bid Item Quantities					
Bid Item	Item Description	Unit	Proposal Total Prior to Addendum	Proposal Quantity Change (-)	Proposal Total After Addendum
643.3105	Temporary Marking Line Paint 4-Inch	LF	18,770	-18,770	0

Plan Sheets:

Revised Plan Sheets	
Plan Sheet	Plan Sheet Title (brief description of changes to sheet)
35	Traffic Control Overview (remove language requiring temporary pavement marking)
48	Miscellaneous Quantities (remove temporary pavement marking item)

The responsibility for notifying potential subcontractors and suppliers of these changes remains with the prime contractor.

Sincerely,

Mike Coleman

Proposal Development Specialist
Proposal Management Section

ADDENDUM NO. 01

7831-06-70

February 2, 2023

Special Provisions

3. Prosecution and Progress

Remove entire section titled Pavement Marking Operations

Schedule of Items

Attached, dated February 2, 2023, are the revised Schedule of Items Pages 4 and 5.

Plan Sheets

The following 8½ x 11-inch sheets are attached and made part of the plans for this proposal:

Revised: 35, 48

END OF ADDENDUM

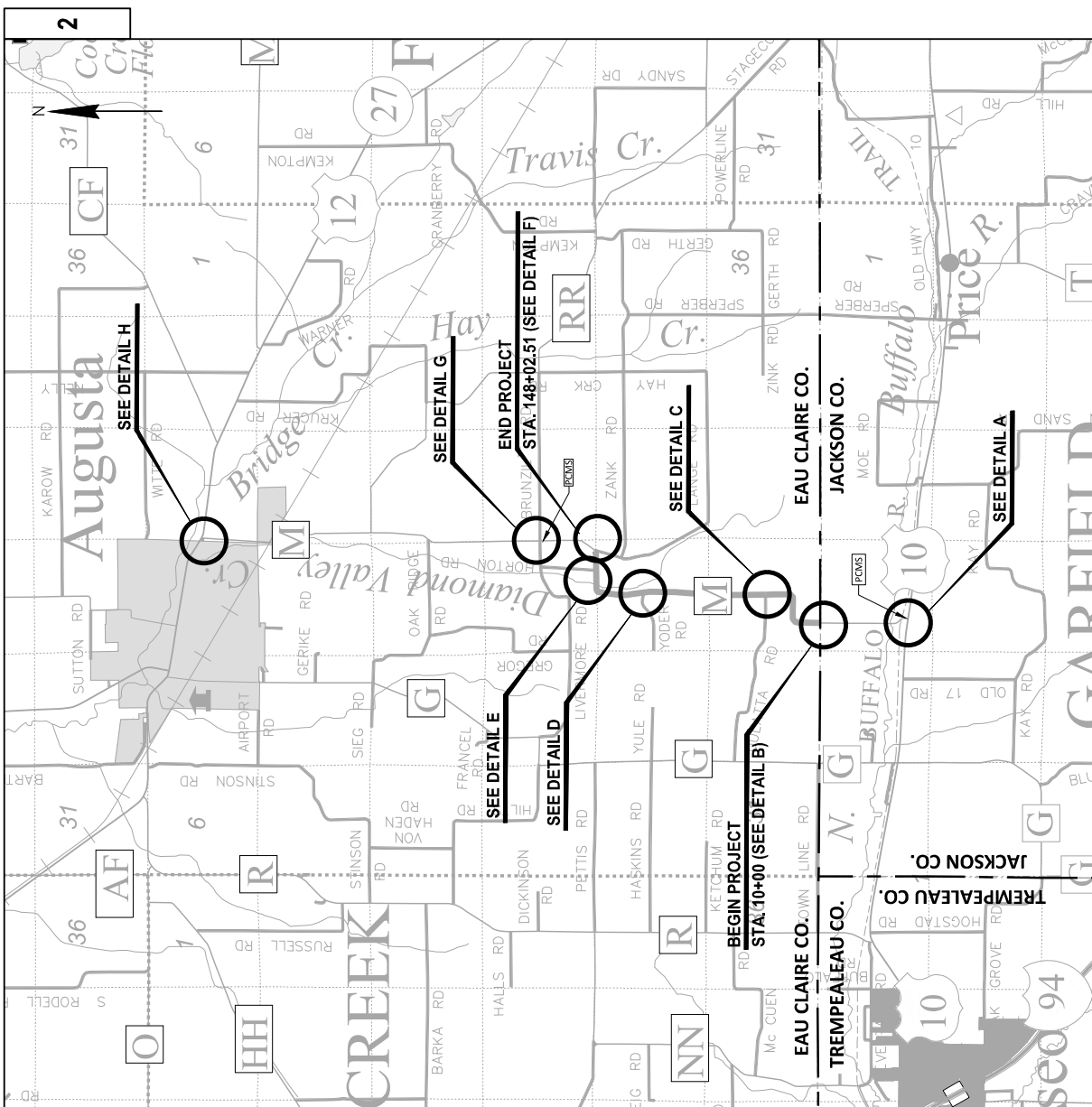

GENERAL NOTES FOR TRAFFIC CONTROL

THE EXACT LOCATION AND SPACING OF ALL SIGNS AND DEVICES SHALL BE ADJUSTED TO FIT FIELD CONDITIONS AS DIRECTED BY THE ENGINEER.

ALL SIGNS INAPPROPRIATE TO THE STATUS OF THE CONTROL ZONE, INCLUDING PRE-EXISTING SIGNING IN THE VICINITY, SHALL BE COVERED OR REMOVED AS DIRECTED BY THE ENGINEER.

"W" AND "WO" SIGNS ARE THE SAME AS "W" AND "WO" SIGNS, EXCEPT THE BACKGROUND IS ORANGE.

ALL "W" AND "WO" SIGNS SHALL BE 48" X 48" UNLESS OTHERWISE NOTED.

ALL ROADS AND STREETS WITHIN THE WORK ZONES SHALL BE KEPT ACCESSIBLE FOR EMERGENCY VEHICLES, RESIDENTS AND BUSINESSES.

ANY STOP SIGNS WHICH ARE REMOVED FOR A CONSTRUCTION OPERATION SHALL BE IMMEDIATELY RE-ESTABLISHED.

ALL SIGN LAYOUT SHALL BE IN ACCORDANCE WITH THE WISCONSIN MANUAL OF UNIFORM TRAFFIC CONTROL DEVICES.

IT SHALL BE THE CONTRACTOR'S RESPONSIBILITY TO PROVIDE AND MAINTAIN ACCESS TO ALL PROPERTY ADJACENT TO THE WORK ZONES. THE CONTRACTOR SHALL PROVIDE AND MAINTAIN ALL NECESSARY BARRICADES, SIGNS, LIGHTS, FLAGGERS, AND SUCH OTHER SAFETY DEVICES AS CALLED FOR ON THE PLANS OR AS DIRECTED BY THE ENGINEER.

ALL SIGNS AND DEVICES SHALL BE ADJUSTED TO FIT FIELD CONDITIONS AND TO PROVIDE A MINIMUM OF 200' CLEARANCE TO EXISTING SIGNS.

DURING NIGHT SHUTDOWN, ONE LANE IN EACH DIRECTION MUST REMAIN OPEN.

DURING HOURS OF DARKNESS, ALL BARRICADES USED TO SHIELD A HAZARD SHALL BE EQUIPPED WITH TYPE "A" (LOW INTENSITY FLASHING) LIGHTS.

DRAWINGS SHOW TRAFFIC CONTROL FOR A TYPICAL SITUATION. ADDITIONAL TRAFFIC CONTROL DEVICES MAY BE REQUIRED AND/OR LAYOUT DETAILS MODIFIED DEPENDING ON CONTRACTOR'S METHODS OR SEQUENCES OF OPERATION.

ROADS ADJACENT TO THE WORK ZONES SHALL BE KEPT OPEN AS MUCH AS POSSIBLE. FLAGGERS AND P.C.S. SIGNS SHALL BE USED AS NEEDED AND SHALL BE REMOVED OR COVERED AT NIGHTS, ON WEEKENDS OR WHEN THE ACTIVITY DOES NOT EXIST.

ADDITIONAL DRUMS OR TYPE III BARRICADES MAY BE REQUIRED ADJACENT TO DROP-OFFS, OPEN TRENCHES, OR PRODUCTIONS. COST TO BE INCLUDED WITH OPERATION WHICH CREATES THE HAZARD.

DRUMS PLACED ADJACENT TO WORK AREAS SHALL BE PULLED BACK FROM THE TRAVEL LANE WHEN WORK IS NOT IN PROGRESS.

PORTABLE CHANGEABLE MESSAGE BOARD TO BE PLACED TWO WEEKS PRIOR TO CONSTRUCTION STARTING.

P.C.S. MESSAGE TO INCLUDE:

- FIRST FRAME
- ROAD CLOSED
- SECOND FRAME
- BEGINS
- AWAY/BACK

Addendum No. 01
 ID 7831-06-70
 Revised Sheet 35
 February 2, 2023

Addendum No. 01
ID 7831-06-70
Revised Sheet 48
February 2, 2023

MARKING LINE EPOXY

STATION	LOCATION	DESCRIPTION	MARKING LINE EPOXY LUNCH			SKIP DASH WHITE (L.F)
			SOLID YELLOW (L.F)	DASHED YELLOW (L.F)	SOLID WHITE (L.F)	
10+00 - 12+75	CTHM, C/L	NS PASSING	275	62.5	-	-
12+75 - 16+40	CTHM, C/L	PASSING	-	87.5	-	-
16+40 - 22+20	CTHM, C/L	SB PASSING	580	150	-	-
22+20 - 36+45	CTHM, C/L	DOUBLE YELLOW	2850	-	-	-
36+45 - 41+00	CTHM, C/L	NS PASSING	465	112.5	-	-
41+00 - 56+50	CTHM, C/L	PASSING	-	387.5	-	-
56+50 - 65+85	CTHM, C/L	SB PASSING	935	237.5	-	-
65+85 - 66+20	CTHM, C/L	DOUBLE YELLOW	70	-	-	-
66+20 - 73+85	CTHM, C/L	NS PASSING	765	187.5	-	-
73+85 - 83+25	CTHM, C/L	PASSING	-	237.5	-	-
83+25 - 89+65	CTHM, C/L	SB PASSING	640	162.5	-	-
89+65 - 148+03	CTHM, C/L	DOUBLE YELLOW	11677	-	-	-
10+00 - 46+95	CTHM, LT	WHITE EDGELINES	-	-	3695	-
46+95 - 104+40	CTHM, LT	WHITE EDGELINES	-	-	5650	-
105+70 - 136+15	CTHM, LT	WHITE EDGELINES	-	-	3045	-
137+13 - 148+03	CTHM, LT	WHITE EDGELINES	-	-	1090	-
10+00 - 145+05	CTHM, RT	WHITE EDGELINES	-	-	13505	-
145+05 - 146+18	CTHM, RT	WHITE SKIP DASH	-	-	-	28
146+18 - 148+03	CTHM, RT	WHITE EDGELINES	-	-	185	-
SUBTOTALS=			18247	1625	27170	28
TOTAL =			47070			

Item 643.3105 Temporary Marking Line
Paint 4-Inch removed from table.

CONSTRUCTION STAKING

STATION-STATION	LOCATION	650-5000 BASE (L.F)	650-5000 CURB & CUTTER (L.F)	650-6000 PIPE CULVERTS (EACH)	650-8000 RESURFACING REFERENCE (L.F)	650-9911 SUPPLEMENTAL CONTROL (ID 7831-06-70) (EACH)	650-9920 SLOPE STAKES (L.F)
32+73 - 36+97	CTHM	425	-	-	-	-	-
111+58 - 116+22	CTHM	485	-	-	-	-	-
116+22 - 119+94	CTHM	372	-	-	-	-	-
125+26 - 128+32	CTHM	312	-	-	-	-	-
143+54 - 147+40	CTHM	387	-	-	-	-	-
16+54	CTHM	-	-	1	-	-	-
18+75	CTHM	-	-	1	-	-	-
44+65	CTHM	-	-	1	-	-	-
82+71	CTHM	-	-	1	-	-	-
98+02	CTHM	-	-	1	-	-	-
106+34	CTHM	-	-	1	-	-	-
116+23	CTHM	-	-	1	-	-	-
138+00	CTHM	-	-	1	-	-	-
15+50 - 17+00	CTHM	-	-	-	-	-	150
18+00 - 19+50	CTHM	-	-	-	-	-	150
21+32 - 24+32	CTHM, RT	300	282	-	-	-	300
31+60 - 32+80	CTHM	-	-	-	-	-	120
33+32 - 36+39	CTHM, L/T	320	291	-	-	-	310
44+00 - 46+50	CTHM	-	-	-	-	-	150
52+25 - 53+35	CTHM	-	-	-	-	-	100
97+50 - 98+50	CTHM	-	-	-	-	-	100
106+00 - 106+75	CTHM	-	-	-	-	-	75
119+25 - 116+75	CTHM, RT	175	161	-	-	-	100
125+50 - 127+65	CTHM	-	-	-	-	-	175
137+50 - 138+50	CTHM	-	-	-	-	-	100
10+00 - 145+03	CTHM	-	-	-	13,810	-	-
TOTALS =		3190	734	8	13,810	1	1,880



Proposal Schedule of Items

Proposal ID: 20230214016 Project(s): 7831-06-70

Federal ID(s): WISC 2023245

SECTION: 0001 Contract Items

Alt Set ID: Alt Mbr ID:

Proposal Line Number	Item ID Description	Approximate Quantity and Units	Unit Price	Bid Amount
0092	634.0618 Posts Wood 4x6-Inch X 18-FT	22.000 EACH	_____.	_____.
0094	637.1210 Signs Type I Reflective H	42.430 SF	_____.	_____.
0096	637.2230 Signs Type II Reflective F	268.110 SF	_____.	_____.
0098	638.2102 Moving Signs Type II	4.000 EACH	_____.	_____.
0100	638.2602 Removing Signs Type II	41.000 EACH	_____.	_____.
0102	638.3000 Removing Small Sign Supports	41.000 EACH	_____.	_____.
0104	642.5001 Field Office Type B	1.000 EACH	_____.	_____.
0106	643.0300 Traffic Control Drums	670.000 DAY	_____.	_____.
0108	643.0420 Traffic Control Barricades Type III	790.000 DAY	_____.	_____.
0110	643.0705 Traffic Control Warning Lights Type A	1,452.000 DAY	_____.	_____.
0112	643.0900 Traffic Control Signs	1,782.000 DAY	_____.	_____.
0114	643.0920 Traffic Control Covering Signs Type II	10.000 EACH	_____.	_____.
0116	643.1050 Traffic Control Signs PCMS	28.000 DAY	_____.	_____.
0120	643.5000 Traffic Control	1.000 EACH	_____.	_____.
0122	646.1020 Marking Line Epoxy 4-Inch	47,070.000 LF	_____.	_____.
0124	648.0100 Locating No-Passing Zones	2.620 MI	_____.	_____.
0126	650.5000 Construction Staking Base	3,190.000 LF	_____.	_____.



Proposal Schedule of Items

Proposal ID: 20230214016 Project(s): 7831-06-70

Federal ID(s): WISC 2023245

SECTION: 0001 Contract Items

Alt Set ID: Alt Mbr ID:

Proposal Line Number	Item ID Description	Approximate Quantity and Units	Unit Price	Bid Amount
0128	650.5500 Construction Staking Curb Gutter and Curb & Gutter	734.000 LF	_____.	_____.
0130	650.6000 Construction Staking Pipe Culverts	8.000 EACH	_____.	_____.
0132	650.8000 Construction Staking Resurfacing Reference	13,810.000 LF	_____.	_____.
0134	650.9911 Construction Staking Supplemental Control (project) 01. 7831-06-70	1.000 EACH	_____.	_____.
0136	650.9920 Construction Staking Slope Stakes	1,880.000 LF	_____.	_____.
0138	690.0150 Sawing Asphalt	175.000 LF	_____.	_____.
0140	740.0440 Incentive IRI Ride	10,456.000 DOL	1.00000	10,456.00
0142	ASP.1.1PA On-the-Job Training Pre-Apprentice at \$5.00/HR	300.000 HRS	5.00000	1,500.00
0144	ASP.1T0G On-the-Job Training Graduate at \$5.00/HR	300.000 HRS	5.00000	1,500.00
Section: 0001			Total:	_____.
			Total Bid:	_____.