



Wisconsin Department of Transportation

February 6, 2023

Division of Transportation Systems Development

Bureau of Project Development
4822 Madison Yards Way, 4th Floor South
Madison, WI 53705

Telephone: (608) 266-1631
Facsimile (FAX): (608) 266-8459

NOTICE TO ALL CONTRACTORS:

Proposal #22: 2722-07-72, WISC 2023227
C New Berlin Moorland Road
W Beloit Road to W National Ave
CTH O
Waukesha County

Letting of February 14, 2023

This is Addendum No. 01, which provides for the following:

Schedule of Items:

Revised Bid Item Quantities					
Bid Item	Item Description	Unit	Proposal Total Prior to Addendum	Proposal Quantity Change (-)	Proposal Total After Addendum
602.0410	Concrete Sidewalk 5-inch	SF	33,598	7,208	40,806

Plan Sheets:

Revised Plan Sheets	
Plan Sheet	Plan Sheet Title (brief description of changes to sheet)
55	Paving Detail (revised legend item)
56	Paving Detail (revised legend item)
57	Paving Detail (revised legend item)
58	Paving Detail (revised legend item)
59	Paving Detail (revised legend item)
60	Paving Detail (revised legend item)
61	Paving Detail (revised legend item)
62	Paving Detail (revised legend item)
63	Paving Detail (revised legend item)
64	Paving Detail (revised legend item)
65	Paving Detail (revised legend item)
66	Paving Detail (revised legend item)
67	Paving Detail (revised bid item callouts; revised legend item)
68	Paving Detail (revised legend item)
69	Paving Detail (revised bid item callouts; revised legend item)
70	Paving Detail (revised bid item callouts; revised legend item)

71	Paving Detail (revised bid item callouts; revised legend item)
372	Miscellaneous Quantities (revised quantities for Concrete Sidewalk 5-inch)
373	Miscellaneous Quantities (revised quantities for Concrete Sidewalk 5-inch)

Schedule of Items

Attached, dated February 6, 2023, are the revised Schedule of Items Page 4.

Plan Sheets

The following 8½ x 11-inch sheets are attached and made part of the plans for this proposal:
Revised: 55 – 71, 372, and 373.

The responsibility for notifying potential subcontractors and suppliers of these changes remains with the prime contractor.

Sincerely,

Mike Coleman

Proposal Development Specialist
Proposal Management Section

END OF ADDENDUM

W BELLOIT RD

- AG01 BASE AGGREGATE DENSE 3/4-INCH (6-INCH DEPTH)
- AS01 ASPHALTIC SURFACE DRIVEWAYS & FIELD ENTRANCES (3-INCH DEPTH)
- AS02 ASPHALTIC SURFACE DRIVEWAYS & FIELD ENTRANCES (3-INCH DEPTH)
- AS04 ASPHALTIC SURFACE (4-INCH DEPTH)
- HVA01 HVA PAVEMENT (4-INCH DEPTH)
- HVA02 HVA PAVEMENT (6-INCH DEPTH)
- CCD CONCRETE CURB TYPE D
- CCP CONCRETE CURB PEDESTRIAN
- CG18A CONCRETE CURB & GUTTER 18-INCH TYPE A
- CG18B CONCRETE CURB & GUTTER 18-INCH TYPE B
- CG30A CONCRETE CURB & GUTTER 30-INCH TYPE A
- CG30B CONCRETE CURB & GUTTER 30-INCH TYPE B

PAVING DETAIL LEGEND

- PF10S CONCRETE PAVEMENT 10 1/2-INCH (DOWELED AND TINED)
- PF10B CONCRETE PAVEMENT HES 10 1/2-INCH (DOWELED AND TINED)
- CS1 CONCRETE SAFETY ISLAND (SEE CONSTRUCTION DETAIL)
- MD MAINTENANCE OPENING (SEE CONSTRUCTION DETAIL)
- SN01 CONCRETE MEDIAN SLOPED NOSE TYPE 1
- SN02 CONCRETE MEDIAN SLOPED NOSE TYPE 2
- S0D TOPSOIL, FERTILIZER TYPE B & SOD LAWN
- SW01 CONCRETE SIDEWALK FINISH
- CS2 STAMPING COLORED CONCRETE
- GW01 CONCRETE DRIVEWAY 7-INCH

Addendum No. 01
ID 2722-07-72
Revised Sheet 55
February 6, 2023



MATCHLINE STA 21+00.00

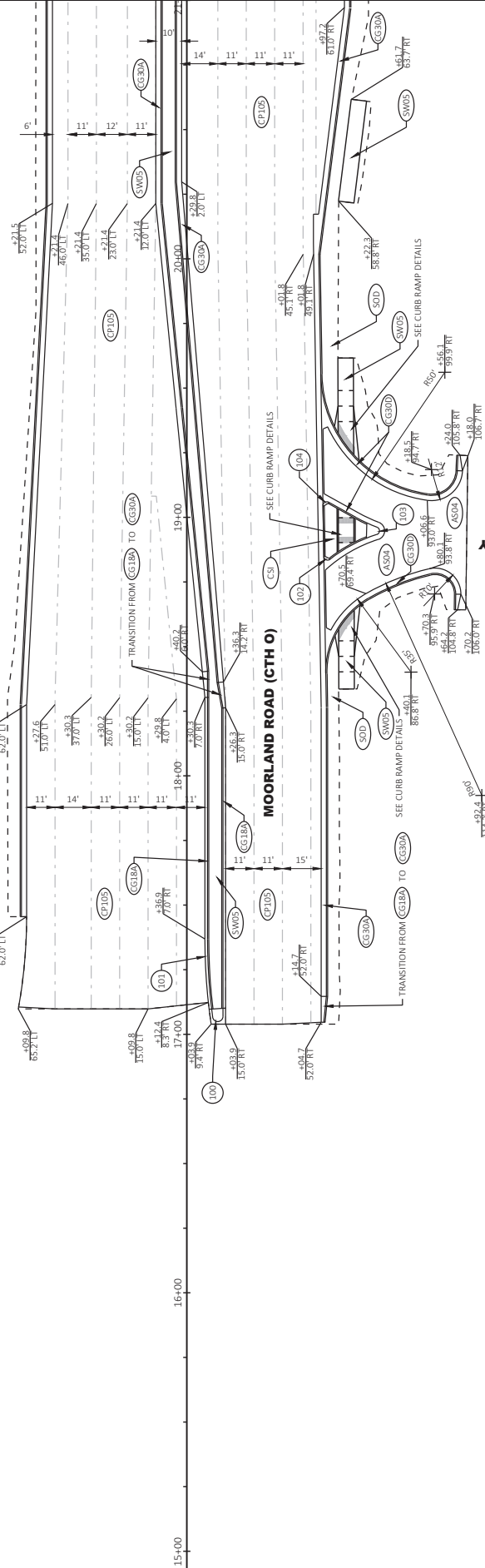

MOORLAND ROAD (CTH O)

STATION & OFFSET TABLE

POINT	STATION	OFFSET	Y COORDS	X COORDS	RADIUS
100	17+06.93	12.00 RT	141106.178	716086.075	2'
101	17+36.86	235.00 RT	141135.679	716309.132	228'
102	18+84.93	54.52 RT	141284.091	716128.945	1.5'
103	18+94.78	73.06 RT	141293.905	716147.504	1.5'
104	19+04.51	54.20 RT	141303.673	716128.656	1.5'

1 OF 17

- CP105 CONCRETE PAVEMENT 10 1/2-INCH (DOWELED AND TINED)
- CP107 CONCRETE PAVEMENT HES 10 1/2-INCH (DOWELED AND TINED)
- CS1 CONCRETE SAFETY ISLAND (SEE CONSTRUCTION DETAIL)
- MD MAINTENANCE OPENING (SEE CONSTRUCTION DETAIL)
- SN01 CONCRETE MEDIAN SLOPED NOSE TYPE 1
- SN02 CONCRETE MEDIAN SLOPED NOSE TYPE 2
- SOD TOPSOIL, FERTILIZER TYPE B & SOD LAWN
- SWMS CONCRETE SUPPLEMENTAL 5-INCH STAMPING COLORED CONCRETE
- SWMS CONCRETE SUPPLEMENTAL 7-INCH STAMPING COLORED CONCRETE

- AG01 BASE AGGREGATE DENSE 3/4-INCH (6-INCH DEPTH)
- AS03 ASPHALTIC SURFACE DRIVEWAYS & FIELD ENTRANCES (3-INCH DEPTH)
- AS04 ASPHALTIC SURFACE (4-INCH DEPTH)
- HM04 HMA PAVEMENT (4-INCH DEPTH)
- HM06 HMA PAVEMENT (6-INCH DEPTH)
- CC0 CONCRETE CURB TYPE D
- CC1 CONCRETE CURB TYPE D
- CC2 CONCRETE CURB TYPE D
- CC3 CONCRETE CURB TYPE D
- CC4 CONCRETE CURB & GUTTER 18-INCH TYPE A
- CC5 CONCRETE CURB & GUTTER 18-INCH TYPED
- CC6 CONCRETE CURB & GUTTER 30-INCH TYPE A
- CC7 CONCRETE CURB & GUTTER 30-INCH TYPED

PAVING DETAIL LEGEND



MATCHLINE STA 27+00.00

MATCHLINE STA 21+00.00

MOORLAND ROAD (CTH O)

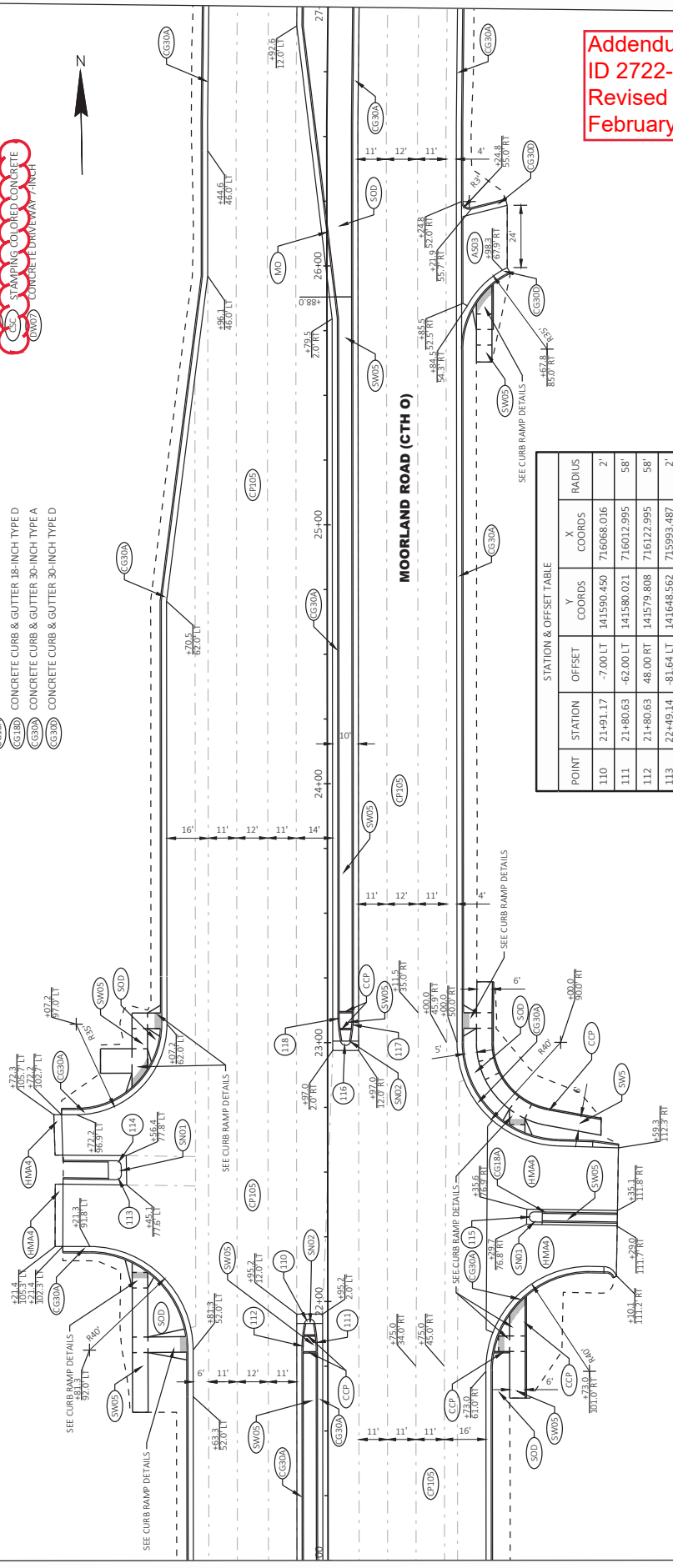

Addendum No. 01
 ID 2722-07-72
 Revised Sheet 56
 February 6, 2023

STATION & OFFSET TABLE					
POINT	STATION	OFFSET	Y COORDS	X COORDS	RADIUS
110	21+91.17	-7.00 LT	141590.450	716068.016	2'
111	21+80.63	-62.00 LT	141580.021	716012.995	58'
112	21+80.63	48.00 RT	141579.808	716122.995	58'
113	22+49.14	-81.64 LT	141648.562	715993.487	2'
114	22+45.24	-81.70 LT	141651.887	715993.439	2'
115	22+32.62	79.76 RT	141631.731	716154.858	2'
116	23+00.96	7.00 RT	141700.218	716082.228	2'
117	23+11.50	-48.00 LT	141710.860	716027.249	58'
118	23+11.50	62.00 RT	141710.647	716137.249	58'

2 OF 17

PROJECT NO: 2722-07-72

HWY: CTH O

COUNTY: WAUKESHA

PAVING DETAILS

SHEET

56

FILE NAME: T:\202800\C\MSD\272207\3\SHEET\PLAN\021201.PD.DWG

LAYOUT NAME: Sheet - 10

PLOT DATE: 2/7/2023 1:43 PM

PLOT NAME: WHITEFOOT, DANIEL

PLOT SCALE: 1 IN=40 FT

WISDOT/CAD/SHEET 42

PAVING DETAIL LEGEND

- (A60) BASE AGGREGATE DENSE 3/4-INCH (6-INCH DEPTH)
- (A592) ASPHALTIC SURFACE DRIVEWAYS & FIELD ENTRANCES (3-INCH DEPTH)
- (A594) ASPHALTIC SURFACE (4-INCH DEPTH)
- (HMA9) HMA PAVEMENT (4-INCH DEPTH)
- (HMA9) HMA PAVEMENT (6-INCH DEPTH)
- (C1D) CONCRETE CURB TYPE D
- (C1P) CONCRETE CURB PEDESTRIAN
- (C318) CONCRETE CURB & GUTTER 18-INCH TYPE A
- (C318D) CONCRETE CURB & GUTTER 18-INCH TYPE D
- (C320) CONCRETE CURB & GUTTER 30-INCH TYPE A
- (C320D) CONCRETE CURB & GUTTER 30-INCH TYPE D
- (P105) CONCRETE PAVEMENT 10 1/2-INCH (DOWELED AND TINED)
- (P105D) CONCRETE PAVEMENT 10 1/2-INCH (DOWELED AND TINED)
- (CSI) CONCRETE SAFETY ISLAND (SEE CONSTRUCTION DETAIL)
- (MDO) MAINTENANCE OPENING (SEE CONSTRUCTION DETAIL)
- (SNO1) CONCRETE MEDIAN SLOPED NOSE TYPE 1
- (SNO2) CONCRETE MEDIAN SLOPED NOSE TYPE 2
- (SOD) TOPSOIL, FERTILIZER TYPE B & SOD LAWN
- (AWW) CONCRETE SIDEWALK 5-INCH
- (SFC) STAMPING COVER CONCRETE
- (DW07) CONCRETE DRIVEWAY 4-INCH

Addendum No. 01
 ID 2722-07-72
 Revised Sheet 57
 February 6, 2023

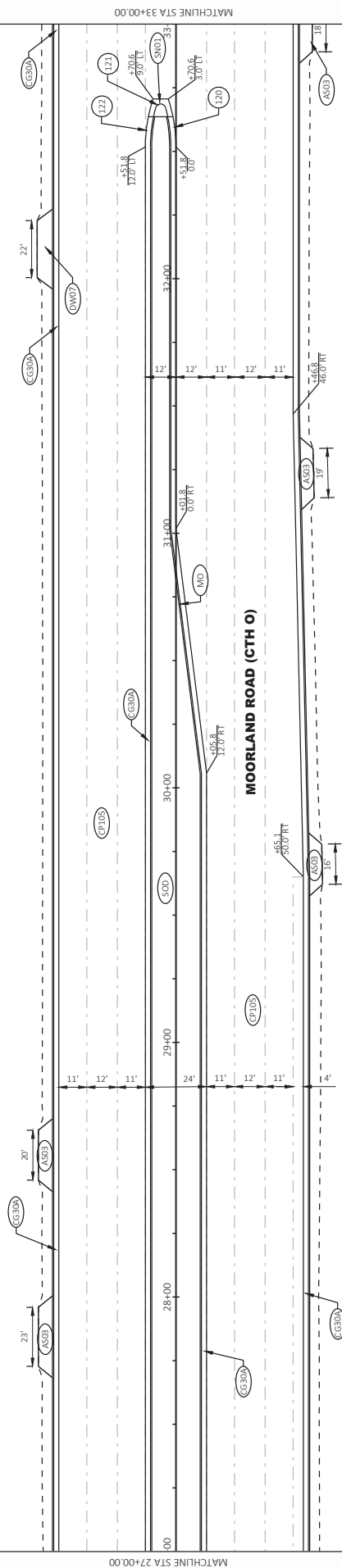

STATION & OFFSET TABLE					
POINT	STATION	OFFSET	Y COORDS	X COORDS	RADIUS
120	32+51.76	-60.00 LT	142651.790	716024.086	60'
121	32+66.59	-6.00 LT	142665.882	716078.284	2'
122	32+51.76	48.00 RT	142650.313	716132.076	60'

PAVING DETAIL LEGEND

- (AC01) BASE AGGREGATE DENSE 3/4-INCH (6-INCH DEPTH)
- (AS01) ASPHALTIC SURFACE DRIVEWAYS & FIELD ENTRANCES (5-INCH DEPTH)
- (AS04) ASPHALTIC SURFACE (4-INCH DEPTH)
- (HM04) HMA PAVEMENT (4-INCH DEPTH)
- (HM08) HMA PAVEMENT (8-INCH DEPTH)
- (CC01) CONCRETE CURB TYPE D
- (CC02) CONCRETE CURB TYPE B
- (CC03) CONCRETE CURB TYPE A
- (CC04) CONCRETE CURB & GUTTER 18-INCH TYPE D
- (CC05) CONCRETE CURB & GUTTER 30-INCH TYPE A
- (CC06) CONCRETE CURB & GUTTER 30-INCH TYPE D
- (CP105) CONCRETE SIDEWALK 5-INCH
- (CS01) CONCRETE PAVEMENT 10 1/2-INCH (DOWELED AND TINED)
- (CS02) CONCRETE PAVEMENT 10 1/2-INCH (DOWELED AND TINED)
- (CS03) CONCRETE SAFETY ISLAND (SEE CONSTRUCTION DETAIL)
- (MS) MAINTENANCE OPENING (SEE CONSTRUCTION DETAIL)
- (SN01) CONCRETE MEDIAN SLOPED NOSE TYPE 1
- (SN02) CONCRETE MEDIAN SLOPED NOSE TYPE 2
- (SOD) TOPSOIL, FERTILIZER TYPE B & SOD LAWN
- (SWS) CONCRETE SIDEWALK 5-INCH
- (CS7) STAMPING COLORED CONCRETE
- (RW07) CONCRETE DRIVEWAY 7-INCH

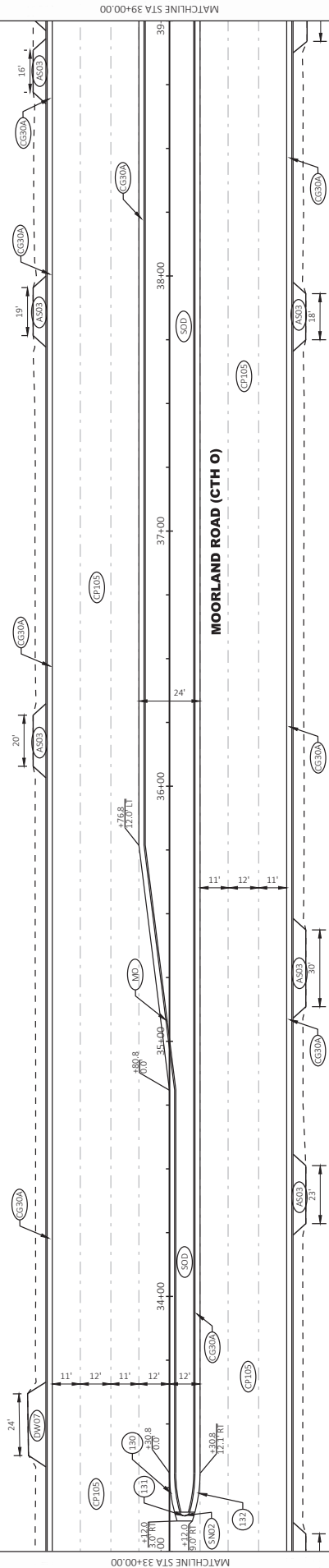

MATCHLINE STA 39+00.00

MATCHLINE STA 33+00.00

MOORLAND ROAD (CTH 0)

Addendum No. 01
ID 2722-07-72
Revised Sheet 58
February 6, 2023

STATION & OFFSET TABLE					
POINT	STATION	OFFSET	Y COORDS	X COORDS	RADIUS
130	33+30.83	-48.00 LT	142730.797	716029.183	60'
131	33+15.99	6.00 RT	142715.159	716087.380	2'
132	33+30.81	60.00 RT	142729.194	716145.157	60'

PAVING DETAIL LEGEND

- (AS30) BASE AGGREGATE DENSE 3/4-INCH (6-INCH DEPTH)
- (AS20) ASPHALTIC SURFACE DRIVEWAYS & FIELD ENTRANCES (3-INCH DEPTH)
- (AS22) ASPHALTIC SURFACE (4-INCH DEPTH)
- (HM20) HMA PAVEMENT (4-INCH DEPTH)
- (HM20) HMA PAVEMENT (6-INCH DEPTH)
- (CC2) CONCRETE CURB TYPED
- (CC1) CONCRETE CURB PEDESTRIAN
- (G110) CONCRETE CURB & GUTTER 18-INCH TYPE A
- (G110) CONCRETE CURB & GUTTER 18-INCH TYPE D
- (G110) CONCRETE CURB & GUTTER 30-INCH TYPE A
- (G110) CONCRETE CURB & GUTTER 30-INCH TYPE D
- (CS30) CONCRETE PAVEMENT 10 1/2-INCH (DOWELED AND TINED)
- (CS30) CONCRETE PAVEMENT HES TO 1/2-INCH (DOWELED AND TINED)
- (CS) CONCRETE SAFETY ISLAND (SEE CONSTRUCTION DETAIL)
- (M0) MAINTENANCE OPENING (SEE CONSTRUCTION DETAIL)
- (SN01) CONCRETE MEDIAN SLOPED NOSE TYPE 1
- (SN02) CONCRETE MEDIAN SLOPED NOSE TYPE 2
- (S01) TOPSOIL, FERTILIZER TYPE B & SOOD LAWN
- (S02) CONCRETE SIDEWALK FINISH
- (SC) STAMPING COLORED CONCRETE
- (UN01) CONCRETE DIMENSION 7-INCH

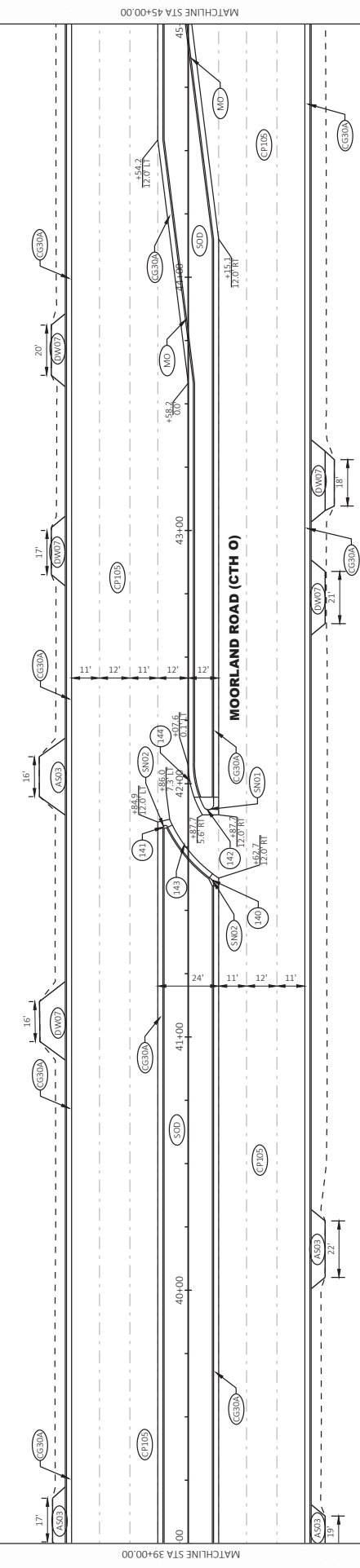

STATION & OFFSET TABLE

POINT	STATION	OFFSET	Y COORDS	X COORDS	RADIUS
140	41+60.18	7.00 RT	149559.211	716103.506	3'
141	41+82.49	-9.00 LT	149581.798	716087.813	1'
142	41+91.69	8.00 RT	149590.702	716104.937	2'
143	42+08.22	43.00 RT	149606.256	716140.159	55'
144	42+08.18	40.00 RT	149606.819	716132.489	40'

Addendum No. 01
 ID 2722-07-72
 Revised Sheet 59
 February 6, 2023

PAVING DETAIL LEGEND

- (A301) BASE AGGREGATE DENSE 3/4-INCH (6-INCH DEPTH)
- (A302) ASPHALTIC SURFACE DRIVEWAYS & FIELD ENTRANCES (3-INCH DEPTH)
- (A303) ASPHALTIC SURFACE DRIVEWAYS & FIELD ENTRANCES (4-INCH DEPTH)
- (A304) ASPHALTIC SURFACE (4-INCH DEPTH)
- (HMA2) HMA PAVEMENT (4-INCH DEPTH)
- (HMA3) HMA PAVEMENT (6-INCH DEPTH)
- (C101) CONCRETE CURB TYPE D
- (C102) CONCRETE CURB PEDESTRIAN
- (C103) CONCRETE CURB & GUTTER 18-INCH TYPE A
- (C104) CONCRETE CURB & GUTTER 18-INCH TYPE D
- (C105) CONCRETE CURB & GUTTER 30-INCH TYPE A
- (C106) CONCRETE CURB & GUTTER 30-INCH TYPE D
- (F101) CONCRETE PAVEMENT 10 1/2-INCH (DOWELED AND TINED)
- (F102) CONCRETE PAVEMENT HES 10 1/2-INCH (DOWELED AND TINED)
- (S1) CONCRETE SAFETY ISLAND (SEE CONSTRUCTION DETAIL)
- (M1) MAINTENANCE OPENING (SEE CONSTRUCTION DETAIL)
- (SND1) CONCRETE MEDIAN SLOPED NOSE TYPE 1
- (SND2) CONCRETE MEDIAN SLOPED NOSE TYPE 2
- (SND3) TOPSOIL, FERTILIZER TYPE B & SOD LAWN
- (SND4) CONCRETE SIDEWALK 5-INCH
- (CSC) STAMPING COLORED CONCRETE
- (RW2) CONCRETE DRIVEWAY FINISH

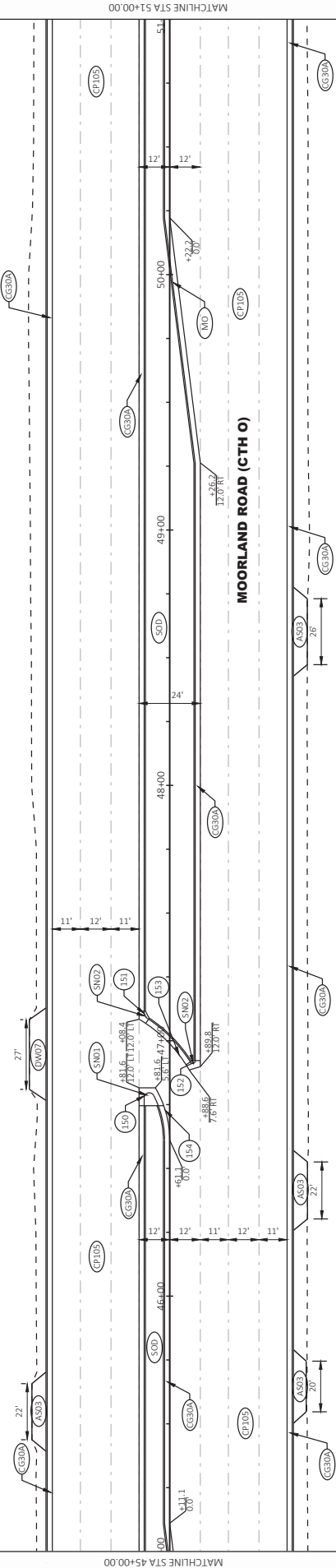

Addendum No. 01
 ID 2722-07-72
 Revised Sheet 60
 February 6, 2023

STATION & OFFSET TABLE

POINT	STATION	OFFSET	Y COORDS	X COORDS	RADIUS
150	46+77.56	-8.00 LT	144076.750	716095.585	2'
151	47+11.18	-7.00 LT	144110.351	716097.044	3'
152	46+92.10	9.00 RT	144091.056	716112.782	1'
153	46+61.07	-40.00 LT	144060.697	716063.362	55'
154	46+61.07	-40.00 LT	144060.697	716063.362	40'

6 OF 17

PAVING DETAIL LEGEND

- (A202) BASE AGGREGATE DENSE 3/4-INCH (6-INCH DEPTH)
- (A303) ASPHALTIC SURFACE DRIVEWAYS & FIELD ENTRANCES (3-INCH DEPTH)
- (A304) ASPHALTIC SURFACE (4-INCH DEPTH)
- (HMA48) HMA PAVEMENT (4-INCH DEPTH)
- (HMA48) HMA PAVEMENT (6-INCH DEPTH)
- (CCD) CONCRETE CURB TYPE D
- (CCP) CONCRETE CURB PEDESTRIAN
- (C218A) CONCRETE CURB & GUTTER 18-INCH TYPE A
- (C218B) CONCRETE CURB & GUTTER 18-INCH TYPE D
- (C218C) CONCRETE CURB & GUTTER 30-INCH TYPE A
- (C218D) CONCRETE CURB & GUTTER 30-INCH TYPE D
- (P103) CONCRETE PAVEMENT 10 1/2-INCH (DOWELED AND TINED)
- (P104) CONCRETE PAVEMENT HES 10 1/2-INCH (DOWELED AND TINED)
- (CS) CONCRETE SAFETY ISLAND (SEE CONSTRUCTION DETAIL)
- (M2) MAINTENANCE OPENING (SEE CONSTRUCTION DETAIL)
- (SNO1) CONCRETE MEDIAN SLOPED NOSE TYPE 1
- (SNO2) CONCRETE MEDIAN SLOPED NOSE TYPE 2
- (SNO3) TOPSOIL, FERTILIZER TYPE B & SOD LAWN
- (SNO4) CONCRETE SIDEWALK 5-INCH
- (CS) STAMPING COLORED CONCRETE
- (SNO5) CONCRETE DRIVEWAY 4-INCH

W HEATHERLY DR

W MAYFLOWER DR

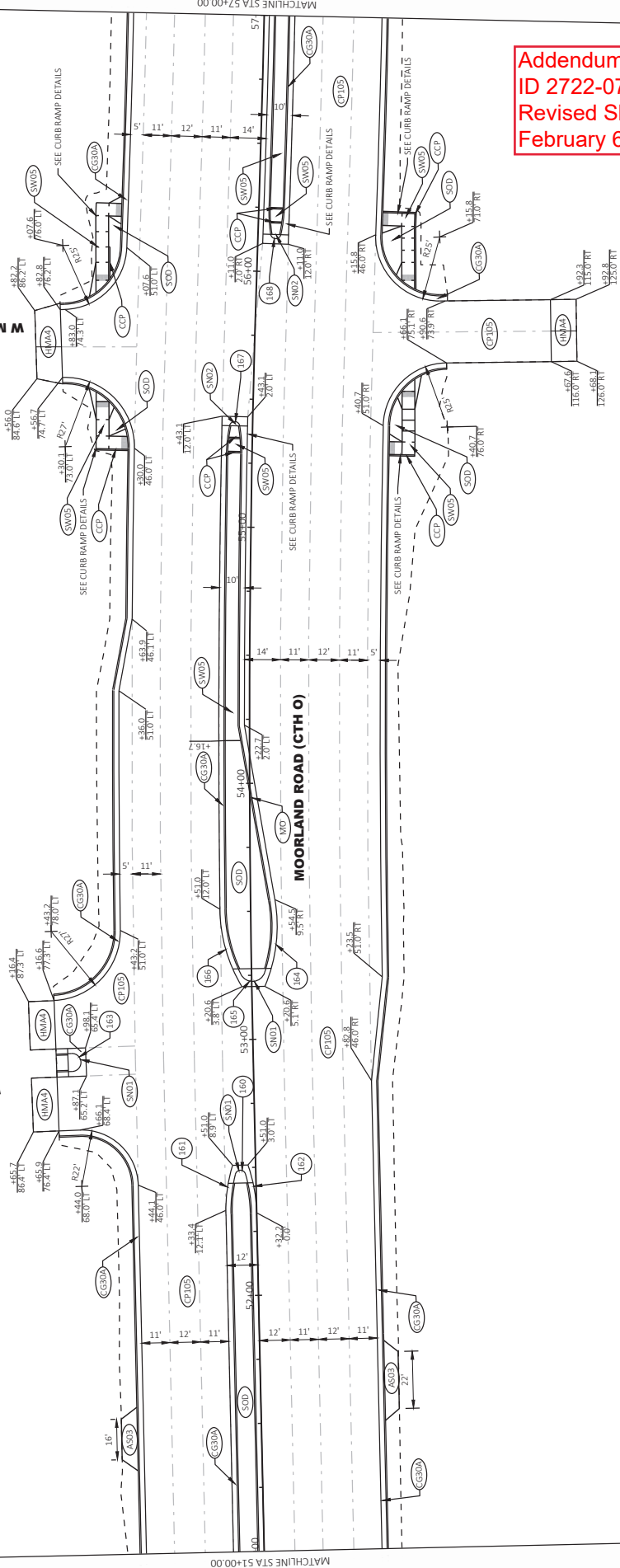

Addendum No. 01
 ID 2722-07-72
 Revised Sheet 61
 February 6, 2023

PAVING DETAIL LEGEND

- (A630) BASE AGGREGATE DENSE 3/4-INCH (6-INCH DEPTH)
- (A503) ASPHALTIC SURFACE DRIVEWAYS & FIELD ENTRANCES (8-INCH DEPTH)
- (A504) ASPHALTIC SURFACE (4-INCH DEPTH)
- (HMA4) HMA PAVEMENT (4-INCH DEPTH)
- (HMA6) HMA PAVEMENT (6-INCH DEPTH)
- (CCD) CONCRETE CURB TYPE D
- (CCP) CONCRETE CURB PEDESTRIAN
- (CC18A) CONCRETE CURB & GUTTER 18-INCH TYPE A
- (CC18D) CONCRETE CURB & GUTTER 18-INCH TYPE D
- (CC30A) CONCRETE CURB & GUTTER 30-INCH TYPE A
- (CC30D) CONCRETE CURB & GUTTER 30-INCH TYPE D
- (CP105) CONCRETE PAVEMENT 10 1/2-INCH (DOWELED AND TINED)
- (CP106) CONCRETE PAVEMENT 10 1/2-INCH (DOWELED AND TINED)
- (CS1) CONCRETE SAFETY ISLAND (SEE CONSTRUCTION DETAIL)
- (MO) MAINTENANCE OPENING (SEE CONSTRUCTION DETAIL)
- (SN02) CONCRETE MEDIAN SLOPED NOSE TYPE 2
- (AS0) TOPSOIL, FERTILIZER TYPE B & SOD LAWN
- (AS01) CONCRETE SIDEWALK FINISH
- (CS) STAMPING COLORED CONCRETE
- (DM07) CONCRETE DRIVEWAY 7-INCH

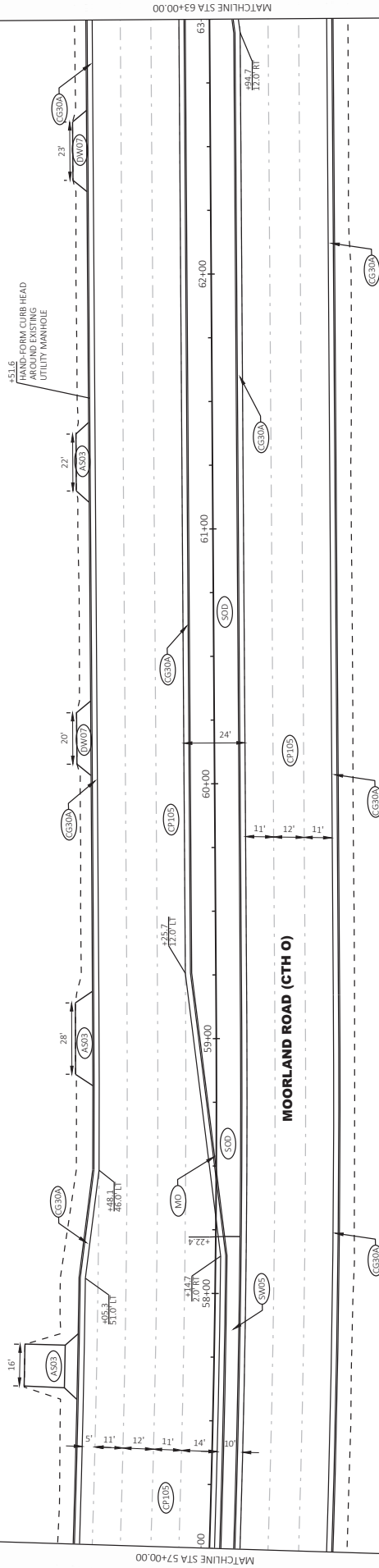

Addendum No. 01
 ID 2722-07-72
 Revised Sheet 62
 February 6, 2023

PAVING DETAIL LEGEND

- (A6G7) BASE AGGREGATE DENSE 3/4-INCH (6-INCH DEPTH)
- (A5S3) ASPHALTIC SURFACE DRIVEWAYS & FIELD ENTRANCES (3-INCH DEPTH)
- (A5S4) ASPHALTIC SURFACE (4-INCH DEPTH)
- (HMA5) HMA PAVEMENT (4-INCH DEPTH)
- (HMA6) HMA PAVEMENT (6-INCH DEPTH)
- (CC1) CONCRETE CURB TYPE D
- (CC2) CONCRETE CURB PEDESTRIAN
- (G118A) CONCRETE CURB & GUTTER 18-INCH TYPE A
- (G118B) CONCRETE CURB & GUTTER 18-INCH TYPE D
- (G330) CONCRETE CURB & GUTTER 30-INCH TYPE A
- (G330B) CONCRETE CURB & GUTTER 30-INCH TYPE D
- (C710S) CONCRETE PAVEMENT 10 1/2-INCH (DOWELED AND TINED)
- (C710B) CONCRETE PAVEMENT HES 10 1/2-INCH (DOWELED AND TINED)
- (CS1) CONCRETE SAFETY ISLAND (SEE CONSTRUCTION DETAIL)
- (M10) MAINTENANCE OPENING (SEE CONSTRUCTION DETAIL)
- (SN03) CONCRETE MEDIAN SLOPED NOSE TYPE 1
- (SN02) CONCRETE MEDIAN SLOPED NOSE TYPE 2
- (S0D) TOPSOIL, FERTILIZER TYPE B & SOD LAWN
- (S0D) CONCRETE SIDEWALK 5-INCH
- (C5) STAMPING COLORED CONCRETE
- (R003) CONCRETE DRIVEWAY 7-INCH

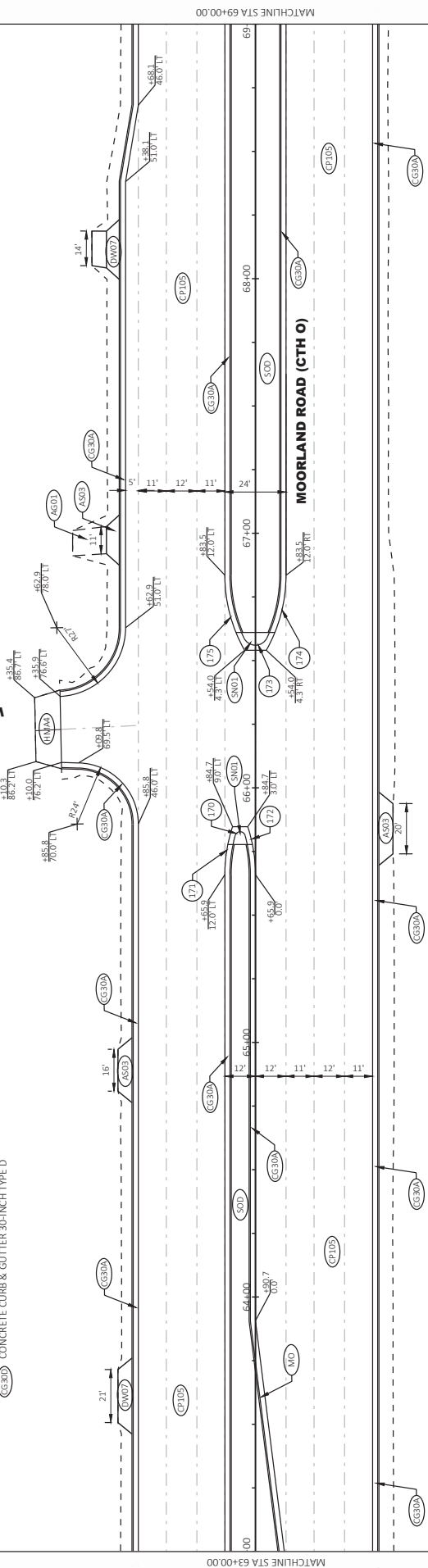

Addendum No. 01
 ID 2722-07-72
 Revised Sheet 63
 February 6, 2023

STATION & OFFSET TABLE					
POINT	STATION	Y COORDS	X COORDS	RADIUS	
170	65+80.72	-6.00 LT	145979.049	716146.568	2'
171	65+65.89	48.00 RT	145963.279	716193.629	60'
172	65+65.89	-60.00 LT	145965.292	716092.284	60'
173	66+61.03	0.00	146059.228	716154.162	5'
174	66+83.51	-48.00 LT	146082.650	716106.618	60'
175	66+83.51	48.00 RT	146080.743	716202.599	60'

PAVING DETAIL LEGEND

- (AG01) BASE AGGREGATE DENSE 3/4-INCH (6-INCH DEPTH)
- (AG02) ASPHALTIC SURFACE DRIVEWAYS & FIELD ENTRANCES (3-INCH DEPTH)
- (AS01) ASPHALTIC SURFACE (4-INCH DEPTH)
- (HM01) HMA PAVEMENT (4-INCH DEPTH)
- (HM02) HMA PAVEMENT (6-INCH DEPTH)
- (CC01) CONCRETE CURB TYPE D
- (CC02) CONCRETE CURB PEDESTRIAN
- (G101) CONCRETE CURB & GUTTER 18-INCH TYPE A
- (G102) CONCRETE CURB & GUTTER 18-INCH TYPE D
- (G201) CONCRETE CURB & GUTTER 30-INCH TYPE A
- (G301) CONCRETE CURB & GUTTER 30-INCH TYPE D
- (E101) CONCRETE PAVEMENT 10 1/2-INCH (DOWELED AND TINED)
- (E102) CONCRETE PAVEMENT HES 10 1/2-INCH (DOWELED AND TINED)
- (CS1) CONCRETE SAFETY ISLAND (SEE CONSTRUCTION DETAIL)
- (MO) MAINTENANCE OPENING (SEE CONSTRUCTION DETAIL)
- (SN01) CONCRETE MEDIAN SLOPED NOSE TYPE 1
- (SN02) CONCRETE MEDIAN SLOPED NOSE TYPE 2
- (SOD) TOPSOIL, FERTILIZER TYPE B & SOD LAWN
- (SODS) CONCRETE SUPERMAK 5-INCH STAMPING COLORED CONCRETE DRIVEWAY / INCH
- (SW01) CONCRETE DRIVEWAY / INCH

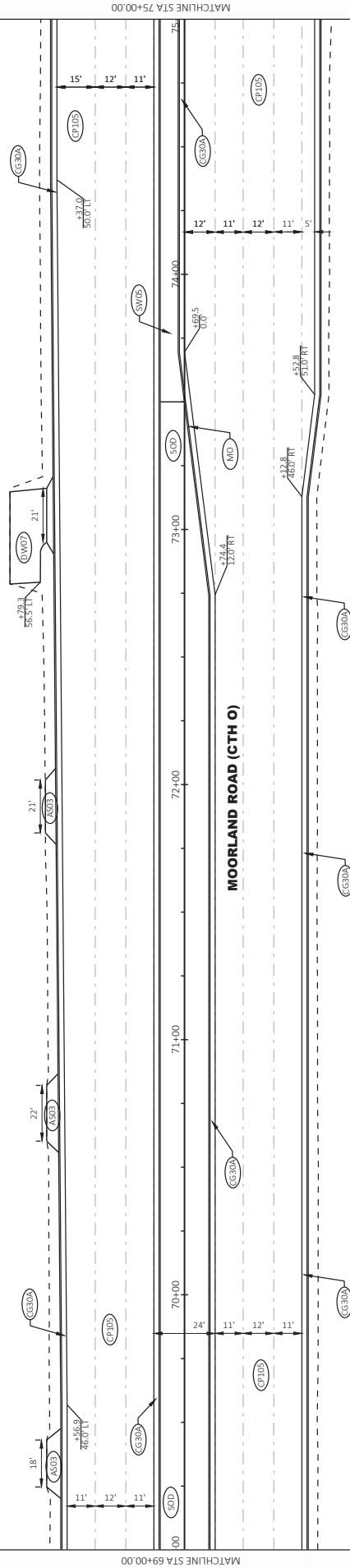

Addendum No. 01
 ID 2722-07-72
 Revised Sheet 64
 February 6, 2023

10 OF 17

Addendum No. 01
ID 2722-07-72
Revised Sheet 65
February 6, 2023



PAVING DETAIL LEGEND

- (AG21) BASE AGGREGATE DENSE 3/4-INCH (6-INCH DEPTH)
- (AS21) ASPHALTIC SURFACE DRIVEWAYS & FIELD ENTRANCES (3-INCH DEPTH)
- (AS24) ASPHALTIC SURFACE (4-INCH DEPTH)
- (HM24) HMA PAVEMENT (4-INCH DEPTH)
- (HM26) HMA PAVEMENT (6-INCH DEPTH)
- (CC) CONCRETE CURB TYPE D
- (CCP) CONCRETE CURB PEDESTRIAN
- (CS18A) CONCRETE CURB & GUTTER 18-INCH TYPE A
- (CS18D) CONCRETE CURB & GUTTER 18-INCH TYPE D
- (CS30A) CONCRETE CURB & GUTTER 30-INCH TYPE A
- (CS30D) CONCRETE CURB & GUTTER 30-INCH TYPE D
- (CP105) CONCRETE PAVEMENT 10 1/2-INCH (DOWELED AND TINED)
- (CP106) CONCRETE PAVEMENT HES 10 1/2-INCH (DOWELED AND TINED)
- (CS1) CONCRETE SAFETY ISLAND (SEE CONSTRUCTION DETAIL)
- (MO) MAINTENANCE OPENING (SEE CONSTRUCTION DETAIL)
- (SN01) CONCRETE MEDIAN SLOPED NOSE TYPE 1
- (SN02) CONCRETE MEDIAN SLOPED NOSE TYPE 2
- (SD) TOPSOIL, FERTILIZER TYPE B & SOO LAWN
- (SWS) CONCRETE SIDEWALK SLUNCH
- (CS2) STAMPING COLORED CONCRETE
- (RW03) CONCRETE DRIVEWAY 7-INCH

W MARK DR

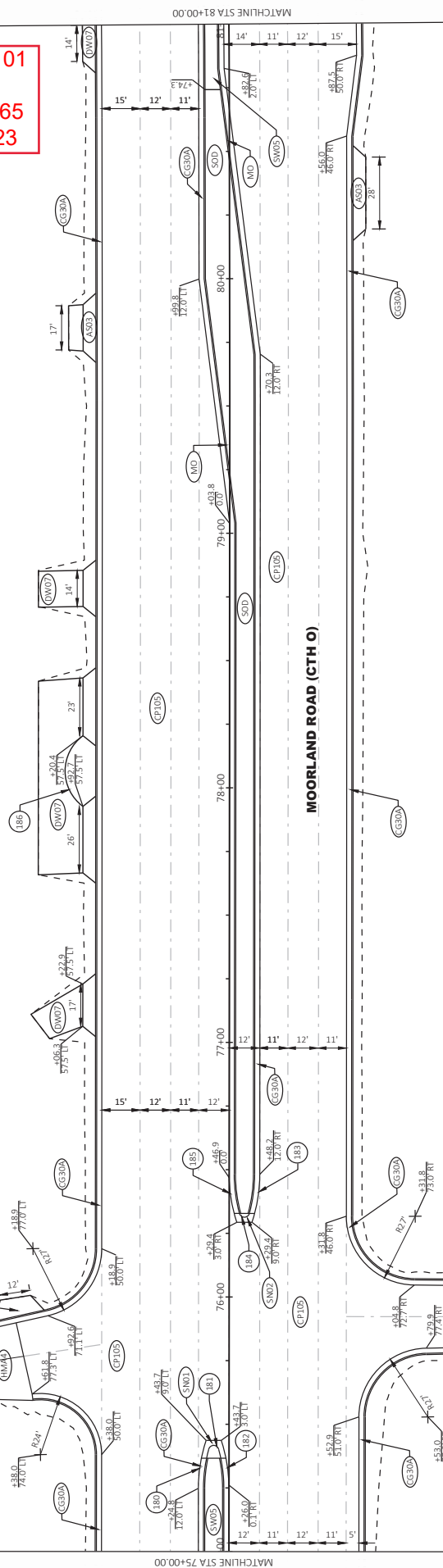

STATION & OFFSET TABLE

POINT	STATION	OFFSET	Y COORDS	X COORDS	RADIUS
180	75+24.83	48.00 RT	146922.092	716209.302	60'
181	75+39.66	-6.00 LT	146937.803	716165.615	2'
182	75+24.83	-60.00 LT	146924.046	716111.331	60'
183	76+48.19	-48.00 LT	147046.962	716135.325	60'
184	76+33.36	6.00 RT	147031.242	716179.474	2'
185	76+48.19	60.00 RT	147045.130	716226.907	60'
186	78+06.79	-47.24 LT	147205.449	716129.678	17.26

11.06.17



PAVING DETAIL LEGEND

- (AS03) BASE AGGREGATE DENSE 3/4-INCH (6-INCH DEPTH)
- (AS02) ASPHALTIC SURFACE DRIVEWAYS & FIELD ENTRANCES (3-INCH DEPTH)
- (AS01) ASPHALTIC SURFACE (4-INCH DEPTH)
- (HMA02) HMA PAVEMENT (4-INCH DEPTH)
- (HMA01) HMA PAVEMENT (6-INCH DEPTH)
- (CCD) CONCRETE CURB TYPE D
- (CPD) CONCRETE CURB PEDESTRIAN
- (C18A) CONCRETE CURB & GUTTER 18-INCH TYPE A
- (C18B) CONCRETE CURB & GUTTER 18-INCH TYPE B
- (C30A) CONCRETE CURB & GUTTER 30-INCH TYPE A
- (C30B) CONCRETE CURB & GUTTER 30-INCH TYPE B
- (CP05) CONCRETE PAVEMENT 10 1/2-INCH (DOWELED AND TINED)
- (CP06) CONCRETE PAVEMENT THS 10 1/2-INCH (DOWELED AND TINED)
- (CPI) CONCRETE SAFETY ISLAND (SEE CONSTRUCTION DETAIL)
- (MO) MAINTENANCE OPENING (SEE CONSTRUCTION DETAIL)
- (SN01) CONCRETE MEDIAN SLOPED NOSE TYPE 1
- (SN02) CONCRETE MEDIAN SLOPED NOSE TYPE 2
- (SOD) TOPSOIL, FERTILIZER TYPE B & SOD LAWN
- (SW05) CONCRETE SIDEWALK 5-INCH
- (CS01) STAMPING COLORED CONCRETE
- (OW07) CONCRETE DRIVEWAY 7-INCH

CONCRETE DRIVEWAY 7-INCH

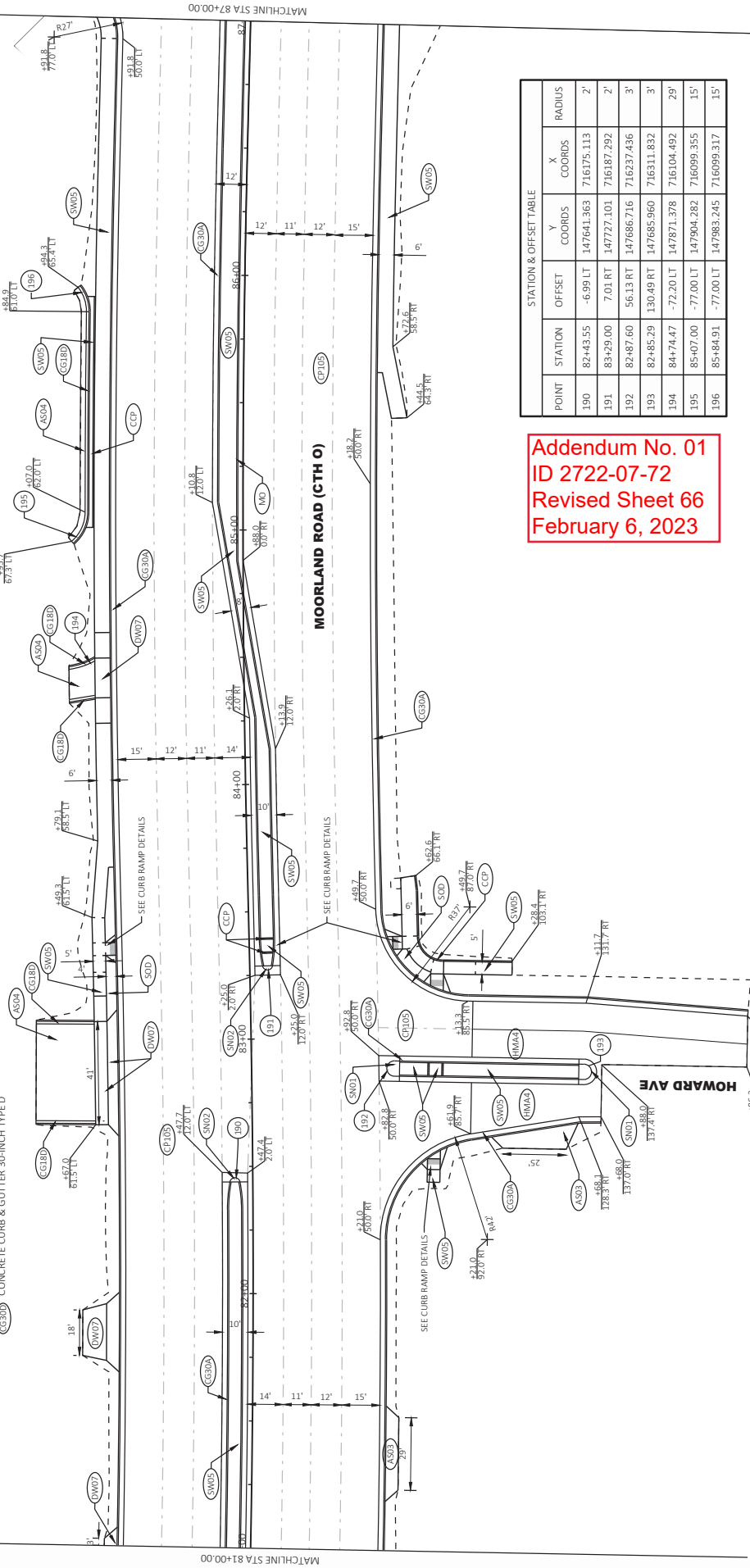

POINT	STATION	OFFSET	Y COORDS	X COORDS	RADIUS
190	82+43.55	-6.99 LT	147641.363	716175.113	2'
191	83+29.00	7.01 RT	147727.101	716187.292	2'
192	82+87.60	56.13 RT	147686.716	716237.436	3'
193	82+85.29	130.49 RT	147685.960	716311.832	3'
194	84+74.47	-72.20 LT	147871.378	716104.492	29'
195	85+07.00	-77.00 LT	147904.282	716099.355	15'
196	85+84.91	-77.00 LT	147983.245	716099.317	15'

Addendum No. 01
 ID 2722-07-72
 Revised Sheet 66
 February 6, 2023

12 OF 17

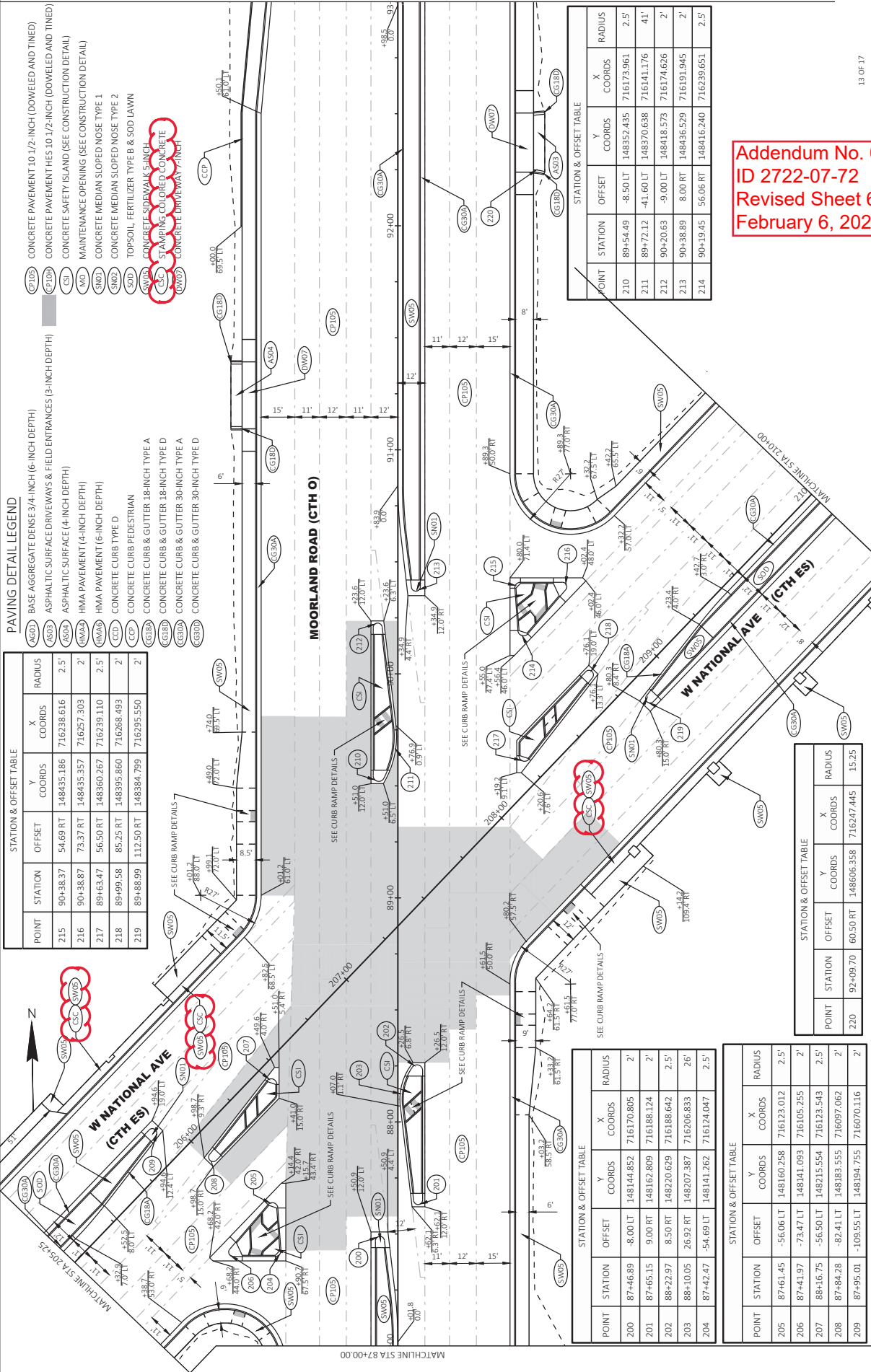

PAVING DETAIL LEGEND

- (AS03) BASE AGGREGATE DENSE 3/4-INCH (6-INCH DEPTH)
- (AS02) ASPHALTIC SURFACE DRIVEWAYS & FIELD ENTRANCES (3-INCH DEPTH)
- (AS01) ASPHALTIC SURFACE (4-INCH DEPTH)
- (HMA2) HMA PAVEMENT (4-INCH DEPTH)
- (HMA3) HMA PAVEMENT (6-INCH DEPTH)
- (CP105) CONCRETE CURB PEDESTRIAN
- (CP100) CONCRETE CURB PEDESTRIAN
- (CP101) CONCRETE CURB & GUTTER 18-INCH TYPE A
- (CP102) CONCRETE CURB & GUTTER 18-INCH TYPE D
- (CP103) CONCRETE CURB & GUTTER 30-INCH TYPE A
- (CP104) CONCRETE CURB & GUTTER 30-INCH TYPE D
- (SW05) CONCRETE SIDEWALK 5-INCH
- (CSC) STAMPING COLORED CONCRETE
- (DW07) CONCRETE DRIVEWAY 7-INCH

STATION & OFFSET TABLE			
POINT	STATION	OFFSET	RADIUS
215	90+38.37	54.69 RT	148435.186
216	90+38.87	73.37 RT	148435.357
217	89+63.47	56.50 RT	148360.267
218	89+95.58	85.25 RT	148395.860
219	89+88.99	112.50 RT	148384.799

STATION & OFFSET TABLE			
POINT	STATION	OFFSET	RADIUS
220	92+09.70	60.50 RT	148606.358
			15.25

STATION & OFFSET TABLE			
POINT	STATION	OFFSET	RADIUS
200	87+46.89	-8.00 LT	148144.852
201	87+65.15	9.00 RT	148162.809
202	88+22.97	8.50 RT	148202.629
203	88+10.05	-26.92 RT	148207.387
204	87+42.47	-54.69 LT	148141.262

STATION & OFFSET TABLE			
POINT	STATION	OFFSET	RADIUS
205	87+61.45	-56.06 LT	148160.258
206	87+41.97	-73.47 LT	148141.093
207	88+16.75	-56.50 LT	148215.554
208	87+84.28	-82.41 LT	148183.555
209	87+95.01	-109.55 LT	148194.755

STATION & OFFSET TABLE			
POINT	STATION	OFFSET	RADIUS
210	89+54.49	-8.50 LT	148352.435
211	89+72.12	-41.60 LT	148370.638
212	90+20.63	-9.00 LT	148418.573
213	90+38.89	8.00 RT	148436.529
214	90+19.45	56.06 RT	148416.240

Addendum No. 01
 ID 2722-07-72
 Revised Sheet 67
 February 6, 2023

PAVING DETAIL LEGEND

- (AS01) BASE AGGREGATE DENSE 3/4-INCH (6-INCH DEPTH)
- (AS02) ASPHALTIC SURFACE DRIVEWAYS & FIELD ENTRANCES (3-INCH DEPTH)
- (AS04) ASPHALTIC SURFACE (4-INCH DEPTH)
- (HM05) HMA PAVEMENT (4-INCH DEPTH)
- (HM06) HMA PAVEMENT (6-INCH DEPTH)
- (CC01) CONCRETE CURB TYPE D
- (CC02) CONCRETE CURB PEDESTRIAN
- (G100A) CONCRETE CURB & GUTTER 18-INCH TYPE A
- (G100B) CONCRETE CURB & GUTTER 18-INCH TYPE D
- (G300A) CONCRETE CURB & GUTTER 30-INCH TYPE A
- (G300B) CONCRETE CURB & GUTTER 30-INCH TYPE D
- (PT05) CONCRETE PAVEMENT 10 1/2-INCH (DOWELED AND TINED)
- (PT06) CONCRETE PAVEMENT HES 10 1/2-INCH (DOWELED AND TINED)
- (CS) CONCRETE SAFETY ISLAND (SEE CONSTRUCTION DETAIL)
- (MO) MAINTENANCE OPENING (SEE CONSTRUCTION DETAIL)
- (SM01) CONCRETE MEDIAN SLOPED NOSE TYPE 1
- (SM02) CONCRETE MEDIAN SLOPED NOSE TYPE 2
- (SOD) TOPSOIL - FERTILIZER TYPE B & SOD LAWN
- (SW05) CONCRETE SIDEWALK 5-INCH
- (CS-5) STAMPING COLORED CONCRETE
- (DN05) CONCRETE DRIVEWAY 7-INCH

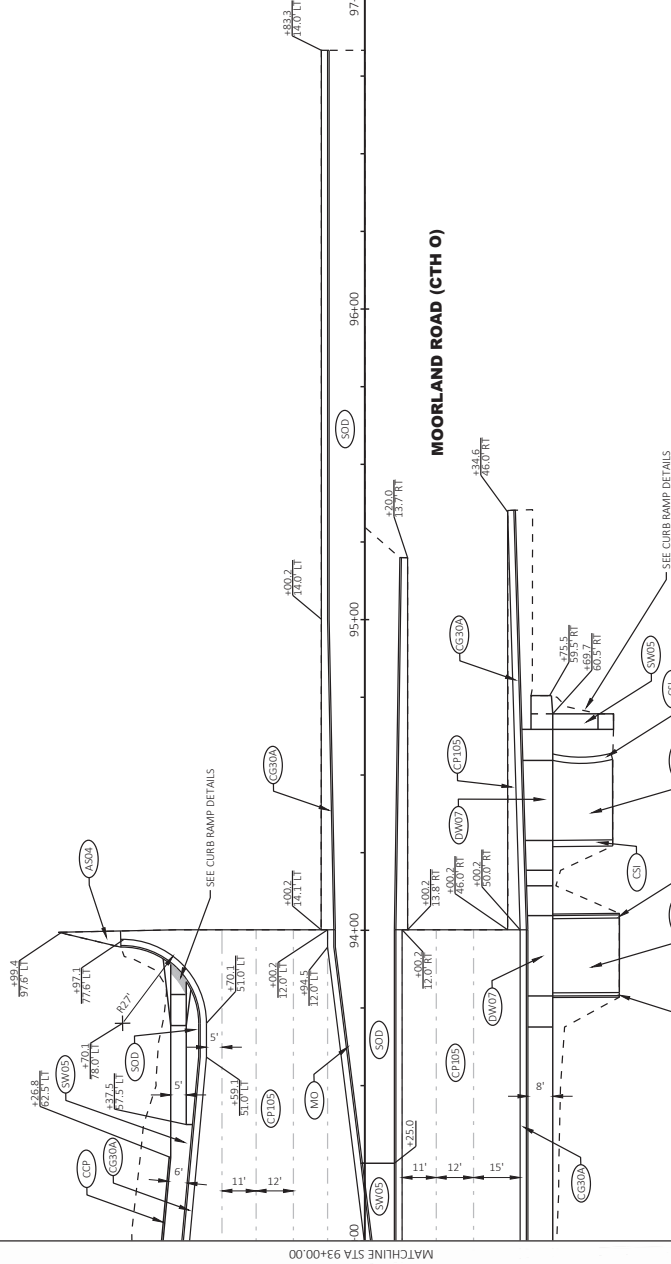

Addendum No. 01
 ID 2722-07-72
 Revised Sheet 68
 February 6, 2023

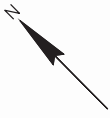

Addendum No. 01
ID 2722-07-72
Revised Sheet 69
February 6, 2023

15 OF 17

SHEET **69** E
WISDOT/CADDS SHEET 42

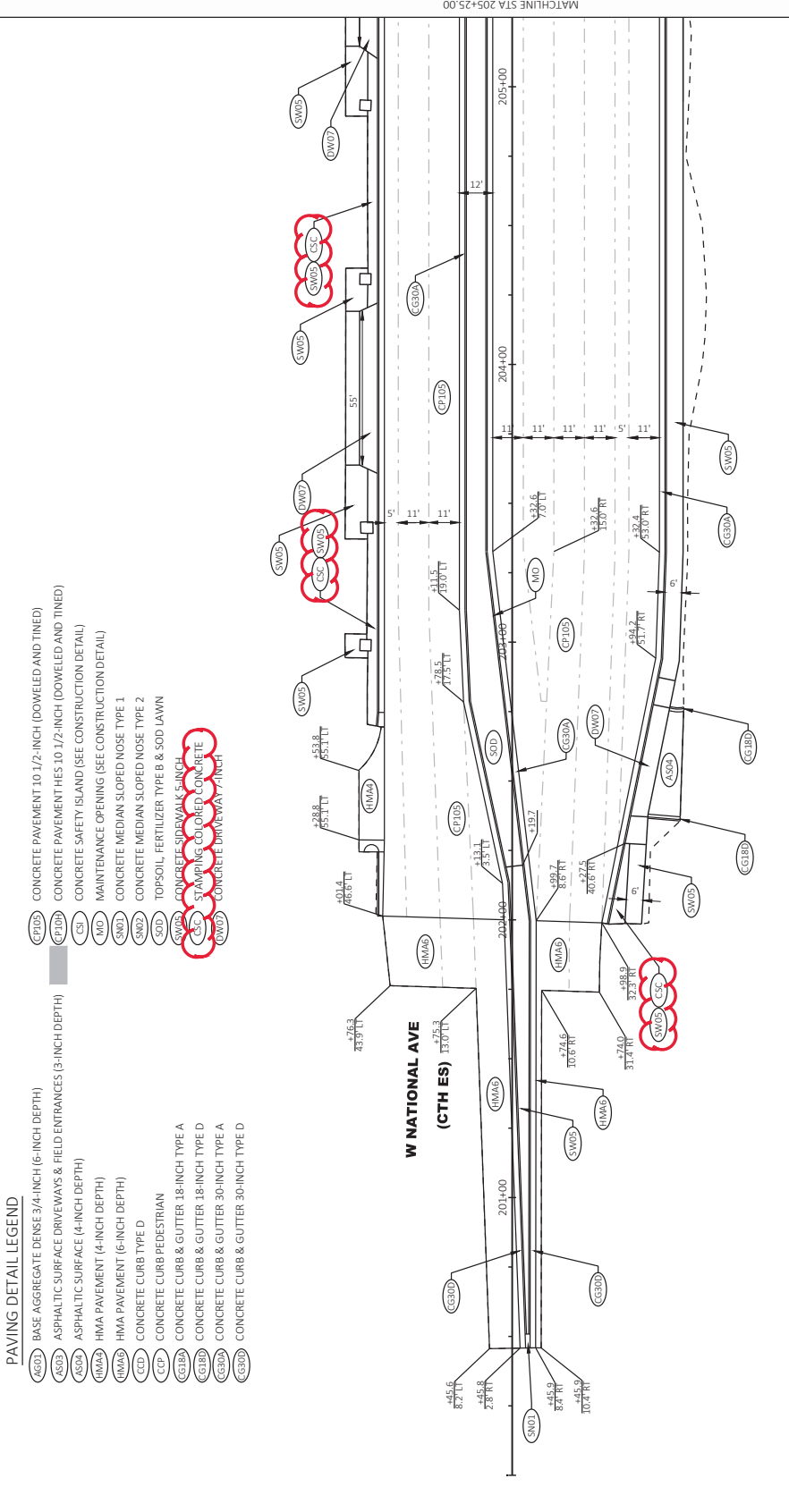

- PAVING DETAIL LEGEND**
- (460) BASE AGGREGATE DENSE 3/4-INCH (6-INCH DEPTH)
 - (4602) ASPHALTIC SURFACE DRIVEWAYS & FIELD ENTRANCES (3-INCH DEPTH)
 - (4604) ASPHALTIC SURFACE (4-INCH DEPTH)
 - (4606) HMA PAVEMENT (4-INCH DEPTH)
 - (4608) HMA PAVEMENT (6-INCH DEPTH)
 - (4610) CONCRETE CURB TYPE D
 - (4612) CONCRETE CURB PEDESTRIAN
 - (4614) CONCRETE CURB & GUTTER 18-INCH TYPE A
 - (4616) CONCRETE CURB & GUTTER 18-INCH TYPE D
 - (4618) CONCRETE CURB & GUTTER 30-INCH TYPE A
 - (4620) CONCRETE CURB & GUTTER 30-INCH TYPE D
 - (4622) CONCRETE PAVEMENT 10 1/2-INCH (DOWELED AND TINED)
 - (4624) CONCRETE PAVEMENT 10 1/2-INCH (DOWELED AND TINED)
 - (4626) CONCRETE SAFETY ISLAND (SEE CONSTRUCTION DETAIL)
 - (4628) MAINTENANCE OPENING (SEE CONSTRUCTION DETAIL)
 - (4630) CONCRETE MEDIAN SLOPED NOSE TYPE 1
 - (4632) CONCRETE MEDIAN SLOPED NOSE TYPE 2
 - (4634) TOPSOIL, FERTILIZER TYPE B & SOIL LAWN
 - (4636) CONCRETE SIDEWALK SUNCH
 - (4638) STAMPING COLORED CONCRETE
 - (4640) CONCRETE DRIVEWAY 7-INCH

PROJECT NO: 2722-07-72 HWY: CTH O COUNTY: WAUKESHA PAVING DETAILS PLOT NAME: 1 IN=40 FT PLOT SCALE: 1 IN=40 FT
 FILE NAME: T:\120800\C\WISDOT\27220772\SHEET\PLAN\021201.PD.DWG LAYOUT NAME: Sheet - 159
 FLOT BY: WHITEFOOT, DANIEL
 PLOT DATE: 2/7/2023 1:44 PM

PAVING DETAIL LEGEND

- (AGD1) BASE AGGREGATE DENSE 3/4-INCH (6-INCH DEPTH)
- (ASD3) ASPHALTIC SURFACE DRIVEWAYS & FIELD ENTRANCES (3-INCH DEPTH)
- (ASD4) ASPHALTIC SURFACE (4-INCH DEPTH)
- (HMA2) HMA PAVEMENT (4-INCH DEPTH)
- (HMA3) HMA PAVEMENT (6-INCH DEPTH)
- (CCT) CONCRETE CURB TYPE D
- (CCT) CONCRETE CURB PEDESTRIAN
- (G18A) CONCRETE CURB & GUTTER 18-INCH TYPE A
- (G18B) CONCRETE CURB & GUTTER 18-INCH TYPE D
- (G30A) CONCRETE CURB & GUTTER 30-INCH TYPE A
- (G30B) CONCRETE CURB & GUTTER 30-INCH TYPE D
- (EP10) CONCRETE PAVEMENT 10 1/2-INCH (DOWELED AND TINED)
- (EP10) CONCRETE PAVEMENT HES 10 1/2-INCH (DOWELED AND TINED)
- (CS) CONCRETE SAFETY ISLAND (SEE CONSTRUCTION DETAIL)
- (MO) MAINTENANCE OPENING (SEE CONSTRUCTION DETAIL)
- (SW1) CONCRETE MEDIAN SLOPED NOSE TYPE 1
- (SW2) CONCRETE MEDIAN SLOPED NOSE TYPE 2
- (SOD) TOPSOIL, FERTILIZER TYPE B & SOD LAWN
- (SOD) CONCRETE SIDEWALK 5-INCH
- (CSW) STAINING COLORED CONCRETE
- (DWO) CONCRETE DRIVEWAY 4-INCH

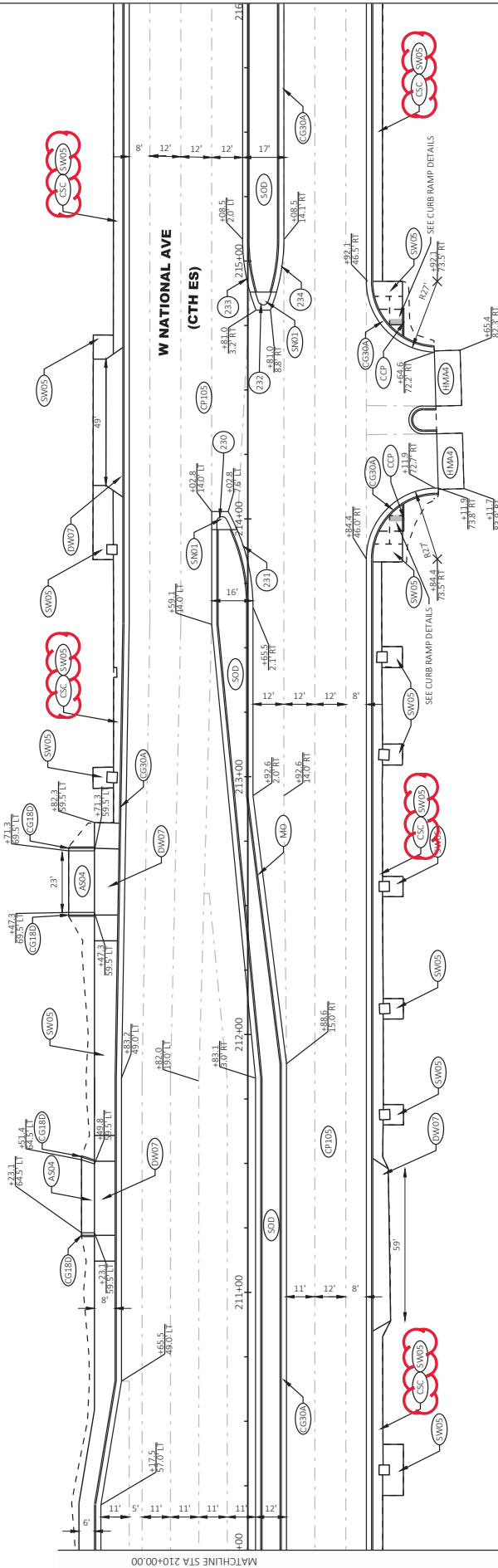
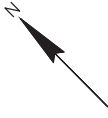

Addendum No. 01
 ID 2722-07-72
 Revised Sheet 70
 February 6, 2023

POINT	STATION	OFFSET	Y COORDS	X COORDS	RADIUS
230	93+75.14	453.14 RT	148764.884	716642.943	2'
231	93+95.06	385.00 RT	148786.002	716575.156	75'
232	94+26.30	524.28 RT	148814.783	716714.968	2'
233	93+96.93	588.92 RT	148784.284	716779.083	75'
234	94+89.60	492.13 RT	148878.646	716683.942	75'

PAVING DETAIL LEGEND

- (ASG2) BASE AGGREGATE DENSE 3/4-INCH (6-INCH DEPTH)
- (ASG3) ASPHALTIC SURFACE DRIVEWAYS & FIELD ENTRANCES (3-INCH DEPTH)
- (ASG4) ASPHALTIC SURFACE (4-INCH DEPTH)
- (HMA2) HMA PAVEMENT (4-INCH DEPTH)
- (HMA6) HMA PAVEMENT (6-INCH DEPTH)
- (CC1) CONCRETE CURB TYPE D
- (CC2) CONCRETE CURB TYPE B
- (G12B) CONCRETE CURB & GUTTER 18-INCH TYPE A
- (G13B) CONCRETE CURB & GUTTER 18-INCH TYPE D
- (G13D) CONCRETE CURB & GUTTER 30-INCH TYPE A
- (G13D) CONCRETE CURB & GUTTER 30-INCH TYPE D
- (E710B) CONCRETE PAVEMENT 10 1/2-INCH (DOWELED AND TINED)
- (E710D) CONCRETE PAVEMENT HES TO 1/2-INCH (DOWELED AND TINED)
- (CS1) CONCRETE SAFETY ISLAND (SEE CONSTRUCTION DETAIL)
- (M10) MAINTENANCE OPENING (SEE CONSTRUCTION DETAIL)
- (SW1) CONCRETE MEDIAN SLOPED NOSE TYPE 1
- (SW2) CONCRETE MEDIAN SLOPED NOSE TYPE 2
- (SW3) TOPSOIL, FERTILIZER TYPE B & SOD LAWN
- (SW4) CONCRETE SIDEWALK 5-INCH
- (CS2) STAMPING COLORED CONCRETE
- (OW1) CONCRETE DRIVEWAY 7-INCH

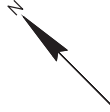

MATCHLINE STA 216+00.00

**W NATIONAL AVE
(CTH ES)**

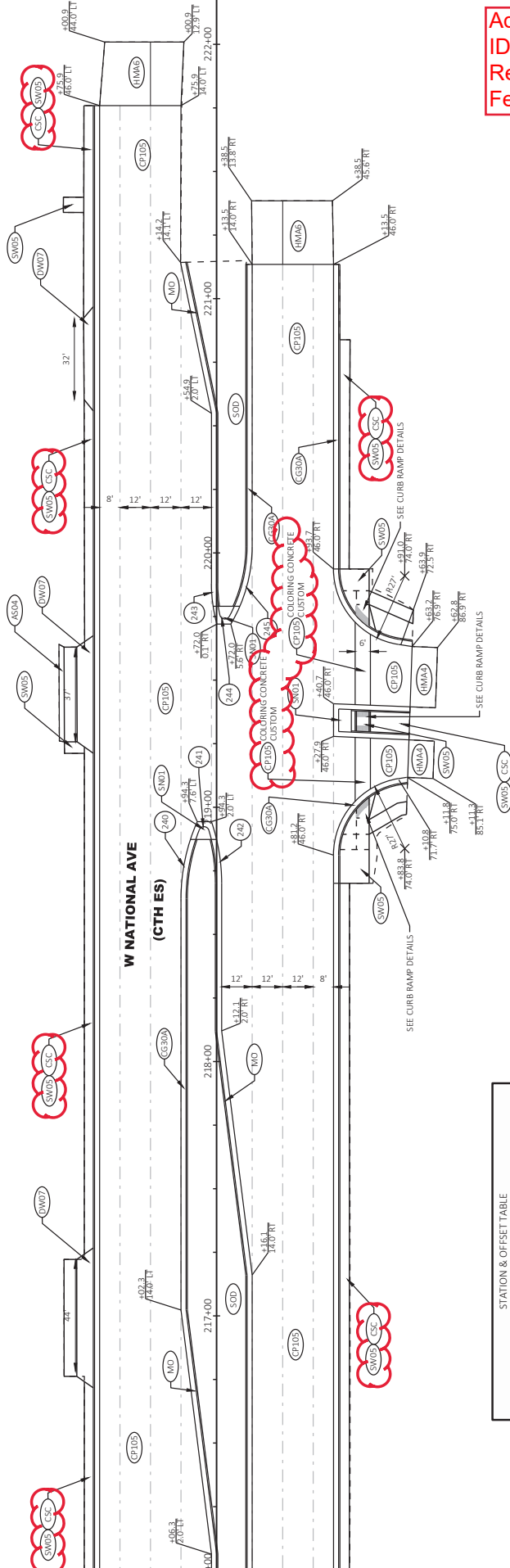

STATION & OFFSET TABLE					
POINT	STATION	OFFSET	Y COORDS	X COORDS	RADIUS
240	96+62.06	826.18 RT	149045.191	717020.974	3000'
241	97+26.66	796.71 RT	149110.296	716992.650	80'
242	97+59.12	733.57 RT	149143.865	716930.087	3000'
243	97+53.60	909.65 RT	149135.245	717106.041	2400'
244	97+82.87	861.91 RT	149165.357	717058.826	80'
245	98+36.17	844.72 RT	149218.950	717042.583	2400'

**Addendum No. 01
ID 2722-07-72
Revised Sheet 71
February 6, 2023**

17 OF 17

PROJECT NO: 2722-07-72

HWY: CTH O

COUNTY: WAUKESHA

PAVING DETAILS

SHEET

71

E

FILE NAME: T:\202800\C\WLS\27220772\3\SHEETPLAN\021201-PP.DWG

LAYOUT NAME: Sheet - 19

PLOT DATE: 2/7/2023 1:44 PM

PLOT BY: WHITEFOOT, DANIEL

PLOT SCALE: 1 IN=40 FT

WISDOT/CAD/SHEET 42

**Addendum No. 01
ID 2722-07-72
Revised Sheet 373
February 6, 2023**

ALL ITEMS ON THIS SHEET CATEGORY 0010

CONCRETE ITEMS

STATION TO	STATION	CONCRETE PAVEMENT 10 1/2-INCH SY	CONCRETE DRIVEWAY 7-INCH SY	DRILLED TIE BARS EACH	DRILLED DOWEL BARS EACH	CONCRETE CURB & GUTTER 18-INCH TYPED LF	CONCRETE CURB & GUTTER 30-INCH TYPED LF	CONCRETE CURB & GUTTER 30-INCH TYPED LF	CONCRETE CURB 5-INCH PEDESTRIAN LF	CONCRETE SIDEWALK 5-INCH SF	CONCRETE DETECTABLE YELLOW CURB RAMP SF	CONCRETE DETECTABLE WARNING FIELD RADIAL YELLOW SAFETY ISLANDS SF	CONCRETE MEDIAN SLOPED NOSE SF
CTH O (STAGE 3)													
17+04	- 21+00	215	---	6	---	242	---	389	---	1,390	---	---	19
21+00	- 27+00	---	---	---	---	---	---	27	---	29	---	---	5
27+00	- 39+00	---	---	---	---	---	---	---	---	---	---	---	---
39+00	- 45+00	---	---	---	---	---	---	---	---	---	---	---	---
45+00	- 51+00	---	---	---	---	---	---	---	---	---	---	---	---
51+00	- 57+00	---	---	---	---	---	---	---	---	---	---	---	---
57+00	- 63+00	---	---	---	---	---	---	---	---	---	---	---	---
63+00	- 69+00	---	---	---	---	---	---	---	---	---	---	---	---
69+00	- 75+00	---	---	---	---	---	---	---	---	---	---	---	---
75+00	- 81+00	---	---	---	---	---	---	---	---	---	---	---	---
81+00	- 87+00	---	---	---	---	---	---	---	---	---	---	---	---
87+00	- 93+00	---	---	---	---	---	---	521	---	1,748	---	---	19
93+00	- 99+00	---	---	166	---	---	---	604	---	477	---	---	---
TOTAL 0010		86,057	1,294	403	164	344	306	35,749	563	593	436	223	3,830
STAGE 3 SUBTOTAL		215	---	172	---	242	---	1,541	---	10	---	---	43

CONCRETE DRIVEWAY	416.0270	416.0270	HES 7-INCH SY
MOORLAND ROAD	416.0270	416.0270	HES 7-INCH SY
PRESTAGE	---	---	---
STAGE 1A	---	---	---
STAGE 1B	---	---	147
STAGE 1C	---	---	---
STAGE 2A	---	---	62
STAGE 2B	---	---	---
STAGE 2C	---	---	---
STAGE 3	---	---	---
TOTALS	---	---	209

CONCRETE PAVEMENT	415.1105	415.0210	HES 10 1/2 INCH GAPS EACH
CTH O	415.1105 <td>415.0210 <td>HES 10 1/2 INCH GAPS EACH</td> </td>	415.0210 <td>HES 10 1/2 INCH GAPS EACH</td>	HES 10 1/2 INCH GAPS EACH
PRE STAGE	---	---	---
STAGE 1A	---	---	6
STAGE 1B	248	---	6
STAGE 1C	544	---	4
STAGE 2A	600	---	8
STAGE 2B	933	---	---
STAGE 2C	---	---	---
STAGE 3	---	---	---
TOTALS	2,325	---	24



Proposal Schedule of Items

Proposal ID: 20230214022 Project(s): 2722-07-72

Federal ID(s): WISC 2023227

SECTION: 0001 Waukesha County Roadway Items

Alt Set ID: Alt Mbr ID:

Proposal Line Number	Item ID Description	Approximate Quantity and Units	Unit Price	Bid Amount
0090	460.6224 HMA Pavement 4 MT 58-28 S	65.000 TON	_____.	_____.
0092	465.0105 Asphaltic Surface	134.000 TON	_____.	_____.
0094	465.0120 Asphaltic Surface Driveways and Field Entrances	118.000 TON	_____.	_____.
0096	465.0125 Asphaltic Surface Temporary	524.000 TON	_____.	_____.
0098	520.8000 Concrete Collars for Pipe	73.000 EACH	_____.	_____.
0100	601.0405 Concrete Curb & Gutter 18-Inch Type A	344.000 LF	_____.	_____.
0102	601.0407 Concrete Curb & Gutter 18-Inch Type D	306.000 LF	_____.	_____.
0104	601.0409 Concrete Curb & Gutter 30-Inch Type A	35,749.000 LF	_____.	_____.
0106	601.0411 Concrete Curb & Gutter 30-Inch Type D	563.000 LF	_____.	_____.
0108	601.0600 Concrete Curb Pedestrian	593.000 LF	_____.	_____.
0110	602.0410 Concrete Sidewalk 5-Inch	40,806.000 SF	_____.	_____.
0112	602.0505 Curb Ramp Detectable Warning Field Yellow	436.000 SF	_____.	_____.
0114	602.0605 Curb Ramp Detectable Warning Field Radial Yellow	223.000 SF	_____.	_____.
0116	602.2400 Concrete Safety Islands	3,830.000 SF	_____.	_____.
0118	608.0342 Storm Sewer Pipe Reinforced Concrete Class III 42-Inch	97.000 LF	_____.	_____.