



Wisconsin Department of Transportation

March 9, 2023

Division of Transportation Systems Development

Bureau of Project Development
4822 Madison Yards Way, 4th Floor South
Madison, WI 53705

Telephone: (608) 266-1631
Facsimile (FAX): (608) 266-8459

NOTICE TO ALL CONTRACTORS:

Proposal #33: 1196-00-62
Minong – Solon Springs
Bus 53 (Minong) to Lakeside Rd (NB)
USH 53
Washburn County

Letting of March 14, 2023

This is Addendum No. 01, which provides for the following:

Special Provisions:

Added Special Provisions	
Article No.	Description
13	Removing Riprap, Item 204.9035.S.
14	Removing Apron Endwalls, Item 204.9060.S

Schedule of Items:

Revised Bid Item Quantities					
Bid Item	Item Description	Unit	Proposal Total Prior to Addendum	Proposal Quantity Change (-)	Proposal Total After Addendum
204.0120	Removing Asphaltic Surface Milling	SY	30,875	668	31,543
455.0605	Tack Coat	GAL	3,899	89	3,988
460.6244	HMA Pavement 4 MT 58-34 S	TON	3,363	224	3,587
643.0900	Traffic Control Signs	DAY	4,915	1840	6,755
643.3155	Temporary Marking Line Removable Contrast Tape 4-Inch	LF	200	2,000	2,200

Added Bid Item Quantities					
Bid Item	Item Description	Unit	Proposal Total Prior to Addendum	Quantity Added	Proposal Total After Addendum
204.9035.S	Removing Riprap	CY	0	5	5
204.9060.S	Removing Apron Endwalls	Each	0	2	2
625.0500	Salvaged Topsoil	SY	0	15	15

627.0200	Mulching	SY	0	15	15
630.0130	Seeding Mixture No. 30	LB	0	5	5

Plan Sheets:

Revised Plan Sheets	
Plan Sheet	Plan Sheet Title (brief description of changes to sheet)
3	Typical Sections (added 6-ft shoulder widening to inside lane)
6	Traffic Control (added 6-ft shoulder widening to stage 1 section)
17	Miscellaneous Quantities (Removing Asphaltic Surface Milling quantity updated)
20	Miscellaneous Quantities (Tack Coat/HMA Pavement 4MT58-34S quantity updated)
22	Miscellaneous Quantities (Traffic Control Signs quantity updated)
23	Miscellaneous Quantities (Temporary Marking Line Removable Contrast Tape 4-Inch quantity updated)

Added Plan Sheets	
Plan Sheet	Plan Sheet Title (brief description of why sheet was added)
25A	Miscellaneous Quantities (added bid items)
55A	SDD (add SDD 15c02-f Advance Width Restrictions Signing)

The responsibility for notifying potential subcontractors and suppliers of these changes remains with the prime contractor.

Sincerely,

Mike Coleman

Proposal Development Specialist
Proposal Management Section

ADDENDUM NO. 01

1196-00-62

March 9, 2023

Special Provisions

13. Removing Riprap, Item 204.9035.S.01

A Description

This special provision describes removing riprap conforming to standard spec 204.

B (Vacant)

C Construction

Carefully remove the riprap and dispose of all materials.

D Measurement

The department will measure Removing Riprap in cubic yard, acceptably completed.

E Payment

Add the following to standard spec 204.5:

ITEM NUMBER	DESCRIPTION	UNIT
204.9035.S	Removing Riprap	CY
stp-204-025 (20230113)		

14. Removing Apron Endwalls, Item 204.9060.S.01

A Description

This special provision describes removing apron endwalls conforming to standard spec 204.

B (Vacant)

C (Vacant)

D Measurement

The department will measure Removing Removing Apron Endwalls in each, acceptably completed.

E Payment

Add the following to standard spec 204.5:

ITEM NUMBER	DESCRIPTION	UNIT
204.9060.S	Removing Apron Endwalls	Each
stp-204-025 (20230113)		

Schedule of Items

Attached, dated March 9, 2023, are the revised Schedule of Items Pages 1 – 4.

Plan Sheets

The following 8½ x 11-inch sheets are attached and made part of the plans for this proposal:

Revised: 3, 6, 17, 20, 22, 23

Added: 25A, 55A

END OF ADDENDUM

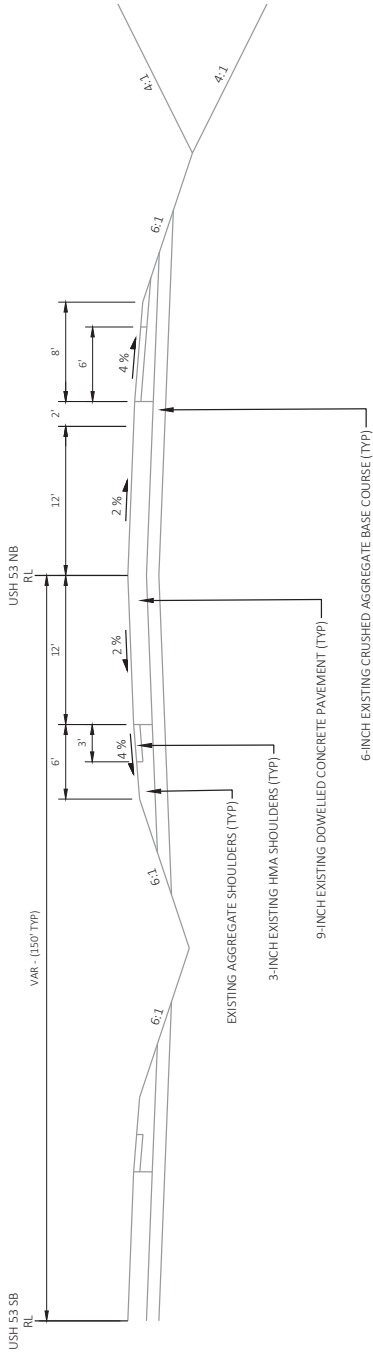

TYPICAL EXISTING SECTION

USH 53
STA 622+54 TO STA 751+39

Addendum No. 01
ID 1196-00-62
Revised Sheet 3
March 9, 2023

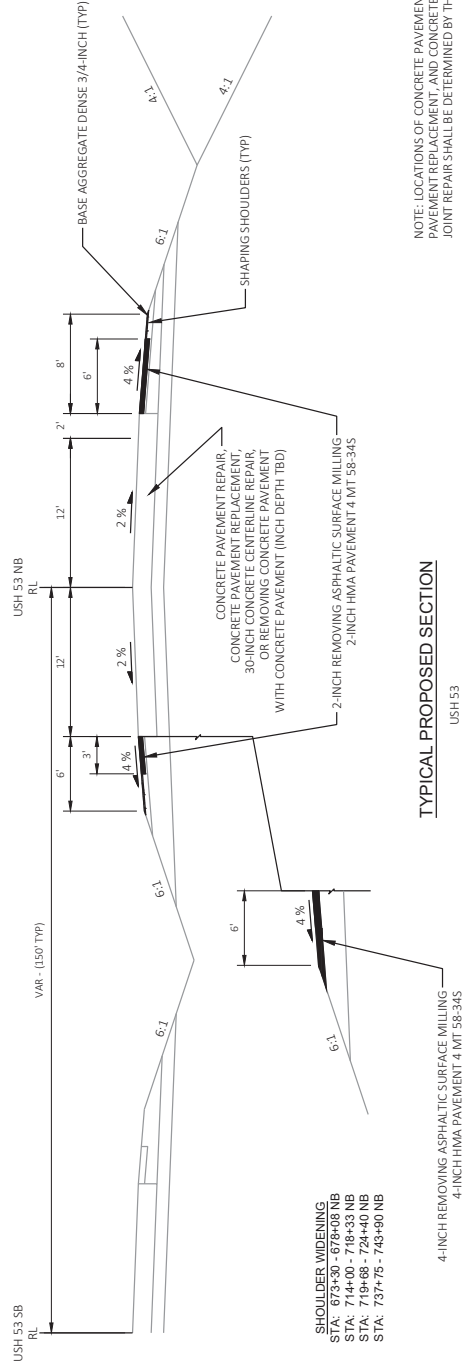

TYPICAL PROPOSED SECTION

USH 53
STA 622+54 TO STA 751+39

NOTE: LOCATIONS OF CONCRETE PAVEMENT REPAIR, CONCRETE PAVEMENT REPLACEMENT, AND CONCRETE PAVEMENT CENTERLINE JOINT REPAIR SHALL BE DETERMINED BY THE ENGINEER IN THE FIELD.

PROJECT NO: 1196-00-62	COUNTY: WASHBURN	TYPICAL SECTIONS	SHEET 3	E
FILE NAME: C:\CSD\11960032\USHEFSR\AND2050-15.DWG	FLYBY: THAO, KOU	PLOT NAME:	PLOT SCALE: 1 IN=10 FT	WISDOT/CADD SHEET 42
LAYOUT NAME: 003201-15-1.mxd	PLOT DATE: 3/09/2023 3:27 PM			
HWY: USH 53				

GENERAL NOTES

- BARRELS, SIGNS, BARRICADES, AND ARROW BOARDS SHALL BE PLACED ACCORDING TO:
- SDD 15012 "TRAFFIC CONTROL - LANE CLOSURE, SPEED REDUCTION"
- SDD 15015 "TRAFFIC CONTROL - PARALLEL ENTRANCE RAMP WITHIN LANE CLOSURE"
- SDD 15021 "TRAFFIC CONTROL, TAPERED ENTRANCE RAMP WITHIN LANE CLOSURE"
- SDD 15027 "TRAFFIC CONTROL, SHOULDER CLOSURE ON DIVIDED ROADWAY, SPEEDS GREATER THAN 40 MPH"
- SDD 15039 "TRAFFIC CONTROL, DROP-OFF SIGNING"
- SDD 15040 "TRAFFIC CONTROL, PARTIAL LANE SHIFT MULTILANE DIVIDED 50 MPH AND GREATER"

ALL SIGNS AND DEVICES SHALL BE IN CONFORMANCE WITH THE WISCONSIN MANUAL ON UNIFORM TRAFFIC CONTROL DEVICES (WMUTCD).

THE EXACT NUMBER, LOCATION, AND SPACING OF ALL TRAFFIC CONTROL DEVICES ARE APPROXIMATE AND SHALL BE ADJUSTED TO FIT FIELD CONDITIONS AS DIRECTED BY THE ENGINEER.

DURING HOURS OF DARKNESS ALL BARRICADES USED TO SHIELD A HAZARD SHALL BE EQUIPPED WITH WARNING LIGHTS, TYPE A.

ALL SIGNS ARE 48"x48" UNLESS OTHERWISE NOTED.

"W0" SIGNS ARE THE SAME AS "W" SIGNS EXCEPT THE BACKGROUND IS ORANGE.

DRUMS IN TAPERS SHALL BE EQUIPPED WITH TYPE C (STEADY BURN) TRAFFIC CONTROL WARNING LIGHTS.

ANY SIGNS TEMPORARY OR EXISTING WHICH CONFLICT WITH TRAFFIC CONTROL "IN USE" SHALL BE COVERED OR REMOVED AS NEEDED AND AS APPROVED BY THE ENGINEER.

USH 53 NB RIGHT TURN LANES SHALL BE OPEN WHEN THE OUTSIDE LANE IS CLOSED. INTERSECTION STAGING SHALL BE DETERMINED BY CONTRACTOR MEANS AND METHODS. INTERSECTION STAGING SHALL BE APPROVED BY THE ENGINEER PRIOR TO DEPLOYMENT.

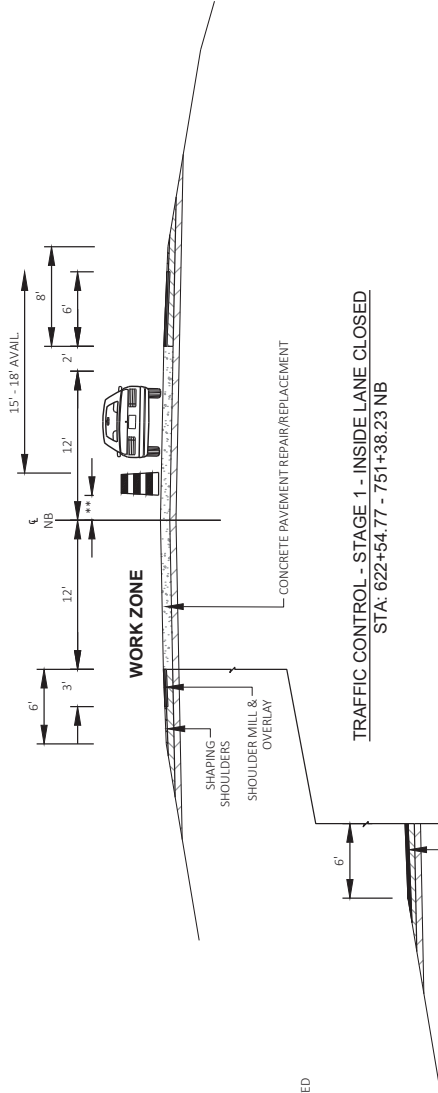

TRAFFIC CONTROL - STAGE 1 - INSIDE LANE CLOSED
 STA: 622+54.77 - 751+38.23 NB

- ** NOTE
- 0" TYP. FOR CENTERLINE JOINT REPAIR
 - UP TO 3" FOR CONCRETE PAVEMENT 9-INCH

SHOULDER WIDENING

- STA: 673+30 - 678+08 NB
- STA: 714+00 - 718+33 NB
- STA: 719+68 - 724+40 NB
- STA: 737+75 - 743+90 NB

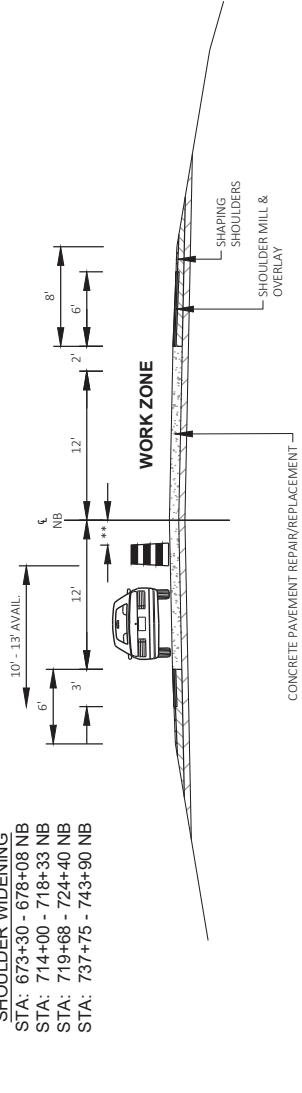

TRAFFIC CONTROL - STAGE 2 - OUTSIDE LANE CLOSED
 STA: 622+54.77 - 751+38.23 NB

Addendum No. 01
 ID 1196-00-62
 Revised Sheet 6
 March 9, 2023

CATEGORY	STATION	TO	STATION	LOCATION	SY	REMARKS
0010	674+82	-	684+33	RT	1,480	
0010	685+38	-	694+89	RT	1,480	
0010	715+48	-	718+65	RT	494	
0010	719+17	-	722+87	RT	576	
0010	739+24	-	742+41	RT	494	
TOTAL 0010					4,524	

CATEGORY	LOCATION	SY	REMARKS
0010	PROJECT	600	UNDISTRIBUTED
TOTAL 0010		600	

CATEGORY	STATION	TO	STATION	LOCATION	SY	REMARKS	
204.0120	REMOVING ASPHALTIC SURFACE MILLING					4,524	

CATEGORY	STATION	TO	STATION	LOCATION	SY	REMARKS
0010	624+55	-	642+48	NB LEFT ASPHALT SHOULDER	665	PROJECT BEGIN LIMIT
0010	642+48	-	644+06	MINONG SOUTH BUSINESS 53 MEDIAN	591	
0010	644+06	-	664+37	NB LEFT ASPHALT SHOULDER	677	
0010	664+37	-	665+39	MEDIAN	588	
0010	665+39	-	673+30	NB LEFT ASPHALT SHOULDER	264	
0010	673+30	-	678+08	NB LEFT ASPHALT SHOULDER	319	NORTH LIMIT AT RECENT PAVING
0010	698+18	-	702+05	NB LEFT ASPHALT SHOULDER	129	6-FT SHLD WIDENING
0010	702+05	-	703+85	WALLACE ST MEDIAN	680	SOUTH LIMIT AT RECENT PAVING
0010	703+85	-	714+00	NB LEFT ASPHALT SHOULDER	339	
0010	714+00	-	718+33	NB LEFT ASPHALT SHOULDER	289	6-FT SHLD WIDENING
0010	718+33	-	719+68	MINONG NORTH BUSINESS 53 MEDIAN	445	
0010	719+68	-	724+40	NB LEFT ASPHALT SHOULDER	315	6-FT SHLD WIDENING
0010	724+40	-	737+75	NB LEFT ASPHALT SHOULDER	445	
0010	737+75	-	743+90	NB LEFT ASPHALT SHOULDER	410	6-FT SHLD WIDENING
0010	743+90	-	751+38	NB LEFT ASPHALT SHOULDER	250	PROJECT END LIMIT
0010	616+87	-	645+98	SOUTH BUSINESS 53 & RAMPS	11,725	
0010	624+55	-	640+77	NB RIGHT ASPHALT SHOULDER	1,215	PROJECT BEGIN LIMIT
0010	640+77	-	644+30	RIGHT TURN LANE & MINONG SOUTH BUSINESS 53	811	
0010	644+30	-	677+08	NB RIGHT ASPHALT SHOULDER	2,186	
0010	683+78	-	689+58	RIGHT TURN LANE & SHOULDER THROUGH 5TH 77	733	NORTH LIMIT AT RECENT PAVING
0010	689+58	-	702+24	NB RIGHT ASPHALT SHOULDER	844	SOUTH LIMIT AT RECENT PAVING
0010	702+24	-	703+79	NB RIGHT ASPHALT SHOULDER & WALLACE ST	376	
0010	703+79	-	714+54	NB RIGHT ASPHALT SHOULDER	171	
0010	714+54	-	720+43	RIGHT TURN LANE & MINONG NORTH BUSINESS 53	1,401	
0010	719+03	-	725+28	NORTH BUSINESS 53 & RAMPS	2,546	
0010	720+43	-	726+20	NB RIGHT ASPHALT SHOULDER	385	
0010	725+35	-	726+20	NB RAMP LEFT ASPHALT SHOULDER	29	
0010	725+35	-	729+73	NB RIGHT GORE AREA	433	
0010	725+35	-	751+38	NB RAMP / MAINLINE RIGHT ASPHALT SHOULDER	1,736	PROJECT END LIMIT
TOTAL 0010					31,543	

CATEGORY	STATION	LOCATION	CY	REMARKS
0010	645+90	RT	68	REPAIR ONE-FOOT DROP OFF
TOTAL 0010			68	

CATEGORY	LOCATION	LS	REMARKS
0010	PROJECT	1	SHLDS, TURNLANES, ROADWAY, RAMPS
TOTAL 0010		1	

CATEGORY	LOCATION	EACH	REMARKS
0010	PROJECT	1	PROJECT LIMITS
TOTAL 0010		1	

Addendum No. 01
ID 1196-00-62
Revised Sheet 17
March 9, 2023

Addendum No. 01
ID 1196-00-62
Revised Sheet 20
March 9, 2023

CATEGORY	STATION	TO	STATION	LOCATION	455.0605 TACK COAT GAL	460.6244 HMA PAVEMENT 4 MT 58-34 S TON	465.0110 ASPHALTIC SURFACE PATCHING TON	465.0400 ASPHALTIC SHOULDER RUMBLE STRIPS LF	REMARKS
									ALL LOCATIONS HAVE BEEN MULTIPLIED BY 2 FOR TACK COAT TO ESTIMATE WITH 2 LIFTS
									PROJECT BEGIN LIMIT
0010	622+55	-	642+48	NB LEFT ASPHALT SHOULDER	87	75	1,993		
0010	642+48	-	644+06	MINONG SOUTH BUSINESS 53 MEDIAN	77	67			
0010	644+06	-	664+37	NB LEFT ASPHALT SHOULDER	89	76	2,031		
0010	664+37	-	665+39	MEDIAN	38	33			
0010	665+39	-	673+30	NB LEFT ASPHALT SHOULDER	35	30			
0010	673+30	-	678+08	NB LEFT ASPHALT SHOULDER	42	72			NORTH LIMIT AT RECENT PAVING
0010	698+18	-	702+05	NB LEFT ASPHALT SHOULDER	17	15			6-FT SHLD WIDENING
0010	702+05	-	703+85	WALLACE ST MEDIAN	51	44			SOUTH LIMIT AT RECENT PAVING
0010	703+85	-	714+00	NB LEFT ASPHALT SHOULDER	44	38			
0010	714+00	-	718+33	NB LEFT ASPHALT SHOULDER	38	65	1,015		6-FT SHLD WIDENING
0010	718+33	-	719+68	MINONG NORTH BUSINESS 53 MEDIAN	34	30			
0010	719+68	-	724+40	NB LEFT ASPHALT SHOULDER	41	71	472		6-FT SHLD WIDENING
0010	724+40	-	737+75	NB LEFT ASPHALT SHOULDER	58	50	1,335		
0010	737+75	-	743+90	NB LEFT ASPHALT SHOULDER	54	92	615		6-FT SHLD WIDENING
0010	743+90	-	751+38	NB LEFT ASPHALT SHOULDER	33	28	748		PROJECT END LIMIT
0010	616+87	-	645+98	SOUTH BUSINESS 53 & RAMPS	1,525	1,314			
0010	622+55	-	640+77	NB RIGHT ASPHALT SHOULDER	158	137	1,822		PROJECT BEGIN LIMIT
0010	640+77	-	644+30	RIGHT TURN LANE & MINONG SOUTH BUSINESS 53	106	91			
0010	644+30	-	677+08	NB RIGHT ASPHALT SHOULDER	285	245			
0010	683+78	-	689+58	RIGHT TURN LANE & SHOULDER THROUGH 5TH 77	96	82	3,278		NORTH LIMIT AT RECENT PAVING
0010	689+58	-	702+24	NB RIGHT ASPHALT SHOULDER	110	95	1,266		SOUTH LIMIT AT RECENT PAVING
0010	702+24	-	703+79	NB RIGHT ASPHALT SHOULDER & WALLACE ST	44	38			
0010	703+79	-	714+54	NB RIGHT ASPHALT SHOULDER	94	81	1,075		
0010	714+54	-	720+43	RIGHT TURN LANE & MINONG NORTH BUSINESS 53	163	140			
0010	719+03	-	725+28	NORTH BUSINESS 53 & RAMPS	331	286			
0010	720+43	-	726+20	NB RIGHT ASPHALT SHOULDER	51	44			
0010	725+35	-	726+20	NB RAMP LEFT ASPHALT SHOULDER	4	4	577		
0010	725+35	-	729+73	NB RIGHT GORE AREA	57	49	85		
0010	725+35	-	751+38	NB RAMP/MAINLINE RIGHT ASPHALT SHOULDER	226	195	2,603		PROJECT END LIMIT
				PROJECT	3,988	3,587			UNDISTRIBUTED
				TOTAL 0010			200		
							21,442		

Addendum No. 01
ID 1196-00-62
Revised Sheet 22
March 9, 2023

CATEGORY	LOCATION	DAY	REMARKS	643.0300	643.0420	643.0705	643.0715	643.0800	643.0900	643.1050	643.5000	REMARKS
0010	PROJECT START	1,900	PROJECT START	50	100	700	100	100	650	1	1	PER SDD TRAFFIC CONTROL, LANE CLOSURE SPEED REDUCTION
0010	PROJECT START	1,000	PROJECT START	100	200	250	250	200	200			PER SDD TRAFFIC CONTROL, PARALLEL EXIT RAMP WITH LANE CLOSURE
0010	WALLACE ST, WOODWARD ENTRANCE	1,300		100				700	700			RIGHT LANE CLOSED; NO RTL BAY
0010	BUS 53 SOUTH, STH 77, BUS 53 NORTH	7,650		150				1,050	1,050			RIGHT LANE CLOSED; RTL BAY
0010	BUS 53 SOUTH, MEDIUM I., WALLACE ST, BUS 53 NORTH	3,400		200				1,200	1,200			LEFT LANE CLOSED; NO LTL BAY
0010	BUS 53 SOUTH & NORTH RAMPS	810		135		495		315	315			RAMP CLOSURES
0010	STH 77	2,750		50				300	300			LEFT LANE CLOSED; LTL BAY
0010	MAINLINE LENGTH	6,250		500		1,000		500	500			APPROX 12,500 LF
0010	PROJECT									30		ESTIMATING 3 PCMS FOR 10 DAYS PRECONSTRUCTION ANNOUNCEMENT
0010	USH 53 NB, LANE WIDTH RESTRICTIONS											PER SDD 15 COZ-F ADVANCED WIDTH RESTRICTIONS SIGNING
	TOTAL 0010	25,060		1,285	1,390	1,445	100	100	6,755	30	1	

CATEGORY	STATION	LOCATION	645.0120 GEOTEXTILE TYPE HR SY	REMARKS
0010	645+90	RT	173	REPAIR ONE-FOOT DROP OFF
	TOTAL 0010		173	

Addendum No. 01
ID 1196-00-62
Revised Sheet 23
March 9, 2023

STATION TO STATION	LOCATION	MARKING LINE GROOVED WET REF CONTRAST EPOXY 4-INCH LF	MARKING LINE GROOVED WET REF CONTRAST EPOXY 8-INCH LF	MARKING ARROW EPOXY EACH	MARKING WORD EPOXY EACH	MARKING STOP LINE EPOXY 18-INCH LF	REMARKS
616+87 - 645+98	SOUTH BUSINESS 53 & RAMPS	4,345				16	WHITE
616+87 - 645+98	SOUTH BUSINESS 53 & RAMPS	4,270					YELLOW
622+54 - 642+60	RT EDGELINE	2,006					WHITE
641+30 - 642+60	RIGHT TURN LANE CHANNELIZING		130	1	1	20	RIGHT TURN ARROW; "ONLY"
641+13 - 642+51	RIGHT TURN LANE						WHITE
643+50 - 643+50	BUS 53 SOUTH; RT						WHITE
644+00 - 687+38	RT EDGELINE	4,338					WHITE
681+50 - 682+50	RIGHT TURN LANE						WHITE
683+75 - 687+40	RIGHT TURN LANE CHANNELIZING		365	1	1		RIGHT TURN ARROW; "ONLY"
685+50 - 686+50	RIGHT TURN LANE						WHITE
688+87 - 702+30	RT EDGELINE	1,343					WHITE
703+30 - 718+61	RT EDGELINE	1,531					WHITE
715+10 - 718+60	RIGHT TURN LANE CHANNELIZING		350	1	1		RIGHT TURN ARROW; "ONLY"
715+41 - 715+85	RIGHT TURN LANE						WHITE
718+05 - 718+45	RIGHT TURN LANE						WHITE
719+03 - 725+28	NORTH BUSINESS 53 & RAMPS	1,237				20	RIGHT TURN ARROW; "ONLY"
719+03 - 725+28	NORTH BUSINESS 53 & RAMPS	1,078					YELLOW
719+50 - 719+50	BUS 53 NORTH; RT						WHITE
719+92 - 733+31	RT EDGELINE INTO LEFT GORE	1,339					WHITE
725+35 - 733+31	BUS 53 NORTH RAMP LT EDGELINE INTO RIGHT GORE	796					WHITE
725+35 - 751+39	RT EDGELINE	2,604					WHITE
622+54 - 642+72	LT EDGELINE	2,018					YELLOW
643+50 - 643+50	BUS 53 SOUTH MEDIUM (BOTH DIRECTIONS); LT					60	YELLOW
644+06 - 686+63	LT EDGELINE	4,257					YELLOW
681+60 - 682+50	LEFT TURN LANE						WHITE
683+75 - 687+60	LEFT TURN LANE CHANNELIZING		385	1	1		LEFT TURN ARROW; "ONLY"
685+50 - 686+50	LEFT TURN LANE						WHITE
688+46 - 702+20	LT EDGELINE	1,374					LEFT TURN ARROW; "ONLY"
703+62 - 718+46	LT EDGELINE	1,484					YELLOW
719+66 - 751+39	LT EDGELINE	3,173					YELLOW
622+54 - 751+39	RL, ON LEFT LANE PANEL	3,225					WHITE SKIPS
TOTAL 0010		40,418	1,230	7	7	116	
CATEGORY		STATION TO STATION		LOCATION		REMARKS	
0010	607+70 - 611+20	RT	350				SDD TRAFFIC CONTROL PARALLEL EXIT RAMP WITHIN LANE CLOSURE
0010	607+70 - 609+70	RT	200				WHITE TAPE; SDD TRAFFIC CONTROL PARALLEL EXIT RAMP WITHIN LANE CLOSURE
0010	612+85 - 614+85	RT	2,000			400	WHITE TAPE; SDD TRAFFIC CONTROL PARALLEL EXIT RAMP WITHIN LANE CLOSURE
0010	673+30 - 743+90	LT	2,200			400	INSIDE SHOULDER WIDENING LOCATIONS; SEE ASHALTIC SURFACE TEMPORARY ITEM
TOTAL 0010		350	400				

Addendum No. 01
ID 1196-00-62
Added Sheet 25A
March 9, 2023

CULVERT PIPE AEW RESTORATION

204.9035.S.01	204.9060.S.01	625.0500	627.0200	630.0130
REMOVING RIPRAP CY	REMOVING APRON ENDWALLS EACH	SALVAGED TOPSOIL SY	MULCHING SY	SEEDING MIXTURE NO. 30 LB
5	1	10	10	3
-	1	5	5	2
5	2	15	15	5
TOTAL 0010				

REMARKS
REPAIR OF ONE-FOOT DROP AT ENDWALL (CONCRETE)
REPLACES 24-INCH CONCRETE AEW

PROJECT NO: 1196-00-62

HWY: USH 53

COUNTY: WASHBURN

MISCELLANEOUS QUANTITIES

SHEET: 25A

E

FILE NAME: N:\PDS\11960000.mxd

PLOT DATE: March 8, 2023

PLOT BY: A.R.H.

PLOT SCALE: 1:1



SDD 15C02-f Advanced Width Restriction Signing

LEGEND
SIGN ON PERMANENT SUPPORT

GENERAL NOTES

THE EXACT NUMBER, LOCATION AND SPACING OF ALL SIGNS SHALL BE ADJUSTED TO FIT FIELD CONDITIONS AS APPROVED BY THE ENGINEER.

THE SPACING BETWEEN SIGNS SHOULD BE ADJUSTED TO NOT CONFLICT WITH ANY OTHER SIGNS. A MINIMUM OF 200 FEET CLEARANCE TO EXISTING SIGNS THAT WILL REMAIN IN PLACE.

ANY SIGNS TEMPORARY OR EXISTING, WHICH CONFLICT WITH TRAFFIC CONTROL - "IN USE" - SHALL BE REMOVED OR COVERED AS NEEDED AND AS APPROVED BY THE ENGINEER.

ALL SIGNS ARE 48" X 48" UNLESS OTHERWISE NOTED.

"W" SIGNS ARE THE SAME AS "M" SIGNS EXCEPT THE BACKGROUND IS ORANGE.

WIDTH ON SIGN TO BE APPROXIMATELY ONE FOOT LESS THAN AVAILABLE WIDTH.

PLACE 500 FEET AFTER THE W20 - 1A AND 500 FEET BEFORE ADDITIONAL SIGNS FOR ROADWAYS WITH A PRE - CONSTRUCTION SPEED LIMIT OF 45 MPH OR MORE. FOR 35-40 MPH, USE 350 FOOT TYPICAL SPACING. FOR 25-30 MPH, USE 200 FOOT TYPICAL SPACING.

SIGN SHALL BE VISIBLE FROM ROADWAY.

ADDITIONAL SIGNS NEEDED IF THERE IS AN ON RAMP BETWEEN SIGNS.

*
**

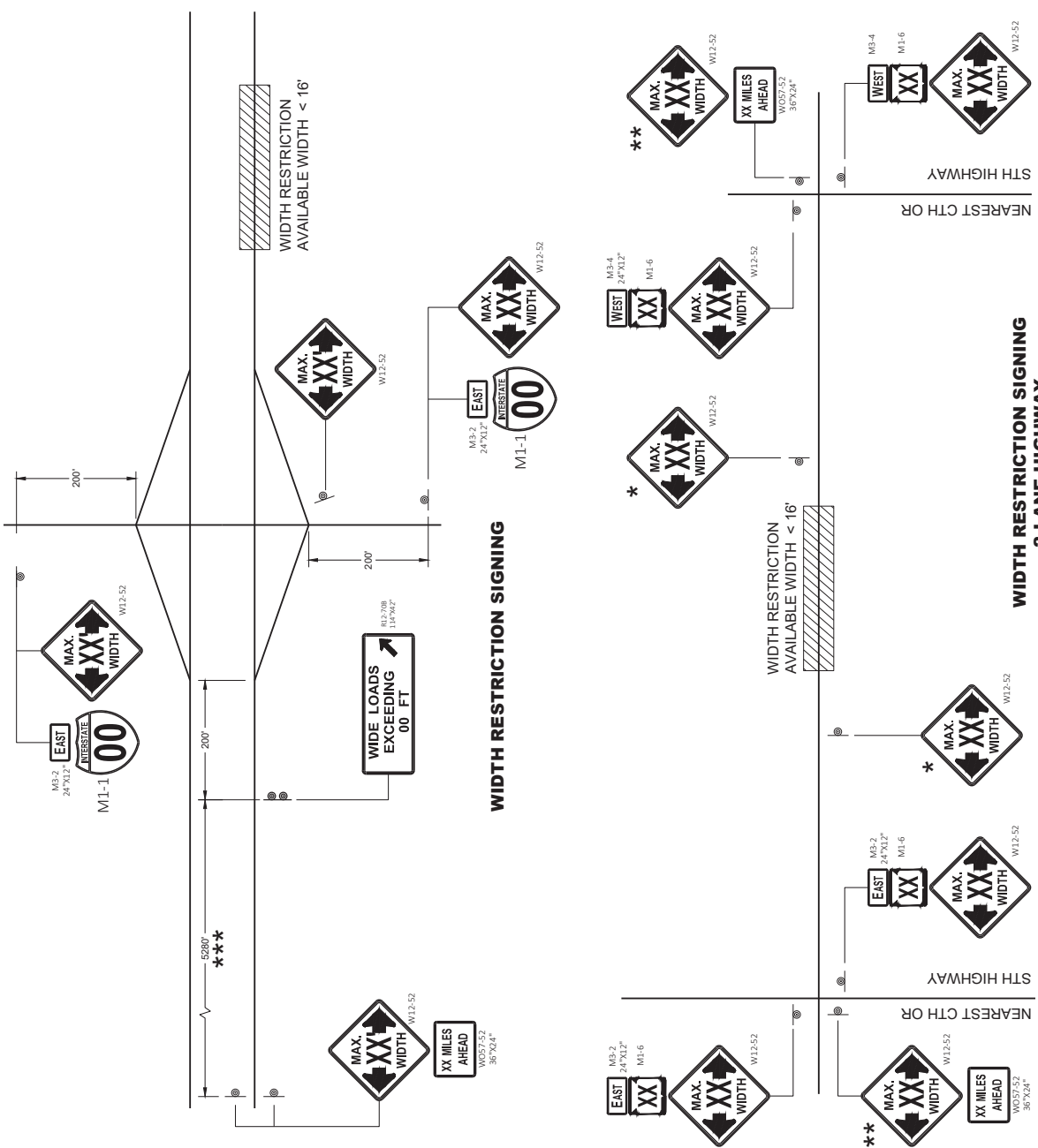

WIDTH RESTRICTION SIGNING

WIDTH RESTRICTION SIGNING 2 LANE HIGHWAY

Addendum No. 01
ID 1196-00-62
Added Sheet 55A
March 9, 2023



WIDTH ON SIGN TO BE APPROX. 1-FOOT LESS THAN AVAILABLE WIDTH

ADVANCED WIDTH RESTRICTION SIGNING

STATE OF WISCONSIN
DEPARTMENT OF TRANSPORTATION

APPROVED
February 2020
DATE
/S/ Andrew Hedling
WORK-ZONE ENGINEER



Proposal Schedule of Items

Proposal ID: 20230314033 Project(s): 1196-00-62

Federal ID(s): N/A

SECTION: 0001

Contract Items

Alt Set ID:

Alt Mbr ID:

Proposal Line Number	Item ID Description	Approximate Quantity and Units	Unit Price	Bid Amount
0002	204.0100 Removing Concrete Pavement	4,524.000 SY	_____.	_____.
0004	204.0115 Removing Asphaltic Surface Butt Joints	600.000 SY	_____.	_____.
0006	204.0120 Removing Asphaltic Surface Milling	31,543.000 SY	_____.	_____.
0008	208.1100 Select Borrow	68.000 CY	_____.	_____.
0010	211.0101 Prepare Foundation for Asphaltic Paving (project) 01. 1196-00-62	1.000 EACH	_____.	_____.
0012	213.0100 Finishing Roadway (project) 01. 1196-00-62	1.000 EACH	_____.	_____.
0014	305.0110 Base Aggregate Dense 3/4-Inch	360.000 TON	_____.	_____.
0016	305.0120 Base Aggregate Dense 1 1/4-Inch	94.000 TON	_____.	_____.
0018	305.0500 Shaping Shoulders	318.000 STA	_____.	_____.
0020	415.0090 Concrete Pavement 9-Inch	4,524.000 SY	_____.	_____.
0022	416.0610 Drilled Tie Bars	1,819.000 EACH	_____.	_____.
0024	416.0620 Drilled Dowel Bars	610.000 EACH	_____.	_____.
0026	455.0605 Tack Coat	3,988.000 GAL	_____.	_____.
0028	460.2000 Incentive Density HMA Pavement	2,160.000 DOL	1.00000	2,160.00
0030	460.6244 HMA Pavement 4 MT 58-34 S	3,587.000 TON	_____.	_____.
0032	465.0110 Asphaltic Surface Patching	200.000 TON	_____.	_____.



Proposal Schedule of Items

Proposal ID: 20230314033 Project(s): 1196-00-62

Federal ID(s): N/A

SECTION: 0001

Contract Items

Alt Set ID:

Alt Mbr ID:

Proposal Line Number	Item ID Description	Approximate Quantity and Units	Unit Price	Bid Amount
0034	465.0400 Asphaltic Shoulder Rumble Strips	21,442.000 LF	_____.	_____.
0036	520.1024 Apron Endwalls for Culvert Pipe 24-Inch	2.000 EACH	_____.	_____.
0038	520.8700 Cleaning Culvert Pipes	3.000 EACH	_____.	_____.
0040	606.0200 Riprap Medium	5.000 CY	_____.	_____.
0042	618.0100 Maintenance And Repair of Haul Roads (project) 01. 1196-00-62	1.000 EACH	_____.	_____.
0044	619.1000 Mobilization	1.000 EACH	_____.	_____.
0046	624.0100 Water	25.000 MGAL	_____.	_____.
0048	628.1504 Silt Fence	330.000 LF	_____.	_____.
0050	628.1520 Silt Fence Maintenance	50.000 LF	_____.	_____.
0052	628.1905 Mobilizations Erosion Control	2.000 EACH	_____.	_____.
0054	628.1910 Mobilizations Emergency Erosion Control	2.000 EACH	_____.	_____.
0056	628.7504 Temporary Ditch Checks	75.000 LF	_____.	_____.
0058	633.5200 Markers Culvert End	24.000 EACH	_____.	_____.
0060	642.5001 Field Office Type B	1.000 EACH	_____.	_____.
0062	643.0300 Traffic Control Drums	25,060.000 DAY	_____.	_____.
0064	643.0420 Traffic Control Barricades Type III	1,285.000 DAY	_____.	_____.



Proposal Schedule of Items

Proposal ID: 20230314033 Project(s): 1196-00-62

Federal ID(s): N/A

SECTION: 0001

Contract Items

Alt Set ID:

Alt Mbr ID:

Proposal Line Number	Item ID Description	Approximate Quantity and Units	Unit Price	Bid Amount
0066	643.0705 Traffic Control Warning Lights Type A	1,390.000 DAY	_____.	_____.
0068	643.0715 Traffic Control Warning Lights Type C	1,445.000 DAY	_____.	_____.
0070	643.0800 Traffic Control Arrow Boards	100.000 DAY	_____.	_____.
0072	643.0900 Traffic Control Signs	6,755.000 DAY	_____.	_____.
0074	643.1050 Traffic Control Signs PCMS	30.000 DAY	_____.	_____.
0076	643.3155 Temporary Marking Line Removable Contrast Tape 4-Inch	2,200.000 LF	_____.	_____.
0078	643.3255 Temporary Marking Line Removable Contrast Tape 8-Inch	400.000 LF	_____.	_____.
0080	643.5000 Traffic Control	1.000 EACH	_____.	_____.
0082	645.0120 Geotextile Type HR	173.000 SY	_____.	_____.
0084	646.1545 Marking Line Grooved Wet Ref Contrast Epoxy 4-Inch	40,418.000 LF	_____.	_____.
0086	646.3545 Marking Line Grooved Wet Ref Contrast Epoxy 8-Inch	1,230.000 LF	_____.	_____.
0088	646.5020 Marking Arrow Epoxy	7.000 EACH	_____.	_____.
0090	646.5120 Marking Word Epoxy	7.000 EACH	_____.	_____.
0092	646.6120 Marking Stop Line Epoxy 18-Inch	116.000 LF	_____.	_____.
0094	646.9000 Marking Removal Line 4-Inch	350.000 LF	_____.	_____.



Proposal Schedule of Items

Proposal ID: 20230314033 Project(s): 1196-00-62

Federal ID(s): N/A

SECTION: 0001

Contract Items

Alt Set ID:

Alt Mbr ID:

Proposal Line Number	Item ID Description	Approximate Quantity and Units	Unit Price	Bid Amount
0096	650.8000 Construction Staking Resurfacing Reference	13,500.000 LF	_____.	_____.
0098	650.9911 Construction Staking Supplemental Control (project) 01. 1196-00-62	1.000 EACH	_____.	_____.
0100	690.0150 Sawing Asphalt	722.000 LF	_____.	_____.
0102	690.0250 Sawing Concrete	22,382.000 LF	_____.	_____.
0104	715.0720 Incentive Compressive Strength Concrete Pavement	1,357.000 DOL	1.00000	1,357.00
0106	SPV.0180 Special 01. Concrete Pavement Repair Doweled	325.000 SY	_____.	_____.
0108	SPV.0180 Special 02. Concrete Pavement Replacement Doweled	3,895.000 SY	_____.	_____.
0110	SPV.0180 Special 03. 30-inch Concrete Centerline Repair	65.000 SY	_____.	_____.
0112	204.9035.S Removing (item description) 01. Riprap	5.000 CY	_____.	_____.
0114	204.9060.S Removing (item description) 01. Apron Endwalls	2.000 EACH	_____.	_____.
0116	625.0500 Salvaged Topsoil	15.000 SY	_____.	_____.
0118	627.0200 Mulching	15.000 SY	_____.	_____.
0120	630.0130 Seeding Mixture No. 30	5.000 LB	_____.	_____.

Section: 0001

Total: _____.

Total Bid: _____.

