

HIGHWAY WORK PROPOSAL

Wisconsin Department of Transportation
DT1502 01/2020 s.66.0901(7) Wis. Stats

Proposal Number: **033**

<u>COUNTY</u>	<u>STATE PROJECT</u>	<u>FEDERAL</u>	<u>PROJECT DESCRIPTION</u>	<u>HIGHWAY</u>
Washburn	1196-00-62	N/A	Minong - Solon Springs; Bus 53 (Minong) To Lakeside Rd (Nb)	USH 053

ADDENDUM REQUIRED ATTACHED AT BACK

This proposal, submitted by the undersigned bidder to the Wisconsin Department of Transportation, is in accordance with the advertised request for proposals. The bidder is to furnish and deliver all materials, and to perform all work for the improvement of the designated project in the time specified, in accordance with the appended Proposal Requirements and Conditions.

Proposal Guaranty Required: \$75,000.00 Payable to: Wisconsin Department of Transportation	Attach Proposal Guaranty on back of this PAGE.
Bid Submittal Date: March 14, 2023 Time (Local Time): 11:00 am	Firm Name, Address, City, State, Zip Code
Contract Completion Time 50 Working Days	SAMPLE NOT FOR BIDDING PURPOSES
Assigned Disadvantaged Business Enterprise Goal 0%	This contract is exempt from federal oversight.

This certifies that the undersigned bidder, duly sworn, is an authorized representative of the firm named above; that the bidder has examined and carefully prepared the bid from the plans, Highway Work Proposal, and all addenda, and has checked the same in detail before submitting this proposal or bid; and that the bidder or agents, officer, or employees have not, either directly or indirectly, entered into any agreement, participated in any collusion, or otherwise taken any action in restraint of free competitive bidding in connection with this proposal bid.

Do not sign, notarize, or submit this Highway Work Proposal when submitting an electronic bid on the Internet.

Subscribed and sworn to before me this date _____

(Signature, Notary Public, State of Wisconsin)

(Bidder Signature)

(Print or Type Name, Notary Public, State Wisconsin)

(Print or Type Bidder Name)

(Date Commission Expires)

(Bidder Title)

Notary Seal

Type of Work: Base, Concrete Pavement, HMA Pavement, Pavement Marking.	For Department Use Only
Notice of Award Dated	Date Guaranty Returned

**PLEASE ATTACH
PROPOSAL GUARANTY HERE**

PROPOSAL REQUIREMENTS AND CONDITIONS

The bidder, signing and submitting this proposal, agrees and declares as a condition thereof, to be bound by the following conditions and requirements.

If the bidder has a corporate relationship with the proposal design engineering company, the bidder declares that it did not obtain any facts, data, or other information related to this proposal from the design engineering company that was not available to all bidders.

The bidder declares that they have carefully examined the site of, and the proposal, plans, specifications and contract forms for the work contemplated, and it is assumed that the bidder has investigated and is satisfied as to the conditions to be encountered, as to the character, quality, and quantities of work to be performed and materials to be furnished, and as to the requirements of the specifications, special provisions and contract. It is mutually agreed that submission of a proposal shall be considered conclusive evidence that the bidder has made such examination.

The bidder submits herewith a proposal guaranty in proper form and amount payable to the party as designated in the advertisement inviting proposals, to be retained by and become the property of the owner of the work in the event the undersigned shall fail to execute the contract and contract bond and return the same to the office of the engineer within fourteen (14) days after having been notified in writing to do so; otherwise to be returned.

The bidder declares that they understand that the estimate of quantities in the attached schedule is approximate only and that the attached quantities may be greater or less in accordance with the specifications.

The bidder agrees to perform the said work, for and in consideration of the payment of the amount becoming due on account of work performed, according to the unit prices bid in the following schedule, and to accept such amounts in full payment of said work.

The bidder declares that all of the said work will be performed at their own proper cost and expense, that they will furnish all necessary materials, labor, tools, machinery, apparatus, and other means of construction in the manner provided in the applicable specifications and the approved plans for the work together with all standard and special designs that may be designed on such plans, and the special provisions in the contract of which this proposal will become a part, if and when accepted. The bidder further agrees that the applicable specifications and all plans and working drawings are made a part hereof, as fully and completely as if attached hereto.

The bidder, if awarded the contract, agrees to begin the work not later than ten (10) days after the date of written notification from the engineer to do so, unless otherwise stipulated in the special provisions.

The bidder declares that if they are awarded the contract, they will execute the contract agreement and begin and complete the work within the time named herein, and they will file a good and sufficient surety bond for the amount of the contract for performance and also for the full amount of the contract for payment.

The bidder, if awarded the contract, shall pay all claims as required by Section 779.14, Statutes of Wisconsin, and shall be subject to and discharge all liabilities for injuries pursuant to Chapter 102 of the Statutes of Wisconsin, and all acts amendatory thereto. They shall further be responsible for any damages to property or injury to persons occurring through their own negligence or that of their employees or agents, incident to the performance of work under this contract, pursuant to the Standard Specifications for Road and Bridge Construction applicable to this contract.

In connection with the performance of work under this contract, the contractor agrees to comply with all applicable state and federal statutes relating to non-discrimination in employment. No otherwise qualified person shall be excluded from employment or otherwise be subject to discrimination in employment in any manner on the basis of age, race, religion, color, gender, national origin or ancestry, disability, arrest or conviction record (in keeping with s.111.32), sexual orientation, marital status, membership in the military reserve, honesty testing, genetic testing, and outside use of lawful products. This provision shall include, but not be limited to the following: employment, upgrading, demotion or transfer; recruitment or recruitment advertising; layoff or termination; rates of pay or other forms of compensation, and selection for training, including apprenticeship. The contractor further agrees to ensure equal opportunity in employment to all applicants and employees and to take affirmative action to attain a representative workforce.

The contractor agrees to post notices and posters setting forth the provisions of the nondiscrimination clause, in a conspicuous and easily accessible place, available for employees and applicants for employment.

If a state public official (section 19.42, Stats.) or an organization in which a state public official holds at least a 10% interest is a party to this agreement, this contract is voidable by the state unless appropriate disclosure is made to the State of Wisconsin Ethics Board.

BID PREPARATION

Preparing the Proposal Schedule of Items

A. General

- (1) Obtain bidding proposals as specified in section 102 of the standard specifications prior to 11:45 AM of the last business day preceding the letting. Submit bidding proposals using one of the following methods:
 1. Electronic bid on the internet.
 2. Electronic bid on a printout with accompanying diskette or CD ROM.
 3. Paper bid under a waiver of the electronic submittal requirements.
- (2) Bids submitted on a printout with accompanying diskette or CD ROM or paper bids submitted under a waiver of the electronic submittal requirements govern over bids submitted on the internet.
- (3) The department will provide bidding information through the department's web site at:

<https://wisconsin.gov/Pages/doing-bus/contractors/hcci/bid-let.aspx>

The contractor is responsible for reviewing this web site for general notices as well as information regarding proposals in each letting. The department will also post special notices of all addenda to each proposal through this web site no later than 4:00 PM local time on the Thursday before the letting. Check the department's web site after 5:00 PM local time on the Thursday before the letting to ensure all addenda have been accounted for before preparing the bid. When bidding using methods 1 and 2 above, check the Bid Express™ on-line bidding exchange at <http://www.bidx.com/> after 5:00 PM local time on the Thursday before the letting to ensure that the latest schedule of items Expedite file (*.ebs or *.00x) is used to submit the final bid.

- (4) Interested parties can subscribe to the Bid Express™ on-line bidding exchange by following the instructions provided at the www.bidx.com web site or by contacting:

Info Tech Inc.
5700 SW 34th Street, Suite 1235
Gainesville, FL 32608-5371
email: <mailto:customer.support@bidx.com>

- (5) The department will address equipment and process failures, if the bidder can demonstrate that those failures were beyond their control.
- (6) Contractors are responsible for checking on the issuance of addenda and for obtaining the addenda. Notice of issuance of addenda is posted on the department's web site at:

<https://wisconsin.gov/Pages/doing-bus/contractors/hcci/bid-let.aspx>

or by calling the department at (608) 266-1631. Addenda can ONLY be obtained from the department's web site listed above or by picking up the addenda at the Bureau of Highway Construction, 4th floor, 4822 Madison Yards Way, Madison, WI, during regular business hours.

- (7) Addenda posted after 5:00 PM on the Thursday before the letting will be emailed to the eligible bidders for that proposal. All eligible bidders shall acknowledge receipt of the addenda whether they are bidding on the proposal or not. Not acknowledging receipt may jeopardize the awarding of the project.

B. Submitting Electronic Bids

B.1 On the Internet

- (1) Do the following before submitting the bid:
 4. Have a properly executed annual bid bond on file with the department.
 5. Have a digital ID on file with and enabled by Info Tech Inc. Using this digital ID will constitute the bidder's signature for proper execution of the bidding proposal.
- (2) In lieu of preparing, delivering, and submitting the proposal as specified in 102.6 and 102.9 of the standard specifications, submit the proposal on the internet as follows:
 1. Download the latest schedule of items reflecting all addenda from the Bid Express™ web site.
 2. Use Expedite™ software to enter a unit price for every item in the schedule of items.
 3. Submit the bid according to the requirements of Expedite™ software and the Bid Express™ web site. Do not submit a bid on a printout with accompanying diskette or CD ROM or a paper bid. If the bidder does submit a bid on a printout with accompanying diskette or a paper bid in addition to the internet submittal, the department will disregard the internet bid.
 4. Submit the bid before the hour and date the Notice to Contractors designates.
 5. Do not sign, notarize, and return the bidding proposal described in 102.2 of the standard specifications.
- (3) The department will not consider the bid accepted until the hour and date the Notice to Contractors designates.

B.2 On a Printout with Accompanying Diskette or CD ROM

- (1) Download the latest schedule of items from the Wisconsin pages of the Bid Express web site reflecting the latest addenda posted on the department's web site at:
<https://wisconsin.gov/Pages/doing-bus/contractors/hcci/bid-let.aspx>
 Use Expedite™ software to prepare and print the schedule of items. Provide a valid amount for all price fields. Follow instructions and review the help screens provided on the Bid Express™ web site to assure that the schedule of items is prepared properly.

- (2) Staple an 8 1/2 by 11 inch printout of the Expedite™ generated schedule of items to the other proposal documents submitted to the department as a part of the bidder's sealed bid. As a separate submittal, not in the sealed bid envelope but due at the same time and place as the sealed bid, also provide the Expedite™ generated schedule of items on a 3 1/2 inch computer diskette or CD ROM. Label each diskette or CD ROM with the bidder's name, the 4 character department-assigned bidder identification code from the top of the bidding proposal, and a list of the proposal numbers included on that diskette or CD ROM as indicated in the following example:

Bidder Name

BN00

Proposals: 1, 12, 14, & 22

- (3) If bidding on more than one proposal in the letting, the bidder may include all proposals for that letting on one diskette or CD ROM. Include only submitted proposals with no incomplete or other files on the diskette or CD ROM.
- (4) The bidder-submitted printout of the Expedite™ generated schedule of items is the governing contract document and must conform to the requirements of section 102 of the standard specifications. If a printout needs to be altered, cross out the printed information with ink or typewriter and enter the new information and initial it in ink. If there is a discrepancy between the printout and the diskette or CD ROM, the department will analyze the bid using the printout information.

- (5) In addition to the reasons specified in section 102 of the standard specifications, proposals are irregular and the department may reject them for one or more of the following:
1. The check code printed on the bottom of the printout of the ExpediteTM generated schedule of items is not the same on each page.
 2. The check code printed on the printout of the ExpediteTM generated schedule of items is not the same as the check code for that proposal provided on the diskette or CD ROM.
 3. The diskette or CD ROM is not submitted at the time and place the department designates.

B Waiver of Electronic Submittal

- (1) The bidder may request a waiver of the electronic submittal requirements. Submit a written request for a waiver in lieu of bids submitted on the internet or on a printout with accompanying diskette or CD ROM. Use the waiver that was included with the paper bid document sent to the bidder or type up a waiver on the bidder's letterhead. The department will waive the electronic submittal requirements for a bidding entity (individual, partnership, joint venture, corporation, or limited liability company) for up to 4 individual proposals in a calendar year. The department may allow additional waivers for equipment malfunctions.
- (2) Submit a schedule of items on paper conforming to section 102 of the standard specifications. The department charges the bidder a \$75 administrative fee per proposal, payable at the time and place the department designates for receiving bids, to cover the costs of data entry. The department will accept a check or money order payable to: "Wisconsin, Dept. of Transportation."
- (3) In addition to the reasons specified in section 102 of the standard specifications, proposals are irregular and the department may reject them for one or more of the following:
 1. The bidder fails to provide the written request for waiver of the electronic submittal requirements.
 2. The bidder fails to pay the \$75 administrative fee before the time the department designates for the opening of bids unless the bidder requests on the waiver that they be billed for the \$75.
 3. The bidder exceeds 4 waivers of electronic submittal requirements within a calendar year.
- (4) In addition to the reasons specified in section 102 of the standard specifications, the department may refuse to issue bidding proposals for future contracts to a bidding entity that owes the department administrative fees for a waiver of electronic submittal requirements.

PROPOSAL BID BOND

DT1303 1/2006

Wisconsin Department of Transportation

Proposal Number	Project Number	Letting Date
Name of Principal		
Name of Surety	State in Which Surety is Organized	

We, the above-named Principal and the above-named Surety, are held and firmly bound unto the State of Wisconsin in the sum equal to the Proposal Guaranty for the total bid submitted for the payment to be made; we jointly and severally bind ourselves, our heirs, executors, administrators, successors and assigns. The condition of this obligation is that the Principal has submitted a bid proposal to the State of Wisconsin acting through the Department of Transportation for the improvement designated by the Proposal Number and Letting Date indicated above.

If the Principal is awarded the contract and, within the time and manner required by law after the prescribed forms are presented for signature, enters into a written contract in accordance with the bid, and files the bond with the Department of Transportation to guarantee faithful performance and payment for labor and materials, as required by law, or if the Department of Transportation shall reject all bids for the work described, then this obligation shall be null and void; otherwise, it shall be and remain in full force and effect. In the event of failure of the Principal to enter into the contract or give the specified bond, the Principal shall pay to the Department of Transportation **within 10 business days of demand** a total equal to the Proposal Guaranty as liquidated damages; the liability of the Surety continues for the full amount of the obligation as stated until the obligation is paid in full.

The Surety, for value received, agrees that the obligations of it and its bond shall not be impaired or affected by any extension of time within which the Department of Transportation may accept the bid; and the Surety does waive notice of any such extension.

IN WITNESS, the Principal and Surety have agreed and have signed by their proper officers and have caused their corporate seals to be affixed this date: **(DATE MUST BE ENTERED)**

PRINCIPAL

(Company Name) **(Affix Corporate Seal)**

(Signature and Title)

(Company Name)

(Signature and Title)

(Company Name)

(Signature and Title)

(Company Name)

(Signature and Title)

(Name of Surety) **(Affix Seal)**

(Signature of Attorney-in-Fact)

NOTARY FOR PRINCIPAL

NOTARY FOR SURETY

(Date)

(Date)

State of Wisconsin)
) ss.
_____ County)

State of Wisconsin)
) ss.
_____ County)

On the above date, this instrument was acknowledged before me by the named person(s).

On the above date, this instrument was acknowledged before me by the named person(s).

(Signature, Notary Public, State of Wisconsin)

(Signature, Notary Public, State of Wisconsin)

(Print or Type Name, Notary Public, State of Wisconsin)

(Print or Type Name, Notary Public, State of Wisconsin)

(Date Commission Expires)

(Date Commission Expires)

Notary Seal

Notary Seal

IMPORTANT: A certified copy of Power of Attorney of the signatory agent must be attached to the bid bond.

CERTIFICATE OF ANNUAL BID BOND

DT1305 8/2003

Wisconsin Department of Transportation

Time Period Valid (From/To)
Name of Surety
Name of Contractor
Certificate Holder Wisconsin Department of Transportation

This is to certify that an annual bid bond issued by the above-named Surety is currently on file with the Wisconsin Department of Transportation.

This certificate is issued as a matter of information and conveys no rights upon the certificate holder and does not amend, extend or alter the coverage of the annual bid bond.

Cancellation: Should the above policy be cancelled before the expiration date, the issuing surety will give thirty (30) days written notice to the certificate holder indicated above.

(Signature of Authorized Contractor Representative)

(Date)

CERTIFICATION REGARDING DEBARMENT, SUSPENSION, AND OTHER RESPONSIBILITY MATTERS - PRIMARY COVERED TRANSACTIONS

Instructions for Certification

1. By signing and submitting this proposal, the prospective contractor is providing the certification set out below.
2. The inability of a person to provide the certification required below will not necessarily result in denial of participation in this covered transaction. The prospective contractor shall submit an explanation of why it cannot provide the certification set out below. The certification or explanation will be considered in connection with the department or agency's determination whether to enter into this transaction. However, failure of the prospective contractor to furnish a certification or an explanation shall disqualify such person from participation in this transaction.
3. The certification in this clause is a material representation of fact upon which reliance was placed when the department determined to enter into this transaction. If it is later determined that the contractor knowingly rendered an erroneous certification in addition to other remedies available to the Federal Government the department may terminate this transaction for cause or default.
4. The prospective contractor shall provide immediate written notice to the department to whom this proposal is submitted if at any time the prospective contractor learns that its certification was erroneous when submitted or has become erroneous by reason of changed circumstances.
5. The terms "covered transaction," "debarred," "suspended," "ineligible," "lower tier covered transaction," "participant," "person," "primary covered transaction," "principal," "proposal," and "voluntarily excluded," as used in this clause, have the meanings set out in the Definitions and Coverage sections of the rules implementing Executive Order 12549. You may contact the department to which this proposal is being submitted for assistance in obtaining a copy of those regulations.
6. The prospective contractor agrees by submitting this proposal that, should this contract be entered into, it shall not knowingly enter into any lower tier covered transaction with a person who is debarred, suspended, declared ineligible, or voluntarily excluded from participation in this covered transaction, unless authorized by the department entering into this transaction.
7. The prospective contractor further agrees by submitting this proposal that it will include the clause titled "Certification Regarding Debarment, Suspension, Ineligibility and Voluntary Exclusion-Lower Tier Covered Transaction," which is included as an addendum to PR- 1273 - "Required Contract Provisions Federal Aid Construction Contracts," without modification, in all lower tier covered transactions and in all solicitations for lower tier covered transactions.
8. The contractor may rely upon a certification of a prospective subcontractor/materials supplier that it is not debarred, suspended, ineligible, or voluntarily excluded from the covered transaction, unless it knows that the certification is erroneous. A contractor may decide the method and frequency by which it determines the eligibility of its principals. Each contractor may, but is not required to, check the Disapproval List (telephone # 608/266/1631).

9. Nothing contained in the foregoing shall be construed to require establishment of a system of records in order to render in good faith the certification required by this clause. The knowledge and information of a contractor is not required to exceed that which is normally possessed by a prudent person in the ordinary course of business dealings.
10. Except for transactions authorized under paragraph 6 of these instructions, if a contractor in a covered transaction knowingly enters into a lower tier covered transaction with a person who is suspended, debarred, ineligible or voluntarily excluded from participation in this transaction, in addition to other remedies available to the Federal Government, the department may terminate this transaction for cause or default.

Certification Regarding Debarment, Suspension, and Other Responsibility Matters - Primary Covered Transactions

1. The prospective contractor certifies to the best of its knowledge and belief, that it and its principals:
 - (a) Are not presently debarred, suspended, proposed for debarment, declared ineligible, or voluntarily excluded from covered transactions by any Federal department or agency;
 - (b) Have not within a three-year period preceding this proposal been convicted of or had a civil judgment rendered against them for commission of fraud or a criminal offense in connection with obtaining, attempting to obtain, or performing a public (Federal, State or local) transaction or contract under a public transaction; violation of Federal or State antitrust statutes or commission of embezzlement, theft, forgery, bribery, falsification or destruction of records, making false statements or receiving stolen property;
 - (c) Are not presently indicted for or otherwise criminally or civilly charged by a governmental entity (Federal, State or local) with commission of any of the offense enumerated in paragraph (1)(b) of this certification; and
 - (d) Have not within a three-year period preceding this proposal had one or more public transactions (Federal, State or local) terminated for cause or default.
2. Where the prospective contractor is unable to certify to any of the statements in this certification, such prospective contractor shall attach an explanation to this proposal.

Special Provisions

Table of Contents

Article	Description	Page #
1.	General	2
2.	Scope of Work	2
3.	Prosecution and Progress	2
4.	Traffic.....	3
5.	Holiday and Special Event Work Restrictions.	4
6.	Utilities	4
7.	Other Contracts	4
8.	Information to Bidders, U.S. Army Corps of Engineers Section 404 Permit	4
9.	Environmental Protection, Aquatic Exotic Species Control.	4
10.	Archaeological Site	5
11.	Select Borrow, Item 208.1100.	5
12.	Concrete Pavement Repair Doweled, Item SPV.0180.01; Concrete Pavement Replacement Doweled, Item SPV.180.02; 30-inch Concrete Centerline Repair, Item SPV.0180.03.....	6

STSP'S Revised June 28, 2022

SPECIAL PROVISIONS

1. General.

Perform the work under this construction contract for Project 1196-00-62, Minong – Solon Springs, Bus 53 (Minong) to Lakeside Rd (NB), Washburn County, Wisconsin as the plans show and execute the work as specified in the State of Wisconsin, Department of Transportation, Standard Specifications for Highway and Structure Construction, 2023 Edition, as published by the department, and these special provisions.

If all or a portion of the plans and special provisions are developed in the SI metric system and the schedule of prices is developed in the US standard measure system, the department will pay for the work as bid in the US standard system.

100-005 (20220628)

2. Scope of Work.

The work under this contract shall consist of concrete pavement repair and replacement, minor culvert work, resurfacing of asphaltic pavement, shoulder rumble strips, pavement marking, and all incidental items necessary to complete the work as shown on the plans and included in the proposal and contract.

104-005 (20090901)

3. Prosecution and Progress.

Begin work within 10 calendar days after the engineer issues a written notice to do so.

Provide the time frame for construction of the project within the 2023 construction season to the engineer in writing within a month after executing the contract but at least 14 calendar days before the preconstruction conference. Assure that the time frame is consistent with the contract completion time. Upon approval, the engineer will issue the notice to proceed within 10 calendar days before the beginning of the approved time frame.

To revise the time frame, submit a written request to the engineer at least two weeks before the beginning of the intended time frame. The engineer will approve or deny that request based on the conditions cited in the request and its effect on the department's scheduled resources.

Northern Long-eared Bat (*Myotis septentrionalis*)

Northern long-eared bats (NLEB) have the potential to inhabit the project limits because they roost in trees, bridges and culverts. Roosts may not have been observed on this project, but conditions to support the species exist. The species and all active roosts are protected by the Federal Endangered Species Act. If an individual bat or active roost is encountered during construction operations, stop work and notify the engineer and the WisDOT Regional Environmental Coordinator (REC).

Ensure all operators, employees, and subcontractors working in areas of known or presumed bat habitat are aware of environmental commitments and avoidance and minimization measures (AMMs) to protect both bats and their habitat.

Direct temporary lighting, if used, away from wooded areas during the bat active season: April 1 to October 31, both dates inclusive.

If additional construction activities beyond what was originally specified are required to complete the work, approval from the engineer, following coordination with WisDOT REC, is required prior to initiating these activities. If trees with a 3-inch or greater diameter at breast height (dbh) need to be removed, no tree clearing shall occur without prior approval from the engineer, following coordination with the WisDOT REC. Tree removal will require consultation with the United States Fish and Wildlife Service (USFWS) and may require a bat presence/absence or visual emergency survey. Notify the engineer if tree clearing cannot be avoided to begin coordination with the WisDOT REC. The WisDOT REC will initiate consultation with the USFWS and determine if a survey is necessary.

4. Traffic.

US Highway 53 Northbound shall remain open to traffic at all times. The project will be constructed under traffic using single lane closures.

Maintain vehicular access along US Highway 53 at all times for all emergency vehicles. Maintain access to all farms, fields, businesses, and residential properties at all times unless approved by the engineer. Coordinate with owner or resident at least 48 hours prior to the work when construction operations may temporarily restrict access to a property.

Do not park equipment or place material within 18 feet of the edge of the shoulder unless approved by the engineer. Do not park or store equipment or material not being used during actual performance of work within 30 feet of the edge of the traveled way.

Coordinate all arrangements for handling traffic with the engineer before work is started. Ensure that all traffic control devices are in place and approved by the engineer before beginning each stage.

Wisconsin Lane Closure System Advance Notification

Provide the following advance notification to the engineer for incorporation into the Wisconsin Lane Closure System (LCS).

TABLE 108-1 CLOSURE TYPE AND REQUIRED MINIMUM ADVANCE NOTIFICATION

Closure type with height, weight, or width restrictions (available width, all lanes in one direction < 16 feet)	MINIMUM NOTIFICATION
Lane and shoulder closures	7 calendar days
Full roadway closures	7 calendar days
Ramp closures	7 calendar days
Detours	7 calendar days
Closure type without height, weight, or width restrictions (available width, all lanes in one direction ≥ 16 feet)	MINIMUM NOTIFICATION
Lane and shoulder closures	3 business days
Ramp closures	3 business days
Modifying all closure types	3 business days

Discuss LCS completion dates and provide changes in the schedule to the engineer at weekly project meetings in order to manage closures nearing their completion date.

Temporary Regulatory Speed Limit Reduction

Establish a statutory 60 mph speed limit zone for USH 53 whenever a lane is closed to traffic, or whenever traffic is shifted onto the shoulder. Reestablish a 70 mph speed limit zone whenever traffic is opened up to two lanes of traffic in each direction driving on the existing or proposed traffic lanes. Coordinate these statutory speed limit zones with the Department of Transportation, NW Region Traffic Section.

During engineer-approved regulatory speed limit reductions, install temporary speed limit signs on the inside and outside shoulders of divided roadways to enhance visibility. On two-lane, two-way roadways, install temporary speed limit signs on shoulders. When construction activities impede the location of a post-mounted regulatory speed limit sign, relocate the sign for maximum visibility to motorists. If work lasts less than seven days, mount the regulatory speed limit sign on a portable sign support.

Post temporary regulatory speed limit signs in work zone only during continuous worker activity. During periods of no work activity or when the traffic controls are removed from the roadway, cover or remove the temporary speed limit signs.

5. **Holiday and Special Event Work Restrictions.**

Do not perform work on, nor haul materials of any kind along or across any portion of the highway carrying USH 53 (Northbound) traffic, and entirely clear the traveled way and shoulders of such portions of the highway of equipment, barricades, signs, lights, and any other material that might impede the free flow of traffic during the following holiday and special event periods:

- From noon Friday, May 26, 2023, to 6:00 AM Tuesday, May 30, 2023, for Memorial Day;
- From noon Friday, June 30, 2023, to 6:00 AM Monday, July 10, 2023, for Independence Day;
- From noon Friday, September 1, 2023, to 6:00 AM Tuesday, September 5, 2023, for Labor Day.

stp-107-005 (20210113)

6. **Utilities.**

This contract comes under the provision of Administrative Rule Trans 220.

The following utility owners have facilities within the project area; however, no adjustments are anticipated:

- **Astrea**
- **CenturyLink**
- **Dahlberg Light And Power Company**
- **Minong, Village of (SEWER)**
- **Minong Village of Water Utility (WATER)**
- **Spectrum**
- **We Energies**

stp-107-065 (20080501)

7. **Other Contracts.**

Pavement resurface project 8550-02-72, on STH 77 from CTH I to CTH G, may be under construction concurrently with the work under this contract. Coordinate trucking activities, work zone traffic control, roadway and lane closures, and other work items as required with this project.

8. **Information to Bidders, U.S. Army Corps of Engineers Section 404 Permit.**

The department has obtained a U.S. Army Corps of Engineers Section 404 permit. Comply with the requirements of the permit in addition to requirements of the special provisions. A copy of the permit is available from the regional office by contacting Adam Hetrick, P.E., WisDOT NW Region at adam.hetrick@dot.wi.gov or (715) 577-8053.

9. **Environmental Protection, Aquatic Exotic Species Control.**

Exotic invasive organisms such as VHS, zebra mussels, purple loosestrife, and Eurasian water milfoil are becoming more prolific in Wisconsin and pose adverse effects to waters of the state. Wisconsin State Statutes 30.07, "Transportation of Aquatic Plants and Animals; Placement of Objects in Navigable Waters", details the state law that requires the removal of aquatic plants and zebra mussels each time equipment is put into state waters.

At construction sites that involve navigable water or wetlands, use the follow cleaning procedures to minimize the chance of exotic invasive species infestation. Use these procedures for all equipment that comes in contact with waters of the state and/or infested water or potentially infested water in other states.

Ensure that all equipment that has been in contact with waters of the state, or with infested or potentially infested waters, has been decontaminated for aquatic plant materials and zebra mussels before being

used in other waters of the state. Before using equipment on this project, thoroughly disinfect all equipment that has come into contact with potentially infested waters. Guidelines from the Wisconsin Department of Natural Resources for disinfection are available at:

<http://dnr.wi.gov/topic/invasives/disinfection.html>

Use the following inspection and removal procedures:

1. Before leaving the contaminated site, wash machinery and ensure that the machinery is free of all soil and other substances that could possibly contain exotic invasive species;
2. Drain all water from boats, trailers, bilges, live wells, coolers, bait buckets, engine compartments, and any other area where water may be trapped;
3. Inspect boat hulls, propellers, trailers and other surfaces. Scrape off any attached mussels, remove any aquatic plant materials (fragments, stems, leaves, seeds, or roots), and dispose of removed mussels and plant materials in a garbage can before leaving the area or invested waters; and
4. Disinfect your boat, equipment and gear by either:
 - 4.1. Washing with ~212 F water (steam clean), or
 - 4.2. Drying thoroughly for five days after cleaning with soap and water and/or high pressure water, or
 - 4.3. Disinfecting with either 200 ppm (0.5 oz per gallon or 1 Tablespoon per gallon) Chlorine for 10-minute contact time or 1:100 solution (38 grams per gallon) of Virkon Aquatic for 20- to 30-minute contact time. Note: Virkon is not registered to kill zebra mussel veligers nor invertebrates like spiny water flea. Therefore, this disinfect should be used in conjunction with a hot water (>104° F) application.

Complete the inspection and removal procedure before equipment is brought to the project site and before the equipment leaves the project site.

stp-107-055 (20130615)

10. **Archaeological Site.**

Site: 47WB67 is located approximately from Station 722+00 to Station 724+50 LT within the limits shown on the plans.

Site: 47WB68 is located approximately from Station 711+00 to Station 718+00 LT outside of the limits shown on the plans.

Notify the Bureau of Technical Services – Environmental Process and Document Section (BTS-EPDS) at (608) 266-0099 at least two weeks before commencement of any ground disturbing activities beyond the existing right-of-way limits. BTS-EPDS will determine if a qualified archaeologist will need to be on site during construction of this area.

Do not use either of the sites for borrow or waste disposal. Do not use the site area not currently capped by asphalt/concrete for the staging of personnel, equipment and/or supplies.

stp-107-220 (20180628)

11. **Select Borrow, Item 208.1100.**

Conform to standard spec 208 as modified in this special provision.

Material

Furnish and use material that consists of granular material meeting the following requirements:

Granular Backfill, Grade 2 according to Standard Spec 209.2.

stp-208-005 (20031103)

**12. Concrete Pavement Repair Doweled, Item SPV.0180.01;
Concrete Pavement Replacement Doweled, Item SPV.180.02;
30-inch Concrete Centerline Repair, Item SPV.0180.03.**

A Description

This special provision describes providing construction of Concrete Pavement Repair Doweled, Concrete Pavement Replacement, and 30-inch Concrete Centerline Repair according to standard spec 415, 416, and 710. QMP for these items shall be combined and covered under standard spec 716, as shown on the plans, and hereinafter provided. The repair work will be the final surface.

B Materials

B.1 Concrete Mixtures

Add the following to standard spec 716.2:

Concrete mix design shall be the responsibility of the contractor. Provide the concrete mix designs necessary to accommodate the contractor's operations and contractor scheduling according to the traffic provisions and prosecution and progress provisions included in the plan.

Chloride base accelerators shall be allowed in any concrete mixes that are specifically designed to meet opening strength within six hours or less within the time placement to accommodate lane restrictions as specified in the contract.

QC slump testing is not required for any concrete mixture that has been approved and has at least 700 lbs of cement per cubic yard.

Random 28-day compressive strength cylinders are not required.

Any chemical admixture(s) to be used, other than air-entraining agents or water reducers from the department's approved list, must be approved in advance by the engineer. The water-cement ratio of the concrete mixture shall not exceed 0.40.

C Construction

C.1 General

Restrict lane operations as specified in the Traffic Section and the Prosecution and Progress Section. Perform work to cause the least possible inconvenience to traffic. The contractor will be allowed to close one lane in each direction to complete the work.

Prepare the base as specified in standard spec 211 using engineer-approved hand methods. Place the repair to the thickness of the contiguous pavement. In lieu of replacing base that was damaged or removed, the contractor will be allowed to place concrete to fill this area at no additional cost to the department.

C.2 Concrete Repair

Add the following to standard spec 416.3.7 and 416.3.8.2:

Deposit concrete to require as little re-handling as possible, place and consolidate by hand with an immersion type vibrator and strike off and finish flush with adjoining surfaces. Any finished surface within the repair that is an 1/8-inch higher than the adjoining pavement shall be diamond ground to match elevation. Any individual repair that, within its defined boundaries, has any finished surface that is 1/8-inch lower than the adjoining pavement shall be paid at 50% of the bid price within the individual repair or shall be removed and replaced as directed by the engineer at no additional cost to the department. Repair areas greater than 15 feet in length shall meet the Surface Testing and Correction parameters as defined in standard spec 415.3.10.

Unless the plans show or the engineer directs otherwise, the department will not require ties to the existing adjoining pavement within repairs that are 15 feet or less in length.

Construct, cure, and protect as specified for concrete pavement repairs in standard spec 416.

C.3 Opening to Traffic

Concrete Pavement Repair Doweled, Concrete Pavement Replacement Doweled, and 30-inch Concrete Centerline Repair must attain a minimum compressive strength of 2500 psi before they can be opened to traffic. The opening strength shall be determined by Maturity Methods, standard spec 502.3.10.1.3.3 or other engineer approved methods. If cylinders are used, the compressive strength shall be measured by testing concrete cylinders cured in the field on top of the slab, under the curing blanket. At least two cylinders shall be tested in determining the attained strength of concrete repairs for the purpose of opening the pavement to traffic. The average of test results for the two cylinders shall be used to determine compliance, except that neither cylinder may be less than 10 percent below the required strength.

If opening is not controlled by maturity methods or cylinders, cores may be substituted.

C.4 Details

Details for the construction of these items shall fall under SDD 13C9-11a, 11b, 11c Concrete Pavement Repair and Replacement and plan details.

D Measurement

The department will measure Concrete Pavement Repair Doweled, Concrete Pavement Replacement Doweled, and 30-inch Concrete Centerline Repair by the square yard, acceptably completed.

E Payment

The department will pay for measured quantities at the contract unit price under the following bid item:

ITEM NUMBER	DESCRIPTION	UNIT
SPV.0180.01	Concrete Pavement Repair Doweled	SY
SPV.0180.02	Concrete Pavement Replacement Doweled	SY
SPV.0180.03	30-inch Concrete Centerline Repair	SY

Payment is full compensation for removing old pavement and disposing of removed materials; for preparing the base; for providing the concrete, curing, and protecting the concrete.

The department will pay separately for the following bid items: Sawing Concrete, Drilled Tie Bars, and Drilled Dowel Bars into existing pavement.

ADDITIONAL SPECIAL PROVISION 4

This special provision does not limit the right of the department, prime contractor, or subcontractors at any tier to withhold payment for work not acceptably completed or work subject to an unresolved contract dispute.

Payment to First-Tier Subcontractors

Within 10 calendar days of receiving a progress payment for work completed by a subcontractor, pay the subcontractor for that work. The prime contractor may withhold payment to a subcontractor if, within 10 calendar days of receipt of that progress payment, the prime contractor provides written notification to the subcontractor and the department documenting "just cause" for withholding payment.

The prime contractor is not allowed to withhold retainage from payments due subcontractors.

Payment to Lower-Tier Subcontractors

Ensure that subcontracting agreements at all tiers provide prompt payment rights to lower-tier subcontractors that parallel those granted first-tier subcontractors in this provision.

Acceptance and Final Payment

Within 30 calendar days of receiving the semi-final estimate from the department, submit written certification that subcontractors at all tiers are paid in full for acceptably completed work.

Additional Special Provision 6
ASP 6 - Modifications to the standard specifications

Make the following revisions to the standard specifications:

416.2.4 Concrete Pavement Repair and Replacement

Replace the entire text with the following effective with the November 2022 letting:

- (1) Except as specified in 416.3.6 for inlaid rumble strips, use grade C concrete as specified in 501.
- (2) The engineer will allow the contractor to open to construction and public traffic when the concrete reaches 2000 psi.

416.2.5 Special High Early Strength Concrete Pavement Repair and Replacement

416.2.5.1 Composition and Proportioning of Concrete

Replace paragraph one with the following effective with the November 2022 letting:

- (1) For the concrete mixture, use a minimum of 846 pounds of cementitious material per cubic yard of concrete. The engineer will allow the contractor to open to construction and public traffic when the concrete reaches 2000 psi. The contractor may add one or a combination of admixtures to the ingredients or to the mixture in order to obtain the required minimum strength and required air content. Do not retemper the concrete mixture.

455.2.4.3 Emulsified Asphalts

Replace paragraph one with the following effective with the November 2022 letting:

- (1) Furnish material conforming, before dilution, to the following:
 - Anionic emulsified asphalts^[1]..... AASHTO M140
 - Cationic emulsified asphalts^[1] AASHTO M208
 - Polymer-modified cationic emulsified asphalts AASHTO M316
- ^[1] Non-tracking emulsified asphalts shall conform to TABLE 455-1 for the type and grade specified.

TABLE 455-1 Requirements for Non-Tracking Emulsified Asphalt

PRODUCT	ANTT	CNTT
Saybolt Viscosity at 77°F (25°C), (AASHTO T 59), SFS	15-100	15-100
Paddle Viscosity at 77°F (25°C), (AASHTO T 382), cPs ^[1]	30-200	30-200
Storage Stability Test, 24 hr, (AASHTO T 59), %	1 max	1 max
Residue by Distillation, 500 ± 10 °F (260 ± 5 °C), or Residue by Evaporation, 325 ± 5 °F (163 ± 3 °C), (AASHTO T 59), %	50 min	50 min
Sieve Test, No. 20 (850 µm), (AASHTO T 59), %	0.3	0.3
Penetration at 77°F (25°C), 100 g, 5 sec, (AASHTO T 49), dmm	10-40	10-40
Ash Content, (AASHTO T 111), %	1 max	1 max
Solubility in Trichlorethylene Test, (AASHTO T 44) ^[2]	97.5% min	97.5% min

^[1] Paddle Viscosity (AASHTO T 382) may be run in lieu of Saybolt Viscosity (AASHTO T 59).
^[2] The solubility in Trichlorethylene test (AASHTO T 44) may be run in lieu of Ash Content (AASHTO T 111).

455.2.5 Tack Coat

Replace paragraph one with the following effective with the November 2022 letting:

- (1) Under the Tack Coat bid item, furnish type SS-1h, CSS-1h, QS-1h, CQS-1h, ANTT, CNTT, or modified emulsified asphalt with an “h” suffix, unless the contract specifies otherwise.

710.5.7 Corrective Action

710.5.7.1 Optimized Aggregate Gradations

Replace paragraph one with the following effective with the November 2022 letting:

- (1) If the contractor's 4-point running average or a department test result of the volumetric percent retained exceeds the tarantula curve limits by less than or equal to 1.0 percent on a single sieve size, notify the other party immediately and do one of the following:
 - Perform corrective action documented in the QC plan or as the engineer approves. Continue with the following:
 1. Document and provide corrective action results to the engineer as soon as they are available.
 2. Department will conduct two tests within the next business day after corrective action is complete.
 - If blended aggregate gradations are within the tarantula curve limits by the second department test:
 - Continue with concrete production.
 - Include a break in the 4-point running average.
 - For Class I Pavements: The department will discontinue reduced frequency testing and will test at a frequency of 1 test per placement day. Once 5 consecutive samples are passing at the 1 test per placement day frequency, the reduced frequency testing will be reapplied.
 - If blended aggregate gradations are not within the tarantula curve limits by the second department test and the contract requires an optimized aggregate gradation mix under 501.2.7.4.2.1(2), stop concrete production and submit a new optimized aggregate gradation mix design.
 - If blended aggregate gradations are not within the tarantula curve limits by the second department test and the contract does not require an optimized aggregate gradation mix under 501.2.7.4.2.1(2), stop concrete production and submit either a new optimized aggregate gradation mix design or a combined aggregate gradation mix design.
 - Submit a new optimized aggregate gradation mix design and perform the following:
 1. Restart control charts for the new mix design.
 2. Amend contractor Quality Control Plan

715.5 Payment

Replace the entire text with the following effective with the November 2022 letting:

715.5.1 General

- (1) The department will pay incentive for concrete strength under the following bid items:

<u>ITEM NUMBER</u>	<u>DESCRIPTION</u>	<u>UNIT</u>
715.0502	Incentive Strength Concrete Structures	DOL
715.0603	Incentive Strength Concrete Barrier	DOL
715.0715	Incentive Flexural Strength Concrete Pavement	DOL
715.0720	Incentive Compressive Strength Concrete Pavement	DOL

- (2) Incentive payment may be more or less than the amount the schedule of items shows.
- (3) The department will administer disincentives for strength under the Disincentive Strength Concrete Structures, Disincentive Strength Concrete Barrier, Disincentive Flexural Strength Concrete Pavement, and Disincentive Compressive Strength Concrete Pavement, administrative items.
- (4) The department will adjust pay for each lot using PWL of the 28-day subplot average strengths for that lot. The department will measure PWL relative to strength lower specification limits as follows:
 - Compressive strength of 3700 psi for pavements.
 - Flexural strength of 650 psi for pavements.
 - Compressive strength of 4000 psi for structures and barrier.
- (5) The department will not pay a strength incentive for concrete that is nonconforming in another specified property, for ancillary concrete accepted based on tests of class I concrete, or for high early strength concrete unless placed in pavement gaps as allowed under 715.3.1.2.2.
- (6) Submit test results to the department electronically using MRS software. The department will verify contractor data before determining pay adjustments.
- (7) All coring and testing costs under 715.3.2.2 including filling core holes and providing traffic control during coring are incidental to the contract.

715.5.2 Pavements

715.5.2.1 Compressive

- (1) The department will adjust pay for each lot using equation “QMP 3.01” as follows:

Percent within Limits (PWL)	Pay Adjustment (dollars per square yard)
>= 95 to 100	$(0.1 \times \text{PWL}) - 9.5$
>= 85 to < 95	0
>= 30 to < 85	$(1.5/55 \times \text{PWL}) - 127.5/55$
< 30	-1.50

- (2) The department will not pay incentive if the lot standard deviation is greater than 400 psi compressive.
- (3) For lots with a full battery of QC tests at less than 4 locations, there is no incentive, but the department will assess a disincentive based on the individual subplot average strengths. The department will reduce pay for sublots with an average strength below 3700 psi compressive by \$1.50 per square yard.
- (4) For integral shoulder pavement and pavement gaps accepted using tests from the adjacent travel lane, the department will adjust pay using strength results of the travel lane for integrally placed concrete shoulders and pavement gaps regardless of mix design and placement method, included in a lane-foot lot.

715.5.2.2 Flexural

- (1) The department will adjust pay for each lot using equation “QMP 6.02” as follows:

Percent within Limits (PWL)	Pay Adjustment (dollars per square yard)
>= 95 to 100	$(0.2 \times \text{PWL}) - 19$
>= 85 to < 95	0
>= 50 to < 85	$(2.0/35 \times \text{PWL}) - 170/35$
< 50	-2.00

- (2) The department will not pay incentive if the lot standard deviation is greater than 60 psi flexural.
- (3) For lots with a full battery of QC tests at less than 4 locations, there is no incentive, but the department will assess a disincentive based on the individual subplot average strengths. The department will reduce pay for sublots with an average strength below 650 psi flexural by \$2.00 per square yard.
- (4) For integral shoulder pavement and pavement gaps accepted using tests from the adjacent travel lane, the department will adjust pay using strength results of the travel lane for integrally placed concrete shoulders and pavement gaps regardless of mix design and placement method, included in a lane-foot lot.

715.5.3 Structures and Cast-in-Place Barrier

- (1) The department will adjust pay for each lot using equation “QMP 2.01” as follows:

Percent within Limits (PWL)	Pay Adjustment (dollars per square yard)
>= 99 to 100	10
>= 90 to < 99	0
>= 50 to < 90	$(7/8 \times \text{PWL}) - 78.75$
< 50	-35

- (2) The department will not pay incentive if the lot standard deviation is greater than 350 psi.
- (3) For lots with less than 4 sublots, there is no incentive, but the department will assess a disincentive based on the individual subplot average strengths. The department will reduce pay for sublots with an average strength below 4000 psi by \$35 per cubic yard.

ADDITIONAL SPECIAL PROVISION 7

A. Reporting 1st Tier and DBE Payments During Construction

1. Comply with reporting requirements specified in the department's Civil Rights Compliance, Contractor's User Manual, Sublets and Payments.
2. Report payments to all DBE firms within 10 calendar days of receipt of a progress payment by the department or a contractor for work performed, materials furnished, or materials stockpiled by a DBE firm. Report the payment as specified in A(1) for all work satisfactorily performed and for all materials furnished or stockpiled.
3. Report payments to all first tier subcontractor relationships within 10 calendar days of receipt of a progress payment by the department for work performed. Report the payment as specified in A(1) for all work satisfactorily performed.
4. All tiers shall report payments as necessary to comply with the DBE payment requirement as specified in A(2).
5. DBE firms must enter all payments to DBE and non-DBE firms regardless of tier.
6. Require all first tier relationships, DBE firms and all other tier relationships necessary to comply with the DBE payment requirement in receipt of a progress payment by contractor to acknowledge receipt of payment as specified in A(1), (2), (3) and (4).
7. All agreements made by a contractor shall include the provisions in A(1), (2), (3), (4), (5), and (6), and shall be binding on all first tier subcontractor relationships, all contractors and subcontractors utilizing DBE firms on the project, and all payments from DBE firms.

B. Costs for conforming to this special provision are incidental to the contract.

NOTE: CRCS Prime Contractor payment is currently not automated and will need to be manually loaded into the Civil Rights Compliance System. Copies of prime contractor payments received (check or ACH) will have to be forwarded to paul.ndon@dot.wi.gov within 5 days of payment receipt to be logged manually.

***Additionally, for information on Subcontractor Sublet assignments, Subcontractor Payments and Payment Tracking, please refer to the CRCS Payment and Sublets manual at:

<https://wisconsindot.gov/Documents/doing-bus/civil-rights/labornwage/crcs-payments-sublets-manual.pdf>

ADDITIONAL SPECIAL PROVISION 9

Electronic Certified Payroll or Labor Data Submittal

- (1) Use the department's Civil Rights Compliance System (CRCS) to electronically submit certified payroll reports for contracts with federal funds and labor data for contracts with state funds only. Details are available online through the department's highway construction contractor information (HCCI) site on the Labor, Wages, and EEO Information page at:
<https://wisconsindot.gov/Pages/doing-bus/civil-rights/labornwage/default.aspx>
- (2) Ensure that all tiers of subcontractors, including all trucking firms, either submit their weekly certified payroll reports (contracts with federal funds) or labor data (contracts with state funds only) electronically through CRCS. These payrolls or labor data are due within seven calendar days following the close of the payroll period. Every firm providing physical labor towards completing the project is a subcontractor under this special provision.
- (3) Upon receipt of contract execution, promptly make all affected firms aware of the requirements under this special provision and arrange for them to receive CRCS training as they are about to begin their submittals. The department will provide training either in a classroom setting at one of our regional offices or by telephone. Contact Paul Ndon at (414) 438-4584 to schedule the training.
- (4) The department will reject all paper submittals for information required under this special provision. All costs for conforming to this special provision are incidental to the contract.
- (5) Firms wishing to export payroll/labor data from their computer system into CRCS should have their payroll coordinator contact Paul Ndon at paul.ndon@dot.wi.gov. Not every contractor's payroll system is capable of producing export files. For details, see Section 4.8 CPR Auto Submit (Data Mapping) on pages 49-50; 66-71 of the CRCS Payroll Manual at:
<https://wisconsindot.gov/Documents/doing-bus/civil-rights/labornwage/crcs-payroll-manual.pdf>

NON-DISCRIMINATION PROVISIONS

During the performance of this contract, the contractor, for itself, its assignees, and successors in interest (hereinafter referred to as the "contractor") agrees as follows:

1. Compliance with Regulations: The contractor (hereinafter includes consultants) will comply with the Acts and the Regulations relative to Non-discrimination in Federally-assisted programs of the U.S. Department of Transportation, Federal Highway Administration, as they may be amended from time to time, which are herein incorporated by reference and made a part of this contract.

2. Non-discrimination: The contractor, with regard to the work performed by it during the contract, will not discriminate on the grounds of race, color, or national origin in the selection and retention of subcontractors, including procurements of materials and leases of equipment. The contractor will not participate directly or indirectly in the discrimination prohibited by the Acts and the Regulations, including employment practices when the contract covers any activity, project, or program set forth in Appendix B of 49 CFR Part 21.

3. Solicitations for Subcontracts, Including Procurements of Materials and Equipment: In all solicitations, either by competitive bidding, or negotiation made by the contractor for work to be performed under a subcontract, including procurements of materials, or leases of equipment, each potential subcontractor or supplier will be notified by the contractor of the contractor's obligations under this contract and the Acts and the Regulations relative to Non-discrimination on the grounds of race, color, or national origin.

4. Information and Reports: The contractor will provide all information and reports required by the Acts, the Regulations, and directives issued pursuant thereto and will permit access to its books, records, accounts, other sources of information, and its facilities as may be determined by the Recipient or the Federal Highway Administration to be pertinent to ascertain compliance with such Acts, Regulations, and instructions. Where any information required of a contractor is in the exclusive possession of another who fails or refuses to furnish the information, the contractor will so certify to the Recipient or the Federal Highway Administration, as appropriate, and will set forth what efforts it has made to obtain the information.

5. Sanctions for Noncompliance: In the event of a contractor's noncompliance with the Non-discrimination provisions of this contract, the Recipient will impose such contract sanctions as it or the Federal Highway Administration may determine to be appropriate, including, but not limited to:

- a. Withholding payments to the contractor under the contract until the contractor complies; and/or
- b. Cancelling, terminating, or suspending a contract, in whole or in part.

6. Incorporation of Provisions: The contractor will include the provisions of paragraphs one through six in every subcontract, including procurements of materials and leases of equipment, unless exempt by the Acts, the Regulations and directives issued pursuant thereto. The contractor will take action with respect to any subcontract or procurement as the Recipient or the Federal Highway Administration may direct as a means of enforcing such provisions including sanctions for noncompliance. Provided, that if the contractor becomes involved in, or is threatened with litigation by a subcontractor, or supplier because of such direction, the contractor may request the Recipient to enter into any litigation to protect the interests of the Recipient. In addition, the contractor may request the United States to enter into the litigation to protect the interests of the United States.

During the performance of this contract, the contractor, for itself, its assignees, and successors in interest (hereinafter referred to as the "contractor") agrees to comply with the following non-discrimination statutes and authorities; including but not limited to:

Pertinent Non-Discrimination Authorities:

- Title VI of the Civil Rights Act of 1964 (42 U.S.C. § 2000d et seq., 78 stat. 252), (prohibits discrimination on the basis of race, color, national origin); and 49 CFR Part 21.
- The Uniform Relocation Assistance and Real Property Acquisition Policies Act of 1970, (42 U.S.C. § 4601), (prohibits unfair treatment of persons displaced or whose property has been acquired because of Federal or Federal-aid programs and projects);
- Federal-Aid Highway Act of 1973, (23 U.S.C. § 324 et seq.), (prohibits discrimination on the basis of sex);
- Section 504 of the Rehabilitation Act of 1973, (29 U.S.C. § 794 et seq.), as amended, (prohibits discrimination on the basis of disability); and 49 CFR Part 27;
- The Age Discrimination Act of 1975, as amended, (42 U.S.C. § 6101 et seq.), (prohibits discrimination on the basis of age);
- Airport and Airway Improvement Act of 1982, (49 USC § 471, Section 47123), as amended, (prohibits discrimination based on race, creed, color, national origin, or sex);
- The Civil Rights Restoration Act of 1987, (PL 100-209), (Broadened the scope, coverage and applicability of Title VI of the Civil Rights Act of 1964, The Age Discrimination Act of 1975 and Section 504 of the Rehabilitation Act of 1973, by expanding the definition of the terms "programs or activities" to include all of the programs or activities of the Federal-aid recipients, sub-recipients and contractors, whether such programs or activities are Federally funded or not);
- Titles II and III of the Americans with Disabilities Act, which prohibit discrimination on the basis of disability in the operation of public entities, public and private transportation systems, places of public accommodation, and certain testing entities (42 U.S.C. §§ 12131-12189) as implemented by Department of Transportation regulations at 49 C.F.R. parts 37 and 38;
- The Federal Aviation Administration's Non-discrimination statute (49 U.S.C. § 47123) (prohibits discrimination on the basis of race, color, national origin, and sex);
- Executive Order 12898, Federal Actions to Address Environmental Justice in Minority Populations and Low-Income Populations, which ensures Non-discrimination against minority populations by discouraging programs, policies, and activities with disproportionately high and adverse human health or environmental effects on minority and low-income populations;
- Executive Order 13166, Improving Access to Services for Persons with Limited English Proficiency, and resulting agency guidance, national origin discrimination includes discrimination because of Limited English proficiency (LEP). To ensure compliance with Title VI, you must take reasonable steps to ensure that LEP persons have meaningful access to your programs (70 Fed. Reg. at 74087 to 74100);
- Title IX of the Education Amendments of 1972, as amended, which prohibits you from discriminating because of sex in education programs or activities (20 U.S.C. 1681 et seq).

BUY AMERICA PROVISION

Buy America (as documented in M-22-11 from the Office of Management and Budget: <https://www.whitehouse.gov/wp-content/uploads/2022/04/M-22-11.pdf>) shall be domestic products and permanently incorporated in this project as classified in the following three categories, and as noted in the Construction and Materials Manual (CMM):

1. Iron and Steel

All iron and steel manufacturing and coating processes (from smelting forward in the manufacturing process) must have occurred within the United States. Coating includes epoxy coating, galvanizing, painting and any other coating that protects or enhances the value of a material subject to the requirements of Buy America.

The exemption of the iron and steel manufacturing and coating processes Buy America requirement is the minimal use of foreign materials if the total cost of such material permanently incorporated in the product does not exceed one-tenth of one percent (1/10 of 1%) of the total contract cost or \$2,500.00, whichever is greater. For purposes of this paragraph, the cost is that shown to be the value of the subject products as they are delivered to the project.

2. Manufactured Product

All manufactured products (as defined in CMM 228.5) are covered under a previous waiver from 1983, and are currently exempt from Buy America.

3. Construction Material

All construction materials (as defined in OMB M-22-11 and as referenced in CMM 228.5) must comply with Buy America. No exemptions (0.0%) are allowed.

The contractor shall take actions and provide documentation conforming to CMM 228.5 to ensure compliance with this Buy America provision.

<https://wisconsin.gov/rdwy/cmm/cm-02-28.pdf>

Upon completion of the project, certify to the engineer, in writing using department form DT4567 that all iron and steel, manufactured products, and construction materials conform to this Buy America provision.

Form DT4567 is available at: <https://wisconsin.gov/Documents/formdocs/dt4567.docx>

Attach a list of iron or steel exemptions and their associated costs to the certification form.



Proposal Schedule of Items

Proposal ID: 20230314033 Project(s): 1196-00-62

Federal ID(s): N/A

SECTION: 0001

Contract Items

Alt Set ID:

Alt Mbr ID:

Proposal Line Number	Item ID Description	Approximate Quantity and Units	Unit Price	Bid Amount
0002	204.0100 Removing Concrete Pavement	4,524.000 SY	_____.	_____.
0004	204.0115 Removing Asphaltic Surface Butt Joints	600.000 SY	_____.	_____.
0006	204.0120 Removing Asphaltic Surface Milling	30,875.000 SY	_____.	_____.
0008	208.1100 Select Borrow	68.000 CY	_____.	_____.
0010	211.0101 Prepare Foundation for Asphaltic Paving (project) 01. 1196-00-62	1.000 EACH	_____.	_____.
0012	213.0100 Finishing Roadway (project) 01. 1196-00-62	1.000 EACH	_____.	_____.
0014	305.0110 Base Aggregate Dense 3/4-Inch	360.000 TON	_____.	_____.
0016	305.0120 Base Aggregate Dense 1 1/4-Inch	94.000 TON	_____.	_____.
0018	305.0500 Shaping Shoulders	318.000 STA	_____.	_____.
0020	415.0090 Concrete Pavement 9-Inch	4,524.000 SY	_____.	_____.
0022	416.0610 Drilled Tie Bars	1,819.000 EACH	_____.	_____.
0024	416.0620 Drilled Dowel Bars	610.000 EACH	_____.	_____.
0026	455.0605 Tack Coat	3,899.000 GAL	_____.	_____.
0028	460.2000 Incentive Density HMA Pavement	2,160.000 DOL	1.00000	2,160.00
0030	460.6244 HMA Pavement 4 MT 58-34 S	3,363.000 TON	_____.	_____.
0032	465.0110 Asphaltic Surface Patching	200.000 TON	_____.	_____.



Proposal Schedule of Items

Proposal ID: 20230314033 Project(s): 1196-00-62

Federal ID(s): N/A

SECTION: 0001

Contract Items

Alt Set ID:

Alt Mbr ID:

Proposal Line Number	Item ID Description	Approximate Quantity and Units	Unit Price	Bid Amount
0034	465.0400 Asphaltic Shoulder Rumble Strips	21,442.000 LF	_____.	_____.
0036	520.1024 Apron Endwalls for Culvert Pipe 24-Inch	2.000 EACH	_____.	_____.
0038	520.8700 Cleaning Culvert Pipes	3.000 EACH	_____.	_____.
0040	606.0200 Riprap Medium	5.000 CY	_____.	_____.
0042	618.0100 Maintenance And Repair of Haul Roads (project) 01. 1196-00-62	1.000 EACH	_____.	_____.
0044	619.1000 Mobilization	1.000 EACH	_____.	_____.
0046	624.0100 Water	25.000 MGAL	_____.	_____.
0048	628.1504 Silt Fence	330.000 LF	_____.	_____.
0050	628.1520 Silt Fence Maintenance	50.000 LF	_____.	_____.
0052	628.1905 Mobilizations Erosion Control	2.000 EACH	_____.	_____.
0054	628.1910 Mobilizations Emergency Erosion Control	2.000 EACH	_____.	_____.
0056	628.7504 Temporary Ditch Checks	75.000 LF	_____.	_____.
0058	633.5200 Markers Culvert End	24.000 EACH	_____.	_____.
0060	642.5001 Field Office Type B	1.000 EACH	_____.	_____.
0062	643.0300 Traffic Control Drums	25,060.000 DAY	_____.	_____.
0064	643.0420 Traffic Control Barricades Type III	1,285.000 DAY	_____.	_____.



Proposal Schedule of Items

Proposal ID: 20230314033 Project(s): 1196-00-62

Federal ID(s): N/A

SECTION: 0001

Contract Items

Alt Set ID:

Alt Mbr ID:

Proposal Line Number	Item ID Description	Approximate Quantity and Units	Unit Price	Bid Amount
0066	643.0705 Traffic Control Warning Lights Type A	1,390.000 DAY	_____.	_____.
0068	643.0715 Traffic Control Warning Lights Type C	1,445.000 DAY	_____.	_____.
0070	643.0800 Traffic Control Arrow Boards	100.000 DAY	_____.	_____.
0072	643.0900 Traffic Control Signs	4,915.000 DAY	_____.	_____.
0074	643.1050 Traffic Control Signs PCMS	30.000 DAY	_____.	_____.
0076	643.3155 Temporary Marking Line Removable Contrast Tape 4-Inch	200.000 LF	_____.	_____.
0078	643.3255 Temporary Marking Line Removable Contrast Tape 8-Inch	400.000 LF	_____.	_____.
0080	643.5000 Traffic Control	1.000 EACH	_____.	_____.
0082	645.0120 Geotextile Type HR	173.000 SY	_____.	_____.
0084	646.1545 Marking Line Grooved Wet Ref Contrast Epoxy 4-Inch	40,418.000 LF	_____.	_____.
0086	646.3545 Marking Line Grooved Wet Ref Contrast Epoxy 8-Inch	1,230.000 LF	_____.	_____.
0088	646.5020 Marking Arrow Epoxy	7.000 EACH	_____.	_____.
0090	646.5120 Marking Word Epoxy	7.000 EACH	_____.	_____.
0092	646.6120 Marking Stop Line Epoxy 18-Inch	116.000 LF	_____.	_____.
0094	646.9000 Marking Removal Line 4-Inch	350.000 LF	_____.	_____.



Proposal Schedule of Items

Proposal ID: 20230314033 Project(s): 1196-00-62

Federal ID(s): N/A

SECTION: 0001

Contract Items

Alt Set ID:

Alt Mbr ID:

Proposal Line Number	Item ID Description	Approximate Quantity and Units	Unit Price	Bid Amount
0096	650.8000 Construction Staking Resurfacing Reference	13,500.000 LF	_____.	_____.
0098	650.9911 Construction Staking Supplemental Control (project) 01. 1196-00-62	1.000 EACH	_____.	_____.
0100	690.0150 Sawing Asphalt	722.000 LF	_____.	_____.
0102	690.0250 Sawing Concrete	22,382.000 LF	_____.	_____.
0104	715.0720 Incentive Compressive Strength Concrete Pavement	1,357.000 DOL	1.00000	1,357.00
0106	SPV.0180 Special 01. Concrete Pavement Repair Doweled	325.000 SY	_____.	_____.
0108	SPV.0180 Special 02. Concrete Pavement Replacement Doweled	3,895.000 SY	_____.	_____.
0110	SPV.0180 Special 03. 30-inch Concrete Centerline Repair	65.000 SY	_____.	_____.
Section: 0001			Total:	_____.
			Total Bid:	_____.

PLEASE ATTACH ADDENDA HERE



Wisconsin Department of Transportation

March 9, 2023

Division of Transportation Systems Development

Bureau of Project Development
4822 Madison Yards Way, 4th Floor South
Madison, WI 53705

Telephone: (608) 266-1631
Facsimile (FAX): (608) 266-8459

NOTICE TO ALL CONTRACTORS:

Proposal #33: 1196-00-62
Minong – Solon Springs
Bus 53 (Minong) to Lakeside Rd (NB)
USH 53
Washburn County

Letting of March 14, 2023

This is Addendum No. 01, which provides for the following:

Special Provisions:

Added Special Provisions	
Article No.	Description
13	Removing Riprap, Item 204.9035.S.
14	Removing Apron Endwalls, Item 204.9060.S

Schedule of Items:

Revised Bid Item Quantities					
Bid Item	Item Description	Unit	Proposal Total Prior to Addendum	Proposal Quantity Change (-)	Proposal Total After Addendum
204.0120	Removing Asphaltic Surface Milling	SY	30,875	668	31,543
455.0605	Tack Coat	GAL	3,899	89	3,988
460.6244	HMA Pavement 4 MT 58-34 S	TON	3,363	224	3,587
643.0900	Traffic Control Signs	DAY	4,915	1840	6,755
643.3155	Temporary Marking Line Removable Contrast Tape 4-Inch	LF	200	2,000	2,200

Added Bid Item Quantities					
Bid Item	Item Description	Unit	Proposal Total Prior to Addendum	Quantity Added	Proposal Total After Addendum
204.9035.S	Removing Riprap	CY	0	5	5
204.9060.S	Removing Apron Endwalls	Each	0	2	2
625.0500	Salvaged Topsoil	SY	0	15	15

627.0200	Mulching	SY	0	15	15
630.0130	Seeding Mixture No. 30	LB	0	5	5

Plan Sheets:

Revised Plan Sheets	
Plan Sheet	Plan Sheet Title (brief description of changes to sheet)
3	Typical Sections (added 6-ft shoulder widening to inside lane)
6	Traffic Control (added 6-ft shoulder widening to stage 1 section)
17	Miscellaneous Quantities (Removing Asphaltic Surface Milling quantity updated)
20	Miscellaneous Quantities (Tack Coat/HMA Pavement 4MT58-34S quantity updated)
22	Miscellaneous Quantities (Traffic Control Signs quantity updated)
23	Miscellaneous Quantities (Temporary Marking Line Removable Contrast Tape 4-Inch quantity updated)

Added Plan Sheets	
Plan Sheet	Plan Sheet Title (brief description of why sheet was added)
25A	Miscellaneous Quantities (added bid items)
55A	SDD (add SDD 15c02-f Advance Width Restrictions Signing)

The responsibility for notifying potential subcontractors and suppliers of these changes remains with the prime contractor.

Sincerely,

Mike Coleman

Proposal Development Specialist
Proposal Management Section

ADDENDUM NO. 01

1196-00-62

March 9, 2023

Special Provisions

13. Removing Riprap, Item 204.9035.S.01

A Description

This special provision describes removing riprap conforming to standard spec 204.

B (Vacant)

C Construction

Carefully remove the riprap and dispose of all materials.

D Measurement

The department will measure Removing Riprap in cubic yard, acceptably completed.

E Payment

Add the following to standard spec 204.5:

ITEM NUMBER	DESCRIPTION	UNIT
204.9035.S	Removing Riprap	CY
stp-204-025 (20230113)		

14. Removing Apron Endwalls, Item 204.9060.S.01

A Description

This special provision describes removing apron endwalls conforming to standard spec 204.

B (Vacant)

C (Vacant)

D Measurement

The department will measure Removing Removing Apron Endwalls in each, acceptably completed.

E Payment

Add the following to standard spec 204.5:

ITEM NUMBER	DESCRIPTION	UNIT
204.9060.S	Removing Apron Endwalls	Each
stp-204-025 (20230113)		

Schedule of Items

Attached, dated March 9, 2023, are the revised Schedule of Items Pages 1 – 4.

Plan Sheets

The following 8½ x 11-inch sheets are attached and made part of the plans for this proposal:

Revised: 3, 6, 17, 20, 22, 23

Added: 25A, 55A

END OF ADDENDUM

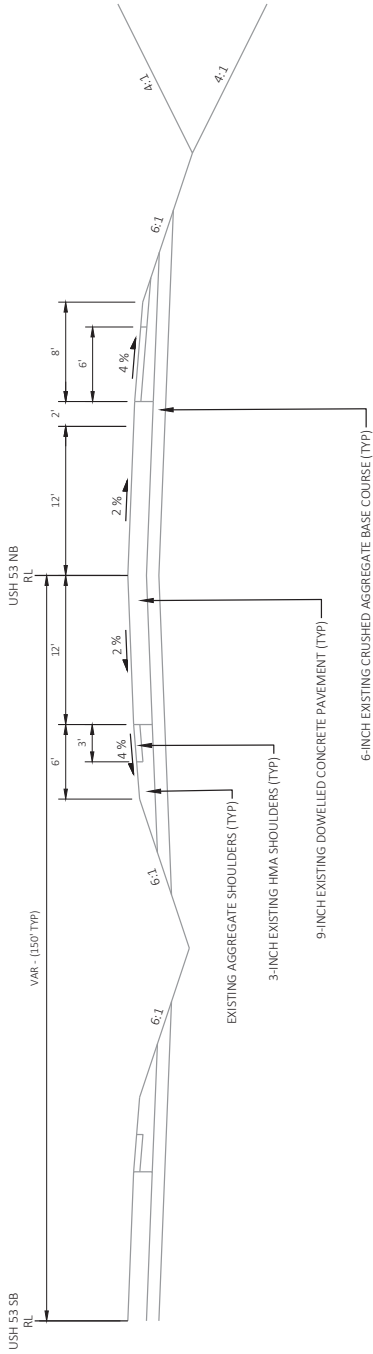

TYPICAL EXISTING SECTION

USH 53
STA 622+54 TO STA 751+39

Addendum No. 01
ID 1196-00-62
Revised Sheet 3
March 9, 2023

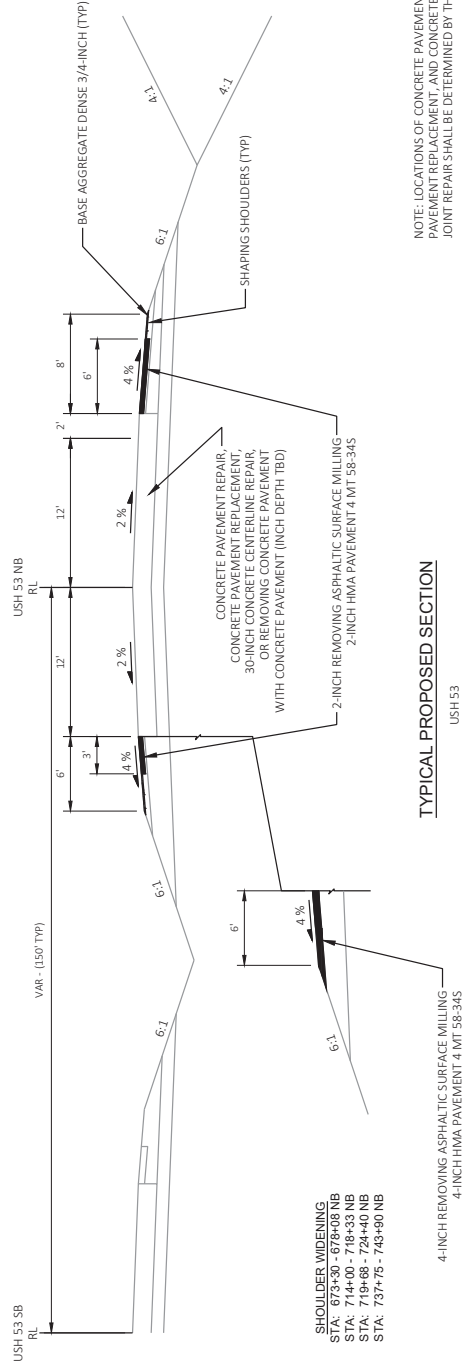

TYPICAL PROPOSED SECTION

USH 53
STA 622+54 TO STA 751+39

PROJECT NO: 1196-00-62	COUNTY: WASHBURN	TYPICAL SECTIONS	SHEET 3	E
FILE NAME: C:\CSD\11960032\USHEFSR\AND2050-15.DWG	FLYBY: THAO, KOU	PLOT NAME:	PLOT SCALE: 1 IN=10 FT	WISDOT/CADD SHEET 42
LAYOUT NAME: 003201-15-1.mxd	PLOT DATE: 3/09/2023 3:27 PM			
HWY: USH 53				

GENERAL NOTES

- BARRIERS, BARRICADES, AND ARROW BOARDS SHALL BE PLACED ACCORDING TO:
 - SDD 15012 "TRAFFIC CONTROL - LANE CLOSURE, SPEED REDUCTION"
 - SDD 15015 "TRAFFIC CONTROL - PARALLEL ENTRANCE RAMP WITHIN LANE CLOSURE"
 - SDD 15021 "TRAFFIC CONTROL, TAPERED ENTRANCE RAMP WITHIN LANE CLOSURE"
 - SDD 15027 "TRAFFIC CONTROL, SHOULDER CLOSURE ON DIVIDED ROADWAY, SPEEDS GREATER THAN 40 MPH"
 - SDD 15039 "TRAFFIC CONTROL, DROP-OFF SIGNING"
 - SDD 15040 "TRAFFIC CONTROL, PARTIAL LANE SHIFT MULTILANE DIVIDED 50 MPH AND GREATER"
- ALL SIGNS AND DEVICES SHALL BE IN CONFORMANCE WITH THE WISCONSIN MANUAL ON UNIFORM TRAFFIC CONTROL DEVICES (WMUTCD).
- THE EXACT NUMBER, LOCATION, AND SPACING OF ALL TRAFFIC CONTROL DEVICES ARE APPROXIMATE AND SHALL BE ADJUSTED TO FIT FIELD CONDITIONS AS DIRECTED BY THE ENGINEER.
- DURING HOURS OF DARKNESS ALL BARRICADES USED TO SHIELD A HAZARD SHALL BE EQUIPPED WITH WARNING LIGHTS, TYPE A.
- ALL SIGNS ARE 48"x48" UNLESS OTHERWISE NOTED.
- "WO" SIGNS ARE THE SAME AS "W" SIGNS EXCEPT THE BACKGROUND IS ORANGE.
- DRUMS IN TAPERS SHALL BE EQUIPPED WITH TYPE C (STEADY BURN) TRAFFIC CONTROL WARNING LIGHTS.
- ANY SIGNS TEMPORARY OR EXISTING WHICH CONFLICT WITH TRAFFIC CONTROL "IN USE" SHALL BE COVERED OR REMOVED AS NEEDED AND AS APPROVED BY THE ENGINEER.
- USH 53 NB RIGHT TURN LANES SHALL BE OPEN WHEN THE OUTSIDE LANE IS CLOSED. INTERSECTION STAGING SHALL BE DETERMINED BY CONTRACTOR MEANS AND METHODS. INTERSECTION STAGING SHALL BE APPROVED BY THE ENGINEER PRIOR TO DEPLOYMENT.

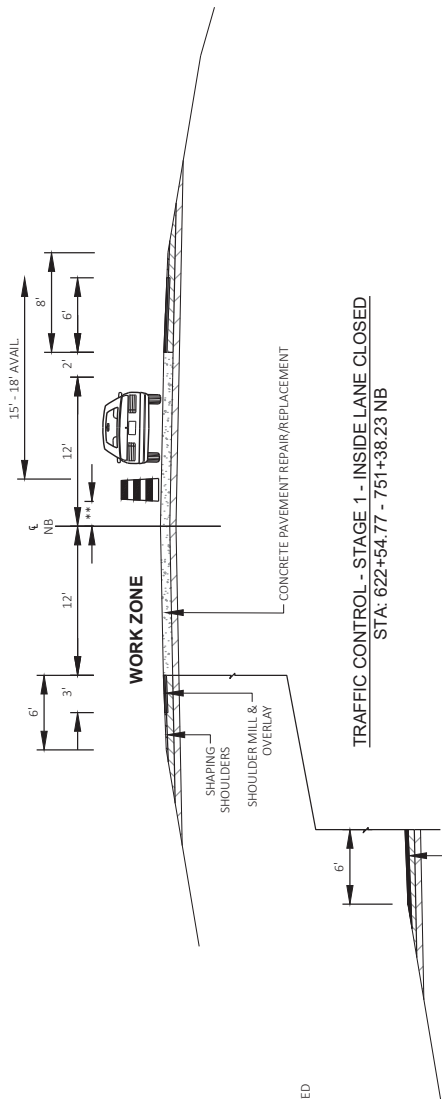

TRAFFIC CONTROL - STAGE 1 - INSIDE LANE CLOSED
STA: 622+54.77 - 751+38.23 NB

- ** NOTE
- 0" TYP. FOR CENTERLINE JOINT REPAIR
 - UP TO 3" FOR CONCRETE PAVEMENT 9-INCH
 - UP TO 4" FOR CONCRETE PAVEMENT 9-INCH

SHOULDER WIDENING
 STA: 673+30 - 678+08 NB
 STA: 714+00 - 718+33 NB
 STA: 719+68 - 724+40 NB
 STA: 737+75 - 743+90 NB

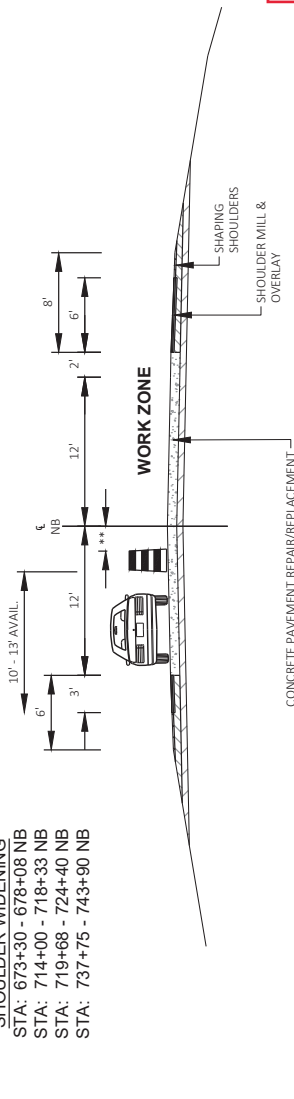

TRAFFIC CONTROL - STAGE 2 - OUTSIDE LANE CLOSED
STA: 622+54.77 - 751+38.23 NB

Addendum No. 01
 ID 1196-00-62
 Revised Sheet 6
 March 9, 2023

PROJECT NO: 1196-00-62

HWY: USH 53

COUNTY: WASHBURN

TRAFFIC CONTROL

SHEET

6

E

FILE NAME: C:\CSD\11960032\SHETS\PLAN\2500-TC_A08RND\DM.DWG LAYOUT NAME: 1-C1

PLOT DATE: 3/8/2023 3:52 PM

FLYBY: THAO_KOU PLOT NAME:

PLOT SCALE: 1 IN=10 FT

WISDOT/CADD SHEET 42

CATEGORY	STATION	TO	STATION	LOCATION	SY	REMARKS
0010	674+82	-	684+33	RT	1,480	UNDISTRIBUTED
0010	685+38	-	694+89	RT	1,480	
0010	715+48	-	718+65	RT	494	
0010	719+17	-	722+87	RT	576	
0010	739+24	-	742+41	RT	494	
TOTAL 0010					4,524	

CATEGORY	LOCATION	SY	REMARKS
0010	PROJECT	600	UNDISTRIBUTED
TOTAL 0010		600	

CATEGORY	STATION	TO	STATION	LOCATION	SY	REMARKS
0010	624+55	-	642+48	NB LEFT ASPHALT SHOULDER	665	PROJECT BEGIN LIMIT
0010	642+48	-	644+06	MINONG SOUTH BUSINESS 53 MEDIAN	591	
0010	644+06	-	664+37	NB LEFT ASPHALT SHOULDER	677	
0010	664+37	-	665+39	MEDIAN	588	
0010	665+39	-	673+30	NB LEFT ASPHALT SHOULDER	264	NORTH LIMIT AT RECENT PAVING
0010	673+30	-	678+08	NB LEFT ASPHALT SHOULDER	319	6-FT SHLD WIDENING
0010	698+18	-	702+05	NB LEFT ASPHALT SHOULDER	129	SOUTH LIMIT AT RECENT PAVING
0010	702+05	-	703+85	WALLACEST MEDIAN	680	
0010	703+85	-	714+00	NB LEFT ASPHALT SHOULDER	339	
0010	714+00	-	718+33	NB LEFT ASPHALT SHOULDER	289	6-FT SHLD WIDENING
0010	718+33	-	719+68	MINONG NORTH BUSINESS 53 MEDIAN	445	
0010	719+68	-	724+40	NB LEFT ASPHALT SHOULDER	315	6-FT SHLD WIDENING
0010	724+40	-	737+75	NB LEFT ASPHALT SHOULDER	445	
0010	737+75	-	743+90	NB LEFT ASPHALT SHOULDER	410	6-FT SHLD WIDENING
0010	743+90	-	751+38	NB LEFT ASPHALT SHOULDER	250	PROJECT END LIMIT
0010	616+87	-	645+98	SOUTH BUSINESS 53 & RAMPS	11,725	
0010	624+55	-	640+77	NB RIGHT ASPHALT SHOULDER	1,215	PROJECT BEGIN LIMIT
0010	640+77	-	644+30	RIGHT TURN LANE & MINONG SOUTH BUSINESS 53	811	
0010	644+30	-	677+08	NB RIGHT ASPHALT SHOULDER	2,186	
0010	683+78	-	689+58	RIGHT TURN LANE & SHOULDER THROUGH 5TH 77	733	NORTH LIMIT AT RECENT PAVING
0010	689+58	-	702+24	NB RIGHT ASPHALT SHOULDER	844	SOUTH LIMIT AT RECENT PAVING
0010	702+24	-	703+79	NB RIGHT ASPHALT SHOULDER & WALLACE ST	376	
0010	703+79	-	714+54	NB RIGHT ASPHALT SHOULDER	171	
0010	714+54	-	720+43	RIGHT TURN LANE & MINONG NORTH BUSINESS 53	1,401	
0010	719+03	-	725+28	NORTH BUSINESS 53 & RAMPS	2,546	
0010	720+43	-	726+20	NB RIGHT ASPHALT SHOULDER	385	
0010	725+35	-	726+20	NB RAMP LEFT ASPHALT SHOULDER	29	
0010	725+35	-	729+73	NB RIGHT GORE AREA	433	
0010	725+35	-	751+38	NB RAMP / MAINLINE RIGHT ASPHALT SHOULDER	1,736	PROJECT END LIMIT
TOTAL 0010					31,543	

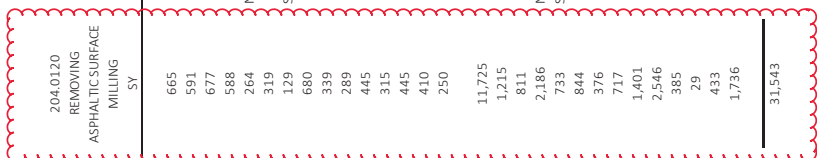

CATEGORY	STATION	LOCATION	CY	REMARKS
0010	645+90	RT	68	REPAIR ONE-FOOT DROP OFF
TOTAL 0010			68	

CATEGORY	LOCATION	LS	REMARKS
0010	PROJECT	1	SHLDS, TURNLANES, ROADWAY, RAMPS
TOTAL 0010		1	

CATEGORY	LOCATION	EACH	REMARKS
0010	PROJECT	1	PROJECT LIMITS
TOTAL 0010		1	

Addendum No. 01
ID 1196-00-62
Revised Sheet 17
March 9, 2023

Addendum No. 01
ID 1196-00-62
Revised Sheet 20
March 9, 2023

CATEGORY	STATION	TO	STATION	LOCATION	455.0605 TACK COAT GAL	460.6244 HMA PAVEMENT 4 MT 58-34 S TON	465.0110 ASPHALTIC SURFACE PATCHING TON	465.0400 ASPHALTIC SHOULDER RUMBLE STRIPS LF	REMARKS
									ALL LOCATIONS HAVE BEEN MULTIPLIED BY 2 FOR TACK COAT TO ESTIMATE WITH 2 LIFTS
									PROJECT BEGIN LIMIT
0010	622+55	-	642+48	NB LEFT ASPHALT SHOULDER	87	75	1,993		
0010	642+48	-	644+06	MINONG SOUTH BUSINESS 53 MEDIATE	77	67			
0010	644+06	-	664+37	NB LEFT ASPHALT SHOULDER	89	76	2,031		
0010	664+37	-	665+39	MEDIATE	38	33			
0010	665+39	-	673+30	NB LEFT ASPHALT SHOULDER	35	30			
0010	673+30	-	678+08	NB LEFT ASPHALT SHOULDER	42	72			NORTH LIMIT AT RECENT PAVING
0010	698+18	-	702+05	NB LEFT ASPHALT SHOULDER	17	15			6-FT SHLD WIDENING
0010	702+05	-	703+85	WALLACE ST MEDIATE	51	44			SOUTH LIMIT AT RECENT PAVING
0010	703+85	-	714+00	NB LEFT ASPHALT SHOULDER	44	38			
0010	714+00	-	718+33	NB LEFT ASPHALT SHOULDER	38	65			6-FT SHLD WIDENING
0010	718+33	-	719+68	MINONG NORTH BUSINESS 53 MEDIATE	34	30			
0010	719+68	-	724+40	NB LEFT ASPHALT SHOULDER	41	71			6-FT SHLD WIDENING
0010	724+40	-	737+75	NB LEFT ASPHALT SHOULDER	58	50			
0010	737+75	-	743+90	NB LEFT ASPHALT SHOULDER	54	92			6-FT SHLD WIDENING
0010	743+90	-	751+38	NB LEFT ASPHALT SHOULDER	33	28			PROJECT END LIMIT
0010	616+87	-	645+98	SOUTH BUSINESS 53 & RAMPS	1,525	1,314			
0010	622+55	-	640+77	NB RIGHT ASPHALT SHOULDER	158	137			PROJECT BEGIN LIMIT
0010	640+77	-	644+30	RIGHT TURN LANE & MINONG SOUTH BUSINESS 53	106	91			
0010	644+30	-	677+08	NB RIGHT ASPHALT SHOULDER	285	245			
0010	683+78	-	689+58	RIGHT TURN LANE & SHOULDER THROUGH 5TH 77	96	82			NORTH LIMIT AT RECENT PAVING
0010	689+58	-	702+24	NB RIGHT ASPHALT SHOULDER	110	95			SOUTH LIMIT AT RECENT PAVING
0010	702+24	-	703+79	NB RIGHT ASPHALT SHOULDER & WALLACE ST	44	38			
0010	703+79	-	714+54	NB RIGHT ASPHALT SHOULDER	94	81			
0010	714+54	-	720+43	RIGHT TURN LANE & MINONG NORTH BUSINESS 53	163	140			
0010	719+03	-	725+28	NORTH BUSINESS 53 & RAMPS	331	286			
0010	720+43	-	726+20	NB RIGHT ASPHALT SHOULDER	51	44			
0010	725+35	-	726+20	NB RAMP LEFT ASPHALT SHOULDER	4	4			
0010	725+35	-	729+73	NB RIGHT GORE AREA	57	49			
0010	725+35	-	751+38	NB RAMP/MAINLINE RIGHT ASPHALT SHOULDER	226	195			PROJECT END LIMIT
				PROJECT			200		UNDISTRIBUTED
				TOTAL 0010	3,988	3,587	200	21,442	

Addendum No. 01
ID 1196-00-62
Revised Sheet 22
March 9, 2023

CATEGORY	LOCATION	DAY	643.0300	643.0420	643.0705	643.0715	643.0800	643.0900	643.1050	643.5000	REMARKS
0010	PROJECT START	1,900	50	100	700	100	1				PER SDD TRAFFIC CONTROL, LANE CLOSURE SPEED REDUCTION
0010	PROJECT START	1,000	100	200	250	100	1				PER SDD TRAFFIC CONTROL, PARALLEL EXIT RAMP WITH LANE CLOSURE
0010	WALLACE ST, WOODWARD ENTRANCE	1,300	100								RIGHT LANE CLOSED; NO RTL BAY
0010	BUS 53 SOUTH, STH 77, BUS 53 NORTH	7,650	150								RIGHT LANE CLOSED; RTL BAY
0010	BUS 53 SOUTH, MEDIUM I, WALLACE ST, BUS 53 NORTH	3,400	200								LEFT LANE CLOSED; NO LTL BAY
0010	BUS 53 SOUTH & NORTH RAMPS	810	135								RAMP CLOSURES
0010	STH 77	2,750	50								LEFT LANE CLOSED; LTL BAY
0010	MAINLINE LENGTH	6,250	500								APPROX 12,500 LF
0010	PROJECT										ESTIMATING 3 PCMS FOR 10 DAYS PRECONSTRUCTION ANNOUNCEMENT
0010	USH 53 NB, LANE WIDTH RESTRICTIONS										PER SDD 15 COZ-F ADVANCED WIDTH RESTRICTIONS SIGNING
	TOTAL 0010	25,060	1,285	1,390	1,445	100					
								6,755	30	1	

CATEGORY	STATION	LOCATION	645.0120	REMARKS
			SY	
0010	645+90	RT	173	REPAIR ONE-FOOT DROP OFF
	TOTAL 0010		173	

Addendum No. 01
ID 1196-00-62
Revised Sheet 23
March 9, 2023

STATION	TO STATION	LOCATION	MARKING LINE GROOVED WET REF CONTRAST EPOXY 4-INCH LF	MARKING LINE GROOVED WET REF CONTRAST EPOXY 8-INCH LF	MARKING ARROW EPOXY EACH	MARKING WORD EPOXY EACH	MARKING STOP LINE EPOXY 18-INCH LF	REMARKS
616+87	- 645+98	SOUTH BUSINESS 53 & RAMPS	4,345				16	WHITE
616+87	- 645+98	SOUTH BUSINESS 53 & RAMPS	4,270					YELLOW
622+54	- 642+60	RT EDGELINE	2,006					WHITE
641+30	- 642+60	RIGHT TURN LANE CHANNELIZING		130				WHITE
641+13	- 642+51	RIGHT TURN LANE			1			RIGHT TURN ARROW; "ONLY"
643+50	- 643+50	BUS 53 SOUTH; RT					20	WHITE
644+00	- 687+38	RT EDGELINE	4,338					WHITE
681+50	- 682+50	RIGHT TURN LANE			1			RIGHT TURN ARROW; "ONLY"
683+75	- 687+40	RIGHT TURN LANE CHANNELIZING		365				WHITE
685+50	- 686+50	RIGHT TURN LANE			1			RIGHT TURN ARROW; "ONLY"
688+87	- 702+30	RT EDGELINE	1,343					WHITE
703+30	- 718+61	RT EDGELINE	1,531					WHITE
715+10	- 718+60	RIGHT TURN LANE CHANNELIZING		350				WHITE
715+41	- 715+85	RIGHT TURN LANE			1			RIGHT TURN ARROW; "ONLY"
718+05	- 718+45	RIGHT TURN LANE			1			RIGHT TURN ARROW; "ONLY"
719+03	- 725+28	NORTH BUSINESS 53 & RAMPS	1,237					WHITE
719+03	- 725+28	NORTH BUSINESS 53 & RAMPS	1,078				20	YELLOW
719+49	- 733+31	BUS 53 NORTH; RT	1,339					WHITE
725+35	- 733+31	RT EDGELINE INTO LEFT GORE	796					WHITE
725+35	- 751+39	BUS 53 NORTH RAMP LT EDGELINE INTO RIGHT GORE	2,604					WHITE
622+54	- 642+72	LT EDGELINE	2,018					YELLOW
643+50	- 643+50	BUS 53 SOUTH MEDIAN (BOTH DIRECTIONS); LT					60	WHITE
644+06	- 686+63	LT EDGELINE	4,257					YELLOW
681+60	- 682+50	LEFT TURN LANE			1			LEFT TURN ARROW; "ONLY"
683+75	- 687+60	LEFT TURN LANE CHANNELIZING		385				WHITE
685+50	- 686+50	LEFT TURN LANE			1			LEFT TURN ARROW; "ONLY"
688+46	- 702+20	LT EDGELINE	1,374					YELLOW
703+62	- 718+46	LT EDGELINE	1,484					YELLOW
719+66	- 751+39	LT EDGELINE	3,173					YELLOW
622+54	- 751+39	RL, ON LEFT LANE PANEL	3,225					WHITE SKIPS
TOTAL 0010			40,418	1,230	7	7	116	
MARKING REMOVAL LINE 4-INCH LF			646.9000					
0010	607+70 - 611+20	RT	350					SDD TRAFFIC CONTROL PARALLEL EXIT RAMP WITHIN LANE CLOSURE
0010	607+70 - 609+70	RT	200					WHITE TAPE; SDD TRAFFIC CONTROL PARALLEL EXIT RAMP WITHIN LANE CLOSURE
0010	612+85 - 614+85	RT	2,000				400	WHITE TAPE; SDD TRAFFIC CONTROL PARALLEL EXIT RAMP WITHIN LANE CLOSURE
0010	673+30 - 743+90	LT	2,200				400	INSIDE SHOULDER WIDENING LOCATIONS; SEE ASHALTIC SURFACE TEMPORARY ITEM
TOTAL 0010			350					

Addendum No. 01
ID 1196-00-62
Added Sheet 25A
March 9, 2023

CULVERT PIPE AEW RESTORATION

204.9035.S.01	204.9060.S.01	625.0500	627.0200	630.0130
REMOVING RIPRAP CY	REMOVING APRON ENDWALLS EACH	SALVAGED TOPSOIL SY	MULCHING SY	SEEDING MIXTURE NO. 30 LB
5	1	10	10	3
-	1	5	5	2
5	2	15	15	5
TOTAL 0010				

REMARKS
REPAIR OF ONE-FOOT DROP AT ENDWALL (CONCRETE)
REPLACES 24-INCH CONCRETE AEW



SDD 15C02-f Advanced Width Restriction Signing

LEGEND
SIGN ON PERMANENT SUPPORT

GENERAL NOTES

THE EXACT NUMBER, LOCATION AND SPACING OF ALL SIGNS SHALL BE ADJUSTED TO FIT FIELD CONDITIONS AS APPROVED BY THE ENGINEER.

THE SPACING BETWEEN SIGNS SHOULD BE ADJUSTED TO NOT CONFLICT WITH ANY OTHER SIGNS. A MINIMUM OF 200 FEET CLEARANCE TO EXISTING SIGNS THAT WILL REMAIN IN PLACE.

ANY SIGNS TEMPORARY OR EXISTING, WHICH CONFLICT WITH TRAFFIC CONTROL - "IN USE" - SHALL BE REMOVED OR COVERED AS NEEDED AND AS APPROVED BY THE ENGINEER.

ALL SIGNS ARE 48" X 48" UNLESS OTHERWISE NOTED.

"W" SIGNS ARE THE SAME AS "M" SIGNS EXCEPT THE BACKGROUND IS ORANGE.

WIDTH ON SIGN TO BE APPROXIMATELY ONE FOOT LESS THAN AVAILABLE WIDTH.

PLACE 500 FEET AFTER THE W20 - 1A AND 500 FEET BEFORE ADDITIONAL SIGNS FOR ROADWAYS WITH A PRE - CONSTRUCTION SPEED LIMIT OF 45 MPH OR MORE. FOR 35-40 MPH, USE 350 FOOT TYPICAL SPACING. FOR 25-30 MPH, USE 200 FOOT TYPICAL SPACING.

SIGN SHALL BE VISIBLE FROM ROADWAY.

ADDITIONAL SIGNS NEEDED IF THERE IS AN ON RAMP BETWEEN SIGNS.

*
**

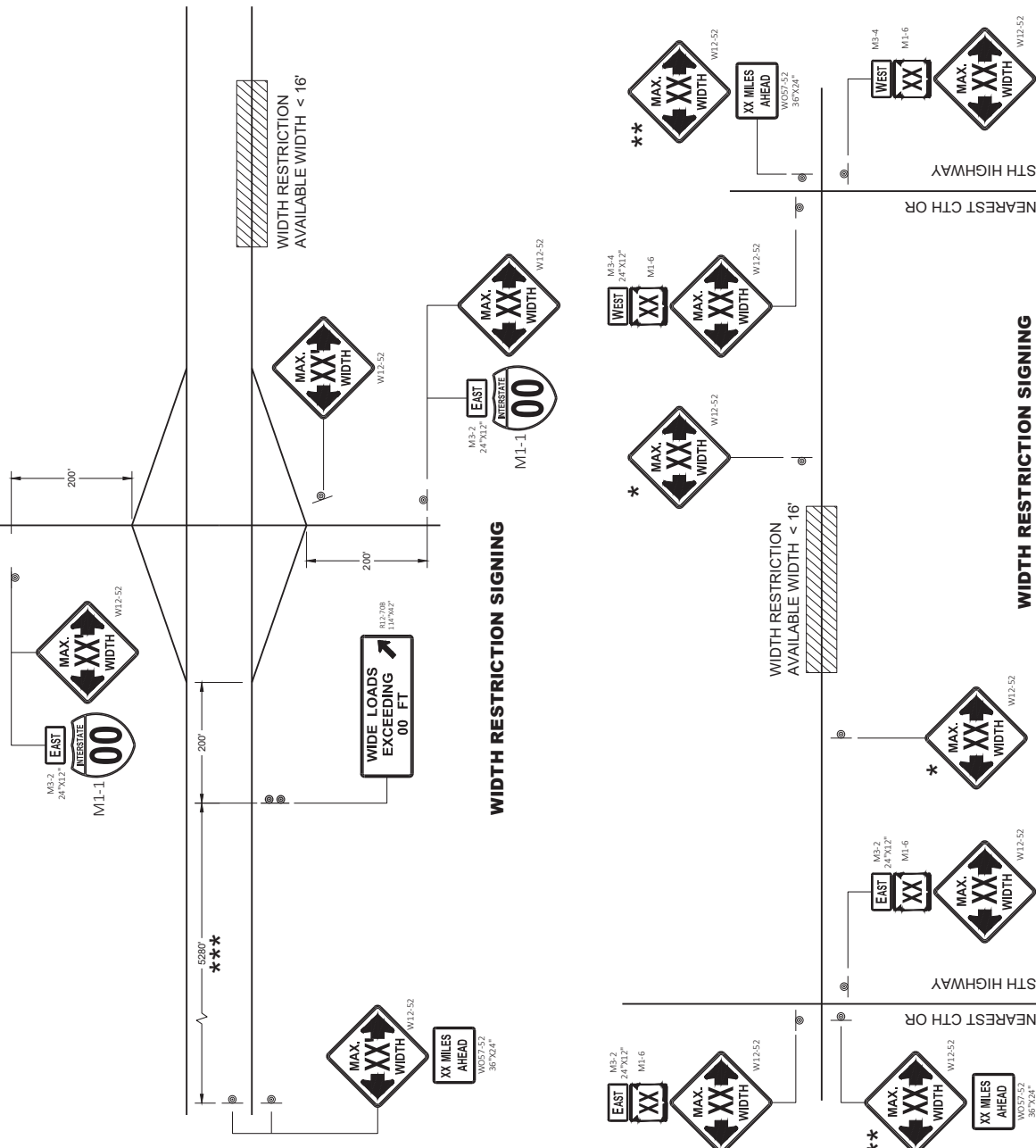

WIDTH ON SIGN TO BE APPROX. 1-FOOT LESS THAN AVAILABLE WIDTH

Addendum No. 01
ID 1196-00-62
Added Sheet 55A
March 9, 2023

ADVANCED WIDTH RESTRICTION SIGNING

STATE OF WISCONSIN
DEPARTMENT OF TRANSPORTATION

APPROVED
February 2020
DATE
/S/ Andrew Hedding
WORK-ZONE ENGINEER



Proposal Schedule of Items

Proposal ID: 20230314033 Project(s): 1196-00-62

Federal ID(s): N/A

SECTION: 0001

Contract Items

Alt Set ID:

Alt Mbr ID:

Proposal Line Number	Item ID Description	Approximate Quantity and Units	Unit Price	Bid Amount
0002	204.0100 Removing Concrete Pavement	4,524.000 SY	_____.	_____.
0004	204.0115 Removing Asphaltic Surface Butt Joints	600.000 SY	_____.	_____.
0006	204.0120 Removing Asphaltic Surface Milling	31,543.000 SY	_____.	_____.
0008	208.1100 Select Borrow	68.000 CY	_____.	_____.
0010	211.0101 Prepare Foundation for Asphaltic Paving (project) 01. 1196-00-62	1.000 EACH	_____.	_____.
0012	213.0100 Finishing Roadway (project) 01. 1196-00-62	1.000 EACH	_____.	_____.
0014	305.0110 Base Aggregate Dense 3/4-Inch	360.000 TON	_____.	_____.
0016	305.0120 Base Aggregate Dense 1 1/4-Inch	94.000 TON	_____.	_____.
0018	305.0500 Shaping Shoulders	318.000 STA	_____.	_____.
0020	415.0090 Concrete Pavement 9-Inch	4,524.000 SY	_____.	_____.
0022	416.0610 Drilled Tie Bars	1,819.000 EACH	_____.	_____.
0024	416.0620 Drilled Dowel Bars	610.000 EACH	_____.	_____.
0026	455.0605 Tack Coat	3,988.000 GAL	_____.	_____.
0028	460.2000 Incentive Density HMA Pavement	2,160.000 DOL	1.00000	2,160.00
0030	460.6244 HMA Pavement 4 MT 58-34 S	3,587.000 TON	_____.	_____.
0032	465.0110 Asphaltic Surface Patching	200.000 TON	_____.	_____.



Proposal Schedule of Items

Proposal ID: 20230314033 Project(s): 1196-00-62

Federal ID(s): N/A

SECTION: 0001

Contract Items

Alt Set ID:

Alt Mbr ID:

Proposal Line Number	Item ID Description	Approximate Quantity and Units	Unit Price	Bid Amount
0034	465.0400 Asphaltic Shoulder Rumble Strips	21,442.000 LF	_____.	_____.
0036	520.1024 Apron Endwalls for Culvert Pipe 24-Inch	2.000 EACH	_____.	_____.
0038	520.8700 Cleaning Culvert Pipes	3.000 EACH	_____.	_____.
0040	606.0200 Riprap Medium	5.000 CY	_____.	_____.
0042	618.0100 Maintenance And Repair of Haul Roads (project) 01. 1196-00-62	1.000 EACH	_____.	_____.
0044	619.1000 Mobilization	1.000 EACH	_____.	_____.
0046	624.0100 Water	25.000 MGAL	_____.	_____.
0048	628.1504 Silt Fence	330.000 LF	_____.	_____.
0050	628.1520 Silt Fence Maintenance	50.000 LF	_____.	_____.
0052	628.1905 Mobilizations Erosion Control	2.000 EACH	_____.	_____.
0054	628.1910 Mobilizations Emergency Erosion Control	2.000 EACH	_____.	_____.
0056	628.7504 Temporary Ditch Checks	75.000 LF	_____.	_____.
0058	633.5200 Markers Culvert End	24.000 EACH	_____.	_____.
0060	642.5001 Field Office Type B	1.000 EACH	_____.	_____.
0062	643.0300 Traffic Control Drums	25,060.000 DAY	_____.	_____.
0064	643.0420 Traffic Control Barricades Type III	1,285.000 DAY	_____.	_____.



Proposal Schedule of Items

Proposal ID: 20230314033 Project(s): 1196-00-62

Federal ID(s): N/A

SECTION: 0001

Contract Items

Alt Set ID:

Alt Mbr ID:

Proposal Line Number	Item ID Description	Approximate Quantity and Units	Unit Price	Bid Amount
0066	643.0705 Traffic Control Warning Lights Type A	1,390.000 DAY	_____.	_____.
0068	643.0715 Traffic Control Warning Lights Type C	1,445.000 DAY	_____.	_____.
0070	643.0800 Traffic Control Arrow Boards	100.000 DAY	_____.	_____.
0072	643.0900 Traffic Control Signs	6,755.000 DAY	_____.	_____.
0074	643.1050 Traffic Control Signs PCMS	30.000 DAY	_____.	_____.
0076	643.3155 Temporary Marking Line Removable Contrast Tape 4-Inch	2,200.000 LF	_____.	_____.
0078	643.3255 Temporary Marking Line Removable Contrast Tape 8-Inch	400.000 LF	_____.	_____.
0080	643.5000 Traffic Control	1.000 EACH	_____.	_____.
0082	645.0120 Geotextile Type HR	173.000 SY	_____.	_____.
0084	646.1545 Marking Line Grooved Wet Ref Contrast Epoxy 4-Inch	40,418.000 LF	_____.	_____.
0086	646.3545 Marking Line Grooved Wet Ref Contrast Epoxy 8-Inch	1,230.000 LF	_____.	_____.
0088	646.5020 Marking Arrow Epoxy	7.000 EACH	_____.	_____.
0090	646.5120 Marking Word Epoxy	7.000 EACH	_____.	_____.
0092	646.6120 Marking Stop Line Epoxy 18-Inch	116.000 LF	_____.	_____.
0094	646.9000 Marking Removal Line 4-Inch	350.000 LF	_____.	_____.



Proposal Schedule of Items

Proposal ID: 20230314033 Project(s): 1196-00-62

Federal ID(s): N/A

SECTION: 0001

Contract Items

Alt Set ID:

Alt Mbr ID:

Proposal Line Number	Item ID Description	Approximate Quantity and Units	Unit Price	Bid Amount
0096	650.8000 Construction Staking Resurfacing Reference	13,500.000 LF	_____.	_____.
0098	650.9911 Construction Staking Supplemental Control (project) 01. 1196-00-62	1.000 EACH	_____.	_____.
0100	690.0150 Sawing Asphalt	722.000 LF	_____.	_____.
0102	690.0250 Sawing Concrete	22,382.000 LF	_____.	_____.
0104	715.0720 Incentive Compressive Strength Concrete Pavement	1,357.000 DOL	1.00000	1,357.00
0106	SPV.0180 Special 01. Concrete Pavement Repair Doweled	325.000 SY	_____.	_____.
0108	SPV.0180 Special 02. Concrete Pavement Replacement Doweled	3,895.000 SY	_____.	_____.
0110	SPV.0180 Special 03. 30-inch Concrete Centerline Repair	65.000 SY	_____.	_____.
0112	204.9035.S Removing (item description) 01. Riprap	5.000 CY	_____.	_____.
0114	204.9060.S Removing (item description) 01. Apron Endwalls	2.000 EACH	_____.	_____.
0116	625.0500 Salvaged Topsoil	15.000 SY	_____.	_____.
0118	627.0200 Mulching	15.000 SY	_____.	_____.
0120	630.0130 Seeding Mixture No. 30	5.000 LB	_____.	_____.

Section: 0001

Total: _____.

Total Bid: _____.

