



# Wisconsin Department of Transportation

August 23, 2023

## Division of Transportation Systems Development

Bureau of Project Development  
4822 Madison Yards Way, 4<sup>th</sup> Floor South  
Madison, WI 53705

Telephone: (608) 266-1631  
Facsimile (FAX): (608) 266-8459

### NOTICE TO ALL CONTRACTORS:

**Proposal #06: 1009-37-02**  
**State Wide Tree Clearing**  
**Various Counties (NWR & NCR)**  
**NON-HWY**  
**Statewide**

### Letting of September 12, 2023

This is Addendum No. 01, which provides for the following:

#### Special Provisions:

Revised Special Provisions	
Article No.	Description
3	Consideration of Proposals (Indefinite Delivery/Indefinite Quantity).
4	Prosecution and Progress.
7	Utilities.

Added Special Provisions	
Article No.	Description
24	Railroad Insurance and Coordination – BNSF Railway Company – Site 7.
25	Single Lane Closure With Bi-Directional Traffic, Item SPV.0060.03.

Deleted Special Provisions	
Article No.	Description
23	Single Closure With Bi-Directional Traffic, Item SPV.0060.05.

#### Schedule of Items:

Revised Bid Item Quantities					
Bid Item	Item Description	Unit	Proposal Total Prior to Addendum	Proposal Quantity Change (-)	Proposal Total After Addendum
201.0105	Clearing	STA	86	-35	51
SPV.0060.01	Semi-Permanent Restoration	EACH	8	-2	6

SPV.0060.02	Work on Shoulder or Parking Lane Undivided Roadway	EACH	4	-1	3
SPV.0060.03	Single Lane Closure With Bi-Directional Traffic	EACH	4	-1	3

**Plan Sheets:**

<b>Revised Plan Sheets</b>	
Plan Sheet	Plan Sheet Title (brief description of changes to sheet)
1	Title Sheet (removed hatching and shading of the counties for sites that have not been cleared through utility coordination)
11	Project Overview (removed the site information for sites that have not been cleared through utility coordination)
13	Project Overview (removed the site information for sites that have not been cleared through utility coordination)
14	Project Overview (removed the site information for sites that have not been cleared through utility coordination)
23	Miscellaneous Quantities (removed the site information for sites that have not been cleared through utility coordination)
24	Miscellaneous Quantities (removed the site information for sites that have not been cleared through utility coordination)

<b>Added Plan Sheets</b>	
Plan Sheet	Plan Sheet Title (brief description of why sheet was added)
None	

<b>Deleted Plan Sheets</b>	
Plan Sheet	Plan Sheet Title (brief description of why sheet was deleted)
5	Project Contacts – Site 3 (site not cleared through utility coordination)
7	Project Contacts – Site 5 (site not cleared through utility coordination)
17 – 21	Plan Details – Site 5 (site not cleared through utility coordination)
28 – 30	Plan Sheets – Site 3 (site not cleared through utility coordination)

The responsibility for notifying potential subcontractors and suppliers of these changes remains with the prime contractor.

Sincerely,

*Mike Coleman*

Proposal Development Specialist  
Proposal Management Section

**ADDENDUM NO. 01**

**1009-37-02**

**August 23, 2023**

**Special Provisions**

**3. Consideration of Proposals (Indefinite Delivery/Indefinite Quantity).**

*Replace table under section titled **Estimated Quantities** with the following:*

Bid Item	Unit	Current Contract Amount	Minimum	Maximum
201.0105	STA	51 STA	40 STA	450 STA

**4. Prosecution and Progress.**

*Replace table under section titled **Coordination** with the following:*

SOURCE WISDOT			
SITE	PROJECT ID	COUNTY	HIGHWAY
1	9205-03-60	VILAS	STH 155
2	1022-04-76/86	DUNN	IH 94
4	7070-06-72	CHIPPEWA	STH 27
6	1530-05-73	PEPIN	USH 10
7	7180-00-77	PEPIN	STH 35
8	7170-00-76	BUFFALO/PEPIN	STH 25

*Remove entire section titled **State-listed snake species** from article.*

*Remove entire section titled **Rusty Patch Bumble Bee** from article.*

**7. Utilities.**

*Replace entire article with the following:*

This contract does not come under the provision of Administrative Rule Trans 220.

There are underground and overhead utility facilities located within the project limits. Coordinate construction activities with a call to Diggers Hotline and/or a direct call to the utilities that have facilities in the area as required per statutes.

Some of the utility work described below may be within the limits of this project and occur during the clearing work. In such situations, coordinate with the engineer and the affected utility such that the clearing work for this project is completed as required and will not result in significant utility delays for the future construction project for which this clearing work is being performed. For situations where the engineer has determined that the utility work will be delayed, provide a 14 to 16 calendar day advance notice of when the clearing work will be completed, and the site will be available to the utility owner. Follow-up with a confirmation notice to the engineer and the utility not less than three working days before the site will be ready for the utility to begin and/or resume its work

Additional detailed information regarding the location of utility facilities is available at the region WisDOT office during normal working hours.  
stp-107-066 (20080501)

## **SITE 1**

**Choicetel LLC (Communication Line)** - has facilities within the construction limits, however, no conflicts are anticipated with tree clearing.

**Frontier Communications of WI LLC (Communication Line)** – has utility poles, anchor cables, overhead utility lines, pedestals, and buried fiber optic lines throughout the project. Relocations of facilities, described below, may occur during construction, requiring 7 working days to complete.

### Ditch grading and Hemlock Lane culvert replacement

There are conflicts with one utility pole, two pedestals and an anchor cable that are along the RT backslope of the existing ditch between Station 17+25 and Station 22+25. To avoid conflicts with ditch grading and culvert replacement operations, the utility company is relocating and/or replacing these utilities outside of slope intercepts.

### Ditch grading and driveway culvert replacements

There are conflicts with one pedestal and buried fiber optic lines that are along the existing ditch between Station 269+85 to Station 280+65. To avoid conflicts with ditch grading and culvert replacement operations, the utility company is relocating these utilities outside of the slope intercepts.

**WE Energies (Gas/Petroleum)** – has buried gas lines throughout the project. Conflicting facilities described below may be within the tree clearing areas. Relocation of these facilities may occur during construction, requiring 20 working days to complete.

### Culvert 63155004224 installation

There is a conflict with a buried gas line that crosses Lollycoogan Lane near the intersection of STH 155 between Station 268+00 and Station 271+00 LT. This location is where the new STH 155 cross culvert is to be placed and the utility company is relocating a portion of this gas line to avoid conflict with culvert installation and ditch grading operations.

### Ditch grading

There is a conflict with buried gas lines crossing STH 155 and the RT ditch at Station 274+50 and Station 278+50. To avoid conflicts with ditch grading operations, the utility company is reinstalling the gas lines at a deeper depth.

**Wisconsin Public Service Corporation (Electricity)** – has utility poles, anchor cables, overhead and buried utility lines, and pedestals throughout the project. Conflicting facilities described below may be within the tree clearing areas. Relocation of these facilities may occur during construction, requiring 5 working days to complete.

### Ditch grading and Hemlock Lane culvert replacement

There are conflicts with existing utility poles that are along the RT backslope of the ditch between Station 21+20 and 21+39. To avoid conflicts with ditch grading and culvert replacement operations, the utility company is removing and relocating these poles to be outside the slope intercepts.

### Ditch Grading

There is a conflict with the existing utility pole that is along the LT backslope of the ditch on Lollycoogan Lane at Station 270+10. To avoid utility pole depth and overhead line clearance conflicts, the utility company is replacing this pole at an extra depth and height.

### Ditch Grading

There is a conflict with the existing utility pole that is along the LT backslope of the ditch at Station 320+15. To avoid utility pole depth and overhead line clearance conflicts, the utility company is replacing this pole at an extra depth and height

#### Culvert 63155004227 replacement

There is a conflict with the existing utility pole that is along the LT foreslope of the ditch at Station 363+49. To avoid culvert replacement and subsequent grading conflicts, the utility company is removing and relocating the utility pole outside the work area.

**Wisconsin Public Service Corporation (Gas/Petroleum)** - has buried gas lines throughout the project. Conflicting facilities described below may be within the tree clearing areas. Relocation of these facilities may occur during construction, requiring 10 working days to complete.

#### Infiltration trench installation

There are conflicts with buried gas lines that cross STH 155 and RT ditch at Station 2+60, 4+65, 5+55, 6+85, 10+35, 11+52, and 15+85. To avoid conflicts with the infiltration trench operations, the utility company is either lowering or relocating the utility lines.

#### Hemlock Lane culvert replacement

There is a conflict with a buried gas line that crosses STH 155 and the intersection of Hemlock Lane at Station 21+71 RT. To avoid a conflict with the culvert replacement operations, the utility company is either lowering or relocating the utility line.

#### Culvert 63155004215 endwall installation

There is a conflict with a buried gas line that crosses the new endwall location at Station 22+57 LT. To avoid a conflict with the endwall installation operations, the utility company is shifting the utility line away from the work area.

#### Culvert 63155004216 culvert replacement

There is a conflict with a buried gas line that lies near the new culvert location at Station 35+38 LT. To avoid a conflict with the culvert replacement operations, the utility company is shifting the utility line further away from the work area.

## **SITE 2**

**24-7 Telecom – Communication** has underground facilities along the south side of USH 12/STH 29 for the length of the reconstruction. No conflicts anticipated with tree clearing.

**AT&T Legacy– Communication** have underground facilities along the EB IH 94 right of way but are outside the project limits. No conflicts anticipated with tree clearing.

**AT&T Wisconsin – Communication** has underground facilities within the project limits at Station 406+00'R' left to crossing of western loop ramp at Station 12+25'L' to the median over to the loop ramp at Station 14+60'L' right then to the back side of the existing SWEF building. No conflicts anticipated with tree clearing.

**Dunn Energy Cooperative– Electricity** has underground and overhead facilities within the project limits at the following locations:

- The overhead line is located north and outside of the existing right of way at the SWEF site. No conflicts anticipated with tree clearing.
- There is an underground line beginning at a pole outside the right of way at the SWEF site and heading to the back of the existing SWEF building. This line will need to be relocated as part of the roadway project as it conflicts with the excavation for the storage shed and tower. No conflicts anticipated with tree clearing.

**Lumen – Communication** has underground facilities along the EB IH 94 right of way and EB USH 12/STH 29 but are outside the construction limits. No conflicts anticipated with tree clearing.

**Windstream Communications – Communication** has overhead communication facilities along the east side of CTH B within the limits of the pull-off inspection site. No conflicts anticipated with tree clearing.

**WisDOT** has **underground Communication and lighting** facilities that will be relocated as part of the roadway project work. No conflicts anticipated with tree clearing.

**Xcel Energy –3 Phase Electrical Distribution** has overhead facilities along the east side of CTH B within the limits of the pull-off inspection site. No conflicts anticipated with tree clearing.

**Xcel Energy – Electrical Transmission** has overhead electric transmission facilities north of USH 12/STH 29 within the limits of the virtual weigh station along USH 12/STH 29. No conflicts anticipated with tree clearing.

**Xcel Energy – Gas/Petroleum** has underground facilities along the full length of the CTH B pull-off site. Topsoil stripping will occur and fills of 0-2' will be placed over the line. No conflicts anticipated with tree clearing.

#### **SITE 4**

The following utility owners have facilities within the project limits; however, no conflicts are anticipated with tree clearing:

- **Cadott Lighting and Water (Electricity)**
- **CenturyLink Com LLC (Communication Line)**
- **Eau Claire Energy Coop (Electricity)**
- **Magellan Pipeline (Gas/Petroleum)**
- **Spectrum (Communication Line)**
- **WE Energies (Gas/Petroleum)**
- **Xcel Energy (Electric Transmission)**
- **Xcel Energy (Electricity)**

#### **SITE 6**

##### **WE Energies (Gas/Petroleum)**

WE Energies has existing underground gas facilities along the south side of USH 10 starting at County D and heading east along the south side of USH 10 to Station 340+30 where it heads north and crosses under USH 10. From here it continues east along the north side of USH 10 to the end of the project.

WE Energies has underground gas facilities in the project area that are not in conflict with the tree clearing.

WE Energies plans to discontinue in place the following existing facilities in the project limits: 3" PE gas main on the south side of USH 10 between Station 337+72 and Station 340+30 as well as 3" PE gas main crossing under USH 10 at Station 340+30.

The following utility owners have facilities within the project area; however, no adjustments are anticipated:

- **Chippewa Valley Cable, Inc. – Communication Line**
- **Dairyland Power Coop – Electricity**
- **NTEC – Communication Line**
- **Northern Natural Gas Company – Gas/Petroleum**
- **Pierce Pepin Coop – Electricity**
- **Xcel Energy – Electricity Transmission**
- **Xcel Energy – Electricity**

#### **SITE 7**

The following utility owners have facilities within the project area; however, no conflicts are anticipated with tree clearing:

- **Brightspeed – Communication Line**
- **Xcel Energy - Electricity**

## **SITE 8**

**Chippewa Valley Cable, Inc. (Communication Line)** has existing underground communication lines along the west side of STH 25 from Station 447+50 through Station 452+00, Station 619+00 through Station 626+00, Station 667+50 through Station 671+00, Station 715+00 through Station 716+50, Station 724+50 through Station 726+75, Station 760+50 through Station 771+00, Station 794+25 through Station 796+00, Station 813+63, Station 820+53, Station 835+00 through Station 847+50, Station 859+00 through Station 865+00 and Station 870+00 through Station 883+00. Additionally, Chippewa Valley Cable has underground communication lines crossing STH 25 at Station 450+05, Station 450+20, Station 780+70, 814+10, 821+50, and Station 860+75. No conflicts anticipated with tree clearing.

**Dairyland Power Cooperative (Electricity)** has existing power facilities crossing STH 25 at Station 455+50. No conflicts anticipated with tree clearing.

**Northern Natural Gas Company (Gas/Petroleum)** has an underground gas main crossing STH 25 at Station 855+20. No conflicts anticipated with tree clearing.

**NTEC (Communication Line)** has underground communication lines along the west side of STH 25 from Station 447+50 through Station 452+00, Station 619+00 through Station 626+00, Station 667+50 through Station 671+00, Station 715+11 through Station 716+50, Station 724+50 through Station 726+75, Station 760+50 through Station 771+00, Station 794+25 through Station A 796+00, Station 813+63, Station 820+53, Station 835+00 through Station 847+50, Station 859+00 through Station 865+00, Station 870+00 through Station 883+00. Additionally, Ntec has underground communication lines crossing STH 25 at Station 450+05, Station 450+20, Station 780+70, Station 814+10, Station 821+50, and Station 860+75. No conflicts anticipated with tree clearing.

**Pierce Pepin Cooperative Services (Electricity)** has existing power facilities crossing STH 25 at Station 850+50. No conflicts anticipated with tree clearing.

**Riverland Energy Cooperative (Electricity)** has power facilities along STH 25 from Station 241+15 to Station 726+75. There are also existing power facilities crossing STH 25 at Station 241+15, Station 269+00, Station 309+40, Station 341+10, Station 481+60, Station 511+50, and Station 560+75. No conflicts anticipated with tree clearing.

**Xcel Energy (Electricity)** has overhead electric facilities crossing STH 25 at Station 850+50 and Station 891+25. No conflicts anticipated with tree clearing.

### **23. Deleted**

### **24. Railroad Insurance and Coordination - BNSF Railway Company**

#### **A. Description**

Comply with standard spec 107.17 for all work affecting BNSF Railway Company property and any existing tracks.

#### **A.1 Railroad Insurance Requirements**

In addition to standard spec 107.26, provide railroad protective liability insurance coverage as specified in standard spec 107.17.3 Insurance is filed in the name of BNSF Railway Company.

Notify evidence of the required coverage, and duration to Jake Rzewnicki, Manager of Public Projects; 4515 Kansas Avenue, Kansas City, Kansas 66106; Telephone (913) 551-4275; Telephone (913) 551-4275; E-mail [Jacob.Rzewnicki@bnsf.com](mailto:Jacob.Rzewnicki@bnsf.com) to determine the applicable railroad rules and regulations. Once determined send the RPLI policy to Patricia Villegas, Jones Lang LaSalle Brokerage, 4300 Amon Carter Blvd, Suite 100, Fort Worth, TX 76155; Telephone (817) 230-2630; E-mail: [patricia.villegas@am.jll.com](mailto:patricia.villegas@am.jll.com). Approval of the policy will not take place until the Manager of Public Projects has been contacted.

Also send a copy to the following: Anna Davey, NW Region Railroad Coordinator; 1701 N 4th Street, Superior, WI 54880; Telephone (715) 392-7960; E-mail: [anna.davey@dot.wi.gov](mailto:anna.davey@dot.wi.gov).

Include the following information on the insurance document:

- Project ID: 1009-37-02
- Project Location: Stockholm, WI
- Route Name: STH 35, Pepin County
- Crossing ID: 080014B – 086467N
- Railroad Subdivision: Aurora Sub
- Railroad Milepost: 372.59 – 378.75
- Work Performed on or within 50' of RR ROW: tree and brush clearing various locations

**Railroad Insurance Requirements**

In addition to standard spec 107.26, provide railroad protective liability insurance coverage as specified in standard spec 107.17.3. Insurance is filed in the name of BNSF Railway Company. Requirements of the standard specifications are changed as follows:<sup>1</sup>

Before the state issues its notice to proceed to the contractor or contractors (collectively, the contractor) awarded the contract for construction involving the project described in this stipulation (the project), the state shall require the contractor to provide certain insurance coverage to protect the railroad (as defined in this section) from loss for property and liability exposures relating to the construction activities on the PROJECT. The manner and process in which this will be accomplished is as detailed below.

TYPE OF INSURANCE	MINIMUM LIMITS REQUIRED
1. Commercial general liability insurance; shall be endorsed to include blanket contractual liability coverage; shall cover bodily injury and property damage, personal and advertising injury, and fire legal liability. There shall be no endorsements limiting coverage for the work to be performed pursuant to this Stipulation.	\$5,000,000 combined single limits per occurrence with an annual aggregate limit of not less than \$10,000,000.
2. Workers' compensation and employer's liability coverage.	Workers' compensation limits: statutory limits. Employers' liability limits: Bodily injury by accident \$100,000 each accident Bodily injury by disease \$500,000 each accident \$100,000 each employee
3. Commercial automobile liability insurance; shall cover all owned, non-owned, and hired vehicles used by the CONTRACTOR in carrying out the contract, and shall include coverage for	\$1,000,000 combined single limit per occurrence.



<p>4. Railroad Protective Liability Insurance, issued on a standard ISO form 00 35 10 93 or its equivalent and endorsed to include the Pollution Exclusion Amendment (ISO form CG 28 31 10 93) and the Limited Seepage and Pollution Endorsement. No endorsements restricting FELA coverage may be added.</p>	<p>\$5,000,000 per occurrence \$10,000,000 in the aggregate</p>
---	---

<sup>1</sup> As used in this section, “STATE” and “COMPANY” have the meanings assigned to them in the Stipulation to which this Exhibit is attached, “FELA” means the Federal Employment Liability Act, and “this Stipulation” means the Stipulation to which this Exhibit is attached.

<sup>2</sup> The CONTRACTOR may satisfy the requirements for insurance types 1, 2 and 3 through primary insurance coverage or through excess/umbrella policies.

1. The policies for insurance types 1, 2 and 3 may not contain an exclusion for punitive damages.
2. The commercial general liability policy shall include an endorsement that removes any restrictions on coverage regarding work being performed within 50 feet of a railroad or railroad property and an endorsement that removes any exclusion related to explosion, collapse or underground hazard.
3. The CONTRACTOR must waive its right of recovery against the RAILROAD for all claims and suits against the RAILROAD. In addition, the CONTRACTOR’s insurers, through the terms of the policy or policy endorsement, must waive their right of subrogation against the RAILROAD for all claims and suits. The certificates of insurance must reflect the waiver of subrogation endorsement. The CONTRACTOR also must waive its right of recovery, and its insurers must also waive their right of subrogation, against the RAILROAD for loss of the CONTRACTOR’s owned or leased property or property under the CONTRACTOR’s care, custody or control.
4. The CONTRACTOR’s insurance policies, except for excess liability/umbrella policies, through policy endorsement, must include wording to the effect that such policies are primary and non-contributing with respect to any insurance carried by the RAILROAD. The certificates of insurance must reflect that such wording is included in the evidenced policies.
5. The policies for insurance types 1 and 3, above, must include a severability of interest endorsement. The RAILROAD and Jones Lang LaSalle Global Services- RR, Inc. must be named as an additional insured with respect to work performed under this project. Severability of interest and naming the RAILROAD and Jones Lang LaSalle Global Services- RR, Inc. as additional insured must be indicated on the certificates of insurance.
6. The CONTRACTOR shall provide the original Railroad Protective Liability policy to the RAILROAD prior to performing any work on the PROJECT.
7. The CONTRACTOR shall only obtain coverage from insurance companies licensed to do business in the State of Wisconsin that have an AM Best rating of A- and Class VII or better.
8. The CONTRACTOR is not allowed to self-insure.
9. Prior to performing any work on the PROJECT, the CONTRACTOR shall provide the RAILROAD acceptable certificates of insurance, including original signatures of the authorized representatives evidencing the required coverages, endorsements, and amendments and referencing the RAILROAD’s contract audit/folder number (if available), as evidence that required coverages for insurance types 1, 2 and 3 are in force.

10. The policies for insurance types 1, 2 and 3 must contain a provision that obligates the insurer to notify the RAILROAD at least 60 calendar days before a cancellation, non-renewal, substitution or material change in coverage, and such provision must be reflected on the insurance certificates.
11. The CONTRACTOR shall send the required insurance documentation to the RAILROAD at the following address:

BNSF Railway Company

c/o CertFocus

PO Box 140528

Kansas City, MO 64114

Toll Free: 877-576-2378

Email: BNSF@certfocus.com

12. Acceptance by the RAILROAD of a certificate of insurance that does not comply with this section shall not operate as a waiver of the CONTRACTOR's obligation to provide the insurance required by this section.
13. If the RAILROAD notifies the STATE that the CONTRACTOR does not have the required insurance, the STATE's engineer shall immediately suspend work on the PROJECT until the matter is resolved.
14. The requirements for insurance types 1, 2, and 3 shall apply with equal force whether the CONTRACTOR or a subcontractor, or anyone directly or indirectly employed by either, performs work on the PROJECT. If any portion of the PROJECT work is subcontracted, the CONTRACTOR must require the subcontractor to provide and maintain insurance coverages for insurance types 1, 2, and 3 that meet the requirements of this section, except that the minimum limits required for the subcontractor's commercial general liability policy shall be \$2,000,000 per occurrence and \$4,000,000 in the aggregate.
15. The fact that the CONTRACTOR obtains insurance as required by this section shall not release or diminish the CONTRACTOR's liability. Damages recoverable by the RAILROAD will not be limited by the required insurance coverages.
16. Upon request from the RAILROAD, the CONTRACTOR will provide a certified duplicate original of any requested policy.
17. For purposes of this section references to the RAILROAD mean the COMPANY, Burlington Northern Santa Fe Corporation, and the subsidiaries, successors, assigns and affiliates of each.

## **A.2 Train Operation**

Approximately 34 through freight trains operate daily at up to 60 mph. There are switching movements at slower speeds.

## **A.3 Names and Addresses of Railroad Representatives for Consultation and Coordination**

### **Construction Contact**

Jake Rzewnicki, Manager of Public Projects; 4515 Kansas Avenue, Kansas City, Kansas 66106; Telephone (913) 551-4275; Telephone (913) 551-4275; E-mail Jacob.Rzewnicki@bnsf.com for consultation on railroad requirements during construction.

Amend standard spec 108.4 to include the railroad in the distribution of the initial bar chart, and monthly schedule updates. The bar chart shall specifically show work involving coordination with the railroad.

### **Flagging Contact**

Notify the Construction Contact above a minimum of 40 working days in advance to arrange for a railroad flagger. Reference the Crossing ID, Wisconsin Milepost and Subdivision found in A.1.

**Cable Locate Contact**

In addition to contacting Diggers Hotline, contact the BNSF Communications Network Control Center at (800) 533-2891, five working days before the locate is needed. Reference Wisconsin Milepost 372.59 – 378.75 on Line Segment 3.

BNSF will only locate railroad owned facilities located in the railroad right-of-way. The railroad does not locate any other utilities.

**A.4 Work by Railroad**

The railroad will perform the work described in this section, except for work described in other special provisions, and will be accomplished without cost to the contractor. None

**A.5 Temporary Grade Crossing**

If a temporary grade crossing is desired, submit a written request to the railroad representative named in A.3 at least 40 days prior to the time needed. Approval is subject to the discretion of the railroad. The department has made no arrangements for a temporary grade crossing.

stp-107-026 (20230629)

**25. Single Lane Closure With Bi-Directional Traffic, Item SPV.0060.03.**

**A Description**

This special provision describes providing a traffic control setup as shown in SDD 15C12, "Traffic Control for Lane Closure With Flagging Operation".

**B Materials**

Furnish traffic control devices, including Signs according to the pertinent requirements of standard spec 643.

**C Construction**

Provide and maintain traffic control devices located where the plans show, or engineer directs in accordance with standard spec 643.

**D Measurement**

The department will measure Single Lane Closure With Bi-Directional Traffic by each site, acceptably completed.

**E Payment**

The department will pay for measured quantities at the contract unit price under the following bid item:

ITEM NUMBER	DESCRIPTION	UNIT
SPV.0060.03	Single Lane Closure With Bi-Directional Traffic	EACH

Payment is full compensation for furnishing and maintaining devices and any incidental work associated with this item.

Flagging is incidental to the work under this bid item.

**Schedule of Items**

Attached, dated August 23, 2023, are the revised Schedule of Items Page 1.

**Plan Sheets**

The following 8½ x 11-inch sheets are attached and made part of the plans for this proposal:  
Revised: 1, 11, 13, 14, 23, and 24.

STATE PROJECT	FEDERAL PROJECT
1009-37-02	

# STATE OF WISCONSIN DEPARTMENT OF TRANSPORTATION

## PLAN OF PROPOSED IMPROVEMENT

### STATE WIDE TREE CLEARING

VARIOUS COUNTIES (NWR & NCR)  
NON HWY  
STATEWIDE

STATE PROJECT NUMBER  
**1009-37-02**

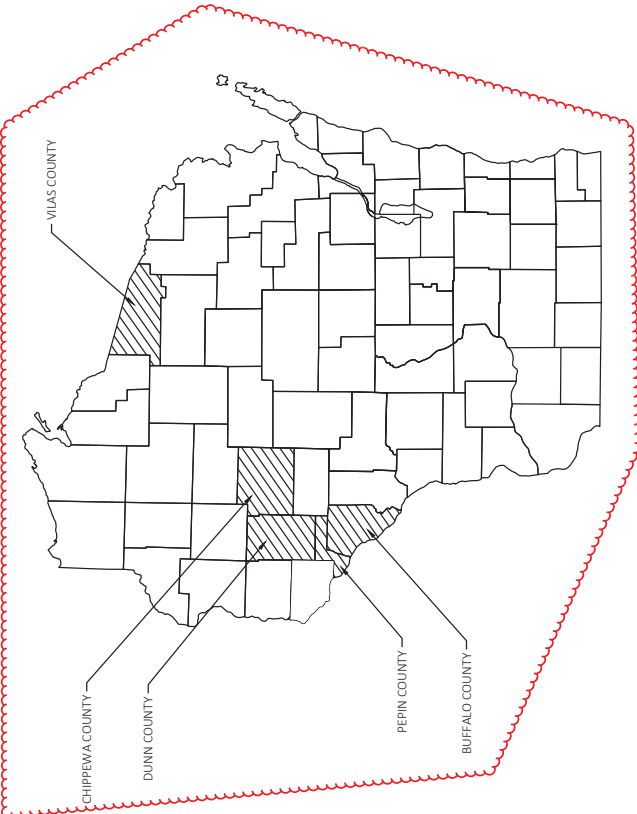
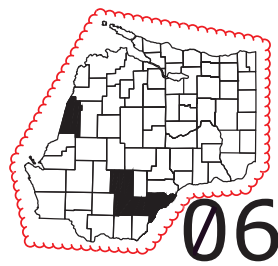

Addendum No. 01  
ID 1009-37-02  
Revised Sheet 1  
August 23, 2023

SEPTEMBER 2023

ORDER OF SHEETS

Section No.	Title
1	Typical Sections and Details
2	Estimate of Quantities
3	Miscellaneous Quantities
4	Right-of-Way Plan
5	Plan and Profile
6	Standard Detail Drawings
7	Sign Details
8	Construction Plans
9	Computer-Enhanced Data
10	Graphic Schedules

TOTAL SHEETS = 52



DESIGN DESIGNATION

AA.D.T.	
AA.V.T.	
DA.V.	
D.D.	
T	
DESIGN SPEED	
ESALS	

CONVENTIONAL SYMBOLS

PLAN	PROFILE
CORPORATE LIMITS	GRADE LINE
PROPERTY LINE	ORIGINAL GROUND
LOT LINE	MARSH OR ROCK PROFILE (To be noted as such)
LIMITED HIGHWAY EASEMENT	SPECIAL DITCH
EXISTING RIGHT OF WAY	GRADE ELEVATION
PROPOSED OR NEW R/W LINE	CULVERT (Profile View)
SLOPE INTERCEPT	UTILITIES
REFERENCE LINE	ELECTRIC
EXISTING CULVERT	FIBER OPTIC
PROPOSED CULVERT (Box or Pipe)	GAS
COMBUSTIBLE FLUIDS	SANITARY SEWER
	STORM SEWER
	TELEPHONE
	WATER
MARSH AREA	UTILITY PEDESTAL
WOODED OR SHRUB AREA	POWER POLE
	TELEPHONE POLE

SCALE 0 LAYOUT

TOTAL NET LENGTH OF CENTERLINE =

HORIZONTAL POSITIONS SHOWN ON THIS PLAN ARE WISCONSIN COORDINATE REFERENCE SYSTEM (WISCRS), COUNTY, NAD83 (2011), IN U.S. SURVEY FEET. POSITIONS SHOWN ARE GRID, CHANGING TO STATE PLANE COORDINATES. DISTANCES ARE THE SAME AS GROUND DISTANCES. ELEVATIONS ARE REFERENCED TO NAVD 88 (2012). GPS DERIVED ELEVATIONS ARE BASED ON GEOID 12A.

STATE OF WISCONSIN  
DEPARTMENT OF TRANSPORTATION

PREPARED BY	WISDOT
Surveyor	E. DANNE
Designer	S. LABEL
Project Manager	E. GOWDT
Regional Examiner	
Regional Supervisor	

APPROVED FOR THE DEPARTMENT

DATE: **7/19/2023**

(Signature)

GRE

PROJECT ID: **1009-37-02**  
WITH: N/A

COUNTY: **NW & NC REGION-WIDE**

Addendum No. 01  
ID 1009-37-02  
Revised Sheet 11  
August 23, 2023

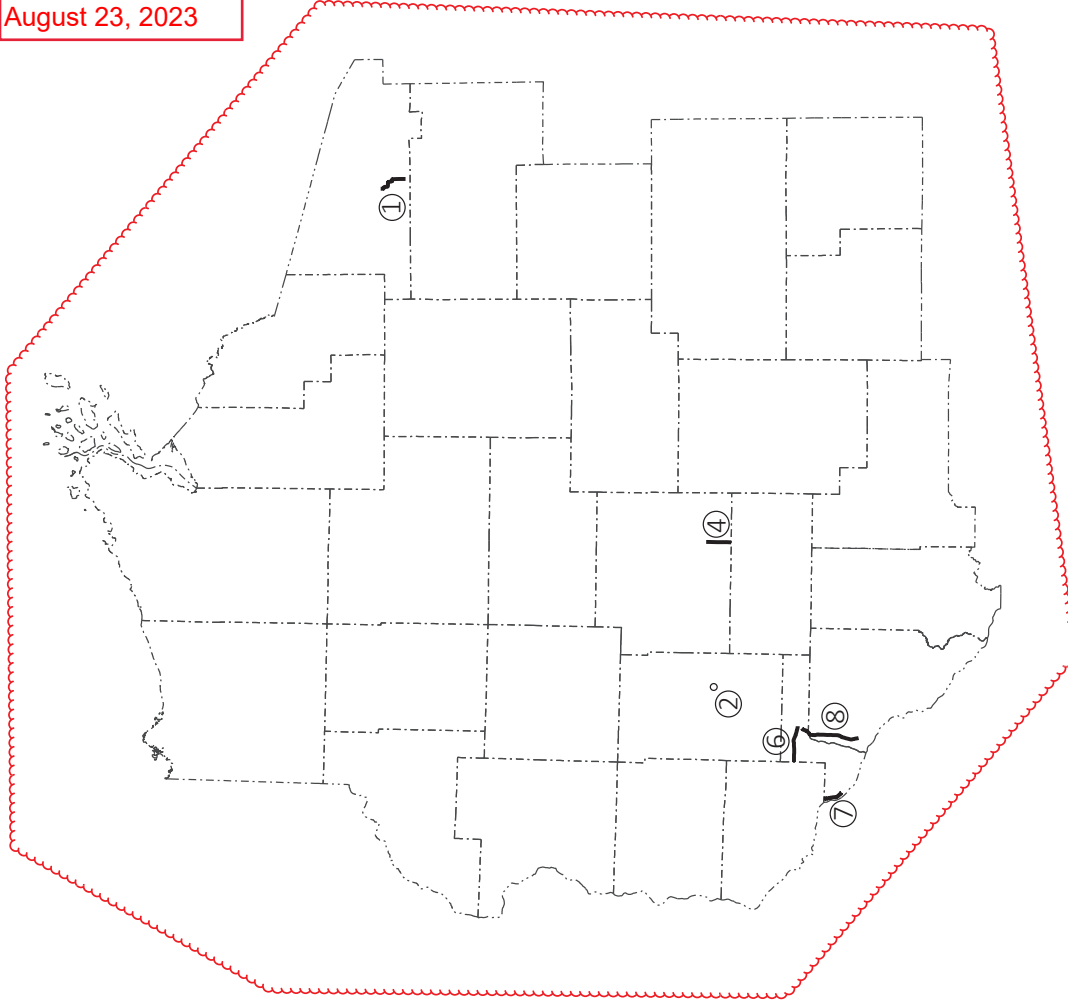

SITE	SOURCE WISDOT PROJECT ID	COUNTY	HIGHWAY
1	9205-03-60	VILAS	STH 155
2	1022-04-76/86	DUNN	IH 94
4	7070-06-72	CHIPPEWA	STH 27
6	1530-05-73	PEPIN	USH 10
7	7180-00-77	PEPIN	STH 35
8	7170-00-76	BUFFALO & PEPIN	STH 25

Addendum No. 01  
ID 1009-37-02  
Revised Sheet 13  
August 23, 2023

SITE 4  
CHIPPEWA COUNTY  
STH 27

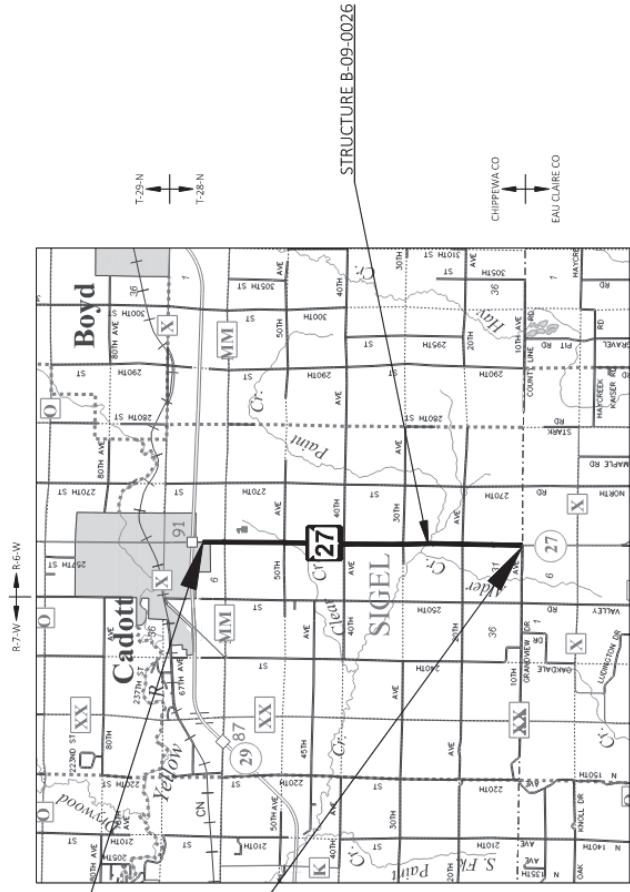

PROJECT NO: 1009-37-02	COUNTY: REGION WIDE	PROJECT OVERVIEW	SHEET 13	E
FILE NAME: N:\PDS\33D\10093700\DSG\WEDGE\LINE\10093702_PROJECTOVERVIEW.DWG	HWY: VARIES	DATE: 7/19/2023 1:28 PM	SCALE: 1 IN=30 FT	WISDOT/CADD SHEET 42
LAYOUT NAME: 10093700_DS\Project_Overview_3	FLYBY: DAME, ERICA	PLOT NAME:		

Addendum No. 01  
ID 1009-37-02  
Revised Sheet 14  
August 23, 2023

SITE 6  
PEPIN COUNTY  
USH 10

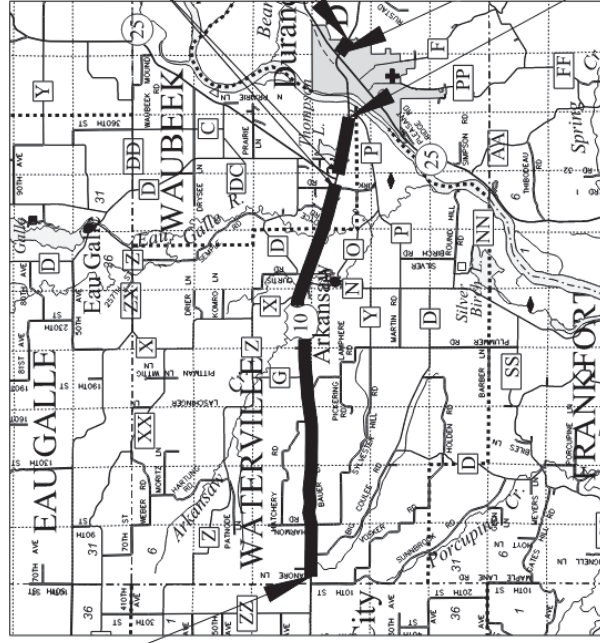

END PROJECT 1530-05-73  
STA 43+91.60

BEGIN PROJECT 1530-05-73  
STA 15+98.10  
Y= 283370.503  
X= 574635.640

PROJECT OVERVIEW

COUNTY: REGION WIDE

HWY: VARIES

PROJECT NO: 1009-37-02

SHEET 14

E

Addendum No. 01  
ID 1009-37-02  
Revised Sheet 23  
August 23, 2023

TREE CLEARING

201.01.05  
CLEARING

SITE	LOCATION	STATION	TO	STATION	OFFSET	STA	REMARKS
1	STH 155	203+00	-	205+00	L7/RT	2	C-63-155-004223 (30 TREES)
	STH 155	299+00	-	300+00	L7/RT	1	C-63-155-004225 (4 TREES)
	LOLLY COOGAN LN	0+00	-	2+00	LT	2	C-63-155-004224 (2 TREES)
					SUBTOTAL	5	
2	IH 94 SWEF	10+00 'SW'	-	15+00 'SW'	L7/RT	5	SWALE
	IH 94 SWEF	50+00 'S'	-	54+00 'S'	LT	4	SALT SHED
					SUBTOTAL	9	
4	STH 27	96+00	-	99+00	LT	3	
	STH 27	159+00	-	161+00	LT	2	
	STH 27	195+00	-	197+00	LT	2	
	STH 27	258+00	-	259+00	LT	1	
	STH 27	279+00	-	280+00	L7/RT	1	
				SUBTOTAL	9		
6	USH 10	100+00	-	101+00	L7/RT	1	
	USH 10	118+00	-	119+00	RT	1	
	USH 10	225+00	-	227+00	L7/RT	2	
	USH 10	258+00	-	263+00	L7/RT	5	
	USH 10	278+00	-	279+00	RT	1	
	USH 10	426+00	-	428+00	LT	2	
				SUBTOTAL	12		
7	STH 35	26+00	-	27+00	LT	1	
	STH 35	31+00	-	32+00	LT	1	
	STH 35	51+00	-	52+00	LT	1	
	STH 35	64+00	-	65+00	LT	1	
	STH 35	94+00	-	95+00	LT	1	
	STH 35	114+00	-	115+00	LT	1	
	STH 35	134+00	-	135+00	LT	1	
	STH 35	135+00	-	136+00	LT	1	
	STH 35	149+00	-	150+00	LT	1	
	STH 35	171+00	-	172+00	LT	1	
	STH 35	212+00	-	213+00	LT	1	
	STH 35	227+00	-	228+00	LT	1	
				SUBTOTAL	12		
8	STH 25	880+00	-	884+00	LT	4	
					SUBTOTAL	4	
				TOTAL	51		

COUNTY: REGION WIDE

HWY: VARIES

PROJECT NO: 1009-37-02

MISCELLANEOUS QUANTITIES

SHEET

23

E

FILE NAME: N:\PDS\3D\10093702\DWG\10093702\_03000\_MQ\_ADDENDUM1.DWG  
LAYOUT NAME: 01  
PLOT DATE: 8/16/2023 1:16 PM  
PLOT BY: DANIEL ERICA  
PLOT NAME:  
PLOT SCALE: 1"=1'  
WISDOT/CADDIS SHEET 42



Addendum No. 01  
ID 1009-37-02  
Revised Sheet 24  
August 23, 2023

EROSION CONTROL AND TRAFFIC CONTROL

SITE	SPV/0060.01	SPV/0060.02	SPV/0060.03
	SEMI-PERMANENT RESTORATION EACH	WORK ON SHOULDER OR PARKING LANE UNDIVIDED ROADWAY EACH	SINGLE LANE CLOSURE WITH BI-DIRECTIONAL TRAFFIC EACH
1	1	-	1
2	1	1	-
4	1	-	1
6	1	1	-
7	1	1	-
8	1	-	1
TOTAL	6	3	3



Proposal Schedule of Items

Proposal ID: 20230912006 Project(s): 1009-37-02

Federal ID(s): N/A

SECTION: 0001 Contract Items

Alt Set ID: Alt Mbr ID:

Proposal Line Number	Item ID Description	Approximate Quantity and Units	Unit Price	Bid Amount
0002	201.0105 Clearing	51.000 STA	_____.	_____.
0004	213.0100 Finishing Roadway (project) 01. 1009-37-02	1.000 EACH	_____.	_____.
0006	618.0100 Maintenance And Repair of Haul Roads (project) 01. 1009-37-02	1.000 EACH	_____.	_____.
0008	619.1000 Mobilization	1.000 EACH	_____.	_____.
0010	SPV.0060 Special 01. Semi-Permanent Restoration	6.000 EACH	_____.	_____.
0012	SPV.0060 Special 02. Work on Shoulder or Parking Lane Undivided Roadway	3.000 EACH	_____.	_____.
0014	SPV.0060 Special 03. Single Lane Closure With Bi-Directional Traffic	3.000 EACH	_____.	_____.
<b>Section: 0001</b>			<b>Total:</b>	_____.
			<b>Total Bid:</b>	_____.