



Wisconsin Department of Transportation

Division of Transportation Systems Development

Bureau of Project Development
4822 Madison Yards Way, 4th Floor South
Madison, WI 53705

November 6, 2023

Telephone: (608) 266-1631
Facsimile (FAX): (608) 266-8459

NOTICE TO ALL CONTRACTORS:

Proposal #44: 8829-00-71, WISC 2024032
Dallas – Rice Lake
Decker Drive Intersection
CTH O
Barron County

Letting of November 14, 2023

This is Addendum No. 01, which provides for the following:

Schedule of Items:

Added Bid Item Quantities					
Bid Item	Item Description	Unit	Proposal Total Prior to Addendum	Quantity Added	Proposal Total After Addendum
643.3150	Temporary Marking Line Removable Tape 4-Inch	LF	0	485	485

Deleted Bid Item Quantities					
Bid Item	Item Description	Unit	Proposal Total Prior to Addendum	Proposal Quantity Change (-)	Proposal Total After Addendum
643.3120	Temporary Marking Line Epoxy 4-Inch	LF	485	-485	0

Plan Sheets:

Revised Plan Sheets	
Plan Sheet	Plan Sheet Title (brief description of changes to sheet)
18	Updated bid item name for temporary pavement marking in the traffic control plan sheet.
25	Updated bid item name for temporary pavement marking in the miscellaneous quantities plan sheet.

Schedule of Items

Attached, dated November 6, 2023, are the revised Schedule of Items Pages 1 – 6.

Plan Sheets

The following 8½ x 11-inch sheets are attached and made part of the plans for this proposal:

Revised: 18, 25.

The responsibility for notifying potential subcontractors and suppliers of these changes remains with the prime contractor.

Sincerely,

Mike Coleman

Proposal Development Specialist
Proposal Management Section

END OF ADDENDUM

Addendum No. 01
 ID 8829-00-71
 Revised Sheet 18
 November 6, 2023

- NOTES:
- LANE WIDTHS LESS THAN 16' WIDTH REQUIRE REDUCED WIDTH SIGNING
 - SEE THE FOLLOWING SDD FOR ADDITIONAL DETAILS
 - TRAFFIC CONTROL, SINGLE LANE CLOSURE, DIVIDED NON-FREEMWAY/EXPRESSWAY
 - TRAFFIC CONTROL, INTERSECTION WITHIN SINGLE LEFT LANE CLOSURE
 - TRAFFIC CONTROL, ADVANCED WIDTH RESTRICTION SIGNING

TEMPORARY MARKING LINE
 REMOVABLE TAPE 4-INCH
 (WHITE ON RIGHT,
 YELLOW ON LEFT)
 (TYP.)

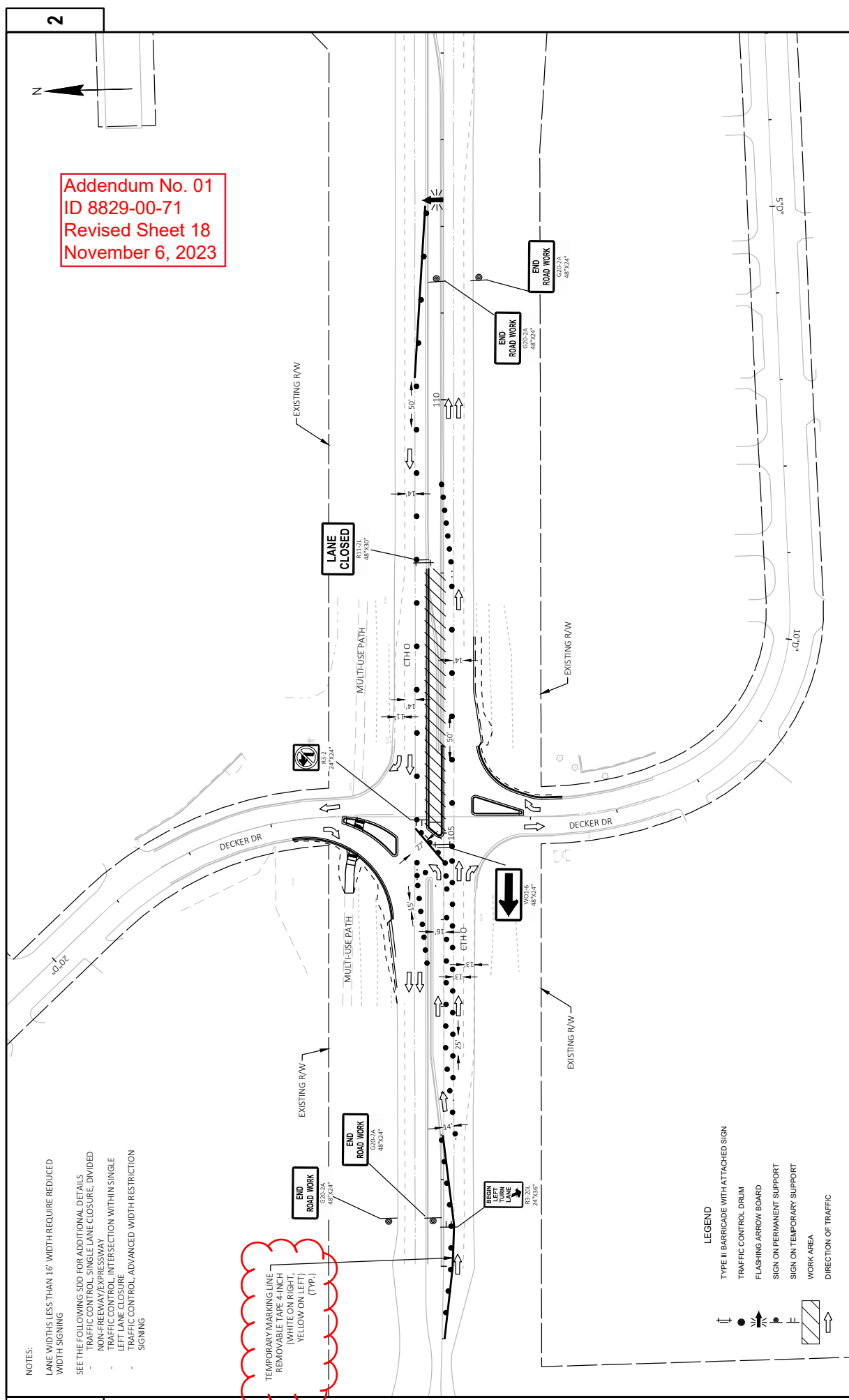

- LEGEND
- TYPE III BARRICADE WITH ATTACHED SIGN
 - TRAFFIC CONTROL DRUM
 - FLASHING ARROW BOARD
 - SIGN ON PERMANENT SUPPORT
 - SIGN ON TEMPORARY SUPPORT
 - WORK AREA
 - DIRECTION OF TRAFFIC

Addendum No. 01
ID 8829-00-71
Revised Sheet 25
November 6, 2023

TRAFFIC CONTROL

643.3150
TEMPORARY
MARKING LINE
REMOVABLE
TAPE 4-INCH

LOCATION	643.0300 DRUMS		643.0420 BARRICADES TYPE III		643.0900 SIGNS		643.1050 SIGNS PCMS		643.5000 TRAFFIC CONTROL		643.0800 TRAFFIC CONTROL ARROW BOARD		644.1440 TEMPORARY PEDESTRIAN SURFACE SKID-RESISTANT MATTING		644.1601 TEMPORARY PEDESTRIAN CURB RAMP		644.1605 TEMPORARY PEDESTRIAN DETECTABLE WARNING FIELD		644.1810 TEMPORARY PEDESTRIAN BARRICADE		REMARKS	
	EACH	DAYS	EACH	DAYS	EACH	DAYS	EACH	DAYS	EACH	DAYS	EACH	DAYS	EACH	DAYS	EACH	DAYS	EACH	DAYS	LF	SF		LF
PROJECT 6085-02-76	-	-	-	-	13	585	4	28	1	-	-	-	-	-	-	-	-	-	-	-	-	INCLUDES REDUCED WIDTH SIGNING
STAGE 1	149	4172	4	112	38	1064	-	-	-	1	28	1	28	500	2	56	40	40	-	-	40	
STAGE 2	81	1296	-	-	8	128	-	-	-	-	1	16	-	-	-	-	-	-	-	-	-	
ITEM TOTALS	230	5468	4	112	59	1777	4	28	1	2	44	2	500	2	56	40	40	-	-	-	40	

CONSTRUCTION DURATION OF APPROXIMATELY 35 WORKING DAYS (45 TOTAL DAYS INCLUDING WEEKENDS)

STAGE 1 - APPROXIMATELY 28 TOTAL DAYS, INCLUDING WEEKENDS

STAGE 2 - APPROXIMATELY 16 TOTAL DAYS, INCLUDING WEEKENDS

PAVEMENT MARKING

STATION	LOCATION	646.1020		646.5020		646.5120		646.6120		646.7020		646.7420		646.8120		646.8220		REMARKS	
		MARKING LINE EPOXY 4-INCH YELLOW	LF	MARKING LINE EPOXY 4-INCH WHITE	LF	MARKING WORD EPOXY	EACH	MARKING STOP LINE EPOXY 18-INCH WHITE	LF	MARKING STOP LINE EPOXY 18-INCH WHITE	LF	MARKING DIAGONAL EPOXY 6-INCH WHITE	LF	MARKING CROSSWALK TRANSVERSE LINE EPOXY 6-INCH WHITE	LF	MARKING CURB EPOXY YELLOW	LF		MARKING ISLAND NOSE EPOXY YELLOW
103+06 - 104+00	LT	-	96	-	-	-	-	-	-	-	-	-	-	-	-	-	-	-	CTH O WB SHOULDER
105+02	LT	-	-	-	-	-	-	-	-	-	-	-	-	-	31	-	-	-	CTH O MEDIAN
106+00 - 107+27	RT	-	128	-	-	-	-	-	-	-	-	-	-	-	-	-	-	-	CTH O EB SHOULDER
13+90 'D'	RT	-	-	-	-	1	-	-	-	-	-	-	-	-	-	-	-	-	SOUTH DECKER DRIVE
14+08 - 13+74 'D'	RT	59	-	-	-	-	-	-	-	-	-	-	-	-	-	-	-	-	SOUTH DECKER DRIVE
14+13 'D'	RT	-	-	-	-	-	-	-	-	-	-	-	-	-	-	-	1	-	SE MEDIAN ISLAND
14+16 'D'	RT	-	-	-	-	-	-	-	-	-	-	-	-	-	11	-	-	-	SE MEDIAN ISLAND
14+30 'D'	RT	-	-	1	-	-	-	-	-	-	-	-	-	-	-	-	-	-	SOUTH DECKER DRIVE
14+57 'D'	RT	-	-	-	-	-	-	29	-	-	-	-	-	-	-	-	-	-	SOUTH DECKER DRIVE
14+66 'D'	RT	-	-	-	-	-	-	-	-	-	-	-	-	-	-	-	-	-	SE MEDIAN ISLAND
15+56 'D'	LT	-	-	-	-	-	-	-	-	-	-	-	-	-	32	-	-	-	NW MEDIAN ISLAND
15+97 'D'	LT	-	-	-	-	-	-	-	-	-	-	-	53	-	-	-	-	-	NORTH DECKER DRIVE
16+01 'D'	LT	-	-	-	-	-	-	-	-	-	-	-	50	-	-	-	-	-	NORTH DECKER DRIVE
16+10 'D'	LT	-	-	-	-	-	-	-	-	-	-	-	-	-	11	-	-	-	NW MEDIAN ISLAND
16+12 'D'	LT	-	-	-	-	-	-	-	-	-	-	-	-	-	-	-	1	-	NW MEDIAN ISLAND
16+14 'D'	LT	-	-	-	-	-	-	-	-	-	-	-	-	-	-	-	-	-	NORTH DECKER DRIVE
16+17 - 16+78 'D'	LT	120	-	-	-	-	-	-	23	-	-	-	-	-	-	-	-	-	NORTH DECKER DRIVE
16+41 'D'	LT	-	-	1	-	-	-	-	-	-	-	-	-	-	-	-	-	-	NORTH DECKER DRIVE
16+88 'D'	LT	-	-	-	-	1	-	-	-	-	-	-	-	-	-	-	-	-	NORTH DECKER DRIVE
ITEM TOTALS		179	224	2	2	2	52	103	175	120	2	2	403						

PROJECT NO: 8829-00-71 HWY: CTH O COUNTY: BARRON MISCELLANEOUS QUANTITIES SHEET 25

FILE NAME: H:\PROJECTS\60001604\DESIGN\CAD_B\W\88290001\SHEETS\PLAN\030201.MXD LAYOUT NAME: 01

PLOT DATE: 11/7/2023 1:28 PM PLOT BY: RACHEL BURHAM PLOT NAME: 1"=1'

W8507/CADD/S SHEET 42



Proposal Schedule of Items

Proposal ID: 20231114044 Project(s): 8829-00-71

Federal ID(s): WISC 2024032

SECTION: 0001 Contract Items

Alt Set ID: Alt Mbr ID:

Proposal Line Number	Item ID Description	Approximate Quantity and Units	Unit Price	Bid Amount
0002	203.0100 Removing Small Pipe Culverts	1.000 EACH	_____.	_____.
0004	204.0110 Removing Asphaltic Surface	1,045.000 SY	_____.	_____.
0006	204.0150 Removing Curb & Gutter	490.000 LF	_____.	_____.
0008	204.0155 Removing Concrete Sidewalk	34.000 SY	_____.	_____.
0010	204.0215 Removing Catch Basins	2.000 EACH	_____.	_____.
0012	204.0220 Removing Inlets	2.000 EACH	_____.	_____.
0014	204.0245 Removing Storm Sewer (size) 01. 12-INCH, RPC	44.000 LF	_____.	_____.
0016	204.0280 Sealing Pipes	1.000 EACH	_____.	_____.
0018	205.0100 Excavation Common	598.000 CY	_____.	_____.
0020	213.0100 Finishing Roadway (project) 01. 8829-00-71	1.000 EACH	_____.	_____.
0022	305.0110 Base Aggregate Dense 3/4-Inch	26.000 TON	_____.	_____.
0024	305.0120 Base Aggregate Dense 1 1/4-Inch	1,568.000 TON	_____.	_____.
0026	305.0500 Shaping Shoulders	4.000 STA	_____.	_____.
0028	312.0110 Select Crushed Material	230.000 TON	_____.	_____.
0030	455.0605 Tack Coat	64.000 GAL	_____.	_____.
0032	465.0105 Asphaltic Surface	436.000 TON	_____.	_____.



Proposal Schedule of Items

Proposal ID: 20231114044 Project(s): 8829-00-71

Federal ID(s): WISC 2024032

SECTION: 0001 Contract Items

Alt Set ID: Alt Mbr ID:

Proposal Line Number	Item ID Description	Approximate Quantity and Units	Unit Price	Bid Amount
0034	601.0411 Concrete Curb & Gutter 30-Inch Type D	295.000 LF	_____.	_____.
0036	601.0557 Concrete Curb & Gutter 6-Inch Sloped 36-Inch Type D	703.000 LF	_____.	_____.
0038	602.0415 Concrete Sidewalk 6-Inch	1,577.000 SF	_____.	_____.
0040	602.0505 Curb Ramp Detectable Warning Field Yellow	60.000 SF	_____.	_____.
0042	608.0215 Storm Sewer Pipe Reinforced Concrete Class II 15-Inch	92.000 LF	_____.	_____.
0044	611.0627 Inlet Covers Type HM	3.000 EACH	_____.	_____.
0046	611.1230 Catch Basins 2x3-FT	3.000 EACH	_____.	_____.
0048	618.0100 Maintenance and Repair of Haul Roads (project) 01. 8829-00-71	1.000 EACH	_____.	_____.
0050	619.1000 Mobilization	1.000 EACH	_____.	_____.
0052	620.0300 Concrete Median Sloped Nose	76.000 SF	_____.	_____.
0054	624.0100 Water	24.000 MGAL	_____.	_____.
0056	625.0100 Topsoil	834.000 SY	_____.	_____.
0058	625.0500 Salvaged Topsoil	417.000 SY	_____.	_____.
0060	627.0200 Mulching	50.000 SY	_____.	_____.
0062	628.1504 Silt Fence	567.000 LF	_____.	_____.



Proposal Schedule of Items

Proposal ID: 20231114044 **Project(s):** 8829-00-71
Federal ID(s): WISC 2024032
SECTION: 0001 Contract Items
Alt Set ID: **Alt Mbr ID:**

Proposal Line Number	Item ID Description	Approximate Quantity and Units	Unit Price	Bid Amount
0064	628.1520 Silt Fence Maintenance	567.000 LF	_____.	_____.
0066	628.1905 Mobilizations Erosion Control	4.000 EACH	_____.	_____.
0068	628.1910 Mobilizations Emergency Erosion Control	2.000 EACH	_____.	_____.
0070	628.2008 Erosion Mat Urban Class I Type B	714.000 SY	_____.	_____.
0072	628.7005 Inlet Protection Type A	2.000 EACH	_____.	_____.
0074	628.7015 Inlet Protection Type C	3.000 EACH	_____.	_____.
0076	629.0210 Fertilizer Type B	60.000 CWT	_____.	_____.
0078	630.0130 Seeding Mixture No. 30	8.500 LB	_____.	_____.
0080	630.0500 Seed Water	19.000 MGAL	_____.	_____.
0082	634.0616 Posts Wood 4x6-Inch X 16-FT	8.000 EACH	_____.	_____.
0084	637.2210 Signs Type II Reflective H	75.000 SF	_____.	_____.
0086	638.2102 Moving Signs Type II	14.000 EACH	_____.	_____.
0088	638.4000 Moving Small Sign Supports	7.000 EACH	_____.	_____.
0090	642.5001 Field Office Type B	1.000 EACH	_____.	_____.
0092	643.0300 Traffic Control Drums	5,468.000 DAY	_____.	_____.
0094	643.0420 Traffic Control Barricades Type III	112.000 DAY	_____.	_____.



Proposal Schedule of Items

Proposal ID: 20231114044 Project(s): 8829-00-71

Federal ID(s): WISC 2024032

SECTION: 0001 Contract Items

Alt Set ID: Alt Mbr ID:

Proposal Line Number	Item ID Description	Approximate Quantity and Units	Unit Price	Bid Amount
0096	643.0800 Traffic Control Arrow Boards	44.000 DAY	_____.	_____.
0098	643.0900 Traffic Control Signs	1,777.000 DAY	_____.	_____.
0100	643.1050 Traffic Control Signs PCMS	28.000 DAY	_____.	_____.
0104	643.5000 Traffic Control	1.000 EACH	_____.	_____.
0106	644.1440 Temporary Pedestrian Surface Matting	500.000 SF	_____.	_____.
0108	644.1601 Temporary Pedestrian Curb Ramp	56.000 DAY	_____.	_____.
0110	644.1605 Temporary Pedestrian Detectable Warning Field	40.000 SF	_____.	_____.
0112	644.1810 Temporary Pedestrian Barricade	40.000 LF	_____.	_____.
0114	646.1020 Marking Line Epoxy 4-Inch	403.000 LF	_____.	_____.
0116	646.5020 Marking Arrow Epoxy	2.000 EACH	_____.	_____.
0118	646.5120 Marking Word Epoxy	2.000 EACH	_____.	_____.
0120	646.6120 Marking Stop Line Epoxy 18-Inch	52.000 LF	_____.	_____.
0122	646.7020 Marking Diagonal Epoxy 6-Inch	175.000 LF	_____.	_____.
0124	646.7420 Marking Crosswalk Epoxy Transverse Line 6-Inch	103.000 LF	_____.	_____.
0126	646.8120 Marking Curb Epoxy	120.000 LF	_____.	_____.
0128	646.8220 Marking Island Nose Epoxy	2.000 EACH	_____.	_____.



Proposal Schedule of Items

Proposal ID: 20231114044 Project(s): 8829-00-71

Federal ID(s): WISC 2024032

SECTION: 0001 Contract Items

Alt Set ID: Alt Mbr ID:

Proposal Line Number	Item ID Description	Approximate Quantity and Units	Unit Price	Bid Amount
0130	650.4000 Construction Staking Storm Sewer	3.000 EACH	_____.	_____.
0132	650.4500 Construction Staking Subgrade	972.000 LF	_____.	_____.
0134	650.5000 Construction Staking Base	972.000 LF	_____.	_____.
0136	650.5500 Construction Staking Curb Gutter and Curb & Gutter	998.000 LF	_____.	_____.
0138	650.9000 Construction Staking Curb Ramps	2.000 EACH	_____.	_____.
0140	650.9500 Construction Staking Sidewalk (project) 01. 8829-00-71	1.000 EACH	_____.	_____.
0142	650.9911 Construction Staking Supplemental Control (project) 01. 8829-00-71	1.000 EACH	_____.	_____.
0144	650.9920 Construction Staking Slope Stakes	325.000 LF	_____.	_____.
0146	654.0102 Concrete Bases Type 2	1.000 EACH	_____.	_____.
0148	655.0640 Electrical Wire Lighting 1 AWG	10.000 LF	_____.	_____.
0150	657.0100 Pedestal Bases	1.000 EACH	_____.	_____.
0152	690.0150 Sawing Asphalt	1,161.000 LF	_____.	_____.
0154	690.0250 Sawing Concrete	12.000 LF	_____.	_____.
0156	ASP.1T0A On-the-Job Training Apprentice at \$5.00/HR	300.000 HRS	5.00000	1,500.00
0158	ASP.1T0G On-the-Job Training Graduate at \$5.00/HR	300.000 HRS	5.00000	1,500.00



Proposal Schedule of Items

Proposal ID: 20231114044 Project(s): 8829-00-71

Federal ID(s): WISC 2024032

SECTION: 0001 Contract Items

Alt Set ID: Alt Mbr ID:

Proposal Line Number	Item ID Description	Approximate Quantity and Units	Unit Price	Bid Amount
0160	SPV.0060 Special 01. Relocate Street Light	1.000 EACH	_____.	_____.
0162	643.3150 Temporary Marking Line Removable Tape 4-Inch	485.000 LF	_____.	_____.
Section: 0001			Total:	_____.
			Total Bid:	_____.